



52G12SW0001 2 16359 ILSLEY

010

HEMLO GOLD MINES INC.
1995 REPORT OF WORK FOR
LINECUTTING, PROSPECTING,
GEOLOGICAL MAPPING AND TRENCHING
ON THE RALEIGH LAKE PROJECT

SUPERIOR DISTRICT

3-16359

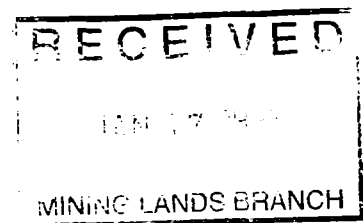

Timmins, Ontario
November, 1995

Bruce MacLachlan
Exploration Technician
Stephen Conquer
Senior Project Geologist

TABLE OF CONTENTS

	<u>Page No.</u>
1.0 Introduction	1
2.0 Location and Access	1
3.0 Property	2
4.0 Ownership	2
5.0 Previous Work	2
6.0 Regional Geology	3
7.0 1994 Work Program	3
7.1 Linecutting	3
7.2 Prospecting and Mapping	4
7.3 Soil Geochemical Survey	5
7.4 Trenching	5
8.0 Conclusions	6



List of Figures

Figure 1 Claim Map

List of Maps

Map 1 Geology Map 1:5,000 scale
Map 2 Trench #1-6 Geology 1:2,000 scale

List of Appendices

Appendix I Rock Assay Certificates
Appendix II List of Personnel and Contractors
Appendix III Sample Descriptions
Appendix IV Soil Sample Certificates

List of Tables

Table 1 Trench Summary Table

1.0 INTRODUCTION

The Raleigh Lake property is contained within the eastern extension of the Dryden-Wabigoon greenstone belt. The main objective of the program was to evaluate an altered/deformed quartz-sericite-schist horizon within a metamorphosed sequence of volcanics and sediments.

The 1995 program consisted of linecutting, prospecting, geological mapping, soil sampling surveys as well as a trenching/channel sampling program.

The best mineralized interval to date was found in trench #2 with returned 314 ppb Au over 6.0 meters including 621 ppb over 1.0 meters from a 40 metre wide alteration zone.

2.0 LOCATION AND ACCESS

The Raleigh Lake property is situated south of the CP railway in Ilsley and Hodgson townships, NTS 52C5. Access is provided by Highway 17 and various logging roads and is approximately 25 kilometers west of Ignace, Ontario.

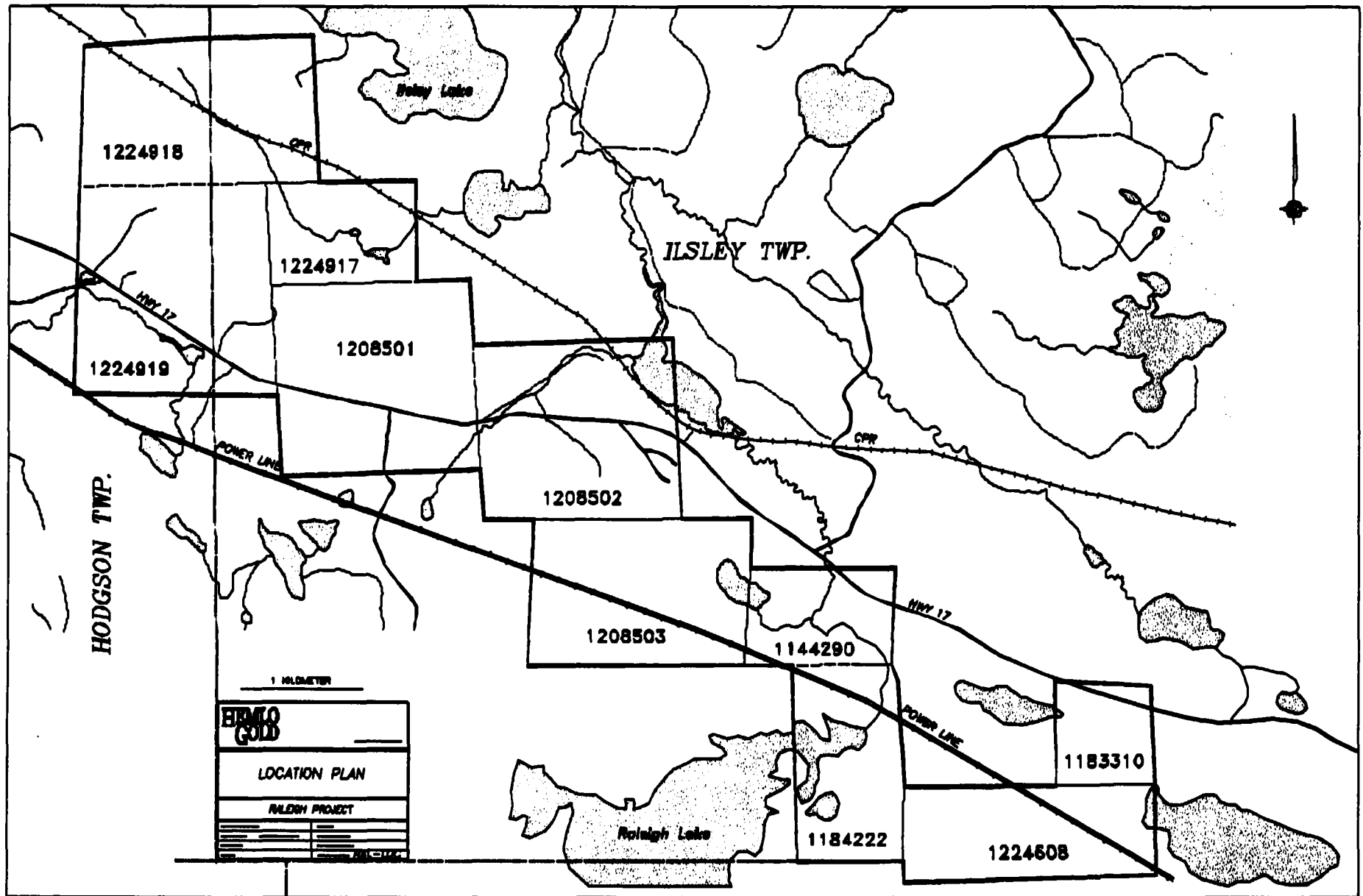

3.0 PROPERTY

The property consists of 10 contiguous unpatent claims whose numbers are as follows:

K1144290	K1208503
K1183310	K1224608
K1184222	K1224917
K1208501	K1224918
K1208502	K1224919

All claims are in good standing and total 110 units.

4.0 OWNERSHIP

Ownership is held by Mick and Steve Stares of Thunder Bay, Ontario.

5.0 PREVIOUS WORK

The area has had no previous exploration and has never been mapped in any detail by government surveys.

6.0 REGIONAL GEOLOGY

The Raleigh Lake property is situated towards the eastern end of the Dryden-Wabigoon greenstone belt. The belt is an easterly trending assemblage of mafic to ultramafic volcanic and intrusive rocks, intercalated with both clastic and chemical sediments. This belt occurs as one of several metavolcanic-metasedimentary supracrustal regimes associated with large granitoid bodies.

7.0 1995 WORK PROGRAM

The 1995 program consisted of linecutting, magnetometer and I.P. surveys, soil geochemistry, prospecting and geological mapping and a trenching/channel sampling program.

7.1 Linecutting

Linecutting was completed over the property where the known quartz-sericite-schist occurs. The grid now covers a strike length of 5.6 kilometers with the majority of the grid having cross lines every 200 metres. In total 13.5 kilometers of grid was cut by Stares Contracting of Thunder Bay, Ontario (Map 1).

7.2 Prospecting and Mapping

Prospecting in conjunction with mapping at 1:5,000 scale was carried out over the entire grid. A total of 66 grab samples were collected for Au analysis of which 9 were for whole rock determinations. The highest assay returned being 560 ppb Au.

The property is underlain by quartz-feldspar-biotite sediments (greywacke) north of the mineralized quartz-sericite-schist and biotite-hornblende rich sediments south of the quartz-sericite-schist. The quartz-sericite-schist, located approximately in the center of the property, was found to be up to 45 metres wide and could be traced intermittently for approximately 4.0 kilometers. This zone is found to contain 2-3% disseminated pyrite and trace amounts of chalcopyrite. The zone strikes at approximately 130 degrees with a south dip of 60°-70°.

Although only observed in one outcrop at the western end of the grid, whole rock analysis suggests that the quartz-sericite-schist at this location may be more altered than what was observed in trenching to the east. Analysis of the rock indicated CaO + Na₂O depletion and K₂O enrichment.

Other areas of interest include some weakly altered sediments near the southern ends of L106E+L108E and a few angular, rusty, pyritic boulders that were observed along the north west shore of a small lake (L110+00E, 103+00N).

7.3 Soil Geochemical Survey

A soil sampling program was carried out over the majority of the property except in the area of the main zone where soil sampling was undertaken in 1994.

A total of 221 soil samples were collected and sent to Chemex Labs for Au analysis. Of the 221 samples collected, only 5 returned a value greater than 5pb Au with highest being 115 ppb Au. Four out of five of the anomalous soils occur at or near the quartz-sericite schist unit.

An additional 136 soil samples had previously been collected in 1994, of which five returned anomalous values up to 135 ppb Au.

All soil results are in appendix IV.

7.4 Trenching

Seven trenches totaling 890 meters were completed along with 131 channel and 10 grab/chip samples. The objective of the trenching program was to: a) better define the quartz-sericite-schist in the center of the property, b) test along linear IP chargeability/resistivity feature and, c) expose the strike extension of anomalous blast rock found along the Trans Canada Pipeline.

Trench Summary Table

Trench	Location	Length	Target	Results
1	99+50E~ 97+80N-101+00N	320m	Quartz-sericite-schist >10m	Altered and mineralized sediments over ~55 meters with a distinctive anomalous gold bearing interval over 25 meters. Best assay 311 ppb Au.
2	96+25E~ 99+70N-101+25N	155m	Strike ext. of TR-1, IP	31 meter wide altered and mineralized zone which contained 314 ppb Au over 6 meters including 621 ppb over 1.0m.
3a, b	93+50E~ 100_00N-100+28N 100+40N-100+85N	28m 25m	Strike ext of TR-2	Weakly altered sediments over 10 meters. No significant assays.
4	96+00E~ 102+85N-104+00N	115m	Long linear IP chargeability/ resistivity feature	Weakly altered and mineralized sediments over 8.0 meters.
5	82+50E 100+40N-102+00N	160m	Strike ext. of anomalous grabs up to 1.5 g/t Au	2 separate zones 1) an altered silicified, pyritic zone which returned 176 ppb over 4.0 meters; 2) an altered quartz flooded zone containing py, cpy, asp. Assays include 176 ppb Au/4.0m.
6	81+70E 100+28N-100+50N	21m	Strike ext. of TR-5	Weak-moderately altered zone 3.0 meters wide. Assays up to 214 ppb Au.
TOTAL		824m		

8.0 CONCLUSIONS

Although no significant assays were returned from the 1995 work program, trenching did indicate a distinctive anomalous quartz-sericite-schist unit that is up to 55 meters wide. Alteration and mineralization appear to weaken to the west, along the main zone, but may continue to the east as this area has extensive swamp coverage.

The most westerly trenches (81+70E) encountered an anomalous zone which was not as wide as the main zone, but was found to be well mineralized with up to 10% sulfides and was moderately sheared over 4.0 metres.

Of the 221 soil samples collected this year, only 5 returned anomalous values. The property has a thick clay layer over most of it and this may be the reason for the poor results. It is important to note that of the five soil samples that were anomalous, four were at or near known mineralization or alteration.

Respectfully Submitted

HEMLO GOLD MINES INC.

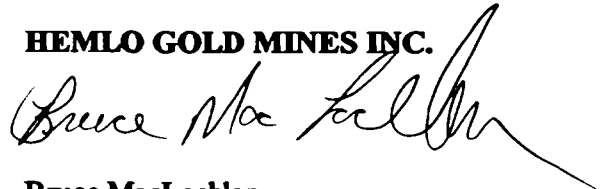

Bruce MacLachlan
Exploration Technician



Stephen Conquer
Exploration Geologist

APPENDIX I
ROCK ASSAY CERTIFICATES



ACCURASSAY LABORATORIES

A DIVISION OF ASSAY LABORATORY SERVICES INC.

1070 LITHIUM DRIVE, UNIT 2
THUNDER BAY, ONTARIO P7B 6G3
PHONE (807) 623-6448
FAX (807) 623-6820

Page 1

HEMLO GOLD MINES INC. - EXPLORATION OFFICE
60 SHIRLEY ST. S.
TIMMINS, ONTARIO
P4N 7J5

September 5, 1995

Job #9541233

ATTENTION: WAYNE REID

Raleigh

Accurassay	Sample #	Customer	Gold ppb	Gold Oz/t
	1	TR-1-1	6	<0.001
	2	TR-1-2	<5	<0.001
	3	TR-1-3	48	0.001
	4	TR-1-4	27	<0.001
	5	TR-1-5	42	0.001
	6	TR-1-6	74	0.002
	7	TR-1-7	311	0.009
	8	TR-1-8	188	0.005
	9	TR-1-9	26	<0.001
	10	TR-1-10	72	0.002
	11	Check TR-1-10	71	0.002
	12	TR-1-11	19	<0.001
	13	TR-1-12	16	<0.001
	14	TR-1-13	20	<0.001
	15	TR-1-14	37	0.001
	16	TR-1-15	39	0.001
	17	TR-1-16	83	0.002
	18	TR-1-17	166	0.005
	19	TR-1-18	63	0.002
	20	TR-1-19	43	0.001
	21	Check TR-1-19	38	0.001
	22	TR-1-20	46	0.001
	23	TR-1-21	61	0.002
	24	TR-1-22	122	0.004
	25	TR-1-23	70	0.002
	26	TR-1-24	16	<0.001
	27	TR-1-25	36	0.001
	28	TR-1-26	46	0.001

Certified By:

Bob Bever



ACCURASSAY LABORATORIES

A DIVISION OF ASSAY LABORATORY SERVICES INC.

1070 LITHIUM DRIVE, UNIT 2
THUNDER BAY, ONTARIO P7B 6G3
PHONE (807) 623-6448
FAX (807) 623-6820

Page 2

HEMLO GOLD MINES INC. - EXPLORATION OFFICE
60 SHIRLEY ST. S.
TIMMINS, ONTARIO
P4N 7J5

September 5, 1995

Job #9541233

ATTENTION: WAYNE REID

Accurassay	Sample #	Customer	Gold ppb	Gold Oz/t
	29	TR-1-27	47	0.001
	30	TR-1-28	45	0.001
	31 Check	TR-1-28	39	0.001
	32	TR-1-29	84	0.002
	33	TR-1-30	20	<0.001
	34	TR-1-31	52	0.002

*total 2067 ppb
29 m = 71 ppb.*

Certified By: _____

[Handwritten Signature]



ACCURASSAY LABORATORIES

A DIVISION OF ASSAY LABORATORY SERVICES INC.

1070 LITHIUM DRIVE, UNIT 2
THUNDER BAY, ONTARIO P7B 6G3
PHONE (807) 623-6448
FAX (807) 623-6820

Page 1

HEMLO GOLD MINES INC.-EXPLORATION OFFICE
60 SHIRLEY ST. S.
TIMMINS, ONTARIO
P4W 7J5

September 7, 1995

Job #9541255

ATTENTION: WAYNE REID

PROJECT #: 471

Accurassay	Sample # Customer	Gold ppb	Gold Oz/t
	1 TR-1-32	14	<0.001
	2 TR-1-33	41	0.001
	3 TR-1-34	23	<0.001
	4 TR-1-35	35	0.001
	5 TR-1-36	9	<0.001
	6 TR-1-37	9	<0.001
	7 TR-1-38	7	<0.001
	8 TR-1-39	10	<0.001
	9 TR-1-40	12	<0.001
	10 TR-1-41	16	<0.001
	11 Check TR-1-41	13	<0.001
	12 TR-1-42	14	<0.001
	13 TR-1-43	23	<0.001
	14 TR-1-44	15	<0.001
	15 TR-1-45	9	<0.001
	16 TR-1-46	<5	<0.001
	17 TR-1-47	5	<0.001
	18 TR-1-48	<5	<0.001
	19 TR-1-49	24	<0.001

Certified By: _____

W. Bever



ACCURASSAY LABORATORIES

A DIVISION OF ASSAY LABORATORY SERVICES INC.

1070 LITHIUM DRIVE, UNIT 2
THUNDER BAY, ONTARIO P7B 6G3
PHONE (807) 623-6448
FAX (807) 623-6820

Page 1

HEMLO GOLD MINES INC. EXPLORATION OFFICE
P.O. BOX 1205, 60 SHIRLEY ST. S.
TIMMINS, ONTARIO
P4N 7J5

September 11, 1991

Job #9541284

PROJECT # 471

ATTENTION: WAYNE REID

Accurassay	Sample # Customer	Gold ppb	Gold Oz/t
	1 TR-1-50	<5	<0.001
	2 TR-2-1	9	<0.001
	3 TR-2-2	6	<0.001
	4 TR-2-3	12	<0.001
	5 TR-2-4	8	<0.001
	6 TR-2-5	18	<0.001
	7 TR-2-6	55	0.002
	8 TR-2-7	24	<0.001
	9 TR-2-8	8	<0.001
	10 TR-2-9	11	<0.001
	11 CHECK TR-2-9	14	<0.001
	12 TR-2-10	<5	<0.001
	13 TR-2-11	<5	<0.001
	14 TR-2-12	21	<0.001
	15 TR-2-13	12	<0.001
	16 TR-2-14	13	<0.001
	17 TR-2-15	160	0.005
	18 TR-2-16	<5	<0.001
	19 TR-2-17	<5	<0.001
	20 TR-2-18	16	<0.001
	21 CHECK TR-2-18	19	<0.001
	22 TR-2-19	50	0.001
	23 TR-2-20	9	<0.001
	24 TR-2-21	20	<0.001
	25 TR-2-22	33	<0.001
	26 TR-2-23	26	<0.001
	27 TR-2-24	13	<0.001
	28 TR-2-25	12	<0.001

Certified By:

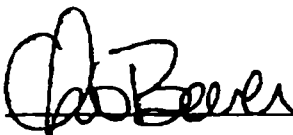



ACCURASSAY LABORATORIES

A DIVISION OF ASSAY LABORATORY SERVICES INC.

1070 LITHIUM DRIVE, UNIT 2
THUNDER BAY, ONTARIO P7B 6G3
PHONE (807) 623-6448
FAX (807) 623-6820

Page 2

HEMLO GOLD MINES INC. EXPLORATION OFFICE
P.O. BOX 1205, 60 SHIRLEY ST. S.
TIMMINS, ONTARIO
P4H 7J5

September 11, 1995

Job #9541284

PROJECT # 471

ATTENTION: WAYNE REID

Accurassay	Sample # Customer	Gold ppb	Gold Oz/t	
	29	TR-2-26	247	0.007
	30	TR-2-27	<5	<0.001
	31 CHECK	TR-2-27	<5	<0.001
	32	TR-2-28	<5	<0.001
	33	TR-2-29	<5	<0.001
	34	TR-2-30	16	<0.001
	35	TR-2-31	35	0.001
	36	TR-2-32	53	0.002
	37	TR-2-33	107	0.003
	38	TR-2-34	532	0.016
	39	TR-2-35	621	0.018
	40	TR-2-36	210	0.006
	41 CHECK	TR-2-36	200	0.006
	42	TR-2-37	216	0.006
	43	TR-2-38	<5	<0.001
	44	TR-2-39	16	<0.001
	45	TR-2-40	31	<0.001
	46	TR-2-41	12	<0.001

1806
6 = 314 ppb

Certified By: _____

Bob Bever



ACCURASSAY LABORATORIES

A DIVISION OF ASSAY LABORATORY SERVICES INC.

1070 LITHIUM DRIVE, UNIT 2
THUNDER BAY, ONTARIO P7B 6G3
PHONE (807) 623-6448
FAX (807) 623-6820

Page 1

HEMLO GOLD MINES INC. EXPLORATION OFFICE
P.O. BOX 1205, 60 SIRLEY ST. S.
TIMMINS, ONTARIO
P4N 7J5

September 12, 1995

Job #9541301

PROJECT # 471

ATTENTION: WAYNE REED

Accurassay	Sample # Customer	Gold ppb	Gold Oz/t
	1 TR-2-42	28	<0.001
	2 TR-3-12	13	<0.001
	3 TF-3-13	15	<0.001
	4 TF-4-7	<5	<0.001
	5 TR-4-8	<5	<0.001
	6 TR-4-9	15	<0.001
	7 TR-4-10	8	<0.001
	8 TR-1-11	<5	<0.001
	9 TR-4-12	<5	<0.001
	10 TR-4-13	<5	<0.001
	11 CHECK TR-4-13	<5	<0.001
	12 TR-4-14	<5	<0.001
	13 TR-5-9	14	<0.001
	14 TR-5-10	40	0.001
	15 TR-5-11	7	<0.001
	16 TR-3-12	6	<0.001
	17 TR-5-13	9	<0.001
	18 TR-5-14	<5	<0.001
	19 TR-5-15	16	<0.001
	20 TR-5-16	12	<0.001
	21 CHECK TR-5-16	10	<0.001
	22 TR-5-17	67	0.002
	23 TR-5-18	8	<0.001

Certified By:





ACCURASSAY LABORATORIES

A DIVISION OF ASSAY LABORATORY SERVICES INC.

1070 LITHIUM DRIVE, UNIT 2
THUNDER BAY, ONTARIO P7B 6G3
PHONE (807) 623-6448
FAX (807) 623-6820

Page 1

HEMLO GOLD MINES INC. EXPLORATION OFFICE
P.O. BOX 1205, 60 SHIRLEY ST. S.
TIMMINS, ONTARIO
P4W 7J5

September 11, 1995

Job #9541283

PROJECT # 471

ATTENTION: WAYNE REID

Accurassay	Sample # Customer	Gold ppb	Gold Oz/t
	1 TR-3-1	<5	<0.001
	2 TR-3-2	<5	<0.001
	3 TR-3-3	6	<0.001
	4 TR-3-4	<5	<0.001
	5 TR-3-5	6	<0.001
	6 TR-3-6	<5	<0.001
	7 TR-3-7	<5	<0.001
	8 TR-3-8	<5	<0.001
	9 TR-3-9	13	<0.001
	10 TR-3-10	9	<0.001
	11 CHECK TR-3-10	<5	<0.001
	12 TR-3-11	<5	<0.001
	13 TR-4-1	<5	<0.001
	14 TR-4-2	<5	<0.001
	15 TR-4-3	<5	<0.001
	16 TR-4-4	<5	<0.001
	17 TR-4-5	<5	<0.001
	18 TR-4-6	<5	<0.001
	19 TR-5-1	340	0.010
	20 TR-5-2	163	0.005
	21 CHECK TR-5-2	135	0.004
	22 TR-5-3	167	0.005
	23 TR-5-4	33	<0.001
	24 TR-5-5	30	<0.001
	25 TR-5-6	51	0.001
	26 TR-5-7	213	0.006
	27 TR-5-8	151	0.004
	28 TR-6-1	30	<0.001

Certified By: _____

Rob Bauer



Chemex Labs Ltd.

Analytical Chemists * Geochemists * Registered Assayers
5175 Timberlea Blvd., Mississauga
Ontario, Canada L4W 2S3
PHONE: 905-624-2006 FAX: 905-624-6163

HEMLO GOLD MINES INC.

P.O. BOX 1205, 60 SHIRLEY ST. S.
TIMMINS, ON
P4N 7J5

Project: 471
Comments: ATN: B. MACLACHLAN

Page Num: 1-A
Total Pages: 1
Certificate Date: 05-OCT-95
Invoice No.: 19529295
P.O. Number:
Account: DHG

CERTIFICATE OF ANALYSIS A9529295

SAMPLE	PREP		Ag	Al	As	Ba	Be	Bi	Ca	Cd	Co	Cr	Cu	Fe	Ga	Hg	K	La	Mg	Mn	Mo
	CODE		ppm	%	ppm	ppm	ppm	ppm	%	ppm	ppm	ppm	ppm	%	ppm	ppm	%	ppm	%	ppm	ppm
TR 510	205	226	< 0.2	0.16	2	10	< 0.5	4	1.90	< 0.5	24	203	729	2.20	< 10	< 1	< 0.01	< 10	0.32	200	6
TR 519	205	226	< 0.2	0.72	< 2	10	< 0.5	2	1.94	< 0.5	35	120	1135	2.90	< 10	< 1	0.05	10	0.55	225	< 1

CERTIFICATION: _____



Chemex Labs Ltd.

Analytical Chemists * Geochemists * Registered Assayers
5175 Timberlea Blvd., Mississauga
Ontario, Canada L4W 2S3
PHONE: 905-624-2806 FAX: 905-624-6163

HEMLO GOLD MINES INC.

P.O. BOX 1205, 60 SHIRLEY ST. S.
TIMMINS, ON
P4N 7J5

Project: 471
Comments: ATN: B. MACLACHLAN

Page Num : 1-B
Total Pages : 1
Certificate Date: 05-OC1-85
Invoice No. : 19529295
P.O. Number :
Account : DHG

CERTIFICATE OF ANALYSIS

A9529295

SAMPLE	PREP		Na	Ni	P	Pb	Sb	Sc	Sr	Ti	Tl	U	V	W	Zn
	CODE		%	ppm	ppm	ppm	ppm	ppm	ppm	%	ppm	ppm	ppm	ppm	ppm
TR 510	205	226	0.03	58	400	< 2	2	2	9	0.05	< 10	< 10	7	< 10	6
TR 519	205	226	0.10	69	30	< 2	2	7	12	0.16	< 10	< 10	45	< 10	12

CERTIFICATION: _____

ACCURASSAY LABORATORIES
A DIVISION OF ASSAY LABORATORY SERVICES INC.

1070 LITHIUM DRIVE, UNIT 2
THUNDER BAY, ONTARIO P7B 6G3
PHONE (807) 623-6448
FAX (807) 623-6820

Page 2

HEMLO GOLD MINES
60 SHIRLEY ST.
TIMMINS, ONTARIO
P4N 7J5

June 27, 1995

Job #954800
Project # 471

Accurassay	Sample #	Customer	Gold ppb	Gold Oz/t
29		2403-J		
30		2403-K	<5	<0.001
31	Check	2403-K	<5	<0.001
32		2403-L	<5	<0.001
33		2403-M	560	0.016
34		2403-N	<5	<0.001
			5	<0.001

Certified By:

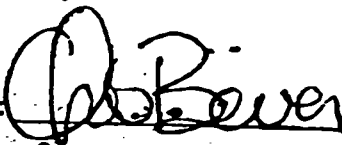



ACCURASSAY LABORATORIES

A DIVISION OF ASSAY LABORATORY SERVICES INC.

1070 LITHIUM DRIVE, UNIT 2
THUNDER BAY, ONTARIO P7B 6G3
PHONE (807) 623-6448
FAX (807) 623-6820

Page 1

HEMLO GOLD MINES INC. EXPLORATION OFFICE
P.O. BOX 1205, 60 SHIRLEY ST. S.
TIMMINS, ONTARIO
P4M 7J5

July 5, 1995

Job #954868

ATTENTION: WAYNE REID

Accurassay	Sample #	Customer	Gold ppb	Gold Oz/t
	1	2402-M	<5	<0.001
	2	2402-N	9	<0.001
	3	2402-O	<5	<0.001
	4	2402-P	<5	<0.001
	5	2406-A	61	0.002
	6 CHECK	2406-A	35	0.001

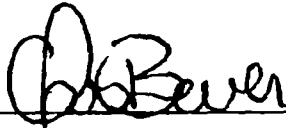
Certified By: 



ACCURASSAY LABORATORIES

A DIVISION OF ASSAY LABORATORY SERVICES INC.

1070 LITHIUM DRIVE, UNIT 2
 THUNDER BAY, ONTARIO P7B 6G3
 PHONE (807) 623-6448
 FAX (807) 623-6820

Page 1

HEMLO GOLD MINES INC. EXPLORATION OFFICE
 P.O. BOX 1205, 60 SHIRLEY ST. SOUTH
 TIMMINS, ONTARIO
 P4W 7J5

July 4, 1995

Job #954847

ATTENTION: WAYNE REID

PROJECT # 471

Accurassay	Sample #	Customer	Gold ppb	Gold Oz/t
	1	2402-I		
	2	2402-J	17	<0.001
	3	2402-K	13	<0.001
	4	2402-L	<5	<0.001
	5	2404-E	57	0.002
	6	2404-F	6	<0.001
	7	2404-G	9	<0.001
	8	2404-H	8	<0.001
	9	2404-I	19	<0.001
	10	2404-J	<5	<0.001
	11 CHECK	2404-J	6	<0.001
	12	2404-K		
	13	2404-L	<5	<0.001
	14	2404-M	<5	<0.001
	15	2404-N	<5	<0.001
	16	2404-O	<5	<0.001
	17	2404-P	7	<0.001
			<5	<0.001

Zoleryl

Certified By: *Bob Bauer*

ACCURASSAY LABORATORIES
 A DIVISION OF ASSAY LABORATORY SERVICES INC.

1070 LITHIUM DRIVE, UNIT 2
 THUNDER BAY, ONTARIO P7B 6G3
 PHONE (807) 623-6448
 FAX (807) 623-6820

Page 1

HEMLO GOLD MINES
 60 SHIRLEY ST.
 TIMMINS, ONTARIO
 P4N 7J5

June 27, 1995

Job #954800
 Project # 471

Accurassay	Sample #	Customer	Gold ppb	Gold Oz/t
	1	2401-A		
	2	2401-B	5	<0.001
	3	2401-C	10	<0.001
	4	2401-D	9	<0.001
	5	2401-E	<5	<0.001
	6	2401-F	17	<0.001
	7	2401-G	9	<0.001
	8	2401-H	<5	<0.001
	9	2401-I	<5	<0.001
	10	2401-J	14	<0.001
	11	Check 2401-J	6	<0.001
	12	2401-K	8	<0.001
	13	2401-L	11	<0.001
	14	2401-M	11	<0.001
	15	2402-A	15	<0.001
	16	2402-B	<5	<0.001
	17	2402-C	<5	<0.001
	18	2402-D	<5	<0.001
	19	2403-A	<5	<0.001
	20	2403-B	<5	<0.001
	21	Check 2403-B	<5	<0.001
	22	2403-C	<5	<0.001
	23	2403-D	30	0.001
	24	2403-E	15	<0.001
	25	2403-F	<5	<0.001
	26	2403-G	6	<0.001
	27	2403-H	<5	<0.001
	28	2403-I	5	<0.001
			<5	<0.001

Certified By:

Bob Bauer

1070 LITHIUM DRIVE, UNIT 2
THUNDER BAY, ONTARIO P7B 6G3
PHONE (807) 623-6448
FAX (807) 623-6820

Page 1

HEMLO GOLD MINES INC. EXPLORATION OFFICE
P.O. BOX 1205, 60 SHIRLEY ST. S.
TIMMINS, ONTARIO
P4N 7J5

July 14, 1995

Job #954829

PROJECT # 471

ATTENTION: WAYNE REID

Sample #	SiO2 %	Al2O3 %	Fe2O3 %	MgO %	CaO %	Na2O %	K2O %	P2O5 %	TiO2 %	MnO %	BaO %	Cr2O3 %	SrO %	LOI %	Total %
2401-D	73.38	12.87	1.16	0.50	1.21	1.54	4.4	0.129	0.080	0.014	0.094	0.075	0.012	1.2	96.7
2404-C	74.38	10.66	1.59	0.53	1.74	1.05	2.2	0.084	0.053	0.042	0.056	0.110	0.013	1.3	93.8

Certified By:

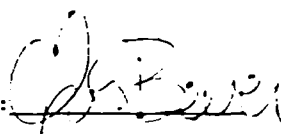



ACCURASSAY LABORATORIES

A DIVISION OF ASSAY LABORATORY SERVICES INC.

1070 LITHIUM DRIVE, UNIT 2
THUNDER BAY, ONTARIO P7B 6G3
PHONE (807) 623-6448
FAX (807) 623-6820

Page 1

MENLO GOLD MINES INC. EXPLORATION OFFICE
P.O. BOX 1205, 60 SHIRLEY ST. S.
TIMMINS, ONTARIO
P4N 7J5

July 21, 1995

Job #954847

PROJECT # 471

ATTENTION: WAYNE REID

Sample #	SiO2 %	Al2O3 %	Fe2O3 %	MgO %	CaO %	Na2O %	K2O %	P2O5 %	TiO2 %	MnO %	BaO %	Cr2O3 %	SrO %	LOI %	Total %
2402-I	74.57	11.74	1.86	0.67	0.79	1.73	2.54	0.034	0.059	0.012	0.025	0.097	0.006	2.0	96.1
2402-K	74.99	12.99	0.97	0.47	2.07	4.68	1.26	0.039	0.038	0.017	0.019	0.158	0.006	0.6	98.3
2402-L	74.10	12.75	1.66	0.60	2.03	3.20	3.05	0.021	0.104	0.027	0.048	0.190	0.014	1.0	98.8
2404-J	51.31	13.68	10.68	7.06	15.68	1.31	0.31	0.182	0.752	0.225	0.003	0.107	0.017	1.2	102.5
2404-K	63.35	13.39	3.87	3.14	5.94	2.02	1.37	0.193	0.429	0.046	0.026	0.054	0.031	1.7	95.6
2404-M	65.04	14.79	3.29	2.26	7.25	2.23	2.16	0.289	0.484	0.054	0.077	0.097	0.032	1.1	99.2
2404-C	65.04	14.24	4.48	2.07	4.71	2.62	1.72	0.314	0.437	0.051	0.045	0.087	0.032	1.8	97.6

Certified By:

John Bever



ACCURASSAY LABORATORIES

A DIVISION OF ASSAY LABORATORY SERVICES INC.

1070 LITHIUM DRIVE, UNIT 2
THUNDER BAY, ONTARIO P7B 6G3
PHONE (807) 623-6448
FAX (807) 623-6820

Page 1

HENLO GOLD MINES INC. EXPLORATION OFFICE
P.O. BOX 1205, 60 SHIRLEY ST. S.
TIMMINS, ONTARIO
P4N 7J5

July 21, 1995

Job #954868

ATTENTION: WAYNE REID

Sample #	SiO ₂	Al ₂ O ₃	Fe ₂ O ₃	MgO	CaO	Na ₂ O	K ₂ O	P ₂ O ₅	TiO ₂	MnO	BaO	Cr ₂ O ₃	SrO	LOI	Total
	%	%	%	%	%	%	%	%	%	%	%	%	%	%	%
<i>all sed</i> 2402-M	63.18	13.86	3.84	0.95	3.04	3.48	1.5	0.201	0.236	0.059	0.031	0.277	0.032	1.9	92.6
<i>all per?</i> 2402-M	71.40	13.78	3.17	1.70	2.90	2.53	2.3	0.205	0.340	0.067	0.042	0.197	0.039	1.9	100.6

Certified By:



APPENDIX II

PERSONNEL

Name

Title

Stephen Conquer

Senior Geologist

Bruce MacLachlan

Exploration Technician

Dave Truscott

Geologist

Ray Gardner

Field Assistant

Contractors

Operation

Steve Hammer (Belham Ltd.)

Backhoe Operator

Stares Contracting

Linecutting

Val d'Or Geophysics Ltd.

I.P. and Mag. Surveys

APPENDIX III
SAMPLE DESCRIPTIONS

CHANNEL SAMPLES

SAMPLE#	PPB	WIDTH	DESCRIPTION
TR1-1	6	1.1m	intrusive?, alt por, tr py, minor qtz vein
TR1-2	5	0.9m	mafic dyke
TR1-3	48	1.0m	alt sed
TR1-4	27	1.0m	alt sed, ser-sch, sil
TR1-5	42	1.0m	qtz-ser-sch, 2% py, sil
TR1-6	74	1.0m	qtz-ser-sch, 5% py, tr cpy
TR1-7	311	1.0m	qtz-ser-sch, 5% py, tr cpy
TR1-8	188	1.0m	qtz-ser-sch, 5% py, tr cpy
TR1-9	26	1.0m	qtz-ser-sch, 5% py, tr cpy
TR1-10	72	1.0m	qtz-ser-sch, 5% py, tr cpy
TR1-11	19	1.0m	qtz-ser-sch, 5% py, tr cpy
TR1-12	16	1.0m	qtz-ser-sch, 5% py, tr cpy
TR1-13	20	1.0m	qtz-ser-sch, 5% py, tr cpy
TR1-14	37	1.0m	qtz-ser-sch, 5% py, tr cpy
TR1-15	39	1.0m	qtz-ser-sch, 2% py
TR1-16	83	1.0m	qtz-ser-sch, 5% py
TR1-17	166	1.0m	qtz-ser-sch, 1-2% py
TR1-18	63	1.0m	qtz-ser-sch, 1-2% py
TR1-19	43	1.0m	alt sed, green color, 1% py, 10% qtz
TR1-20	46	1.0m	alt sed/qtz-ser-sch, 2% py
TR1-21	61	1.0m	qtz-ser-sch, 20cm mafic dyke
TR1-22	122	1.0m	qtz-ser-sch, 2% py
TR1-23	70	1.0m	qtz-ser-sch, 2% py
TR1-24	16	1.0m	qtz-ser-sch, 2% py
TR1-25	36	1.0m	alt sed, 1% py
TR1-26	46	1.0m	qtz-ser-sch, 1% py
TR1-27	47	1.0m	qtz-ser-sch, 2-3% py
TR1-28	45	0.8m	qtz-ser-sch, 1-2% py
TR1-29	84	.45m	qtz-ser-sch, 5% py
TR1-30	20	1.1m	mafic dyke

CHANNEL SAMPLES

SAMPLE#	PPB	WIDTH	DESCRIPTION
TR1-31	52	1.0m	qtz-ser-sch,2-3% py
TR1-32	14	1.0m	qtz-ser-sch,2-3% py
TR1-33	41	1.0m	qtz-ser-sch,2-3% py
TR1-34	23	0.5m	qtz-ser-sch,2-3% py
TR1-35	35	1.0m	alt sed, tr-1% py
TR1-36	9	1.0m	weakly sheared, alt sed, tr-1% py
TR1-37	9	1.0m	weakly sheared, alt sed, tr-1% py
TR1-38	7	1.0m	weakly sheared, alt sed, tr-1% py
TR1-39	10	1.0m	weakly sheared, alt sed, 2-3% py
TR1-40	12	1.0m	weakly alt sed, tr py
TR1-41	16	1.0m	weakly alt sed, tr py
TR1-42	14	1.0m	weakly alt sed, tr py
TR1-43	23	1.0m	weakly alt sed, tr py
TR1-44	15	1.0m	weakly alt sed, tr py
TR1-45	9	1.0m	weakly alt sed, tr py
TR1-46	5	1.0m	weakly alt sed, tr py
TR1-47	5	1.0m	weakly alt sed, tr py
TR1-48	5	1.0m	weakly alt sed, tr py
TR1-49	24	1.0m	weakly alt sed, tr py
TR1-50	5	grab	rusty sed, tr py

CHANNEL SAMPLES

SAMPLE#	PPB	WIDTH	DESCRIPTION
TR2-1	9	1.0m	greywacke
TR2-2	6	1.0m	greywacke
TR2-3	12	1.0m	greywacke
TR2-4	8	0.7m	greywacke
TR2-5	18	1.0m	greywacke
TR2-6	55	0.8m	alt sed,1-2% py
TR2-7	24	1.0m	alt sed,qtz-carb str
TR2-8	8	1.0m	greywacke,tr py
TR2-9	11	0.8m	greywacke,tr py
TR2-10	5	1.2m	weakly alt sed,garnets
TR2-11	5	1.0m	alt sed
TR2-12	21	1.0m	alt sed,1% py
TR2-13	12	0.8m	greywacke,tr py
TR2-14	13	1.2m	mafic dyke
TR2-15	160	0.6m	ser-sch/alt sed,2% py
TR2-16	5	1.0m	hornblend,biotite sed
TR2-17	5	1.0m	mafic dyke
TR2-18	16	1.0m	alt sed, tr py
TR2-19	50	1.0m	alt sed, 1-2% py, massive py locally
TR2-20	9	1.0m	alt greywacke,tr py
TR2-21	20	1.0m	alt greywacke, 5% py
TR2-22	33	1.0m	alt greywacke,2% py
TR2-23	26	1.0m	alt greywacke,2% py
TR2-24	13	1.0m	alt greywacke,tr py
TR2-25	12	1.0m	alt sed
TR2-26	247	1.0m	alt sed/ser-sch, 1-2% py
TR2-27	5	1.0m	mafic dyke
TR2-28	5	1.0m	alt sed, minor qtz veining
TR2-29	5	1.0m	alt sed
TR2-30	16	1.0m	alt sed,2-3% py

CHANNEL SAMPLES

SAMPLE#	PPB	WIDTH	DESCRIPTION
TR2-31	35	1.0m	alt sed, minor qtz str, 1% py
TR2-32	53	1.0m	alt sed, minor qtz str, 1% py
TR2-33	107	1.0m	alt sed, 3-5% dis py, qtz str
TR2-34	532	1.0m	alt sed, massive py locally, 1-2% dis py
TR2-35	621	1.0m	alt sed, massive py locally, 2-3% dis py
TR2-36	210	1.0m	alt sed, massive py locally, 2-3% dis py
TR2-37	216	1.0m	greywacke, tr py
TR2-38	5	1.0m	greywacke, tr py
TR2-39	16	1.0m	greywacke, tr py
TR2-40	31	1.0m	greywacke, tr py
TR2-41	12	0.6m	greywacke, tr py
TR2-42	28	grab	rusty greywacke, tr py

CHANNEL SAMPLES

SAMPLE#	PPB	WIDTH	DESCRIPTION
TR3-1		5 1.0m	weakly alt greywacke
TR3-2		5 1.0m	weakly alt greywacke
TR3-3		6 1.0m	weakly alt greywacke
TR3-4		5 1.0m	weakly alt greywacke
TR3-5		6 1.0m	weakly alt greywacke
TR3-6		5 1.0m	weakly alt greywacke
TR3-7		5 1.0m	weakly alt greywacke
TR3-8		5 1.0m	weakly alt greywacke
TR3-9		13 1.0m	weakly alt greywacke
TR3-10		9 0.6m	weakly alt greywacke
TR3-11		5 grab	(tr-3b) rusty sed, qtz veining
TR3-12		grab	(tr-3b) rusty sed

CHANNEL SAMPLES

SAMLPE#	PPB	WIDTH	DESCRIPTION
TR4-1		5 1.0m	weakly alt greywacke
TR4-2		5 0.6m	alt greywacke/ser-sch, 1% py
TR4-3		5 1.0m	weakly alt greywacke
TR4-4		5 1.0m	weakly alt greywacke
TR4-5		5 1.0m	mod alt greywacke, 1% py rusty
TR4-6		5 1.0m	weakly alt greywacke
TR4-7		5 1.0m	weakly alt greywacke
TR4-8		5 1.0m	weakly alt greywacke, tr py
TR4-9		15 1.0m	weakly alt greywacke, tr py
TR4-10		8 1.0m	mod alt greywacke, rusty, tr-1% py
TR4-11		5 1.0m	mod alt greywacke, rusty, tr-1% py
TR4-12		5 1.0m	mod alt greywacke, rusty, tr-1% py
TR4-13		5 1.0m	weakly alt sed, tr py
TR4-14		5 1.2m	weakly alt sed, tr py, minor rust

CHANNEL SAMPLES

SAMPLE#	PPB		DESCRIPTION
TR5-1	340	1.0m	alt sed, sil, 5-10% py
TR5-2	163	1.0m	alt sed, sil, 5-10% py
TR5-3	167	1.0m	alt sed, sil, 5-10% py
TR5-4	33	1.0m	alt sed, sil, 5-10% py
TR5-5	30	grab	alt sed, sil, 5-10% py
TR5-6	51	grab	alt sed, sil, 5-10% py
TR5-7	213	grab	alt sed, sil, 5-10% py
TR5-8	151	soil	rusty soil
TR5-9	14	1.0m	weakly alt greywacke
TR5-10	40	1.0m	rusty qtz, 2-3%py, 1%asp, tr cpy
TR5-11	7	1.0m	alt sed, tr-1% py/asp
TR5-12	6	1.0m	alt sed, tr-1% py/asp
TR5-13	9	1.0m	alt sed, tr-1% py/asp
TR5-14	5	0.8m	alt sed, tr-1% py/asp
RE5-15	16	.75m	greywacke
TR5-16	12	.45m	greywacke
TR5-17	10	.55m	weakly alt greywacke, minor rust
TR5-18	67	.55m	greywacke
TR5-19	8	1.2m chip	90% qtz, 2-3% asp, tr cpy, 1% py

CHANNEL SAMPLES

SAMPLE#	PPB	WIDTH	DESCRIPTION
TR6-1	30	1.0m	alt greywacke, rusty, tr-1% py
TR6-2	10	1.0m	alt greywacke, rusty, tr-1% py
TR6-3	21	1.0m	alt greywacke, rusty, tr-1% py
TR6-4	214	grab	silicified sed, 1% py

06

HIMLO GOLD MINES IN - SAMPLE RECORD SHEET

Project Name: Redeigh Number: 471 District: Superior
 Date: July 95 Sampler: Bm N.T.S.: _____

SAMPLE #	AU P.P.B.	AU O.P.T.	W.R.	ICP		NORTHING	EASTING	SAMPLE DESCRIPTION
A	✓ 61					100775 _N	98720 _E	rusty Qtz-eye schist.
B	✓					97190N	96490E	siliceous, banded sediment 15-20% py
C	✓					97190N	96485N	siliceous, banded sediment- 3-5% py
D					stray sed	103110N	96405E	.
E								
F								
G								
H								
I								
J								
K								
L								
M								
N								
O								

2401

HEMLO GOLD MINES INC - SAMPLE RECORD SHEET

Project Name: RoLeighNumber: 471District: SuperiorDate: June 24/95Sampler: Bm/DT

N.T.S.:

SAMPLE #	AU P.P.B.	AU O.P.T.	W.R.	ICP	Rep	NORTHING	EASTING	SAMPLE DESCRIPTION
A	✓ 5					100100N	90105E	rusty biotitic sed 2-3% py Qtz str
B	✓ 10					100185N	100125E	rusty biotitic sed 1% py Qtz Blobs.
C	✓ 9					100190N	9200E	Qtz Boulders in sed 1% py, 2-3% po
D	✓ 25		✓		✓	101100N	93130E	Qtz Por? shered/Altered ser
E	✓ 17					101100N	93130E	rusty sed 2-3% po, py
F	✓ 9					101100N	93130E	Qtz - Fsp sed
G	✓ 25				✓	101100N	93155E	alt sed Qtz eyes Qtz str rusty
H	✓ 25				✓	101100N	9380E	rusty Qtz Boulder 1% py
I	✓ 14					100195N	9380E	rusty sed Biotitic 1% po, py
J	✓ 6				✓	101100N	9383E	rusty Biotitic sed Qtz str to py
K	✓ 11					101102N	9380E	rusty Bio/sed
L	✓ 11				✓	101100N	9390E	Qtz/carb Boulder 2-3% po, py
M	✓ 15					10100N	9405E	Qtz + sed Boulder to po py rusty.
N	✓					100170N	84150E	Qtz vein minor rust.
O	✓		✓		✓	100170N	84150E	Qtz eye schist Qtz str.

2092

HIMLO GOLD MINES INC - SAMPLE RECORD SHEET

Project Name: RaleighNumber: 471District: Superior

2402

Date: June 25Sampler: DT

N.T.S.:

SAMPLE #	AU P.P.B.	AU O.P.T.	W.R.	ICP	Rep	NORTHING	EASTING	SAMPLE DESCRIPTION
A	✓ 25					102+25	98+00	qtz-fsp-bt sed, tr py, beds separated by thin chloritic bands, dk to med grey
B	✓ 25		✓			101+55	98+00	mg unformed. intrusive (diabrite?) tr. fsp py
C	✓ 25			✓		101+55	98+00	qtz-fsp-bt sediment (qtz eye schist?) "the zone" shd(?) sld(?) ser'd(?) @ intrusive etc.
D	✓ 25					98+00	95+75	bt-hb sediment, conformed rose quartz ms. 1-2 mm wide semi-massive py bands // bedding in bt-rich beds
E	✓				✓	W side of Hwy 96+75N	82+00E	rusty bio-hn blende sed tr. tr. py.
F	✓				✓	W side of Hwy 96+75	82+00E	propylitic? 2-3% py rusty
G	✓					" 96+75	82+00E	rusty propylitic tr. py
H	✓				✓	S side of Hwy 94+65	78+75E	" " "
I	✓ 17		✓		✓	100+60N	61+65E	Qtz-ser-schist .4m wide rusty 2-3% d= py
J	✓ 13					100+60N	61+65E	Qtz-ser-sch tr. py .3m wide.
K	✓ 25		✓		✓	93+15N	63+75E	alt w/ sed, fine gr. rusty, tr. py and Boulders.
L	✓ 57		✓			93+10N	63+85E	alt sed, Boulders
M	✓ 25		✓			100+03N	86+50E	wreakly alt Qtz-eye sch.
N	✓ 9		✓			100+10N	86+50E	wreakly alt porphyry
O	✓ 25					101+00N	90+00E	rusty - Qtz-eye sch tr. py
P	✓ 25					98+75N	92+00E	alt Bio-hn blende sed. tr. py massive silicification.

2 13

HEMLO GOLD MINES IN - SAMPLE RECORD SHEET

Project Name: Raleigh Number: 471 District: Superior
 Date: June 95 Sampler: BM N.T.S.:

2403

SAMPLE #	AU P.P.B.	AU O.P.T.	W.R.	ICP	RD	NORTHING	EASTING	SAMPLE DESCRIPTION
A	✓ 25					98100N	98100E	rusty Biotite / Hornblende sed
B	✓ 25					98100N	101100E	rusty bio sed 2% py
C	✓ 30			33	✓	100100N	99150E	Qtz eye schist rusty 2-3% py
D	✓ 15				✓	100105N	99135E	Qtz eye schist stn py rusty.
E	✓ 25				✓	101145N	99185E	Qtz eye schist minor rust, Qtz str
F	✓ 6				✓	102150N	88120E	Hornblende sed Qtz str rusty *
G	✓ 25					101125N	98100E	Rusty biotitic sed Qtz str
H	✓ 5					102100N	89125E	Rusty sed Qtz str.
I	✓ 25				✓	100110N	82100E	ang boulders minor rusty alt sed? felsic app.
J	✓ 25					98125N	94100E	Bio/hornschist rusty Qtz str
K	✓ 25				✓	101120N	94100E	Qtz Boulders ang Boulders rusty 17% py 2-3% po
L	✓ 560		✓		✓	100150N	84150E	Qtz eye schist? old rock rusty 2% py.
M	✓ 25		✓		✓	103135N	84150E	gypsum? fine-mud grained
N	✓ 25				✓	99175N	83175E	altered sed rusty 2-17% py
O	✓		✓		✓	100165E	84100E	Qtz eye schist rusty 10% py.

'04

HEMLO GOLD MINES IN - SAMPLE RECORD SHEET

Project Name: ReleighNumber: 471District: SuperiorDate: June 1995Sampler: BM

N.T.S.:

SAMPLE #	AU P.P.B.	AU O.P.T.	W.R.	ICP	Rep	NORTHING	EASTING	SAMPLE DESCRIPTION
A	✓					100155N	83175E	rusty Biotite + Qtz Boulder tu py
B	✓					25m North of Pipe Line 99975E 82100E	82100E	ang Boulder thembled 5-10% py, po rusty. all N of Pipeline
C	✓		✓			North side of Pipeline 77100E	77100E	altered sand (schist) minor rust minor Qtz str. on Pipeline
D	✓					100130N	82165E	rusty Biotite Act.
E	✓ 6					" 99140N	88100E	rusty sand Biotite 1-2% py
F	✓ 9					" 99140N	88100E	rusty sand + Qtz 1-2% py
G	✓ 8				✓	99140N	88100E	rusty sand Biotite 1-2% py
H	✓ 19		✓	✓	✓	103100N	109140E	rusty ang Boulder sand? 2% dia py
I	✓ 25		✓		✓	103100N	109140E	same as "H"
J	✓ 6		✓			103165N	108110E	large ang boulder greywacke? weak silicification, minor rust tu py
K	✓ 25		✓		✓	96150N	107140E	altered sand tu-1% py minor rust
L	✓ 25				✓	96150N	107140E	rusty alt sand - ser
M	✓ 25		✓			106470N	761740E	alt. sep. bio-pyrophy. minor rust
N	✓ 25		✓			107110N	106100E	alt. sep. bio-pyrophy. minor rust
O	✓ 7		✓		✓	98185N	106100E	alt. sep. bio, minor silicification tu py
P	✓ 25					99125N	103195E	rusty schist 1% py

White - Office Copy • Yellow - Field Copy

APPENDIX IV
SOIL SAMPLE CERTIFICATES



Chemex Labs Ltd.

Analytical Chemists * Geochemists * Registered Assayers
 212 Brooksbank Ave., North Vancouver
 British Columbia, Canada V7J 2C1
 PHONE: 604-684-0221 FAX: 604-684-0218

To: HEMLO GOLD MINES INC.

P.O. BOX 1205, 60 SHIRLEY ST. S.
 TIMMINS, ON
 P4N 7J5

Page Number 1
 Total Pages 2
 Certificate Date 17-JUL-1
 Invoice No. 1952106
 P.O. Number :
 Account :

Project: 471

Comments: ATTN: STEVE CONQUER CC: BRUCE MacLACHLAN

CERTIFICATE OF ANALYSIS

A9521067

SAMPLE DESCRIPTION	PREP CODE	Au ppb FA+AA									
L62E-97+25M	217 --	< 5									
L62E-97+50M	217 --	< 5									
L62E-97+75M	217 --	< 5									
L62E-98+00M	217 --	< 5									
L62E-98+25M	217 --	< 5									
L62E-103+50M	217 --	< 5									
L62E-103+75M	217 --	< 5									
L64E-94+50M	217 --	< 5									
L64E-94+75M	217 --	< 5									
L64E-96+75M	217 --	< 5									
L64E-97+00M	217 --	< 5									
L64E-97+25M	217 --	< 5									
L64E-97+50M	217 --	< 5									
L64E-98+25M	217 --	< 5									
L64E-98+50M	217 --	< 5									
L64E-100+25M	217 --	< 5									
L64E-100+50M	217 --	< 5									
L64E-100+75M	217 --	< 5									
L64E-101+00M	217 --	< 5									
L64E-101+25M	217 --	< 5									
L64E-101+50M	217 --	< 5									
L64E-101+75M	217 --	< 5									
L64E-102+00M	217 --	< 5									
L64E-102+25M	217 --	< 5									
L64E-102+75M	217 --	< 5									
L74E-99+50M	217 --	< 5									
L74E-99+75M	217 --	< 5									
L74E-101+00M	217 --	< 5									
L84E-101+50M	217 --	< 5									
L84E-101+75M	217 --	< 5									
L84E-102+00M	217 --	< 5									
L84E-103+00M	217 --	< 5									
L84E-103+25M	217 --	< 5									
L84E-103+50M	217 --	< 5									
L88E-99+50M	217 --	< 5									
L88E-99+75M	217 --	< 5									
L88E-100+00M	217 --	< 5									
L88E-100+50M	217 --	< 5									
L88E-102+00M	217 --	< 5									
L88E-102+25M	217 --	< 5									

CHEMEX LABS LTD

416 624 6163

95 07/19 12:25



Chemex Labs Ltd.

Analytical Chemists * Geochemists * Registered Assayers
 212 Brookbank Ave., North Vancouver
 British Columbia, Canada V7J 2C1
 PHONE: 604-664-0221 FAX: 604-664-0218

To: HEMLO GOLD MINES INC.

P.O. BOX 1205, 60 SHIRLEY ST. S.
 TIMMINS, ON
 P4N 7J5

Page Number 2
 Total Pages 2
 Certificate Date: 17-JUL-1
 Invoice No. H052104
 P.O. Number :
 Account :

Project: 471
 Comments: ATTN: STEVE CONQUER CC: BRUCE MacLACHLAN

CERTIFICATE OF ANALYSIS A9521867

SAMPLE DESCRIPTION	PREP CODE	Au ppb FA+AA										
L92E-97+00M	217 --	< 5										
L92E-103+25M	217 --	< 5										
L96E-96+50M	217 --	< 5										
L96E-96+75M	217 --	< 5										
L96E-100+50M	217 --	< 5										
L96E-100+75M	217 --	< 5										
L96E-103+25M	217 --	< 5										
L102E-102+50M	217 --	< 5										
L102E-102+75M	217 --	< 5										
L102E-103+00M	217 --	< 5										
L106E-102+50M	217 --	< 5										
L116E-98+00M	217 --	< 5										
L116E-98+25M	217 --	< 5										
L116E-98+50M	217 --	< 5										
L116E-101+25M	217 --	< 5										
L116E-101+00M	217 --	< 5										

CHEMEX LABS LTD

416 624 6163

'95 07/19 12:26

CERTIFICATION:



Chemex Labs Ltd.

Analytical Chemists * Geochemists * Registered Assayers
 212 Brockbank Ave., North Vancouver
 British Columbia, Canada V7J 2C1
 PHONE: 604-984-0221 FAX: 604-984-0218

To: HEMLO GOLD MINES INC.

P.O. BOX 1205, 60 SHIRLEY ST. S.
 TIMMINS, ON
 P4N 7J5

Page Number 1
 Total Pages 3
 Certificate Date 14-JUL-1
 Invoice No. 1-95218
 P.O. Number
 Account

Project: 471
 Comments: ATTN: STEVE CONQUER CC: BRUCE MacLACHLAN

CERTIFICATE OF ANALYSIS A9521688

SAMPLE DESCRIPTION	PREP CODE	Au ppb FA+AA							
L92E-96+00M	201 --	< 5							
L92E-96+25M	201 --	< 5							
L92E-96+50M	201 --	< 5							
L92E-96+75M	201 --	< 5							
L92E-97+25M	201 --	< 5							
L92E-97+50M	201 --	< 5							
L92E-97+75M	201 --	< 5							
L92E-98+00M	201 --	< 5							
L92E-98+25M	201 --	< 5							
L92E-98+50M	201 --	< 5							
L92E-98+75M	201 --	< 5							
L92E-99+00M	201 --	< 5							
L92E-99+25M	201 --	< 5							
L92E-99+50M	201 --	< 5							
L92E-99+75M	201 --	< 5							
L92E-100+00M	201 --	< 5							
L92E-100+25M	201 --	< 5							
L92E-100+50M	201 --	< 5							
L92E-101+50M	201 --	< 5							
L92E-101+75M	201 --	< 5							
L92E-102+00M	201 --	< 5							
L92E-102+25M	201 --	< 5							
L92E-102+50M	201 --	< 5							
L92E-102+75M	201 --	< 5							
L92E-103+00M	201 --	< 5							
L92E-103+50M	201 --	< 5							
L92E-103+75M	201 --	< 5							
L92E-104+00M	201 --	< 5							
L96E-97+00M	201 --	< 5							
L96E-97+25M	201 --	5							
L96E-97+50M	201 --	< 5							
L96E-97+75M	201 --	< 5							
L96E-98+00M	201 --	< 5							
L96E-98+25M	201 --	< 5							
L96E-98+50M	201 --	< 5							
L96E-98+75M	201 --	< 5							
L96E-99+00M	201 --	< 5							
L96E-99+25M	201 --	< 5							
L96E-99+50M	201 --	< 5							
L96E-99+75M	201 --	25							



Chemex Labs Ltd.

Analytical Chemistry * Geochemistry * Registered Assayers
 212 Brookbank Ave., North Vancouver
 British Columbia, Canada V7J 2C1
 PHONE: 604-984-0221 FAX: 604-984-0218

To: HEMLO GOLD MINES INC.

P.O. BOX 1205, 60 SHIRLEY ST. S.
 TIMMINS, ON
 P4N 7J6

Page Number 2
 Total Pages 5
 Certificate Date 14-JUL-4
 Invoice No. 1-052106
 P.O. Number
 Account

Project: 471

Comments: ATTN: STEVE CONQUER OC: BRUCE MacLACHLAN

CERTIFICATE OF ANALYSIS

A9521666

SAMPLE DESCRIPTION	PREP CODE	Au ppb FA+AA									
L96E-100+00M	201 --	< 5									
L96E-100+25M	201 --	< 5									
L96E-101+00M	201 --	< 5									
L96E-101+25M	201 --	< 5									
L96E-101+50M	201 --	< 5									
L96E-102+00M	201 --	< 5									
L96E-102+25M	201 --	< 5									
L96E-102+50M	201 --	< 5									
L96E-102+75M	201 --	< 5									
L96E-103+00M	201 --	< 5									
L96E-103+25M	201 --	< 5									
L96E-103+50M	201 --	< 5									
L96E-103+75M	201 --	< 5									
L96E-104+00M	201 --	< 5									
L98E-101+00M	201 --	< 5									
L98E-101+25M	201 --	< 5									
L98E-102+00M	201 --	< 5									
L98E-102+25M	201 --	< 5									
L98E-102+50M	201 --	< 5									
L98E-102+75M	201 --	< 5									
L98E-103+00M	201 --	< 5									
L98E-103+50M	201 --	< 5									
L102E-102+00M	201 --	< 5									
L102E-102+25M	201 --	< 5									
L106E-102+75M	201 --	< 5									
L106E-103+00M	201 --	< 5									
L106E-103+25M	201 --	< 5									
L106E-103+50M	201 --	< 5									
L116E-97+50M	201 --	< 5									
L116E-97+75M	201 --	< 5									
L116E-98+75M	201 --	< 5									
L116E-99+00M	201 --	< 5									
L116E-99+25M	201 --	< 5									
L116E-99+50M	201 --	< 5									
L116E-99+75M	201 --	< 5									
L116E-100+00M	201 --	< 5									
L116E-100+25M	201 --	< 5									
L116E-100+50M	201 --	< 5									
L116E-100+75M	201 --	< 5									
L116E-101+00M	201 --	< 5									

1 1
 CHEMEX LABS LTD.

410 644 6163

'95 07/19 12:22



Chemex Labs Ltd.

Analytical Chemists * Geochemists * Registered Assayers

212 Brookbank Ave., North Vancouver
British Columbia, Canada V7J 2C1
PHONE: 604-964-0221 FAX: 604-964-0218

To: HEMLO GOLD MINES INC

P.O. BOX 1205, 60 SHIRLEY ST. S.
TIMMINS, ON
P4N 7J5

Project: 471

Comments: ATTN: STEVE CONQUER CC: BRUCE MacLACHLAN

Page Number 3
Total Pages 3
Certificate Date 14-JUL
Invoice No. 1-65211
P.O. Number :
Account :

CERTIFICATE OF ANALYSIS

A9521666

SAMPLE DESCRIPTION	PREP CODE	Au ppb FA+AA																		
L116E-101+50M	201 --	< 5																		
L116E-101+75M	201 --	< 5																		
L116E-102+00M	201 --	< 5																		
L116E-102+25M	201 --	< 5																		
L116E-102+50M	201 --	< 5																		
L116E-102+75M	201 --	< 5																		
L116E-103+25M	201 --	< 5																		
L116E-103+50M	201 --	< 5																		
L116E-103+75M	201 --	< 5																		
L116E-104+00M	201 --	< 5																		



Chemex Labs Ltd.

Analytical Chemists * Geochemists * Registered Assayers
 212 Brooksbank Ave., North Vancouver
 British Columbia, Canada V7J 2G1
 PHONE: 604-664-0221 FAX: 604-664-0218

To: HEMLO GOLD MINES INC

P.O. BOX 1205, 60 SHIRLEY ST. S
 TIMMINS, ON
 P4N 7J5

Page Number 2
 Total Pages 2
 Certificate Date 14-JUL-
 Invoice No. 1-95214
 P.O. Number
 Account

Project: 471
 Comments: ATTN: STEPHEN CONQUER CC: BRUCE MacLACHLAN

CERTIFICATE OF ANALYSIS

A9521492

SAMPLE DESCRIPTION	PREP CODE	Au ppb FA+AA							
L74E-100-75M	201 --	< 5							
L74E-101+25M	201 --	< 5							
L74E-101+50M	201 --	40							
L84E-98+00M	201 --	< 5							
L84E-98+25M	201 --	< 5							
L84E-98+50M	201 --	< 5							
L84E-98+75M	201 --	< 5							
L84E-99+00M	201 --	< 5							
L84E-99+25M	201 --	< 5							
L84E-99+50M	201 --	< 5							
L84E-99+75M	201 --	10							
L84E-100+00M	201 --	< 5							
L84E-100-50M	201 --	< 5							
L84E-100+75M	201 --	< 5							
L84E-101+00M	201 --	< 5							
L84E-101+25M	201 --	< 5							
L84E-102+25M	201 --	< 5							
L84E-102-50M	201 --	< 5							
L84E-102+75M	201 --	< 5							
L88E-96+00M	201 --	< 5							
L88E-96+25M	201 --	25							
L88E-96+50M	201 --	< 5							
L88E-96-75M	201 --	< 5							
L88E-97+00M	201 --	< 5							
L88E-97+25M	201 --	< 5							
L88E-97+50M	201 --	< 5							
L88E-97+75M	201 --	< 5							
L88E-98+00M	201 --	< 5							
L88E-98+25M	201 --	< 5							
L88E-98+50M	201 --	< 5							
L88E-98-75M	201 --	< 5							
L88E-99+00M	201 --	< 5							
L88E-99+25M	201 --	< 5							
L88E-100+75M	201 --	< 5							
L88E-101+00M	201 --	< 5							

CERTIFICATE

Z 410 64 0.00 UNELIK LABS LTD

30 07/19 14:34

APPENDIX V
IP PSEUDO SECTIONS

**HEMLO
GOLD**

HEMLO GOLD MINES INC.

Exploration Office
60 Shirley Street South
P.O. Box 1205

2.163 59 Timmins, Ontario
P4N 7J5

Telephone: (705) 268-9600

Fax: (705) 268-9572

FAX COVER SHEET

DELIVER TO:

Mining Recorder (Katrina)

FROM:

Carol Pepin

SUBJECT:

Raleigh - Trenching

DATE:

Jan 2 1996

OPERATOR:

NUMBER OF PAGES:

(INCLUDING COVER SHEET)

COMMENTS:

Belham Ltd. - H.S. 410 Superhse

Sept. 1 8.5 hours Sept 10 1 hour

Sept. 2 9 hours

Sept. 3 9 hours Total 76 hours

Sept. 4 9 hours @ \$125.00/hr. = \$9500.00

Sept. 5 9.5 hours

Sept. 6 2.5 hours

Sept. 7 9.5 hours

Sept. 8 8 hours

Sept. 9 10 hours

RECEIVED

JAN 17 1996

MINING LANDS BRANCH

IF YOU DO NOT RECEIVE ALL THE PAGES CONTACT OUR OFFICE AS SOON AS POSSIBLE

FOR YOU INFO

AS REQUESTED

URGENT

DEL IMMEDIATELY

YOUR COMMENTS

CONFIDENTIAL

2.163 59

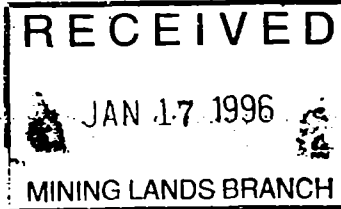

BELHAM LTD.
 BOX 25
 KAMINISTIOUIA, ONT.
 P0T 1X0

SOLD TO HEMLO GOLD MINES INC.
60 SHIRLEY ST. SOUTH
 SHIPPED TO TIMMINS ONTARIO
 ADDRESS _____ VIA _____

OUR NUMBER	31906
DATE	Sept. 10 / 95
CUSTOMER'S ORDER	
SALESMAN	SA.
TERMS	
G.S.T.	R100457167

ICE	PRE: RALEIGH LAKE PROJECT 471-105			
	Aug 31 MOB TO JOB 4 HRS. @ 75.00		300.00	
	Sept 10 DEMOB TO KAM. 4 HRS. @ 75.00		300.00	
	Sept 1 TO SEPT 10 43.40 SUPERHOE. TRENCHING. 76 HRS. @ 125.00		9500.00	
	<i>[Signature]</i>	SUB. TOTAL	10100.00	
	<i>[Signature]</i>	7% G.S.T.	707.00	
		TOTAL		\$10807.00

032

032-2



Report of Work Conducted After Recording Claim

Transaction Number

W 9510.00156

Mining Act

Personal information collected on this form is obtained under the authority of the Mining Act. This information will be used for correspondence. Questions about this collection should be directed to the Provincial Manager, Mining Lands, Ministry of Northern Development and Mines, Fourth Floor, 168 Cedar Street, Sudbury, Ontario, P3E 6A5, telephone (705) 670-7264.

2.16359

- Instructions:
- Please type or print and submit in duplicate.
 - Refer to the Mining Act and Regulations for req. Recorder.
 - A separate copy of this form must be completed
 - Technical reports and maps must accompany this
 - A sketch, showing the claims the work is assigned to



52G12SW0001 2 16359 ILSLEY

900

Recorded Holder(s) Hemlo Gold Mines Inc.		Client No. 143550
Address 60 Shirley St. So., P.O. Box 1205, Timmins, Ontario P4N 7J5		Telephone No. 705-268-9600
Mining Division Thunder Bay <i>Kenora</i>	Township/Area Ilsley	M or G Plan No. G-3950
Dates Work Performed From: June 1, 1995		To: July 31, 1995

Work Performed (Check One Work Group Only)

Work Group	Type
<input checked="" type="checkbox"/> Geotechnical Survey	Geological mapping, prospecting, soil sampling
<input type="checkbox"/> Physical Work, including Drilling	
<input type="checkbox"/> Rehabilitation	
<input type="checkbox"/> Other Authorized Work	
<input checked="" type="checkbox"/> Assays	Soil, Rock assays
<input type="checkbox"/> Assignment from Reserve	

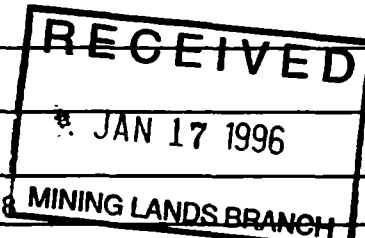

Total Assessment Work Claimed on the Attached Statement of Costs \$ 17,108

Note: The Minister may reject for assessment work credit all or part of the assessment work submitted if the recorded holder cannot verify expenditures claimed in the statement of costs within 30 days of a request for verification.

Persons and Survey Company Who Performed the Work (Give Name and Address of Author of Report)

Name	Address
Bruce MacLachlan (author)	P.O. Box 1205, Timmins, Ontario P4N 7J5
Dave Truscott, Ray Gardner, Stephen Conquer	" " " " " "
Chemex Labs. Ltd.	212 Brooksbank Ave., No. Vancouver, B.C. V7J 2C1
Accurassay Labs	P.O. Box 426, Kirkland Lake, Ontario P2N 3J1

(attach a schedule if necessary)

Certification of Beneficial Interest * See Note No. 1 on reverse side

I certify that at the time the work was performed, the claims covered in this work report were recorded in the current holder's name or held under a beneficial interest by the current recorded holder.	Date Dec 15, 1995	Recorded Holder or Agent (Signature) <i>[Signature]</i>
--	----------------------	--

Certification of Work Report

I certify that I have a personal knowledge of the facts set forth in this Work report, having performed the work or witnessed same during and/or after its completion and annexed report is true.		
Name and Address of Person Certifying Wayne Reid, c/o P.O. Box 1205, Timmins, Ontario P4N 7J5		
Telephone No. 705-268-9600	Date Dec 15/95	Certified By (Signature) <i>[Signature]</i>

For Office Use Only

Total Value Cr. Recorded	Date Recorded	Mining Recorder <i>[Signature]</i>	Received Stamp KENORA - MINING DIV. RECEIVED DEC 21 1995 AM 7 8 9 10 11 12 1 2 3 4 5 6 PM
Deemed Approval Date MAR. 20, 1995	Date Approved		
Date Notice for Amendments Sent			



Report of Work Conducted After Recording Claim

Mining Act

Transaction Number
W 9510.00157

Personal information collected on this form is obtained under the authority of the Mining Act. This information will be used for correspondence. Questions about this collection should be directed to the Provincial Manager, Mining Lands, Ministry of Northern Development and Mines, Fourth Floor, 159 Cedar Street, Sudbury, Ontario, P3E 6A5, telephone (705) 670-7284.

2.16359

- Instructions:**
- Please type or print and submit in duplicate.
 - Refer to the Mining Act and Regulations for requirements of filing assessment work or consult the Mining Recorder.
 - A separate copy of this form must be completed for each Work Group.
 - Technical reports and maps must accompany this form in duplicate.
 - A sketch, showing the claims the work is assigned to, must accompany this form.

Recorded Holder(s) Hemlo Gold Mines Inc.		Client No. 143550
Address 60 Shirley St. So., P.O. Box 1205, Timmins, Ontario P4N 7J5		Telephone No. 705-268-9600
Mining Division Thunder Bay <i>Hemlo</i>	Township/Area Ilsley	M or G Plan No. G-3950
Date Work Performed	From: Aug. 31, 1995	To: Sept. 10, 1995

Work Performed (Check One Work Group Only)

Work Group	Type
<input type="checkbox"/> Geotechnical Survey	
<input checked="" type="checkbox"/> Physical Work, including Drilling	Trenching
<input type="checkbox"/> Rehabilitation	
<input type="checkbox"/> Other Authorized Work	
<input checked="" type="checkbox"/> Assays	Rock Assays
<input type="checkbox"/> Assignment from Reserve	

RECEIVED
JAN 17 1996
MINING LANDS BRANCH

Total Assessment Work Claimed on the Attached Statement of Costs \$ 22,789

Note: The Minister may reject for assessment work credit all or part of the assessment work submitted if the recorded holder cannot verify expenditures claimed in the statement of costs within 30 days of a request for verification.

Persons and Survey Company Who Performed the Work (Give Name and Address of Author of Report)

Name	Address
Belham Ltd.	P.O. Box 25, Kaministiquia, Ontario P0T 1X0
Bruce MacLachlan (author),	P.O. Box 1205, Timmins, Ontario P4N 7J5
Ray Gardner, Stephen Conquer	" " " " " "

(attach a schedule if necessary)

Certification of Beneficial Interest * See Note No. 1 on reverse side

I certify that at the time the work was performed, the claims covered in this work report were recorded in the current holder's name or held under a beneficial interest by the current recorded holder.	Date <u>Dec 15, 1995</u>	Recorded Holder or Agent (Signature) <i>[Signature]</i>
--	-----------------------------	--

Certification of Work Report

I certify that I have a personal knowledge of the facts set forth in this Work report, having performed the work or witnessed same during and/or after its completion and annexed report is true.		
Name and Address of Person Certifying Wayne Reid, c.o./P.O. Box 1205, Timmins, Ontario P4N 7J5		
Telephone No. (705) 268-9600	Date <u>Dec. 15 / 95</u>	Certified By (Signature) <i>[Signature]</i>

For Office Use Only

Total Value Cr. Recorded	Date Recorded <u>Dec. 21, 1995</u>	Mining Recorder <i>[Signature]</i>	
	Deemed Approval Date <u>MAR. 20, 1995</u>	Date Approved <u>JAN. 9, 1996</u>	
	Date Notice for Amendments Sent		

Work Report# for Applying Reserve	Claim Number (see note 2)	# of Claim Units	Value of Assessment Work Done on this Claim	Value Applied to this Claim	Values Assigned from this Claim	Reserve Work to be Claimed at a Future Date
	K 1.208.503	13	3.420.00	5.200.00		
	K 1.208.502	16	13.669.00	6.400.00	7.269.00	
	K 1.208.501	16	5.700.00	6.400.00		
	K 1.224.918	15	0.00	4.126.00		
	K 1.224.919	16	0.00	663.00		
			2.103.59			
					<div style="border: 1px solid black; padding: 5px; width: fit-content; margin: auto;"> RECEIVED JAN 17 1996 MINING LANDS BRANCH </div>	
5			22.789.00	22.789.00	7.269.00	0.00
Total Number of Claims			Total Value Work Done	Total Value Work Applied	Total Assigned From	Total Reserve

Credits you are claiming in this report may be cut back. In order to minimize the adverse affects of such deletions, please indicate from which claims you wish to prioritize the deletion of credits. Please mark (x) one of the following:

1. Credits are to be cut back starting with the claims listed last, working backwards.
2. Credits are to be cut back equally over all claims contained in this report of work.
3. Credits are to be cut back as prioritized on the attached appendix.
4. Credits are to be cut back starting with the claims that have reserve credits.

In the event that you have not specified your choice of priority, option one will be implemented.

Note 1: Examples of beneficial interest are unrecorded transfers, option payments, memorandum of agreements, etc., with respect to the mining claims.
 Note 2: If work has been performed on patented or leased land, please complete the following:

I certify that the recorded holder had a beneficial interest in the patented or leased land at the time the work was performed.	Signature	Date
---	-----------	------



Ministry of
Northern Development
and Mines

Ministère du
Développement du Nord
et des mines

**Statement of Costs
for Assessment Credit**

**État des coûts aux fins
du crédit d'évaluation**

Mining Act/Loi sur les mines

Transaction No./N° de transaction

W9510.00157

Personal information collected on this form is obtained under the authority of the Mining Act. This information will be used to maintain a record and ongoing status of the mining claim(s). Questions about this collection should be directed to the Provincial Manager, Minings Lands, Ministry of Northern Development and Mines, 4th Floor, 159 Cedar Street, Sudbury, Ontario P3E 6A5, telephone (705) 670-7264.

Les renseignements personnels contenus dans la présente formule sont recueillis en vertu de la Loi sur les mines et serviront à tenir à jour un registre des concessions minières. Adresser toute question sur la collecte de ces renseignements au chef provincial des terrains miniers, ministère du Développement du Nord et des Mines, 159, rue Cedar, 4^e étage, Sudbury (Ontario) P3E 6A5, téléphone (705) 670-7264.

1. Direct Costs/Coûts directs

Type	Description	Amount Montant	Totals Total global
Wages Salaires	Labour Main-d'oeuvre	6,000	
	Field Supervision Supervision sur le terrain	1,653	7,653
Contractor's and Consultant's Fees Droits de l'entrepreneur et de l'expert- conseil	Type Belham Ltd.	9,500	
	Accurassay	606	10,106
Supplies Used Fournitures utilisées	Type Diamond Blades	1,350	
			1,350
Equipment Rental Location de matériel	Type Wajax	1,240	
			1,240
Total Direct Costs Total des coûts directs			20,349

2. Indirect Costs/Coûts indirects

** Note: When claiming Rehabilitation work Indirect costs are not allowable as assessment work.
Pour le remboursement des travaux de réhabilitation, les coûts indirects ne sont pas admissibles en tant que travaux d'évaluation.

Type	Description	Amount Montant	Totals Total global
Transportation Transport	Type Truck Rental	465	
	Gas	275	740
Food and Lodging Nourriture et hébergement	Room & Board Northwoods Motel	1100	1100
	Mobilization and Demobilization Mobilisation et démobilisation	Mob & demob backhoe	600
Sub Total of Indirect Costs Total partiel des coûts indirects			2,440
Amount Allowable (not greater than 20% of Direct Costs) Montant admissible (n'excédant pas 20 % des coûts directs)			
Total Value of Assessment Credit (Total of Direct and Allowable indirect costs)			22,789

Note: The recorded holder will be required to verify expenditures claimed in this statement of costs within 30 days of a request for verification. If verification is not made, the Minister may reject for assessment work all or part of the assessment work submitted.

Note : Le titulaire enregistré sera tenu de vérifier les dépenses demandées dans le présent état des coûts dans les 30 jours suivant une demande à cet effet. Si la vérification n'est pas effectuée, le ministre peut rejeter tout ou une partie des travaux d'évaluation présentés.

Filing Discounts

1. Work filed within two years of completion is claimed at 100% of the above Total Value of Assessment Credit.
2. Work filed three, four or five years after completion is claimed at 50% of the above Total Value of Assessment Credit. See calculations below:

Total Value of Assessment Credit	Total Assessment Claimed
	x 0.50 =

Remises pour dépôt

1. Les travaux déposés dans les deux ans suivant leur achèvement sont remboursés à 100 % de la valeur totale susmentionnée du crédit d'évaluation.
2. Les travaux déposés trois, quatre ou cinq ans après leur achèvement sont remboursés à 50 % de la valeur totale du crédit d'évaluation susmentionné. Voir les calculs ci-dessous.

Valeur totale du crédit d'évaluation	Evaluation totale demandée
	x 0,50 =

Certification Verifying Statement of Costs

I hereby certify:
that the amounts shown are as accurate as possible and these costs were incurred while conducting assessment work on the lands shown on the accompanying Report of Work form.

that as Leanne Mungie I am authorized
(Recorded Holder, Agent, Position in Company)

to make this certification

Attestation de l'état des coûts

J'atteste par la présente :
que les montants indiqués sont le plus exact possible et que ces dépenses ont été engagées pour effectuer les travaux d'évaluation sur les terrains indiqués dans la formule de rapport de travail ci-joint.

Et qu'à titre de _____ je suis autorisé
(titulaire enregistré, représentant, poste occupé dans la compagnie)

à faire cette attestation.

Signature	Date
	Dec 15, 1995

Ministry of
Northern Development
and Mines

Ministère du
Développement du Nord
et des Mines

April 17, 1996

Geoscience Approvals Office
933 Ramsey Lake Rd., 6th Floor
Sudbury, Ontario
P3E 6B5

Telephone: (705) 670-5853
Fax: (705) 670-5863

Mining Recorder
Ministry of Northern Development and Mines
Box 5200, 808 Robertson St
Kenora, Ontario
P9N 3X9

Our File: 2.16359
Transaction #: W9510.00156

Dear Mr. Rivett

RE: Approval of Assessment work submitted on Mining Claims KRL1114290 et al. in the Township(s) of Ilsley.

This assessment work report was not assessed prior to the 90 day deemed approval date. Accordingly, as outlined in subsection 6(7) of the Mining Act Regulations, this Report of Work is deemed approved as of April 3, 1996.

If you have any questions regarding this correspondence please contact Blair Kite at (705) 670-5861.

Yours sincerely
ORIGINAL SIGNED BY

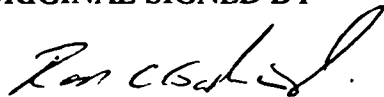

Ron C. Gashinski
Senior Manager, Mining Lands Section
Mining and Land Management Branch

BK/bk

cc: Resident Geologist, Kenora
✓ Assessment Files Office, Sudbury

REFERENCES

AREAS WITHDRAWN FROM DISPOSITION

- M R O - MINING RIGHTS ONLY
- S R O - SURFACE RIGHTS ONLY
- M & S - MINING AND SURFACE RIGHTS

Description	Order No	Date	Disposition	File
W92/77		11/22/77	S R O	116325
R2 Sec 43	W6/80	22/12/80	S R O	158155
R3 Sec 36	W4/87	08/01/87	M & S	188585

HYNDMAN TWP.

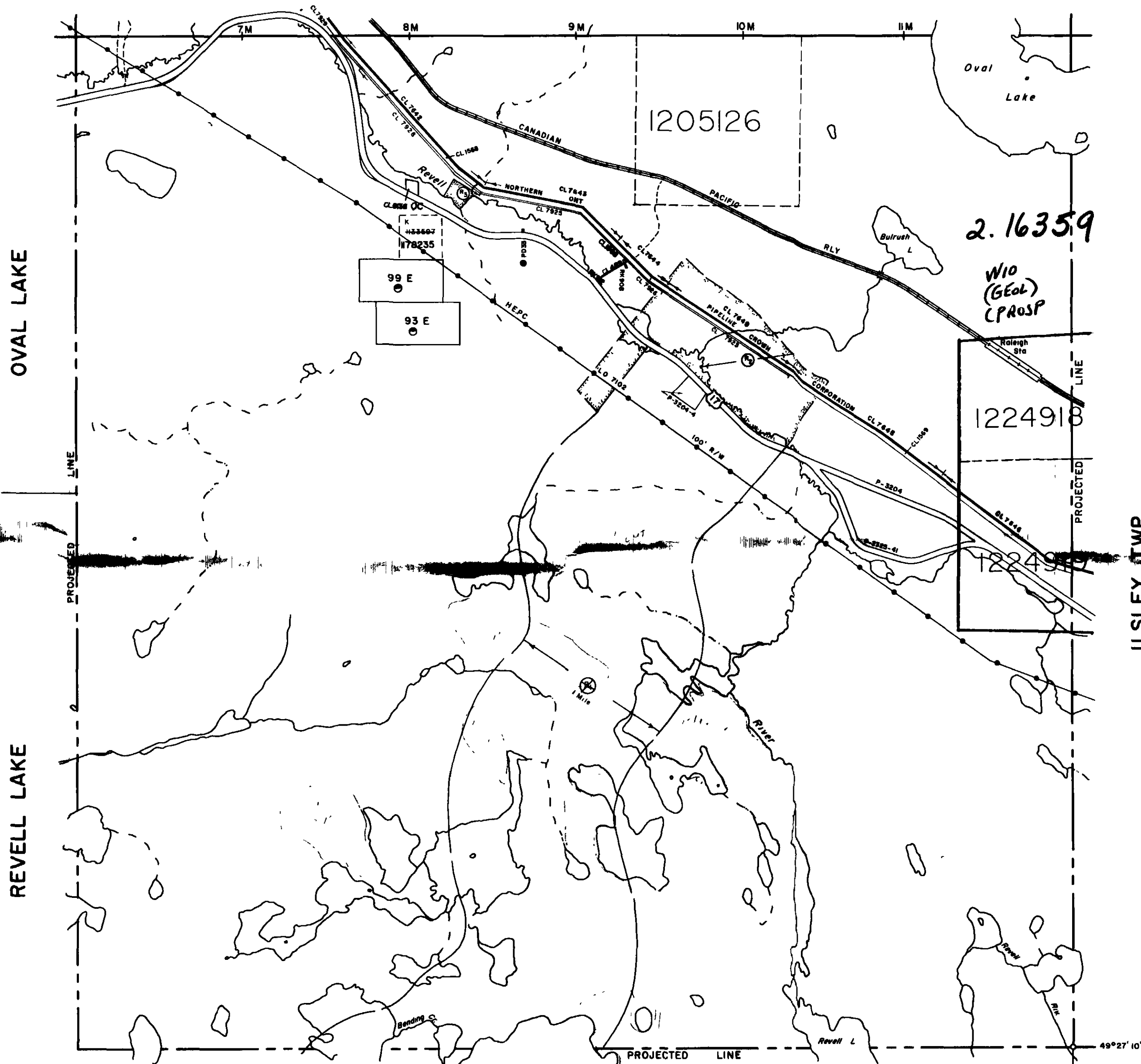

LEGEND

- HIGHWAY AND ROUTE No
- OTHER ROADS
- TRAILS
- SURVEYED LINES
- TOWNSHIPS, BASE LINES, ETC
- LOTS, MINING CLAIMS, PARCELS, ETC
- UNSURVEYED LINES
- LOT LINES
- PARCEL BOUNDARY
- MINING CLAIMS ETC
- RAILWAY AND RIGHT OF WAY
- UTILITY LINES
- NON-PERENNIAL STREAM
- FLOODING OR FLOODING RIGHTS
- SUBDIVISION OR COMPOSITE PLAN
- RESERVATIONS
- ORIGINAL SHORELINE
- MARSH OR MUSKEG
- MINES
- TRAVERSE MONUMENT

DISPOSITION OF CROWN LANDS

TYPE OF DOCUMENT	SYMBOL
PATENT, SURFACE & MINING RIGHTS	●
" SURFACE RIGHTS ONLY	○
" MINING RIGHTS ONLY	◐
LEASE, SURFACE & MINING RIGHTS	■
" SURFACE RIGHTS ONLY	□
" MINING RIGHTS ONLY	◻
LICENCE OF OCCUPATION	▼
ORDER-IN-COUNCIL	○
RESERVATION	⊙
CANCELLED	⊖
SAND & GRAVEL	⊕

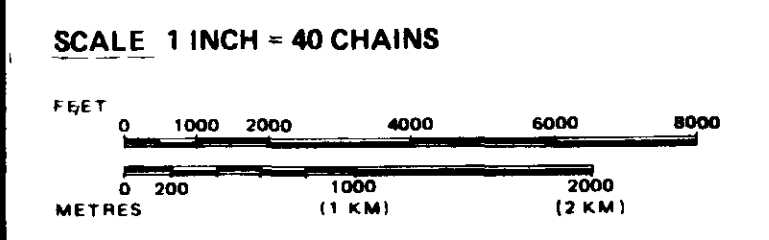

TOWNSHIP

HODGSON

M.N.R. ADMINISTRATIVE DISTRICT
DRYDEN
 MINING DIVISION
KENORA
 LAND TITLES / REGISTRY DIVISION
KENORA

Ministry of Natural Resources Ontario
 Ministry of Northern Development and Mines

Date NOVEMBER / 92
 Number **G-1313**

DATE OF ISSUE
JAN - 8 1996
 KENORA
 MINING DIVISION



AREAS WITHDRAWN FROM DISPOSITION

- M.R.O. - MINING RIGHTS ONLY
- S.R.O. - SURFACE RIGHTS ONLY
- M + S. - MINING AND SURFACE RIGHTS

Description Order No Date Disposition File

OVAL LAKE

HOOK LAKE

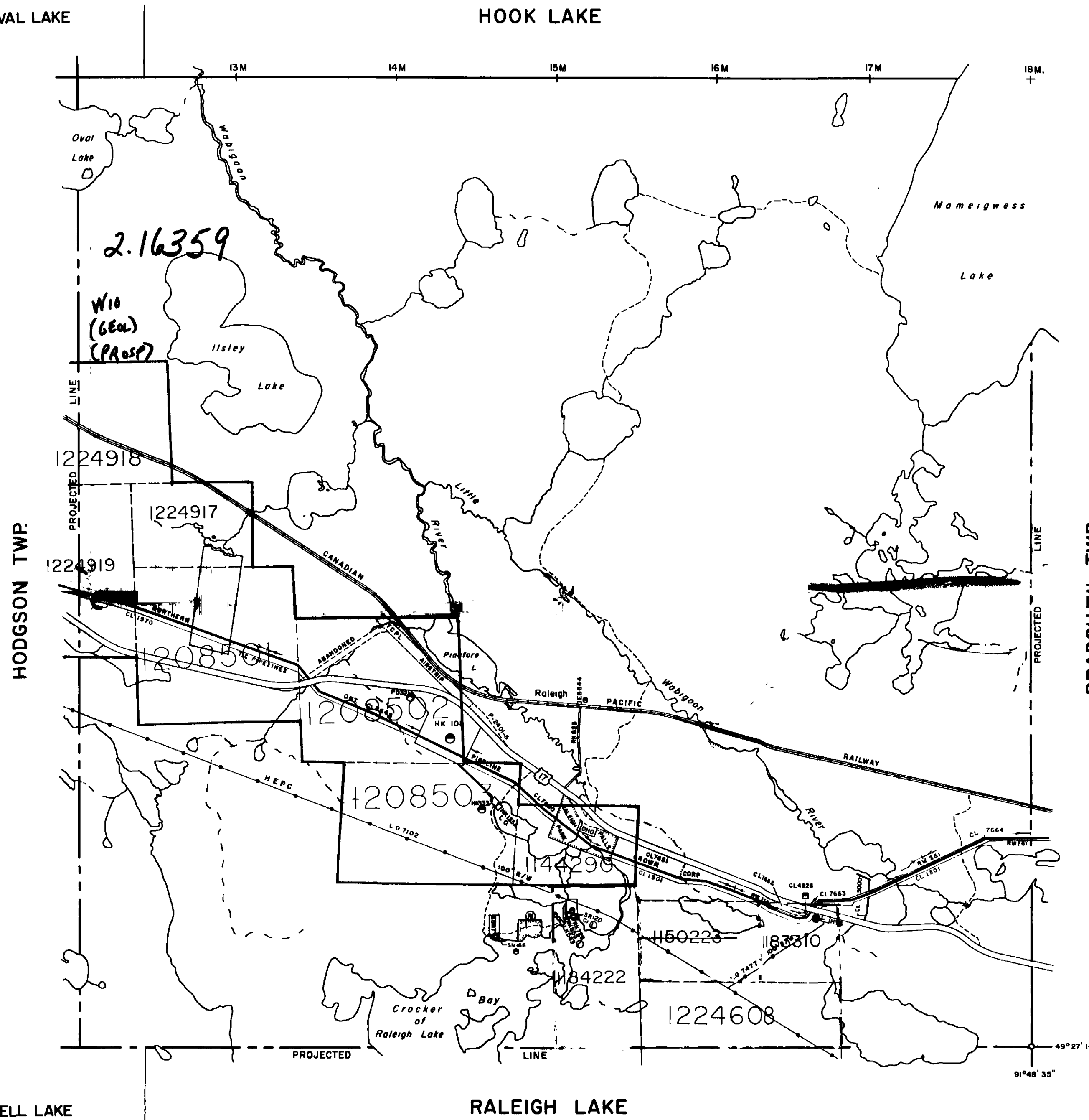

DATE OF ISSUE
JAN - 8 1988
 KENORA
 MINING DIVISION

LEGEND

- HIGHWAY AND ROUTE No
- OTHER ROADS
- TRAILS
- SURVEYED LINES
 - TOWNSHIPS, BASE LINES, ETC
 - LOTS, MINING CLAIMS, PARCELS, ETC
- UNSURVEYED LINES
 - LOT LINES
 - PARCEL BOUNDARY
 - MINING CLAIMS ETC
- RAILWAY AND RIGHT OF WAY
- UTILITY LINES
- NON PERENNIAL STREAM
- FLOODING OR FLOODING RIGHTS
- SUBDIVISION OR COMPOSITE PLAN
- RESERVATIONS
- ORIGINAL SHORELINE
- MARSH OR MUSKEG
- MINES
- TRAVERSE MONUMENT

DISPOSITION OF CROWN LANDS

TYPE OF DOCUMENT	SYMBOL
PATENT, SURFACE & MINING RIGHTS	●
" SURFACE RIGHTS ONLY	○
" MINING RIGHTS ONLY	⊙
LEASE, SURFACE & MINING RIGHTS	■
" SURFACE RIGHTS ONLY	□
" MINING RIGHTS ONLY	▣
LICENCE OF OCCUPATION	▼
ORDER IN-COUNCIL	OC
RESERVATION	⊖
CANCELLED	⊗
SAND & GRAVEL	⊕

SCALE, 1 INCH = 40 CHAINS

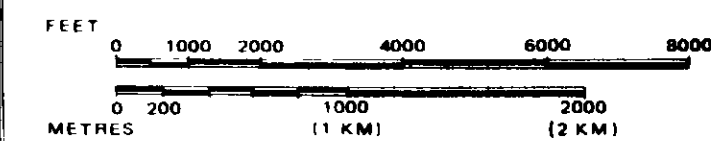

TOWNSHIP

ILSLEY

M.N.R. ADMINISTRATIVE DISTRICT

DRYDEN

MINING DIVISION

KENORA

LAND TITLES / REGISTRY DIVISION

KENORA

Ministry of
 Natural
 Resources
 Ontario

Ministry of
 Northern Development
 and Mines

Date NOVEMBER /92

Number
G-1315

THE INFORMATION
 APPEARS ON THIS
 HAS BEEN COM
 FROM VARIOUS SO
 AND ACCURACY IS
 GUARANTEED. I
 WISHING TO STAK
 ING CLAIMS SHOU
 SULT WITH THE M
 RECORDER MINIS
 NORTHERN DIV
 MENT AND MINES
 DITIONAL INFORM
 ON THE STATUS O
 LANDS SHOWN HE



52G12SW0001 2 16359 ILSLEY

AREAS WITHDRAWN FROM DISPOSITION

- M.R.O. - MINING RIGHTS ONLY
- S.R.O. - SURFACE RIGHTS ONLY
- M + S. - MINING AND SURFACE RIGHTS

Description Order No Date Disposition File

OVAL LAKE

HOOK LAKE

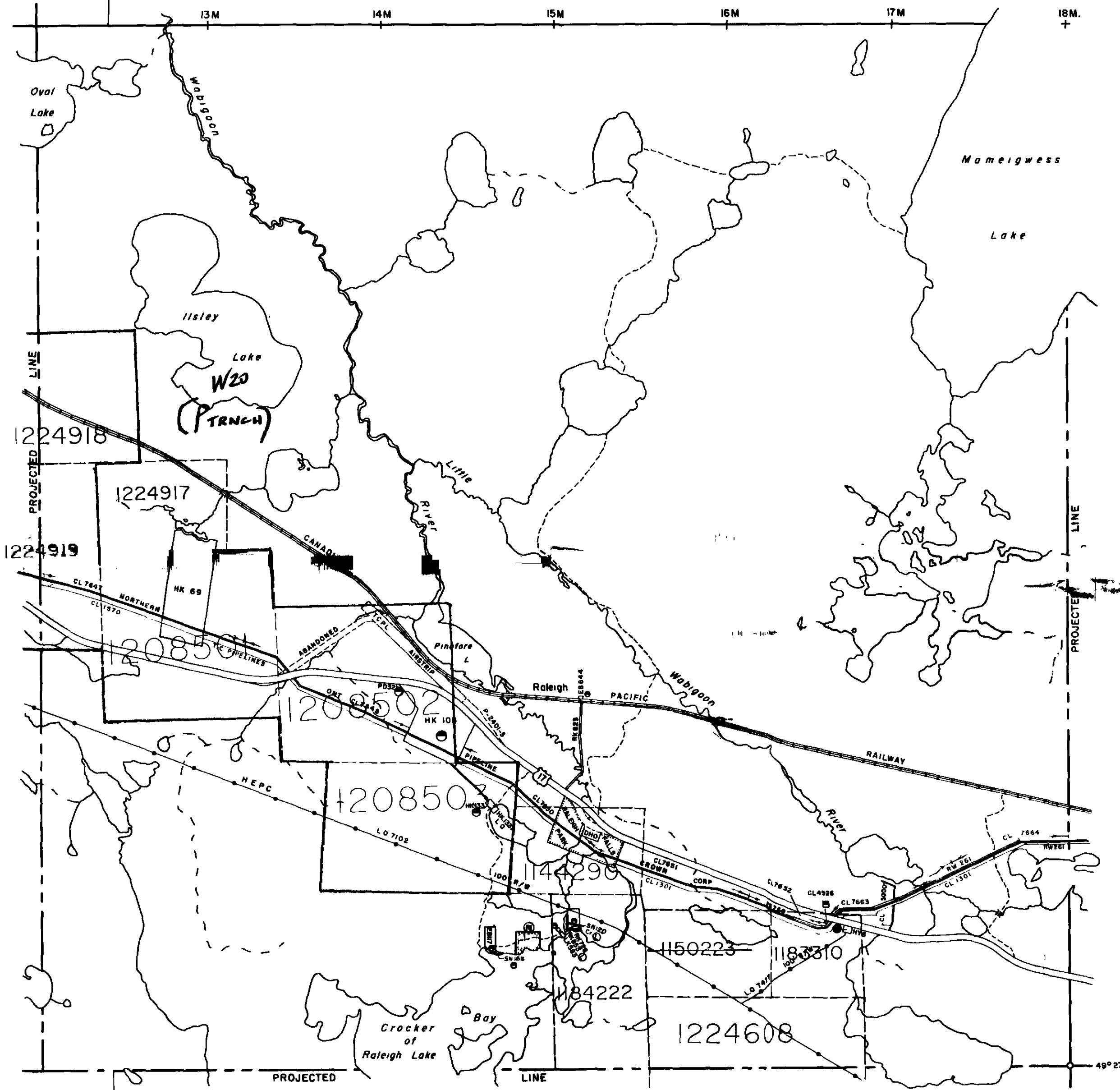

LEGEND

- HIGHWAY AND ROUTE No
- OTHER ROADS
- TRAILS
- SURVEYED LINES
- TOWNSHIPS, BASE LINES, ETC
- LOTS, MINING CLAIMS, PARCELS, ETC
- UNSURVEYED LINES
- LOT LINES
- PARCEL BOUNDARY
- MINING CLAIMS ETC
- RAILWAY AND RIGHT OF WAY
- UTILITY LINES
- NON-PERENNIAL STREAM
- FLOODING OR FLOODING RIGHTS
- SUBDIVISION OR COMPOSITE PLAN
- RESERVATIONS
- ORIGINAL SHORELINE
- MARSH OR MUSKEG
- MINES
- TRAVERSE MONUMENT

DISPOSITION OF CROWN LANDS

TYPE OF DOCUMENT	SYMBOL
PATENT, SURFACE & MINING RIGHTS	●
" SURFACE RIGHTS ONLY	○
" MINING RIGHTS ONLY	◐
LEASE, SURFACE & MINING RIGHTS	■
" SURFACE RIGHTS ONLY	□
" MINING RIGHTS ONLY	◻
LICENCE OF OCCUPATION	▼
ORDER-IN-COUNCIL	OC
RESERVATION	⊙
CANCELLED	⊖
SAND & GRAVEL	⊕

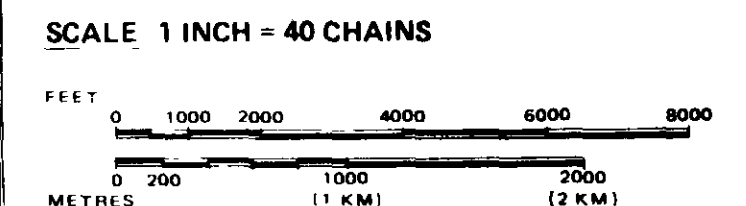

TOWNSHIP 2. 163 59

RECEIVED
JAN 17 1996
MINING LANDS BRANCH
ADMINISTRATIVE DISTRICT

DRYDEN
MINING DIVISION
KENORA
LAND TITLES / REGISTRY DIVISION
KENORA

Ministry of Natural Resources Ontario
Ministry of Northern Development and Mines

Date NOVEMBER /92 Number G-1315

DATE OF ISSUE
JAN - 8 1996
KENORA
MINING DIVISION



REFERENCES

AREAS WITHDRAWN FROM DISPOSITION

- M R O - MINING RIGHTS ONLY
- S R O - SURFACE RIGHTS ONLY
- M B S - MINING AND SURFACE RIGHTS

Description	Order No	Date	Disposition	File
(X) W92/77		11/22/77	S R O	116325
(R2) Sec 43	W6/80	22/12/80	S R O	158155
(R3) Sec 36	W4/87	08/01/87	M B S	188555

HYNDMAN TWP

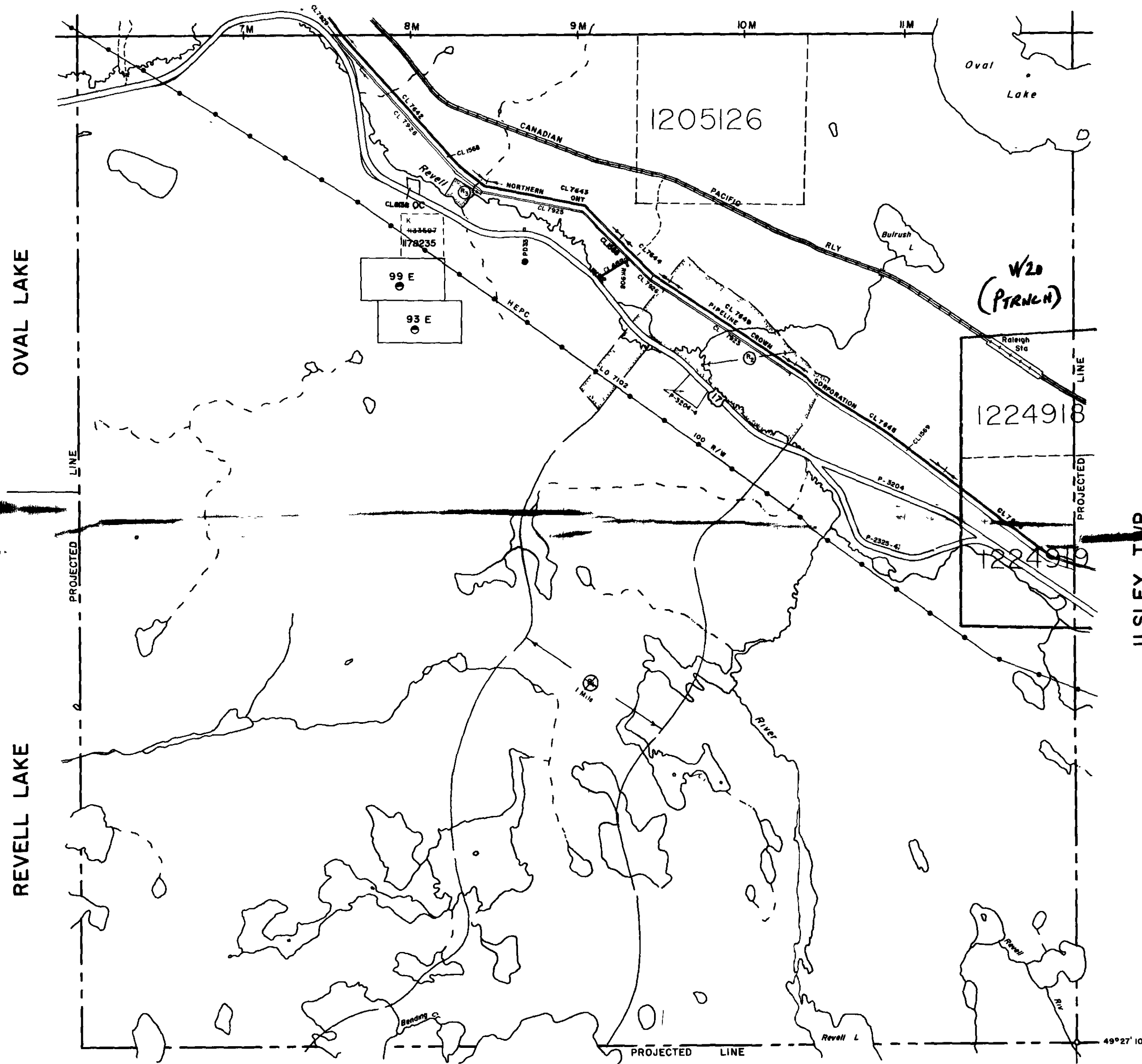

REVELL LAKE

ILSLEY TWP

REVELL LAKE

LEGEND

- HIGHWAY AND ROUTE No
- OTHER ROADS
- TRAILS
- SURVEYED LINES
- TOWNSHIPS, BASE LINES, ETC
- LOTS, MINING CLAIMS, PARCELS, ETC
- UNSURVEYED LINES
- LOT LINES
- PARCEL BOUNDARY
- MINING CLAIMS ETC
- RAILWAY AND RIGHT OF WAY
- UTILITY LINES
- NON-PERENNIAL STREAM
- FLOODING OR FLOODING RIGHTS
- SUBDIVISION OR COMPOSITE PLAN
- RESERVATIONS
- ORIGINAL SHORELINE
- MARSH OR MUSKEG
- MINES
- TRAVERSE MONUMENT

DISPOSITION OF CROWN LANDS

TYPE OF DOCUMENT	SYMBOL
PATENT, SURFACE & MINING RIGHTS	●
" SURFACE RIGHTS ONLY	○
" MINING RIGHTS ONLY	◐
LEASE, SURFACE & MINING RIGHTS	■
" SURFACE RIGHTS ONLY	◼
" MINING RIGHTS ONLY	◻
LICENCE OF OCCUPATION	▼
ORDER-IN-COUNCIL	OC
RESERVATION	⊙
CANCELLED	⊗
SAND & GRAVEL	⊕

SCALE 1 INCH = 40 CHAINS

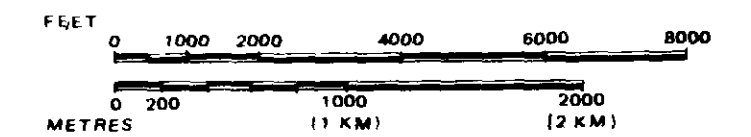

TOWNSHIP

HODGSON

M.N.R. ADMINISTRATIVE DISTRICT
DRYDEN
 MINING DIVISION
KENORA
 LAND TITLES / REGISTRY DIVISION
KENORA

Ministry of Natural Resources Ontario
 Ministry of Northern Development and Mines

Date NOVEMBER/92

Number

G-1313

DATE OF ISSUE

JAN - 8 1996

KENORA
 MINING DIVISION



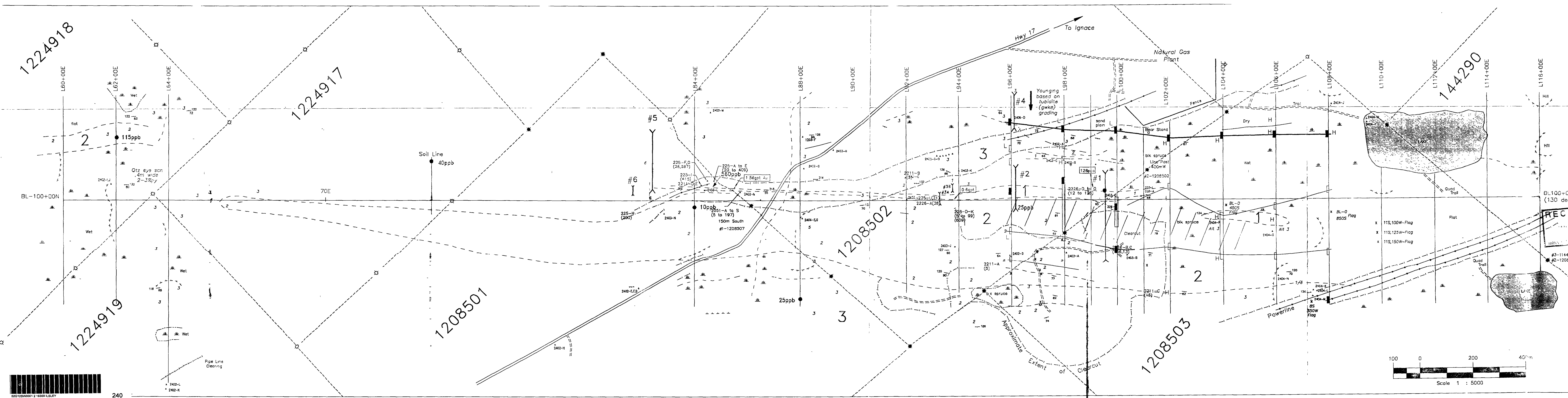

LEGEND

6	Gabbro	swamp
5	Porphyry Dykes	clear cut
4	Diorite	road
3	Qtz-fsp-bt-seds (gwks)	area
2	Bt-hb seds	power line
1	Qtz-eye schist (alt'd Qtz-fsp-bt-gwke seds)	trench

- - - contact - observed
 - - - - - contact - assumed
 / / / bedding
 - - - cleavage
 / / / foliation / schistos. ty
 x outcrop - large, small
 * claim post
 --- claim line
 * anomalous soil
 H L High/Low Resistivity
 ■ High Chargeability
 □ Med. Chargeability
 * 2404-0 grab sample and number
 * 2404-0

RECEIVED
 BRANCH

HEMLO GOLD 2.163 59
 Timmins, ONT

RALEIGH LAKE PROJECT
GEOLOGY

Interpreted by: B. MacLachlan
 Drawn by: L. Waddell
 Revised:
 Date: November 1995

Scale
 NTS number: 52-F-8
 Project number: 471
 File number: RALGEO

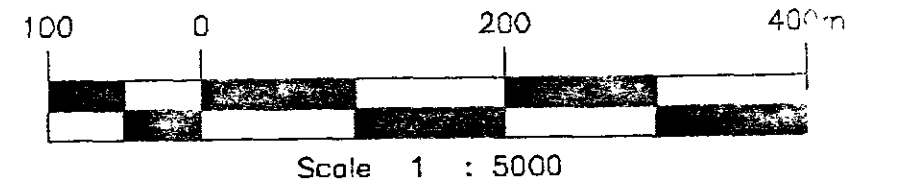

240

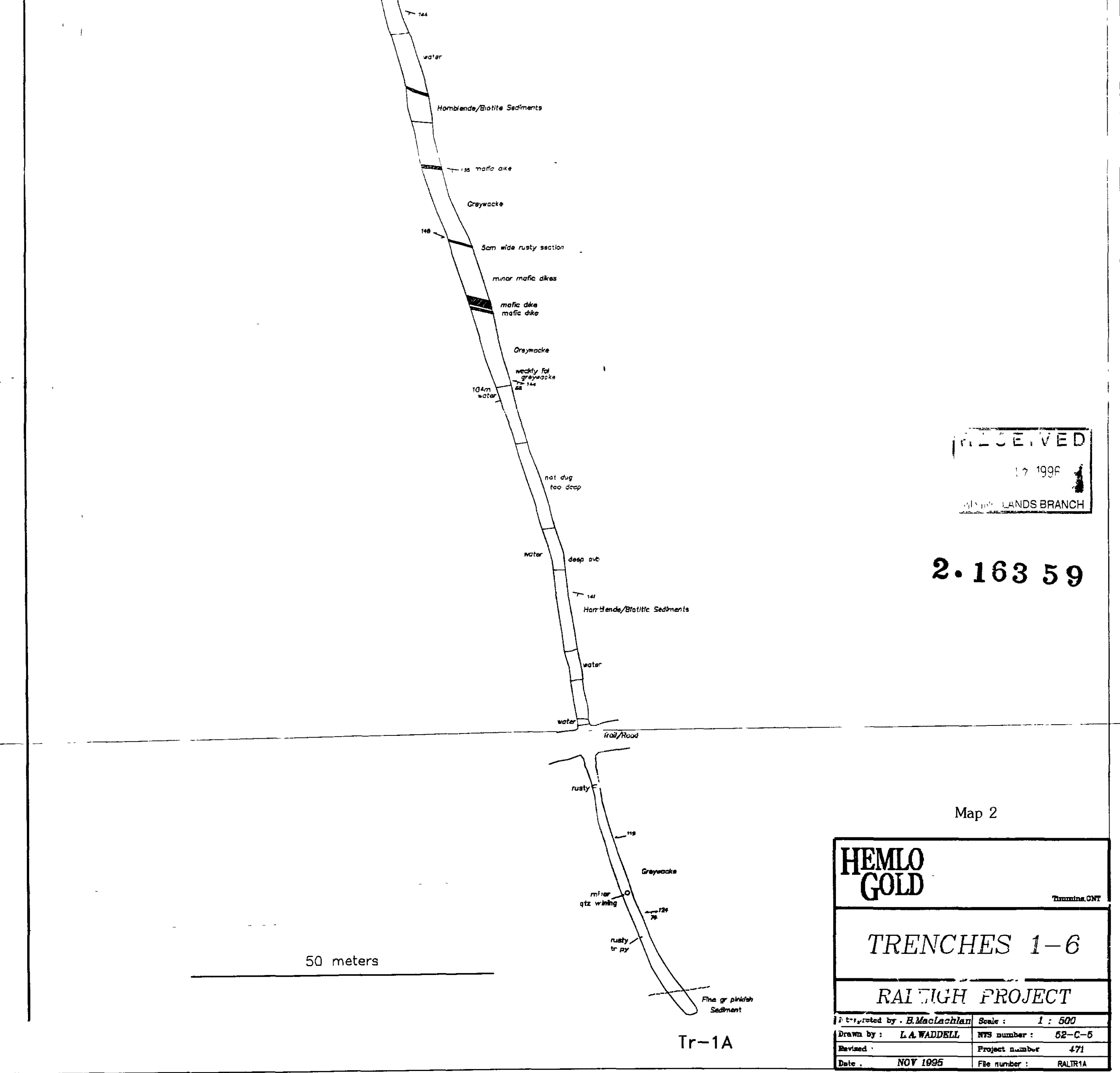
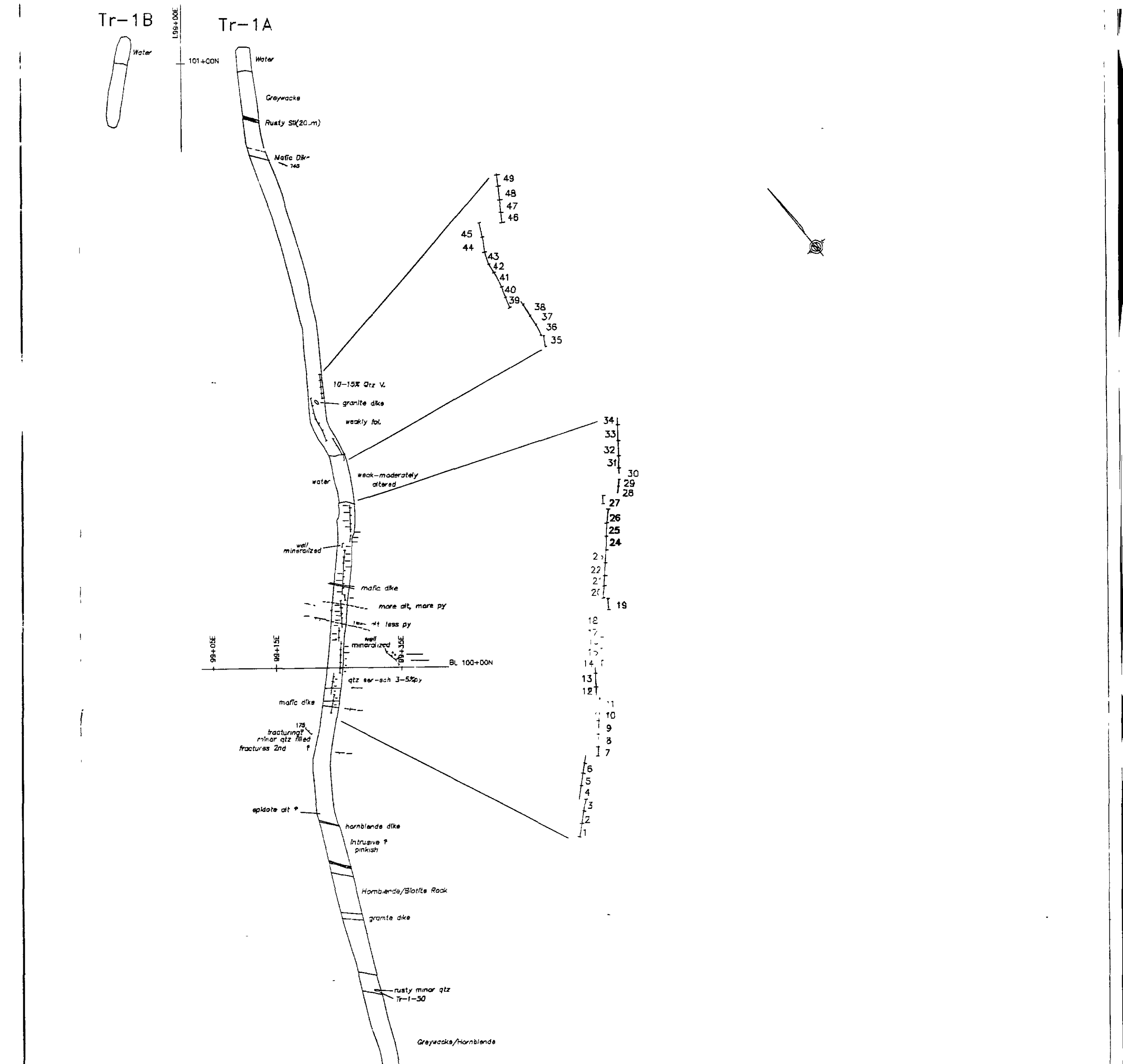
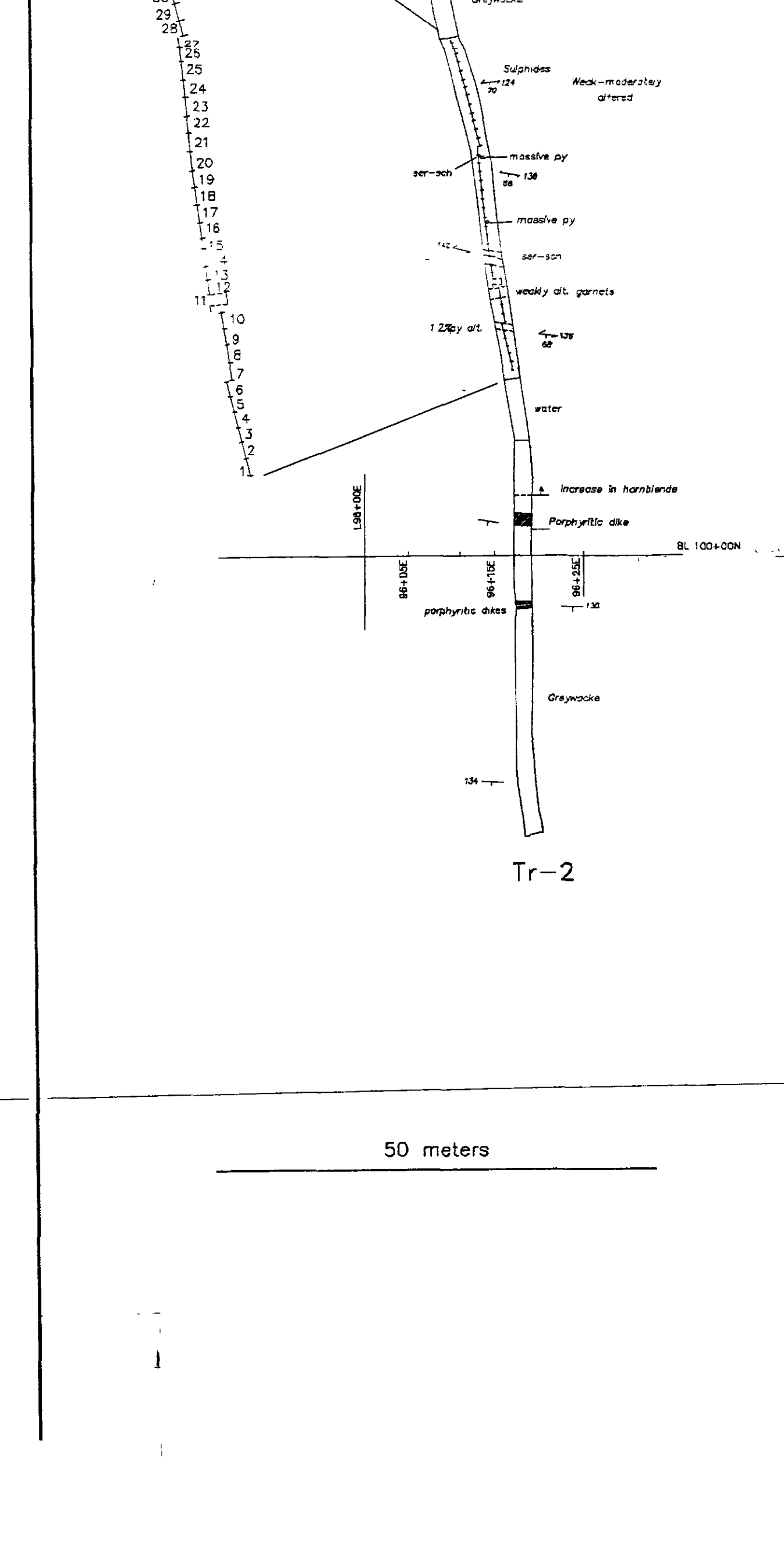
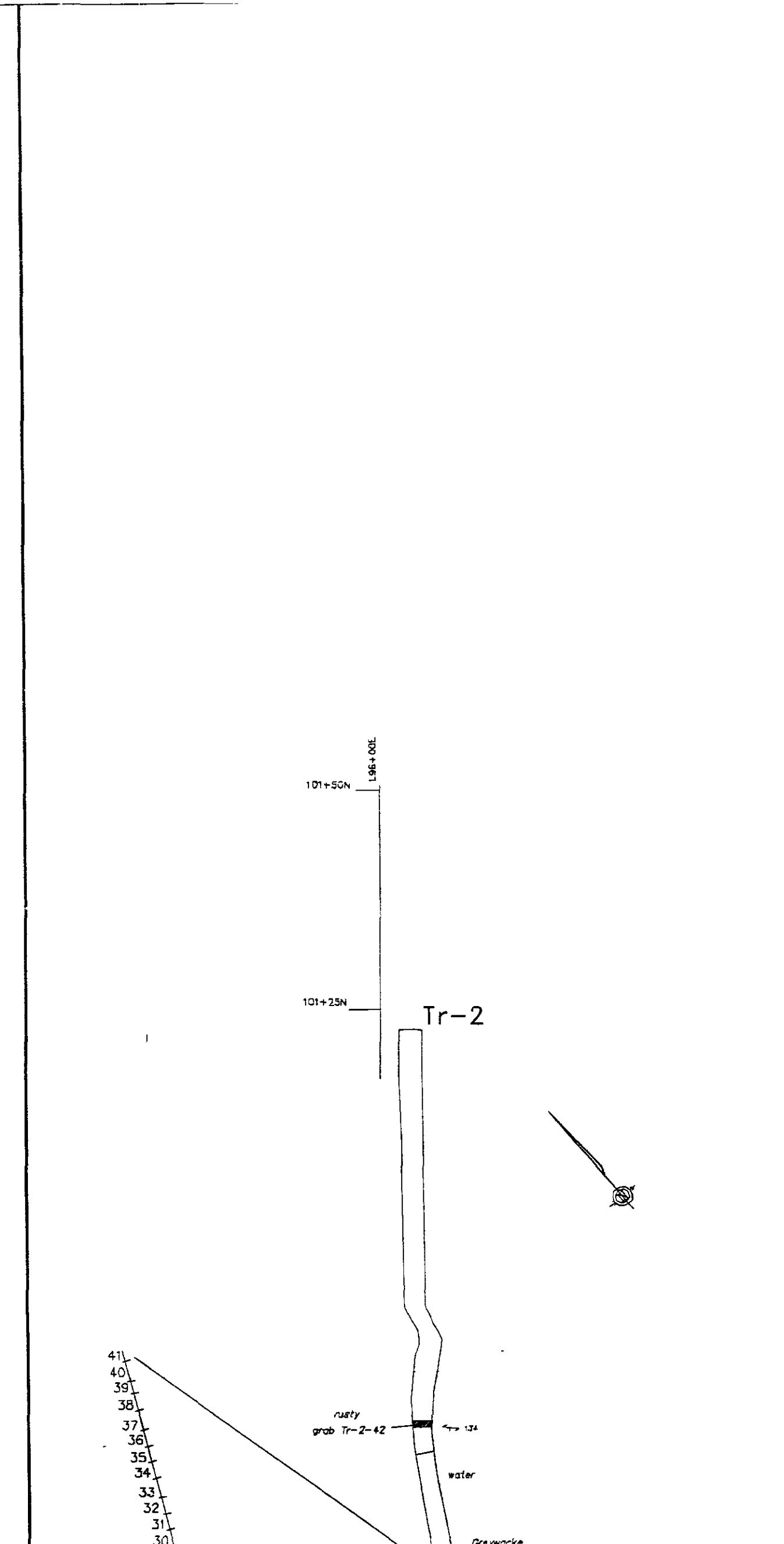
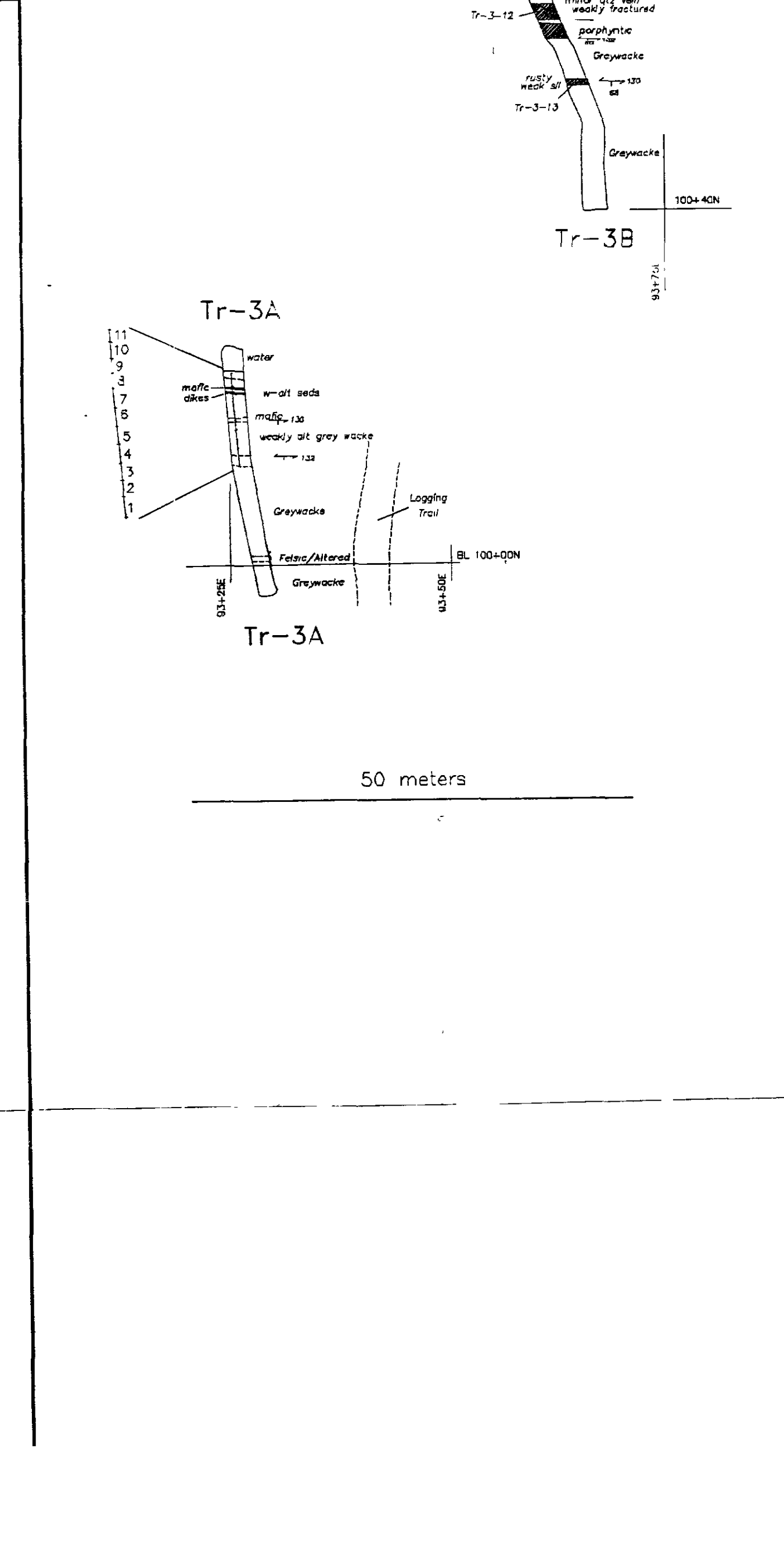
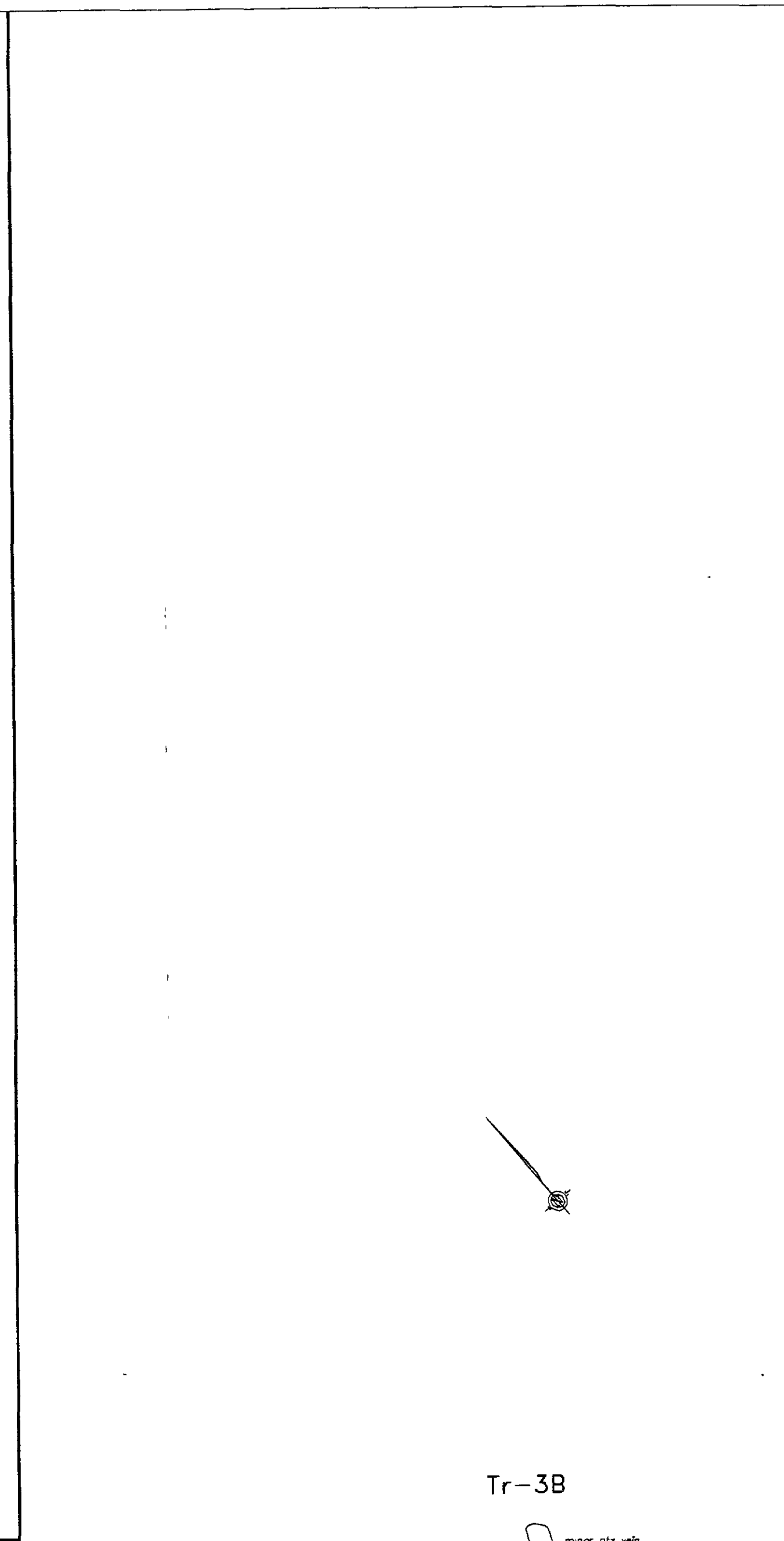
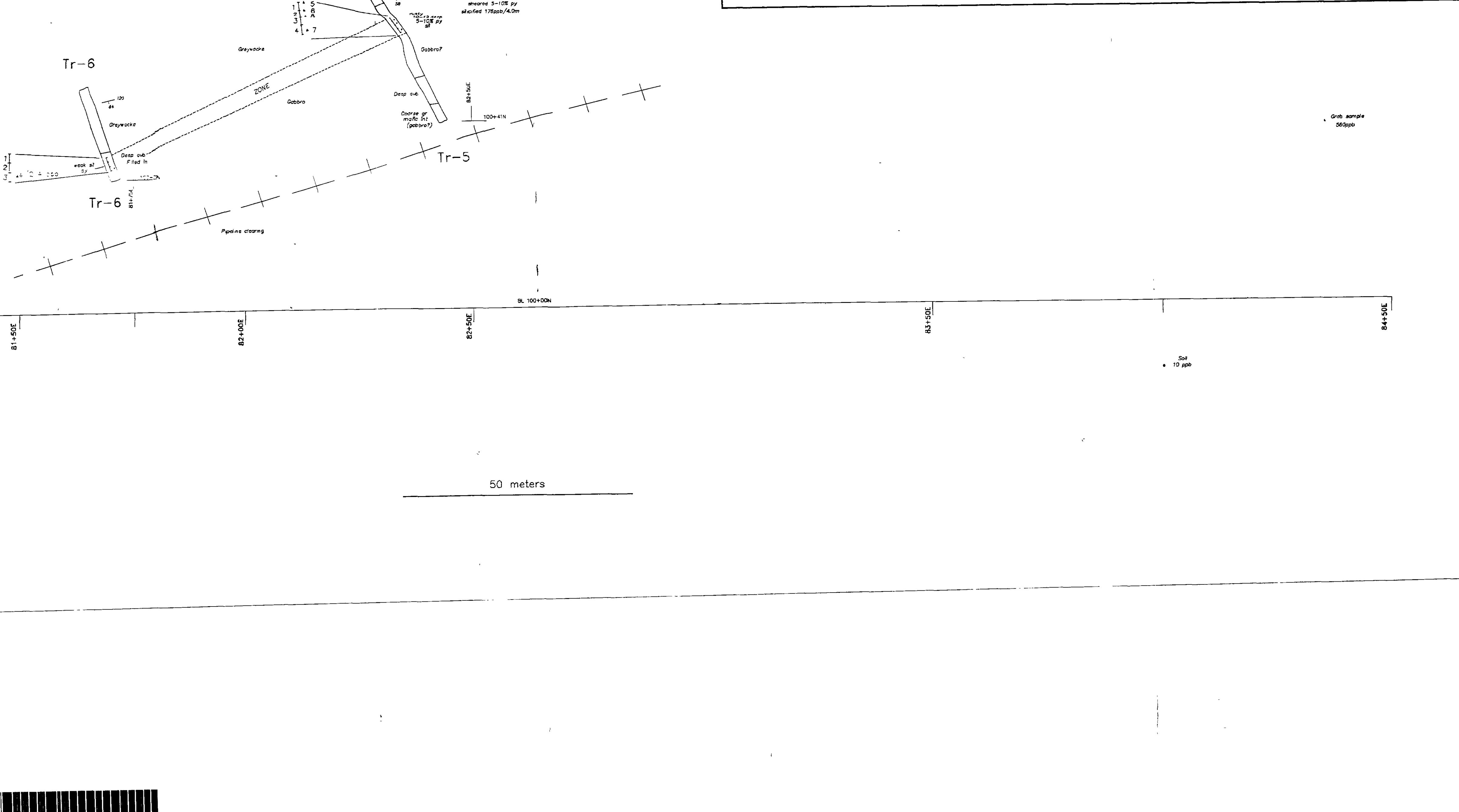
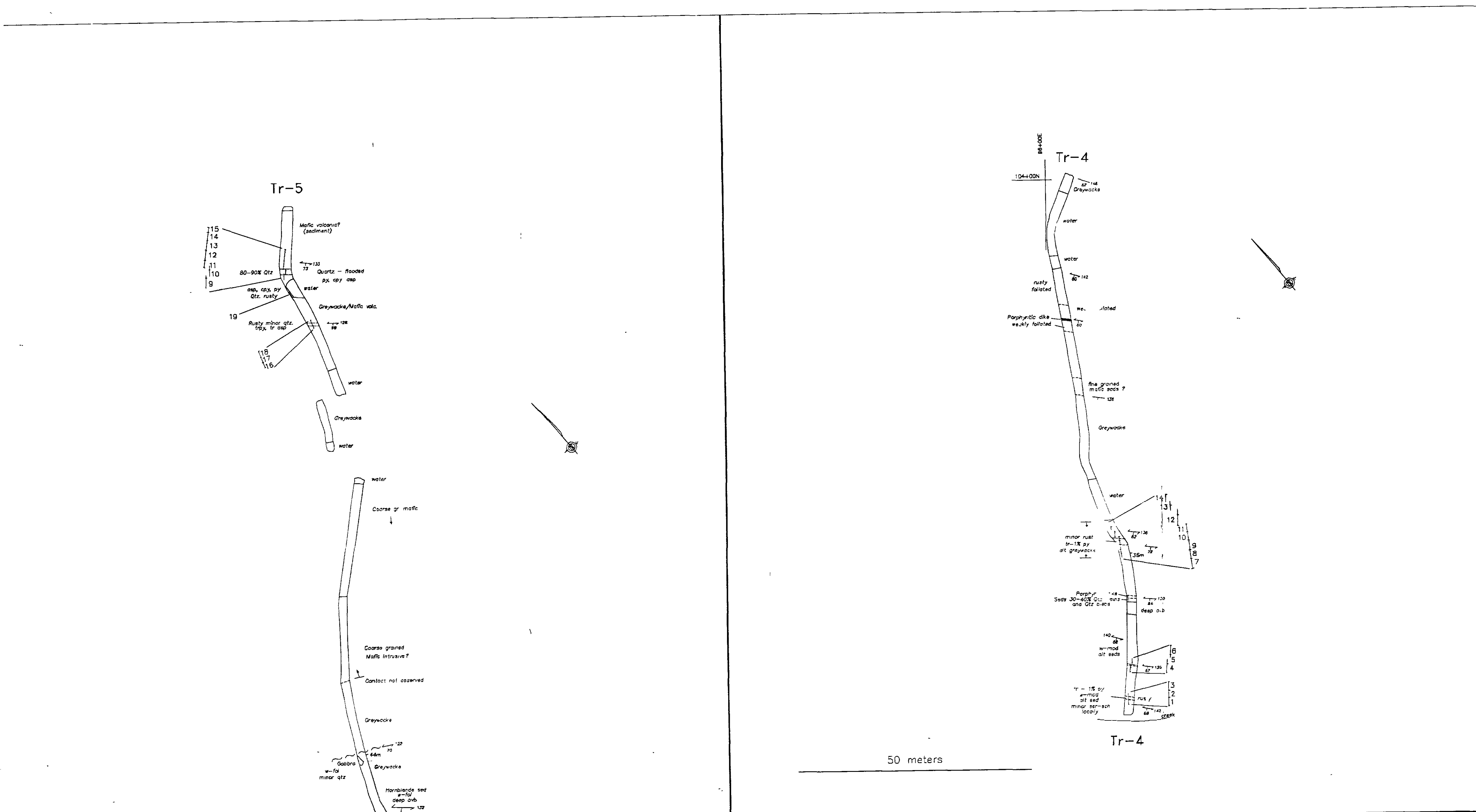

RECEIVED
1996
LANDS BRANCH

2.163 59

Map 2

HEMLO GOLD
TRENCHES 1-6
RALEIGH PROJECT
Scale: 1:500
Drawn by: L.A. WADDELL
Date: NOV 1995

