

52G13NW9229 2.14341 PARNES LAKE

010

MINING DIVISION
PATRICIA
MINING RECORDER

JUN 8 09:22

REPORT

ON

GEOLOGIC MAPPING

AND

SAMPLING

KURYLIW CLAIM GROUP

BURNTHUT ISLAND - MINNITAKI LAKE

SIoux LOOKOUT AREA, ONTARIO

2.14341

December 23, 1990

Chester J. Kuryliw, M.Sc., P.Eng.

63.1789



52G13NW9229 2.14341 PARNES LAKE

010C

INDEX

Title Page

Property, Location and Access

History

Topography, Overburden, Tree Growth

General Geology

Local Geology

Table of Formations

1. Quarts veining
2. Carbonatization in sheared Basalts
3. Quartz Porphyry

Intrusive Contact

4. Sediments, Greywackes

Unconformity

5. Interflow Sediments
6. Interflow Cherts
7. Basalt, Fine to med. grained massive flows
8. Basalt, Fine grained in parts Ellipsoidal

Structural Geology

Economic Geology and Sampling

Conclusions

Recommendations

Certificate

PROPERTY, LOCATION AND ACCESS

The property consists of a single group of 53 claims in Minnitaki Lake that included Burnthut Island and the west end of Neepawa Island, Parnes Lake area, M.N.R. map G2164, Patricia mining Division, Northwestern, Ontario.

The 54 unpatented claims are fully owned by Chester J. Kuryliw of Dryden, Ontario. The claims are numbered as follows:

Pa - 1133370	Pa - 1133394	Pa-1102298
Pa - 1133371	Pa - 1133395	Pa-1102299
Pa - 1133372	Pa - 1133396	Pa-1133403
Pa - 1133373	Pa - 1133398	Pa-1133404
Pa - 1133374	Pa - 1133399	Pa-1133407
Pa - 1133375	Pa - 1119400	Pa-1133408
Pa - 1133376	Pa - 1119401	Pa-1133411
Pa - 1133377	Pa - 1119402	Pa-1133412
Pa - 1133378	Pa - 1119403	Pa-1133415
Pa - 1133379	Pa - 1119404	Pa-1133416
Pa - 1133380	Pa - 1119405	Pa-1133417
Pa - 1133381	Pa - 1119406	Pa-1133418
Pa - 1133382	Pa - 1119407	
Pa - 1133383	Pa - 1119408	
Pa - 1133384	Pa - 1119409	
Pa - 1133385	Pa - 1119410	
Pa - 1133386	Pa - 1119411	
Pa - 1133387	Pa - 1102294	
Pa - 1133388	Pa - 1102295	
Pa - 1133389	Pa - 1102296	
Pa - 1133393	Pa - 1102297	

Access to the property from Dryden is by Highway 17 East and Highway 72 to Pickerel Arm Camp. (A total of 55 miles from Dryden). The remaining 12 miles to Burnthut Island was travelled by boat in summer and by snowmobile over the ice in winter.

Gold occurrences have been known on Burnthut Island as early as 1898 when a shaft about 50 feet deep was sunk on the contact between quartz porphyry and sheared "greenstone" in the southern part of the island (Hurst 1932, p.21).

The following information has been taken mainly from the reports of Oja (1962) and Hudson (1947; 1948).

A diamond drill program totalling 5,028 feet was completed in 1947 and, in 1961 to 1962, a further 2,300 feet were drilled and a magnetometer survey was conducted on ice.

There have been four areas where gold mineralization has been partially outlined on the property. These are designated as a shaft zone and numbers 1, 2, and 3 zones (Figure 6).

The shaft and number 1 zones occur at or near the contact of the quartz porphyry with schistose and massive fine-grained mafic metavolcanics on the southern part of the island. This contact is sheared and carbonatized over varying widths of up to 150 feet. Gold-bearing quartz veins and stringer zones accompanied by much mariposite and pyrite also occur along this contact over a distance of more than 1,300 feet. Small amounts of galena and chalcopyrite are also present.

Number 1 zone is essentially a continuation of the shaft zone except that mineralization in the former appears to lie wholly within the mafic metavolcanics and in the latter the mineralization is confined to the contact zone between porphyry and greenstone.

Number 2 zone lies about $\frac{1}{4}$ mile to the north of the shaft zone and is associated with quartz stringers in a fractured and sheared quartz porphyry dike. Diamond drilling of this one revealed low and erratic gold-values.

Number 3 zone lies on the mainland to the west of number 2 zone (claim Pa27918) where a few trenches have been excavated on small quartz veins in "greenstone". A grab sample by the writer from a small trench by the shore was found by the Laboratory and Research Branch, Ontario Department of Mines and Northern Affairs to assay 0.04 ounces gold.

Grab samples taken in the vicinity of the shaft are reported by Oja (1962) to assay up to \$21.00 per ton (\$35 U.S. per ounce) but assays from drill results were quite low over narrow widths. Better intersections were obtained from number 1 zone where drilling, in 1947, indicated a gold-bearing section 300 feet long, 4 feet wide, and grading \$6.15 per ton (\$35 U.S. per ounce). Further drilling, in 1961, failed to verify the continuity of this section.

Oja (1962) suggests that the gold-bearing stringers may lie transverse to the quartz-carbonate-mariposite zone and hence are roughly parallel to the drill holes, accounting for the lack of continuity and erratic values obtained.

Vermilion-Abram Lakes Area

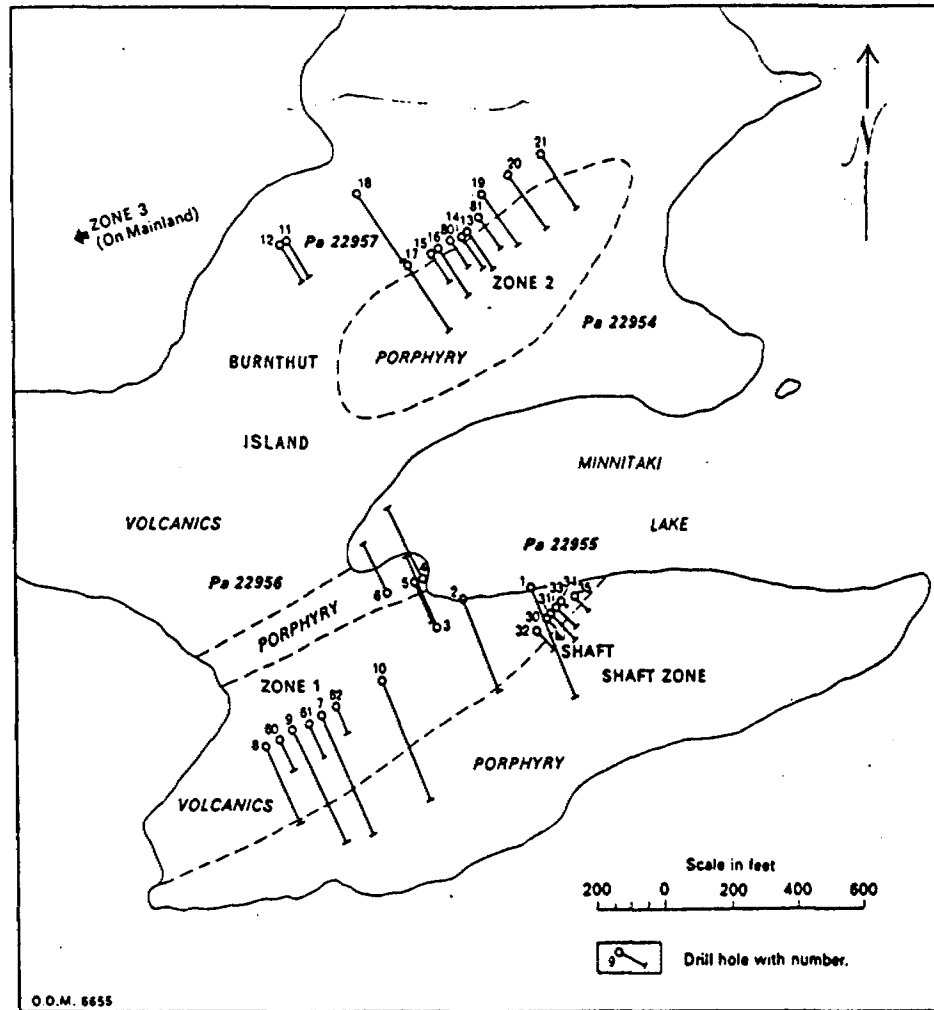
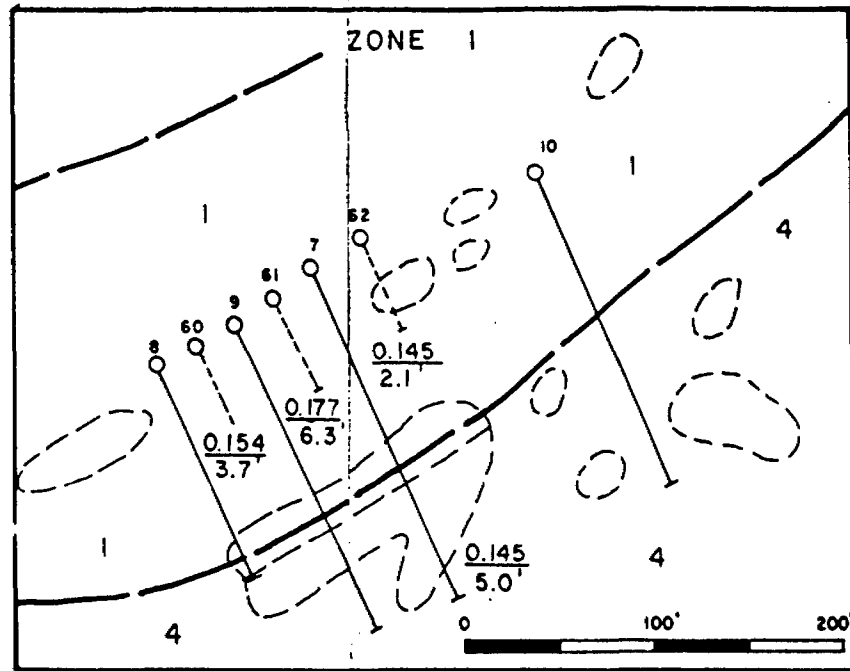

Figure 6—Diamond drill plan, Ourgold Mining Company Limited (13) Burnthut Island property.



LEGEND

- 4 QUARTZ FELDSPAR PORPHYRY
- 3 METASEDIMENTS
- 2 INTERMEDIATE METAVOLCANICS
- 1 MAFIC METAVOLCANICS

SYMBOLS

- : ZONE OF SILICIFICATION & CARBONITIZATION
- : DIAMOND DRILL HOLE 1947
- : DIAMOND DRILL HOLE 1961

TOPOGRAPHY, OVERBURDEN AND TREE GROWTH

The Topography of Burnthut Island consists of relatively sharp relief with two east-north-east trending ridges separated by a narrow valley that forms sand beaches along the shoreline. There is a light cover of overburden on the ridges which are essentially outcrops of bedrocks. The valleys between ridges are relatively flat with a good growth of balsam with minor spruce, poplar and birch.

The tree growth on the ridges are essentially scrub balsam with some spruce, birch and poplar. A few large Norway pines occur on the crests of the ridges. The overburden in the valleys is essentially rubble with some sandy silt.

INTRODUCTION

This claim group was staked by this writer in July 1989. Subsequently this writer obtained an O.P.A.P. Grant that covered the cost of an exploratory drill hole. The drill hole was drilled on claim PA-1133417 to a depth of 479 feet during the latter part of December 1989 and into early January 1990.

A second O.P.A.P. grant was received by this writer in 1990 which was used to finance a program of line-cutting, a controlled grid on Burnthut Island, the geologic mapping of that Grid, the geologic mapping of the Dog Island - West Neepawa Island area and the reconnaissance mapping of the area of the claim group. A program of sampling was also carried out using a diamond - blade - saw which was used to cut channels for sampling the more favourable looking veins and quartz-carbonate alteration. This large bulk of rock samples was transported to the Wawa Assaying Lab in Wawa, Ontario where it was assayed for gold content.

A temporary camp was established on Burnthut Island for accommodations to carry out the work programs in 1990.

GENERAL GEOLOGY

The Kuryliw Minnitaki Lake property is underlain by early precambrian rocks of the Wabigoon sub-province, part of the Superior Province. It straddles the contact of a four kilometer wide East-North-East trending clastic sedimentary belt to the South and an eight kilometer wide belt of Mafic Volcanics to the North. (Ontario Geologic survey map 2442)

A major East-North-East trending fault movement occurs along multiple planes, parallel to the contacts (and the sedimentary bedding) that results in a shift of the southern sediments East-North-Eastwards relative to the Northerly Volcanics. This shearing movement resulted in the formation of a strong - shear foliation of the Mafic volcanics near the Sedimentary Contact. This foliation parallels the sedimentary belt and the fault plane. This foliation cuts across the volcanic flow trends in parts where it is unconformable with the Sedimentary contact.

The foliated mafic volcanics that occur just north of the sedimentary contact, and fault, are the site of strong carbonate alteration in parts that have been intruded by a chain of Quartz-porphry intrusions and then silicified with gold bearing Quartz veins and stockworks.

TABLE OF FORMATIONS

PHANEROZOIC

Pleistocene and Recent
(Sand, Till, Clay Rubble)

PRECAMBRIAN

LATE PRECAMBRIAN

- (8) Quartz Veining, Quartz Stockworks in Carbonate.
- (7) Quartz Porphyry Intrusions.
- (6) Carbonatization of Foliated Basalts.

UPPER EARLY PRECAMBRIAN

- (5) Sediments and Metasediments.
(Greywacke Argillite Siltstones, etc)

UNCONFORMITY

LOWER EARLY PRECAMBRIAN (VOLCANIC SERIES)

- (4) Interflow Sediments.
- (3) Interflow Chert Beds.
- (2) Basalt - Massive Flows.
- (1) Basalt Fine Grained, In Parts Ellipsoidal Flows.

LOCAL GEOLOGY

Rock Types:

BASALTS:

The Basalt lavas are dark greenish and fine grained flows in some parts these exhibit elipsoidal (pillowed lava) structures. A fine to medium grained massive flow of Basalt occurs across the south-central part of Burnthut Island where it resembles a fine grained Diorite-Gabbro.

INTERFLOW CHERTS:

On Dog Island an Interflow Chert two-three feet thick consists of a bluish grey "flinty" Chert finely banded with a very low content of iron Sulphides. On one side of the Cherts well defined pillow-lava structures follow the bed.

INTERFLOW SEDIMENTS:

On Burnthut Island near the North shore of the South-Eastern Bay a band of sediments up to seventy feet thick occurs in the Basalts. The sediments consist of finely banded Argillites and lean iron formation.

SEDIMENTARY FORMATION:

This formation is over one mile thick and occurs to the South of and unconformably over the older Basalt formation. It consist largely of dark greenish grey, finely bedded Greywackes with some interbedded Argillites and more rarely narrow beds of lean Iron formation.

LOCAL GEOLOGY

Rock Types:

BASALTS:

The Basalt lavas are dark greenish and fine grained flows in some parts these exhibit elipsoidal (pillowed lava) structures. A fine

Rock Types Continued:

QUARTZ PORPHYRY

An extensive elongated mass of Quartz-Porphyry intrudes the Basalt formation just North of the Sedimentary contact. The main intrusion occurs along the Southern shore of Burnthut Island and the Southern shore of the Penninsula to the South-West of Burnthut Island. A chain of smaller intrusions of Quartz-Porphyry occur on the Central part of Burnthut Island and on the West side of Neepawa Island. The rock is a light buff-grey and consists largely of fine white Feldspar and Quartz with some sericite and rare quartz-phenocrysts.

QUARTZ-CARBONATE ALTERATION:

Extensive carbonate alteration occurs along the trend of the foliated sheared and faulted Basalts immediately to the North of the contact with the sedimentary formation.

The quartz in the carbonitized zones occurs in a stockwork fracture and is generally milky-white to glassy type.

The quartz veins found in proximity to quartz Porphyry intrusions that occur on the central part of Burnthut Island are located about one-half mile North of the Sedimentary formation contact. At this location the quartz veins are of a greyish, very hard nature with a "flinty" Choncoidal fracture and recognizable carbonate alteration is absent.

STRUCTURAL GEOLOGY

The stratigraphic contact between the Precambrian sediments to the South of the claim group in Minnitaki Lake and the Basalt Volcanic group to the North of the sedimentary contact is the major geologic feature of the area. There is much evidence that there was a shear movement of the southern portion moving East, North East parallel to the contact relative to the volcanics to the North. There is excellent evidence of this at Dog Island just West of Neepawa Island where a curved northerly trending chert bed is progressively cut by faulting and a sheared zone in the Lavas that parallels the sedimentary contact. The shift of the interflow chert bed with its conformable adjoining pillowed lava beds at Dog Island is progressively shifted to the East North East as the bed is traced southwards.

The mapping has located the shearing, faulting, and carbonitization along some of the shearing in the volcanics that is in proximity to the sedimentary contact, where it is found, that they are approximately conformable with the sedimentary bedding that occurs in the sedimentary formation to the South.

The mapping also confirms that an unconformity occurs at the contact between the volcanics and sediments. The best evidence occurs at Dog Island where the Interflow Cherts, that are conformable with adjoining pillow lava beds are northerly trending and almost at right angles to the bedding of the sediments a few hundred feet to the south. Care had to be taken not to assume apparent conformity in the trends of the volcanics with the trends of the sediments. This apparent conformity in the volcanics is due to a strong foliation in the volcanics that follow the volcanic-sedimentary contact due to the conformable direction of shearing and faulting movements and carbonate alteration in proximity to the contact. Most commonly the stronger foliation and carbonate alteration occur within one thousand feet of the sedimentary contact.

On Burnthut Island quartz porphyry intrusions extend along the southern most point, approximately along the volcanic-sedimentary contact. Sampling areas S-2, S-3, S-7, and S-6 all occur in volcanics that have been strongly foliated and quartz-carbonitized and these occur along the Northerly contact of the quartz-porphyry intrusions.

STRUCTURAL GEOLOGY CONTINUED

In the central part of Burnthut Island and East, North-East trending chain of quartz-porphyry intrusions occur in massive basalt where foliation is subdued to absent. Quartz veining occurs along the contact of the quartz porphyry and these veins as found at sampling area S-1, S-4 are a very hard flinty-type of grey quartz with very little recognizable carbonate alteration in the vicinity.

ECONOMIC GEOLOGY AND SAMPLING

The Gold mineralization is widespread over the claim group. The type of alteration that carries the gold mineralization can be classified into two separate groupings. The first is a strong carbonate alteration that follows the trend of the foliation in the volcanics immediately north of the main sedimentary contact. Concentrations of quartz stockworks occur in the more strongly sheared and faulted portions especially in contact with intruding quartz-porphyry. This type of carbonate alteration was sampled in areas S-2, S-3, S-5, S-6, S-7.

The quartz stockworks veining follows three fracture trends. The main trend is East-North-East and conformable with the volcanic foliation, which dips 75° - 85° northwards. The second most prominent stockwork fracture trend strikes with the foliation but dip southwards about 45° . A third quartz-filled fracture trend cuts perpendicular across the foliation and has varying dips from 30° - 80° eastwards.

The second group classification of gold bearing quartz veins consists of a flinty greyish quartz veining with a conchoidal fracture that occurs along the contact of quartz porphyry intrusions as in sampling area S-1, and near quartz porphyry intrusions as in sampling area S-4. No recognizable carbonate alteration occurs in area S-1, and S-4 and there is no prominent foliation in the Basalt volcanics.

SAMPLING PROCEDURE

Outcroppings of Quartz veins and of Carbonatized zones with Quartz Stockworks were stripped and cleaned of their light overburden cover. These outcroppings were mapped on a scale of 1" = 20ft. Channel samples were marked out to cross the quartz veins and more intense quartz-carbonate alteration.

SAMPLING PROCEDURE CONTINUED

The channel samples were cut using a gas driven saw with a 12" diamond tipped circular blade. A five gallon backpack with a hand pump was used to provide the coolant for the diamond blade. The channels were cut an average of 2" wide and 1" deep. The rock in the channel was then removed using a hammer and chisel and were then bagged to include the length of the sample marked. Most samples weighed five to fifteen pounds. A total of ninety-one samples were cut and then transported to the Wawa Assaying Lab, in Wawa, Ontario to be assayed for gold content.

The Assay results of the sampling with their gold content are indicated on sampling maps S-1 to S-7 inclusive. The gold mineralization is widespread and occurs in each of the seven areas sampled but no rich assays were returned. The best results were obtained from sampling area S-4 where the quartz veining had richer gold values that ran as high as 0.129 oz.au. over a vein width of one to five feet.

Sampling area S-4 is over an intriguing pattern of quartz veins that form a pyramidal structure. The East, North East vein dips 75° to the North, the North-North-West vein dips 30° to the West and the West-North-West vein dips 50° to the North. This unusual pattern may suggest the trends of a stockwork forming fracture pattern that may be repeated at depth. This structure warrants further exploration.

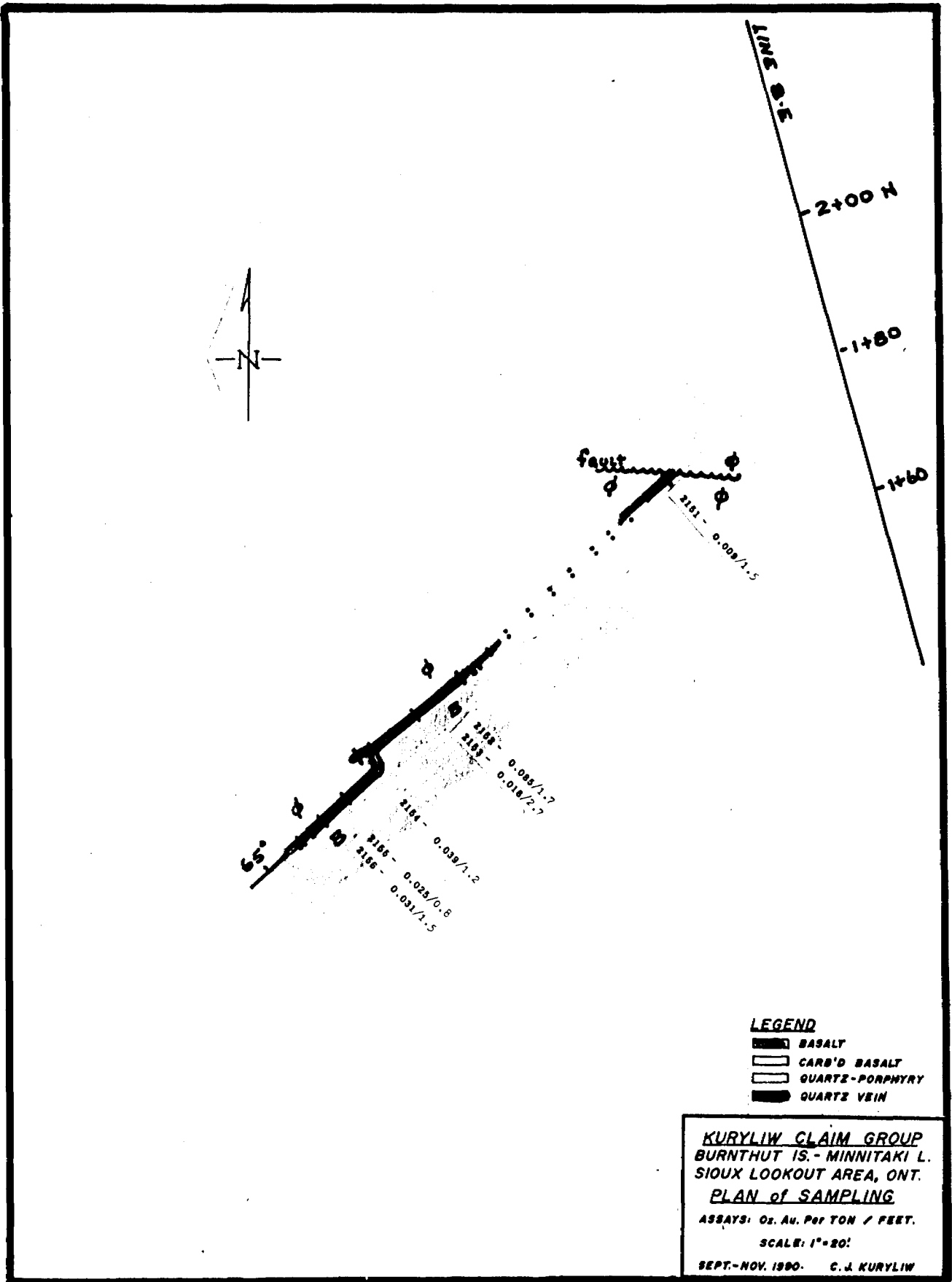

(S-1) CLAIM Pa 1133375

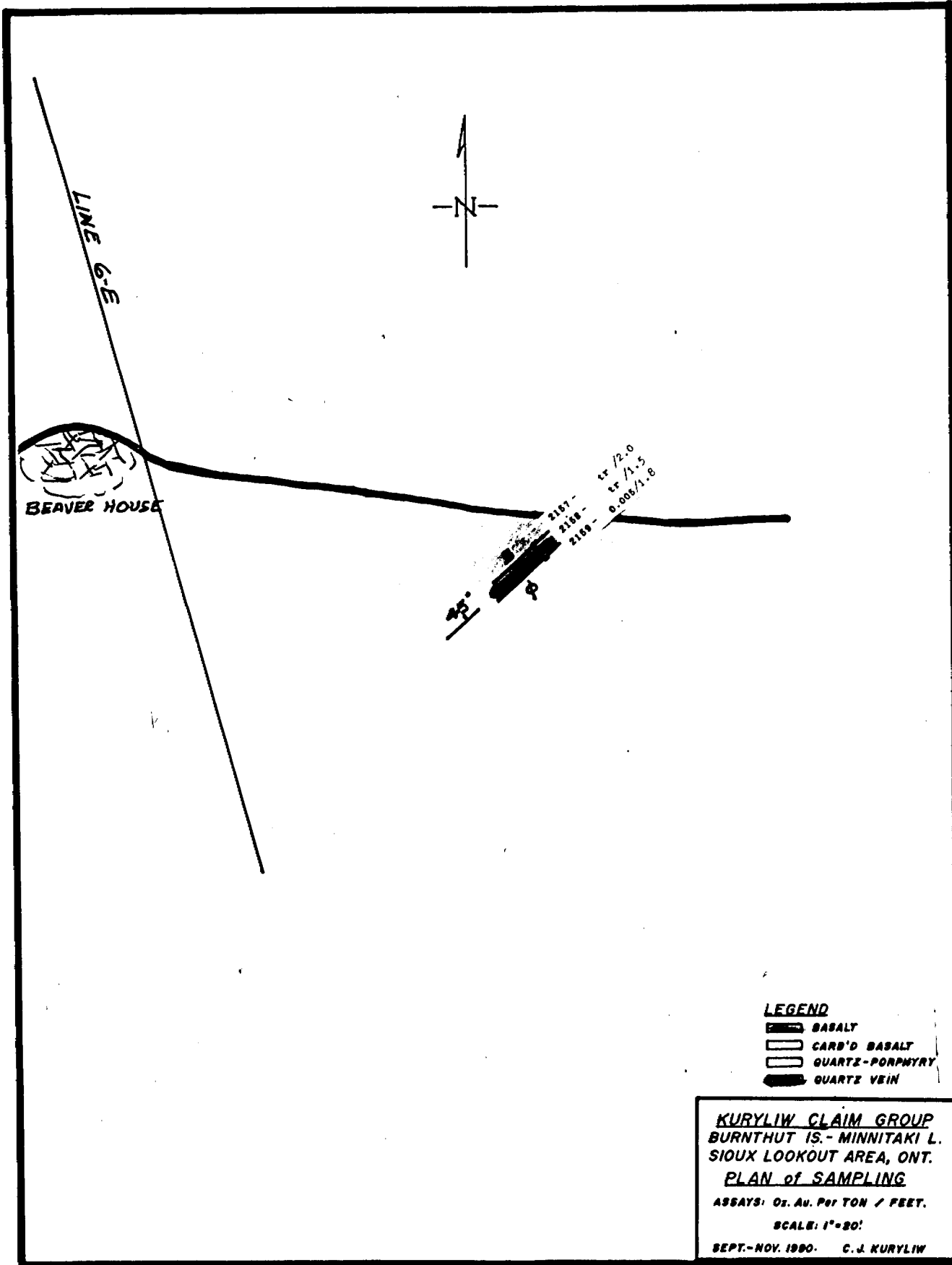

(S-2) CLAIM Pa 1133370

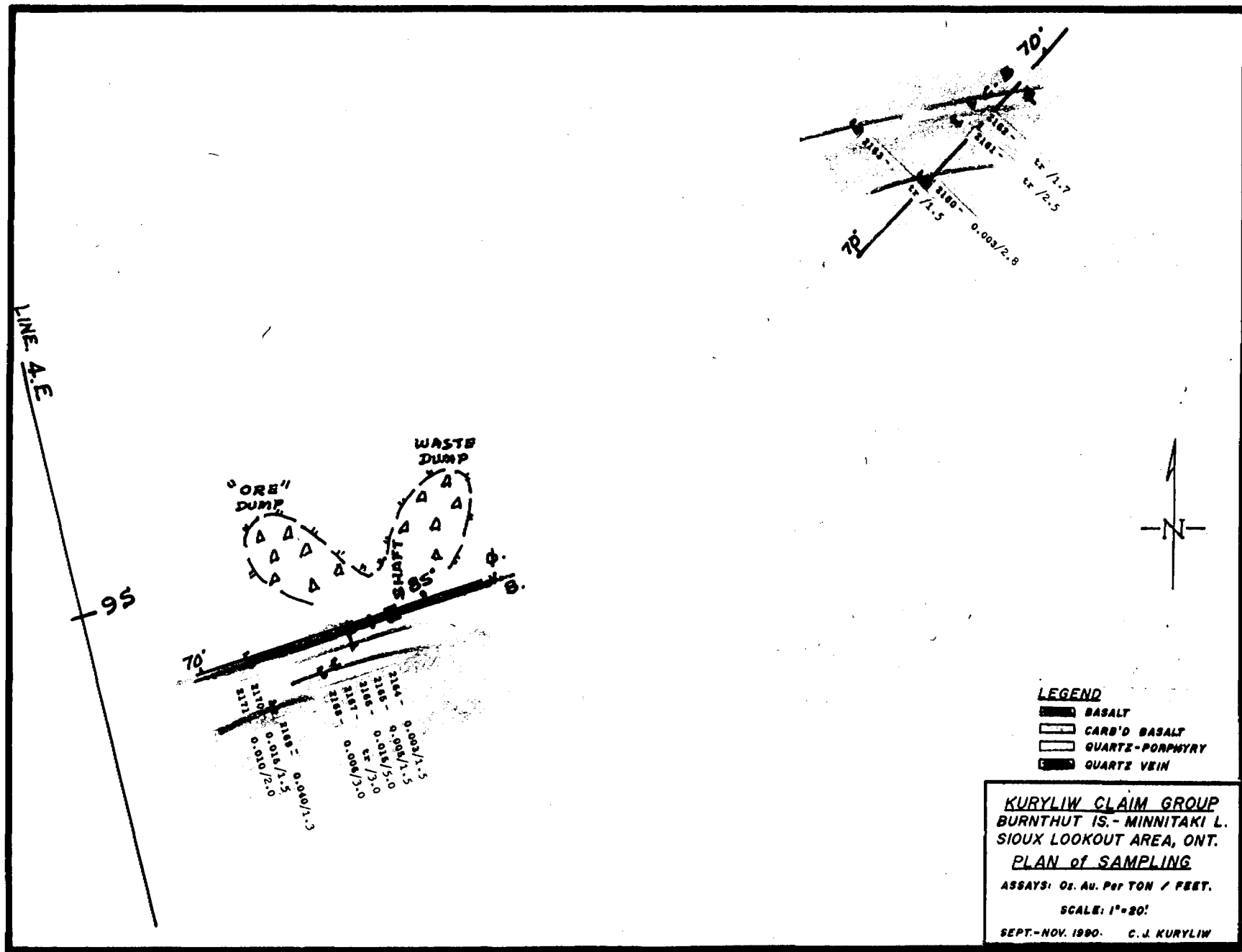

(S-3) CLAIM Pa 1133370

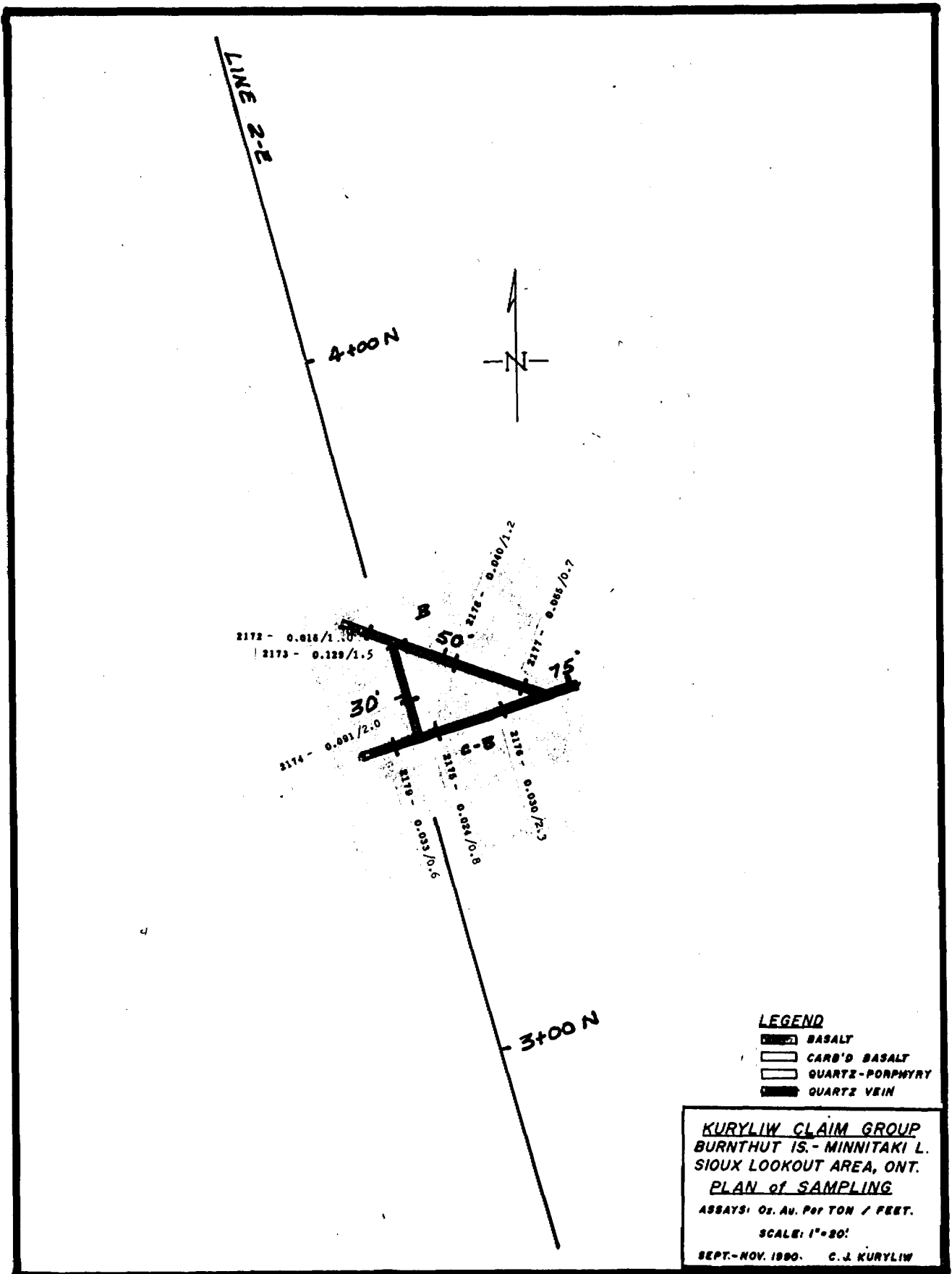

(S-4) CLAIM Pa 1133374

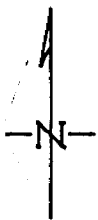



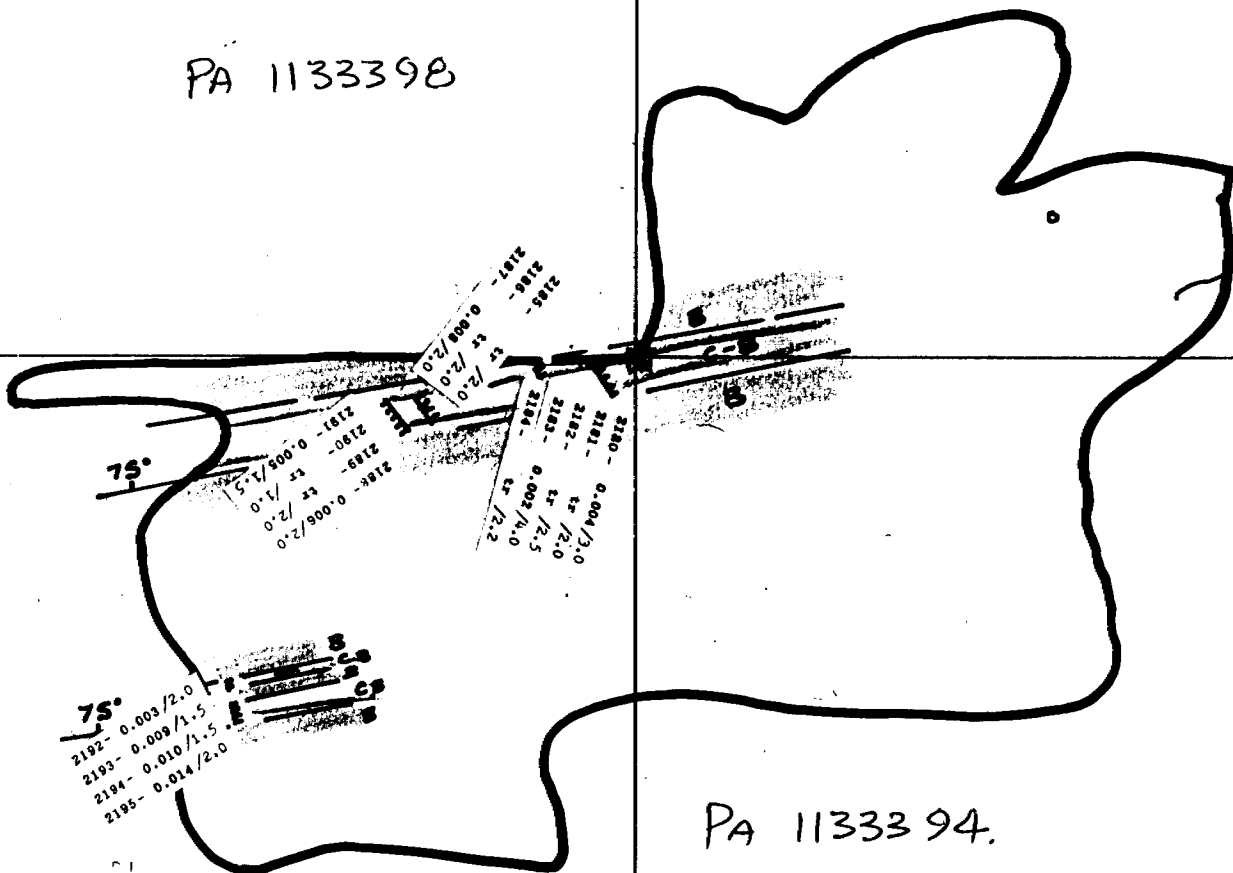

PA 1133398



PA 1133399

PA 1133394.

- LEGEND**
-  BASALT
 -  CARB'D BASALT
 -  QUARTZ-PORPHYRY
 -  QUARTZ VEIN



KURLIOW CLAIM GROUP
BURNTHUT IS. - MINNITAKI L.
SIoux LOOKOUT AREA, ONT.
PLAN of SAMPLING

ASSAYS: Oz. Au. Per TON / FEET.
 SCALE: 1"=200'
 SEPT.-NOV. 1990. C. J. KURLIOW

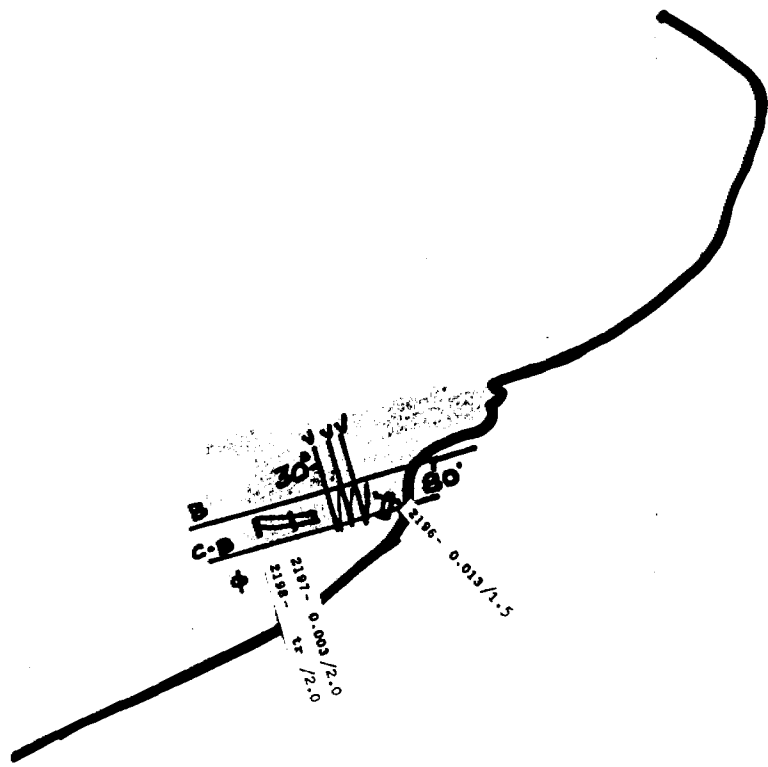
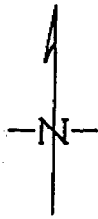
(S-5) CLAIM Pa 1133399

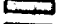

LEGEND

-  BASALT
-  CARB'D BASALT
-  QUARTZ-PORPHYRY
-  QUARTZ VEIN

KURLIOW CLAIM GROUP
BURNTHUT IS. - MINNITAKI L.
SIOUX LOOKOUT AREA, ONT.

PLAN of SAMPLING

ASSAYS: Oz. Au. Per TON / FEET.

SCALE: 1" = 20'

SEPT.-NOV. 1990. C. J. KURLIOW

(S-6) CLAIM Pa 1133387

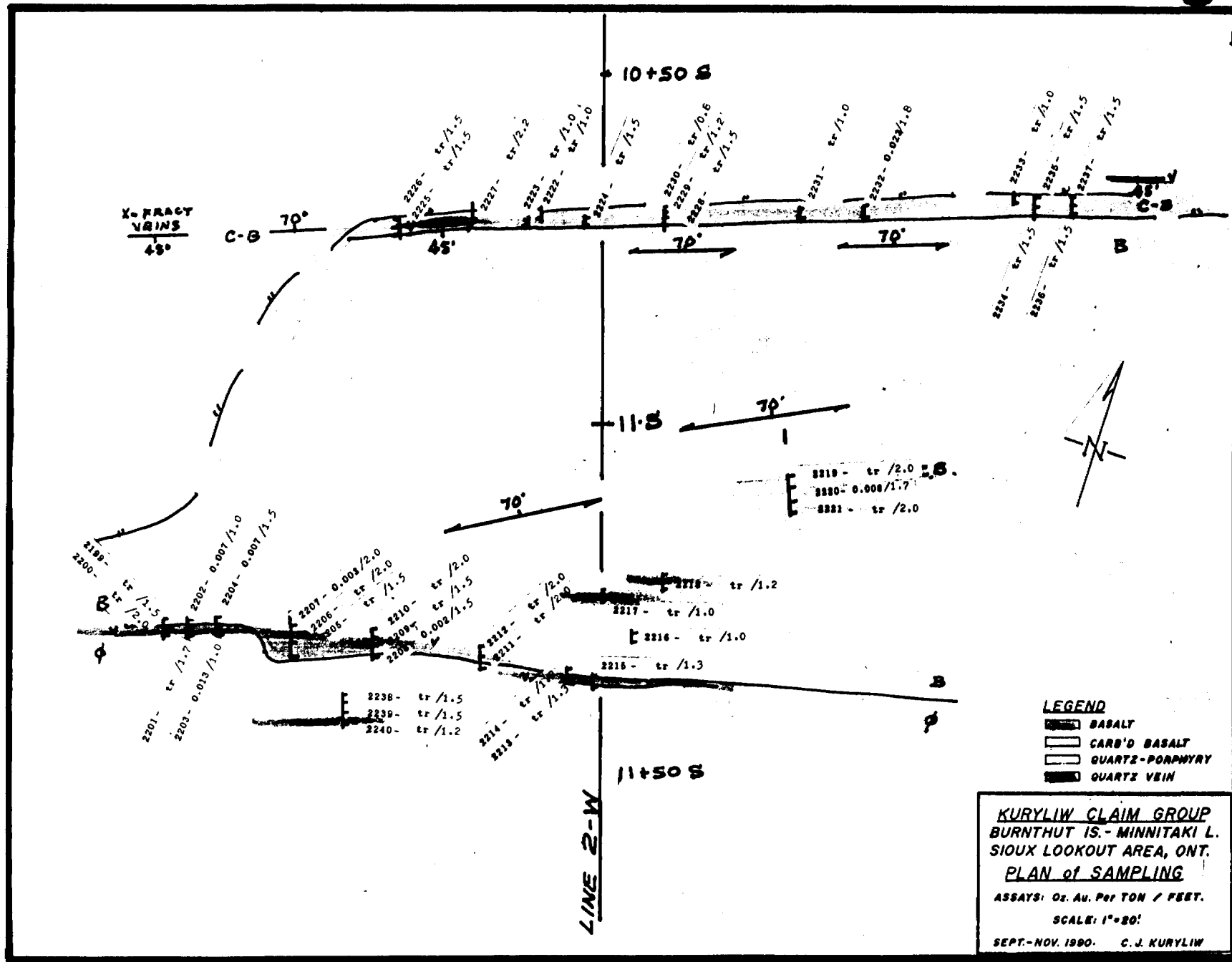

(S-7) CLAIM Pa 1133373

CONCLUSIONS

Gold mineralization occurs extensively along the trend of the foliated and quartz carbonate altered Basalt lavas immediately north of the contact with the sedimentary formation. In this favourable trend there appears to be a direct correlation of increased gold content with proximity to the contacts of quartz porphyry intrusions. Much of this favourable horizon underlies lake water and cannot be examined by surface prospecting.

In the presence of additional favourable structural features this carbonatized trend of foliated volcanics could host a gold ore body. This favourable trend warrants a determined exploration program. The program would initially consist of a detailed ground magnetic survey to locate the sedimentary-basalt contact and the locations of quartz-porphyry intrusions in or near the foliated and quartz carbonatized basalts. The magnetic survey may also indicate important structural features such as faulting, folding or more intense alteration that would indicate some favourable structured situations. The more favourable structured locations would then be tested by diamond drilling.

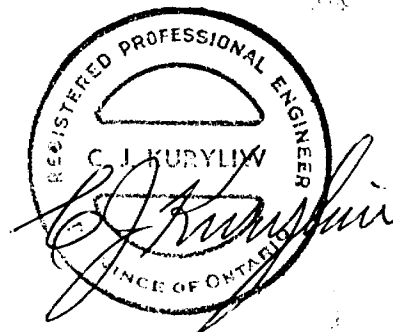

December 23, 1990

Chester J. Kuryliw, M.Sc., P.Eng.

RECOMMENDATIONS

A detailed ground magnetic survey should be carried out on the lake ice centered over the quartz carbonatized basalts immediately North of the sedimentary contact.

The grid would consist of a five mile long base line with one-half-mile long cross lines. The cross lines would be at two hundred foot intervals with magnetic survey readings at fifty foot intervals.

ESTIMATES

Line grid on Lake, 70 miles at \$125 per mile	\$ 8750.00
Magnetic survey on Lake and Land 75 miles complete at \$ 225 per mile	\$16,875.00
Total	<u>\$25,625.00</u>

Provision for Preliminary Diamond Drilling	
10 drill holes 400 feet each at \$ 25.00 per foot	\$100,000.00

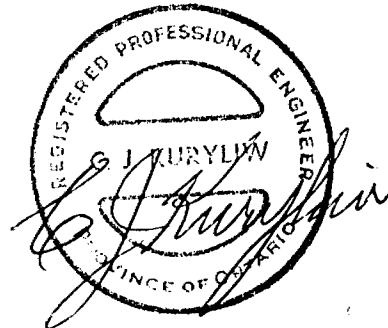

December 23, 1990

Chester J. Kuryliw, M.Sc., P.Eng.

C E R T I F I C A T E

I, Chester J. Kuryliw of 46 Ingall Drive, Dryden Ontario do hereby certify that

- (1) I am a Professional Engineer and I am currently employed as a Consulting Geologist for several mining companies.
- (2) I am a graduate of:

The University of Manitoba B.Sc. Degree, 1949.
The University of Manitoba M.Sc. Degree, 1966.
- (3) I am a registered Engineer of the Association of Professional Engineers of Ontario and also Manitoba. I am a fellow of the Geologic Association of Canada, also a member of the Canadian Institute of Mining and Metallurgy.
- (4) I have practiced my profession for over 42 years, most of those years at gold mines, during which time I often planned, supervised and directed underground exploration, development and production.
- (5) My report is based upon programs of sampling and Geologic mapping I carried out in the field over the the property with my interpretations incorporated in this report and the plan of Geology.



December 23, 1990

Chester J. Kuryliw, M.Sc., P.Eng.

ADDENDUM

SAMPLING and ASSAYING

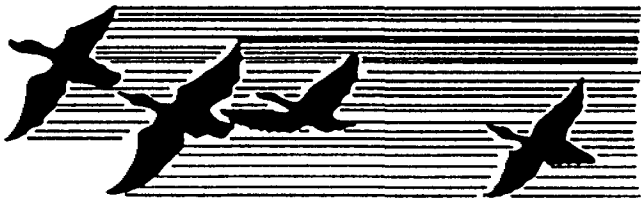

WAWA ASSAYING INC.

P.O. Box 1998 - Wawa, Ontario P0S 1K0 - 705-856-4443
127 Mission Road Fax - 705-856-2902

CERTIFICATE OF ANALYSIS

NO. 09251

No. 6092

CLIENT: Mr. Chester Kuryliw

DATE: October 29, 1990

SAMPLE No.		Au oz/Ton
2225		tr
2226		tr
2227		tr
2228		tr
2229		tr
2230		tr
2230	check no chrg	tr
2231		tr
2232		0.023
2233		tr
2234		tr
2235		tr
2236		tr
2237		tr
2238		tr
2239		tr
2240		tr
2240	check no chrg	tr
2288		0.041

Samples, Pulps and rejects discarded after two months.

Assayer: Sandra Model



WAWA ASSAYING INC.

P.O. Box 1998 - Wawa, Ontario P0S 1K0 - 705-856-4443
127 Mission Road Fax - 705-856-2902

CERTIFICATE OF ANALYSIS

NO. 09250

No. 6091

CLIENT: Mr. Chester Kuryliw

DATE: October 29, 1990

SAMPLE No.		Au oz/Ton
2206		tr
2207		0.003
2208		0.002
2209		tr
2210		tr
2210	check no chrg	tr
2211		tr
2212		tr
2213		tr
2214		tr
2215		tr
2216		tr
2217		tr
2218		tr
2219		tr
2220		0.008
2220	check no chrg	0.007
2221		tr
2222		tr
2223		tr
2224		tr

Samples, Pulps and rejects discarded after two months.

Assayer: Daunte Moskel

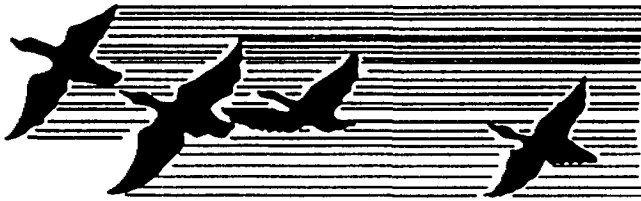

WAWA ASSAYING INC.

P.O. Box 1998 - Wawa, Ontario P0S 1K0 - 705-856-4443
127 Mission Road Fax - 705-856-2902

CERTIFICATE OF ANALYSIS

NO. 09249

No. 6090

CLIENT: Mr. Chester Kuryliw

DATE: October 29, 1990

SAMPLE No.		Au oz/Ton
2188		0.006
2189		tr
2190		tr
2190	check no chrg	tr
2191		0.005
2192		0.003
2193		0.009
2194		0.010
2195		0.014
2196		0.013
2197		0.003
2198		tr
2199		tr
2200		tr
2200	check no chrg	tr
2201		tr
2202		0.007
2203		0.013
2204		0.007
2205		tr

Samples, Pulps and rejects discarded after two months.

Assayer: Lamute Moskel

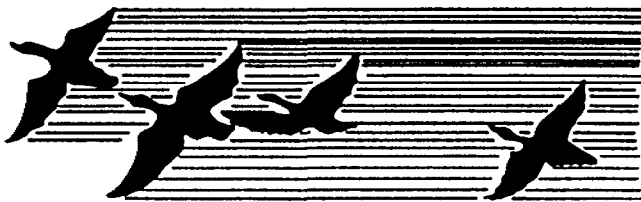

WAWA ASSAYING INC.

P.O. Box 1998 - Wawa, Ontario P0S 1K0 - 705-856-4443
127 Mission Road Fax - 705-856-2902

CERTIFICATE OF ANALYSIS

NO. 09248

No. 6089

CLIENT: Mr. Chester Kuryliw

DATE: October 29, 1990

SAMPLE No.		Au oz/Ton
2170		0.015
2170	check no chrg	0.013
2171		0.010
2172		0.015
2173		0.129
2174		0.091
2175		0.024
2176		0.030
2177		0.065
2178		0.040
2179		0.033
2180		0.004
2180	check no chrg	0.003
2181		tr
2182		tr
2183		0.002
2184		tr
2185		tr
2186		tr
2187		0.008

Samples, Pulps and rejects discarded after two months.

Assayer: Janette Moskel



WAWA ASSAYING INC.

P.O. Box 1998 - Wawa, Ontario POS 1K0 - 705-856-4443
127 Mission Road Fax - 705-856-2902

CERTIFICATE OF ANALYSIS

NO. 09247

No. 6088

CLIENT: Mr. Chester Kuryliw

DATE: October 29, 1990

SAMPLE No.		Au oz/Ton
2151		0.009
2152		0.085
2153		0.016
2154		0.039
2155		0.025
2156		0.031
2157		tr
2158		tr
2159		0.005
2160		0.003
2160	check no chrg	0.003
2161		tr
2162		tr
2163		tr
2164		0.003
2165		0.005
2166		0.015
2167		tr
2168		0.006
2169		0.040

Samples, Pulps and rejects discarded after two months.

Assayer: Samuel Moskyl

(1) CHANNEL - WHIMMING.

KURYLIW CLAIM GROUP, MINNITAKI LAKE, ONT.

SAMPLE No.	ROCK TYPE	MINERALIZATION	LENGTH IN FEET.	ASSAYS OZ. AU / TON
2151	QUARTZ VEIN. FLINTY, GREY,	RARE PYRITE	1.5	0.009
2152	"	"	1.7	0.085
2153	"	"	2.7	0.016
2154	"	"	1.2	0.039
2155	"	"	0.8	0.025
2156	"	"	1.5	0.031
2157	QUARTZ-CARB VEIN	MINOR PYRITE	2.0	Tr
2158	"	"	1.5	Tr
2159	"	"	1.8	0.005
2160	SHEARED BASALT. 25% FUSCHITE Q-CARB	1% PYRITE	2.8	0.003
2161	" 25% "	1% "	2.5	Tr
2162	" 25% "	1% "	1.7	Tr
2163	" 25% "	1% "	1.5	Tr
2164	WHITE QUARTZ VEIN	1% PYRITE 1/2% GALENA	1.5	0.003
2165	" " "	1% " 1/4% "	1.5	0.005
2166	SHEARED BASALT 30% FUSCHITE Q-CARB	1/2% " —	5.0	0.015
2167	" 30% "	1/2% " —	3.0	Tr
2168	" 20% "	1/2% " —	3.0	0.006
2169	" 70% "	2% " —	1.3	0.040
2170	QUARTZ VEIN (WHITE)	1% " 2% GALENA	1.5	0.015
2171	WHITE QTZ VEIN	1% " 1% "	2.0	0.010
2172	FLINTY GREY QUARTZ VEIN.	MINOR TO TRACES PYRITE	1.0	0.015
2173	"	"	1.5	0.129
2174	"	"	2.0	0.091
2175	"	"	0.8	0.024
2176	"	"	2.3	0.030
2177	"	"	0.7	0.065
2178	"	"	1.2	0.040
2179	"	"	0.6	0.033
2180	STRONGLY SHEARED CARB'D BASALT. QTZ. STOCKWORK.	MINOR TO 1/2% PYRITE	3.0	0.004
2181	"	"	2.0	Tr
2182	"	"	2.5	Tr
2183	"	"	4.0	0.002
2184	"	"	2.2	Tr
2185	"	"	2.0	Tr
2186	"	"	2.0	Tr

(2) CHANNEL SAMPLING

SAMPLE NO.	ROCK TYPE	MINERALIZATION	LENGTH IN FEET	ASSAYS GC. AW/TON
2187	STRONGLY SHEARED CARB'D BASALT, RTZ. STOCKWORK.	MINOR TO 1/2% PYRITE	2.0	0.008
2188	"	"	2.0	0.006
2189	"	"	2.0	Tr
2190	"	"	1.0	Tr
2191	"	"	1.5	0.005
2192	"	"	2.0	0.003
2193	"	"	1.5	0.009
2194	"	"	1.5	0.010
2195	"	"	2.0	0.014
2196	"	"	1.5	0.013
2197	"	"	2.0	0.003
2198	"	"	2.0	Tr
2199	40% RTZ IN Q. POR'Y	"	1.5	Tr
2200	20% " IN CARB'D BASALT	"	2.0	Tr
2201	20% QTZ. IN Q. POR'Y	"	1.7	Tr
2202	40% QTZ IN CARB. BAS.	"	1.0	0.007
2203	WHITE QUARTZ VEN	"	1.0	0.013
2204	30% QTZ. IN CARB. BASALT	"	1.5	0.007
2205	20% " "	"	1.5	Tr
2206	10% " "	"	2.0	Tr
2207	10% " "	"	2.0	0.003
2208	10% " "	"	1.5	0.002
2209	10% " "	"	1.5	Tr
2210	20% " "	"	2.0	Tr
2211	10% " "	"	2.0	Tr
2212	10% " "	"	2.0	Tr
2213	20% " "	"	1.3	Tr
2214	30% RTZ IN Q. POR'Y	"	1.2	Tr
2215	RTZ VEN AT BASALT-Q. POR'Y CONTACT	1/2% PYRITE	1.3	Tr
2216	20% QTZ IN CARB'D BASALT	1/2% "	1.0	Tr
2217	RTZ-C. VEN " "	1/2% "	1.0	Tr
2218	QRTZ-C VEN " "	1/2% "	1.2	Tr
2219	20% QTZ. IN CARB'D BASALT	1% "	2.0	Tr
2220	20% QTZ. "	1% "	2.0	0.008
2221	20% QTZ. "	1% "	1.0	0.007
2222	70% QTZ IN CARB'D BAS.	1% "	1.0	Tr

(3) CHANNEL SAMPLING

SAMPLE NO	ROCK TYPE	MINERALIZATION	LENGTH IN FEET	ASSAYS OZ. Au / TON
2223	SHEARED, BASALT CARB'D QUARTZ-STOCKWORK	RARE PYRITE	1.0	Tr
2224	80% Q. "	1/2% PYRITE	1.5	Tr
2225	15% Q. "	1/2% "	1.5	Tr
2226	30% Q. "	1/2% "	1.5	Tr
2227	20% Q. "	1/2% "	2.2	Tr
2228	QUARTZ VEIN	1/2% "	1.5	Tr
2229	" "	1/2% "	1.2	Tr
2230	SHEARED BASALT, CARB'D 20% QZ. STOCKWORK.	1/4% "	0.8	Tr
2231	20% QZ. "	2% "	1.0	Tr
2232	20% QZ. "	1% "	1.8	0.023
2233	SHEARED BASALT, CARB'D 6" QZ VEIN	1% "	1.0	Tr
2234	8" A.V. "	1% "	1.5	Tr
2235	6" A.V. "	2% "	1.5	Tr
2236	6" A.V. "	1% "	1.5	Tr
2237	5" A.V. "	1% "	1.5	Tr
2238	QUARTZ PORPHYRY 20% A.V.	MINOR "	1.5	Tr
2239	" " 20% QZ	" "	1.5	Tr
2240	" " 30% QZ	" "	1.2	Tr
2288	QUARTZ VEIN AT Q. PORPHYRY-BASALT CONTACT.	1/2% PYRITE	1.0	0.041

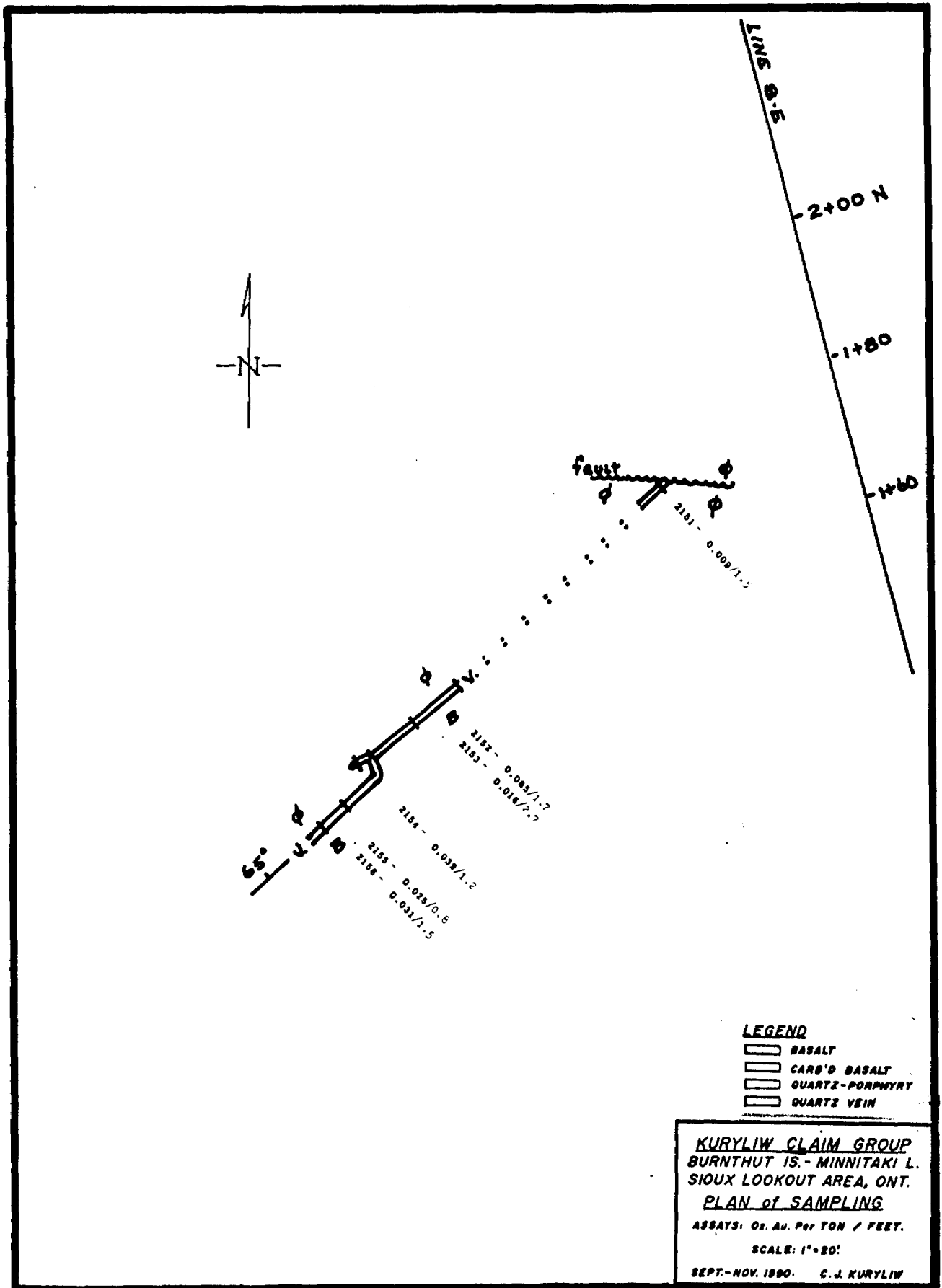

(S-1) CLAIM Pa 1133375

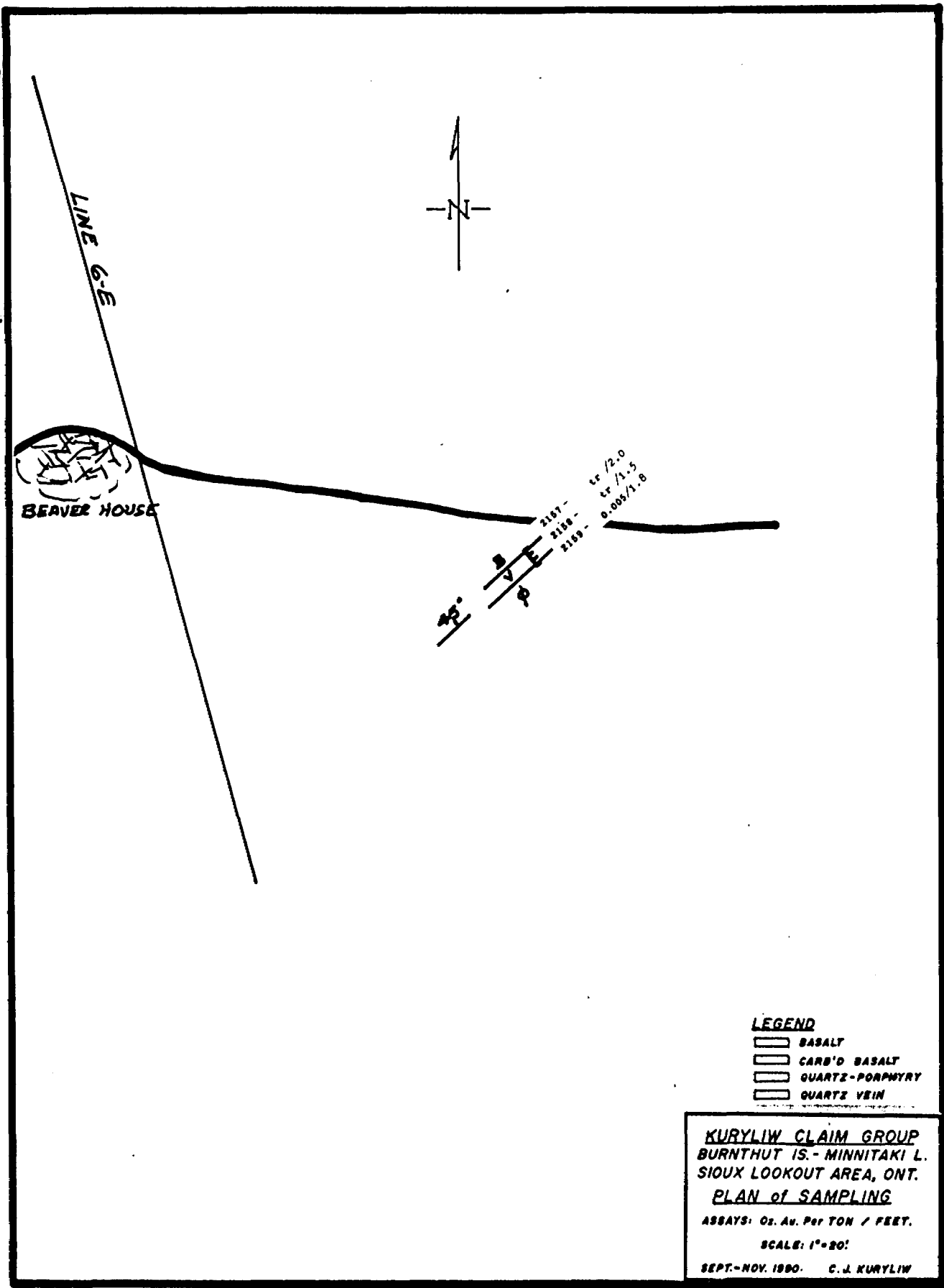

(S-2) CLAIM Pa 1133370

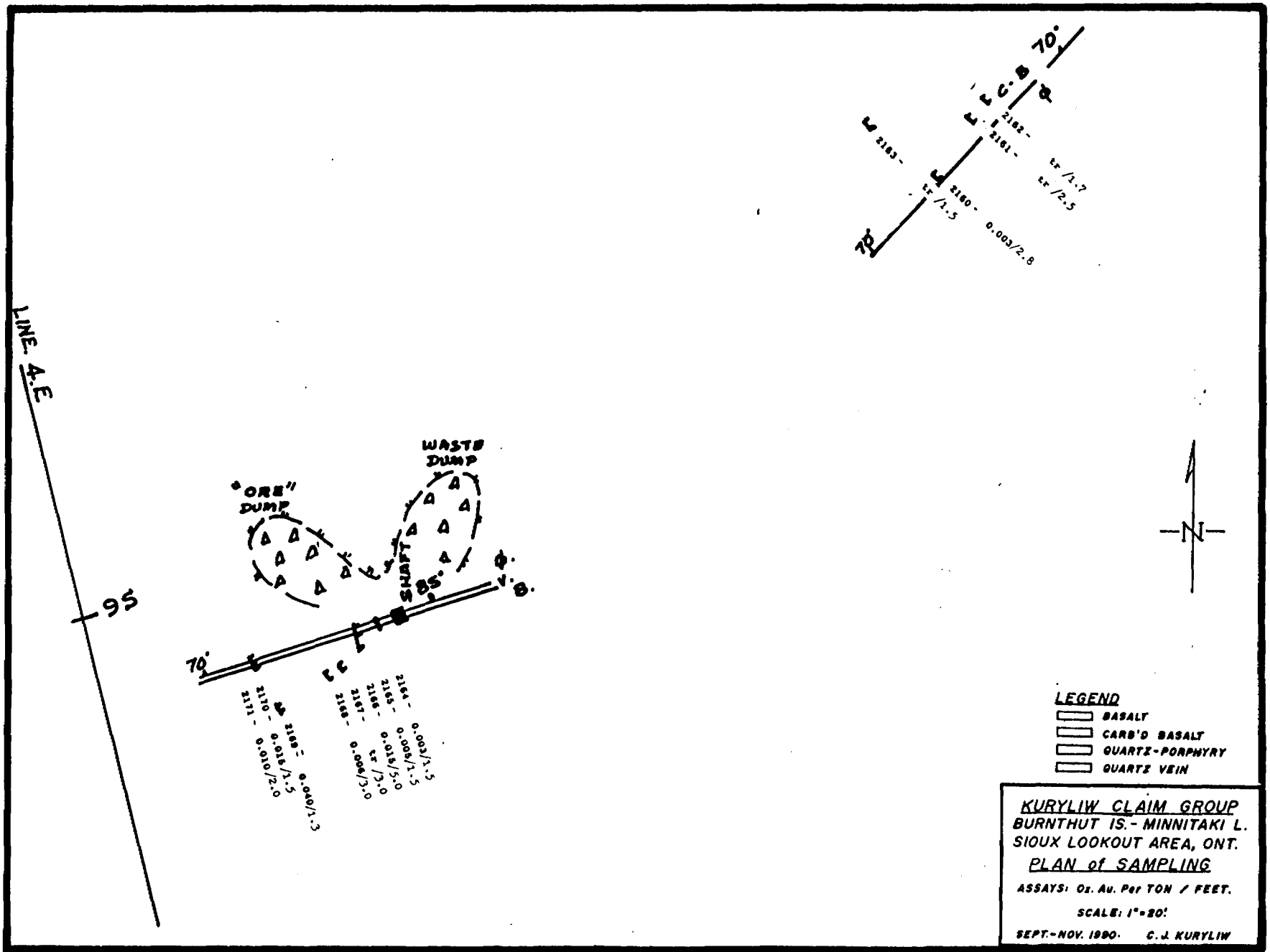

(S-3) CLAIM Pa 1133370

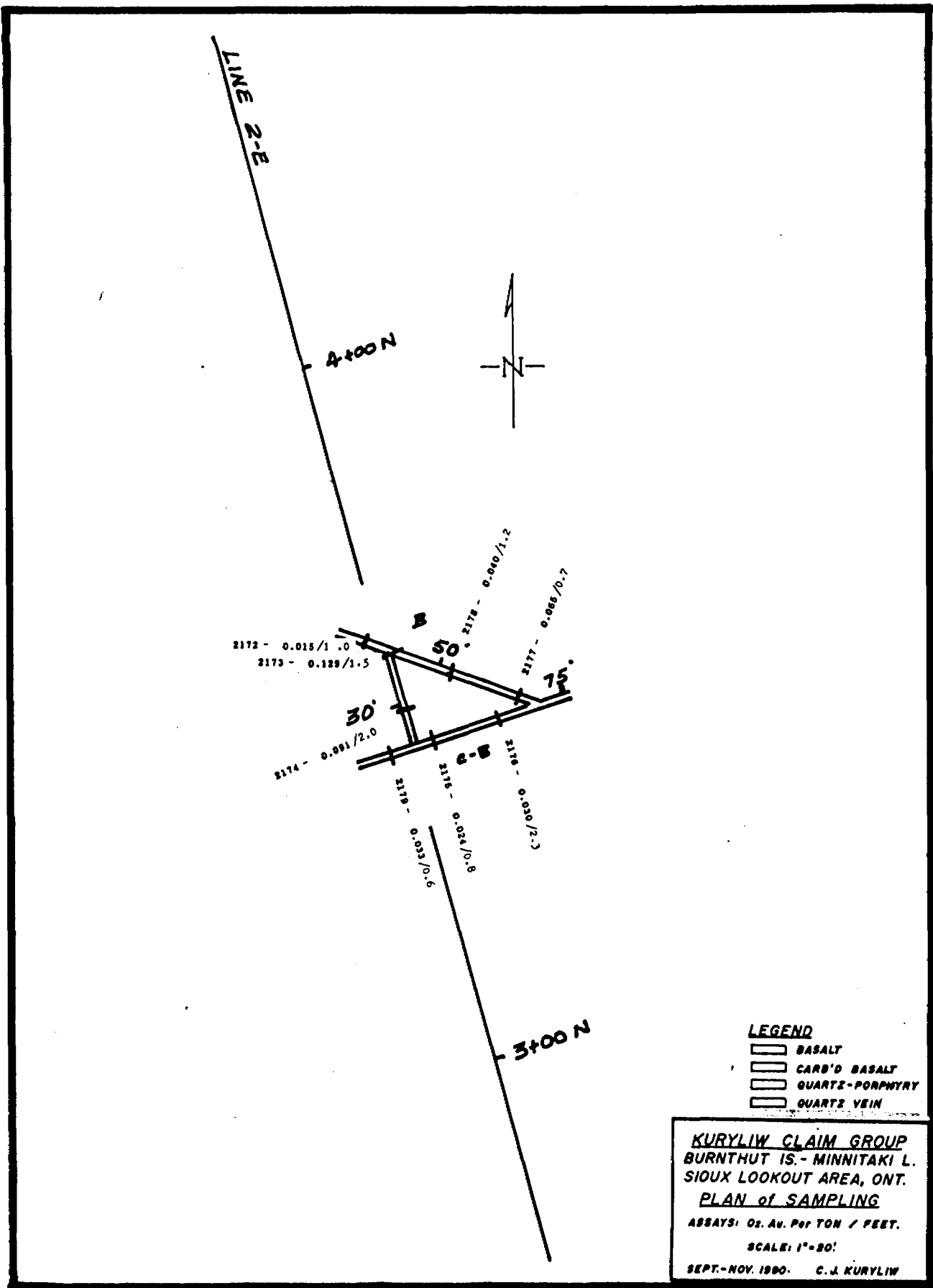

(S-4) CLAIM Pa 1133374

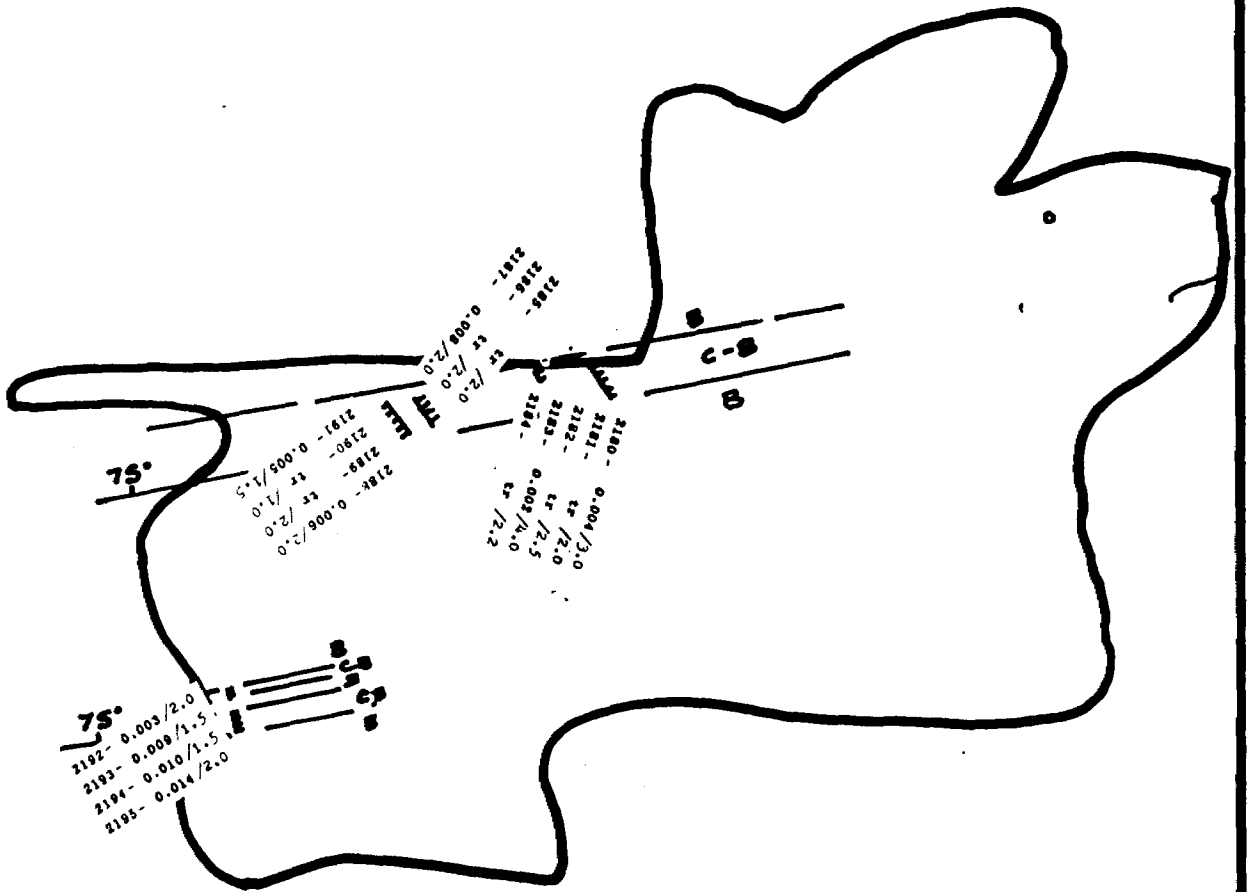
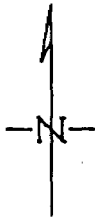

LEGEND

- BASALT
- CARB'D BASALT
- QUARTZ-PORPHYRY
- QUARTZ VEIN

KURYLIV CLAIM GROUP
BURNTHUT IS. - MINNITAKI L.
SIoux LOOKOUT AREA, ONT.
PLAN of SAMPLING

ASSAYS: Oz. Av. Per TON / FEET.



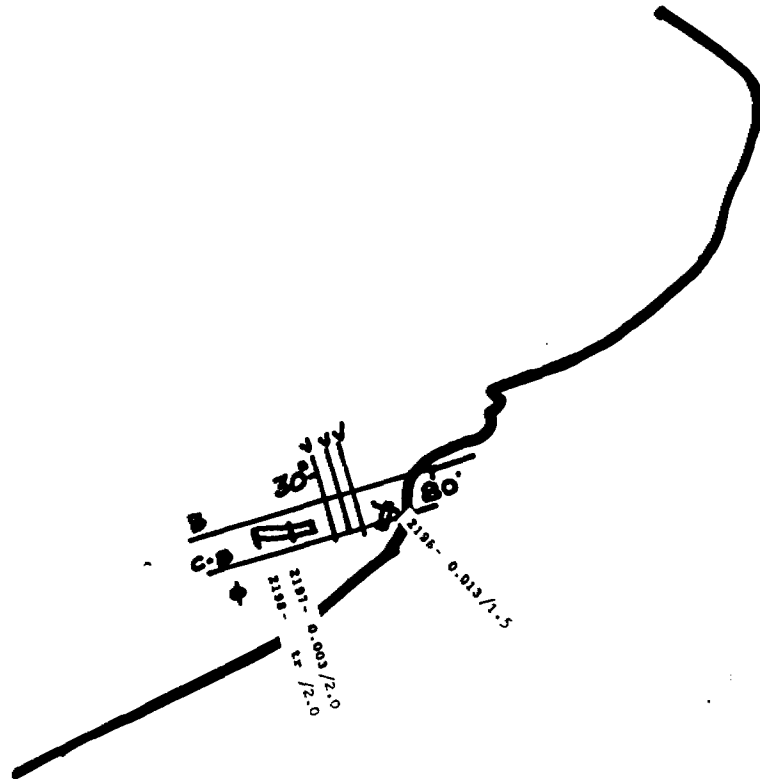
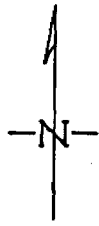

SCALE: 1"=200'

SEPT.-NOV. 1980. C. J. KURLIV

(S-5) CLAIM Pa 1133399

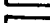

LEGEND

-  BASALT
-  CARB'D BASALT
-  QUARTZ-PORPHYRY
-  QUARTZ VEIN

KURYLIW CLAIM GROUP
BURNTHUT IS. - MINNITAKI L.
SIOUX LOOKOUT AREA, ONT.
PLAN of SAMPLING

ASSAYS: Oz. Au. Per TON / FEET.

SCALE: 1" = 20'

SEPT.-NOV. 1990. C. J. KURYLIW

(S-6) CLAIM Pa 1133387



Ontario



52G13NW9229 2.14341 PARNES LAKE

900

Ministry of
Northern Development
and Mines

Ministère du
Développement du Nord
et des Mines

Mining Lands Branch
Geoscience Approvals Section
159 Cedar Street, 4th Floor
Sudbury, Ontario
P3E 6A5

Toll Free: 1-800-465-3880
Telephone: (705) 670-7264
Fax: (705) 670-7262

November 26, 1991

Our File: 2.14341
Your File: W. 9130.5007
W. 9130.5008

Mining Recorder
Ministry of Northern Development
and Mines
Court House Building
P. O. Box 3000
Sioux Lookout, Ontario
POV 2T0

Dear Romona:

**SUBJECT: APPROVAL OF ASSESSMENT WORK SUBMITTED ON MINING CLAIMS
PA. 1133370 ET AL. IN PARNES LAKE AREA.**

The assessment work credits for the Geological Mapping under Section 12, and Sampling under Section 17 of the Mining Act Regulations, submitted on the above work reports have been approved as of November 26, 1991.

The approved value of work, amounts applied, assigned and put into reserve are outlined in the October 11, 1991 Notice of Assessment Credit Reduction mailed to Mr. Kuryliw and yourself.

Please indicate this approval on your records.

Yours sincerely,

Ron C. Gashinski
Senior Manager, Mining Lands Branch
Mines and Minerals Division

BK/jl
Enclosures:

cc: ✓ Assessment Files Office
Toronto, Ontario

Resident Geologist
Sioux Lookout, Ontario

<u>CLAIM(S)</u>	<u>TOTAL APPLIED</u>	<u>GOOD UNTIL</u>
113370	1,200	1996 (\$280.00)
113373	1,200	1996 (\$280.00)
113375	1,200	1996 (\$280.00)
113371	1,200	1994 (\$360.00)
113372	1,200	1994 (\$360.00)
113374	1,200	1994 (\$360.00)
113376	1,200	1994 (\$360.00)
113378	1,200	1994 (\$360.00)
113377	1,200	1994 (\$360.00)
<hr/>		
113393	542.38	1992 (\$217.62)
113394	342.00	1993 (\$400.00)
113395	524.37	1992 (\$235.63)
113396	524.37	1992 (\$235.63)
113398	524.37	1992 (\$235.63)
113399	524.37	1992 (\$235.63)

CLAIM(S)**TOTAL APPLIED****GOOD UNTIL**

113370	1,200	1996 (\$280.00)
113373	1,200	1996 (\$280.00)
113375	1,200	1996 (\$280.00)
113371	1,200	1994 (\$360.00)
113372	1,200	1994 (\$360.00)
113374	1,200	1994 (\$360.00)
113376	1,200	1994 (\$360.00)
113378	1,200	1994 (\$360.00)
113377	1,200	1994 (\$360.00)

113393	542.38	1992 (\$217.62)
113394	342.00	1993 (\$400.00)
113395	524.37	1992 (\$235.63)
113396	524.37	1992 (\$235.63)
113398	524.37	1992 (\$235.63)
113399	524.37	1992 (\$235.63)

Report of Work Conducted After Recording Claim

Mining Act

Transaction Number
W9130-5007

Personal information collected on this form is obtained under the authority of the Mining Act. This information will be used for correspondence. Questions about this collection should be directed to the Provincial Manager, Mining Lands, Ministry of Northern Development and Mines, Fourth Floor, 159 Cedar Street, Sudbury, Ontario, P3E 6A5, telephone (705) 870-7284.

- Instructions:**
- Please type or print and submit in duplicate.
 - Refer to the Mining Act and Regulations for requirements of filing assessment work or consult the Mining Recorder.
 - A separate copy of this form must be completed for each Work Group. *2-1-0-1*
 - Technical reports and maps must accompany this form in duplicate.
 - A sketch, showing the claims the work is assigned to, must accompany this form.

Recorded Holder(s) <i>CHESTER J. KURYLIW</i>	Client No. <i>154635</i>
Address <i>46 INGALL DR DRYDEN ONT. P8N 3B7</i>	Telephone No. <i>807-223-6080</i>
Mining Division <i>PATRICIA MINING DIV.</i>	Township/Area <i>PARNES LAKE</i>
M or G Plan No. <i>G-2164</i>	
Dates Work Performed From: <i>AUGUST 28 1990</i>	To: <i>JANUARY 23 1991</i>

Work Performed (Check One Work Group Only)

Work Group	Type
<input checked="" type="checkbox"/> Geotechnical Survey	<i>GEOLOGIC MAPPING PLANS + REPORT.</i>
<input checked="" type="checkbox"/> Physical Work, Including Drilling	<i>CUTTING LINE GRIP THAT WAS MAPPED</i>
Rehabilitation	
Other Authorized Work	
Assays	<i>1,994.79</i>
Assignment from Reserve	<i>10,812.80</i>

Total Assessment Work Claimed on the Attached Statement of Costs \$ *12807.59*

Note: The Minister may reject for assessment work credit all or part of the assessment work submitted if the recorded holder cannot verify expenditures claimed in the statement of costs within 30 days of a request for verification.

Persons and Survey Company Who Performed the Work (Give Name and Address of Author of Report)

Name	Address
<i>C.J. KURYLIW</i>	<i>GEOLOGIST, 46 INGALL DR. DRYDEN ONT</i>
<i>D. TERNOWSKI</i>	<i>ASSISTANT, DRYDEN, ONT</i>
<i>E. McDONALD</i>	<i>ASSISTANT, DRYDEN, ONT.</i>

(attach a schedule if necessary)

Certification of Beneficial Interest * See Note No. 1 on reverse side

I certify that at the time the work was performed, the claims covered in this work report were recorded in the current holder's name or held under a beneficial interest by the current recorded holder.	Date <i>Aug 15, 91</i> <i>(for Aug 6, 91)</i>	Recorded Holder or Agent (Signature) <i>C.J. Kuryliw</i>
--	---	---

Certification of Work Report

I certify that I have a personal knowledge of the facts set forth in this Work report, having performed the work or witnessed same during and/or after its completion and annexed report is true.		
Name and Address of Person Certifying <i>CHESTER J. KURYLIW, 46 INGALL DR DRYDEN ONT. P8N 3B7</i>		
Telephone No. <i>807 223 6080</i>	Date <i>Aug 15 1991</i> <i>(for Aug 6 1991)</i>	Certified By (Signature) <i>C.J. Kuryliw</i>

For Office Use Only

Total Value Cr. Recorded <i>12807.59</i>	Date Recorded <i>22 Aug 91</i>	Mining Recorder <i>R. Maple</i>	Received Stamp <i>31 AUG 22 1991</i>
	Deemed Approval Date <i>Nov 20 1991</i>	Date Approved	
	Date Notice for Amendments Sent		

Statement of Costs for Assessment Credit

État des coûts aux fins du crédit d'évaluation

Mining Act/Loi sur les mines

Transaction No./N° de transaction
W9130.5007

Personal information collected on this form is obtained under the authority of the Mining Act. This information will be used to maintain a record and ongoing status of the mining claim(s). Questions about this collection should be directed to the Provincial Manager, Minings Lands, Ministry of Northern Development and Mines, 4th Floor, 159 Cedar Street, Sudbury, Ontario P3E 6A5, telephone (705) 870-7264.

Les renseignements personnels contenus dans la présente formule sont recueillis en vertu de la Loi sur les mines et serviront à tenir à jour un registre des concessions minières. Adresser toute question sur la collecte de ces renseignements au chef provincial des terrains miniers, ministère du Développement du Nord et des Mines, 159, rue Cedar, 4^e étage, Sudbury (Ontario) P3E 6A5, téléphone (705) 870-7264.

1. Direct Costs/Coûts directs **GEO TECHNICAL**

Type	Description	Amount Montant	Totals Total global
Wages Salaires	Labour Main-d'oeuvre		
	Field Supervision Supervision sur le terrain		8474.25
Contractor's and Consultant's Fees Droits de l'entrepreneur et de l'expert-conseil	Type		
Supplies Used Fournitures utilisées	Type CAMP. FIELD MATERIALS & SUPPLIES	536.42	
	GROCERIES FIELD-CAMP	726.05	
			1262.47
Equipment Rental Location de matériel	Type BOAT + 40 HP MOTOR	2,070.81	
	CHEV 1/2 TON	1,000.81	
Total Direct Costs Total des coûts directs			3,070.81
			12,801.59

8,9,01067

2. Indirect Costs/Coûts indirects

** Note: When claiming Rehabilitation work indirect costs are not allowable as assessment work. Pour les travaux de réhabilitation, les coûts indirects ne sont pas admissibles en tant que travaux d'évaluation.

REPEATED COSTS

Type	Description	Amount Montant	Totals Total global
Transportation Transport	Type CHEV 1/2 TON	1,000.81	
	+ BOAT GAS + OIL	2070.81	
Food and Lodging Nourriture et hébergement	CAMP MATERIALS & SUPPLIES	536.42	
	FIELD GROCERIES CAMP	726.05	
Sub Total of Indirect Costs Total partiel des coûts indirects			3,762.92
Amount Allowable (not greater than 20% of Direct Costs) Montant admissible (n'excédant pas 20 % des coûts directs)			752.58
Total Value of Assessment Credit (Total of Direct and Allowable indirect costs) Valeur totale du crédit d'évaluation (Total des coûts directs et indirects admissibles)			10,812.80

Note: The recorded holder will be required to verify expenditures claimed in this statement of costs within 30 days of a request for verification. If verification is not made, the Minister may reject for assessment work all or part of the assessment work submitted.

Note: Le titulaire enregistré sera tenu de vérifier les dépenses demandées dans le présent état des coûts dans les 30 jours suivant une demande à cet effet. Si la vérification n'est pas effectuée, le ministre peut rejeter tout ou une partie des travaux d'évaluation présentés.

Filing Discounts

- Work filed within two years of completion is claimed at 100% of the above Total Value of Assessment Credit.
- Work filed three, four or five years after completion is claimed at 50% of the above Total Value of Assessment Credit. See calculations below:

Total Value of Assessment Credit	Total Assessment Claimed
	× 0.50 =

Remises pour dépôt

- Les travaux déposés dans les deux ans suivant leur achèvement sont remboursés à 100 % de la valeur totale susmentionnée du crédit d'évaluation.
- Les travaux déposés trois, quatre ou cinq ans après leur achèvement sont remboursés à 50 % de la valeur totale du crédit d'évaluation susmentionné. Voir les calculs ci-dessous.

Valeur totale du crédit d'évaluation	Evaluation totale demandée
	× 0,50 =

Certification Verifying Statement of Costs

I hereby certify that the amounts shown are as accurate as possible and these costs were incurred while conducting assessment work on the lands shown on the accompanying Report of Work form.

that as OWNER I am authorized (Recorded Holder, Agent, Position in Company)

to make this certification

Attestation de l'état des coûts

J'atteste par la présente que les montants indiqués sont le plus exact possible et que ces dépenses ont été engagées pour effectuer les travaux d'évaluation sur les terrains indiqués dans la formule de rapport de travail ci-joint.

Et qu'à titre de OWNER je suis autorisé (titulaire enregistré, représentant, poste occupé dans la compagnie)

à faire cette attestation.

Signature [Signature] Date Aug 15 1991
(for Aug 6 1991)



Statement of Costs
for Assessment Credit

État des coûts aux fins
du crédit d'évaluation

Mining Act/Loi sur les mines

Transaction No./N° de transaction

W9130.5007.

Personal information collected on this form is obtained under the authority of the Mining Act. This information will be used to maintain a record and ongoing status of the mining claim(s). Questions about this collection should be directed to the Provincial Manager, Minings Lands, Ministry of Northern Development and Mines, 4th Floor, 159 Cedar Street, Sudbury, Ontario P3E 6A5, telephone (705) 670-7264.

Les renseignements personnels contenus dans la présente formule sont recueillis en vertu de la Loi sur les mines et servent à tenir à jour un registre des concessions minières. Adresser toute question sur la collecte de ces renseignements au chef provincial des terrains miniers, ministère du Développement du Nord et des Mines, 159, rue Cedar, 4^e étage, Sudbury (Ontario) P3E 6A5, téléphone (705) 670-7264.

1. Direct Costs/Coûts directs

Type	Description	Amount Montant	Totals Total global
Wages Salaires	Labour Main-d'oeuvre		
	Field Supervision Supervision sur le terrain		8974.25
Contractor's and Consultant's Fees Droits de l'entrepreneur et de l'expert- conseil	Type		
Supplies Used Fournitures utilisées	Type Comp Field Material	536.42	
			536.42
Equipment Rental Location de matériel	Type		
Total Direct Costs Total des coûts directs			9,010.67

2. Indirect Costs/Coûts indirects

** Note: When claiming Rehabilitation work indirect costs are not allowable as assessment work.
Pour le remboursement des travaux de réhabilitation, les coûts indirects ne sont pas admissibles en tant que travaux d'évaluation.

Type	Description	Amount Montant	Totals Total global
Transportation Transport	Type Charleston	1000.87	
	Doct, Gas, Oil	2070	
			3,070.87
Food and Lodging Nourriture et hébergement	Groceries	726.05	
Mobilization and Demobilization Mobilisation et démobilisation			
Sub Total of Indirect Costs Total partiel des coûts indirects			3,796.92
Amount Allowable (not greater than 20% of Direct Costs) Montant admissible (n'excédant pas 20 % des coûts directs)			1,802.13
Total Value of Assessment Credit (Total of Direct and Allowable indirect costs)		Valeur totale du crédit d'évaluation (Total des coûts directs et indirects admissibles)	
			10,812.80

20% - 1,802.13

Note: The recorded holder will be required to verify expenditures claimed in this statement of costs within 30 days of a request for verification. If verification is not made, the Minister may reject for assessment work all or part of the assessment work submitted.

Note: Le titulaire enregistré sera tenu de vérifier les dépenses demandées dans le présent état des coûts dans les 30 jours suivant une demande à cet effet. Si la vérification n'est pas effectuée, le ministre peut rejeter tout ou une partie des travaux d'évaluation présentés.

Filing Discounts

1. Work filed within two years of completion is claimed at 100% of the above Total Value of Assessment Credit.
2. Work filed three, four or five years after completion is claimed at 50% of the above Total Value of Assessment Credit. See calculations below:

Total Value of Assessment Credit	Total Assessment Claimed
	x 0.50 =

Remises pour dépôt

1. Les travaux déposés dans les deux ans suivant leur achèvement sont remboursés à 100 % de la valeur totale susmentionnée du crédit d'évaluation.
2. Les travaux déposés trois, quatre ou cinq ans après leur achèvement sont remboursés à 50 % de la valeur totale du crédit d'évaluation susmentionné. Voir les calculs ci-dessous.

Valeur totale du crédit d'évaluation	Evaluation totale demandée
	x 0,50 =

Certification Verifying Statement of Costs

I hereby certify:
that the amounts shown are as accurate as possible and these costs were incurred while conducting assessment work on the lands shown on the accompanying Report of Work form.

that as _____ I am authorized
(Recorded Holder, Agent, Position in Company)

to make this certification

Attestation de l'état des coûts

J'atteste par la présente :
que les montants indiqués sont le plus exact possible et que ces dépenses ont été engagées pour effectuer les travaux d'évaluation sur les terrains indiqués dans la formule de rapport de travail ci-joint.

Et qu'à titre de _____ je suis autorisé
(titulaire enregistré, représentant, poste occupé dans la compagnie)

à faire cette attestation.

Signature	Date



Ministry of Northern Development and Mines

Report of Work Conducted After Recording Claim

Transaction Number
W 9130 - 5008

Ontario

Mining Lands

Mining Act

Personal information collected on this form is obtained under the authority of the Mining Act. This information will be used for correspondence. Questions about this collection should be directed to the Provincial Manager, Mining Lands, Ministry of Northern Development and Mines, Fourth Floor, 159 Cedar Street, Sudbury, Ontario, P3E 6A5, telephone (705) 670-7264.

- Instructions:**
- Please type or print and submit in duplicate.
 - Refer to the Mining Act and Regulations for requirements of filing assessment work or consult the Mining Recorder.
 - A separate copy of this form must be completed for each Work Group. **2.148.91**
 - Technical reports and maps must accompany this form in duplicate.
 - A sketch, showing the claims the work is assigned to, must accompany this form.

Recorded Holder(s) CHESTER J. Kuryliw	Client No. 154635
Address 46 INGALL DR., DRYDEN ONT. P8N 3B7	Telephone No. 807 223 6080
Mining Division PATRICIA MINING DIV	Township/Area PARNES LAKE
M or G Plan No. G-2164	
Dates Work Performed From: AUGUST 28/90	To: JANUARY 22/91

Work Performed (Check One Work Group Only)

Work Group	Type
<input type="checkbox"/> Geotechnical Survey	
<input type="checkbox"/> Physical Work, Including Drilling	
<input type="checkbox"/> Rehabilitation	
<input type="checkbox"/> Other Authorized Work	
<input checked="" type="checkbox"/> Assays	SAMPLING OUTCROPPING VEINS ETC, WITH DIAMOND SAW (249.53) CUTS, ASSAYING
<input type="checkbox"/> Assignment from Reserve	

Total Assessment Work Claimed on the Attached Statement of Costs \$ **6346.19 6096.66**

Note: The Minister may reject for assessment work credit all or part of the assessment work submitted if the recorded holder cannot verify expenditures claimed in the statement of costs within 30 days of a request for verification.

Persons and Survey Company Who Performed the Work (Give Name and Address of Author of Report)

Name	Address
C J Kuryliw	GEOLOGIST, 46 INGALL DR, DRYDEN.
E McDONALD	ASSISTANT, DRYDEN, ONT.

(attach a schedule if necessary)

Certification of Beneficial Interest * See Note No. 1 on reverse side

I certify that at the time the work was performed, the claims covered in this work report were recorded in the current holder's name or held under a beneficial interest by the current recorded holder.

Date: **Aug 15 1991** (for Aug 6, 1991)
Recorded Holder or Agent (Signature): **C J Kuryliw**

Certification of Work Report

I certify that I have a personal knowledge of the facts set forth in this Work report, having performed the work or witnessed same during and/or after its completion and annexed report is true.

Name and Address of Person Certifying: **CHESTER J. Kuryliw 46 INGALL DR. DRYDEN ONT. P8N 3B7**

Telephone No.: **807 223 6080**

Date: **Aug 15, 1991** (for Aug 6, 1991)
Certified By (Signature): **C J Kuryliw**

For Office Use Only

Total Value Cr. Recorded 6346.19	Date Recorded 22 AUG 91	Mining Recorder [Signature]	Received Stamp: 31 AUG 22 1991
	Deemed Approval Date	Date Approved	
	Date Notice for Amendments Sent		



Statement of Costs for Assessment Credit

État des coûts aux fins du crédit d'évaluation

Mining Act/Loi sur les mines

Transaction No./N° de transaction
W9130.5008

Personal information collected on this form is obtained under the authority of the Mining Act. This information will be used to maintain a record and ongoing status of the mining claim(s). Questions about this collection should be directed to the Provincial Manager, Minings Lands, Ministry of Northern Development and Mines, 4th Floor, 159 Cedar Street, Sudbury, Ontario P3E 6A5, telephone (705) 670-7264.

Les renseignements personnels contenus dans la présente formule sont recueillis en vertu de la Loi sur les mines et serviront à tenir à jour un registre des concessions minières. Adresser toute question sur la collecte de ces renseignements au chef provincial des terrains miniers, ministère du Développement du Nord et des Mines, 159, rue Cedar, 4^e étage, Sudbury (Ontario) P3E 6A5, téléphone (705) 670-7264.

1. Direct Costs/Coûts directs *SAMPLING / ASSAYING*

Type	Description	Amount Montant	Totals Total global
Wages Salaires	Labour Main-d'oeuvre		
	Field Supervision Supervision sur le terrain		2,824.75
Contractor's and Consultant's Fees Droits de l'entrepreneur et de l'expert-conseil	Type		
	<i>SAMPLING + ASSAYING</i>		1,782.00
Supplies Used Fournitures utilisées	Type <i>CAMP FIELD MATERIALS + SUPPLIES</i>	178.80	
	<i>GROCERIES FIELD CAMP</i>	242.01	
			178.80
Equipment Rental Location de matériel	Type		
	<i>BOAT + 4 DIAM. MATR</i>	690.00	
	<i>DIAMOND SAW SAMPLER</i>	295.00	295
	<i>CHAIN 1/2 TON</i>	333.63	1,318.63
Total Direct Costs Total des coûts directs			6,396.19
			5,085.55

2. Indirect Costs/Coûts indirects

** Note: When claiming Rehabilitation work indirect costs are not allowable as assessment work. Pour le remboursement des travaux de réhabilitation, les coûts indirects ne sont pas admissibles en tant que travaux d'évaluation. *REPEATED COSTS.*

Type	Description	Amount Montant	Totals Total global
Transportation Transport	Type		
	<i>CHAIN 1/2 TON TRUCK</i>	333.63	
	<i>BOAT GAS FUEL</i>	690.00	
Sub Total of Indirect Costs Total partiel des coûts indirects			1,023.63
Food and Lodging Nourriture et hébergement	<i>CAMP MATERIALS AND SUPPLIES</i>	178.80	
	<i>FIELD GROCERIES</i>	242.01	242.01
Mobilization and Demobilization Mobilisation et démoblisation	<i>CAMP</i>		
Sub Total of Indirect Costs Total partiel des coûts indirects			1,265.64
Amount Allowable (not greater than 20% of Direct Costs) Montant admissible (n'excédant pas 20 % des coûts directs)			1,016.11
Total Value of Assessment Credit (Total of Direct and Allowable Indirect costs) Valeur totale du crédit d'évaluation (Total des coûts directs et indirects admissibles)			6,096.64

Note: The recorded holder will be required to verify expenditures claimed in this statement of costs within 30 days of a request for verification. If verification is not made, the Minister may reject for assessment work all or part of the assessment work submitted.

Note: Le titulaire enregistré sera tenu de vérifier les dépenses demandées dans le présent état des coûts dans les 30 jours suivant une demande à cet effet. Si la vérification n'est pas effectuée, le ministre peut rejeter tout ou une partie des travaux d'évaluation présentés.

Filing Discounts

- Work filed within two years of completion is claimed at 100% of the above Total Value of Assessment Credit.
- Work filed three, four or five years after completion is claimed at 50% of the above Total Value of Assessment Credit. See calculations below:

Total Value of Assessment Credit	Total Assessment Claimed
	× 0.50 =

Remises pour dépôt

- Les travaux déposés dans les deux ans suivant leur achèvement sont remboursés à 100 % de la valeur totale susmentionnée du crédit d'évaluation.
- Les travaux déposés trois, quatre ou cinq ans après leur achèvement sont remboursés à 50 % de la valeur totale du crédit d'évaluation susmentionné. Voir les calculs ci-dessous.

Valeur totale du crédit d'évaluation	Evaluation totale demandée
	× 0,50 =

Certification Verifying Statement of Costs

I hereby certify: that the amounts shown are as accurate as possible and these costs were incurred while conducting assessment work on the lands shown on the accompanying Report of Work form.

that as OWNER I am authorized (Recorded Holder, Agent, Position in Company)

to make this certification

Attestation de l'état des coûts

J'atteste par la présente: que les montants indiqués sont le plus exact possible et que ces dépenses ont été engagées pour effectuer les travaux d'évaluation sur les terrains indiqués dans la formule de rapport de travail ci-joint.

Et qu'à titre de _____ je suis autorisé (titulaire enregistré, représentant, poste occupé dans la compagnie)

à faire cette attestation.

Signature: *[Signature]* Date: *Aug 12 1991*



Ministry of
Northern Development
and Mines

Ministère du
Développement du Nord
et des mines

**Statement of Costs
for Assessment Credit**

**État des coûts aux fins
du crédit d'évaluation**

Mining Act/Loi sur les mines

Transaction No./N° de transaction

5008

Personal information collected on this form is obtained under the authority of the Mining Act. This information will be used to maintain a record and ongoing status of the mining claim(s). Questions about this collection should be directed to the Provincial Manager, Minings Lands, Ministry of Northern Development and Mines, 4th Floor, 159 Cedar Street, Sudbury, Ontario P3E 6A5, telephone (705) 670-7264.

Les renseignements personnels contenus dans la présente formule sont recueillis en vertu de la Loi sur les mines et serviront à tenir à jour un registre des concessions minières. Adresser toute question sur la collecte de ces renseignements au chef provincial des terrains miniers, ministère du Développement du Nord et des Mines, 159, rue Cedar, 4^e étage, Sudbury (Ontario) P3E 6A5, téléphone (705) 670-7264.

1. Direct Costs/Coûts directs

Type	Description	Amount Montant	Totals Total global
Wages Salaires	Labour Main-d'œuvre		
	Field Supervision Supervision sur le terrain		2,824.75
Contractor's and Consultant's Fees Droits de l'entrepreneur et de l'expert- conseil	Type Sample Assay		
			1,782.
Supplies Used Fournitures utilisées	Type Camp Material	178	
			178.80
Equipment Rental Location de matériel	Type Diamond Saw	295	
			295

Total Direct Costs
Total des coûts directs **5,080.55**

less 203.22 - Samples not on claims

2. Indirect Costs/Coûts indirects

** Note: When claiming Rehabilitation work Indirect costs are not allowable as assessment work.
Pour le remboursement des travaux de réhabilitation, les coûts indirects ne sont pas admissibles en tant que travaux d'évaluation.

Type	Description	Amount Montant	Totals Total global
Transportation Transport	Type Chow 1/2 Ton	333.63	
	Boat	600	
			1,023.63
Food and Lodging Nourriture et hébergement	Grac.	242.01	242.01
Mobilization and Demobilization Mobilisation et démobilisation			

Sub Total of Indirect Costs
Total partiel des coûts indirects **1,265.64**

Amount Allowable (not greater than 20% of Direct Costs)
Montant admissible (n'excédant pas 20 % des coûts directs) **1,016.11**

Total Value of Assessment Credit
(Total of Direct and Allowable
Indirect costs) **6,096.66**

Valeur totale du crédit
d'évaluation
(Total des coûts directs
et indirects admissibles)

Note: The recorded holder will be required to verify expenditures claimed in this statement of costs within 30 days of a request for verification. If verification is not made, the Minister may reject for assessment work all or part of the assessment work submitted.

Note: Le titulaire enregistré sera tenu de vérifier les dépenses demandées dans le présent état des coûts dans les 30 jours suivant une demande à cet effet. Si la vérification n'est pas effectuée, le ministre peut rejeter tout ou une partie des travaux d'évaluation présentés.

Filing Discounts

1. Work filed within two years of completion is claimed at 100% of the above Total Value of Assessment Credit.
2. Work filed three, four or five years after completion is claimed at 50% of the above Total Value of Assessment Credit. See calculations below:

Total Value of Assessment Credit	Total Assessment Claimed
	× 0.50 =

Remises pour dépôt

1. Les travaux déposés dans les deux ans suivant leur achèvement sont remboursés à 100 % de la valeur totale susmentionnée du crédit d'évaluation.
2. Les travaux déposés trois, quatre ou cinq ans après leur achèvement sont remboursés à 50 % de la valeur totale du crédit d'évaluation susmentionné. Voir les calculs ci-dessous.

Valeur totale du crédit d'évaluation	Evaluation totale demandée
	× 0,50 =

Certification Verifying Statement of Costs

I hereby certify:
that the amounts shown are as accurate as possible and these costs were incurred while conducting assessment work on the lands shown on the accompanying Report of Work form.

that as _____ I am authorized
(Recorded Holder, Agent, Position in Company)

to make this certification

Attestation de l'état des coûts

J'atteste par la présente :
que les montants indiqués sont le plus exact possible et que ces dépenses ont été engagées pour effectuer les travaux d'évaluation sur les terrains indiqués dans la formule de rapport de travail ci-joint.

Et qu'à titre de _____ je suis autorisé
(titulaire enregistré, représentant, poste occupé dans la compagnie)

à faire cette attestation.

Signature	Date
-----------	------

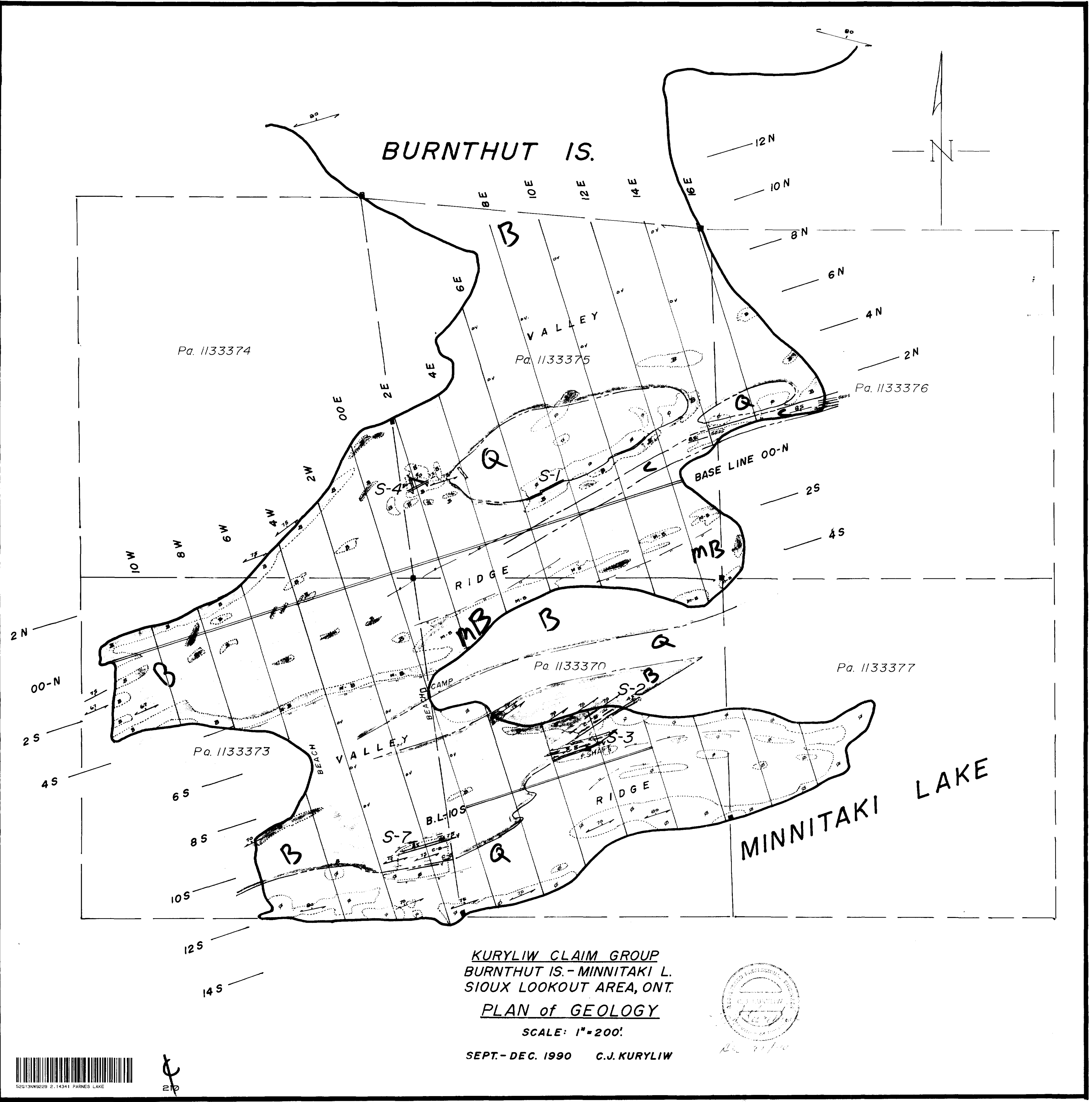

KURYLIW CLAIM GROUP
BURNTHUT IS. - MINNITAKI L.
SIoux LOOKOUT AREA, ONT.
PLAN of GEOLOGY
SCALE: 1" = 200'
SEPT.-DEC. 1990 C.J. KURYLIW



LEGEND

- QUARTZ VEIN
- CARBONATIZED, SHEARED-BASALT
- QUARTZ-PORPHYRY INTRUSIVE CONTACT
- SEDIMENTS, GREYWACKES.
- UNCONFORMITY
- INTERFLOW SEDIMENTS
- INTERFLOW CHERTS
- BASALT, FINE TO MED. GR. MASSIVE FLOWS.
- BASALT, FINE GR. IN PARTS ELLIPSOIDAL.

SYMBOLS

- OUTCROP
- GEOLOGICAL CONTACT, INTERPRETED.
- DIP AND STRIKE OF BEDDING
- DIP AND STRIKE OF SHEARING
- FAULT TRACE
- EDGE OF CLIFF OR RIDGE
- CLAIM POST
- SAMPLED OUTCROPS, LOCATION.
- PILLOWED LAVA

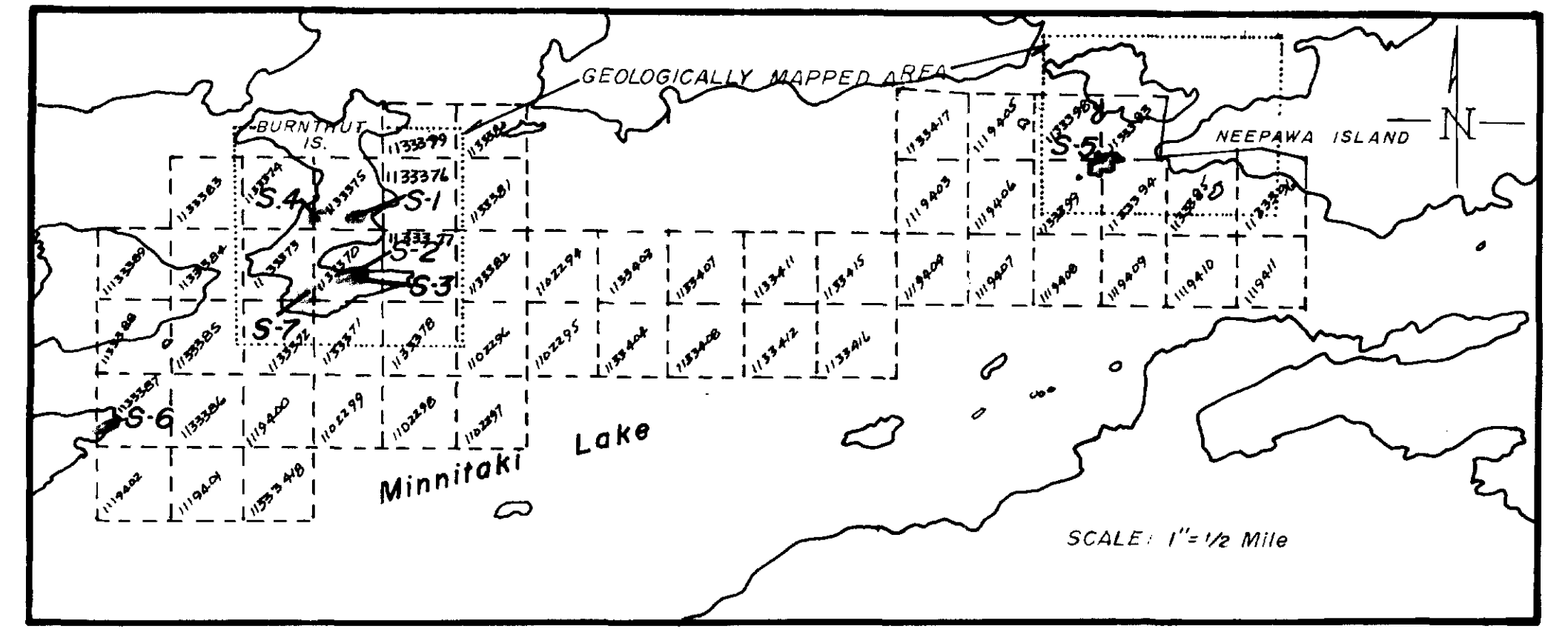

KEY MAP
 SHOWING - KURYLIW CLAIM GROUP, SAMPLED LOCATIONS S-1 TO S-7
 GEOLOGICALLY MAPPED AREAS

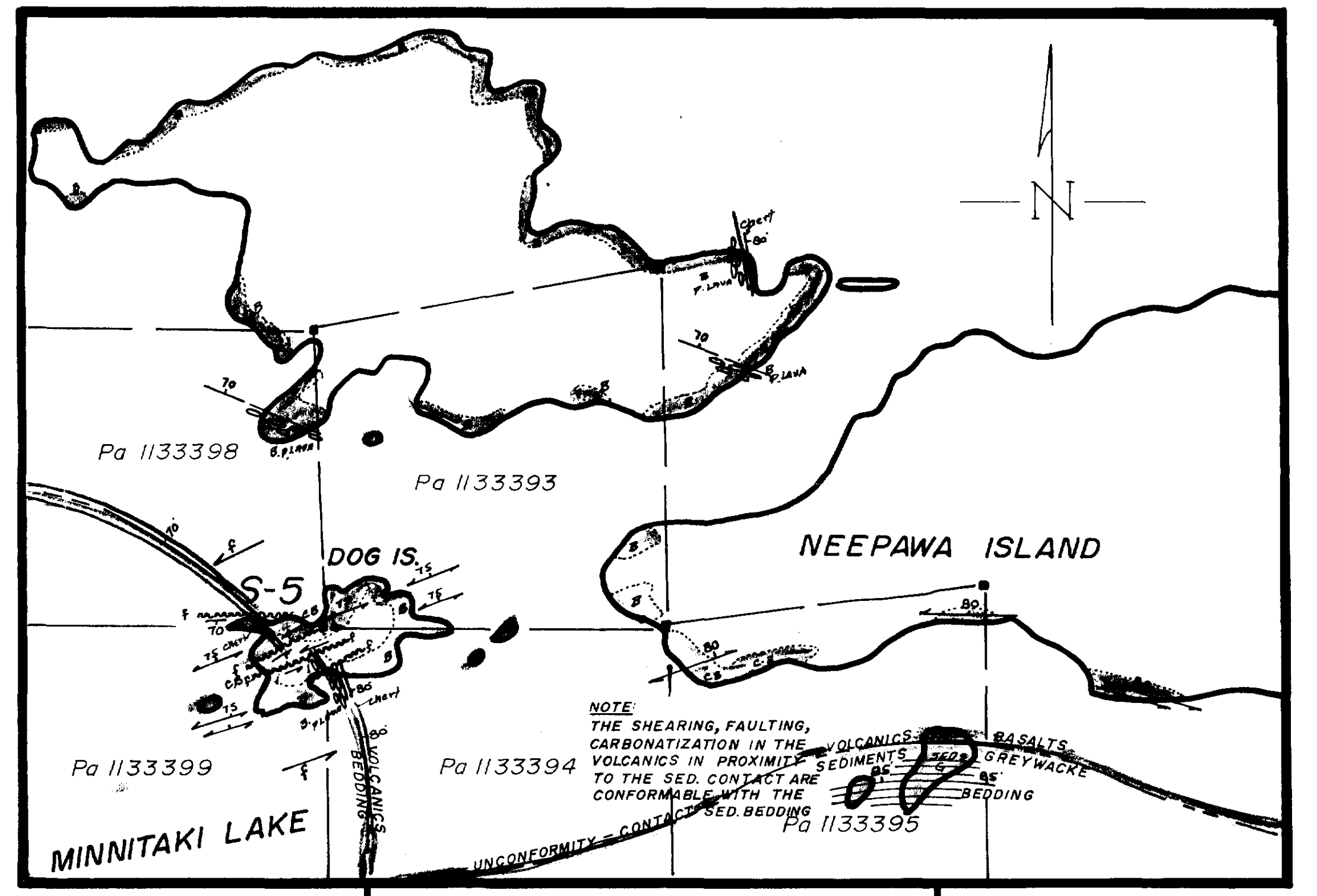

KURYLIW CLAIM GROUP
MINNITAKI L. DOG-NEEPAWA IS.
SIoux LOOKOUT AREA, ONT.
PLAN of GEOLOGY
SCALE: 1" = 400'
SEPT.-DEC. 1990 C.J. KURYLIW

