



52G13SE0002 52G13SE0010A1 FLYING LOON LAKE

010

Diamond Drilling

Area of FLYING LOON LAKE

Report NO 11

Work performed by: Mattagami Lake Mines Limited

Claim NO	Hole NO	Footage	Date	Note
Pa 376302	ER-DK-78-11	426.0'	Feb/78	(1)
Pa 376301	78-12	453.0'	Feb/78	(2)

2 DH 879 FT

Notes:

(1) #39-78

(2) #86-78

MATTAGAMI LAKE MINES LIMITED - EXPLORATION DIVISION - DIAMOND DRILL HOLE RECORD

Po

PROPERTY ENGLISH R. GROUP "D & K"	LATITUDE 9 + 00S	STARTED	FEBRUARY 3, 1978	DIP TEST				
HOLE NO. ER-D+K-78-11	DEPARTURE 32 + 00W	FINISHED	FEBRUARY 8, 1978	Footage	Corrected	Footage	Corrected	Footage
BEARING 0°	ELEVATION	LENGTH	426.0 FEET	100'	-55°	400'	-42°	
DIP-COLLAR -50°	SECTION 32 + 00W	LOGGED BY	G. STEINERT	200'	-53°			
				300'	-48°			

FOOTAGE		DESCRIPTION	% Mineralization	SAMPLE NO.	FOOTAGE			ASSAYS				
From	To				From	To	Length	CU	ZN	NI	FE	
0'	48.0'	CASING: (42' overburden including 15' of water)										
48.0'	77.1'	PORPHYRITIC MAFIC FLOW: Dark green, fine to med grained, fairly massive groundmass containing numerous white feldspar phenocrysts averaging 2-3mm diam, trace fine gr po, non-magnetic.	tr sulphides	525	72.0	77.0	5.0'	Tr	Tr	.04	3.88	
77.1'	80.2'	MAFIC VOLCANIC: Very fine grained, dark green flow, massive, sharp contacts, upper contact at 60o to core axis, lower contact at 60o also, at lower contact a thin inclusion of porphyritic mafic flow in fine gr flow (this is a chilled flow top with minor flow top breccia).	tr py	526	77.0	80.2	3.2'	Tr	Tr	.05	5.64	
80.2'	131.5'	PORPHYRITIC MAFIC FLOW: Same as above, no visible sulphides.	tr sulphides	527	117.0	122.0	5.0'	Tr	Tr	.04	3.24	
131.5'	134.7'	MAFIC FLOW: Fine grained, same as above, sharp contacts.										
134.7'	145.5'	PORPHYRITIC MAFIC FLOW: Same as above, 48.0-77.1'.										
145.5'	146.3'	MAFIC FLOW: Fine grained, same as 77.1-80.2', sharp contacts, upper at 55-60o, lower at 60o to core axis.										
146.3'	171.6'	PORPHYRITIC MAFIC FLOW: Same as above, 48.0-77.1'.	tr sulphides	528	147.0	152.0	5.0'	Tr	Tr	.03	3.53	
171.6'	176.6'	MAFIC FLOW: Fine grained, sharp upper contact at 45o to core axis, less sharp lower contact at 55o to core axis.	tr sulphides	529	171.6	176.6	5.0'	Tr	Tr	.02	5.75	
176.6'	181.8'	PORPHYRITIC MAFIC FLOW: Same as above, 48.0-77.1'.										
181.8'	183.1'	MAFIC FLOW: Fine gr. Sharp upper and lower contacts at 60o.										
183.1'	197.8'	PORPHYRITIC MAFIC FLOW: Same as above 48.0-77.1'.										
	190.5-191.0'	banded chert unit, very fine gr, sharp contacts at 60o to core axis.										
197.8'	205.0'	MAFIC FLOW: Fine grained, sharp upper contact at 70o to core axis, lower contact more gradational (flow top).										
205.0'	210.6'	PORPHYRITIC MAFIC FLOW: Same as above, 48.0-77.1'.										
	208.0-208.5'	Few carbonate? veinlets, feldspar phenocrysts stained pink.										

MATTAGAMI LAKE MINES DIV.
 1972

MATTAGAMI LAKE MINES LIMITED - EXPLORATION DIVISION - DIAMOND DRILL HOLE RECORD

PROPERTY ENGLISE RIVER GROUP "D&K"	LATITUDE	STARTED	DIP TEST				
			Footage	Corrected	Footage	Corrected	Footage
MOLE NO. ER-D&K-78-11	DEPARTURE	FINISHED					
BEARING	ELEVATION	LENGTH					
DIP-COLLAR	SECTION	LOGGED BY					

FOOTAGE		DESCRIPTION	% Mineralization	SAMPLE NO.	FOOTAGE			ASSAYS				
From	To				From	To	Length	CU	ZN	NI	FE	
210.6'	211.0'	MAFIC FLOW: Fine gr. Sharp contacts at 550 to core axis.										
211.0'	218.0'	PORPHYRITIC MAFIC FLOW: Same as above 48.0-77.1'.	no vis sulph	530	213.0	218.0	5.0'	Tr	Tr	.03	5.41	
		217.0-217.5': Some of feldspar phenocrysts stained pink.	tr py	531	218.0	223.0	5.0'	Tr	Tr	.04	6.50	
			tr py + po	532	223.0	227.0	4.0'	.01	Tr	.10	5.12	
			tr py + po	533	227.0	232.0	5.0'	Tr	Tr	.06	5.31	
218.0'	277.7'	MAFIC VOLCANIC: Fine gr. Porphyritic sections with feldspar phenocrysts from 219.0-219.3', 220.6-220.7', 225.6-227.7', 262.5-265.3', 269.4-269.8'.	tr 3% po+py	534	235.0	237.5	2.5'	.03	Tr	.06	6.17	
			tr 3%po+py .5%cpy	535	237.5	240.0	2.5'	.03	Tr	.30	8.63	
			1-5%po, .5%cpy	536	240.0	242.5	2.5'	.08	Tr	.35	9.47	
		232.0-235.0': 3.0' of lost core.	1-5%po, few specks	537	242.5	245.0	2.5'	.09	Tr	.32	8.21	
		Magnetic sections at 232.2', 235.8-256.5'.	1-3%po(+py)	538	245.0	250.0	5.0'	.07	Tr	.16	7.34	
		Sulphide mineralization: 238.5-239.8': tr 1% diss po (+py)	tr 2%po(+py)	539	250.0	252.0	2.0'	.03	Tr	.04	5.81	
		239.8-245.0': 1-5% po (+py), few specks & "splashes" of cpy (0.5%)	1-5%po(+py).5%cpy	540	252.0	255.2	3.2'	.09	Tr	.13	7.82	
			tr 1%po(+py)	541	255.2	257.7	2.5'	Tr	Tr	.04	5.51	
		245.0-252.0': 1-3% po (+py)	tr 1%po	542	257.7	260.2	2.5'	.03	.03	.14	6.10	
		252.0-255.2': 1-5% po (+py) 0.5% cpy "splashes".	no vis sulph	543	260.2	265.2	5.0'	Tr	Tr	.06	5.35	
		255.2-260.0': tr 1% po, disseminated.	" " "	544	265.2	270.2	5.0'	.01	.01	.04	5.37	
		Several sections are very chloritic & broken into thin "washers" could be chloritic tuff.	" " "	545	270.2	275.2	5.0'	Tr	Tr	.01	5.04	
			" " "	546	275.2	277.7	2.5'	Tr	Tr	.01	5.12	
277.7'	397.7'	PORPHYRITIC MAFIC FLOW: Sharp upper contact at 550 to core axis.	" " "	547	277.7	280.7	3.0'	Tr	Tr	Tr	4.06	
		324.9-325.1': few splashes of cpy in quartz-carbonate veinlet.	few specks cpy	548	324.0	327.0	3.0'	.02	Tr	Tr	4.89	
		Fine gr sections from 307.7-309.0', 316.7-318.6', 331.4-333.5', 359.6-360.6', 362.5-362.8', 374.0-372.7', 380.2-381.5', 387.0-388.7', 392.3-394.2', 396.0-396.8'.	no vis sulph	549	374.0	377.0	3.0'	Tr	.01	Tr	8.57	
397.7'	426.0'	MAFIC VOLCANIC: Fine grained, sheared flow or tuff.	tr py	550	408.0	411.0	3.0'	.01	.04	.02	7.01	
			tr po + cpy	551	411.0	413.0	2.0'	.03	.02	.02	5.29	
		412.0': tr 1% dissem po + cpy	few specks py	552	413.0	416.0	3.0'	.03	.06	.02	6.96	
		420.3': splash of po + cpy	no vis sulph	553	416.0	419.0	3.0'	Tr	.06	.02	9.09	
			tr po + cpy	554	419.0	421.0	2.0'	Tr	.09	.04	9.20	
	426.0'	END OF HOLE	no vis sulph	555	421.0	426.0	5.0'	Tr	.09	.02	6.10	

— NORTH —>

ER-DK-78-II

Por. Mafic flow
Mafic Volc

Por. Mafic Flow

Mafic Flow
Por. Mafic Flow

Por. Mafic Flow

Mafic Flow Por. Mafic Flow

Por. Mafic Flow

Mafic Flow Por. Mafic Flow

Por. Mafic Flow

Mafic Flow

Por. Mafic Flow

Mafic Volc.
426-0'

PATRICIA
MINING DIV.
RECEIVED
MAY - 4 1978
AM 7:00 PM 3:45

MATTAGAMI LAKE MINES LTD.

EXPLORATION DIVISION

PROJECT: ENGLISH RIVER
SECTION: 32+00 W.
D.D.H.# ER-DK-78-II

SCALE: 1" = 100 FEET

DATE: March 17, 1978 DRW. BY: R. S.

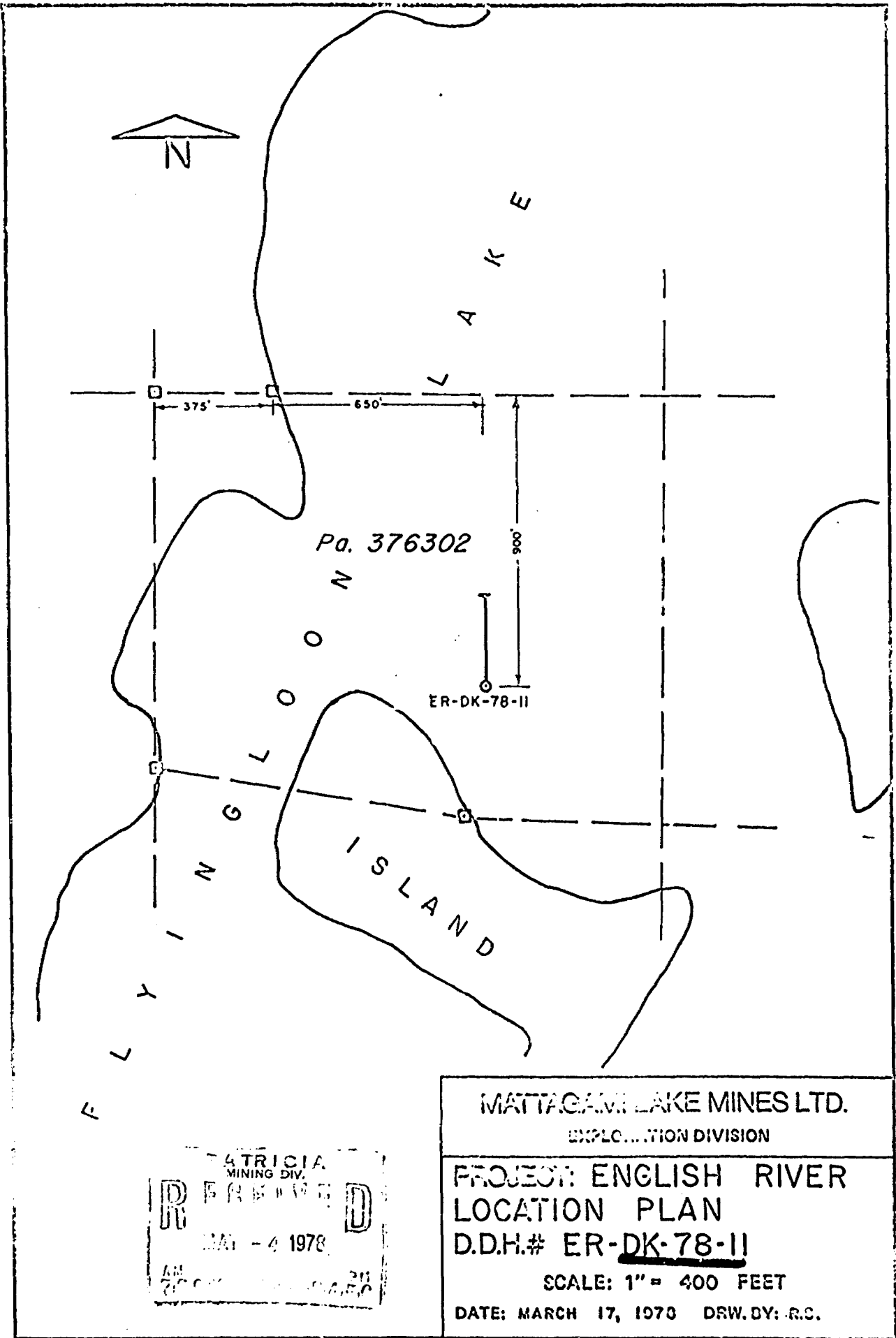

PATRICIA
 MINING DIV.
 R E P R O D U C E D
 MAR - 4 1978
 AM 2000

MATTAGAMI LAKE MINES LIMITED - EXPLORATION DIVISION - DIAMOND DRILL HOLE RECORD

PROPERTY ENGLISH RIVER GROUP "D&K"	LATITUDE 7 + 50S	STARTED FEBRUARY 9, 1978	Footage	Corrected	DIP TEST Footage	Corrected	Footage
HOLE NO. ER-D&K-78-12	DEPARTURE 44 + 00W	FINISHED FEBRUARY 12, 1978	100'	-57°	400'	-35°	
BEARING 0° 00'	ELEVATION	LENGTH 453.0 FEET	200'	-47°			
DIP-COLLAR -50°	SECTION 44 + 00W	LOGGED BY G. STEINERT	300'	-41°			

FOOTAGE		DESCRIPTION	% Mineralization	SAMPLE NO.	FOOTAGE			ASSAYS						
From	To				From	To	Length	CU	Zn	NI	FE	AU		
0'	56.0'	CASING: (50' overburden)												
56.0'	110.0'	PORPHYRITIC MAFIC FLOW: Fine med grained, dark green matrix containing numerous white feldspar phenocrysts average 2-3mm diam, ranges from fairly massive to foliated, foliation at 50o to core axis, tr fine gr dissem po. Very blocky from 56.0-73.3'.	tr sulphides	556	78.0	83.0	5.0'	Tr	.01	.03	4.42			
110.0'	236.2'	INTERBANDED CHLORITE TUFF, MAFIC TUFF & CHERTY TUFF: 110.0-110.8', 124.3-126.5', 128.8-236.2': Chlorite tuff: fine gr, soft, dark greenish-black, highly foliated at 55-60o to core axis. 110.8-128.8': Mafic tuff: Dark green, fine gr, med hard, fairly massive, cut by occasional qtz-carb, veinlets trending various angles to core axis. 153.7-154.3', 192.0-195.4', 203.6-205.1', 207.8-212.0', 216.6-217.0', 225.4-228.5': Fine gr dark gray to green, med hard to very hard, massive cherty tuff (or impure siltstone?), very occasional banding. 153.7-154.3': tr 1% py & cpy blebs on fracture surface. 183.3': Few specks cpy on chloritic fracture surface. 216.8': Dissem py on chloritic fracture surface. 223.7-223.8': Dissem py on chloritic fracture surface. 229.9-230.3': Porphyritic section (feldspar pheno's).	tr py	557	114.0	119.0	5.0'	Tr	Tr	.02	6.77			
			no vis sulph	558	144.0	147.0	3.0'	.05	Tr	.04	4.44			
			cpy-py blebs @154.0'	559	153.7	154.3	0.6'	.08	.02	.02	4.20	.005		
236.2'	280.9'	PORPHYRITIC MAFIC FLOW: Dark green, fine med gr massive matrix containing numerous white feldspar phenocrysts average 2-3mm diam. Sharp upper contact at 58o to core axis. 249.8-250.1': Interbanded green chlorite tuff & reddish fels-pathic sediment. 256.0-256.8': Dark green fine gr massive cherty tuff.	few specks cpy @183.3'.	560	182.0	185.0	3.0'	.01	Tr	.04	4.11			
			no vis sulph	561	233.2	236.2	3.0'	Tr	Tr	.02	4.42			

FOOTAGE		DESCRIPTION	% Mineralization	SAMPLE NO.	FOOTAGE			ASSAYS				
From	To				From	To	Length	CU	ZN	NI	FE	AU
281.9'	340.0'	INTERBANDED CHLORITE TUFF & MAFIC TUFF: Same as above, pre-dominantly chlorite tuff, highly foliated, minor mafic tuff and dark gray cherty tuff or impure siltstone.	no vis sul	562	282.0	287.0	5.0'	Tr	Tr	.03	4.49	
			tr 1% py + po	563	287.0	292.0	5.0'	.04	Tr	.09	5.36	
			1-3% po + py, few cpy	564	292.0	294.5	2.5'	.06	Tr	.13	7.26	
			1-3% po + py few cpy	565	294.5	297.0	2.5'	.10	Tr	.04	6.39	
		Magnetic sections from 292.0-300.3', 304.5-304.8', 307.0-307.5'	tr 1% sulph	566	297.0	300.0	3.0'	.03	Tr	.06	4.92	
		320.9-321.3', 328.5-329.0', 333.7-334.2', 336.0-336.6'.	tr 1% py, few cpy	567	300.0	305.0	5.0'	.04	Tr	.05	4.42	
			tr sulph	568	305.0	310.0	5.0'	.01	Tr	.04	4.44	
		Mineralized as follows: 287.0-292.0': Tr 1% py + po.	no vis sulph	569	310.0	315.0	5.0'	Tr	Tr	.04	4.18	
			" " "	570	315.0	320.0	5.0'	.02	Tr	.07	5.50	
			few specks cpy	571	320.0	325.0	5.0'	.01	Tr	.05	5.41	
		292.0-294.5': 1-5% po + py, few blebs cpy.	no vis sulph	572	325.0	330.0	5.0'	.02	Tr	.07	5.92	
			" " "	573	330.0	335.0	5.0'	.02	Tr	.05	4.98	
		294.5-297.0': 1-3% po + py, few blebs cpy.	" " "	574	335.0	340.0	5.0'	Tr	Tr	.04	4.83	
		297.0-305.0': Tr 1% sulphides, few specks cpy at 304.7'.										
		305.0-310.0': Tr sulphides										
		321.0': Few specks cpy on fracture surface.										
341.0'	353.0'	PORPHYRITIC MAFIC FLOW: Same as above.										
351.0'	453.0'	INTERBANDED MAFIC TUFF & CHERTY TUFF: Same as above, appears to become more silicified towards bottom of hole.	2-5% py	575	415.0	416.0	1.0'	Tr	.05	.03	5.27	.005
		Quartz veins at 364.0-364.7', 373.6-374.5', 380.6-380.7', 395.8-395.9', 415.8-416.0', 427.6-427.7', 450.3-450.4'.	no vis sulph	576	448.0	453.0	5.0'	.01	Tr	.02	4.63	
	453.0'	END OF HOLE										

PATRICIA
 10/20/78
 1576

— NORTH —→

ER-DK-78-12

Per. Mafic Flow

Intruded Tuff

Per. Mafic Flow

Intruded Tuff

Per. Mafic Flow

Intruded Tuff

4550

MATTAGAMI LAKE MINES LTD.
EXPLORATION DIVISION

PROJECT: ENGLISH RIVER
SECTION: 44+00 W.
D.D.H.# ER-DK-78-12

SCALE: 1" = 100 FEET

DATE: MARCH 17, 1978 DRW. BY: R.S.

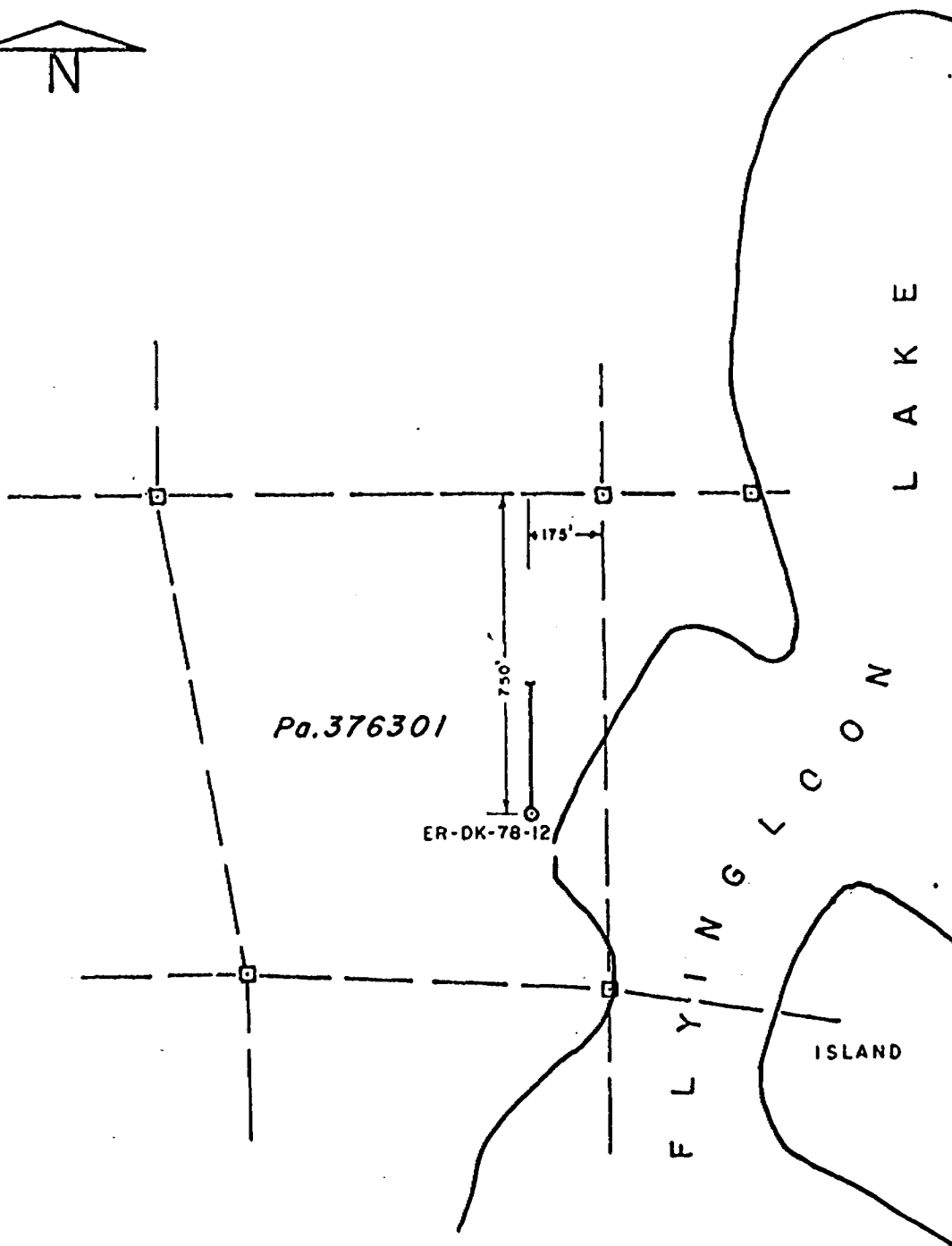

MATTAGAMI LAKE MINES LTD.

EXPLORATION DIVISION

PROJECT: ENGLISH RIVER
LOCATION PLAN

D.D.H.# ER-DK-78-12

SCALE: 1" = 400 FEET

DATE: MARCH 17, 1978 DRW. BY: R.S.



52G13SE0002 52G13SE0010A1 FLYINGLOON LAKE

900



Ontario

Ministry of Natural Resources

FLYINGLOON LAKE

M-3198

A separate form is required for each type of work to be recorded.

78-39

THE MINING ACT REPORT OF WORK

To the Recorder of Patricia Mining Division

I, Mattagami Lake Mines Limited T-84

name of Recorded Holder Prospector's Licence

Suite 1110 - 8 King St. East, Toronto, Ontario MSC 1B5

Post Office Address

do hereby report the performance of 426 days of Diamond Drilling type of work

not before reported to be applied on the following contiguous claims

Claim No.	Days	Claim No.	Days	Claim No.	Days
Pa. 459731	20	Pa. 459737	20	Pa. 459743	27
459732	20	459738	20	459744	20
459733	28	459739	20	459745	20
459734	28	459740	20	459746	20
459735	20	459741	28	459747	20
459736	20	459742	28	459748	20
		Pa. 376302		459749	27

All the work was performed on Mining Claim (s) Pa. 376302 (In the case of geological and/or geophysical survey (s) where more than 18 claims are involved attach a schedule)

READ CAREFULLY: THE FOLLOWING INFORMATION IS REQUIRED BY THE MINING RECORDER.

- For Manual Work, Stripping or Opening up of Mines, Sinking Shafts or Other Actual Mining Operations - Names and addresses of the men who performed the work and the dates and hours of their employment.
- For Diamond and other Core Drilling - Footage, No. and angle of holes and diameter of core. Name and address of owner or operator of drill. Dates when drilling was done. Signed core log and sketch in duplicate.
- For Compressed Air or Other Power Driven or Mechanical Equipment Type of drill or equipment. Names and addresses of men engaged in operating equipment and the dates and hours of their employment.
- For Power Stripping - Type of equipment. Name and address of owner or operator. Amount expended. Dates on which work was done. Proof of actual cost must be submitted within 30 days of recording.
- With each of the above types of work sketches are required to show the location and extent of the work in relation to the nearest claim post. In the case of diamond or other core drilling the sketch must be submitted in duplicate.
- For Geophysical, Geological, Geochemical Surveys and Expenditure Credits - the name of author of report. Covering dates of survey (linecutting & office). Type of instrument used. Total amount of expenditure. Technical reports, maps, expenditure breakdown, receipts must be filed in duplicate with the Minister within 60 days of recording.
- For Land Survey - the name and address of Ontario Land surveyor.

The Required Information is as Follows: (Attach a list if this space is insufficient)

Hole ER-DK-78-11 was drilled North on claim Pa.376302 to a depth of 426.0 feet at -50° Feb. 3-8, 1978 by Morissette Diamond Drilling Ltd., Haileybury, Ontario. Core size is AQ Wireline.

Date May 1, 1978.

Signature of Recorded Holder or Agent

The Mining Act Certificate Verifying Report of Work

I, J. Hinzer Suite 1110 - 8 King St. E., Toronto, Ontario MSC 1B5 (Post Office Address)

hereby certify:

- That I have a personal and intimate knowledge of the facts set forth in the report of work annexed hereto, having performed the work or witnessed same during and/or after its completion.
- That the annexed report is true.

Dated May 1, 1978

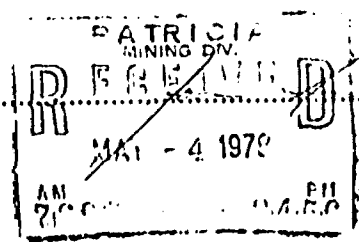

Signature

Pa. 376301

THE PENALTY FOR MAKING A FALSE STATEMENT IN THIS REPORT AND/OR CERTIFICATE IS \$500. OR SIX MONTHS IMPRISONMENT OR BOTH



Ministry of Natural Resources

Ontario

Flyingloon Mine
M-3198

A separate form is required for each type of work to be recorded.

78-86

THE MINING ACT REPORT OF WORK

To the Recorder of *Patricia* Mining Division

I, *Mattagami Lake Mines Limited* T-84

name of Recorded Holder

Prospector's Licence

Suite 1110 - 8 King St. East, Toronto, Ontario. MSC 1B5

Post Office Address

do hereby report the performance of *453* days of *Diamond Drilling* type of work

not before reported to be applied on the following contiguous claims

Claim No.	Days	Claim No.	Days	Claim No.	Days
.....
.....
.....	SEE ATTACHED LIST
.....
.....
.....

All the work was performed on Mining Claim (s) *Pa. 376301*
(In the case of geological and/or geophysical survey (s) where more than 18 claims are involved attach a schedule)

READ CAREFULLY: THE FOLLOWING INFORMATION IS REQUIRED BY THE MINING RECORDER.

For Manual Work, Stripping or Opening up of Mines, Sinking Shafts or Other Actual Mining Operations - Names and addresses of the men who performed the work and the dates and hours of their employment.

For Diamond and other Core Drilling Footage, No. and angle of holes and diameter of core. Name and address of owner or operator of drill. Dates when drilling was done. Signed core log and sketch in duplicate.

For Compressed Air or Other Power Driven or Mechanical Equipment

Type of drill or equipment. Names and addresses of men engaged in operating equipment and the dates and hours of their employment.

For Power Stripping - Type of equipment. Name and address of owner or operator. Amount expended. Dates on which work was done. Proof of actual cost must be submitted within 30 days of recording.

With each of the above types of work sketches are required to show the location and extent of the work in relation to the nearest claim post. In the case of diamond or other core drilling the sketch must be submitted in duplicate.

For Geophysical, Geological, Geochemical Surveys and Expenditure Credits - the name of author of report. Covering dates of survey (linecutting & office). Type of instrument used. Total amount of expenditure. Technical reports, maps, expenditure breakdown, receipts must be filed in duplicate with the Minister within 60 days of recording.

For Land Survey - the name and address of Ontario Land surveyor.

The Required Information is as Follows: (Attach a list if this space is insufficient)

Diamond Drill Hole ER-DK-78-12 was drilled North to a depth of 453 feet at -50° on claim Pa.376301 by Morissette Diamond Drilling Ltd., Haileybury from February 9 to 12, 1978.
Core Size is A.Q. Wireline

Date *July 17 / 78*

Signature of Recorded Holder or Agent

The Mining Act Certificate Verifying Report of Work

I, *J.D. Harvey*

Suite 1110 - 8 King St. East, Toronto, Ontario. MSC 1B5

(Post Office Address)

hereby certify:

- That I have a personal and intimate knowledge of the facts set forth in the report of work annexed hereto, having performed the work or witnessed same during and/or after its completion.
- That the annexed report is true

Dated *July 17 / 1978*

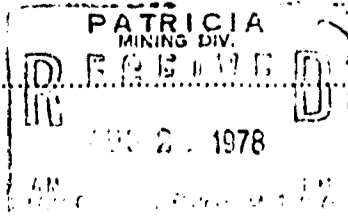

Pa. 376301

THE PENALTY FOR MAKING A FALSE STATEMENT IN THIS REPORT AND/OR CERTIFICATE IS \$500. OR SIX MONTHS IMPRISONMENT OR BOTH

<u>Claim No.</u>	<u>Days</u>	<u>Claim No.</u>	<u>Days</u>
Pa.376301	16	Pa.459737	9
Pa.376302	36	Pa.459738	9
Pa.376303	36	Pa.459739	9
Pa.376304	16	Pa.459740	9
Pa.458742	13	Pa.459741	32
Pa.458743	13	Pa.459742	32
Pa.458744	13	Pa.459743	33
Pa.458745	34	Pa.459744	9
Pa.459731	9	Pa.459745	9
Pa.459732	9	Pa.459746	9
Pa.459733	32	Pa.459747	9
Pa.459734	28	Pa.459748	9
Pa.459735	9	Pa.459749	2
Pa.459736	9		

PATRICIA
 MINING DIV.
R E F U S E D
 AUG 21 1978
 ALL INFORMATION CONTAINED HEREIN IS UNCLASSIFIED
 DATE 08-21-2009 BY 92456



Ministry of
Natural
Resources

Ontario

Flyingloon Lake
M-3198

A separate form is
required for each
type of work to be
recorded.

78-86

THE MINING ACT REPORT OF WORK

To the Recorder of *Patricia* Mining Division
I, *Mattagami Lake Mines Limited* T-84
name of Recorded Holder Prospector's Licence
Suite 1110 - 8 King St. East, Toronto, Ontario. MSC 1B5
Post Office Address

do hereby report the performance of *453* days of *Diamond Drilling*
type of work

not before reported to be applied on the following contiguous claims

Claim No.	Days	Claim No.	Days	Claim No.	Days
.....
.....
.....	SEE ATTACHED LIST
.....
.....
.....

All the work was performed on Mining Claim (s) *Pa. 376301*
(In the case of geological and/or geophysical survey (s) where more than 18 claims are involved attach a schedule)

READ CAREFULLY: THE FOLLOWING INFORMATION IS REQUIRED BY THE MINING RECORDER.

- For Manual Work, Stripping or Opening up of Mines, Sinking Shafts or Other Actual Mining Operations - Names and addresses of the men who performed the work and the dates and hours of their employment.
- For Diamond and other Core Drilling - Footage, No. and angle of holes and diameter of core. Name and address of owner or operator of drill. Dates when drilling was done. Signed core log and sketch in duplicate.
- For Compressed Air or Other Power Driven or Mechanical Equipment
Type of drill or equipment. Names and addresses of men engaged in operating equipment and the dates and hours of their employment.
- For Power Stripping - Type of equipment. Name and address of owner or operator. Amount expended. Dates on which work was done. Proof of actual cost must be submitted within 30 days of recording.
- With each of the above types of work sketches are required to show the location and extent of the work in relation to the nearest claim post. In the case of diamond or other core drilling the sketch must be submitted in duplicate.
- For Geophysical, Geological, Geochemical Surveys and Expenditure Credits - the name of author of report. Covering dates of survey (linecutting & office). Type of instrument used. Total amount of expenditure. Technical reports, maps, expenditure breakdown, receipts must be filed in duplicate with the Minister within 60 days of recording.
- For Land Survey - the name and address of Ontario Land surveyor.

The Required Information is as Follows: (Attach a list if this space is insufficient)

Diamond Drill Hole ER-DK-78-12 was drilled North to a depth of 453 feet at -50° on claim Pa.376301 by Morissette Diamond Drilling Ltd., Haileybury from February 9 to 12, 1978.
Core Size is A.Q. Wireline

Date *Aug 17 / 78* Signature of Recorded Holder or Agent *[Signature]*

The Mining Act
Certificate Verifying Report of Work

I, *J.D. Harvey*
Suite 1110 - 8 King St. East, Toronto, Ontario. MSC 1B5
(Post Office Address)

hereby certify:

- That I have a personal and intimate knowledge of the facts set forth in the report of work annexed hereto, having performed the work or witnessed same during and/or after its completion.
- That the annexed report is true.

Dated *Aug 17 / 1978*

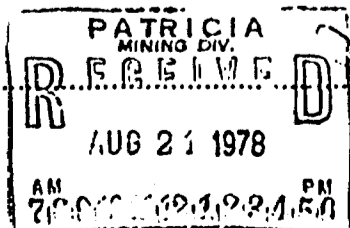

Pa. 376301

THE PENALTY FOR MAKING A FALSE STATEMENT IN THIS REPORT AND/OR CERTIFICATE IS \$500. OR SIX MONTHS IMPRISONMENT OR BOTH

<u>Claim No.</u>	<u>Days</u>	<u>Claim No.</u>	<u>Days</u>
Pa. 376301	16	Pa. 459737	9
Pa. 376302	36	Pa. 459738	9
Pa. 376303	36	Pa. 459739	9
Pa. 376304	16	Pa. 459740	9
Pa. 458742	13	Pa. 459741	32
Pa. 458743	13	Pa. 459742	32
Pa. 458744	13	Pa. 459743	33
Pa. 458745	34	Pa. 459744	9
Pa. 459731	9	Pa. 459745	9
Pa. 459732	9	Pa. 459746	9
Pa. 459735	32	Pa. 459747	9
Pa. 459734	28	Pa. 459748	9
Pa. 459735	9	Pa. 459749	2
Pa. 459736	9		

PATRICIA
 MINING DIV.
 RECEIVED
 1978
 APR 21 1978
 AN
 2000 2200 2.50
 BN

459737	459736	459735	459734	459733	459732	459731	458742	458743
459738	376301	376302	376303	376304	459745	459746	458744	458745
459739	459740	459741	459742	459743	459744	459747	459748	459749

BLOCK No 9

FLYINGLOON LAKE

M-3198

SCALE: 1" = 40CH

