



52G13SE0003 52G13SE0010C1 FLYINGLOON LAKE

010

Diamond Drilling

Area of FLYINGLOON LAKE

Report NO 10

Work performed by: Mattagami Lake Mines

Claim NO	Hole NO	Footage	Date	Note
PA 376304	ER-D-77-8	416.0'	Mar/77	(1)
PA 458744	ER-K-77-6	427.0'	Feb/77	(2)

TOTAL: 2 DH 843 FT

Notes:

(1) #65-77

(2) #66-77

ATTIGAMI LAKE MINES LIMITED - EXPLORATION DIVISION - DIAMOND DRILL HOLE RECORD #65

PROPERTY	ENGLISH RIVER GROUP "D"	LATITUDE	9 + 50S	STARTED	MARCH 5, 1977	DIP TEST					
E NO.	ER-D-77-8	DEPARTURE	8 + 00W	FINISHED	MARCH 11, 1977	Footage	Corrected	Footage	Corrected	Footage	Corrected
RING	NORTH (00)	ELEVATION	SURFACE	LENGTH	416.0 FEET	200'	-430	416'	-350		
COLLAR	-500	SECTION	8 + 00W	LOGGED BY	G. STEINERT	300'	-410				

From	To	DESCRIPTION	% Mineralization	SAMPLE NO.	FOOTAGE			ASSAYS							
					From	To	Length	CU	ZN	FE	MN	NI/AU	S102		
0'	104.0'	CASING: (96' of overburden)													
104.0'	161.0'	MAFIC FLOW, PORPHYRITIC: Fine gr dark green massive matrix containing 25-50% subrounded buff to pink feldspar phenocrysts 2-3mm in diam, cut by occasional thin barren calcite & qtz veinlets, no visible sulphides.													
161.0'	166.0'	MAFIC FLOW: Fine gr. Dark green, massive, fine gr, flow, sharp upper contact at 400 to core axis.													
166.0'	245.0'	MAFIC FLOW, PORPHYRITIC: Same as above.													
		173.0-181.5': Highly sheared	Tr	192	202.0	207.0	5.0'	Tr	Tr	8.13	.09			54.6	
		179.5-180.0': barren qtz vein													
		184.8-185.2': fine gr mafic phase (chilled flow top?)													
		184.4-194.8': , contacts at 450 to core axis													
		Also fine gr mafic phases at 197.1-198.0', 198.3-199.0', 209.4-212.0', & 216.0-216.3'.	Tr	193	242.9	245.9	3.0'	Tr	Tr				.03/		
		240.0-240.6': iron stained fractures semi parallel to core axis.													
245.9'	250.4'	CHERT: Pink, fine gr, barren, banded at 450 to core axis, contacts at 450 to core axis.	Tr	194	245.9	250.4	4.5'	Tr	Tr						
250.4	324.5'	MAFIC FLOW: Fine gr, Dark green, massive, fine gr, cut by thin calcite veinlets, fractured, tr -2% po + py (diss & filling fractures), few specks cpy.	Tr	195	250.4	255.4	5.0'	.05	.02				.05/		
		250.4-257.0': sheared, tr py + po	Tr - 2%	196	255.4	260.4	5.0'	.10	.01	12.22	.13		.12/	48.4	
		273.5-273.6': po stringer containing mafic inclusions		197	260.4	265.4	5.0'	.14	.01	.02 (Co)			.28/		
		274.2+ cpy stringer .5 cm wide	Mass cpy over 5cm	198	265.4	270.4	5.0'	.12	.01				.23/		
		280.8-280.9': po-py stringer		199	270.4	274.0	3.6'	.06	.02	.02 (Co)			.25/		
		292.6': py stringer .5cm wide		200	274.0	275.0	1.0'	.50	.02	.02 (Co)			.17/		
		297.7-297.8' & 298.0-298.1': barren qtz veins	Tr - 2%	201	275.0	280.0	5.0'	.08	.01	.02 (Co)			.21/		
		298.9': po stringer 1cm wide		202	280.0	285.0	5.0'	.11	.01	.02 (Co)			.17/		
		298.9-299.2': 18 diss cpy		203	285.0	290.0	5.0'	.08	.01				.11/		
		299.1-300.0': massive po stringer with basaltic inclusions	Mass po over 1'	204	290.0	295.0	5.0'	.03	.02				.07/		
		300.0-300.3': 1-3% cpy, 5-10% po		205	295.0	297.5	2.5'	.04	.02				.03/		
		300.3-300.4': po stringer	Mass po over .5'	206	297.5	300.0	2.5'	.56	.02	.08 (Co)			1.19/		
		301.1': po stringer 1cm wide	1-3% cpy over .3'	207	300.0	302.5	2.5'	.36	.02	.03 (Co)			.53/		
		301.1-303.0': Fine gr massive purplish gray felsic vein, also from 304.5-304.8'.	Mass cpy-po over .2cm	208	302.5	305.0	2.5'	.23	.01	.09 (Co)			1.26/		
		303.5-304.0': po stringer with mafic inclusions		209	305.0	310.0	5.0'	.32	.02	.03 (Co)			.36/		
		306.0 & 307.3': magnetite stringers .5cm wide each	Mass mag over 1cm	210	310.0	315.0	5.0'	.07	.02				.10/		
		306.8': cpy-po stringer 0.2cm wide		240	315.0	320.0	5.0'	TR	Tr				.14/		
				241	320.0	324.0	4.0'	Tr	Tr				.08/		

GEOPHYSICS

Mag M-700
 EM-17 { In Phase
 Quadrature
 Frequency: 1600 Hz
 Coil Separation 300'
 σt : 11 mhos.
 Depth: 90' Width: 40'

MAGNETIC FIELD STRENGTH (GAMMAS)

+25
 +20
 +15
 +10
 +5
 0
 -5
 -10
 -15
 -20
 -25
 -30

RESULTANT DIP ANGLE (DEGREES)

SURFACE

10+00 ±

ER-D-77-8

8+00 ±

DIAMOND DRILLING

100'
 200'
 300'
 400'
 500'

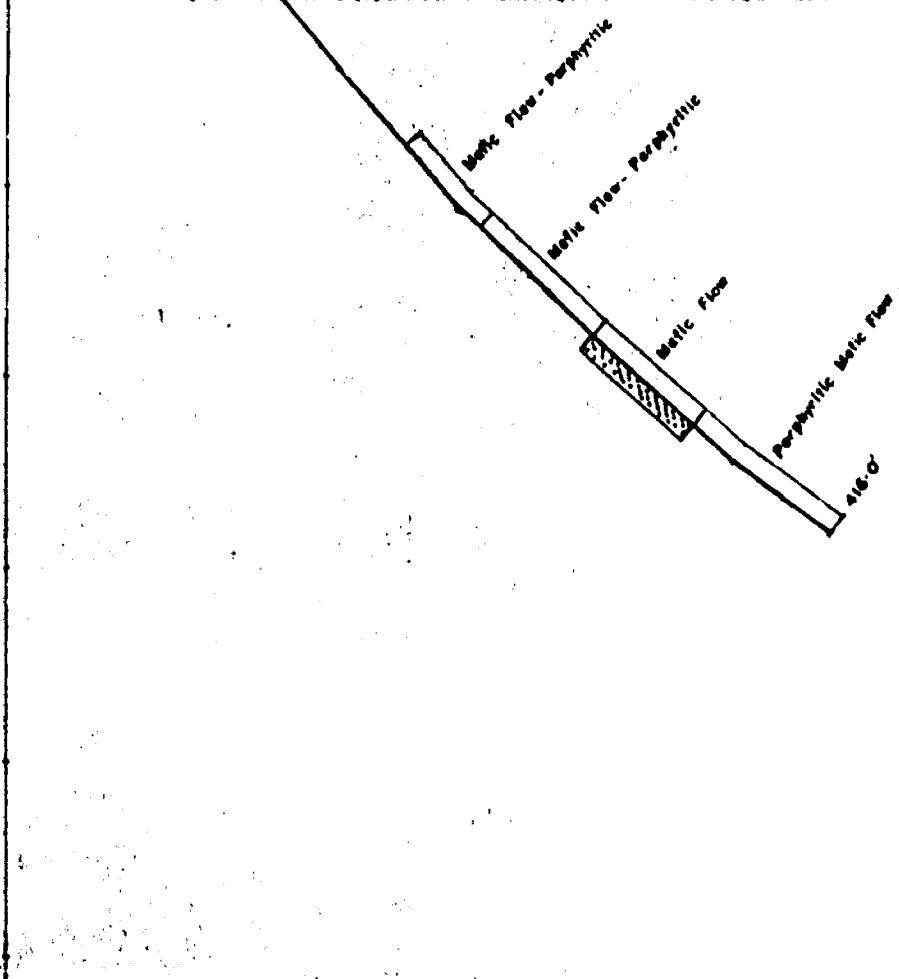

LEGEND

- 1-5 % Sulphide
- 5-10% "
- 10-25% "
- 25-50% "
- 50-100% "

MATTAGAMI LAKE MINES LTD.
 EXPLORATION DIVISION

PROJECT: ENGLISH RIVER
 ANOMALY: ZONE A, GROUP D.
 SECTION: 8+00 W.
 DD.H. NO.: ER-D-77-8

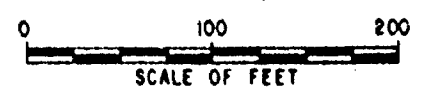

DATE: APRIL 29/77 DRAWN BY:

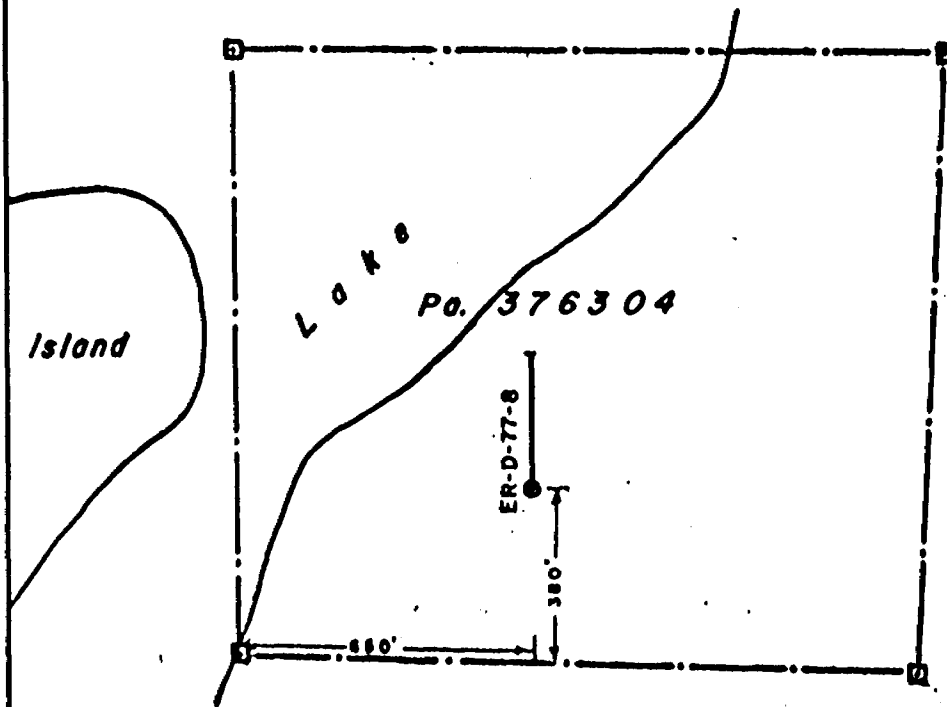

MATTAGAMI LAKE MINES LTD.

EXPLORATION DIVISION

PROJECT: ENGLISH RIVER

LOCATION PLAN

D.D.H.# ER-D-77-8

SCALE: 1" = 400 FEET

DATE: APRIL 29, 1977 DRW. BY: R.S.

ITTAGAMI LAKE MINES LIMITED - EXPLORATION DIVISION - DIAMOND DRILL HOLE RECORD

#66

PERTY	ENGLISH RIVER GROUP "K"	LATITUDE	10 + 50S	STARTED	FEBRUARY 16, 1977	DIP TEST					
						Footage	Corrected	Footage	Corrected	Footage	Corrected
E NO.	ER-K-77-6	DEPARTURE	12 + 00E	FINISHED	FEBRUARY 25, 1977	100'	-460	400'	-270		
RING	NORTH	ELEVATION		LENGTH	427.0 FEET	200'	-420				
COLLAR	-500	SECTION	12 + 00E	LOGGED BY	G. STEINERT	300'	-350				

FOOTAGE		DESCRIPTION	To Mineralization	SAMPLE NO.	FOOTAGE			ASSAYS				
From	To				From	To	Length	CU	ZN	NI	AU	FE
	146.0'	CASING (135' overburden)										
146.0'	152.0'	PORPHYRITIC MAFIC FLOW: Dark gray-green to black, white fd, phenocrysts 1-2mm in fine gr matrix.										
152.0'	197.0'	GRAYWACKE: Interbedded greenish-gray & pale brown units, very thin (1-5cm average), banding at 500 to core axis, cut by buff to pale yellow carbonate veinlets, tr pyrite. Greenish-gray units: composed of fine gr qtz & fd & clusters of coarse gr (< 1-2mm) med to dark green mafic minerals (amphibole, chlorite), foliated at 500 to core axis. Pale brown units: thinner than other units, fine gr, biotitic. 171.0-173.0': fine gr dark green massive mafic flow. 182.1-182.5': qtz vein, barren 195.0-196.8': 1-5% po + py, tr - 1% cpy										
			Trace po	161	192.0	195.0	3.0'	.02	Tr			.07/53
			1-5% po + py	162	195.0	197.0	2.0'	.12	.01	.25		13.73.11/
			tr - 1% cpy									
197.0'	270.0'	PILLOWED MAFIC VOLCANIC WITH MINOR MAFIC TUFF: Dark green, fine to med gr to porphyritic, amphibolitic; pillows vary from porphyritic inner portions (fd pheno's 1-3mm diam) to fine gr outer portions & are separated by thin (1cm) chloritic selvages also minor mafic tuff cut by thin qtz & buff to pale yellow carbonate veinlets, mineralization mainly po (1-10%), tr py & cpy assoc with fractures & veinlets. 200.5-201.5': 10-15% diss po, tr - 2% cpy 201.5-201.7': qtz vein containing 1-3% po + cpy 203.6-205.6', 205.9': solid cpy - po filled fractures 204.8': diss cpy 1-2% 217.0-244.2': tr po 241.0-241.1': cpy stringer assoc with very thin felsic section 244.0-244.2': 1-10% po (diss & stringers) few specks cpy 252.2-259.0': 1-5% diss py, few specks cpy + po										
			Tr - 1% PPTPY	163	197.0	200.5	3.5'	.02	.01	.05		
			10-15% po,	164	200.5	201.7	1.2'	1.08	.02	.63		
			tr - 2% cpy									
			1-5% po, tr-2% cpy	165	201.7	205.9	4.2'	.30	.01	.27		
			Tr po, cpy	166	205.9	210.9	5.0'	.04	.01	.08		7.59 .08/
			1-10% po + cpy	167	210.9	213.4	2.5'	.16	Tr	.07		
			Tr 2% po+cpy	168	213.4	218.4	5.0'	.11	Tr	.13		7.44 .07/51
			1-3% po, tr cpy	169	218.4	223.4	5.0'	.18	Tr	.22		
			Tr po	170	223.4	228.4	5.0'	.05	Tr	.11		8.69 .07/
			Tr po, cpy	171	235.5	240.5	5.0'	.02	.01			.08/
			Cpy str. 1' wide	172	240.5	243.0	2.5'	.82	.03	.17		
			Po-cpy str over .2'	173	243.0	245.5	2.5'	1.11	.02	.37		
			Tr 10% po, tr cpy	174	245.5	250.5	5.0'	.17	.01	.49	Nil	
			1-10% py, tr 2% cpy	175	250.5	255.5	5.0'	.18	.01	.18	Nil	8.71 .05/
			1-10% po, tr 1% cpy	176	255.5	260.5	5.0'	.11	Tr	.15		/48.5
				214	260.5	265.5	5.0'	.06	.02	.12		
				215	265.5	270.0	4.5'	.02	.03	.07		
270.0'	282.0'	MAFIC FLOW: Fine gr, dark green, massive, sphanitic, tr po										
				212	228.4	232.0	3.6'	.02	.02	.05		
				213	232.0	235.5	3.5'	.01	.05	.11		
282.0'	302.0'	MAFIC TUFF: Dark green, fine gr, finely banded at 350 to core axis.										
302.0'	318.0'	MAFIC AGGLOMERATE: Med-dark green, fine to med gr, chloritic matrix foliated at 600 to core axis, contains rounded to subrounded dacite fragments up to 1cm diam stretched at 55-600 to core axis, rounded cherty fragment 2cm diam at 302.9', most fragments fine gr, some porphyritic (fd pheno's 1mm diam).	Trace	160	311.0	314.0	3.0'	Tr	.01			6.88 .07/52.6

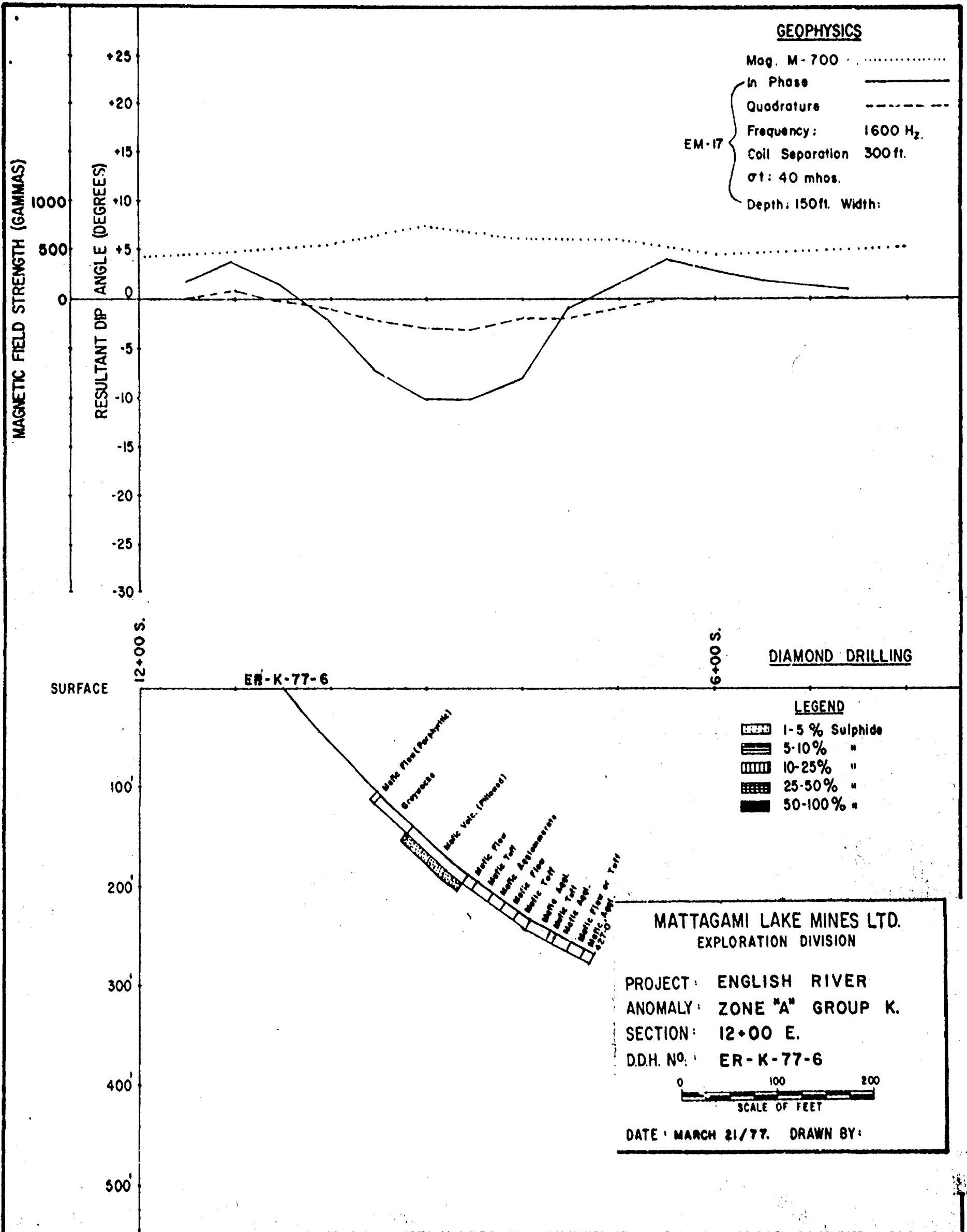



Pa. 458742

Pa. 458743

Pa. 458744

Pa. 458745

ER-K-77-6
1050'
220'

MATTAGAMI LAKE MINES LTD.
EXPLORATION DIVISION

PROJECT: ENGLISH RIVER.
LOCATION PLAN

D.D.H.# ER-K-77-6

SCALE: 1" = 400 FEET

DATE: MARCH 21, 1977 DRW. BY:



Flyingloon Lake M-3198

900



A separate form is required for each type of work to be recorded.

77-66

THE MINING ACT REPORT OF WORK

To the Recorder of Patricia Mining Division
I, Mattagami Lake Mines Limited T-84
name of Recorded Holder Prospector's Licence
Suite 1110 - 8 King St. East, Toronto, Ontario. M5C 1B5
do hereby report the performance of 427 days of Diamond Drilling
type of work

not before reported to be applied on the following contiguous claims

Table with columns: Claim No., Days, Claim No., Days, Claim No., Days. Contains entries for Pa. 458742, 458743, 458744, 458745 with days 107 and 106.

Geological Branch ODM ASSESSMENT FILES RESEARCH OFFICE SEP 27 1977 RECEIVED

All the work was performed on Mining Claim (s) Pa. 458744 (In the case of geological and/or geophysical survey (s) where more than 18 claims are involved attach a schedule)

READ CAREFULLY: THE FOLLOWING INFORMATION IS REQUIRED BY THE MINING RECORDER.

- For Manual Work, Stripping or Opening up of Mines, Sinking Shafts or Other Actual Mining Operations - Names and addresses of the men who performed the work and the dates and hours of their employment.
For Diamond and other Core Drilling - Footage, No. and angle of holes and diameter of core. Name and address of owner or operator of drill. Dates when drilling was done. Signed core log and sketch in duplicate.
For Compressed Air or Other Power Driven or Mechanical Equipment
Type of drill or equipment. Names and addresses of men engaged in operating equipment and the dates and hours of their employment.
For Power Stripping - Type of equipment. Name and address of owner or operator. Amount expended. Dates on which work was done. Proof of actual cost must be submitted within 30 days of recording.
With each of the above types of work sketches are required to show the location and extent of the work in relation to the nearest claim post. In the case of diamond or other core drilling the sketch must be submitted in duplicate.
For Geophysical, Geological, Geochemical Surveys and Expenditure Credits - the name of author of report. Covering dates of survey (linecutting & office). Type of instrument used. Total amount of expenditure. Technical reports, maps, expenditure breakdown, receipts must be filed in duplicate with the Minister within 60 days of recording.
For Land Survey - the name and address of Ontario Land surveyor.

The Required Information is as Follows: (Attach a list if this space is insufficient)

Hole #ER-K-77-6 was drilled north at -50° to a depth of 427.0' on claim Pa.458744 during the period of Feb. 16-25, 1977 by Morissette Diamond Drilling Ltd. of Haileybury, Ontario. Core Size is AQ wireline.

416.0
427.0
-843.0

Date Sept 20/77

Signature of Recorded Holder or Agent

MINISTRY OF NATURAL RESOURCES RECEIVED OCT 12 1977 RESIDENT GEOLOGIST'S OFFICE

The Mining Act Certificate Verifying Report of Work

I, J.D. Harvey Suite 1110 - 8 King St. East, Toronto, Ontario. M5C 1B5 (Post Office Address)

hereby certify:

- 1. That I have a personal and intimate knowledge of the facts set forth in the report of work annexed hereto, having performed the work or witnessed same during and/or after its completion.
2. That the annexed report is true.

Dated Sept 20 1977

PATRICIA MINING DIV. RECEIVED SEP 20 1977 AM 8:00 PM 4:50

Signature

Pa. 458742

THE PENALTY FOR MAKING A FALSE STATEMENT IN THIS REPORT AND/OR CERTIFICATE IS \$500. OR SIX MONTHS IMPRISONMENT OR BOTH



Ministry of Natural Resources Ontario

A separate form is required for each type of work to be recorded.

77-65

THE MINING ACT REPORT OF WORK

To the Recorder of Patricia Mining Division

I, Mattagami Lake Mines Limited T-84

name of Recorded Holder Suite 1110 - 8 King St. East, Toronto, Ontario. MSC 1B5

Post Office Address 416

do hereby report the performance of 416 days of Diamond Drilling type of work

not before reported to be applied on the following contiguous claims

Table with columns: Claim No., Days, Claim No., Days, Claim No., Days. Entries include Pa. 376301, 376302, 376303, 376304.

Geological Branch ODM ASSESSMENT FILES RESEARCH OFFICE SEP 27 1977 RECEIVED

All the work was performed on Mining Claim (s) Pa. 376304 (In the case of geological and/or geophysical survey (s) where more than 18 claims are involved attach a schedule)

READ CAREFULLY: THE FOLLOWING INFORMATION IS REQUIRED BY THE MINING RECORDER.

- For Manual Work, Stripping or Opening up of Mines, Sinking Shafts or Other Actual Mining Operations - Names and addresses of the men who performed the work and the dates and hours of their employment. For Diamond and other Core Drilling - Footage, No. and angle of holes and diameter of core. Name and address of owner or operator of drill. Dates when drilling was done. Signed core log and sketch in duplicate. For Compressed Air or Other Power Driven or Mechanical Equipment - Type of drill or equipment. Names and addresses of men engaged in operating equipment and the dates and hours of their employment. For Power Stripping - Type of equipment. Name and address of owner or operator. Amount expended. Dates on which work was done. Proof of actual cost must be submitted within 30 days of recording. With each of the above types of work sketches are required to show the location and extent of the work in relation to the nearest claim post. In the case of diamond or other core drilling the sketch must be submitted in duplicate. For Geophysical, Geological, Geochemical Surveys and Expenditure Credits - the name of author of report. Covering dates of survey (linecutting & office). Type of instrument used. Total amount of expenditure. Technical reports, maps, expenditure breakdown, receipts must be filed in duplicate with the Minister within 60 days of recording. For Land Survey - the name and address of Ontario Land surveyor.

The Required Information is as Follows: (Attach a list if this space is insufficient)

Hole ER-D-77-8 was drilled North at -50° to a depth of 416.0' on claim Pa.376304 during period March 5-11, 1977 by Morissette Diamond Drilling Ltd. of Haileybury, Ontario. Core size is AQ wire line.

MINISTRY OF NATURAL RESOURCES RECEIVED OCT 12 1977 RESIDENT GEOLOGIST'S OFFICE SIOUX LOOKOUT

Date Sept 20/77

Signature of Recorded Holder or Agent

The Mining Act Certificate Verifying Report of Work

J.D. Harvey Suite 1110 - 8 King St. East, Toronto, Ontario. MSC 1B5 (Post Office Address)

hereby certify:

- 1. That I have a personal and intimate knowledge of the facts set forth in the report of work annexed hereto, having performed the work or witnessed same during and/or after its completion. 2. That the annexed report is true.

Dated Sept 20 19 77

PATRICIA MINING DIV. RECEIVED SEP 20 1977 AM 3:00 PM 1.50

Signature Pa. 376301

THIS REPORT AND/OR CERTIFICATE IS \$500. OR SIX MONTHS IMPRISONMENT OR BOTH THE PENALTY FOR MAKING A FALSE STATEMENT

							458743
459737	459736	459735	459734	459733	459732	459731	458742
	FD 376301	FD 376302	FD 376303	FD 376304			
459738				459745	459746	458744	458745
459739	459740	459741	459742	459743	459744	459747	459748 459749

SCALE: 1" = 40CH

BLOCK N° 9

Flyingloon Lake
M-3198

65-77