



52G14NE0001 63.5771 PENASSI LAKE

" CORBE BAY " REPORT

Individuals Who Applied for Assistance for This Project:

Sherridon Johnson
Bill Read
Stan Johnson

Location and Access:

Attached

Geology:

Showings occur in two rock types. Zone #1 occurs at the contact of a fairly large body of quartz porphyry with mafic meta-volcanics. Iron carbonate rust is very pronounced in some sections of the contact and sulphides and gold bearing quartz veins in these sections are prevalent. At the contact, quartz veins of various sizes ramify in all directions and the mafic meta-volcanics are altered, bleached and rusty. In some areas of the showings fuchite mica is evident.

Zone #2 is 1/2 mile south and the showings are in a quartz porphyry dike. Mineralization is pyrite, sparse chalcopyrite, quartz tourmaline stockworks and visible gold in the porphyry.

Work Done:

Prospecting of area. Cut road in to property that will handle a 4-wheel ATV or a 4-wheel drive truck. Trenched and sampled both cones, samples were analysed and panned.

Results and Recommendations:

Trenching extended Zone #1 by 100' and indicates that the contact with the porphyry may be favourable at any given point.

Zone #2 is very interesting because it is the porphyry itself and as well as VG in the porphyry, visible quartz tourmaline veins can very well. Much more work is needed on this property, concentrating on finding more occurrences of quartz tourmaline in the porphyry.

Daily Log:

Attached

Expenditures:

Attached

31 OCT 4 10016

COBBS BAY

Area - Penassi Lake

Mining Division - Patricia

Claim map no. -G2526

N.T.S. map - 52G-NW

Location map - Enclosed

Claim map - Enclosed

Prospecting Targets - AU -CU

Deposit Type - Quartz vein system

Geology - Volcanics and sheared porphyry

MINING RECORDER
PATRICIA
MINING DIVISION

31 OCT 4 4:13



ONTARIO
DIVISION OF MINES

HONOURABLE LEO BERNIER, Minister of Natural Resources

W. Q. MACNEE, Deputy Minister of Natural Resources

G. A. Jewett, Executive Director, Division of Mines

E. G. Pye, Director, Geological Branch

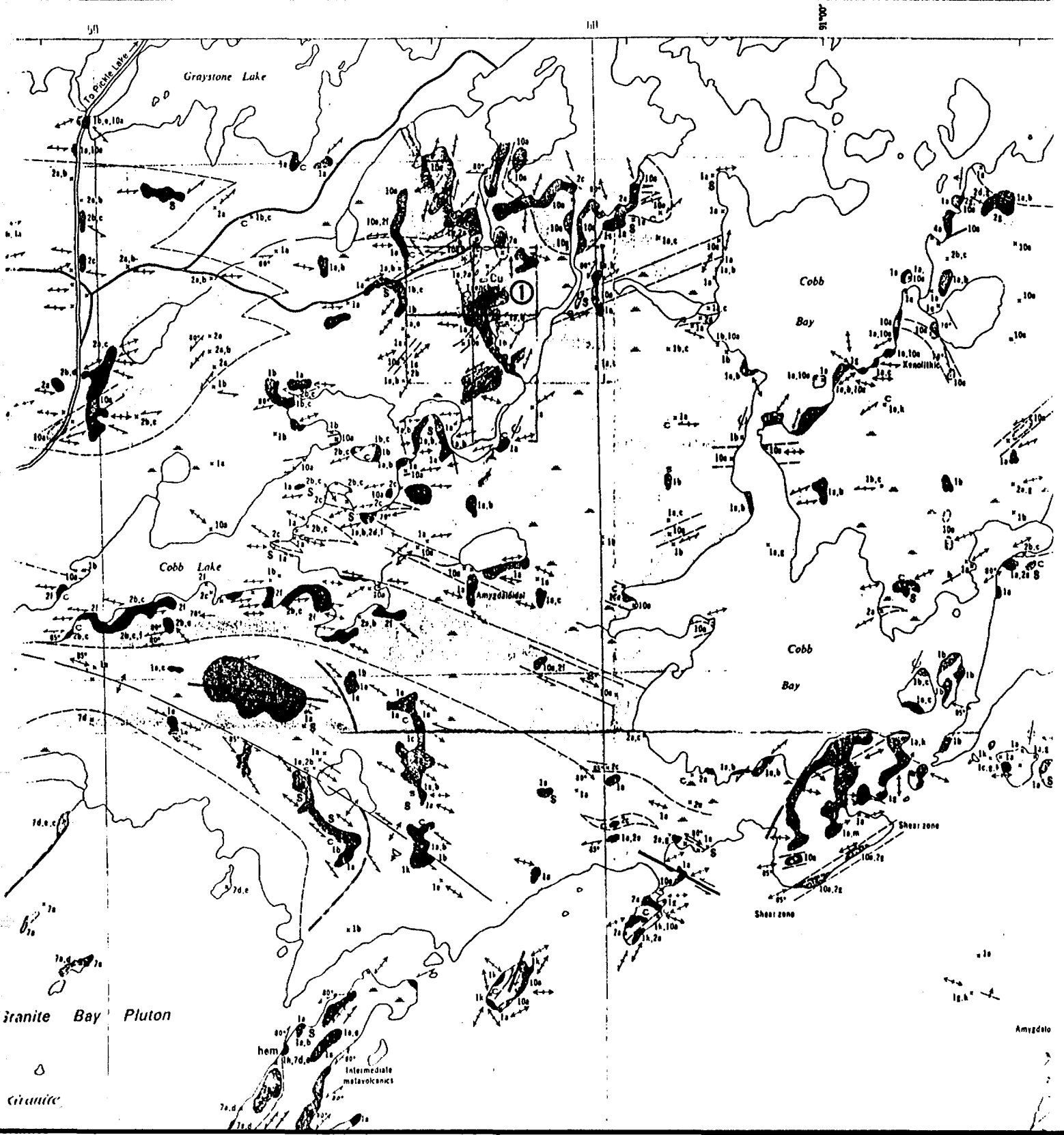

PENASSI LAKE
G 2526

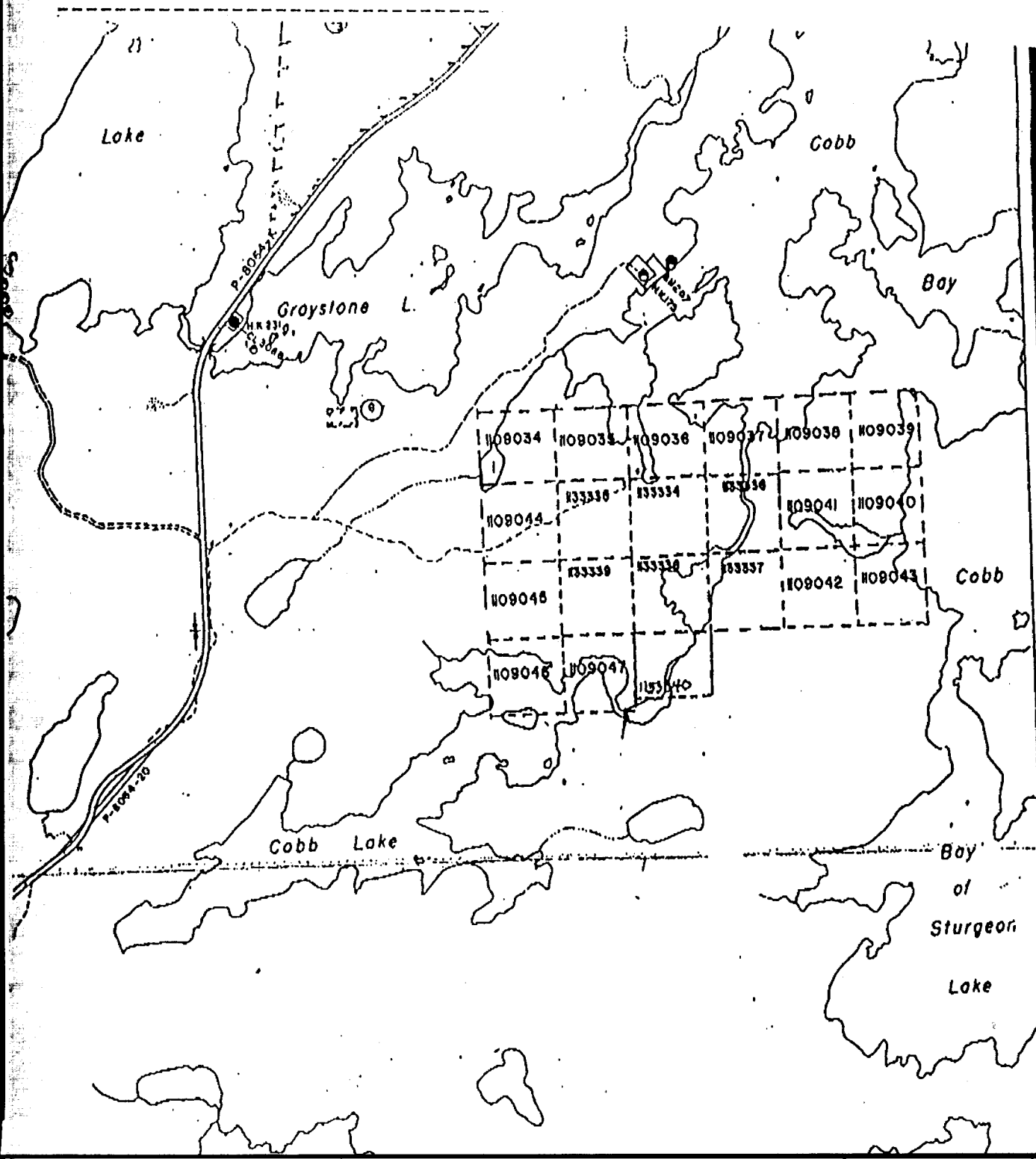

WISHING TO
ING CLAIMS S
SULT WITH 7
RECORDER, N
NORTHERN
MENT AND MI
DITIONAL IN
ON THE STA
LANDS SHOW

59'

58'

57'

1109035

1109036

1109037

COBB
BAY
STURGEON
LAKE

1133335

1133334

1133336

OLD
TRENCH

NEW TRENCH
5'14'

5'15' ← NEW TRENCH

← OLD TRENCH

← NEW TRENCH
3'20'

1133339

1133338

1133337

COBB BAY

NEW TRENCH
5'33'

1109047

OLD TRENCHES

1133340

1

Sample No

1912
1923
1924
1927
1928
1930

■ 1925
1926

Cobb's Bay

Pt 5
■ ■ ■

Cobb's Lake



ONTARIO
DIVISION OF MINES

HONOURABLE LEO BERNIER, Minister of Natural Resources
W. Q. MACNEE, Deputy Minister of Natural Resources

G. A. Jewett, Executive Director, Division of Mines

E. G. Pye, Director, Geological Branch

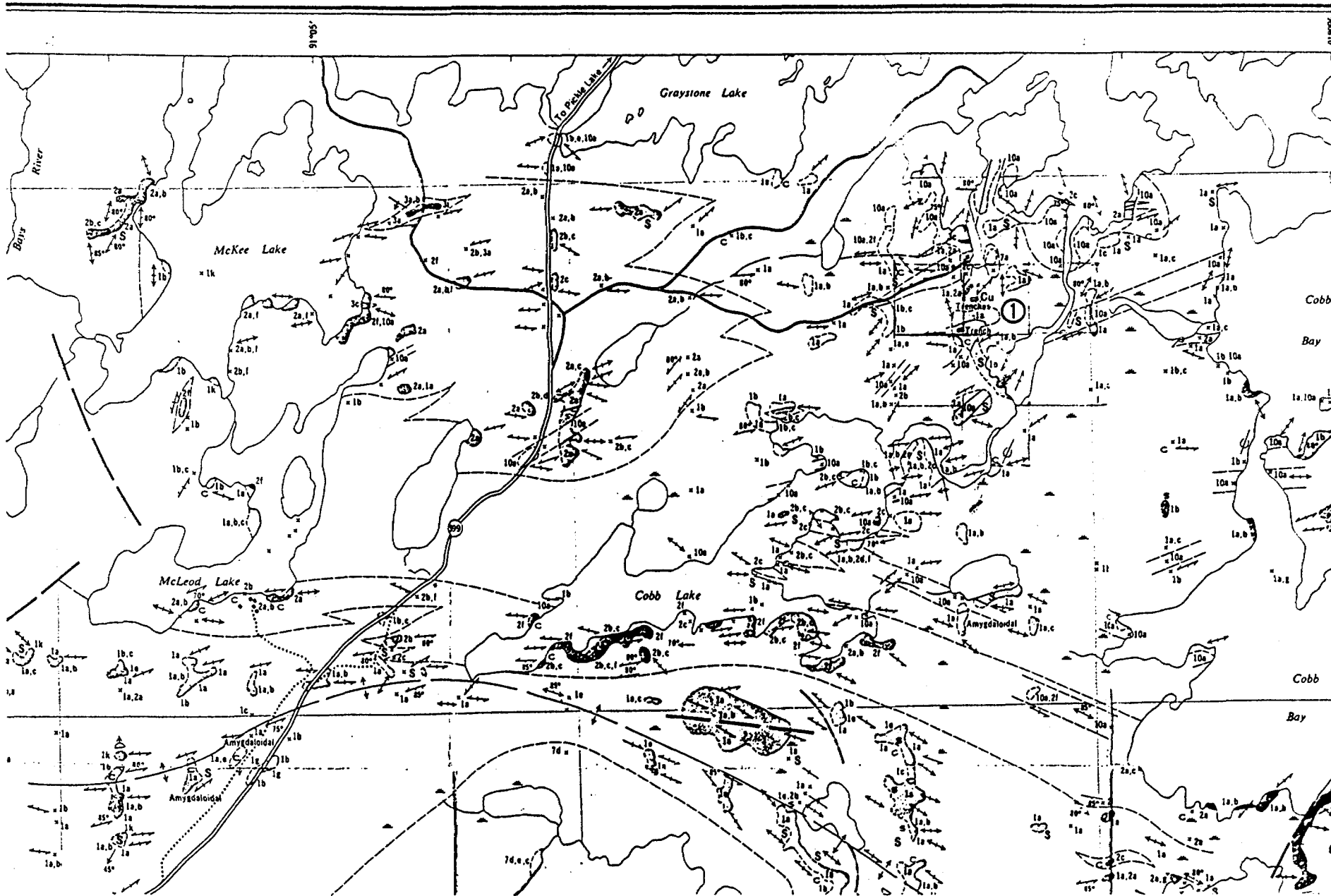

May 27/1990 Rick Cartwright
Cobb Lake Property
of Sheridan Johnson

cobb bay lodge
road

trail; bad blow down; road skulder.

cobb bay
lodge dock

N
↑

trench #2 | trench: north most
- path 300'
- canoe dock

samples 1664-1668 - stop 2
lakeside aft

stop 3 { trench 13; 1669, 75
trench 4; 1670, 78 } canoe dock; stop 3.

path

552
672, 73

Por phyny - 20-30 ft. width

- Mineralization
decreases to
SW.

COBB LAKE

82-4940
51-106

COBB LAKE,
PLAN VIEW OF TRENCH #1

1" = 1 foot

Rick Cartwright
May 27/90

WEST

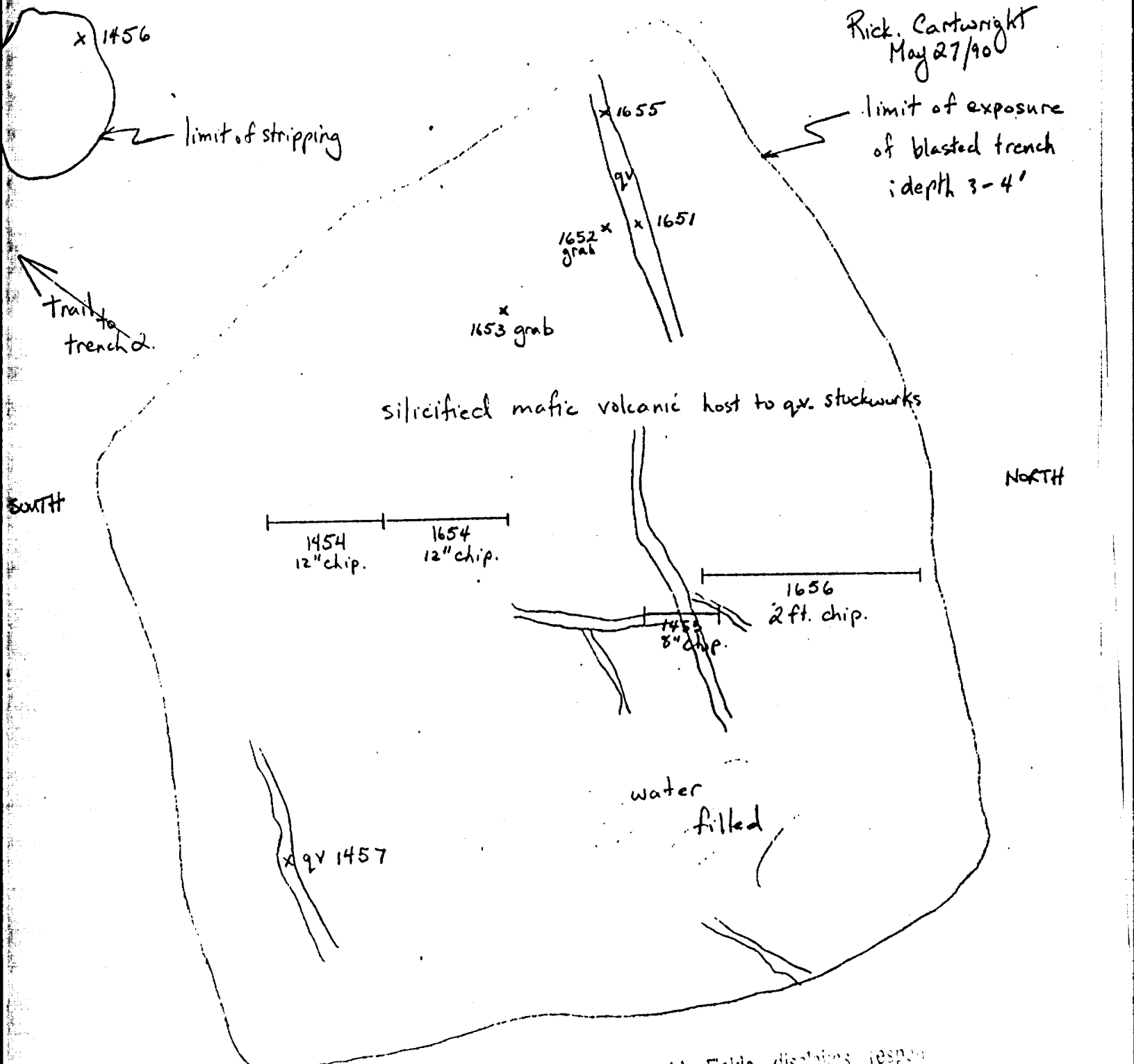

limit of stripping

limit of exposure
of blasted trench
depth 3-4'

Trail to
trench 2.

silicified mafic volcanic host to q.v. stockworks

NORTH

1454
12" chip.

1654
12" chip.

1656
2 ft. chip.

1455
8" chip.

water
filled

x qv 1457

Cold Fields disclaims respon-
sibility for the accuracy of any
core (s), log (s) or other data

Cobb Lake
Trench #2.

1" = 5 ft.

Rick Cartwright
May 27/90

300° trench trend

x mafic volcanic

1664 felsite alteration
contact.

qtz feldspar porphyry grab.
1660

qfp.

alteration
zone (silicified)

1658
2ft. chip.

x 1659
mafic
volc.

contact trend 202° / ?90° dip.

2 cm. wide
qtz. vein

1662 = 6" chip along length

qfp.

1665 = 2ft chip in qfp . 5-10% py, asf
in qfp along contact.

May 26/90

-Went to Cobb Bay and cleaned out trails and trenches - stayed at Cobb Bay Camp (\$118.00)

-S.J. 26-05-90- #1

- Found mineralized Qtz. Por. - Tourmaline
- First Bay N. of portage into Cobb Lake
- On strike with previous showings

< panned 6-8 coarse colors - up to .10 oz/ton - Tourmaline panned the same with very little to no sulphides - Tourmaline should be looked for more specifically

May 27/90

-Spent day at Cobb Bay examining previous showings and prospecting the immediate area

May 28/90

-No work - I was not feeling good.

May 29/90

-Went to Long Lead

- Finished cutting lines from pits to base line (Am. Jack)
- 4 lines making a total of 15 pits so far

-Prospected E. end of American Jack in detail

-S.J. 29-05-90- #1

- Pit # 15 - shearing 1-2 ft. wide - mineralized
- Took rust and rock
- Cube Pv.

-S.J. 29-05-90- #2

- Same as #1 but 6 ft. west
- Better pv. - some Qtz.

-S.J. 29-05-90- #3

- Very rusty - vuggy - mineralized rock on strike with #1

Aug. 2/90

- Went to our Pike Lake, Pluton claims
- S.J. 02-08-90- #1
 - 1 claim N. of claim # 1133342 #4 post
 - Qtz. stringers in Gabbro
 - Nice Cpy. in Qtz.
 - Minor Cpy. and Po. in Gabbro
- S.J. 02-08-90- #2
 - Same outcrop as # 1
 - Qtz. stringer 4 inches W. abundant Cpy.
 - Lots of mineralized stringers in area
- S.J. 02-08-90- #3
 - Last years pits on claim # 1133342
 - Took for assay re. Pt. and Cu.
 - Nice Cpy. and Po. in sample
- S.J. 02-08-90- #4
 - New shallow T. P.
 - N.E. corner of group of 9 claims
 - Took sample for assay
 - Nice Po. and Cpy.
- S.J. 02-08-90- #5
 - 50 ft. S.W. of sample # 4
 - Old pit - group of 9 claims
 - Took sample for assay
 - Nice Po. and Cpy.

Aug 3/90

- Spent day cutting road to Cobb Bay showing

Aug. 5/90

Went back to Pike Lake to follow up on samples taken July 2/90

Sept. 12/90

- Worked on rock from hilltop - roasting and panning
- Very coarse gold

Sept. 26/90

- Prospected Nabish Lake road, because of Gabbro found earlier
- S.J. 26-09-90 #1
 - Just across Nabish Cr. and N. off road
 - Gabbro - nice Cpy.-minor Po.
- S.J. 26-09-90- #2
 - 500 ft. N.W. of # 1 on next outcrop
 - Por. - large blobs of Py.

Sept. 27/90

- Prospected between Contact and Larson Bays of Wabigoon Lake because the old Indian (American Jack) had his campsite located there
- S.J. 27-09-90- #1
 - Shear zone
 - Felsite dike
 - Py
 - Zone 20 - 30 ft w. - 200 ft. l. open both ends
- S.J. 27-09-90- #2
 - Same as # 1
 - E. along zone 150 ft.
- S.J. 27-09-90- #3
 - Just inside N. claim of Contact Bay group of claims optioned to Leonard Rosenberg
 - Along shore
 - etc. vein 3 ft. w. - sparse Py.

Sept. 1990

Oct. 2/90

- On way to Cobb Bay
- Had truck trouble 30 mi. N. of Ignace.
- Towed to Ignace
- Had timing kit installed

Oct 3/90

- Worked on Cobb Bay showings
- Blasted trenches in Mafics in an effort to pick up the mineralized contact
- Eastern most trench picked it up - altered - greyish - mineralized contact with Por.
- Centre trench did not

Oct. 7 to 12/90

- Worked on Cobb Bay showings
- Particularly blasting the Por. ledge on shore across Bay from trench # 1
- Found very nicely mineralized (Py.) Por. with Qtz. - Tourmaline stringers throughout
- Gold seems to be concentrated in and around Tourmaline although we did find V.G. in the Por. itself
- Brought Glen Sciern from the Sioux Lookout office to see property

- S.J. 08-10-90- #1
- Por. on shore
- Tourmaline - Qtz. stringers
- S.W. end of exposure
- Bans nice gold

- S.J. 08-10-90- #2
- Same as # 1
- 40 ft. N.E.

- S.J. 08-10-90- #3
- Same as # 1
- 50 ft. N.E.

Oct. 15/90

-Cobb Bay

- Started bringing out equipment
- Found heavily carbonitized Mafics in contact with Por. beside trail
- Panned a grab sample and found minor gold

Oct. 18/90

-Went back to Cobb Bay and stripped and blasted where we had found contact on trail - significant because it is between trench # 1 and # 2

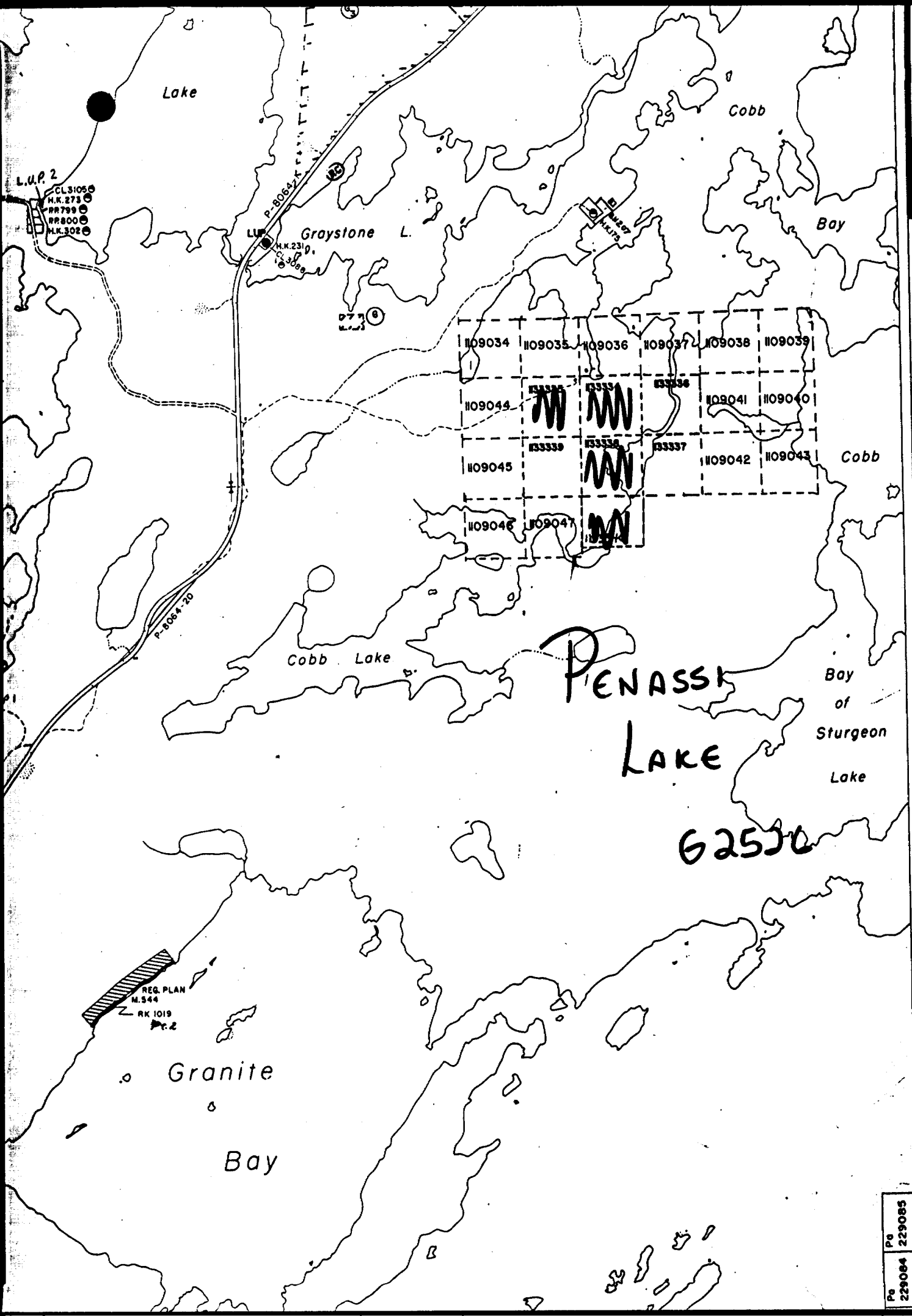

59'

58'

57'

56'

55'

Pg 229084
Pg 229085



Ontario

Ministry of
Northern Development
and Mines

Ministère du
Développement du Nord
et des Mines.

P. O. Box 3000
Sioux Lookout, Ontario
POV 2T0

1990.11.01

Mr. Sherridan Johnson
P. O. Box 81
Wabigoon, Ontario
POV 2W0

Dear Sherridan,

Subject: Assay Results from J.R.J. Cobb Bay Showings

Here are the assay results from the samples I took while examining your Cobb Bay property on October 11. In the first trench we examined, gold mineralization is apparently associated only with the altered rock containing quartz stringer mineralization. The samples of carbonated rock from the north and south sides of the trench yielded only low gold values. The two samples taken from the second trench also only gave low gold values. The best assay, a value of 0.377 oz Au/ton, was from a grab sample taken from the carbonatized mafic volcanic with quartz stringers in the old trench where we had lunch. With respect to the shoreline porphyry showings and those between the shoreline and Cobb Lake, assay values are generally low. The highest value from the shoreline outcrop was 0.028 oz. Au/ton and from the hilltop we had one sample return 0.067 oz/Au/ton.

My suggestion to you at this time, is that your efforts should concentrate on trying to extend the mineralization in the first trench and further prospecting and trenching around the old trench where we had lunch. I would also be interested in knowing if your samples that you had assayed from the shoreline outcrop returned significantly higher values than those which we got.

Cordially,

Ministère du
Développement du Nord

Ministry of
Northern Development
and Mines

Temiskaming
Testing
Laboratories

P.O. Box 799
Presley St.
Cobalt, Ontario
POJ 1C0
(705) 679-8313

Report Number
CB 11558

Laboratory Report

Date Oct. 25, 1990

Issued To: Glenn Seim, Resident Geologist Office, MNDM, P.O. Box 3000, Sioux Lookout, Ont. POW 2T0

Sample Number	Gold Oz. Per Ton	Silver Oz. Per Ton	
#GWS-90-140	0.127		
-141	42 PPB		
-142	177		
-143	0.147		
-144	0.009		
-145	63 PPB		
-146	0.377		
-147	57 PPB		
-148	0.022		
-149	0.028		
-150	417 PPB		
-151	0.067		
-152	363 PPB		

Charged Cost Code 9551-6455-12

L. Owsicki
L. Owsicki
Manager

Report of Work Conducted After Recording Claim

Transaction Number
W9130-5009

63.5771

Assess LIBRARY

Mining Act

Personal information collected on this form is obtained under the authority of the Minister. This collection should be directed to the Provincial Manager, Mining Lands, Ministry of Northern Development and Mines, Sudbury, Ontario, P3E 6A5, telephone (705) 670-7264.



900

- Instructions:**
- Please type or print and submit in duplicate.
 - Refer to the Mining Act and Regulations for requirements of the Recorder.
 - A separate copy of this form must be completed for each Work Group.
 - Technical reports and maps must accompany this form in duplicate.
 - A sketch, showing the claims the work is assigned to, must accompany this form.

Recorded Holder(s) SHERRIDON JOHNSON		Client No. 149509 LIC. NO. 53513
Address BOX 20, GROUP 24, RR2, DRYDEN ONT. P8N 2Y5		Telephone No. 807-937-5769
Mining Division PATRICIA	Township/Area PENASSI	M of M Plan No. 2526
Dates Work Performed From: MAY 26+27 - AUG. 3,4+5, - OCT. 1,2+3, OCT 7+12+15+16 / 90 To:		

Work Performed (Check One Work Group Only)

Work Group	Type
<input type="checkbox"/> Geotechnical Survey	
<input checked="" type="checkbox"/> Physical Work, Including Drilling	PROSPECTING + BEDROCK TRENCHING
<input type="checkbox"/> Rehabilitation	
<input type="checkbox"/> Other Authorized Work	
<input type="checkbox"/> Assays	
<input type="checkbox"/> Assignment from Reserve	

Total Assessment Work Claimed on the Attached Statement of Costs \$ **9860.00**

Note: The Minister may reject for assessment work credit all or part of the assessment work submitted if the recorded holder cannot verify expenditures claimed in the statement of costs within 30 days of a request for verification.

Persons and Survey Company Who Performed the Work (Give Name and Address of Author of Report)

Name	Address
SHERRIDON JOHNSON	DRYDEN
STAN JOHNSON	DRYDEN
BILL READ	SIOUX LOOKOUT
CHARLES GIROUD	DRYDEN

ONTARIO GEOLOGICAL SURVEY
GIS - ASSESSMENT FILES
OCT 24 1991
RECEIVED

(attach a schedule if necessary)

Certification of Beneficial Interest * See Note No. 1 on reverse side

I certify that at the time the work was performed, the claims covered in this work report were recorded in the current holder's name or held under a beneficial interest by the current recorded holder.	Date	Recorded Holder or Agent (Signature)
--	------	--------------------------------------

Certification of Work Report

I certify that I have a personal knowledge of the facts set forth in this Work report, having performed the work or witnessed same during and/or after its completion and annexed report is true.

Name and Address of Person Certifying
SHERRIDON JOHNSON, BOX 20, GROUP 24, RR2, DRYDEN ONT P8N 2Y5

Telephone No. 807-937-5769	Date OCT 4/91	Certified By (Signature) <i>Sheridan Johnson</i>
--------------------------------------	-------------------------	---

For Office Use Only

Total Value Cr. Recorded # 9860.00	Date Recorded OCTOBER 4/91	Mining Recorder <i>R. Mychals</i>	Received Stamp RECORDED OCT - 4 1991 Receipt <i>AK</i>
	Deemed Approval Date JANUARY 4/91	Date Approved <i>[Signature]</i>	
	Date Notice for Amendments Sent		



Ministry of
Northern Development
and Mines

Ministère du
Développement du Nord
et des mines

**Statement of Costs
for Assessment Credit**

**État des coûts aux fins
du crédit d'évaluation**

Mining Act/Loi sur les mines

Transaction No./N° de transaction
W9130-5009

Personal information collected on this form is obtained under the authority of the Mining Act. This information will be used to maintain a record and ongoing status of the mining claim(s). Questions about this collection should be directed to the Provincial Manager, Minings Lands, Ministry of Northern Development and Mines, 4th Floor, 159 Cedar Street, Sudbury, Ontario P3E 6A5, telephone (705) 670-7264.

Les renseignements personnels contenus dans la présente formule sont recueillis en vertu de la Loi sur les mines et serviront à tenir à jour un registre des concessions minières. Adresser toute question sur la collecte de ces renseignements au chef provincial des terrains miniers, ministère du Développement du Nord et des Mines, 159, rue Cedar, 4^e étage, Sudbury (Ontario) P3E 6A5, téléphone (705) 670-7264.

1. Direct Costs/Coûts directs

Type	Description	Amount Montant	Totals Total global
Wages Salaires	Labour Main-d'oeuvre	16x220(4)	3520.00
		16x150	2400.00
	Field Supervision Supervision sur le terrain	16x150	2400.00
Contractor's and Consultant's Fees Droits de l'entrepreneur et de l'expert- conseil	Type		
Supplies Used Fournitures utilisées	Type FEUL	627.00	
	MAINTENANCE	401.00	
			1028.00
Equipment Rental Location de matériel	Type BOAT	16.00	
	COBRA 4x25.00	100.00	
			116.00
Total Direct Costs Total des coûts directs			9465.00

2. Indirect Costs/Coûts indirects

** Note: When claiming Rehabilitation work indirect costs are not allowable as assessment work.
Pour le remboursement des travaux de réhabilitation, les coûts indirects ne sont pas admissibles en tant que travaux d'évaluation.

Type	Description	Amount Montant	Totals Total global
Transportation Transport	Type		
Food and Lodging Nourriture et hébergement		396.00	396.00
Mobilization and Demobilization Mobilisation et démobilisation			
Sub Total of Indirect Costs Total partiel des coûts indirects			396.00
Amount Allowable (not greater than 20% of Direct Costs) Montant admissible (n'excédant pas 20 % des coûts directs)			396.00
Total Value of Assessment Credit (Total of Direct and Allowable indirect costs)			9861.00
Valeur totale du crédit d'évaluation (Total des coûts directs et indirects admissibles)			9861.00

Note: The recorded holder will be required to verify expenditures claimed in this statement of costs within 30 days of a request for verification. If verification is not made, the Minister may reject for assessment work all or part of the assessment work submitted.

Note : Le titulaire enregistré sera tenu de vérifier les dépenses demandées dans le présent état des coûts dans les 30 jours suivant une demande à cet effet. Si la vérification n'est pas effectuée, le ministre peut rejeter tout ou une partie des travaux d'évaluation présentés.

Filing Discounts

- Work filed within two years of completion is claimed at 100% of the above Total Value of Assessment Credit.
- Work filed three, four or five years after completion is claimed at 50% of the above Total Value of Assessment Credit. See calculations below:

Total Value of Assessment Credit	Total Assessment Claimed
	x 0.50 =

Remises pour dépôt

- Les travaux déposés dans les deux ans suivant leur achèvement sont remboursés à 100 % de la valeur totale susmentionnée du crédit d'évaluation.
- Les travaux déposés trois, quatre ou cinq ans après leur achèvement sont remboursés à 50 % de la valeur totale du crédit d'évaluation susmentionné. Voir les calculs ci-dessous.

Valeur totale du crédit d'évaluation	Evaluation totale demandée
	x 0,50 =

Certification Verifying Statement of Costs

I hereby certify:
that the amounts shown are as accurate as possible and these costs were incurred while conducting assessment work on the lands shown on the accompanying Report of Work Form.

that as RECORDED HOLDER I am authorized
(Recorded Holder, Agent, Position in Company)

to make this certification

Attestation de l'état des coûts

J'atteste par la présente :
que les montants indiqués sont le plus exact possible et que ces dépenses ont été engagées pour effectuer les travaux d'évaluation sur les terrains indiqués dans la formule de rapport de travail ci-joint.

Et qu'à titre de _____ je suis autorisé
(titulaire enregistré, représentant, poste occupé dans la compagnie)

à faire cette attestation.

Signature _____ Date OCT 4/91