



52G14NE0043 52G14NE0014 PENASSI LAKE

010

### Diamond Drilling

Area OF PENASSI LAKE

Report N<sup>o</sup> 19

Work performed by: Chimo Gold Mines Ltd.

Claim N <sup>o</sup>	Hole N <sup>o</sup>	Footage	Date	Note	
Pa. 229099	#70-1	557'	Feb/70	(1)	
	#70-2	557'	Feb/70		
	#70-5	550.2'	March/70		
	#70-6	546.3	March/70		
	#70-7	350'	March/70		
	#70-8	417'	April/70		
	<hr/>		<hr/>		
	<hr/>		<hr/>		

Total:- 6 DH 2977.5'

Notes: (1) 155/71

Hole Number	Location Claim No.	Dist. to nearest Post		Azimuth Degrees	Dip		Depth Feet	Date Started	Date Completed
		Latitude	Departure		Collar	Bottom			
70-1	PA-229532 ✓	600' North	610' East	180°	-60°	-48°	557' ✓	Feb. 8, 1970	Feb. 14, 1970
70-2	PA-229531 ✓	900' North	425' East	180°	-60°	-51°	587' ✓	Feb. 16, 1970	Feb. 18, 1970
70-3	PA-229254 ✓	2070' North	375' West	180°	-70°	-48°	429' ✓	March 10, 1970	March 14, 1970
70-4	PA-229254 ✓	2195' North	482' West	0	-63°	-53°	370' ✓	March 15, 1970	March 17, 1970
70-5	PA-205502 ✓	995' South	500' East	180°	-60°	-34°	550' ✓	March 20, 1970	March 23, 1970
70-6	PA-205497 ✓	1170' South	430' West	180°	-60°	-26°	546' ✓	March 24, 1970	March 26, 1970
70-7	PA-205497	328' South	900' West	180°	-60°	-33°	350' ✓	March 28, 1970	March 31, 1970
70-8	PA-210943 ✓	305' North	710' West	180°	-60°	-41°	417' ✓	April 2, 1970	April 7, 1970
70-9-KT	PA-245541 ✓	465' North	350' East	225°	-45°	-24°	773'	May 25, 1970	June 3, 1970
70-10-KT	PA-245542 ✓	465' North	17' West	225°	-60°	-56°	732' ✓	June 8, 1970	June 17, 1970
70-11-KT	PA-245542 ✓	465' North	432' West	225°	-60°	-52°	643' ✓	June 25, 1970	July 2, 1970
70-12-KT	PA-245542 ✓	465' North	957' West	189°	-50°	-46°	402'	July 5, 1970	July 10, 1970
70-13-KT	PA-224320 ✓	200' North	445' West	180°	-50°	-39°	439'	July 17, 1970	July 20, 1970
70-14-KT	PA-243561 ✓	220' South	410' East	180°	-50°	-27°	487'	July 31, 1970	Aug. 4, 1970
Total							7212'		

PATRICIA  
RECORDS  
APR 30 1971  
RE 7180

CHIMO GOLD MINES LIMITED

TABULATED DRILL HOLE DATA

W.G. WAHL LTD.

WGL

JANUARY 1971

# DIAMOND DRILL RECORD

PROPERTY CHIMO GOLD MINES LIMITED

STURGEON LAKE

HOLE NO. 70 - 1

SHEET NUMBER 1

SECTION FROM \_\_\_\_\_ TO \_\_\_\_\_

STARTED February 8, 1970

LATITUDE 45 + 50 N

DATUM \_\_\_\_\_

COMPLETED February 14, 1970

DEPARTURE 8 + 00 E

BEARING 180°

ULTIMATE DEPTH 557'

ELEVATION \_\_\_\_\_

DIP 0° - 60° 500' - 48°

PROPOSED DEPTH \_\_\_\_\_

DEPTH FEET	FORMATION	SAMPLE NO. Footage	WIDTH OF SAMPLE	GOLD g	BLUDES GOLD g
0 - 4	Overburden				
4 - 97.5	Andesite - even medium grain - fine mottling in places.	12 42			
	Small blebs pyrite and chalcopyrite.	62 89			
97.5 - 112	Andesite - fine grained, vein and seams of light grey quartz feldspar. 100' - fine pyrrhotite splashes.				
112 - 126.7	Porphyry - grey feldspar rounded phenocrysts. Small apophyses into andesite at upper contact - Lower contact sharp but no chill. Few small blebs of pyrrhotite and chalcopyrite.	114			
126.7 - 129.5	Rhyolitic tuff - 35° - irregular to good banding - sparse grains pyrite, pyrrhotite, chalcopyrite.	128			
129.5 - 179.2	Andesite - fine grain - some flow banding near top - Few seams and small aggregates of pyrrhotite.	167			
179.2 - 182	Rhyolitic tuff - Pink crystal tuff - Faint banding at 40°	197 217			
	Few grains pyrite.	237 257			
182 - 327.5	Andesite - mottled in upper part, fine below with small amygdules in bands - some flow banding or pillow margins carries fine pyrrhotite.	275			
		294 308			
327.5 - 338.5	Andesitic tuff - well banded greys, light green 50°.	330			
	Sparse pyrrhotite on some bands.				
338.5 - 557	Andesite - massive, mottled, few light grey seams	348 371			

**PATRICIA**  
 MINING DIV.  
 E. G. E. B. W. F.  
 APR 30 1970  
 12:15  
 A



# DIAMOND DRILL RECORD

PROPERTY CHIMO GOLD MINES LIMITED STURGEON LAKE HOLE NO. 70 - 2

SHEET NUMBER 1 SECTION FROM \_\_\_\_\_ TO \_\_\_\_\_ STARTED February 16, 1970  
 LATITUDE 43 + 72 N DATUM \_\_\_\_\_ COMPLETED February 18, 1970  
 DEPARTURE 8 + 00 W BEARING 180° ULTIMATE DEPTH 557'  
 ELEVATION \_\_\_\_\_ DIP 0° - 60° 500' - 51°31' PROPOSED DEPTH \_\_\_\_\_

DEPTH FEET	FORMATION	SPECIMEN SAMPLE NO. FOOTAGE	WIDTH OF SAMPLE	GOLD g	SLURRY GOLD g
0 - 11	Casing				
11 - 39.6	Porphyry grey feldspar, massive - phenocrysts up to 1".	15			
39.6 - 76.5	Dacite - medium grained, massive, pepper-and-salt texture - Sharp contacts - Could be intrusive.	40 64			
76.5 - 215.0	Porphyry grey feldspar - massive - few grains pyrite -	85 108			
	76 - 81 Greenstone inclusion Chalcopyrite	132 155			
	106 - 109 " "	177 200			
	Several narrow greenstone bands (inclusions?)	225			
215 - 221	Tuff? Sheared or banded at 40° - Silicified with feldspar grains - chloritic wisps.	218			
221 - 227	Porphyry, as above.				
227 - 236	Dacite - fine grained - quartz veins and seams	231			
236 - 426	Andesite - mainly medium to fine grain, massive - mottled in places.	255 280			
		306 331	355		
426 - 433.5	Rhyolite tuff - siliceous light grey, banded at 30°. Carbonate stringers and pyrite streaks	390 401	424		
		329			
433.5 - 481	Andesite - fine grained, massive	354 377			
481 - 496.5	Rhyolite - fine grained, grey, few quartz-carbonate stringers, sparse pyrite and pyrrhotite (5 samples)	487			
		507 527			
496.5 - 557	Andesite - fine grain, massive	555			
557	End of hole.				
	TOTAL	27			

PATRICK  
MINING DIV.  
E0EIV

APR 30 1970

AM 1970-04-12 12:15 P

M.M.P. TORONTO - STOCK FORM NO. 301 REV. 12/61

*N.S. Butler*

# DIAMOND DRILL RECORD

PROPERTY CHIMO GOLD MINES LIMITED STURGEON LAKE HOLE NO. 70 - 5

SHEET NUMBER 1 SECTION FROM \_\_\_\_\_ TO \_\_\_\_\_ STARTED March 20, 1970  
 LATITUDE 18 + 00 S DATUM \_\_\_\_\_ COMPLETED March 23, 1970  
 DEPARTURE 86 + 00 W BEARING 180° ULTIMATE DEPTH 550.2'  
 ELEVATION \_\_\_\_\_ DIP 0 - 60° 524° - 34° PROPOSED DEPTH \_\_\_\_\_

DEPTH FEET	FORMATION	Specimen SAMPLE NO. Footage	WIDTH OF SAMPLE	GOLD \$	SLUDGE GOLD \$
-	Casing				
97.5 - 195.5	Tuff - Rhyolite - Variable from speckled grey to pink, well banded 45° - Few shattered quartz - 1/2"	115 140 160			
195.5 - 216	Tuff - Interbanded rhyolite, andesite, graphitic, sericitic. Heavy bands of pyrite partially leached and drusy.	184 203			
216 - 300	Rhyolite tuff - Light grey, well banded 70° - Sericitic vuggy quartz along beds - carbonated bands.	224 268 291			
300 - 311	Rhyolite fragmental - Bands of pyrite up to 1".				
311 - 325.5	Graphitic tuff, fragmental, mud stone, abundant pyrite variably interbanded.	310			
325.5 - 334	Mineralized zone - Coarse and fine pyrite with streaks and aggregates of fine pyrite - Split -	330 355			
334 - 376	Tuff - intermediate - Some fragmental bands - 65°	375			
376 - 377	Mineralized zone - Irregular wisps of chalcopryite - 1/8" - bands of sphalerite.				
377 - 422.5	Rhyolite tuff - Silicified in places. Few wisps of chalcopryite - Sampled - sericitic	391 415			
422.5 - 430.5	Graphitic schist - Abundant pyrite, sparse chalcopryite some rusty - Sampled.	425			
430.5 - 486	Rhyolite tuff - sericitic - light grey - 75°. Grey	449 468			

PATRICK  
 MINING DIV.  
 APR 30 1971  
 HOSKING DIAMOND DRILLING CO. LTD.

N.M.P. TORONTO - STOCK FORM NO. 901 REV. 12/61



# DIAMOND DRILL RECORD

PROPERTY CHINO GOLD MINES LIMITED STURGEON LAKE HOLE NO. 70 - 6

SHEET NUMBER 1 SECTION FROM \_\_\_\_\_ TO \_\_\_\_\_ STARTED March 24, 1970  
 LATITUDE 17 + 00 S DATUM \_\_\_\_\_ COMPLETED March 26, 1970  
 DEPARTURE 84 + 00 W BEARING \_\_\_\_\_ ULTIMATE DEPTH 546.3'  
 ELEVATION \_\_\_\_\_ DIP 0' - 60°, 455' - 31°, 546' - 26° PROPOSED DEPTH \_\_\_\_\_

DEPTH FEET	FORMATION	Specimen SAMPLE NO. FOOTAGE	WIDTH OF SAMPLE	GOLD g	SLURRY GOLD g
0 - 61	Casing.				
61 - 292.5	Rhyolite tuff - Grey to pink - well bedded - 40° - Sericitic - few vuggy quartz veins.	75 100	122		
	207 - 257 - Pink with shattered quartz eyes	221 235	265		
	257 - 60°				
292.5 - 294	Graphite schist - heavy coarse pyrite - 2' quartz vein with rusty pyrite.	293			
294 - 405	Rhyolite tuff - Uniform, well banded with good cross- bedding at 326'.	313 338			
	263 - 1.5' silicified with pyrite.	358			
	379 - 405 - Disseminated and seams of pyrite - 85°	380 398			
405 - 416	Graphitic schist - heavy pyrite - some siliceous bands.	413			
416 - 546	Rhyolite tuff - scattered pyrite seams	440 465			
	445 - Ghosts of fragments - 80°				
	475 - Fine disseminated pyrite, 1' - split	485 506			
	525 - 546 - Pink with quartz eyes, also tan	531 545			
	END TOTAL	22			

PATRICIA  
MINING DIV.  
**RECEIVED**  
APR 30 1970  
11:23 AM

*T. L. Burt*



# DIAMOND DRILL RECORD

PROPERTY CHINO GOLD MINES LIMITED STURGEON LAKE HOLE NO. 70 - 7

SHEET NUMBER \_\_\_\_\_ SECTION FROM \_\_\_\_\_ TO \_\_\_\_\_ STARTED March 28, 1970  
 LATITUDE 20 + 00 S DATUM \_\_\_\_\_ COMPLETED March 31, 1970  
 DEPARTURE 76 + 00 W BEARING 180° ULTIMATE DEPTH 350.0'  
 ELEVATION \_\_\_\_\_ DIP 0° - 60° 347' - 33° PROPOSED DEPTH \_\_\_\_\_

DEPTH FEET	FORMATION	Specimen No.	WIDTH OF SAMPLE	GOLD g	SILVER g		
0 - 52	Casing						
52 - 153	Rhyolite tuff - Sandy at top - grey - sericitic - well banded 50° - Few drusy quartz veins.	68 91 113 138					
153 - 170	Rhyolite tuff - silicified - fine pyrite in dissemination and bands - carbonated.						
170 - 209	Rhyolite tuff - Grey to tan 180 - 195 - Fractured quartz eyes.	163 188					
209 - 247	Rhyolite tuff - Abundant pyrite in bands up to 1/2", disseminated, and streaks, massive and split at 244.	210 235					
247 - 254	Graphitic schist - Abundant pyrite in streaks and concretions - some siliceous bands 75°.	254					
254 - 280.5	Rhyolite tuff - Grey - banded - Sparse pyrite. 275 - 1' heavy pyrite split.	279					
280.5 - 292	Graphite schist and rhyolite tuff interbanded. Heavy pyrite in both - streaks, bands, concretions.	285					
292 - 350	Rhyolite tuff 300 - 301 - Heavy pyrite - split 305.5 - 307 - " " 310.5 - 311 " "	305 325					
350	END	TOTAL	13				

F.A. RICHIA  
 MINE DIV.  
 E.W.E.V.I.  
 APR 30 1971  
 AM 11:10:12  
 PW

*mir*

# DIAMOND DRILL RECORD

PROPERTY CHINO GOLD MINES LIMITED STURGEON LAKE HOLE NO. 70 - 8

SHEET NUMBER 1 SECTION FROM \_\_\_\_\_ TO \_\_\_\_\_ STARTED April 2, 1970  
 LATITUDE 34 + 50 N DATUM \_\_\_\_\_ COMPLETED April 7, 1970  
 DEPARTURE 46 + 00 W BEARING 180° ULTIMATE DEPTH 417.0'  
 ELEVATION \_\_\_\_\_ DIP 0° - 60° 387' - 41° PROPOSED DEPTH \_\_\_\_\_

DEPTH FEET	FORMATION	Specimen SAMPLE NO. FCOTAGE	WIDTH OF SAMPLE	GOLD %	SLUDGE GOLD %		
0 - 73	Casing						
73 - 149	Andesite - Fairly coarse grained, irregular veins and streaks of quartz and feldspar - Few grains and veinlets of pyrite	93 117 140					
149 - 170	Andesite - Fine chlorite with marble-shaped masses of darker green - Sparse pyrite in places.	162					
170 - 241.5	Andesite - fine massive - dark green. 180' - Shearing along core - quartz-carbonate stringers.	181 206					
241.5 - 260	Andesite - breached mineralized - Sparse pyrite, pyrrhotite and chalcopyrite - split.	229 248 273 297					
260 - 312	Andesite - fine grained, streaked with quartz and sheared in places.	320					
312 - 362	Tuff andesite - poor banding 40° - much silicification along irregular mottlings - Sparse pyrite, pyrrhotite in places.	339					
362 - 398	Porphyry - Grey feldspar, massive, few greenstone inclusions.	364 387					
398 - 417	Interbanded feldspar porphyry and andesitic tuff - Irregular silicification and quartz stringers banding not distinct, 45°.	407					
	TOTAL	15					

**PATRICIA**  
MINING DIV.  
**DEFEW**  
**APR 30 1971**  
112.12.3

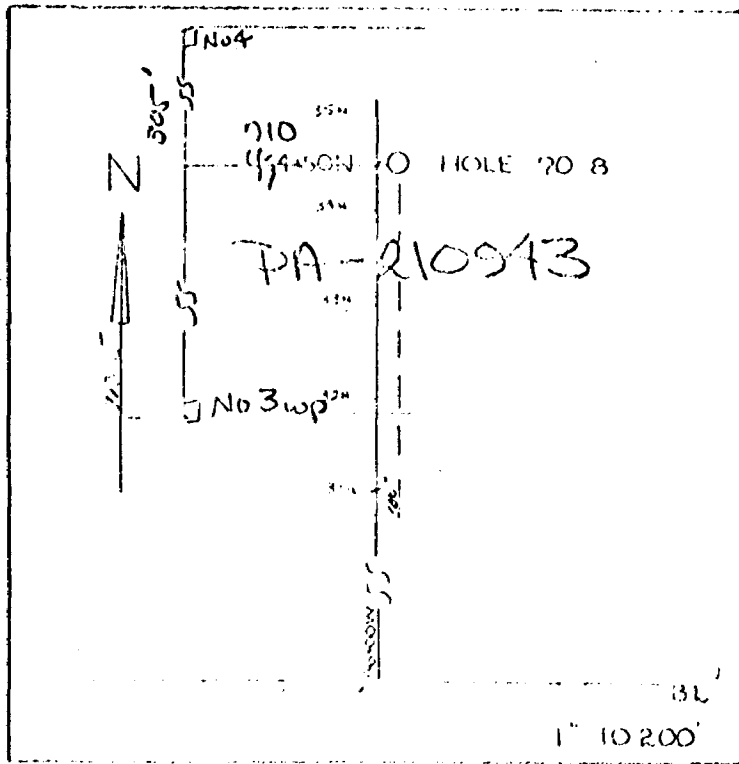

scale

200'

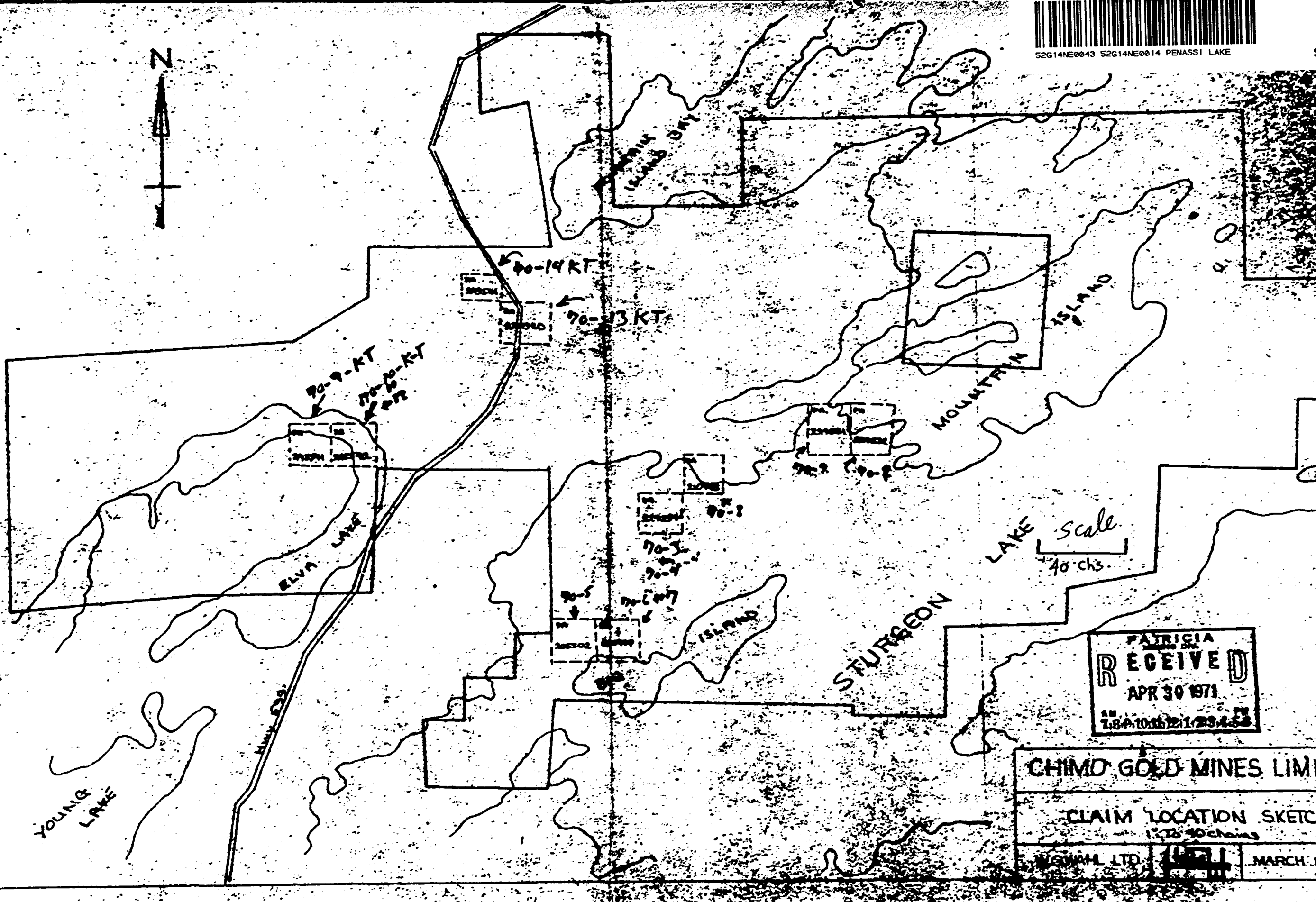

Scale  
40 chs.

PATRICIA  
RECEIVED  
APR 30 1971  
784-10th St 1-234-55

CHIMO GOLD MINES LIMITE

CLAIM LOCATION SKETCH  
1:10 40 chains

NGWAL LTD. MARCH 1971

#155/71

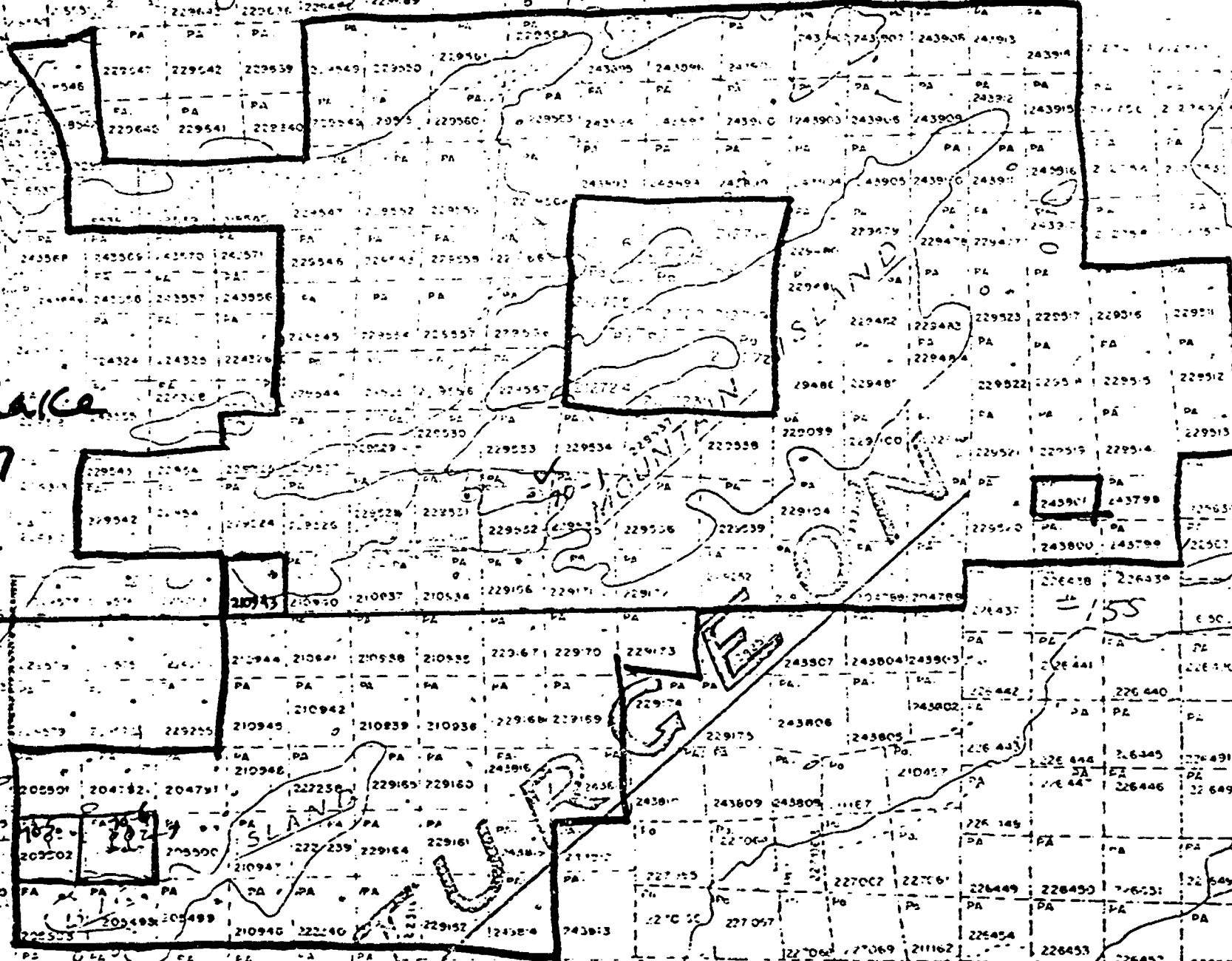

Penassi Lake  
 M-2257  
 52G/14NE

52G/14SE  
 M-2052  
 Valera LK

155

Scale  
 40 chains

K



Sturgeon  
Lake  
M-2266

A separate form is required for each type of work to be recorded.

#155

THE MINING ACT REPORT OF WORK

Patricia Mining Division

To the Recorder of..... Mining Division

Chimo Gold Mines Limited A 35533

name of Recorded Holder Minor's Licence

Suite 1000, 11 King Street West, Toronto 105, Ontario

Post Office Address

do hereby report the performance of 2977 days of diamond drilling type of work

not before reported to be applied on the following contiguous claims

Claim No.	Days	Claim No.	Days	Claim No.	Days
.....	.....	.....	.....	.....	.....
.....	SEE SCHEDULE ATTACHED	.....	.....	.....	.....
.....	.....	.....	.....	.....	.....
.....	.....	.....	.....	.....	.....
.....	.....	.....	.....	.....	.....
.....	.....	.....	.....	.....	.....

All the work was performed on Mining Claim (s) see below (In the case of geological and/or geophysical survey (s) where more than 18 claims are involved attach a schedule)

READ CAREFULLY: THE FOLLOWING INFORMATION IS REQUIRED BY THE MINING RECORDER.

- For Manual Work, Stripping or Opening up of Mines, Sinking Shafts or Other Actual Mining Operations - Names and addresses of the men who performed the work and the dates and hours of their employment.
- For Diamond and other Core Drilling - Footage, No. and angle of holes and diameter of core. Name and address of owner or operator of drill. Dates when drilling was done. Signed core log and sketch in duplicate.
- For Compressed Air or Other Power Driven or Mechanical Equipment - Type of drill or equipment. Names and addresses of men engaged in operating equipment and the dates and hours of their employment.
- For Power Stripping - Type of equipment. Name and address of owner or operator. Amount expended. Dates on which work was done. Proof of actual cost must be submitted within 30 days of recording.
- With each of the above types of work sketches are required to show the location and extent of the work in relation to the nearest claim post. In the case of diamond or other core drilling the sketch must be submitted in duplicate.
- For Geological and Geophysical Survey - The names and addresses of men employed as well as dates. Type of instrument used in the case of geophysical survey. Reports and maps in duplicate must be filed with the Minister within 60 days of recording.
- For Land Survey - the name and address of Ontario Land surveyor.

The Required Information is as Follows: (Attach a list if this space is insufficient)

Hole Number	Footage	Claim Number
70-1	557	229532
70-2	557	229532
70-5	550	205502
70-6	546	205497
70-7	350	205497
70-8	417	210943
	2,977	

CHIMO GOLD MINES LIMITED

[Signature]

Date April 28, 1971

The Mining Act Certificate Verifying Report of Work

A. C. Mosher Suite 1000, 11 King Street West, Toronto 105, Ontario (Post Office Address)

hereby certify:

- That I have a personal and intimate knowledge of the facts set forth in the report of work annexed hereto, having performed the work or witnessed same during and/or after its completion.
- That the unaxed report is true.

Dated April 28, 1971

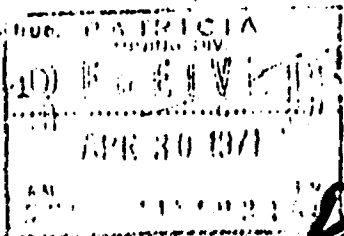

[Signature]

Pa. 229099

THE PENALTY FOR MAKING A FALSE STATEMENT IN THIS REPORT AND/OR CERTIFICATE IS \$500. OR SIX MONTHS IMPRISONMENT OR BOTH

K

MINING ACT REPORT OF WORK  
PATRICIA DIVISION

A separate form is required for each type of work to be recorded.

THE MINING ACT REPORT OF WORK  
Patricia Mining Division

To the Recorder of ..... Mining Division  
Chimo Gold Mines Limited A 35533

I, ..... name of Recorded Holder  
Suite 1000, 11 King Street West, Toronto 105, Ontario Miner's Licence

do hereby report the performance of ..... 114 ..... days of ..... Core samples  
Post Office Address type of work

not before reported to be applied on the following contiguous claims

Claim No.	Days	Claim No.	Days	Claim No.	Days
229532	10	205497	10		
229166	12	204792	10		
229531	10	205500	15		
210934	12	210943	15		
205502	10				
205503	10				

see below

All the work was performed on Mining Claim (s) .....  
(In the case of geological and/or geophysical survey (s) where more than 18 claims are involved attach a schedule)

READ CAREFULLY: THE FOLLOWING INFORMATION IS REQUIRED BY THE MINING RECORDER.

- For Manual Work, Stripping or Opening up of Mines, Sinking Shafts or Other Actual Mining Operations - Names and addresses of the men who performed the work and the dates and hours of their employment.
- For Diamond and other Core Drilling - Footage, No. and angle of holes and diameter of core. Name and address of owner or operator of drill. Dates when drilling was done. Signed core log and sketch in duplicate.
- For Compressed Air or Other Power Driven or Mechanical Equipment - Type of drill or equipment. Names and addresses of men engaged in operating equipment and the dates and hours of their employment.
- For Power Stripping - Type of equipment. Name and address of owner or operator. Amount expended. Dates on which work was done. Proof of actual cost must be submitted within 30 days of recording.
- With each of the above types of work sketches are required to show the location and extent of the work in relation to the nearest claim post. In the case of diamond or other core drilling the sketch must be submitted in duplicate.
- For Geological and Geophysical Survey - The names and addresses of men employed as well as dates. Type of instrument used in the case of geophysical survey. Reports and maps in duplicate must be filed with the Minister within 60 days of recording.
- For Land Survey - the name and address of Ontario Land surveyor.

The Required Information is as Follows: (Attach a list if this space is insufficient)

Hole Number	Number of Samples	Credit claimed	Mining Claim Number
70-1	25	22	229532
70-2	27	22	229531
70-5	20	20	205502
70-6	22	22	205497
70-7	13	13	205497
70-8	15	15	210943
		114	

CHIMO GOLD MINES LIMITED

Date ..... April 28, 1971

Signature of Recorded Holder or Agent

The Mining Act  
Certificate Verifying Report of Work

I, ..... A. C. Mosher .....  
Suite 1000, 11 King Street West, Toronto 105, Ontario.  
(Post Office Address)

hereby certify:

- That I have a personal and intimate knowledge of the facts set forth in the report of work annexed hereto, having performed the work or witnessed same during and/or after its completion.
- That the annexed report is true.

Dated ..... April 28, 1971

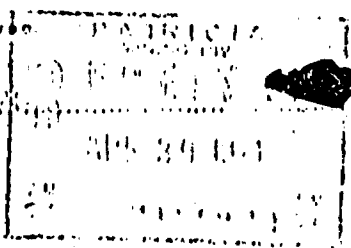

Pa. 210934

THE PENALTY FOR MAKING A FALSE STATEMENT IN THIS REPORT AND OR CERTIFICATE IS \$500. OR SIX MONTHS IMPRISONMENT OR BOTH

Core Samples Submitted for Assessment

Credit by Chimo Gold Mines Ltd.

Hole Number	Samples	Footages
70-1	1 A6000	12'
	2 A6001	42'
	3 A6002	62'
	4 A6003	89'
	5 A6004	114'
	6 A6005	128'
	7 A6006	167'
	8 A6007	197'
	9 A6008	217'
	10 A6009	237'
	11 A6010	257'
	12 A6011	275'
	13 A6012	294'
	14 A6013	308'
	15 A6014	330'
	16 A6015	348'
	17 A6016	354'
	18 A6017	371'
	19 A6018	377'
	20 A6019	388'
	21 A6020	419.5'
	22 A6021	422'
	23 A6022	447'
	24 A6023	471'
	25 A6024	495'
	26 A6025	542'
	27 A6026	556'



Core Samples Submitted for Assessment

Credit by Chimo Gold Mines Ltd.

Hole Number	Samples	Footages
70-1	1	12'
	2	42'
	3	62'
	4	89'
	5	114'
	6	128'
	7	167'
	8	197'
	9	217'
	10	237'
	11	257'
	12	275'
	13	294'
	14	308'
	15	330'
	16	348'
	17	354'
	18	371'
	19	377'
	20	388'
	21	419.5'
	22	422'
	23	447'
	24	471'
	25	495'
	26	542'
	27	556'

Hole Number	Samples	Footages
70-2	1 A6027	15'
	2 A6028	40'
	3 A6029	64'
	4 A6030	85'
	5 A6031	108'
	6 A6032	132'
	7 A6033	155'
	8 A6034	177'
	9 A6035	200'
	10 A6036	218'
	11 A6037	225'
	12 A6038	231'
	13 A6039	255'
	14 A6040	280'
	15 A6041	306'
	16 A6042	331'
	17 A6043	355'
	18 A6044	380'
	19 A6045	401'
	20 A6046	424'
	21 A6047	487'
	22 A6048	507'
	23 A6049	527'
	24 A6050	555'

Hole Number	Samples	Footages
70-2	1	15'
	2	40'
	3	64'
	4	85'
	5	108'
	6	132'
	7	155'
	8	177'
	9	200'
	10	218'
	11	225'
	12	231'
	13	255'
	14	280'
	15	306'
	16	331'
	17	355'
	18	380'
	19	401'
	20	424'
	21	487'
	22	507'
	23	527'
	24	555'
70-3	1	71'
	2	91'
	3	107'
	4	130'
	5	155'
	6	174'
	7	194'
	8	230'
	9	254'
	10	282'
	11	300'
	12	325'
	13	329'
	14	344'
	15	363'
	16	388'
	17	413'
	18	429'

Hole Number	Samples	Footagen
70-4	1	60'
	2	85'
	3	109'
	4	124'
	5	147'
	6	170'
	7	193'
	8	211'
	9	231'
	10	250'
	11	265'
	12	285'
	13	303'
	14	323'
	15	333'
	16	368'
70-5	1	115'
	2	141'
	3	160'
	4	184'
	5	203'
	6	224'
	7	268'
	8	291'
	9	294'
	10	310'
	11	330'
	12	355'
	13	375'
	14	391'
	15	415'
	16	425'
	17	449'
	18	468'
	19	520'
	20	544'

Hole Number	Sample	Footage
70-5	1	75'
	2	100'
<u>Hole Number</u>	3	122'
	4	145'
70 - 6	5	171'
	6	195'
	7	221'
	8	235'
	9	265'
	10	293'
	11	313'
	12	338'
	13	358'
	14	380'
	15	398'
	16	413'
	17	440'
	18	465'
	19	485'
	20	506'
	21	531'
	22	545'
		75'
		100'
		122'
		145'
		171'
		195'
		221'
		235'
		265'
		293'
		313'
		338'
		358'
		380'
		398'
		413'
		440'
		465'
		485'
		506'
		531'
		545'
70-7	1	68'
	2	91'
	3	113'
70 - 7	4	133'
	5	166'
	6	188'
	7	210'
	8	235'
	9	254'
	10	279'
	11	285'
	12	305'
	13	325'
	14	350'
		68'
		91'
		113'
		133'
		166'
		188'
		210'
		235'
		254'
		279'
		285'
		305'
		325'
		350'

Hole Number	Samples	Footages
70-8	1 1 A6141	93' 93'
	2 2 A6142	117' 117'
70 - 8	3 3 A6143	140' 140'
	4 4 A6144	162' 162'
	5 5 A6145	181' 181'
	6 6 A6146	206' 206'
	7 7 A6147	229' 229'
	8 8 A6148	248' 248'
	9 9 A6149	273' 273'
	10 10 A6150	297' 297'
	11 11 A6151	320' 320'
	12 12 A6152	339' 339'
	13 13 A6153	364' 364'
	14 14 A6154	387' 387'
	15 15 A6155	407' 407'

Hole Number	Samples	Footages
70-9 KT	1	53'
	2	76'
	3	92'
	4	112'
	5	135'
	6	142'
	7	154'
	8	177'
	9	193'
	10	196'
	11	222'
	12	242'
	13	262'
	14	288'
	15	313'
	16	342'
	17	366'
	18	388'
	19	406'
	20	429'
	21	450'
	22	471'
	23	486'
	24	509'
	25	519'
	26	543'
	27	563'
	28	577'
	29	602'
	30	623'
	31	642'
	32	667'
	33	689'
	34	708'
	35	732'
	36	756'
	37	773'

Hole Number	Samples	Footages
70-10 KT	1	93'
	2	115'
	3	140'
	4	166'
	5	182'
	6	207'
	7	219'
	8	238'
	9	262'
	10	287'
	11	310'
	12	333'
	13	357'
	14	378'
	15	402'
	16	421'
	17	445'
	18	460'
	19	483'
	20	508'
	21	526'
	22	537'
	23	543'
	24	568'
	25	590'
	26	613'
	27	636'
	28	657'
	29	677'
	30	701'
	31	727'



Hole Number	Samples	Footages
70-11 KT	1	141'
	2	165'
	3	188'
	4	206'
	5	234'
	6	256'
	7	278'
	8	303'
	9	328'
	10	348'
	11	372'
	12	393'
	13	413'
	14	430'
	15	455'
	16	475'
	17	499'
	18	524'
	19	538'
	20	587'
	21	617'
	22	639'
70-12 KT	1	102'
	2	125'
	3	143'
	4	158'
	5	170'
	6	191'
	7	216'
	8	234'
	9	258'
	10	281'
	11	297'
	12	316'
	13	324'
	14	335'
	15	358'
	16	375'
	17	402'

Hole Number	Samples	Footages
70-13 KT	1	34'
	2	58'
	3	83'
	4	96'
	5	121'
	6	146'
	7	167'
	8	187'
	9	212'
	10	220'
	11	239'
	12	253'
	13	275'
	14	300'
	15	324'
	16	348'
	17	372'
	18	382'
	19	398'
	20	418'
	21	437'
70-14 KT	1	28'
	2	53'
	3	82'
	4	106'
	5	136'
	6	162'
	7	160'
	8	204'
	9	228'
	10	252'
	11	275'
	12	300'
	13	321'
	14	336'
	15	357'
	16	377'
	17	400'
	18	416'
	19	426'
	20	451'
	21	472'
	22	487'

Total Samples received: 14 holes and 306 samples

China Gold Mines Limited

A location of Diamond Drilling Assessment  
 P. 229099

217546	20	229099	20	217549	20
217547	20	229100	20	217550	20
217548	20	229101	20	217551	20
217549	20	229102	20	217552	20
217550	20	229103	20	217553	20
217551	20	229104	20	217554	20
217552	20	229105	20	217555	20
217553	20	229106	20	217556	20
217554	20	229107	20	217557	20
217555	20	229108	20	217558	20
217556	20	229109	20	217559	20
217557	20	229110	20	217560	20
217558	20	229111	20	217561	20
217559	20	229112	20	217562	20
217560	20	229113	20	217563	20
217561	20	229114	20	217564	20
217562	20	229115	20	217565	20
217563	20	229116	20	217566	20
217564	20	229117	20	217567	20
217565	20	229118	20	217568	20
217566	20	229119	20	217569	20
217567	20	229120	20	217570	20
217568	20	229121	20	217571	20
217569	20	229122	20	217572	20
217570	20	229123	20	217573	20
217571	20	229124	20	217574	20
217572	20	229125	20	217575	20
217573	20	229126	20	217576	20
217574	20	229127	20	217577	20
217575	20	229128	20	217578	20
217576	20	229129	20	217579	20
217577	20	229130	20	217580	20
217578	20	229131	20	217581	20
217579	20	229132	20	217582	20
217580	20	229133	20	217583	20
217581	20	229134	20	217584	20
217582	20	229135	20	217585	20
217583	20	229136	20	217586	20
217584	20	229137	20	217587	20
217585	20	229138	20	217588	20
217586	20	229139	20	217589	20
217587	20	229140	20	217590	20
217588	20	229141	20	217591	20
217589	20	229142	20	217592	20
217590	20	229143	20	217593	20
217591	20	229144	20	217594	20
217592	20	229145	20	217595	20
217593	20	229146	20	217596	20
217594	20	229147	20	217597	20
217595	20	229148	20	217598	20
217596	20	229149	20	217599	20
217597	20	229150	20	217600	20



SEE ACCOMPANYING  
MAP(S) IDENTIFIED AS

52G114NE-0014 # 1-3

LOCATED IN THE MAP  
CHANNEL IN THE  
FOLLOWING SEQUENCE

(X)

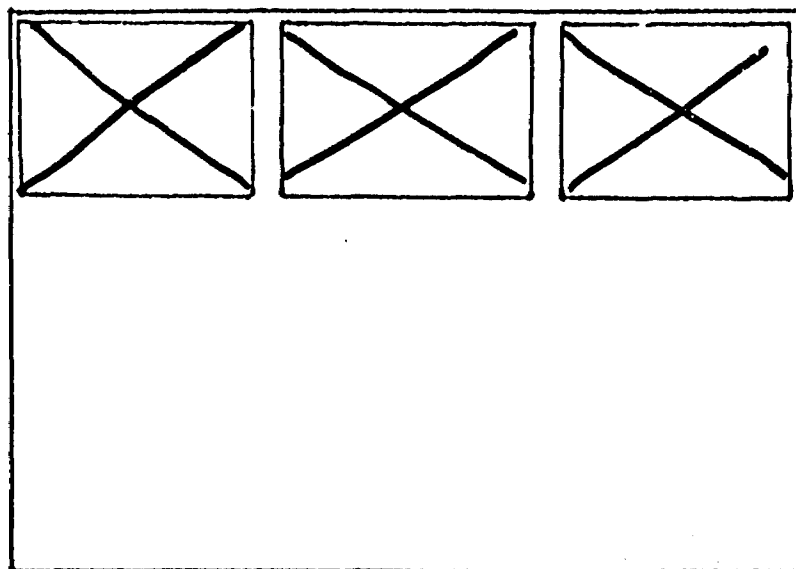

**FOR ADDITIONAL**

**INFORMATION**

**SEE MAPS:**

52G/14NE - 0014

# 4-6

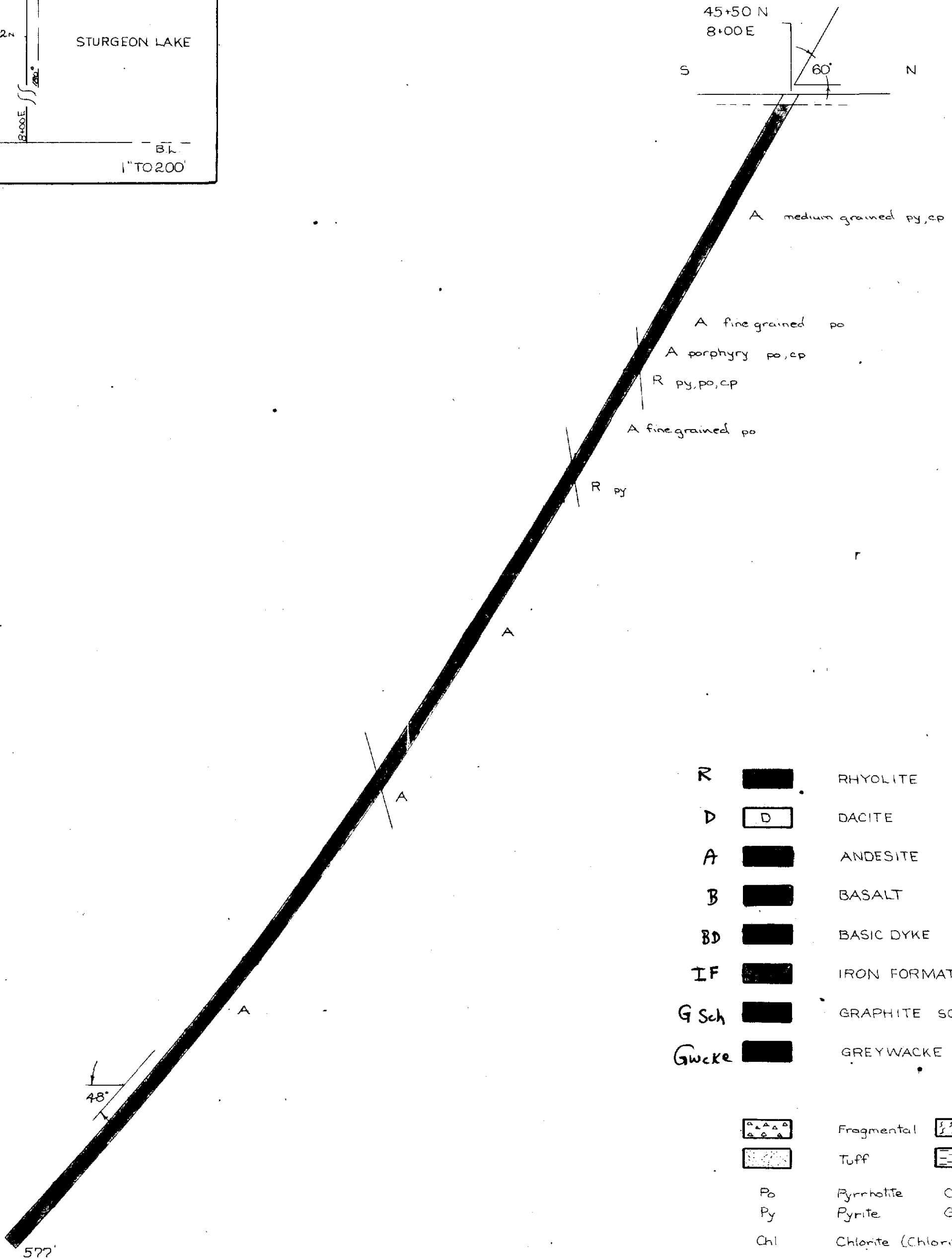
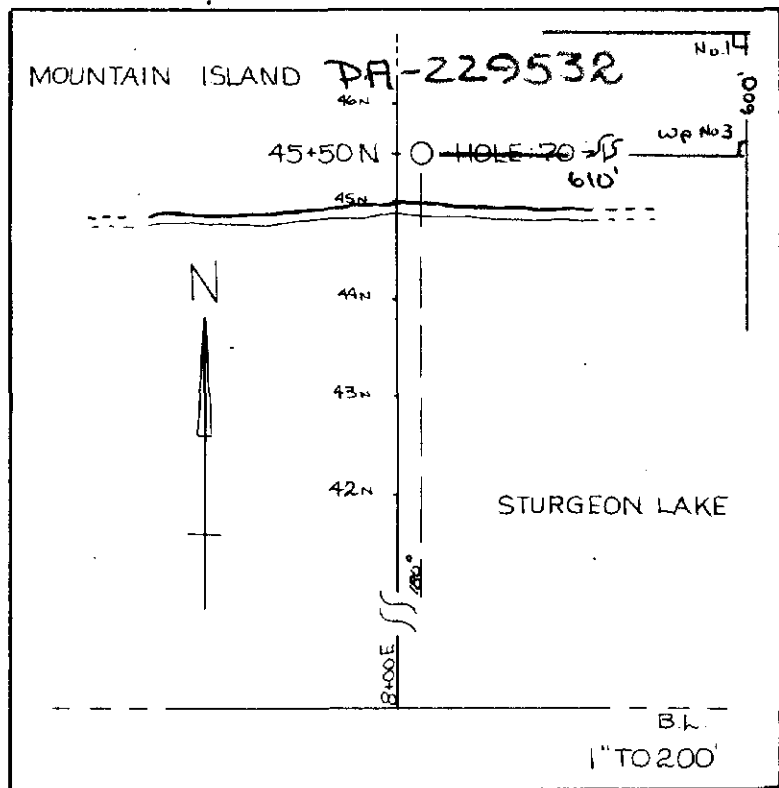

- R RHYOLITE
- D DACITE
- A ANDESITE
- B BASALT
- BD BASIC DYKE
- IF IRON FORMATION
- G Sch GRAPHITE SCHIST
- Gwcke GREYWACKE

- Fragmental Schists
- Tuff Meta-Sediments
- Po Pyrrhotite Cp Chalcopyrite
- Py Pyrite G Graphite
- Chl Chlorite (Chloritization)
- Ser Sericite (Sericitization)

PATRICIA  
 MINING DIV.  
**RECEIVED**  
 APR 30 1971  
 AM 718-101121-23:45B

52G/14 NE - 0014 #1



# 155/71

CHIMO GOLD MINES LIMITED

70-1  
 1 INCH TO 40 FEET

W.G. WAHL Ltd **WGH** NOVEMBER 1970

16/951 #

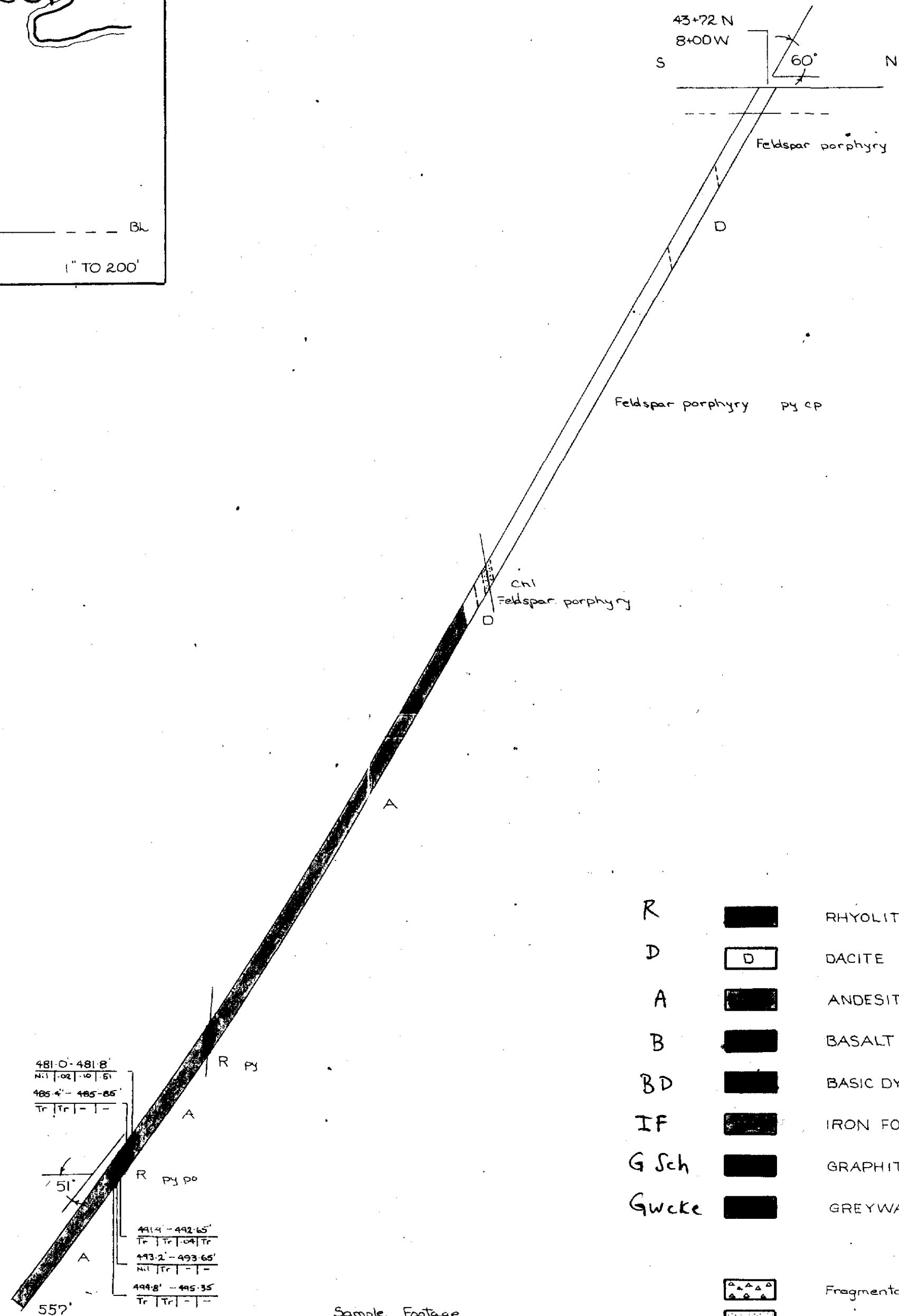
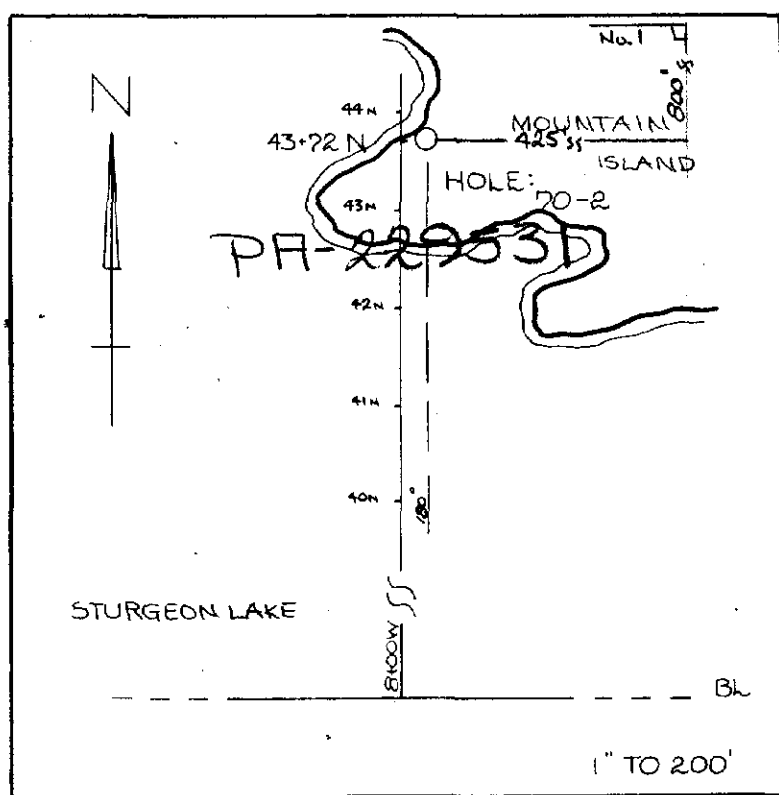

- R RHYOLITE
- D DACITE
- A ANDESITE
- B BASALT
- BD BASIC DYKE
- IF IRON FORMATION
- G Sch GRAPHITE SCHIST
- Gwacke GREYWACKE

- Fragmental Schists
- Tuff Meta-Sediments
- Po Pyrrhotite Cp Chalcopyrite
- Py Pyrite G Graphite
- Chl Chlorite (Chloritization)
- Ser Sericite (Sericitization)

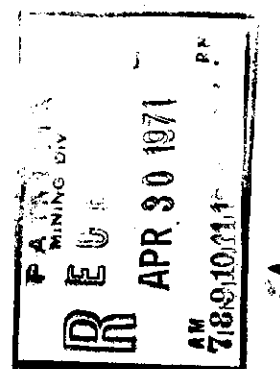

481.0 - 481.8	Nil	0.02	0.01	0.01
485.4 - 485.65	Tr	Tr	Tr	Tr
491.4 - 492.65	Tr	Tr	0.04	Tr
493.2 - 493.65	Nil	Tr	Tr	Tr
494.8 - 495.35	Tr	Tr	Tr	Tr

Sample Footage			
0% Ru	0% Pb	% Cu	% Zn

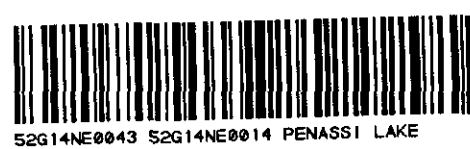

210

52G/14 NE-0014 #2



**CHIMO GOLD MINES LIMITED**

70-2

1 INCH TO 40 FEET

W.G. WAHL Ltd NOVEMBER 1970



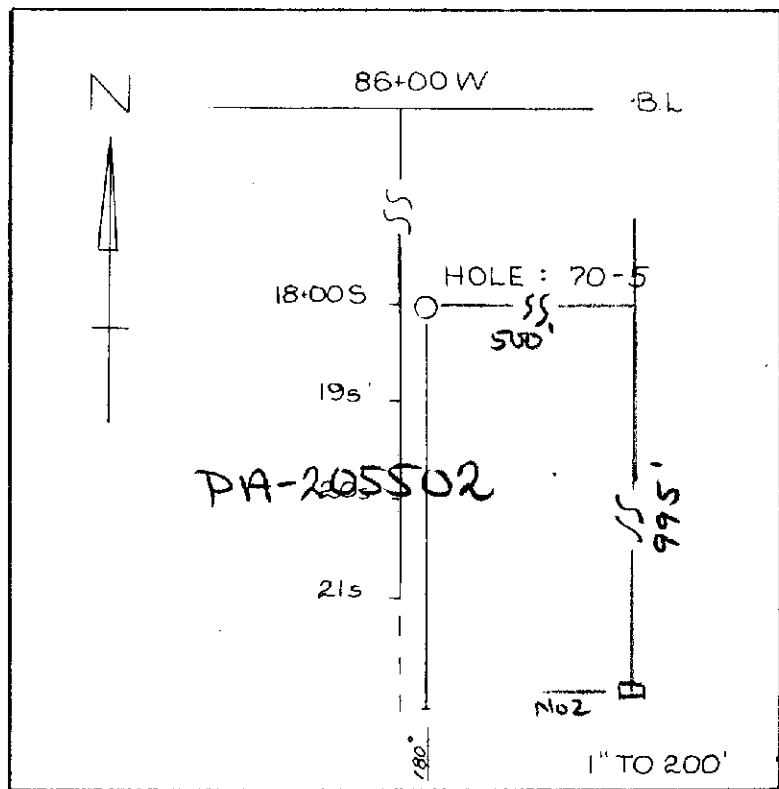

PA-205502

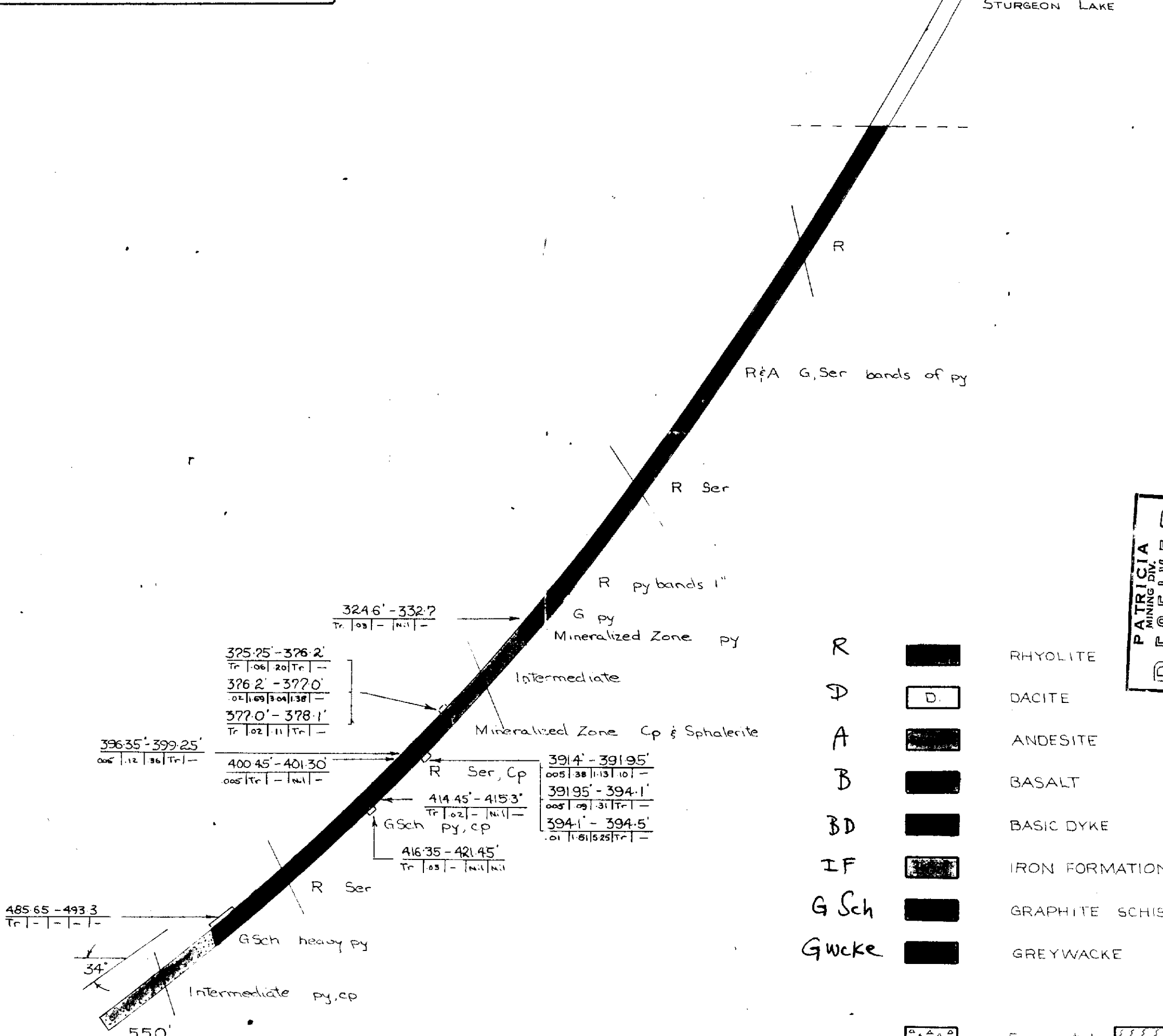
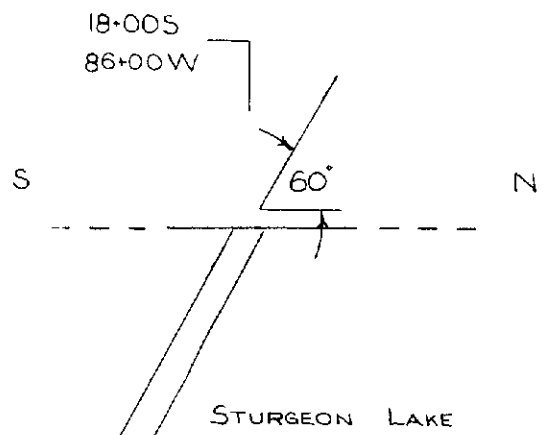

3246'-3327'  
Tr 103 - 111 -

325.25'-326.2'  
Tr 106 20 | Tr 1 -

326.2'-327.0'  
Tr 109 130 | 138 | -

327.0'-328.1'  
Tr 102 | 11 | Tr 1 -

396.35'-399.25'  
Tr 112 | 136 | Tr 1 -

400.45'-401.30'  
Tr 105 | Tr 1 -

391.4'-391.95'  
Tr 005 | 38 | 113 | 101 -

391.95'-394.1'  
Tr 102 | - | 111 | -

394.1'-394.5'  
Tr 101 | 61 | 62 | Tr 1 -

416.35'-421.45'  
Tr 103 | - | 111 | 111 -

485.65 - 493.3  
Tr 1 - 1 - 1 -

550'

- R RHYOLITE
- D DACITE
- A ANDESITE
- B BASALT
- BD BASIC DYKE
- IF IRON FORMATION
- G Sch GRAPHITE SCHIST
- Gwcke GREYWACKE

- Fragmental Schists
- Tuff Meta-Sediments
- Po Pyrrhotite Cp Chalcopyrite
- Py Pyrite G Graphite
- Chl Chlorite (Chloritization)
- Ser Sericite (Sericitization)

Sample Footage in feet  
Oz Au | Oz Ag | % Cu | % Zn | % Pb

PATRICIA  
MINING DIV.  
RECEIVED  
APR 30 1971  
AM 7:00 PM 12:12:45

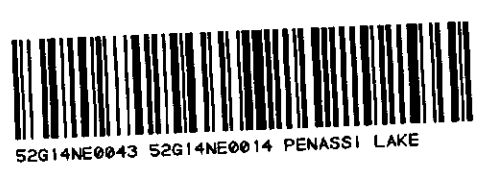

220

52G/14 NE-0014 #3  
# 155/71

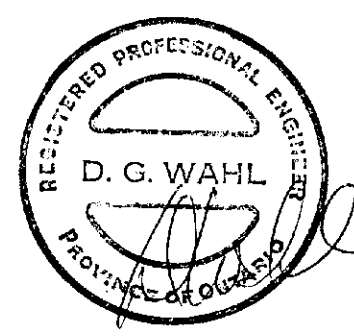

CHIMO GOLD MINES LIMITED

70-5  
1 INCH TO 40 FEET

W.G. WAHL Ltd NOVEMBER 1970

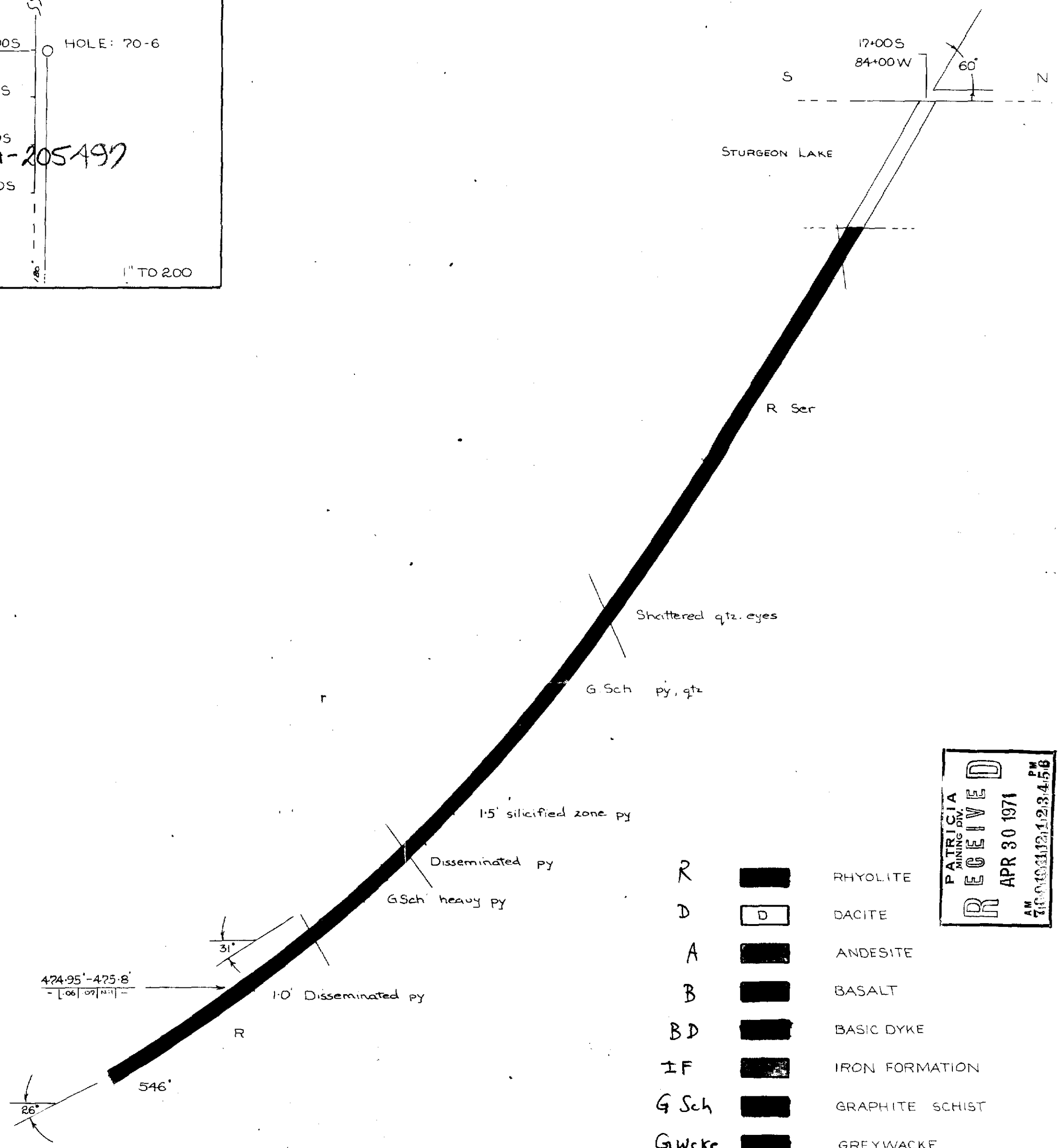
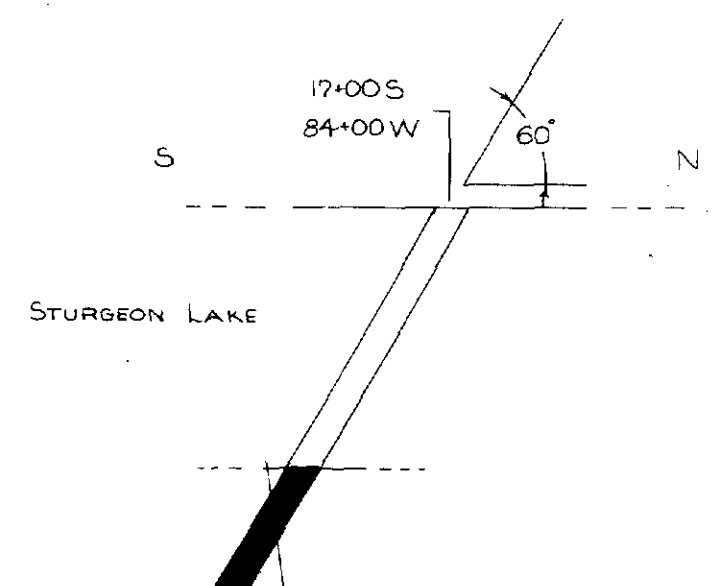
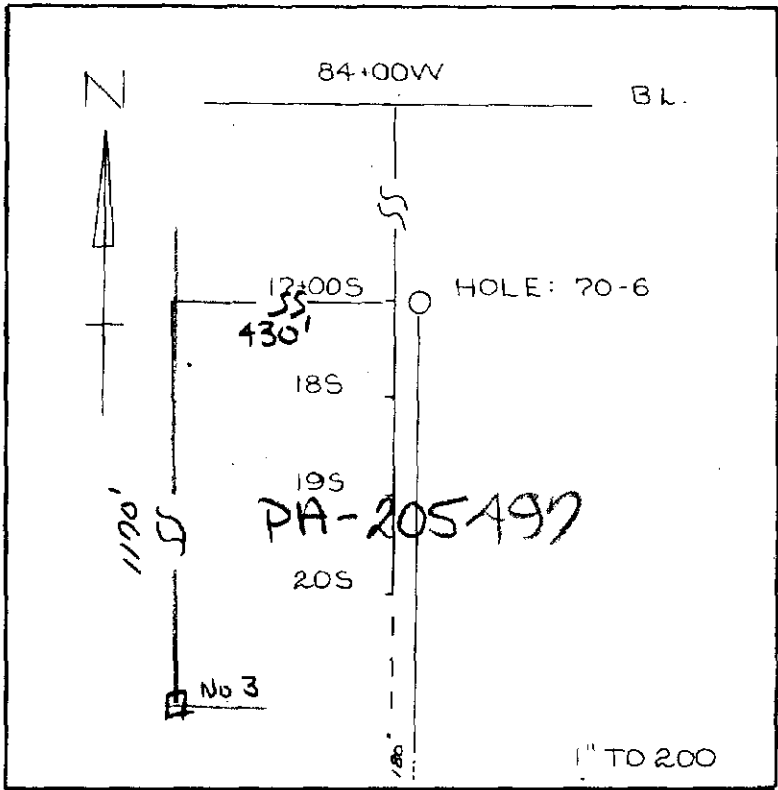

R		RHYOLITE
D		DACITE
A		ANDESITE
B		BASALT
BD		BASIC DYKE
IF		IRON FORMATION
G Sch		GRAPHITE SCHIST
Gwcke		GREYWACKE

	Fragmental		Schists
	Tuff		Meta-Sediments
Po	Pyrrhotite	Cp	Chalcopyrite
Py	Pyrite	G	Graphite
Chl	Chlorite (Chloritization)		
Ser	Sericite (Sericitization)		

Sample Footage in Feet  
 Oz Au | Oz Ag | % Cu | % Zn | % Pb

PATRICIA  
 MINING DIV  
 RECEIVED  
 APR 30 1971  
 AM 7:00 PM 12:34:58

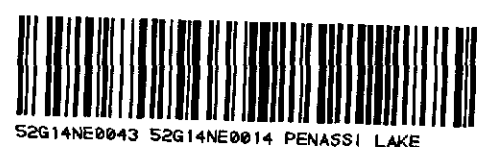

230

52G/14 NE - 0014 #4

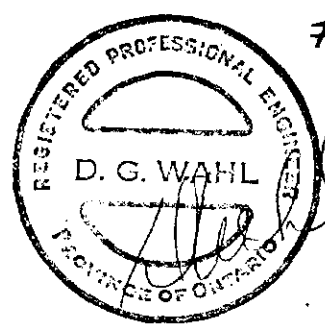

#155/11

CHIMO GOLD MINES LIMITED

70-6  
 1 INCH TO 40 FEET

W.G. WAHL Ltd NOVEMBER 1970

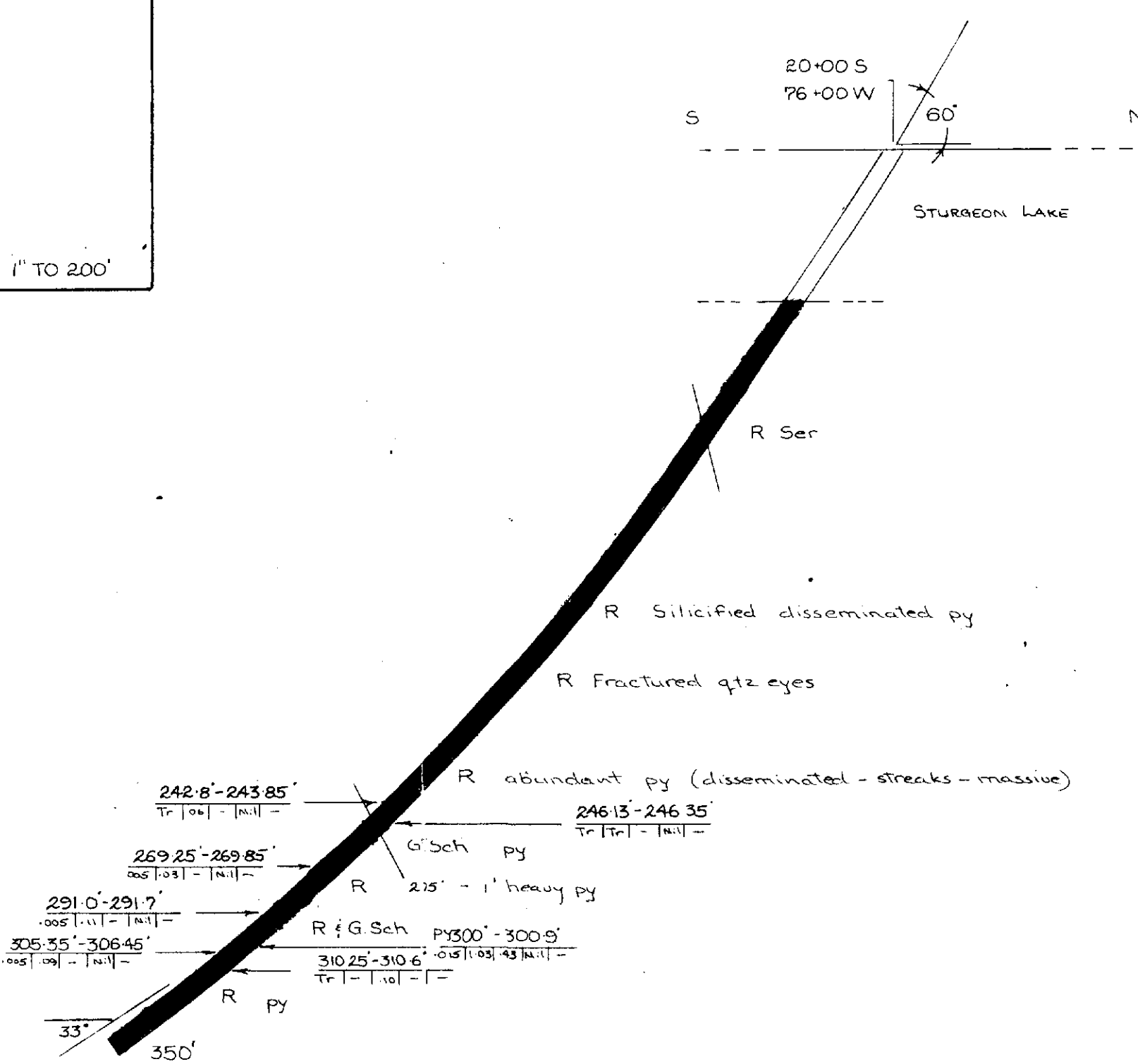
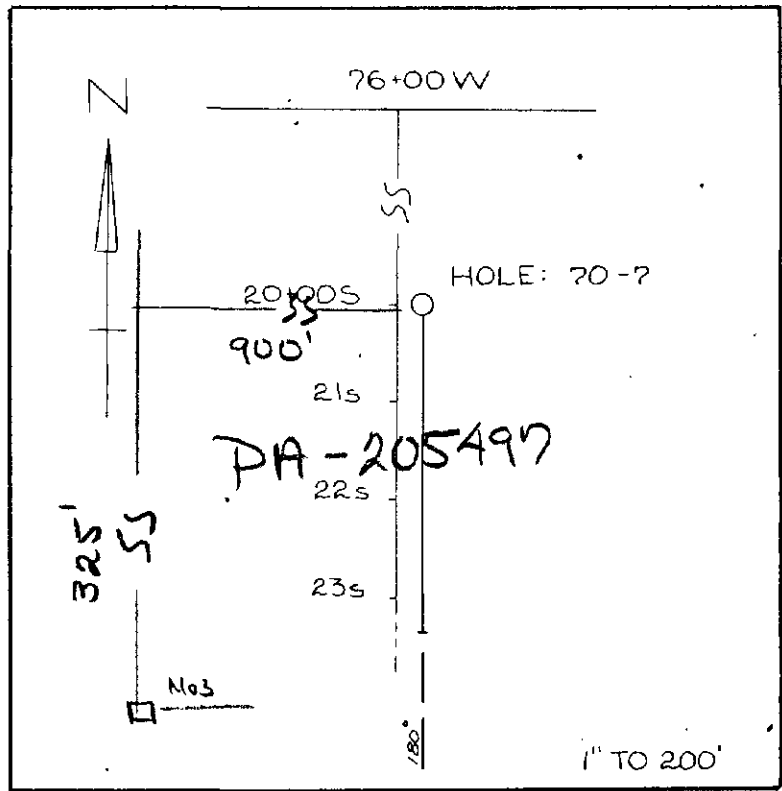

242.8' - 243.85' Tr | 0.6 | - | Nil | -  
 246.13' - 246.35' Tr | Tr | - | Nil | -  
 269.25' - 269.85' 0.05 | 0.03 | - | Nil | -  
 291.0' - 291.7' 0.05 | 0.01 | - | Nil | -  
 305.35' - 306.45' 0.05 | 0.09 | - | Nil | -  
 310.25' - 310.6' 0.05 | 0.03 | 0.03 | Nil | -  
 R abundant py (disseminated - streaks - massive)  
 G Sch py  
 R 2.5' - 1' heavy py  
 R & G Sch Py 300' - 300.5'  
 R py

- R RHYOLITE
- D DACITE
- A ANDESITE
- B BASALT
- BD BASIC DYKE
- IF IRON FORMATION
- G Sch GRAPHITE SCHIST
- Gwcke GREYWACKE

Sample Footage in Feet  
 Oz Au | Oz Ag | % Cu | % Zn | % Pb

- Fragmental Schists
- Tuff Meta-Sediments
- Po Pyrrhotite Cp Chalcopyrite
- Py Pyrite G Graphite
- Chl Chlorite (Chloritization)
- Ser Sericite (Sericitization)

PATRICIA  
 MINING DIV.  
 RECEIVED  
 APR 30 1971  
 AM 12:34:56 PM

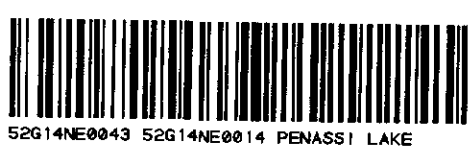

52G/14 NE - 0014 #5

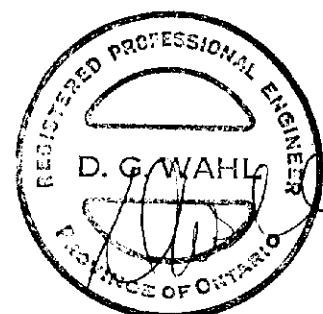

**CHIMO GOLD MINES LIMITED**  
 70-7  
 1 INCH TO 40 FEET  
 W.G. WAHL Ltd NOVEMBER 1970

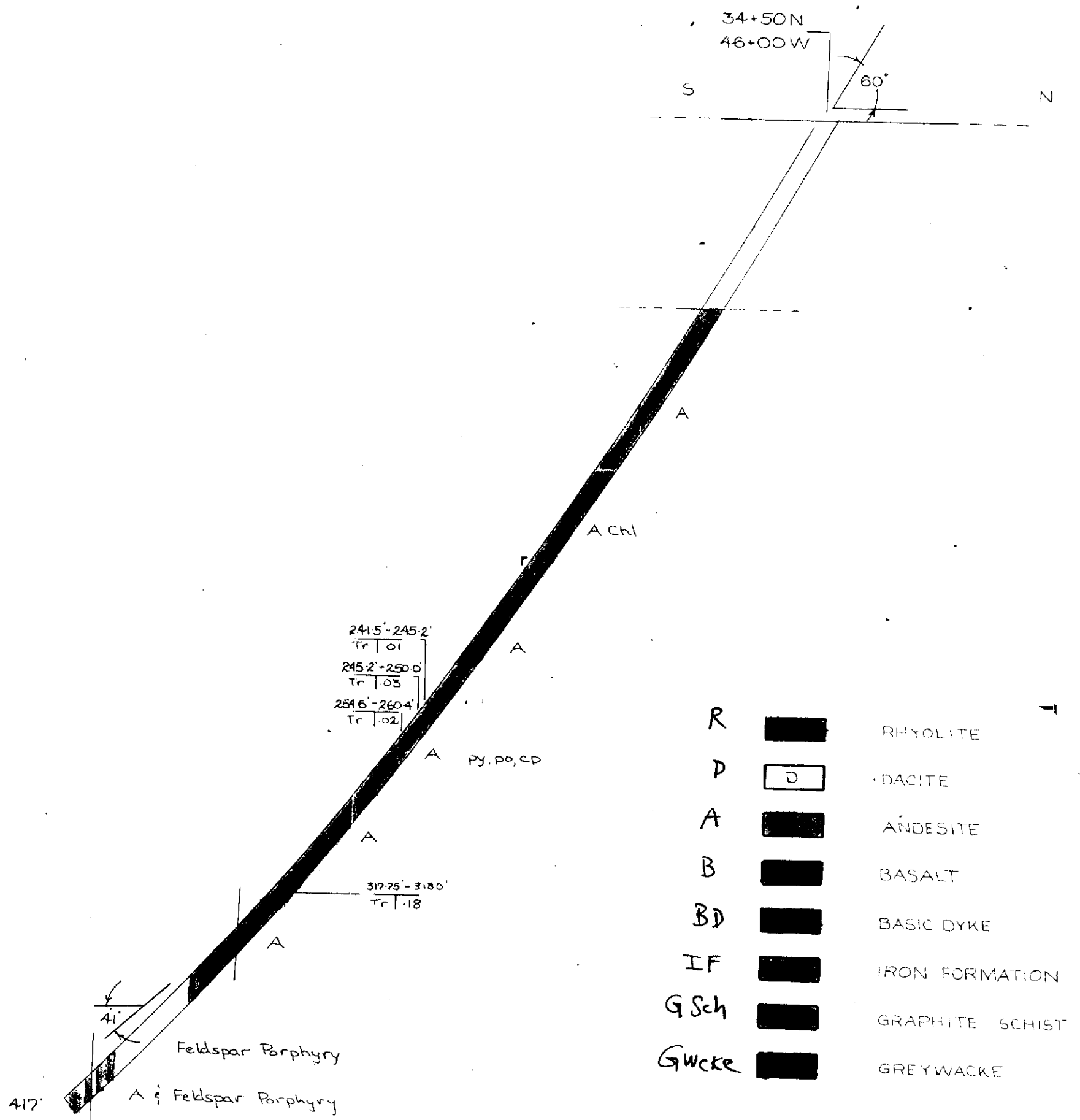
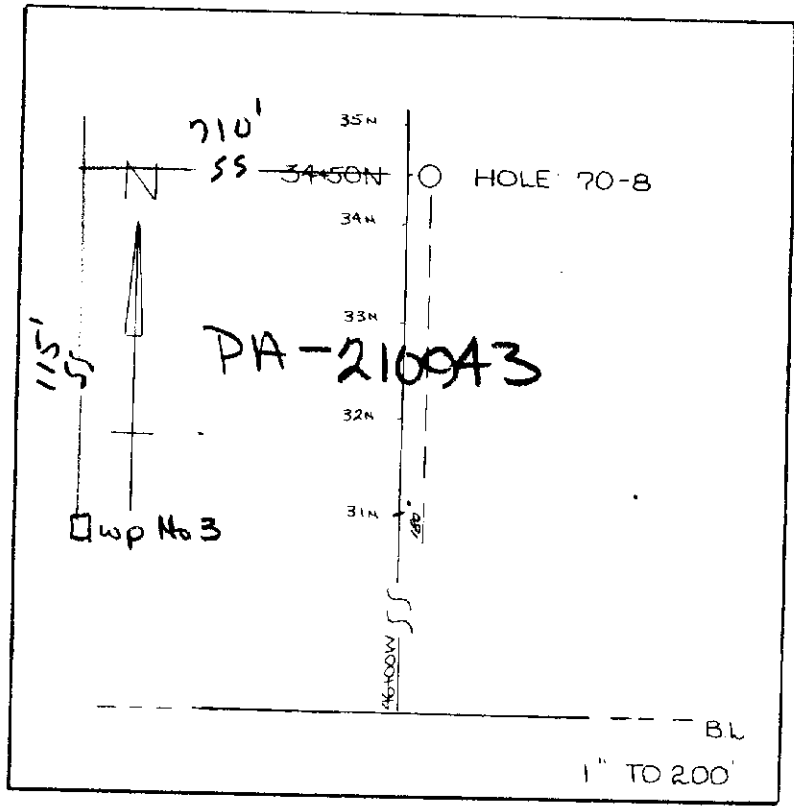

R		RHYOLITE
D		DACITE
A		ANDESITE
B		BASALT
BD		BASIC DYKE
IF		IRON FORMATION
Gsch		GRAPHITE SCHIST
Gwcke		GREYWACKE
		Fragmental Schists
		Tuff
		Pyrrhotite
		Pyrite
		Chlorite (chloritization)
		Sericite (sericitization)
		Chalcopyrite
		Graphite
		Motac Sediments

Sample Footage  
Oz. Ag | % Cu



52G/14NE-0014 #6

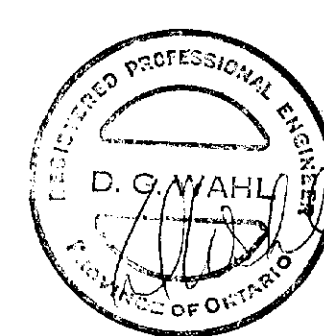

154/70

**CHIMO GOLD MINES LIMITED**

**70-8**

1 INCH TO 40 FEET

W.G. WAHL Ltd NOVEMBER 1970