



52G14SE0013 52G14SE0010 VALORA LAKE

010

DIAMOND DRILLING

AREA: Valora Lake

REPORT No.: 49

WORK PERFORMED BY: Seagull Resources Ltd.

<u>CLAIM No.</u>	<u>HOLE No.</u>	<u>FOOTAGE</u>	<u>DATE</u>	<u>NOTE</u>
PA227061	SG-81-7	1467.0	Feb/81	(1)
PA436738	SG-81-9	827.0	Mar/81	(2)
PA436741	SG-81-11	835.0	Mar/81	(2)
PA243805	SG-81-10	297.0	Mar/81	(3)
PA243805	SG-81-12	637.0	Mar/81	(3)
PA227062	SG-81-5	857.0	Feb/81	(4)
PA227062	SG-81-6	1127.0	Feb/81	(4)
PA227062	SG-81-14	847.0	Mar/81	(4)
PA227063	SG-81-1	597.0	Feb/81	(5)
PA227063	SG-81-2	847.0	Feb/81	(5)
PA227063	SG-81-3	697.0	Feb/81	(5)
PA227063	SG-81-4	556.0	Feb/81	(5)
PA227063	SG-81-8	1107.0	Mar/81	(5)
PA227063	SG-81-13	857.0	Mar/81	(5)

Total:- 14 DH 11555'

- NOTES:
- (1) #70-82
 - (2) #71-82
 - (3) #72-82
 - (4) #73-82
 - (5) #74-82

PROPERTY Seagull Sturgeon Lake CLAIM _____
 LATITUDE 18 + 50N STARTED February 13, 1981
 DEPARTURE 112 + 00E FINISHED February 18, 1981
 ELEVATION _____ TOTAL LENGTH 597

DEPTH	DIP	AZI.	DEPTH	DIP	AZI.
COLLAR	65	180	557	42	
57	63				
157	61				
257	59				
357	50				
457	46				

HOLE NO. SG 81-1
 LOGGED BY Doug Hunter
 CORE SIZE BQ
 SECTION 112E
 LEVEL _____

D.D.Co. _____

Page 1 of 2

CORE FOOTAGE		DESCRIPTION	SAMPLE NO	FROM	TO	LENGTH	Cu PPM	Zn PPM	Ag PPB	Al PPM
FROM	TO									
0	55	Casing in overburden								
55	70	Light pink-grey lapilli-tuff. Chlorite in siliceous fragments and throughout ground mass. Generally massive with hints of bedding only. Strong foliation c.a. = 45°.								
70		Green, chloritic lapilli-tuff with white siliceous fragments, local lenses, generally massive. Becomes massive, grey tuff-lapilli tuff at approximately 100'. Well foliated chloritic tuff and lapilli								
	154	tuff near end of section. Foliation c.a. = 38°. Quartz-carbonate-tourmaline vein at 154-159'.	3101			191.0 192.0	100	86		
154		Very well bedded fine grained tuff and argillaceous tuff. Very distinct thin beds and laminations, some chloritic, others very siliceous. Bedding locally folded, with foliation appearing axialplanar to folds.	3101			191.0 192.0	100	86		
	355	Local pyrite-rich band sampled for assay. Extremely siliceous section 283-330', this carries pyrite 'lenses' from 297-310'. Bedding and cleavage essentially parallel, c.a. = 44°.	3102			298.0 299.0	320	1570		
355	407	Grey-green, massive tuff, lapilli tuff with bedding distinct from place to place, although beds thicker than previous section. At 391.5 a 2cm. bed carrying 15% CPy disseminated. At 315 foliation c.a. = 44°.	3103			429.0 430.0	42	9800		
407		Grey, massive lapilli tuff distinguished by wispy and lensy mafic fragments throughout. Bedding present, but not so pronounced as in previous sections. Extremely siliceous sections in tuff-breccia with minute iridescent milky blue quartz eyes. Sulphides conspicuous at 448'. 'Heaviest' over 472-487' where pyrite and CPy occur disseminated (2-5%) and in chlorite stringers and quartz-carbonate	3104 3105 3106 3107			471.1 477.1 477.1 482.1 482.1 487.1 487.1 489.1	380 1290 7700	1410 8900 7700 19000		

TRG

PROPERTY Seagull Sturgeon Lake CLAIM _____

TUBE _____ STARTED _____

DEPTH _____ FINISHED _____

DATE _____ TOTAL LENGTH _____

DEPTH	DIP	AZI.

DEPTH	DIP	AZI.

HOLE NO. 01-1

LOGGED BY Doug Hunter

CORE SIZE _____

SECTION _____

LEVEL _____

D.D.Co. _____

FOOTAGE TO	DESCRIPTION	SAMPLE NO	FROM	TO	LENGTH	Cu	Zn	Ag	Au
						ppm	ppm	ppb	ppb
495	Very chloritic lapilli tuff, tuff breccia begins at 495' (FvBx?). Graded bed over 1.5' at 492-493.5' indicated 'tops' north.	3108			499.2 501.4	720	12000	1100	8
597	Dark, green-grey lapilli tuff, tuff breccia (FvBx?). Layering not common, quite massive, white siliceous clasts, blebs and lenses in chloritic matrix.	3109			509.5 512.2	1270	480	1370	10
		3110			514.0 515.8	310	4800		
of hole									

PATRICIA MINING DIV.
RECEIVED
 JUL 15 1982
 A.M. P.M.
 7 8 9 10 11 12 1 2 3 4 5 6

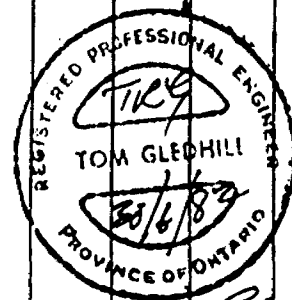

Tom Gleghill

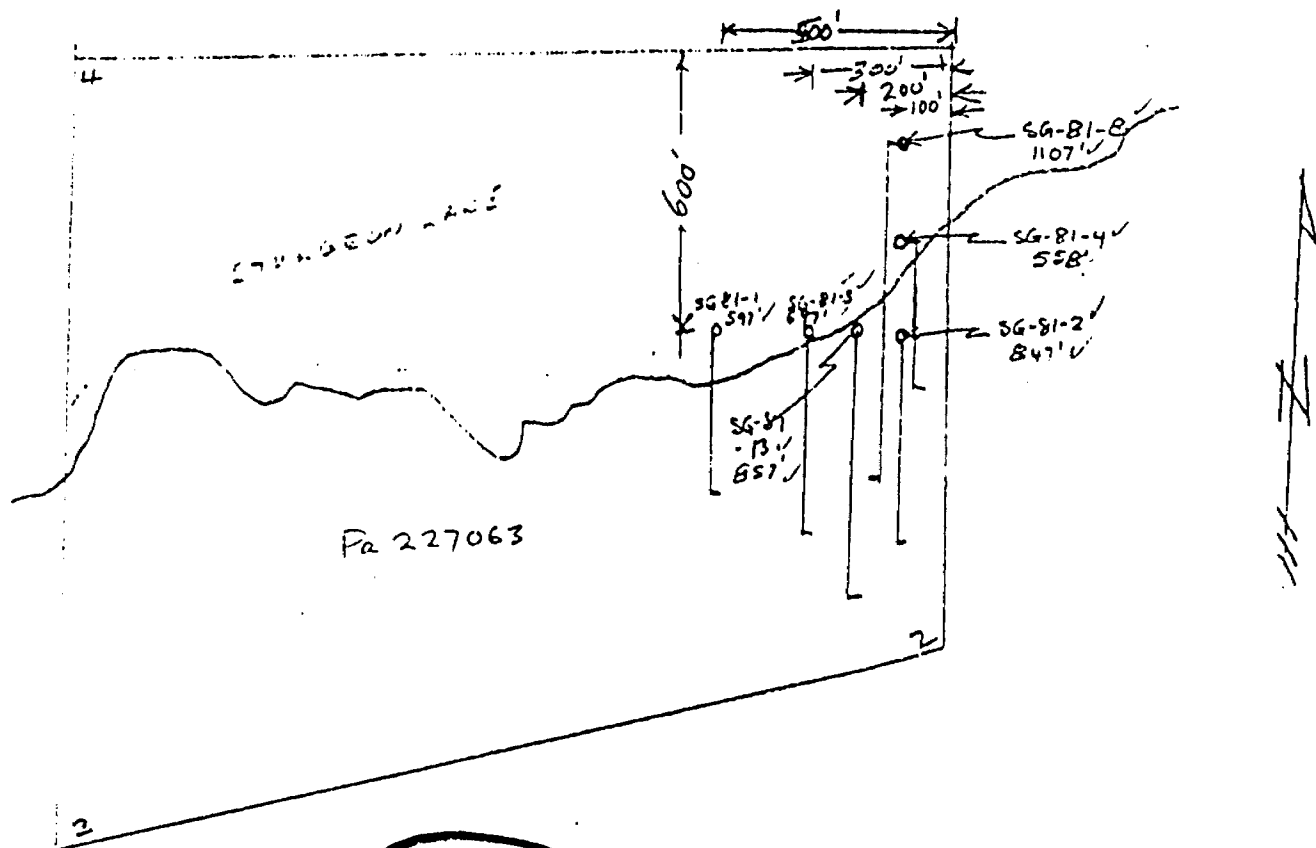

Pa 227063

HOLE NO.

SG-81-1

SG-81-2

SG-81-3

SG-81-4

SG-81-8

SG-81-13

VALORA LAKE

S2 G/14SE

M-2052

scale

400 FT.

TKG

30/6/82

Tom Sludhert

PROPERTY Seagull Sturgeon CLAIM
 LATITUDE 18 + 50N STARTED Feb 17, 1981
 DEPARTURE 116E FINISHED Feb 21, 1981
 ELEVATION _____ TOTAL LENGTH 847

DEPTH	DIP	AZI	DEPTH	DIP	AZI
collar	65	180			
157	62				
300	57				
467	52				
600	53				
757	52				
837	50.5				

HOLE NO. SG 81-2

LOGGED BY D. Hunt

CORE SIZE BQ

SECTION 116E

LEVEL Page 1 of 2

CORE FOOTAGE		DESCRIPTION	Sample No.	from	to	Length	Cu ppm	Zn ppm	Ag ppb
from	to								
0	53	Casing in overburden							
53	79	Green chloritic tuff, lapilli tuff with narrow pinkish sericitic tuff beds up to 1.0'.	3111	69.0	71.5	1.5	1050	460	960
79	138	Fine Grained yellow-grey tuff-bedded tuff with uniform 2% disseminated pyrite and pyrite stringers, patchy stringers, patchy carbonate. Foliation at 42° to c.a.	3112	78.0	98.0	20.0	24	845	180
38	165	Abrupt contact with darker grey lapilli tuff-tuff, bedding locally distinct. Local carbonate-hematitic patches and stringers.							
65	299	Uniform medium grey tuff with distinct bedding throughout, contorted. Siliceous sections, e.g. at 215'. Pyrite tr-1% sometimes vuggy carbonate-quartz veins with 20% pyrite over 1 cm. Oxidized limonite-carbonate zone 192-196' (fracture zone?)	3113 3114	219.5 256.0	221.5 257.5	2.0 1.5	25 17	131 148	
99	317	Well foliated lt-green-grey rock (tuff or dike?), locally pink hematitic.							
7	487	Well-bedded grey-cream coloured very fine-grained tuff, darker chloritic layers define bedding here whereas at 79-138' the tuff is uniform with very little chlorite, thus bedding is indistinct. Grey 'speckled' tuff and lapilli tuff with less distinct bedding from 365', local 0.5' section laminated tuff. Chalcopyrite-pyrite stringers from 331-352', up to 2 cm across, but averaging 3mm. These occur in a very distinct thin bedded-laminated cream-grey coloured tuff.	3115 3116 3117 3118 3119	331.5 336.5 341.5 345.0 350.0	336.5 341.5 345.0 350.0 352.0	5.0 5.0 3.5 5.0 2.0	2800 8600 4200 7500 4700	410 470 440 630 115	1510 6230 2230 11700 1540

TAS

PROPERTY Seagull Sturgeon CLAIM
 LATITUDE _____ STARTED _____
 DEPARTURE _____ FINISHED _____
 ELEVATION _____ TOTAL LENGTH _____

DEPTH	DIP	AZI	DEPTH	DIP	AZI

HOLE NO. SG 81-2
 LOGGED BY D. Hunter
 CORE SIZE _____
 SECTION _____
 LEVEL _____
 Page 2 of 2

CORE FOOTAGE		DESCRIPTION	Sample No.	from	to	Length	Cu ppm	Zn ppm	Ag ppb
from	to								
487	502	Distinct grey lapilli tuff with chloritic fragments and wisps as in SG 81-1 (407-495')							
502	602	Grey-dark grey massive lapilli-tuff, and tuff, well bedded green at 568-569.5'. Foliation 53° to c.a. @ 568'.	3120	6010	602.0	1.0	2300	1830	3050
602	614	Siliceous, finely laminated, very light yellow to pink (oxidized) tuff. Up to 2-3% quartz eyes less than 1mm. Perhaps 2% disseminated pyrite. Perhaps the hardest rock in the hole.							
614	701	Green-grey lapilli tuff as at 502', local chloritic sections in general massive, with massive tuff beds up to 3' thick at 654'. Not very chloritic, intermediate in composition, closely resembles last 60' of SG 81-1.							
701	709	Chloritic unit, dike?							
709	847	Massive grey lapilli-tuff as in previous section 614-701'. Locally characteristic of the "Fwbx"; contact must be arbitrarily drawn 635' (?)	3121	764.0	767.0	3.0	30	44	

end of hole

PATRICIA MINING DIV.
RECEIVED
 JUL 15 1982
 P.M.
 7:8:9:10:11:12 1:2:8:1:9:0

REGISTERED PROFESSIONAL ENGINEER
 TR9
 TOM GLEDHILL
 1986/8
 PROVINCE OF ONTARIO

Tom Gledhill

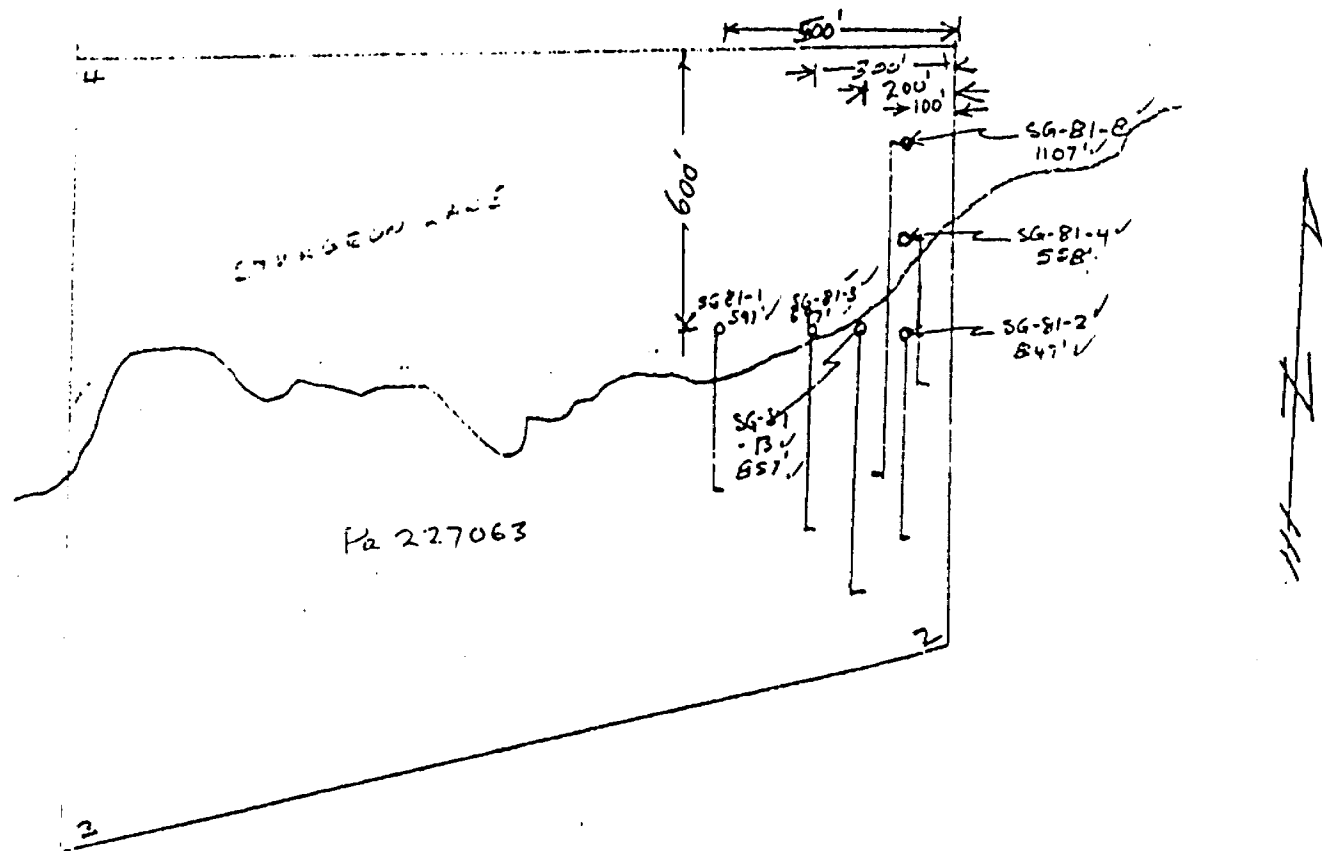

VALORA LAKE
 S2 G/14SE
 M-2052
 Scale
 400 Ft.

HOLE NO. SG-81-1
SG-81-2
 SG-81-3
 SG-81-4
 SG-81-8
 SG-81-13

TK9
 30/6/82)
 Tom Sheddell

PROPERTY Seagull Sturgeon Lake CLAIM _____
 LATITUDE 18 + 50N STARTED Feb 19, 1981
 DEPARTURE 114 + 00E FINISHED Feb 22, 1981
 ELEVATION _____ TOTAL LENGTH 697 ✓

DEPTH	DIP	AZI	DEPTH	DIP	AZI
collar	65	180			
57	63				
237	59				
337	57				
357	55				
597	35				
697	30				

HOLE NO. SG 81-3 ✓
 LOGGED BY D. Hunt
 CORE SIZE BQ
 SECTION 114E
 LEVEL _____
 Page 1 of 2

CORE FOOTAGE		DESCRIPTION	Sample No.	from	to	Length	Cu ppm	Zn ppm	Ag ppt
From	to								
0	48.5	Casing in lake and overburden							
48.5	145	Massive green-grey lapilli tuff. Some chloritic sections over 5' e.g. 107-112 and siliceous sections, e.g. at 140-143'. Hints of very siliceous contorted beds at 142'. Narrow, 1-2 ft. sections with 3% disseminated pyrite (assayed).	3122	127.0	128.0	1.0	30	188	
			3123	130.0	131.8	1.8	33	217	
145	158	Light grey siliceous lapilli tuff with pink, hematitic stringers throughout. This unit may be carbonate-rich locally. Seems to grade into a distinctive tuff. This lapilli tuff occurs at 138-165' in SG 81-2.							
158	200	Very fine grained yellow grey pyritic tuff, bedding present but is not distinct until about 175', where the tuff is thin-bedded to laminated. Disseminated and lensey pyrite conspicuous to about 195'. From 158-172', 3-5% disseminated pyrite. Same unit occurs at 75-138' in SG 81-2.	3124	160.2	165.2	5.0	33	217	
00	338	From 200 - light green thin bedded-laminated tuff, siliceous-sericitic layers alternate with chloritic ones. Siliceous section 239.5-242.5 contains conspicuous chalcopyrite. Matches rock in SG 81-1 between 154-355 (check?) Chalcopyrite beds and stringers from 326-333', 1 band 1" wide, also, disseminations, blebs and fine stringers.	3125	240.3	242.7	2.4	16	111	
			3126	316.3	321.5	5.2	118	230	
			3127	325.8	327.7	1.9			
			3304						
			3128	327.7	332.7	5.0	2560	980	2270

TRG

PROPERTY Seagull Sturgeon
Lake CLAIM _____
 ALTITUDE _____ STARTED _____
 PARTURE _____ FINISHED _____
 ELEVATION _____ TOTAL LENGTH _____

DEPTH	DIP	AZI	DEPTH	DIP	AZI

HOLE NO. SG 81-3
 LOGGED BY _____
 CORE SIZE _____
 SECTION 114 E
 LEVEL _____
 Page 2 of 2

DEPTH	CORE FOOTAGE		DESCRIPTION	Sample No.	from	to	Length	Cu ppm	Zn ppm	Ag ppb
	from	to								
38			More massive grey tuff, lapilli-tuff with indistinct bedding and patchy siliceous nature, as towards bottom of other 2 (previous) holes. Local well-bedded horizons throughout. After 575' massive lapilli-tuff (good FwBx). Local blebs and stringers of chalcopyrite, perhaps some honey sphalerite in one 0.5' section (to be assayed)	3305	332.7	337.0	4.3			
				3129	387.0	390.5	3.5	410	191	
				3130	408.4	410.1	1.7	810	520	
		575		3131	524.3	526.2	1.9	8700	1370	1800
575	697		Core Lapilli tuff log incomplete: essentially the same as SG 81-2 637-847.5". Richmond	3132	534.9	535.6	0.7	3100	1760	6030
				3133	539.8	540.7	0.9	400	1380	4930

End of hole

PATRICIA MINING DIV.
RECEIVED
 JUL 15 1982
 A.M. 7 8 9 10 11 12 P.M. 1 2 3 4 5 6

REGISTERED PROFESSIONAL ENGINEER
 TRB
 TOM GLEDHILL
 30/6/82
 PROVINCE OF ONTARIO

Tom Gledhill

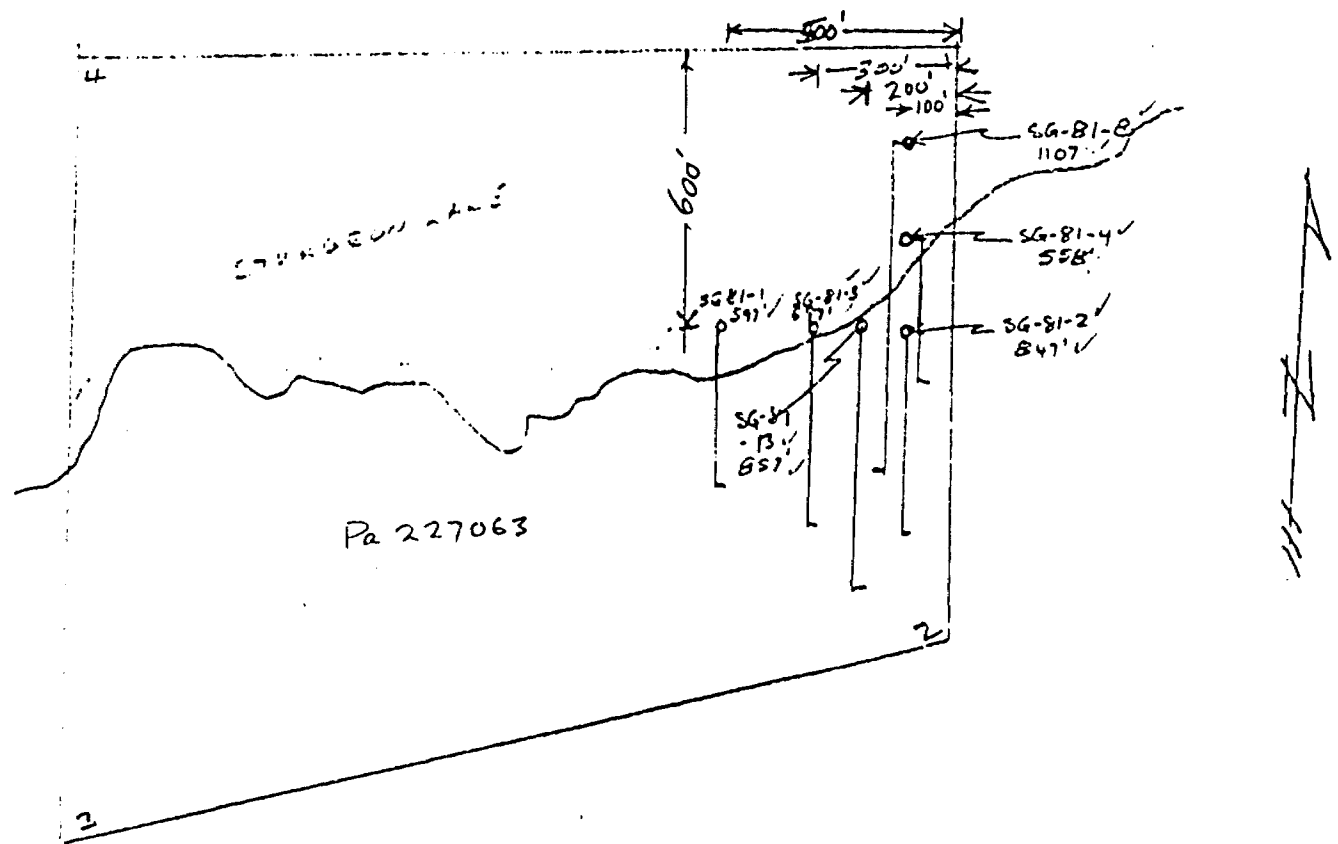

VALORA LAKE
 S2G/14SE
 M-2052
 Scale
 400 FT.

HOLE NO. SG-81-1

SG-81-2

SG-81-3

SG-81-4

SG-81-8

SG-81-13

TKG

30/6/82

Tom Gladwell

PROPERTY Seagull Sturgeon Lake CLAIM _____
 LATITUDE 20 + 50N STARTED Feb 21, 1981
 DEPARTURE 116 + 00E FINISHED Feb 24, 1981
 ELEVATION _____ TOTAL LENGTH 556

DEPTH	DIP	AZI	DEPTH	DIP	AZI
collar	66	180	556	46	
10	58				
17	54				
357	48				
457	43				

HOLE NO. SG 81-4 ✓
 LOGGED BY D. Hunte
 CORE SIZE B0
 SECTION 116E
 LEVEL 1 of 1
 Page 1 of 1

CORE FOOTAGE		DESCRIPTION	Sample No.	from	to	Length	Cu ppm	Zn ppm	Ag ppb
from	to								
0	72	Casing in overburden							
72	94	Massive, green very well foliated lapilli-tuff ag in the top of SG 81-1 (?) Foliation \angle c.a. about 45°.							
94	300	Dark grey-green and grey massive lapilli-tuff. Hints of bedding and/or breccia-size fragments at 145-159'. Felsite dike at 110-122'. Some narrow (2-4") quartz carbonate-tourmaline veins.							
300	446	Fine-grained sericitic tuff with hematitic bands and stringers to 333. From 333 the tuff is green-grey and thinly bedded to laminated, with the bedding largely disrupted (contorted and chopped up). At about 375', some thicker beds of green and grey tuff appear, bedding not as well defined as 333-375'. Well-bedded light grey siliceous tuff appears at about 430'. Mafic dyke at 435-445'							
446	517	Conspicuous chalcopyrite appears at 496'. Very fine grained thin-bedded to laminated siliceous tuff as in mineralized zone in SG 81-2 and SG 81-3. Chalcopyrite as blebs, stringers, and in bands.							
517	556	Massive grey tuff and lapilli-tuff with hints of bedding locally. Siliceous with local disseminated pyrite and chalcopyrite.							
end of hole									

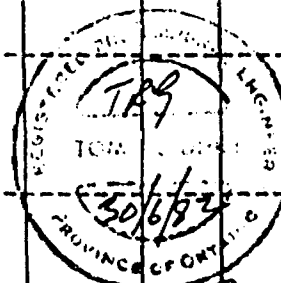
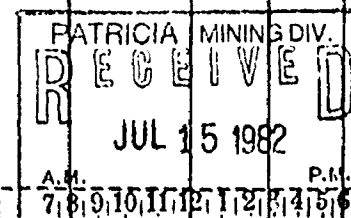

Tom Gladhill

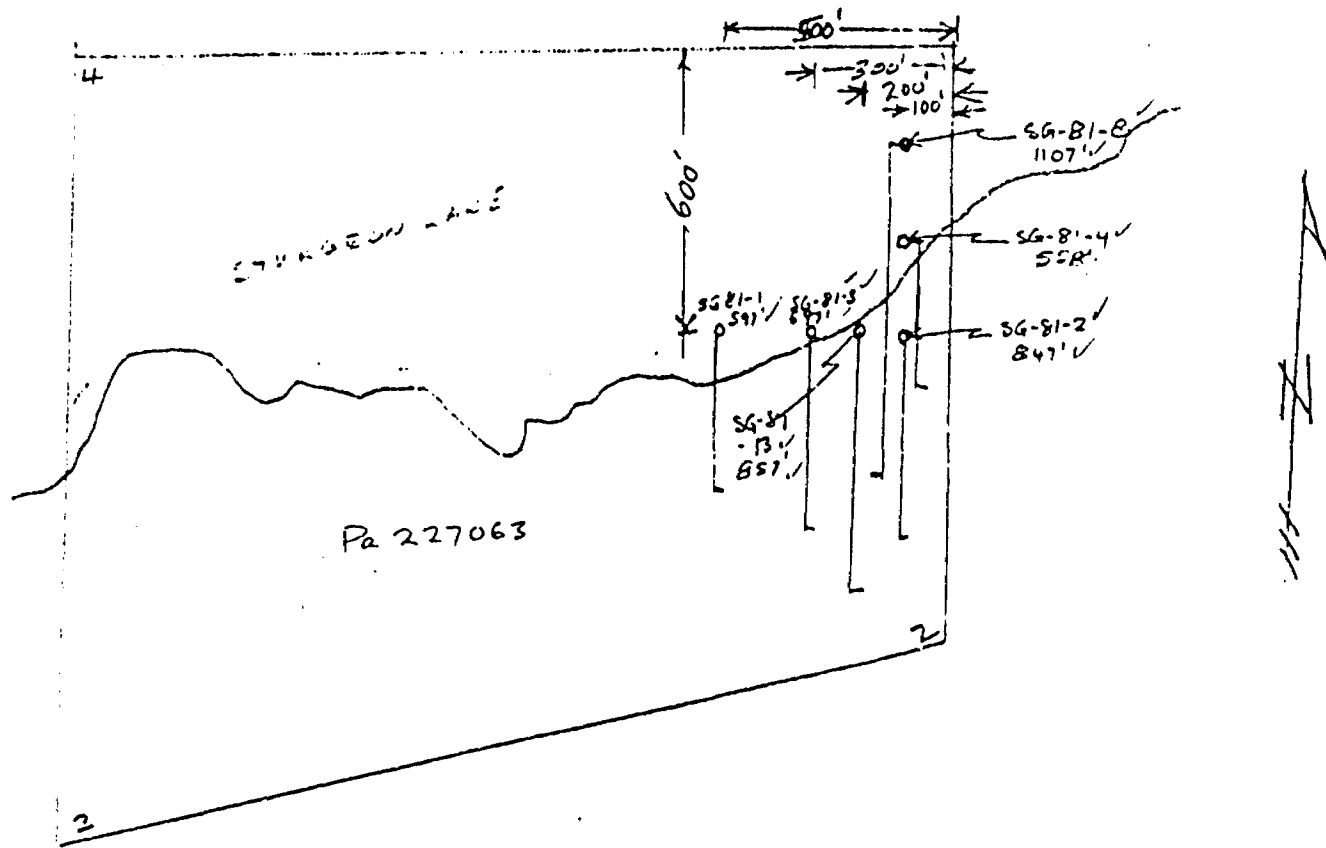

VALORA LAKE
 S2G/14SE
 M-2052
 Scale
 400 Ft.

- HOLE NO. SG-81-1
 SG-81-2
 SG-81-3
SG-81-4
 SG-81-8
 SG-81-13

TKG
 30/6/82
 Tom Skidwell

PROPERTY Seagull Sturgeon Lake CLAIM _____

ATTITUDE 18 + 50N STARTED Feb 23, 1981

DEPARTURE 118 + 00E FINISHED Feb 27, 1981

ELEVATION _____ TOTAL LENGTH 857 ✓

DEPTH	DIP	AZI.
Collar	65	180
49	63.5	
217	53	
307	47	
400	39	

DEPTH	DIP	AZI.
497	31	
607	31	
707	29	
807	31	

HOLE NO. SG-81-5 ✓

LOGGED BY D. Hunter
D. Richmond

CORE SIZE RO

SECTION 118E

LEVEL _____

Page 1 of 2

D.D.Co. _____

CORE FOOTAGE		DESCRIPTION	SAMPLE NO.	FROM	TO	LENGTH			
FROM	TO								
0	39	Casing to bedrock							
39	169	Massive, green-grey and green tuff and lapilli-tuff with only a hint of bedding. Locally, "heavy" disseminated pyrite in chloritic tuff from 140-198 in up to 3' bands (assayed) Foliation \swarrow c.a. about 45° , not pronounced; bad ground; chopped up and oxidized 67-71', 100-106', 146-154'.							
169	214	At 169' a very fine-grained light-grey to cream coloured tuff with disseminated pyrite and thin bands of pyrite appears. This tuff resembles rock in other holes, particularly SG 81 2 (79-138') and SG 81 3 (158-175') Assays over 5'. Foliation 40° to c.a. at 172' and 62° (wavy) at 213'							
214	340	Well-bedded, well-foliated tuff and lapilli-tuff, occasional massive bands, highly chloritic over most of the section. 220-235' approximately is a fairly constant lapilli tuff unit. From 287-237 rock consists of wispy grey fragments in a green matrix. Fragments could be lapilli or disrupted beds, probably the latter. Beds are often highly contorted. Pink hematite staining in bands and patches distinguishes the above interval. Some bleaching about a section of ground core at 312 indicates a groundwater channel. Little core lost. A few stringers of pyrite in section. Foliation: 58° at 255', 55° at 322', 60° at 336'.							
340	353	Indistinctly bedded to massive tuff, quite chloritic. some lapilli. A gradational change from above. Foliation about 60° to c.a.							

FR

PROPERTY Seagull Sturgeon Lake CLAIM _____

ELEVATION _____ STARTED _____

DEPARTURE _____ FINISHED _____

ELEVATION _____ TOTAL LENGTH _____

PAGE 2 - 2

DEPTH	DIP	AZI.	DEPTH	DIP	AZI.

D.D.Co. _____

HOLE NO. SG 81-5

LOGGED BY _____

CORE SIZE _____

SECTION 118 E

LEVEL _____

Page 2 of 2

RE FOOTAGE		DESCRIPTION	SAMPLE NO.	FROM	TO	LENGTH			
FROM	TO								
353	356.5	Pink felsic dike cut by some quartz veins, sharp upper contact at 50° to c.a., crosscuts bedding at 10-20°. Chilled contact? Bottom somewhat disrupted, perhaps 40° to c.a. Foliation is 62° at 354.							
356.5	732	Grey massive tuff to lapilli-tuff, some sections vaguely bedded. Some short, distinctly banded sections may be tuff or intermediate porphyry dikes. Most of the interval is grey siliceous fragmental rock, with fragments varying from vague to distinct. Some fine-grained massive bands be intermediate tuff or intrusions. Lower contact of this unit is fairly distinct. Foliation: 63° at 384', 61° at 462', 80° at 510', 80° at 600', 70° at 729'. A few blebs and disseminated grains of sulfides. Patches of carbonate alteration throughout.							
732	745	Green chloritic fine-grained banded tuff. Moderate pyrite>chalcopyrite disseminated along foliation. Foliation about 45° to c.a.							
745	857	Massive grey fragmental as 356.5-732'. Contacts of sulfide band are highly contorted. Band of massive sphalerite>chalcopyrite at 750.4-751.4, carbonate alteration if anything more intense in f.w. to sulfide zone. Doug Hunter notes: "up to 25% t. yellow "buff" coloured carbonate, check chemistry (L.O.I.-Fe ₂ O ₃)"							
end of hole									

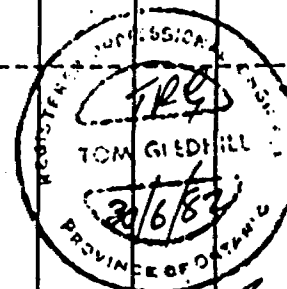
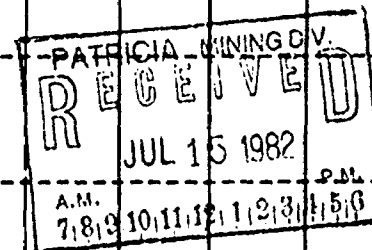

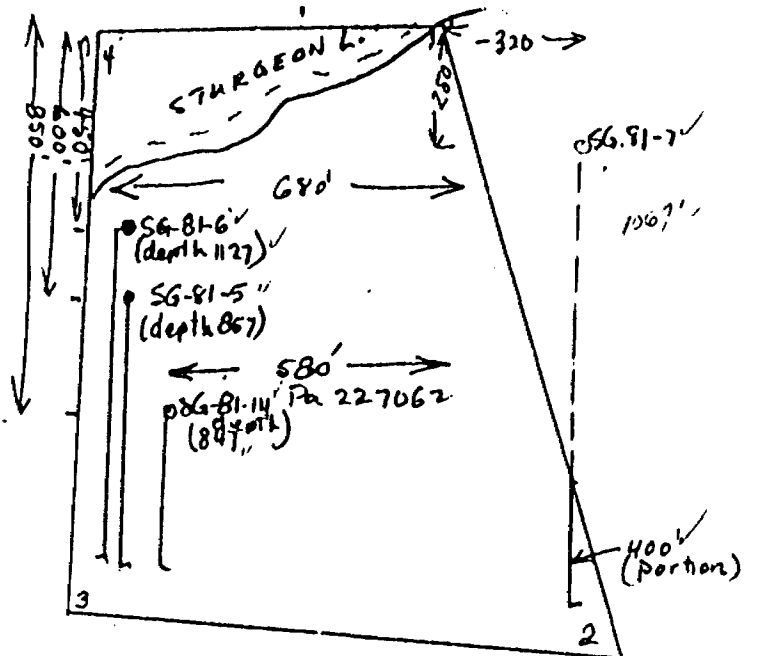

HOLE NO. SG-81-5
 SG-81-6
 SG-81-14

VALORA LAKE
 S2G/14SE
 M-2052
 Scale
 400 Ft.



Tom Gibbins 1" = 400'

PROPERTY Seagull Sturgeon Lake CLAIM _____
 LATITUDE 20 + 50 N STARTED Feb 26/81
 DEPARTURE 118 + 00E FINISHED Mar 3/81
 ELEVATION _____ TOTAL LENGTH 1127

DEPTH	DIP	AZI.
collar	65°	180
100	50	
200	54	
300	52	
400	49	

DEPTH	DIP	AZI.
501'	47°	
600'	49°	
Bearing		180°

HOLE NO. SG 81-6
 LOGGED BY G. Richmond
 CORE SIZE BQ
 SECTION 118E
 LEVEL _____
 Page 1 of 2

D.D.Co. _____

ORE FOOTAGE		DESCRIPTION	SAMPLE NO.	FROM	TO	LENGTH			
FROM	TO								
0	66.0	Casing in overburden							
66.0	132	Grey to greenish grey bedded tuff to lapilli tuff. Some met. qz-carb veins. Quartz-tourmaline-carbonate veins more common near bottom of interval. Minor dissem. & stringer pyrite. Some fe-carb alteration. Blocky core. Foliation @ about 40° - 35°.							
132	152	Grey to purplish grey lapilli tuff, some more massive. Lapilli usually very distinct. Appears to be more siliceous, also considerable sericite and possibly chloritoid. Some conformable bands of fine grained semi-massive pyrite, also high dissem. pyrite. Assays. Blocky core, often vuggy & broken. Foliation 40° - 45°.							
152	169	Massive green tuff to lapilli tuff, altered and vuggy in spots. May include some intermediate intrusive. Minor dissem. pyrite. Foliation about 45°.							
169	202	Grey to buff fine grained siliceous tuff, bedding fairly distinct. Includes some fine lapilli tuff. Numerous narrow stringers of pyrite along foliation. Foliation 40°.							
202	291	Greenish grey lapilli tuff. Some fairly large fragments, but most < 1 cm. Well foliated. A few specks of dissem. pyrite, trace chalcopyrite. Foliation 45°.							
291	320	Fine grained siliceous massive tuff and lapilli tuff. Some wispy bands and patches of fine grained pyrite. Assays. Foliation about 45°.							
320	399	Greenish grey to green massive tuff to fine lapilli tuff. Some sections fairly distinctly bedded. A number of metamorphic quartz & quartz - carb. veins, some are vuggy. A little ground core. Last 2 1/2 feet altered. Minor dissem. pyrite. Foliation 45° - 50°.							TRG

PROPERTY Seagull Sturgeon Lake CLAIM _____
 ALTITUDE 20 + 50 N STARTED _____
 DEPARTURE 118 + 00E FINISHED _____
 ELEVATION _____ TOTAL LENGTH _____

DEPTH	DIP	AZI.	DEPTH	DIP	AZI.

HOLE NO. SG 81-6
 LOGGED BY _____
 CORE SIZE BQ
 SECTION 118E
 LEVEL _____

D.D.Co. _____

Page 2 of 2

ELEVATION FOOTAGE		DESCRIPTION	SAMPLE NO.	FROM	TO	LENGTH				
FROM	TO									
399	410.5	Fine grained pink felsic intrusive - "aplite". Includes 2' of altered tuff? 405 - 407. Chilled contacts and baking? of wall rock. Some pyrite on fracture surface. Foliation about 60° - 65°								
410.5	460	Dark green to pale green massive to lapilli. Strongly bleached and pinkened from 450 - 454. May be aplite dike but texture looks like tuff. Abundant patches and bands of fine grained pyrite ± chalcopyrite & sphalerite from 446.5 - 450. Assay. Foliation about 65°.								
460	542	Grey fragmental white to buff large lapilli in grey to greenish grey matrix. Appears quite siliceous. Some bands of fine grained tuff in sections. Looks like ore hosting? Horizon from other holes. Trace fine grained disseminated pyrite in massive bands (to 542). Foliation 60° - 65°.								
542	710	as above								
542	710	Grey fragmental, prominent white lapilli 563 - 567, elsewhere varies from bedded to massive; some narrow green fine grained bands may be int. dikes of fine grained tuff. gradational change 570 - 603 scattered stringers of chalcopyrite & 1" band of granular pyrite @ 582. Foliation 65° - 70°.								
710	850	Massive grey tuff - lapilli and/or bedding indistinct and rarely seen. Otherwise quite similar to unit above. Scattered wispy patched of disseminated pyrite. Very sparse overall. Foliation from 75° - 90° usually 80°.								
850	1023	Grey fragmental? to massive grey tuff becoming more chloritic toward bottom of section. Some fine grained tuff layers and some zones of distinct lapilli. No great change from previous section. As above. Foliation 70° - 80°.								
1023	1127	as above foliation 80° - 85°								

PATRICIA MINING DIV.
 RECEIVED
 JUL 15 1982
 P.M.
 7 8 9 10 11 12 1 2 3 4 5 6

REGISTERED PROFESSIONAL
 GEOLOGIST
 TERRY G. SCHILL
 2/6/82
 PROVINCE OF ONTARIO

Tom Schill
 TRG

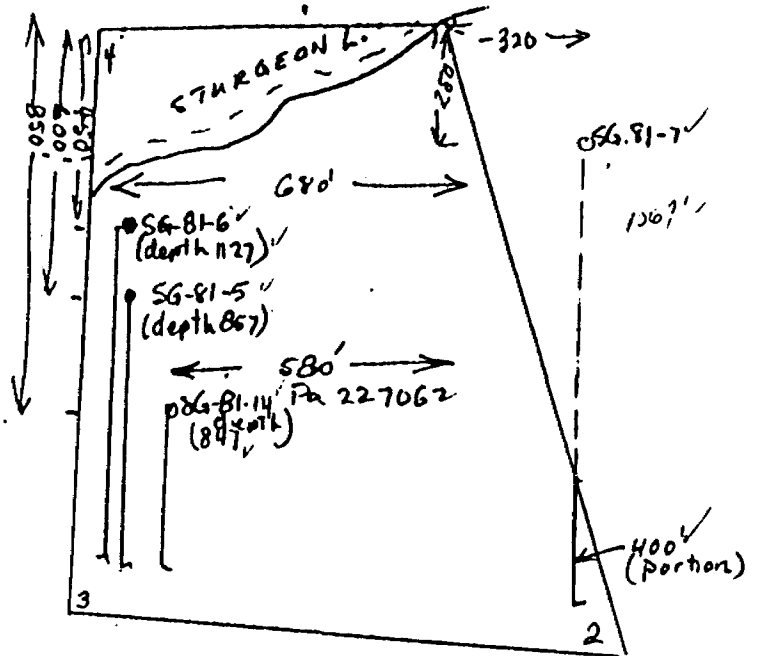

HOLE NO. SG-81-5

SG-81-6

SG-81-14

VALORA LAKE
 S2G/14SE
 M-2052
 scale
 400 Ft.



Tom Greenhill 1" = 400'

PROPERTY Seagull Sturgeon Lake CLAIM _____
 ALTITUDE 22 + 50N STARTED Feb 27/81
 DEPARTURE 128 + 00E FINISHED Mar 9/81
 ELEVATION _____ TOTAL LENGTH 1467

DEPTH	DIP	AZI.	DEPTH	DIP	AZI.
collar	65°	180°	707	45°	
97	59°		807	43°	
197	59°		907	41°	
297	58°		1007	37°	
397	53°		1107	35°	
497	48°		1207	34°	
607	48°		1307	31°	
O.B.Co.			1400	29°	

HOLE NO. SG 81-7
 LOGGED BY G. Richmond
 CORE SIZE BQ
 SECTION 128E
 LEVEL _____

CORE FOOTAGE		DESCRIPTION	SAMPLE NO.	FROM	TO	LENGTH			
FROM	TO								
0	57	Casing							
57	132	Coarse lapilli tuff. Large white lapilli in a dark green chloritic matrix. Very distinctive. Minor pyrite association with quartz veins. Foliation 35° - 45°.							
		--- gradational contact ---							
132	240	Fine lapilli tuff. As above but lapilli smaller. Some appears bedded. Lapilli more wispy and indistinct than in above section. Minor pyrite with quartz veins. Dissem pyrite & magnetite? in bleached zone about 0.4 @ 142. Some dissem chalcopyrite @ 225-230. Assay. Foliation 35° - 45°. Foliation about 45° @ 240.							
240	306	Lapilli tuff to wispy chloritic fragmental. No sharp division from previous section. Few fine grained bands; virtually all is distinctly fragmental. Possible f.w. lapilli tuff. Indistinct bedding. Few quartz veins of any size. Trace dissem. chalcopyrite 270 - 275. Foliation about 45°.							
306	360	Wispy tuff - fine grained bedded tuff, bedding quite distinct in places. Some vaguely fragmental bands, some just massive. becoming less chloritic and more heterogeneous upper contact marked by sudden absence of distinct lapilli. A number of quartz veins some contorted little or no sulfides visible. Foliation 50° - 50°.							
360	476	"Grey fragmental"? More siliceous than above unit, with wispy chloritic and rarely distinct fragments. Some quartz veins minor dissem. pyrite. Assay. Foliation about 50°.							
476	535	Heterogeneous fragments and bedded units. varies from pale to grey to dark green. Some well developed beddings. Some bands of pyrite. Assay. Foliation about 60°.							

TRB

PROPERTY Seagull Sturgeon Lake CLAIM _____
 ALTITUDE 22 + 50N STARTED _____
 DEPARTURE 128 + 00E FINISHED _____
 ELEVATION _____ TOTAL LENGTH _____

DEPTH	DIP	AZI.	DEPTH	DIP	AZI.

D.D.Co. _____

HOLE NO. SG 81-7
 LOGGED BY _____
 CORE SIZE BQ
 SECTION 128E
 LEVEL _____

Page 2 of 3

CORE FOOTAGE		DESCRIPTION	SAMPLE NO.	FROM	TO	LENGTH			
FROM	TO								
535	600	Fine grained siliceous tuff, weakly to distinctly bedded. Contacts with underlying and overlying units are gradational & arbitrarily set. Bands and patches of wispy fine grained pyrite, and traces of chalcopyrite. Bedding & foliation about 60° to c.a. no contorted bedding noticeable.							
600	650	Massive grey tuff. Bedding rarely seen, and no lapilli evident. Fairly siliceous. Trace dissem. pyrite. Foliation weak.							
650	690	Grey lapilli tuff - tuff breccia. Cream fragments in a grey matrix, some fragments fairly large. Fragments often distinct. Moderately siliceous, more than unit above. A few wispy bands of pyrite. Foliation about 70°. - - - - - fairly abrupt contact - - - - -							
690	743	Graphitic banded tuff? Fine grained siliceous tuff with contorted dark bands, presumably graphite, that give it a marble-like appearance in places. Some sections highly siliceous. Distinctly bedded in places. A laminated section 738 - 743, contains mod. finely laminated pyrite. Bedding minutely contorted. Foliation about 60°.							
743	807	Grey lapilli tuff. Moderately siliceous. Possibly graphitic. Lapilli vague to distinct, some contorted bedding at about 20° Minor stringer chalcopyrite from about 760 - 770. Bedding about 20°? Foliation 60° - 70°.							
807	960	Massive tuff with occasional fine grained bedded layers. No distinct lapilli. Somewhat more chloritic. Lower contact not defined as yet. Minor stringer and dissem. pyrite stringer chalcopyrite dissem 927 - 936 & 947 - 957. Assays. Foliation @ about 70° to core axis.							
879	887								
705	707								

708

PROPERTY Seagull Sturgeon Lake CLAIM _____

ELEVATION 22 + 50N STARTED _____

DEPARTURE 118 + 00E FINISHED _____

ELEVATION _____ TOTAL LENGTH _____

DEPTH	DIP	AZI.	DEPTH	DIP	AZI.

D.O.Co. _____

HOLE NO. SG 87-7

LOGGED BY _____

CORE SIZE BQ

SECTION 128E

LEVEL _____

CORE FOOTAGE		DESCRIPTION	SAMPLE NO.	FROM	TO	LENGTH			
FROM	TO								
960	1197	Massive grey tuff to lapilli tuff. Lapilli not abundant above 960 - vary from scarce to common and distinct between 960 and 1110 - otherwise this unit is similar to the one above. Fairly chloritic. A few small quartz veins; moderate carbonate alteration? A bit less chloritic below 1152, patchy carbonate alteration, not obvious - should be relogged after core oxidises. Some narrow stringers of chalcopyrite ± z. 1135 - 1150. one 7' Assay - low angle to core axis. Foliation average about 75°. - rather indistinct (gradational?) contact-							
ground and drilled over core from 1032	0 1047								
1197	1255	Indistinctly bedded to delicately laminated tuff ± sediments, moderately to highly chloritic. Includes some fine grained massive bands that may be flows or dikes (intermediate) some well-displayed contorted bedding. Some fairly narrow lapilli bands, and some quartz veins. 0.6 pink aplite dike at 1244.5. Some blebs and dissem. pyrite. Foliation about 75°							
very blocky core, some ground, 1207-1217	blocky core 1247-1255								
1255	1466	Chloritic massive tuff to lapilli tuff, bedding rarely discernable. Mostly lapilli tuff towards bottom of section. Some small stringers of chalcopyrite starting at about 1235 some lapilli contain pyrite. Foliation 75° - 80°.							
END									
Some ground & drilled over core 1386	1387								

PATRICIA MINING DIV.
RECEIVED
 JUN 15 1982
 A.M. 7:8, 9:10, 11:21 P.M. 2:31, 4:51, 6:0



Tom Gledhill

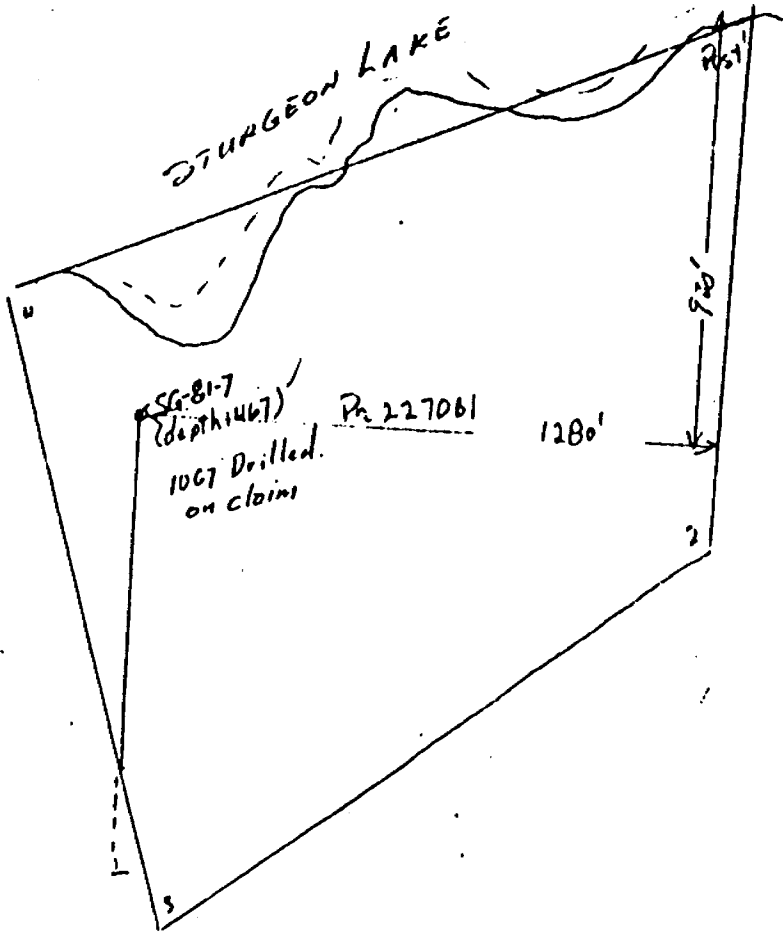

HOLE NO.

SG-81-7

VALORA LAKE

S2G/14SE

M-2052

scale

400 FT.

Scale

1" = 400'

PROPERTY Seagull Sturgeon Lake CLAIM _____
 ALTITUDE 22 + 50 N STARTED Mar 4/81
 DEPARTURE 116 + 00E FINISHED Mar 12/81
 ELEVATION _____ TOTAL LENGTH 1107

DEPTH	DIP	AZI.
collar	65	180
100	58	
200	57	
300	49	
400	49	
500	49	
600	43	
D.O.C.		

DEPTH	DIP	AZI.
700	40	
800	39	
900	37	
1000	35	
1100	33	

HOLE NO. SG 81-8
 LOGGED BY G. Richmond
 CORE SIZE BQ
 SECTION 116E
 LEVEL _____
 Page 1 of 3

CORE FOOTAGE		DESCRIPTION	SAMPLE NO.	FROM	TO	LENGTH				
FROM	TO									
0	115	Casing in lake & overburden								
115	155	Intermediate tuff & lapilli tuff, blackish lapilli conspicuous in some sections Top 25' weathered. Some possible int. flows. Trace dissem. pyrite. Foliation about 60°.								
155	225	Intermediate massive tuff, mod chloritic, some fine textured lapilli tuff, Some contorted quartz carbonate veins. Some blebs of chalcopyrite in quartz veins. Foliation about 65°.								
225	247	Heterogeneous zone - chloritic to siliceous? massive tuff, and lahar-like breccia, some minor lapilli bands, and some contorted and cutoff quartz veins. Hematite staining. Minor dissem. pyrite. Foliation about 60°.								
247	330	Intermediate massive to lapilli tuff, generally lapilli tuff predominates. Lapilli generally rhyolitic vary from distinct to quite wispy. 0.2' qz-pyrite-T0-carbonate vein @ 312. Foliation about 50° - 60°.								
330	343	Finely laminated to thin bedded tuff and/or sediments, often contorted bedding. Several qz-carb. - t0 veins, contacts not distinct. Some blebs of pyrite in qz. veins. Foliation 45° - 50°.								
343	360	Light grey siliceous tuff, indistinctly bedded. A few qz-carb-t0 veins. Trace of dissem. pyrite along foliation. Foliation about 45°.								
360	437	Massive grey fragmental, some lapilli tuff. Several QZ-carb-t0 veins. Weakly to mod. foliated. Trace pyrite, very sparse. Foliation 70° - 90°.								

TR

PROPERTY Seagull Sturgeon Lake CLAIM

LATITUDE 22 + 50N STARTED

DEPARTURE 116 + 00E FINISHED

ELEVATION TOTAL LENGTH

DEPTH	DIP	AZI.	DEPTH	DIP	AZI.

D.D.Co.

HOLE NO. SG 81-8

LOGGED BY

CORE SIZE BQ

SECTION 116E

LEVEL

Page 2 of 3

ORE FOOTAGE		DESCRIPTION	SAMPLE NO.	FROM	TO	LENGTH			
FROM	TO								
437	575	Siliceous, sericitic sometimes moderately chloritic, bedded tuff-lapilli tuff. Lapilli tuff more as a chloritic break in an otherwise siliceous sequence. (Lapilli most common from 545 - 560) Fine stringers and wispy lenses of pyrite along foliation. One short zone about 2' w'ith some chalcopyrite. Assay. Foliation about 60°.							
575	612	Siliceous and sericitic; + hematite stained massive tuff and bedded tuff. A few lapilli and breccia bands, gradational contacts in and out. Fine stringers and wispy lenses of pyrite along foliation. Foliation about 70°.							
612	665	Grey tuff varies from cream to grey mottled (obscure lapilli?) to distinctly bedded. Lower part of unit speckled with little wisps of chlorite that are probably tiny lapilli. As above, but somewhat less pyrite. Foliation mod. 70° - 75°.							
665	750	Heterogeneous grey fragmental. Varies from distinctly bedded to fairly distinct lapilli. Mostly siliceous, but some chloritic beds, especially where chalcopyrite is more abundant. Stringers of chalcopyrite and pyrite. fairly low grade overall but assayed from 675 to 735 - 60'. Foliation typically about 70°. cut a 1' qz-carb-tó zone @ 685.							
750	850	Grey fragmental commences to be more chloritic. Grey fragmental ground & drilled over core 775-778 varies from fine grained massive tuff to indistinctly bedded (foliated?) fine grained tuff to lapilli tuff. Lapilli tuff predominates in section. Some sections chloritic overall. Sparse and rare stringers of pyrite and chalcopyrite. Foliation about 70°.							
850	1107'	Grey fragmental is more siliceous varies from massive, featureless overall to bedded tuff and lapilli tuff from 920 - 933. Rock is on							

TRK

PROPERTY Seagull Sturgeon Lake CLAIM _____

TITUDE _____ STARTED _____

PARTURE _____ FINISHED _____

ELEVATION _____ TOTAL LENGTH _____

DEPTH	DIP	AZI.	DEPTH	DIP	AZI.

D.D.Co. _____

HOLE NO. 5001-B

LOGGED BY _____

CORE SIZE _____

SECTION _____

LEVEL _____

E FOOTAGE		DESCRIPTION	SAMPLE NO.	FROM	TO	LENGTH			
DM	TO								
		the whole fine textured, although much is indistinctly mottled-lapilli texture. Carbonate and chloritoid in lower part of section from 1025 - 1032 a very chloriti- band with significant chalcopryrite from 1029 - 1032 Patches & stringers of chalcopryrite 1029 - 1032 Assay. Foliation 80° - 90°.							
		End							

PATRICIA MINING DIV.
RECEIVED
 JUL 15 1982
 A.M. P.M.
 7 8 9 10 11 12 1 2 3 4 5 6

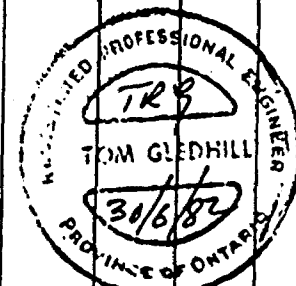

Tom Gledhill

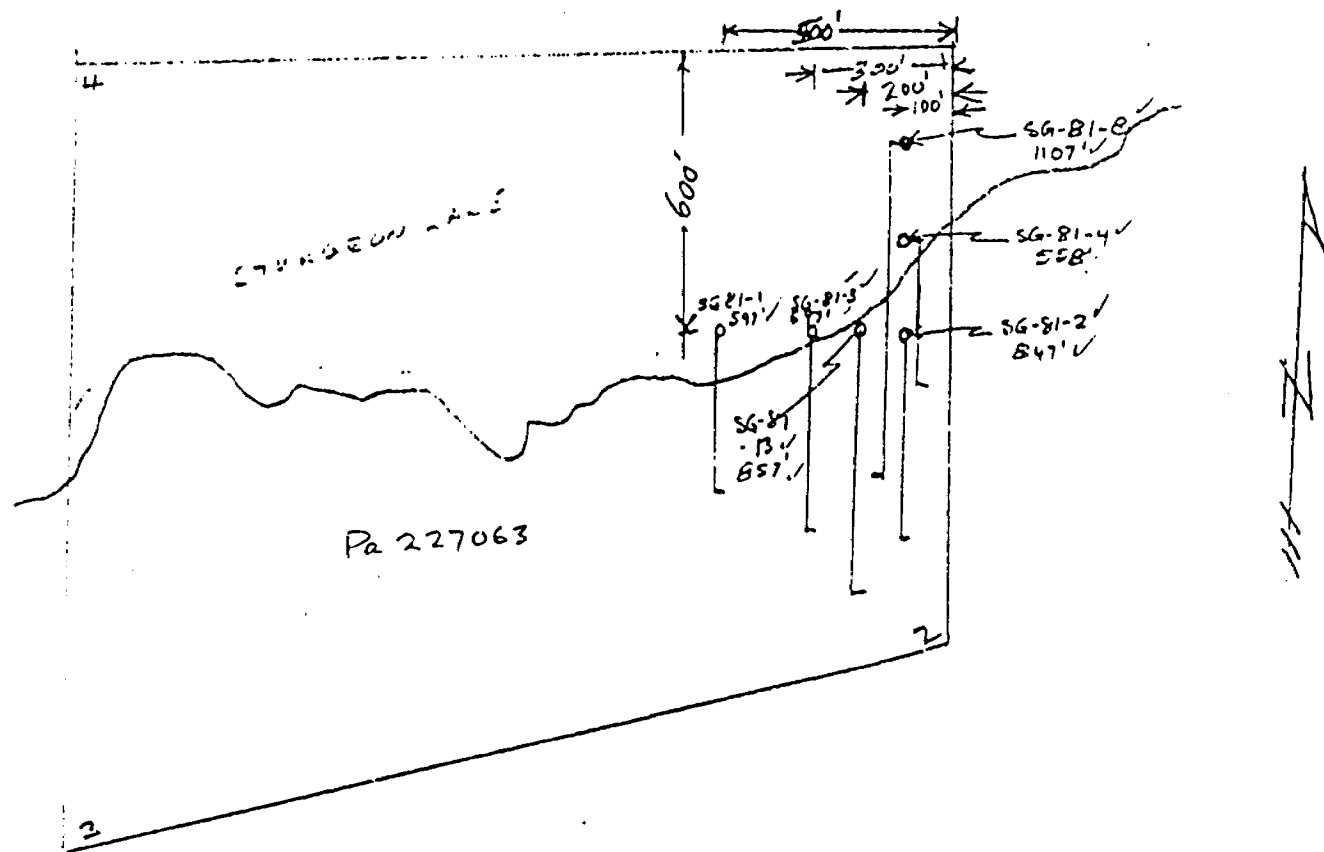

VALORA LAKE
 S2 G/14SE
 M-2052
 scale
 400 FT.

- HOLE NO. SG-81-1
 SG-81-2
 SG-81-3
 SG-81-4
SG-81-8
 SG-81-13

TRG
 30/6/82
 Tom Sledziew

PROPERTY Seagull Sturgeon Lake CLAIM _____
 ALTITUDE 6 + 00S STARTED Mar. 11 /81
 DEPARTURE 4 + 00E FINISHED Mar. 18/81
 ELEVATION _____ TOTAL LENGTH 827

DEPTH	DIP	AZI.	DEPTH	DIP	AZI.
collar	65°	180	197	50	
107	61		707	37	
200	55		807	35	
300	53				
407	51				

HOLE NO. SG 81-9
 LOGGED BY G. Richmond
 CORE SIZE BQ
 SECTION 4E
 LEVEL _____

D.D.Co. _____

FROM	TO	DESCRIPTION	SAMPLE NO	FROM	TO	LENGTH					
0	100	Casing in lake and overburden									
100	120	Grey massive tuff, moderate chloritic, a few quartz carbonate veins. A number of stringers and blebs of pyrite. Foliation about 45° c.a.									
120	177	Intermediate to acid bedded tuff, some lapilli bands, most of section highly sericitic - blocky core. A number of stringers and blebs of pyrite - quite high overall. Foliation at 45° - 50°.									
177	195	Intermediate lapilli tuff, lapilli small & white in a chloritic matrix. Trace dissem. pyrite. Foliation continues about 50°.									
195	276	Siliceous? and sericitic bedded tuff, grading downwards into lapilli tuff. Light to med. grey in color, some qz-carbonate veins. Foliation pretty consistent at 45°. High dissem. and stringer pyrite up to 10%. Trace chalcopyrite as isolated blebs, and fine grained sphalerite? in pyrite bands (may be magnetite?) Matrix of lapilli tuff quite chloritic from 266 - 276		217	221	4.7					
276	299	Siliceous? and sericitic banded tuff to massive tuff. Some stringers and large blebs of pyrite. Foliation very strong at about 60°. Trace chalcopyrite 294-297 brecciated by qz- 10 veins.									
299	315	Andesitic flow of fine grained uniform tuff, chloritic matrix with white speckles contacts fairly sharp. Foliation weaker about 70° - 80°.									
315	341	Grey massive tuff to bedded tuff. Quite sericitic in places. Some fine lapilli bands. Blocky core: foliation strong at about 60° to c.a.									
		-gradual contact.-									

TRE

PROPERTY Seagull Sturgeon Lake CLAIM
 ALTITUDE 6 + 00S STARTED _____
 DEPARTURE 4 + 00 FINISHED _____
 ELEVATION _____ TOTAL LENGTH _____

DEPTH	DIP	AZI.	DEPTH	DIP	AZI.

HOLE NO. SG 81-9
 LOGGED BY G. Richmond
 CORE SIZE BQ
 SECTION _____
 LEVEL _____
 Page 2 of 3

D.D.Co. _____

CORE FOOTAGE		DESCRIPTION	SAMPLE NO.	FROM	TO	LENGTH			
FROM	TO								
341	362	Chloritic lapilli tuff, lapilli to 2-3 cm. Some lapilli highly pyritized. Foliation at 60° to c.a. Foliation varies from 45° - 60°.							
362	444	Siliceous and strongly sericitic bedded tuff, a few small pale lapilli and some bands of chlorite. Possibly traces of graphite. A few stringers, disseminated grains, and wispy patches of pyrite but fairly sparse overall. Foliation quite strong at about 50°.							
-----		----- dist contact -----							
444	495	Chloritic lapilli tuff, quite uniform, mean lapilli size about 1 cm. Broken by a few later qz veins. Foliation quite strong about 60°. Blocky core 485-495. A number of bands of fine grained pyrite 472 - 486, elsewhere a few dissem grains.							
indistinct contact									
495	535	Lapilli tuff, matrix less chloritic and lapilli much larger and more varied in size. Quite sericitic in places. Lapilli up to 2" or more (tuff brxx) Only traces of pyrite. Foliation quite strong at 60° - 70° to c.a.							
535	565	Bedded sericitic tuff, some hematite staining, a few small lapilli. Section heterogeneous - varies from finely bedded to lapilli tuff to tuff breccia rather erratically. Perhaps at transition zone between units above and below. Strong foliation @ 70°. Sulfides very sparse.							
565	587	Siliceous and sericitic fine bedded tuff. Some wisps of chlorite and a few small indistinct lapilli. Core undersize from 567-577 - burnt bit? Rather indistinct contacts of an interfingering nature? Core blocky - Foliation strong @ about 70°.							
587		Quartz crystal rich lapilli tuff - quartz eye fragmental. Some sections of sil-sericitic bedded tuff as well, but lapilli tuff predominates. More distinctly rhyolite. Foliation still About 70°							

TRG

PROPERTY Seagull Sturgeon Lake CLAIM
 ELEVATION 6 + 00S STARTED _____
 DEPARTURE 4 + 00 FINISHED _____
 ELEVATION _____ TOTAL LENGTH _____

DEPTH	DIP	AZI.	DEPTH	DIP	AZI.

HOLE NO. SG 81-9
 LOGGED BY _____
 CORE SIZE _____
 SECTION _____
 LEVEL _____

D.D.Co. _____

CORE FOOTAGE		DESCRIPTION	SAMPLE NO	FROM	TO	LENGTH			
FROM	TO								
		but weaker, except in sericitic bands. Some bands and dissem. pyrite also a few grains chalcopyrite. Int. sills? 644.5-645.7 and 647.8-651.2 (approx. footages) - May be near a lower contact as qz-sericite tuff, increasing again.							
537	827 END	Above description amended: sequence is intercalated qz-sericite bedded tuff, and lapilli tuffs often with (mud chips) and quartz-crystal rich fragmentals: Some quartz crystals are blue quartz "eyes". Ratio of bedded tuffs to fragmentals tends to increase with depth. A few later quartz veins; one at 685 contains a bleb of chalcopyrite. Otherwise little visible sulfides except the occasional stringer and minor dissem. pyrite. Foliation quite strong, from 70° - 80° c.a.							
		ground & drilled over core 666 - 670 extremely blocky 770-778							

PATRICIA MINING DIV.
RECEIVED
 JUL 15 1982
 P.M.
 8 9 10 11 12 1 2 3 4 5 6

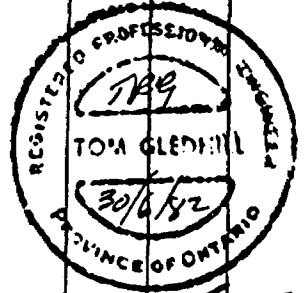

Tom Gledhill

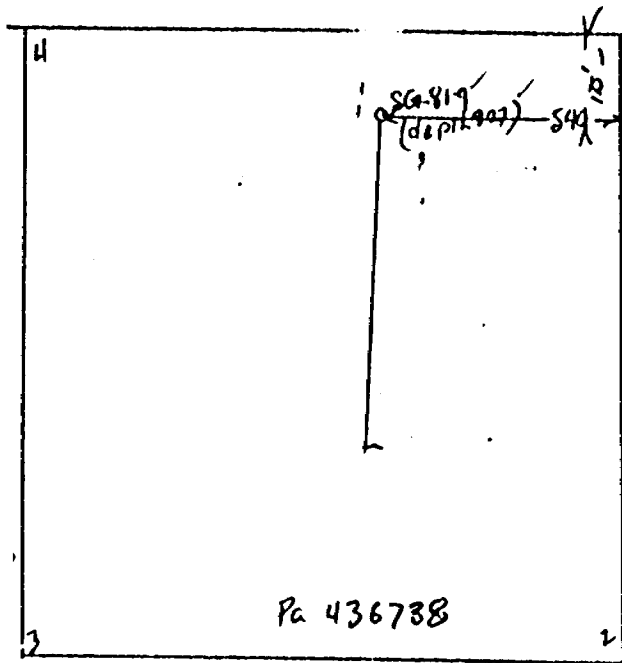

HOLE NO. SG-81-9

1" = 400'

VALORA LAKE
 S2G/14SE
 M-2052
 Scale
 400 FT.

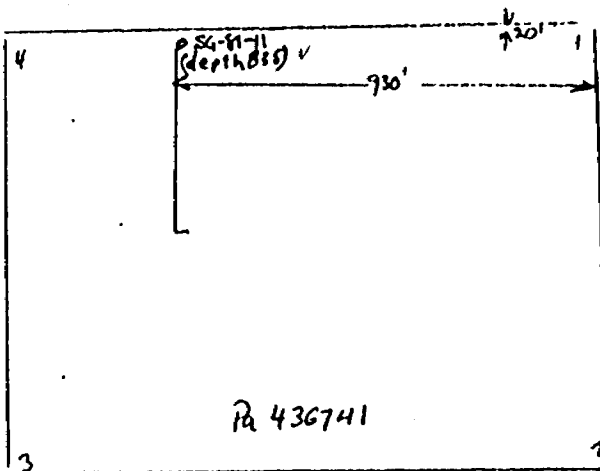

HOLE NO. SG-81-11

PROPERTY Seagull Sturgeon Lake CLAIM _____
 LATITUDE 37 + 00N STARTED March 13/81
 DEPARTURE 120 + 60E FINISHED March 16/81
 ELEVATION _____ TOTAL LENGTH 297

DEPTH	DIP	AZI.	DEPTH	DIP	AZI.
collar	65°				
100	65°				
200	62°				
297	59°				

HOLE NO. SG 81-10
 LOGGED BY G. Richmond
 CORE SIZE B0
 SECTION 120E
 LEVEL _____

D.D.Co. _____

CORE FOOTAGE		DESCRIPTION	SAMPLE NO	FROM	TO	LENGTH			
FROM	TO								
0	110	casing in lake overburden							
110	195	Intermediate massive to lapilli tuff, First two boxes quite weathered and hematite stained. Ground core 123 - 124, 110 - 123 very blocky, some ground. Blocky core 137 - 139, 142 - 144. Lower contact of unit is gradual. Strong foliation @ 40° to c.a. Strong hematite stain 189 - 195.							
195	212	Similar to above but fairly well-bedded. Foliation strong at about 40°. Traces only of pyrite.							
212	297	Highly chloritic andesite? Flows, in places amygdaloidal. May be a few tuff bands. Textures not well preserved. Heavily dotted with minute white specks of clay minerals, and specks of dissem. pyrite near bottom. Met. qz-carb veins common.							
		LOST HOLE							

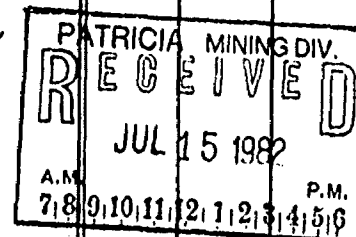

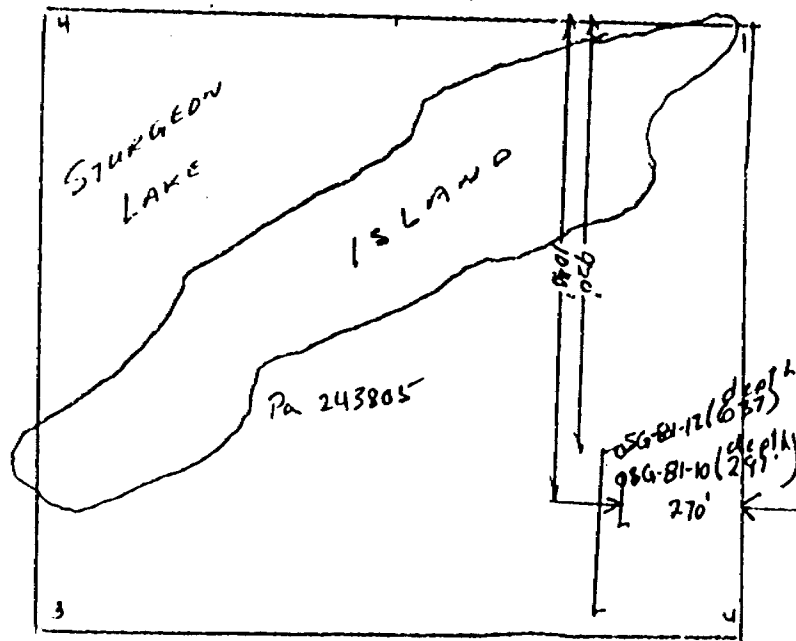

HOLE - NO. SG-81-10 & SG-81-12

VALORA LAKE

S2G/14SE

M-2052

scale

400 FT.

1" = 400'

PROPERTY Seagull Sturgeon Lake CLAIM _____

ALTITUDE 7 + 00S STARTED Mar 18, 1981

DEPARTURE 40 + 00E FINISHED Mar 25, 1981

ELEVATION _____ TOTAL LENGTH 835

DEPTH	DIP	AZI.
collar	65	180
200	70	
300	67	
400	62	
500	58	

DEPTH	DIP	AZI.
600	53	
700	59	
800	50	

HOLE NO. SG 61

LOGGED BY G. Ric

CORE SIZE BQ

SECTION 40E

LEVEL _____

D.D.Co. _____

CORE FOOTAGE		DESCRIPTION	SAMPLE NO	FROM	TO	LENGTH			
FROM	TO								
0	159	casing in lake; overburden, Lake = 63' along casing							
159	172	Mafic fragmental volcanic, blocky core. Essentially nil sulfides.							
172	212	Weakly to moderately foliated feldspar porphyritic monzonite? Feldspars slightly saussuritized? Matrix strongly chloritized little or no quartz. Some sections fine grained massive (matrix).							
212	264	Essentially same rock as above, but more or less pinkened, probably by hematite. 216-220 appears same composition, but fine grained and highly foliated. Maybe a dike.							
264	330	Feldspar porphyritic monzonite; phenocrysts up to 1cm, but most about 0.25cm. Not notably pinkened. Feldspar alteration varies from weak to moderate. Section fairly uniform, but scarce grains of disseminated pyrite, often on fracture surfaces. Minor qz. veining. Andesite dikes: 269.6-271.0 (WR) 272.0-272.2, 273.0-273.2, 328.8-329.0, 329.5-329.7							
330	367	Transitional to rhyolite? qz eyes becoming much more numerous, last box of lot probably same unit as above but more intensely foliated. A few large qz. eyes. Traces of pyrite, some bleaching and pinkening. Feldspars more altered and flattened, resembles fine lapilli tuff, but too uniform? Andesite dike 347.5-399							

TRG

PROPERTY Seagull Sturgeon Lake CLAIM _____
 ALTITUDE _____ STARTED _____
 DEPARTURE _____ FINISHED _____
 ELEVATION _____ TOTAL LENGTH _____

DEPTH	DIP	AZI.	DEPTH	DIP	AZI.

D.D.Co. _____

HOLE NO. SG 0111
 LOGGED BY _____
 CORE SIZE _____
 SECTION 40E
 LEVEL _____

Page 2 of 4

CORE FOOTAGE		DESCRIPTION	SAMPLE NO.	FROM	TO	LENGTH			
FROM	TO								
367	406	Feldspar porphyritic monzonite. Phenocrysts somewhat saussuritized, variably corroded. A few qz eyes < 1%. Chloritic matrix. Moderately foliated @ about 45° to c.a. Trace only of pyrite							
406	420	Contact zone of intrusion? Becoming bleached and pinkened, and more highly altered. Contact with lower unit indistinct. Becoming more blocky, foliation at 50° - 60° to c.a. strong fracture (minor fault?) at about 5° to c.a. has broken up core badly. 0.5cm qz. vein @ 415 with blebs of pyrite, trace chalcopyrite.							
420	469	Siliceous bedded tuff and lapilli tuff, some sericite. Strongly foliated at 45°-50° to c.a. Cream to pale pink in colour, small white lapilli. Minor disseminated pyrite, and a few small quartz eyes. Grades? Into unit below, poor contact.							
469	479	Amygdaloidal and massive intermediate to acid flows. Amygdaloidal 469-474 and 477-479. Tuff band 476.7-477.0 Amygdales white carbonate; samples 471, 476 (specimen) Foliation continues strong at about 50°, Only traces of pyrite.							
479	493	Siliceous tuff, possibly some rhyolite flows? Fine grained, sericitic, some flattened white lapilli and a few wisps of chlorite. Trace disseminated pyrite. Foliation strong at 50°-60° to c.a. Similar to unit logged as 'speckled tuff' in holes on shore.							
493	507	Qz-eye siliceous tuff. Colour cream to grey to pinkish. Abundant quartz eyes up to 5mm. - eyes slightly squarish (β qz) somewhat larger chlorite wisps as well. Trace only of disseminated pyrite. Foliation about 60° to c.a.							

TRG

PROPERTY Seagull Sturgeon Lake CLAIM _____

ALTITUDE _____ STARTED _____

DEPARTURE _____ FINISHED _____

ELEVATION _____ TOTAL LENGTH _____

DEPTH	DIP	AZI.	DEPTH	DIP	AZI.

D.D.Co. _____

HOLE NO. SG 81-11

LOGGED BY _____

CORE SIZE _____

SECTION 40E

LEVEL _____

Page 3 of 4

CORE FOOTAGE		DESCRIPTION	SAMPLE NO.	FROM	TO	LENGTH			
FROM	TO								
507	550	Heterogeneous tuff zone. Varies from massive siliceous tuff to qz eye tuff to chloritic tuff. Some sections strongly pinkened. Poker chip core. 515-517, ground about 1½' near 517. Foliation very strong, closer to 70° lower contact rather arbitrary.							
550	585	Well bedded grey siliceous tuff. A few quartz eyes and indistinct lapilli in places. At 565 a 1-2' band, quite light in colour, with quartz-rimmed carbonate and pyrite grains. Moderate sericite in section, however at about 584 there is a quartz carbonate vein with massive sericite in selvage. Trace disseminated pyrite. Foliation moderate-strong at 65° - 70°, gradational contact.							
585	630	Chloritic and sericitic tuff. Still moderately siliceous. Minor qz carbonate veining. Similar to "wispy chlorite fragmental". A few blebs and lenses of fine grained pyrite. Foliation continues moderate to strong at 65° - 70°. Lower contact fairly sharp-sudden absence of chlorite.							
630	660	Vaguely bedded to massive qz-sericite tuff. A few indistinct lapilli. A few qz. and tourmaline veins, notably at 646 and 652 the latter contains a few grains of chalcopyrite & bornite. Section as a whole is very uniform, with a sort of waxy yellowish-grey colour.							
660	686	Grey fragmental? Vague to distinct lapilli tuff. With siliceous sericitic matrix, with both siliceous and chloritic fragments, the latter by far most abundant. Moderate foliation about 70° to core axis.							

TFS

PROPERTY Seagull Sturgeon Lake CLAIM _____

ELEVATION _____ STARTED _____

DEPARTURE _____ FINISHED _____

ELEVATION _____ TOTAL LENGTH _____

DEPTH	DIP	AZI.

DEPTH	DIP	AZI.

HOLE NO. SG 81-11

LOGGED BY _____

CORE SIZE _____

SECTION 40E

LEVEL _____

D.D.Co. _____

Page 4 of 4

CORE FOOTAGE		DESCRIPTION	SAMPLE NO.	FROM	TO	LENGTH			
FROM	TO								
686	717	Bedded to massive siliceous and sericite tuff, a few quartz eyes and indistinct lapilli 707 - 712 slightly pinkened. Foliation strong at about 70°. Some kinking at 708							
717	835	Vaguely bedded to indistinct lapilli tuff, grey green in colour moderate siliceous 750-757 has a few stringers and lenses of pyrite, little elsewhere. Character of rock becomes bedded towards 815'. Foliation strong to intense -varies from 60°-70° - lower contact arbitrary.							
815	835	Very blocky: light to moderate grey massive to bedded quartz eye siliceous tuff. Foliation intense at 70°-80°. Traces of disseminated pyrite. Poker chip core, about 1' ground.							
End of hole									

PATRICIA MINING DIV
RECEIVED
 JUL 15 1982
 A.M. 7:18 9:10 11:12 1:12 3:14 5:16 P.M.

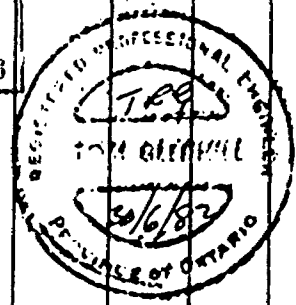

Tom Seddie

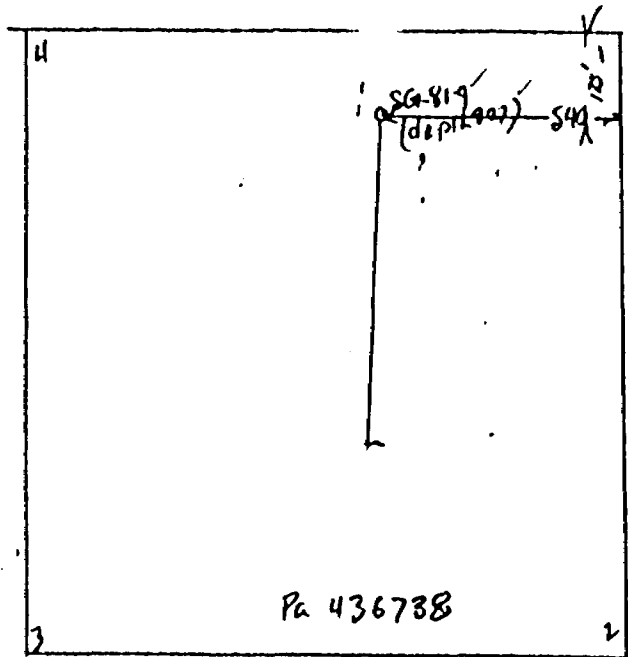

HOLE NO. SG-81-9

1" = 400'

VALORA LAKE
 S2G/14SE
 M-2052
 Scale
 400 Ft.

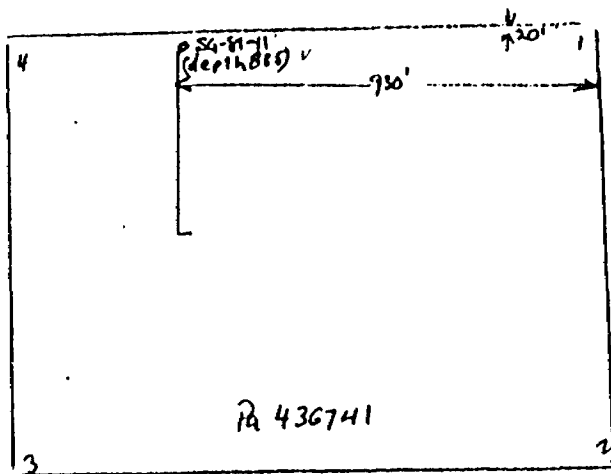

HOLE NO. SG-81-11

PROPERTY Seagull Sturgeon Lake CLAIM

LATITUDE 37 + 62N STARTED Mar 20, 1981

DEPARTURE 120 + 00E FINISHED Mar 25, 1981

ELEVATION _____ TOTAL LENGTH 637

DEPTH	DIP	AZI.	DEPTH	DIP	AZI.
collar	65		500	47	
127	63				
217	56				
307	54				
407	49				

D.D.Co. _____

HOLE NO. SG 81-12

LOGGED BY G. Richmond

CORE SIZE BQ

SECTION 120E

LEVEL _____

Page 1 of 4

CORE FOOTAGE		DESCRIPTION	SAMPLE NO.	FROM	TO	LENGTH			
FROM	TO								
0	121	Casing in Sturgeon Lake & overburden							
121	147	Poker chip quartz eyes siliceous tuff. Very delicately banded in colours of hem. pink, green & white foliation intense at 45° to core axis. Strong kink banding in places in a plane parallel to the long axis of the intersection ellipse and varying from 0-15° to core axis. 2 uncut core specimens 142 & 143.5 very blocky ground between 135 & 140? little or no sulfides.							
147	164	Rather indistinct contact, becomes gradually more massive and chloritic. 147-157 appears rather bleached. Amygdaloidal 149-152 and 157-158 - probably a section of basaltic or andesite flows, highly sheared and altered. Foliation continues very strong at 45° to c.a. and kink banding continues, through less distinct (due to more massive character of rock?) also higher angle to c.a. & ellipse of intersection.							
164	195	Amygdaloidal to massive flows (andesitic or more mafic) may include fine grained bedded tuffs. Carbonate veining moderate to intense along foliation. No great break from unit above. Rock is so intensely sheared and chloritized that exact I.D. is very nearly impossible. Kink banding seen at diverse angles - 90° to c.a. and a very low angle. Conjugate kinking? Long specimen 190.0 about 192.0 - not cut.							

TRG

PROPERTY Seagull Sturgeon Lake CLAIM _____
 ALTITUDE _____ STARTED _____
 DEPARTURE _____ FINISHED _____
 ELEVATION _____ TOTAL LENGTH _____

DEPTH	DIP	AZI.	DEPTH	DIP	AZI.

HOLE NO. SG R1-12
 LOGGED BY _____
 CORE SIZE _____
 SECTION 120E
 LEVEL _____

D.D.Co. _____

CORE FOOTAGE		DESCRIPTION	SAMPLE NO	FROM	TO	LENGTH			
FROM	TO								
-195	210	Bedded tuff? varies from obviously chloritic to possibly moderately siliceous. Most of this unit is very fine grained, and hematite stained. Veinlets and lenses of magnetite along foliation - some ptymatically folded magnetite stringers. Upper contact of zone denoted by first magnetite stringer, lower by sharp colour change. 1 section to be done for W.R.							
210	229	Bedded intermediate tuff, possibly some thin flows. Some bands hematite stained around 217 & 231. Foliation quite strong at about 45°. A few small quartz eyes and the usual foliation veining. Ptygmatic quartz stringer about 218'. Very sparse disseminated pyrite.							
229	286	Amygdaloidal to massive andesite flows, (doubtful dike?) Quite a bright green colour, due no doubt to chlorite. A number of patches and veins of quartz or carbonate. Epidote in a fracture zone at 280, elsewhere as a few disseminated grains. Sparse to moderate disseminated pyrite and magnetite COLOUR BREAK Foliation weak to moderate at 45°.							
286	307	Massive dark green andesite, possibly andesitic tuff, contains fine grains of a buff coloured mineral that may be carbonate or possibly leucoxene. Foliation weak to moderate at 45° - Traces of disseminated pyrite & magnetite.							
307	320	Bedded intermediate tuff, possibly thin flows. Highly chloritic, considerable pinkish carbonate in lower 4'. Qz-Tg vein at 309 along foliation; moderate to strong @ 45°.							

TBG

PROPERTY Seagull Sturgeon Lake CLAIM _____

ALTITUDE _____ STARTED _____

DEPARTURE _____ FINISHED _____

ELEVATION _____ TOTAL LENGTH _____

DEPTH	DIP	AZI.	DEPTH	DIP	AZI.

D.D.Co. _____

HOLE NO. SG 81-12

LOGGED BY _____

CORE SIZE _____

SECTION 120E

LEVEL _____

Page 3 of 4

CORE FOOTAGE		DESCRIPTION	SAMPLE NO.	FROM	TO	LENGTH			
FROM	TO								
320	328	Andesite flow? Dark green highly chloritic, many irregular wisps of carbonate that may be deformed amygdales. Foliation moderate about 50°-60°. Very minor disseminated pyrite & magnetite.							
328	355	Gabbro sill or massive andesite flow. Weakly foliated, more equigranular texture with grain size about 0.5mm. Little or no noticeable structure. A few carbonate and quartz carbonate veins, at odd angles to core axis, but general sub-parallel to foliation. At 337 a patch of fine grained epidote containing chloritized crystals of amphibole? Rock contains little magnetite or pyrite.							
355	360	Andesite flow? - same as 320-328 - both these units may be sheared contacts of gabbro sill.							
360	445	Intermediate tuffs, possibly some small flows. Generally distinctly bedded, may be some argillic sediments and greywacke. Probably all of volcanic origin. Inter-fingers to some extent with lower unit. Foliation quite strong at 45° to c.a., with locally some jointing at about 50° to core axis, facing the other way (i.e. rotated about core axis about 140°). Some hematite staining.							
445	500	"Poker chip" siliceous and sericitic to moderately chloritic quartz-eye bedded tuff. Chloritic sections a little more competent, all intensely foliated, with kink banding common, hematite stain common throughout sub-parallel to core axis. Traces of fine grained disseminated pyrite, quartz eyes small and scarce in chloritic zones, larger and abundant in sil-sericitic. Foliation intense at about 50° - lower contact arbitrary							

TRG

PROPERTY Seagull Sturgeon Lake CLAIM _____

ELEVATION _____ STARTED _____

DEPARTURE _____ FINISHED _____

ELEVATION _____ TOTAL LENGTH _____

DEPTH	DIP	AZI.

DEPTH	DIP	AZI.

HOLE NO. SG 81-1'

LOGGED BY _____

CORE SIZE _____

SECTION 120E

LEVEL _____

D.D.Co. _____

Page 4 of 4

CORE FOOTAGE		DESCRIPTION	SAMPLE NO	FROM	TO	LENGTH		
FROM	TO							
500	551	Upper contact of this unit is arbitrary, marked by absence of conspicuous quartz eyes - Multicoloured banded tuff. Varies from white to cherty through shades of pink to distinctly green and chloritic. Some very delicate colour banding (=bedding) quartz eyes scarce to absent otherwise very like above unit. 544-550 has high - moderate disseminated pyrite, Assayed - kink banding not well developed, some shearing in the same direction.						
551	609	Mostly "poker chip" siliceous and sericitic bedded quartz-eye tuff, intensely foliated at about 50° to core axis, very blocky core. Several small amygdaloidal andesite flows? between 551 & 560. Kink banding not well developed, but fracturing and shearing at low angles to core axis can be seen reflecting stresses in the same general direction. Well laced with small quartz eyes little or no sulfides.						
609	637	Rather imperceptible change from unit above. Lapilli just slowly grow more abundant and bedding becomes indistinct. "heteroclastic" lapilli tuff. A variety of white, green and pinkish lapilli in a grey matrix. A variety in size as well as colour. Still slightly siliceous. No noticeable sulfides.						
end of hole								

PATRICIA MINING DIV.
RECEIVED
 JUL 15 1982
 P.M.
 A.M. 7:8:9 10:11:12 1:2:3 4:5:6

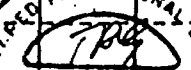
REGISTERED PROFESSIONAL ENGINEER

 TOM GLEDHILL
 30/6/82
 PROVINCE OF ONTARIO

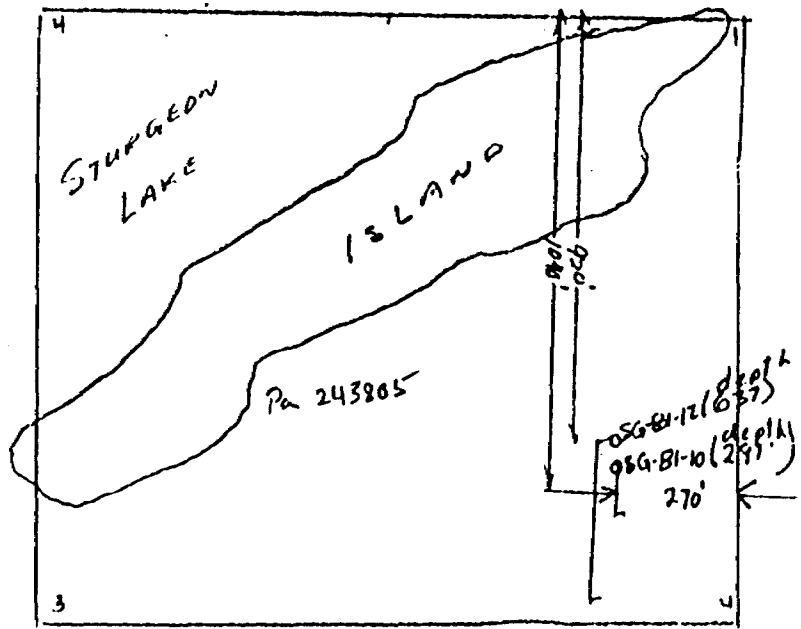
T. Gledhill TRS



HOLE - NO. SG-81-10 &

SG-81-12

VALORA LAKE

S2G/14SE

M-2052

scale

400 FT.

1" = 400'

PROPERTY Seagull Sturgeon Lake CLAIM _____
 ALTITUDE 18 + 50N STARTED Mar 26, 1981
 DEPARTURE 115 + 00E FINISHED Mar 30, 1981
 ELEVATION _____ TOTAL LENGTH 857

DEPTH	DIP	AZI.	DEPTH	DIP	AZI.
collar	80	180	600	47	
200	73		700	45	
300	65		800	43	
400	59				
500	52				

HOLE NO. SG 81-13
 LOGGED BY G. Richmc
 CORE SIZE BQ
 SECTION 115 East
 LEVEL _____

DD Co. _____

Page 1 of 6

CORE FOOTAGE		DESCRIPTION	SAMPLE NO	FROM	TO	LENGTH		
FROM	TO							
0	50	Casing						
50	102	Moderately chloritic tuff and lapilli tuff. Foliation moderate to strong about 40° to c.a. Quite fractured, blocky core. Vuggy quartz veins, - ground water leaching of pyrite.						
102	153	Grey to greenish grey massive tuff and lapilli tuff, moderately chloritic. Disseminated and stringer pyrite throughout. Foliation weak 35°-40°. A few quartz stringers containing grains of pyrite and rare chalcopyrite. Overall considerable carbonate?						
153	166.7	Grey green cherty tuff with wisps of chlorite abundant along foliation (about 40° to c.a.) Carbonate distinct in places, probably more than meets the eye. Pyrite quite high as stringers and disseminated grains.						
166.7	169.1	Massive moderate to fine grained greenish grey andesite? Possibly a flow, as lower contact appears chilled, and the upper one is not. Grains of disseminated pyrite - most likely a dike.						
169.1	171.3	Grey green cherty tuff as above.						
171.3	175.2	Andesite as above, probably a dike or sill.						
175.2	176.1	Grey green cherty tuff as above						
176.1	178.2	Andesite? as above - sill or dike						

TRG

PROPERTY Seagull Sturgeon Lake CLAIM _____
 ALTITUDE _____ STARTED _____
 DEPARTURE _____ FINISHED _____
 ELEVATION _____ TOTAL LENGTH _____

DEPTH	DIP	AZI.	PLIN	VIF	QAL.

LOGGED BY _____
 CORE SIZE _____
 SECTION 115 E
 LEVEL _____

DD Co. _____

CORE FOOTAGE		DESCRIPTION	SAMPLE NO	FROM	TO	LENGTH		
FROM	TO							
178.2	187	Cherty tuff with wispy chlorite as above, but stained to pink by hematite. Pyrite as stringers, disseminated grains and wispy fine grained patches. Foliation strong at about 40°, blocky in places.						
187	247	Imperceptible change from above unit. Cherty tuff, a bit more chloritic than above and chlorite less wispy - more diffuse. Pyrite continues high as stringers and disseminated grains. Some quartz-carbonate and qz-carb. - TØ veins with a few contained grains of chalcopyrite. Foliation moderate at about 45°.						
247	257	Cherty tuff with high pyrite, not distinctly bedded - generally stained pink with hematite. Foliation moderate at 40°-45° to c.a.						
257	302	Somewhat less siliceous and more chloritic massive tuff and lapilli tuff. Possibly bedded in places, but neither bedding nor lapilli are any place distinct. Presents a generally mottled and marbled appearance. Probably contains considerable carbonate alt'n. Foliation weak about 50° + ? often breaks across foliation. Minor disseminated pyrite, a few qz-carb veins along foliation, especially in the last 10' or so, which is fractured and blocky with signs of ground water leaching.						
302		Generally confused succession of cherty tuffs as above and intermediate flows or intrusions, probably flows. (or both) Intermediates vary in grain size sometimes show chilled contacts, sometimes not. Some quartz stringers across foliation. Some sections appear to be bedded and there are numerous pink carbonate bands. Some material appears amygdaloidal. Andesitic material						

TRG

PROPERTY Seagull Strugeon Lake CLAIM _____

ELEVATION _____ STARTED _____

DEPARTURE _____ FINISHED _____

ELEVATION _____ TOTAL LENGTH _____

DEPTH	DIP	AZI.

DEPTH	DIP	AZI

HOLE NO. SG 81-13

LOGGED BY _____

CORE SIZE _____

SECTION 115 E

LEVEL _____

D.D.Co. _____

Page 3 of 6

CORE FOOTAGE		DESCRIPTION	SAMPLE NO.	FROM	TO	LENGTH			
FROM	TO								
360	405	Massive (lapilli??) tuff, generally grey, with wispy chlorite. Not so patchy in appearance as tuffs above. Pyrite moderate to high, especially 366.8-nearly massive. Foliation weak at 45° to c.a. Becomes very siliceous about 395-402 with stringers and patches of chalcopyrite. Assay 395-405, 2" qz-carb-t _g veins at 395.5 with minor chalcopyrite. Main chalcopyrite zone is quite cherty, almost a blue grey colour.							
405	490	Grey fragmental, usually recognizable lapilli tuff. A little darker in colour than unit above. Lapilli most distinct at top of section, gradually becoming indistinct, with a few exceptional zones. Much of this zone is quite massive. Sparse sulfides, mainly pyrite as blebs or disseminated grains. A few small qz-carb veins along foliation, which is weak to moderate at 45° to c.a. Intermediate dike with chilled contacts 442.8-444.5 from 470-490, grey fragmental is essentially massive.							
490	526	Rather sharp upper contacts; distinct lapilli visible in grey fragmental below 490. Change appears to be mainly textural. Continues to be moderately siliceous. Chloritoid begins to be noticeable, often as a few grains within single lapilli, and notably as a diffuse vein about 15° to c.a. @ 552. Foliation weak at about 50° - rock often breaks across it. Sulfides generally quite sparse. Minor chalcopyrite in ¼" qz vein at 523'.							
526	542	Dike zone: Massive and lapilli tuff as above cut by a number of intermediate dikes with chilled contacts. Curiously, the two larger dikes (527-528.4) & (532.5-534.1) are neatly bisected by qz-carb veins.							

T.P.C.

PROPERTY Seagull Strugeon Lake CLAIM _____

ALTITUDE _____ STARTED _____

DEPARTURE _____ FINISHED _____

ELEVATION _____ TOTAL LENGTH _____

DEPTH	DIP	AZI.

DEPTH	DIP	AZI.

HOLE NO. SG 81-13

LOGGED BY _____

CORE SIZE _____

SECTION 115 E

LEVEL _____

D.D.Co. _____

Page 4 of 6

CORE FOOTAGE		DESCRIPTION	SAMPLE NO	FROM	TO	LENGTH			
FROM	TO								
542	563	Upper contact sharply marked by sudden absence of lapilli: Virtually featureless massive grey tuff; could possibly be flow. Qz.-filled tension veins about 0-5° to c.a. at 543 most noticeable feature. Lower contact abrupt.							
563	586	Lapilli-chloritoid zone. Well developed lapilli tuff with pervasively disseminated grains of chloritoid. Very weak foliation Lapilli quite variable in size, mostly pale in a grey green matrix. Lower contact quite sharp.							
586	668	Massive tuff, grey to green grey, lapilli visible. Rock appears more basic than above. Indistinct banding noticeable about 606. Foliation weak to moderate @ 45°. 594-597 a few very narrow stringers of pyrite and chalcopyrite along foliation. Most included in W.R.A. Below 597, a number of small qz-carb veins mostly along foliation but some apparently younger are contrary esp. at 606.5 where foliation & foliation veins are about 50° and a cross cutting tension vein is at about 35° to c.a. and rotated about 85° from foliation (Foliation 090, tension 160/55E) 70N							
668	672	Fine grained pale green dike or sill. Mafic minerals appear as needles of chlorite along foliation. Rock was perhaps porphyritic ground mass very fine grained. Foliation weak about 70° to c.a. Slightly chilled contacts.							
672	678.5	Chloritic vague lapilli tuff. Appears to be slightly more mafic than average at 556-668. Weakly foliated A about 70°.							

TR9

PROPERTY Seagull Sturgeon Lake CLAIM _____
 ALTITUDE _____ STARTED _____
 DEPARTURE _____ FINISHED _____
 ELEVATION _____ TOTAL LENGTH _____

DEPTH	DIP	AZI.	DEPTH	DIP	AZI.

D.D.Co. _____

HOLE NO. SG 81-13
 LOGGED BY _____
 CORE SIZE _____
 SECTION 115 E
 LEVEL _____
 Page 5 of 6

CORE FOOTAGE		DESCRIPTION	SAMPLE NO.	FROM	TO	LENGTH			
FROM	TO								
678.5	680.5	Intrusion as in 668-672 - probably a sill. Chilled contacts, some possible bleaching of wall rock. Intrusion contains very minor disseminated pyrite. Contacts very irregular (Fracture).							
680.5	698.0	Chloritic massive to vague lapilli tuff. Much as 672-678.5. Foliation-controlled: qz-carb veins are about 40° to c.a.							
698.0	703.0	Fine grained amygdaloidal (in places) mafic flows. Very fine grained highly chloritic rock, a few possible amygdaloids of carbonate. A few blebs and grains of chalcopryrite and pyrite especially in contacts. Contacts within this zone appear to run at 35°-45° to c.a. while foliation is weak at 60°. Relationship would indicate an easterly plunge of ~15°.							
703.0	709.0	Chloritic fragmental. Foliation weak about 50°?							
709.0	718.8	Pale green fine grained, slightly porphyritic dike. Would appear to be at least as acid as andesite. Dacite? Upper contact (w.r.t.hole) is chilled, with 1" bleached wall rock, lower contact obscured by qz-carbonate vein along it. Contacts are both about 35° to c.a. Foliation within dike is weak at about 60°-65°. There appears to be another fabric at about 35° marked by pale bands, possibly old joints? Suite specimen is characteristic (714.9-715.9).							
718.8	743.0	Chloritic vague fragmental massive - no distinct lapilli - appears to be made up of mostly chlorite and carbonate. Not too dissimilar to fragmentals above. Foliation is weak at 50°-60°. No significant sulfides.							

TRP

PROPERTY Seagull Sturgeon Lake CLAIM _____

ALTITUDE _____ STARTED _____

DEPARTURE _____ FINISHED _____

ELEVATION _____ TOTAL LENGTH _____

DEPTH	DIP	AZI.	DEPTH	DIP	AZI.

DD Co. _____

HOLE NO. SG 81-13

LOGGED BY _____

CORE SIZE _____

SECTION 115 E

LEVEL _____

Page 6 of 6

CORE FOOTAGE		DESCRIPTION	SAMPLE NO	FROM	TO	LENGTH			
FROM	TO								
743.0	745.0	Intensely chloritic shear zone? At about 5-10° at c.a. Boudinaged carbonate stringers, and some clay minerals. Foliation carbonate vein @ about 45° cross cuts.							
745.0	787.0	Grey fragmental? Massive and lapilli tuff, lapilli often quite distinct, grey to greenish grey in colour. Distinctly different from 718.8-743.0. Strongly foliated (45°) and blocky 775-777. Appears to be getting more siliceous with depth. Lower contact purely arbitrary on the basis of noticeable chloritoid.							
787.0	827.0	Chloritoid rich grey fragmental lapilli tuff to massive tuff. Chloritoid as wispy stringers and disseminated grains (porphyroblasts). Rock is foliated @ about 45° to c.a., as often as not breaks contrary. Little or no sulfides, carbonate abundant: Contacts are arbitrary in the basis of noticeable chloritoid.							
827		Wispy chlorite fragmental. Massive to lapilli tuff, wispy chlorite along foliation, which is still about 45°. Rock appears to be high in carbonate. Last 8 feet or so are increasingly hematite stained and vuggy, probably due to ground water leaching. Contains traces of disseminated pyrite.							
		end of hole							

PATRICIA MINING DIV.
RECEIVED
 JUL 15 1982
 A.M. P.M.
 7:8:9:10:11:12:1:2:3:4:5:6

REGISTRATION OF PROFESSIONAL ENGINEERS
 T.M. GLENNIE
 30/6/82
 PROVINCE OF ONTARIO
Tom Glennie

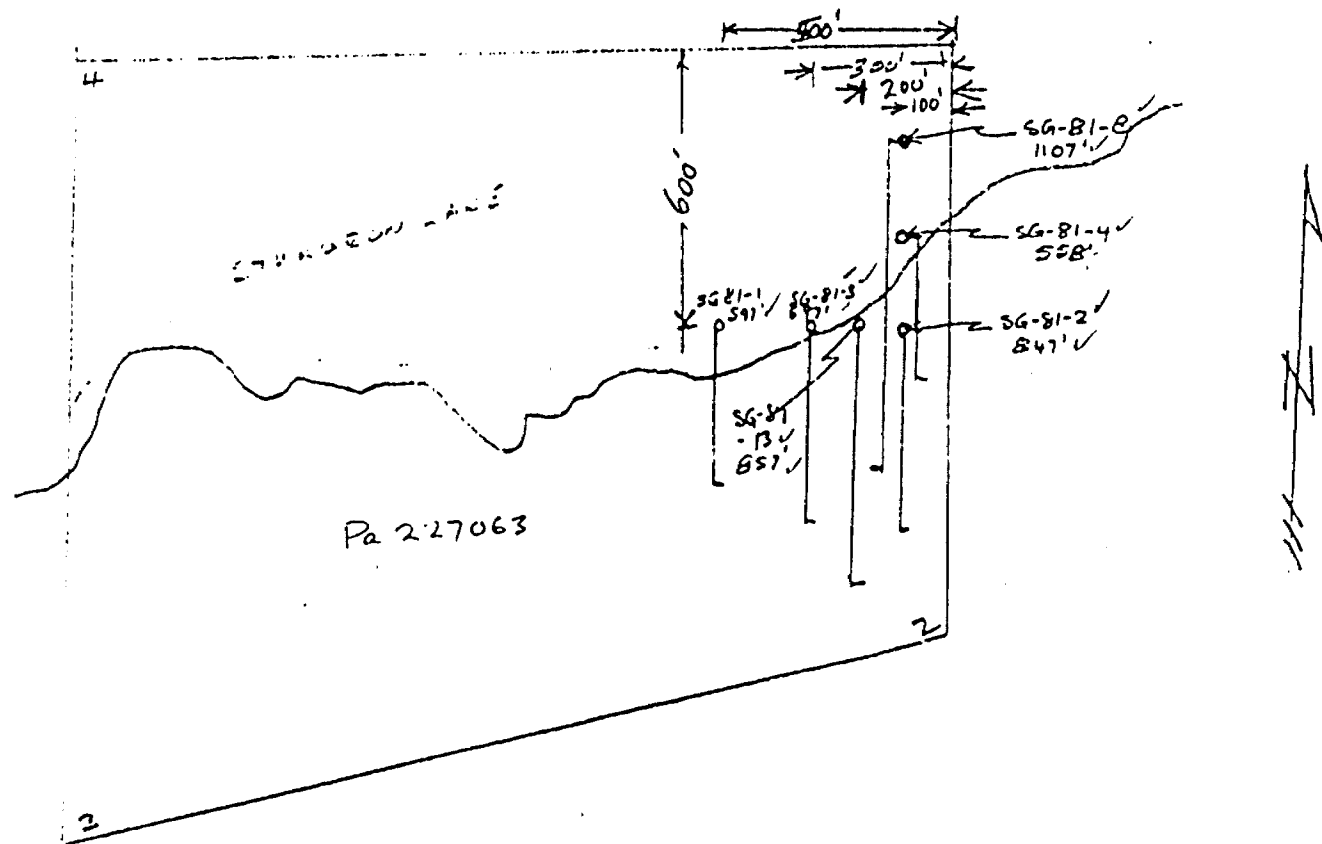

VALORA LAKE
 S2 G/14SE
 M-2052
 1" scale
 400 FT.

HOLE NO. SG-81-1

SG-81-2

SG-81-3

SG-81-4

SG-81-8

SG-81-13

TKG

20/6/82

Tom Stedman

PROPERTY Seagull Sturgeon Lake CLAIM _____
 LATITUDE 16 + 50N STARTED Mar 31, 1981
 DEPARTURE 119E FINISHED Apr 4, 1981
 ELEVATION _____ TOTAL LENGTH 847 ✓

DEPTH	DIP	AZI.
collar	80	180
97	77	
200	74	
300	70	
407	66	

DEPTH	DIP	AZI.
507	61	
600	59	
700	55	

HOLE NO. SG 81-14 ✓
 LOGGED BY G. Richmond
 CORE SIZE B0
 SECTION 119E
 LEVEL _____
 Page 1 of 5

DD Co. _____

CORE FOOTAGE		DESCRIPTION	SAMPLE NO	FROM	TO	LENGTH			
FROM	TO								
0	37	Casing in overburden							
37	52	Moderately siliceous grey lapilli tuff. Foliation fairly weak & varies 35°-45° to core axis. A few small quartz & qz-carb veins, one of which, at 46' has a small stringer of chalcopyrite. There are also some large blebs of pyrite, which appears to fragments. Lower contact not distinct.							
52	75	Vague lapilli to indistinctly bedded cherty tuff. Mottled appearance varies from green to grey to yellowish white, some iron staining. Foliation continues to be fairly weak at 40°. Still a few quartz carbonate veins; should be fairly siliceous. Both contacts of this unit are rather arbitrary based on lapilli and colour.							
75	92	Grey lapilli tuff. Pale lapilli in a grey matrix. Foliation weak to moderate at about 45° to c.a. Trace disseminated pyrite, and a few grey cherty layers- ?exhalites?							
92	106	Bedded to massive tuff. Upper contact quite sharp, lower also. Fine grained, grey, bedding distinct to vague, a few zones possible lapilli. Bedding and foliation essentially = at 45°.							

TRG

PROPERTY Seagull Sturgeon Lake CLAIM _____

ELEVATION _____ STARTED _____

DEPARTURE _____ FINISHED _____

ELEVATION _____ TOTAL LENGTH _____

DEPTH	DIP	AZI.	DEPTH	DIP	AZI.

D.D. Co _____

HOLE NO. SG 81-14

LOGGED BY _____

CORE SIZE _____

SECTION 119 E

LEVEL _____

Page 2 of 5

CORE FOOTAGE		DESCRIPTION	SAMPLE NO	FROM	TO	LENGTH			
FROM	TO								
106	194.2	Fine grained disseminated pyrite, and hematite stain is common. Foliation appears to be moderate to strong at 45°. From 119-124 is rhyolite tuff? with bleached wall rock contacts, grain size is very small, with minor disseminated pyrite, and the odd quartz eye. Sill? is highly limonite stained at contacts and along fractures. Could possibly be a cherty tuff, less likely intrusion. From about 180-194 there are stringers or wisps of fine grained pyrite with occasional traces of chalcopyrite that may be fragments of bedded sulfides.							
194.2	197.5	Fine grained massive pale greenish grey rock, uniformly foliated at about 45°. Bleaching within unit at contacts suggests chilled margins; this is probably a dike or <u>sill</u> .							
197.5	225	Hematite stained bedded tuff. Interval contains several small intrusions similar to unit above. Bedding varies from relatively undisturbed to highly contorted over intervals as short as 0.5' suggesting the possibility at least of soft sediment deformation. Rock contains dark green highly chloritic bands and white to pink bands rich in quartz or carbonate and stained by hematite, giving a very distinctive marbled look. Included in this unit is a zone of disrupted beds of fine grained pyrite and possibly sphalerite, from about 204-207. Elsewhere wisps of fine grained sulfides. Foliation is about 43° to c.a.	3313	205-	208				
			3314	209-	213				
225		Vaguely bedded siliceous tuff to tuff breccia. Only a few large fragments. At 237 some funny granular - looking carbonate fragments with disseminated pyrite similar to ones seen at <u>767</u> in hole <u>8</u> . Most of unit is a pale grey cherty (cont'd. next page)							

TRC

PROPERTY Seagull Sturgeon Lake CLAIM _____

ALTITUDE _____ STARTED _____

DEPARTURE _____ FINISHED _____

ELEVATION _____ TOTAL LENGTH _____

DEPTH	DIP	AZI.	DEPTH	DIP	AZI.

DDC# _____

HOLE NO. SG 81-14

LOGGED BY _____

CORE SIZE _____

SECTION 119 E

LEVEL _____

Page 3 of 5

CORE FOOTAGE		DESCRIPTION	SAMPLE NO	FROM	TO	LENGTH			
FROM	TO								
		matrix with wisps or ill-defined bands of chloritic material; fairly siliceous overall. Massive band from 260.5-263.5 may be rhyolite flow. Coarse grained intermediate flow from 265.1-268.8 with coarse grained pyrite. Below 267, rock appears the same composition, but a generally fine texture. Foliation weak-moderate at about 45°. Lower contact arbitrary							
287		Grey massive tuff to lapilli tuff. Bedding usually vague or nil. Foliation generally weak to moderate at 45° - 50°. Layering or banding (bedding) is at a lower angle, often nearly 0°, some rounded blebs of carbonate that may be lapilli and some pygmatic quartz-carbonate veins with minor pyrite & chalcopyrite. Some carbonate stringers contain chloritoid. Overall quite siliceous. From 324.5-328.0 there is a sill or dike of gneissic intrusive rock, possibly quartz monzonite? Upper contact badly fractured, lower is about 35° to core axis and rotated about 120° (counter clockwise) from foliation, looking down the hole (135/90)							
357.5		Fairly sharp upper contact to this zone: Finely laminated siliceous sericitic tuff. Intensely foliated at 45° to core axis. Distinct crenulation, with axial traces of crenulation about 20° from the long axis of the foliation ellipse, viewed in plane of foliation. (I would estimate the axial plane of crenulation to strike N20 (+ 10) E and dip 75° - 85° W) lower contact also sharp.							
363.4		Massive and structureless grey siliceous tuff, with locally a few wisps or stringers of chlorite. Weakly foliated about 50° to c.a. a few blebs of pyrite and chalcopyrite, but overall less than 1% sulfides.							

TR9

PROPERTY Seagull Sturgeon Lake CLAIM _____

ALTITUDE _____ STARTED _____

DEPARTURE _____ FINISHED _____

ELEVATION _____ TOTAL LENGTH _____

DEPTH	DIP	AZI.	DEPTH	DIP	AZI.

DD Co. _____

HOLE NO. SG 81 -1

LOGGED BY _____

CORE SIZE _____

SECTION 119 E

LEVEL _____

Page 4 of 5

CORE FOOTAGE		DESCRIPTION	SAMPLE NO.	FROM	TO	LENGTH			
FROM	TO								
		Pale coloured lapilli become fairly distinct locally below 400', and there are a few stringers? of chlorite with associated sulfides but on the whole sulfides are next to nil. At 461 there is a highly contorted qz-carb chlorite vein with minor pyrite & chalcopryrite. The quartz is exceptionally glassy and transparent. The lower contact of this unit is gradational & arbitrary.							
487									
487		Chloritoid Zone. The same rock essentially as above, but with conspicuous to abundant chloritoid, giving a definitely speckled appearance. There appears to be no preferred orientation, as is the case with wisps of chlorite. A few lapilli visible in lower part of section. Lower contact fairly sharp.							
	542								
542	560	Sudden absence of chloritoid. Grey massive - structureless tuff as in 363.4-487. Still quite highly siliceous Weakly foliated at about 50°. Lower contact fairly sharp (over about 1').							
560	580	Chloritoid bearing lapilli tuff as in 487-542, lower contact indistinct and gradational.							
580		Grey massive tuff, the only structures commonly seen being quartz carbonate veins along foliation, and occasional clusters & stringers of chloritoid grains. Chloritoid much reduced from previous section, but visible because of bland backgrounds. A zone from 554-558.8 appears to be lapilli tuff, and has some blebs and minute stringers of chalcopryrite 558.3 - 559.5 is massive, very fine grained rhyolite - may be a dike or sill, as contacts appear slightly chilled.	3316	554.4	558.3				
	666.1								

TRG

PROPERTY Seagull Sturgeon Lake CLAIM _____

ALTITUDE _____ STARTED _____

DEPARTURE _____ FINISHED _____

ELEVATION _____ TOTAL LENGTH _____

DEPTH	DIP	AZI.

DEPTH	DIP	AZI.

HOLE NO. SG 81-14

LOGGED BY _____

CORE SIZE _____

SECTION 119 E

LEVEL _____

Page 5 of 5

DD Co. _____

CORE FOOTAGE		DESCRIPTION	SAMPLE NO	FROM	TO	LENGTH			
FROM	TO								
666.1	676.8	Fine grained massive grey tuff, with a few small quartz eyes much less than 1%. Foliation weak, about 60°.							
676.8	760	Siliceous vague lapilli tuff. Blocky and hematite stained 680-683, and 686-687 is quite siliceous and indistinctly bedded. Locally a few wispy patches of fine grained pyrite. Foliation varies from 45° - 60° to c.a. and is weak, which probably explains the variation.							
760	776	Heterogeneous zone. Bedded to massive tuff, including lapilli tuff, some ribboned and simple quartz-carbonate veins, and some minor dykes. Chloritoid is abundant locally, elsewhere absent. Grey siliceous massive tuff to lapilli tuff, chloritoid apparent in last 10-20'. Several very small intermediate dikes.	808-815	3317					
847		Quartz-carbonate-chlorite vein at 809-810 contains minor pyrite & chalcopyrite, and disseminated grains of pyrite & chalcopyrite can be seen at 817-820.	815 - 882.4	3318					
end of hole									

PATRICIA MINING DIV.
RECEIVED
 JUL 15 1982
 A.M. P.M.
 7 8 9 10 11 12 1 2 3 4 5 6

REGISTERED PROFESSIONAL ENGINEER
 T.G.
 TOM GLEDHILL
 7/16/82
 PROVINCE OF ONTARIO

Tom Gledhill

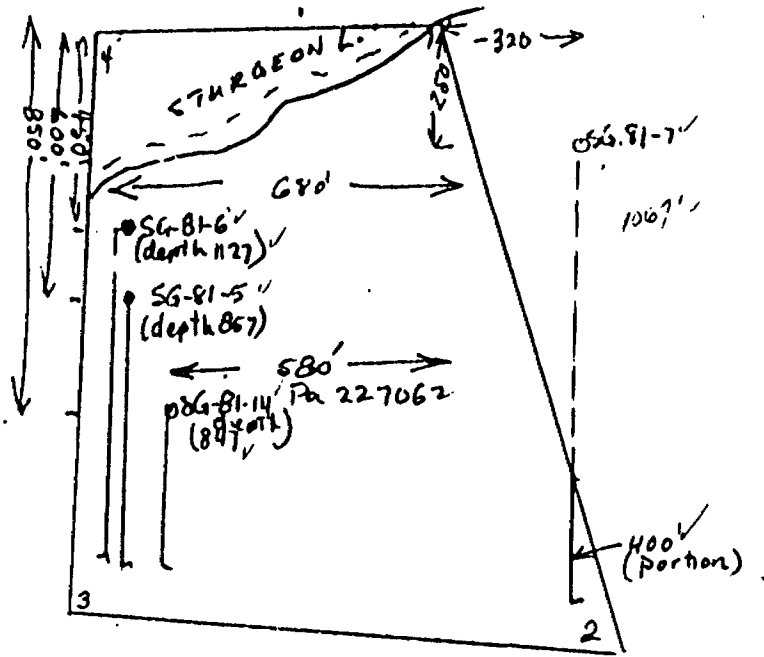

HOLE NO. SG-81-5

SG-81-6

SG-81-14

VALORA LAKE
 S2G/14SE
 M-2052
 Scale
 400 FT.



Tom Gladhill 1" = 400'

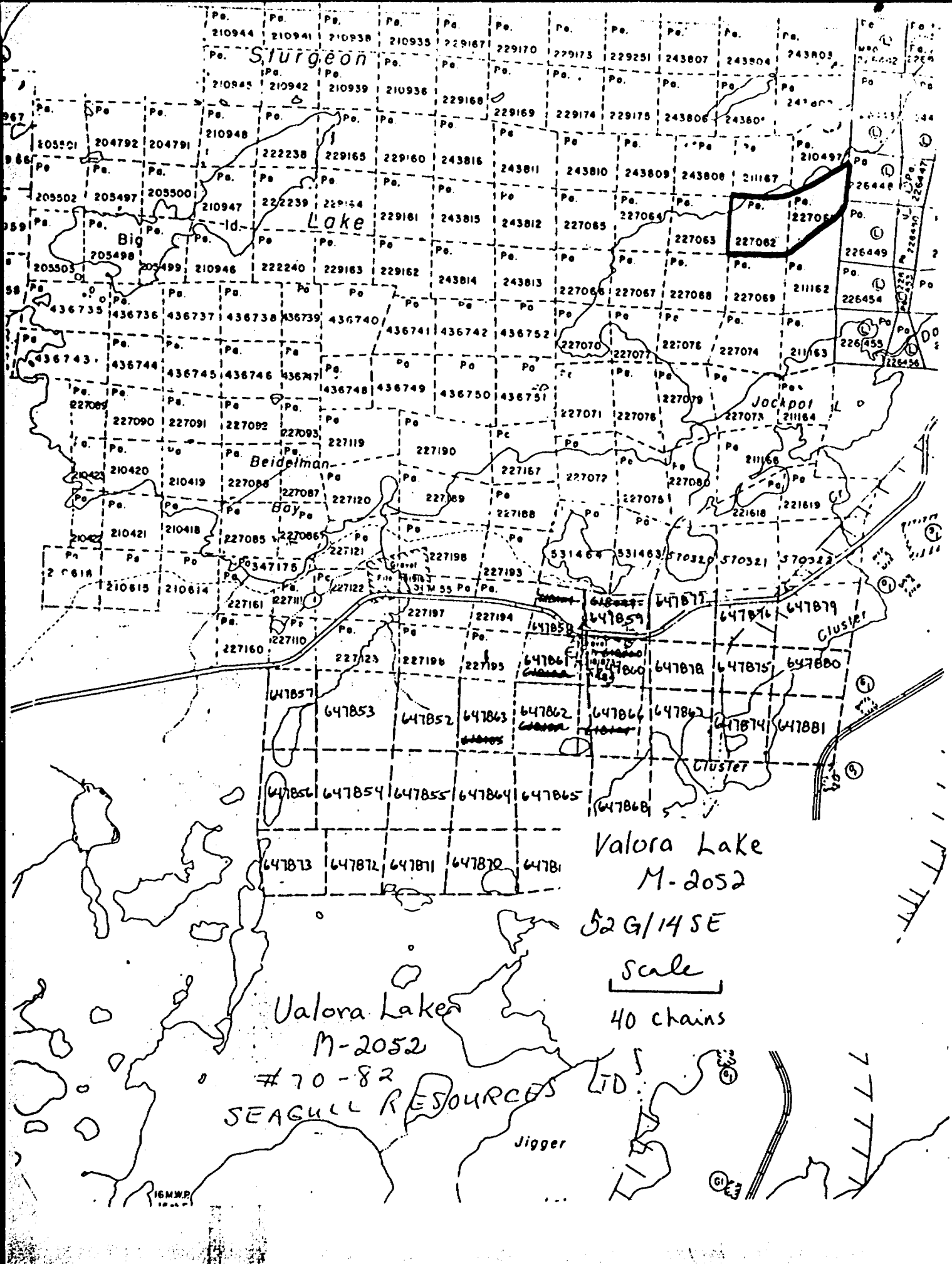

Sturgeon

Big Lake

Beideman
Boy

Jockoi

Cluster

Cluster

Valora Lake
M-2052

52 G/14 SE
Scale

40 chains

Valora Lake
M-2052
#70-82
SEAGULL RESOURCES LTD

Jigger

16MWP

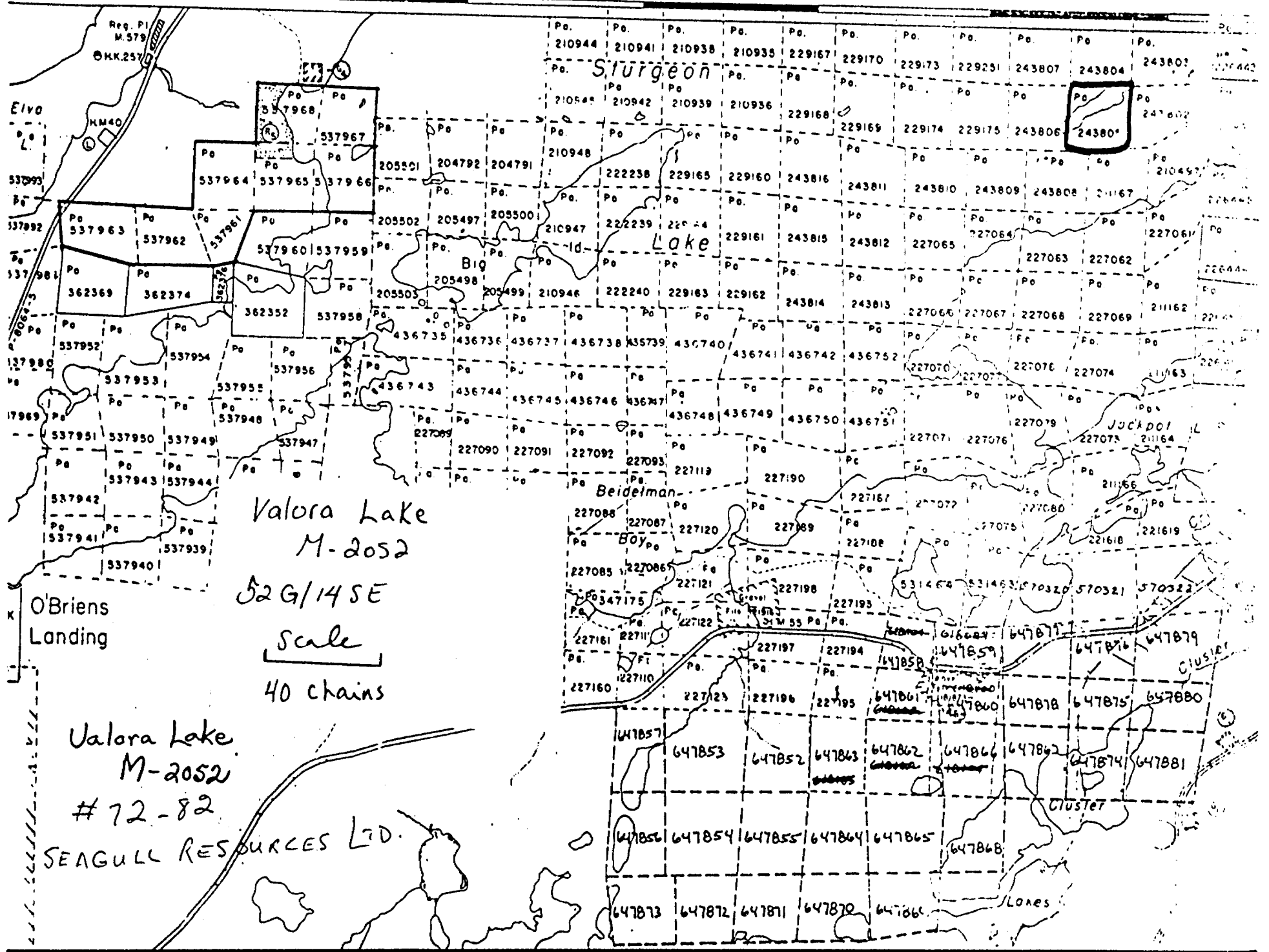

Surgeon

Big Lake

Beideman

Boyo

24380*

Valora Lake
M-2052

52 G/14 SE

Scale

40 chains

Valora Lake
M-2052
72-82
SEAGULL RESOURCES LTD.

Cluster

Lozes

Cluster

Reg. P1
M.579

HK.257

Eivo

KM40

537993

537992

537981

537980

537980

17969

O'Briens
Landing

V

K

V

V

V

V

210944 210941 210938 210935 229167 229170 229173 229251 243807 243804 243803
 210545 210942 210939 210936 229168 229169 229174 229175 243806 243805
 210948 222238 229165 229160 243816 243811 243810 243809 243808 211167
 205501 204792 204791 210948 222239 229165 229160 243816 243811 243810 243809 243808 211167
 205502 205497 205500 210947 222239 229165 229160 243816 243811 243810 243809 243808 211167
 205498 205499 210946 222240 229163 229162 243814 243813 227065 227064 227063 227062
 205503 205499 210946 222240 229163 229162 243814 243813 227065 227064 227063 227062
 436735 436736 436737 436738 436739 436740 436741 436742 436752 227070 227071 227072 227073 227074 211163
 436743 436744 436745 436746 436747 436748 436749 436750 436751 227071 227072 227073 227074 211163
 227089 227090 227091 227092 227093 227119 227190 227167 227077 227075 227076 227077 227078 227079 211164
 227088 227087 227120 227189 227108 227107 227075 227076 227077 227078 227079 211164
 227085 227086 227121 227198 227193 531464 531463 570320 570321 570322 211166 227075 227076 227077 227078 227079 211164
 227175 227122 227197 227194 647858 647859 647876 647877 647879 211166 227075 227076 227077 227078 227079 211164
 227161 227110 227197 227194 647858 647859 647876 647877 647879 211166 227075 227076 227077 227078 227079 211164
 227160 227123 227196 227195 647861 647860 647878 647875 647880 211166 227075 227076 227077 227078 227079 211164
 647857 647853 647852 647863 647862 647866 647862 647862 647874 647881 211166 227075 227076 227077 227078 227079 211164
 647856 647854 647855 647864 647865 647868 647874 647881 211166 227075 227076 227077 227078 227079 211164
 647873 647872 647871 647870 647866 647868 647874 647881 211166 227075 227076 227077 227078 227079 211164

PENASSI LAKE M.2257

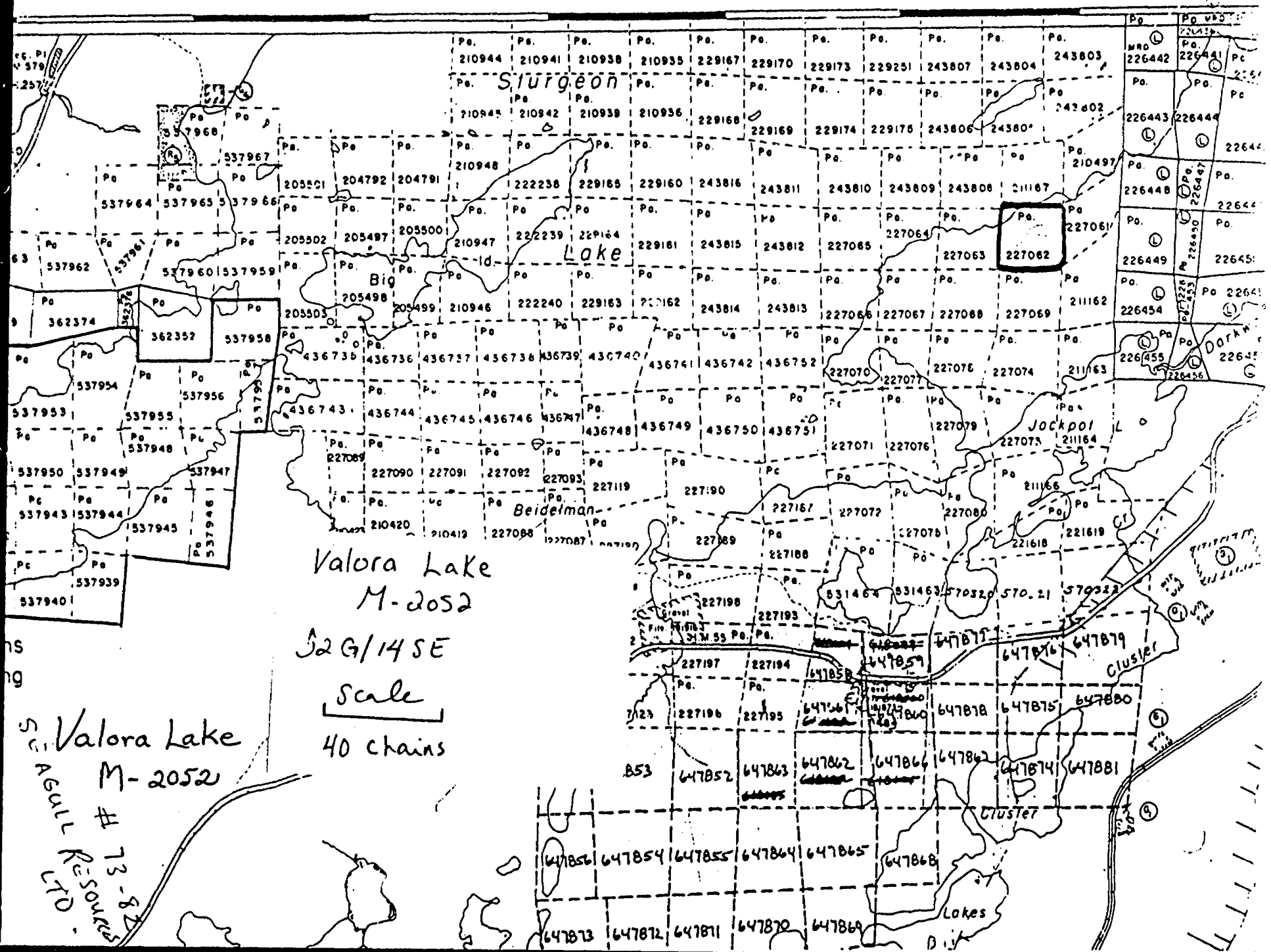

Valora Lake
M-2052

22 G/14 SE
Scale
40 chains

S. Valora Lake
M-2052
AGULL # 13-877
RESOURCES LTD.

227062

647856 647854 647855 647864 647865 647868
647873 647872 647871 647870 647869

226442 226441
226443 226444
226448 226447
226449 226450
226454 226453
226455 226456

DORAN

JOCKO

CLUSTER

CLUSTER

Lakes



Ministry of Natural Resources

Report of Work

Valora Lake M-2062

Penassi Lake M-2257

82-70

The Mining Act

52 G/14 SE (99)

Instructions - Supply required data on a separate form for each type of work to be recorded (see table below). - For Geo-technical work use form no. 1362 "Report of Work (Geological, Geophysical, Geochemical and Expenditures)".

Name and Postal Address of Recorded Holder: **SEAGULL RESOURCES LTD**
 Prospector's Licence No.: **T927**
 % Tom Gledhill 21 Sandalwood Place **DON MILLS ONT. M3B1L5**

Summary of Work Performance and Distribution of Credits

Total Work Days Cr. claimed 1167	Mining Claim			Mining Claim			Mining Claim		
	Prefix	Number	Work Days Cr.	Prefix	Number	Work Days Cr.	Prefix	Number	Work Days Cr.
for Performance of the following work. (Check one only)	Pa	537930	115	Pa	544438	115			
		537931	115						
		537936	115						
		537937	115						
		537938	115						
		544438	115						
	544434	115							
	544435	115							

1036 days

- Manual Work
- Shaft Sinking Drifting or other Lateral Work.
- Compressed Air, other Power driven or mechanical equip.
- Power Stripping
- Diamond or other Core drilling
- Land Survey

All the work was performed on Mining Claim(s): **Pa 227061**

Required Information eg: type of equipment, Names, Addresses, etc. (See Table Below)

*Drilling - Canadian Longyear Canada Inc
 Box 330 North Bay, Ont.
 Supervisor - Tom Gledhill P. Eng
 21 Sandalwood Place
 DON MILLS, ONT. M3B1L5*

BQ. winch

Performed **1167** days
 Recorded **1035** days
 Balance **32** days
 for future use

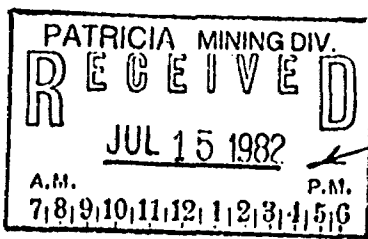

Recorded Doris H. Coe

Pa. 537930

Date of Report: **June 30/82** Recorded Holder or Agent (Signature): **Tom Gledhill**

Certification Verifying Report of Work

I hereby certify that I have a personal and intimate knowledge of the facts set forth in the Report of Work annexed hereto, having performed the work or witnessed same during and/or after its completion and the annexed report is true.

Name and Postal Address of Person Certifying: **TOM GLEDHILL - 21 Sandalwood Place**
DON MILLS, ONT M3B1L5
 Date Certified: **June 30/82** Certified by (Signature): **Tom Gledhill**

Table of Information/Attachments Required by the Mining Recorder

Type of Work	Specific information per type	Other Information (Common to 2 or more types)	Attachments
Manual Work	Nil	Names and addresses of men who performed manual work /operated equipment, together with dates and hours of employment.	Work Sketch: these are required to show the location and extent of work in relation to the nearest claim post.
Shaft Sinking, Drifting or other Lateral Work			
Compressed air, other power driven or mechanical equip.	Type of equipment		
Power Stripping	Type of equipment and amount expended. Note: Proof of actual cost must be submitted within 30 days of recording.	Names and addresses of owner or operator together with dates when drilling/stripping done	

52614SE0013 52614SE0010 VALORA LAKE 900

MINISTRY OF NATURAL RESOURCES

Report of Work

Valora Lake M-2052
 Penassi Lake M-2257
 # 82-70

Name and postal address of recorded holder: Seagull Resources Ltd.
 c/o Tom Gledhill
 21 Sandalwood Place
 Don Mills, Ontario
 M3B 1L5

Prospectors Licence No: T 927

Summary of Work Performance and Distribution of Credits

Total work days Cr. claimed: 1067

All work performed on mining claim(s): PA 227061 & 227062

<u>Mining Claim</u>	<u>Work</u>	<u>Mining Claim</u>	<u>Work</u>	<u>Mining Claim</u>	<u>Work</u>
<u>Prefix Number</u>	<u>Days Cr.</u>	<u>Prefix Number</u>	<u>Days Cr.</u>	<u>Prefix Number</u>	<u>Days Cr.</u>
PA 537930	115	PA 544438	115		
537931	115				
537936	115				
537937	115				
537938	115				1035 days
544433	115				
544434	115				
544435	115				

Drilling: Longyear Canada Inc.
 Box 330
 North Bay, Ontario

B.Q. Wireline

Supervisor: Tom Gledhill, P. Eng.
 21 Sandalwood Place
 Don Mills, Ontario
 M3B 1L5

*Performed 1067 days
 Recorded 1035 days
 Balance 32 days for future use

PA537930

Date of Report: June 30, 1982

Recorded holder or agent: Tom Gledhill

Name and postal address of person certifying: Tom Gledhill
 21 Sandalwood Place
 Don Mills, Ontario
 M3B 1L5

Date Certified: June 30, 1982

Valora Lake. M-2052

52.6/14 SE (96)



Report of Work

82-71

Instructions - Supply required data on a separate form for each type of work to be recorded (see table below).
- For Geo-technical work use form no. 1362 "Report of Work (Geological, Geophysical, Geochemical and Expenditures)".

The Mining Act

Name and Postal Address of Recorded Holder SEAGULL RESOURCES LTD.	Prospector's Licence No. 1927
1/2 Tom Gledhill 21 Sandalwood Pl. DON MILLS, ONT M3B1L5	

Summary of Work Performance and Distribution of Credits

Total Work Days Cr. claimed 1662	Mining Claim			Mining Claim			Mining Claim		
	Prefix	Number	Work Days Cr.	Prefix	Number	Work Days Cr.	Prefix	Number	Work Days Cr.
For Performance of the following work. (Check one only) <input type="checkbox"/> Manual Work <input type="checkbox"/> Shaft Sinking Drifting or other Lateral Work. <input type="checkbox"/> Compressed Air, other Power driven or mechanical equip. <input type="checkbox"/> Power Stripping <input checked="" type="checkbox"/> Diamond or other Core drilling <input type="checkbox"/> Land Survey	Pa	436735	75	Pa	436743	75	Pa	436751	75
		436736	75		436744	75		436752	75
		436737	75		436745	75		537956	115 125
		436738	75		436746	75		537957	115 125
		436939	75		436747	75			125
		436940	75		436748	75			
		436941	75		436749	75			
		436942	75		436750	75			

All the work was performed on Mining Claim(s): **Pa 436738 and 436741**

Required Information eg: type of equipment, Names, Addresses, etc. (See Table Below)

Drilling: Longyear Canada Inc
Box 330 North Bay, Ont B.Q. Wireline

Supervisor: Tom Gledhill P.Eng. Performed **1662 days**
 21 Sandalwood Place Recorded **1350 days**
 DON MILLS, Ontario M3B1L5 Balance **312 days** for future use

PATRICIA MINING DIV.
RECEIVED
 JUL 15 1982
 A.M. 7 8 9 10 11 12 P.M. 1 2 3 4 5 6

Pa. 436735

Certification Verifying Report of Work

I hereby certify that I have a personal and intimate knowledge of the facts set forth in the Report of Work annexed hereto, having performed the work or witnessed same during and/or after its completion and the annexed report is true.

Name and Postal Address of Person Certifying TOM GLEDHILL 21 Sandalwood Place	Date of Report June 30/82	Recorded Holder or Agent (Signature) Tom Gledhill
DON MILLS, ONT. M3B1L5	Date Certified June 30/82	Certified by (Signature) Tom Gledhill

Table of Information/Attachments Required by the Mining Recorder

Type of Work	Specific Information per type	Other Information (Common to 2 or more types)	Attachments
Manual Work	Nil	Names and addresses of men who performed manual work/operated equipment, together with dates and hours of employment.	Work Sketch: these are required to show the location and extent of work in relation to the nearest claim post.
Shaft Sinking, Drifting or other Lateral Work			
Compressed air, other power driven or mechanical equip.	Type of equipment	Names and addresses of owner or operator together with dates when drilling/stripping done.	
Power Stripping	Type of equipment and amount expended. Note: Proof of actual cost must be submitted within 30 days of recording.		

MINISTRY OF NATURAL RESOURCES

Report of Work
Valora Lake M-2052
82-71

Name and postal address of recorded holder: Seagull Resources Ltd.
c/o Tom Gledhill
21 Sandalwood Place
Don Mills, Ontario M3B 1L5

Prospectors Licence No: T927

Work performed on Mining Claim(s): PA436738 and 436741

For performance of following work: Diamond or other core drilling

<u>Mining Claim</u>			<u>Mining Claim</u>			<u>Mining Claim</u>		
<u>Prefix</u>	<u>Number</u>	<u>Work Days Cr.</u>	<u>Prefix</u>	<u>Number</u>	<u>Work Days Cr.</u>	<u>Prefix</u>	<u>Number</u>	<u>Work Days Cr.</u>
PA	436735	75	PA	436743	75	PA	436751	75
	436736	75		436744	75		436752	75
	436737	75		436745	75			
	436738	75		436746	75			
	436739	75		436747	75			
	436740	75		436748	75			
	436741	75		436749	75			
	436742	75		436750	75			

Drilling: Longyear Canada Inc.
Box 330
North Bay, Ontario

B.Q. Wireline

Supervisor: Tom Gledhill, P. Eng.
21 Sandalwood Place
Don Mills, Ontario
M3B 1L5

*Performed 1662 days
Recorded 1350 days
Balance 312 days for future use

PA 436735

Date of Report: June 30, 1982

Recorded holder or Agent: Tom Gledhill

Name and postal address of person certifying: Tom Gledhill
21 Sandalwood Place
Don Mills, Ontario
M3B 1L5

Volume 1000 (1982)

52 G/14 SE (97)

Geology
82-12

The Mining Act

Supply report of days of work performed...
For Geotechnical work...
of Work (Geological, Geophysical, Geochemical and Expenditures)''.

Name and Address of Recorded Holder
SEAGULL RESOURCES LTD.
 1/2 TOM GLEDHILL 21 Sandalwood Place DON MILLS, ONT. M3B 1L5

Inspector's License No.
7927

Summary of Work Performance and Distribution of Credits

Total Work Days Cr. claimed 934	Mining Claim			Work Days Cr.	Mining Claim			Work Days Cr.
	Prefix	Number	Work Days Cr.		Prefix	Number	Work Days Cr.	
For Performance of the following work. (Check one only) <input type="checkbox"/> Manual Work <input type="checkbox"/> Shaft Sinking Drifting or other Lateral Work. <input type="checkbox"/> Compressed Air, other Power driven or mechanical equip. <input type="checkbox"/> Power Stripping <input checked="" type="checkbox"/> Diamond or other Core drilling <input type="checkbox"/> Land Survey	P	537961	115					
		537962	115					
		537963	115					
		537964	115					
		537965	115					
		537966	115					
		537967	115					
	537968	115						

All the work was performed on Mining Claim(s): ~~P~~, 243805

Required Information eg: type of equipment, Names, Addresses, etc. (See Table Below)

Drilling. Longyear Canada Inc.
 BOX 330 NORTH BAY ONT. BQ. wireline

Supervisor: TOM GLEDHILL
 21 Sandalwood Place
 DON MILLS, ONT. M3B 1L5

Performed 934 days
 Recorded 920 days
 Balance 14 days
 M3B 1L5 for future use

MINING RECORDS OFFICE - TORONTO
RECEIVED
 JUL 13 1982
 AM 7 8 9 10 11 12 1 2 3 4 5 6 P.M.

PATRICIA MINING DIV.
RECEIVED
 JUL 15 1982
 A.M. 7 8 9 10 11 12 1 2 3 4 5 6 P.M.

Pa. 537939
 Date of Report: June 30/82
 Recorded Holder or Agent (Signature): Tom Gledhill

Certification Verifying Report of Work

I hereby certify that I have a personal and intimate knowledge of the facts set forth in the Report of Work annexed hereto, having performed the work or witnessed same during and/or after its completion and the annexed report is true.

Name and Postal Address of Person Certifying
TOM GLEDHILL 21 Sandalwood Place
DON MILLS, ONT. M3B 1L5

Date Certified: June 30/82
 Certified by (Signature): Tom Gledhill

Table of Information/Attachments Required by the Mining Recorder

Type of Work	Specific Information per type	Other information (Common to 2 or more types)	Attachments
Manual Work	Nil	Names and addresses of men who performed manual work/operated equipment, together with dates and hours of employment.	Work Sketch: these are required to show the location and extent of work in relation to the nearest claim post.
Shaft Sinking, Drifting or other Lateral Work			
Compressed air, other power driven or mechanical equip.	Type of equipment		
Power Stripping	Type of equipment and amount expended. Note: Proof of actual cost must be submitted within 30 days of recording.	Names and addresses of owner or operator together with dates when drilling/stripping	

MINISTRY OF NATURAL RESOURCES

Report of Work

Valara Lake M-2052
82-72

Name and address of recorded holder: Seagull Resources Ltd.
c/o Tom Gledhill
Prospectors Licence No: T927 21 Sandalwood Place
Don Mills, Ontario
M3B 1L5

Summary of Work Performance and Distribution of Credits

Total work days claimed: 934

For performance of following work: Diamond or other Core Drilling

<u>Mining Claim</u>		Work
<u>Prefix</u>	<u>Number</u>	<u>Days Cr.</u>
PA	537961	115
	537962	115
	537963	115
	537964	115
	537965	115
	537966	115
	537967	115
	537968	115

All work performed on following claims: 243805

Drilling: Longyear Canada Inc.
Box 330
North Bay, Ontario

B.Q. Wireline

Supervisor: Tom Gledhill
21 Sandalwood Place
Don Mills, Ontario

*Performed 934 days
Recorded 920 days
Balance 14 days for future use

PA537939

Date of Report: June 30, 1982

Recorded holder or agent: Tom Gledhill

Name and postal address of person certifying: Tom Gledhill
21 Sandalwood Place
Don Mills, Ontario
M3B 1L5



Ministry of
Natural
Resources

Report
of Work # 82-73

Instructions - Supply required data on a separate form for each
type of work to be recorded (see table below).
- For Geo-technical work use form no. 1362 "Report
of Work (Geological, Geophysical, Geochemical and
Expenditures)".

Geology

The Mining Act

Name and Postal Address of Recorder Holder SEAGULL RESOURCES LTD c/o Tom GLEDHILL 21 Sandalwood Pl, Don Mills, ONT	Prospector's Licence No. T 927 M3B1LS
--	---

Summary of Work Performance and Distribution of Credits

Total Work Days Cr. claimed 3231	Mining Claim			Mining Claim			Mining Claim		
	Prefix	Number	Work Days Cr.	Prefix	Number	Work Days Cr.	Prefix	Number	Work Days Cr.
For Performance of the following work. (Check one only) <input type="checkbox"/> Manual Work <input type="checkbox"/> Shaft Sinking Drifting or other Lateral Work. <input type="checkbox"/> Compressed Air, other Power driven or mechanical equip. <input type="checkbox"/> Power Stripping <input checked="" type="checkbox"/> Diamond or other Core drilling <input type="checkbox"/> Land Survey	Pg	537939	115	Pg	537947	115		537955	115
		537940	115		537948	115		537956	115
		537941	115		537949	115		537957	115
		537942	115		537950	115		537958	115
		537943	115		537951	115		537969	115
		537944	115		537952	115		537970	115
	537945	115		537953	115		537971	115	
	537946	115		537954	115		537972	115	
							537977	115	
							537978	115	
							537979	115	
							537980	115	

All the work was performed on Mining Claim(s): **Pg 227062**

Required Information eg: type of equipment, Names, Addresses, etc. (See Table Below)

Drilling: **Longyear Canada Inc.**
Box 330 NORTH BAY ONT. **B.Q. Wireline**

Supervisor: **TOM GLEDHILL P. Eng** Performed **3231** days
21 Sandalwood Place Recorded **3220** days
DON MILLS, ONTARIO M3B1LS Balance **11** days
for future use

PATRICIA MINING DIV.
RECEIVED
JUL 15 1982
A.M. P.M.
7 8 9 10 11 12 1 2 3 4 5 6

Pg. 537939

Date of Report June 30/82	Recorded Holder or Agent (Signature) Tom Gledhill
-------------------------------------	---

Certification Verifying Report of Work

I hereby certify that I have a personal and intimate knowledge of the facts set forth in the Report of Work annexed hereto, having performed the work or witnessed same during and/or after its completion and the annexed report is true.

Name and Postal Address of Person Certifying TOM GLEDHILL 21 Sandalwood Place DON MILLS, ONTARIO M3B1LS	Date Certified June 30/82	Certified by (Signature) Tom Gledhill
---	-------------------------------------	---

Table of Information/Attachments Required by the Mining Recorder

Type of Work	Specific information per type	Other information (Common to 2 or more types)	Attachments
Manual Work	Nil	Names and addresses of men who performed manual work/operated equipment, together with dates and hours of employment.	Work Sketch: these are required to show the location and extent of work in relation to the nearest claim post.
Shaft Sinking, Drifting or other Lateral Work			
Compressed air, other power driven or mechanical equip.	Type of equipment	Names and addresses of owner or operator together with dates when drilling/stripping	
Power Stripping	Type of equipment and amount expended. Note: Proof of actual cost must be submitted within 30 days of recording.		



The Mining Act

Name and Postal Address of Recorded Holder: **SEAGULL RESOURCES LTD**
 Prospector's Licence No.: **P 927**
c/o TOM GLEDHILL, 21 Sandalwood Pl. Don Mills, Ont

Summary of Work Performance and Distribution of Credits

Total Work Days claimed 4000	Mining Claim			Mining Claim			Mining Claim		
	Prefix	Number	Work Days Cr.	Prefix	Number	Work Days Cr.	Prefix	Number	Work Days Cr.
For Performance of the following work. (Check one only) <input type="checkbox"/> Manual Work <input type="checkbox"/> Shaft Sinking Drifting or other Lateral Work. <input type="checkbox"/> Compressed Air, other Power driven or mechanical equip. <input type="checkbox"/> Power Stripping <input checked="" type="checkbox"/> Diamond or other Core drilling <input type="checkbox"/> Land Survey	Pa	537960	115	Pa	537983	115	Pa	537991	115
		537959	115		537984	115		537992	115
		537973	115		537985	115		537993	115
		537974	115		537986	115		537994	115
		537975	115		537987	115		537995	115
		537976	115		537988	115		537996	115
		537981	115		537989	115		537997	115
		537982	115		537990	115		537998	115
							537999	115	
							538000	115	

All the work was performed on Mining Claim(s): **Pa 227063**

Required Information eg: type of equipment, Names, Addresses, etc. (See Table Below)

Drilling: **Longyear Canada Inc.**
Box 330 North Bay Ont. **B.Q. Weirnie**

Supervisor: **TOM GLEDHILL P. Eng.** Performed 4000 days
21 Sandalwood Place Recorded 2990
DON MILLS, ONTARIO M3B1L5 Balance 1010 days
 for future use

PATRICIA MINING DIV.
RECEIVED
 JUL 15 1982
 A.M. 7 8 9 10 11 12 P.M. 1 2 3 4 5 6

Pa. 537939

Date of Report: **June 30/82** Recorded Holder or Agent (Signature): **Tom Gledhill**

Certification Verifying Report of Work

I hereby certify that I have a personal and intimate knowledge of the facts set forth in the Report of Work annexed hereto, having performed the work or witnessed same during and/or after its completion and the annexed report is true.

Name and Postal Address of Person Certifying: **TOM GLEDHILL 21 Sandalwood Place**
DON MILLS, ONT. M3B1L5
 Date Certified: **June 30/82** Certified by (Signature): **Tom Gledhill**

Table of Information/Attachments Required by the Mining Recorder

Type of Work	Specific information per type	Other information (Common to 2 or more types)	Attachments
Manual Work	Nil	Names and addresses of men who performed manual work / operated equipment, together with dates and hours of employment.	Work Sketch: these are required to show the location and extent of work in relation to the nearest claim post.
Shaft Sinking, Drifting or other Lateral Work			
Compressed air, other power driven or mechanical equip.	Type of equipment	Names and addresses of owner or operator together with dates when drilling/stripping	
Power Stripping	Type of equipment and amount expended. Note: Proof of actual cost must be submitted within 30 days of recording.		

MINISTRY OF NATURAL RESOURCES

Report of Work

Valora Lake M-2052

82-74

Name and address of Recorded Holder: Seagull Resources Ltd.

Prospectors Licence No: P 927
c/o Tom Gledhill
21 Sandalwood Place
Don Mills, Ontario

Total work days claimed: 4000

For performance of following work: Diamond or other Core drilling

All work was performed on Mining Claim(s): PA227063

Summary of Work Performance and Distribution of Credits

Mining Claim		Work	Mining Claim		Work	Mining Claim		Work
Prefix	Number	Days Cr.	Prefix	Number	Days Cr.	Prefix	Number	Days Cr.
PA	537960	115	PA	537983	115	PA	537991	115
	537959	115		537984	115		537992	115
	537973	115		537985	115		537993	115
	537974	115		537986	115		537994	115
	537975	115		537987	115		537995	115
	537976	115		537988	115		537996	115
	537981	115		537989	115		537997	115
	537982	115		537990	115		537998	115
							537999	115
							538000	115

Required Information:

Drilling: Longyear Canada Inc.
 Box 330
 North Bay, Ontario

B.Q. Wireline

Supervisor: Tom Gledhill, P. Eng.
 21 Sandalwood Place
 Don Mills, Ontario
 M3B 1L5

*Performed 4000 days
 Recorded 2990 days
 Balance 1010 days for future use

*PA537939

Date of Report: June 30, 1982
 Recorded Holder or Agent: Tom Gledhill