



52G14SE0017 52G/14SE-23-A VALORA LAKE

010

DIAMOND DRILLING

Area:

Report No:

WORK PERFORMED FOR:

RECORDED HOLDER: SAME AS ABOVE []

; OTHER []

<u>CLAIM NO:</u>	<u>HOLE NO:</u>	<u>FOOTAGE</u>	<u>DATE</u>	<u>NOTE</u>
205502	70-5	550	Mar/70	
205497	70-6	546	Mar/70	
205497	70-7	350	Mar/70	

Total: 3DH 1446

NOTES:

DIAMOND DRILL RECORD

PROPERTY CHIKO GOLD MINES LIMITED STURGEON LAKE HOLE NO. 70 - 5

SHEET NUMBER 1 SECTION FROM _____ TO _____ STARTED March 20, 1970
 LATITUDE 18 + 00 S DATUM _____ COMPLETED March 23, 1970
 DEPARTURE 86 + 00 W BEARING 180° ULTIMATE DEPTH 550.2'
 ELEVATION _____ DIP 0 - 60° 524° - 34° PROPOSED DEPTH: _____

DEPTH FEET	FORMATION	SPECIMEN SAMPLE NO. FOOTAGE	WIDTH OF SAMPLE	GOLD G	BLANKET GOLD'S
-	Casing				
97.5 - 195.5	Tuff - Rhyolite - Variable from speckled grey to pink, well banded 45° - Few shattered quartz - 1 2"	115 140			
195.5 - 216	Tuff - Interbanded rhyolite, andesite, graphitic, sericitic. Heavy bands of pyrite partially leached and crusy.	184 203			
216 - 300	Rhyolite tuff - Light grey, well banded 70° - Sericitic wuggy quartz along beds - carbonated bands.	224 268			
300 - 311	Rhyolite fragmental - Bands of pyrite up to 1".				
311 - 325.5	Graphitic tuff, fragmental, mud stone, abundant pyrite - variably interbanded.	310			
325.5 - 334	Mineralized zone - Coarse and fine pyrite with streaks and aggregates of fine pyrite - Split -	330 355			
334 - 376	Tuff - intermediate - Some fragmental bands - 65°	375			
376 - 377	Mineralized zone - Irregular wisps of chalcopryrite - 1/8" - bands of sphalerite.				
377 - 422.5	Rhyolite tuff - Silicified in places. Few wisps of chalcopryrite - Sampled - sericitic	391 415			
422.5 - 430.5	Graphitic schist - Abundant pyrite, sparse chalcopryrite some rusty - Sampled.	425			
430.5 - 486	Rhyolite tuff - sericitic - light grey - 75°. Grey	449 468			

N.M.P. TORONTO-STOCK FORM NO. 501 REV. 12/51

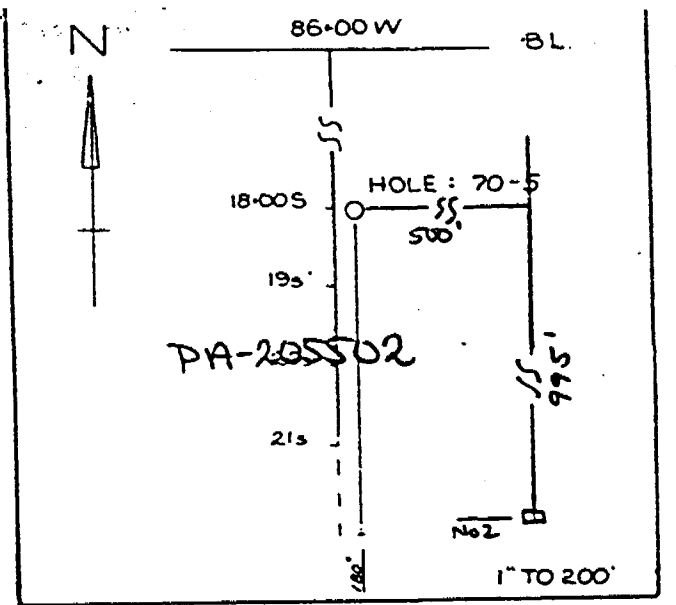

PA-205502

Scale
1" TO 200'

485.65 - 493.3
Tr 1-1-1-1-

396.35 - 399.25
Tr 1-1-1-1-

375.75 - 376.2
Tr 1-1-1-1-
376.2 - 377.0
Tr 1-1-1-1-
377.0 - 378.1
Tr 1-1-1-1-

324.6 - 332.7
Tr 1-1-1-1-

391.4 - 391.95
Tr 1-1-1-1-
391.95 - 394.1
Tr 1-1-1-1-
394.1 - 394.5
Tr 1-1-1-1-

416.35 - 421.95
Tr 1-1-1-1-

414.45 - 415.3
Tr 1-1-1-1-

400.45 - 401.30
Tr 1-1-1-1-

Sample Footage in feet
0 - 100 | 100 - 200 | 200 - 300

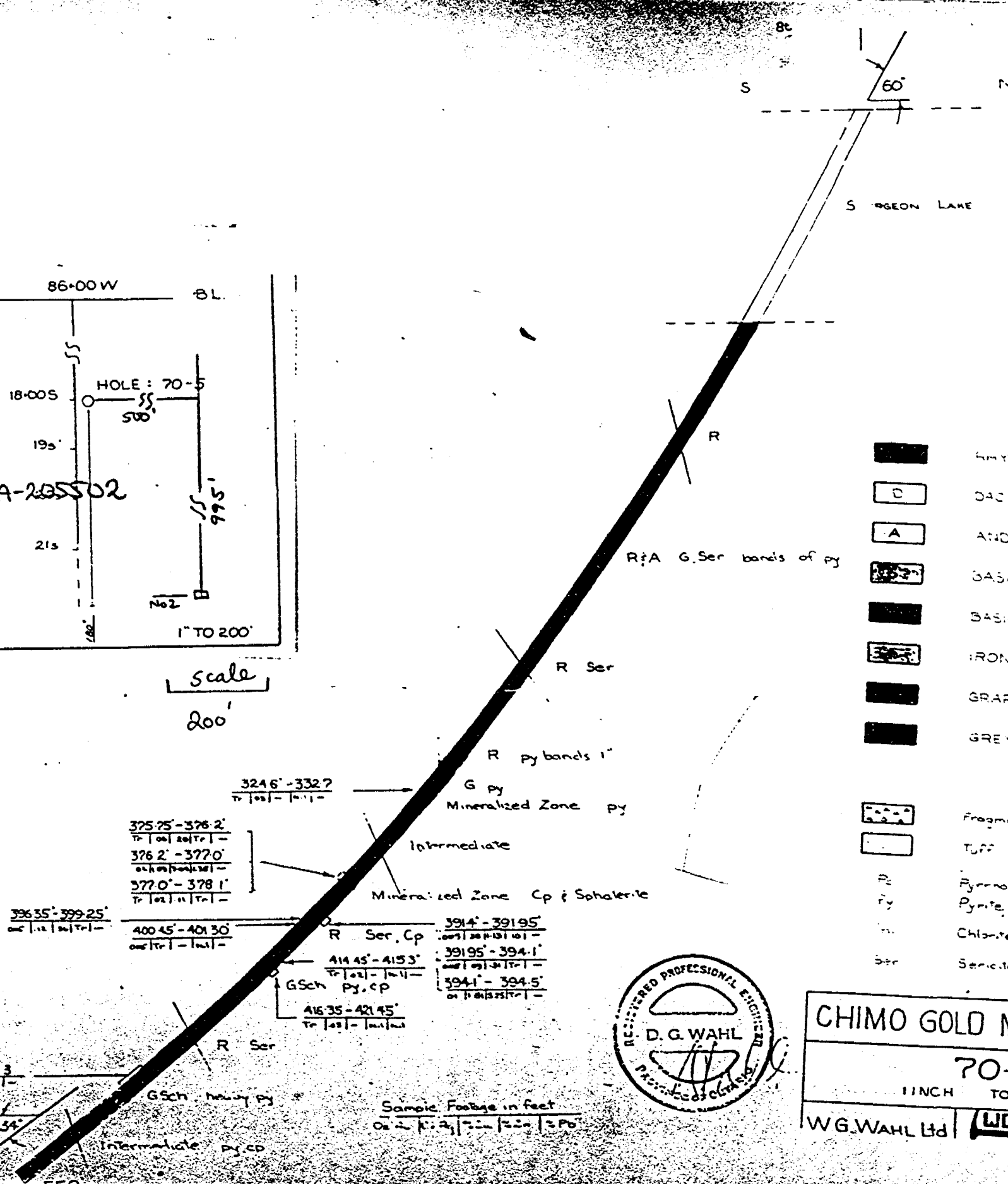

PATRICIA
Mining Div.
RECEIVED
APR 30 1971
7:48 AM 10/11/21 12:34 PM

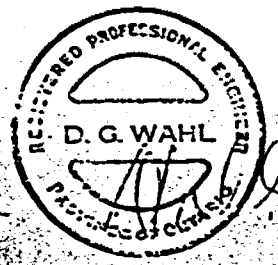

CHIMO GOLD MINES LIMITED
70-5
1 INCH TO 40 FEET
W.G. WAHL LTD. **WGL** NOVEMBER 1971

DIAMOND DRILL RECORD









PROPERTY CHINO GOLD MINES LIMITED STURGEON LAKE HOLE NO. 70 - 6





SHEET NUMBER 1 SECTION FROM _____ TO _____ STARTED March 24, 1970
 LATITUDE 17 + 00 S DATUM _____ COMPLETED March 26, 1970
 DEPARTURE 84 + 00 W BEARING _____ ULTIMATE DEPTH 545.5'
 ELEVATION _____ DIP 0° - 60°, 455' - 31°, 546' - 25° PROPOSED DEPTH _____

DEPTH FEET	FORMATION	SPECIMEN SAMPLE NO FOOTAGE	WIDTH OF SAMPLE	GOLD g	BLANK GOLD g
0 - 61	Casing.				
61 - 292.5	Rhyolite tuff - Grey to pink - well bedded - 40° - Sericitic - few vuggy quartz veins.	75 100	122		
	207 - 257 - Pink with shattered quartz eyes	145 171	195		
	257 - 60°	221 235	265		
292.5 - 294	Graphite schist - heavy coarse pyrite - 2' quartz vein with rusty pyrite.	293			
294 - 405	Rhyolite tuff - Uniform, well banded with good cross- bedding at 326'. 263 - 1.5' silicified with pyrite.	513 333			
	379 - 405 - Disseminated and seams of pyrite - 85°	580 398			
405 - 416	Graphitic schist - heavy pyrite - some siliceous bands.	413			
416 - 546	Rhyolite tuff - scattered pyrite seams 445 - Ghosts of fragments - 80° 475 - Fine disseminated pyrite, 1' - split	440 465			
	525 - 546 - Pink with quartz eyes, also tan	585 506			
	END TOTAL	531 545			
		22			

APR 30 1971
 77101

PATRICIA
 RECEIVED
 APR 30 1971
 7:18:10 PM
 12:12:24:58

-  RHYOLITE
-  DACITE
-  ANDESITE
-  BASALT
-  BASIC DYKE
-  IRON FORMATION
-  GRAPHITE SCHIST
-  GREYWACKE

-  Fragmental
-  Schists
-  Tuff
-  Meta-Sediments
- Pb Pyrrhotite Cp Chalcopyrite
- Py Pyrite G Graphite
- Chl Chlorite (Chloritization)
- Ser Sericite (Sericitization)

HIMO GOLD MINES LIMITED

70-6
 1 INCH TO 40 FEET
 W.G.L.

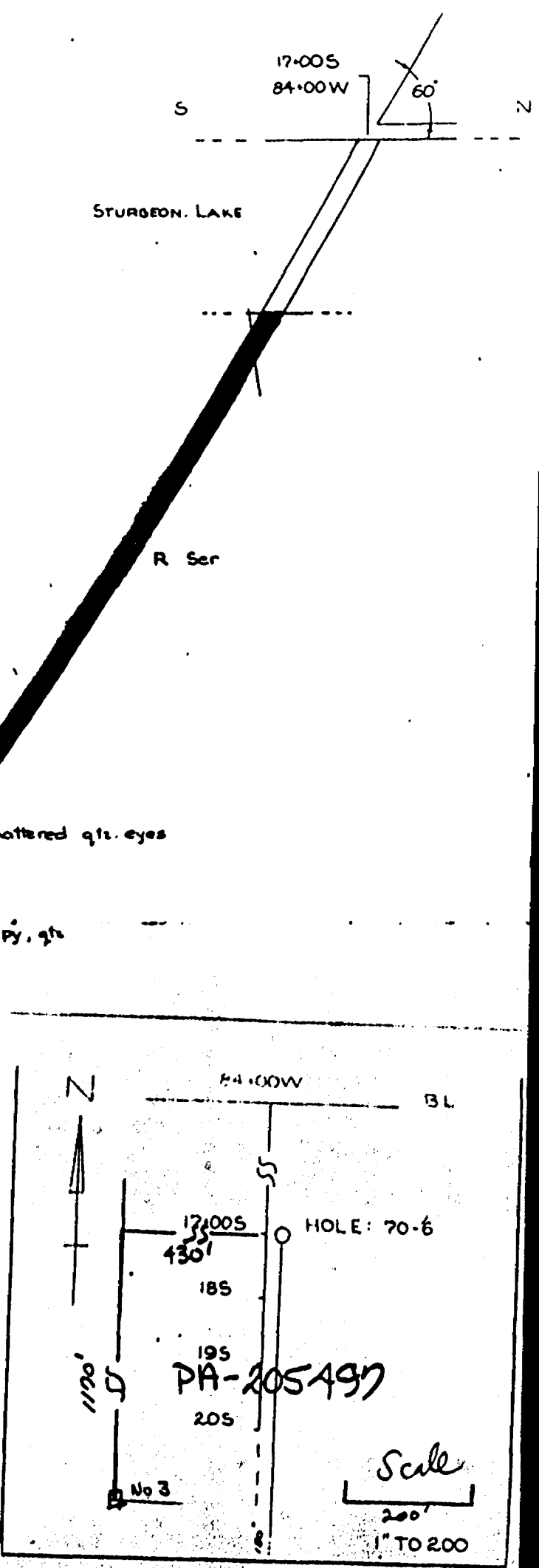
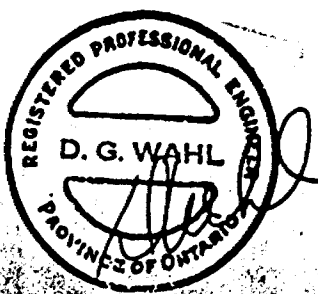
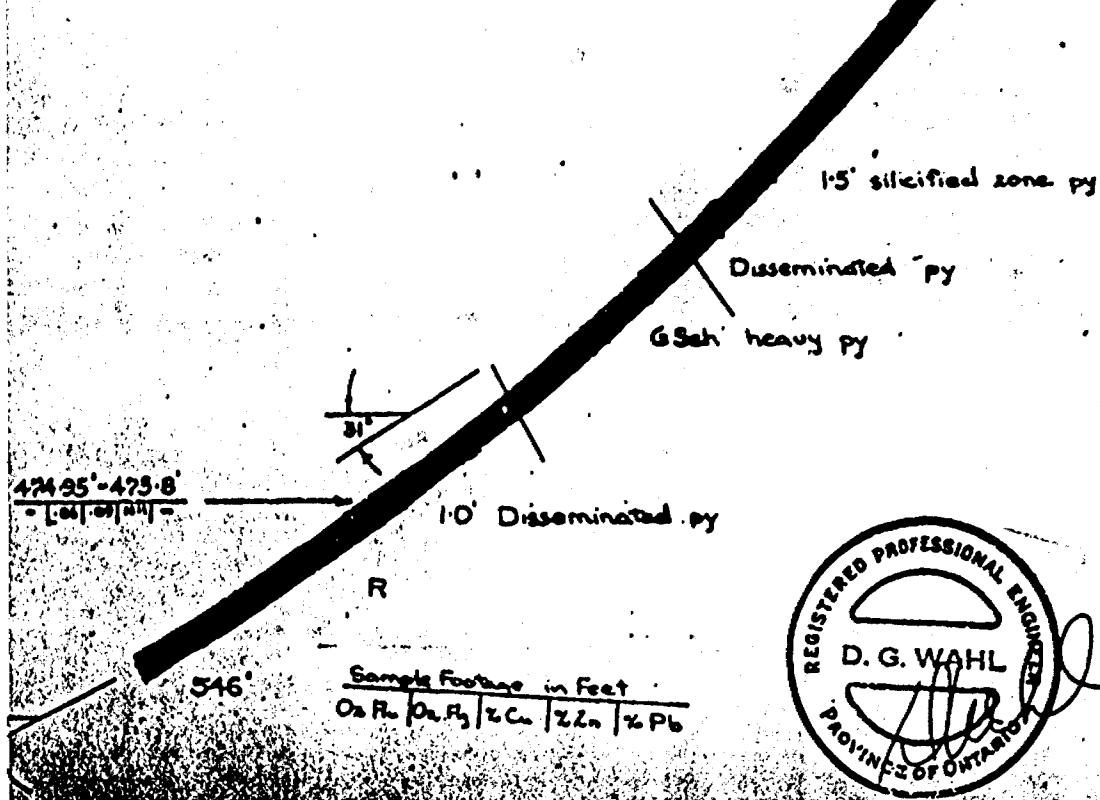

DIAMOND DRILL RECORD

PROPERTY CHINO GOLD MINES LIMITED STURGEON LAKE HOLE NO. 70 - 7

SHEET NUMBER _____ SECTION FROM _____ TO _____ STARTED March 26, 1970
 LATITUDE 20 + 00 S DATUM _____ COMPLETED March 31, 1970
 DEPARTURE 76 + 00 W BEARING 180° ULTIMATE DEPTH 350.0'
 ELEVATION _____ DIP 0° - 60° 347' - 35° PROPOSED DEPTH _____

DEPTH FEET	FORMATION	SPECIMEN NO.	WIDTH OF SAMPLE	GOLD g	SILVER g
0 - 52	Casing				
52 - 153	Rhyolite tuff - Sandy at top - grey - sericitic - well banded 50° - Few drusy quartz veins.	68 91 113 130			
153 - 170	Rhyolite tuff - silicified - fine pyrite in dissemination and bands - carbonated.				
170 - 209	Rhyolite tuff - Grey to tan 180 - 195 - Fractured quartz eyes.	163 180			
209 - 247	Rhyolite tuff - Abundant pyrite in bands up to 1/2", disseminated, and streaks, massive and split at 244.	210 235			
247 - 254	Graphitic schist - Abundant pyrite in streaks and concretions - some siliceous bands 75°.	254			
254 - 280.5	Rhyolite tuff - Grey - banded - Sparse pyrite. 275 - 1' heavy pyrite split.	279			
280.5 - 292	Graphite schist and rhyolite tuff interbanded. Heavy pyrite in both - streaks, bands, concretions.	285			
292 - 350	Rhyolite tuff				
	300 - 301 - Heavy pyrite - split	305			
	305.5 - 307 - " "	325			
	310.5 - 311 - " "				
350	END	TOTAL	13		

Penassi Lake
M-2257
52G/14NE

52G/14SE
M-2052

Valera Lake

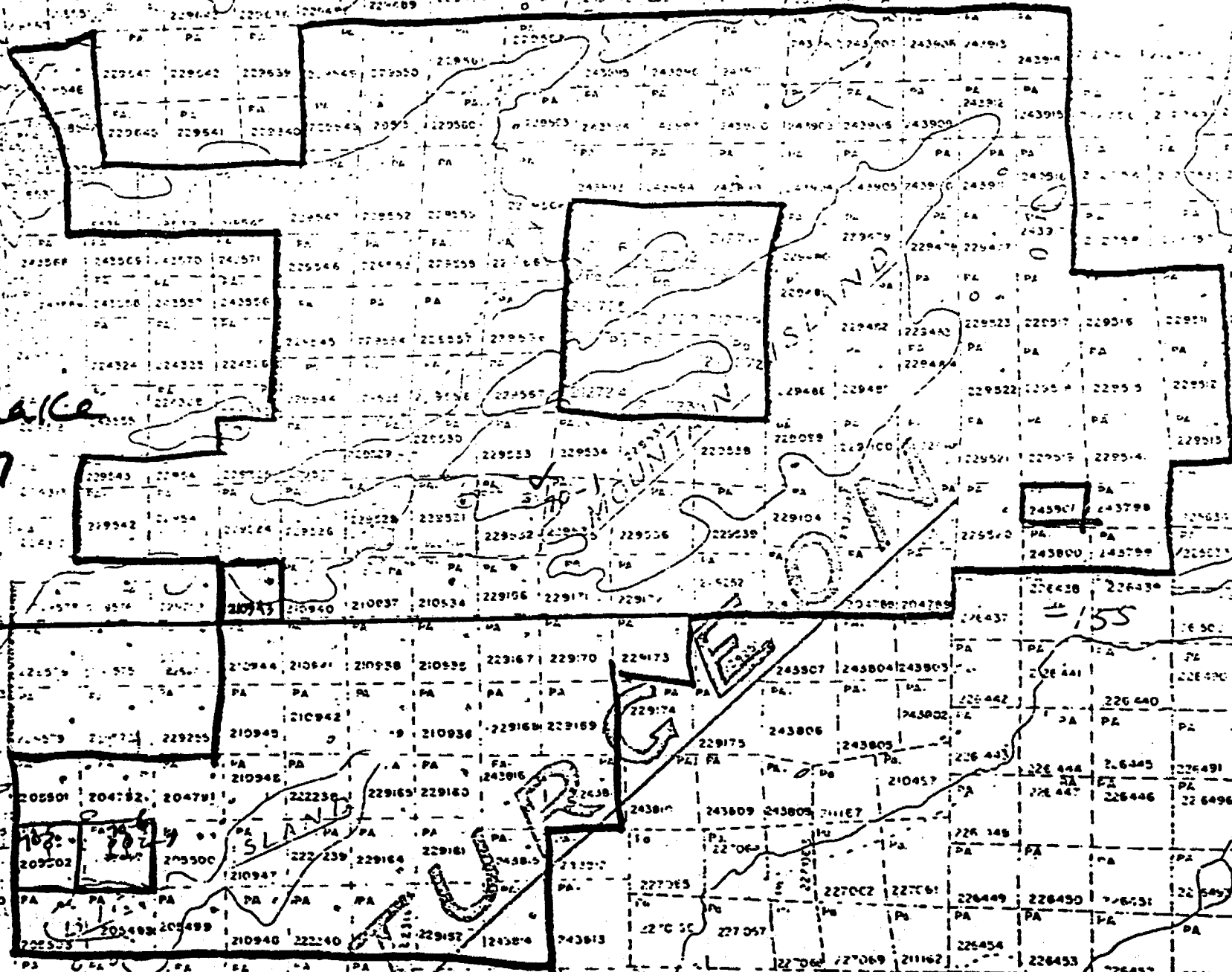

Scale
40 chains

CHIMO GOLD MINES LIMITED

List of Core Samples

Hole Number	Samples	Footages
70 - 4	1 A6069	60'
	2 A6070	85'
	3 A6071	109'
	4 A6072	124'
	5 A6073	147'
	6 A6074	170'
	7 A6075	193'
	8 A6076	211'
	9 A6077	231'
	10 A6078	250'
	11 A6079	265'
	12 A6080	285'
	13 A6081	303'
	14 A6082	323'
	15 A6083	333'
	16 A6084	368'
70 - 5	1 A6085	115'
	2 A6086	141'
	3 A6087	160'
	4 A6088	184'
	5 A6089	203'
	6 A6090	224'
	7 A6091	268'
	8 A6092	291'
	9 A6093	294'
	10 A6094	310'
	11 A6095	330'
	12 A6096	355'
	13 A6097	375'
	14 A6098	391'
	15 A6099	415'
	16 A6100	425'
	17 A6101	449'
	18 A6102	468'
	19 A6103	520'
	20 A6104	544'

DUPLICATE COPY
POOR QUALITY ORIGINAL
TO FOLLOW

Chino Gold Mines Ltd List of core samples

- 3 -

Hole Number	Samples	Footages
70-4	1 A6060	60'
	2 A6070	85'
	3 A6071	109'
	4 A6072	124'
	5 A6073	147'
	6 A6074	170'
	7 A6075	193'
	8 A6076	211'
	9 A6077	231'
	10 A6078	250'
	11 A6079	265'
	12 A6080	285'
	13 A6081	303'
	14 A6082	323'
	15 A6083	333'
	16 A6084	368'
70-5	1 A6085	115'
	2 A6086	141'
	3 A6087	160'
	4 A6088	184'
	5 A6089	203'
	6 A6090	224'
	7 A6091	268'
	8 A6092	291'
	9 A6093	294'
	10 A6094	310'
	11 A6095	330'
	12 A6096	355'
	13 A6097	375'
	14 A6098	391'
	15 A6099	415'
	16 A6100	425'
	17 A6101	449'
	18 A6102	468'
	19 A6103	520'
	20 A6104	544'

Hole Number	Samples	Footages
70 - 6	1 A6105	75'
	2 A6106	100'
	3 A6107	122'
	4 A6108	145'
	5 A6109	171'
	6 A6110	195'
	7 A6111	221'
	8 A6112	235'
	9 A6113	265'
	10 A6114	293'
	11 A6115	313'
	12 A6116	338'
	13 A6117	358'
	14 A6118	380'
	15 A6119	398'
	16 A6120	413'
	17 A6121	440'
	18 A6122	465'
	19 A6123	485'
	20 A6124	506'
	21 A6125	531'
	22 A6126	545'
70 - 7	1 A6127	68'
	2 A6128	91'
	3 A6129	113'
	4 A6130	138'
	5 A6131	168'
	6 A6132	188'
	7 A6133	210'
	8 A6134	235'
	9 A6135	254'
	10 A6136	279'
	11 A6137	285'
	12 A6138	305'
	13 A6139	325'
	14 A6140	350'
70 - 8	1 A6141	93'
	2 A6142	117'
	3 A6143	140'
	4 A6144	162'
	5 A6145	181'
	6 A6146	206'
	7 A6147	229'
	8 A6148	248'
	9 A6149	273'
	10 A6150	297'
	11 A6151	320'
	12 A6152	339'
	13 A6153	364'
	14 A6154	387'
	15 A6155	407'

**DUPLICATE COPY
POOR QUALITY ORIGINAL
TO FOLLOW**

Hole Number	Samples	Footages
70-6	1 A6105	75'
	2 A6106	100'
	3 A6107	122'
	4 A6108	145'
	5 A6109	171'
	6 A6110	195'
	7 A6111	221'
	8 A6112	235'
	9 A6113	265'
	10 A6114	293'
	11 A6115	313'
	12 A6116	338'
	13 A6117	358'
	14 A6118	380'
	15 A6119	398'
	16 A6120	413'
	17 A6121	440'
	18 A6122	465'
	19 A6123	485'
	20 A6124	506'
	21 A6125	531'
	22 A6126	545'
70-7	1 A6127	68'
	2 A6128	91'
	3 A6129	113'
	4 A6130	138'
	5 A6131	168'
	6 A6132	188'
	7 A6133	210'
	8 A6134	235'
	9 A6135	254'
	10 A6136	279'
	11 A6137	285'
	12 A6138	305'
	13 A6139	325'
	14 A6140	350'

Hole Number	Samples	Footages
70-8	1 A6141 2 A6142 3 A6143 4 A6144 5 A6145 6 A6146 7 A6147 8 A6148 9 A6149 10 A6150 11 A6151 12 A6152 13 A6153 14 A6154 15 A6155	93' 117' 140' 162' 181' 206' 229' 248' 273' 297' 320' 339' 364' 387' 407'