



52G14SE0022 52G14SE0015 VALORA LAKE

010

Diamond Drilling

Township OF VALORA LAKE

Report N^o: 35

Work performed by: SCURRY- RAINBOW OILS LTD.

Claim N ^o	Hole N ^o	Footage	Date	Note
PA 221021	# 12	102.6'	Oct/71	(1)
	# 13	104.6'	Oct/71	
	# BC-11A	327'	July/73	(2)
	# BC-12	583'	July/73	(2)
Total:- 4 OH		1117'		

- Notes:
- (1) 125/71 (Ken)
 - (1) 423/71 (PA)
 - (2) 135/73- autositives N.T.S.



THE MINING ACT - DEPARTMENT OF MINES
DIAMOND DRILLING LOG

Start a new page for every new hole, but fill in top portion of form only on first page for each hole.

FILL IN ON EVERY PAGE

HOLE NO.	PAGE NO.
12	1

DRILLING COMPANY
Curry-Rainbow Oil Limited

DATE HOLE STARTED
October 24, 1971

DATE COMPLETED
Oct. 26, 1971

EXPLORATION CO., OWNER OR OPTIONEE
Curry-Rainbow Oil Limited

COLLAR ELEVATION

BEARING OF HOLE FROM TRUE NORTH
148°

TOTAL FOOTAGE
102.6

DIP OF HOLE AT collar
-60°

DATE LOGGED
Oct. 27/71

LOGGED BY
D. R. S. Doal

DATE SUBMITTED

SUBMITTED BY (Signature)
[Signature]

LOCATION OF HOLE IN RELATION TO A FIXED POINT ON THE CLAIM
**From Line 178+50E
700' @ N-52° E**

MAP REFERENCE NO.
D

CLAIM NO.
221021

LOCATION (Tp., Lot, Con. OR Lot. and Long.)
49° 50' 03" 11° 12' 28"

PROPERTY NAME
Scurry-Rainbow Briar-Court

FOOTAGE FROM	TO	ROCK TYPE	DESCRIPTION Colour, grain size, texture, minerals, alteration, etc.	PLANAR FEATURE ANGLE	CORE SPECIMEN FOOTAGE +	YOUR SAMPLE NUMBER	SAMPLE FOOTAGE		SAMPLE LENGTH	ASSAYS +	
							FROM	TO			
0	30	Meta diorite	Light-grey-green. Porphyritic light. Fracturing No mineralization								
30	40	Metavolcanic	Dark green-fine grained, banded tuffaceous rock quartz - 33-33.8" 72% pyrite. 38.5-39 quartz with Po pyrite and chalcopyrite - shearing								
40	64	meta diorite	Coarse grained - grey-green quartz stringers - No mineralization								
64	69.1	Metavolcanic	Grey to light green, calcite quartz - pyrite on slips and on contact with meta diorite.								
69.1	74.2	Meta diorite	As above - coarse grained porphyritic								
74.2	83.7	Metavolcanic	Dark-green - banded tuffaceous siliceous, pyrite, Po. chalcopyrite from 81-81.6								
83.7	91	Meta diorite	Meta diorite as above No mineralization								
91	95	Metavolcanics	Grey-green. agglomeritic - Mud seam from 92-93.1 - minor pyrite								
95	102.6'	Meta diorite	As above - No mineralization								
			Hole completed to 102.6								



THE MINING ACT - DEPARTMENT OF MINES
DIAMOND DRILLING LOG

Start a new page for every new hole, but fill in top portion of form only on first page for each hole.

FILL IN ON EVERY PAGE

HOLE NO.	PAGE NO.
13	1

DRILLING COMPANY Curry-Rainbow Oil Limited		COLLAR ELEVATION X	BEARING OF HOLE FROM TRUE NORTH 145°	TOTAL FOOTAGE 104.6	DIP OF HOLE AT collar -55°	LOCATION OF HOLE IN RELATION TO A FIXED POINT ON THE CLAIM 75' east of hole #12	MAP REFERENCE NO. D	CLAIM NO. 221021
DATE HOLE STARTED October 27, 1971	DATE COMPLETED Oct. 30, 1971	DATE LOGGED	LOGGED BY D. R. S. Doal				LOCATION (Tp., Lot, Con. OR Lat. and Long.) 47° 50' 03" 91° 12' 27"	PROPERTY NAME Scurry-Rainbow Briar-Court
EXPLORATION CO., OWNER OR OPTIONEE Curry-Rainbow Oil Limited		DATE SUBMITTED	SUBMITTED BY (Signature) <i>[Signature]</i>					

FROM	TO	ROCK TYPE	DESCRIPTION Colour, grain size, texture, minerals, alteration, etc.	PLANAR FEATURE ANGLE	CORE SPECIMEN FOOTAGE †	YOUR SAMPLE NUMBER	SAMPLE FOOTAGE		SAMPLE LENGTH	ASSAYS †	
							FROM	TO			
0	17	Meta diorite	Medium-coarse grained - grey-green porphyritic								NIL
17	17.6	Metavolcanic	Grey-green fine-grained, sheared - lost core - 8" recovered								
19.6	37	Meta diorite	Coarse grained porphyritic - becoming finer grained 32-36 - sparse pyrite speck - chalcopyrite								
37	50	Metavolcanic	Dark-green - black - banded siliceous tuff? - pyrite, sparse chalcopyrite								
50	81	Meta diorite	As above								
81	85	Metavolcanic	Dark-green - siliceous - minor pyrite								
85	104.6	Meta diorite	Same as above								
			Hole stopped - 104.6								

† Additional credit available. See Assessment Work Regulations.

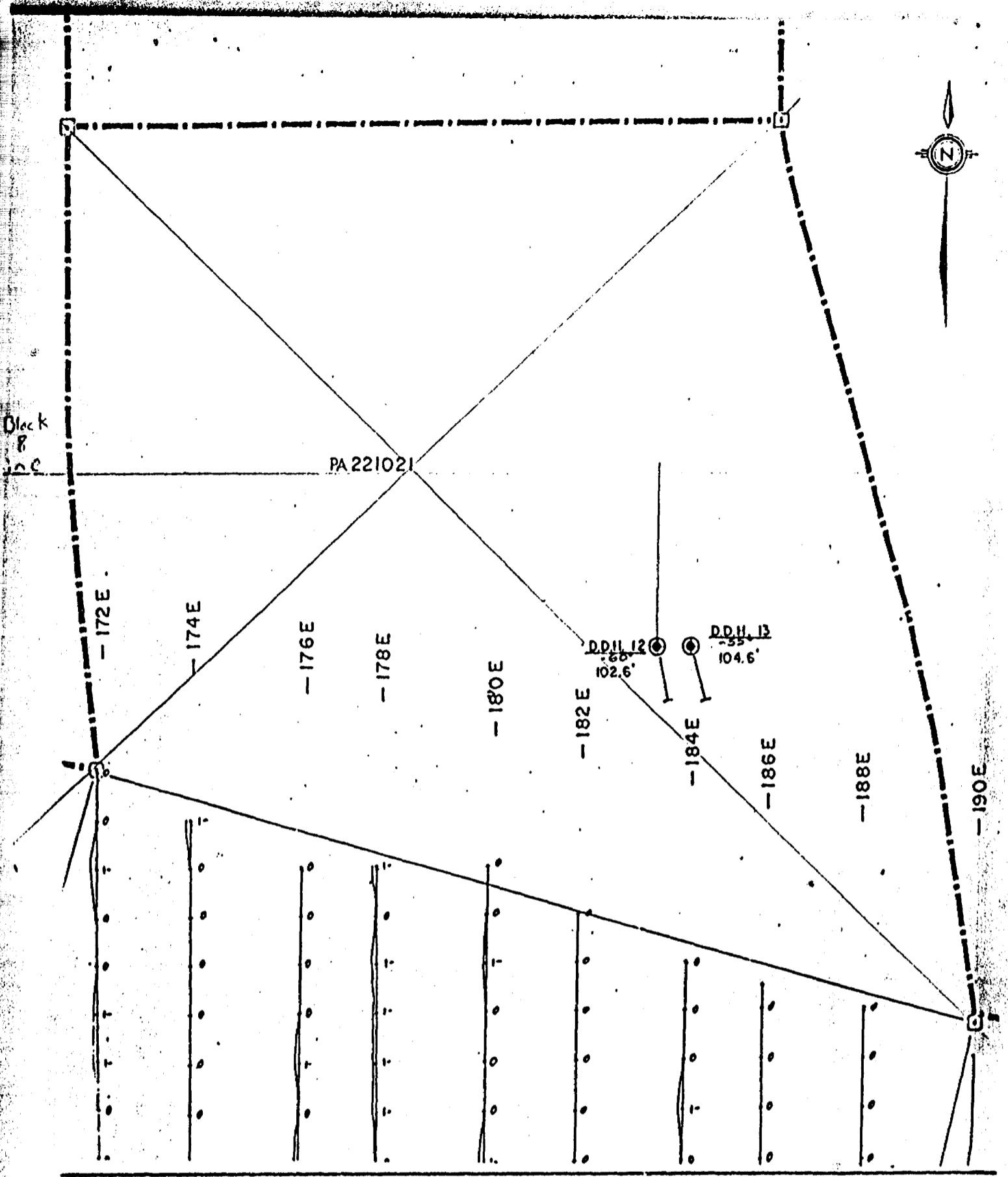

SCALE IN FEET

SCURRY-RAINBOW OIL LIMITED BRIARCOURT OPTION STURGEON LK. ONT.	CLAIM PA 221021 D.D.H. 12, 13
	FILE NO.

Ont. DEPT. OF MINES
 JAN 10 1972
 Geological Survey, Ontario

Drill Hole Log

COMPANY Scurry-Rainbow Oil Limited

PROPERTY Briar Court

Section No.

SOLE No. 11A

Started July 14	Bearing N	Lat. 132+00N	Collar EL	Logged by D. R. Doal	Date July 15, 1973
Completed July 17	Angle from Horiz. -55°	Dep. 186+00E	Bottom EL	Remarks Anomaly Drilling	
Driller Midwest	Length 327'	Location	Level		

Footage		Interval	RECOVERY		Graphic Log	DESCRIPTION	Sample No.	From - to	Interval	ASSAY		
From	To		Ft.	%						Ag	Ag	Cu
0	12	12	12			Overburden Boulders sand						
12	30					Intrusive-meta-gabbro minor chalcopyrite	11869	13-18	5	Tr	.06	.11
							11870	23-32	4	Tr	.06	.17
30	31					Dyke - fine grained felsite						
31	35					Intrusive - Cpy - Pyr. Quartz veining	11871	32-37	5	Tr	.08	.17
35	40					Greenish grey greenstone. fine grained	11872	37-41'6"	4'6"	Tr	.06	.07

Drill Hole Log

COMPANY Scurry-Rainbow Oil Limited

PROPERTY Briar Court

Section No.

HOLE No. 11A

Started July 14	Bearing N	Lat. 132+00N	Collar EL	Logged by D. R. Doal	Date July 15, 1973
Completed July 17	Angle from Horiz. -55°	Dep. 186+00E	Bottom EL	Remarks Anomaly Drilling	
Driller Midwest	Length 327'	Location	Level		

Footage		Interval	RECOVERY		Graphic Log	DESCRIPTION	Sample No.	From - to	Interval	ASSAY		
From	To		Fl	%						Ag	Cu	
0	12	12	12		Overburden Boulders sand							
12	30				Intrusive-meta-gabbro minor chalcopyrite	11869	13-18	5	Tr	.06	.11	
						11870	23-32	4	Tr	.06	.17	
30	31				Dyke - fine grained felsite							
31	35				Intrusive - Cpy - Pyr. Quartz veining	11871	32-37	5	Tr	.08	.17	
35	40				Greenish grey greenstone. fine grained	11872	37-41'6"	4'6"	Tr	.06	.07	

Drill Hole Log

COMPANY Scurry-Rainbow Oil Limited PROPERTY Briar Court Section No. _____ HOLE No. 11A

Started July 14 Bearing N Lat. 132+00N Collar EL _____ Logged by D. R. Deal Date July 15, 1973
 Completed July 17 Angle from Hertz -55° Dep. 186' DE Bottom EL _____ Remarks Anomaly Drilling
 Driller Midwest Length 327' Location _____ Level _____

Footage		Interval	RECOVERY		Graphic Log	DESCRIPTION	Sample No.	From-To	Interval	ANALYSIS		
From	To		Ft.	%						As	Ag	Gr
73'6"	96'10"											
					Medium to coarse grained meta gabbro with intermittent patch of greenstone 85'7"-88'5"							
96'10"	98'10"				Dyke - fine grained	11875	96-98	2	Tr	.06	.02	
98'10"	106'3"				Medium grained greenstone in part gabbroic minor chalcopyrite pyrite	11876	98-105	7	Tr	.18	.05	
106'3"	107'9"				Dyke - felspar							
107'9"	150				Medium to fine grained greenstone sections of coarse grained meta gabbro							

Drill Hole Log

COMPANY Scurry-Rainbow Oil Limited

PROPERTY Briar Court

Section No.

HOLE No. 11A

Started July 14	Bearing N	Lat. 132+00N	Collar EL	Logged by D. R. Doal	Date July 15, 1971
Completed July 17	Angle from Hertz -55°	Dep. 186+00E	Bottom EL	Remarks Anomaly Drilling	
Driller Midwest	Length 327'	Location	Level		

Footage		Interval	RECOVERY		Graphic Log	DESCRIPTION	Sample No.	From-To	Interval	ASSAY		
From	To		Ft.	%						Au	Ag	Cu
40	43					Intrusive as above	11873	41'6"-46'6"	5'	.010	.34	.08
43	45					Fine grained greenstone calcite veining Minor chalcopyrite pyrite						
45	54					Agglomerate? pyrite. Po. Chalcopyrite Pyrite	11874	46'6"-51'	4'6"	Tr	.04	.05
54	70					As above. Sheared. Little mineralization						
70	73'6"					Fine grained greenstone calcite veining approx. 80° to C. A.						

Drill Hole Log

COMPANY Scurry-Rainbow Oil Limited

PROPERTY Briar Court

Section No.

HOLE No. **11A**

Started July 14	Bearing N	Lat. 132+00N	Collar El.	Logged by D. R. Doal	Date July 15, 1973
Completed July 17	Angle from Horiz. -55°	Dep. 186+00E	Bottom EL	Remarks Anomaly Drilling	
Driller Midwest	Length 327'	Location	Level		

Footage		Interval	RECOVERY		Graphic Log	DESCRIPTION	Sample No.	From-To	Interval	ASSAY	
From	To		Fl.	%							
150	154				Agglomerate						
154	158				Tuff - bands at 85° to CA						
158	159'10"				Quartz vein						
159'10"	167				Tuff						
167	246'6"				agglomerate-matrix. Mafic						

Drill Hole Log

COMPANY Scurry-Rainbow Oil Limited PROPERTY Briar Court Section No _____ HOLE No. 11A

Started July 14	Bearing N	Lat. 132+00N	Collar EL	Logged by D. R. Doal	Date July 15, 1973
Completed July 17	Angle from Horiz. -55°	Dep. 186+00E	Bottom EL	Remarks Anomaly Drilling	
Driller Midwest	Length 327'	Location	Level		

Footage		Interval	RECOVERY		Graphic Log	DESCRIPTION	Sample No.	From-To	Interval	ASSAY
From	To		Ft	%						
246'6"	261				Rhyolite Dark Grey porphyritic					
261	271				Tuff banded					
271	279				Agglomerate					
279	283				Tuff - well banded					
283	294'8"				Agglomerate matrix, green-grey-meta volcanics					

Drill Hole Log

COMPANY Scurry-Rainbow Oil Limited

PROPERTY Briar Court

Section No.

HOLE No. 12

Started July 18	Bearing South	Lat. 134+00N	Collar EL	Logged by D. R. Doal	Date July 27, 1973
Completed July 24	Angle from Horiz. -55°	Dep. 184+00E	Bottom EL	Remarks	
Driller Midwest	Length 33'	Location	Level	Anomaly Drilling	

Footage		Interval	RECOVERY		Graphic Log	DESCRIPTION	Sample No.	From-To	Interval	ASSAY	
From	To		Ft.	%							
0	10					Overburden. Boulders Sand					
10	19'					Medium-coarse grained intr. meta-gabbro					
19	19'6"					Dyke fine grained, pyrite					
19'6"	22'3"					Intrusive as above					
22'3"	24'10"					Meta volcanics					

Drill Hole Log

COMPANY Scurry-Rainbow Oil Limited PROPERTY Briar Court Section No. HOLE No. 12

Started July 18 Bearing South Lat. 134+00N Collar EL Logged by D. R. Doal Date July 27, 1973

Completed July 24 Angle from Horiz. -55° Dep. 184+00E Bottom EL Remarks

Driller Midwest Length 583 Location Level Anomaly Drilling

Footage		Interval	RECOVERY		Graphic Log	DESCRIPTION	Sample No.	From To	Interval	ASSAY	
From	To		FL	%							
24'10"	26'					Intrusive					
26'	30'8"					Fine-grained-banded siliceous - Rhyolite? - pyrite					
30'8"	48'					Medium to coarse grained meta volcanics quartz seams with chalcopyrite. Sparse pyrite					
48'	50'7"					Dark green siliceous volc. banding. pyrite and Po.					
50'7"	70'					Intrusive. Coarse grained meta gabbro Minor pyrite Magnetite					

Drill Hole Log

COMPANY Scurry-Rainbow Oil Limited PROPERTY Briar Court Section No. HOLE No. 12

Started July 18 Bearing South Lat. 134+00N Collar EL Logged by D. R. Deal Date July 27, 1970
 Completed July 24 Angle from Horiz. -55° Dep. 184+00E Bottom EL Remarks
 Driller Midwest Length 583' Location Level Anomaly Drilling

Footage		Interval	RECOVERY		Graphic Log	DESCRIPTION	Sample No.	From-To	Interval	ASSAY		
From	To		Fl	%						Au	Ag	Cu
70	77'9"					Mafic volcanics - dark green with qtz. stringers. Minor chalcoprite, pyrite @ 70'6"						
77'9"	90'					Intrusive as above						
90'	98'6"					Mafic volcanic - calcite // 'll to C. A.						
98'6"	121'6"					Intrusive - mafic as above						
121'6"	125'6"					Meta volc. py-chalcopyrite, Po	11877	121-126	5	.010	.16	.17

Drill Hole Log

COMPANY Scurry-Rainbow Oil Limited PROPERTY Briar Court Section No. HOLE No. 12

Started July 18 Bearing South Lat. 134 + 00 N Collar EL Logged by D. R. Doal Date July 27, 1973
 Completed July 24 Angle from Horiz. -55° Dep. 134 + 00 E Bottom EL Remarks
 Driller Midwest Length 553' Location Level Anomaly Drilling

Footage		Interval	RECOVERY		Graphic Log	DESCRIPTION	Sample No.	From-To	Interval	ASSAY
From	To		Ft.	%						
125'6"	131'6"				Int. Mafic					
131'6"	132'4"				Fine grained rhyolite porphyry					
132'4"	153				Intrusive mafic vol. pyrite					
153	163				Siliceous - vol. - blue qtz. eyes - rhyolite?					
163	184				Int. Mafic - 183' - minor chalcopyrite					

Drill Hole Log

COMPANY Scurry-Rainbow Oil Limited PROPERTY Brice Court Section No. HOLE No.

Started July 18 Bearing South Lat. 134 + 00N Collar El. Logged by D. R. Doal Date July 27, 1971
 Completed July 24 Angle from Horiz. - 50° Dep. 184 + 00E Bottom El. Remarks
 Driller Midwest Length 583' Location Level Anomaly Drilling

Footage		Interval	RECOVERY		Graphic Log	DESCRIPTION	Sample No.	From-To	Interval	ASSAY		
From	To		Ft.	%						Au	Ag	Cu
254	256				Int. mafic Mineralized - 211' - 224' - chalcopyrite. Pyrite Biotite - 242-252 - sheared	11878	211'6" - 214' 2'6"		Tr	.18	.54	
						11879	220-224	4'	Tr	.16	.48	
256	284				As above - Biotite - minor chalcopyrite @ 274							
284	289				Dark green m. volc. lightly banded tuff?							
289	297				M. Volc. pyrite, chalc. pyrite with qtz. veins dark - greenish - grey							
297	335'6"				Intr. mafic - minor cpy pyrite - through- out - cpy in qtz vein @ 330'8"	11880	311-314	3		.010	.20	.89

Drill Hole Log

COMPANY Scurry-Rainbow Oil Limited PROPERTY Briar Court Section No. _____ HOLE No. 12

Started July 18 Bearing South Lat. 134 + 00 N Collar EL _____ Logged by D. R. Doal Date July 27, 1973
 Completed July 24 Angle from Horiz. -55° Dep. 1S4+00E Bottom EL _____ Remarks _____
 Driller Midwest Length 583' Location _____ Level _____ Anomaly Drilling _____

Footage		Interval	RECOVERY		Graphic Log	DESCRIPTION	Sample No.	From-To	Interval	ASSAY	
From	To		FL	%							
335'6"	375					Fine-grained porphyritic grey - rhyolite					
375	411					Intr. mafic dark green - minor cpy - 409-410					
411	413					Fine-grained dyke grey - calcite					
413	424					Intr. mafic					
424	428					Dyke porphyritic rhy. ?					

Drill Hole Log

COMPANY Scurry-Rainbow Oil Limited PROPERTY Briar Court Section No. HOLE No. 12

Started July 18 Bearing South Lat. 134 + 00 N Collar EL. Logged by D. R. Doal Date July 27, 1971
 Completed July 24 Azim. from Horiz. -55° Dep. 134+00E Bottom EL. Remarks
 Driller Midwest Length 583' Location Level Anomaly Drilling

Footage		Interval	RECOVERY		Graphic Log	DESCRIPTION	Sample No.	From-To	Interval	ASSAY
From	To		Ft.	%						
428	439'6"				Intr. mafic as before					
439'6"	443'6"				Porphyritic rhyolite grey					
443'6"	456'6"				Meta volc - light green qtz. veins, sheared minor cpy and pyrite					
456'6"	467'				Grey - agglomerate? (Brecciated?) Minor cpy, pyrite, qtz. veining 458-459 and 465-466					
467	471'6"				Meta volc. - light green					

Drill Hole Log

COMPANY Scurry-Rainbow Oil Limited PROPERTY Briar Court Section No. HOLE No. 12

Started July 18 Bearing South Lat. 134 + 00 N Collar EL Logged by D. R. Doa. Date July 27, 1973

Completed July 24 Angle from Horiz. -55° Dep. 184 + 00 E Bottom EL Remarks

Driller Midwest Length 83' Location Level Anomaly Drilling

Footage		Interval	RECOVERY		Graphic Log	DESCRIPTION	Sample No.	From-To	Interval	ASSAY
From	To		ft	%						
471'6"	512'6"					Light grey green banded chloritic schist				
512'6"	516					Light grey porphyritic rhy.				
516	524					Meta volc. dk green chloritic - minor cpy.				
524	551					Light grey - green rhyolite porphyritic 524-527				
551	576'3"					M. vol. chloritic minor cpy.				

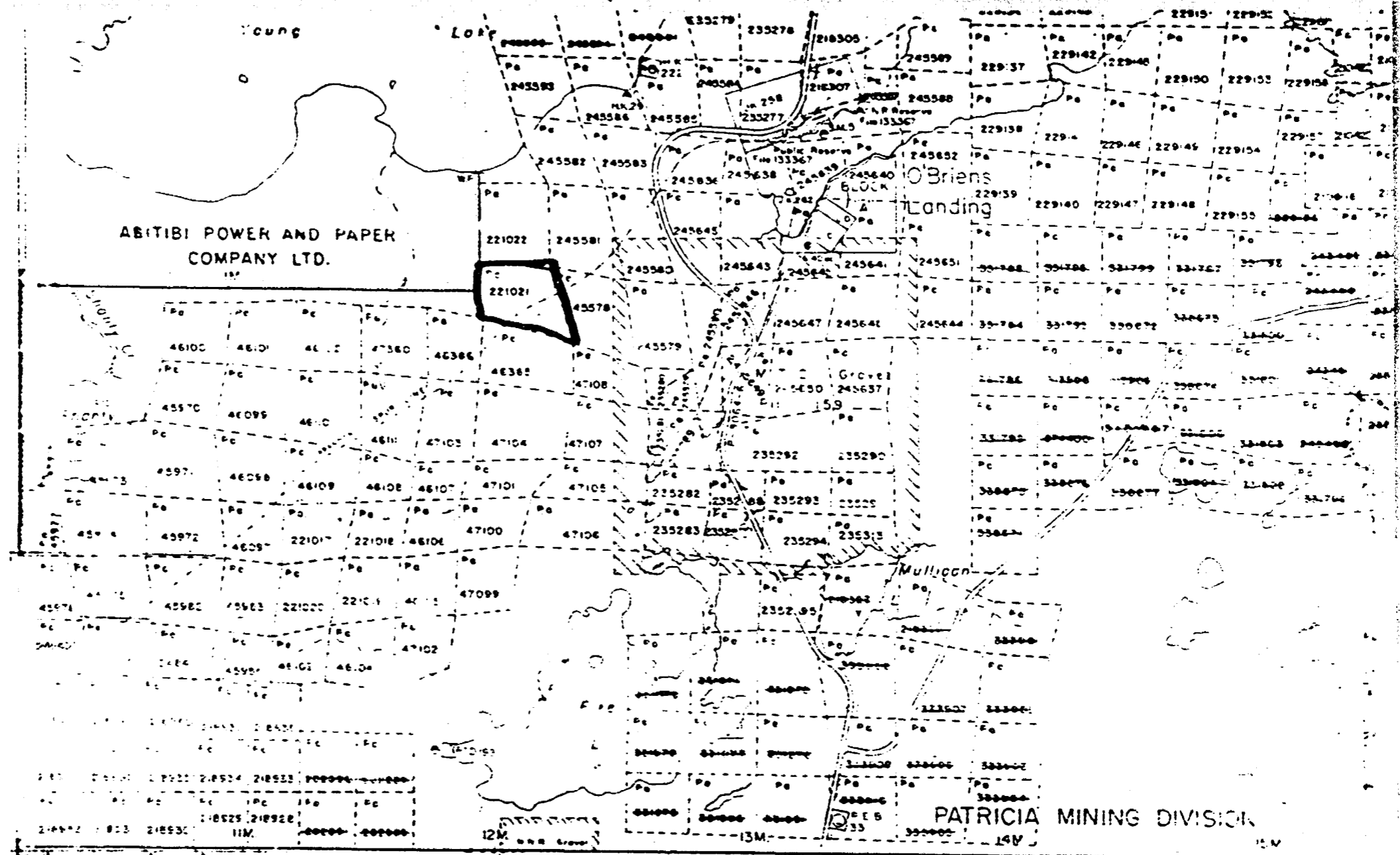

ABITIBI POWER AND PAPER
COMPANY LTD.

O'Briens
Landing

PATRICIA MINING DIVISION

KENORA MINING DIVISION

VALORA LAKE 
M-2052

Scale
40 chains

21892 21893 21894 21895

12M
181903 & 181904

BASE

LINE

15M

PRESS LAKE RECEIVED VALORA LAKE

M-1947

DEC 17 1973

REGIONAL OFFICE, KENORA

M-2052

A separate form is required for each type of work to be recorded.

135

THE MINING ACT REPORT OF WORK

To the Recorder of... Patricia Mining Division Mining Division

I, Scurry-Rainbow Oil Limited name of Recorded Holder

1279 Miner's Licence

709-8th Avenue Southwest, Calgary, Alberta T2P 1H5 Post Office Address

do hereby report the performance of 2220' days of Diamond drilling type of work

not before reported to be applied on the following contiguous claims

Claim No.	Days	Claim No.	Days	Claim No.	Days
PA248402	80	PA248410	80	PA248422	80
PA248403	80	PA248411	80	PA 248430	80
PA.248404	80	PA248421	80	PA 244353	80
PA248405	80	PA248423	80	PA244354	80
PA248408	80	PA248424	80	PA244355	80
PA248409	80	PA248425	80		

All the work was performed on Mining Claim (s) Pa. 40100, 221017, 221018, 21021 (In the case of geological and/or geophysical survey (s) where more than 18 claims are involved attach a schedule.)

READ CAREFULLY: THE FOLLOWING INFORMATION IS REQUIRED BY THE MINING RECORDER.

- For Manual Work, Stripping or Opening up of Mines, Sinking Shafts or Other Actual Mining Operations - Names and addresses of the men who performed the work and the dates and hours of their employment.
- For Diamond and other Core Drilling - Footage, No. and angle of holes and diameter of core. Name and address of owner or operator of drill. Dates when drilling was done. Signed core log and sketch in duplicate.
- For Compressed Air or Other Power Driven or Mechanical Equipment - Type of drill or equipment. Names and addresses of men engaged in operating equipment and the dates and hours of their employment.
- For Power Stripping - Type of equipment. Name and address of owner or operator. Amount expended. Dates on which work was done. Proof of actual cost must be submitted within 30 days of recording.
- With each of the above types of work sketches are required to show the location and extent of the work in relation to the nearest claim post. In the case of diamond or other core drilling the sketch must be submitted in duplicate.
- For Geological and Geophysical Survey - The names and addresses of men employed as well as dates. Type of instrument used in the case of geophysical survey. Reports and maps in duplicate must be filed with the Minister within 60 days of recording.
- For Land Survey - the name and address of Ontario Land surveyor.

The Required Information is as Follows: (Attach a list if this space is insufficient)

See Appendix "A"

Core Logs and Sketches to follow

Drilled 2667
Records 2220
444 for future filling

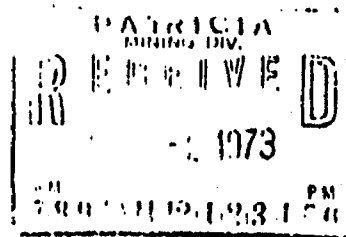

Date October 30, 1973

Signature of Recorded Holder or Agent

The Mining Act



52G14SE0022 52G14SE0015 VALORA LAKE

NG A FALSE STATEMENT IN THIS REPORT AND/OR CERTIFICATE IS \$500. OR SIX MONTHS IMPRISONMENT OR BOTH.

SCURRY - RAINBOW OIL LIMITED
 REQUIRED INFORMATION TO ACCOMPANY
 MINING ACT REPORT OF WORK - OCTOBER 30, 1973

<u>Drill #</u>	<u>Footage</u>	<u>∟ Hole</u>	<u>Core Dia</u>	<u>Dates</u>	<u>Name/Address</u>
11A 221021	327	-55°N	1 7/16" BQ	July 13-17	Scurry-Rainbow Oil Limited 709 - 8th Avenue Southwest Calgary, Alberta T2P 1H5
12 221021	583	-55°S	1 7/16" BQ	July 18-22	
13 221017	367	-50°S30°E	1 7/16" BQ	July 27-31	
14 221018	343	-60°S	1 7/16" BQ	Aug. 1-6	
15 221017	597	-60°S	1 7/16" BQ	Aug. 7-15	
16	28 <i>see Log.</i>		1 7/16" BQ	Aug. 23	
16A 46106	447	-60°S	1 7/16" BQ	Aug. 23-31	

Total Drilled 2692'

Total M/D applied for ~~2660~~ ²⁶⁶⁴

NB: Drill move July 23-26 ²²²⁰ ₄₄₄ *for future filing*
 Water preparation August 16-22

Contract Drillers - Midwest Drilling, Kenora, Ontario

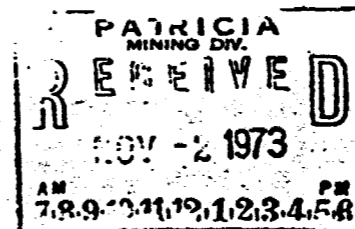

Claim No.	Days
PA218928	40
PA218929	40
PA218930	40
PA218931	40
PA218932	40
PA218933	40
PA218934	40
PA218935	40
PA218936	40
PA218937	40
PA218938	40
PA218939	40
PA218940	40
PA218941	40
PA218942	40
	<u>40</u>
	600

Claim No.	Days
PA45978	40
PA45979	60
PA45980	60
PA45981	60
PA45982	40
	<u>40</u>
	260

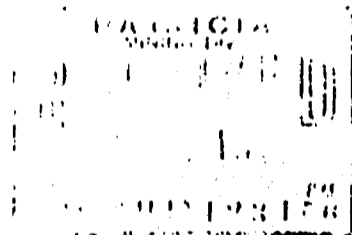

KENORA
 MINING DIV.
RECEIVED
 NOV 29 1971
 8:00 PM
 R. 10 11 12 1 2 3 4 5 6 7

S. Wpt of Sturgeon Lake 2266
 Valora & Unaka M-2052



A separate form is required for each type of work to be recorded.

THE MINING ACT REPORT OF WORK

To the Recorder of... Kenora Mining Division

I, Scurry-Rainbow Oil Limited T-299
 name of Recorded Holder Miner's Licence

..... 709 - 8th Avenue S.W., Calgary 2, Alberta
 Post Office Address

do hereby report the performance of ... 1240' - 6" ... days of Diamond Drilling
 not before reported to be applied on the following contiguous claims Valora M-2052
 type of work

Claim No.	Days	Claim No.	Days	Claim No.	Days
K218923	60
K218924	60
K218925	60
K218926	60
K218927	60

V4U

~~Sturgeon Lake M-1947~~

All the work was performed on Mining Claim (s) PA249109, PA45982, PA221021, K-249112, K-248431...
 (In the case of geological and/or geophysical survey (s) where more than 18 claims are involved attach a schedule)

READ CAREFULLY: THE FOLLOWING INFORMATION IS REQUIRED BY THE MINING RECORDER.

- For Manual Work, Stripping or Opening up of Mines, Sinking Shafts or Other Actual Mining Operations - Names and addresses of the men who performed the work and the dates and hours of their employment.
- For Diamond and other Core Drilling - Footage, No. and angle of holes and diameter of core. Name and address of owner or operator of drill. Dates when drilling was done. Signed core log and sketch in duplicate.
- For Compressed Air or Other Power Driven or Mechanical Equipment
 Type of drill or equipment. Names and addresses of men engaged in operating equipment and the dates and hours of their employment.
- For Power Stripping - Type of equipment. Name and address of owner or operator. Amount expended. Dates on which work was done. Proof of actual cost must be submitted within 30 days of recording.
- With each of the above types of work sketches are required to show the location and extent of the work in relation to the nearest claim post. In the case of diamond or other core drilling the sketch must be submitted in duplicate.
- For Geological and Geophysical Survey - The names and addresses of men employed as well as dates. Type of instrument used in the case of geophysical survey. Reports and maps in duplicate must be filed with the Minister within 60 days of recording.
- For Land Survey - the name and address of Ontario Land surveyor.

The Required Information is as Follows: (Attach a list if this space is insufficient)

SEE ATTACHED

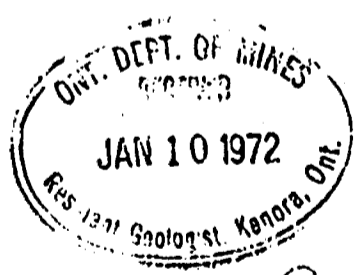

Date November 8, 1971

Signature of Recorded Holder or Agent

**The Mining Act
 Certificate Verifying Report of Work**

I, Don Doa
 709 - 8th Avenue S.W., Calgary 2, Alberta
 (Post Office Address)

hereby certify:
 1. That I have a personal and intimate knowledge of the facts set forth in the report of work annexed hereto, having performed the work or witnessed same during and/or after its completion.
 2. That the annexed report is true.

Dated November 8, 1971

Signature

K248431

THE PENALTY FOR MAKING A FALSE STATEMENT IN THIS REPORT AND/OR CERTIFICATE IS \$500. OR SIX MONTHS IMPRISONMENT OR BOTH

Required information to accompany 'Mining Act Report of Work' Scurry-Rainbow Oil

Limited submission dated November 8, 1971.

<u>DRILL #</u>	<u>FOOTAGE</u>	<u>/ HOLE</u>	<u>CORE DIA.</u>	<u>DATES</u>	<u>NAME/ADDRESS</u>
249112 1 Kenwa	101.' - 0"	- 55°	7/8" XRP	Sept. 16 - 18	S.R.O. 709 - 8th Avenue S.W.
2	26.' - 0"	- 50°	7/8" XRP	Sept. 19 - 20	S.R.O. 709 - 8th Avenue S.W.
3	102.' - 6"	- 55°	7/8" XRP	Sept. 21 - 23	S.R.O. 709 - 8th Avenue S.W.
4	101.' - 6"	- 90°	7/8" XRP	Sept. 24 - 25	S.R.O. 709 - 8th Avenue S.W.
249131 5 Kenwa	103.' - 0"	- 55°	7/8" XRP	Sept. 27 - 29	S.R.O. 709 - 8th Avenue S.W.
249131 6 Kenwa	101.' - 0"	- 55°	7/8" XRP	Sept. 30 - Oct. - 2	S.R.O. 709 - 8th Avenue S.W.
7	103.' - 6"	- 55°	7/8" XRP	Oct. 6 - 9	S.R.O. 709 - 8th Avenue S.W.
8	103.' - 6"	- 60°	7/8" XRP	Oct. 11 - 13	S.R.O. 709 - 8th Avenue S.W.
9	103.' - 6"	- 60°	7/8" XRP	Oct. 14 - 16	S.R.O. 709 - 8th Avenue S.W.
10	104.' - 6"	- 55°	7/8" XRP	Oct. 17 - 19	S.R.O. 709 - 8th Avenue S.W.
11	103.' - 6"	- 50°	7/8" XRP	Oct. 20 - 22	S.R.O. 709 - 8th Avenue S.W.
12	102.' - 6"	- 60°	7/8" XRP	Oct. 24 - 26	S.R.O. 709 - 8th Avenue S.W.
13	104.' - 6"	- 55°	7/8" XRP	Oct. 27 - 29	S.R.O. 709 - 8th Avenue S.W.

Requesting Hole #1, #3 to #13 inclusive 1234.6 M/D

Hole #2 only 6.0 M/D

Total Man/Days Applied For 1240.6 M/D

101
103
101
305

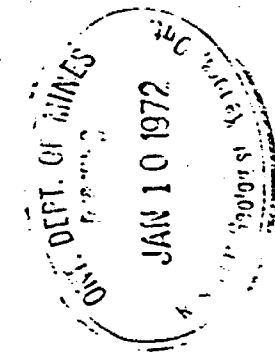

Handwritten signature

SEE ACCOMPANYING
MAP(S) IDENTIFIED AS

52G/14SE-0015 #1-2

LOCATED IN THE MAP
CHANNEL IN THE
FOLLOWING SEQUENCE

(X)

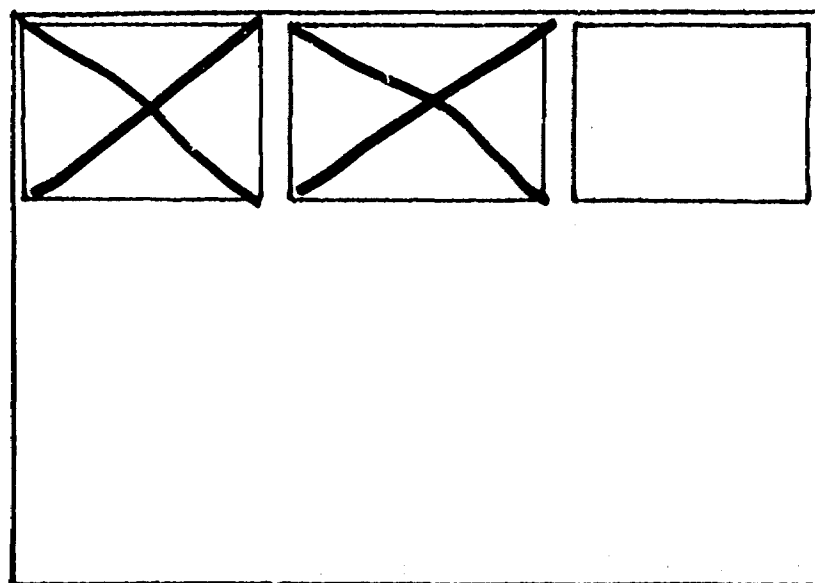

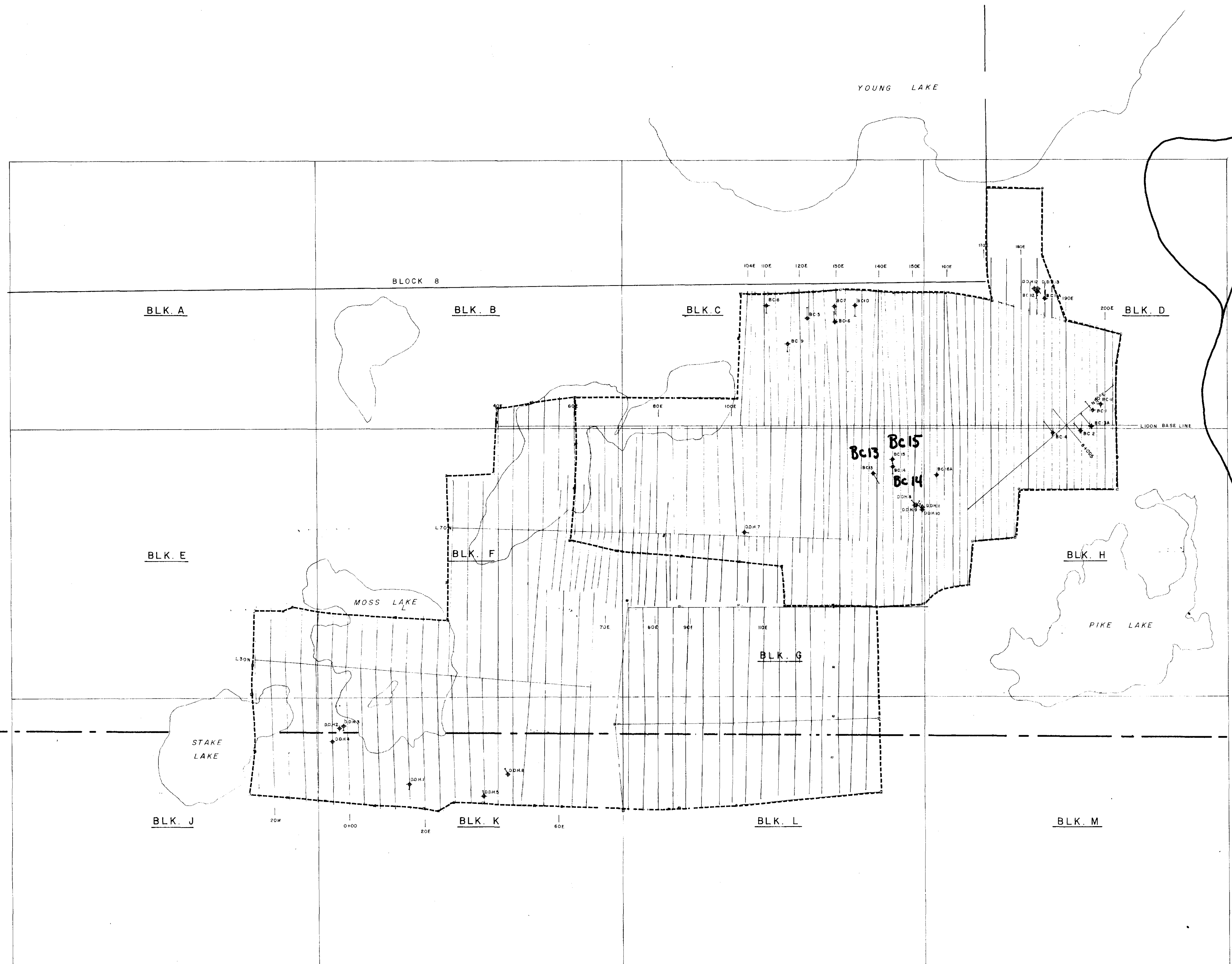
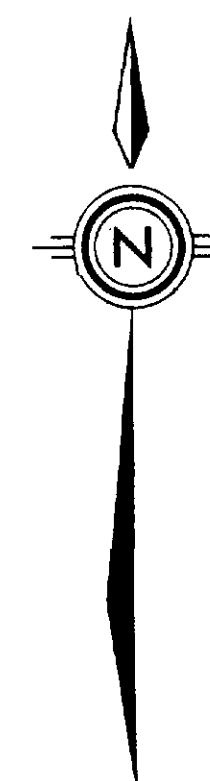

PATRICIA MINING DISTRICT
KENORA MINING DISTRICT

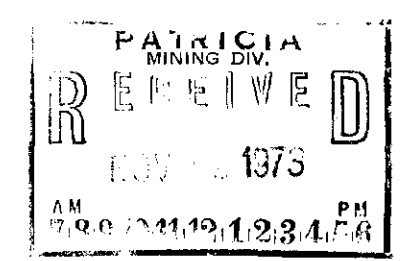

ASSESSMENT AREA
PACK SACK DRILLING DDH-2
DIAMOND DRILLING BC-2



200

52G/15 SE-0015 #1

DRAWN R.M.	SCALE 1" = 1320'	SCURRY-RAINBOW OIL LTD.	MASTER BLOCK PLAN & CUT LINES
TRACED	DATE MAR 1970	BRIARCOURT OPTION STURGEON LAKE, ONT.	FILE NO. STUR 2-6-2
APPROVED			

