

52G15NW0006 52G/15NW-90-A SIXMILE LAKE

010

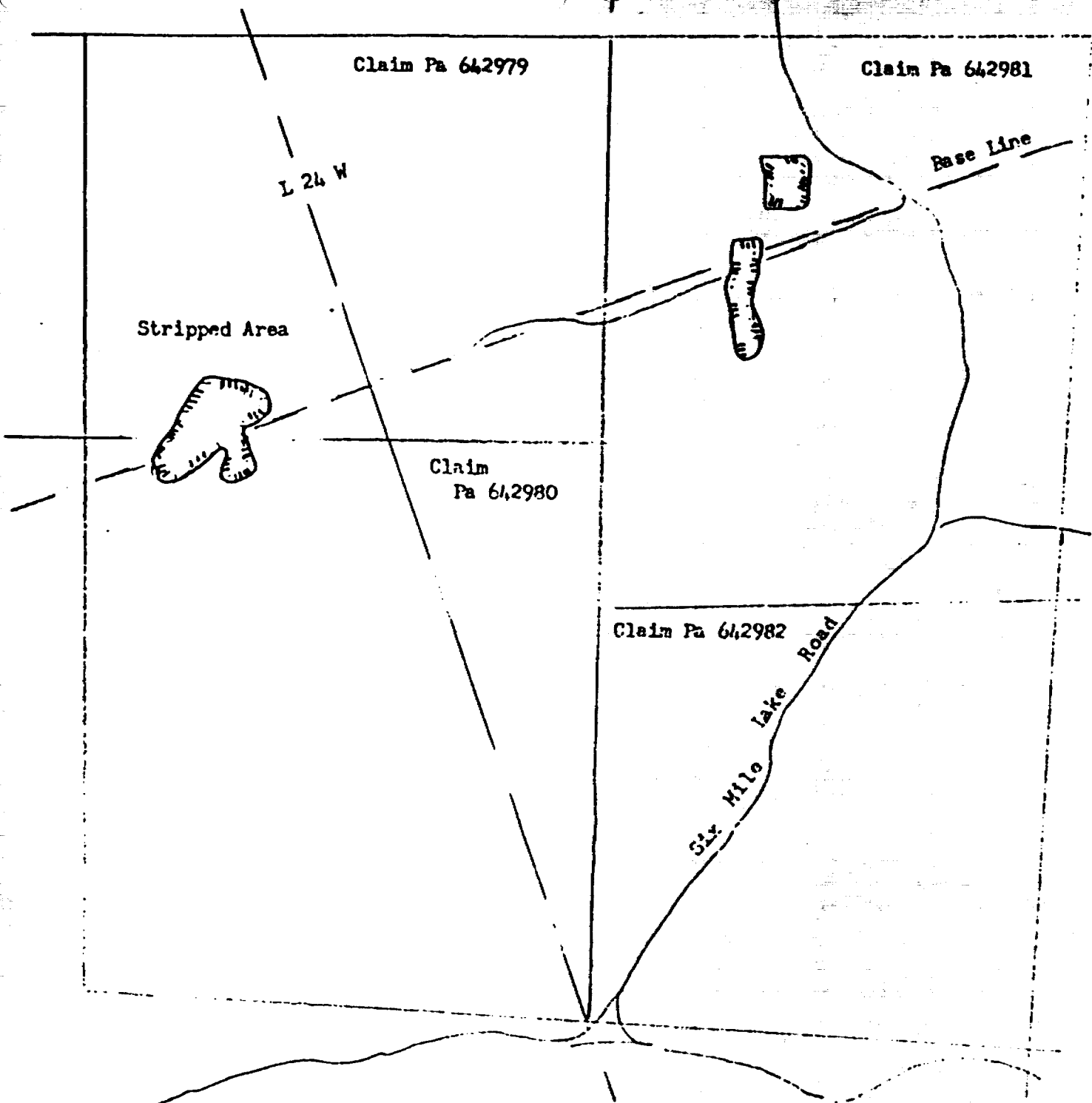

PATRICIA MINING DIV.
RECEIVED
 MAR - 1 1984
 A.M. P.M.
 7 8 9 10 11 12 1 2 3 4 5 6

POWER STIPPED AREAS
 Claims Pa. 642979 - 80 - 81

SIX MILE LAKE AREA
 Claim Map M. 2877
 Sturgeon Lake, Ont.
 CANADAX PLAYFAIR JOINT VENTURE
 Scale 1" = 400'
 L. J. Cunningham, B.Sc., P.Eng.
 February, 1984

400 FT
 SCALE

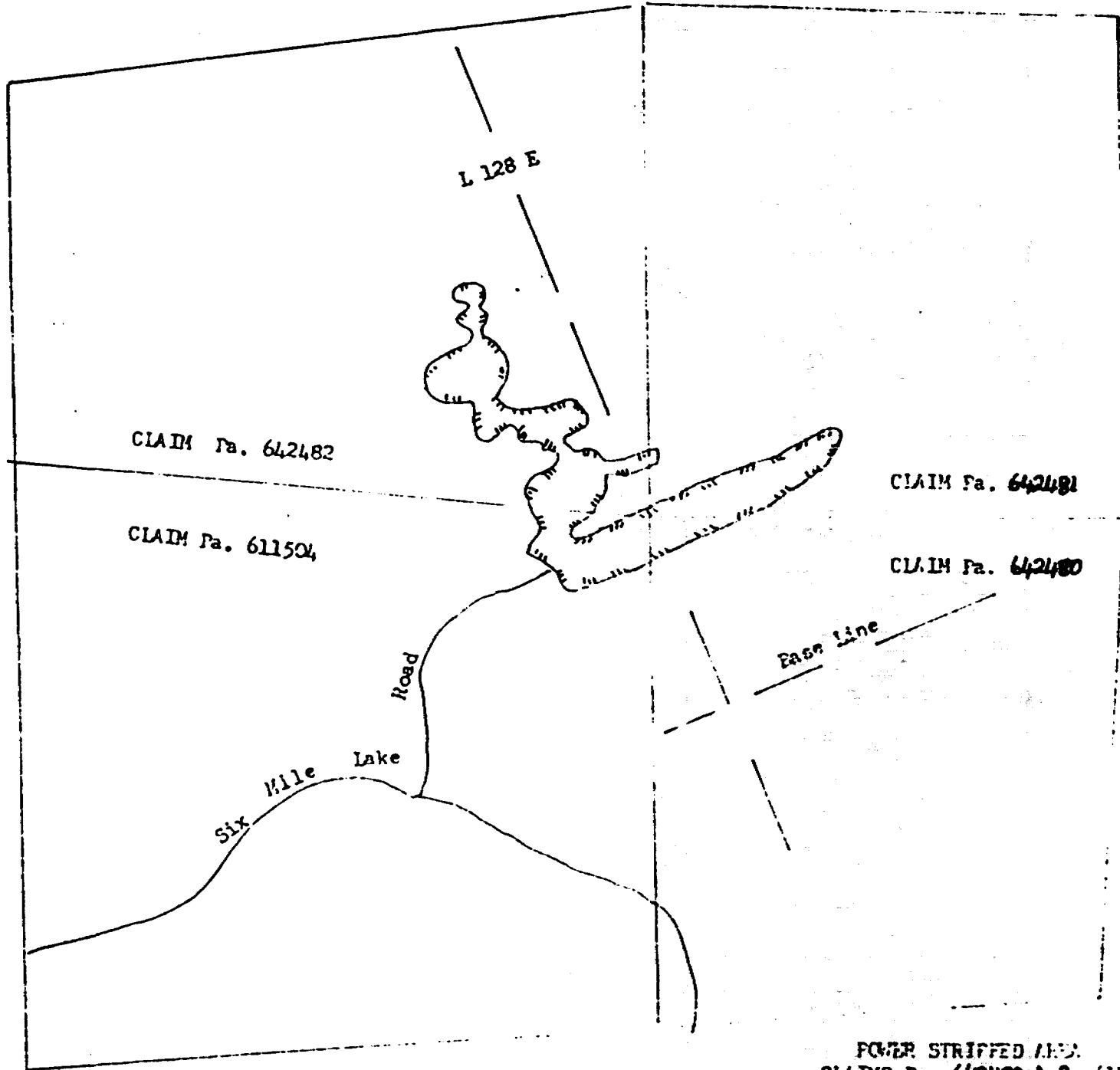

POWER STRIPPED AREA
 CLAIMS Pa. 642480-1-2, 611504

PATRICIA MINING DIV.
RECEIVED
 MAR - 1 1984
 A.M. P.M.
 7 8 9 10 11 12 1 2 3 4 5 6

SIX MILE LAKE AREA
 Claim Map M.2877
 Sturgeon Lake, Ont.

CANADIX PLAYFAIR JOINT VENTURE

Scale 1" = 400' 400 FT
SCALE

L. J. Cunningham, P.Sc., P.Eng.
 February, 1984

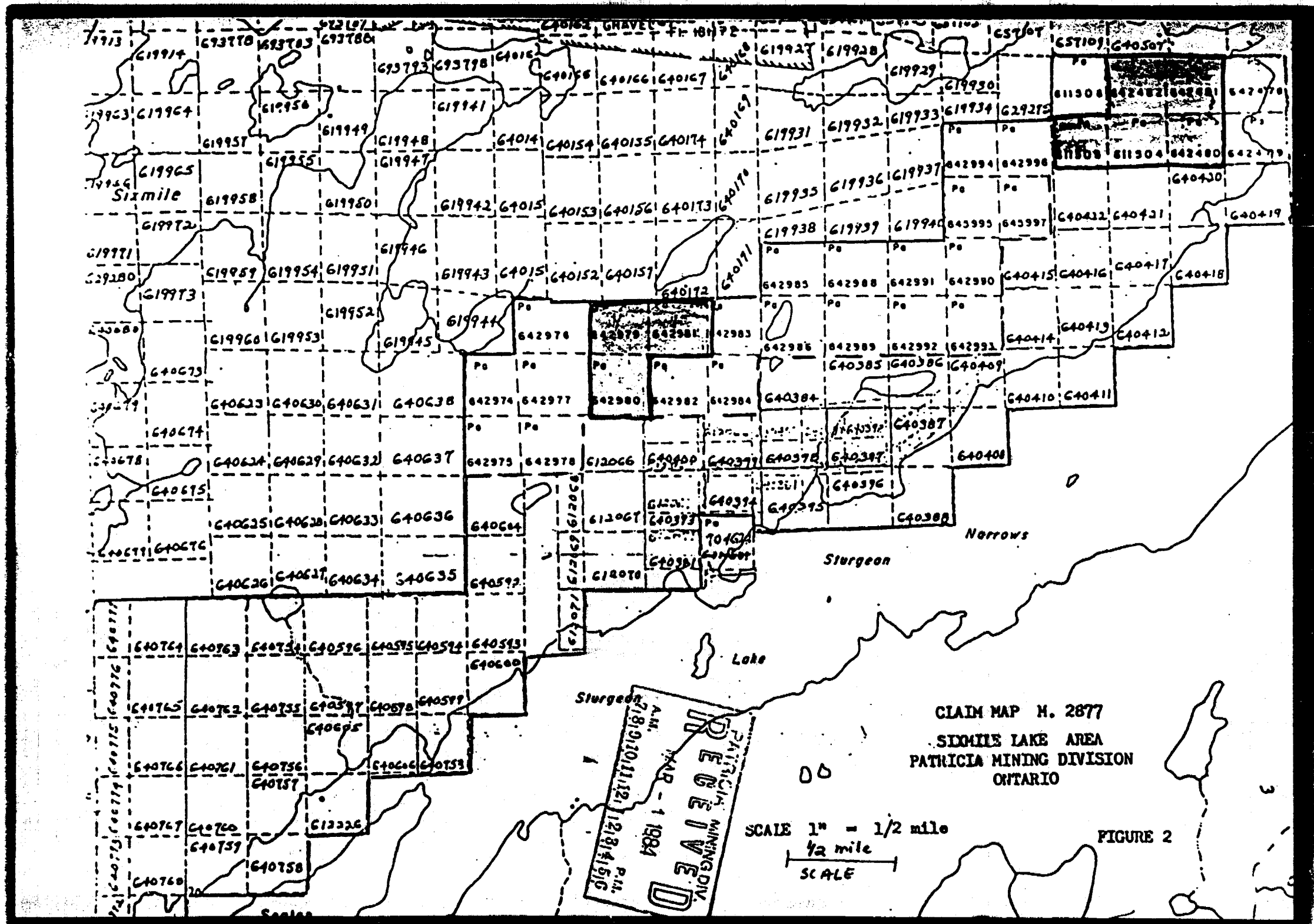

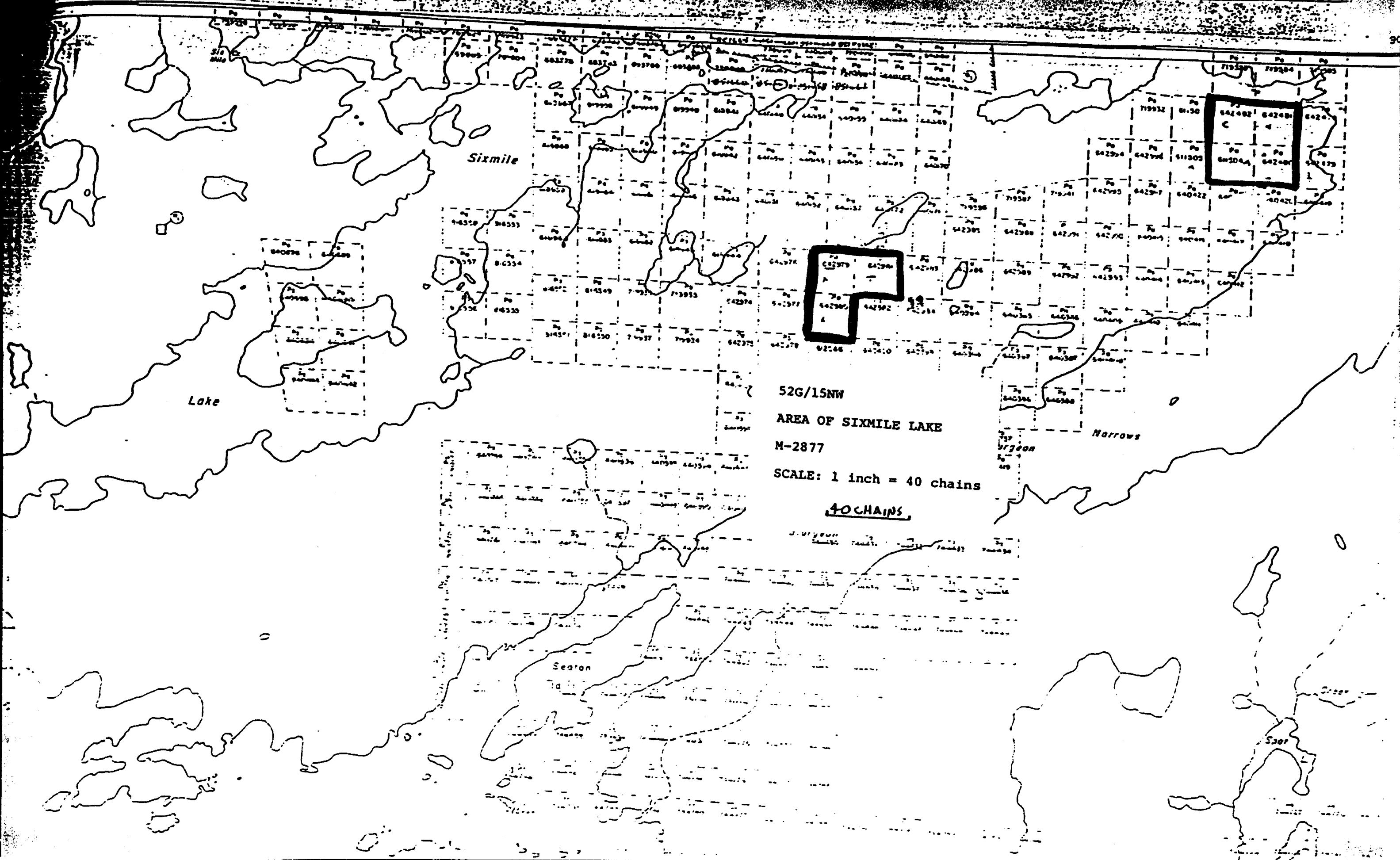

52G/15NW

AREA OF SIXMILE LAKE

M-2877

SCALE: 1 inch = 40 chains

40 CHAINS

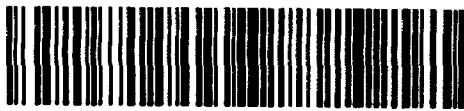

52G15NW0006 52G/15NW-90-A SIXMILE LAKE

900

Sixmile Lake M-2877

Ministry of Natural Resources Report of Work

#84-43

Instructions - Supply required data on a separate form for each type of work to be recorded (see table below). For Geo-technical work use form no. 1362 "Report of Work (Geological, Geophysical, Geochemical and Expenditures)".

Res. Geologist

52G15NW(16) The Mining Act

Name and Postal Address of Recorded Holder: **L. J. CUNNINGHAM**
 1 McPhee Ave Kirkland Lake, Ont. P2N1M1

Prospector's Licence No.: **321286**

Summary of Work Performance and Distribution of Credits

Total Work Days Cr. claimed 411.6	Mining Claim			Mining Claim			Mining Claim		
	Prefix	Number	Work Days Cr.	Prefix	Number	Work Days Cr.	Prefix	Number	Work Days Cr.
for Performance of the following work. (Check one only) <input type="checkbox"/> Manual Work <input type="checkbox"/> Shaft Sinking Drifting or other Lateral Work. <input type="checkbox"/> Compressed Air, other Power driven or mechanical equip. <input checked="" type="checkbox"/> Power Stripping <input type="checkbox"/> Diamond or other Core drilling <input type="checkbox"/> Land Survey	Pa	611504	20	Pa	642482	20	Pa	642480	20
		611505	20		-			642481	20
		611506	20		642474	20		642482	20
		-			642475	20		642483	20
		642478	20		642476	20		642484	20
		642479	20		642477	20		642485	20
		642480	20		642478	20		642486	11.6
		642481	20		642479	20			

All the work was performed on Mining Claim(s): Pa 611504; 642480-81-82 642479-80-81

Required Information eg: type of equipment, Names, Addresses, etc. (See Table Below)

POWER STRIPPING

1st Rec'd Mar. 1/84	D.E. & J.C. Hutchinson Contracting Co. Ltd., Box 220, Dryden, Ontario	25-29 Sept. 1983	\$3,000.00
	Kenora Drilling, Box 661, Kenora, Ont. P9N 3X6	21-31 Aug. 1983	1,116.00
		Total	\$4,116.00

PATRICIA MINING DIV.

RECEIVED APR 26 1984

Recorded

Total

\$4,116.00

EQUIVALENT CRED DAYS @ 10.00/day = 411.6 days

Receipts attached

Pa. 611504

Date of Report: **25 Feb/84**
 Recorder/Holder or Agent (Signature): *[Signature]*

Certification Verifying Report of Work

and 24 April/84

I hereby certify that I have a personal and intimate knowledge of the facts set forth in the Report of Work annexed hereto, having performed the work or witnessed same during and/or after its completion and the annexed report is true.

Name and Postal Address of Person Certifying

L. J. CUNNINGHAM, 1 McPHEE AVE Kirkland Lake, Ontario P2N1M1

Date Certified: **25 Feb/84**
 Certified by (Signature): *[Signature]*

Table of Information/Attachments Required by the Mining Recorder and 24 April/84

Type of Work	Specific information per type	Other information (Common to 2 or more types)	Attachments
Manual Work	Nil	Names and addresses of men who performed manual work/operated equipment, together with dates and hours of employment.	2 sketches Work Sketch: these are required to show the location and extent of work in relation to the nearest claim post.
Shaft Sinking, Drifting or other Lateral Work			
Compressed air, other power driven or mechanical equip.	Type of equipment	Names and addresses of owner or operator together with dates when drilling/stripping done.	2 copies Work Sketch (as above) in duplicate
Power Stripping	Type of equipment and amount expended. Note: Proof of actual cost must be submitted within 30 days of recording.		
Diamond or other core drilling	Signed core log showing; footage, diameter of core, number and angles of holes.	Nil	Nil
Land Survey	Name and address of Ontario land surveyor.		