

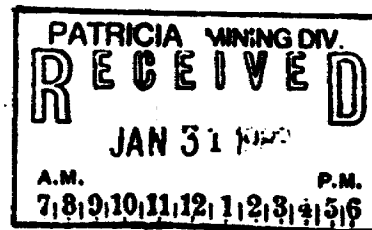

52G15NW0026 52G15NW0006 PENASSI LAKE

010

ELECTROMAGNETIC SURVEY



COBB BAY PROJECT

NTS 52 G 14 & 15

RECEIVED
JAN 8 1982
MINING LANDS SECTION

PHANTOM EXPLORATION SERVICES LTD.

March, 1982

R. D. Middaugh

INTRODUCTION

Corporation Falconbridge Copper of Thunder Bay, Ontario contracted Phantom Exploration Services Ltd., also of Thunder Bay, to undertake cutting a grid and subsequently conducting an electromagnetic (H. E. M.) survey on this grid on the so called Cobb Bay Project during the winter of 1982.

LOCATION, ACCESS, AND GRID

The survey area is located just east of highway #599 approximately 50 kilometers south of Savant Lake, Ontario. The area is protected by 60 unpatented claims numbered 587725-587744 inclusive, 587704-587723 inclusive, and 602090-602109 inclusive.

Access to the area via highway #599 is excellent all year round. The road to Cobb Bay resort can be travelled easily during the summer and it greatly facilitates access to the property by snow machine in the winter.

The grid was established under subcontract by Mr. G. Sage of Yellowknife, N.W.T. The work was done during the winter months of 1982. Approximately 118.4 kilometers of line were cut, chained, and picketed at 25 meter intervals.

PERSONNEL

The day to day supervision of the survey crew during March was under Derek F. Brown while overall supervision of the geophysical program was under R. D. Middaugh. Both men are employees of Phantom Exploration Services Ltd.

INSTRUMENTATION

Two Max Min II units manufactured by Apex Parametrics Limited of Markham, Ontario were used for this survey. Both in and out of phase readings were taken at 25 meter intervals. The frequencies read were 444 Hz and 1777 Hz while the coil separation was 150 meters.

DISCUSSION OF RESULTS

The survey area is presented in plan form at a scale of 1:5000 with the vertical scale set at 1 cm = 10% for the EM profiles.

Unfortunately, other than a few weak conductive trends no major anomalies were located. These weak responses, located in the lake, are only identified on 1777 Hz and are due to lake bottom.

The rather noisy readings obtained on the extreme western portion of the grid are due to powerline interference.

The only other thing of note is very weak responses associated with magnetic highs such as the one located on lines 12E and 13E at 10S. These are probably due to sulphide concentrations associated with gabbroic (?) intrusions.

CONCLUSIONS AND RECOMMENDATIONS

Barring any encouragement obtained from a limited mapping program to check out the weak responses associated with the magnetic highs, no further work is warranted on this property.

Submitted by,

Phantom Exploration Services Ltd.

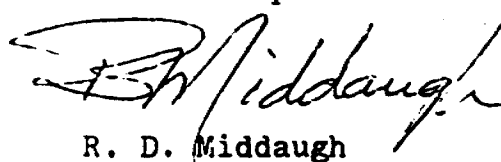
A handwritten signature in cursive script, appearing to read 'R. D. Middaugh', written in dark ink.

R. D. Middaugh

Geologist

APPENDIX

Map 1.	HEM Survey	1777 Hz Profiles
Map 2.	HEM Survey	1777 Hz Raw Data
Map 3.	HEM Survey	444 Hz Profiles
Map 4.	HEM Survey	444 Hz Raw Data



52G15NW0026 52G15NW0086 PENASSI LAKE

ural Resources

File _____

900 GICAL - GEOCHEMICAL
A STATEMENT

PATRICIA MINING DIV.
RECEIVED
JAN 31 1983
P.M.
7 8 9 10 11 12 1 2 3 4 5 6

TO BE ATTACHED AS AN APPENDIX TO TECHNICAL REPORT
FACTS SHOWN HERE NEED NOT BE REPEATED IN REPORT
TECHNICAL REPORT MUST CONTAIN INTERPRETATION, CONCLUSIONS

Type of Survey(s) ELECTROMAGNETIC MAXMIN II, LINECUTTING
Township or Area PENASSI LAKE AND SIX MILE LAKE
Claim Holder(s) CORPORATION FALCONBRIDGE COPPER
P.O. BOX 40, COMMERCE COURT WEST, TORONTO, ONT. M5L 1B4
Survey Company PHANTOM EXPLORATION SERVICES LIMITED
Author of Report R. D. MIDDAGH
Address of Author R.R. #14, 736 ALICE AVE. THUNDER BAY, ONT.
Covering Dates of Survey JANUARY 15th - MARCH 15th, 1982
(including to office)
Total Miles of Line Cut 118.4 Km.

MINING CLAIMS TRAVERSED
List numerically

PA (prefix)	587704 (number)
PA	587705
	587706
	587707
	587708
	587709
	587710
	587711
	587712
	587713
	587714
	587715
	587716
	587717
	587718
	587719
	587720
	587721
	587722
	587723
	587724
	587725
TOTAL CLAIMS 61	

If space insufficient, attach list

SPECIAL PROVISIONS
CREDITS REQUESTED

DAYS
per claim

ENTER 40 days (includes
line cutting) for first
survey.

ENTER 20 days for each
additional survey using
same grid.

Geophysical
- Electromagnetic 40
- Magnetometer _____
- Radiometric _____
- Other _____
Geological _____
Geochemical _____

AIRBORNE CREDITS (Special provision credits do not apply to airborne surveys)

Magnetometer _____ Electromagnetic _____ Radiometric _____
(enter days per claim)

DATE: MARCH 15, 1982 SIGNATURE: R. D. Middagh
Author of Report or Agent

Res. Geol. _____ Qualifications D. B. S.

Previous Surveys

File No.	Type	Date	Claim Holder

RECEIVED

JUN 8 1983

MINING LANDS SECTION

See
List

TOTAL CLAIMS 61 Attached

OFFICE USE ONLY

GEOPHYSICAL TECHNICAL DATA

GROUND SURVEYS - If more than one survey, specify data for each type of survey

Number of Stations _____ Number of Readings _____
Station interval _____ Line spacing _____
Profile scale _____
Contour interval _____

MAGNETIC

Instrument _____
Accuracy - Scale constant _____
Diurnal correction method _____
Base Station check-in interval (hours) _____
Base Station location and value _____

ELECTROMAGNETIC

Instrument MAXMIN II
Coil configuration _____
Coil separation 150 Meters
Accuracy _____
Method: Fixed transmitter Shoot back In line Parallel line
Frequency 444 Hz, 1777 Hz (specify V.L.F. station)
Parameters measured In phase, out of phase

GRAVITY

Instrument _____
Scale constant _____
Corrections made _____
Base station value and location _____
Elevation accuracy _____

INDUCED POLARIZATION RESISTIVITY

Instrument _____
Method Time Domain Frequency Domain
Parameters - On time _____ Frequency _____
- Off time _____ Range _____
- Delay time _____
- Integration time _____
Power _____
Electrode array _____
Electrode spacing _____
Type of electrode _____

CORPORATION FALCONBRIDGE COPPER,
P. O. BOX 40,
COMMERCE COURT WEST,
TORONTO, ONTARIO.
M5L 1B4

LICENCE T-556

Additional Claims Special Provisions Assessment
Electromagnetic MAXMIN II and Linecutting.

PA 587726	PA 602098
587727	602099
587728	602100
587729	602101
587730	602102
587731	602103
587732	602104
587733	602105
587734	602106
587735	602107
587736	602108
587737	602109
587738	
587739	
587740	
587741	
587742	
587743	
587744	

TOTAL 61 CLAIMS

and

PA 602090
602091
602092
602093
602094
602095
602096
602097



CORPORATION FALCONBRIDGE COPPER
P.O. Box 40
Commerce Court West
TORONTO, Ontario
M5L 1B4

LICENCE T-556

Additional Claims Special Provisions Assessment
Electromagnetic MAXMIN II and Linecutting

PA - 602095
602096
602097
602098
602099
602100
602101
602102
602103
- 602104
- 602105
602106
602107
602108
602109

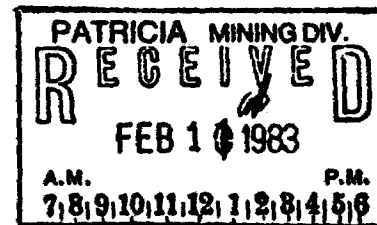

TOTAL: 61 Claims

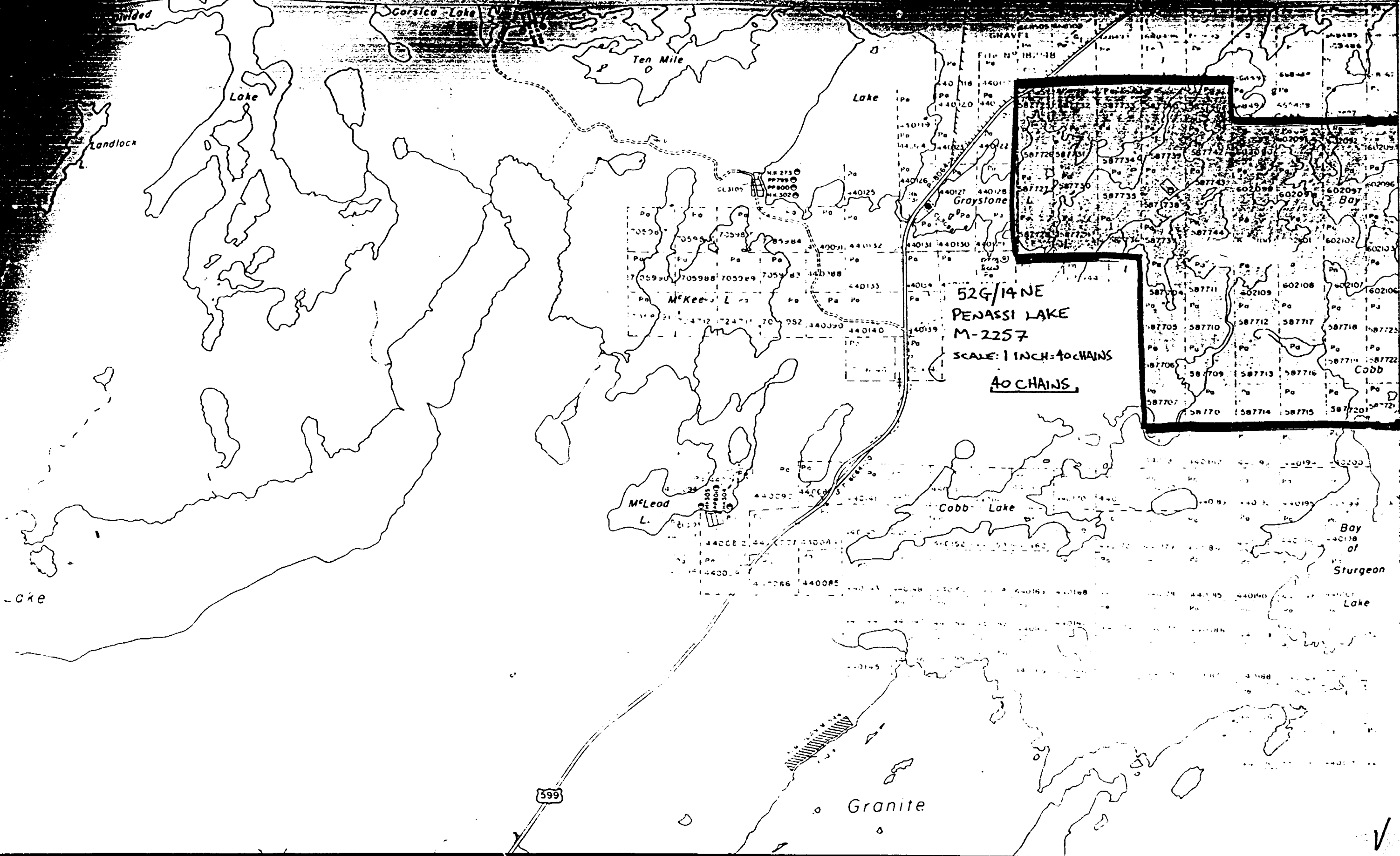

divided

Corsica Lake

Ten Mile

Lake

Landlock

Lake

GRAVEL
File No 118-38

Graystone

McKee L.

52G/14 NE
PENASSI LAKE
M-2257
SCALE: 1 INCH=40 CHAINS
40 CHAINS

McLead L.

Cobb Lake

Bay of Sturgeon

Lake

Granite

599

V

Penassi Lake M.2257

60209
60210
60211
60212
60213
60214
60215
60216
60217
60218
60219
60220
60221
60222
60223
60224
60225
60226
60227
60228
60229
60230
60231
60232
60233
60234
60235
60236
60237
60238
60239
60240

52G/15NW
AREA OF SIXMILE LAKE
M-2877
SCALE: 1 inch = 40 chains
40 CHAINS

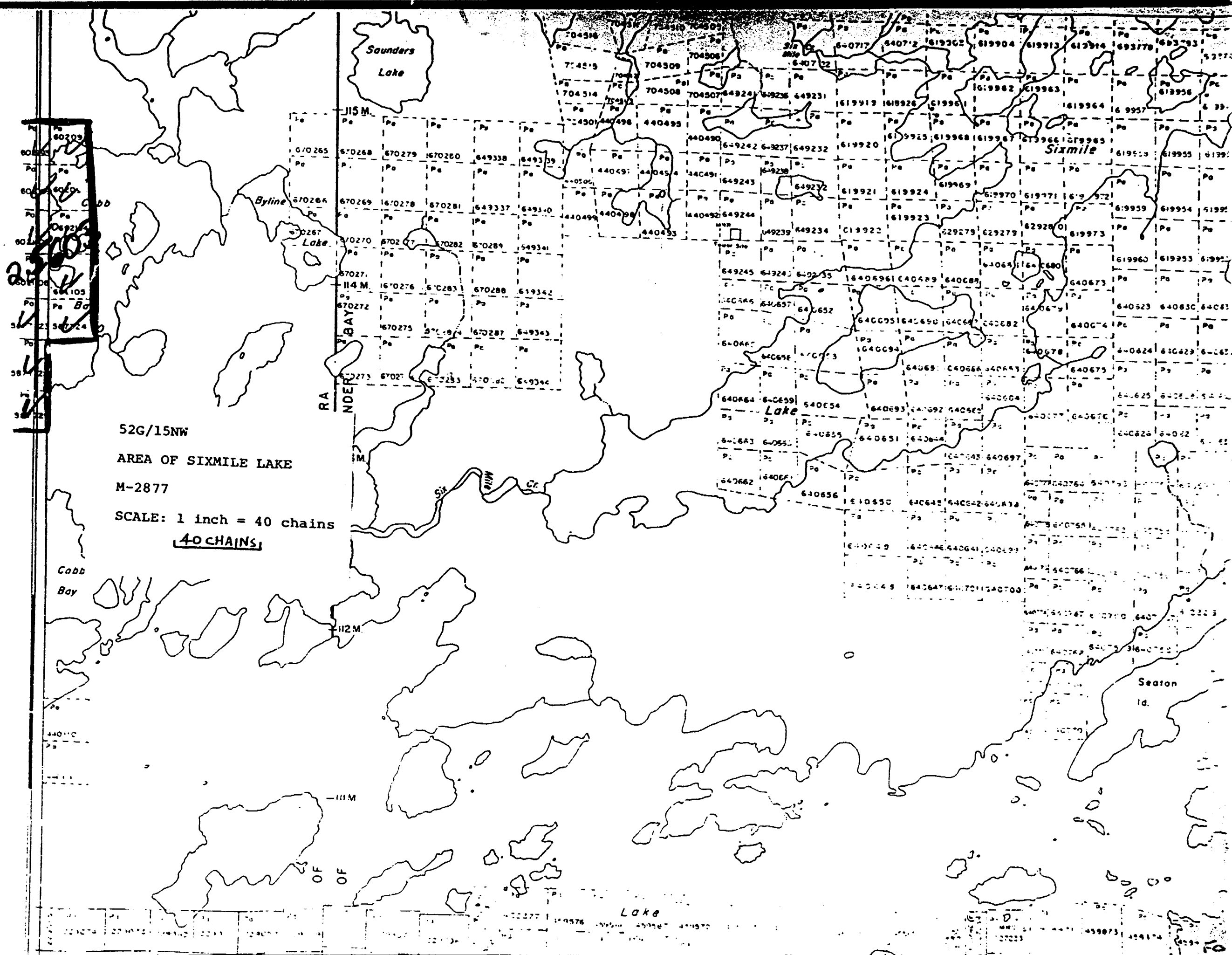

F.W.P.



Ministry of Natural Resources Ontario

Report of Work (Geophysical, Geological, Geochemical and Expenditures)

83-27

Instructions: - Please type or print. - If number of mining claims traversed exceeds space on this form, attach a list. - Only days credits calculated in the 'Expenditures' section may be entered in the 'Expend. Days Cr.' columns. - Do not use shaded areas below.

Mining Lands

The Mining Act 25603

Type of Survey(s) **ELECTROMAGNETIC MAXMIN II, LINECUTTING** Township or Area **M-2257 / M-2877**
 Claim Holder(s) **CORPORATION FALCONBRIDGE COPPER** **PENASSI LAKE/SIXMILE LAKE**
 Address **P.O. Box 40, Commerce Court West, Toronto, Ontario M5L 1B4** Prospector's License No. **T-556**
 Survey Company **PHANTOM EXPLORATION SERVICES LTD.** Date of Survey (from & to) **15 01 82 | 15 03 82** Total Miles of line Cut **118.4**
 Name and Address of Author (of Geo-Technical report) **R.D. Middaugh, R.R.#14, 736 Alice Ave. Thunder Bay, Ontario**

Special Provisions	Geophysical	Days per Claim
For first survey: Enter 40 days. (This includes line cutting)	- Electromagnetic	40
For each additional survey: using the same grid: Enter 20 days (for each)	- Magnetometer	
	- Radiometric	
	- Other	
	Geological	
Man Days Complete reverse side and enter total(s) here	Geophysical	Days per Claim
	- Electromagnetic	
	- Magnetometer	
Airborne Credits	Electromagnetic	Days per Claim
	Magnetometer	
	Radiometric	

Mining Claims Traversed (List in numerical sequence)		
Prefix	Mining Claim Number	Expend. Days Cr.
PA	587704	
	587705	
	587706	
	587707	
	587708	
	587709	
	587710	
	587711	
	587712	
	587713	
	587714	
	587715	
	587716	
	587717	
	587718	
	587719	
	587720	
	587721	
	587722	
	587723	
	587724	
	587725	
	587726	
		602090
		602091
		602092
		602093
		602094

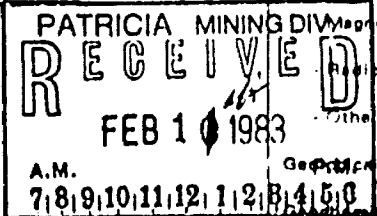

Expenditures (excludes power stripping)

Type of Work Performed **RECEIVED**

Performed on Claim(s) **MIN 8 1983**

Calculation of Expenditure Days Credits

Total Expenditures \$ + 15 = Total Days Credits

Instructions: Total Days Credits may be apportioned at the claim holder's choice. Enter number of days credits per claim selected in columns at right.

Total number of mining claims covered by this report of work. **61**

Pa. 587704

For Office Use Only

Total Days Cr. Recorded **2440** Date Recorded **Feb. 11, 1983** Mining Recorder *[Signature]*

Date Approved as Recorded **February 8, 1983** Branch Director *[Signature]*

Date **February 8, 1983** Recorded Holder or Agent (Signature) *Paul Severin*

Certification Verifying Report of Work

I hereby certify that I have a personal and intimate knowledge of the facts set forth in the Report of Work annexed hereto, having performed the work or witnessed same during and/or after its completion and the annexed report is true.

Name and Postal Address of Person Certifying **Paul W. A. Severin 2606 Victoria Ave E. Thunder Bay, Ontario**

Date Certified **Feb. 9, 1983** Certified by (Signature) *P. Severin*

Recorded Holder **FALCONBRIDGE COPPER**

Township or Area **PENASSI LAKE/SIXMILE LAKE AREA**

Type of survey and number of Assessment days credit per claim	Mining Claims Assessed
Geophysical Electromagnetic _____ 40 days Magnetometer _____ days Radiometric _____ days Induced polarization _____ days Other _____ days	PA 587704 to 06 inclusive 587709 to 13 inclusive 587716 to 19 inclusive 587722 to 24 inclusive 587726 to 44 inclusive 602090 to 109 inclusive
Section 77 (19) See "Mining Claims Assessed" column	
Geological _____ days	
Geochemical _____ days	
Man days <input type="checkbox"/> Airborne <input type="checkbox"/>	
Special provision <input checked="" type="checkbox"/> Ground <input checked="" type="checkbox"/>	
<input checked="" type="checkbox"/> Credits have been reduced because of partial coverage of claims.	
<input type="checkbox"/> Credits have been reduced because of corrections to work dates and figures of applicant.	

Special credits under section 77 (18) for the following mining claims

20 DAYS ELECTROMAGNETIC

PA 587707 -08
 587714 -15
 587720 -21
 587725

No credits have been allowed for the following mining claims

not sufficiently covered by the survey Insufficient technical data filed

The Mining Recorder may reduce the above credits if necessary in order that the total number of approved assessment days recorded on each claim does not exceed the maximum allowed as follows: Geophysical — 80; Geological — 40; Geochemical — 40; Section 77 (19)—60:

Mining Lands Comments

Handwritten 'OK' in the top left corner of the Mining Lands Comments section.

To: Geophysics MR. BARLOW

Comments section for Geophysics, currently blank.

Approved Wish to see again with corrections

Date Sept 1 / 83

Signature (Ryan Rankin)

To: Geology - Expenditures

Comments section for Geology - Expenditures, currently blank.

Approved Wish to see again with corrections

Date

Signature

To: Geochemistry

Comments section for Geochemistry, containing handwritten initials 'L.D.' in the middle.

Approved Wish to see again with corrections

Date

Signature

To: Mining Lands Section, Room 6462, Whitney Block. (Tel: 5-1380)

November 3, 1983

2.5603

Falconbridge Copper
P.O. Box 40
Commerce Court West
Toronto, Ontario
M5L 1B4

Dear Sir:

RE: Geophysical (Electromagnetic) Survey submitted
on mining claims PA 587704 et al in the Areas
of Penass Lake and Sixmile Lake

Enclosed are two ~~66~~ the plans, in duplicate, for the
above-mentioned survey. Please show all claim lines
and numbers and return them to this office.

For further information, please contact Mr. F.W. Matthews
at (416)965-1380.

Yours very truly,

E.F. Anderson
Director
Land Management Branch

Whitney Block, Room 6643
Queen's Park
Toronto, Ontario
M7A 1W3
Phone: (416)965-1380

D. Kinvig: mc

Encl.

cc: Mining Recorder
Sioux Lookout, Ontario

83-27 PA 587704

1983 06 10

2.5603

Mr. Albert Hanson
Mining Recorder
Ministry of Natural Resources
P.O. Box 668
SIOUX LOOKOUT, Ontario
POV 2T0

Dear Sir:

We have received reports and maps for a Geophysical (Electro-magnetic) survey submitted under Special Provisions (Credit for Performance and Coverage) on mining claims PA 587704 et al in the Areas of Penassi Lake and Sixmile Lake.

This material will be examined and assessed and a statement of assessment work credits will be issued.

Yours very truly,

E.F. Anderson
Director
Land Management Branch

Whitney Block, Room 6450
Queen's Park
Toronto, Ontario
M7A 1W3
Phone: 416/965-1380

A.Barr:efb

cc: Corporation Falconbridge Copper
P.O. Box 40
Commerce Court West
Toronto, Ontario
M5L 1B4

Mr. R.D. Middaugh
R.R. #14
736 Alice Avenue
Thunder Bay, Ontario
P7B 5E5



Ministry of
Natural
Resources

Dec 9/83

Your file: 83-27

1983 11 24

Our file: 2.5603

Mr. Albert Hanson
Mining Recorder
Ministry of Natural Resources
P.O. Box 669
Sioux Lookout, Ontario
POV 2T0

Dear Sir:

Enclosed are two copies of a Notice of Intent with statements listing a reduced rate of assessment work credits to be allowed for a technical survey. Please forward one copy to the recorded holder of the claims and retain the other. In approximately fifteen days from the above date, a final letter of approval of these credits will be sent to you. On receipt of the approval letter, you may then change the work entries on the claim record sheets.

For further information, if required, please contact Mr. F.W. Matthews at 416/965-1380.

Yours very truly,

E.F. Anderson
Director
Land Management Branch

Whitney Block, Room 6450
Queen's Park
Toronto, Ontario
M7A 1W3
Phone: 416/965-1316

D. Kinvig:mc

Encls:

cc: Falconbridge Copper
P.O. Box 40
Commerce Court West
Toronto, Ontario
M5L 1B4

cc: Mr. G.H. Ferguson
Mining & Lands Commissioner
Toronto, Ontario



Ministry of
Natural
Resources

Notice of Intent
for Technical Reports

1983 11 24

83-27 / 2.5603

An examination of your survey report indicates that the requirements of The Ontario Mining Act have not been fully met to warrant maximum assessment work credits. This notice is merely a warning that you will not be allowed the number of assessment work days credits that you expected and also that in approximately 15 days from the above date, the mining recorder will be authorized to change the entries on his record sheets to agree with the enclosed statement. Please note that until such time as the recorder actually changes the entry on the record sheet, the status of the claim remains unchanged.

If you are of the opinion that these changes by the mining recorder will jeopardize your claims, you may during the next fifteen days apply to the Mining and Lands Commissioner for an extension of time. Abstracts should be sent with your application.

If the reduced rate of credits does not jeopardize the status of the claims then you need not seek relief from the Mining and Lands Commissioner and this Notice of Intent may be disregarded.

If your survey was submitted and assessed under the "Special Provision-Performance and Coverage" method and you are of the opinion that a re-appraisal under the "Man-days" method would result in the approval of a greater number of days credit per claim, you may, within the said fifteen day period, submit assessment work breakdowns listing the employees names, addresses and the dates and hours they worked. The new work breakdowns should be submitted direct to the Lands Management Branch, Toronto. The report will be re-assessed and a new statement of credits based on actual days worked will be issued.

2.5603

83-27

1983 12 20

2.5603

Mining Recorder
Ministry of Natural Resources
P.O. Box 669
Sioux Lookout, Ontario
POV 2T0

Dear Sir:

RE: Geophysical (Electromagnetic) Survey on Mining
Claims PA 587704 et al in the Areas of Penass
Lake and Sixmile Lake.

The Geophysical (Electromagnetic) Survey assessment work
credits as listed with my Notice of Intent dated November 24,
1983 have been approved as of the above date.

Please inform the recorded holder of these mining claims and
so indicate on your records.

Yours very truly,

E.F. Anderson
Director
Land Management Branch

Whitney Block, Room 6643
Queen's Park
Toronto, Ontario
M7A 1W3
Phone: 416/965-1380

D. Kinvi:sc

cc: Falconbridge Copper
P.O. Box 40
Commerce Court West
Toronto, Ontario
M5L 1B4

cc: G.H. Ferguson
Mining & Lands Commissioner
Toronto, Ontario

cc: Resident Geologist
Sioux Lookout, Ontario

SEE ACCOMPANYING
MAP(S) IDENTIFIED AS

52G/15NW-0086 # 1-3

LOCATED IN THE MAP
CHANNEL IN THE
FOLLOWING SEQUENCE

(X)

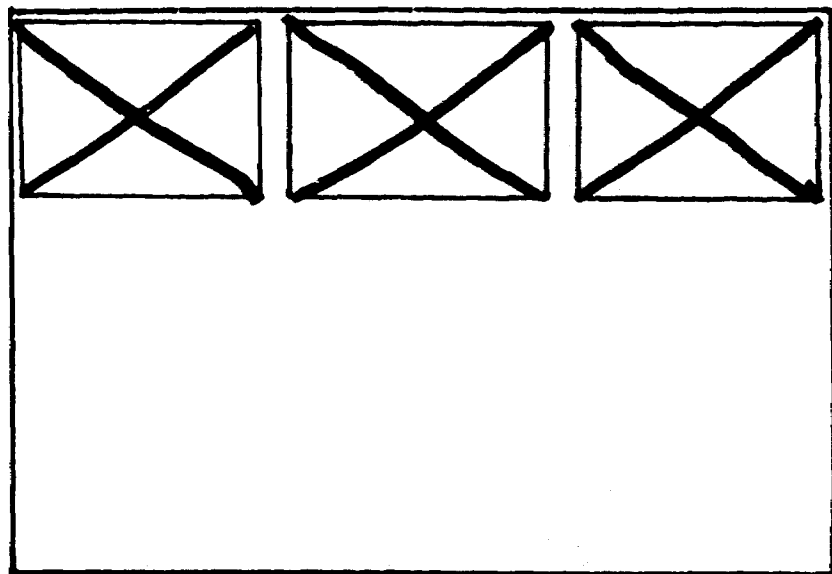

FOR ADDITIONAL

INFORMATION

SEE MAPS:

52G/15NW-0086# 4

12W 11W 10W 9W 8W 7W 6W 5W 4W 3W 2W 1W 0 1E 2E 3E 4E 5E 6E 7E 8E 9E 10E 11E 12E 13E 14E 15E 16E 17E 18E 19E 20E 21E 22E 23E 24E 25E 26E 27E 28E 29E 30E

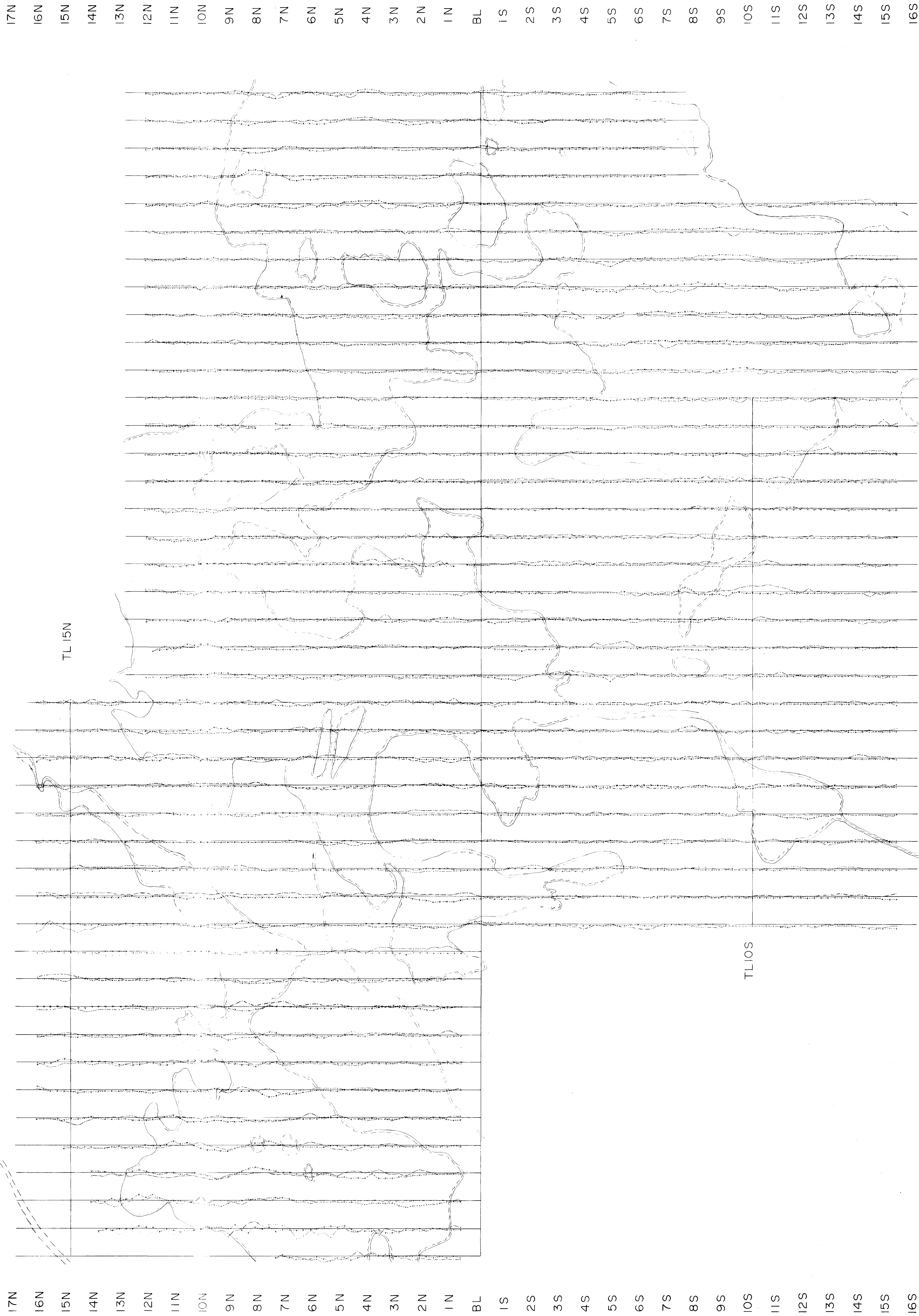

17N
16N
15N
14N
13N
12N
11N
10N
9N
8N
7N
6N
5N
4N
3N
2N
1N
BL
1S
2S
3S
4S
5S
6S
7S
8S
9S
10S
11S
12S
13S
14S
15S
16S

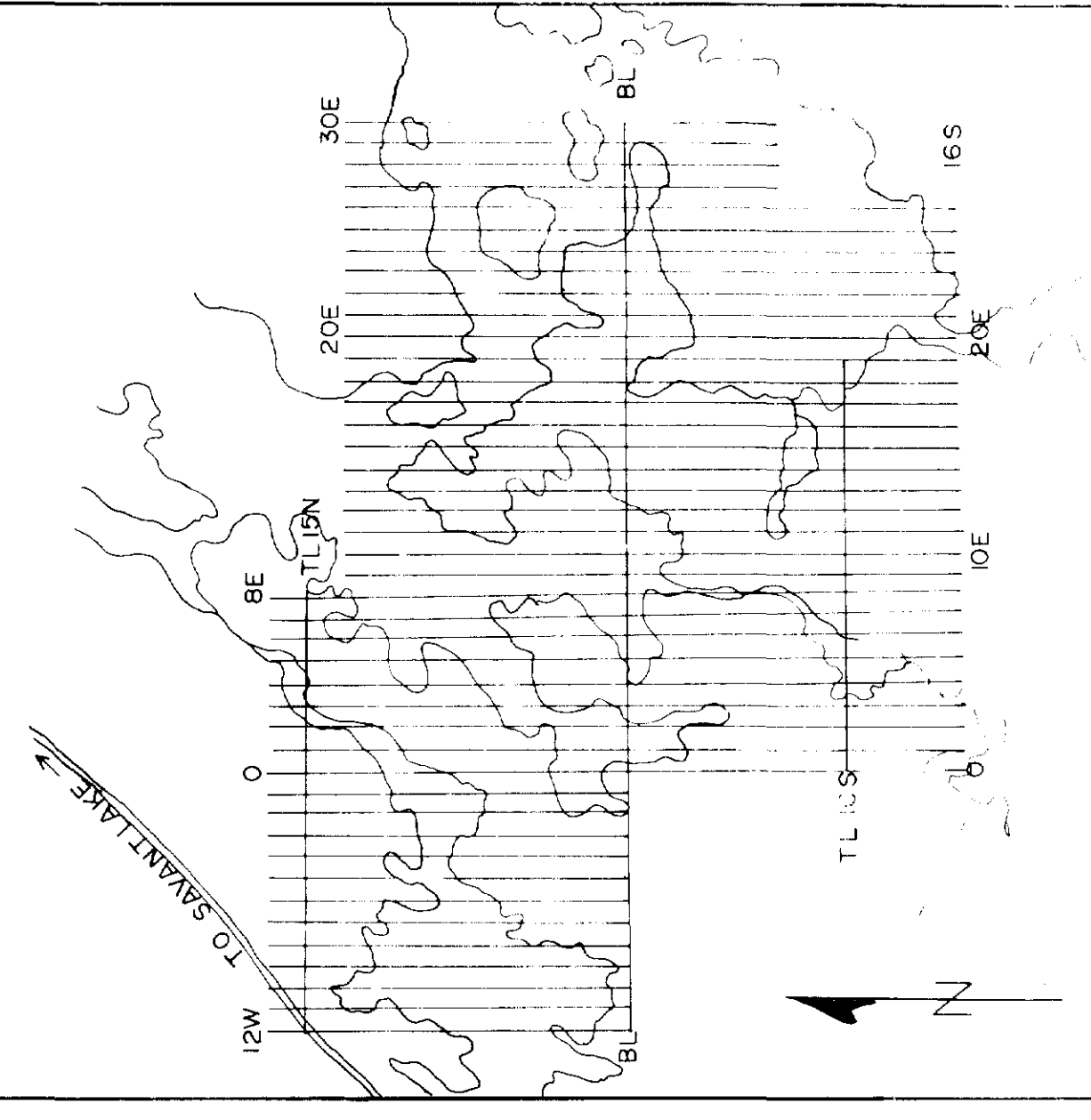

LOCATION MAP SCALE 1" = 1/2 MILE

LEGEND

HEM SURVEY

INSTRUMENT: APEX PARAMETRICS MAX MIN II
 COIL SEPARATION: 150 METRES
 FREQUENCY: 444 HZ
 PROFILE: 1CM = 10%
 IN PHASE READINGS: - - - - -
 OUT OF PHASE READINGS: ······
 CONDUCTOR AXIS: ————
 POSITIVE READINGS: EAST OF LINE

MAGNETOMETER SURVEY

INSTRUMENT: SCINTREX MP-2
 DATUM: 60000 X
 CONTOUR INTERVAL:
 MAGNETIC LOW: ○

BASE STATION RECORDER INFORMATION

INSTRUMENT: SCINTREX MBS-2
 RECORDING INTERVAL: 10 SECONDS
 RECORDING RANGE: 100 X
 CHART SPEED: 2.0 MM/HR

TOPOGRAPHY

SHORELINE: - - - - -
 ROAD: = = = = =

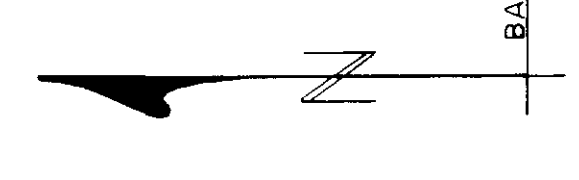

[Signature]
 FOR: CORPORATION FALCONBRIDGE COPPER

HEM SURVEY

SIX MILE LAKE / COBB BAY PROJECT MAP NO. / 3
 DATE: MARCH 1982 MAP SCALE 1: 5000
 BY: PHANTOM EXPLORATION SERVICES LTD.

52G/15NW-0086 #4



12W 11W 10W 9W 8W 7W 6W 5W 4W 3W 2W 1W 0 1E 2E 3E 4E 5E 6E 7E 8E 9E 10E 11E 12E 13E 14E 15E 16E 17E 18E 19E 20E 21E 22E 23E 24E 25E 26E 27E 28E 29E 30E

12W 11W 10W 9W 8W 7W 6W 5W 4W 3W 2W 1W 0 1E 2E 3E 4E 5E 6E 7E 8E 9E 10E 11E 12E 13E 14E 15E 16E 17E 18E 19E 20E 21E 22E 23E 24E 25E 26E 27E 28E 29E 30E

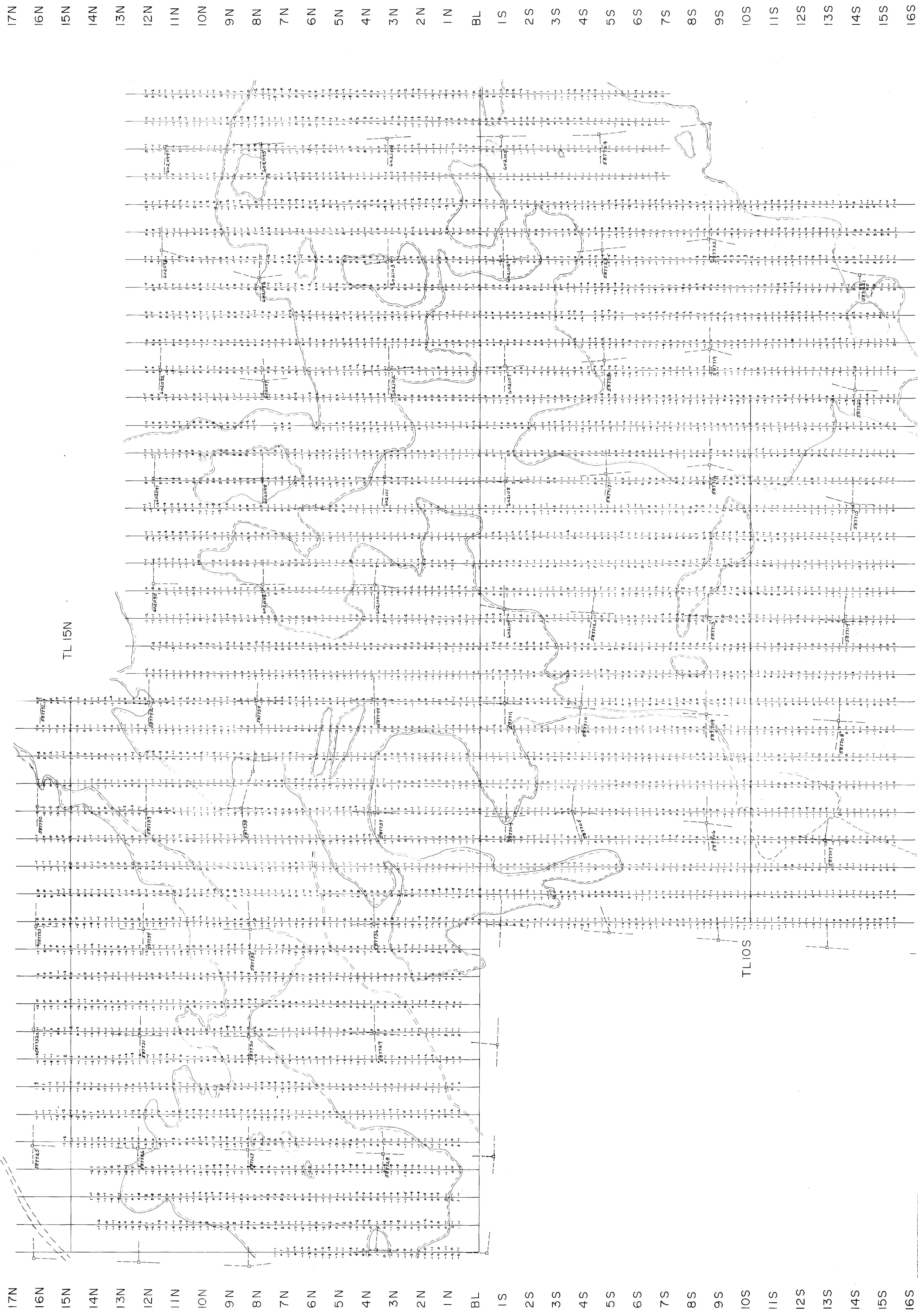

17N 16N 15N 14N 13N 12N 11N 10N 9N 8N 7N 6N 5N 4N 3N 2N 1N BL 1S 2S 3S 4S 5S 6S 7S 8S 9S 10S 11S 12S 13S 14S 15S 16S

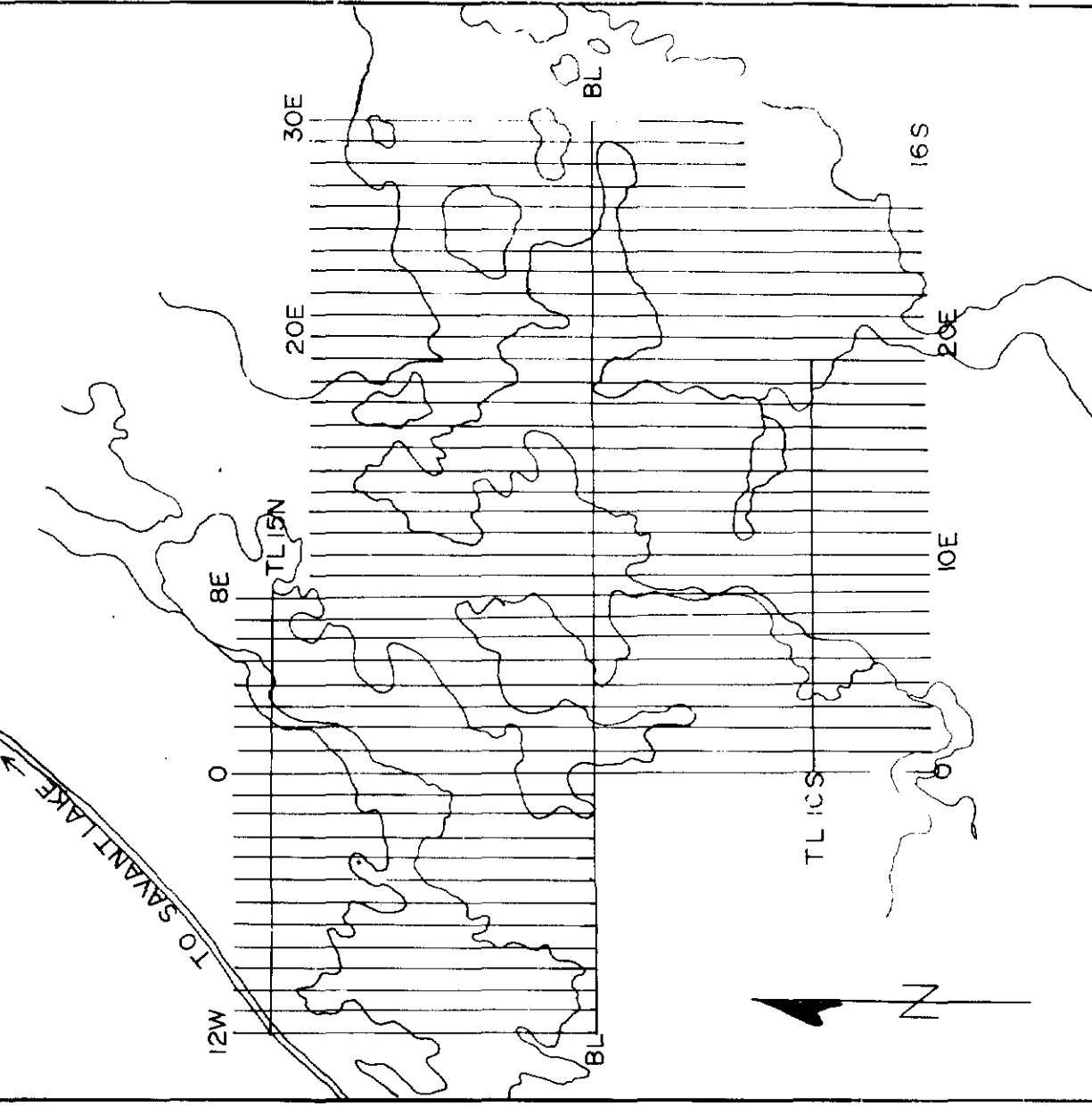

LOCATION MAP SCALE 1" = 1/2 MILE

LEGEND

- HEM SURVEY
- INSTRUMENT: APEX PARAMETRICS MAX MIN II
- COIL SEPARATION: 150 METRES
- FREQUENCY: 444 HZ
- PROFILE: 1CM = 10%
- IN PHASE READINGS: LEFT OF LINE
- OUT OF PHASE READINGS: RIGHT OF LINE
- CONDUCTOR AXIS: ————
- POSITIVE READINGS: EAST OF LINE
- MAGNETOMETER SURVEY
- INSTRUMENT: SCINTREX MP-2
- DATUM: 60000 X
- CONTOUR INTERVAL: 10
- MAGNETIC LOW: ○
- BASE STATION RECORDER INFORMATION
- INSTRUMENT: SCINTREX MBS-2
- RECORDING INTERVAL: 10 SECONDS
- RECORDING RANGE: 100 X
- CHART SPEED: 20 MM/HR

TOPOGRAPHY

- SHORELINE: ————
- ROAD: = = = = =

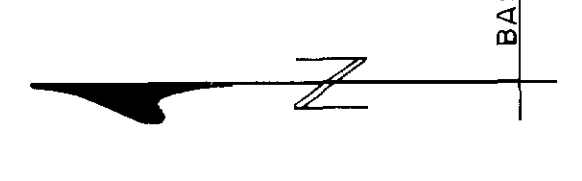

[Signature]
 FOR CORPORATION FALCONBRIDGE COPPER

H.E.M. SURVEY

SIX MILE LAKE / COBB BAY PROJECT MAP NO. 13
 DATE: MARCH 1982 MAP SCALE 1" = 5000
 BY: PHANTOM EXPLORATION SERVICES LTD.

52G/15NW-0086, #3



210

12W 11W 10W 9W 8W 7W 6W 5W 4W 3W 2W 1W 0 1E 2E 3E 4E 5E 6E 7E 8E 9E 10E 11E 12E 13E 14E 15E 16E 17E 18E 19E 20E 21E 22E 23E 24E 25E 26E 27E 28E 29E 30E

12W 11W 10W 9W 8W 7W 6W 5W 4W 3W 2W W O 1E 2E 3E 4E 5E 6E 7E 8E 9E 10E 11E 12E 13E 14E 15E 16E 17E 18E 19E 20E 21E 22E 23E 24E 25E 26E 27E 28E 29E 30E

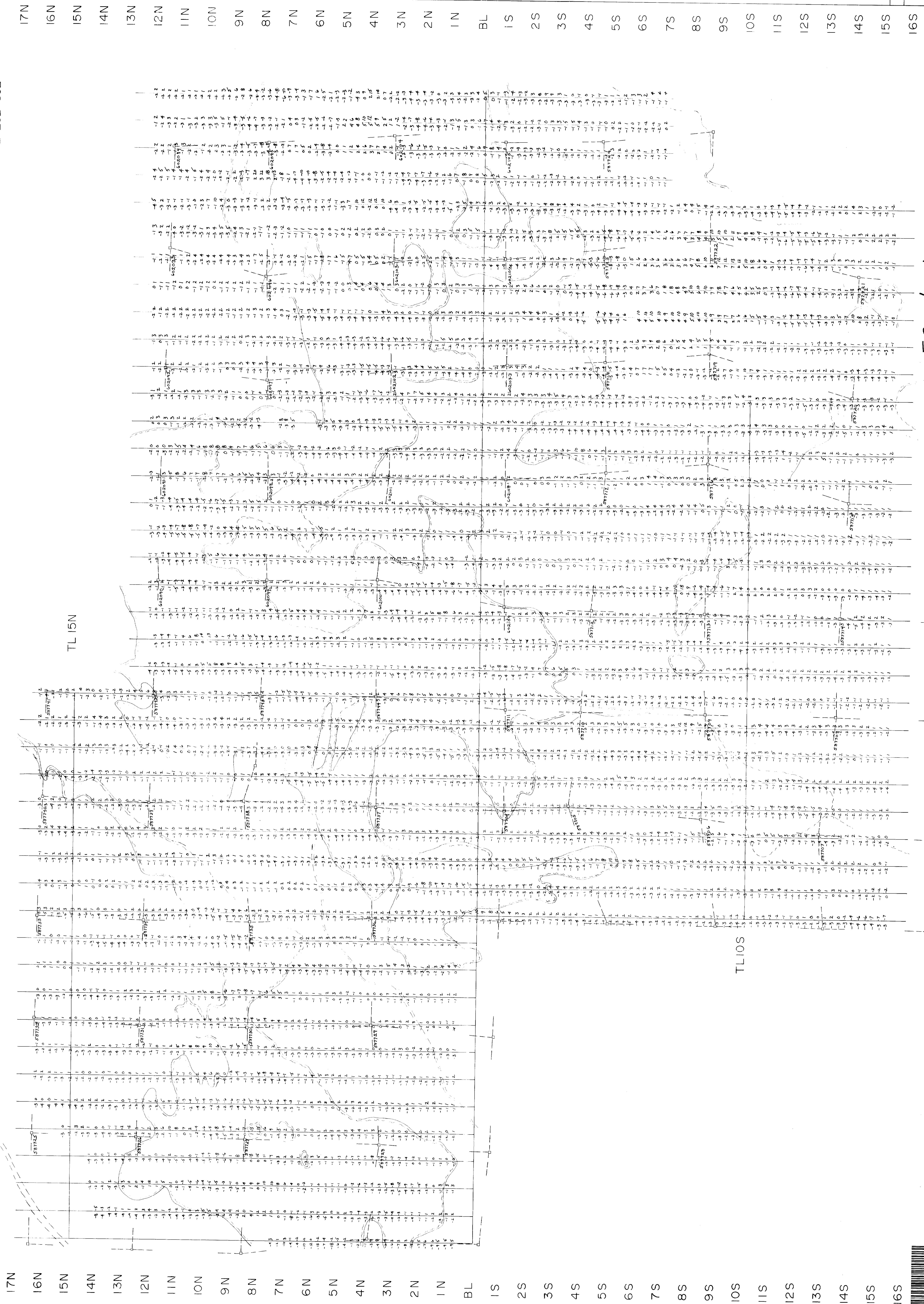

17N
16N
15N
14N
13N
12N
11N
10N
9N
8N
7N
6N
5N
4N
3N
2N
1N
BL
IS
2S
3S
4S
5S
6S
7S
8S
9S
10S
11S
12S
13S
14S
15S
16S

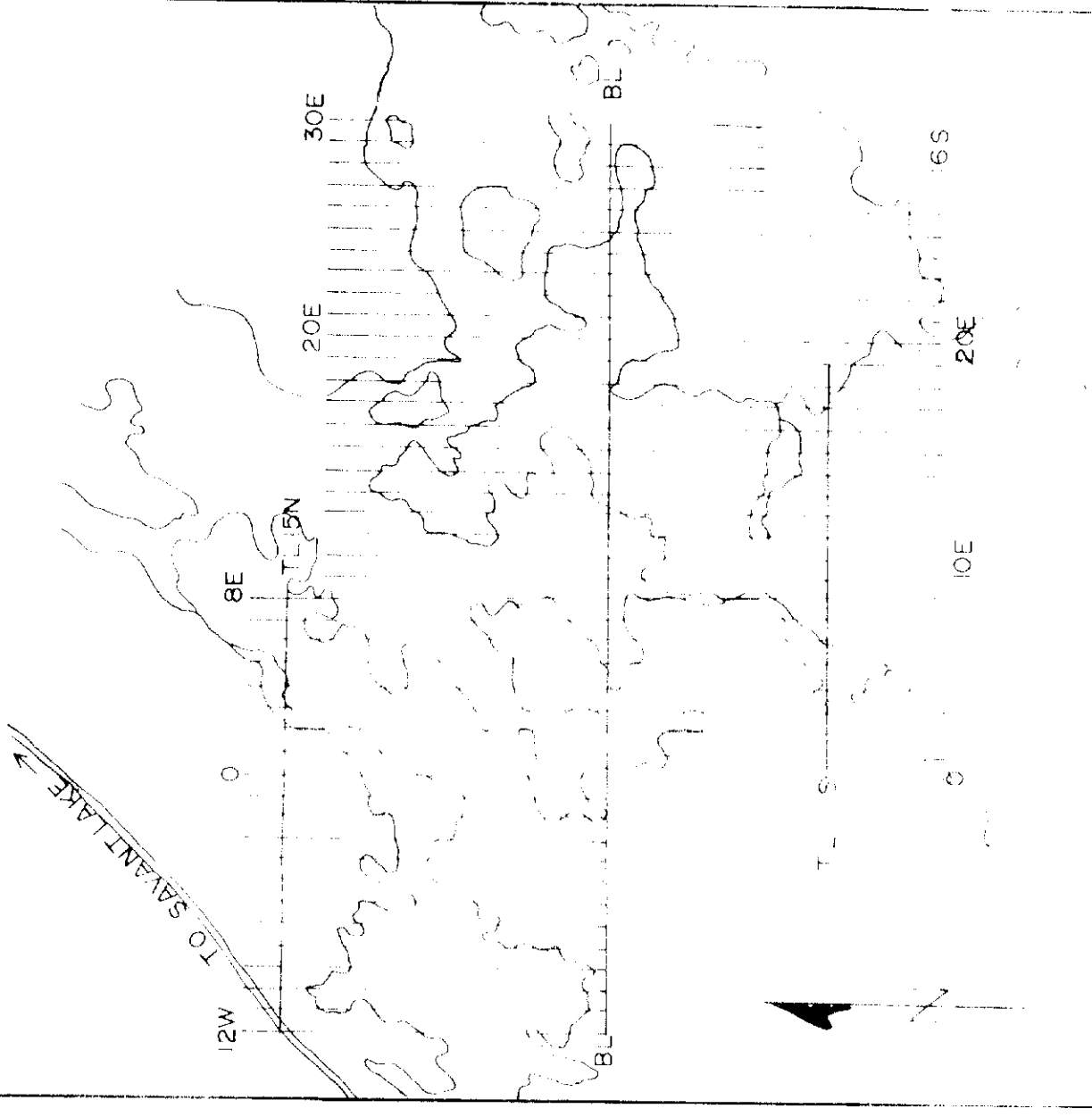

LOCATION MAP SCALE 1" = 1/2 MILE

LEGEND
HEM SURVEY

INSTRUMENT APX PARAMETRICS MAX MIN II
COL SEPARATION: 150 METRES
FREQUENCY: 1777 HZ
PROFILE: 1CM - 10%
IN PHASE READINGS: LEFT OF LINE
OUT OF PHASE READINGS: RIGHT OF LINE
CONDUCTOR AXIS: ————
POSITIVE READINGS: EAST OF LINE

MAGNETOMETER SURVEY

INSTRUMENT: SCINTREX MP-2
DATUM: 60000 X
CONTOUR INTERVAL:
MAGNETIC LOW:
BASE STATION RECORDER INFORMATION
INSTRUMENT: SCINTREX MBS-2
RECORDING INTERVAL: 10 SECONDS
RECORDING RANGE: 100 X
CHART SPEED: 2.0 MM/HR

TOPOGRAPHY

SHORELINE:
ROAD:

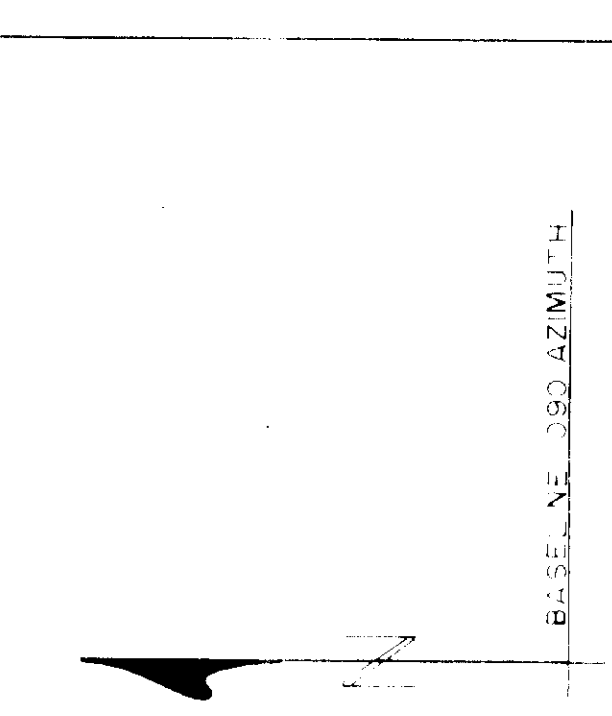

FOR: CORPORATION FALCONBRIDGE COPPER

H.E.M. SURVEY

SIX MILE LAKE / COBB BAY PROJECT MAP NO. 73
DATE: MARCH 1982 MAP SCALE: 1:5000
BY: PHANTOM EXPLORATION SERVICES LTD.

52G/15NW-0086 #1

12W 11W 10W 9W 8W 7W 6W 5W 4W 3W 2W W O 1E 2E 3E 4E 5E 6E 7E 8E 9E 10E 11E 12E 13E 14E 15E 16E 17E 18E 19E 20E 21E 22E 23E 24E 25E 26E 27E 28E 29E 30E

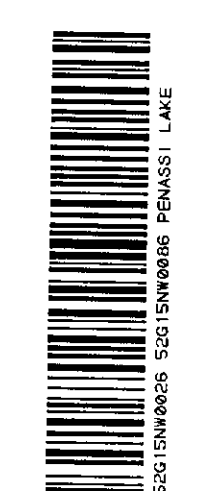

12W 11W 10W 9W 8W 7W 6W 5W 4W 3W 2W 1W 0 1E 2E 3E 4E 5E 6E 7E 8E 9E 10E 11E 12E 13E 14E 15E 16E 17E 18E 19E 20E 21E 22E 23E 24E 25E 26E 27E 28E 29E 30E

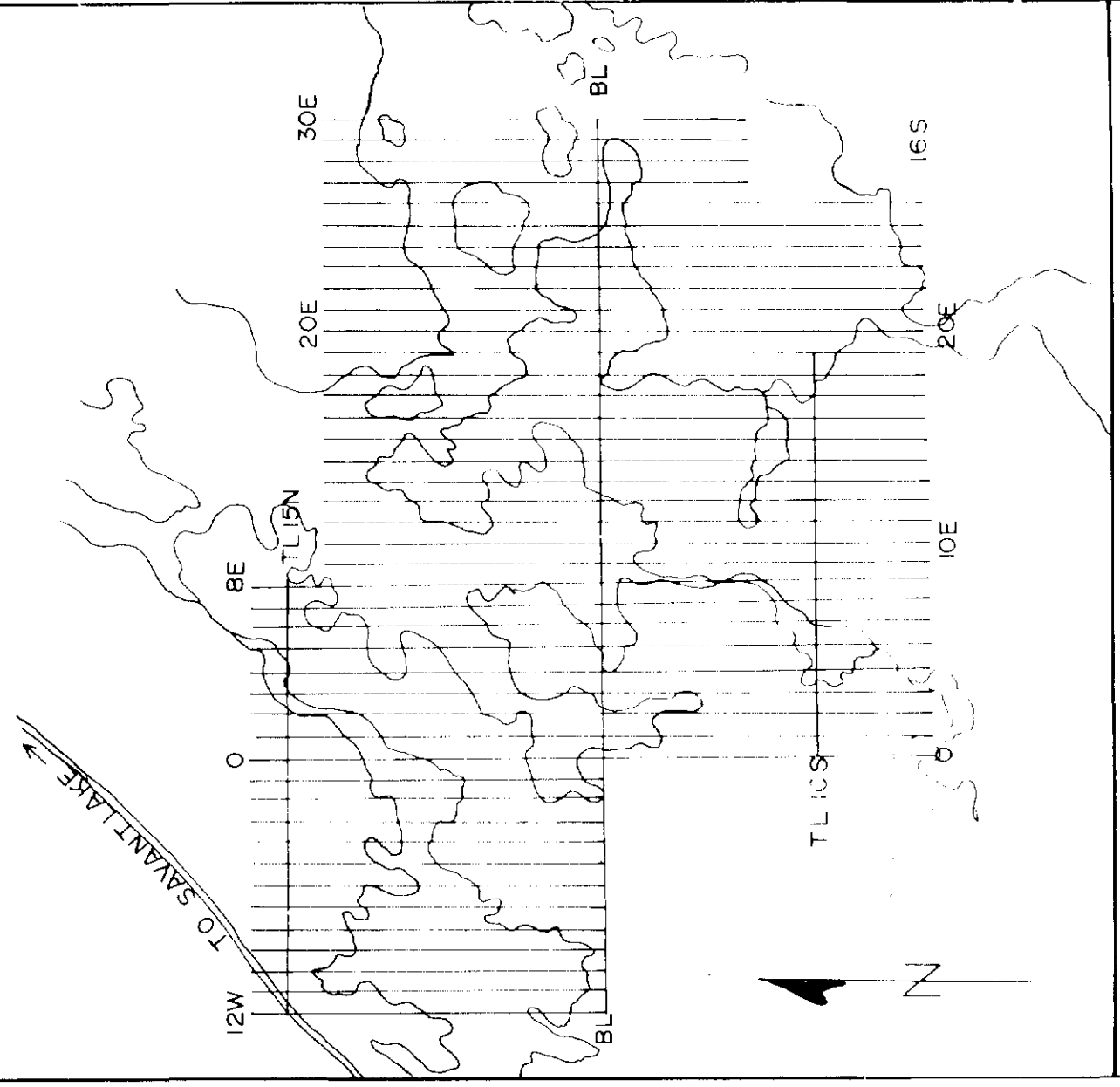
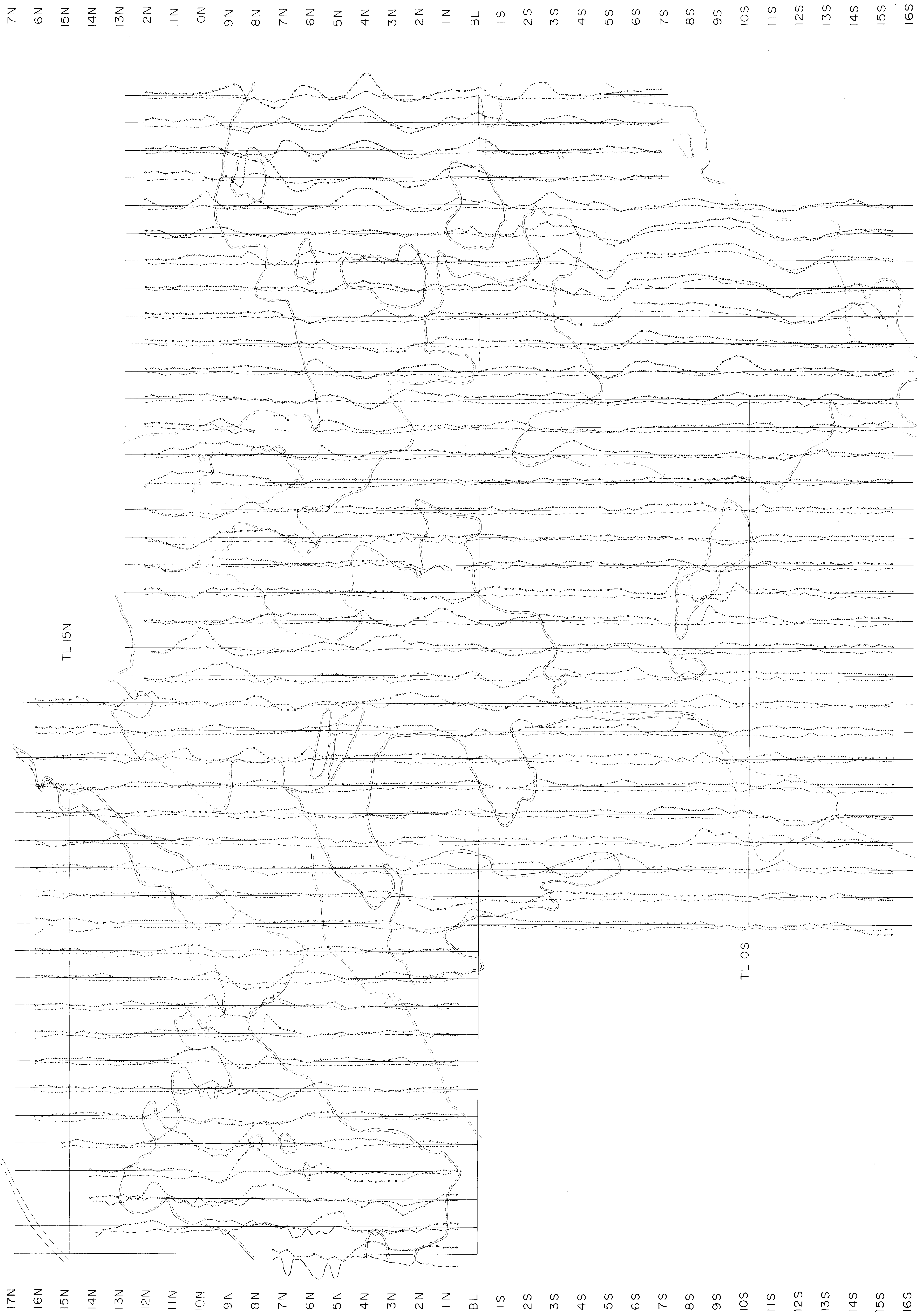

LOCATION MAP SCALE 1" = 1/2 MILE

LEGEND

HEM. SURVEY

INSTRUMENT: APEX PARAMETRICS MAX MIN II
 COIL SEPARATION: 150 MET RES
 FREQUENCY: 1777 HZ
 PROFILE: 1 CM @ 10 %
 IN PHASE READINGS: - - - - -
 OUT OF PHASE READINGS:
 CONDUCTOR AXIS: ————
 POSITIVE READINGS: EAST OF LINE

MAGNETOMETER SURVEY

INSTRUMENT: SCINTREX MP-2
 DATUM: 60000 G
 CONTOUR INTERVAL: 10
 MAGNETIC LOW: ○
 BASE STATION RECORDER INFORMATION
 INSTRUMENT: SCINTREX MBS-2
 RECORDING INTERVAL: 10 SECONDS
 RECORDING RANGE: 100 G
 CHART SPEED: 20 MM/HR

TOPOGRAPHY

SHORELINE: ————
 ROAD: = = = = =

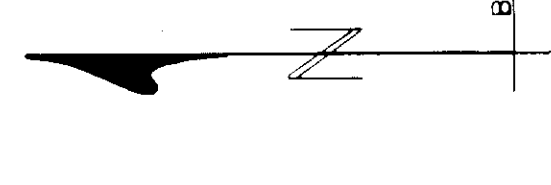

[Signature]
 FOR: CORPORATION FALCONBRIDGE COPPER

HEM. SURVEY

SIX MILE LAKE / COBB BAY PROJECT MAP NO. 73
 DATE: MARCH 1982 MAP SCALE 1:5000
 BY: PHANTOM EXPLORATION SERVICES LTD.

52G/15NW-0086, #2

12W 11W 10W 9W 8W 7W 6W 5W 4W 3W 2W 1W 0 1E 2E 3E 4E 5E 6E 7E 8E 9E 10E 11E 12E 13E 14E 15E 16E 17E 18E 19E 20E 21E 22E 23E 24E 25E 26E 27E 28E 29E 30E

