

PATRICIA MINING CO  
**RECEIVED**  
MAY - 3 1982  
A.M. P.M.  
7:30 10:12 1:30 4:15



52G15NW0027 52G15NW007501 PENAS81 LAKE

010

PROTON MAGNETOMETER SURVEY

COBB BAY PROJECT

NTS 52 G 14 & 15

PHANTOM EXPLORATION SERVICES LTD.

March, 1982

R.D. Middaugh

**RECEIVED**

MAY - 7 1982

MINING LANDS SECTION

## INTRODUCTION

Corporation Falconbridge Copper of Thunder Bay, Ontario contracted Phantom Exploration Services Ltd., also of Thunder Bay, to undertake cutting a grid and subsequently conducting a Proton Magnetometer survey on this grid on the so called Cobb Bay Project during the winter of 1982.

## LOCATION, ACCESS, AND GRID

The survey area is located just east of highway #599 approximately 50 kilometers south of Savant Lake, Ontario. The area is protected by 60 unpatented claims numbered 587725-587744 inclusive, 587704-587724 inclusive, and 602090-602109 inclusive.

Access to the area via highway #599 is excellent all year round. The road to Cobb Bay resort can be travelled easily during the summer and it greatly facilitates access to the property by snow machine in the winter.

The grid was established under subcontract by Mr. G. Sage of Yellowknife, N.W.T. The work was done during the winter months of 1982. <sup>Approximately 118.4</sup> Approximately 113.4 kilometers of line were cut, chained, and picketed at 25 meter intervals.

### PERSONNEL

The day to day supervision of the survey crew during March was under Derek F. Brown while overall supervision of the geophysical program was under R.D. Middaugh. Both men are employees of Phantom Exploration Services Ltd.

### INSTRUMENTATION

Two Proton Precession Magnetometers (model MP-2) manufactured by Scintrex Limited, of Ontario were used for this survey. The total field measurement was read with a resolution of 1 gamma and all values were corrected for diurnal variations using a MBS-2 model base station recorder also manufactured by Scintrex Limited. Readings were recorded at 25 meter intervals on the picket lines. Intermediate readings were taken at 12.5 meter intervals where a magnetic gradient greater than 300 gammas was exceeded between the 25 meter stations. The datum was selected to be 59,000 gammas.

### DISCUSSION OF RESULTS

The survey area is present in plan form at a scale of 1:25,000. The corrected magnetic data is plotted on this map and contoured using a 1000 gamma interval.

The area has a background of 800 to 1000 gammas. Three east southeast trending zones of slightly higher magnetic signature (1000 to 2000 gammas) can be distinguished

within the survey area. These zones which are not continuous increase in aerial extent from northeast to southwest. Several zones of 2000 to 4000 gammas and higher are found within these bands. They also increase in extent from northeast to southwest.

#### CONCLUSIONS AND RECOMMENDATIONS

The magnetic highs located within the east southeast magnetic trends are probably gabbroic intrusions within the mafic volcanics as suggested by the Sioux Lookout - Armstrong Sheet of the Geological Compilation Series published by the Ministry of Natural Resources.

Further evaluation of the property would be facilitated by an electromagnetic survey to outline any conductive zones in the area. Subsequent mapping and/or geochemical surveys carried out in any areas of interest located could possibly outline future drill targets.

Submitted by,

Phantom Exploration Services Ltd.



R.D. Middaugh  
Geologist



**GEOPHYSICAL - GEOLOGICAL - GEOCHEMICAL  
TECHNICAL DATA STATEMENT**

**TO BE ATTACHED AS AN APPENDIX TO TECHNICAL REPORT  
FACTS SHOWN HERE NEED NOT BE REPEATED IN REPORT  
TECHNICAL REPORT MUST CONTAIN INTERPRETATION, CONCLUSIONS ETC.**

Type of Survey(s) MAGNETIC  
Township or Area SIX MILE LAKE-PENASSI LAKE (M2877-M2257)  
Claim Holder(s) CORPORATION FALCONBRIDGE COPPER  
P. O.: BOX 40, COMMERCE COURT WEST, TORONTO, ONT. M5L 1B4  
Survey Company PHANTOM EXPLORATION SERVICES LTD.  
Author of Report R. D. MIDDGAUGH  
Address of Author RR #14, ALICE AVE., THUNDER BAY, ONT.  
Covering Dates of Survey JANUARY 2 - APRIL 28, 1982  
(linecutting to office)  
Total Miles of Line Cut 73,586

**MINING CLAIMS TRAVERSED**  
List numerically

..... PA. 587725... - PA. 587744... incl.....  
(prefix) (number)  
..... PA. 587704... - PA. 587723... incl.....  
..... PA. 602090... - PA. 602109... incl.....



900

If space insufficient, attach list

<u>SPECIAL PROVISIONS CREDITS REQUESTED</u>	Geophysical	DAYS per claim
ENTER 40 days (includes line cutting) for first survey.	-Electromagnetic _____	
ENTER 20 days for each additional survey using same grid.	-Magnetometer _____	<u>20</u>
	-Radiometric _____	
	-Other _____	
	Geological _____	
	Geochemical _____	

**AIRBORNE CREDITS** (Special provision credits do not apply to airborne surveys)

Magnetometer \_\_\_\_\_ Electromagnetic \_\_\_\_\_ Radiometric \_\_\_\_\_  
(enter days per claim)

DATE: APRIL 28, 1982 SIGNATURE: *R. D. Middgaugh*  
Author of Report or Agent

Res. Geol. \_\_\_\_\_ Qualifications \_\_\_\_\_

Previous Surveys

File No.	Type	Date	Claim Holder

See Attached List

TOTAL CLAIMS 61

OFFICE USE ONLY

GEOPHYSICAL TECHNICAL DATA

GROUND SURVEYS - If more than one survey, specify data for each type of survey

Number of Stations 4600 Number of Readings 4800
Station interval 25 Metre and 12 Metre Line spacing 100 Metres
Profile scale N/A
Contour interval 1000 Gamma

MAGNETIC

Instrument SCINTREX LTD, MP-2 PROTON PRECESSION MAGNETOMETER
Accuracy - Scale constant 1 Gamma Resolution
Diurnal correction method
Base Station check-in interval (hours) Base Station Recorder and Time Sync. (Scintrex MBS -2)
Base Station location and value 150 Feet Behind Paul Gagnau's House 61190 Gammas

ELECTROMAGNETIC

Instrument
Coil configuration
Coil separation
Accuracy
Method: [ ] Fixed transmitter [ ] Shoot back [ ] In line [ ] Parallel line
Frequency (specify V.L.F. station)
Parameters measured

GRAVITY

Instrument
Scale constant
Corrections made
Base station value and location
Elevation accuracy

INDUCED POLARIZATION RESISTIVITY

Instrument
Method [ ] Time Domain [ ] Frequency Domain
Parameters - On time Frequency
- Off time Range
- Delay time
- Integration time
Power
Electrode array
Electrode spacing
Type of electrode

APRIL 28, 1982

CORPORATION FALCONBRIDGE COPPER,  
P. O. BOX 40,  
COMMERCE COURT WEST,  
TORONTO, ONTARIO.  
M5L 1B4

LICENCE #T-556

MAGNETOMETER SURVEY M2877- M2257

LIST OF CLAIMS COVERED

PA 587704	20	Days	PA 587733	20	Days	PA 602106	20	Days
587705	20		587734	20		602107	20	
587706	20		587735	20		602108	20	
587707	20		587736	20		602109	20	
587708	20		587737	20				
587709	20		587738	20				
587710	20		587739	20				
587711	20		587740	20				
587712	20		587741	20				
587713	20		587742	20				
587714	20		587743	20				
587715	20		587744	20				
587716	20							
587717	20		and					
587718	20		PA 602090	20				
587719	20		602091	20				
587720	20		602092	20				
587721	20		602093	20				
587722	20		602094	20				
587723	20		602095	20				
587724	20		602096	20				
PA 587725	20		602097	20				
587726	20		602098	20				
587727	20		602099	20				
587728	20		602100	20				
587729	20		602101	20				
587730	20		602102	20				
587731	20		602103	20				
587732	20		602104	20				
			602105	20				

TOTAL 61 CLAIMS

AREA OF  
PE

MIN

SCALE: 7

PATENTED LAND  
PATENTED FOR S  
LEASES  
LICENSE OF OCC  
CROWN LAND SA  
LOCATED LAND  
CANCELLED  
MINING RIGHTS  
SURFACE RIGHT  
HIGHWAY & RO  
ROADS  
TRAILS  
RAILWAYS  
POWER LINES  
MARSH OR MU  
MINES

\*used only with s  
space is limited

400' Surface Right  
and Rivers

- ⊙<sub>1</sub> ..... M. T.
- ⊙<sub>2</sub> ..... M. T.
- ⊙<sub>3</sub> ..... Gro
- ⊙<sub>4</sub> ..... "
- ⊙<sub>5</sub> ..... M.N
- ⊙<sub>6</sub> ..... QU

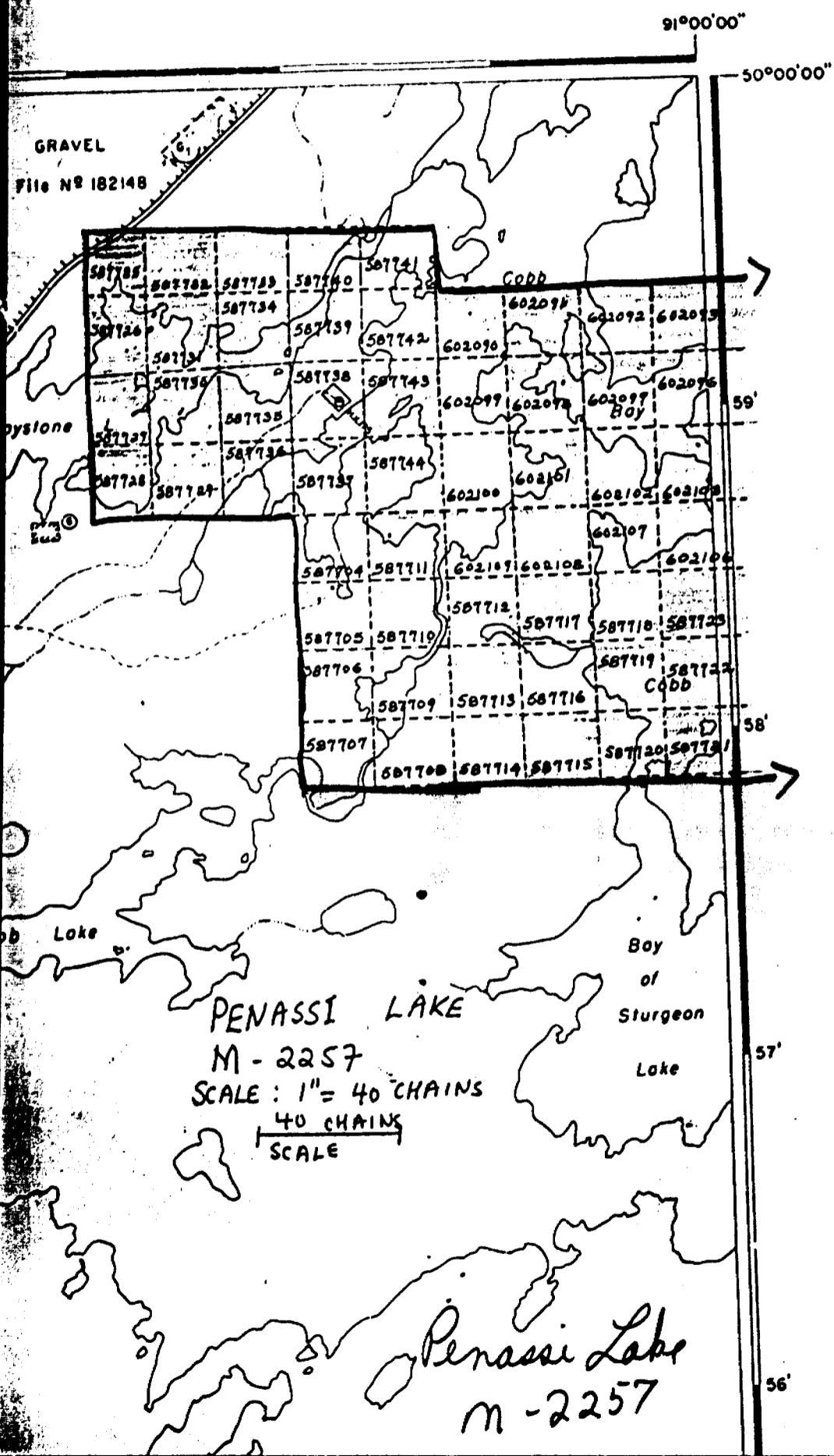

MILE LAKE M.2877

*Penassi Lake*  
M-2257



91900'  
50°00'

602094
602095
602104
602105
587124

587121 587122 587123 587124 587125 587126 587127 587128 587129 587130

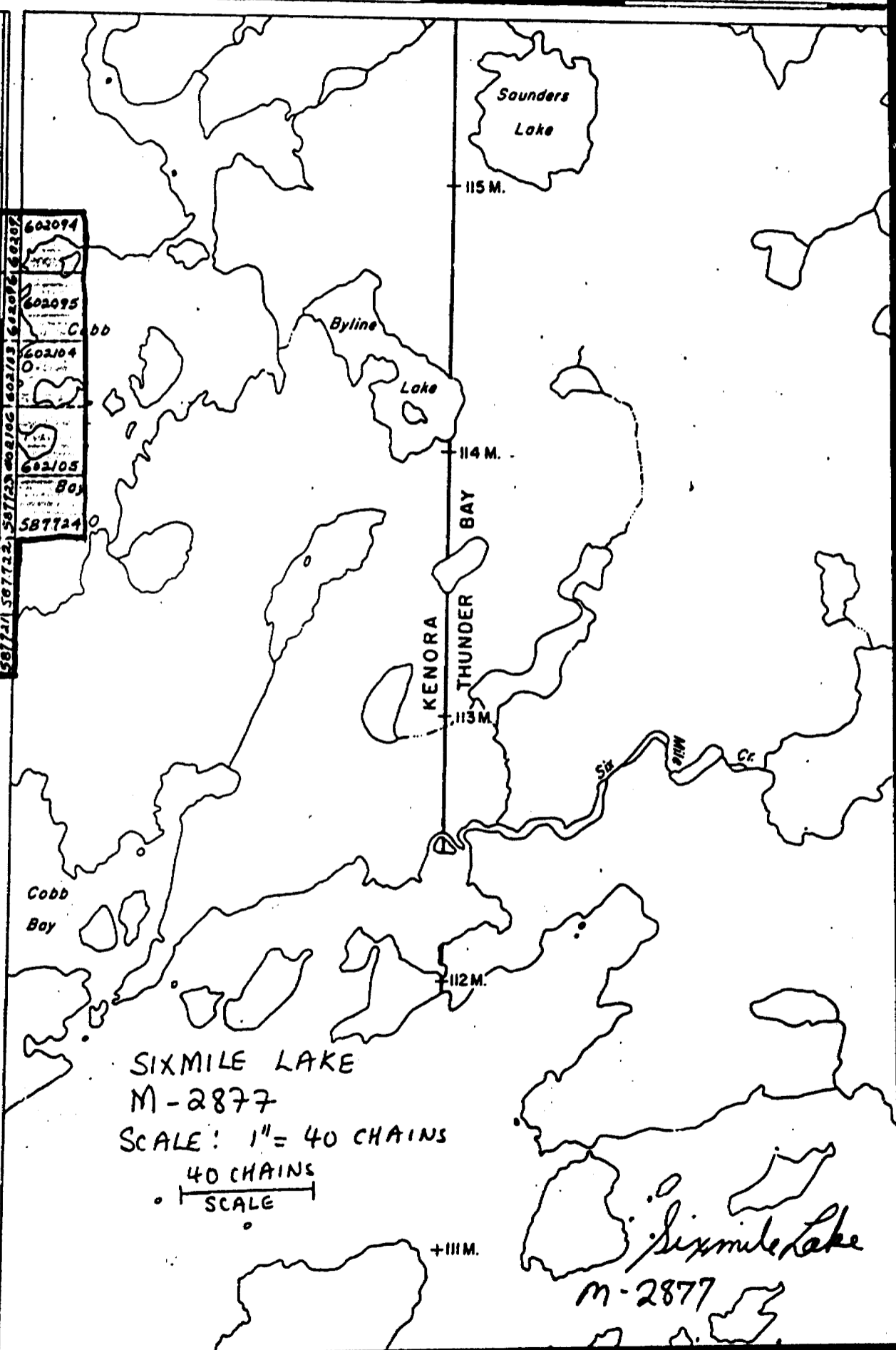

Penassi Lake M.2257

SIX MILE LAKE  
M-2877  
SCALE: 1" = 40 CHAINS  
40 CHAINS  
SCALE

Six Mile Lake  
M-2877

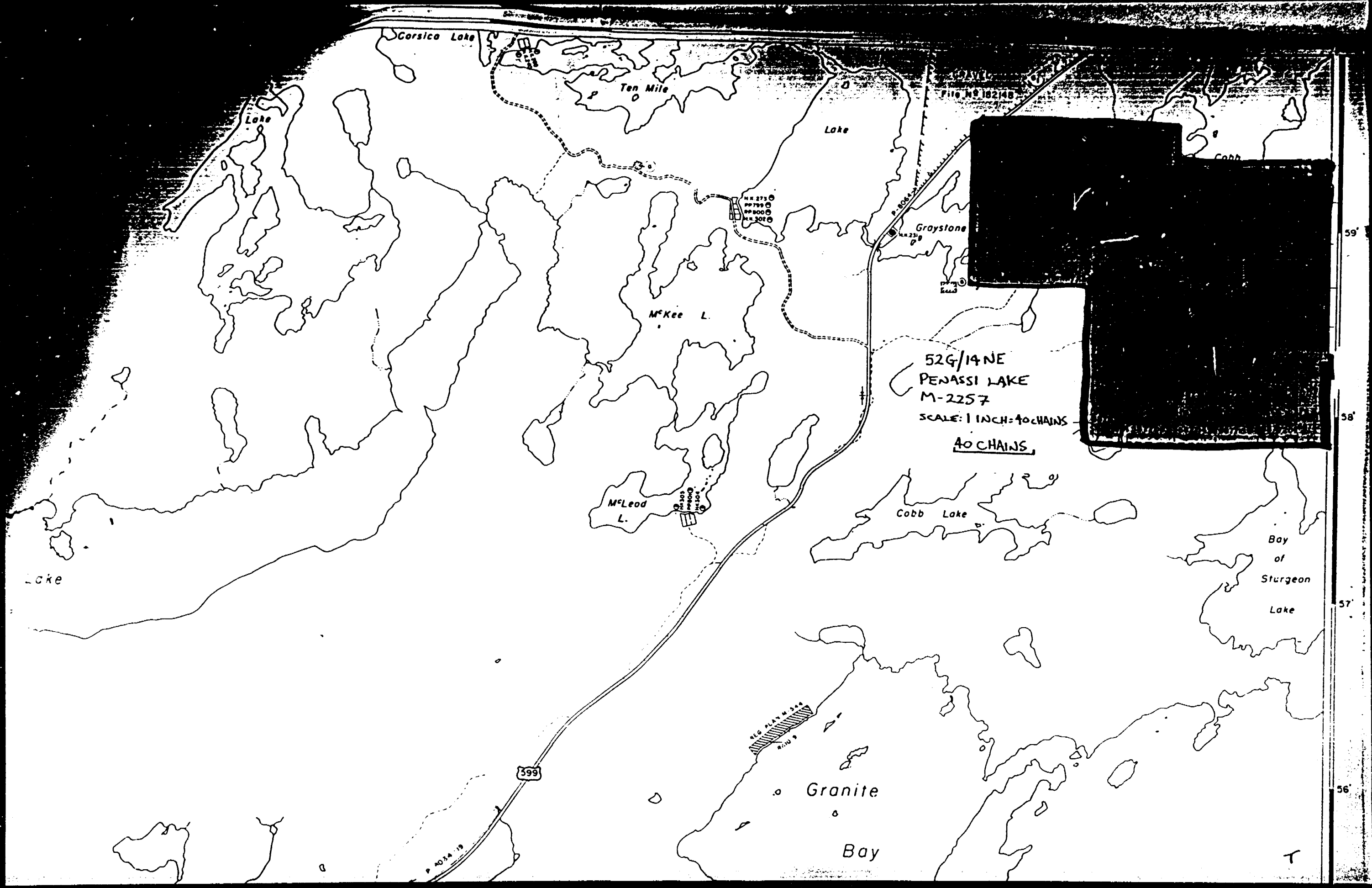

52G/14NE  
PENASSI LAKE  
M-2257  
SCALE: 1 INCH = 40 CHAINS  
40 CHAINS

59'  
58'  
57'  
56'

T

Penasi Lake M 2257

52G/15NW

AREA OF SIXMILE LAKE

M-2877

SCALE: 1 inch = 40 chains

40 CHAINS

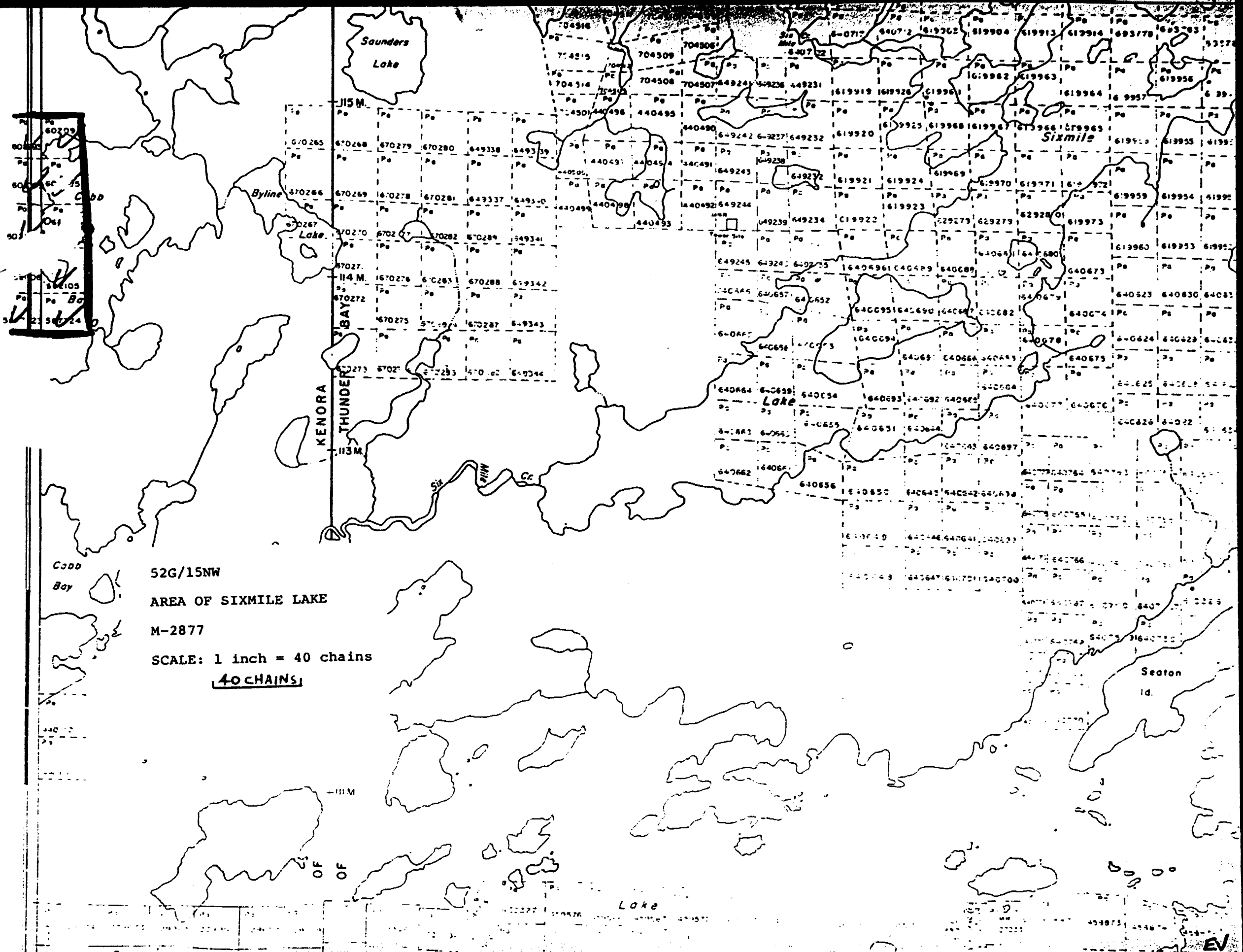



Ministry of  
Natural  
Resources

PENASSI LAKE M-22574  
SIXMILE LAKE M-2877

82-~~24~~  
30

A separate form is  
required for each  
type of work to be  
recorded.

THE MINING ACT REPORT OF WORK

To the Recorder of.....PATRICIA.....Mining Division

I, A. J. DAVIDSON - AGENT FOR - CORPORATION FALCONBRIDGE COPPER.....I-556.....  
name of Recorded Holder Prospector's Licence

P.O. BOX 40, COMMERCE COURT WEST, TORONTO, ONTARIO M5L 1B4.....  
Post Office Address

do hereby report the performance of .....1,220<sup>8</sup>.....days of .....MAGNETOMETER SURVEY.....  
type of work

not before reported to be applied on the following contiguous claims TOTAL 61 CLAIMS

Claim No.	Days	Claim No.	Days	Claim No.	Days
PA 587704	20	PA 587710	20	PA 587716	20
587705	20	587711	20	587717	20
587706	20	587712	20	587718	20
587707	20	587713	20	587719	20
587708	20	587714	20	587720	20
587709	20	587715	20	587721	20

See also Attached List

All the work was performed on Mining Claim (s) PA 587704-744 incl; and PA 602090-602109 incl:  
(In the case of geological and/or geophysical survey (s) where more than 18 claims are involved attach a schedule)

READ CAREFULLY: THE FOLLOWING INFORMATION IS REQUIRED BY THE MINING RECORDER.

- For Manual Work, Stripping or Opening up of Mines, Sinking Shafts or Other Actual Mining Operations - Names and addresses of the men who performed the work and the dates and hours of their employment.
- For Diamond and other Core Drilling - Footage, No. and angle of holes and diameter of core. Name and address of owner or operator of drill. Dates when drilling was done. Signed core log and sketch in duplicate.
- For Compressed Air or Other Power Driven or Mechanical Equipment  
Type of drill or equipment. Names and addresses of men engaged in operating equipment and the dates and hours of their employment.
- For Power Stripping - Type of equipment. Name and address of owner or operator. Amount expended. Dates on which work was done. Proof of actual cost must be submitted within 30 days of recording.
- With each of the above types of work sketches are required to show the location and extent of the work in relation to the nearest claim post. In the case of diamond or other core drilling the sketch must be submitted in duplicate.
- For Geophysical, Geological, Geochemical Surveys and Expenditure Credits - the name of author of report. Covering dates of survey (linecutting & office). Type of instrument used. Total amount of expenditure. Technical reports, maps, expenditure breakdown, receipts must be filed in duplicate with the Minister within 60 days of recording.
- For Land Survey - the name and address of Ontario Land surveyor.

The Required Information is as Follows: (Attach a list if this space is insufficient)

AUTHOR OF REPORT: A. J. DAVIDSON - CORPORATION FALCONBRIDGE COPPER  
2606 VICTORIA AVENUE, EAST, THUNDER BAY, ONTARIO P7C 1E7

DATES: JANUARY 1, 1982 - MARCH 1, 1982

INSTRUMENT: SCINTREX MP-2;  
SCINTREX MBS-2:

Date MARCH 5, 1982.....

*Alex Davidson*  
Signature of Recorded Holder or Agent

The Mining Act  
Certificate Verifying Report of Work

I, A. J. DAVIDSON - CORPORATION FALCONBRIDGE COPPER.....

.....2606 VICTORIA AVENUE, EAST, THUNDER BAY, ONTARIO.....P7C 1E7.....  
(Post Office Address)

hereby certify:

- That I have a personal and intimate knowledge of the facts set forth in the report of work annexed hereto, having performed the work or witnessed same during and/or after its completion.
- That the annexed report is true.

Dated MARCH 5 19 82.....

PATRICIA MINING DIV  
RECEIVED  
MAR - 8 1982  
A.M. P.M.

*Alex Davidson*  
Signature

587704

THE PENALTY FOR MAKING A FALSE STATEMENT IN THIS REPORT AND/OR CERTIFICATE IS \$500. OR SIX MONTHS IMPRISONMENT OR BOTH

MARCH 5, 1982 - ASSESSMENT - PATRICIA MINING DIVISION

CORPORATION FALCONBRIDGE COPPER - LICENCE T-556

P. O. BOX 40,  
COMMERCE COURT WEST,  
TORONTO, ONTARIO.  
MSL 1B4

<u>CLAIM NUMBER</u>	<u>DAYS</u>	<u>CLAIM NUMBER</u>	<u>DAYS</u>
PA 587722	20	PA 602090	20
587723	20	602091	20
587724	20	602092	20
587725	20	602093	20
587726	20	602094	20
587727	20	602095	20
587728	20	602096	20
587729	20	602097	20
587730	20	602098	20
587731	20	602099	20
587732	20	PA 602100	20
587733	20	602101	20
587734	20	602102	20
587735	20	602103	20
587736	20	602104	20
587737	20	602105	20
587738	20	602106	20
587739	20	602107	20
587740	20	602108	20
587741	20	602109	20
587742	20		
587743	20		
587744	20		

**RECEIVED**

APR 30 1982

MINING LANDS SECTION

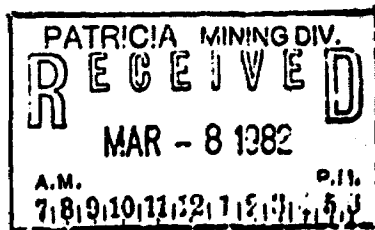

2.4749

1983 03 01

2.4749

CC  
Mining Recorder  
Ministry of Natural Resources 115362  
P.O. Box 669  
Sioux Lookout, Ontario  
POV 2T0

Dear Sir:

RE: Geophysical (Magnetometer) Survey submitted  
under Special Provisions (credit for Performance  
and Coverage) on Mining Claims Pa 587704 et al  
in the Areas of Six Mile Lake and Penassi Lake.  
*50 90-45 5272SW+356 Kenora*

The Geophysical (Magnetometer) Survey assessment  
work credits as shown on the attached statement  
have been approved as of the above date.

Please inform the recorded holder of these mining  
claims and so indicate on your records.

Yours very truly,

E.F. Anderson  
Director  
Land Management Branch

Whitney Block, Room 6450  
Queen's Park  
Toronto, Ontario  
M7A 1W3

Phone: 416/965-1380

A. Barr;jh

Encls.

cc: Corporation Falconbridge Copper  
Toronto

Phantom Exploration Services Ltd.  
Thunder Bay

Resident Geologist  
Court House Building  
Sioux Lookout



**Technical Assessment  
Work Credits**

File  
**2.4749**

1983 03 01

Recorded Holder  
**Corporation Falconbridge Cooper, Toronto**

Township or Area  
**Pensacola Lake & Six Mile Lake**

Type of survey and number of Assessment days credit per claim	Mining Claims Assessed
<b>Geophysical</b>	
Electromagnetic _____ days	
Magnetometer <b>20</b> _____ days	<b>Pa 587704 - 44 incl.</b>
Radiometric _____ days	<b>Pa 602090 - 099 incl.</b>
Induced polarization _____ days	<b>Pa 602100 - 09 incl.</b>
Section 86 (18) _____ days	
Geological _____ days	
Geochemical _____ days	
Man days <input type="checkbox"/> Airborne <input type="checkbox"/>	
Special provision <input checked="" type="checkbox"/> Ground <input checked="" type="checkbox"/>	
<input type="checkbox"/> Credits have been reduced because of partial coverage of claims.	
<input type="checkbox"/> Credits have been reduced because of corrections to work dates and figures of applicant.	

Special credits under section 86 (15a) for the following mining claims

No credits have been allowed for the following mining claims

not sufficiently covered by the survey       Insufficient technical data filed

The Mining Recorder may reduce the above credits if necessary in order that the total number of approved assessment days recorded on each claim does not exceed the maximum allowed as follows: Geophysical — 80; Geological — 40; Geochemical — 40; Section 86(18)-60:



Ministry of  
Natural  
Resources

Geotechnical  
Report  
Approval

File  
2.4749

Mining Lands Comments

To: Geophysics *Mr. Barber*

Comments

Approved     Wish to see again with corrections

Date  
*Jan 3/83*

Signature  
*Ryan Rhu*

To: Geology - Expenditures

Comments

*Pa*

Approved     Wish to see again with corrections

Date

Signature

To: Geochemistry

Comments

*LD*

Approved     Wish to see again with corrections

Date

Signature

To: Mining Lands Section, Room 6462, Whitney Block. (Tel: 5-1380)





Ministry of  
Natural  
Resources

Notification of recording  
of assessment work credits

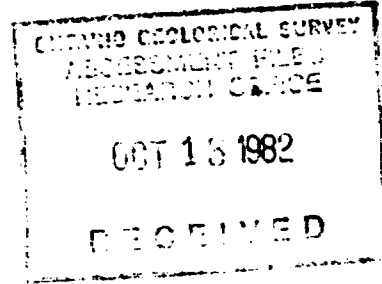

Supervisor, Projects Unit  
Mining Lands Section  
Ministry of Natural Resources  
Room 1617, Whitney Block  
Queen's Park, Toronto  
M7A 1W3

Date of recording of work: March 8, 1982

Recorded holder: CORPORATION FALCONBRIDGE COPPER

Address: P.O. Box 40, Commerce Court West, Toronto Ont.  
M5L 1B4

Township or Area: Pennessi Lake M-2257 and Sixmile Lake M-2877

Type of survey and number of Assessment days credit per claim	Mining claims
Geophysical	
Electromagnetic _____ days	Pa. 587704-44 incl.
Magnetometer <u>20</u> _____ days	Pa. 602090-602099 incl.
Radiometric _____ days	Pa. 602100-09 incl.
Induced polarization _____ days	
Section 86 (18) _____ days	
Geological _____ days	
Geochemical _____ days	
Man days <input type="checkbox"/>	Airborne <input type="checkbox"/>
Special provision <input type="checkbox"/>	Ground <input checked="" type="checkbox"/>

Notice to recorded holder:

- Survey reports and maps in duplicate must be submitted to the Projects Unit, Toronto within 60 days from the date of recording of this work.
- Reports and maps are being forwarded to the Projects Unit with this letter.

*A. Hanson*

Mining recorder

c.c. Corp. Falconbridge Copper-Tor.  
Corp. Falconbridge Copper-T. Bay  
#82-30



**CORPORATION FALCONBRIDGE COPPER**

2606 Victoria Avenue East  
Thunder Bay, Ontario P7C 1E7  
Telephone 807/623-1511

April 29th, 1982.

Mr. A. Hanson,  
The Mining Recorder,  
Ministry of Natural Resources,  
P. O. Box 669,  
Sioux Lookout, Ontario.  
POV 2T0

Dear Mr. Hanson:

Enclosed please find two (2) copies of report covering  
Proton Magnetometer Survey on 61 claims we hold in the  
Six Mile Lake and Penassi Lake area, NTS 52-G-14 and 15.  
The work was performed by R. Middaugh, Phantom Exploration  
Services Ltd., of Thunder Bay, Ontario, on our behalf.

Yours truly,  
CORPORATION FALCONBRIDGE COPPER

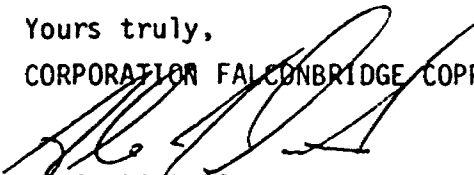

A. J. DAVIDSON  
SENIOR EXPLORATION GEOLOGIST

encls. 2

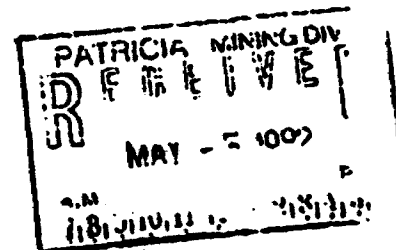

RECEIVED

MAY - 7 1982

MINING LANDS

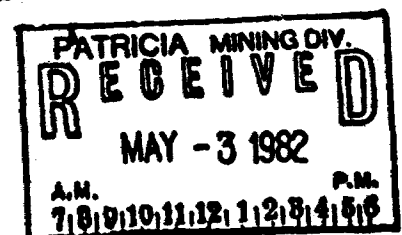

A

P. O. Box 669  
Sioux Lookout, Ontario  
POV 2T0

May 4, 1982

Corporation Falconbridge Copper  
2606 Victoria Avenue East  
Thunder Bay, Ontario  
P7C 1E7

ATTENTION: A.J. Davidson  
Senior Exploration Geologist

Dear Sir:

SUBJECT: Copies of Report-Magnetometer Survey  
61 claims-Six Mile & Penassi Lake Areas

We received the above reports on May 3, 1982.  
These reports are a follow-up to a work report submitted,  
and recorded in this office on March 8, 1982.

As nothing further is required in this office with  
regard to a Geophysical Survey, all reports pertaining  
to the survey should be filed with the Land Management  
Branch in Toronto, Attention P.W. Matthews, within 60  
days of the recording of the work.

We have stamped them received in this office, (May 3/82)  
and have forwarded them on to Toronto on your behalf.

Yours very truly;

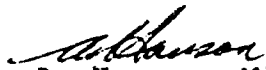
  
A. Hanson, Mining Recorder  
Land Management Branch  
Telephone: 807-737-2100

DHC:pjc

cc: ~~Land Management Branch, Toronto~~  
~~Attention: P.W. Matthews~~

REC

MAY - 7 1982

MINING LANDS SECTION

1982 05 18

0.4749

Mining Recorder's Office  
Ministry of Natural Resources  
P.O. Box 669  
Sioux Lookout, Ontario  
POV 2T0

Dear Sir:

We have received reports and maps for a Geophysical (Magnetometer) survey submitted under Special Provisions (credit for Performance and Coverage) on Mining Claims Pa 587704 et al in the Areas of Six Mile Lake & Penassí Lake.

This material will be examined and assessed and a statement of assessment work credits will be issued.

Yours very truly,

E.F. Anderson  
Director  
Land Management Branch

Whitney Block, Room 6450  
Queen's Park  
Toronto, Ontario  
M7A 1W3  
Phone: 416/965-1316

J. Skura/amc

cc: Corporation Falconbridge Copper  
Toronto, Ontario

cc: Phantom Exploration Services Ltd.  
Thunder Bay, Ontario

Comp. Tolconbridge Copper

2.11.11

Pa 587704	✓		Pa 587742	✓
05	✓		43	✓
06	✓		44	✓
07	✓		602090	✓
08	✓		91	✓
09	✓		92	✓
10	✓		93	✓
11	✓		94	✓
12	✓		95	✓
13	✓		96	✓
14	✓		97	✓
15	✓		98	✓
16	✓		99	✓
17	✓		602100	✓
18	✓		01	✓
19	✓		02	✓
20	✓		03	✓
21	✓		04	✓
22	✓		05	✓
23	✓		06	✓
24	✓		07	✓
25	✓		08	✓
26	✓		09	✓
27	✓			
28	✓			
29	✓			
30	✓			
31	✓			
32	✓			
33	✓		61 (Diss. ...)	
34	✓		61 claims	
35	✓			
36	✓			
37	✓			
38	✓			
39	✓			
40	✓			
41	✓			

SEE ACCOMPANYING  
MAP(S) IDENTIFIED AS

526/15 NW-0075-B1 #1

LOCATED IN THE MAP  
CHANNEL IN THE  
FOLLOWING SEQUENCE

(X)

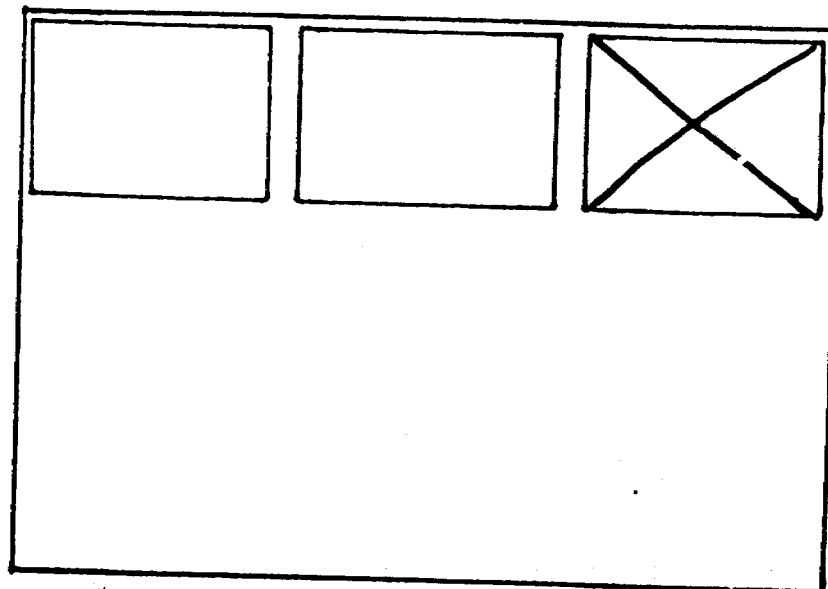

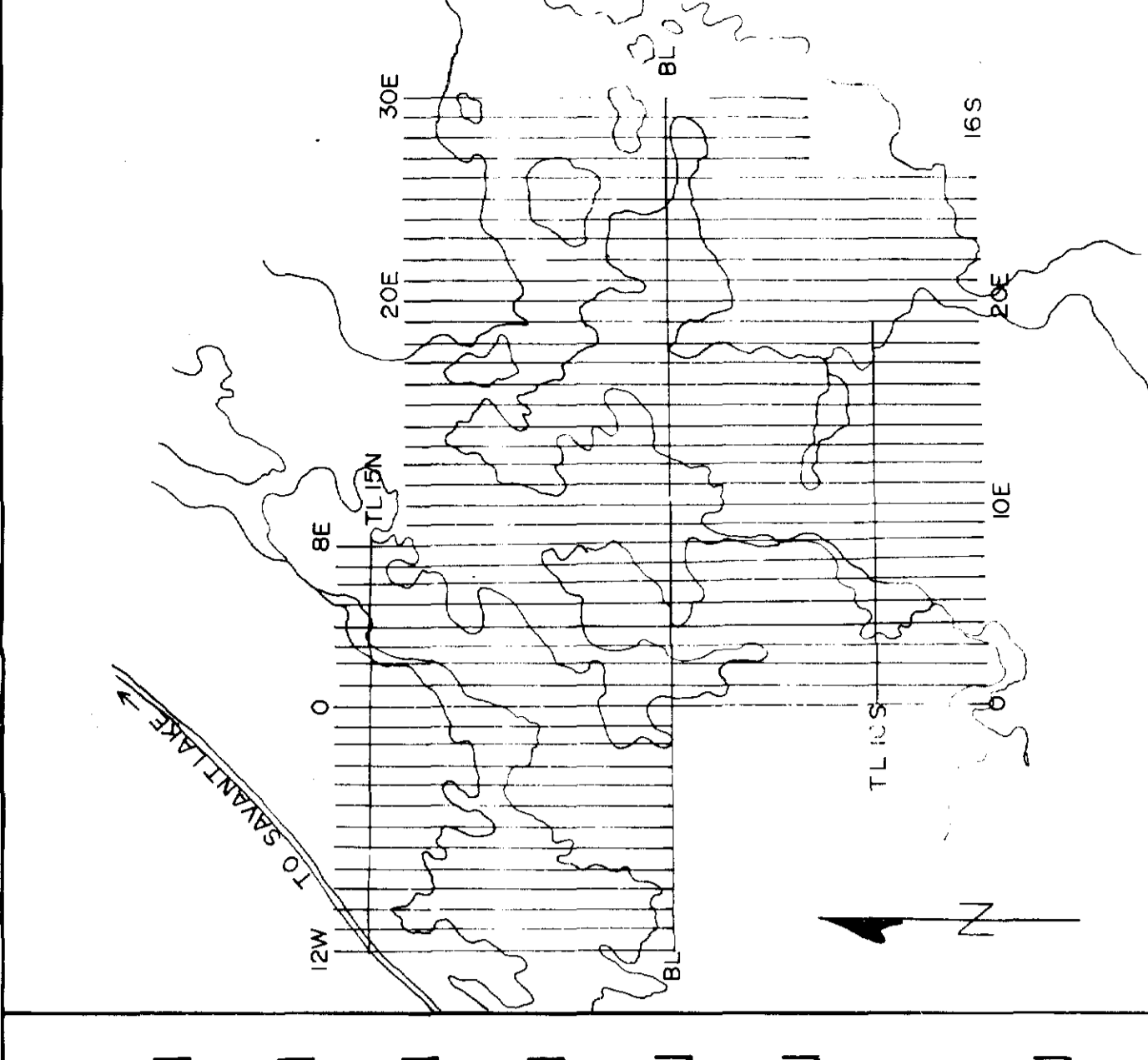

LOCATION MAP SCALE 1" = 1/2 MILE

LEGEND

HEM SURVEY

INSTRUMENT: APEX PARAMETRICS MAX MIN II  
 COIL SEPARATION: 150 METRES  
 FREQUENCY: HZ  
 PROFILE: 1CM = 10 %  
 IN PHASE READINGS: - - - - -  
 OUT OF PHASE READINGS: ······  
 CONDUCTOR AXIS: ————  
 POSITIVE READINGS: EAST OF LINE

MAGNETOMETER SURVEY

INSTRUMENT: SCINTREX MP-2  
 DATUM: 59 000 X  
 CONTOUR INTERVAL: 1000 Y  
 MAGNETIC LOW: ○

BASE STATION RECORDER INFORMATION

INSTRUMENT: SCINTREX MBS-2  
 RECORDING INTERVAL: 10 SECONDS  
 RECORDING RANGE: 100 X  
 CHART SPEED: 20 MM/HR

TOPOGRAPHY

SHORELINE: ————  
 ROAD: = = = =

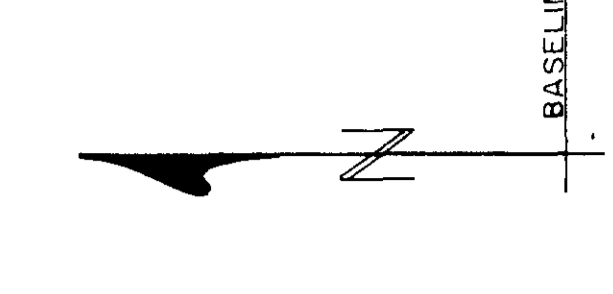

FOR: CORPORATION FALCONBRIDGE COPPER

PROTON MAGNETOMETER SURVEY

SIX MILE LAKE / COBB BAY PROJECT MAP NO.  
 DATE: MARCH 1982 MAP SCALE 1: 5000

BY: PHANTOM EXPLORATION SERVICES LTD.



526/15 NW - 0075 - B1 #1

12W 11W 10W 9W 8W 7W 6W 5W 4W 3W 2W 1W 0 1E 2E 3E 4E 5E 6E 7E 8E 9E 10E 11E 12E 13E 14E 15E 16E 17E 18E 19E 20E 21E 22E 23E 24E 25E 26E 27E 28E 29E 30E

17N 16N 15N 14N 13N 12N 11N 10N 9N 8N 7N 6N 5N 4N 3N 2N 1N BL IS 2S 3S 4S 5S 6S 7S 8S 9S 10S 11S 12S 13S 14S 15S 16S

