



52G15NW0099 52G15NW0017C1 SIXMILE LAKE

010

### Diamond Drilling

Area of SIXMILE LAKE

Report N<sup>o</sup> 40

Work performed by: Mattagami Mines

Claim N <sup>o</sup>	Hole N <sup>o</sup>	Footage	Date	Note
PA 225592	SL-23-70-4	523.0'	Jan/70	
PA 225593	<u>SL-23-70-5</u>	<u>597.0'</u>	Jan/70	
	2 OH	1120 FT		

Notes:

#298/71

MATTAGAMI LAKE MINES LIMITED - EXPLORATION DIVISION - DIAMOND DRILL HOLE RECORD

PROPERTY #23-2 STURGEON LAKE-ANOMALY	LATITUDE 54 + 47 - NORTH	STARTED January 11, 1970	DIP TEST			
HOLE NO. SL-23-70-4	DEPARTURE 32 + 00 - EAST	FINISHED January 14, 1970	Footage 100	Corrected 45°	Footage 500	Corrected --
BEARING South 26° WEST	ELEVATION SURFACE	LENGTH 523 FEET	200	47°		
DIP-COLLAR 45°	SECTION --	LOGGED BY J. D. MURPHY	300	36°		
			400	34°		

FOOTAGE		DESCRIPTION	% Mineralization	SAMPLE NO.	FOOTAGE			ASSAYS						
From	To				From	To	Length	Au	Ag	Zn	Cu	Pb		
0.0	56.0	CASING: Stick up 2.0' - casing left in hole												
56.0	232.2	ANDESITE: Dark green, fine to medium grained, massive to weakly bedded @ 45-50°, slightly chloritic in part, minor carb. as str. and along fractures, occasional grey qtz. str. up to 2" wide, mainly barren with some weakly disseminated Py and Pho.												
	65.0-82.0	Medium grey, med. to coarse grained section with fair banding @ 45°, contacts arbitrary, appears to be more felsic phase of andesite												
	145.5-159.7	sheared zone, grey green, well banded @ 50-60°, short sections show well developed, L. H. drag filling with axes @ 50-60 to core, section generally soft, chloritic, talcose, minor introduced qtz. and carb., wkPho. over short sections, minor coarse Py.												
	147.3-3"	brecciated "Gouge" zone, possible plane of maximum movement.												
	159.7-180.0	Mineralized (sphalerite?) section, weakly foliated, andesite containing numerous grey felsic bands up to 6" wide carrying approx. 20% dark, soft metallic min. as medium identified as sphalerite, fine to med. pale blue qtz phenos. commonly associated with min., some minor Pho												
	Sample:	fair sphalerite min. w. minor Pho.	10-15	6201	159.0	162.0	3.0	0.004	0.05	Tr.	Nil	Nil		
	Sample:	Mainly barren and, 8" mineralized section	1-3	6202	162.0	167.0	5.0	0.008	Tr.	Tr.	Nil	Nil		
	Sample:	Mainly barren W. narrow sect'd min. sections	1	6203	167.0	172.0	5.0	0.004	Nil	Tr.	Nil	Nil		
	Sample:	barren and.	<1	6204	172.0	175.0	3.0	0.006	Nil	Tr.	Nil	Nil		
	Sample:	fair min. over combined width of 18"	5	6205	175.0	178.0	3.0	0.007	Nil	Nil	Nil	Nil		
	Sample:	weak scat'd weak scat'd min.	1-2	6206	178.0	180.0	2.0	0.006	0.17	Tr.	Tr.	Nil		
	Sample:	strong Py, minor Pho., scat'd sphalerite XL's near End of section	65-70	6207	219.5	221.5	2.0	0.005	0.05	Nil	Nil	Nil		



MATTAGAMI LAKE MINES LIMITED - EXPLORATION DIVISION - DIAMOND DRILL HOLE RECORD

PROPERTY	LYON LAKE	LATITUDE	64 + 50 NORTH	STARTED	January 16, 1970	DIP TEST					
HOLE NO.	SL-23-70-5	DEPARTURE	36 + 00 EAST	FINISHED	January 19, 1970	Footage	Corrected	Footage	Corrected	Footage	Corrected
BEARING	SOUTH 26° WEST	ELEVATION	SURFACE	LENGTH	597 FEET	100	37°	500	23°		
DIP-COLLAR	43°	SECTION	36 + 00 EAST	LOGGED BY	P. P. GRIGGS	200	34°30'	597	21°30'		
						300	30°				
						400	25°				

FOOTAGE		DESCRIPTION	% Mineralization	SAMPLE NO.	FOOTAGE			ASSAYS						
From	To				From	To	Length	An	Ag	Zn	Cu	Pb		
0.0	40.0	CASING: Casing pulled, lost four (4) feet.												
40.0	146.0	DACITE: Med. to dark grey, fine grained, massive but with definite banding @ 55° to core axis, cut by qtz.-carb. stringers from 1/16" to 2" width, poorly disseminated pyrite scattered with occasional pyrrhotite.												
		57.0 - lost 0.5' (ground)												
		69.0 - lost 1.0' (ground)												
		77.0 - lost 1.0' (ground)												
		140.0 - lost 0.5' (ground)												
146.0	187.7	CHLORITIC DACITE: Med. to dark green, fine to medium grained, well banded at 50° to core axis, qtz-carb. stringers up to 1" wide and generally cutting the core axis at 50° but occasionally at 10°, occasional qtz-carb phenocrysts aligned parallel to banding. Pyrite & pyrrhotite finely disseminated and scattered.												
		160.0-161.0 - section bounded by 2.1" thick qtz-carbonate stringers containing minor sulphides including pyrite, pyrrhotite and trace of sphalerite.												
		Sample: Minor pyrite & Pyrrhotite with tr. sph.	1-2%	6215	160.0	161.0	1.0	0.026	Nil	Nil	Tr.	Nil		
		167.0-173.0 - section of mainly barren tuff but with several distinct patches of mineralization including pyrite & sphalerite.												
		Sample: Minor pyrite & sphalerite in 1" bands	1-3%	6216	167.0	169.0	2.0	0.005	0.12	Nil	Nil	Nil		
		Sample: Good sphalerite & pyrite in blebs & strgs.	1-3%	6217	169.0	173.0	4.0	0.003	0.05	Nil	Nil	Nil		
		178.3-187.7 Dark black and massive, fine grained. Some very distinct banding but not throughout. Sulphide mineralization all but absent except for one section between 180.0 & 180.4. In this area disseminated pyrite & pyrrhotite exist with a trace of sphalerite. The entire section is cut by qtz-carb. stringers @ from 30° to core axis. Neither top nor bottom contact definite but appear gradational.												
		Sample: 0.4 ft. fair pyrite & pyrrhotite in otherwise barren tuff.		6218	179.6	180.6	1.0	0.003	0.05	Nil	Tr.	Nil		



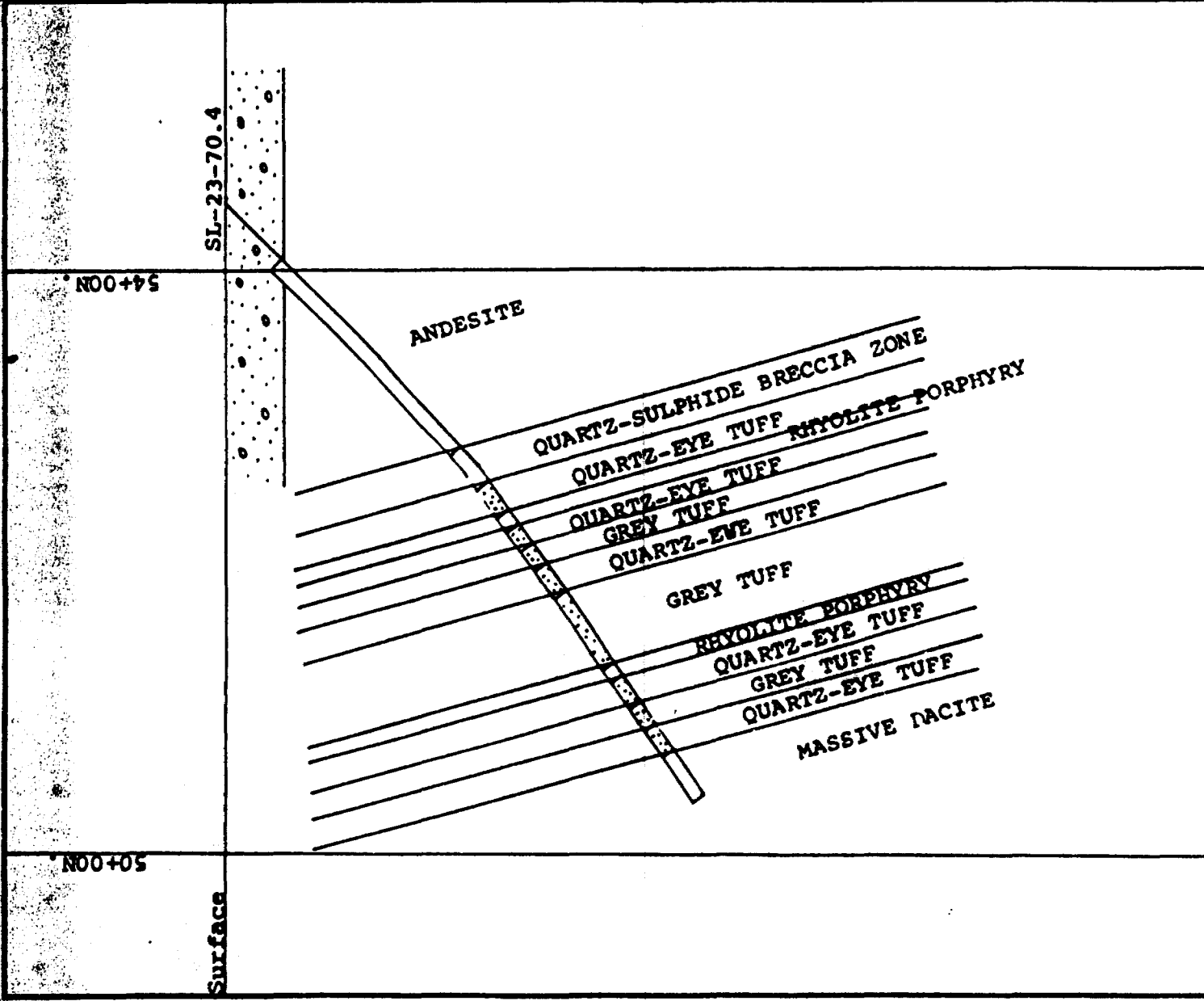

**MATTAGAMI LAKE MINES LTD.**  
 EXPLORATION DIVISION  
 PROJECT: STURGEON LAKE - GROUP '23  
 SECTION: LINE 32+00E. (OLD GRID)  
 D.D.H.# SL-23-70.4  
 SCALE: 1" = 100 FEET  
 DATE: 26 Aug. '71      DRW. BY: L.I.

100 FEET





FOOTAGE		DESCRIPTION	Mineralization	SAMPLE NO.	FOOTAGE			ASSAYS						
From	To				From	To	Length	Au	Ag	Zn	Cu	Pb		
477.5	486.3	<b>QUARTZ DIORITE:</b> Med. to coarse grained, dark gray in colour massive with no banding texture appears somewhat sugary. Top contact distinct at 40° to core axis, bottom contact somewhat indistinct dike cut by three small qtz-carbonate stringers cutting core axis at 30°. These stringers brought sulphides including chalcopyrite, pyrite pyrrhotite & sphalerite. Other than with the stringers, sulphides are absent.  Sample: very poor sulphides with trace chalco & sph. 1-2% Sample: very poor sulphides with trace chalco & sph. 1-2% Sample: very poor sulphides with trace chalco & sph. 1-2%												
477.5	486.3			6225	480.0	481.0	1.0	Nil	Nil	Nil	Tr.	Nil		
				6226	481.5	482.5	1.0	.007	Nil	Nil	Tr.	Nil		
				6227	482.5	483.5	1.0	.005	Nil	Nil	Tr.	Nil		
486.3	504.0	<b>GREY TUFF:</b> Light to med. grey in colour, fine to medium grained, banded. Contact not distinct but grades into Dacite dike above. Cut by qtz-carb. Stringers up to 1" wide cutting core axis at 40°. Sulphide mineralization very finely disseminated and scattered.												
504.0	597.0	<b>DACITE:</b> Med. to dark gray, fine to med. grained, massive and generally no banding contact between above tuff & dacite not visible was probably ground. Dacite cut by qtz-calcite stringers up to 1 1/2" wide at 60° to core axis. Sulphide mineralization scattered and finely disseminated is very poor. Pyrite and pyrrhotite are the two minerals present.												
		END OF HOLE												

*[Handwritten signature]*



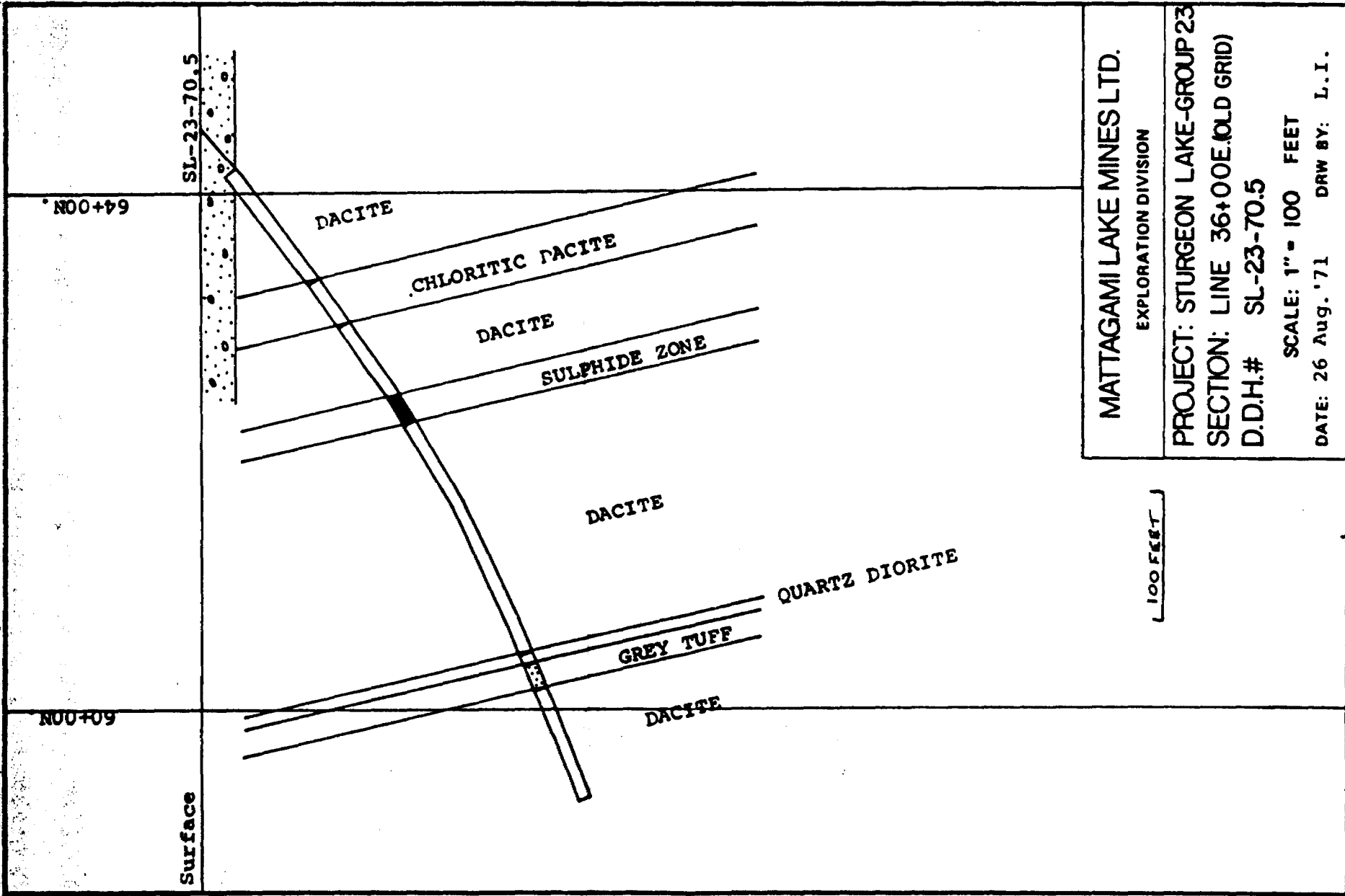

MATTAGAMI LAKE MINES LTD.  
 EXPLORATION DIVISION  
 PROJECT: STURGEON LAKE-GROUP 23  
 SECTION: LINE 36+00E.(OLD GRID)  
 D.D.H.# SL-23-70.5  
 SCALE: 1" = 100 FEET  
 DATE: 26 Aug. '71    DRW BY: L.I.

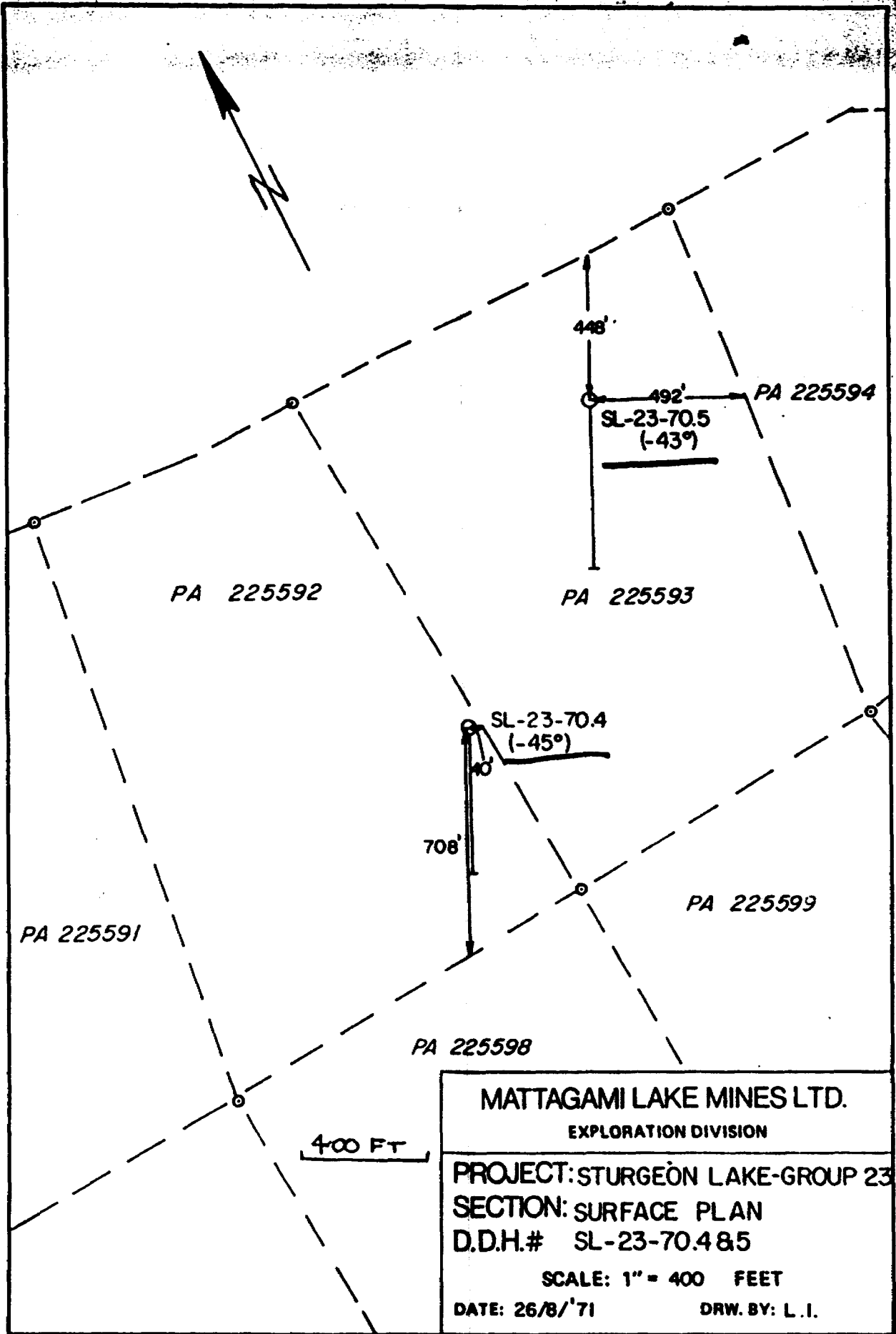

**MATTAGAMI LAKE MINES LTD.**  
 EXPLORATION DIVISION

---

**PROJECT: STURGEON LAKE-GROUP 23**  
**SECTION: SURFACE PLAN**  
**D.D.H.# SL-23-70.4 & 5**

---

**SCALE: 1" = 400 FEET**  
**DATE: 26/8/'71**                      **DRW. BY: L.I.**

40 CHAINS

246021	246026	246035	246042	245997	246006	246009	245984	246759	246758	246757	227212	227215	227220	227222	227227
246022	246025	246036	246043	245996	246007	246008	245985	246760	246761	246762	227213	227214	227221	227223	227228
246023	246024	246037	246044	246045	227221	227222	227223	225395	225396	225397	225398	225399	225400	225401	225402
211736	211737	211755	211756	211757	211775	211776	211777	211778	211779	227224	227225	227226	225396	225397	225398
211725	211734	211740	211742	211750	211760	211761	211762	211763	211764	227227	227228	227229	225399	225400	225401
211726	211733	211741	211748	211751	211769	211768	211767	211766	211765	227230	227231	227232	225402	225403	225404
211727	211732	211742	211747	211752	211770	211771	211772	211773	211774	227233	227234	227235	225405	225406	225407
211728	211731	211743	211746	211753	211780	211783	211784	211787	211788	227236	227237	227238	225408	225409	225410
211729	211730	211744	211745	211754	211781	211782	211785	211786	211789	227239	227240	227241	225411	225412	225413
229087	229086	229256	229261	229262	229267	229268	229273	229274		227242	227243	227244	225414	225415	225416
		229257	229260	229263	229266	229269	229272	229275		227245	227246	227247	225417	225418	225419
		229258	229259	229264	229265	229270	229271	229276		227248	227249	227250	225420	225421	225422
383	222982	225556	225558	225554	225553	225552	225551	225525	225524	225523	225591	225592	225593	225594	225595
222980	222981	225563	225564	225560	225559	225558	225557	225528	225527	225526	225597	225598	225599	225600	225601

APER CO. LTD.  
 SIX MILE LAKE  
 M-2877  
 #54 MATTAGAMI LAKE  
 MINGS LTD.

212610	212617	212706	212742	225571	225572	225518	225514	225513	225516	225777	225771	211807	211808
212611	212616	212736	212741	225577	225518	225519	225520	225521	225522	225780	225772	211809	211810
212612	212615	212707	212740	225661	225662	225667	225672	225773	225778	225781	225773	225779	225780
212613	212614	212738	212709	225662	225665	225668	225671	225774	225777	225782	225774	225778	225779

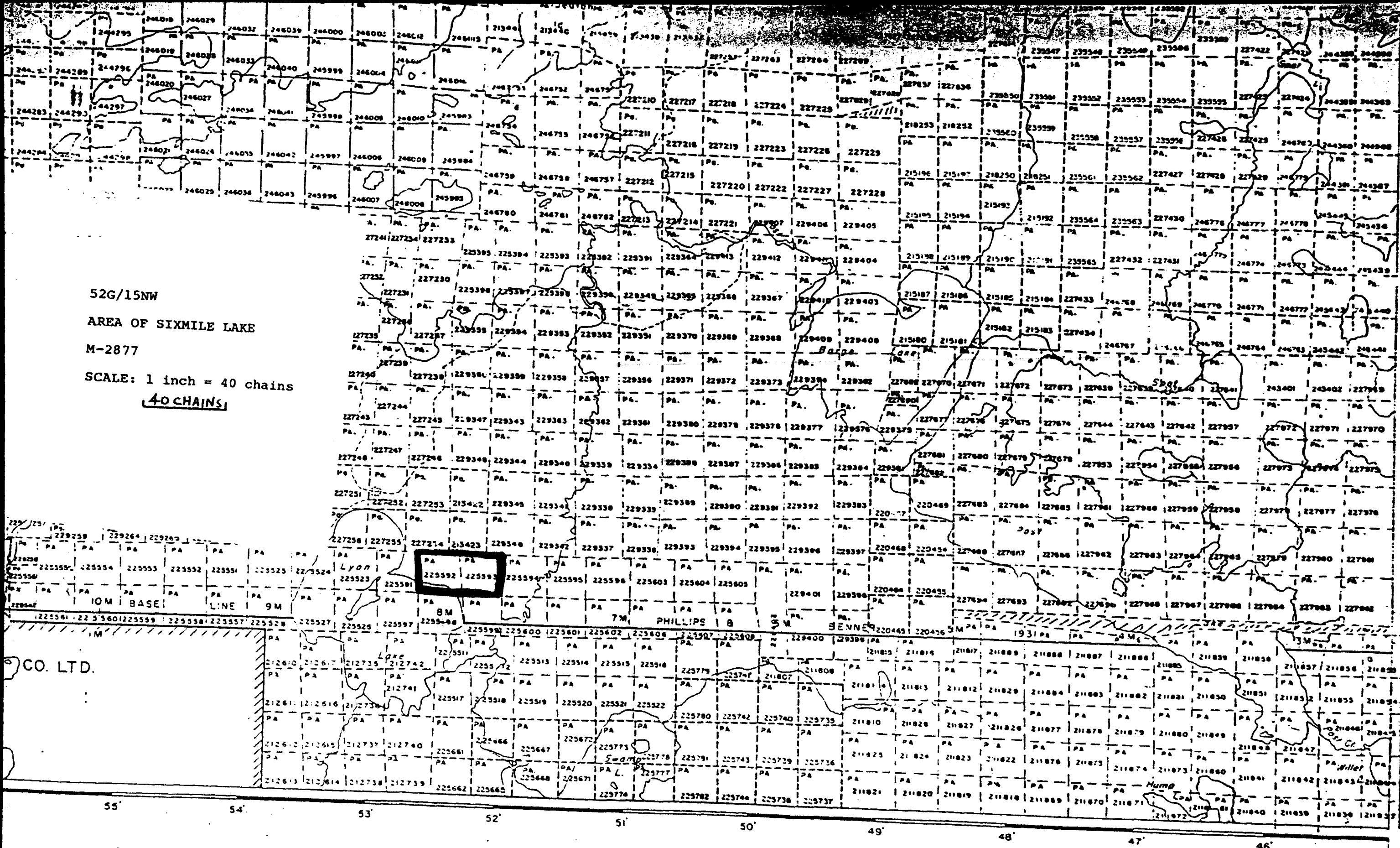

52G/15NW

AREA OF SIXMILE LAKE

M-2877

SCALE: 1 inch = 40 chains

40 CHAINS

CO. LTD.

55' 54' 53' 52' 51' 50' 49' 48' 47' 46'



52G15NW0099 52G15NW0017C1 SIXMILE LAKE

900



ONTARIO

SIXMILE LAKE

M-2877

A separate form is required for each type of work to be recorded.

#298

THE MINING ACT REPORT OF WORK

To the Recorder of.....PATRICIA.....Mining Division

I,.....MATTAGAMI LAKE MINES LIMITED.....T 84

name of Recorded Holder Miner's Licence

.....Suite 205, 8 King Street East, Toronto, Ontario.....

Post Office Address

do hereby report the performance of .....1120..... days of .....Diamond Drilling.....

type of work

not before reported to be applied on the following contiguous claims

Claim No.	Days	Claim No.	Days	Claim No.	Days
PA 225512	120	PA 225596	120		
225513	49	225599	120		
225592	1	225600	120		
225593	69	225601	120		
225594	120	225603	120		
225595	120	225604	41		

All the work was performed on Mining Claim (s) ..... PA 225592 and 225593  
(In the case of geological and/or geophysical survey (s) where more than 18 claims are involved attach a schedule)

READ CAREFULLY: THE FOLLOWING INFORMATION IS REQUIRED BY THE MINING RECORDER.

For Manual Work, Stripping or Opening up of Mines, Sinking Shafts or Other Actual Mining Operations - Names and addresses of the men who performed the work and the dates and hours of their employment

For Diamond and other Core Drilling - Footage, No. and angle of holes and diameter of core. Name and address of owner or operator of drill. Dates when drilling was done. Signed core log and sketch in duplicate.

For Compressed Air or Other Power Driven or Mechanical Equipment

Type of drill or equipment. Names and addresses of men engaged in operating equipment and the dates and hours of their employment.

For Power Stripping - Type of equipment. Name and address of owner or operator. Amount expended. Dates in which work was done. Proof of actual cost must be submitted within 30 days of recording.

With each of the above types of work sketches are required to show the location and extent of the work in relation to the nearest claim post. In the case of diamond or other core drilling the sketch must be submitted in duplicate.

For Geological and Geophysical Survey - The names and addresses of men employed as well as dates. Type of instrument used in the case of geophysical survey. Reports and maps in duplicate must be filed with the Minister within 60 days of recording.

For Land Survey - the name and address of Ontario Land surveyor.

The Required Information is as Follows: (Attach a list if this space is insufficient)

Owner of Drill: N. Morissette Diamond Drilling Limited, Box 789, Haileybury, Ontario.

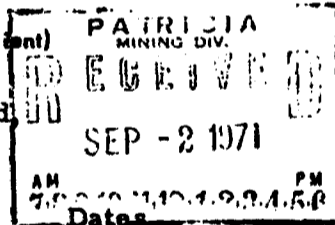

Hole Nos.	Angle	Footage	Core Dia.	Dates
SL 23 - 70-4	45°	225592 523	1 5/16"	Jan. 11 - 14, 1970
SL 23-70-5	43°	Pa 225593 597	1 5/16"	Jan. 16-19, 1970

Date..... Aug 31/71..... Signature of Recorded Holder or Agent

The Mining Act Certificate Verifying Report of Work

I,.....JOHN D. HARVEY.....

.....Suite 205, 8 King Street East, Toronto, Ontario,.....  
(Post Office Address)

hereby certify:

1. That I have a personal and intimate knowledge of the facts set forth in the report of work annexed hereto, having performed the work or witnessed same during and/or after its completion.
2. That the annexed report is true.

Dated..... Aug 31 1971..... Signature

Pa. 225511

THE PENALTY FOR MAKING A FALSE STATEMENT IN THIS REPORT AND/OR CERTIFICATE IS \$500. OR SIX MONTHS IMPRISONMENT OR BOTH