

52G15NW0101 52G15NW0033C1 SIXMILE LAKE

010

Diamond Drilling

Area of SIXMILE LAKE

Report NO 38

Work performed by: G.G. Plaskett

Claim NO	Hole NO	Footage	Date	Note
PA 227255	70-1	605.0'	Mar/70	
	70-2	557.5'	Mar/70	
PA 227252	70-4	666.0'	Mar/70	
PA 227246	<u>70-6</u>	<u>532.0'</u>	Apr/70	
TOTAL	4 DH	2360.5		

Notes:

For Drill Hole Location Map, see report #39

1200 FT SOUTH
100 FT EAST

#4 Post CLAIM 227255
PROPERTY Canadex Mines Limited Sturgeon Lake
Property

HOLE NO. 70-1

LOCATION: Lyon Lake - 700' off shore

LATITUDE: _____

STRIKE: 8 30° W

PAGE NO. _____

DEPARTURE: L 24 E

DIP: - 50° @ collar

ELEVATION: 69 + 503

DATE DRILLED: 1 - 4th March, 1970

PURPOSE: To test geophysical anomaly

FOOTAGE	DESCRIPTION	SAMPLE NO.	WIDTH	ASSAY VALUE	
0 - 64	CASINO				
64 -169	Altered BASIC VOLCANICS tuff - massive med. grained, schistose chloritic - 60°/core grey to green soft Scattered qts. veinlets 1/4" - 1" wide includes sections of tuff - med. grained - intermediate exhibiting grey feldspar fragments in dark ground mass 126 - 4" qts. & coarse pyrite ± 5% sulphides 134 - 4" fine brown pyrrhotite mineralization in dark green basic volcanic ± 5% sulphide - at 125 - squeezed acid fragment 1" x 1/2" in basic altered volcanic fine sparse pyrite mineralization for 1 ft. ± 1% sulphide				
169 -180	Acid AGGLOMERATE light coloured - acid - fragments comprising 70-80% of rock - layers - seams - stringers of fine disseminated to massive pyrrhotite with some pyrite est. 5-10% sulphide showing bedding - 60°/core				
	169-175 6'	Cu .01	Zn .01	Ag .01	Pb .01
	175-200 5'	.01	.01	.02	.01
180 -296	180-2 White qts. with coarse blebs vugy pyrite Altered basic tuff including considerable basic agglomerate schisted - 60°/core very soft dark Scattered seams & irregular bands of finely disseminated pyrrhotite to 1/2" wide - estimated 25% sulphides over width of the bands				
296 -308	Acid AGGLOMERATE - 50% Qts & rhyolite fragments - matrix mineralized to 10-15% sulphides being pyrrhotite with some pyrite - generally finely disseminated - foliated with the bedding.				
	296-300 1'	.01	.01	.01	.01
	300-304 1'	.01	.01	.01	.01
	304-308 1'	.01	.01	.05	.01
308 -310	BRECCIATED VEIN QTZ ₂ white with wall rock inclusions				
310 -350	BEDDED TUFF - 60-70°/core				
	310-312 thin bedded black cherty with seams of coarse pyrite small amount brown sphalerite at 311				
	312-350 grey siliceous massive bands alternating with dark thin beds - streaks & bands of pyrite - coarse & fine ± 1-3% sulphide - includes narrow bands of quartz eye rhyolite				
350 -388	341 small amount chalcopyrite within pyrrhotite INTERMEDIATE VOLCANIC TUFF light grey massive few small fragments occasional evidence of bedding 60-70°/core no sulphides				
388 -395	ACID TUFF thin bedded to 2" wide - 60°/core light coloured includes rhyolite & black chert beds widely scattered seams of fine pyrrhotite ± 3% sulphides sparse small tuff fragments				

DRILLED BY Barron Diamond Drilling

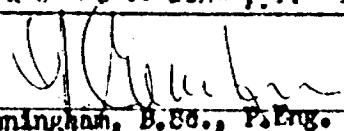
SIGNED 
L.J. Cunningham, B.Sc., P.Eng.
Mine

PROPERTY Canada

Sturgeon Lake Property

HOLE No. 70-1

LOCATION: _____

LATITUDE: _____

DEPARTURE: _____

ELEVATION: _____

STRIKE: _____

DIP: _____

DATE DRILLED: _____

PAGE No. 2

PURPOSE: _____

FOOTAGE	DESCRIPTION	SAMPLE NO.	WIDTH	ASSAY VALUE
395 -430	BASIC to Intermediate TUFF dark coloured black to grey occasional narrow acidic bands			
430 -455	INTERMEDIATE to acid TUFF light grey alternating with darker bands at 432 4" white well bedded rhyolite - 60°/core cut by quartz veins to 2" wide			
455 -550	BASIC TUFF dark grey massive occasional fragment			
550 -605	ACID TUFF & AGGLOMERATE light & dark grey tuff sections dark - 60-70°/core agglomerate light rhyolite & quartz fragments occasional seams of fine pyrrhotite			
605	END OF HOLE			

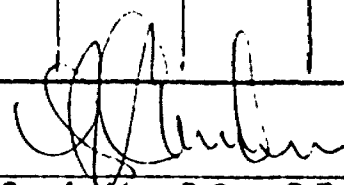

DRILLED BY Barron Diamond Drilling

SIGNED 
L. J. Cunningham, B.Sc., P.Eng.

550 ft SOUTH of # 4 Post. CLAIM 227255
 100 ft EAST
 PROPERTY Canadex (Sturgeon Lake Property)

LOCATION: Lyon Lake 50' off shore

HOLE NO. 70-3

LATITUDE: _____

STRIKE: S 30° W

PAGE NO. _____

DEPARTURE: L 20 E

DIP: - 50° at collar

ELEVATION: 64 + 50 S

DATE DRILLED: 7 - 10 March 1970

PURPOSE: To test geophysical anomaly

FOOTAGE	DESCRIPTION	SAMPLE NO.	WIDTH	ASSAY VALUE
0-33	CASINO			
33-152	TUFF intermediate to acid - greyish fine grained with many fine fragments generally massive with well bedded sections - 60°/core with variable colour from grey to black occasional narrow rhyolitic bands grey to black numerous carbonate stringers and veinlets			
152-163	TUFF well bedded - generally soft basic with occasional light coloured acid bands 60°-70°/core			
163-206	TUFF mineralized ± 15% of fine pyrrhotite with some pyrite in bands, seams & blebs conformably to bedding intermediate to acid tuff showing quartz eyes entire section estimated t-10% sulphides 181 - 8" white vein quartz coarse bleb pyrrhotite			
206-280	TUFF intermediate to acid bedded - 60°/core light grey colour numerous quartz eyes tuff beds occasional narrow acid agglomerate bands minor fine seams of pyrrhotite			
280-350	AGGLOMERATE at approximately 280 gradational Change to motley grey more massive acidic hard			
350-417	Gradational change to dark grey green intermediate TUFF			
417-557.5	AGGLOMERATE as 280-350 generally massive coarse light motley grey with occasional dark fine grained bands			
557.5	END OF HOLE			

Samples

163 - 168 -
 168 - 173 -
 173 - 178 -
 178 - 183 -
 183 - 188 -
 188 - 193 -
 193 - 198 -
 198 - 202 -
 202 - 206 -

8
9
10
11
12
13
14
15
16

Ag - Cu - Zn
 ↓ .02
 ↓ .01
 AU ALL .01
 NIL .0
 ↓ .0
 ↓ .0
 ↓ .0



DRILLED BY Barron Diamond Drilling

SIGNED [Signature]
 L.J. Cunningham, B.Sc., P.Eng.
 Mining

450 ft WEST of #1 Post cl. 227252
 550 ft SOUTH

PROPERTY CANADIAN Mining Corp.
 Sturgeon Lake Property

HOLE NO. 70-1

LOCATION: _____

LATITUDE: _____

DEPARTURE: L 12 E

ELEVATION: 45 + 505

STRIKE: 83° W

DIP: 45° at collar

DATE DRILLED: 19 - 23 March, 1970

PAGE NO. 1

PURPOSE: To test geophysical anomaly

FOOTAGE	DESCRIPTION	SAMPLE NO.	WIDTH	ASSAY VALUE
0 - 37	CASINO			
37 - 200	TUFF dark grey, med. gr. to fine grained - soft - BASIC - cut by qtz-carbonate stringers vugy - leached - rare acid fragment generally massive but with bedded sections of f.g. material 60°/core			
200 - 214	Grades into well bedded light grey TUFF & AGGLOMERATE beds 1"-2" thick - acid fragments in med. gr. groundmass			
214 - 234	GRAPHITIC SLATY TUFF black, thin bedded sheared, siliceous pyrite nodules seams, bands and xls graden into med. grained tuff lighter in colour disseminated pyrite Total ± 3% sulphides occ. acid fragment to 1/4"			Cu - Zn
	214 - 220	30	6'	.003 .001
	220 - 225	31	5'	.002 "
	225 - 230	32	5'	.001 "
	230 - 235	33	5'	.002 "
234 - 255	ALTERNATING BANDS BLACK GRAPHITIC SLATY TUFF and grey medium tuff texture sandstone grading into occ. sections of agglomerate with 1/4 fragment pyrite developed in graphitic tuff as fine seams & blebs ± 2% pyrite little pyrrhotite			
	242 - 247	34	5'	.002 "
	247 - 254	35	7'	.002 "
255 - 266	TUFF grey, medium (sandstone texture) grained massive uniform hard acidic			
266 - 272	AGGLOMERATE dark acidic with light acidic fragments & dark black siliceous fragment scattered pyrite ± 3%			
	266 - 272	36	6'	.002 "
272 - 280	TUFF grey, medium massive as 255-266			
280 - 288	AGGLOMERATE as 266-272 less sulphides ± 1% pyrite & pyrrhotite			
288 - 337	Black siliceous TUFF with few small acid fragments f.g. dense with pyrite & pyrrhotite in nodules, fine seams & blebs ± 3% sulphides contains 20% grey med. gr. tuffs as above			
337 - 339	AGGLOMERATE as 280-288 acidic dark			
339 - 375	Grades into med. grained uniform TUFF acidic grey in colour generally lighter coloured fragment but few black siliceous fragments			
375 - 376	Black graphitic TUFF f.g. dense, hard mineralized pyrite seams, blebs ± 3% sulphides			
376 - 277	Grey TUFF med. gr. as above			
377 - 400	Black graphitic TUFF dense acidic bedded 60-70°/core mineralized with concentric nodular pyrite to 3/4" dia. nodules often accompanied by rings or sections of qtz. pyrite often fractured			Ag Cu - Zn
	377 - 382	37	5'	.01 .002 .01
	382 - 387	38	5'	.01 .007 .01
	387 - 392	39	5'	.01 .003 .01
	392 - 397	40	5'	.01 .002 .01
	397 - 400	41	3'	.003 .01

DRILLED BY Barron Diamond Drilling

SIGNED 
 L. J. Cunningham B.Sc., P. Eng.

PROPERTY CANADIAN

Sturgeon Lake

HOLE No. 70-1

LOCATION: _____

LATITUDE: _____

STRIKE: _____

PAGE No. 2

DEPARTURE: _____

DIP: _____

ELEVATION: _____

DATE DRILLED: 19 - 23 March, 1970

PURPOSE: _____

FOOTAGE	DESCRIPTION	SAMPLE NO.	WIDTH	ASSAY VALUE
400 - 406	AGGLOMERATE acid fragments heavy sulphides pyrite in concentric nodules and heavy sections of 2" massive pyrite fractured usually accompanied by qtz.	42	6"	Cu - 0.05 Zn - 0.01
406 - 408	AGGLOMERATE buff coloured rhyolite fractured			
408 - 440	TUFF dark grey acidic massive fine to med. grained			
440 - 525	AGGLOMERATE dark acidic fragments & matrix both dark 452-460 pyrite & pyrrhotite mineralization \pm 3% sulphides 453 - 460 grading into intermediate agglomerate around 460 to 490 490-525 acidic	43	7"	Cu 0.003 Zn 0.01
525 - 535	AGGLOMERATE dark grey acidic crumpled bedding from parallel to 60° some fracturing qtz. filled pyrrhotite around 530 over 6"			
535 - 666	TUFF DARK GREY MASSIVE f.g. dense intermediate to acid cratches readily some qtz. filled fractures minor agglomerate some narrow sections of agglomerate or flow breccia (possibly volcanic flow)			
666	END OF HOLE			

PATRICIA
 MINING DIV.
RECEIVED
 JUN 17 1971
 AM 7:8-9:10:11:12:1:50 PM

DRILLED BY Barron Diamond Drilling

SIGNED [Signature]
 L. J. Cunningham, B.Sc., P.Eng.

PROPERTY CANADIAN Mining Corp.
 400' south of } 227246 Sturgeon Lake
 LOCATION: 20' west of post #1 } 289960
 HOLE NO. 70-6
 LATITUDE: _____ STRIKE: South PAGE NO. 1
 DEPARTURE: _____ DIP: 50°
 ELEVATION: 12 + 50 E DATE DRILLED: April, 1970
 19 + 50 S
 PURPOSE: To test geophysical anomaly

FOOTAGE	DESCRIPTION	SAMPLE NO.	WIDTH	ASSAY VALUE
0 - 61	CASING			
61 - 100	ACID AGGLOMERATE dark grey sparse acid fragments to 1" dia. scattered small seams of pyrrhotite			
100 - 131	Intermediate TUFF gradational contact to bedded grey to black TUFF - 30°/core minor pyrrhotite and a little calcite grey - acid tuff black - graphitic tuff			
	116-118.5 pyrrhotite in graphitic tuff 5% sulphides fine bands and seams	109	{ 2.5'	ALL Sample
	123-125.5 " " " " "		{ 2.5'	
131 - 145	ACID AGGLOMERATE light grey with pyrite & pyrrhotite in seams, bands & nodules ± 10% sulphides split 130-141	113 114	6' 5.5'	Aq-TR
145 - 160	INTERMEDIATE TUFF grey, banded, - 60°/core minor pyrrhotite at dark graphitic sections			
160 - 208	ACID TUFF grey with few acid fragments Occasional bands of pyrrhotite with pyrite includes few narrow interbedded black graphitic sections 45° - 60°/core containing fine seams pyrite with quartz carbonate stringers 202 - 207	108	5'	Cu-0.07 -0.04
	198-208 Acid Tuff with pyrite & pyrrhotite mineralization in seams & bands & nodules 197-197.5	119	0.59'	2N 0.02 -0.05
208 - 237	ACID AGGLOMERATE numerous fragments small 1/4" - 1/2" acid - light to dark in grey matrix - blebs and seams pyrrhotite			
	227-228.5 - 30-40% sulphides massive nodular pyrite with minor pyrrhotite	117	2.5'	Pb-0.01
237 - 242	GRAPHITIC TUFF black, thin bedded - ± 5% sulphides with thin seams of pyrite & blob of Xline pyrite bedding 50-60°/core		5'	
242 - 260	ACID TUFF with few fragments light grey fine grained			
260 - 380	INTERMEDIATE TO ACID TUFF dark grey, medium grained cut by numerous light grey quartz carbonate ? irregular contorted bands containing spotty magnetite & heavy concentrates of pyrrhotite within which are blebs of pyrite 15 - 20% of core is made of these bands estimated ± 5% sulphides in core			
	Section of core) highly) magnetic)	262 - 265 264 - 266 270 - 274 272-274	259 118 110 112 111 116 115	6" 3' - 4' 2.5' 5' 2.5' 2.0 1.5

DRILLED BY Barron Diamond Drilling

SIGNED L. J. Cunningham, B.Sc., P.Eng.

PROPERTY CANADIAN Mining Corp
Sturgeon Lake

HOLE NO. 70-6

LOCATION: _____

LATITUDE: _____

DEPARTURE: _____

ELEVATION: _____

STRIKE: _____

DIP: _____

DATE DRILLED: April, 1970

PAGE No. 2

PURPOSE: _____

FOOTAGE	DESCRIPTION	SAMPLE NO.	WIDTH	ASSAY VALUE
260 - 380 continued	sulphide content decreasing from 325 on			
380 - 475	GRADATIONAL CHANGE TO BASIC TUFF with dark grey black texture considerable magnetite developed cut by scattered grey bands of qtz-carbonate with magnetite & pyrrhotite as above Bands generally about 60°/core occasional patch pyrrhotite with inclusion of pyrite			
475 - 532	GRADATIONAL CHANGE TO INTERMEDIATE TO BASIC TUFF & AGGLOMERATE dark green with small light coloured sparse fragments bedded 60°/core 517 1 foot Volcanic Breccia 503-509 dark purple, med. grained massive basic tuff			
532	END OF HOLE			



DRILLED BY Barron Diamond Drilling

SIGNED [Signature]
L. J. Cunningham, B.Sc., P.Eng.



52G15NW01 52G15NW0033C1 SIX MILE LAKE

900

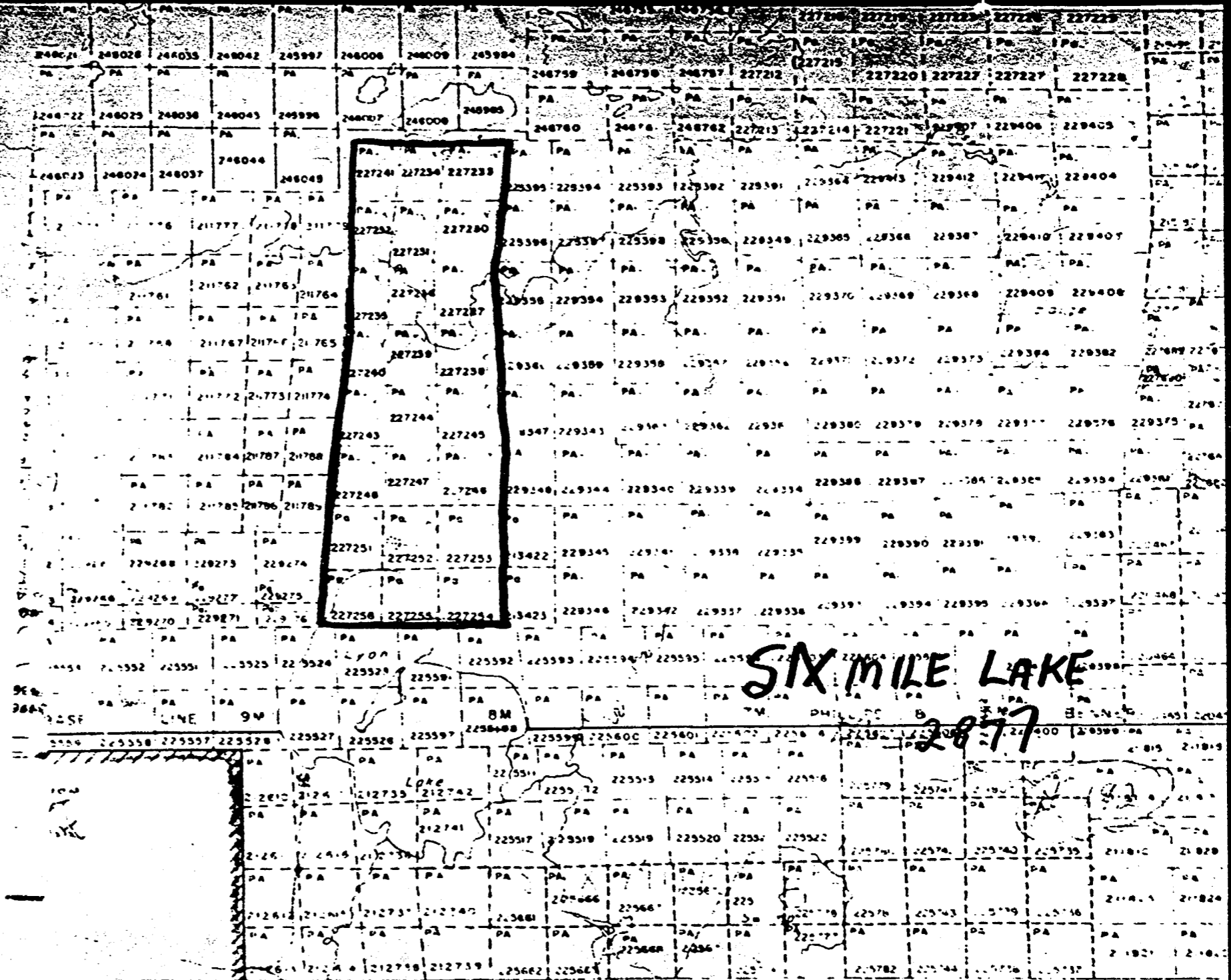

1" = 40 CHAINS

40 CHAINS

SIX MILE LAKE

2877

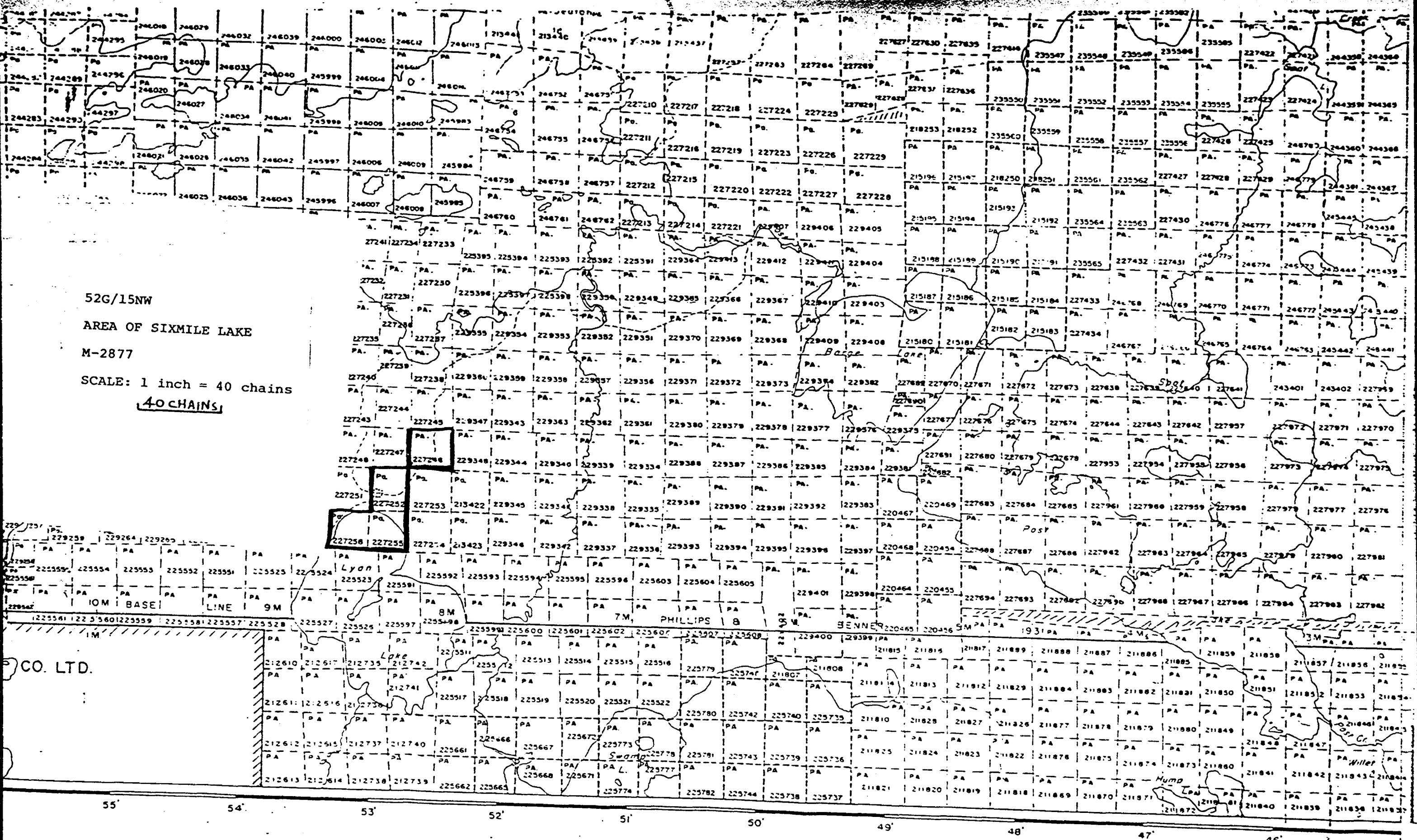

52G/15NW
 AREA OF SIXMILE LAKE
 M-2877
 SCALE: 1 inch = 40 chains
40 CHAINS

CO. LTD.

55' 54' 53' 52' 51' 50' 49' 48' 47' 46'

Tagged

SIX MILE LAKE

M-2877



ONTARIO

THE MINING ACT REPORT OF WORK

A separate form is required for each type of work to be recorded.

#192

To the Recorder of PATRICA Mining Division

I, G. G. PLASKETT name of Recorded Holder

A 22178 Miner's Licence

1501 - 330 Bay St. Toronto Ont. Post Office Address

do hereby report the performance of 2914.5 days of DIAMOND DRILLING type of work

not before reported to be applied on the following contiguous claims

Claim No.	Days	Claim No.	Days	Claim No.	Days
227230	121	227236	121	227243	121
231	121	237	121	244	121
232	121	238	121	245	121
233	121	239	121	246	121
234	121	240	121	247	121
235	121	241	121	248	121

All the work was performed on Mining Claim (s) 227255; 227252; 227243; 227246
(In the case of geological and/or geophysical survey (s) where more than 18 claims are involved attach a schedule)

Claim No.	Days	Claim No.	Days	Claim No.	Days
227251	121				
227252	121				
227253	121				
227254	121				
227255	121				
227256	121				

For Geological and Geophysical Survey - The names and addresses of men employed as well as dates. Type of instrument used in the case of geophysical survey. Reports and maps in duplicate must be filed with the Minister within 60 days of recording.
For Land Survey - the name and address of Ontario Land surveyor.

The Required Information is as Follows: (Attach a list if this space is insufficient)

No. of HOLES - 5
 DATES: 1 MAR 1970 - April 1970
 CORE SIZE - AXT
 LOCATION - CORE ON SHORE OF STURGEON LAKE NEAR #4 POST CLAIM-227245
 CONTRACT - BARRON DIAMOND DRILLING HAILEY BURY ONTARIO
 2 COPIES of DRILL LOGS ATTACHED.
 2 COPIES of LOCATION MAP ATTACHED.
 Date 11 June 1971

DISTRIBUTION / Work

CLAIM 227255	1162.5 FT
227252	666.0
227243	554.0
227246	532.0
TOTAL	2914.5 FT
	2904.0

[Signature]
Signature of Recorded Holder or Agent

The Mining Act Certificate Verifying Report of Work

I, L. J. CUNNINGHAM
1 MCPHEE AVE KIRKLAND LAKE
(Post Office Address)

hereby certify:

- That I have a personal and intimate knowledge of the facts set forth in the report of work annexed hereto, having performed the work or witnessed same during and/or after its completion.
- That the annexed report is true.

Dated 11 June 71

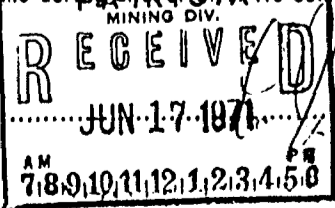

[Signature]
Signature

P

Pg. 227230

THE PENALTY FOR MAKING A FALSE STATEMENT IN THIS REPORT AND/OR FOR IMPRISONMENT OR BOTH