



S2G15NW0149 S2G/15NW35A1 SIXMILE LAKE

010

Diamond Drilling

Area of SIXMILE LAKE

Report NO 39

Work performed by: G.G. Plaskett

Claim NO	Hole NO	Footage	Date	Note
PA 227243	<u>70-5</u>	<u>554.0'</u>	Apr-May/70	
TOTAL	1 DH	554.0 FEET		

Notes:

Drill hole location map for reports #38 and #39 in map-jacket.

LOCATION: L 16 W
 LATITUDE: 26 + 30.8
 DEPARTURE: _____
 ELEVATION: _____

STRIKE: S 25° W
 DIP: _____ = 50°

HOLE NO. 703
 PAGE NO. 1

DATE DRILLED: 28 April - 4 May, 1970
28 APRIL - 4 MAY, 1970

PURPOSE: To test geophysical anomaly

FOOTAGE	DESCRIPTION	SAMPLE NO.	WIDTH	ASSAY VALUE
0 - 170	Overburden			
170 - 186	BASIC TUFF soft, dark grey matrix with numerous small 1/8" - 1/2" light coloured fragments			
186 - 204	BASIC TUFF but becoming very dark, soft, graphitic graphitic - fine grained with interbedded gritty sections as above containing sparse blebs of pyrite and narrow seams of pyrite 1/2" - 1" wide thin bedding in places 50°/core Core is vugy			All samples
		184 - 195	51	Ag - Nil
		199 - 204	52	Cu - Nil
204 - 230	TUFF well bedded 45° - 60° soft grey fine grained silty material interbedded with coarser grey material also soft. Softy - vugy - few pyrite blebs			Zn - Nil
230 - 234	GRAPHITIC MATERIAL black, fine grained, hard blebs pyrite bedded - 60°/core			
234 - 273	TUFF well bedded - 45° - 60° - 80°/core soft - grey varying light to dark Some crumpling of bedding suggesting slumping generally fine grained with occasional coarse bands.	53	4"	ALL SAMPLES
273 - 325	Grades into soft grey massive TUFF with sparse blebs and patches pyrite to 300 feet. Patches, stringers carbonate. Occasional fragments or tuff bomb evident usually acidic			Ag - Nil
325 - 554	Gradational change to goidic TUFF - uniform massive occasional acidic fragment med. grained, includes some intermediate tuff several narrow sections (4" - 6") dark, fine grained bedded tuff - 30°/core fine brown specks developed - carbonate? 450-473 possibly altered intrusive rock 536-537 metasediment interbed 60-70°/core dark grey soft			Cu - Nil Zn - Nil
554	END OF HOLE			

PATRICIA
 MINING DIV.
RECEIVED
 JUN 17 1971
 AM
 718-210-1151

DRILLED BY Barron Diamond Drilling

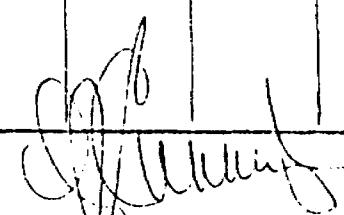
SIGNED 
 L. J. Cunningham, P. Eng., P. Geog.
 Mining Engineer

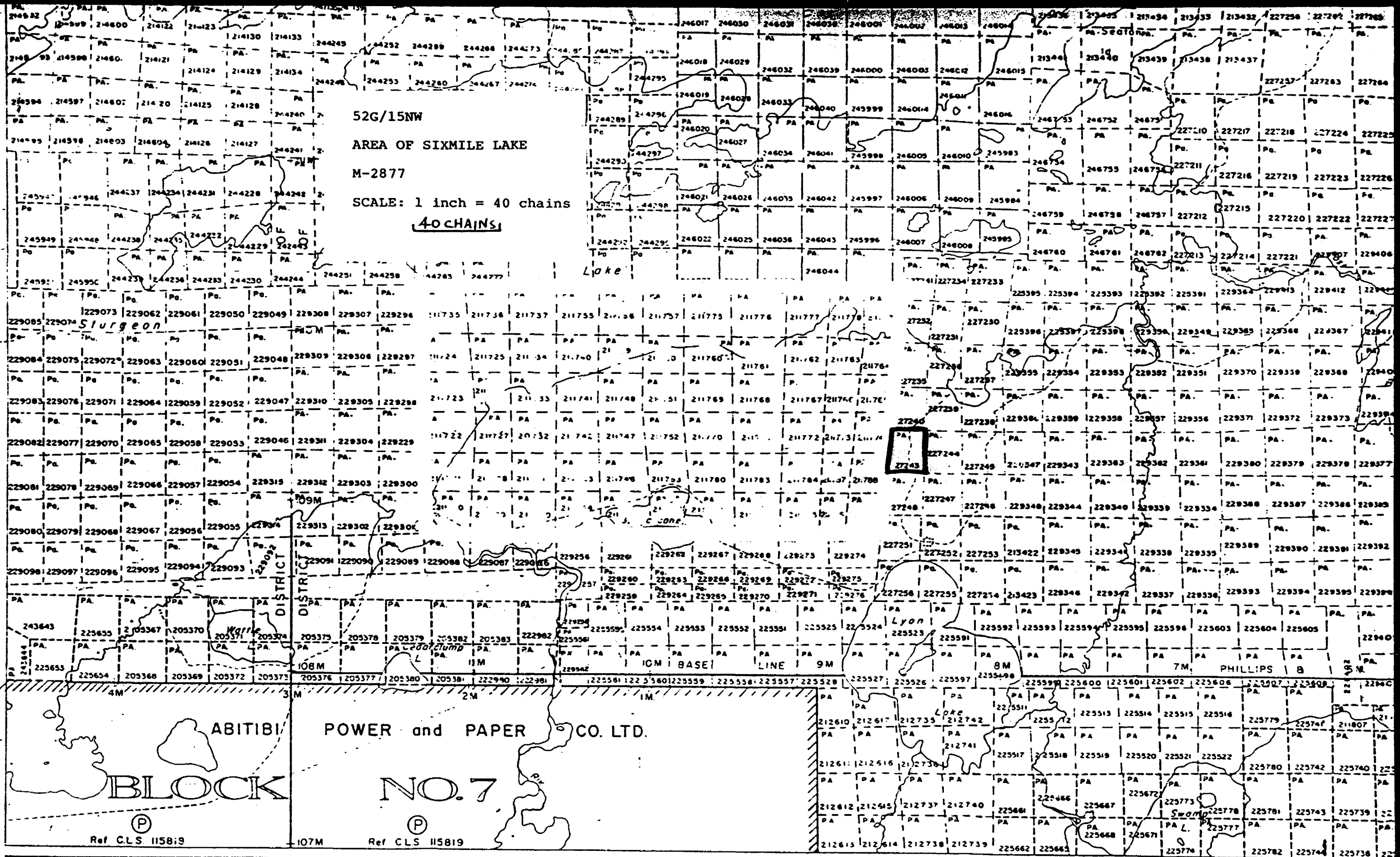

52G/15NW
AREA OF SIXMILE LAKE
M-2877
SCALE: 1 inch = 40 chains
40 CHAINS

BLOCK

NO. 7

Ref. C.L.S. 115819

Ref. C.L.S. 115819

91°00' 59' 58' 57' 56' 55' 54' 53' 52' 51' 50'

SEE ACCOMPANYING
MAP(S) IDENTIFIED AS

52G/15NW-0035-A1 # 1

LOCATED IN THE MAP
CHANNEL IN THE
FOLLOWING SEQUENCE

(X)

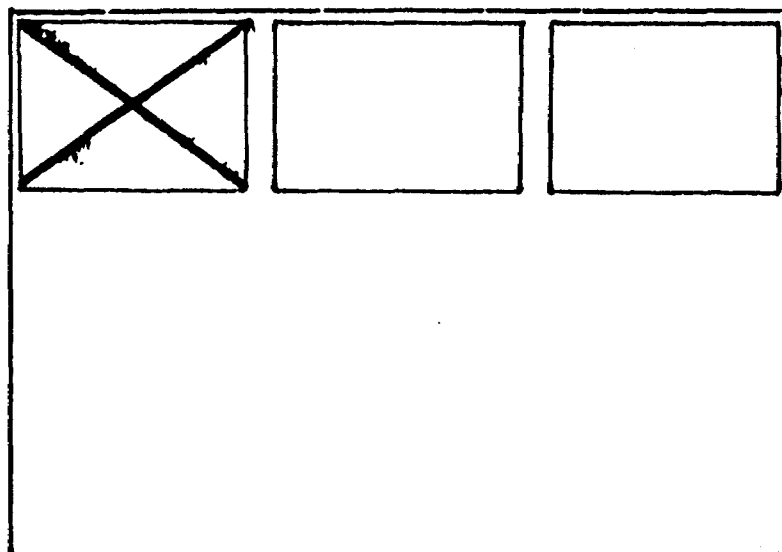

CANADAX MINING CORP.'N
 STURGEON LAKE PROPERTY
 SCALE 1" = 400 FT.
 SHOWING
 EM SURVEY - CRONE SHOOTBACK
 AND
 DRILL HOLES

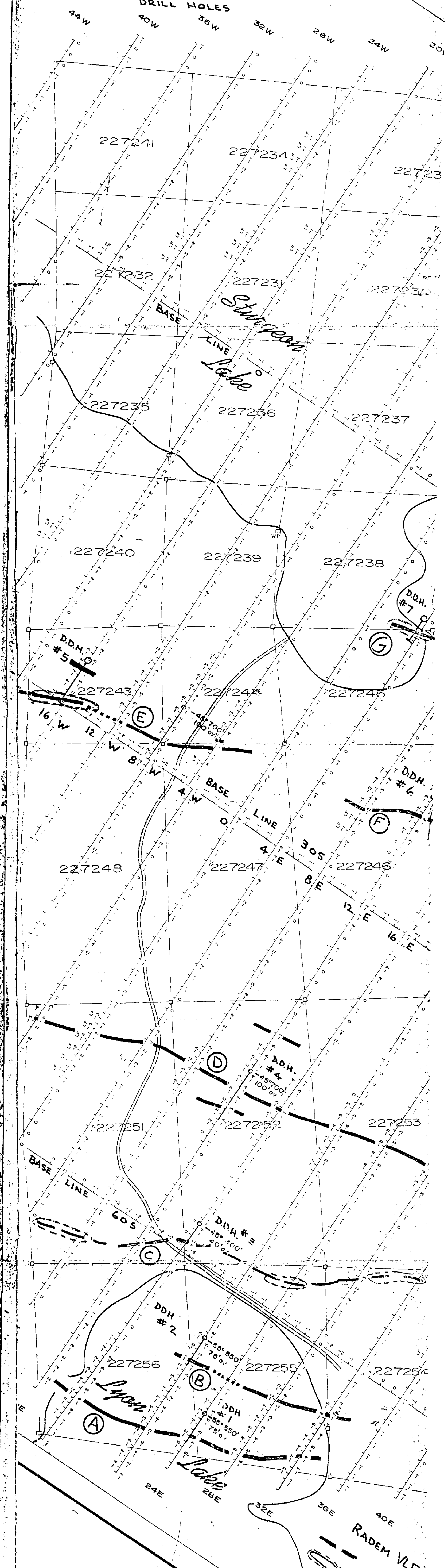

Area of Simile Lake
 DDH report # 39

[Handwritten signatures]
 20 Aug 70

52 G/15NW-0035-A1, #1

