

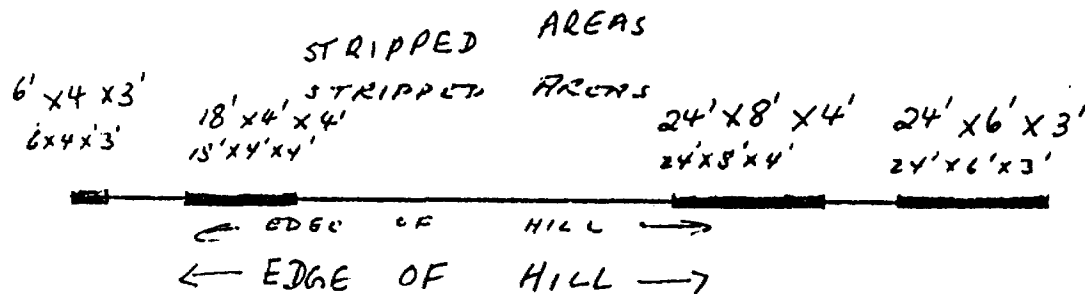

52G15NW9267 52G15NW0078B1 SIXMILE LAKE

010

Pa 704623



PATRICIA MINING DIV.
RECEIVED
 AUG - 6 1935
 A.M. P.M.
 7 8 9 10 11 12 1 2 3 4 5 6

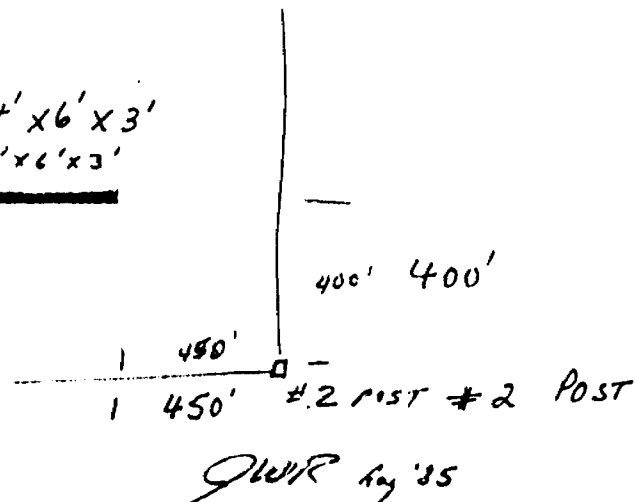

Don Jones



52G15NW9267 52G15NW0078B1 SIXMILE LAKE

900

Sixmile Lake G-2561
85-123



Ministry of
Natural
Resources

Report
of Work

Instructions - Supply required data on a separate form for each
type of work to be recorded (see table below).
- For Geo-technical work use form no. 1362 "Report
of Work (Geological, Geophysical, Geochemical and
Expenditures)".

Mining Act

Name and Postal Address of Recorded Holder J. W. REDDEN	Prospector's Licence No. E23950
Box 117 WABIGOON BAY POV2W0	

Summary of Work Performance and Distribution of Credits

Total Work Days Cr. claimed 20	Mining Claim			Work			Mining Claim			Work		
	Prefix	Number	Days Cr.	Prefix	Number	Days Cr.	Prefix	Number	Days Cr.	Prefix	Number	Days Cr.
for Performance of the following work. (Check one only)	Pc	704623	20									
<input checked="" type="checkbox"/> Manual Work												
<input type="checkbox"/> Shaft Sinking Drifting or other Lateral Work.												
<input type="checkbox"/> Compressed Air, other Power driven or mechanical equip.												
<input type="checkbox"/> Power Stripping												
<input type="checkbox"/> Diamond or other Core drilling												
<input type="checkbox"/> Land Survey												

All the work was performed on Mining Claim(s): **P-704623**

Required Information eg: type of equipment, Names, Addresses, etc. (See Table Below)

H. LUNDMARK
396 RAY BLVD.
THUNDER BAY

W. MCATEER
914 ALBERTA ST.
THUNDER BAY

July 26, 27, 28, 29 } 1984 7:00am - 7:00pm daily
AUG 2 }

Recorded → **PATRICIA MINING DIV.**
RECEIVED
AUG - 6 1985
A.M. P.M.
7 8 9 10 11 12 1 2 3 4 5 6

Pa. 704623

Date of Report **Aug 1 / 85** Recorded Holder or Agent (Signature) *[Signature]*

Certification Verifying Report of Work

I hereby certify that I have a personal and intimate knowledge of the facts set forth in the Report of Work annexed hereto, having performed the work or witnessed same during and/or after its completion and the annexed report is true.

Name and Postal Address of Person Certifying
J. W. REDDEN

Box 117 WABIGOON BAY POV2W0

Date Certified **Aug 1 / 85** Certified by (Signature) *[Signature]*

Table of Information/Attachments Required by the Mining Recorder

Type of Work	Specific Information per type	Other Information (Common to 2 or more types)	Attachments
Manual Work			
Shaft Sinking, Drifting or other Lateral Work	NII	Names and addresses of men who performed manual work /operated equipment, together with dates and hours of employment.	Work Sketch: these are required to show the location and extent of work in relation to the nearest claim post.
Compressed air, other power driven or mechanical equip.	Type of equipment		
Power Stripping	Type of equipment and amount expended. Note: Proof of actual costing. within 30 days of recording.	Names and addresses of owner or operator together with dates when drilling/stripping done.	
Diamond or other core drilling	Signed core log showing; footage, diameter of core, number and angles of holes.		Work Sketch (as above) in duplicate
Land Survey	Name and address of Ontario land surveyor.	NII	NII

M. 2879

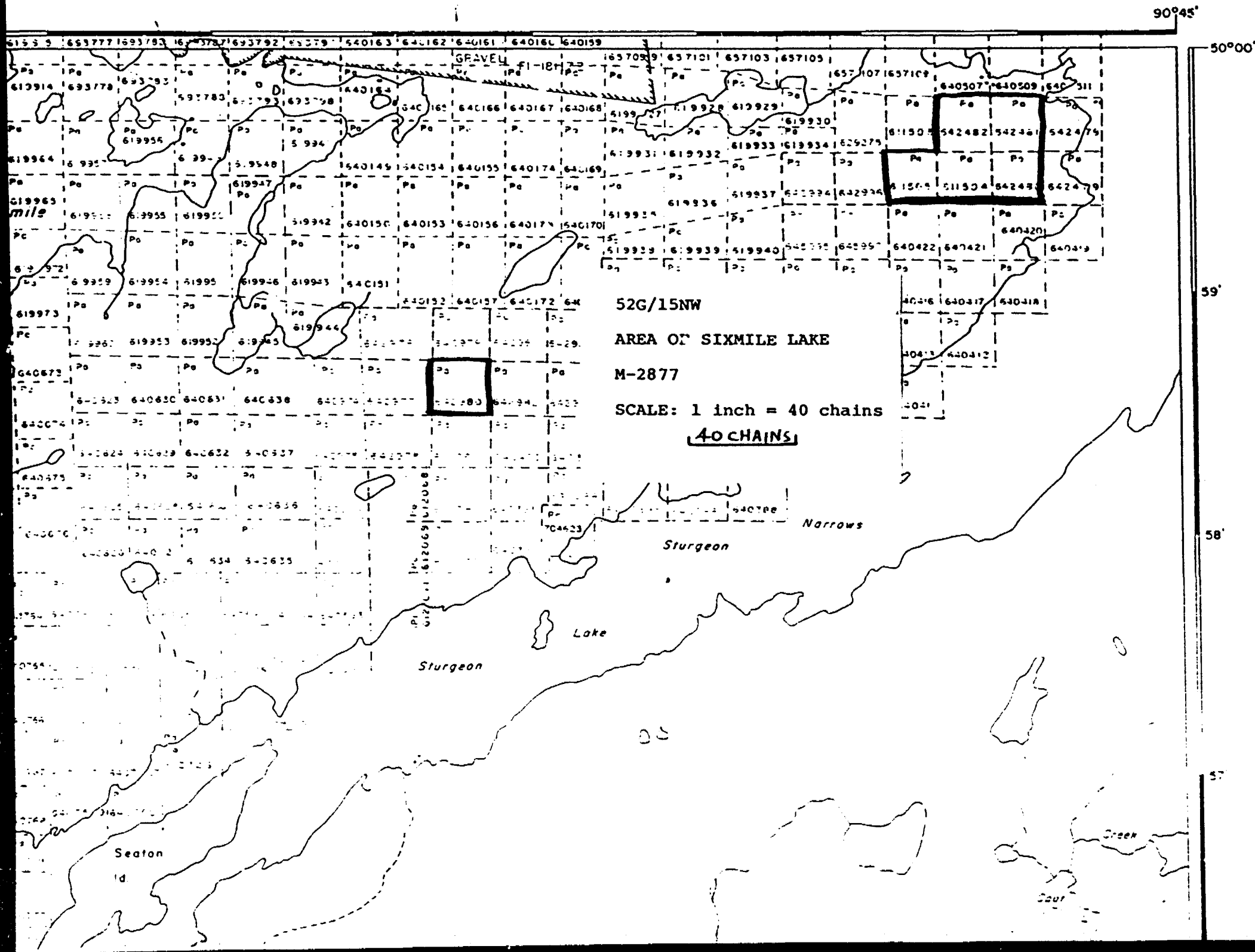

52G/15NW
 AREA OF SIXMILE LAKE
 M-2877
 SCALE: 1 inch = 40 chains
40 CHAINS

AREA OF

SIXMILE LAKE

DISTRICT OF
KENORA · THUNDER BAY

PATRICIA
MINING DIVISION

SCALE: 1-INCH = 40 CHAINS

LEGEND

PATENTED LAND	Ⓟ
CROWN LAND SALE	C.S.
LEASES	Ⓛ
LOCATED LAND	Loc.
LICENSE OF OCCUPATION	L.O.
MINING RIGHTS ONLY	M.R.O.
SURFACE RIGHTS ONLY	S.R.O.
ROADS	—
IMPROVED ROADS	—
KING'S HIGHWAYS	—
RAILWAYS	—
POWER LINES	—
MARSH OR MUSKEG	—
MINES	Ⓧ
CANCELLED	Ⓞ

NOTES

400' surface rights reservation along
 the shores of all lakes and rivers.

reg - M.2875



Name and Postal Address of Recorded Holder J. W. REDDEN	Prospector's Licence No. E 23950
Box 117 WABIGON ONT P0V2W0	

Summary of Work Performance and Distribution of Credits

Total Work Days Cr. claimed 24	Mining Claim		Work Days Cr.	Mining Claim		Work Days Cr.	Mining Claim		Work Days Cr.
	Prefix	Number		Prefix	Number		Prefix	Number	
for Performance of the following work. (Check one only)	Pa	704623	24						
<input type="checkbox"/> Manual Work									
<input type="checkbox"/> Shaft Sinking Drifting or other Lateral Work.									
<input checked="" type="checkbox"/> Compressed Air, other Power driven or mechanical equip.									
<input type="checkbox"/> Power Stripping									
<input type="checkbox"/> Diamond or other Core drilling									
<input type="checkbox"/> Land Survey									

All the work was performed on Mining Claim(s): **Pa 704623**

Required Information eg: type of equipment, Names, Addresses, etc. (See Table Below)

WATER PUMP

H. LUNDHOLM
396 RAY BLVD
THUNDER BAY

W. MONTEER
914 ALBERTA ST
THUNDER BAY

July 30, 31 } 1984
Aug 1

7:00 am - 7:00 pm daily

Recorded →

PATRICIA MINING DIV.
RECEIVED
AUG - 6 1985
A.M. P.M.
7|8|9|10|11|12| 1|2|3|4|5|6

Pa 704623

Date of Report: **Aug 1/85**
Recorded Holder or Agent (Signature): *[Signature]*

Certification Verifying Report of Work

I hereby certify that I have a personal and intimate knowledge of the facts set forth in the Report of Work annexed hereto, having performed the work or witnessed same during and/or after its completion and the annexed report is true.

Name and Postal Address of Person Certifying
J. W. REDDEN

Box 117 WABIGON ONT P0V2W0

Date Certified: **Aug 1/85**
Certified by (Signature): *[Signature]*

Table of Information/Attachments Required by the Mining Recorder

Type of Work	Specific Information per type	Other information (Common to 2 or more types)	Attachments
Manual Work	Nil	Names and addresses of men who performed manual work/operated equipment, together with dates and hours of employment.	Work Sketch: these are required to show the location and extent of work in relation to the nearest claim post.
Shaft Sinking, Drifting or other Lateral Work			
Compressed air, other power driven or mechanical equip.	Type of equipment	Names and addresses of owner or operator together with dates when drilling/stripping done.	Work Sketch (as above) in duplicate
Power Stripping	Type of equipment and amount expended. Note: Proof of actual cost must be submitted within 30 days of recording.		
Diamond or other core drilling	Signed core log showing; footage, diameter of core, number and angles of holes.	Nil	Nil
Land Survey	Name and address of Ontario land surveyor.		