

Dempster



52108NW0012 10 CRESCENT LAKE

010

AREA OF CRESCENT LAKE REPORT NO. 10

This file contains work performed by Dempster Expl. Ltd. on claims:

KK.16850	Hole # 23	June/58
	24	June/58
	31	June-July/60
KK.17086	Hole # 25	June/59
	26	June/59
	27	June/59
	28	June/59
	29	June/59
KK.16848	Hole # P-2	May/58
	P-3	May/58
KK.16851	Hole # P-4	May-June/58
	P-5	June/58
KK.17082	Hole # 6	July/58
	7	July/58
	8	July/58
KK.17087	Hole # 9	July-Aug/58
	10	Aug/58

DIAMOND DRILL RECORD

4-2-44

PROPERTY Dempster Explorations Ltd.

HOLE NO. 23

SHEET NUMBER 4

SECTION FROM 0 TO 40'

STARTED June 26/58

LATITUDE On base line @ 1100'E

DATUM _____

COMPLETED June 30/58

DEPARTURE & 170'S 14°E Claim

BEARING S14°E

ULTIMATE DEPTH 40'

ELEVATION KK16850 as on plan

DIP 45°

PROPOSED DEPTH _____

DEPTH FEET	FORMATION	SAMPLE NO.	WIDTH OF SAMPLE	GOLD \$	SLUDGE GOLD \$
0 - 38.4	Silicious Banded tuffs @ 50° to core				
38.4 - 40'	Pegmati to some altered spodumene, fine grained felspar, border zone material, green muscovite.				
40	End of hole				
	Drilled by packsack 7/8 core				

N.M.P., TORONTO-STOCK FORM NO. 501 REV. 12/51

DRILLED BY Lloyd Dempster & John Mattson

SIGNED Rorne Dempster

DIAMOND DRILL RECORD

PROPERTY Dempster Explorations Ltd. HOLE NO. 24

SHEET NUMBER 4 SECTION FROM 0 TO 50' STARTED July 1/58
 LATITUDE On base line @ 1100' E DATUM _____ COMPLETED July 6/58
 DEPARTURE & 170'S 14°E Claim BEARING S 14 E ULTIMATE DEPTH 50'
 ELEVATION KK16850 as on plan DIP 45° PROPOSED DEPTH _____

DEPTH FEET	FORMATION	SAMPLE No.	WIDTH OF SAMPLE	GOLD \$	SLUDGE GOLD \$		
0 - 8.6	Hornblend gneiss						
8.6 - 50	Albite-microcline granite						
50	End of hole						
	Drilled by Packsack 7/8 core						

N.M.P. TORONTO—STOCK FORM NO. 501 REV. 12/51

DRILLED BY Lloyd Dempster & John Mattson

SIGNED Lorne Dempster

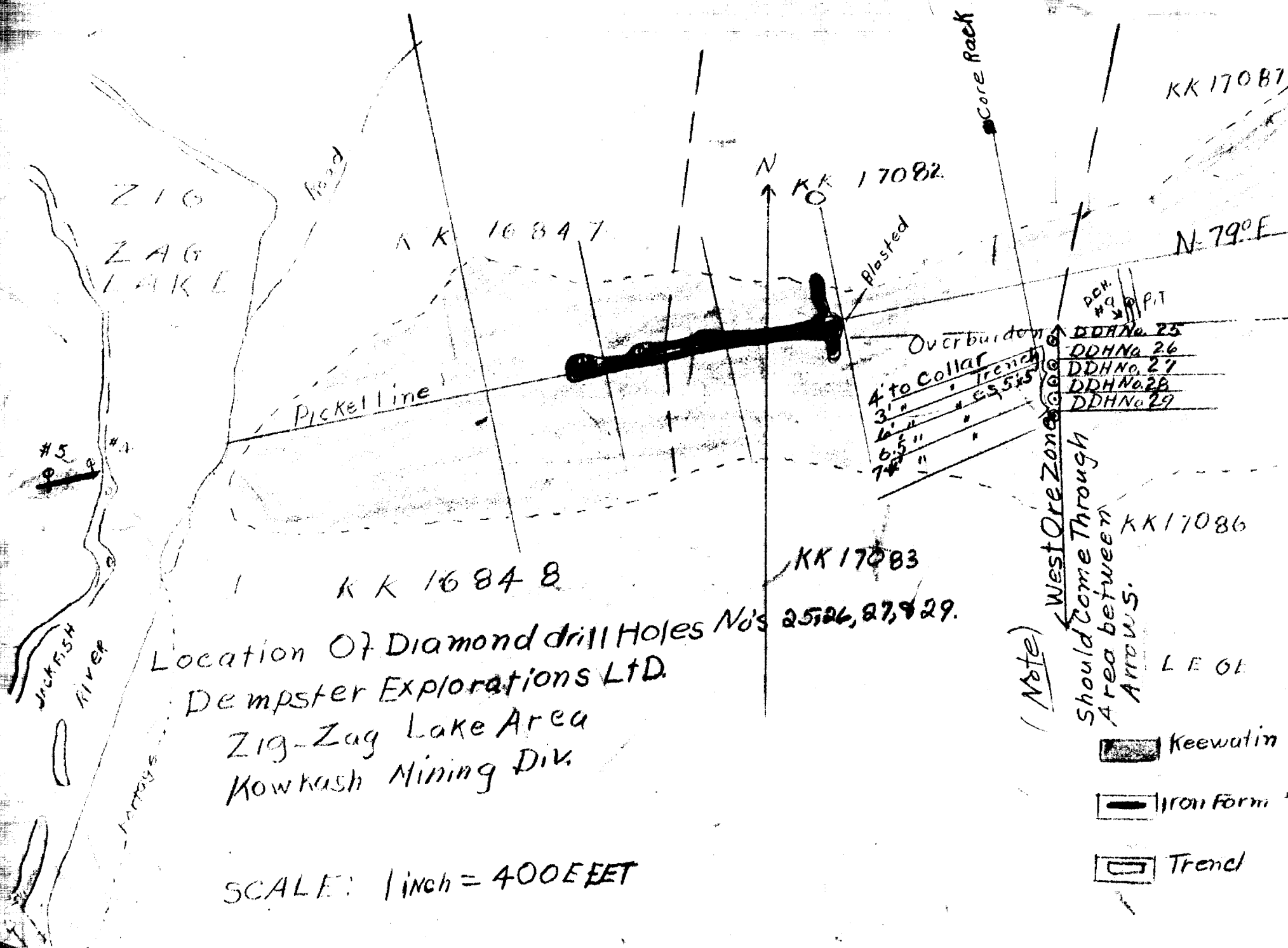

Location Of Diamond drill Holes No's 25, 26, 27, 28, 29.
 Dempster Explorations Ltd.
 Zig-Zag Lake Area
 Kowkash Mining Div.

SCALE: 1 inch = 400 FEET

(Note)

West Ore Zone
 Should Come Through
 Area between
 Arrows.

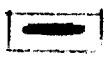
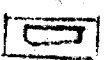
-  Keewatin
-  Iron Form
-  Trench

LEG

DIAMOND DRILL RECORD

PROPERTY Dempster Explorations Ltd. HOLE NO. 27

SHEET NUMBER 5 SECTION FROM 0 TO 70' STARTED June 10/59
 LATITUDE S. (Mag) 142' From No. 4 DATUM _____ COMPLETED June 11/59
 DEPARTURE Post C1. KK17086 & BEARING 180° ULTIMATE DEPTH 70'
 ELEVATION No. 1 Post C1. KK17083 DIP 45° PROPOSED DEPTH _____

DEPTH FEET	FORMATION	SAMPLE NO.	WIDTH OF SAMPLE	GOLD g	SLUDGE GOLD g
0 - 26.5'	Probably Amphibolite				
26.5' - 40'	Amphibolite to 1' of Barren Peg - Matite, Quartz, Felspar, Biotite Mica & some 4" of granitic rock.	A+30 ft.			
40' - 70'	Gneissic looking Amphibolite. Note Maybe Close to Granite Contact.				
70'	End of Hole				
Drilled By Packsack 7/8 Core					

N.M.P., TORONTO-STOCK FORM NO. 501 REV. 12/51

DRILLED BY Ployd Dempster & Frank Ames SIGNED Lorne Dempster

DIAMOND DRILL RECORD

PROPERTY Dempster Explorations HOLE NO. 28

SHEET NUMBER 5 SECTION FROM 0 TO 70' STARTED June 12/59
 LATITUDE South (Mag.) 192' From DATUM _____ COMPLETED June 14/59
 DEPARTURE No 4 Post Cl. KK17086 + BEARING 180° ULTIMATE DEPTH 70'
 ELEVATION No 1, Post Cl. KK17083. DIP 45° PROPOSED DEPTH _____

DEPTH FEET	FORMATION	SAMPLE NO.	WIDTH OF SAMPLE	GOLD \$	SLUDGE GOLD \$
0 - 70' 70'	Very Basic Amphibolite, Massive End Of Hole				
	Drilled By Packsach 7/8 Core				

N.M.P., TORONTO-STOCK FORM NO. 501 REV. 12/51

DRILLED BY Lloyd Dempster & Frank Ames

SIGNED Lorne Dempster

DIAMOND DRILL RECORD

PROPERTY Dempster Explorations Ltd. HOLE NO. 29

SHEET NUMBER 5 SECTION FROM 0 TO 70' STARTED June 15/59
 LATITUDE South (Mag.) 242' From DATUM _____ COMPLETED June 18/59
 DEPARTURE No. A Post C.I. KK17086+ BEARING 180° ULTIMATE DEPTH 70'
 ELEVATION No. 1 Post C.I. KK17083. DIP 45 PROPOSED DEPTH _____

DEPTH FEET	FORMATION	SAMPLE NO.	WIDTH OF SAMPLE	GOLD \$	SLUDGE GOLD \$		
<u>0-29.5'</u>	<u>Dark Amphibolite</u>						
<u>29.5-42'</u>	<u>Sediments lost 5 ft. of core from 29.5 to 27.5 slightly sheared at 42' 80° to core.</u>						
<u>42-70'</u>	<u>Dark Gneissic looking bedded rock.</u>						
<u>70'</u>	<u>End of Hole</u>						
	<u>Drilled By Packsack 7/8 Core</u>						

N.M.P., TORONTO-STOCK FORM NO. 501 REV. 12/51

DRILLED BY Lloyd Dempster + Frank Ames SIGNED Lorne Dempster

NORTH MAGNETIC

BASE

LINE

M 76° E Mag.

Mixed bush up to 12" diam.

Location of Diamond Holes No's 30 & 31
Dempster Explorations Ltd.
Zig-zag Lake Area, Kowkash Mining Div.

KK16851

KK 16850

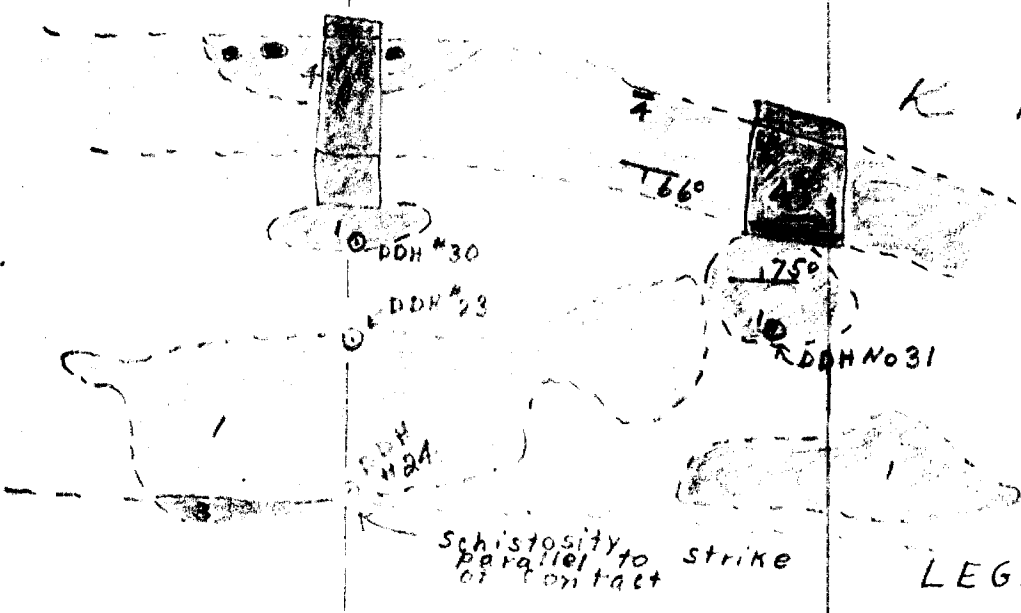

LEGEND

- Lithium bearing pegmatite
- Albite-microcline granite
- Schistose basic volcanics

Scale 40' = 1 inch

DIAMOND DRILL RECORD

8-1-50

PROPERTY Dempster Explorations Ltd. HOLE NO. 31

SHEET NUMBER 6 SECTION FROM 0 TO 61' STARTED June 27/60
LATITUDE At Base line at 1200E DATUM _____ COMPLETED July 2/60
DEPARTURE 166'S 14°E & 10'N 76°W BEARING N 14° W ULTIMATE DEPTH 61'
ELEVATION _____ DIP 45° PROPOSED DEPTH _____

DEPTH FEET	FORMATION	SAMPLE NO.	WIDTH OF SAMPLE	GOLD g	SLUDGE GOLD g		
0 - 20'	Dark Sediments 66° to Core. 4" Pegmatite.						
20 - 40.6'	Barren Pegmatite Felspar Dark Quartz, Biotite, & Green Mica.						
40.6 - 61	Dark sediments.						
61'	End Of Hole						
	Drilled By Paksack 7/8 Core						

DRILLED BY Lloyd Dempster & Frank Ames.SIGNED Lorne Dempster

Zig-Zag Lake

Hydro

Boad

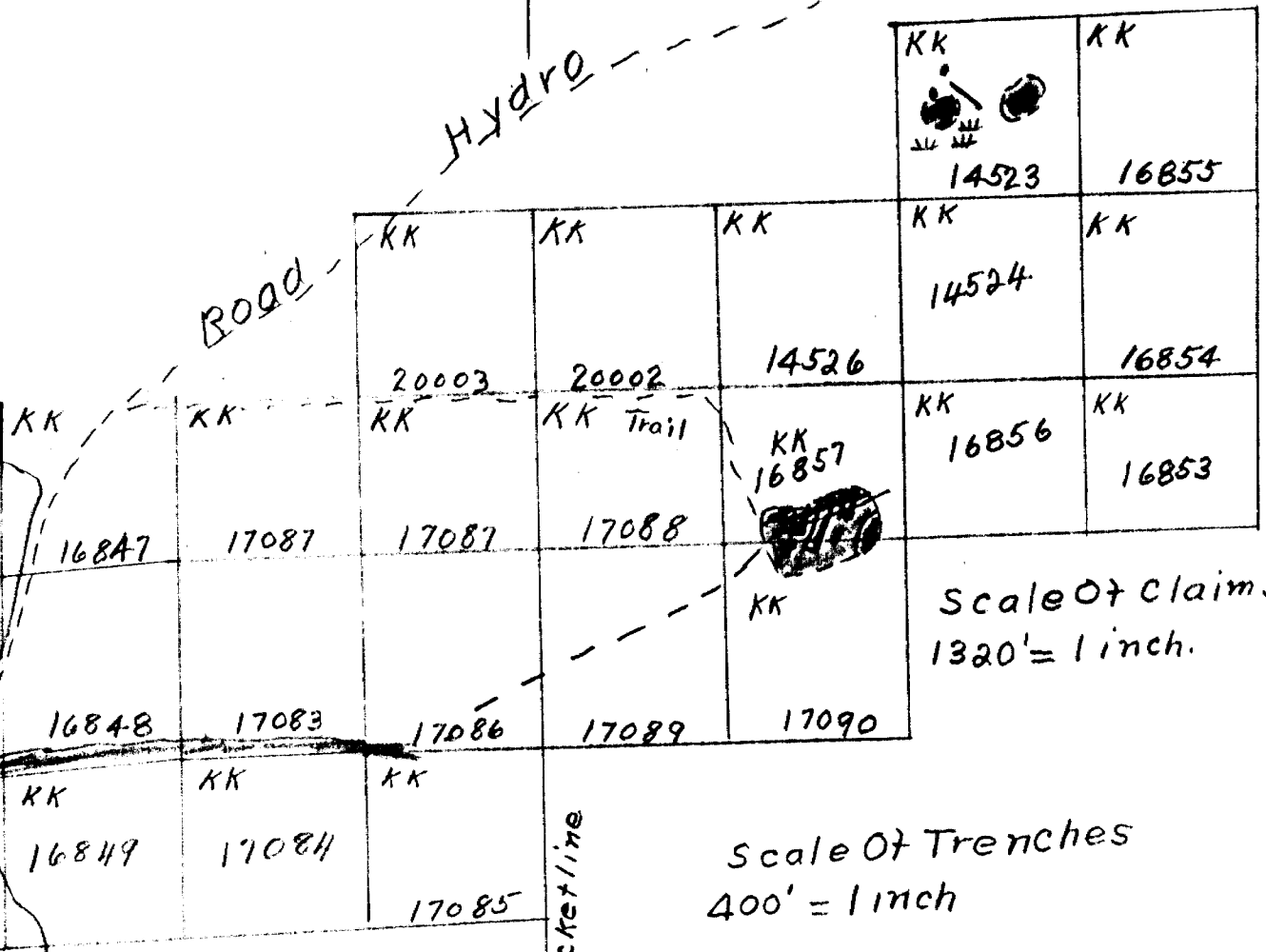

Scale of Claims
1320' = 1 inch.

Scale of Trenches
400' = 1 inch



Low ground.

Line
N 80° E.



Picket

Picketline

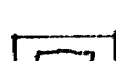
Legend

-  Granite
-  Pegmatite
-  Keewatin
-  Trenches

LEGEND

-  Schistose basic volcanics
-  Iron formation

ZIG
ZAG
LAKE

Road

K.K. 16847

N

#5 #4

#3 #2
Fe.
Iron
Formation

K.K. 16846

K.K. 16848

LITTLE JACKFISH RIVER

Porpoise

Location Of Diamond drill Holes Nos. 2,3,4,5.
 Dempster Explorations Ltd.
 Zig-Zag Lake Area
 Kowkash Mining Dist

SCALE: 1 INCH = 400 FEET

BASE

LINE

N. 76° E Mag.

Mixed bush up to
12" diam.

K. K. 16851

Lower ground

Claim Line

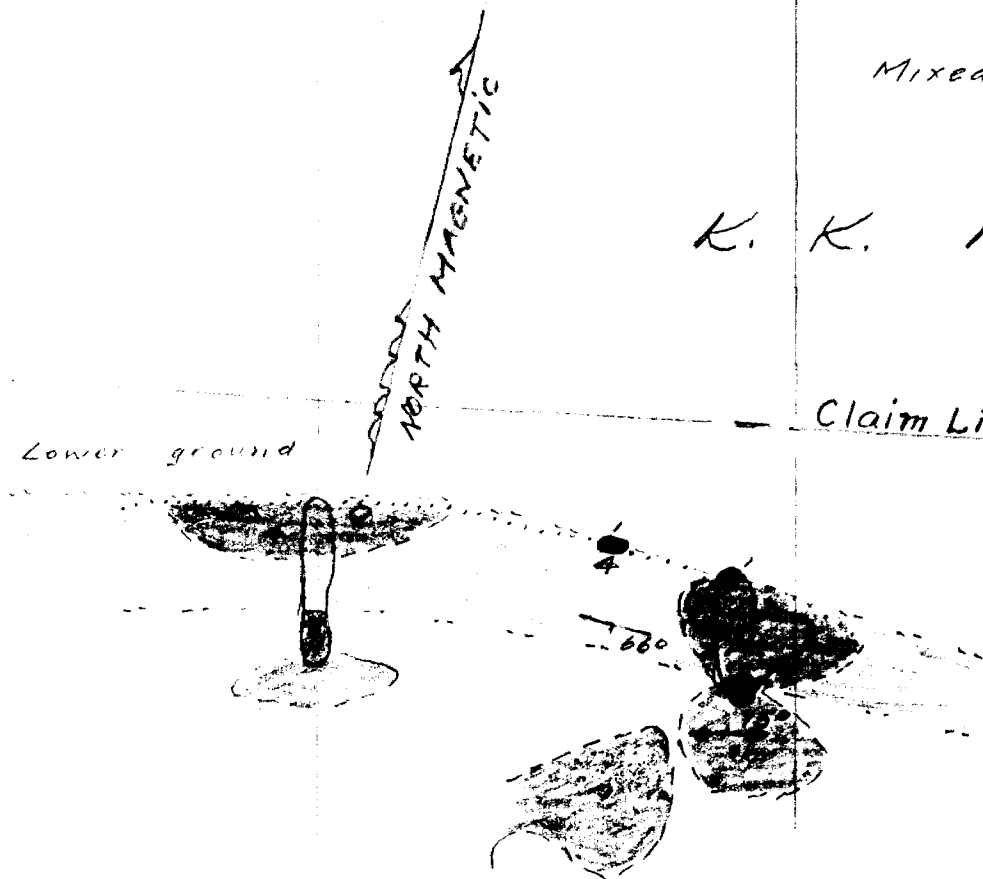

K. K. 16850

SECTION Showing Trenches East

Of Main Showing, Dempster Explorations Ltd.

ZIG ZAG LAKE AREA - KOWKASH MINING DIV. - DNT

SCALE: 1 INCH = 40 FEET

DIAMOND DRILL RECORD

8-2-51

PROPERTY DEMPESTER EXPLORATIONS LIMITED

HOLE NO. P.2

SHEET NUMBER 1

SECTION FROM 0 TO 43

STARTED May 24/58

LATITUDE 50' West of No.1 Post of claim KKL6848 along claim line.

DATUM 50'

COMPLETED May 27/58

BEARING 180°

ULTIMATE DEPTH 43'

ELEVATION _____

DIP 45°

PROPOSED DEPTH _____

DEPTH FEET	FORMATION	SAMPLE NO.	WIDTH OF SAMPLE	GOLD \$	SLUDGE GOLD \$
0 - 20	Sediments or bedded volcanic tuffs with biotite and hornblend bedding 75° to core minor blebs of pyrite.				
20 - 26.7	Iron formation bands richer in magnetite alternating with silica rich bands scattered pyrite. 2" seam with minor chalcopryite and sphalerite at 22.1'				
26.7 - 43	Sediments				
43	END OF HOLE				
	Drilled with packsack 7/8 core				
	<i>Low is stated in the property</i>				

DRILLED BY Lloyd Dempster & G. Mattison

SIGNED Lloyd Dempster

DIAMOND DRILL RECORD

PROPERTY _____

HOLE NO. P. 3

SHEET NUMBER 1 SECTION FROM 0 TO 58 STARTED May 27/58
LATITUDE 250 Wes t of No. 1 post of claim KK16848 along claim DATUM _____ COMPLETED May 29/58
DEPARTURE line BEARING 180° ULTIMATE DEPTH 58
ELEVATION _____ DIP 60° PROPOSED DEPTH _____

DEPTH FEET	FORMATION	SAMPLE No.	WIDTH OF SAMPLE	GOLD \$	SLUDGE GOLD \$				
0 - 48	Sediments or bedded volcanic tuffs with biotite and hor nblend bedding 48° to core								
48 - 57.1	Iron formation bands richer in magnetite alternating with silica rich bands minor pyrite.								
57.1 - 58	Sediments								
58	END OF HOLE								
	Drilled with packsack 7/8 core								

Core is stored at site property

DRILLED BY *Phaed Dempster & J. Matterson*SIGNED *Phaed Dempster*

DIAMOND DRILL RECORD

8-2-52

PROPERTY _____ HOLE NO. P. 4

SHEET NUMBER _____ SECTION FROM 1 TO 01 STARTED May 30/58

LATITUDE 30' West of shore of Zig Zag Lake north of little island DATUM _____ COMPLETED June 1/58

DEPARTURE in claim KK10851 BEARING 180° ULTIMATE DEPTH 61

ELEVATION _____ DIP 00° PROPOSED DEPTH _____

DEPTH FEET	FORMATION	SAMPLE No.	WIDTH OF SAMPLE	GOLD \$	SLUDGE GOLD \$
0 - 47.5	Sediments or bedded volcanic tuffs slightly metamorphosed with biotite and hornblend bedding 47° to core				
47.5 - 53.0	Iron formation bands richer in magnetite alternating with silica rich bands minor pyrite				
53.0 - 01	Sediments				
01	END OF HOLE				
Drilled with Packsack 7/8 core					
<p><i>Core is stored in site property</i></p>					

N.M.P., TORONTO-STOCK FORM NO. 501 REV. 12/51

DRILLED BY Lloyd Dempster & G. Mattieion

SIGNED Lorne Dempster

DIAMOND DRILL RECORD

PROPERTY _____

HOLE NO. P. 5

SHEET NUMBER _____

SECTION FROM 1 TO 64

STARTED June 1/58

LATITUDE 100' West of No. 4 hole

DATUM _____

COMPLETED June 3/58

DEPARTURE _____

BEARING 180°

ULTIMATE DEPTH 64

ELEVATION _____

DIP 61 45°

PROPOSED DEPTH _____

DEPTH FEET	FORMATION	SAMPLE NO.	WIDTH OF SAMPLE	GOLD %	SLUDGE GOLD %
0 - 24	Sediments metamorphosed bedded 60° to core				
24 - 31	Iron formation lean magnetite rich bands				
31 - 64	Sediments				
64	END OF HOLE				

Drilled with Packsack 7/8 core:

Core is stored in the property

DRILLED BY Lloyd Dempster & Mattison

SIGNED Lloyd Dempster

DIAMOND DRILL RECORD

PROPERTY DEMPESTER EXPLORATIONS LTD.

HOLE NO. 7

SHEET NUMBER 1

SECTION FROM 0 TO 70'

STARTED July 14/58

LATITUDE 530' East of No. 3 Post Claim DATUM _____

COMPLETED July 21/58

DEPARTURE KK17082 on picket line

BEARING 158°

ULTIMATE DEPTH 75'

ELEVATION _____

DIP 60°

PROPOSED DEPTH _____

DEPTH FEET	FORMATION	SAMPLE NO.	WIDTH OF SAMPLE	GOLD \$	SLUDGE GOLD \$
0 - 26	Dark Sediments with biotite and hornblend bedding 65° to core.				
26.8 - 62	Iron formation, bands richer in Magnetite alternating with silica rich bands scattered pyrite & chalcocite, possibly some zinc blende				
62.8 - 75	soft altered sediments.				
75	End of Hole				
	Drilled with Packsack 7/8 core				

DIAMOND DRILL RECORD

8-3-40

PROPERTY DEMPSTER EXPLORATIONS LTD.

HOLE NO. 6

SHEET NUMBER 1

SECTION FROM 0 TO 70'

STARTED July 6/58

LATITUDE 130° east of No. 3 Post of claim
KK17082, on picket line.

COMPLETED July 13/58

DEPARTURE _____

BEARING 168°

ULTIMATE DEPTH 70'

ELEVATION _____

DIP 45°

PROPOSED DEPTH _____

DEPTH FEET	FORMATION	SAMPLE NO.	WIDTH OF SAMPLE	GOLD \$	SLUDGE GOLD \$
0 - 25.6	Sediments				
25.6 - 58.4	Very lean Iron formation, with silica rich bands, scattered pyrite, one 3" seam of heavy pyrite and scattered chalcopyrite very little magnetite.				
58.4 - 70	Dark bedded sediments 70° to core				
xxx					
70	End of Hole				
	Drilled with Packsack 7/8 core				

P. TORONTO-STOCK FORM NO. 501 REV. 12/51

DRILLED BY Lloyd Dempster & J. Mattson

SIGNED Lorne Dempster

DIAMOND DRILL RECORD

PROPERTY DEMPSTER EXPLORATIONS LTD. HOLE NO. 8

SHEET NUMBER 1 SECTION FROM 0 TO 56 STARTED July 22/58
 LATITUDE 270' East of No.3 Post of DATUM _____ COMPLETED July 29/58
 DEPARTURE Claim KK17082 on BEARING 168° ULTIMATE DEPTH 56'
 ELEVATION Picket Line. DIP 45° PROPOSED DEPTH _____

DEPTH FEET	FORMATION	SAMPLE No.	WIDTH OF SAMPLE	GOLD \$	SLUDGE GOLD \$
0 - 12	Dark bedded sediments Minor pyrite				
12 - 51.6	Very lean Iron Formation wider bands of silica mostly sugary quartz with scattered pyrite and Chalcopyrite some Magnetite, 4 inch seam of massive pyrite on Footwall.				
51.6 - 56	Sediments				
56	End of Hole				

Drilled with Packsack 7/8 core.

DIAMOND DRILL RECORD

8-2-41

PROPERTY DEMPSTER EXPLORATIONS LTD.

HOLE NO. 9

SHEET NUMBER 1

SECTION FROM 0 TO 54'

STARTED July 30/58

LATITUDE N88°E 250' of No 3 Post
of Claim KK17087 &
DEPARTURE 50' N12°W. on Claim

DATUM _____

COMPLETED Aug. 7/58

BEARING 168°

ULTIMATE DEPTH 54

ELEVATION Line.

DIP 45

PROPOSED DEPTH _____

DEPTH FEET	FORMATION	SAMPLE NO.	WIDTH OF SAMPLE	GOLD \$	SLUDGE GOLD \$
0 - 11	Dark bedded Sediments				
11 - 48.4	Dark slightly schisted Rock alternating with silica rich bands scattered pyrite this part of the zone looks more like a fahlband, only very little Magnetite				
48.4 - 54	Sediments				
54	End of Hole				
	Drilled with Paeksak 7/8 core				

M.P. TORONTO-STOCK FORM NO. 501 REV. 12/51

DRILLED BY Lloyd Dempster & J. Mattson

SIGNED Lorne Dempster

DIAMOND DRILL RECORD

PROPERTY DEMPSTER EXPLORATIONS LTD.

HOLE NO. 10

SHEET NUMBER

1

SECTION FROM

0

TO 60'

STARTED Aug. 8/58

LATITUDE

N88° E. 710' of No. 3 Post Cl.

DATUM

COMPLETED Aug. 15/58

DEPARTURE

KK17087- & 150' N. 12° W. on

BEARING

168°

ULTIMATE DEPTH 60'

ELEVATION

Claim Line

DIP

50°

PROPOSED DEPTH

DEPTH FEET	FORMATION	SAMPLE NO.	WIDTH OF SAMPLE	GOLD \$	SLUDGE GOLD \$
0 - 28.5	Dark bedded Sediments, more biotite & hornblend than in Hole 9.				
28.5 - 55.4	Very lean Iron Formation Material some Magnetite More lean Silica bands, scattered pyrite.				
55.4 - 60	Sediments or bedded tuffs with biotite and hornblend bedding 65° to core				

DRILLED BY Lloyd Dempster & John Mattson

SIGNED Lorne Dempster