

15 pages

2.4934

sherritt

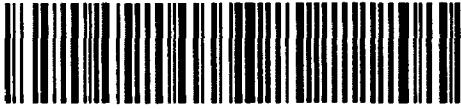

52J02NE0047 52J02NE0036B1 BECKINGTON LAKE

010

RECEIVED

JUL 14 1982

MINING LANDS SECTION

REPORT ON GEOLOGICAL SURVEY
DAVIDSON-CARR CLAIM GROUP
STURGEON LAKE AREA

November 20, 1981

Lynn I. Kelley

SHERRITT GORDON MINES LIMITED

THE DAVIDSON-CARR PROSPECT

Project Number 1256

N.T.S. 52J/2NE M-1740

Beckington Lake Area

LOCATION MAP

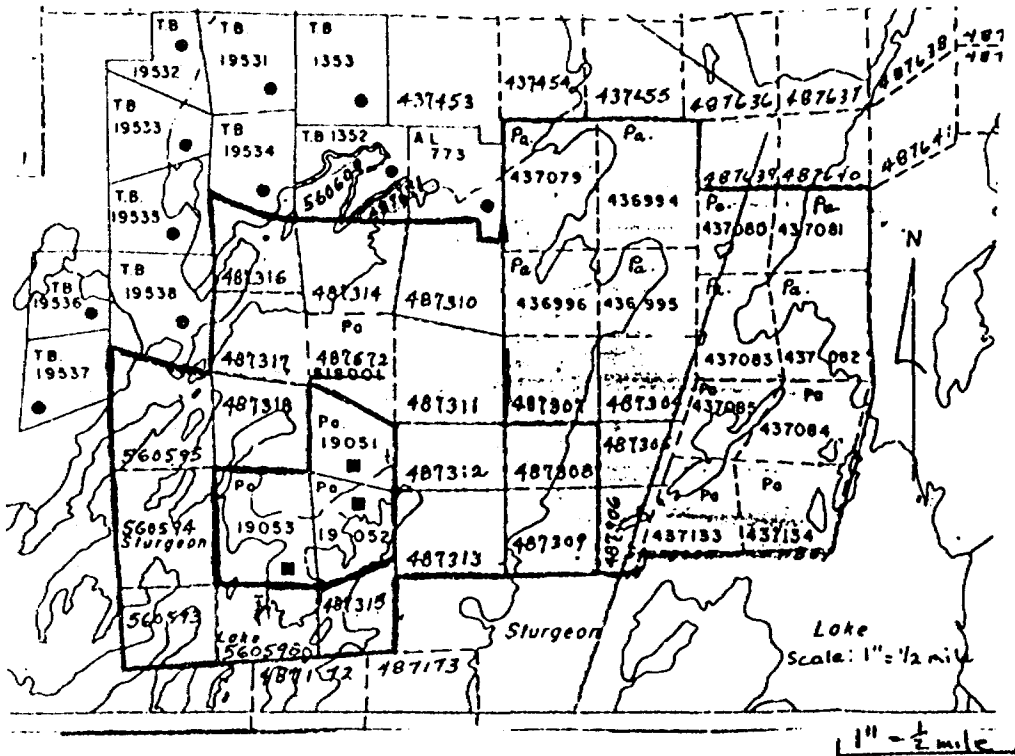

□ Davidson-Carr Project

SHERRITT GORDON MINES LIMITED

TABLE OF CONTENTS

TOPIC	PAGE
LOCATION MAP	
I INTRODUCTION	1
II ACCESS	1
III OWNERS	1
IV HISTORY	1
V PRESENT WORK	2
VI GEOLOGY	3
VII LITHOLOGIES	4
VIII GOLD OCCURRENCES	5
A - Davidson-Carr	
B - Powell Occurrence	
IX RECOMMENDATIONS	7



010C

SHERRITT GORDON MINES LIMITED

APPENDICES

APPENDIX "A" - Table of Assay Locations

APPENDIX "B" - Qualifications of author

MAPS

1 - Geology Map

1" = 200'

I INTRODUCTION

The Davidson-Carr claims group consists of 34 contiguous claims (437070-437085 inclusive; 436994-436996 inclusive; 487671; 487672; 560593-560595 inclusive; 560598 and 560609). The claims group is located on the Northeast Arm of Sturgeon Lake.

II ACCESS

The property can be reached by water via Angler's Cove Campground near the town of Savant Lake. A winter road, which runs between the Richelieu Property and a Great Lakes Pulp and Paper road to the north would provide access with some improvements. There are very few standing trees on the part of the property on the west side of the Northeast Arm. Tornadoes went through the area several years ago and blew down nearly all of the trees. The portion of the property east of the Northeast Arm is covered with standing trees, with heavy brush in some parts.

III OWNERS

The property is presently held under option from Stan Johnson of Sioux Lookout, Ontario.

IV HISTORY

The property includes two abandoned gold prospects, The Davidson-Carr in the northeast corner of the

property, and the Powell, directly across the lake from the Davidson-Carr. Gold has been found in quartz veins in both of these localities, but due to overburden and tailings, rock piles, etc., it is difficult to determine the lateral extent of the veins or vein systems. Visible gold is found at three other locations on the property. Gold occurs in quartz veins at the northeast and southwest tips of the island south of the Davidson-Carr Occurrence, and in lenses of quartz in a chlorite schist north of the Richelieu Property, which consists of three mining leases in the center of the Sherritt optioned property. Several other mineralized quartz veins were encountered during mapping and were sampled for assay. All gold-bearing structures have a northeast strike, but as stated above it is difficult to determine their extent. They may be lenticular.

V PRESENT WORK

The present work was carried on by the author from September 25 to October 21, 1981. The work involved geological mapping, prospecting and sampling of the above claim group at a scale of 1" to 200'. Grid control over the claim group had previously been established. Base lines were cut at 2,000' intervals in a north-south direction; crosslines were established at 90° to the baselines and 400 foot intervals except over main mineral occurrences, where lines were established at 200' intervals. A total of 16.2 miles of line was mapped at a scale of 1" = 400'.

V GEOLOGY

General:

Previous mapping by Trowell (M.N.R. map 2420) shows the west side of the property to consist of NE trending bands of mafic intrusive rock alternating with bands of felsic meta-volcanic or volcanoclastic rocks. Recent mapping generally confirms this. Some of the mafic rocks found were quite fine-grained, and appeared to be volcanic, but the frequent presence of a thin unit of intermediate composition, and a dike like change of grain size (coarser in center, finer towards margins) seems to indicate that the mafic rocks are largely intrusive.

Trowell's map shows the east side of the property as being mostly mafic metavolcanic rocks, with thin bands of felsic metavolcanic rocks. Recent mapping does not support this interpretation. The eastern part of the property consists of felsic to intermediate metavolcanic or volcanoclastic rocks with bands of mafic intrusions or flows. Field relationships seem clearer on the east part of the property. Mafic rocks seen on the east side of the property often appeared clearly intrusive, while the origin of identical counterparts on the west side were often in doubt.

Outcrop patterns of the mafic rocks found on the east side of the property indicate that the area may be tightly folded.

VII LITHOLOGIES

1. Mafic metavolcanic or shallow intrusive rocks.
 - a) Fine to medium grained, massive to weakly foliated, dark green chloritic rocks.
 - b) Fine to medium grained dark green rocks with single crystal feldspar phenocrysts.
 - c) Medium to coarse grained, massive, dark green chloritic rocks with amphibole phenocryst.
 - d) Fine to medium grained massive rocks with feldspar aggregate phenocrysts.
 - e) Calcareous chlorite schist, fine grained weakly to moderately schistose, chloritic, with numerous pods and veins of quartz.
2. Intermediate metavolcanic rocks (may be altered felsic rocks).
 - a) Massive, grey-green (slightly chloritic?) siliceous tuff.
 - b) Massive, grey-green lapilli tuff or tuff breccia.
3. Felsic meta-volcanic or volcanoclastic rocks.
 - a) Fine to very fine grained flows or tuff, buff to light grey-green, siliceous, with occasional quartz phenocrysts.

- b) Lapilli tuff consisting of rounded to subangular clasts embedded in a fine grained matrix. Both clasts and matrix are fine to very fine grained, siliceous and buff-coloured. Fresh surfaces on this unit are difficult to distinguish from unit 3a, but the difference is apparent on weathered surfaces.
- c) Porphyritic tuff, grey-green to buff, massive with quartz and alkali feldspar phenocrysts.
- d) Tuff breccia, with angular clast of 3c and/or 3a embedded in a buff fine-grained siliceous matrix.
- e) Bedded volcanoclastic rocks, consisting of fragments of above units in thin graded (pebble to fine sand size) beds. This unit is apparent only along shorelines where the exposure is unusually good.

VIII GOLD OCCURRENCES

Five gold occurrences are known on the property. The Powell and Davidson-Carr showings were worked in the past, and each have several shafts and adits. Several drill set ups are present on the Davidson-Carr Property. Apparently no record of this previous work can be found. Quartz veins are the site of all known gold mineralization on the property. All quartz veins carrying gold are weakly to moderately mineralized with pyrite, chalcopryite, carbonate stringers, and occasional tourmaline and bornite. The quartz itself is often gold-coloured to red and translucent.

A) Davidson-Carr:

The gold-bearing quartz vein at the Davidson-Carr showing is 2-3 feet wide and strikes NE. It is found at the entrance to an adit along the shoreline, and cannot be traced for more than a few feet, because the adit entrance has collapsed. Judging by the location of a shaft which appears to intercept the adit, the diggers of the adit may have followed the vein for about 70-100 feet.

The gold bearing structure on the northeast tip of the large island south of the Davidson-Carr strikes NNE. It appears to be a network of sub-parallel veins, each several inches wide. Individual dip southeast, but it is not apparent whether the entire structure does likewise. The structure is seen on a 15 foot high cliff on the northeast tip of the island, where some material has been blasted, but was not found beyond the cliff exposure.

Several pits have been dug in the gold bearing vein on the southwest tip of the island. The vein is not clearly exposed, but appears to be three to five feet wide. The series of pits expose quartz along a NNE line about 100 feet long.

B) Powell Occurrence:

Several shafts, trenches, and rockpiles are present at the Powell showing. There appears to be a network of NE bearing quartz veins, but neither their width nor lateral extent can be determined due to cover of vegetation, overburden and piles of rock apparently extracted from the shafts. Quartz found in rockpiles on the Powell showing is more strongly mineralized than other showings on the property, and in fact visible gold is found quite readily in certain of the rockpiles.

Gold has been panned from a crushed sample of quartz from a small vein in unit 1 e, from an exposure where line 480 crosses the winter road leading to the Ricelieu Property. Quartz occurs as pods and stringers in this rock unit at this locality.

Random grab samples have been taken at all of the above occurrences, and at several other quartz veins on the property and submitted for assay.

VIII RECOMMENDATIONS

Observations to date seem to indicate that the Powell showing is the most favourable on the property. Stripping of vegetation and soil would facilitate better exposure of the vein system, and could be done by using a small bulldozer, or a high pressure water hose. This should be followed by trenching and systematic sampling of the veins and wall rocks. A similar exercise should be carried out on both of the island showings.

Due to the collapsed adit and the presence of large rockpiles, following the vein exposed at the Davidson-Carr will necessitate considerable excavation.

The gold bearing quartz pods of unit 1 e are small (several inches by several feet) and offer little potential as a mineral deposit. However the rock unit surrounding them appears to be strongly altered and may be mineralized throughout. There are several good exposures of this unit which should be systematically sampled.

Submitted November 24, 1981

Lynn I. Kelley



APPENDIX "A"

SHERRITT GORDON MINES LIMITED
 MINING DIVISION - LYNN LAKE
 MANITOBA

ASSAY REPORT

DATE November 19 81

LOT NO.	SAMPLE NO.		% Ni	% Cu	% Zn	% Fe	oz/ton	
							Au	Ag
1	Q-6121	qtz from sm. rockpile near shaft and hoist.		0.05			0.85	0.08
2								
3	Q-6122	qtz & crushed rock from above adit		0.05			0.452	0.05
4								
5	Q-6123	Qtz & crushed rock from top of large rk pile S of shaft		0.03			0.43	0.08
6								
7	Q6124	Qtz & crushed rock from bottom of large rk pile S of shaft		0.02			0.01	0.05
8								
9	Q-6125	wall rock from adit entrance		0.10			0.53	0.13
10	Q-6126	qtz from vein exposed at adit entrance		0.05			0.97	0.11
11								
12	Q-6127	qtz highly mineralized (py, cpy, v.g.) from stockpile near shaft.		1.07			1.33	0.41
13				511N, 189E				
14	Q66128	rock type 1e w/qtz stringers from pit at 511N, 190E		0.02			tr	0.05
15								
16	Q-6129	rock type 1e w/qtz stringers from rock pile at 512N, 189+50E		0.14			0.25	0.06
17								
18	Q-6130	bulldozed qtz from rockpile at 512N, 189+50E		0.03			tr	0.04
19								
20	Q-6131	Qtz from small pit at 512N, 192+50E; highly mineralized (py, cpy, carb) no v.g. in sample but v.g. fairly common from this site		0.08			2.07	0.14
21								
22								
23	Q-6132	bulldozed qtz & rock type 1e from rockpile near shaft at 513N, 192+20E		0.03			0.02	0.03
24								
25								

SHERRITT GORDON MINES LIMITED
MINING DIVISION - LYNN LAKE
MANITOBA

ASSAY REPORT

DATE _____ 19__

LOT NO.	SAMPLE NO.		% Ni	% Cu	% Zn	% Fe	oz/ton	
							Au	Ag
1	Q-6133	qtz from vein, NE tip of island		0.66			4.544	0.25
2		w/py, cpy, v.g. carb.						
3	Q-6134	qtz from rockpile at NE tip		0.01			0.01	0.04
4		of island.						
5	Q-6135	wall rock from vein at NE tip		0.08			1.022	0.08
6	Q-6136	qtz from veins along SE flank		0.08			0.640	0.04
7		of island						
8	Q-6137	qtz (slightly minearlixed) from		0.18			0.01	0.03
9		vein at SW tip of island						
10	Q-6138	Bulldozed qtz fom above.		0.12			0.02	0.07
11	Q-6166	le & qtz along road North of		0.02			tr	0.03
12		Richelieu property						
13	Q-6167	same as above		0.01			tr	0.08
14	Q-6168	" "		0.02			tr	0.03
15	Q-6169	Richelieu Property		0.02			tr	0.04
16	Q-6170	" "		1.28			m 0.01	0.17
17	Q-6171	Q.v at L 472N, 165+70E		0.03			tr	0.03
18	Q-6172	Q.V at 462+80N, 164+50E		0.05			tr	0.03
19	Q-6173	Q.V. at L 460N, 161+80E		0.01			tr	0.03
20								
21								
22								
23								
24								
25								

SHERRITT GORDON MINES LIMITED

APPENDIX "B"

Qualifications of Writer - Mr. Lynn I. Kelley

Bachelor of Arts - Earth Sciences

- (1977) Millersville State College,
Pennsylvania, U.S.A.

Master of Science and Geology (1980)

- University of South Dakota,
South Dakota, U.S.A.

Graduate Experience - Sherritt Gordon Mines Limited.



52J02NE0047 52J02NE0036B1 BECKINGTON LAKE

900



Ontario

Ministry of Natural Resources

File _____

GEOPHYSICAL - GEOLOGICAL - GEOCHEMICAL
TECHNICAL DATA STATEMENT

RECEIVED

TO BE ATTACHED AS AN APPENDIX TO TECHNICAL REPORT
FACTS SHOWN HERE NEED NOT BE REPEATED IN REPORT
TECHNICAL REPORT MUST CONTAIN INTERPRETATION, CONCLUSIONS ETC.

JUL 14 1982

MINING LANDS SECTION

Type of Survey(s) GEOLOGICAL
 Township or Area Beckington Lake Area M-1740
 Claim Holder(s) Sherritt Gordon Mines Limited
 Survey Company Sherritt Gordon Mines Limited
 Author of Report Mr. L. Kelley
 Address of Author Box 723, Dryden, Ontario P8N 2Z4
 Covering Dates of Survey Sept. 25/81-Nov. 11/81
 (linecutting to office)
 Total Miles of Line Cut 16.2

MINING CLAIMS TRAVERSED	
List numerically	
Pa	437079
(prefix)	(number)
	080
	081
	082
	083
	084
	085
	436991
	995
	996
	437133
	134
	487304
	305
	306
	307
	308
	309
	310
	311
	312
	313 cont.
TOTAL CLAIMS _____	

If space insufficient, attach list

SPECIAL PROVISIONS CREDITS REQUESTED	DAYS per claim
ENTER 40 days (includes line cutting) for first survey.	Geophysical _____
ENTER 20 days for each additional survey using same grid.	-Electromagnetic _____
	-Magnetometer _____
	-Radiometric _____
	-Other _____
	Geological <u>20</u>
	Geochemical _____

AIRBORNE CREDITS (Special provision credits do not apply to airborne surveys)

Magnetometer _____ Electromagnetic _____ Radiometric _____
(enter days per claim)

DATE: July 9/82 SIGNATURE: [Signature]
Author of Report or Agent

Res. Geol. _____ Qualifications 2.3935

Previous Surveys			
File No.	Type	Date	Claim Holder

OFFICE USE ONLY



Mining Claims traversed

Pa 487314
315
316
317
318
487671
672
560609
560593
594
595
598

a total of 34 claims.

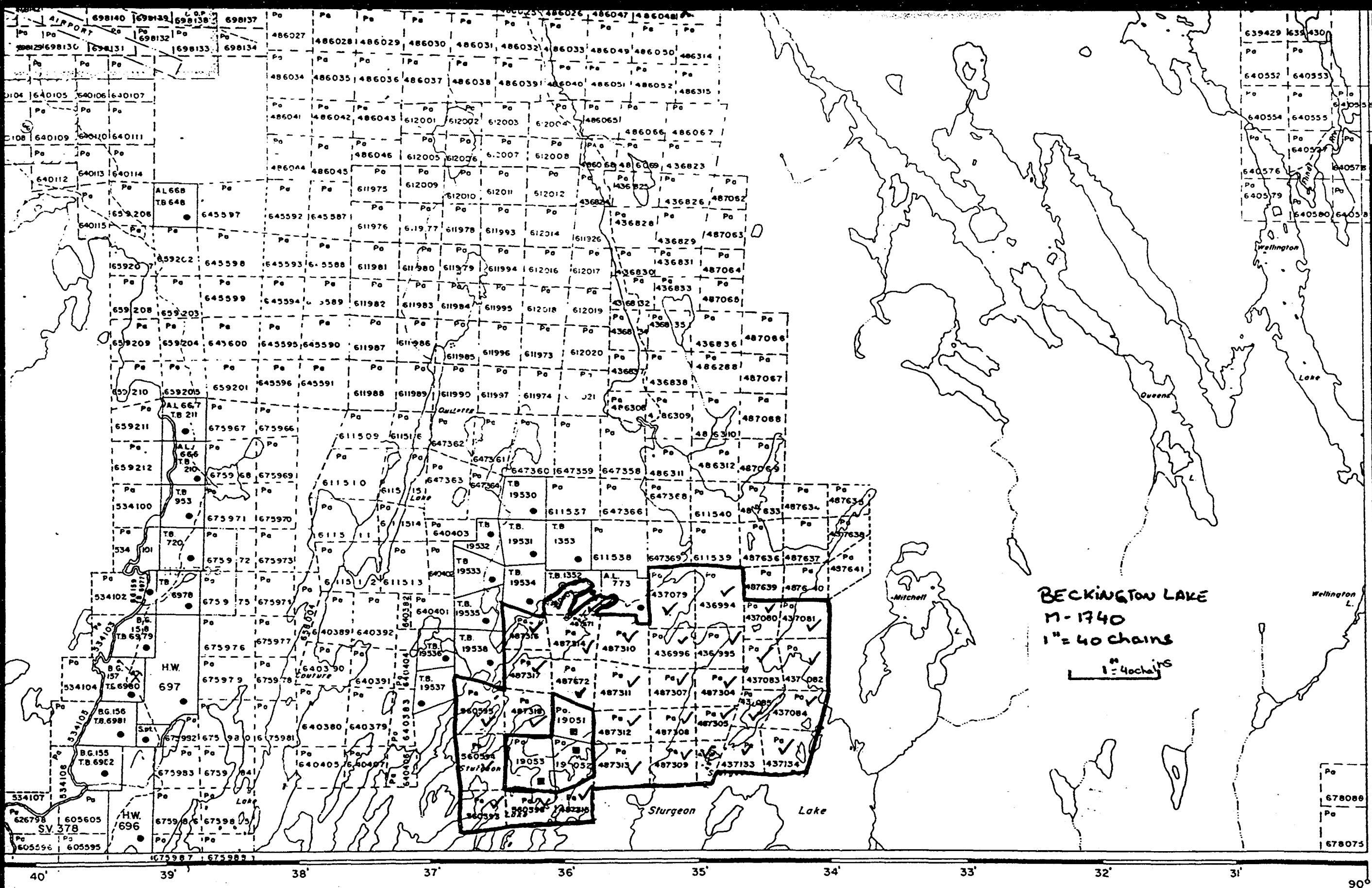

Fog Lake & Manion Twp.

Squaw Lake Area - M.1904

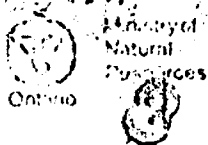

Report of Work
(Geophysical, Geological,
Geochemical and Expenditures)

#82-65

Instructions: Only days credits selected in the "Expend. Days Cr." column are included in the total.

The Mining Act

Type of Survey(s) **Geological** Location of Area **Beckington Lake K-1740**

Claim Holder(s) **Sherritt Gordon Mines Limited** District Office File No. **P-042**

Address **Box 723, Dryden, Ontario P8N 2Z4**

Survey Company **Sherritt Gordon Mines Limited** Date of Survey (from & to) **25, 09, 81 to 11, 81** Total Miles of Line Cut **16.2**

Name and Address of Author (of Geo Technical report) **Lynn Kelley, Box 723 Dryden, Ontario**

Credits Requested per Each Claim in Columns at right

Special Provisions	Geophysical	Days per Claim
For first survey: Enter 40 days. (This includes line cutting)	- Electromagnetic	
	- Magnetometer	
	- Radiometric	
	- Other	
For each additional survey: using the same grid: Enter 20 days (for each)	Geological	20
	Geochemical	
Man Days	Geophysical	Days per Claim
Complete reversal and enter total	- Electromagnetic	
	- Magnetometer	
	- Radiometric	
	Geological	
	Geochemical	
Airborne Credits	Electromagnetic	Days per Claim
Note: Special provisions credits do not apply to Airborne Surveys.	Magnetometer	
	Radiometric	

RECEIVED
JUL 26 1982
MINING LANDS SECTION

Mining Claims Traversed (List in numerical sequence)

Prefix	Mining Claim Number	Expend Days Cr.	Prefix	Mining Claim Number	Expend Days Cr.
Pa	437079	20	Pa	487315	20
	080	20		316	20
	081	20		317	20
	082	20		318	20
	083	20		487671	20
	084	20		672	20
	085	20		560609	20
	436994	20		560593	20
	995	20		594	20
	996	20		595	20
	437133	20		598	20
	134	20			
	487304	20			
	305	20			
	306	20			
	307	20			
	308	20			
	309	20			
	310	20			
	311	20			
	312	20			
	313	20			
	314	20			

PATRICIA MINING DIV.
RECEIVED
JUL -5 1982
A.M. P.M.
7 8 9 10 11 12 1 2 3 4 5 6

See reversed statement

Total number of mining claims covered by this report of work **34**

Expenditures (excludes power stripping)

Type of Work Performed

Performed on Claim(s)

Calculation of Expenditure Days Credits

Total Expenditures **\$** + **15** = Total Days Credits

Instructions
Total Days Credits may be apportioned at the claim holder's choice. Enter number of days credits per claim selected in columns at right.

For Office Use Only

Total Days Cr. Recorded **680** Date Recorded **JUL 5 1982** Mining Recorder **[Signature]**

Date Approved as Recorded **[Signature]** Branch Director

Date **July 2, 82** Recorded Holder or Agent (Signature) **[Signature]**

Certification Verifying Report of Work

I hereby certify that I have a personal and intimate knowledge of the facts set forth in the Report of Work annexed hereto, having performed the work or witnessed same during and/or after its completion and the annexed report is true.



Date
1983 08 22

Mining Recorder's Report of
Work No. 82-65

Recorded Holder
SHERRITT GORDON MINES LIMITED

Township or Area
BECKINGTON LAKE AREA

Type of survey and number of Assessment days credit per claim	Mining Claims Assessed
Geophysical	
Electromagnetic _____ days	P 436994 to 96 incl.
Magnetometer _____ days	437079
Radiometric _____ days	437081 to 85 incl.
Induced polarization _____ days	437133
Other _____ days	487305
Section 77 (19) See "Mining Claims Assessed" column	487307 to 318 incl.
Geological _____ 18 _____ days	487671-72
Geochemical _____ days	560593 to 95 incl
Man days <input checked="" type="checkbox"/> Airborne <input type="checkbox"/>	560598
Special provision <input type="checkbox"/> Ground <input checked="" type="checkbox"/>	
<input checked="" type="checkbox"/> Credits have been reduced because of partial coverage of claims.	
<input type="checkbox"/> Credits have been reduced because of corrections to work dates and figures of applicant.	

Special credits under section 77 (16) for the following mining claims

[Empty box for special credits]

No credits have been allowed for the following mining claims

not sufficiently covered by the survey Insufficient technical data filed

P 437080
437134
487304
487306
560609



Ministry of
Natural
Resources

Assessment
Work
Breakdown

RECEIVED

JUL 19 1983

1. Type of Survey GEOLOGICAL MINING LANDS SECTION
2. Township or Area BECKINGTON LAKE AREA M-1740
3. Numbers of Mining Claims Traversed by Survey
- 436994, 436995, 436996, 437079, 437080, 437081, 437082, 437083, 437084
- 437085, 437133, 437134, 487304, 487305, 487306, 487307, 487808, 487309
- 487310, 487311, 487312, 487313, 487314, 487315, 487316, 487317, 487318
- 487671, 487672, 560593, 560594, ~~560594~~, 560595, 560598, 560609
4. Number of Miles of Line Cut already applied Flown nil
- *5. Number of Stations Established
- *6. Make and type of Instrument Used
- *7. Scale Constant or Sensitivity
- *8. Frequency Used and Power Output

9. Summary of Assessment credits (details on reverse side)

Total 8 hour Technical Days (Include Consultants, Draughting etc.) 73.8

Total 8 hour Line-Cutting Days nil

Calculation

$$\frac{73.8}{\text{Technical}} \times 7 = \frac{516.6}{\text{Line-cutting}} \div \frac{34}{\text{Number of claims}} = \frac{15}{\text{Assessment credits per claim}}$$

The dates listed on this form represent working time spent entirely within the limits of the above listed claims Check

If otherwise, please explain Yes for geologic work. J. Lavergne's dates include time spent on other projects but total hours for this project only are as indicated.

Dated: June 20, 1983

Signed: J. Lavergne

- Note: (A) * Complete only if applicable.
 (B) Complete list of names, addresses and dates on reverse side.
 (C) Submit separate breakdown for each type of survey.
 (D) Submit in duplicate.

Details of Assessment Work Breakdown

FIELD WORK

<u>Type of Work</u>	<u>Name & Address</u>	<u>Dates Worked</u>	<u>Number of 8 hour days</u>
GEOLOGICAL	L. Kelley	Aug. 12-31, Sept. 7-30, 1981	44
	V. Scime	Aug. 12-15, Sept. 1, 2, 1981	15
		Oct. 1-9, 1981	
REPORT AND MAP PREPARATION	L. Kelley	Nov. 13, 16-20, 1981	6

Box 723, Dryden, Ontario P8N 2Z4

CONSULTANTS

<u>Name & Address</u>	<u>Dates Worked (specify in field or office)</u>	<u>Number of 8 hour days</u>

DRAUGHTSMAN, TYPING, OTHERS (specify)

<u>Name & Address</u>	<u>Type of Work</u>	<u>Dates Worked</u>	<u>Number of 8 hour days</u>
	FINAL DRAFTING,	(Total Hours=78.5)	
J. Lavergne	TYPING, REPRODUCTION	Mar. 1-5, 10, 11, 16-18, 1982	
Box 723, Dryden, Ontario P8N 2Z4		Apr. 7, 12, 13, 1982	9.8
TOTAL 8 HOUR TECHNICAL DAYS			73.8

LINE-CUTTING

<u>Name</u>	<u>Address</u>	<u>Dates Worked</u>	<u>Number of 8 hour days</u>
TOTAL 8 HOUR LINE-CUTTING DAYS			



Mining Lands Comments

- No traverse lines
1 traverse were done along
grid lines which cover most of
the property.

To: Geophysics

Comments

Approved

Wish to see again with corrections

Date

Signature

To: Geology - Expenditures

W/R. Kuster

Comments

Approved

Wish to see again with corrections

Date

Feb 28/83

Signature

Chesira

To: Geochemistry

Comments

LD

Approved

Wish to see again with corrections

Date

Signature

sherritt

RECEIVED	
Land Management Branch	
CIRCULATE	<input type="checkbox"/>
COMMENTS PLEASE	<input type="checkbox"/>
BY	
JUL 14 1982	
E. F. ANDERSON	
J. R. MORTON	
J. C. SMITH	

July 9, 1982

Mr. E. F. Anderson
Director
Lands Management Branch
Whitney Block, Rm 6450
Queen's Park
Toronto, Ontario
M7A 1W3

Dear Sir:

Enclosed are work reports and maps on 34 mining claims in the Beckington Lake Area, M-1740, Mining District of Patricia.

We are applying for assessment credits under special provisions for a geological survey.

Mining claims: Pa437079 -437085 incl., Pa 436994-436996 incl.
Pa 437133, 437134, Pa 487304-437318 incl.,
Pa 487671, 487672, Pa 560593-560595 incl.,
Pa 560609, 560598.

Enclosures: duplicated copies of the geological map
duplicated copies of the geological report.

Yours truly,

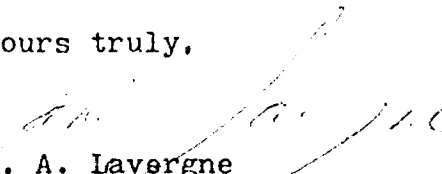
J. A. Lavergne
Sherritt Gordon Mines Limited
Dryden, Ontario

JL/jl

encl.

1982 07 22

2.4934

Mining Recorder
Ministry of Natural Resources
P.O. Box 669
Sioux Lookout, Ontario
POV 2T0

Dear Sir:

We have received reports and maps for a Geological Survey submitted under Special Provisions (credit for Performance and Coverage) on Mining Claims Pa 436994 et al in the Area of Beckington Lake.

This material will be examined and assessed and a statement of assessment work credits will be issued.

Yours very truly,

E.F. Anderson
Director
Land Management Branch

Whitney Block, Room 6450
Queen's Park
Toronto, Ontario
M7A 1W3
Phone: 416/965-1316

J. Skura/sc

c/c. Sherritt Gordon Mines Limited
Dryden, Ontario.
Attn: J.A. Lavergne

c.c. Mr. L. Kelley
Dryden, Ontario.

1983 04 19

2.4934

Sherritt Gordon Mines Limited
Box 723
Dryden, Ontario
P8N 2Z4

Attention: Lynn Kelly.

Dear Ms Kelly:

RE: Geological Survey on Mining Claims Pa 437079 et
al in the Beckington Lake Area

Due to excessive water coverage of the surveyed area, assessment of your requested credits may not be considered using the Special Provisions method. Credits will be allowed under the man-days method provided you complete and return the enclosed man-day breakdown forms.

Yours very truly,

E.F. Anderson
Director
Land Management Branch

Whitney Block, Room 6450
Queen's Park
Toronto, Ontario
M7A 1W3

R. Pichette:sc

Encls:

cc: Mining Recorder
Sioux Lookout, Ontario

REGISTERED

July 12, 1983

*- received
called July 15th
claimed data sent
will send new
info
2.4934*

Sherritt Gordon Mines Ltd
Box 723
Dryden, Ontario
P8N 2Z4

Attention: J.A. Lavergne

Dear Sir:

RE: Geological Survey submitted on Mining Claims PA437079
et al in the Area of Beckington Lake

Enclosed is a copy of our letter dated April 19, 1983,
requesting additional information for the above-mentioned
survey.

Unless you can provide the required data by July 25, 1983,
the mining recorder will be directed to cancel the work
credits recorded on June 5, 1982.

For further information, please contact Mr. F.W. Matthews
at (416) 965-1380.

Yours very truly,

E.F. Anderson
Director
Land Management Branch

Whitney Boock, Room 6450
Queen's Park
Toronto, Ontario
M7A 1W3
Phone: (416) 965-1380

S. Hurst:mc

Encl.

cc: Mining Recorder
Sioux Lookout, Ontario



Ministry of
Natural
Resources

Sept 12, '83

Your file

1983 08 22

Our file. 2.4934

Mining Recorder
Ministry of Natural Resources
60 Wilson Avenue
Timmins, Ontario
P4N 2S7

Dear Sir:

Enclosed are two copies of a Notice of Intent with statements listing a reduced rate of assessment work credits to be allowed for a technical survey. Please forward one copy to the recorded holder of the claims and retain the other. In approximately fifteen days from the above date, a final letter of approval of these credits will be sent to you. On receipt of the approval letter, you may then change the work entries on the claim record sheets.

For further information, if required, please contact Mr. F.W. Matthews at 416/965-1380.

Yours very truly,

E.F. Anderson
Director
Land Management Branch

Whitney Block, Room 6450
Queen's Park
Toronto, Ontario
M7A 1W3
Phone: 416/965-1316

R. Pichette:sc

Encls:

cc: Sherritt Gordon Mines Limited
Box 723
Dryden, Ont
P8N 2Z4 Attn: J.A. Levergne.
cc: Mr. G.H. Ferguson
Mining & Lands Commissioner
Toronto, Ontario



Ministry of
Natural
Resources

Notice of Intent
for Technical Reports

1983 08 22

2.4934

An examination of your survey report indicates that the requirements of The Ontario Mining Act have not been fully met to warrant maximum assessment work credits. This notice is merely a warning that you will not be allowed the number of assessment work days credits that you expected and also that in approximately 15 days from the above date, the mining recorder will be authorized to change the entries on his record sheets to agree with the enclosed statement. Please note that until such time as the recorder actually changes the entry on the record sheet, the status of the claim remains unchanged.

If you are of the opinion that these changes by the mining recorder will jeopardize your claims, you may during the next fifteen days apply to the Mining and Lands Commissioner for an extension of time. Abstracts should be sent with your application.

If the reduced rate of credits does not jeopardize the status of the claims then you need not seek relief from the Mining and Lands Commissioner and this Notice of Intent may be disregarded.

If your survey was submitted and assessed under the "Special Provision-Performance and Coverage" method and you are of the opinion that a re-appraisal under the "Man-days" method would result in the approval of a greater number of days credit per claim, you may, within the said fifteen day period, submit assessment work breakdowns listing the employees names, addresses and the dates and hours they worked. The new work breakdowns should be submitted direct to the Lands Management Branch, Toronto. The report will be re-assessed and a new statement of credits based on actual days worked will be issued.



Ministry of
Natural
Resources

115561

52 J/2 NE (58)

Your file:

1983 09 14

Our file: 2.4934

Mr. Albert Hanson
Mining Recorder
Ministry of Natural Resources
P.O. Box 669
Sioux Lookout, Ontario
POV 2T0

Ministry of Natural Resources
RECEIVED
SEP 19 1983
RESIDENT GEOLOGIST
SIOUX LOOKOUT

Dear Sir:

RE: Geological Survey on Mining Claims PA 436994 et al
in the Township of Beckington Lake Area

The Geological Survey assessment work credits as listed with
my Notice of Intent dated August 22, 1983, have been approved
as of the above date.

Please inform the recorded holder of these mining claims and
so indicate on your records.

Yours very truly,

E.E. Anderson
Director
Land Management Branch

Whitney Block, Room 6450
Queen's Park
Toronto, Ontario
M7A 1W3
Phone: (416)965-1380

R. Pichette:mc

Encl.

cc: Sherritt Gordon Mines Limited
Box 723
Dryden, Ontario
P8N 2Z4
Attention: J.A. Levergne

cc: Resident Geologist
Sioux Lookout, Ontario

August 15, 1985

Your File: 83-90
Our File: 2.4934

Mining Recorder
Ministry of Natural Resources
P.O. Box 309
Sioux Lookout, Ontario
POV 2T0

Dear Sir:

Sherridon Johnson recorded 15 days Geological assessment work credits on each of Mining Claims PA 436994 to 96 inclusive; PA 437079 to 85 inclusive and PA 437133-34 on August 3, 1983.

This survey has previously been recorded on July 5, 1982 (Our File 2.4934) and credits were approved on September 14, 1983.

You are hereby authorized to delete the work credits recorded on August 3, 1983 from each of the claim record sheets. Please inform the recorded holder accordingly.

Yours sincerely,

S.E. Yundt
Director
Land Management Branch

Whitney Block, Room 6643
Queen's Park
Toronto, Ontario
M7A 1W3
Phone:(416)965-4888

D. Kinvig:mc

cc: William Reed
Box 1134
Sioux Lookout, Ontario
POV 2T0
cc: Sherridon Johnson
PP00 Box 725
Vulcan, Alberta
TOL 2B0

cc: Sherritt Gordon Mines Ltd
P.O. 723
Dryden, Ontario
P8N 2Z4

SEE ACCOMPANYING
MAP(S) IDENTIFIED AS

525/02NE-0036-B1 #1

LOCATED IN THE MAP
CHANNEL IN THE
FOLLOWING SEQUENCE

(X)

		X

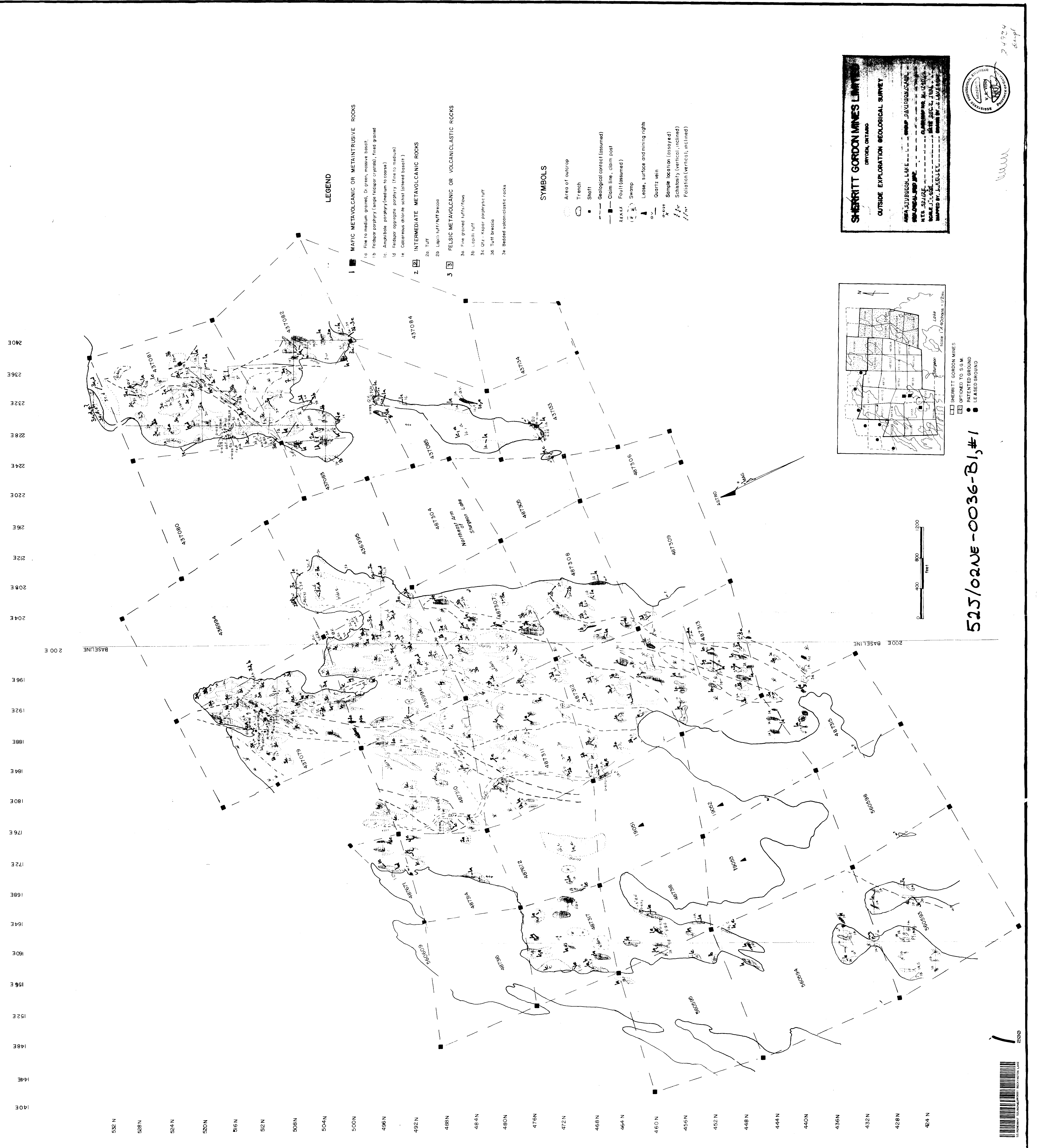

LEGEND

- 1** MAFIC METAVOLCANIC OR METAINTRUSIVE ROCKS
 - 1a Fine to medium grained, Dr. green, massive basalt.
 - 1b Feldspar porphyry (single feldspar crystals), fine grained
 - 1c Amphibole porphyry (medium to coarse)
 - 1d Feldspar aggregate porphyry (fine to medium)
 - 1e Calcic-reous chlorite schist (altered basalt)
- 2** INTERMEDIATE METAVOLCANIC ROCKS
 - 2a Tuff
 - 2b Lapilli tuff/tuff breccia
- 3** FELSIC METAVOLCANIC OR VOLCANICLASTIC ROCKS
 - 3a Fine grained tuff/flows
 - 3b Lapilli tuff
 - 3c Qtz - Kspar porphyritic tuff
 - 3d Tuff breccia
 - 3e Bedded volcanoclastic rocks

SYMBOLS

- Area of outcrop
- Trench
- Shaft
- Geological contact (assumed)
- Claim line, claim post
- Fault (assumed)
- Swamp
- Lease, surface and mining rights
- Quartz vein
- Sample location (assayed)
- Schistosity (vertical, inclined)
- Foliation (vertical, inclined)

SHERITT GORDON MINES LIMITED
 ONTARIO, ONTARIO

OUTSIDE EXPLORATION GEOLOGICAL SURVEY

AREA: STURGEON LAKE
 CONSULTANT: MR. DAVIDSON/CARE
 GEOLOGICAL SURVEY
 DATE: 1982
 DRAWN BY: M. J. B. / L. V.

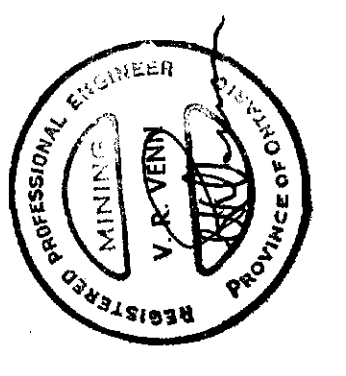

74924
 dmpf

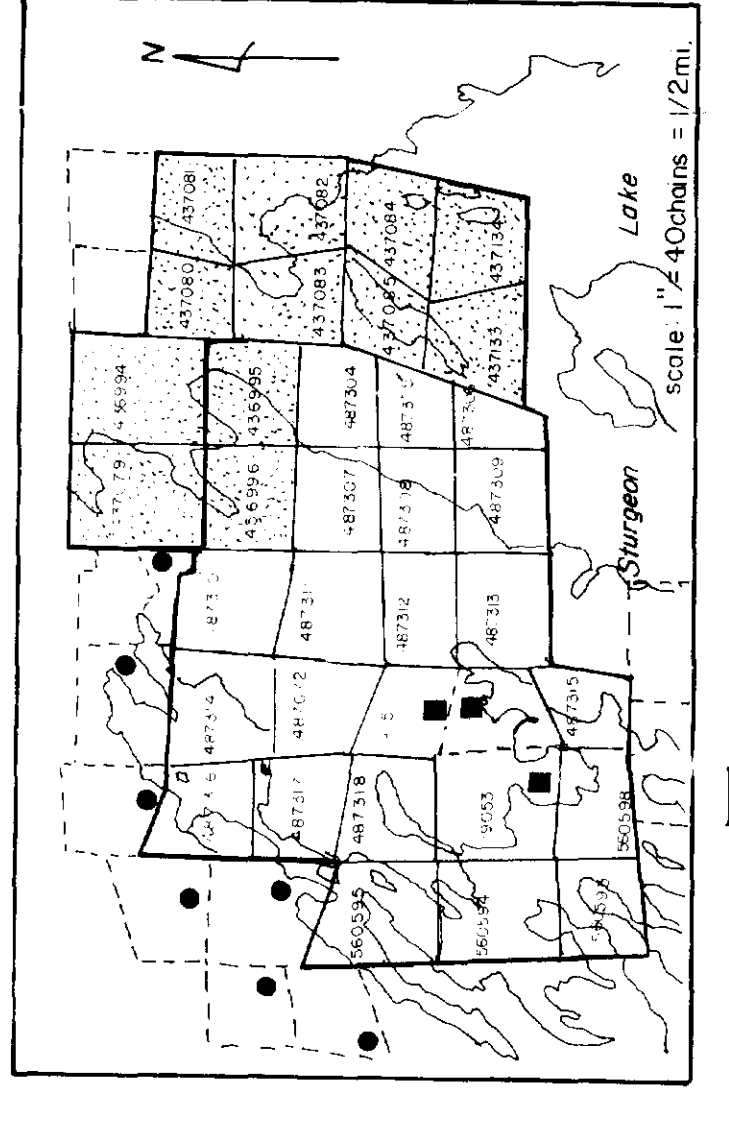

SHERITT GORDON MINES
 PATENTED GROUND
 LEASED GROUND

525/02NE-0036-B1, #1

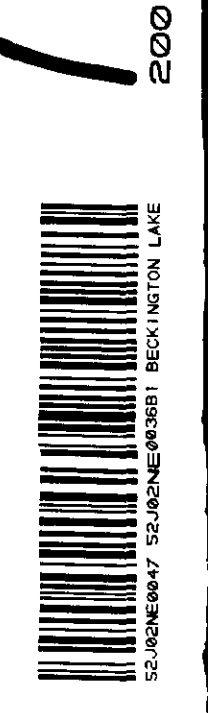
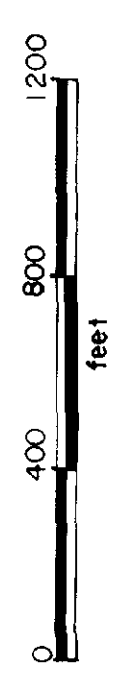

500