



52J02SE0010 W9630-00022 SQUAW LAKE

010

**STURGEON LAKE PROPERTY
PROSPECTING AND GEOPHYSICAL
REPORT**

**FOR
EQUATOR MINING CORPORATION
VANCOUVER, BRITISH COLUMBIA**

**BY
MAJOR MANAGEMENT EXPLORATION SERVICES
SASKATOON, SASKATCHEWAN
FEBRUARY 19, 1996**

2.16564

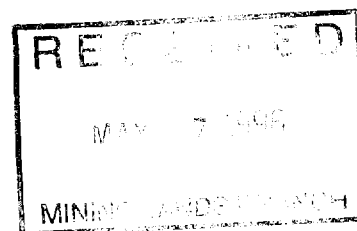

101 WING ST
VICTORIA
BC V8W 101

26 APR 9 11:31

W9630.00022/.00038

MAJOR MANAGEMENT EXPLORATION SERVICES

Robert J. Major
President

302 - 385 Kingsmere Blvd.
Saskatoon, Sask. S7J 4J6
Telephone: (306) 955-5095
Facsimile: (306) 955-5095

March 5, 1995

1995 EXPLORATION PROGRAM

Prospecting, Trenching, Sampling and Ground Geophysics

was carried out

By: Major Management Exploration Services
385 - 302 Kingsmere Blvd.
Saskatoon, Sask.
S7J 4J6

For: Equator Mining Corporation
201 - 110 Cambie St.
Vancouver, BC
V6B 2M8

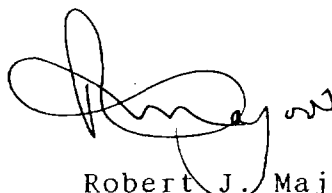
Robert J. Major
President

Decl. #



52J02SE001G W9630-00C22 SQUAW LAKE

010C

TABLE OF CONTENTS

	PAGE
1.0 INTRODUCTION	1
1.1 1995 EXPLORATION PERSONNEL	1
1.2 EXPLORATION SERVICE AND SUPPORT	1
2.0 LOCATION AND ACCESS	1
3.0 PROPERTY AND OWNERSHIP	1
4.0 PHYSIOGRAPHY	3
5.0 GENERAL GEOLOGY	4
6.0 1995 EXPLORATION PROGRAM	5
6.1 PROSPECTING	5
6.2 GEOPHYSICS	6
7.0 CONCLUSION	6
8.0 RECOMMENDATIONS	6
9.0 REFERENCES	7

LIST OF MAPS

MAP NO. 1 PROPERTY MAP

MAP NO. 2 PROSPECTING MAP

MAP NO. 3 ELECTROMAGNETIC SURVEY MAP

LIST OF FIGURES

- Figure No. 1 Photo of Gold Showing "C" (pre exposure)
- Figure No. 2 Photo of Gold Showing "C" (post exposure)
- Figure No. 3 Photo of Gold Showing "C" (post exposure)
- Figure No. 4 Photo of Gold Showing "C" (post exposure)
- Figure No. 5 Property Location Map

LIST OF APPENDICIES

- Appendix A TSL Laboratories Certificates of Analysis
- Appendix B Equator Mining Corp. 1995 Exploration Expenditures

GEOLOGY AND PRINCIPAL MINERALS OF ONTARIO

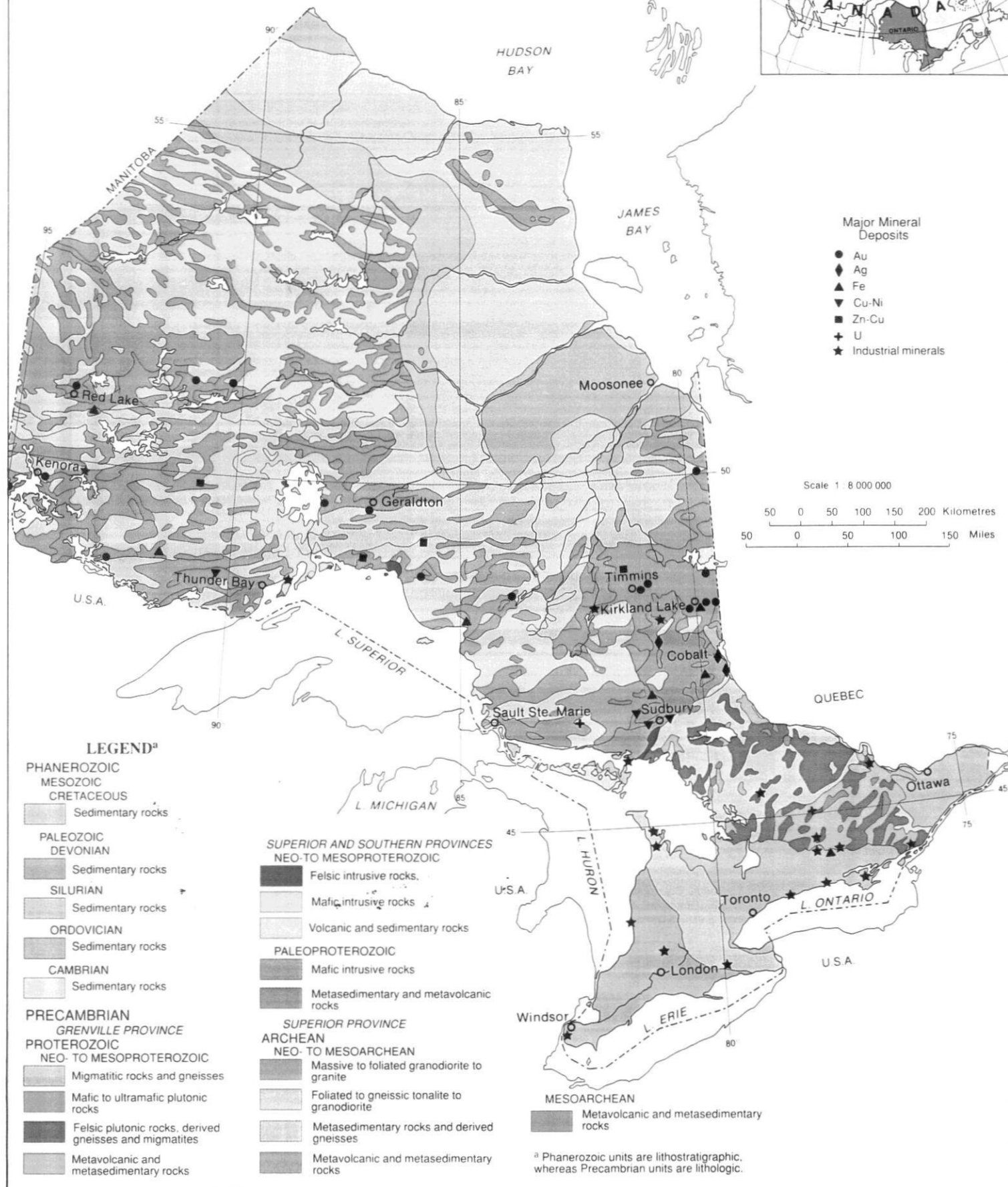
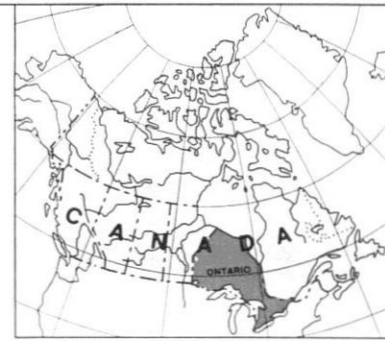

1.0 INTRODUCTION

This report describes the 1995 Equator Mining Corp. exploration program on claims: 1162859, 1162887, 1124734, 1124735, 1124731, 1134732, and 1162888 in the Sturgeon Lake area of Ontario. The property was acquired by Equator Mining Corp. to explore for economic gold deposits.

1.1 1995 EXPLORATION PERSONNEL

R. Major	Saskatoon, Sask.	Project supervisor
E. Barkaskus	Sioux Lookout, Ont.	senior prospector
B. McKilroy	Ignace, Ont.	senior prospector
B. Major	Saskatoon, Sask.	junior prospector
V. Cook	Stanley Mission, Sask.	geophysical operator
H. Ratt	La Ronge, Sask.	line cutter
H. Cook	Stanley Mission, Sask.	line cutter

1.2 EXPLORATION SERVICE AND SUPPORT

Technical Services Laboratories	Saskatoon, Sask.
IGA	Sioux Lookout, Ont.
Whiskeyjack Lodge	Savant Lake, Ont.

2.0 LOCATION AND ACCESS

The property is located adjacent to and immediately north of the east end of East Bay on Sturgeon Lake Ontario. The claims are outlined on Ontario Ministry of Natural Resources, Squaw Lake Map Sheet Number G-3140. Access to the property is by boat or snow machine from Whiskeyjack Landing on Sturgeon Lake. The nearest townsite is Savant Lake approximately 15 miles north of Whiskeyjack Lodge.

3.0 PROPERTY AND OWNERSHIP

The property consists of 38 claims owned 100% by Equator Mining Corp. The claims are as follows:

<u>CLAIM NUMBER</u>	<u>RECORDING DATE</u>
1162859	Feb. 13/95
1162887	June 23/95
1124734	
1124735	
1124731	

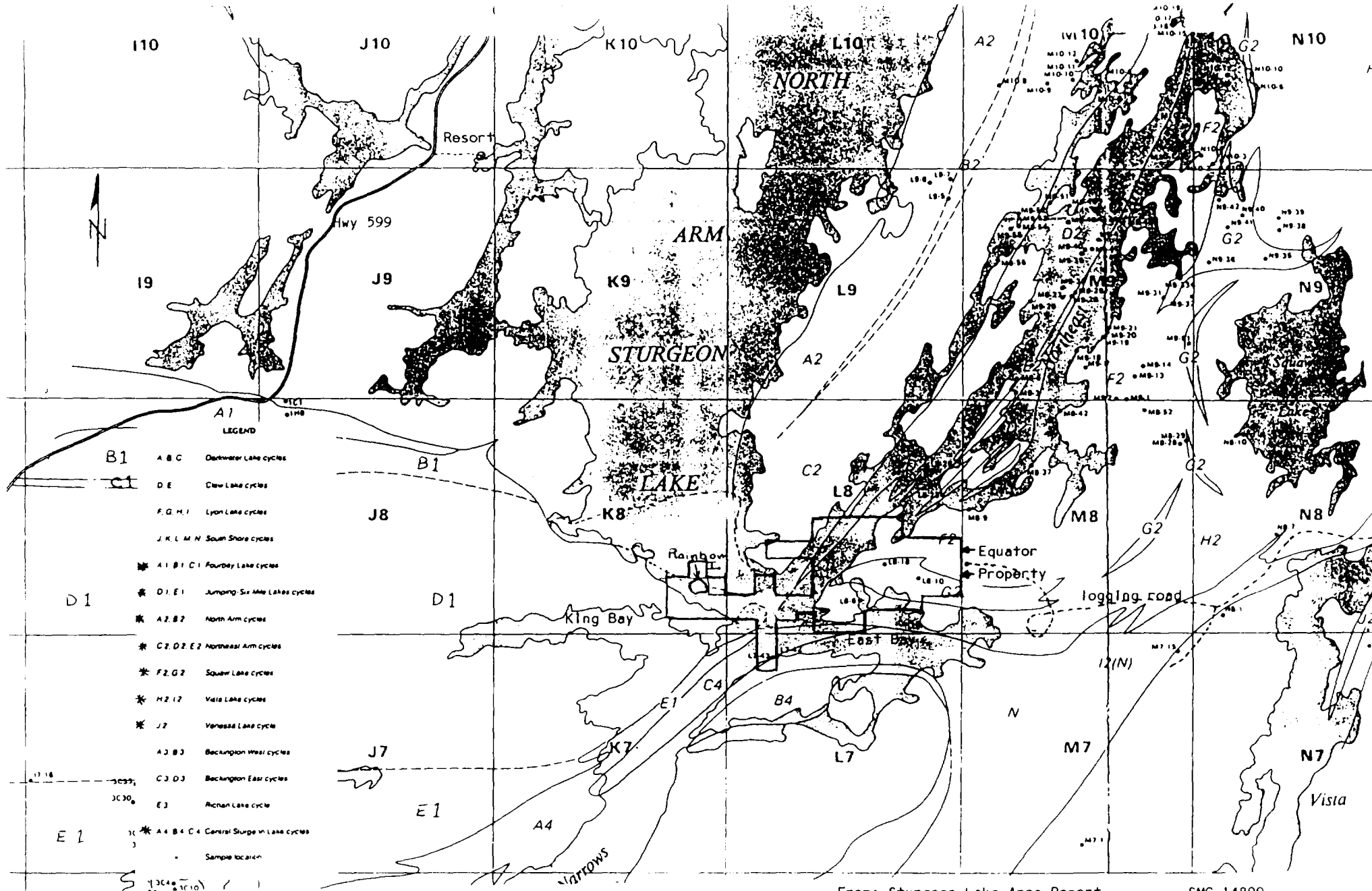

From: Sturgeon Lake Area Report
Chart A, Fig. 2 and 15

SMC 14809

* Units Represented on Map.

5 km



Scale

Subdivision of the Upper Sturgeon Lake Volcano-sedimentary belt.

<u>CLAIM NUMBER</u>	<u>RECORDING DATE</u>
1134732	
1162888	June 23/95
1039270	
896060	Aug. 12/86
896062	Jan. 05/87
896063	Jan. 05/87
1047744	Feb. 22/89
1068213	May 20/88
1150291	Jan. 27/95
1150292	Jan. 27/95
1162852	Nov. 21/94
1162853	Nov. 21/94
1162854	Nov. 21/94
1162855	Nov. 21/94
1162856	Nov. 21/94
1162857	Nov. 21/94
1162858	Jan. 27/95
1162859	Feb. 13/95
1162861	Jan. 17/95
1162862	Jan. 17/95
1162863	Jan. 17/95
1162864	Jan. 17/95
1162865	Feb. 09/95
1162883	June 23/95
1162884	June 23/95

<u>CLAIM NUMBER</u>	<u>RECORDING DATE</u>
1162885	June 23/95
1162886	July 06/95
1162887	June 23/95
1162888	June 23/95
1162889	June 23/95
1162890	July 06/95
1162891	July 06/95
1162911	Aug. 01/95
1162912	Aug. 01/95
1162913	Aug. 01/95
1162914	Aug. 03/95
1162916	July 21/95
1162917	July 21/95
1162918	July 21/95
1162919	July 21/95
1162980	Sept.26/95

4.0 PHYSIOGRAPHY

The area lies within the drainage systems of the English and Sturgeon Rivers. Sturgeon Lake is 409 meters above sea level and the maximum local relief is approximately 500 meters above sea level. Greater relief can occur along the faulted contact between the eastern granitic complex and the metasedimentary - metavolcanic belt. This contact marks a river system divide with the waters to the west flowing into Lake Winnipeg and the waters to the east flowing into the Albany River. The area has been glaciated with deeper lakes occurring within glacially scoured depressions in the bedrock. Outcrop exposure in the area is generally abundant.

Forest cover in the region consists of poplar, balsam, tamarack, birch, jackpine, spruce, poplar and cedar. Trapping of

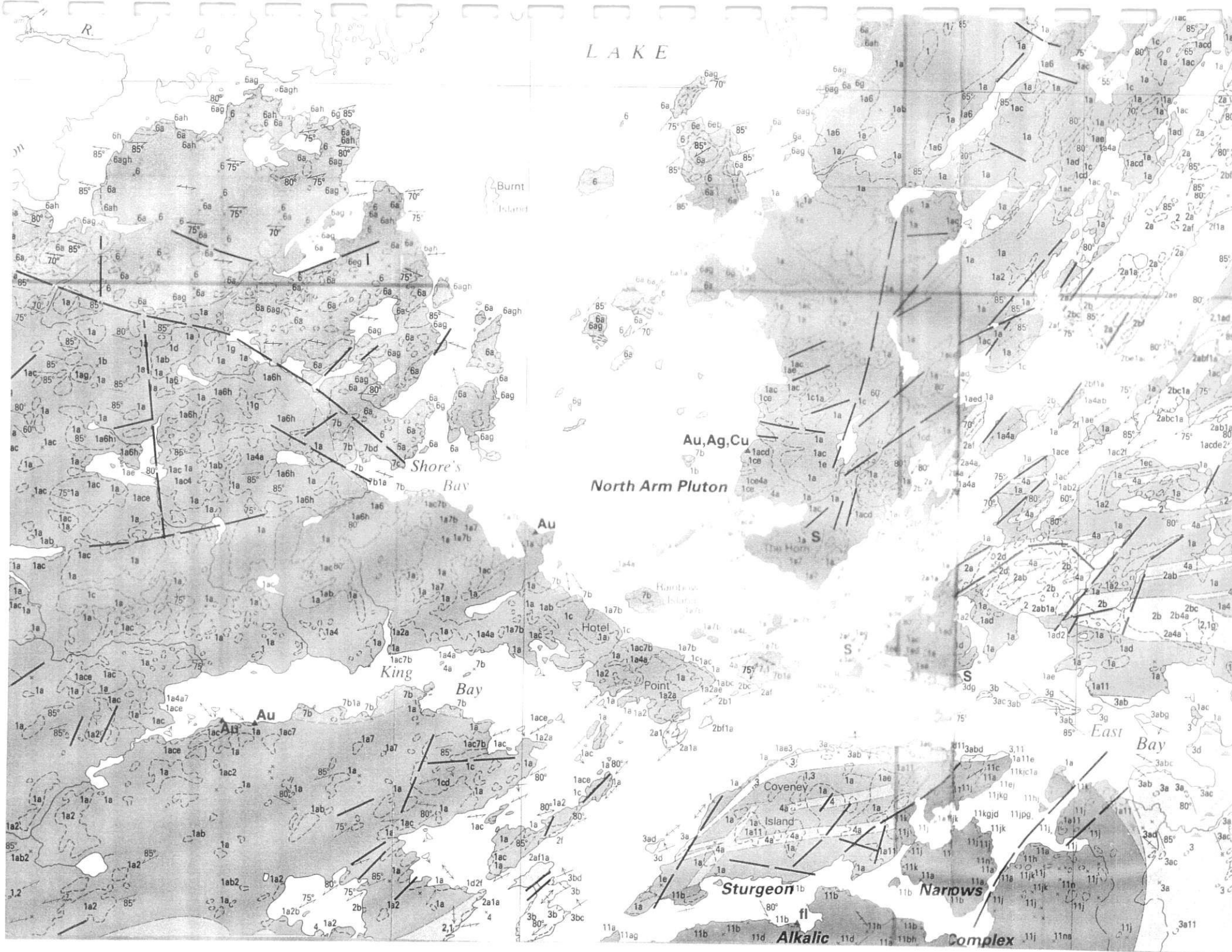

fur bearing animals is carried out in the Sturgeon Lake area.

5.0 GENERAL GEOLOGY

(N.F. Trowell, Ont. Geol. Surv. Rep. 227)

The Squaw Lake - Sturgeon Lake area occurs within the Wabigoon Belt of the Superior Province of the Canadian Shield. The metavolcanic - metasedimentary sequence of rocks is approximately 12 kilometers wide, 19 kilometers long and is flanked on the east and west by intrusive granitic complexes. The metavolcanic - metasedimentary sequence has been divided into 10 assemblages. These assemblages from west to east are as follows:

Assemblage 1: Intermediate mafic to intermediate volcanics composed of volcanic flows and mafic intrusives.

Assemblage 2: Intermediate to felsic pyroclastic rocks and metasediments. sections are possibly repeated by folding or faulting.

Assemblage 3: Carbonate breccia, possibly a Precambrian example of hyaloclastic volcanism.

Assemblage 4: Mafic to intermediate pillowed and amygdaloidal volcanic flows with thin felsic to intermediate pyroclastic units.

Assemblage 5: Intermediate to felsic pyroclastic units.

Assemblage 6: Scattered intercalated units within assemblage 4, possibly caused by the intrusion of the Squaw Lake Alkalic Complex combined with folding.

Assemblage 7: Mafic to intermediate metavolcanics and thin intercalated metasedimentary units.

Assemblage 8: It is the main sedimentary succession in the area and may represent an off - lapping sequence of the above assemblages.

Assemblage 9: Mafic to intermediate mafic volcanics that occur on Coveney Island and extend southward. This assemblage overlies assemblage 8.

Assemblage 10: Amphibolite facies metavolcanics that may represent the oldest assemblage in the area.

The Sturgeon Lake - Squaw Lake volcanic - sedimentary sequence has been deformed by a minimum of three phases of folding and faulting. Faulting is possibly associated with all phases of folding. The large regional fault zones; (The Sturgeon Narrows Fault and the Northeast Arm Fault) are conformable to initial foliation and stratigraphy.

The later faults are transgressive to the regional foliation.

6.0 1995 EXPLORATION PROGRAM

The 1995 Equator Mining Corp. exploration program commenced on July 20 and was completed on August 23. Major Management Exploration Services of Saskatoon, Saskatchewan supervised the program. The surface exploration program consisted of line cutting, ground geophysics, prospecting; locating, refurbishing and sampling of old trenches and one old addit was discovered in exploration process.

6.1 PROSPECTING

The prospecting traverses, gold showings and associated assay results are shown on MAP #2. Two gold showings and old trenches (A and B) were cleaned off and sampled. A description of the showings are as follows:

Showing_A

This showing is located on the north side of Rainbow Island. The showing consists of an west north west trending mineralized vuggy quartz vein occurring within a granodiorite. The western extension of the quartz vein is transected by a north north east trending diabase dyke. The gold mineralized quartz vein where exposed is approximately 4' in width. Detailed sampling is not possible at the present time due to excessive amounts of very coarse blasted rubble covering the trench. Samples taken from the showing range from 100 ppb to 340 ppb Au.

Showing_B

This gold showing is located on a small island approximately 2300' south east of Showing A. The sulphides within the quartz vein are strongly oxidized giving the entire exposed area of the quartz vein a red - brown appearance. The gold bearing quartz vein is approximately 2' in width and has a limited exposure of approximately 8' due to the strike extremities extending below the waters of Sturgeon Lake. Samples taken from this showing range from 340 ppb to 540 ppb Au.

Showing_C

This gold showing is located on the south end of the peninsula that extends into the junction of the North East Arm and the East Bay of Sturgeon Lake; near the south boundary of claim No. 1162854. The long overgrown addit was rediscovered by R. Major while on a prospecting traverse over the peninsula, a small opening was observed on the hill side, surrounded by forest growth. The opening was cleared of bush and debris and revealed a large addit



Fig. No. 1



FIG NO. 2

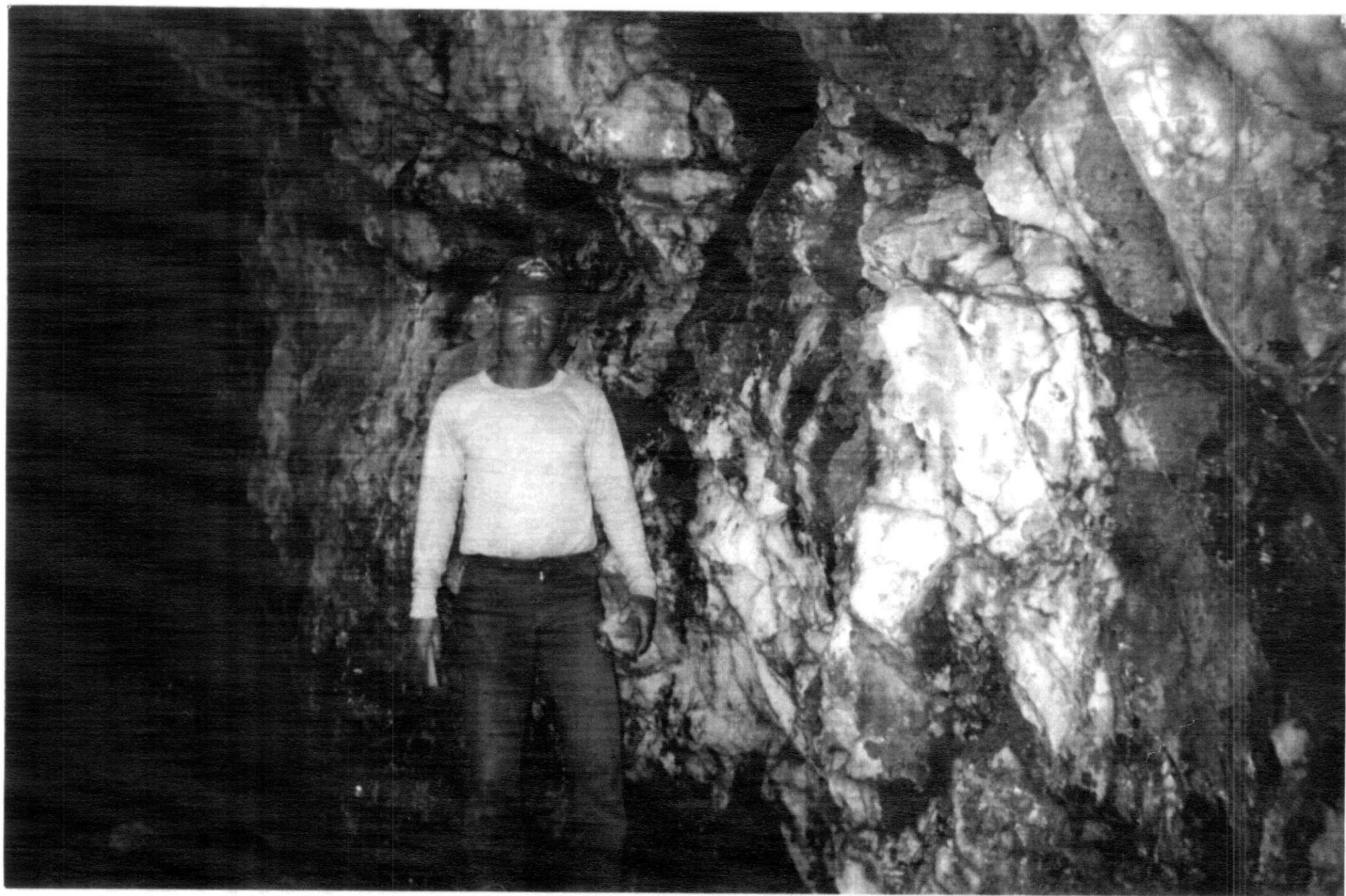

Fig No.3

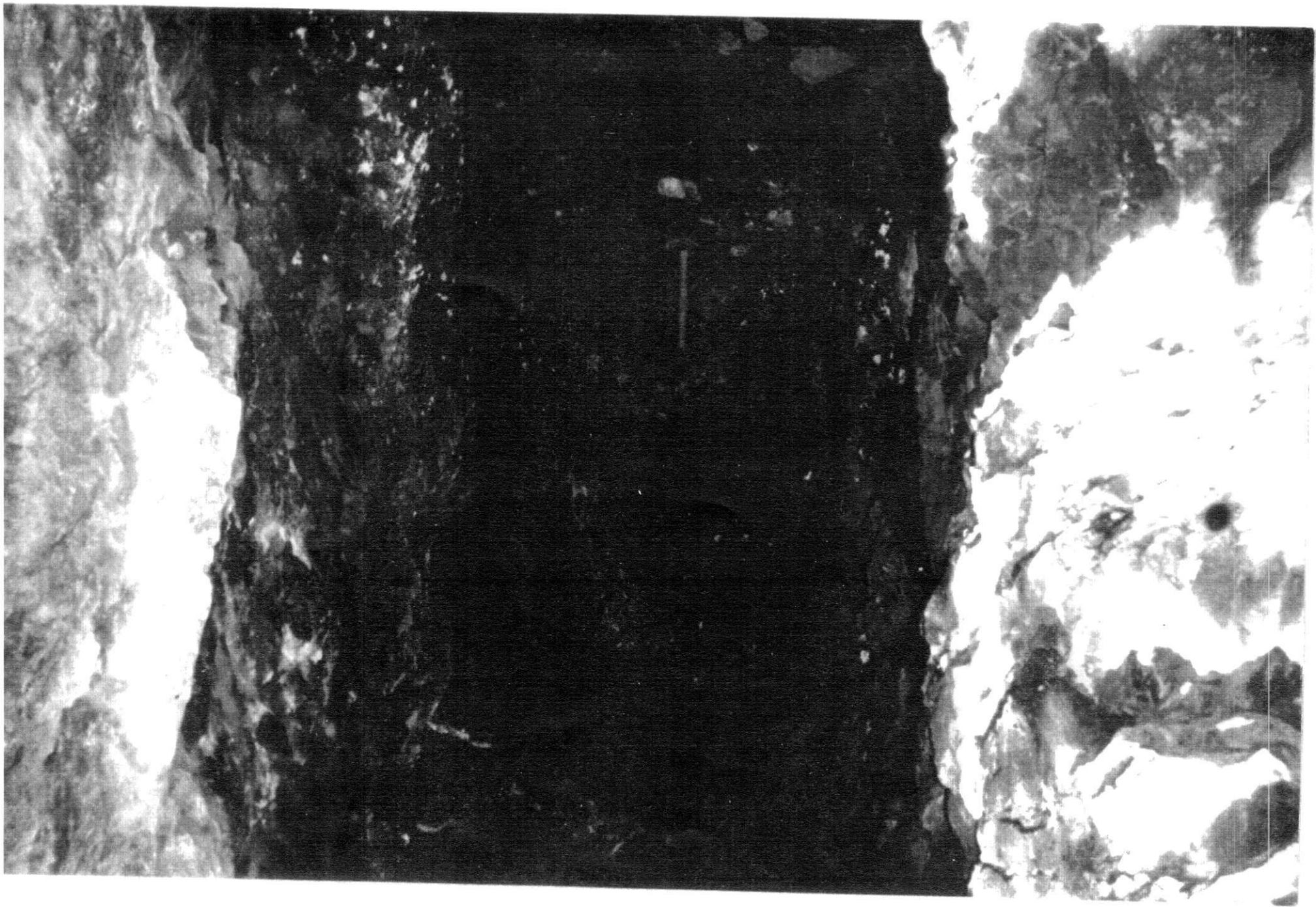

FIG. NO. 4

approximately 8' x 8' and some 30' in length. The addit had been collared in a large rusty quartz vein. Subsequent research revealed that this addit was blasted and worked between the years 1898 and 1904. Photos of this discovery are reproduced on Figs. 1, 2, 3, and 4. Samples taken on the east wall of the addit range from 170 ppb Au to 0.210 oz/ton.

Showing D

This is a small quartz exposure on the north east corner of a small island approximately 1600' east of Showing B. The quartz vein occurs along the water line and is approximately 1' in width. Strike length is obscured by lake water. Sulphides, including pyrite and pyrrhotite occur within the quartz. Samples taken from this showing range from 210 ppb to 250 ppb Au.

6.2 GEOPHYSICS

A 30 kilometer line cutting program was carried out on claims: 1162887, 1162859, 1124731, 1124732, 1124734, 1124735 and 1162888 (Map # 3) for the purpose of ground control for an EM - 16 geophysical survey. The purpose of the geophysical survey was to test for possible gold bearing shear zones. The geophysical instrument used for the survey was a Geonics EM - 16 using the Seattle Washington station. The EM - 16 survey identified five weak east - west trending narrow anomalies (see Map # 3).

7.0 CONCLUSIONS

Four gold bearing quartz veins were identified as a result of the prospecting program. Showings A, B, C and D have not been adequately mapped, trenched or sampled to determine if diamond drilling is warranted. The limited exploration by Equator Mines Corp. indicates that these sulphide and gold bearing quartz veins require additional geological investigation.

The EM - 16 geophysical survey identified five weak, narrow anomalies, that do not appear to be related to any significant mineralized zones or structures.

8.0 RECOMMENDATIONS

As a follow up to the 1995 summer prospecting program that identified four gold bearing quartz veins of generally unknown dimensions and gold content, additional exploration on the property is recommended. A future mineral exploration program should include some regional geological mapping, detailed mapping

of the known showings, trenching of the showings for the purpose of sampling. A grid should be established to cover the entire area hosting the known showings for control of ground magnetic and electromagnetic surveys. The geophysical surveys should be carried out in an attempt to correlate the known gold showings.

9.0 REFERENCES

Trowell, N.F. (1983) Geology of the Squaw Lake - Sturgeon Lake Area District of Thunder Bay; Ontario Geological Survey, Report 227.

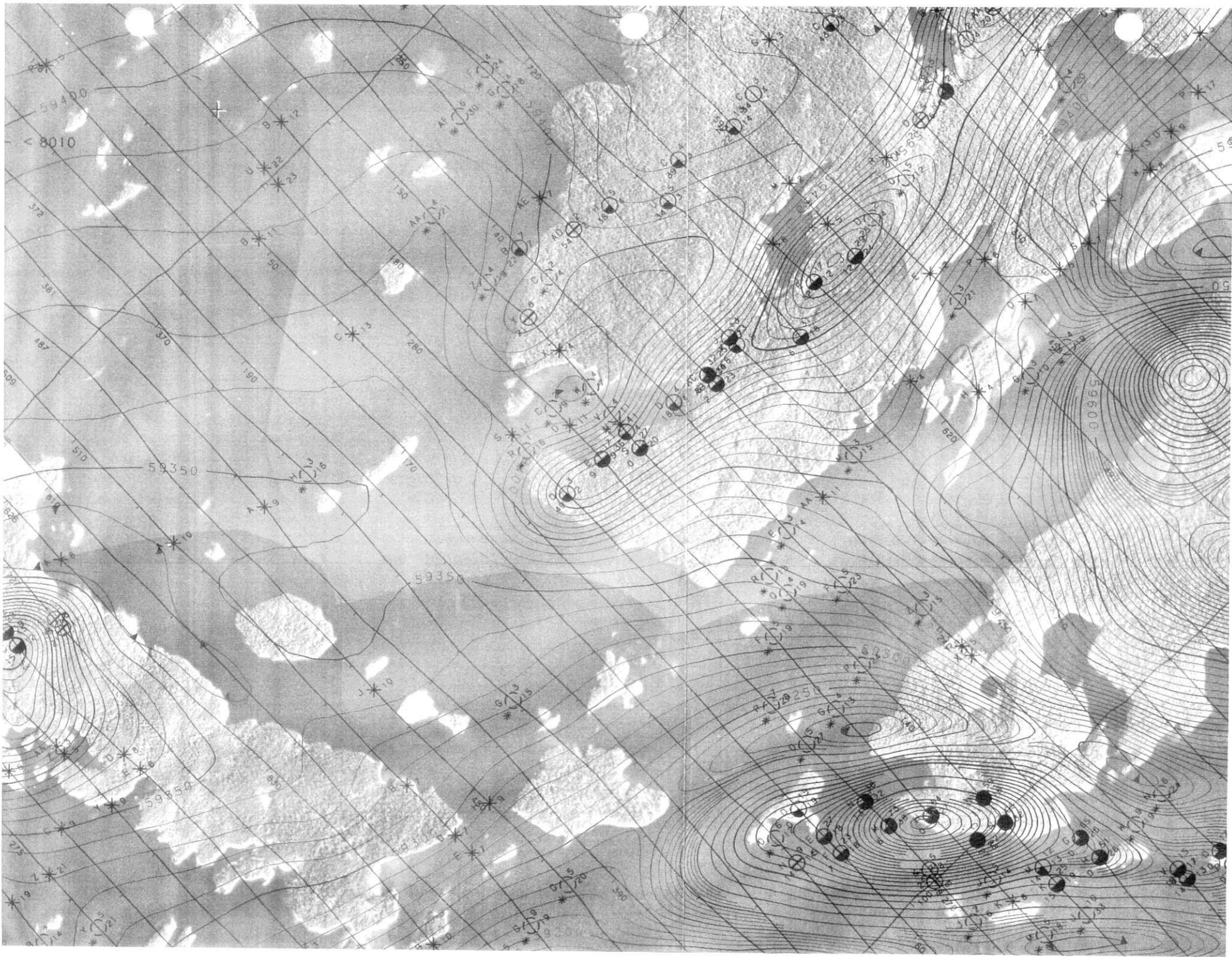

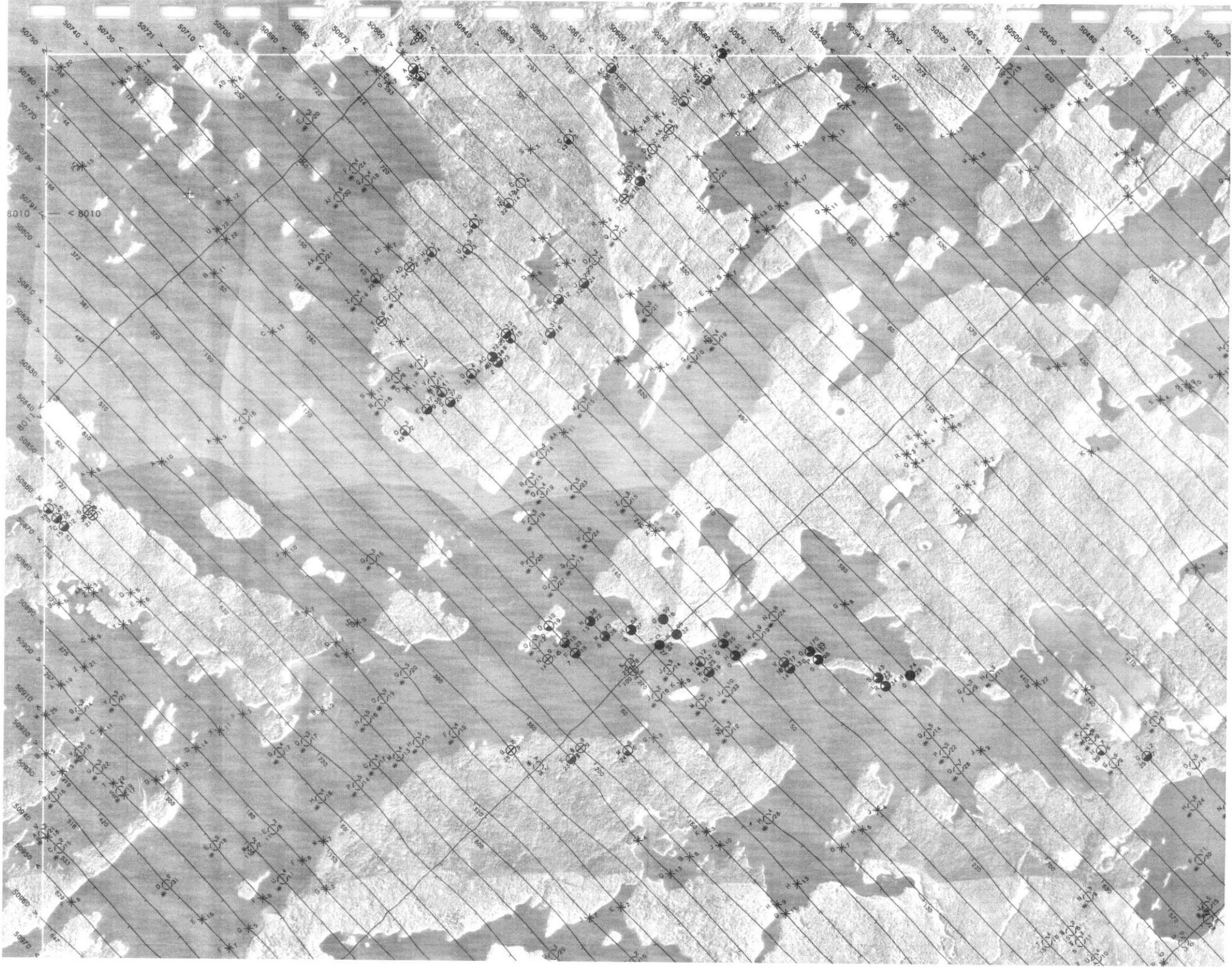

APPENDIX A



T S L LABORATORIES

DIVISION OF THE ASSAYERS INC.

2 - 302 - 48th STREET,
SASKATOON, SASKATCHEWAN
S7K 6A4

☎ (306) 931-1033 FAX. (306) 242-4717

CERTIFICATE OF ANALYSIS

SAMPLE(S) FROM

Arista Resources Inc.
Suite 1010 - 99 West Hastings Street
Vancouver, B.C.
V6C-2W2

REPORT No.

S1227

SAMPLE(S) OF

Rock

INVOICE #: 25008

P.O.:

	Au
	ppb
1020303	35
1020304	110
1020302	300/340
1020301	540/500

COPIES TO: W. Martin, B. Major
INVOICE TO: Arista Resources Inc.

Aug 31, 95

SIGNED

T S L LABORATORIES

DIVISION OF TSL ASSAYERS INC.

2 - 302 - 48 th STREET.
SASKATOON, SASKATCHEWAN
S7K 6A4

☎ (306) 931-1033 FAX: (306) 242-4717

CERTIFICATE OF ANALYSIS

SAMPLE(S) FROM

Arista Resources Inc.
Suite 1010 - 99 West Hastings Street
Vancouver, B.C.
V6C-2W2

REPORT No.

S1228

SAMPLE(S) OF

Rock

INVOICE #: 25009

P.O.:

	Au ppb	Au ozt	Ag ppm	As ppm
102305	10			
102306	95		<.2	
102307	130			
102308	170			<20
102309	160			<20
102310	310/340			
102311	70			
102312	270/270			
102313	290			
102314	75			
102315	250			
102316	80			
102317	15			
102318	210/210			
102319	210			
102320	>1000	.065/.048/.073		

COPIES TO: W. Martin, B. Major
INVOICE TO: Arista Resources Inc.

Aug 31/95

SIGNED



APPENDIX B

Report of Work Conducted After Recording Claim

Transaction Number
W9630.00022

Mining Act

Information collected on this form is obtained under the authority of the Mining Act. This information will be used for correspondence. Questions about collection should be directed to the Provincial Manager, Mining Lands, Ministry of Northern Development and Mines, Fourth Floor, 159 Cedar Street, Toronto, Ontario, P3E 6A5 telephone (705) 670-7264.

- Instructions:**
- Please type or print and submit in duplicate
 - Refer to the Mining Act and Regulations for Recorder.
 - A separate copy of this form must be completed
 - Technical reports and maps must accompany
 - A sketch, showing the claims the work is associated with



900

Recorded Holder(s) ESMATOR MINING CORP	Client No. 300107
Address 420-625 HOWE STREET, VANCOUVER B.C.	Telephone No. 604 687-6288
Recording Division STRATHMORE MINING DIV	Township/Area SQUAW LAKE
Dates Work Performed From: AUGUST 1995	To: SEPT 30, 1995
	M or G Plan No. M 2456

Work Performed (Check One Work Group Only)

Work Group	Type
Geotechnical Survey	
Physical Work, Including Drilling	PROSPECTING/SAMPLING PROGRAM ETC
Rehabilitation	(W20 - PMAN/PROSP/ASSAY)
Other Authorized Work	
Assays	
Assignment from Reserve	

RECEIVED
MAY 27 1996
MINING LANDS BRANCH

Advised to #22236

Total Assessment Work Claimed on the Attached Statement of Costs \$ **5,550.**

Note: The Minister may reject for assessment work credit all or part of the assessment work submitted if the recorded holder cannot verify expenditures claimed in the statement of costs within 30 days of a request for verification.

Persons and Survey Company Who Performed the Work (Give Name and Address of Author of Report)

Name	Address
MATCH MANAGEMENT (R.J. MATCH)	302-325 KINGSMEAD BLVD SASKATOON S4K 1R1 S7J 4J6

(attach a schedule if necessary)

Certification of Beneficial Interest * See Note No. 1 on reverse side

I certify that at the time the work was performed, the claims covered in this work report were recorded in the current holder's name or held under a beneficial interest by the current recorded holder.

Date: **April 20/96** Recorded Holder or Agent (Signature): *[Signature]*

Certification of Work Report

I certify that I have a personal knowledge of the facts set forth in this Work report, having performed the work or witnessed same during and/or after its completion and annexed report is true.

Name and Address of Person Certifying: **WALTER C. MARTIN, 420-625 HOWE STREET, VANCOUVER B.C. V6C 2T6**

Telephone No.: **604 687-6288** Date: **April 20/96** Certified By (Signature): *[Signature]*

For Office Use Only

Total Value Cr. Recorded	Date Recorded 96 APR 09	Mining Recorder <i>[Signature]</i>	Received Stamp First Received 96 APR 09
	Deemed Approval Date	Date Approved	
	Date Notice for Amendments Sent 96 MAY 23 FAXED/XPRESSPOST		



Ontario

AFRI

Ministry of
Northern Development
and Mines

Ministère du
Développement du Nord
et des Mines

P.O. Box 3000
Sioux Lookout, Ontario
P8T 1C6

96SEP25

Equator Mining Corp.
Attention: Walter C. Martin
420 - 625 Howe Street
Vancouver, B.C.
V6C 2T6

SUBJECT: APPROVAL OF ASSESSMENT WORK FILED ON W9630.00022
AREA OF SQUAW LAKE G-3140, PATRICIA MINING DIVISION

Assessment credits have been approved as follows:

MINING CLAIM #	PERFORMED	APPLIED
Pa. 1068213	\$ 800	\$ 800
Pa. 1150292	\$ 2400	\$ 2400
Pa. 1162852	\$ 800	\$ 800
Pa. 1162853	\$ 1200	\$ 1200
Pa. 1162854	\$ 1800	\$ 1800
Pa. 1162855	\$ 1800	\$ 1800
Pa. 1162856	\$ 800	\$ 800
Pa. 1162857	\$ 800	\$ 800
Pa. 1162858	\$ 800	\$ 800
Pa. 1162883	\$ 3600	\$ 3600
Pa. 1162884	\$ 3000	\$ 3000
Pa. 1162913	\$ 3236	\$ 3236
Pa. 1162917	\$ 1200	\$ 1200

This schedule reflects the acceptable costs outlined on the 45 notification submitted on 96MAY22 in the total amount of \$ 22236. These credits have been approved under Section (9) of the Mining Act Regulations.

THE APPROVAL DATE IS 96APR09.

If you have any questions regarding this correspondence, please contact myself at the following numbers.

Yours truly,

Sharon Kemash
Acting Mining Recorder
Patricia Mining Division
TEL: 807:737-2034
FAX: 807:737-1727

Ministry of
Northern Development
and Mines
Ministère du
Développement du Nord
et des mines

Statement of Costs
for Assessment Credit

État des coûts aux fins
du crédit d'évaluation

Mining Act/Loi sur les mines

Transaction No./N° de transaction

96-22

Personal information collected on this form is obtained under the authority of the Mining Act. This information will be used to maintain a record and ongoing status of the mining claim(s). Questions about this collection should be directed to the Provincial Manager, Minings Lands, Ministry of Northern Development and Mines, 4th Floor, 159 Cedar Street, Sudbury, Ontario P3E 6A5, telephone (705) 670-7264.

Les renseignements personnels contenus dans la présente formule sont recueillis en vertu de la Loi sur les mines et serviront à tenir à jour un registre des concessions minières. Adresser toute question sur la collecte de ces renseignements au chef provincial des terrains miniers, ministère du Développement du Nord et des Mines, 159, rue Cedar, 4^e étage, Sudbury (Ontario) P3E 6A5, téléphone (705) 670-7264.

1. Direct Costs/Coûts directs

Type	Description	Amount Montant	Totals Total global
Wages Salaires	Labour Main-d'oeuvre	4300	
	Field Supervision Supervision sur le terrain	6500	10,800
Contractor's and Consultant's Fees Droits de l'entrepreneur et de l'expert- conseil	Type MINING MAN	5500	
	ASSESS	300	5,800
Supplies Used Fournitures utilisées	Type FUEL OIL	500	
			500
Equipment Rental Location de matériel	Type BOAT	400	
	TRUCK	1,000	1,400
Total Direct Costs Total des coûts directs			18,530

2. Indirect Costs/Coûts indirects

** Note: When claiming Rehabilitation work indirect costs are not allowable as assessment work.
Pour le remboursement des travaux de réhabilitation, les coûts indirects ne sont pas admissibles en tant que travaux d'évaluation.

Type	Description	Amount Montant	Totals Total global
Transportation Transport	Type		
Food and Lodging Nourriture et hébergement	LODGING FOOD ET	420 1596 1575	4091
Mobilization and Demobilization Mobilisation et démobilisation			
Sub Total of Indirect Costs Total partiel des coûts indirects			4091
Amount Allowable (not greater than 20% of Direct Costs) Montant admissible (n'excedent pas 20 % des coûts directs)			3706
Total Value of Assessment Credit (Total of Direct and Allowable indirect costs)			22236
Valeur totale du crédit d'évaluation (Total des coûts directs et indirects admissibles)			

Notes: The recorded holder will be required to verify expenditures claimed in this statement of costs within 30 days of a request for verification. If verification is not made, the Minister may reject for assessment work all or part of the assessment work submitted.

Note: Le titulaire enregistré sera tenu de vérifier les dépenses demandées dans le présent état des coûts dans les 30 jours suivant une demande à cet effet. Si la vérification n'est pas effectuée, le ministre peut rejeter tout ou une partie des travaux d'évaluation présentés.

Billing Discounts

Work filed within two years of completion is claimed at 100% of the above Total Value of Assessment Credit.

Work filed three, four or five years after completion is claimed at 50% of the above Total Value of Assessment Credit. See calculations below:

Total Value of Assessment Credit	Total Assessment Claimed
x 0.50 =	

Certification Verifying Statement of Costs

I hereby certify:
that the amounts shown are as accurate as possible and these costs are incurred while conducting assessment work on the lands shown in the accompanying Report of Work form.

as RECORDED HOLDER I am authorized
(Recorded Holder, Agent, Position in Company)

to make this certification

Remises pour dépôt

1. Les travaux déposés dans les deux ans suivant leur achèvement sont remboursés à 100 % de la valeur totale susmentionnée du crédit d'évaluation.

2. Les travaux déposés trois, quatre ou cinq ans après leur achèvement sont remboursés à 50 % de la valeur totale du crédit d'évaluation susmentionné. Voir les calculs ci-dessous.

Valeur totale du crédit d'évaluation	Evaluation totale demandée
x 0,50 =	

Attestation de l'état des coûts

J'atteste par la présente:
que les montants indiqués sont le plus exact possible et que ces dépenses ont été engagées pour effectuer les travaux d'évaluation sur les terrains indiqués dans la formule de rapport de travail ci-joint.

Et qu'à titre de RECORDED HOLDER je suis autorisé
(titulaire enregistré, représentant, poste occupé dans la compagnie)

à faire cette attestation.

Signature [Signature]

Work Report Number for Applying Reserve	Claim Number (see Note 2)	Number of Claim Units	Value of Assessed Work Done on the Claim	Value Applied to the Claim	Value Assigned from the Claim	Reserve: Work to be Claimed at a Future Date
	116284	9	1800	1800		
	1162855	6	1800	1800		
	1162853	3	1200	1200		
	1150292	12	2400	2400		
	1068223	1	800	800		
	1162417	3	1200	1200		
	1162852	1	800	800		
	1162856	2	800	800		
	1162883	12	3600	3600		
	1162884	14	3000	3000		
	1162857	2	800	800		
	1162858	2	800	800		
	1162913	8	3236	3236		
Total Number of Claims	13	75	22236	22236		

Credits you are claiming in this report may be cut back. In order to minimize the adverse effects of such deletions, please indicate from which claims you wish to prioritize the deletion of credits. Please mark (✓) one of the following:

1. Credits are to be cut back starting with the claim listed last, working backwards.
2. Credits are to be cut back equally over all claims contained in this report of work.
3. Credits are to be cut back as prioritized on the attached appendix.

In the event that you have not specified your choice of priority, option one will be implemented.

Note 1: Examples of beneficial interest are unrecorded transfers, option agreements, memorandum of agreements, etc., with respect to the mining claims.

Note 2: If work has been performed on patented or leased land, please complete the following:

I certify that the recorded holder had a beneficial interest in the patented or leased land at the time the work was performed.	Signature 	Date 12/22/96
---	--	------------------

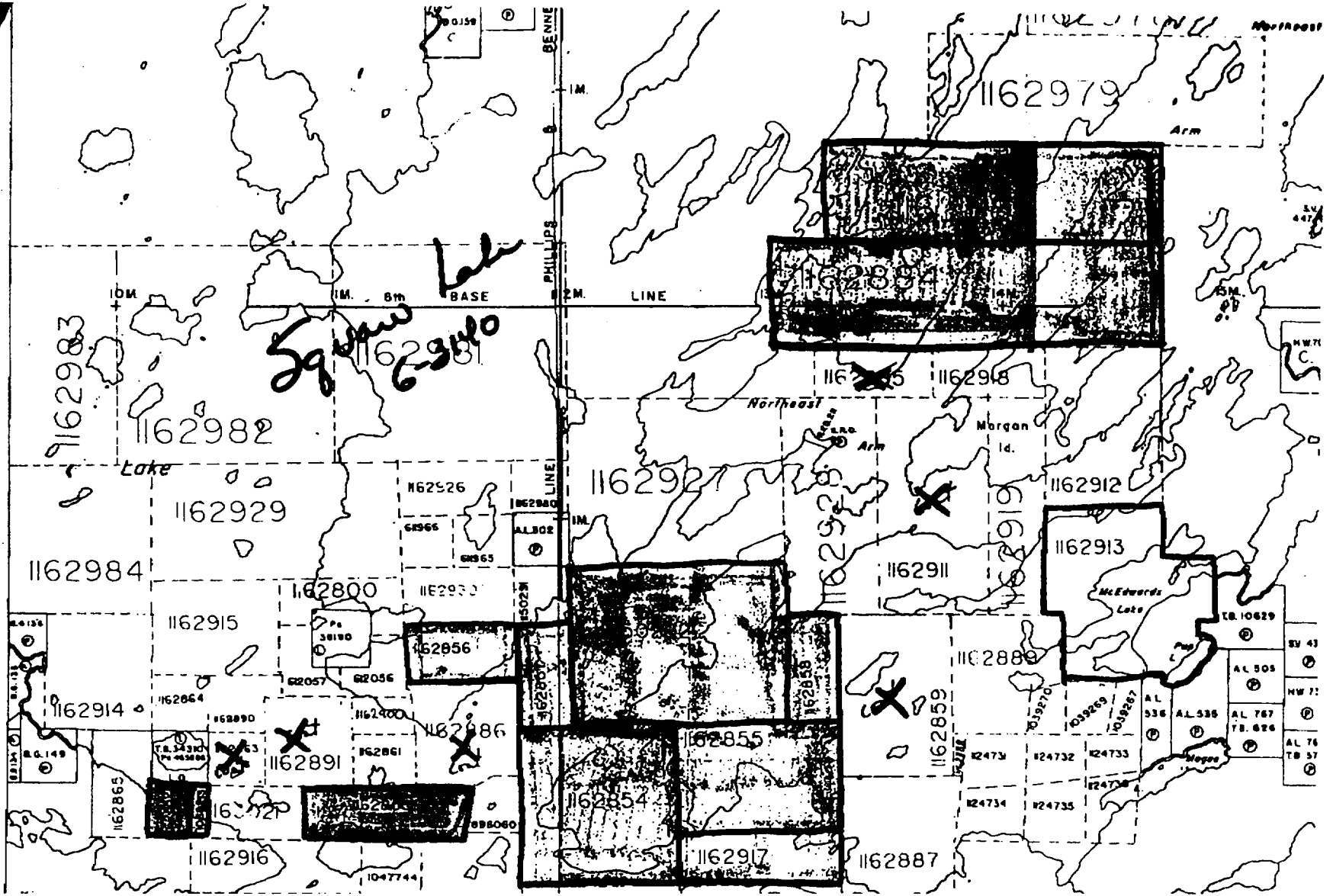

SV 43
HW 77
AL 505
AL 535
AL 767
AL 78
AL 76
TB 57

Apr 21/84 A
Mar 21/84 B
Mar 21/84 C
Mar 21/84 D
Mar 21/84 E
Mar 21/84 F
Mar 21/84 G
Mar 21/84 H
Mar 21/84 I
Mar 21/84 J
Mar 21/84 K
Mar 21/84 L
Mar 21/84 M
Mar 21/84 N
Mar 21/84 O
Mar 21/84 P
Mar 21/84 Q
Mar 21/84 R
Mar 21/84 S
Mar 21/84 T
Mar 21/84 U
Mar 21/84 V
Mar 21/84 W
Mar 21/84 X
Mar 21/84 Y
Mar 21/84 Z

Beckington Lake Area G-2532

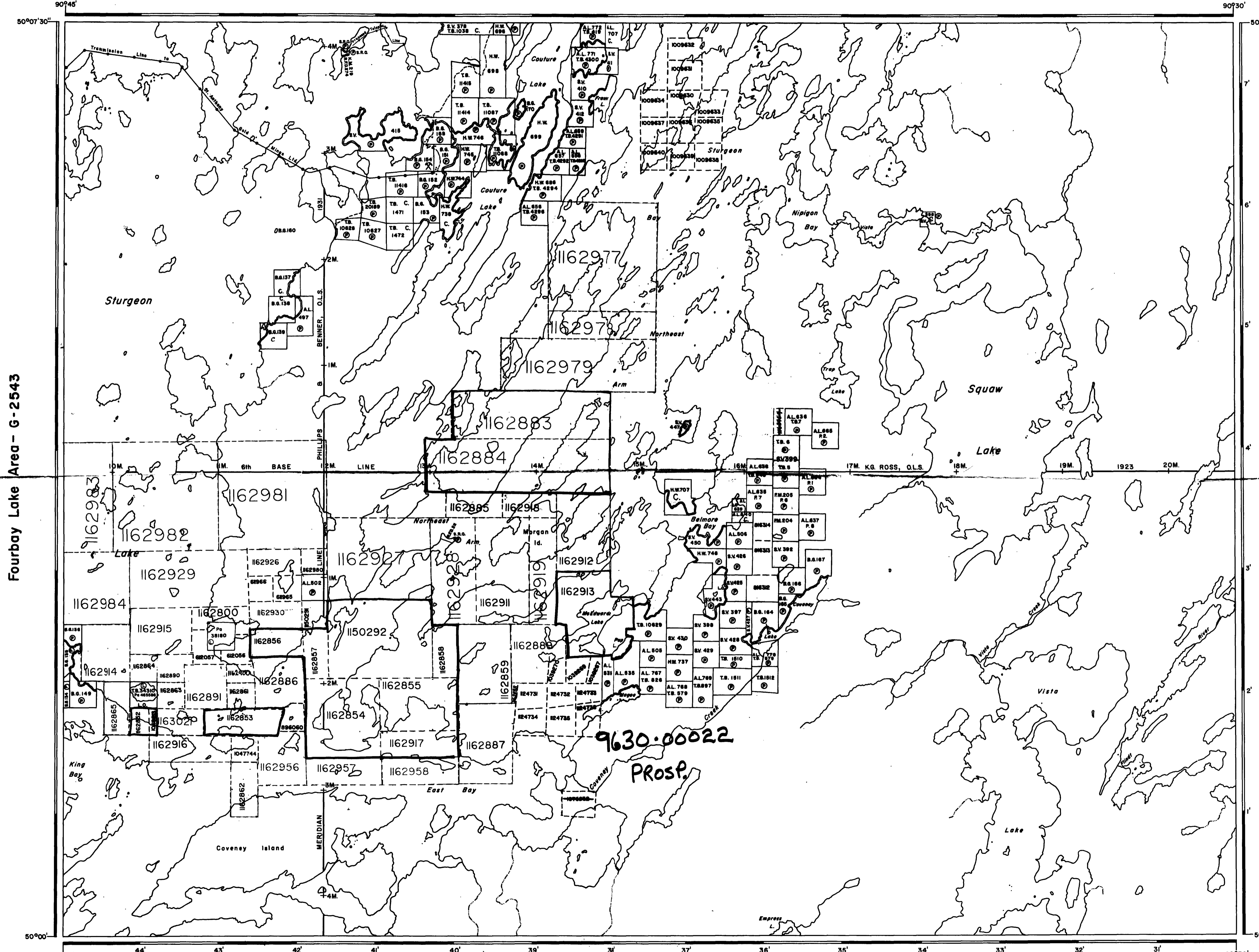

2 165 6 4

RECEIVED
MAY 27 1996
MINING LANDS BRANCH

LEGEND

- PATENTED LAND (C.S.)
- CROWN LAND SALE (C.S.)
- LEASES (C.S.)
- LOCATED LAND (L.O.)
- LICENSE OF OCCUPATION (L.O.)
- MINING RIGHTS ONLY (M.R.O.)
- SURFACE RIGHTS ONLY (S.R.O.)
- ROADS
- IMPROVED ROADS
- KING'S HIGHWAYS
- RAILWAYS
- POWER LINES
- MARSH OR MUSKEG
- MINES
- CANCELLED (C.)

REFERENCES

AREAS WITHDRAWN FROM DISPOSITION

M.R.O. - MINING RIGHTS ONLY
S.R.O. - SURFACE RIGHTS ONLY
M.+S. - MINING AND SURFACE RIGHTS

Description	Order No.	Date	Disposition	File
-------------	-----------	------	-------------	------

Fourbay Lake Area - G-2543

Sesaganaga Lake Area - G-2524

96 MAY 23 AM 10:07

Quest Lake Area - G-2556

9630.00022
PROSP.

AREA
SQUAW LAKE
M.N.R. ADMINISTRATIVE DISTRICT
DRYDEN
MINING DIVISION
PATRICIA
LAND TITLES / REGISTRY DIVISION
THUNDER BAY



Ministry of Natural Resources
Land Management Branch
Ontario

Date FEBRUARY, 1984

Number

G-3140



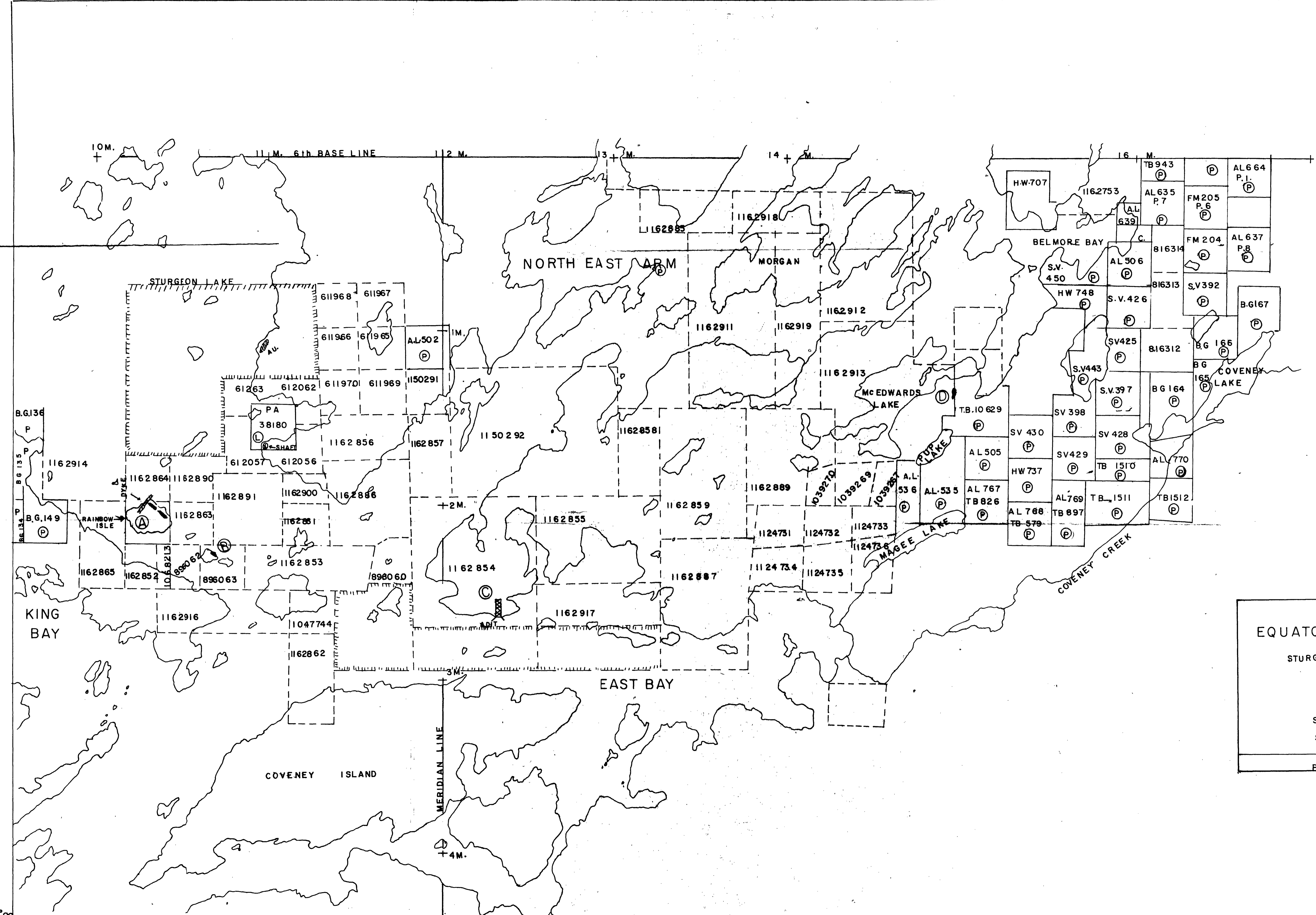

2.16564

DUPLICATE COPY

RECEIVED

MAY 27 1996

MINING LANDS BRANCH

EQUATOR MINING CORP.

STURGEON LAKE ONTARIO

NTS G-3140

SCALE 4" = 1 MILE

SQUAW LAKE

PROPERTY MAP 1

50°00'



210

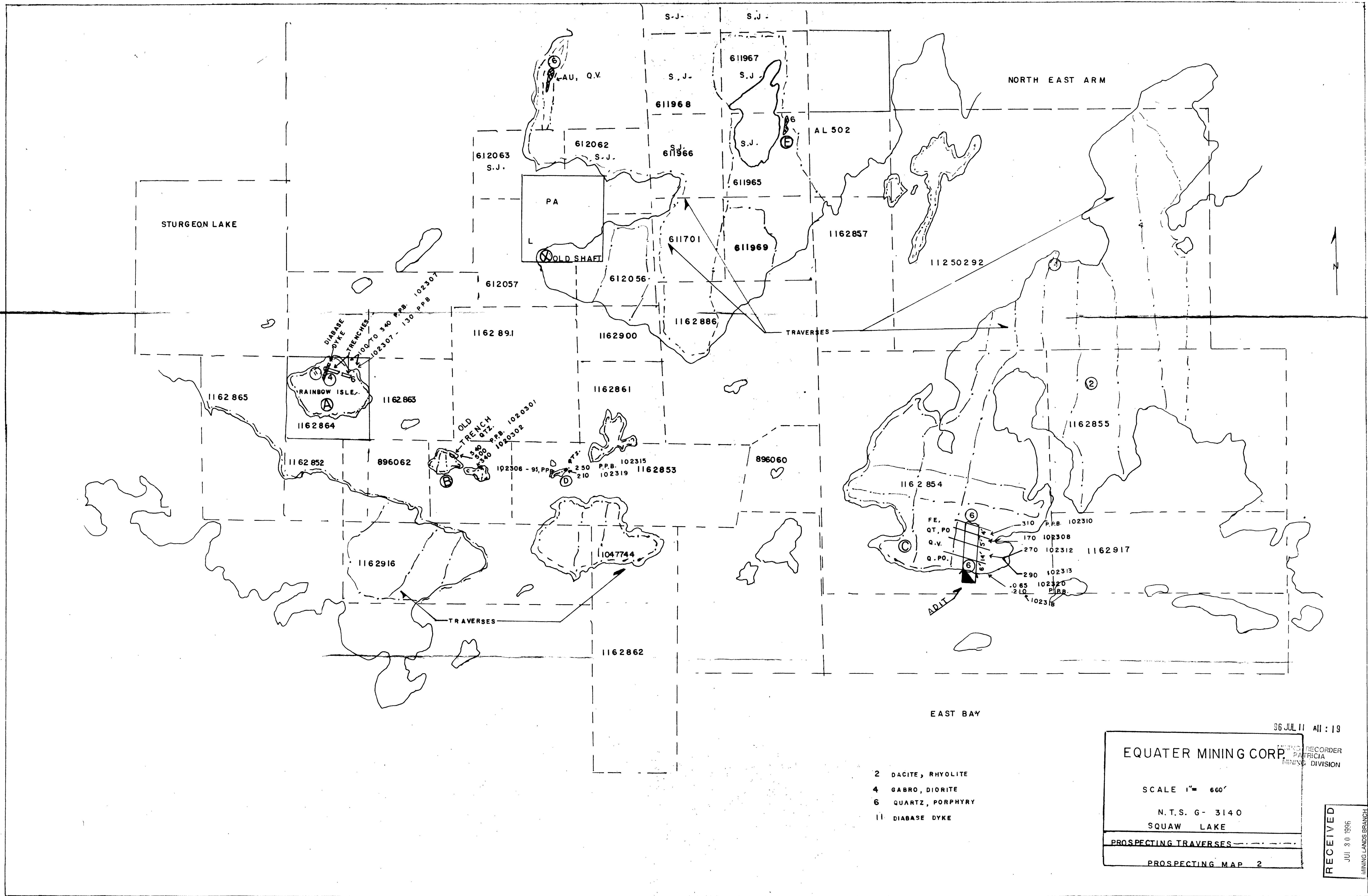

96 JUL 11 AM 1:19
 EQUATER MINING CORP. RECORDING DIVISION
 SCALE 1" = 660'
 N.T.S. G- 3140
 SQUAW LAKE
 PROSPECTING TRAVERSES
 PROSPECTING MAP 2

RECEIVED
 JUL 30 1996
 MINING LANDS BRANCH

2.16564