

Report of Prospecting

①

Claim P.A. 612056

Total time spent on this venture
was 10 days. MAY 4 to May 13 1997

2 days were spent on road
travel: Riverton, Man. to Savant Lake Ont.
return - total 900 miles **2.17700**

3½ days were lost because
of ice jam 3 miles north of the claim

4½ days were spent prospecting

Dates worked: May 8 - ½ day

May 9 - 10 - 11 - 12 full days

all prospecting was done on
anomaly area of claim P.A. 612056

Some minor stripping was ~~done~~ **RECEIVED**
on shears in gabbro.

SEP 19 1997
8:30
GEOSCIENCE ASSESSMENT
OFFICE

2

Nothing of particular interest was found.

all work was done by Ed Robercki and Joel Robercki of Riverton Manitoba

2.17700

E. L. Robercki

RECEIVED
SEP 16 1997
3:30
GEOSCIENCE ASSESSMENT
OFFICE

SURVEYED CLAIM P.A. 38180 (L)

Jan 21 98 23:40 No. 003 P.02
TEL: 13782832
RIVERTON BLDG SUPPLY

STURGEON LAKE

URVEY LINE

P.A. CLAIM 612057

BLOW DOWN AREA
ALL TREES BROKEN

TRAVERSES IN THIS AREA
ALL TREES BROKEN
VERY LITTLE ROCK EXPOSED

AREA STRIPPED

BOUNDARY POSTS SURVEY LINE

GABBRO ROCK

BLOW DOWN AREA
ALL TREES BROKEN BY HIGH WINDS

P.A. CLAIM 612056

SHORE LINE
GABBRO ROCK

PROSPECTING IN THIS AREA

STANDING WHITE PINE

GABBRO 40' WIDE 500' LONG

STANDING TIMBER

TURBEON LAKE

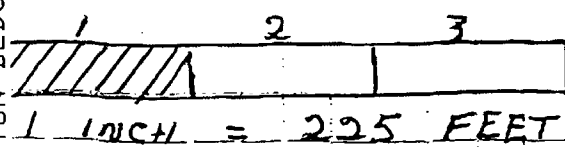

PLAN OF PROSPECTING
ON CLAIM P.A. 612056
STURGEON NARROWS AREA
SQUAW LAKE MAP G3140

Ed Roberech

MAGNETIC NORTH

PAGE. 02
13782832
JAN 21 '98 13:56

SURVEYED CLAIM P.A. 38180 (L)

Jan 21 98 23:41 No.003 P.03

STURGEON LAKE

MAGNETIC NORTH

PAGE: 03 13782832

CLAIM PA 612056

RICKABY MINE OPEN CUT

CLAIM 612057

B.P. 350' 45° 300' B.P.

19" YELLOW QUARTZ VEIN

6" RUSTY QUARTZ VEIN

95% IRON

24" IRON FORMATION

STURGEON LAKE

TEL: 13782832 RIVERTON BLDG SUPPLY

PLAN OF IRON FORMATION STRIPPED
LOCATION: 350 FEET EAST OF WEST BOUNDARY OF CLAIM PA. 612056
5 FEET SOUTH OF NORTH BOUNDARY (CUT SURVEY LINE)

Ed Roberech

JAN 21 '98 13:57

GEOSCIENCE ASSESSMENT

10 DATE TIME TD/FROM
01/12 14:43 13782832

MODE MIN/SEC PGS CMD# STATUS
G3--S 00'35" 001 097 OK

RIVERTON BLDG SUPPLY TEL:13782832

Sep 19 97 1:45 No.002 P.05

PLAN OF PROSPECTING
ON CLAIM P.A. 612056 STURGEON NARROWS
SQUAW LAKE MAP THUNDER BAY DISTRICT

Ed Pollock

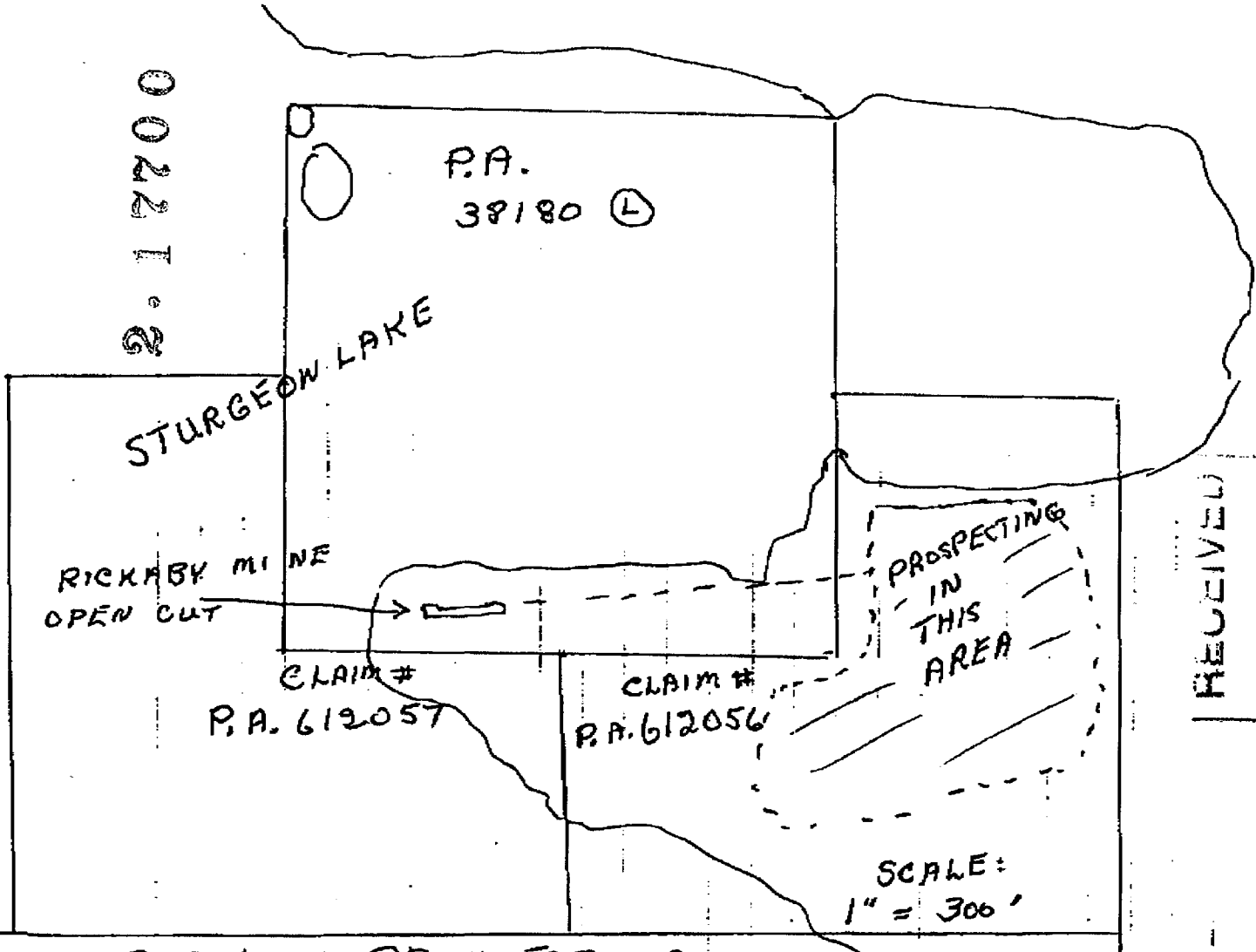

2. 12200

RECEIVED

SEP 19 1997
8:30

GEOSCIENCE ASSESSMENT
OFFICE

NORTH



Ministry of Northern Development and Mines

Declaration of Assessment Work Performed on Mining Land

Mining Act, Subsection 65(2) and 66(3), R.S.O. 1990

Transaction Number (office use) 129730.00435 Assessment Files Research Imaging

Personal information collected on this form is obtained under the authority of subsections 65(2) and 66(3) of the Mining Act. Under section 8 of the Mining Act, the information is to be made available to the public and correspond with the mining land holder. Questions about this form should be directed to the Ministry of Northern Development and Mines, 6th Floor, 933 Ramsey Lake Road

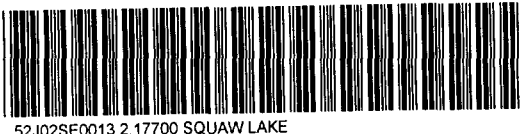

52J02SE0013 2.17700 SQUAW LAKE

Instructions: - Form 0240 - Print

900 e form 0240.

1. Recorded holder(s) (Attach a list if necessary)

Name: EDWARD ARTHUR ROBERECKI Client Number: 188074 Address: Box 472 Riverton, MB. Roc 2R0 Telephone Number: 204-378-5298 or 2157 Fax Number: 2157

2. Type of work performed: Check (✓) and report on only ONE of the following groups for this declaration.

Geotechnical: prospecting, surveys, assays and work under section 18 (regs) [checked] Physical: drilling, stripping, trenching and associated assays [checked] Rehabilitation [unchecked]

Work Type: PROSPECTING Office Use: Commodity, Total \$ Value of Work Claimed, NTS Reference, Mining Division, Resident Geologist District. Dates Work Performed: From 4/05/97 to 10/05/97 (10 days). Township/Area: SQUAW LAKE M or G-Plan Number: G 3140

- Please remember to: - obtain a work permit from the Ministry of Natural Resources as required; - provide proper notice to surface rights holders before starting work; - complete and attach a Statement of Costs, form 0212; - provide a map showing contiguous mining lands that are linked for assigning work; - include two copies of your technical report.

3. Person or companies who prepared the technical report (Attach a list if necessary)

Name: EDWARD ROBERECKI Telephone Number: 204-378-5298 Address: Box 472 Riverton, MB Roc 2R0 Fax Number: 2157

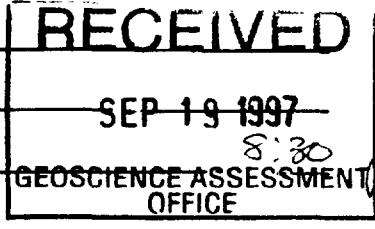

4. Certification by Recorded Holder or Agent

I, EDWARD ROBERECKI (Print Name), do hereby certify that I have personal knowledge of the facts set forth in this Declaration of Assessment Work having caused the work to be performed or witnessed the same during or after its completion and, to the best of my knowledge, the annexed report is true.

Signature of Recorded Holder or Agent: Ed Roberneck Date: December 18/97 Agent's Address: Telephone Number: 204-378-5298 Fax Number: 204-378-2757

6. Work to be recorded and distributed. Work can only be assigned to claims that are contiguous (adjoining) to the mining land where work was performed, at the time work was performed. A map showing the contiguous link must accompany this form.

W9736.00435

Mining Claim Number. Or if work was done on other eligible mining land, show in this column the location number indicated on the claim map.	Number of Claim Units. For other mining land, list hectares.	Value of work performed on this claim or other mining land.	Value of work applied to this claim.	Value of work assigned to other mining claims.	Bank. Value of work to be distributed at a future date.
eg TB 7827	16 ha	\$26,825	N/A	\$24,000	\$2,825
eg 1234567	12	0	\$24,000	0	0
eg 1234568	2	\$8,892	\$4,000	0	\$4,892
1 PA612056	1	2350 ⁰⁰	1350 ⁰⁰	1000 ⁰⁰	0
2 PA612057	1	0	1000 ⁰⁰	0	0
3					
4					
5					
6					
7					
8					
9					
10					
11					
12					
13					
14					
15					
Column Totals		2350 ⁰⁰	2350 ⁰⁰	1000 ⁰⁰	

2.17.97

I, EDWARD ROBERECKI, do hereby certify that the above work credits are eligible under subsection 7 (1) of the Assessment Work Regulation 6/96 for assignment to contiguous claims or for application to the claim where the work was done.

Signature of Recorded Holder or Agent Authorized in Writing

Date SEPT 18/97

6. Instructions for cutting back credits that are not approved.

Some of the credits claimed in this declaration may be cut back. Please check (✓) in the boxes below to show how you wish to prioritize the deletion of credits:

- 1. Credits are to be cut back from the Bank first, followed by option 2 or 3 or 4 as indicated.
- 2. Credits are to be cut back starting with the claims listed last, working backwards; or
- 3. Credits are to be cut back equally over all claims listed in this declaration; or
- 4. Credits are to be cut back as prioritized on the attached appendix or as follows (describe):

IF ANY CREDITS ARE CUT BACK THEY SHOULD BE CUT BACK FROM PA612057

Note: If you have not indicated how your credits are to be deleted, credits will be cut back from the Bank first, followed by option number 2 if necessary.

For Office Use Only
Received Stamp

RECEIVED
SEP 19 1997
8:30
GEOSCIENCE ASSESSMENT
OFFICE

Deemed Approved Date	Date Notification Sent
Date Approved	Total Value of Credit Approved
Approved for Recording by Mining Recorder (Signature)	

January 22, 1998

EDWARD ARTHUR ROBERECKI
P.O. BOX 472
RIVERTON, MANITOBA
R0C-2R0

Geoscience Assessment Office
933 Ramsey Lake Road
6th Floor
Sudbury, Ontario
P3E 6B5

Telephone: (888) 415-9846
Fax: (705) 670-5881

Dear Sir or Madam:

Submission Number: 2.17700

Status

Subject: Transaction Number(s): W9730.00435 Approval After Notice

We have reviewed your Assessment Work submission with the above noted Transaction Number(s). The attached summary page(s) indicate the results of the review. **WE RECOMMEND YOU READ THIS SUMMARY FOR THE DETAILS PERTAINING TO YOUR ASSESSMENT WORK.**

If the status for a transaction is a 45 Day Notice, the summary will outline the reasons for the notice, and any steps you can take to remedy deficiencies. The 90-day deemed approval provision, subsection 6(7) of the Assessment Work Regulation, will no longer be in effect for assessment work which has received a 45 Day Notice.

Please note any revisions must be submitted in **DUPLICATE** to the Geoscience Assessment Office, by the response date on the summary.

If you have any questions regarding this correspondence, please contact Lucille Jerome by e-mail at jeromel2@epo.gov.on.ca or by telephone at (705) 670-5858.

Yours sincerely,



ORIGINAL SIGNED BY
Blair Kite
Supervisor, Geoscience Assessment Office
Mining Lands Section

Work Report Assessment Results

Submission Number: 2.17700

Date Correspondence Sent: January 22, 1998

Assessor: Lucille Jerome

Transaction Number	First Claim Number	Township(s) / Area(s)	Status	Approval Date
W9730.00435	612056	SQUAW LAKE	Approval After Notice	January 21, 1998

Section:

9 Prospecting PROSP

The revisions outlined in the Notice dated December 8, 1997, have been corrected. Accordingly, assessment work credit has been approved as outlined on the Declaration of Assessment Work Form accompanying this submission.

Correspondence to:

Resident Geologist
Sioux Lookout, ON

Recorded Holder(s) and/or Agent(s):

EDWARD ARTHUR ROBERECKI
RIVERTON, MANITOBA

Assessment Files Library
Sudbury, ON

Beckington Lake Area G-2532

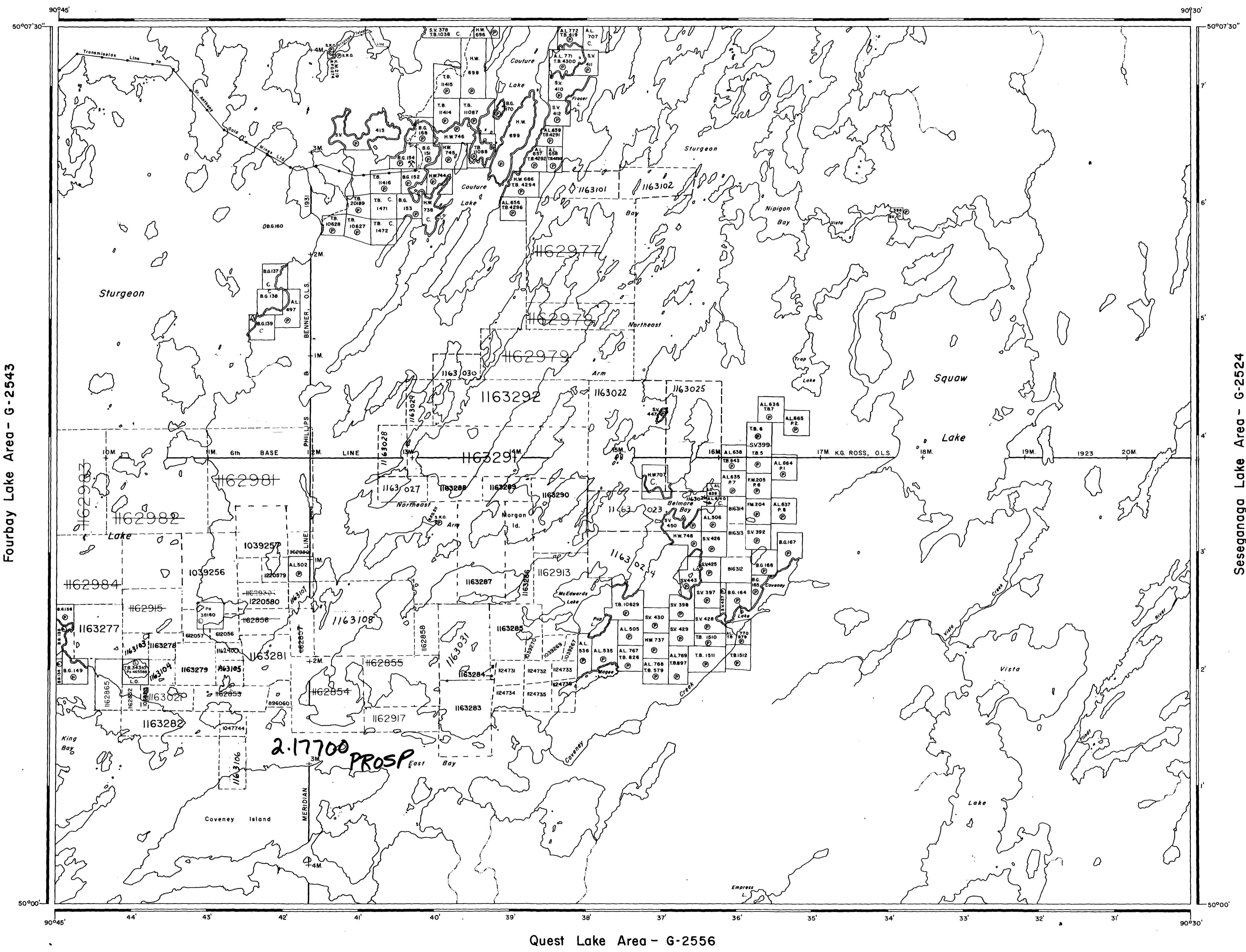

LEGEND

- PATENTED LAND
- CROWN LAND SALE LEASES
- LOCATED LAND
- LICENSE OF OCCUPATION
- MINING RIGHTS ONLY
- SURFACE RIGHTS ONLY
- ROADS
- IMPROVED ROADS
- KING'S HIGHWAYS
- RAILWAYS
- POWER LINES
- MARSH OR MUSKEG
- MINES
- CANCELLED

REFERENCES

AREAS WITHDRAWN FROM DISPOSITION

M.R.O. - MINING RIGHTS ONLY
 S.R.O. - SURFACE RIGHTS ONLY
 M + S. - MINING AND SURFACE RIGHTS

Description	Order No.	Date	Disposition	File

DATE OF ISSUE

JAN 27 1986
 PROVINCIAL RECORDING OFFICE - SUDBURY

AREA
SQUAW LAKE
 M.N.R. ADMINISTRATIVE DISTRICT
DRYDEN
 MINING DIVISION
PATRICIA
 LAND TITLES / REGISTRY DIVISION
THUNDER BAY

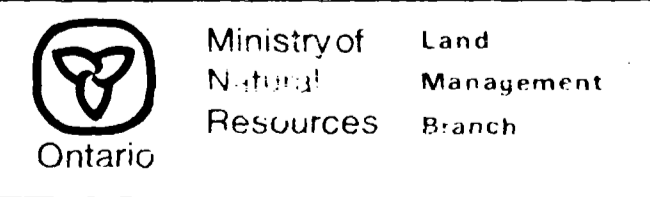

Date FEBRUARY, 1984
 Number: **G-3140**

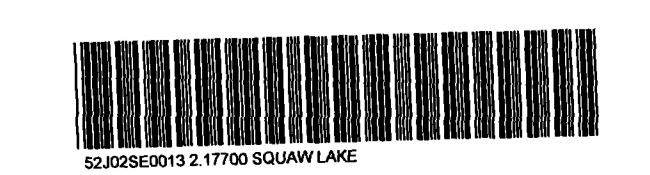

Jan 29/94 (Rec)
 94 MAR 04 (R)
 23 24 25 26 27 28 29 30 31 32 33 34 35 36 37 38 39 40 41 42 43 44 45 46 47 48 49 50 51 52 53 54 55 56 57 58 59 60 61 62 63 64 65 66 67 68 69 70 71 72 73 74 75 76 77 78 79 80 81 82 83 84 85 86 87 88 89 90 91 92 93 94 95 96 97 98 99 100
 96 AUG 04 (R)
 97 MAR 17 (R)

Fourbay Lake Area - G-2543

Sesegonaga Lake Area - G-2524

Quest Lake Area - G-2556

2.17700 PROSP East Bay