



52J02SE8661 41 SQUAW LAKE

010

DIAMOND DRILLING

AREA: SQUAW LAKE

REPORT NO: 41

WORK PERFORMED FOR: Villeneuve Resources Ltd.

RECORDED HOLDER: Same as Above [xx]
: Other []

<u>Claim No.</u>	<u>Hole No.</u>	<u>Footage</u>	<u>Date</u>	<u>Note</u>
902143	B-87-4	223'	Dec/87	(1)
	B-87-5	183'	Dec/87	(1)

406

NOTES: (1) #W8803.266, filed Feb/89

Claim # PA 902143

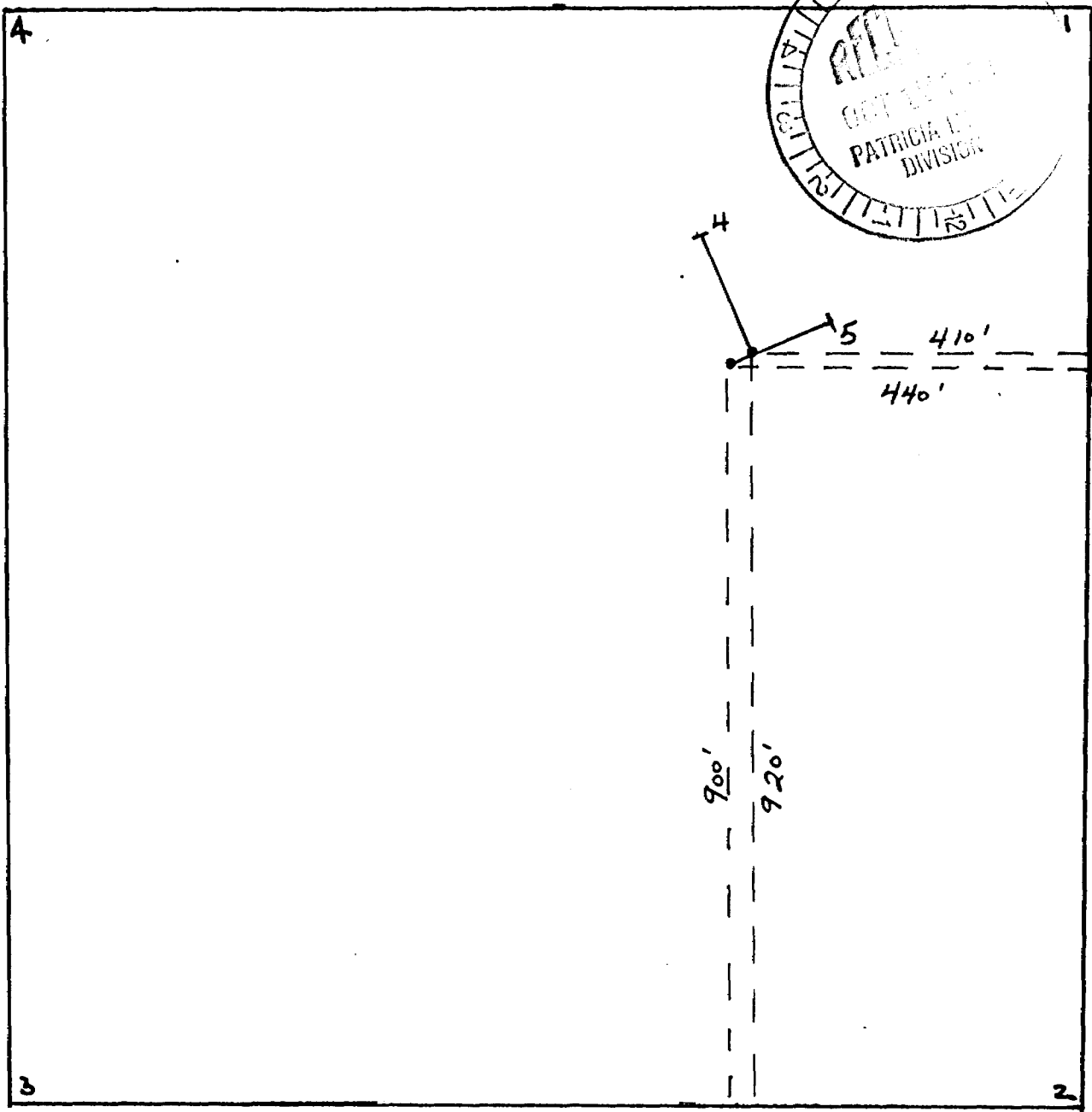
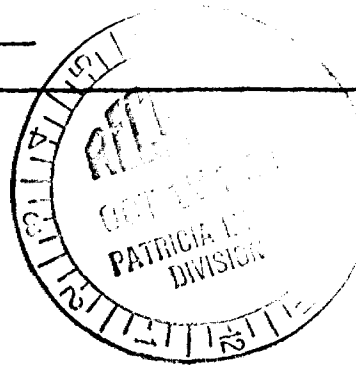

HOLE : B 87-4

COLLARED : DEC. 2, 1987

COMPLETED : DEC. 5, 1987

DIP : -45°

BEARING : 333°

DEPTH : 223'

HOLE : B87-5

COLLARED : DEC. 6, 1987

COMPLETED : DEC. 7, 1987

DIP : -45°

BEARING : 70°

DEPTH : 183'

Scale 1"=200'

VILLENEUVE RESOURCES LTD.

On claims 902143 - On east side at base of prominent peninsular, PENINSULAR SHOWING.

Best Claims, Sturgeon Lake

Sheet No. 1 of 7 Hole No. B-87-4

Property

N.T.S. 52 J-2

Core Size: BQ

Project No.

Collared 2 Dec. 1987

Logged by: Dick Janes and George Giga.

Lat.

Elev.

Dip

-45°

Completed

5 Dec. 1987

Dem.

Depth

223 ft.

Bearing

333°

ASSAYS

Footage	Rec'y	Rock Type/Alteration	Graphic Log	Mineralization/Structure	% Sulfides	Sample No.	Li.	Au										
0 - ~17		Casing and overburden.																
~17 - ^47		<u>Felsic intrusive.</u> Light grey green, variably but generally highly silicified, ground mass aphanitic. Mafic component chloritized, variable content, average 5-10%.		disseminated Crystalline Py.	1-2													
~17 - 23.0		Chlorite tends to occur as discrete masses and shreds - if present Py. tends to accompany it.		Fractured. Quartz vein 1/4 in. Quartz + carb. + chlorite > Py. irregular vein 45°. Quartz + py. > carb. + chlorite vein 3/8, 24°. Irregular masses of Quartz + carb. < 1 1/2 ins.	1-2	702	6.0	Tr.										
23.0- 28.0	92			Quartz > carb. + chlorite + Py. vein, approx. 3, irregular. Quartz > carb. + chlorite > Py. vein 1/4, 48°.	1-2	703	5.0	Tr.										
				Irregular masses of Quartz + carb. > chlorite. Quartz + white mica >> Py. + chlorite vein, approx. 90°, ground.														
				Quartz + screens of wall rock (light green) >> chlorite + Py., irregular vein 3 ins.														

ONTARIO GEOLOGICAL SURVEY
ASSESSMENT FILES
OFFICE
NOV 18 1988
RECEIVED

VILLENEUVE RESOURCES LTD.

Best Claims, Sturgeon Lake

Sheet No. 1 of 3 Hole No. B-87-5

On claim 902143, On west side at base of prominent

Property

narrow peninsular peninsular showing.

Project No.

N.T.S. 52 J-2

Core Size: BQ

Lt.

Elev.

Dip

-45°

Collared

6 Dec. 1987.

Logged by:

Dick Janes and George Giga

Dep.

Depth

183 ft.

Bearing

70°

Completed

7 Dec. 1987

ASSAYS

Footage	Rec'y	Rock Type/Alteration	Graphic Log	Mineralization/Structure	% Sulfides	Sample No.	Lt.	ASSAYS												
								Au												
0 - 8.5		Casing and overburden.																		
8.5- 130.8		<u>Felsic Volcanic Breccia</u>																		
		Strongly silicified, light grey, structure not entirely clear down to approx. 70. Some felsic intrusive could be present but doubtful.		Occasional Quartz + carbonate veins very minor Py, then as local streaks volc clasts down to approx. 30' shown same stretching of interior frag.																
		Extent of oxidation fronts from fractures suggests a high (>10%) carb. content.																		
8.5- 13.0	88				< 1	8302	4.5	.01												
10.0- 12.0				2 shears, one oxidized (core broken) 10°																
13.0- 18.0	95			Quartz vein, 1/4", 44° Irreg. frac. V. minor Py., approx. parallel ca. 2 carb. + Quartz > chlorite veins, 1/8-3/16" - 30°, 20°. Oxidized frac.	< 1	8303	5.0	Tr.												
18.0- 23.0	96	Localized slight flesh coloration.		Oxidized Frac., 60° Frac. with Chl. + Py.	< 1	8304	5.0	Tr.												
23.0- 28.0	92			Quartz + reddish carb. (oxidized) vein 1 1/2"-2", 20° both walls oxidized for several ins. Several fractures oxidized but also reddish.	< 1	8305	5.0	Tr.												

ONTARIO GEOLOGICAL SURVEY

ASSESSMENT FILES
OFFICE

NOV 18 1988

RECEIVED



Assess 118

Mining /

Name and Address of Recorded Holder: VILLENEUVE RESOURCES ENG. LTD.

610, 650 WEST GEORGIA, VANCOUVER, B.C. V6B 4N7

Summary of Work Performance and Distribution of Credits: BECKINGTON LAKE 62532 / SQUAW LAKE 6310

Table with columns for Mining Claim Prefix, Number, Work Days Cr., and Performance of the following work (Manual Work, Shaft Sinking, etc.).

All the work was performed on Mining Claim(s): TB 19535, PA 902143, 902131

Required Information eg: type of equipment, Names, Addresses, etc. (See Table Below)

DRILCOR
OWNER: DARYL FRYE
17 - 7449 HUME AVE.
TILBURY INDUSTRIAL PARK
DELTA, B.C.
V4G 1C3

MINING GEOLOGICAL SURVEY
ASSESSMENT FILES
OFFICE
NOV 18 1988
RECEIVED

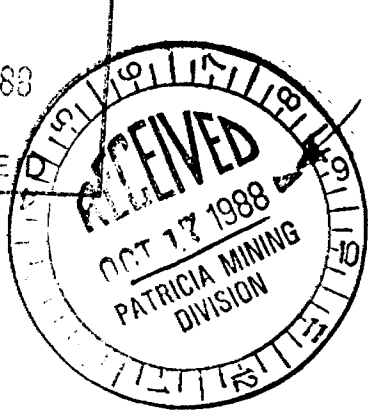

RECORDED

DATE STARTED: DEC. 2, 1987
DATE COMPLETED: DEC. 11, 1987

TYPE OF EQUIPMENT: FLY DRILL
Date of Report: Oct. 11, 1988
Recorded Holder or Agent (Signature): Zoran Madon

Certification Verifying Report of Work

I hereby certify that I have a personal and intimate knowledge of the facts set forth in the Report of Work annexed hereto, having performed the work or witnessed same during and/or after its completion and the annexed report is true.

Name and Postal Address of Person Certifying: ZORAN MADON, 188 ave. PERREAULT, VAL D'OR, QUEBEC

Date Certified: Oct. 11, 1988
Certified by (Signature): Zoran Madon

Table of Information/Attachments Required by the Mining Recorder

Table with 4 columns: Type of Work, Specific information per type, Other information (Common to 2 or more types), Attachments.

11/15/88

SCHEDULE "A": VILLENEUVE/ABH CLAIMS

Page 1

PROJ NAME	TOWNSHIP	TAG NO	WORK DAYS
ABH	BECKINGTON LAKE PA	902109	8.9
ABH	BECKINGTON LAKE PA	902110	↓
ABH	BECKINGTON LAKE PA	902111	
ABH	BECKINGTON LAKE PA	902116	
ABH	BECKINGTON LAKE PA	902117	
ABH	BECKINGTON LAKE PA	902118	
ABH	BECKINGTON LAKE PA	902119	
ABH	BECKINGTON LAKE PA	902120	
ABH	BECKINGTON LAKE PA	902121	↓
ABH	BECKINGTON LAKE PA	902122	
ABH	BECKINGTON LAKE PA	902123	
ABH	BECKINGTON LAKE PA	902124	
ABH	BECKINGTON LAKE PA	902125	
ABH	BECKINGTON LAKE PA	902126	
ABH	BECKINGTON LAKE PA	902127	8.9
ABH	BECKINGTON LAKE PA	902128	↓
ABH	BECKINGTON LAKE PA	902129	
ABH	BECKINGTON LAKE PA	902130	
ABH	BECKINGTON LAKE PA	902131	
ABH	BECKINGTON LAKE PA	902132	
ABH	BECKINGTON LAKE PA	902133	
ABH	BECKINGTON LAKE PA	902134	
ABH	BECKINGTON LAKE PA	902135	
ABH	BECKINGTON LAKE PA	902136	
ABH	BECKINGTON LAKE PA	902137	
ABH	BECKINGTON LAKE PA	902138	
ABH	BECKINGTON LAKE PA	902139	
ABH	BECKINGTON LAKE PA	902140	
ABH	BECKINGTON LAKE PA	902141	
ABH	SQUAW LAKE PA	902142	
ABH	SQUAW LAKE PA	902143	
ABH	SQUAW LAKE PA	902144	
ABH	SQUAW LAKE PA	902145	
ABH	BECKINGTON LAKE PA	902146	
ABH	BECKINGTON LAKE PA	902147	
ABH	BECKINGTON LAKE PA	902148	
ABH	BECKINGTON LAKE PA	902149	
ABH	BECKINGTON LAKE PA	902150	
ABH	BECKINGTON LAKE PA	902151	
ABH	BECKINGTON LAKE PA	902152	
ABH	BECKINGTON LAKE PA	902153	
ABH	BECKINGTON LAKE PA	902154	0
ABH	BECKINGTON LAKE PA	911541	8.9
ABH	BECKINGTON LAKE PA	911546	0
ABH	BECKINGTON LAKE PA	911547	8.9
ABH	BECKINGTON LAKE PA	911548	↓
ABH	BECKINGTON LAKE PA	911551	
ABH	BECKINGTON LAKE PA	911552	
ABH	BECKINGTON LAKE PA	911553	
ABH	BECKINGTON LAKE PA	911554	
ABH	BECKINGTON LAKE PA	911618	
ABH	BECKINGTON LAKE PA	911619	
ABH	BECKINGTON LAKE PA	911620	

11/15/88

SCHEDULE "A": VILLENEUVE/ABH CLAIMS

Page 2

PROJ NAME	TOWNSHIP	TAG NO	WORK DAYS
ABH	BECKINGTON LAKE	PA 911621	8.9
ABH	BECKINGTON LAKE	PA 911622	↓
ABH	BECKINGTON LAKE	PA 911623	↓
ABH	BECKINGTON LAKE	PA 911624	↓
ABH	BECKINGTON LAKE	PA 911625	14.0
ABH	BECKINGTON LAKE	PA 911626	14.0
ABH	BECKINGTON LAKE	PA 911627	8.9
ABH	BECKINGTON LAKE	PA 911628	↓
ABH	BECKINGTON LAKE	PA 911629	↓
ABH	BECKINGTON LAKE	PA 911630	↓
ABH	BECKINGTON LAKE	PA 911631	↓
ABH	BECKINGTON LAKE	PA 911632	↓
ABH	BECKINGTON LAKE	PA 911678	25.0
ABH	BECKINGTON LAKE	PA 911679	25.9

TOTAL: 604 DAYS

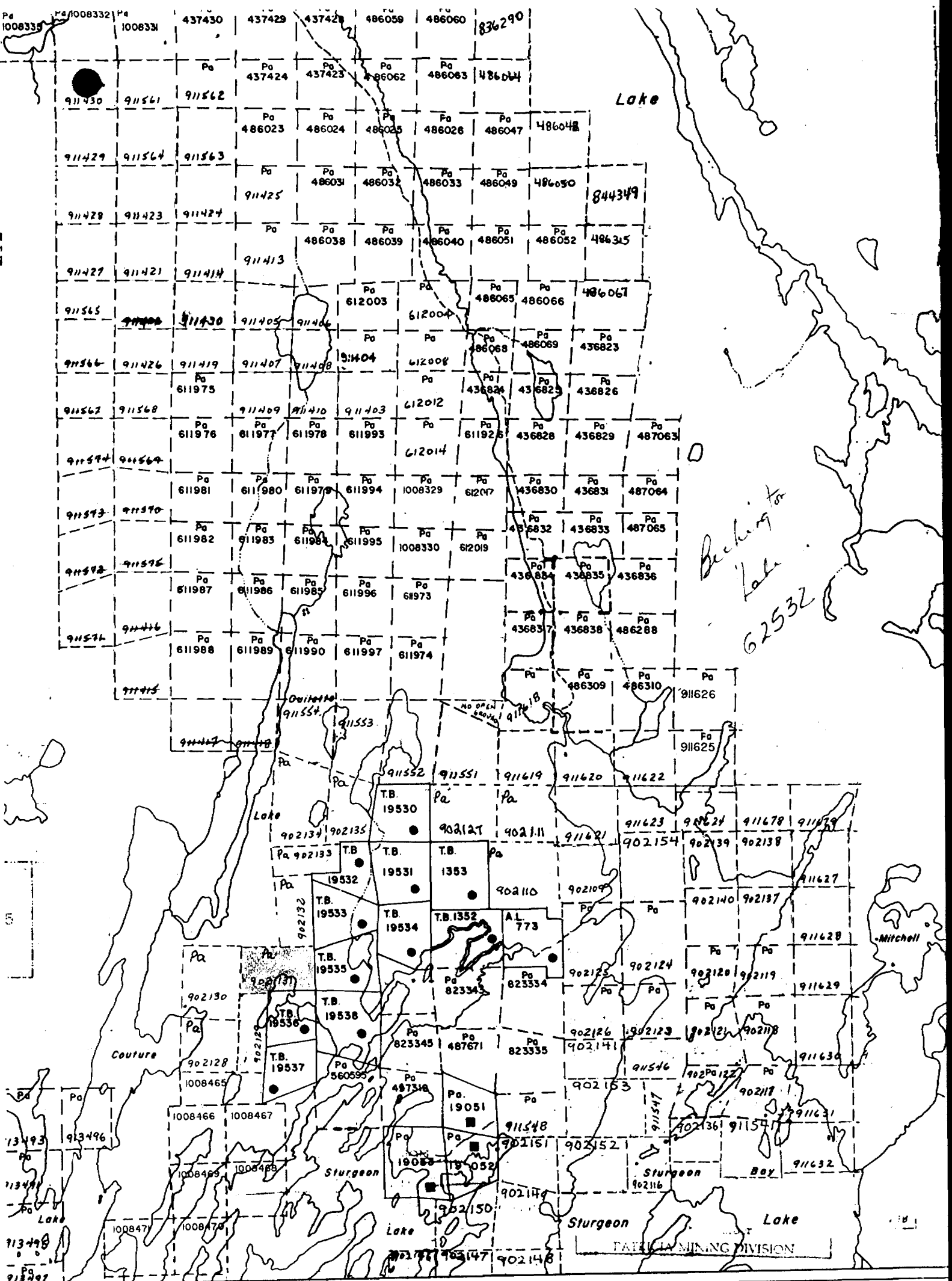

Pa 1008339 Pa 1008332 Pa 1008331

437430 437429 437428 486059 486060 836290

Pa 437424 Pa 437423 Pa 486062 Pa 486063 Pa 486064

911430 911431 911432 Pa 486023 Pa 486024 Pa 486025 Pa 486026 Pa 486047 486048 Lake

911429 911428 911427 Pa 486031 Pa 486032 Pa 486033 Pa 486049 486050 844349

911428 911423 911424 Pa 486038 Pa 486039 Pa 486040 Pa 486051 Pa 486052 486055

911427 911421 911414 911413 Pa 612003 Pa 612004 Pa 486065 Pa 486066 486067

911426 911419 911407 911406 Pa 612004 Pa 486068 Pa 486069 Pa 436823

911426 911419 911407 911406 Pa 611975 Pa 612008 Pa 436824 Pa 436825 Pa 436826

911427 911426 911419 911409 911410 911403 Pa 611976 Pa 611977 Pa 611978 Pa 611993 Pa 612012 Pa 611926 Pa 436828 Pa 436829 Pa 487063

911427 911426 911419 911409 911410 911403 Pa 611976 Pa 611977 Pa 611978 Pa 611993 Pa 612014 Pa 611926 Pa 436828 Pa 436829 Pa 487063

911427 911426 911419 911409 911410 911403 Pa 611981 Pa 611980 Pa 611979 Pa 611994 Pa 1008329 Pa 612017 Pa 436830 Pa 436831 Pa 487064

911427 911426 911419 911409 911410 911403 Pa 611982 Pa 611983 Pa 611984 Pa 611995 Pa 1008330 Pa 612019 Pa 436832 Pa 436833 Pa 487065

911427 911426 911419 911409 911410 911403 Pa 611987 Pa 611986 Pa 611985 Pa 611996 Pa 611973 Pa 436834 Pa 436835 Pa 436836

911427 911426 911419 911409 911410 911403 Pa 611988 Pa 611989 Pa 611990 Pa 611997 Pa 611974 Pa 436837 Pa 436838 Pa 486288

911427 911426 911419 911409 911410 911403 Pa 611988 Pa 611989 Pa 611990 Pa 611997 Pa 611974 Pa 486309 Pa 486310 Pa 911626

911427 911426 911419 911409 911410 911403 Pa 911552 Pa 911551 Pa 911619 Pa 911620 Pa 911622 Pa 911625

911427 911426 911419 911409 911410 911403 Pa 911552 Pa 911551 Pa 911619 Pa 911620 Pa 911622 Pa 911625

911427 911426 911419 911409 911410 911403 Pa 911552 Pa 911551 Pa 911619 Pa 911620 Pa 911622 Pa 911625

911427 911426 911419 911409 911410 911403 Pa 911552 Pa 911551 Pa 911619 Pa 911620 Pa 911622 Pa 911625

911427 911426 911419 911409 911410 911403 Pa 911552 Pa 911551 Pa 911619 Pa 911620 Pa 911622 Pa 911625

911427 911426 911419 911409 911410 911403 Pa 911552 Pa 911551 Pa 911619 Pa 911620 Pa 911622 Pa 911625

911427 911426 911419 911409 911410 911403 Pa 911552 Pa 911551 Pa 911619 Pa 911620 Pa 911622 Pa 911625

911427 911426 911419 911409 911410 911403 Pa 911552 Pa 911551 Pa 911619 Pa 911620 Pa 911622 Pa 911625

911427 911426 911419 911409 911410 911403 Pa 911552 Pa 911551 Pa 911619 Pa 911620 Pa 911622 Pa 911625

911427 911426 911419 911409 911410 911403 Pa 911552 Pa 911551 Pa 911619 Pa 911620 Pa 911622 Pa 911625

911427 911426 911419 911409 911410 911403 Pa 911552 Pa 911551 Pa 911619 Pa 911620 Pa 911622 Pa 911625

911427 911426 911419 911409 911410 911403 Pa 911552 Pa 911551 Pa 911619 Pa 911620 Pa 911622 Pa 911625

38' 37' 36' 35' 34'

