

52J02SE8664 2.11388 SQUAW LAKE

010

REPORT ON
GEOPHYSICAL SURVEYS
ON THE
ROBERECKI PROPERTY
SQUAW LAKE AREA
PATRICIA MINING DIVISION
ONTARIO

RECEIVED

JUL 12 1988

MINING LANDS SECTION

Prepared by:

J. W. Redden, B. Sc.
Box 117
Wabigoon, Ont.

June 12, 1988

Jual
2.1942

Introduction:

The Sturgeon Lake Area has been the scene of mining exploration for almost a hundred years. Numerous Gold Prospects have been discovered. It has only been in the last few years that systematic exploration has been undertaken.

Presently, several Properties in the area are being explored for Gold.

Mr. R. Roberecki of Riverton, Manitoba holds two claims on the east side of the north bay of Sturgeon Lake.

Location and Access

The Roberecki Claims are located in Northwestern Ontario, 30 km southwesterly from Savant Lake, Ontario.

It is most conveniently reached by outboard motor boat from camps along the northwest Part of the lake.

The Claims

The Property consists of two claims; Pa 612056 and Pa 612057. Both claims are in good standing.

Previous Work in Area

The claim block is situated between several small Past-Producers and showings. The area has been actively Prospected for Gold since the 1890's.

No work Prior to the Present owner is on file for the area covered by the claims.

Trenching and stripping has been carried out on the leased claim Pa 38180 adjoining to the north. A high grade Quartz vein carrying considerable chalcoprite was bulk sampled. No assay data is available. The wallrock is highly altered and Pyritized.

Selco carried out a base metal exploration in the late 1960's and early 70's in the area. One hole was drilled 400 feet east of the claim line. The drill log indicates diorite, andesite, a variety of felsic volcanics and Graphite were intersected. Sulphides were Present as was carbonatization. Silicification is not specified but would appear to be Present. Samples were taken but no assays are given. During this Period Gold assays were not routine determinations for most companies due to the general lack of interest in Precious metals.

Mistango carried out Geophysical and Geological surveys during the mid 1980's. Nothing of note was discovered.

E. Robenecki has done stripping, sampling and assaying on the claims. One sample returned 0.2 oz./ton Au across 3'. This sample appears to be from an east-west trending shear near the centre of the claims a few hundred feet south of Pa 38180.

Geology

According to U. G. S. Map 2420 the land Portion of the claims is underlain by mafic volcanics. Granite occurs along the shore of Sturgeon Lake.

The general trend of the volcanics is east-west to east northeast. The trend curves to almost due north within a claim width east of the claims. Parallel to the granitoid contact. The volcanics to the west are truncated by the intrusive granite.

Geophysical Surveys

Magnetic Surveys

The northeast part of the property exhibits a highly erratic magnetic pattern. At least part of this pattern is due to the alteration associated with the vein structure extending from Pa 38180. A tighter spacing will be required to better define the feature.

The very flat pattern over the west part of the claims particularly under the lake indicates the granite exposed on the shoreline continues westward. The lack of spikes indicate a very homogeneous intrusive.

The remainder of the claims exhibit a pattern typical of volcanic terrains. A more detailed survey may allow tracing of individual units within the volcanics. Magnetic lows within these volcanics may represent alteration zones.

VLF Surveys

Both surveys show a strong conductive zone in the northeast part of the property and a parallel weaker zone. They define a zone extending northeastward from Pa 38180 - likely the host structure for the high grade gold-bearing vein.

Over the remainder of the property the response is nil to very weak. The zone on Pa 38180 may continue westward but the response from the VLF is too weak to confirm this theory.

It is interesting to note that the VLF survey carried out on the property adjoining to the south was yielding positive in phase readings at the north ends of their lines. The present survey gave negative in phase readings at the south ends of the lines. It appears that a conductor lies in the vicinity of the common claim boundary.

Conclusions

1. The geophysics located a major anomaly in the northeast part of the property. This appears to represent the continuation of the mineralized zone on Pa 38180 .
2. The magnetics indicate the portion of the property covered by water is underlain by granite.
3. The geophysics did not pick up the zone in the centre of the claims.

Recommendations

1. Detailed prospecting and geological mapping are warranted both to better define the source of the northeast anomaly and to discover other mineralization which does not respond to geophysics.
2. Several VLF lines are warranted to clarify the location and character of the assumed conductor adjacent to the south boundary.
3. Stripping of the northeast anomaly should be done, followed by sampling and assaying. A trench on 1E from 0+75 to 1+50N will expose the entire width of the anomalous zone.

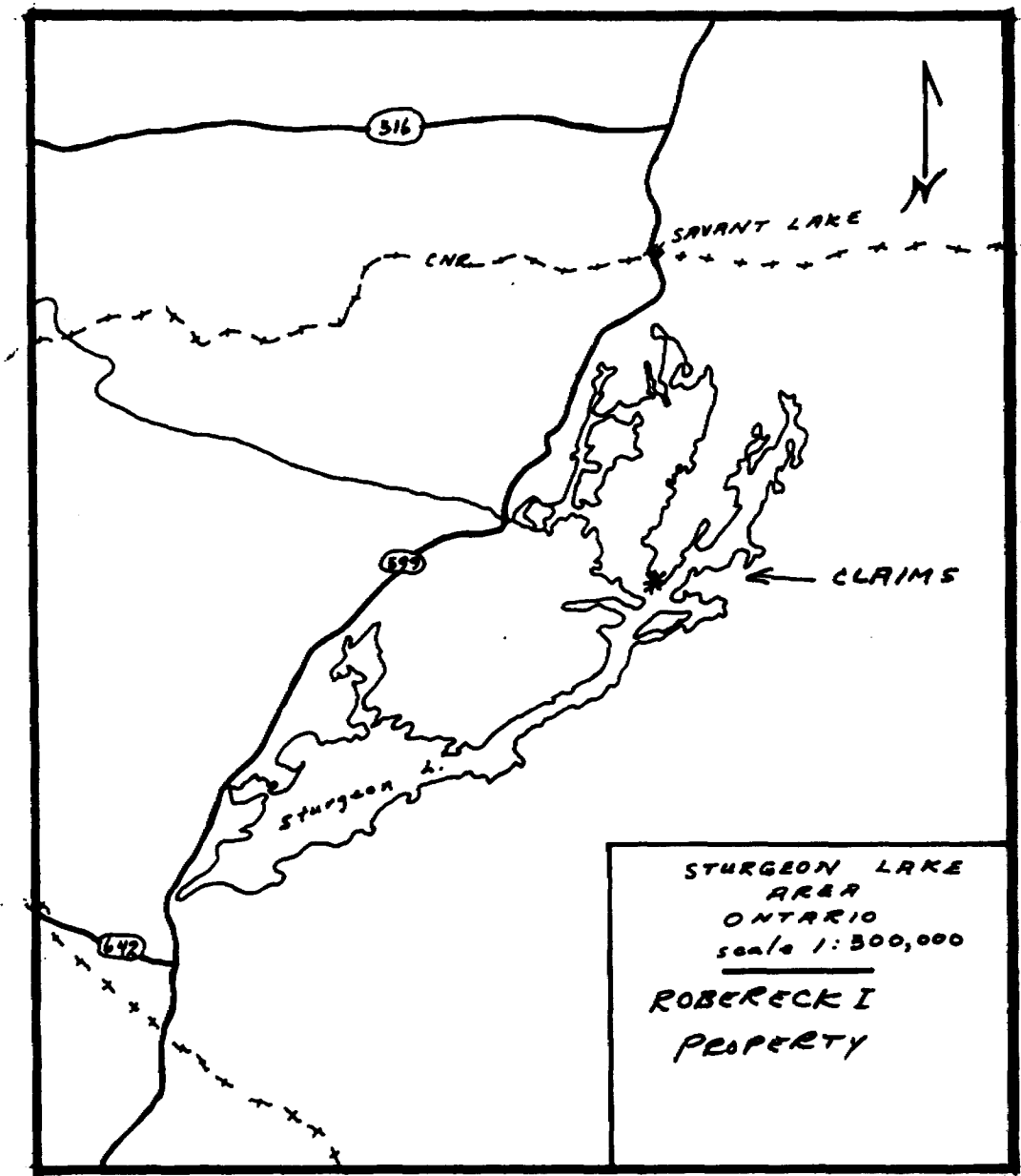

W88

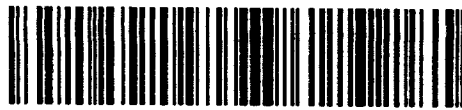

52J02SE8664 2.11388 SQUAW LAKE

900

Mining Lands 88-70 Mir

Type of Survey(s) **GEOPHYSICAL (mag, 2 VLF)**

Claim Holder(s) **E. ROBERECKI** 2.11388 Prospector's Licence No. **H 9790**

Address **RIVERTON, MANITOBA ROC 2R0**

Survey Company **J. W. REDDEN** Date of Survey (from & to) **08 03 88** to **12 03 88** Total Miles of line Cut **2.4**

Name and Address of Author (of Geo-Technical report) **J. W. REDDEN Box 117 WABIGOON ONT P0V2W0**

Credits Requested per Each Claim in Columns at right

Special Provisions	Geophysical	Days per Claim
For first survey: Enter 40 days. (This includes line cutting)	- Electromagnetic	40
	- Magnetometer	40
For each additional survey: using the same grid: Enter 20 days (for each)	- Radiometric	
	- Other	
Man Days Complete reverse side and enter total(s) here	Geological	
	Geochemical	
Airborne Credits Note: Special provisions credits do not apply to Airborne Surveys.	Electromagnetic	
	Magnetometer	
	Radiometric	

Mining Claims Traversed (List in numerical sequence)

Mining Claim		Expend. Days Cr.	Mining Claim		Expend. Days Cr.
Prefix	Number		Prefix	Number	
Pa	612056				
	612057				
RECEIVED					
APR 8 1988					
MINING LANDS SECTION					
RECEIVED					
MAR 15 1988					
PATRICIA MINING DIVISION					
ONTARIO GEOLOGICAL SURVEY ASSESSMENT FILES OFFICE					
JUL 22 1988					
RECEIVED					

Expenditures (excludes power stripping)

Type of Work Performed

Performed on Claim(s)

Calculation of Expenditure Days Credits

Total Expenditures \$ ÷ 15 = Total Days Credits

Instructions
Total Days Credits may be apportioned at the claim holder's choice. Enter number of days credits per claim selected in columns at right.

Date **MAR 13/88** Recorded Holder or Agent (Signature) *[Signature]*

For Office Use Only

Total Days Cr. Recorded **160** Date Recorded **MARCH 15, 1988** Mining Recorder *[Signature]*

Date Approved as Recorded **21 July 88** Branch Director *[Signature]*

Certification Verifying Report of Work

I hereby certify that I have a personal and intimate knowledge of the facts set forth in the Report of Work annexed hereto, having performed the work or witnessed same during and/or after its completion and the annexed report is true.

Name and Postal Address of Person Certifying **J. W. REDDEN**

Box 117, Wabigoon Ont P0V2W0 Date Certified **MAR 13/88** Certified by (Signature) *[Signature]*

Beckington Lake Area G-2532

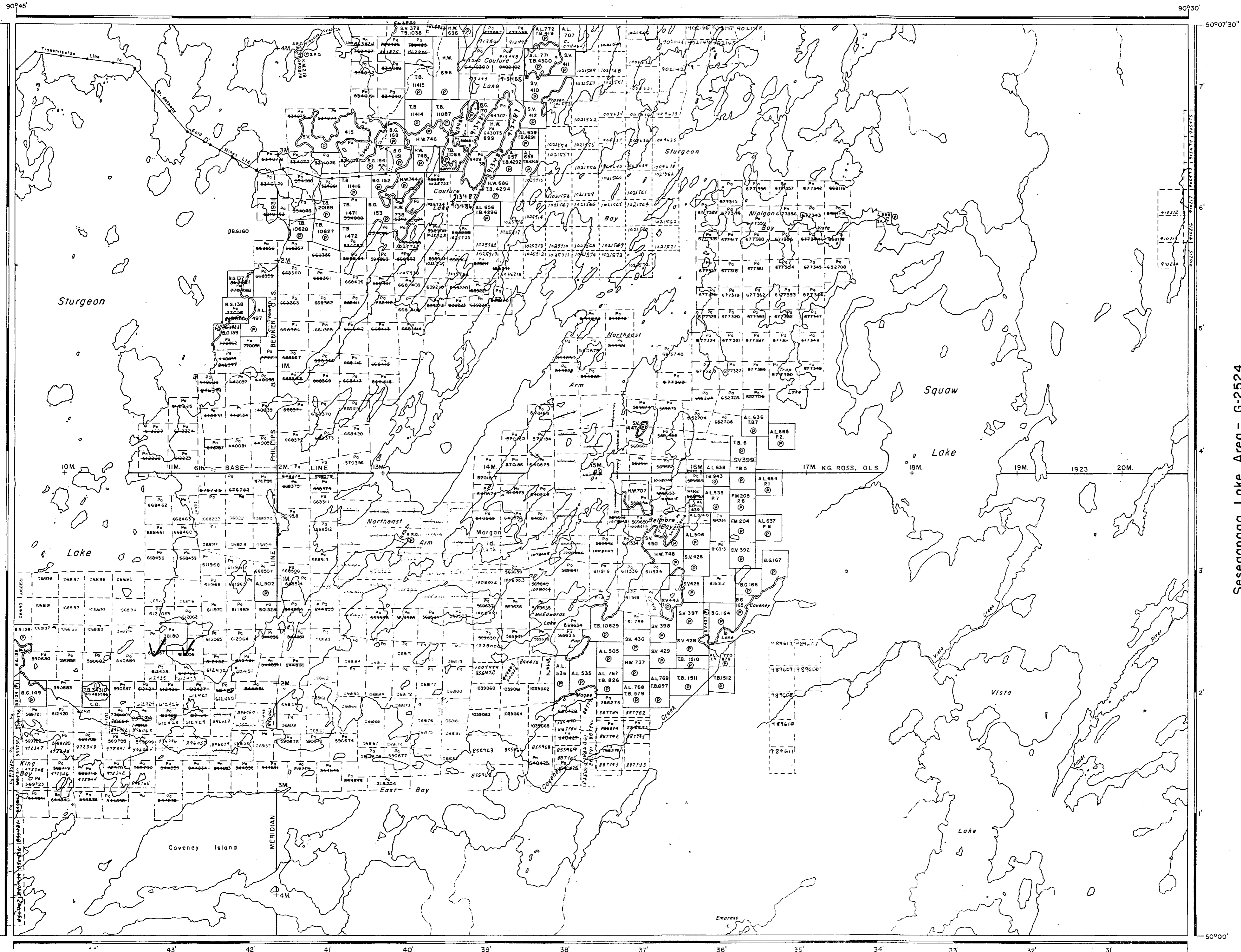

Fourbay Lake Area - G-2543

Sesegana Lake Area - G-2524

LEGEND

- PATENTED LAND
- CROWN LAND SALE
- LEASES
- LOCATED LAND
- LICENSE OF OCCUPATION
- MINING RIGHTS ONLY
- SURFACE RIGHTS ONLY
- ROADS
- IMPROVED ROADS
- KING'S HIGHWAYS
- RAILWAYS
- POWER LINES
- MARSH OR MUSKEG
- MINES
- CANCELLED

REFERENCES

AREAS WITHDRAWN FROM DISPOSITION

M.R.O. - MINING RIGHTS ONLY
 S.R.O. - SURFACE RIGHTS ONLY
 M+S - MINING AND SURFACE RIGHTS

Description	Order No.	Date	Disposition	File

4-6-85
 5047 23105
 0225135
 400-1195
 MAY 1987
 APR 17, 1982
 APR 13, 87
 APR 15, 87
 MAR 5, 87
 APR 15, 87
 MAR 20, 87

AREA
SQUAW LAKE
 M.N.R. ADMINISTRATIVE DISTRICT
IGNACE
 MINING DIVISION
PATRICIA
 LAND TITLES / REGISTRY DIVISION
THUNDER BAY



Ministry of Natural Resources
 Ontario

Quest Lake Area - G-2556



2.11388

Pa 38180

(L)



Sturgeon Lake

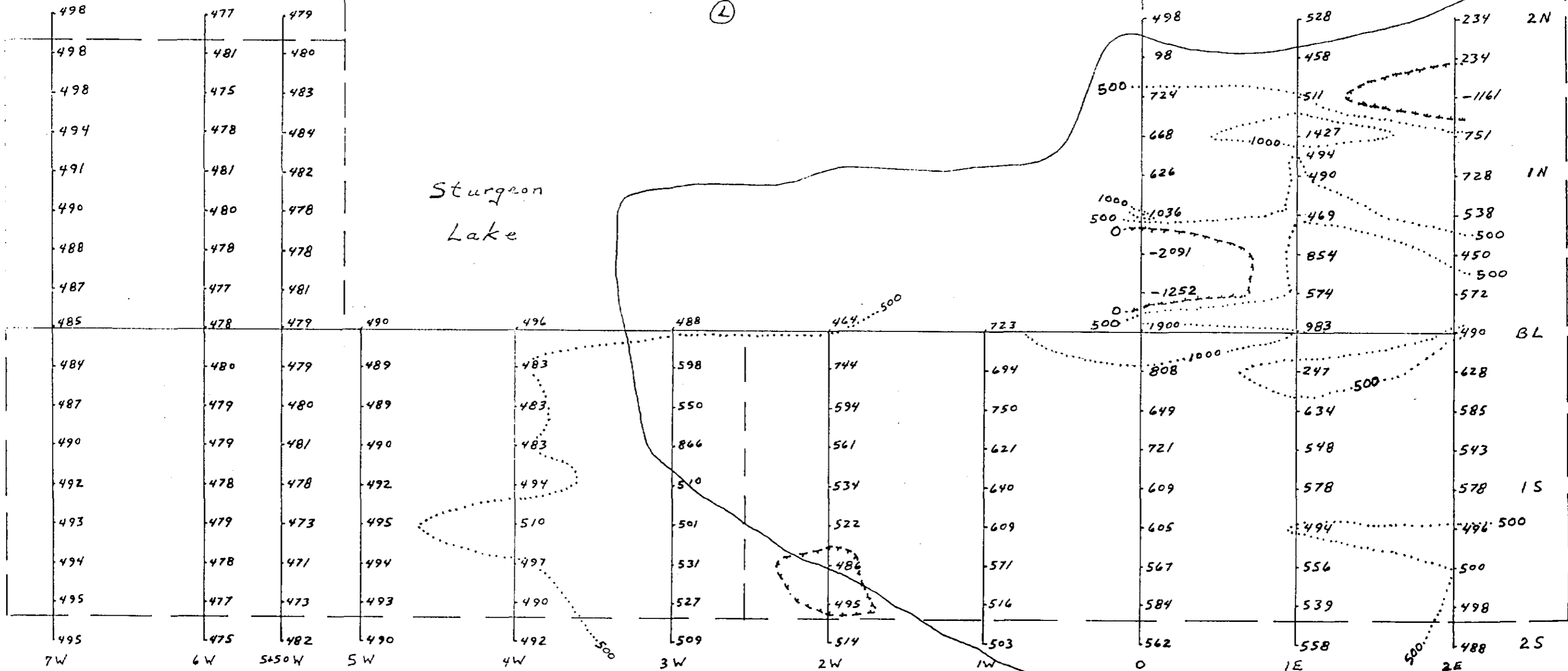

ROBERECKI PROPERTY
 Squaw Lake Area
 Patricia Mining Division
 Ontario
 scale 1:2500

TOTAL FIELD MAGNETIC SURVEY
 value + 59000 γ = total field

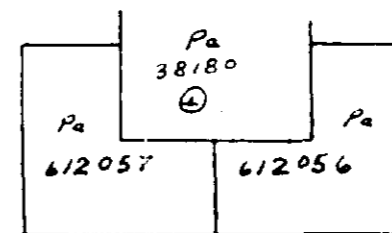

J. W. Redden, MAR 31/88



52J02SE8664 2.11388 SQUAW LAKE



2.11388
Pa 38180

(L)

Sturgeon
Lake

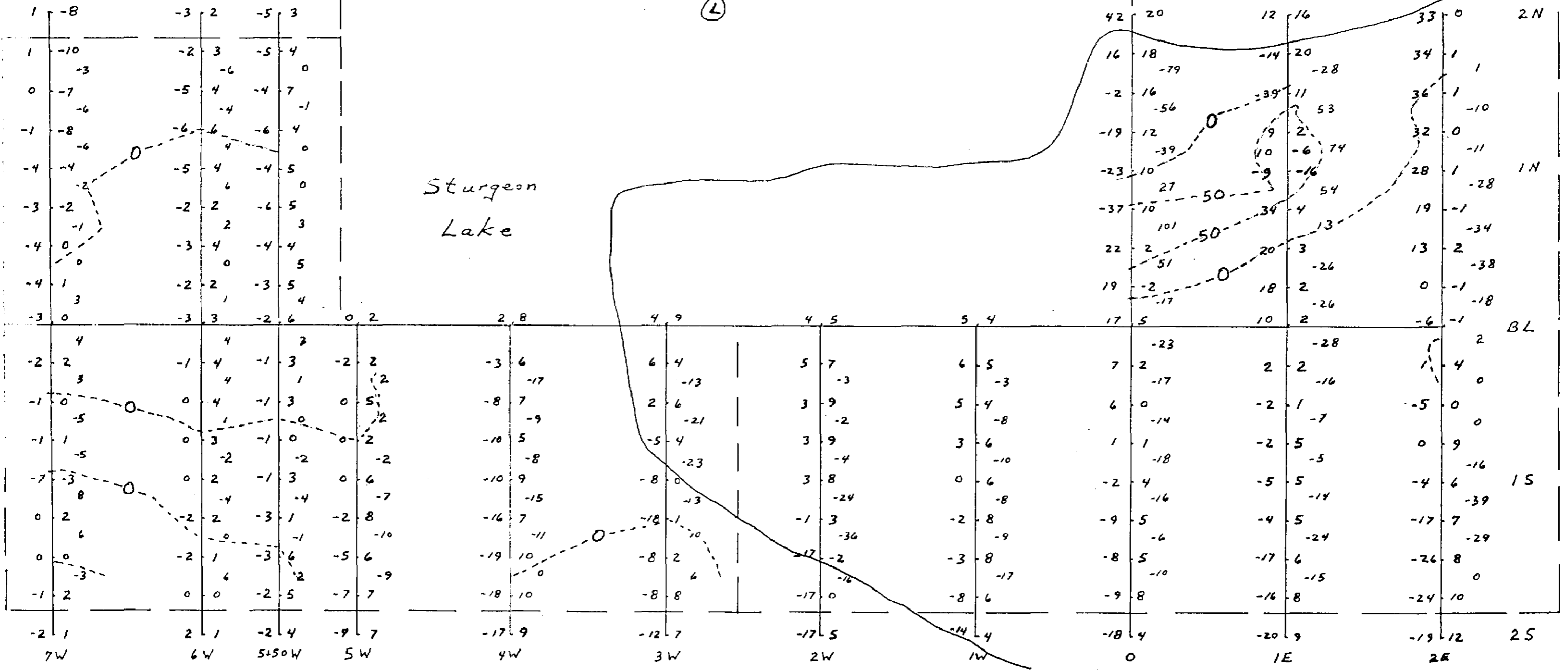

ROBERECKI PROPERTY
 Squaw Lake Area
 Patricia Mining Division
 Ontario
 scale 1:2500

VLF SURVEY

sta: Cutler
freq. 24.0

i.P. Quad

10 | 6
12 Fraser Filter

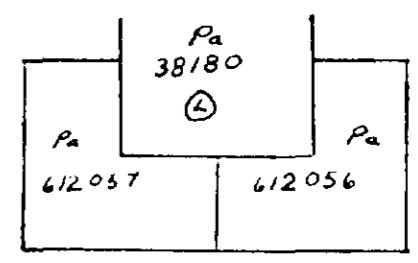

J.W. Redden, MAR 31/88





2.11388

Pa 38180

Ⓛ

Sturgeon
Lake

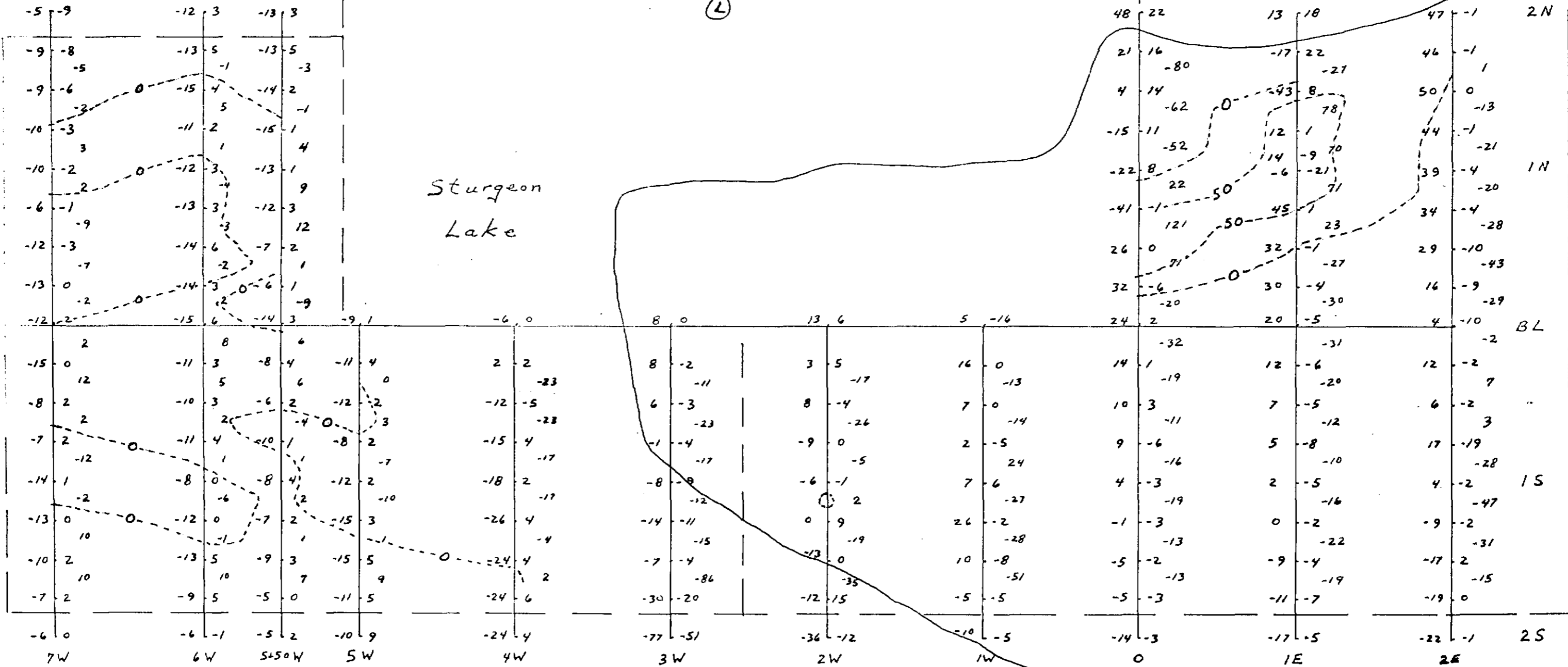

ROBERECKI PROPERTY
 Squaw Lake Area
 Patricia Mining Division
 Ontario
 scale 1:2500

VLF SURVEY
 sta. Seattle
 freq. 24.8
 1P. Quad.
 10-4 12 Fraser Filter

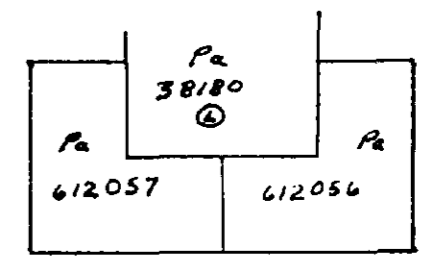

J.W. Redden, MAR. 31/88

