

SHERRITT GORDON MINES LIMITED
MINING DIVISION - LYNN LAKE
MANITOBA

8/10/81

ASSAY REPORT

DATE Sept 28 19 81

LOT NO.	SAMPLF. NO.	% Ni	% Cu	% Zn	% Fe	Au
1	Q 6101 ✓					0.01
2	6102 ✓					0.06
3	6103 ✓					0.436
4	6104 ✓					0.01
5	6105 ✓					0.10
6	6106 ✓					0.244
7	6107 ✓					0.09
8	6108 ✓					0.01
9	6109 ✓					0.01
10	6110 ✓					0.01
11	6111 ✓					0.02
12	6112 ✓					0.17
13	6113 ✓					0.03
14	6114 ✓					0.01
15	6115 ✓					0.01
16	6116 ✓					0.01
17	6117 ✓					0.02
18	6118 ✓					0.066
19	6119 ✓					0.01
20	6120 ✓					0.01
21						
22						
23						
24						
25						

STURGEON AREA
Steine / Kelly



52/10/12
SHERRITT GORDON MINES LIMITED
 MINING DIVISION - LYNN LAKE
 MANITOBA

ASSAY REPORT

DATE Sept 27, 19 82

LOT NO.	SAMPLE NO.	% Ni	% Cu	% Zn	% Fe	% Pb	oz./ton	
							Au	Ag
1	B1 201						0.26	
2	202						nil	
3	203						0.01	
4	204						tr	
5	205 ✓						0.21	
6	206						0.08	
7	207 ✓						0.14	
8	208 ✓						0.05	
9	209							
10								
11								
12								
13								
14								
15								
16								
17								
18								
19								
20								
21								
22								
23								
24								
25								

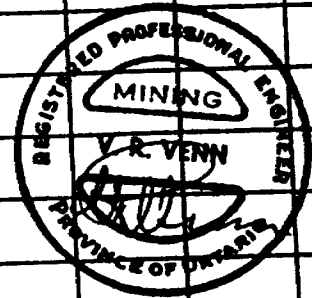

62/10/12

SHERRITT GORDON MINES LIMITED
MINING DIVISION - LYNN LAKE
MANITOBA

ASSAY REPORT

DATE Sept 27, 19 82

LOT NO.	SAMPLE NO.		% Ni	% Cu	% Zn	% Fe	% Pb	oz/ton	
								Au	Ag
1		B1 215						0.01	0.03
2		216						0.08	0.03
3		217						0.03	0.03
4		218						0.03	0.03
5		219						0.23	0.01
6		220						0.02	0.02
7		221						0.04	0.03
8		222						0.20	0.01
9		223						0.01	0.02
10		224						0.01	0.03
11		225						tr	0.04
12		226						0.01	0.02
13		227 *						1.15	0.05
14		228						0.01	0.04
15		229						0.03	0.02
16		230						0.14	0.02
17		231						tr	0.02
18		232						0.05	0.02
19		233						0.19	0.03
20		234						0.01	0.01
21		235						tr	0.02
22		236						0.01	0.00
23		237						0.01	0.04
24		238						0.01	0.01
25		239						0.02	0.02

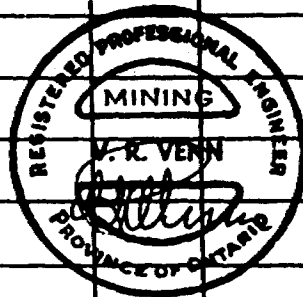

SIERRITT GORDON MINES LIMITED
 MINING DIVISION - LYNN LAKE
 MANITOBA

ANALYSIS REPORT

DATE October 29, 1981 19__

PT NO.	SAMPLE NO.		% Ni	% Cu	% Zn	% Fe	oz/ton	
							Au	Ag
	Q-6139	<i>Sample from East Bay Q-6139 - Q-6165</i>		0.03			0.12	0.03
	Q-6140			0.06			0.02	0.04
	Q-6141			0.05			0.15	0.03
	Q-6142			0.01	0.01		tr	0.02
	Q-6143			0.05			0.29	0.05
	Q-6144		0.01			nil	0.05	
	Q-6145		0.02			0.24	0.03	
	Q-6146		0.05			0.01	0.05	
	Q-6147		0.02			0.15	0.04	
	Q-6148		0.02			0.10	0.06	
	Q-6149		0.03			0.30	0.06	
	Q-5151		0.01			0.80	0.06	
	Q-6152		0.02			0.06	0.06	
	Q-6153		0.01			0.54	0.04	
	Q-6154		0.02			tr	0.05	
	Q-6155		0.05			nil	0.05	
	Q-6156		0.04			0.14	0.04	
	Q-6157							
	Q-6158			nil			0.02	0.03
	Q-6159			0.04			0 tr	0.06
	Q-6160			0.02			0.02	0.07
	Q-6161			0.03			0.33	0.02

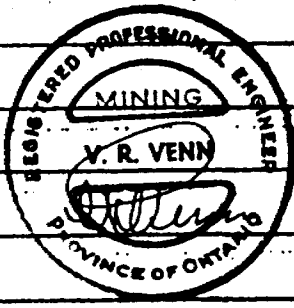

SHERRITT GORDON MINES LIMITED
 MINING DIVISION - LYNN LAKE
 MANITOBA

ASSAY REPORT

DATE October 29 19 81

LOT NO.	SAMPLE NO.	% Ni	% Cu	% Zn	% Fe	oz/t Au	oz/t Ag
1	Q-6162		0.03			nil	0.04
2	Q-6163		0.02			0.01	0.01
3	Q-6164		0.03			tr	0.04
4	Q-6165		0.03			0.01	0.03
5							
6							
7							
8							
9							
10							
11							
12							
13							
14							
15							
16							
17							
18							
19							
20							
21							
22							
23							
24							
25							

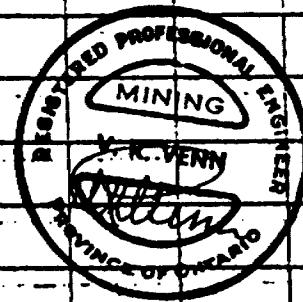

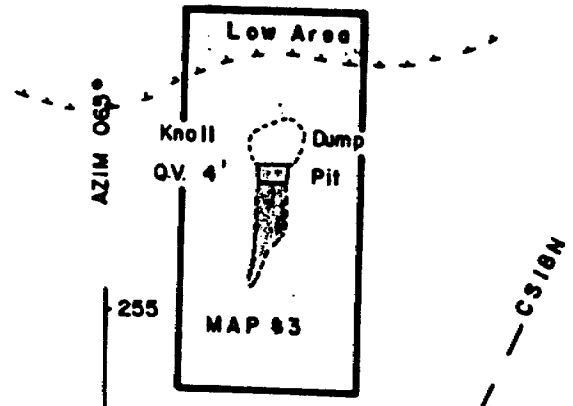
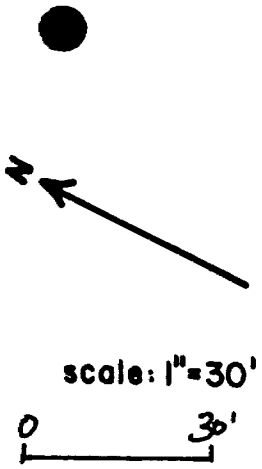

- 270
- 260
- 250
- 240
- 230
- 220
- 210
- 200
- 190
- 180
- 170
- 160
- 150
- 140
- 130
- 120
- 110
- 100
- 90
- 80
- 70
- 60
- 50
- 40
- 30
- 20
- 10
- 0

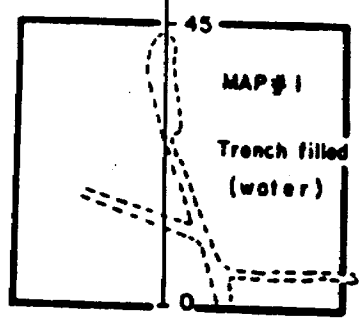
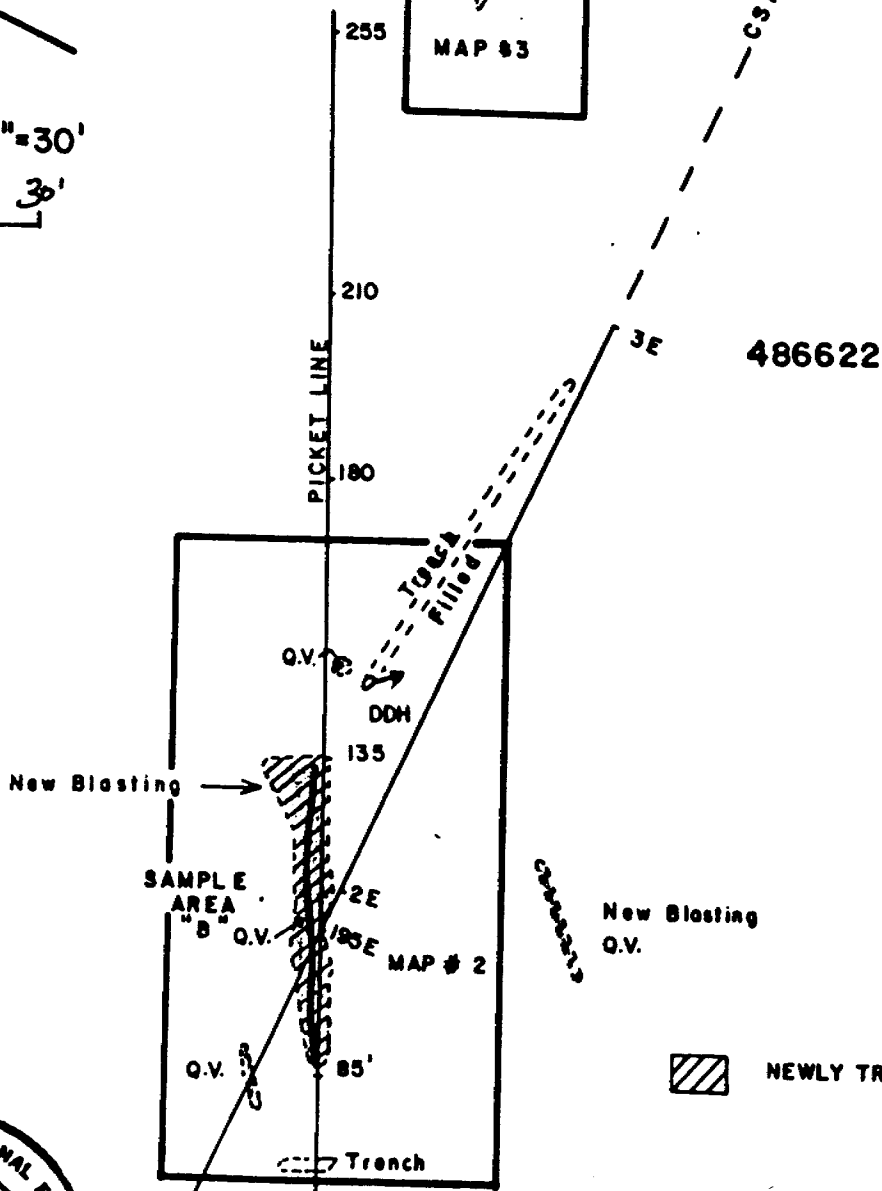

**EAST BAY
SKETCH LOCATION
MAP
"B" SHOWING
n.f.s. 52-J-2
V. R. VENN
MAY, 1982**

486622

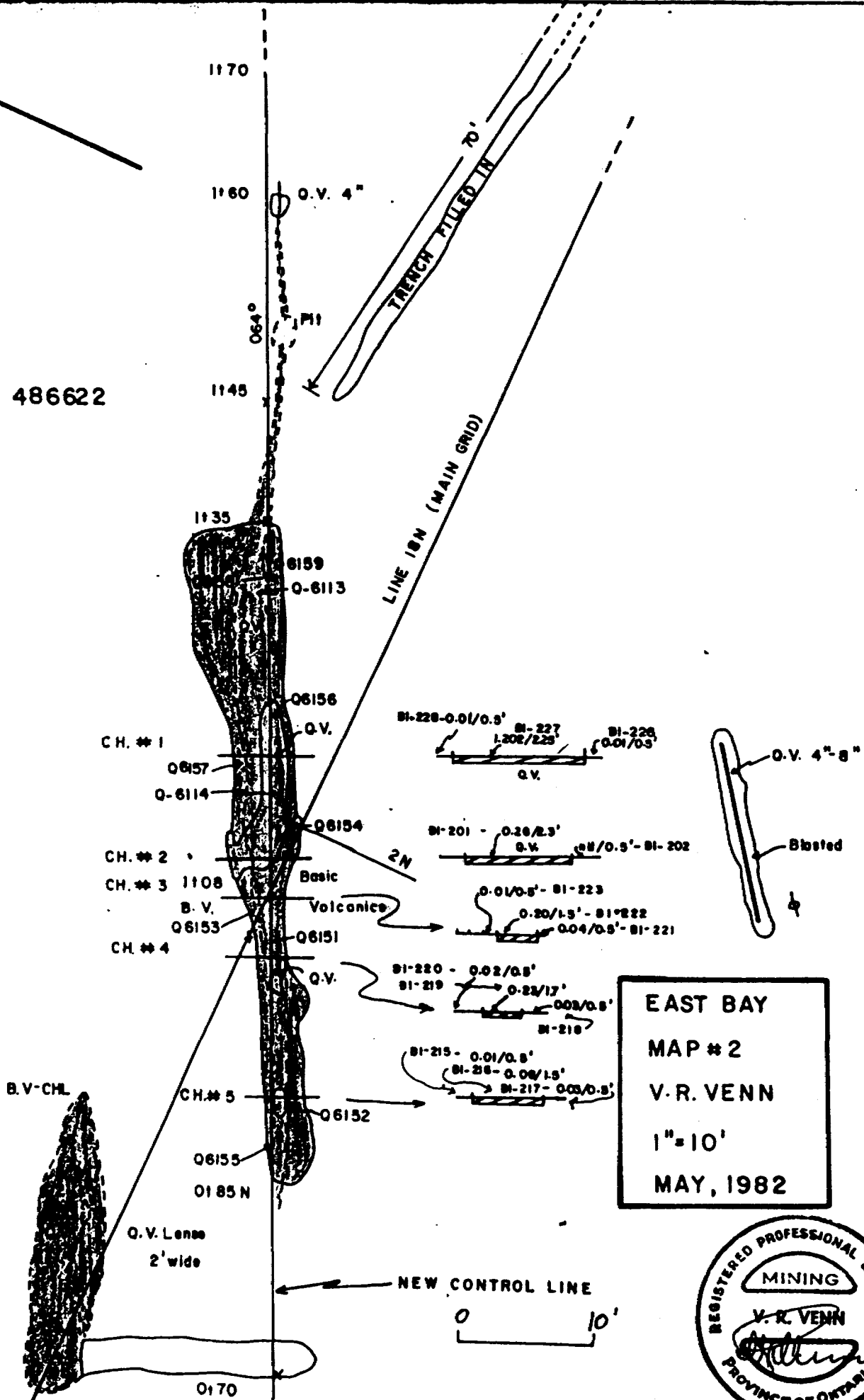

EAST BAY
 MAP # 2
 V.R. VENN
 1" = 10'
 MAY, 1982



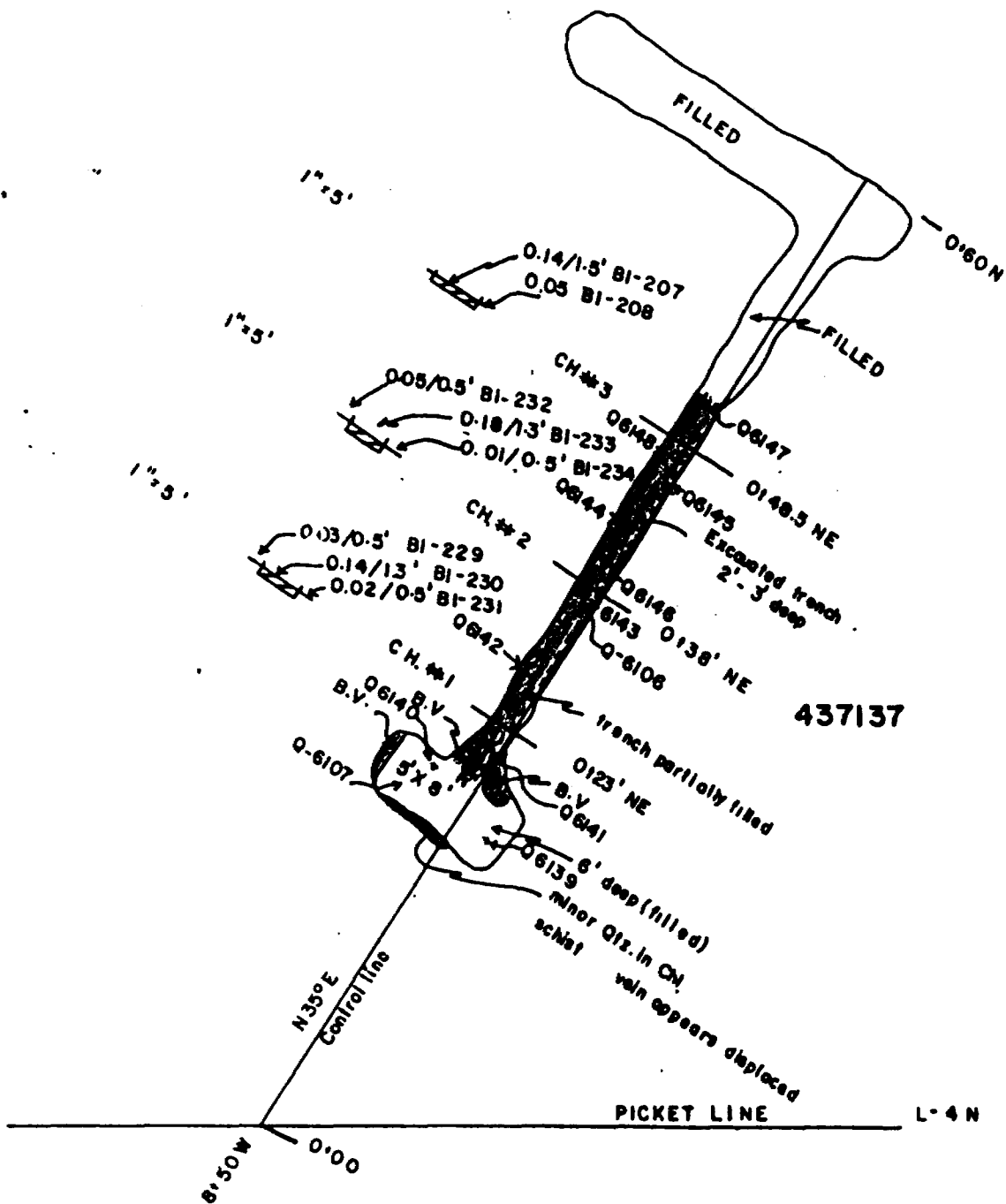

EAST BAY
 MAP "A"
 SCALE: 1" = 10'
 V. R. VENN
 MAY, 1982



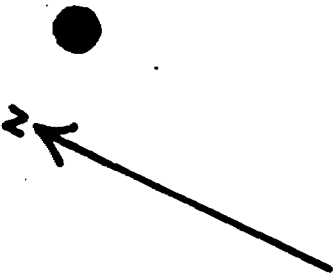

486622

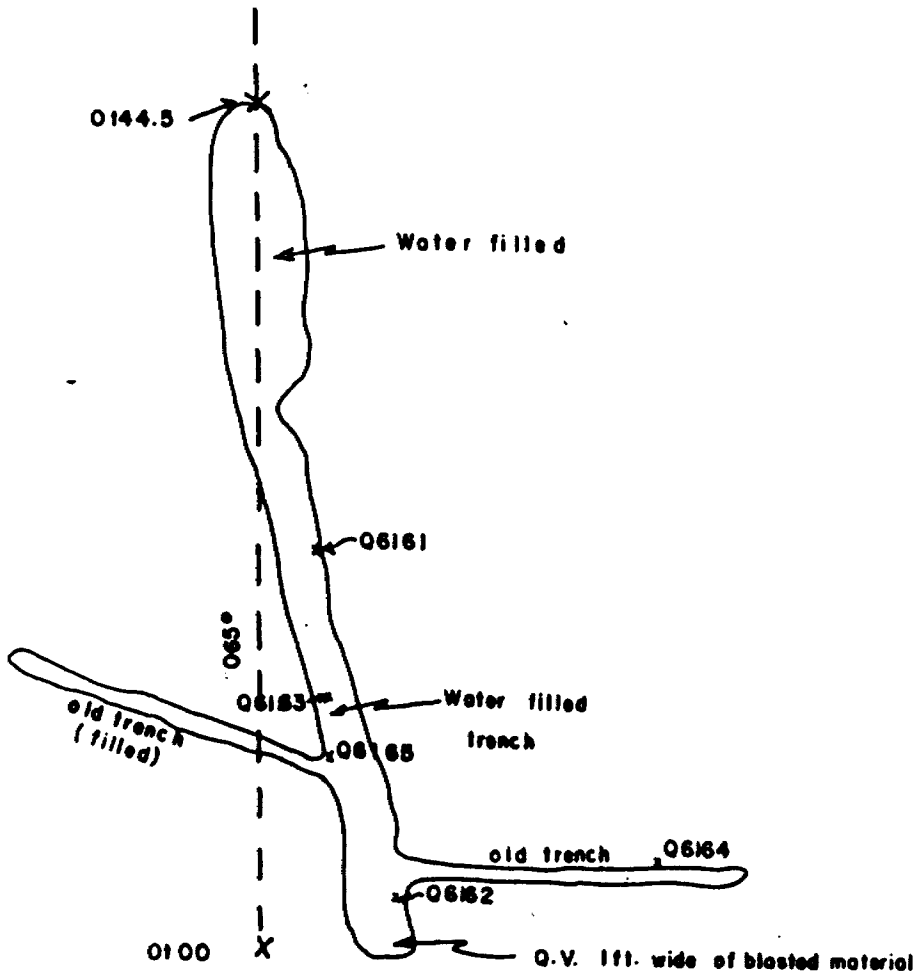

EAST BAY
MAP # 1
1" = 10'
V.R. VENN
MAY, 1982



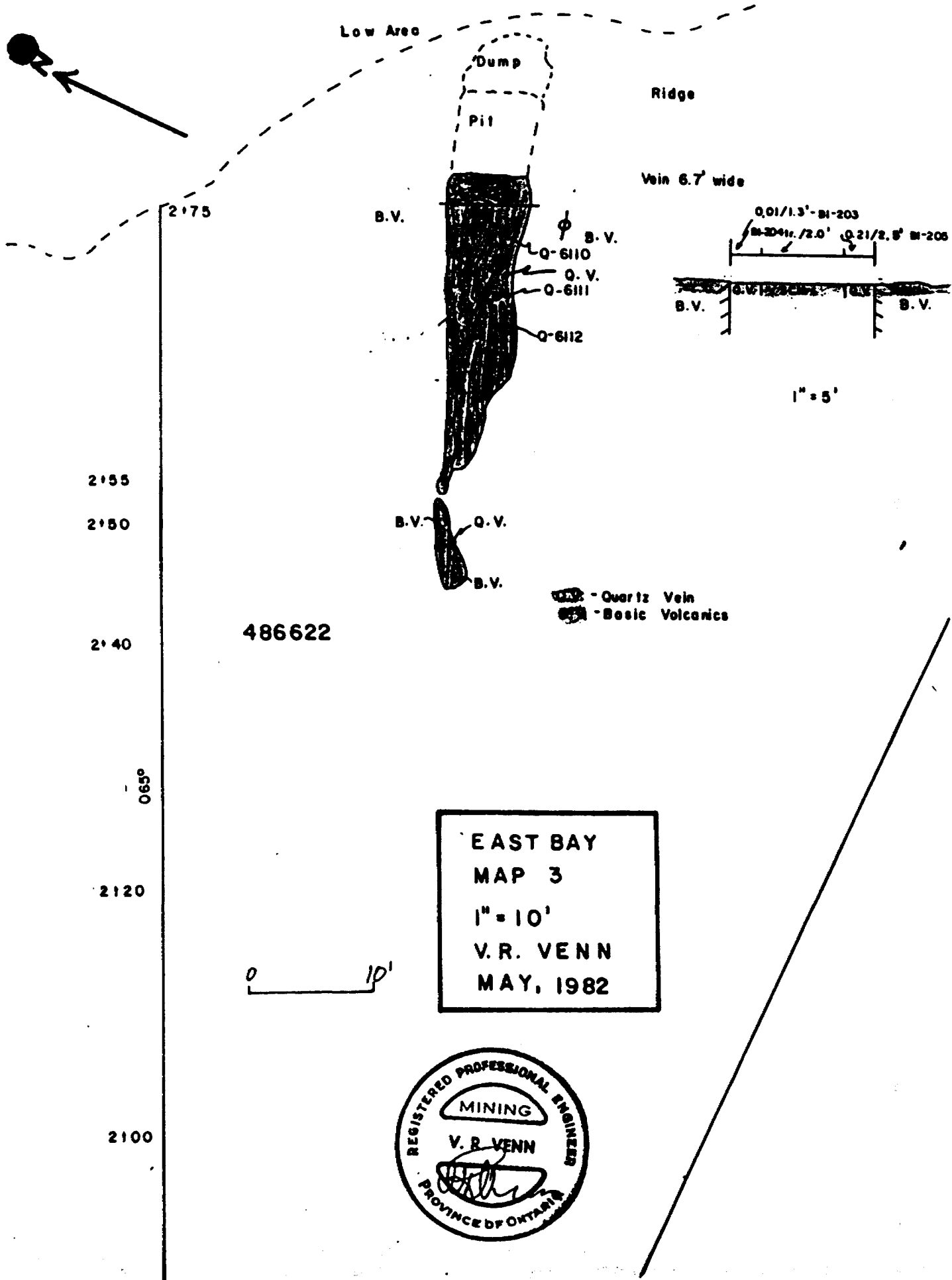

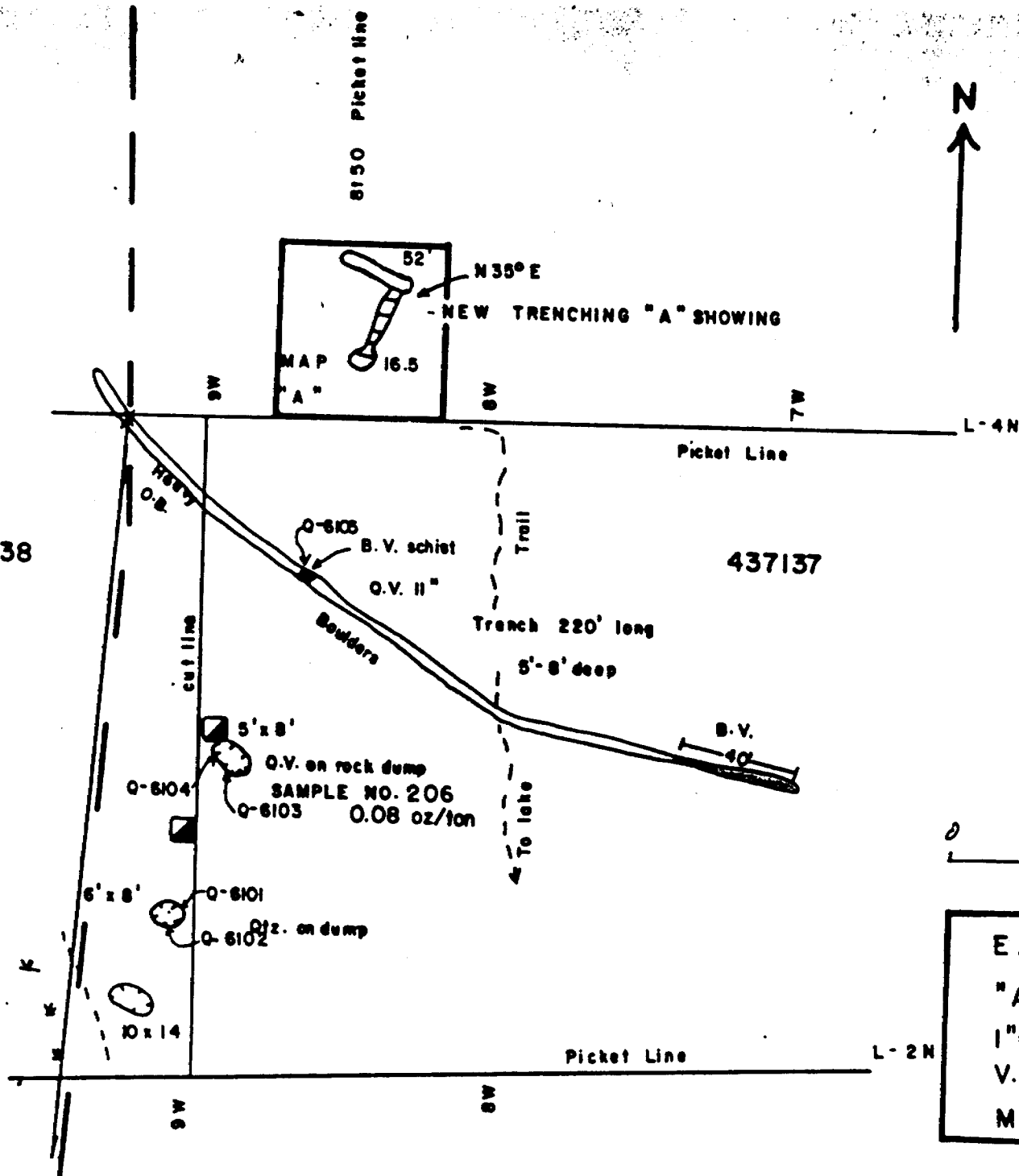

L16N

L16

486622

Showing C

0616

0617

Q.V.

0618



3c

- Mafic Volcanics (flow)
- Felsic Volcanics (tuff)
- Sediments (lithic wacke)
- Quartz Vein
- Outcrop Boundary
- Geological Contact (assumed)
- Trench



0 50' Scale: 1" = 50'

claim line



Jan 25/83

Mining Lands Comments

- cheque receipt ~~is attached~~ OK

To: Geophysics

Comments

Approved

Wish to see again with corrections

Date

Signature

To: Geology - Expenditures

n/a. Kustra

Comments

Geological map OK

Approved

Wish to see again with corrections

Date

Mar 15/83

Signature

Kustra

To: Geochemistry

Comments

JD

Approved

Wish to see again with corrections

Date

Signature

To: Mining Lands Section, Room 6462, Whitney Block.

(Tel: 5-1380)

1982 11 12

2.5148

Mining Recorder
Ministry of Natural Resources
P.O. Box 669
Sioux Lookout, Ontario
POV 2T0

Dear Sir:

We have received data for assaying submitted under Section 77(19) of the Mining Act R.S.O. 1980 submitted on Mining Claims Pa 437135 et al in the area of Squaw Lake.

This material will be examined and assessed and a statement of assessment work credits will be issued.

Yours very truly

E.F. Anderson
Director
Land Management Branch

Whitney Block, Room 6450
Queen's Park
Toronto, Ontario
M7A 1W3
Phone: 416/965-1380

DW:sc

cc: Sherritt Gordon Mines
Dryden, Ontario
Attn: V. Scime.
V. Venn.



Sherritt Gordon Mines Ltd.
Exploration Field Office
P.O.Box 723
Claybanks Road, Dryden, Ont.
P8N 2Z4

October 5, 1982

RECEIVED

NOV - 5 1982

MINING LANDS SECTION

To acknowledge work done by our Assay Department.

Project # 1304 East Bay

Q-6139 to 6149, Q-6151 to 6165. (sample series)	
26 samples, 3 determinations each (Au, Ag, Cu)	78 assays @ \$3.09 = \$ 241.02
Q-6101 to 6120. (sample series)	
20 samples, 1 determination each (Au)	20 assays @ \$3.09 = 61.80
B1-201 to 209, B1-215 to 239. (sample series)	
34 samples, 2 determinations each (Au, Ag)	68 assays @ \$3.09 = <u>210.12</u>
	<u>\$ 512.94</u>

N.O. Pfeiffer
Special Projects Accountant



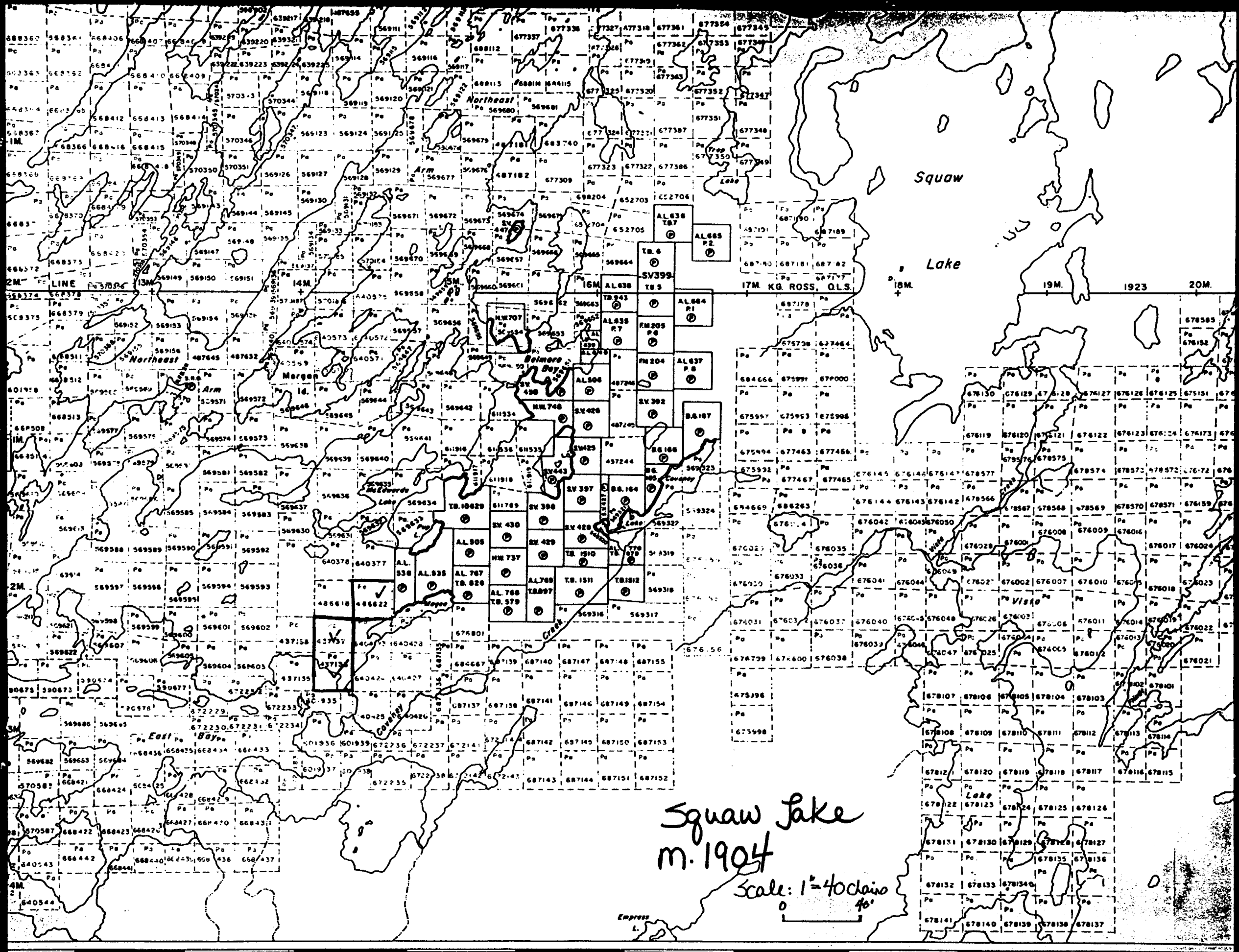

Squaw Lake
m. 1904

Scale: 1" = 40 chains
40'

SEE ACCOMPANYING
MAP(S) IDENTIFIED AS
52 J/02 SE-0023 #1

LOCATED IN THE MAP
CHANNEL IN THE FOLLOWING
SEQUENCE (X)

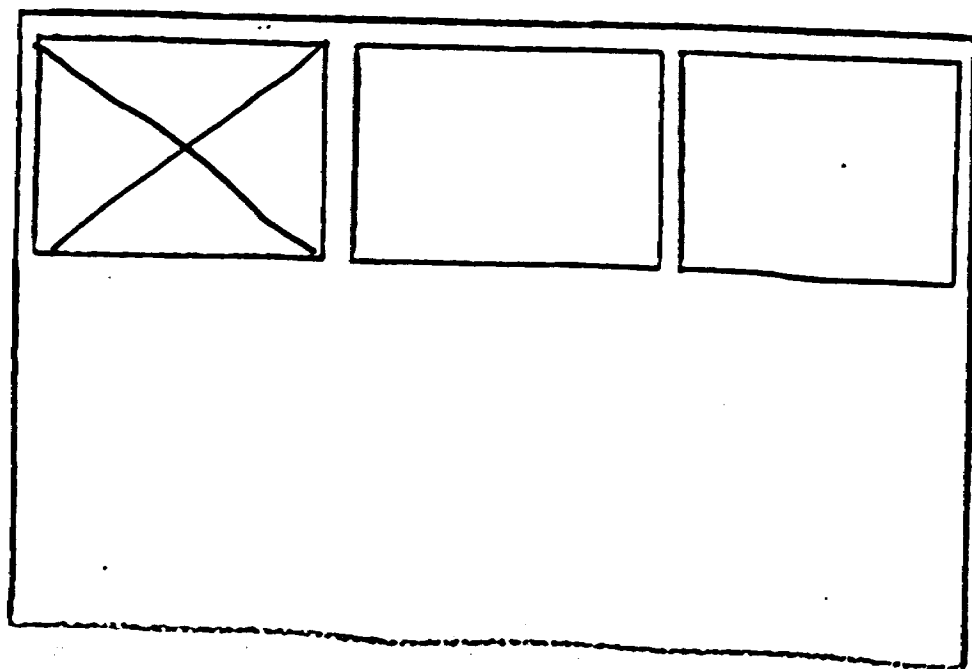

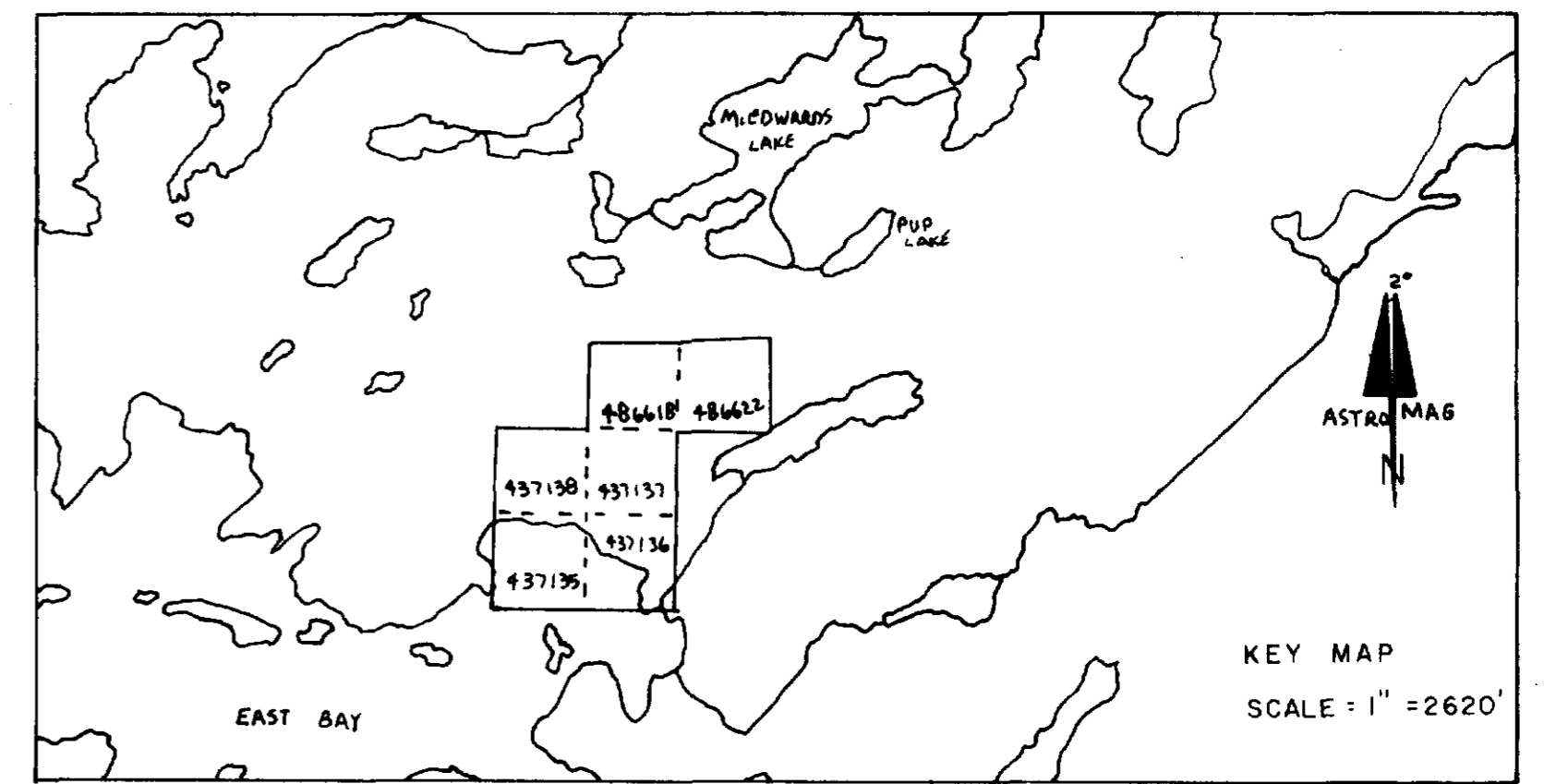

SHERRITT GORDON MINES LIMITED

AREA-STURGEON LAKE

GROUP-EAST BAY

GEOLOGY SURVEY

N.T.S. 52-J-2

PLAN SCALE 1" = 200'

GEOLOGY BY: VINCE SCIME

DRAWN BY: J.R. WARD

SEPTEMBER 1981

LEGEND

- 1 MAFIC VOLCANICS
 - a FINE TO MEDIUM GRAINED FLOWS
 - c MEDIUM TO COARSE GRAINED FLOWS
 - f PILLOWED FLOWS
- 3 FELSIC VOLCANICS
 - a FINE GRAINED TUFFS/FLOWS
 - b LAPILLI TUFF
 - c TUFF (QUARTZ EYES & FELDSPAR PHENOCRYSTS)
 - d TUFF BRECCIA/LAPILLI TUFF
- 4 SEDIMENTS
 - a LITHIC WACKE
 - b CONGLOMERATE

2-5148 Duplicate

SYMBOLS

- AREA OF OUTCROP
- TRENCH
- TIMBERED PIT/SHAFT
- OLD DIAMOND DRILL SITE (X-RAY)
- GEOLOGIC CONTACT (ASSUMED)
- FAULT (ASSUMED)
- ▲ PILLOWED LAVA; TOPS INDICATED

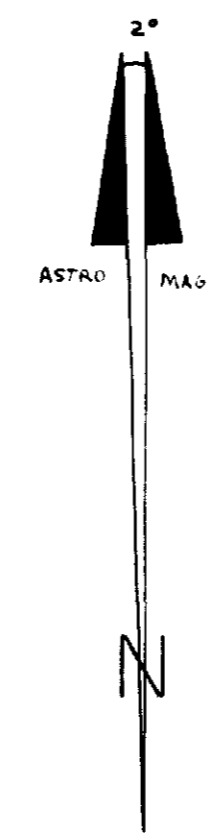
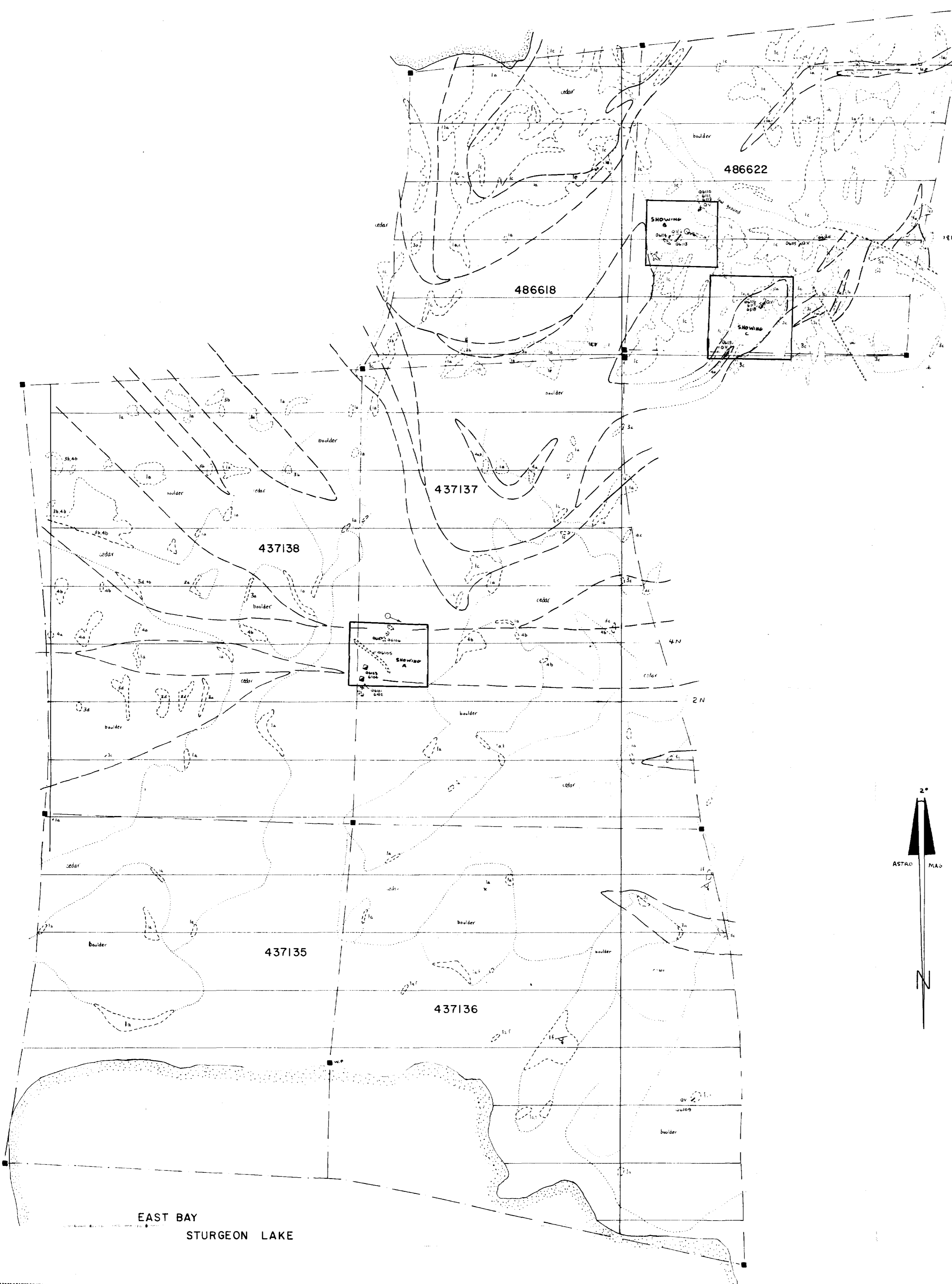

EAST BAY
STURGEON LAKE

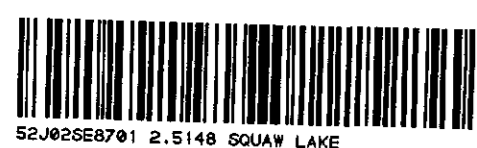

52J/02SE 0023 #1