



52J025E8705 2.2068 SQUAW LAKE

2.2068

010

RECEIVED

MAR 23 1976

*by hand*  
PROJECTS UNIT

GEOLOGY - MORGAN ISLAND

INTRODUCTION:

During the early fall of 1974 the author and his partner, J. R. Nixon, spent a week on Sturgeon Lake endeavouring to trace the location where, during the late 1930's, a pair of prospectors discovered a large number of quartz boulders well mineralized with gold. The boulders were crushed by the prospectors and the gold recovered by panning. The location was either at the south end of the lake near Granite Bay or at King Bay, twelve miles to the north. Granite Bay and surrounding area was explored during the early fall with negative results and plans made to explore King Bay during the fall of 1975. In early January, 1975, preliminary map No. P. 968 by N. F. Trowell was published which covered part of King Bay. Dr. Trowell pointed out an area of carbonate breccia on Morgan Island which ran anomalously high in gold and, as Morgan Island lay four miles up the glacial strike from King Bay, it was decided to stake the carbonate breccia formation on Morgan Island. On the 27th of April, 1975, Robert Andrews and the author engaged a Pegasus Helicopter from Dryden and staked claims No.'s 431450 to 431454 inclusive.

On September 8, 1975 two employees of Bayhill Development Ltd., Kingston, a company in which the author is a shareholder,

left Kingston for Savant Lake in a three quarter ton pickup. This vehicle was necessary to transport the estimated one thousand pounds of rock samples to be collected on the claims and returned to Kingston. The two employees, Kevin Kehoe and Jack Howes, were to be engaged in line cutting and sampling. The author flew to Thunder Bay and was picked up and driven to Savant Lake by the two employees on September the tenth. The party was joined by J. R. Nixon on Sunday, September the fourteenth and the work completed by the evening of September nineteenth.

LOCATION:

Morgan Island, an island in the Northeast arm of Sturgeon Lake lies 130 air miles north-west of Thunder Bay. It may be reached by car from Thunder Bay via Highway 17 to Ignace (180 miles) and north via Highway 599 to Savant Lake (77 miles). The town of Savant Lake lies one mile north of the north-west corner of Sturgeon Lake. The party was picked up at the landing south of Savant Lake and driven by Mr. Art Mousseau to his fishing lodge on the northeast arm of Sturgeon Lake, a distance of eighteen miles. This lodge is located one mile south west of the claim group on Morgan Island. There is an air base on Savant Lake which will fly passengers to the Lodge in a flying time of ten minutes.

TOPOGRAPHY:

In flying over or circling the island by boat the topography appears to rise gently from the southern boundary of

the claim group towards the north east for a distance of about 1500 feet to an altitude of ninety feet above the lake level. From there it appears to gradually flatten towards the north and west. On the ground the terrain is much more rugged. In general the central carbonate core of the island has low relief, seldom rising more than thirty feet above the lake level while the volcanics on either side stand out in much higher relief. The ground over the carbonates tends to be swampy with a heavy growth of spruce, fir, cedar, jack pine and poplar. These trees attain a thickness of as much as three feet. The growth over the volcanics is much more stunted, due to the acidic nature of the rocks, and, in the highest sections, is practically nonexistent. It is this uneven growth pattern that tends to give the island the appearance of a gentle even topography.

Line cutting was particularly difficult due to the heavy growth, swamp, irregular topography over the volcanics and the dense windfall. Fifty-one hundred feet of base line was cut the lines set with a transit and chained and staked at 200 foot intervals. The base line was trimmed out of undergrowth and fallen trees for a width of six feet.

REGIONAL GEOLOGY:

According to N. F. Trowell (Preliminary Map No. P. 968) Morgan Island lies near the juncture **of two** metavolcanic

assemblages, one lower mafic to intermediate metavolcanic sequence and another higher, finely intercalated sequence of mafic to intermediate and intermediate to felsic metavolcanics. North of the area rapid alternation of mafic to intermediate and intermediate to felsic metavolcanics suggests that both are occurring simultaneously. The fragmental rocks of the area show bedding, laminations and well rounded fragments suggestive of subaqueous reworking. Metasediments in the area are volcanoclastic. Sills, dikes and irregular bodies of metaquartzite and metadiorite have intruded both the metasediments and metavolcanics. Three syenite-monzonite complexes intrude the metavolcanics and metasediments in the Vanessa and Vista Lake areas to the east and south. A nepheline scapolite alkalic complex occurs north of Vista Lake on Squaw Lake.

The area is dissected by a major penetrative shear zone trending north-east along the north-east arm of Sturgeon Lake. Associated shear folding with north-east trending axial planes and subvertical fold axes have been observed in the shear zone. This has been superimposed on regional flexural slip folding with east-west trending fold axes. Warping of foliations around the syenite complexes and other intrusives has further complicated the structural relationships.

CLAIM AREA GEOLOGY:

The rock formation on the northern peninsula of Morgan Island covered by the five mining claims has been subdivided into five basic units. These units, from west

to east. are the Dacite Unit, Felsic Carbonate Unit, Mafic Carbonate Unit, Andesite Unit and Agglomerate Unit. These have been intruded, in places, by metadiorite and metagabbro. An examination of the graded bedding and contact relationships between the mafic carbonate and agglomerate units suggest that they are to the east with the Dacite Unit at the footwall side of the carbonates. The field examinations of the two carbonate units, the upper part of the dacite unit and the lower part of the agglomerate unit suggest that they have been subjected to aqueous sedimentary processes and, in fact, were deposited in a marine environment.

DACITE UNIT:

This unit consists of subangular to subrounded felsic clasts from .5 to 25 cm. measured along their axes. The clasts contain subhedral quartz phenocrysts up to 5 mm. in a matrix of chert and chlorite and constitutes about 70% of the rock. The matrix contains ash sized fragments of plagioclase (20%) quartz (25%) and chlorite (10%) with some chert. There are local zones where the fragments are smaller and can be classified as a lapilli tuff. There is a narrow zone 50 feet  $\pm$  of dacite tuff at the top portion of the unit which is highly sheared and altered and has numerous quartz phenocrysts. The alteration appears to be sericite - pyrophyllite - talc series and, the uniformity in grain size suggests it may have been water lain.

FELSIC CARBONATE UNIT:

This unit overlies the Dacite Unit and is, in places, interbedded with the Mafic Carbonate Unit. In general, the unit is composed of 2 - 3 mm. long clasts, subangular to rounded and forming 50 to 80% of the rock. The cement, mostly ankerite with minor calcite and chlorite, surrounds the brown and greenish clasts and in turn is often cut by narrow pinkish carbonate veinlets. Some of the clasts show reaction rims and carbonate filled amygdules. In places the rock has been extensively sheared and altered, the effect of which is to elongate the clasts and facilitate the development of fuchite which gives a pale apple-green colour to the zone.

MAFIC CARBONATE UNIT:

The mafic carbonate unit consists of subangular to subrounded clasts 2mm. to 3cm. in length. They occupy from 50 to 80% of the rock and consist of chlorite, epidote, megnetite, leucoxene and, nucleating along the edges, stilpnomelane. The carbonate cement is usually ankerite but calcite and siderite are also present. Towards the hangwall side of the unit breccia fragments of up to 2 feet in length were noted some of which were seen interbedded with the agglomerate unit. In places there are zones of felsic clasts suggesting some interbedding of the two carbonate units.

ANDESITE UNIT:

In this zone massive mafic volcanics grade upwards into pillowed mafic volcanics with calcite filled amygdules occupying 30% of the rock. The pillows are rounded, from 2 to 3 feet in width with a  $\frac{1}{2}$  inch selvage. The andesites are fine grained and consist of chlorite, magnetite, plagioclase, leucosene, epidote and a small amount of carbonate.

ACID AGGLOMERATE UNIT:

Although the clasts and matrix are somewhat similar in composition to the Dacite Unit the clasts are more rounded and show strong evidence of subaqueous reworking with bedding of ash size particles quite common. The unit, particularly the lower portion, could be properly called a volcanic conglomerate. There are numerous zones of very well rounded boulders up to three feet in diameter. Periods of quiescence are represented by thin bands of chert and weathered horizons. The matrix is generally a mixed zone of intermediate lapilli tuff and tuff breccia.

METADIORITE INTRUSIVES:

The dacite unit is interrupted along the northwest shore of the island by a local intrusion of metadiorite. The metadiorite still shows residual vestiges of original igneous texture although extensively altered to a chlorite, epidote, albite assemblage of minerals typical of greenschist facies of metamorphism. In the east central portion of the map area a porphyritic metagabbro dyke was encountered cutting the

agglomerate unit. This dyke had the unusual spotted or leopard texture resulting from metamorphism.

STRUCTURE:

Sedimentary structures found in the field were very variable in type and distribution. Bedding was most evident in outcrops along the shore with bedding directions being deformed considerably due to folding. Both the mafic and felsic units are bedded but, due either to soft sediment deformation or secondary remobilization, it was not always apparent. Towards the top of the mafic carbonate unit bedded clasts of carbonate breccia 2 to 3 feet in length and up to one foot in width are found as well as in the overlying agglomerate unit.

According to N. F. Trowell the Northeast arm of Sturgeon Lake is a major shear zone. This is most evident on Morgan Island at both the footwall side of the felsic carbonate and on the hanging wall side of the mafic carbonate unit. The outcrop of the carbonate are usually shear faces one to three feet in height and from two to thirty feet in length. The shearing direction varies from N. 10 E. to N. 60 E. and is nearly vertical. There is a fairly strong fault scarp striking N. 30 W. cutting the claim group. The fault scarp is very noticeable in the dacite and agglomerate units (up to 50 feet in height) but disappears in the carbonate units.



It is hoped that there are; within the carbonates, a number of major shear zones that could be localizing agents for gold bearing solutions.

ASSAYS:

Fifty hand specimens and three 250 pound samples were collected in the field and assayed by combined fire assay and atomic adsorption methods. The purpose of the assays was to try and determine if; in fact, there was a low uniform syngenetic gold content in the carbonates. Samples were taken that were free of quartz veins or heavy alteration that would suggest any contained gold was introduced or secondary and thus give an anomalously high reading. One sample, collected near the hanging wall of the mafic carbonate unit, was highly sheared and ran anomalously high gold (4535 ppb).

Of the 20 samples of mafic carbonate assayed 85% ran between 40 and 95 ppb, two ran less than 40 and one ran over 95. The average (excluding the anomalously high value) was 60 ppb. Of the sixteen felsic carbonate samples assayed, eleven were between 35 and 145 ppb, three less than 35 and two were greater than 148 ppb. The average was 82 ppb. The eight samples of volcanics assayed ran from N. D. to 100 (Sheared dacite) and averaged 46 ppb.

CONCLUSIONS

The detailed mapping has located the carbonate units in some detail and, within the claim group, has an average width of 420 feet and a strike length of 4200 feet. The carbonates do contain a low syngenetic gold content but it appears to be too low to be of economic significance. The shear zone adjacent to the hanging wall does contain, apparently, a significantly higher gold content but there is insufficient data to assess its importance. The present plans call for the drilling of a diamond drill hole across the carbonate units this fall to try and locate any major mineralized zones.

*W. H. Higgins*

W. H. HIGGINS

\* Qualifications: New —  
on this file



R E F E R E N C E S

N. F. TROWELL

Preliminary Map P. -968

Northeast Arm -SQUAW LAKE SHEET

WAGNE GORDANIER

Unpublished thesis University of Ottawa

Geochemistry of a Carbonate Breccia

Unit in N. W. Ontario.

ASSESSMENT WORK BREAKDOWN

1. TYPE OF SURVEY.....Geological
2. AREA..... Patricia Mining Division  
Sturgeon Lake
3. MINING CLAIM NUMBERS..... 431450  
431451  
431452  
431453  
431454
4. LENGTH OF LINE CUT AND CHAINED..... 5185 feet.
5. SUMMARY OF DAYS WORKED
  - (a) Total technical work..... 68 days
  - (b) Total line cutting and sampling... 18days
  - (c) Assays..... 19 days

105 days

ASSESSMENT WORK BREAKDOWN

TECHNICAL WORK

W. H. Higgins  
980 Bourne Cresc., --Geologist -Sept. 11-19 (incl.) 9 X 7 = 63 days  
Kingston, Ontario

J. R. Nixon P. Eng. --Assistant -Sept. 15-19 (incl.) 5 days

LINE CUTTING AND SAMPLING

Kevin Kehoe --Labourer -Sept. 11-19 (incl.) 9 days  
23 John Street  
Apt. #9  
Kingston, Ontario

Jack Howes --Labourer -Sept. 11-19 (incl.) 9 days  
R. R. #3  
Odessa, Ontario

ASSAYING

Bondar Clegg	-Oct. 9, 1975	.....	237.50
Bondar Clegg	-Jan. 14, 1976	.....	23.75
Technical Services	-Oct. 27, 1975	.....	35.00
			<u>296.25</u>
Assessment	<u>296.25</u>	-	<u>19 days</u>
	15		
		Total	<u>105 days</u>

QUALIFICATIONS --- Wilfrid H. Higgins

EDUCATION: B. A. -geology, mineralogy - Queens University, 1949  
B.Sc. -mining engineering - Queens University, 1953

Experience: -2 years government geological survey  
-4 years - party chief mining exploration parties  
-4 years -in charge of exploration on 8,000 square  
mile concession in Newfoundland.  
-7 years -Assistant Mine Superintendent -Buchans  
Unit of American Smelting and Refining in Newfoundland  
-2 years -Superintendent of Mines for three producing  
mines in Newfoundland.  
-4 years -Resident Engineer Terra Nova Explorations  
in Quebec City -mining subsidiary of the Price  
Company Ltd.  
- 3 years - Member of Board of Directors of Terra  
Nova Properties -owners of Buchans Operations.

MEMBERSHIP - Professional Engineers of Ontario  
- Canadian Institute of Mining and Metallurgy  
- Prospectors Association of Canada.



• CHEMICAL RESEARCH AND ANALYSIS  
• CONTRACT LABORATORIES

# TECHNICAL SERVICE LABORATORIES

DIVISION OF INCO/AMER TECHNICAL ENTERPRISES LIMITED

518 EVANS AVE., TORONTO, ONT., M8W 2V4 CANADA

TELEPHONE: 252-5895 - AREA 416

CABLE ADDRESS: TECSERV

## CERTIFICATE OF ANALYSIS

SAMPLE(S) FROM Dr. J. H. Brown,  
Department of Mining Engineering,  
Queen's University,  
Kingston, Ontario. K7L 3N6

REPORT NO.

T - 9900

Inv. #1190

SAMPLE(S) OF PULP

### Gold (Au) ppm

1 (a)	0.04
1 (b)	0.02
2 (a)	<0.02
2 (b)	<0.02
3 (a)	0.02
3 (b)	0.02

Samples, Pulps and Rejects discarded after two months

DATE October 27th, 1975.

SIGNED 



TORONTO, MONCTON, and SPOKANE, WASH.



# BONDAR-CLEGG & COMPANY LTD.

784 BELFAST ROAD, OTTAWA, ONTARIO, K1G 0Z8

PHONE: 237-3110

## Geochemical Lab Report

Extraction Au HNO<sub>3</sub> - HCl  
 Method F.A.-A.A.  
 Fraction Used -100 Rocks

Report No. 975-5  
 From Mr. W.H. Higgins  
 Date October 9 19 75

SAMPLE NO.	Au ppb		SAMPLE NO.	Au ppb
1 - 13	4535		14W - 150	10
13 - 10	220		14W - 410	50
13 - 20	230		16W - 500	55
13 - 30	160		16W - 560	75
13 - 40	95		18W - 110	N.D.
13 - 50	375		18W - 500	5
25 - 13	75		18W - 640	20
BL - 5	90		210W - 110	145
BL2 - 610	100		210W - 180	10
8E - 13	140		212W - 50	55
12E - 120	75		212W - 160	60
18E - 400	15		214W - 320	100
210E - 230	95		214W - 500	85
210E - 350	50		216W - 190	65
212E - 50	80		218W - 350	65
212E - 270	35		22W - 140	60
218E - 300	40		22W - 200	35
22E - 200	45		28W - 50	50
22E - 340	80		28W - 820	20
22E - 800	5			
28E - 300	75		Note: N.D. - Not Detected	
2W - 115	35			
4W - 85	45			
8W - 60	60			
10W - 5	50			
10W - 240 light	60			
10W - 240 dark	95			
10W - 360	N.D.			
12W - 65	80			
12W - 445	35			
13W - 380	110			







# BONDAR-CLEGG & COMPANY LTD.

764 BELFAST ROAD, OTTAWA, ONTARIO, K1G 0Z5 PHONE: 237-3110 TELEX: 053-3548

Mr. W.H. Higgins,  
1015 Hudson Drive,  
Kingston, Ontario.

INVOICE: **Nº 6188**  
DATE: **October 9, 1975.**  
REPORT NO: **975-5**  
PROJECT:

50	Analyses of Gold	@ \$3.50	\$175.00
50	Sample Prep. (rocks)	1.25	62.50
		<b>TOTAL</b>	<b>\$237.50</b>

MINISTRY OF NATURAL RESOURCES  
**RECEIVED**  
 OCT 9 1976  
 RESIDENT GEOLOGIST'S OFFICE  
 SIOUX LOOKOUT

**THIS IS A PROFESSIONAL SERVICE  
ACCOUNTS DUE WHEN RENDERED**



# BONDAR-CLEGG & COMPANY LTD.

784 BELFAST ROAD, OTTAWA, ONTARIO, K1G 3Z5 PHONE: 237-3110 TELEX: 053-3548

Mr. H. W. Higgins,  
980 Bourne Crescent,  
Kingston, Ontario.

INVOICE: **No** 6702

DATE: January 14, 1976.

REPORT NO: 10-6

PROJECT:

5	Analyses of Gold	@ \$3.50	\$17.50
5	Sample Prep. (rocks)	@ 1.25	6.25
		TOTAL	<u>\$23.75</u>

MINISTRY OF NATURAL RESOURCES

**RECEIVED**

OCT 8 1976

RESIDENT GEOLOGIST'S OFFICE  
SIOUX LOOKOUT

THIS IS A PROFESSIONAL SERVICE  
ACCOUNTS DUE WHEN RENDERED

DEPARTMENT OF MINING ENGINEERING  
GOODWIN HALL

Queen's University  
Kingston, Canada  
K7L 3N6

February 16, 1976

Mr. W.H. Higgins,  
1015 Hudson Drive,  
Kingston, Ontario.

Dear Mr. Higgins:

This letter will serve as your receipt for the amount  
of \$35.00 , for analyses and expenses in gold evaluation.

Yours truly,

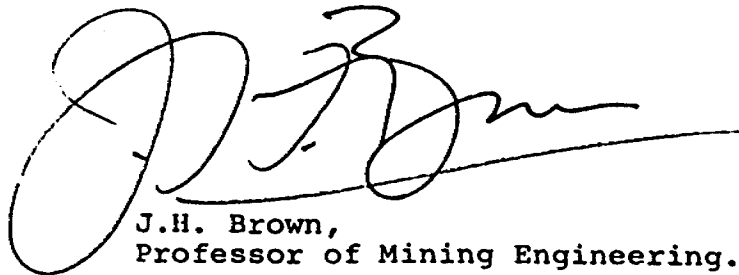

J.H. Brown,  
Professor of Mining Engineering.

JHB/dl

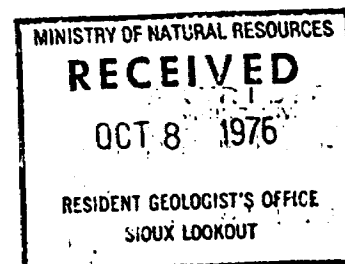



Ontario



52J02SE8705 2.2068 SQUAW LAKE

900

Ministry of  
Natural  
Resources

August 19, 1976

Mr. Harry L. Bell  
Mining Recorder  
Ministry of Natural Resources  
Box 669  
Court House  
Sioux Lookout, Ontario  
POV 2T0

Our file number 2.2068

Your file number

Dear Sir:

Re: Mining Claims Pa. 431450 et al, Squaw Lake,  
File 2.2068

The Assaying of Bulk and Grab samples Section 86(18, 19, & 20) and Geological assessment work credits as shown on the attached statement have been approved as of the above date.

Please inform the recorded holder of these mining claims and so indicate on your records.

Yours very truly,

J. F. McGinn  
Director  
Lands Administration Branch

Whitney Block, Room 1617  
Queen's Park  
Toronto, Ontario  
M7A 1X1  
Phone: 416-965-6918

DN/mw

cc: Mr. Wilfrid H. Higgins  
Kingston, Ontario

cc: Resident Geologist  
Sioux Lookout, Ontario ✓

Squaw Lake  
M-1904



ONTARIO

THE MINING ACT REPORT OF WORK

A separate form is required for each type of work to be recorded.

76-45

To the Recorder of Patricia Division Mining Division

I, Wilfrid H. HIGGINS Miner's Licence A 42266

280 Baurne Crescent Kingston Ontario  
Post Office Address

do hereby report the performance of 19 days of Assaying type of work

not before reported to be applied on the following contiguous claims

Claim No.	Days	Claim No.	Days	Claim No.	Days
<u>431950</u>	<u>3 1/2</u>	.....	.....	.....	.....
<u>431951</u>	<u>3 1/2</u>	.....	.....	.....	.....
<u>431952</u>	<u>3 1/2</u>	.....	.....	.....	.....
<u>431953</u>	<u>3 1/2</u>	.....	.....	.....	.....
<u>431954</u>	<u>3 1/2</u>	.....	.....	.....	.....

Geological Branch ODM  
ASSESSMENT FILES  
RESEARCH OFFICE  
SEP 23 1976  
RECEIVED

All the work was performed on Mining Claim (s) .....  
(In the case of geological and/or geophysical survey (s) where more than 18 claims are involved attach a schedule)

READ CAREFULLY: THE FOLLOWING INFORMATION IS REQUIRED BY THE MINING RECORDER.

For Manual Work, Stripping or Opening up of Mines, Sinking Shafts or Other Actual Mining Operations - Names and addresses of the men who performed the work and the dates and hours of their employment.

For Diamond and other Core Drilling - Footage, No. and angle of holes and diameter of core. Name and address of owner or operator of drill. Dates when drilling was done. Signed core log and sketch in duplicate.

For Compressed Air or Other Power Driven or Mechanical Equipment  
Type of drill or equipment. Names and addresses of men engaged in operating equipment and the dates and hours of their employment.

For Power Stripping - Type of equipment. Name and address of owner or operator. Amount expended. Dates on which work was done. Proof of actual cost must be submitted within 30 days of recording.

With each of the above types of work sketches are required to show the location and extent of the work in relation to the nearest claim post. In the case of diamond or other core drilling the sketch must be submitted in duplicate.

For Geological and Geophysical Survey - The names and addresses of men employed as well as dates. Type of instrument used in the case of geophysical survey. Reports and maps in duplicate must be filed with the Minister within 60 days of recording.

For Land Survey - the name and address of Ontario Land surveyor.

The Required Information is as Follows: (Attach a list if this space is insufficient)

MINISTRY OF NATURAL RESOURCES  
RECEIVED  
OCT 6 1976  
RESIDENT GEOLOGIST'S OFFICE  
SIOUX LOOKOUT

Date 10 September 1976

Wilfrid H. Higgins  
Signature of Recorded Holder or Agent

The Mining Act  
Certificate Verifying Report of Work

I, Wilfrid H. HIGGINS

280 Baurne Cres Kingston Ont  
(Post Office Address)

hereby certify:

1. That I have a personal and intimate knowledge of the facts set forth in the report of work annexed hereto, having performed the work or witnessed same during and/or after its completion.
2. That the annexed report is true.

Dated 10 Sept 19 76

Wilfrid H. Higgins  
Signature

431450

THE PENALTY FOR MAKING A FALSE STATEMENT IN THIS REPORT AND/OR CERTIFICATE IS \$500. OR SIX MONTHS IMPRISONMENT OR BOTH



Recorded Holder	Wilfrid H. Higgins
Township or Area	Squaw Lake

Type of survey and number of Assessment days credit per claim	Mining Claims
<b>Geophysical</b> Electromagnetic _____ days Magnetometer _____ days Radiometric _____ days Induced polarization _____ days Section 86 (18) _____ days Geological _____ 23 _____ days Geochemical _____ days Man days <input checked="" type="checkbox"/> Airborne <input type="checkbox"/> Special provision <input type="checkbox"/> Ground <input type="checkbox"/>	Pa. 431450 to 54 inclusive
<b>Notice of Intent to be issued:</b> <input type="checkbox"/> Credits have been reduced because of partial coverage of claims. <input type="checkbox"/> Credits have been reduced because of corrections to work dates and figures of applicant. <input type="checkbox"/> No credits have been allowed for the following mining claims as they were not sufficiently covered by the survey: _____ _____ _____ _____ _____	

The Mining Recorder may reduce the above credits if necessary in order that the total number of approved assessment days recorded on each claim does not exceed the maximum allowed as follows: Geophysical — 80; Geological — 40; Geochemical — 40;

Recorded Holder	Wilfrid H. Higgins
Township or Area	Squaw Lake

Type of survey and number of Assessment days credit per claim	ASSAYING
<p><b>Geophysical</b></p> <p>Electromagnetic _____ days</p> <p>Magnetometer _____ days</p> <p>Radiometric _____ days</p> <p>Induced polarization _____ days</p> <p>Section 86 (18) 19, &amp; 20 see across _____ days</p> <p><b>Geological</b> _____ days</p> <p><b>Geochemical</b> _____ days</p> <p>Man days <input type="checkbox"/> Airborne <input type="checkbox"/></p> <p>Special provision <input type="checkbox"/> Ground <input type="checkbox"/></p>	<p>3 Bulk samples</p> <p>50 Grab samples</p> <p>collected from mining claims Pa. 431450 to 431454 inclusive.</p> <p>Amount expended on assaying of samples = \$296.25</p> <p>Total assessment days credit allowed = 19 days</p> <p>The assessment work credits of 19 days is to be proportioned on the above 5 mining claims as 3.5 days for each claim.</p> <p><i>L. B. ...</i></p> <p>Approved - August 19, 1976</p>
<p><b>Notice of Intent to be issued:</b></p> <p><input type="checkbox"/> Credits have been reduced because of partial coverage of claims.</p> <p><input type="checkbox"/> Credits have been reduced because of corrections to work dates and figures of applicant.</p> <p><input type="checkbox"/> No credits have been allowed for the following mining claims as they were not sufficiently covered by the survey:</p> <p>_____</p> <p>_____</p> <p>_____</p> <p>_____</p> <p>_____</p>	



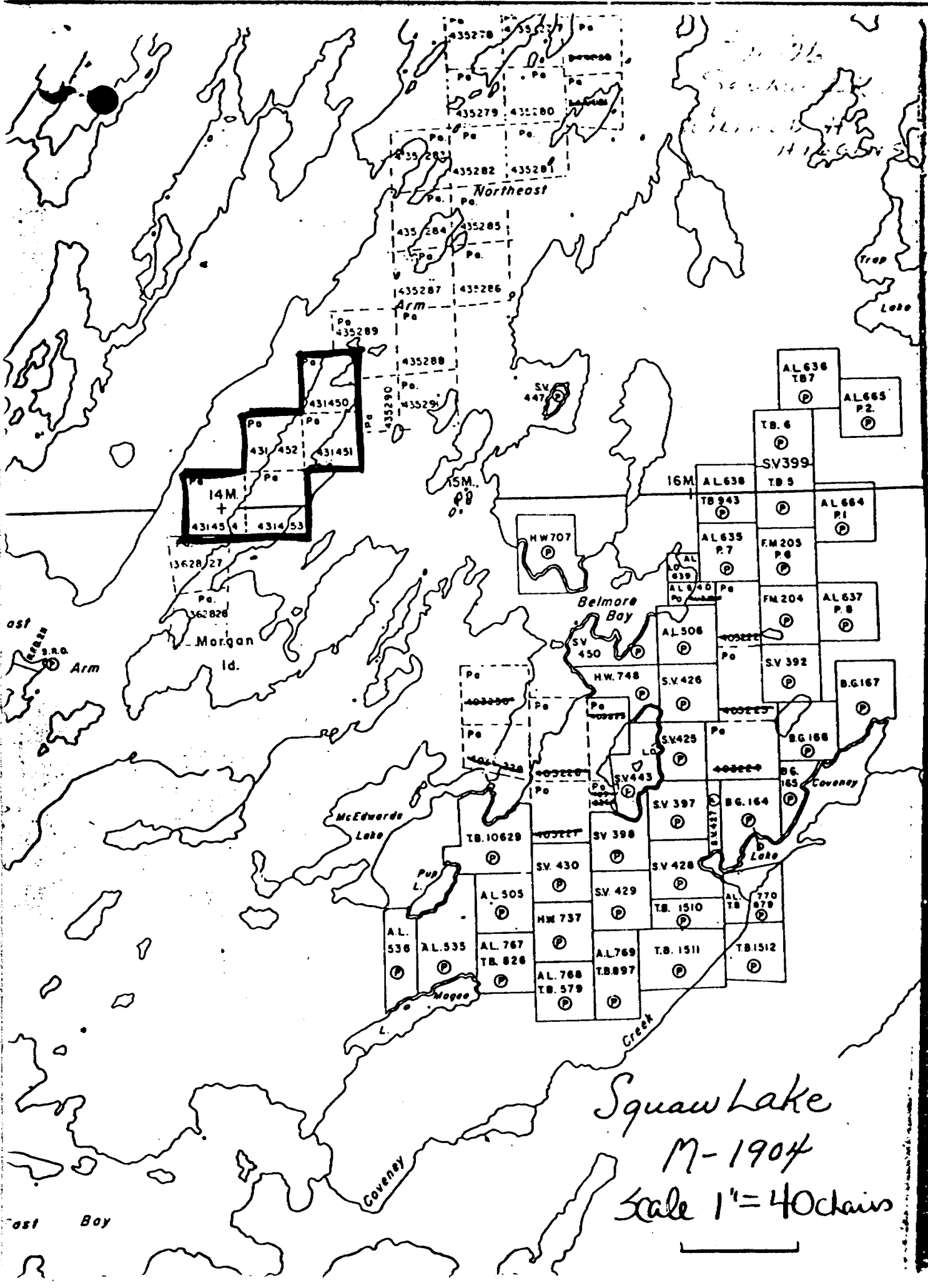

Squaw Lake  
 M-1904  
 Scale 1" = 40 chains



Total expenditures  
including Assays  
Total \$3305.68

W.H. Higgins Expenditures in relation to Morgan

Island gold claims & geological survey of same

		<u>amt</u>	<u>receipt #</u>
<u>April 24/75</u>	Ont. Min. of Natural Resources - lic. & claim Tags.	20.00	H-1
<u>Sept 5</u>	STAKES & Crayons for survey. - - - -	49.25	H-2
	Axes & file - - - -	33.71	H-3
<u>Sept 9</u>	CNR - Kingston To Toronto W.H.H. 9.75		
	% Skyline Hotel - - - 22.58		H-4
	airline TAXI - - - - 2.50		
	lunch - W.H.H. & 2 men, English River 7.65	42.48	
<u>SEPT 23</u>	Bay Hill Dev. - services of 2 workmen for 2 weeks - -	844 <sup>00</sup>	H-5
<u>Sept 22</u>	Weekend o/T wages - Kevin Kehoe - - - -	253 <sup>60</sup>	H-6
	weekend. o/T wages - Jack Howes - - - -	253 <sup>60</sup>	H-7
<u>Sept 21</u>	2 workmens expenses driving Truck To Savent lake & back.		
	meals - receipts - - - 25.00		
	accommodation. Sept 8, 9 = 52.50		
	Sept 19, 20 = 53.55		
	meals & misc exp. <del>receipts</del> 48.95 ✓	180 <sup>00</sup>	H-7
<u>Sept. 8-21</u>	gasoline for Truck 2 workmen, equipment & mill samples of ore.	151 <sup>74</sup>	H-8
<u>Sept 14-20</u>	Wilderness Lake Lodge - Cabin # 40.00	40 <sup>00</sup>	
	food - 57.22 + 4.49 - - - - 61.71	61 <sup>71</sup>	H-9
<u>Sept 19</u>	lunch - Wawa - - - -	4 <sup>90</sup>	
	dinner - Iron Bridge - - - -	8 <sup>75</sup>	
<u>Sept 20</u>	dinner. Caroline Beach. - - - -	26 <sup>50</sup>	
<u>Sept 24</u>	Four Way Graphics - enlargement of Ministry Map - -	23 <sup>52</sup>	H-10
<u>Oct 9 /75</u>	Bondar - Clegg & Co - 50 samples analyzed for gold content 23T <sup>50</sup>		H-11
	Total	<u>2232.06</u>	



Ontario

Ministry of  
Natural  
Resources

H-1

OFFICIAL RECEIPT

OFFICE AT Toronto DATE April 24/75  
 RECEIVED FROM Mr. W. H. Higgins  
 ADDRESS 1015 Hudson Drive  
Kingston, Ont. C 055191

DETAILS	PERMIT NO.	AMOUNT	TOTAL
New license - 1975-76 A 42266			5.00
(15) Sets of Tags - # 131450 to 431464 encl.			15.00
FOR ACCT OF (A 42266)			
RECEIVED BY <u>M.C.</u>			TOTAL 20.00

CHECK/FORM RECEIVED  
 CASH  CK  M O

FORM FM 077  
 6-74 100M 74-1165T

FILE NUMBER \_\_\_\_\_  
 BY ADDRESS OF ISSUANCE \_\_\_\_\_  
 REVENUE FILE # 41-20



3019 2150 HIGGINS  
 KINGSTON ONT 9  
 1015 HUDSON DR

H4

420774

NO	DATE	DESCRIPTION	AMOUNT	TAX	TOTAL
	8-9-75	R 3018	21.50		
	8-9-75	TAX 3019	1.00		
					# 22.50
					22.58

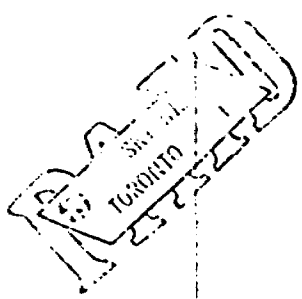

054 246 159 5 500AX  
 VALID 07 75 THRU 06 75  
 HIGGINS  
 19 0 75

NOUS APPRECIERIONS VOTRE CLIENTELE  
 ET ESPERONS QUE VOUS SEREZ  
 TROUVEZ NOS SERVICES EXCELLENTS.  
 S'IL VOUS PLAIT, MERCI DE  
 NOUS EN FAIRE PART EN UN  
 BREVET.



SKYLINE HOTELS

The Canadian Chain of Lodging Companies

WE APPRECIATE YOUR COURTESY  
 AND HOPES TO SERVE YOU  
 IN THE FUTURE. PLEASE  
 FEEL FREE TO CONTACT US BY  
 PHONE OR MAIL AT THE  
 ADDRESS LISTED BELOW.

SI NECESSAIRE, NOUS VOUS  
 SUGGERONS DE GARDER LA PRESENTE COPIE  
 POUR VOS DECLARATIONS D'IMPOTS.

TORONTO • MONTREAL • OTTAWA  
 KINGSTON • WINDSOR • VANCOUVER

IF REQUIRED, WE SUGGEST  
 YOU RETAIN THIS STATEMENT  
 FOR INCOME TAX PURPOSES.

HODGINS  
 (4)

4088 5015

0 03711L  
 0 00161 +  
 0 000000  
 0 03210 S  
 0 01430 +  
 0 01430 +  
 9 99920000  
 0 00350 +  
 9 44900000

H-3  
 THANK YOU

# BAYHILL

William A. Higgins Construction

DATE September 23rd, 1975

re: Two weeks, services for two men.

Jack Howes 80 hrs.....@ 4.80 384.00

Kevin Kehoe 80 hrs.....

*768.00*

Plus 10% for Vacation  
Pension, UIC, etc.

842.80

*# 133  
23 546 78*

*(H.S.)*

*#5*

**BAYHILL DEVELOPMENT LIMITED**

Bayridge Subdivision  
800 Development Drive, Kingston Phone 389-1025  
K7M 4W8

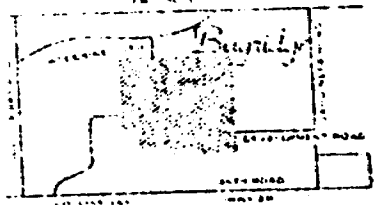

THE BANK OF NOVA SCOTIA  
523 GARDINER'S ROAD  
KINGSTON, ONT.

Scotiabank 

132      September 22, 1975  
NO      DATE

PAY TO THE ORDER OF      Kevin Kehoe

\$ 253.60

SUM OF      Two Hundred and Fifty-three-----60/100      DOLLARS

WILLIAM A. HIGGINS CONSTRUCTION

*H-6*

*William A. Higgins*

⑆ 2480 2000 21 0004 8 18 ⑈      ⑈0000025360⑈

THE BANK OF NOVA SCOTIA  
523 GARDINER'S ROAD  
KINGSTON, ONT.

Scotiab

731      September  
NO      DATE

PAY TO THE ORDER OF      Jack Howes

253.60

SUM OF      Two Hundred and Fifty-three-----60/100

WILLIAM A. HIGGINS CONSTRUCTION

*William A. Higgins*

⑆ 2480 2000 21 0004 8 18 ⑈      ⑈0000025360⑈





CASH CREDIT

WE ACKNOWLEDGE RECEIPT OF THE AMOUNT PRINTED BELOW WHICH HAS BEEN CREDITED TO YOUR ACCOUNT. PLEASE RETAIN THIS COPY FOR REFERENCE.

NAME M Kehoe DATE Sept 19/75  
ROOM OR ACCOUNT NO. 123  
DATE \_\_\_\_\_ AMOUNT \_\_\_\_\_

DO NOT WRITE IN SPACE ABOVE

<input type="checkbox"/> ADVANCE PAYMENT	28.00
<input type="checkbox"/> PAYMENT ON ACCOUNT	1.40
<input type="checkbox"/> OTHER (EXPLAIN)	
	29.40

*[Signature]*  
Authorized Signature

No. \_\_\_\_\_ 28 Sept 1975  
Received from Blaine Kehoe The sum of  
Forty-eight dollars 100 95 Dollars  
for meals and miscellaneous travel expenses from  
August 4 Thunder Bay  
\$ 48.95 Blaine Kehoe

ROOM \_\_\_\_\_ NAME (SURNAME FIRST) \_\_\_\_\_ RATE No. PER \_\_\_\_\_  
STREET \_\_\_\_\_ CITY \_\_\_\_\_ PROV. OR STATE \_\_\_\_\_  
AREA CODE 307 TELEX 073-4536  
TELEPHONE 243-9621



MEMO	DATE	DESCRIPTION	CHARGE	CREDIT	BALANCE
	SEP-9-75	PAID		A* 25.20	25.20
	SEP-9-75	ROOM 4111	C* 24.00		
	SEP-9-75	TAX 4111	C* 1.20		

THE COMMODORE MOTOR HOTEL  
HIGHWAY 17 EAST PHONE 254-6417  
SAULT STE. MARIE, ONTARIO

ROOM <u>105</u>	DATE <u>8/19-75</u>	AMT. PAID <u>\$ 27.32</u>	CLERK <u>[Signature]</u>
--------------------	------------------------	------------------------------	-----------------------------

THANK YOU CALL AGAIN

SOLD BY: [ ]

DATE: MO. DAY YR. [ ] 7 [ ]

PRODUCT	QUANTITY	PRICE	AMOUNT
REGULAR	10.2	91.9	934
TAX			
TOTAL			934

thank you

*Kevin Kehle*

IMPERIAL OIL LIMITED

35 950-2 11/73

H-8

gas.

Sept 8-21

AMOUNT OF PURCHASE: [ ]

SOLD TO: [ ]

SOLD BY: [ ]

LICENSE NO. [ ] PROV/STATE [ ]

DATE: MO. DAY YR. [ ] [ ] [ ]

PRODUCT	QUANTITY	PRICE	AMOUNT
REGULAR	10.837		900
TAX			
TOTAL			900

thank you

*Kevin Kehle*

IMPERIAL OIL LIMITED

35 950-2 11/73

51553274

AMOUNT OF PURCHASE: [ ]

SOLD TO: [ ]

SOLD BY: [ ]

LICENSE NO. [ ] PROV/STATE [ ]

DATE: MO. DAY YR. [ ] [ ] [ ]

PRODUCT	QUANTITY	PRICE	AMOUNT
REGULAR	10.5		925
TAX			
TOTAL			925

thank you

*Kevin Kehle*

IMPERIAL OIL LIMITED

35 950-2 11/73

AMOUNT OF PURCHASE: [ ]

SOLD TO: [ ]

SOLD BY: [ ]

LICENSE NO. [ ] PROV/STATE [ ]

DATE: MO. DAY YR. [ ] [ ] [ ]

PRODUCT	QUANTITY	PRICE	AMOUNT
REGULAR	10.4		800
TAX			
TOTAL			800

thank you

*Kevin Kehle*

IMPERIAL OIL LIMITED

35 950-2 11/73

517577597

SOLD TO: [ ]

SOLD BY: [ ]

HOUSTON ESSO

RR 2

DATE: MO. DAY YR. [ ] [ ] [ ]

LICENSE NO. [ ] PROV/STATE [ ]

PRODUCT	QUANTITY	PRICE	AMOUNT
REGULAR	10.4		800
TAX			
TOTAL			800

thank you

*Kevin Kehle*

IMPERIAL OIL LIMITED

35 950-2 11/73

AMOUNT OF PURCHASE

SOLD TO  
SOLD BY  
ADDRESS COMPANY  
DATE: MO DAY YR

LICENSE NO. PROV. STATE  
**D61 002**

PRODUCT	QUANTITY	PRICE	AMOUNT
Motor Oil	7.9	8/16	6.90
TAX			
TOTAL			6.90

thank you  
*Kevin Kelpie*  
ESSEX OIL LIMITED



AMOUNT OF PURCHASE

SOLD TO  
SOLD BY  
ADDRESS COMPANY  
DATE: MO DAY YR

LICENSE NO. PROV. STATE

PRODUCT	QUANTITY	PRICE	AMOUNT
Motor Oil	11.3	9.30	9.30
TAX			
TOTAL			9.30

mercî - thank you  
*Kevin Kelpie*  
ESSEX OIL LIMITED



AMOUNT OF PURCHASE

SOLD TO  
SOLD BY  
ADDRESS COMPANY  
DATE: MO DAY YR

LICENSE NO. PROV. STATE

PRODUCT	QUANTITY	PRICE	AMOUNT
Motor Oil	7.50		7.50
TAX			
TOTAL			7.50

thank you  
*Kevin Kelpie*  
ESSEX OIL LIMITED



AMOUNT OF PURCHASE

SOLD TO  
SOLD BY  
ADDRESS COMPANY  
DATE: MO DAY YR

LICENSE NO. PROV. STATE  
**D61-002**

PRODUCT	QUANTITY	PRICE	AMOUNT
Motor Oil	9	8.35	8.35
TAX			
TOTAL			8.35

thank you  
*Kevin Kelpie*  
ESSEX OIL LIMITED



SOLD TO  
SOLD BY  
ADDRESS COMPANY  
DATE: MO DAY YR

LICENSE NO. PROV. STATE  
**D6100200**

PRODUCT	QUANTITY	PRICE	AMOUNT
Motor Oil	7.5	8.34	8.15
TAX			
TOTAL			8.15

thank you  
*Kevin Kelpie*  
ESSEX OIL LIMITED



SOLD TO  
SOLD BY  
ADDRESS COMPANY  
DATE: MO DAY YR

LICENSE NO. PROV. STATE

PRODUCT	QUANTITY	PRICE	AMOUNT
Motor Oil	10.50		10.50
TAX			
TOTAL			10.50

thank you  
*Kevin Kelpie*  
ESSEX OIL LIMITED

250 777 799 9 01

AMOUNT OF PURCHASE  
**00.00**

250 777 799 9 0674

AMOUNT OF PURCHASE  
**010.50**

AMOUNT OF PURCHASE  
10.00

SOLD TO

SOLD BY

CUSTOMER'S SIGNATURE  
*Kevin Heber*

NO. DAY YR.  
1 17 75

PRODUCT	QUANTITY	PRICE	AMOUNT
ES90	1.0		10.00
TAX			
TOTAL			10.00

happy motoring

LICENSE NO. PROV./STATE  
K22444-43374-092

IMPERIAL OIL LIMITED

515725237



AMOUNT OF PURCHASE  
10.60

SOLD TO

SOLD BY

LICENSE NO. PROV./STATE

DATE: MO. DAY YR.  
1 17 75

PRODUCT	QUANTITY	PRICE	AMOUNT
ES90	1.0		10.60
TAX			
TOTAL			10.60

thank you

CUSTOMER'S SIGNATURE  
*Kevin Heber*

IMPERIAL OIL LIMITED

5153072 11773



AMOUNT OF PURCHASE  
9.00

SOLD TO

SOLD BY

LICENSE NO. PROV./STATE

DATE: MO. DAY YR.  
1 17 75

PRODUCT	QUANTITY	PRICE	AMOUNT
ES90	1.0		9.00
TAX			
TOTAL			9.00

thank you

CUSTOMER'S SIGNATURE  
*Kevin Heber*

IMPERIAL OIL LIMITED

5153072 11773



AMOUNT OF PURCHASE  
8.75

SOLD TO

SOLD BY

LICENSE NO. PROV./STATE  
D61-002 OUT.

DATE: MO. DAY YR.  
1 17 75

PRODUCT	QUANTITY	PRICE	AMOUNT
ES90	1.0		8.75
TAX			
TOTAL			8.75

thank you

CUSTOMER'S SIGNATURE  
*Kevin Heber*

IMPERIAL OIL LIMITED

514715215



SOLD TO

SOLD BY

DATE: MO. DAY YR.  
1 17 75

LICENSE NO. PROV./STATE

AMOUNT OF PURCHASE  
10.75

TAX

TOTAL

ES90

10.75

10.75

10.75

IMPERIAL OIL LIMITED

5153072 11773

SOLD TO

SOLD BY

DATE: MO. DAY YR.  
1 17 75

LICENSE NO. PROV./STATE

AMOUNT OF PURCHASE  
8.15

TAX

TOTAL

ES90

8.15

8.15

8.15

IMPERIAL OIL LIMITED

5153072 11773

250 111 199 9 0815 00815

# BARRIE To Savant Lake (Morgan Island) & Return

(September 12 - 21, 2258 miles round Trip)

		Amount	Receipt #
	Sept 10 - Air Canada - Ft 341 - Malton - Thunder Bay	63. <sup>75</sup>	-
Fri	<u>Sept 12</u> - motel accommodation, Blind River	21. <sup>00</sup>	①
	- 4 CBO, Massey	17. <sup>15</sup>	②
SAT.	<u>Sept 13</u> - breakfast	7. <sup>55</sup>	-
	- petrol	7. <sup>40</sup>	-
	- lunch	5. <sup>75</sup>	-
	- dinner	8. <sup>00</sup>	-
	- 4 CBO, Shabagua Corners	6. <sup>50</sup>	-
	- motel accommodation	19. <sup>95</sup>	③
Sun	<u>Sept 14</u> - breakfast	6. <sup>00</sup>	-
	- petrol	8. <sup>00</sup>	-
	- lunch	9. <sup>50</sup>	-
	Sept 14-19 Mousseau's Wilderness Island Camp	753. <sup>75</sup>	④
Fri	<u>Sept 19</u> - petrol	8. <sup>00</sup>	-
	- motel accommodation - Dorion	25. <sup>40</sup>	-
SAT.	<u>Sept 20</u> - breakfast	13. <sup>95</sup>	⑤
	- petrol	8. <sup>60</sup>	-
	- canned pop	1. <sup>50</sup>	-
	- motel accommodation - Iron Bridge	27. <sup>30</sup>	⑤
Sun	<u>Sept 21</u> - petrol	8. <sup>60</sup>	-
	- breakfast	12. <sup>35</sup>	⑦
		<u>1027.60</u>	

direct & indirect expenses,

	- 2qt crankcase oil - Cdn Tire	1.84 ✓	
	- Oil for addition To diesel fuel. Cdn Tire - 2gal	5.38 ✓	
	- Felt pen	.83 ✓	(10)
	- bushman's <sup>best</sup> axe - Cdn Tire	9.95	
	- 2 1/2 # hammer - "	5.19	
	- 1qt chainsaw oil - "	1.39	
	- 1 gal naphtha. gas - "	1.71	
	- paper Towelle -	.87 ✓	(8)
Sept 12.	- meat food (meat).	5.54 ✓	(9)
Sept 12	- Cooper Tool- 200' Tape, 11 chainsaw pins	87.78	(11)
Aug 19	- Flashlight - Cdn Tire	6.17 ✓	(12)
Sept 9			
	<u>Cambridge</u>		
	- 250 soil sample bags 17 <sup>25</sup> +5%	18.38	
	- 200 ore sample bags & Ties 16 <sup>40</sup> +5%	17.22	
Aug 18/25	- 1-8"moil & 2 points (8 <sup>25</sup> , 10 <sup>15</sup> , 10 <sup>25</sup> ) +5%	32.18	
	- 10" pan. - 2 <sup>30</sup> +5%	2.62	
	- felt pen marker - 1 <sup>10</sup> +5%	1.16	
	- waterproof match box, compass, whistle, flint 2 <sup>50</sup> +5%	2.62	

- automotive crankcase oil - 2qt. Cdn Tire - - - - - 1.84  
 - diesel fuel oil additive 2gal - - - - - 5.38  
 - felt pen marker - - - - - 83 (10)  
 sept. - paper Towells - - - - - 87 (8)  
 " - food - meat - - - - - 554 (9)

Aug 18 - Bangridge  
 250 soil sample bags - - - - - 17<sup>50</sup>  
 200 10x16 ore sample bags - - - - - 16<sup>40</sup> (13)  
 1 - 8" mail - - - - - 8<sup>75</sup> (14)  
 2 - points for above @ 10<sup>45</sup> ea 21<sup>90</sup>  
 1 - 10" Ø gravel washing pan - 2<sup>50</sup>  
 1 - felt pen marker 1<sup>10</sup> 68 15  
 5% PSTax - - - - - 341 31<sup>50</sup>

46<sup>02</sup>  
102760  
107362

direct applicable expenditure by J.K.N.



## STATEMENT / ÉTAT DE COMPTE

④

M. &amp; NIXON

In Account With  
Doit ÀMAUSSEAU  
ESLAND (A.M.S.)

Terms/Conditions

SEPT 10 - 14

DAY 5	3 PARTIAL PLAN	20.00 each	300.00	
DAY 8	4 2 PARTIAL PLAN	20.00 each	160.00	
DAY 4	H.K. CARIN @	20.00	80.00	
DAY 9	BOAT & MOTOR	75.00	135.00	
10	Mixed GAS @		15.00	
	TRANSPORTATION	2 TRIP	30.00	
	5 TO SALES TAX @	675.00	33.75	
			\$ 753.75	
	LESS DEPOSIT		150.00	
			\$ 603.75	
	P. A. MAUSSEAU			

**Lapgridge**  
LIMITED

(13)

AND ITS SUBSIDIARY

**TARLING MAP MOUNTING CO.**  
105 CHURCH ST. • TORONTO, M5C 2G3 • PHONE 366-1108

DATE April 8 1975NAME J. R. Nixon

ADDRESS \_\_\_\_\_

QUANTITY	DESCRIPTION	AMOUNT
1	Mail tip	10.95
1	Postmark	2.44
1	Markers	1.10
1	10" Paper	2.50
	Mail bags	17.50
		34.84

RECEIVED BY Prospect supl RC4-60 TAX 3.75  
TOTAL 38.09

CLERK	CASH	C.O.D.	CHARGE	CHACCT.	MOBE. RT'D.	PAID OUT

# FASTCAMS

CA 1218

Thank You!

**Lapgridge**  
LIMITED

(14)

AND ITS SUBSIDIARY

**TARLING MAP MOUNTING CO.**  
104 ADELAIDE ST. W. • TORONTO 1, ONT. • PHONE 366-1108

DATE August 18 1975NAME J. R. NixonADDRESS 8 Centennial Bldg

QTY.	DESCRIPTION	AMOUNT
1	Mail Handle	8.75
1	Mail tip	10.95
100	10x16 plastic Bags	16.40
		36.10

RECEIVED BY \_\_\_\_\_ TAX 1.81  
TOTAL 37.91

CLERK	REC'D BY	CASH	C.O.D.	CHGE	ON ACC	MOBE. RT.	PD. OUT

CA 12288

Thank You!

YOUR RECEIPT  
THANK YOU

21 SEP 75

\$002.80 —

\$000.80 —

354 \$003.60 CASH TOTAL

YOUR RECEIPT  
THANK YOU

21 SEP 75 (7)

\$000.35 —

\$000.35 —

\$000.50 —

\$000.50 —

\$002.00 —

\$001.35 —

\$001.70 —

\$002.00 —

355 \$008.75 CASH TOTAL

YOUR RECEIPT  
THANK YOU

(9) *pen*

012813: 012814: 012815: 012816: 012817: 012818: 012819: 0600: 00: 21 SEP 75

WE APPRECIATE  
YOUR  
PATRONAGE

(6)

0650 GEN  
0745 GEN

1395 A

THANK YOU

9434 20 SEP 75

7993 12 SEP 75

160 00.79 M2  
00 00.04 ST  
00 00.83 AN  
00 00.83 TD  
Marksalot pen  
Pack Samples  
00 00.00 BU

(12)

Belts (1x) —  
Hammer —  
1 gal oil —  
1 gal oil —  
220 oil —  
Chain oil —  
220 1st oil —  
Naptha —  
Lube —  
Screw Tnk —

(10)

(8) *pen*

Account from Fr. 21-21  
run fgin — 17 15  
break set — 750  
diesel - 10 gal — 740  
lunch - Sat — 511  
Bironic II — 8 00  
1 rum — 6 50  
Motel SAT — 19 95  
Break Sun — 6 00  
fuel — 8 00  
lunch Sun - silburg — 9 50  
  
Fuel Fri — 8 00  
Acc Fri — 25 00  
Break Sat — 13 25  
fuel — 0 00  
Set Accom — 27 00  
soft drinks — 6 50  
San fuel — 0 00  
  
1079  
225 trail 1059

198

0083-  
0004:  
0087  
0102  
0015



Room or Cottage No. /	Date Sept 20	Amt. Paid \$ 2430	Clerk EP
-----------------------	--------------	-------------------	----------

THANK YOU

STOP AGAIN

STOCK MOTOR INN LIMITED  
IRON BRIDGE, ONTARIO

Old Mill Motel  
PHONE (705) 356-2237

BOX 251, HIGHWAY 17 EAST  
BLIND RIVER, ONTARIO

NAME NIXON J.R.

Room 19	Date Sept 12/75	Amount Paid \$ 57.51	Clerk OR
---------	-----------------	----------------------	----------

THIS IS YOUR RECEIPT — THANK YOU!

5

THIS IS YOUR RECEIPT  
PLEASE RETAIN

TRILLIUM MOTEL  
DORION, ONTARIO

DATE Sept 19 1975

NAME Mr. J.S. Fisher

ROOM NO.	544
ROOM	\$ 14.70
MISC.	\$
PHONE	\$
PROV. TAX	\$
TOTAL	\$ 25.40

TRILLIUM MOTEL  
PER J.S. Fisher  
THANK YOU!

3

TIMBERLAND MOTEL  
HIGHWAY 17, SHABAGUA  
40 MILES WEST OF THUNDER BAY  
R.R. 2  
KAMINISTIQUIA, ONTARIO, P.O. 1X0  
PHONE 933-4323

DATE Sept 13 1975

NAME \_\_\_\_\_

ROOM NO.	3
ROOM	\$ 19.08
MISC.	\$
PHONE	\$ 95
TOTAL	\$ 19.95

TIMBERLAND MOTEL  
PER Dr. [unclear]  
THANK YOU!



Ontario

STORE 256  
SEP 12 1975  
MASSEY

617.15

LIQUOR CONTROL BOARD OF ONTARIO

THE ABOVE REGISTERED AMOUNT REPRESENTS PURCHASES

5 73-6/74

AIR CANADA (2) PASSENGER TICKET AND BAGGAGE CHECK BILLET DE PASSAGE ET BILLETIN DE BAGAGES  
Subject to Conditions of Contract Soumis aux Conditions de Transport

014 4430713606

FLIGHT COUPON  
COUPON DE VOL  
No. 4

CLASS OF SERVICE	FARE BASIS	CARRIER	FLIGHT NO.	CLASS	DATE	TIME	STATUS	FARE	TAXES	TOTAL
Y	Y	AC	800	Y	SEP 12 1975	19:00	OK	53.00	4.70	57.70
Y	Y	AC	800	Y	SEP 13 1975	19:00	OK	4.70		4.70

WESTLHA

4 014 4430713606 6 4

PLEASE DUE TO GOVT APPROVAL

Squaw Lake

M. 1904

Scale:  
1" = 40 chains

Sturgeon

Lake

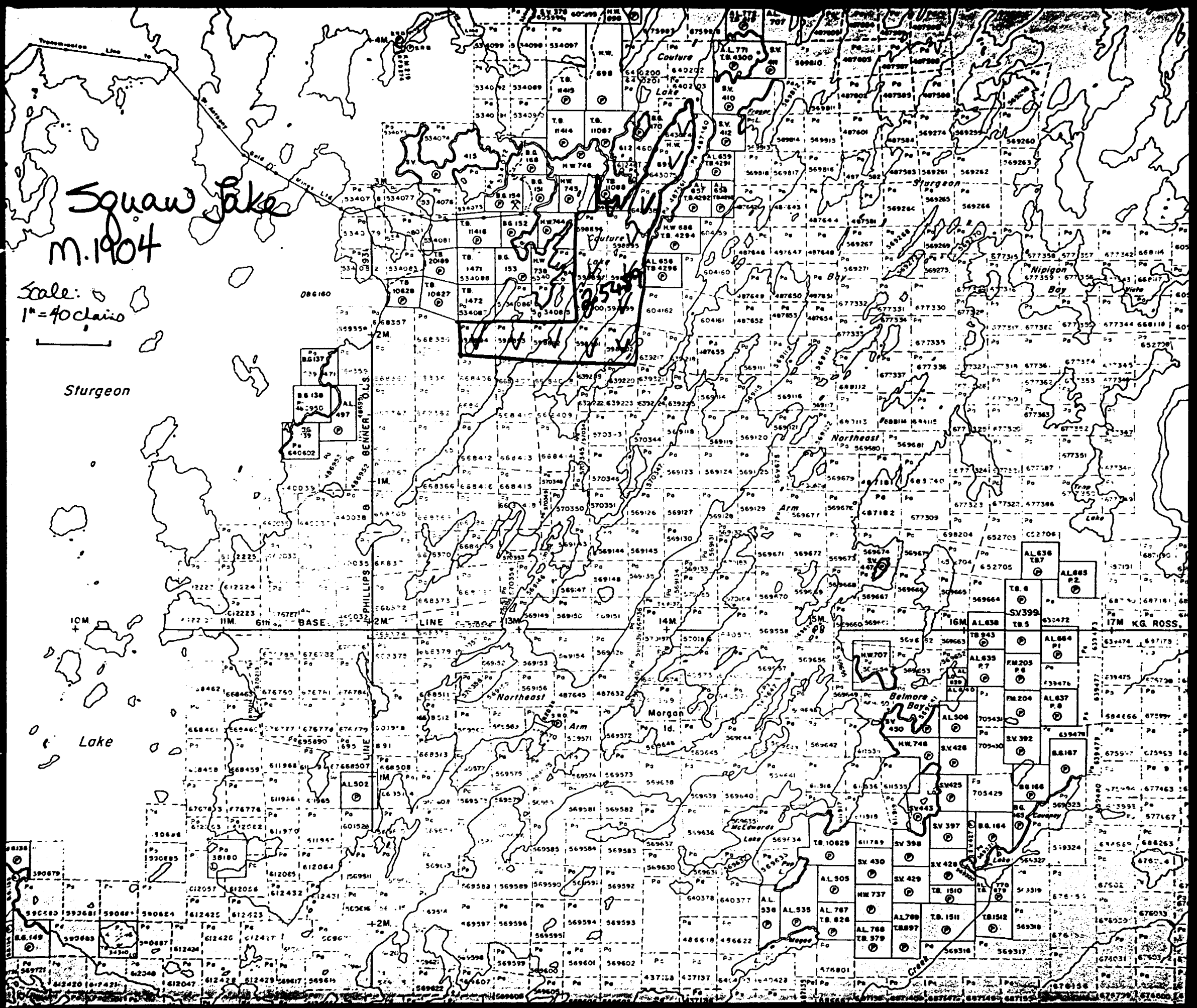

FOR ADDITIONAL

INFORMATION

SEE MAPS:

52J/02SE-0030 # 1, 2

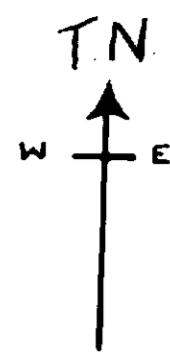

NORTHEAST ARM  
STURGEON LAKE

CL-431450

CL-431452

MORGAN  
ISLAND

CL-431451

CL-431454

CL-431453

523/02SE 0027 #1

AVALON SYNDICATE

MORGAN ISLAND  
NORTHEAST ARM - STURGEON LAKE  
PATRICIA MINING DIVISION

CLAIM MAP

Date: Staked: 27 April 1975 Scale: 1" = 200ft  
Owner: W.H. Higgins Licence No A-42266

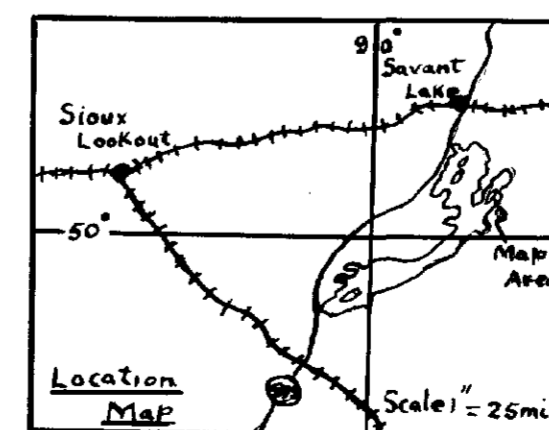



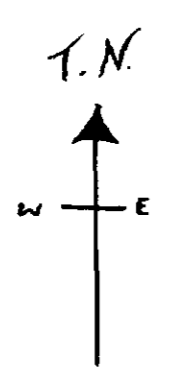

NORTHEAST ARM  
STURGEON LAKE

SYMBOLS	
	Outcrop
	Fault
	Contact
	Shearing
	Swamp

### LEGEND

#### MAFIC INTRUSIVES

**1.** Metadiorite, porphyritic metagabbro

#### METAVOLCANICS

**2** Acid Agglomerates, volcanic conglomerates, acid tuffs and breccias.

**3** Andesite - pillowed and massive.

**4** Felsic carbonate breccia, both laminated and with lepilli sized pinkish felsic clasts.

**5** Mafic carbonate breccia, both bedded and with mafic agglomerate clasts.

**6** Dacite tuff, dacitic schists, sericite schists, agglomerates and breccias.

MORGAN ISLAND

52J/02SE-0027 #2

AVALON SYNDICATE

MORGAN ISLAND  
NORTHEAST ARM - STURGEON LAKE

PATRICIA MINING DIVISION

### GEOLOGY

Date: 10-19 Sept 1975 Scale: 1" = 200ft.  
Geologist: W.H. Higgins.

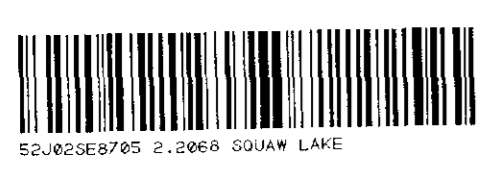
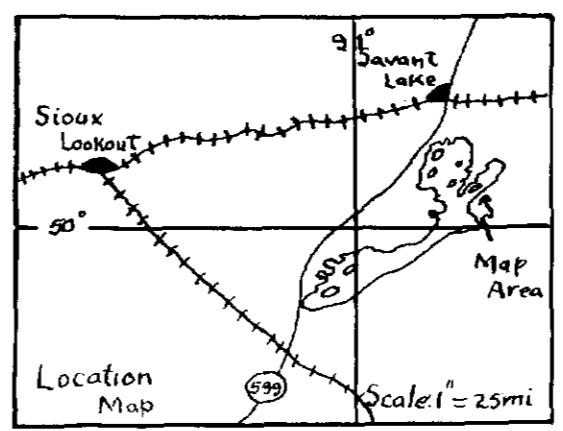



NORTHEAST ARM  
STURGEON LAKE

MORGAN  
ISLAND

LEGEND

- Cut and Chained Lines
- - - Traverse Lines
- +<sup>20</sup> Assay in ppb
- ⊙<sup>20</sup> Assay of 250lb samples in ppb.

AVALON SYNDICATE  
MORGAN ISLAND  
NORTHEAST ARM - STURGEON LAKE  
PATRICIA MINING DIVISION  
CUT AND TRAVERSE LINES

Date: 10-19 Sept 1975 Scale 1" = 200ft  
Line Cutters: J. Howes, K. Kehoe

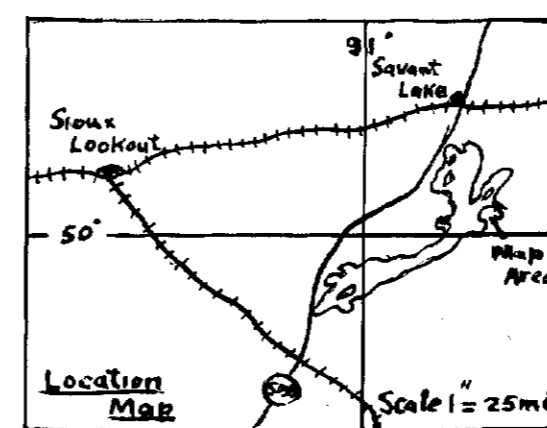

52J/02SE-0027#3

