



52J02SE9260 36 SQUAW LAKE

010

DIAMOND DRILLING

Area: SQUAW LAKE

Report No: 36

WORK PERFORMED FOR: MISTANGO CONSOLIDATED RESOURCES LTD.

RECORDED HOLDER: SAME AS ABOVE [x]

: OTHER []

<u>CLAIM NO.</u>	<u>HOLE NO.</u>	<u>FOOTAGE</u>	<u>DATE</u>	<u>NOTE</u>
Pa 590680	M-86-1	350'	May/86	(1)
	M-86-2	297'	May/86	(1)
Pa 590681	M-86-3	347'	May/86	(1)
Pa 612421	M-86-7	497'	June/86	(1)
Pa 590687	M-86-8	486'	June/86	(1)

TOTAL: 5 OH 1977'

NOTES: (1) #124-86

Claim 590680
B.Q. Core size
Core stored at Mousseau
Camp - sturgeon Lake

DIAMOND DRILL RECORD

MISTANGO CONS. RES. LTD.

HOLE NO. M-86-1 SHEET NO. 1

GEOLOGY-

LATITUDE 0 + 20N DATUM STARTED May 16, 1986
DEPARTURE 111 + 20W BEARING Due South COMPLETED May 20, 1986
ELEVATION Lake & 4.0' DIP -40° @ 300' - 40° ULTIMATE DEPTH 350.0'

DEPTH FEET	FORMATION	FORMATION
0-8.0	Casing	
8.0-22.0	Trondheimite. This is a coarse grained porphyry that consists of 50-60% white plagioclase feldspar as phenocrysts up to 8mm. diam. 10%-20% qtz. phenocrysts up to 5mm diam. and a finer ground mass that consists of qtz. feldspar and minor ferromagnesians.	
22.0-29.0	Trondheimite, finer grained contact phase, slightly silicified in parts, minor pyrite.	
29.0-79.0	Trondheimite, greyish, coarse grained, as above.	
79.0-81.0	A gabbro dyke, dk. greenish fine grained contacts at 70° to Core Axis.	
81.0-106.5	Trond. coarse grained, greyish, as above.	
106.5-107	Basalt lava, dk. greenish, fine grained, contact at 55° to core axis.	

Drilled by: Morsette D. Drilling

DUPLICATE COPY
POOR QUALITY ORIGINAL
TO FOLLOW

CLAIM 590680

3" CORE SIZE

ARE STORED AT MOUSSEAU
CAMP - STURGEON LAKE

DIAMOND DRILL RECORD MISTANGO CONS. RES. LTD.

HOLE NO. M-56-1 SHEET NO. 1

Geology -
LATITUDE 0 + 20 N
DEPARTURE 111 + 20 W
ELEVATION LAKE + 4' 0

DATUM
BEARING Due South
DIP - 48

STARTED May 16, 1986
COMPLETED May 20, 1986
ULTIMATE DEPTH 350' 0

STANDARD GEOLOGICAL SURVEY
ASSESSMENT FILE # 300-20
RESEARCH CENTER
AUG 18 1986
RECEIVED

DEPTH FEET	FORMATION	FORMATION
0 - 8.0	Casing	
8.0 - 22.0	Treadheimitu. This is a coarse grained porphyry that consists of 50-60% white plagioclase feldspar as phenocrysts up to 5mm. diam. 10% - 20% gtz phenocrysts up to 5mm. diam and a finer ground mass that consists of gtz. feldspar and minor ferromagnesian.	
22.0 - 29.0	Treadheimitu, finer grained contact plane, slightly silicified in parts, minor pyrite.	
29.0 - 79.0	Treadheimitu, greyish, coarse grained, as above.	
79.0 - 81.0	a Gabbro dyke, dk. greenish fine grained contacts at 70° to Core axis.	
81.2 - 106.5	Tread. coarse grained, greyish, as above.	
106.5 - 107.0	Basalt lava, dk. greenish, fine grained, contacts at 55° to Core axis.	

DRILLED BY *Moritte J. Drilling*

SIGNED *C. J. Korb*
CLIFFER J. KORB, M.Sc., P. ENG.
CONSULTING GEOL. ENGINEER

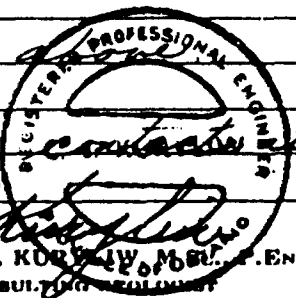

DIAMOND DRILL RECORD MISTANGO CONS. RES. LTD.

HOLE NO. M-86-1. SHEET NO. 2

LATITUDE _____ DATUM _____ STARTED _____
 DEPARTURE _____ BEARING _____ COMPLETED _____
 ELEVATION _____ DIP _____ ULTIMATE DEPTH _____

DEPTH FEET	FORMATION
107.0-112.8	Rhyolitic tuff, finely banded in parts at 50° to C/A, siliceous and sericitic in parts, carries minor pyrite.
112.8-121.0	Basaltic lava, sheared and partly brecciated: It carries irreg. carbonate and calcite filled fractures, 3% pyrite.
121.0-164.3	Fine to med. grained gabbro or dioritized basalt some hairline calcitic fractures suggest a massive basalt lava flow.
164.3-166.7	Trondheimite prophyry dyke, med. grained contacts at 40° to core axis.
166.7-187.0	Massive fine grained, andesite to basalt lava, greenish fine grained with a few irreg. calcitic fractures.
187.0-204.0	Trond. porphyry, greyish, coarse grained.

Drilled by: Morssette D. Drilling

**DUPLICATE COPY
POOR QUALITY ORIGINAL
TO FOLLOW**

DIAMOND DRILL RECORD MISTANGO CONS. RES. LTD.

HOLE NO. *17-86-1* SHEET NO. *2*

LATITUDE

DATUM

STARTED

DEPARTURE

BEARING

COMPLETED

ELEVATION

DIP

ULTIMATE DEPTH

DEPTH FEET	FORMATION	FORMATION
<i>107.0 - 112.8</i>	<i>Rhyolitic tuff, finely bedded in parts at 50° to 61° siliceous and sericitic in parts, carries minor pyrite.</i>	
<i>112.8 - 121.0</i>	<i>Basaltic lava, sheet and partly brecciated. It carries irreg. carbonate and Calcite filled fractures. 37% pyrite.</i>	
<i>121.0 - 164.3</i>	<i>Fine to med. grained gabbro or dioritized basalt some hairline calcitic fractures suggest a massive basalt lava flow.</i>	
<i>164.3 - 166.7</i>	<i>Troodheimitic porphyry dyke, med. grained, contacts at 40° to core axis</i>	
<i>166.7 - 187.0</i>	<i>massive fine grained, andesite to basaltic lava, greenish, fine grained with a few irreg. calcitic fractures.</i>	
<i>187.0 - 204.0</i>	<i>Trood. porphyry, greyish, coarse grained</i>	

DRILLED BY

Mossette S. Drilling

SIGNED

C. J. Kuryliw
CHESTER J. KURLIOW, M.Sc., P. Eng.
CONSULTING GEOLOGIST

DIAMOND DRILL RECORD MISTANGO CONS. RES. LTD.

HOLE NO. M-86-1 SHEET NO. 3

LATITUDE _____ DATUM _____ STARTED _____
 DEPARTURE _____ BEARING _____ COMPLETED _____
 ELEVATION _____ DIP _____ ULTIMATE DEPTH _____

DEPTH FEET	FORMATION	FORMATION
------------	-----------	-----------

204.0-246.4	Massive basalt flow or fine to med. grained gabbro dark greenish amphibolized in part.
246.4-249.0	Trond. greyish coarse grained, as previously, contact at 70° to C/A.
249.0-290.5	Gabbro fine to med. grained, a diabasic texture in parts.
290.5-297.8	Trond. porphyry, coarse grained, as previously, contacts at 70° to C/A.
297.8-350.0	Gabbro, dk. greenish fine to med. grained, becomes progressively coarser grained toward 350.0'

350.0 ft. END OF HOLE

Drilled by Morisette D. D.

DUPLICATE COPY
 POOR QUALITY ORIGINAL
 TO FOLLOW

DIAMOND DRILL RECORD MISTANGO CONS. RES. LTD.

HOLE NO. *M-86-1* SHEET NO. *3*

LATITUDE DATUM STARTED

DEPARTURE BEARING COMPLETED

ELEVATION DIP ULTIMATE DEPTH

DEPTH FEET	FORMATION	FORMATION
204.0 - 246.4	massive basalt flow or fine to med. grained gabbro dark greenish amphibolized in part.	
246.4 - 249.0	Trough greyish, coarse grained, as previously contact at 70° to C/a.	
249.0 - 290.5	Gabbro, fine to med. grained, a diabasic texture in parts.	
290.5 - 297.8	Trough porphyry, coarse grained, as previously contact at 70° to C/a.	
297.8 - 350.0	Gabbro, dk. greenish, fine to med. grained, becomes progressively coarser grained toward 350.0'	
	350.0 ft. End of Hole	

PATRICIA MINING DIV.

RECEIVED

JUN 26 1986

A.M. P.M.

7 8 9 10 11 12 1 2 3 4 5 6

DRILLED BY *Morisseth S. S.*

 SIGNED **CHESTER J. KURYLIW, M.Sc., P.Eng.**
 CONSULTING GEOLOGIST

Claim 590680
B.Q. Core size
Core Stored At:

DIAMOND DRILL RECORD

MISTANGO CONS. RES. LTD.

HOLE NO. M-86-1 SHEET NO. 1

SAMPLING-

LATITUDE 0 + 20N DATUM _____ STARTED May 16, 1986
DEPARTURE 111 + 20W BEARING Due South COMPLETED May 20, 1986
ELEVATION Lake + 4.0' DIP -40° @ 300' ULTIMATE DEPTH 350.0'

DEPTH FEET	FORMATION	Sample			Ozs	
		No.	From	To	Width	Au
22.0-25.2	Trond. slightly silicified, 3% Py.	1404			3.2	Tr.
41.0-43.0	Trond. partly silicified 2% Py, 1% Po	1405			2.0	Tr.
100.4-101.4	Trond. porphyry, 2% Py in qtz. carb. fracture and a narrow streak of chalcopryrite	1406			1.0	Tr.
105.8-106.6	Trond. porphyry, brecciated, 10% qtz. carb. minor Py.	1407			.8	.02
107.0-109.5	Rhyolitic tuff slightly silicified 1% Py	1408			2.5	Tr.
109.5-113.0	Rhyolitic tuff finely banded, partly sil'd, 1% Py	1409			3.5	.01
113.0-116.0	Basalt lava, sheared chloritic, brecciated, 20% calcite in fracture, 3% Py	1410			3.0	Tr.

Drilled by: Morisette D. Drilling

DUPLICATE COPY
POOR QUALITY ORIGINAL
TO FOLLOW

AIM 590680
 Q CORE SIZE
 CORE STORED AT

DIAMOND DRILL RECORD MISTANGO CONS. RES. LTD.

HOLE NO. *M-86-1* SHEET NO. *1*

Sampling -

LATITUDE *0 + 20N*

DATUM

STARTED *May 16, 1986*

DEPARTURE *111 + 20W*

BEARING *DUE SOUTH*

COMPLETED *May 20, 1986*

ELEVATION *LAKE + 4.0*

DIP *-40° @ 300'*

ULTIMATE DEPTH *350.0*

DEPTH FEET	FORMATION	SAMPLE NO.	FROM	TO	WIDTH	OZS Au
<i>22.0 - 25.2</i>	<i>Irond. slightly silicified, 3% PY.</i>	<i>1404</i>			<i>3.2</i>	<i>TR.</i>
<i>41.0 - 43.0</i>	<i>Irond. partly silicified, 2% PY, 1% PO</i>	<i>1405</i>			<i>2.0</i>	<i>TR.</i>
<i>100.4 - 101.4</i>	<i>Irond. porphyry, 2% PY in gte. carb. fracture and a narrow streak of chalcocopyrite.</i>	<i>1406</i>			<i>1.0</i>	<i>TR.</i>
<i>105.8 - 106.6</i>	<i>Irond. porphyry, brecciated, 10% gte. carb. minor PY.</i>	<i>1407</i>			<i>.8</i>	<i>10%</i>
<i>107.0 - 109.5</i>	<i>Rhyolitic tuff, slightly silicified, 1% PY.</i>	<i>1408</i>			<i>2.5</i>	<i>TR.</i>
<i>109.5 - 113.0</i>	<i>Rhyolitic tuff, finely banded, partly sil'ed, 1% PY.</i>	<i>1409</i>			<i>2.5</i>	<i>.01</i>
<i>113.0 - 116.0</i>	<i>Basalt lava, sheared chloritic, brecciated, 20% calcite in fractures, 3% PY.</i>	<i>1410</i>			<i>3.0</i>	<i>TR.</i>

DRILLED BY

Morissette D. Drilling

SIGNED

C. J. Kurylow
 CHESTER J. KURYLOW, M.Sc., P. Eng.
 CONSULTING GEOLOGIST

DIAMOND DRILL RECORD MISTANGO CONS. RES. LTD.

HOLE NO. M-86-1.. SHEET NO. 2.....

LATITUDE DATUM STARTED

DEPARTURE BEARING COMPLETED

ELEVATION DIP ULTIMATE DEPTH

DEPTH FEET	FORMATION	Sample No.	From	To	Width	Ozs. Au.
116.0-119.0	Lava sheared, chloritic, 7% qtz. carb. in fractures, 2% Py	1411			3.0	Tr.
147.2-150.0	10% qtz carb in fractures, one irreg. qtz carb stringer carries a few specks of chalco.	1412			2.8	Tr.

Drilled by: Morisette D.D.

DUPLICATE COPY
POOR QUALITY ORIGINAL
TO FOLLOW

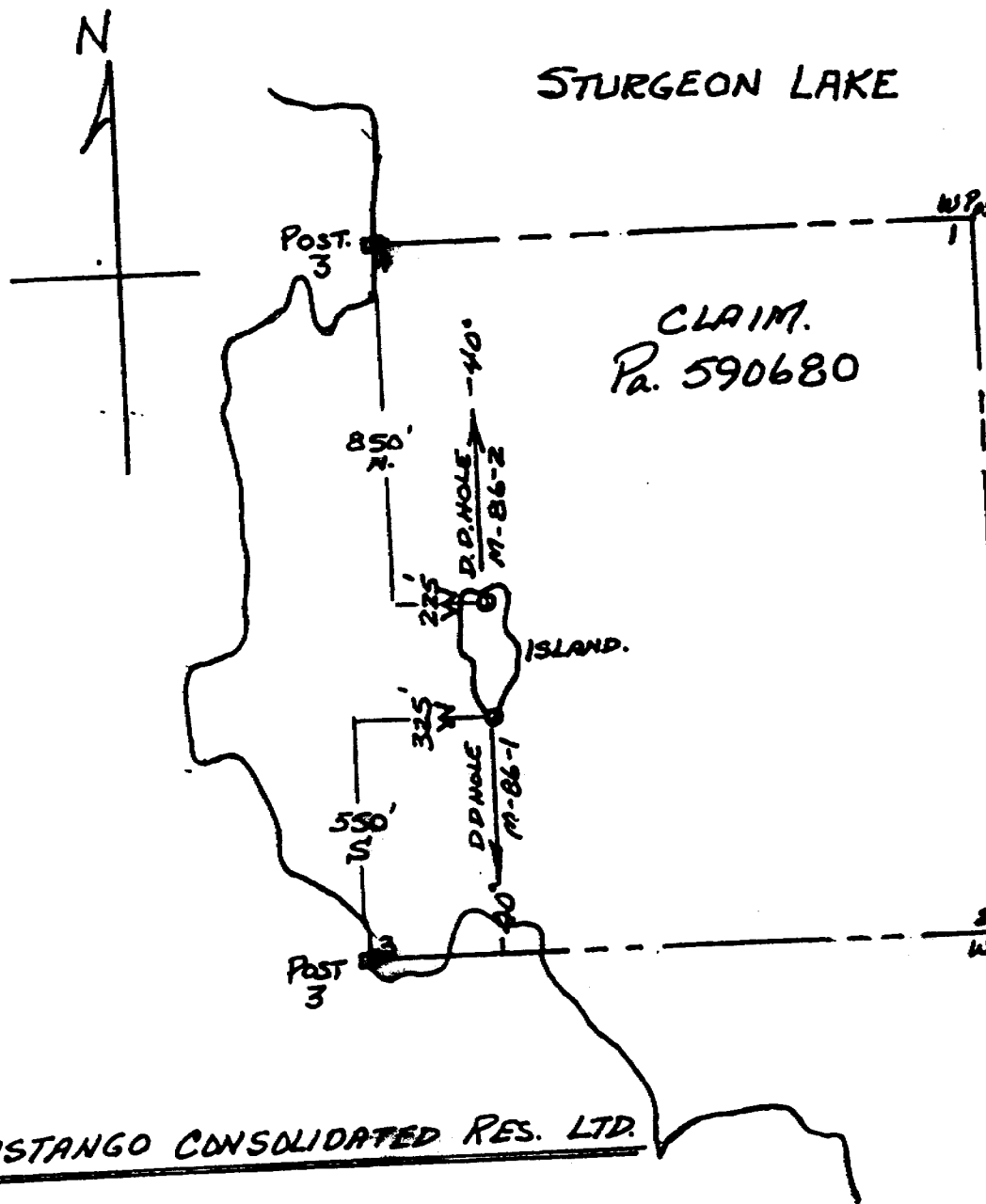

PATRICIA MINING DIV.
RECEIVED
 JUN 26 1986
 A.M. P.M.
 7 8 9 10 11 12 1 2 3 4 5 6

MISTANGO CONSOLIDATED RES. LTD.

SKETCH
 OF
 LOCATION
 OF

D. DRILL HOLE M-86-1
 @ -40°, DUE NORTH, DEPTH 350'0

D. DRILL HOLE M-86-2
 @ -40°, DUE SOUTH, DEPTH 297'0

Claim 590680-B.Q. Core
Core stored at Mousseau
Camp-Sturgeon Lake

DIAMOND DRILL RECORD MISTANGO CONS. RES. LTD.

HOLE NO. M-86-2 SHEET NO. 1

GEOLOGY-
LATITUDE 2 + 80N DATUM STARTED May 20, 1986
DEPARTURE 111 + 00W BEARING North COMPLETED May 22, 1986
ELEVATION Lake + 4.0' DIP -40° @ 290' -384' ULTIMATE DEPTH 297.0'

DEPTH FEET	FORMATION	FORMATION
0-8.0	Casing	
8.0-97.8	Porphyritic granite to granodiorite - 50-60% feldspar phenocrysts. The feldspar has light greenish wavy appearance and some feldspar phenocrysts are pinkish. 10% qtz. phenocrysts, the ground mass is dk, greyish and is composed of feldspar qtz. and minor ferromagnesians.	
97.8-101.8	Basalt, dk. greenish, fine grained, massive	
101.8-131.8	Granitic porphyry, med. to coarse grained as above	
131.8-138.2	Basalt lava, dk. greenish, fine grained with irreg. calcitic hairline fractures.	
138.2-139.6	Granitic, prophyry, coarse grained	
139.6-147.3	Basalt lava, dk. greenish, fine grained, calcitic hairline fractures.	

Drilled by: Morisette D.D.

DUPLICATE COPY
POOR QUALITY ORIGINAL
TO FOLLOW

BLM 590680-13.4 CORE
CORE STORED AT MORSEAU
CAMP - SURGEON LAKE

DIAMOND DRILL RECORD
MISTANGO CONS. RES. LTD.

Geology -

HOLE NO. A-56-2 SHEET NO. 1

LATITUDE 2 + 80 N

DATUM

STARTED MAY 20, 1986

DEPARTURE 111 + 00 W

BEARING NORTH

COMPLETED MAY 22, 1986

ELEVATION LAKE + 4.0

DIP - 40° @ 290' - 38½°

ULTIMATE DEPTH 297.0

DEPTH FEET	FORMATION	FORMATION
0 - 8.0	Lasing	
8.0 - 97.8	Porphyritic granite to granodiorite - 50-60% feldspar phenocrysts. The feldspar has light greenish waxy appearance and some feldspar phenocrysts are pinkish. 10% Qtz. phenocrysts, the ground mass is dk. greyish and is composed of feldspar Qtz. and minor ferromagnesian.	
97.8 - 101.8	Basalt, dk. greenish, fine grained, massive.	
101.8 - 131.8	Granitic porphyry, med. to coarse grained as above.	
131.8 - 138.2	Basalt lava, dk. greenish, fine grained with irreg. calcitic hairlike fractures.	
138.2 - 139.6	Granitic, porphyry, coarse grained	
139.6 - 147.3	Basalt lava, dk. greenish, fine grained, calcitic hairlike fractures.	

DRILLED BY

Murielle S. S.

SIGNED

CHESTER J. KURLIOW, M. S., P. E.
CONSULTING ENGINEER - T.A.

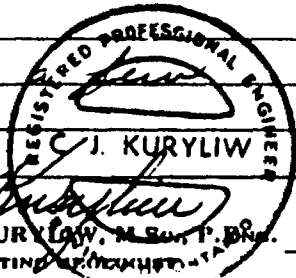

DIAMOND DRILL RECORD MISTANGO CONS. RES. LTD.

HOLE NO. M-86-2 SHEET NO. 2

LATITUDE _____ DATUM _____ STARTED _____
 DEPARTURE _____ BEARING _____ COMPLETED _____
 ELEVATION _____ DIP _____ ULTIMATE DEPTH _____

DEPTH FEET	FORMATION	FORMATION
147.3-152.5	Granitic porphyry, as previously described	
152.5-153.3	Basalt lava, 5% calcitic fractures.	
153.3-187.0	Granite-porphyry, coarse grained with some lt yellowish-green feldspar phenocrysts. Similar to previous sections.	
187.0-189.0	Basalt lava, 10% qtz. carb. in bands, minor pyrite.	
189.0-219.0	Granite-porphyry, 30% feldspar phenocrysts. 70% greyish groundmass composed of feldspar qtz. and minor ferromagnesian.	
219.0-237.3	Basaltic lava, dk. greenish, fine grained, some calcitic qtz. filled fractures.	
237.3-296.0	Granite prophyry coarse grained as previous.	
	296.0 ft. END OF HOLE	

Drilled by Morisette D.D.

DUPLICATE COPY
 POOR QUALITY ORIGINAL
 TO FOLLOW

DIAMOND DRILL RECORD MISTANGO CONS. RES. LTD.

HOLE NO. *A-56-2* SHEET NO. *2*

LATITUDE DATUM STARTED

DEPARTURE BEARING COMPLETED

ELEVATION DIP ULTIMATE DEPTH

DEPTH FEET	FORMATION	FORMATION
147.3 - 152.5	Granitic porphyry, as previously described	
152.5 - 153.3	Basalt lava, 5% calcitic fractures.	
153.3 - 187.0	Granite - porphyry, coarse grained with some lt. yellowish-green feldspar phenocrysts similar to previous sections.	
187.0 - 187.0	Basalt lava, 10% gr. carb. in bands, minor pyrite.	
189.0 - 219.0	Granite porphyry, 30% feldspar phenocrysts, 70% gneiss groundmass composed of feldspar gr. and minor ferromagnesian.	
219.0 - 237.3	Basaltic lava, dk. greenish, fine grained, some calcitic gr. filled fractures.	
237.3 - 296.0	Granite porphyry coarse grained as previous	
	296.0 ft. End of Hole	

DRILLED BY Morissette D. D.

 SIGNED CHESTER J. KURLIOW, M.Sc., P. Eng.
 CONSULTING GEOLGIST

DIAMOND DRILL RECORD

MISTANGO CONS. RES. LTD.

HOLE NO. M-86-2.. SHEET NO. 1

SAMPLING-

LATITUDE 2 + 80N DATUM STARTED May 20, 1986

DEPARTURE 111 + 00W BEARING North COMPLETED May 22, 1986

ELEVATION Lake + 4.0" DIP -40° ULTIMATE DEPTH 297.0'

DEPTH FEET	FORMATION	Sample No.	From	To	Width	Ozs Au
187.0-189.0	Basalt lava, 10% qtz carb. in bands minor pyrite	1413			2.0	.01
214.7-215.2	Granite porphyry, a 1/2" qtz vein at 50° to C/A. carries 50% massive Po with trace of chalco.	1414			.5	Tr.
219.0-219.8	Basalt lava, a 1/2" dk greyish qtz. veinlet at 45° to C/A 30% massive py in veinlet.	1415			.8	Tr.
237.0-237.8	Contact area between lava and granite porphyry, 20% qtz in stringers.	1416			.8	Tr.
257.5-258.5	Granite porphyry. Two 1/2" qtz. veinlets at 50° to C/A.	1417			1.0	Tr.

Drilled by Morisette D.D.

DUPLICATE COPY
POOR QUALITY ORIGINAL
TO FOLLOW

DIAMOND DRILL RECORD MISTANGO CONS. RES. LTD.

Sampling -

HOLE NO. *A-86-2* SHEET NO. *1*

LATITUDE *2 + 80. N*

DATUM

STARTED *May 20, 1956*

DEPARTURE *111 + 00 W*

BEARING *NORTH*

COMPLETED *May 22, 1956*

ELEVATION *LAKE + 4' 0*

DIP *-40°*

ULTIMATE DEPTH *297' 0*

DEPTH FEET	FORMATION	SAMPLE NO.	FROM	TO	WIDTH	GRS. AN.
<i>187.0 - 189.0</i>	<i>Basalt lava, 10% gtz. carb. in bands, minor pyrite.</i>	<i>1413</i>			<i>2.0</i>	<i>.01</i>
<i>214.7 - 215.2</i>	<i>Granite porphyry, a 1/2" gtz. vein at 50° to c/a. carries 50% massive py. with traces of chalc.</i>	<i>1414</i>			<i>.5</i>	<i>Tr.</i>
<i>219.0 - 219.8</i>	<i>Basalt lava, a 1/2" dk. grayish gtz. veinlet at 45° to c/a. 30% massive py. in veinlet.</i>	<i>1415</i>			<i>.8</i>	<i>Tr.</i>
<i>237.0 - 237.8</i>	<i>Contact area between lava and granite porphyry, 20% gtz. in stringers.</i>	<i>1416</i>			<i>.8</i>	<i>Tr.</i>
<i>257.5 - 258.5</i>	<i>Granite porphyry. Two 1/2" gtz. veinlets at 50° to c/a.</i>	<i>1417</i>			<i>1.0</i>	<i>Tr.</i>

DRILLED BY *Murielle S. D.*

SIGNED

C. J. Kuryliw
CHESTER J. KURLIOW, M.Sc., P. Eng.
CONSULTING GEOMINER

STURGEON LAKE

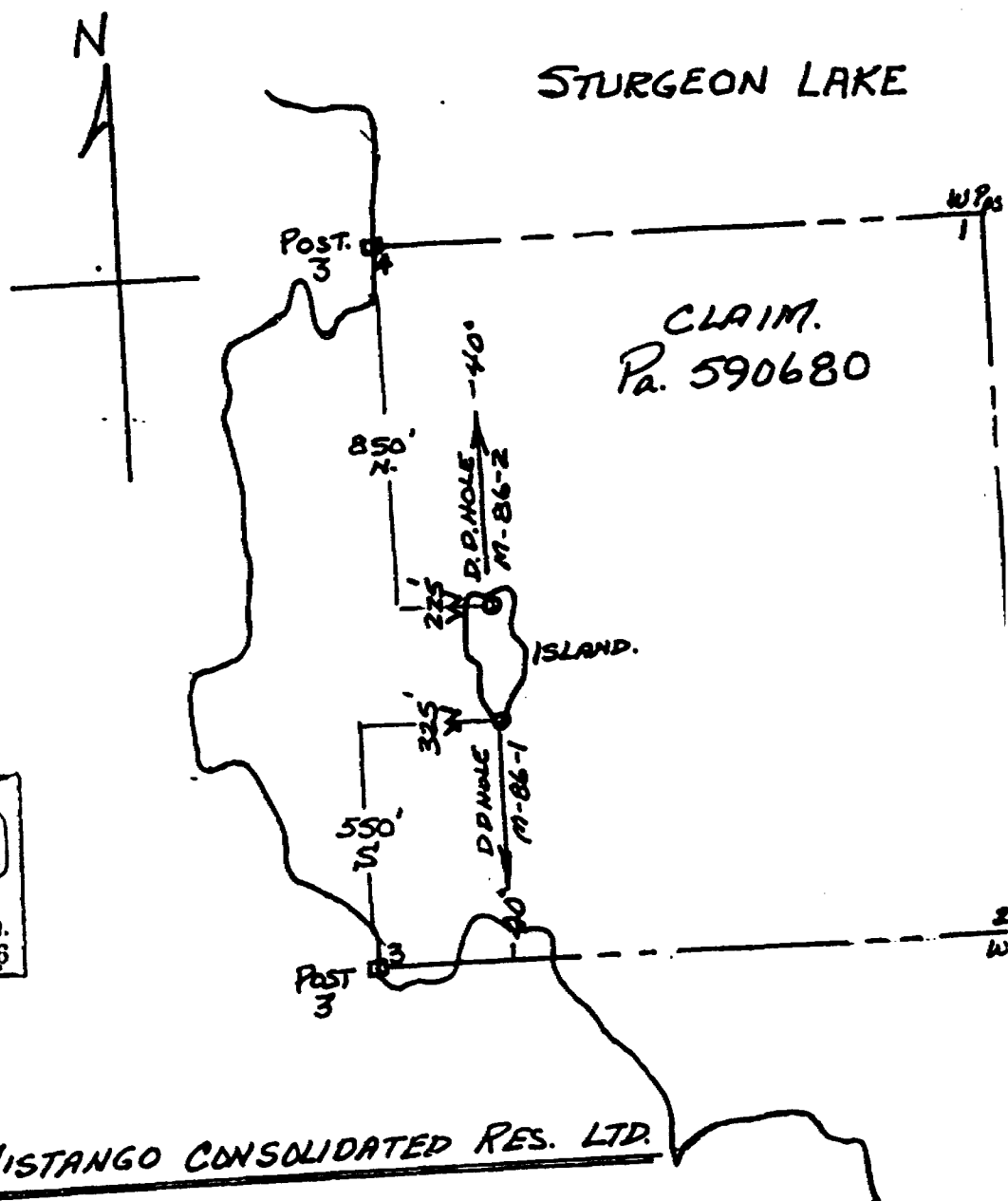

PATRICIA MINING DIV.
RECEIVED
 JUN 26 1986
 A.M. P.M.
 7 8 9 10 11 12 1 2 3 4 5 6

MISTANGO CONSOLIDATED RES. LTD.

SKETCH
 OF
 LOCATION
 OF

D. DRILL HOLE M-86-1
 @ -40°, DUE NORTH, DEPTH 350'0

D. DRILL HOLE M-86-2
 @ -40°, DUE SOUTH, DEPTH 297'0

Claim 590681
B.Q. Core size
Stored at A. Mousseau
Camp- Sturgeon Lake

DIAMOND DRILL RECORD

MISTANGO CONS. RES. LTD.

HOLE NO. M-86-3 SHEET NO. 1

LATITUDE 1 + 40 S DATUM STARTED May 22, 1986
DEPARTURE 92 + 00W BEARING Due South COMPLETED May 24, 1986
ELEVATION Lake + 4.0' DIP -40° @ 290! = 36° ULTIMATE DEPTH 347.0

DEPTH FEET	GEOLOGY- FORMATION	FORMATION
0-8.0	Casing	
8.0-48.5	Gabbro, dk. greenish, med. grained	
48.5-105.6	Andesite to basalt lava, dk. greenish, fine grained, laced with a network of 5-10% qtz. carbonate irregular stringers. Some narrow tuffaceous sections along pillow rims.	
105.6-160.0	Gabbro, dk. greenish fine to med. grained, relatively massive contact at 160.0' is 25° to core axis.	
160.0-164.8	Andesite-basalt lava. An inclusion between two gabbro intrusives with qtz. veins at each contact, some patches of Po with traces of chalco	
164.8-347.0	Gabbro, med. grained, somewhat massive appearance.	

347.0 END OF HOLE

Drilled by: Morisette D. Drilling

DUPLICATE COPY
POOR QUALITY ORIGINAL
TO FOLLOW

590681
 3 1/2" CORE SIZE
 STORED AT A. MOUSSEAU
 CAMP - STURGEON LAKE

DIAMOND DRILL RECORD

MISTANGO CONS. RES. LTD.

HOLE NO. *M-86-3* SHEET NO. *1*

LATITUDE *17405'* DATUM _____ STARTED *May 22, 1986*
 DEPARTURE *92 ± 00 W* BEARING *DUE SOUTH* COMPLETED *May 24, 1986*
 ELEVATION *LAKE + 4'0* DIP *-40° @ 290' -36°* ULTIMATE DEPTH *347'0*

DEPTH FEET	Geology - FORMATION	FORMATION
<i>0 - 8.0</i>	<i>Casing</i>	
<i>8.0 - 48.5</i>	<i>Gabbro, dk. greenish, med. grained</i>	
<i>48.5 - 105.6</i>	<i>Andesite to Basalt lava, dk. greenish, fine grained, laced with a network of 5-10% gtz. carbonate irregular stringers. Some narrow tuffaceous sections along pillow rims.</i>	
<i>105.6 - 160.0</i>	<i>Gabbro, dk. greenish fine to med. grained, relatively massive. Contact at 160' is 25° to core axis.</i>	
<i>160.0 - 164.8</i>	<i>Andesite - Basalt lava, an inclusion between two Gabbro intrusives with gtz. veins at each contact. Some patches of Pc. with traces of chalc.</i>	
<i>164.8 - 347.0</i>	<i>Gabbro, med. grained, somewhat massive appearance.</i>	

PATRICIA MINING DIV.

RECEIVED

JUN 26 1986

A.M. _____ P.M. _____

7 8 9 10 11 12 1 2 3 4 5 6

347'0 End of Hole

 CHESTER KURYLIW, M.Sc., P.Eng.
 CONSULTING GEOMINING ENGINEER

DRILLED BY *Monique D. Drilling*

Claim 590681
B.Q. Core size
Core stored at Mousseau
Camp - Sturgeon Lake

DIAMOND DRILL RECORD MISTANGO CONS. RES. LTD.

HOLE NO. M-86-3 SHEET NO. 1

LATITUDE 1 + 40 S DATUM _____ STARTED May 22, 1986
DEPARTURE 92 + 00W BEARING South COMPLETED May 24, 1986
ELEVATION Lake + 4.0' DIP -40° ULTIMATE DEPTH _____

DEPTH FEET	SAMPLING- FORMATION	Sample No.	From	To	Width	Ozs Au
55.5-58.4	Strongly carbonitized lava, some epidote alt'n, a few specks of Po	1418			2.9	Tr.
74.7-75.7	Lava, Two 1/4" qtz veinlets at 45° to C/A and some irreg. qtz. carb. in a lace net, several specks of Po and chalco.	1419			1.0	.01
80.0-82.0	Lava, 10% qtz. carb. in a laced network 1/2% of Po, a few specks of chalco	1420			2.0	Tr
103.8-105.6	Lava, 10% qtz. carb. in a laced network 1/2% Po several specks of chalco	1421			1.8	Tr.
160.0-161.5	Lava, with a 10" white qtz. carb vein, carries some streaks of Po and a trace of chalco, some patches of qtz with coarse crystals of pyrite	1422			1.5	Tr.

Drilled by: Morisette D. Drilling

**DUPLICATE COPY
POOR QUALITY ORIGINAL
TO FOLLOW**

CLAIM 590681
 BQ CORE SIZE
 CORE STORED AT
 MUSEUM CAMP
 STURGEON LAKE.

DIAMOND DRILL RECORD MISTANGO CONS. RES. LTD.

HOLE NO. M-86-3 SHEET NO. 1

LATITUDE 1405' DATUM _____ STARTED May 22, 86
 DEPARTURE 92+00.W BEARING SOUTH COMPLETED May 24, 86
 ELEVATION LAKE + 4'0 DIP -40° ULTIMATE DEPTH _____

DEPTH FEET	FORMATION	SAMPLE NO.	FROM	TO	WIDTH	OZS Au
	<i>Sampling -</i>					
<u>55.5 - 58.4</u>	<i>Strongly carbonitized lava, some epidote alt'ns, a few specks of P.C.</i>	<u>1418</u>			<u>2.9</u>	<u>Tr.</u>
<u>74.7 - 75.7</u>	<i>Lava, two 1/2" gtz. vesicles at 45° to Cl_a and some irreg. gtz. carb. in a loose net, several specks of P.C. and chalc.</i>	<u>1419</u>			<u>1.0</u>	<u>.01</u>
<u>80.0 - 82.0</u>	<i>Lava, 10% gtz. carb. in a loose network 1/2% P.C. a few specks of chalc.</i>	<u>1420</u>			<u>2.0</u>	<u>Tr.</u>
<u>103.8 - 105.6</u>	<i>Lava, 10% gtz. carb. in a loose network 1/2% P.C. several specks of chalc.</i>	<u>1421</u>			<u>1.8</u>	<u>Tr.</u>
<u>160.0 - 161.5</u>	<i>Lava, with a 10" white gtz. carb. vein, carries some streaks of P.C. and a trace of chalc., some</i>	<u>1422</u>			<u>1.5</u>	<u>Tr.</u>

DRILLED BY Mouille D. Drilling

SIGNED

C. J. Kuryliw
 CHESTER J. KURLIOW, M.Sc., P. Eng.
 CONSULTING GEOLOGIST

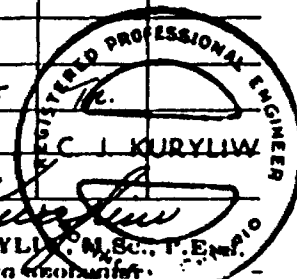

DIAMOND DRILL RECORD MISTANGO CONS. RES. LTD.

HOLE NO. M-86-3 SHEET NO. 2

LATITUDE _____ DATUM _____ STARTED _____
 DEPARTURE _____ BEARING _____ COMPLETED _____
 ELEVATION _____ DIP _____ ULTIMATE DEPTH _____

DEPTH FEET	DESCRIPTION	Sample No.	From	To	Width	Ozs Au
161.5-163.5	Lava, 5% qtz carb in a laced network, some patches of Po in the carb.	1423			2.0	Tr.
163.5-164.8	White qtz, carb. vein, a few specks of Po	1424			1.3	Tr.
296.5-297.2	Quartz-carb vein, glassy qtz. a few specks of Po	1425			.7	Tr.
328.0-328.6	A 1" glassy qtz vein, 2% Po, trace of chalco in the vein.	1426			.6	Tr.

Drilled by: Morisette D. Drilling

**DUPLICATE COPY
POOR QUALITY ORIGINAL
TO FOLLOW**

DIAMOND DRILL RECORD

MISTANGO CONS. RES. LTD.

HOLE NO. *M-86-3* SHEET NO. *2*

LATITUDE DATUM STARTED

DEPARTURE BEARING COMPLETED

ELEVATION DIP ULTIMATE DEPTH

DEPTH FEET	FORMATION	SAMPLE NO.	FROM	TO	WIDTH	OZS Au
	<i>patches of gte. with coarse crystals of pyrite</i>					
<i>161.5 - 163.5</i>	<i>Lava, 5% gte. carb in a laced network, some patches of Ps. in the carb.</i>	<i>1423</i>			<i>2.0</i>	<i>TR.</i>
<i>163.5 - 164.8</i>	<i>White gte. carb. vein, a few specks of Ps.</i>	<i>1424</i>			<i>1.3</i>	<i>TR.</i>
<i>296.5 - 297.2</i>	<i>Dusky carb vein, glassy gte. a few specks of Ps.</i>	<i>1425</i>			<i>.7</i>	<i>TR.</i>
<i>328.0 - 328.6</i>	<i>A 1" glassy gte. vein, 2% Ps. trace of chalc in the vein</i>	<i>1426</i>			<i>.6</i>	<i>TR.</i>

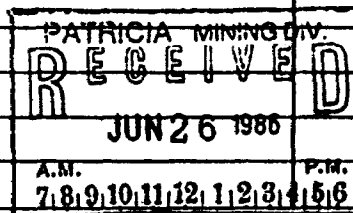

DRILLED BY *Maurice D. Drilling*

SIGNED

C. J. Kurylko
CHESTER J. KURLIW, M.Sc., P.Eng.
 CONSULTING GEOLOGIST

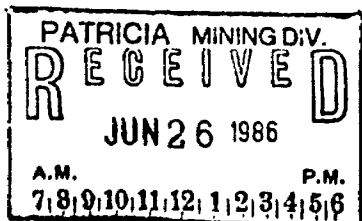
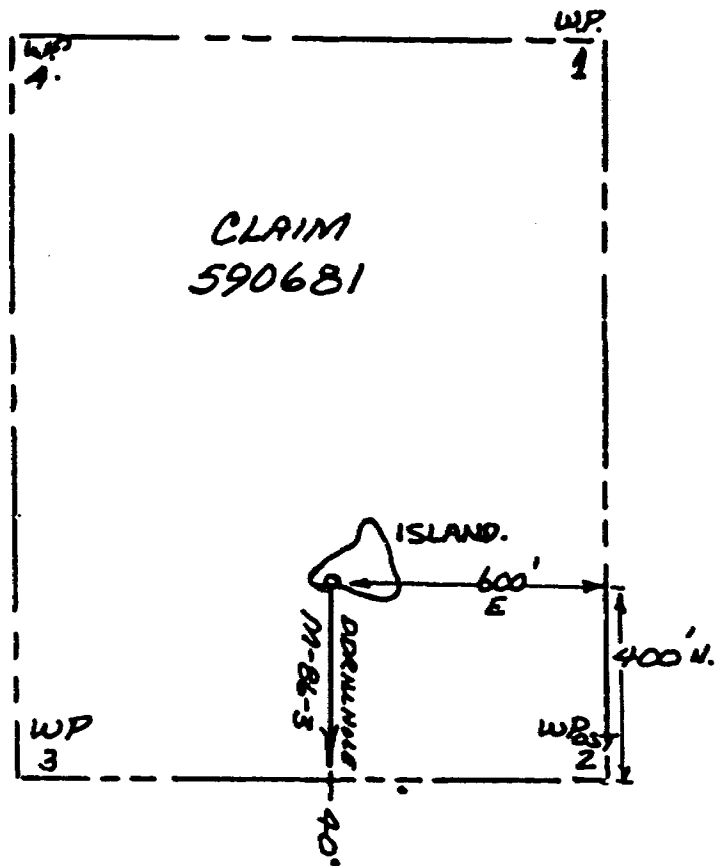
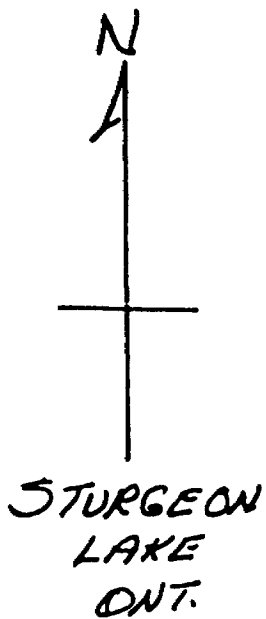

MISTANGO CONSOLIDATED RES. LTD.

SKETCH OF LOCATION OF D.D. HOLE M-86-3

D. D. HOLE M-86-3

@ -40°, DUE SOUTH, TO DEPTH OF 347.0

Claim PA 612421
BQ Core size
Core storeat at Mousseau
Camp Sturgeon Lake

DIAMOND DRILL RECORD

MISTANGO CONS. RES. LTD.

GEOLOGY

HOLE NO. M-86-7 SHEET NO. 1

LATITUDE 24 + 50 S DATUM _____ STARTED June 16, 1986
DEPARTURE 86 + 00W BEARING Due North COMPLETED June 19, 1986
ELEVATION Lake + 4.0' Dip Collar -45° @ 300' - 44° @ 490' - 42° ULTIMATE DEPTH 497.0'

DEPTH FEET	FORMATION	FORMATION
0-20.0	Casing in overburden	
20.0-100.0	Basalt lava, greenish grey, massive with a few irregular calcite filled hairline stringers.	
100.0-135.5	Basalt lava, greenish, fractured and blocky. ←-5% qtz. calcite filled fractures.	
135.5-136.5	Gabbro dyke, fine grained, sharp chilled contacts at 40° to core axis.	
136.5-147.9	Basalt lava, 5-10% fractured and filled with irrg. qtz. calcite stringers ome of which carry some Po and minor chalcopyrite.	
147.9-148.3	A grey qtz. vein at 60° to C/A it carries 5% chalco in the qtz. with 5% Po in the wallrocks of the qtz.	
148.3-156.4	Basalt lava, with a few tongues of feldspar porphyry and some fractures carry minor Po and chalco in a groundmass of greyish qtz.	

Drilled by: Morisette D. Drilling

DUPLICATE COPY
POOR QUALITY ORIGINAL
TO FOLLOW

CLAIM Pa. 612421
BQ CORE SIZE

CORE STORED AT MOUSSEAU
CAMP STURGEON LAKE.

DIAMOND DRILL RECORD
MISTANGO CONS. RES. LTD. GEOLOGY

HOLE NO. A-86-7 SHEET NO. 1

LATITUDE 24°50' S DATUM STARTED JUNE 16, 1986
DEPARTURE 86°00' W BEARING DUE NORTH COMPLETED JUNE 19, 1986
ELEVATION LAKE + 4' 0" DIP COLLAR - 45° @ 300' - 44° @ 490' - 42° ULTIMATE DEPTH 497' 0"

DEPTH FEET	FORMATION	FORMATION
0 - 20.0	Casing in overburden	
20.0 - 100.0	Basalt lava, greenish grey, massive with a few irregular calcite filled veinlike stringers	
100.0 - 135.5	Basalt lava, greenish, fractured and blocky. α-5% gtz. calcite filled fractures	
135.5 - 136.5	Gabbro dyke, fine grained, steep shelled, contacts at 40° to core axis.	
136.5 - 147.9	Basalt lava, 5-10% fractured and filled with irg. gtz. calcite stringers, some of which carry some Po. and minor Chalcopyrite.	
147.9 - 148.3	A grey gtz. vein at 60° to core axis carries 5% chalc in the gtz. with 5% Po. in the wallrock of the gtz.	
148.3 - 156.4	Basalt lava, with a few tongues of feldspar and some fractures carry minor Po and chalc. a groundmass of greyish gtz.	

DRILLED BY Moussette S. Drilling

SIGNED

C. J. Kurylow
CHESTER J. KURLAW, M.Sc., P. Eng.
CONSULTING GEOL. ENG. & MIN. ENGR.



DIAMOND DRILL RECORD

MISTANGO CONS. RES. LTD.

GEOLOGY

HOLE NO. M-86-7 SHEET NO. 2

LATITUDE _____ DATUM _____ STARTED _____
 DEPARTURE _____ BEARING _____ COMPLETED _____
 ELEVATION _____ DIP _____ ULTIMATE DEPTH _____

DEPTH FEET	FORMATION
156.4-160.4	Quartz-feldspar prophyry dyke, 25% phenocrysts of white feldspar up to 5mm diam, 5% coarse quartz phenocrysts.
160.4-162.6	Basalt lava, dark greenish, fine grained
162.6-163.3	Quartz porphyry dyke, 20% qtz. phenocrysts, 10% feldspar phenocrysts, greyish to bluish grey.
163.3-164.7	Basalt lava, dark greenish, massive
164.7-170.0	Quartz porphyry dyke, contact at 60° to core, bluish grey, 20% qtz. phenocrysts, 10% feldspar phenocrysts.
170.0-176.8	Basalt lava, dk. greenish, blocky.
176.8-202.0	Greyish to blueish grey qtz feldspar prophyry dyke.
202.0-206.0	Basalt lava, greenish, fine grained partly intruded with qtz. feldspar prophyry.

Drilled by: Morisette D. Drilling

DUPLICATE COPY
 POOR QUALITY ORIGINAL
 TO FOLLOW

DIAMOND DRILL RECORD

MISTANGO CONS. RES. LTD. GEOLOGY

HOLE NO. *A-96-7* SHEET NO. *2*

LATITUDE _____ DATUM _____ STARTED _____
 DEPARTURE _____ BEARING _____ COMPLETED _____
 ELEVATION _____ DIP _____ ULTIMATE DEPTH _____

DEPTH FEET	FORMATION	FORMATION
<i>156.4-160.4</i>	<i>Quartz - feldspar porphyry dyke, 25% phenocrysts of white feldspar up to 5mm. diam., 5% coarse quartz phenocrysts.</i>	
<i>160.4-162.6</i>	<i>Basalt lava, dark greenish, fine grained</i>	
<i>162.6-163.3</i>	<i>Quartz porphyry dyke, 20% gte. phenocrysts, 10% feldspar phenocrysts, greyish to bluish grey.</i>	
<i>163.3-164.7</i>	<i>Basalt lava, dark greenish, massive</i>	
<i>164.7-170.0</i>	<i>Quartz porphyry dyke, contact at 60° to core, bluish grey, 20% gte. phenocrysts, 10% feldspar phenocrysts</i>	
<i>170.0-176.8</i>	<i>Basalt lava, dk. greenish, blocky.</i>	
<i>176.8-202.0</i>	<i>Greyish to bluish grey gte. feldspar porphyry dyke</i>	
<i>202.0-206.0</i>	<i>Basalt lava, greenish, fine grained partly intruded with gte. feldspar porphyry.</i>	

DRILLED BY *Murielle D. Drilling*

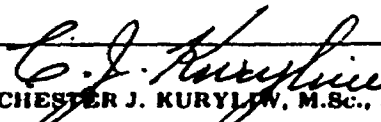
 SIGNED **CHESTER J. KURLAW, M.Sc., P.Eng.**
 CONSULTING GEOLOGIST

DIAMOND DRILL RECORD

MISTANGO CONS. RES. LTD.

GEOLOGY

HOLE NO. m-86-7 SHEET NO. 3

LATITUDE _____ DATUM _____ STARTED _____
 DEPARTURE _____ BEARING _____ COMPLETED _____
 ELEVATION _____ DIP _____ ULTIMATE DEPTH _____

DEPTH FEET	FORMATION
206.0-215.5	Greyish to blueish grey qtz. feldspar prophyry dyke.
215.5-224.0	Basalt lava, dk. greenish, some epidote alt'n, also some amygdules with indicates pillowed lava flows.
224.0-247.0	Feldspar prophyry dyke, coarse grained. This may be a tongue of granitic intrusion.
247.0-250.0	Basalt lava, greenish, blocky, minor qtz. carb. stringer development.
250.0-259.0	Quartz-porphry dyke, fine grained siliceous. sericitic in part.
259.0-260.0	Basalt lava, sheared mud fault zone that runs at 60-80° to the C/A.
260.0-275.0	Basalt lava, strongly sheared and qtz. carb'd. The qtz carbonate comprises up to 25% of the core.

Drilled by: Morisette D. Drilling

DUPLICATE COPY
POOR QUALITY ORIGINAL
TO FOLLOW

DIAMOND DRILL RECORD

MISTANGO CONS. RES. LTD. GEOLOGY

HOLE NO *M-86-7* SHEET NO. *3*

LATITUDE _____ DATUM _____ STARTED _____
 DEPARTURE _____ BEARING _____ COMPLETED _____
 ELEVATION _____ DIP _____ ULTIMATE DEPTH _____

DEPTH FEET	FORMATION	FORMATION
<i>206.0 - 215.5</i>	<i>Greyish to bluish grey gtz. feldspar porphyry dyke</i>	
<i>215.5 - 224.0</i>	<i>Basalt lava, dk. greenish, some epidote alt'ns, also some amygdules which indicates pillowed lava flows</i>	
<i>224.0 - 247.0</i>	<i>Feldspar porphyry dyke, coarse grained. This may be a tongue of granitic intrusion.</i>	
<i>247.0 - 250.5</i>	<i>Basalt lava, greenish, blocky, minor gtz. carb. stringer development.</i>	
<i>250.5 - 259.0</i>	<i>Quartz porphyry dyke, fine grained siliceous, peritic in part.</i>	
<i>259.0 - 260.0</i>	<i>Basalt lava, sheared, near fault zone that runs at 60°-80° to the C/A.</i>	
<i>260.0 - 275.0</i>	<i>Basalt lava, strongly sheared and gtz. carb'd. The gtz. carbonate comprises up to 25% of the core</i>	

DRILLED BY *Maurice S. Drilling*

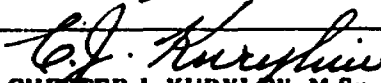
 SIGNED **CHESTER J. KURLAW, M.Sc., P.Eng.**
 CONSULTING GEOLOGIST

DIAMOND DRILL RECORD

MISTANGO CONS. RES. LTD.

GEOLOGY

HOLE NO. M-86-7 SHEET NO. 4

LATITUDE _____ DATUM _____ STARTED _____
 DEPARTURE _____ BEARING _____ COMPLETED _____
 ELEVATION _____ DIP _____ ULTIMATE DEPTH _____

DEPTH FEET	FORMATION	FORMATION
275.0-302.0	Basalt lava, dk. greenish, fine grained with numerous hairline fractures filled with calcite	
302.0-330.0	Gabbro, dk. greenish med. grained. <u>Note:</u> a pink glassy granitic tongue follows along the core at 307.0 ft.	
330.0-331.0	Dyke, light greenish, andesitic with contacts at 60° to c/a	
331.0-334.3	Gabbro, dark greenish, fine to med. grained.	
334.3-335.0	A granitic dyke, pinkish, med. grained, contacts at 35° to c/a	
335.0-338.3	Gabbro, dk. greenish, med. grained	
338.3-344.5	Dyke, lt-greenish grey, andesitic	
344.5-362.0	Gabbro, dk greenish, fine to med. grained.	

Drilled by: Morisette D. Drilling

DUPLICATE COPY
POOR QUALITY ORIGINAL
TO FOLLOW

DIAMOND DRILL RECORD

MISTANGO CONS. RES. LTD. GEOLOGY

HOLE NO. *17-26-7* SHEET NO. *4*

LATITUDE _____ DATUM _____ STARTED _____
 DEPARTURE _____ BEARING _____ COMPLETED _____
 ELEVATION _____ DIP _____ ULTIMATE DEPTH _____

DEPTH FEET	FORMATION	FORMATION
<i>275.0-302.0</i>	<i>Basalt lava, dk. greenish, fine grained with numerous hairline fractures filled with calcite</i>	
<i>302.0-330.0</i>	<i>Gabbro, dk. greenish, med. grained. Note: a pink glassy granitic tongue follows along the core at 307.0 ft.</i>	
<i>330.0-331.0</i>	<i>Dyke, light greenish, andesitic with contacts at 60° to 90°</i>	
<i>331.0-334.3</i>	<i>Gabbro, dark greenish, fine to med. grained</i>	
<i>334.3-335.0</i>	<i>A granitic dyke, pinkish, med. grained, contacts at 35° to 90°</i>	
<i>335.0-338.3</i>	<i>Gabbro, dk. greenish, med. grained</i>	
<i>338.3-344.5</i>	<i>Dyke, lt. greenish grey, andesitic</i>	
<i>344.5-362.0</i>	<i>Gabbro, dk. greenish, fine to med. grained</i>	

DRILLED BY *Moisette S. Drilling*

 SIGNED **CHESTER J. KURLIN, M.Sc., P. Eng.**
 CONSULTING GEOLOGIST

DIAMOND DRILL RECORD MISTANGO CONS. RES. LTD.

GEOLOGY

HOLE NO. M-86-7... SHEET NO. 5

LATITUDE _____

DATUM _____

STARTED _____

DEPARTURE _____

BEARING _____

COMPLETED _____

ELEVATION _____

DIP _____

ULTIMATE DEPTH _____

DEPTH FEET	FORMATION
362.0-363.4	Pink granitic dyke, contacts at 60° to C/A, some silicification and qtz. carb. alt'n.
363.4-403.5	Gabbro, dk. greenish grey, fine to med. grained
403.5-404.0	Basalt lava - an inclusion between gabbro dykes.
404.0-416.3	Gabbro dk, greenish grey, fine to med. grained.
416.3-417.7	A granitic dyke, pinkish, contacts at 60° to C/A.
417.7-444.0	Gabbro, dk. greenish grey, fine to med. grained.
444.0-452.2	Pink granitic dyke, med. grained, contacts at 70° to C/A.
452.2-467.5	Gabbro, dk. greenish, fine grained.
467.5-470.0	Basalt lava, greenish, fine grained with a few calcitic stringers, contact with gabbro at 35° to C/A.

Drilled by: Morisette D. Drilling

**DUPLICATE COPY
POOR QUALITY ORIGINAL
TO FOLLOW**

GEOLOGY
DIAMOND DRILL RECORD
MISTANGO CONS. RES. LTD. GEOLOGY

HOLE NO. A-86-7 SHEET NO. 5

LATITUDE DATUM STARTED
 DEPARTURE BEARING COMPLETED
 ELEVATION DIP ULTIMATE DEPTH

DEPTH FEET	FORMATION	FORMATION
362.0-363.4	Pink granitic dyke, contacts at 60° to 90°, some silicification and gtr. carb. all'v.	
363.4-403.5	Gabbro, dk. greenish grey, fine to med. grained	
403.5-404.0	Basalt lava - an inclusion between gabbro dykes.	
404.0-416.3	Gabbro, dk. greenish grey, fine to med. grained.	
416.3-417.7	A Granitic dyke, pinkish, contacts at 60° to 90°.	
417.7-444.0	Gabbro, dk. greenish grey, fine to med. grained.	
444.0-452.2	Pink granitic dyke, med. grained, contacts at 70° to 90°.	
452.2-467.5	Gabbro, dk. greenish, fine grained.	
467.5-470.0	Basalt lava, greenish, fine grained with a few calcitic stringers. contact with gabbro at 35° to 90°.	

DRILLED BY Mousette L. Drilling

 CHESTER J. KURLIOW, M.Sc., P.Eng.
(REGISTERED) (COMMERCIAL) (INDUSTRIAL)

DIAMOND DRILL RECORD

MISTANGO CONS. RES. LTD.

GEOLOGY.

HOLE NO. M-86-7 SHEET NO. 6

LATITUDE _____ DATUM _____ STARTED _____
 DEPARTURE _____ BEARING _____ COMPLETED _____
 ELEVATION _____ DIP _____ ULTIMATE DEPTH _____

DEPTH FEET	FORMATION	FORMATION
------------	-----------	-----------

470.0-471.5	Some pink granitic tongue along edge of glassy qtz. vein that it is relatively barren.	
471.5-478.1	Basalt lava, dk. greenish fine grained, a few qtz. carb. filled fractures.	
478.1-487.7	Gabbro, dk. greenish, fine grained, somewhat massive	
487.7-489.3	Pink granitic dyke.	
489.3-497.0	Gabbro dk greenish, fine grained, massive.	

497.0' END OF HOLE

Drilled by: Morisette D. Drilling

DUPLICATE COPY
POOR QUALITY ORIGINAL
TO FOLLOW

DIAMOND DRILL RECORD

MISTANGO CONS. RES. LTD. GEOLOGY

HOLE NO. *A-86-7* SHEET NO. *6*

LATITUDE _____ DATUM _____ STARTED _____
 DEPARTURE _____ BEARING _____ COMPLETED _____
 ELEVATION _____ DIP _____ ULTIMATE DEPTH _____

DEPTH FEET	FORMATION	FORMATION
470.0-471.5	<i>Some pink granitic tongues along edge of glassy gte. vein that it is relatively barren.</i>	
471.5-478.1	<i>Basalt lower dk. greenish fine grained, a few gte. carb. filled fractures.</i>	
478.1-487.7	<i>Gabbro dk. greenish, fine grained, somewhat massive.</i>	
487.7-489.3	<i>Pink granitic dyke.</i>	
489.3-497.0	<i>Gabbro dk greenish, fine grained, massive.</i>	
	<i>497.0' End of hole</i>	

PATRICIA MINING DIV.

RECEIVED

JUN 26 1986

A.M. _____ P.M. _____

7 8 9 10 11 12 1 2 3 4 5 6

DRILLED BY *Mariette O. Drilling*

 SIGNED **CHESTER J. KURYLIW, M.Sc., P.Eng.**
 CONSULTING GEOLOGIST

DIAMOND DRILL RECORD MISTANGO CONS. RES. LTD.

SAMPLING

HOLE NO. M-86-7... SHEET NO.1.....

LATITUDE -----

DATUM -----

STARTED June 16, 1986

DEPARTURE -----

BEARING -----

COMPLETED June 19, 1986

ELEVATION -----

DIP -----

ULTIMATE DEPTH -----

DEPTH FEET	FORMATION	Sample No.	From	To	Width	OZS Au	Ag
129.7-130.4	Basalt lava, a 1" qtz. carb. veinlet 1% dissem. Chalco. trace Po.	1466			.7	Tr	
144.1-147.0	Basalt lava, 10% qtz. calcite in an irregular fish net pattern of veinlets, a few stringers carry minor Po. and traces of chalco	1467			2.9	Tr	
147.0-147.9	Basalt lava, 10% irreg. qtz. calcite stringers, 3% Po. 1/2% chalco	1468			.9	Tr	
147.9-149.3	Grey qtz. vein that runs at 60° to core axis, 5% chalco pyrite in qtz., 5% Po largely in wallrock next to quartz. A good vein.	1468			1.4	0.06	0.40
153.0-156.0	Mixed lava and feldspar prophyry 2% streaks of Po. 1/2% chalco, 2% qtz. carb in irreg. stringers.	1470			2.8	Tr.	

Drilled by: Morisette D. Drilling

**DUPLICATE COPY
POOR QUALITY ORIGINAL
TO FOLLOW**

DIAMOND DRILL RECORD MISTANGO CONS. RES. LTD.

SAMPLING

HOLE NO. *A-86-7* SHEET NO. *1*

LATITUDE _____

DATUM _____

STARTED *June 16, 1986*

DEPARTURE _____

BEARING _____

COMPLETED *June 19, 1986*

ELEVATION _____

DIP _____

ULTIMATE DEPTH _____

DEPTH FEET	FORMATION	SAMPLE NO.	FROM	TO	WIDTH	OZS Au
129.7 - 130.4	Basalt lava, a 1" gtz. carb. veinlet 17% diatom. Chalco. Trace PO.	1466			.7	Tr
144.1 - 147.0	Basalt lava, 10% gtz. calcite in an irregular fish net pattern of vesiculae, a few stringers, carry minor PO. and Trace of Chalco.	1467			2.9	Tr
147.0 - 147.9	Basalt lava, 10% irreg. gtz. Calcite stringers, 3% PO. 1/4% Chalco.	1468			.9	Tr
147.9 - 149.3	Grey gtz. vein that runs at 60° to core axis, 5% Chalco pyrite in gtz., 5% PO. largely in wallrock next to quartz. A good looking vein.	1469			1.4	0.06 Au 0.40 Ag
153.7 - 156.0	Mixed lava and feldspar porphyry 2% streaks of PO. 1/4% Chalco, 5% gtz. carb. in irreg. stringers	1470			2.8	Tr

DRILLED BY *Mariette D. Drilling*

SIGNED *Robert J. Kurylew*
ROBERT J. KURYLEW, M.Sc., P. Eng.
CONSULTING GEOLOGIST

DIAMOND DRILL RECORD MISTANGO CONS. RES. LTD.

SAMPLING

HOLE NO. M-86-7 SHEET NO. 2

LATITUDE _____ DATUM _____ STARTED _____
 DEPARTURE _____ BEARING _____ COMPLETED _____
 ELEVATION _____ DIP _____ ULTIMATE DEPTH _____

DEPTH FEET	FORMATION	Sample No.	From	To	Width	OzS Au
162.5-163.6	Quartz porphyry dyke mixed with basalt lava, 10% qtz. carb. in fractures, 1% Po, minor chalco	1471			1.1	Tr
247.0-247.7	50% qtz. charbonitized lava 1/2% Py. traces of chalco	1472			.7	Tr
249.1-250.0	Basalt lava at porphyry contact, 10% silicified, 1% chalco, traces of Py and Po	1473			.9	Tr
260.0-262.9	Basalt lava, 20% qtz. carb. alt'n, minor Py, traces of chalco	1474			2.9	Tr
262.9-265.6	Altered lava, 25% qtz. carb. in irreg. shear fractures, traces of chalco, minor Py	1475			2.7	Tr

Drilled by: Morisette D. Drilling

**DUPLICATE COPY
POOR QUALITY ORIGINAL
TO FOLLOW**

DIAMOND DRILL RECORD MISTANGO CONS. RES. LTD.

SAMPLING

HOLE NO. *A-56-7* SHEET NO. *2*

LATITUDE _____ DATUM _____ STARTED _____
 DEPARTURE _____ BEARING _____ COMPLETED _____
 ELEVATION _____ DIP _____ ULTIMATE DEPTH _____

DEPTH FEET	FORMATION	SAMPLE NO	FROM	TO	WIDTH	OZS Au
					1.1	Tc
162.5 - 163.6	Quartz porphyry dyke mixed with basalt lava, 10% gtz. carb. in fractures, 1% PO. minor chalc.	1471				
247.0 - 247.7	50% gtz. carbonitized lava 12% PY. Traces of chalc.	1472			.7	Tc
249.1 - 250.0	Basalt lava at porphyry contact, 10% silicified, 1% chalc. traces of PY and PO.	1473			.9	Tc
260.0 - 262.9	Basalt lava, 20% gtz. carb. alt'ns, minor PY. Traces of chalc.	1474			2.9	Tc
262.9 - 265.6	Altered lava, 25% gtz. carb. in irreg. shear fractures, traces of chalc, minor PY.	1475			2.7	Tc

DRILLED BY *Moisette D. Drilling*

 SIGNED **CHESTER J. KURYLIW, M.Sc., P. Eng.**
 CONSULTING GEOLOGIST

DIAMOND DRILL RECORD

MISTANGO CONS. RES. LTD.

SAMPLING

HOLE NO. M-86-7 SHEET NO. 3

LATITUDE _____ DATUM _____ STARTED _____
 DEPARTURE _____ BEARING _____ COMPLETED _____
 ELEVATION _____ DIP _____ ULTIMATE DEPTH _____

DEPTH FEET	FORMATION	Sample No.	From	To	Width	Ozs. Au
265.6-267.8	Basalt lava 15% qtz carb. in irreg. shear 1% Py. Traces of chalco	1476			2.2	Tr
293.3-294.0	Basalt lava, 20% white qtz. stringers at 70° to core axis, minor Py	1477			.7	Tr
267.8-271.0	Sheared lava with shearing at 50-80° to C/A, 10% qtz. carb. in an irreg. fishnet pattern of stringers, 1% patches of py.	1478			3.2	Tr
271.0-274.5	Sheared basalt, 15% qtz. carb. in irreg. fishnet pattern of fractures, 2% blebs of Py.	1479			3.5	Tr.
301.0-301.8	25% qtz. stringers and silicification along shearings at 70° to C/A 2% Py.	1480			.8	Tr.

Drilled by: Morisette D. Drilling

DUPLICATE COPY
 POOR QUALITY ORIGINAL
 TO FOLLOW

DIAMOND DRILL RECORD MISTANGO CONS. RES. LTD.

SAMPLING

HOLE NO. *M-86-7* SHEET NO. 3

LATITUDE _____ DATUM _____ STARTED _____
 DEPARTURE _____ BEARING _____ COMPLETED _____
 ELEVATION _____ DIP _____ ULTIMATE DEPTH _____

DEPTH FEET	FORMATION	SAMPLE NO.	FROM	TO	WIDTH	OZS Au
265.6 - 267.8	Basalt lava, 15% gtz. carb. in irreg. shear 1% Pt. Traces of chalc.	1476			2.2	Tr
293.3 - 294.0	Basalt lava, 20% white gtz. stringers at 70° to core axis, minor Pt.	1477			.7	Tr
267.8 - 271.0	Sheared lava with shearing at 50°-80° to C/A, 10% gtz. carb. in an irreg. fishnet pattern of stringers, 1% patches of py.	1478			9.2	Tr
271.0 - 274.5	Sheared basalt, 15% gtz. carb. in irreg. fishnet pattern of fractures, 2% blebs of py.	1479			3.5	Tr
301.0 - 301.8	25% gtz. stringers and silicification along shearing at 70° to C/A 2% py.	1480			.8	Tr

DRILLED BY *Maisette D. Drilling*

 CHESTER J. KURYLOW, M.Sc., P.Eng.
 SIGNED CONSULTING GEOLOGIST

DIAMOND DRILL RECORD MISTANGO CONS. RES. LTD.

SAMPLING
HOLE NO. M-86-7 SHEET NO. 4

LATITUDE _____ DATUM _____ STARTED _____
 DEPARTURE _____ BEARING _____ COMPLETED _____
 ELEVATION _____ DIP _____ ULTIMATE DEPTH _____

DEPTH FEET	DESCRIPTION	Sample No.	From	To	Width	Ozs Au
338.3-339.3	Andesitic dyke at contact with gabbro, 10% qtz. carb. 2% Py. 2% Po. traces of chalco.	1481			1.0	Tr.
343.7-344.5	Andesitic dyke near contact with gabbro, 15% qtz. carb. 3% Py, traces of chalco.	1482			.8	Tr.
362.6-363.4	Strongly qtz. carb'd contact between a granitic tongue and gabbro, a few specks of chalco pyrite, minor Py	1483			.8	Tr
470.0-472.3	50% glassy qtz. carb. associated with a granitic tongue, looks barren	1484			2.3	Tr.

Drilled by: Morisette D. Drilling

DUPLICATE COPY
 POOR QUALITY ORIGINAL
 TO FOLLOW

DIAMOND DRILL RECORD MISTANGO CONS. RES. LTD.

SAMPLING

HOLE NO. *M-56-7* SHEET NO. *4*

LATITUDE _____ DATUM _____ STARTED _____
 DEPARTURE _____ BEARING _____ COMPLETED _____
 ELEVATION _____ DIP _____ ULTIMATE DEPTH _____

DEPTH FEET	FORMATION	SAMPLE NO.	FROM	TO	WIDTH	OZS. Au
338.3-339.3	Andesitic dyke at contact with gabbro, 10% gtz. carb. 2% P4. 2% PO. traces of chalc..	1481			1.0	Tr
343.7-344.5	Andesitic dyke near contact with gabbro, 15% gtz. carb. 3% P4, traces of chalc.	1482			.8	Tr
362.6-363.4	Strongly gtz. carb'd. Contact between a granitic tongue and gabbro, a few specks of chalc. pyrite, minor P4.	1483			.8	Tr
470.0-472.3	50% glassy gtz. carb. associated with a granitic tongue, looks barren.	1484			2.3	Tr

PATRICIA MINING DIV.

RECEIVED

JUN 26 1986

A.M. P.M.

7 8 9 10 11 12 1 2 3 4 5 6

DRILLED BY Maureen J. Drilling

 CHESTER J. KURYLOW, M.Sc., P.Eng.
 CONSULTING GEOLOGIST

STURGEON LAKE

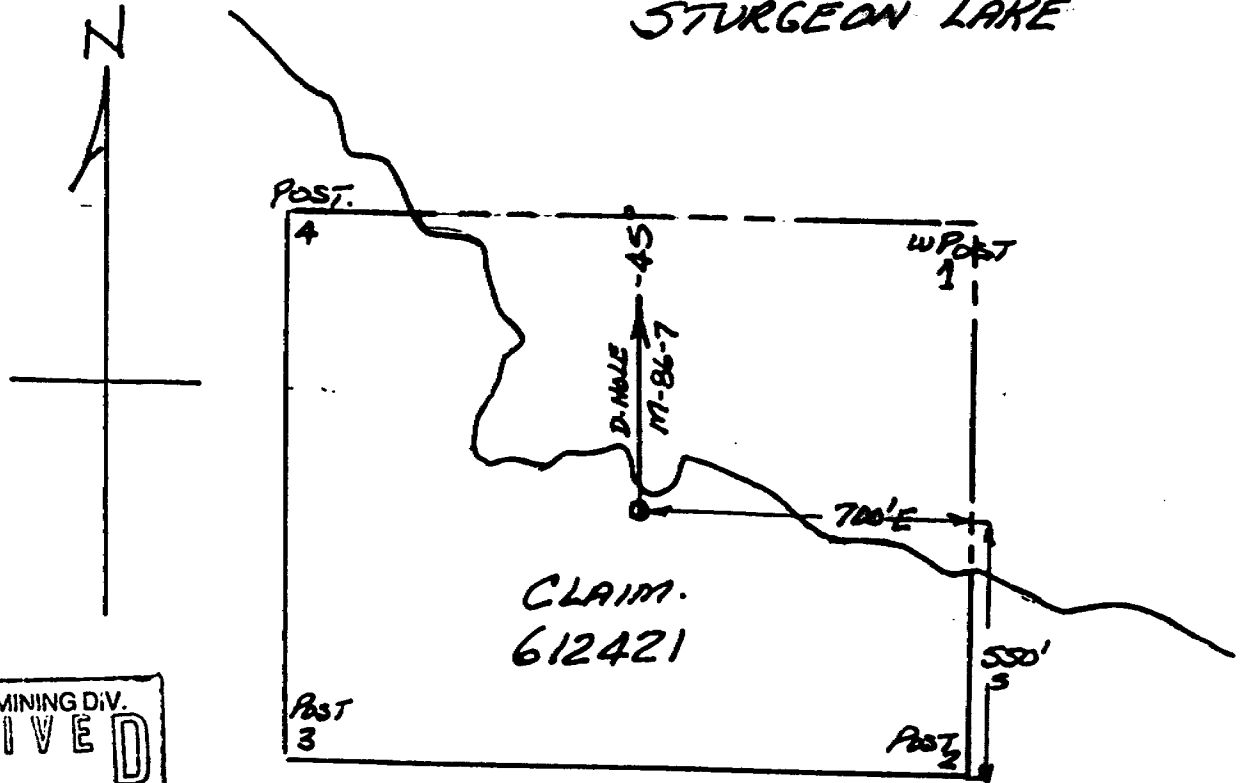

CLAIM.
612421

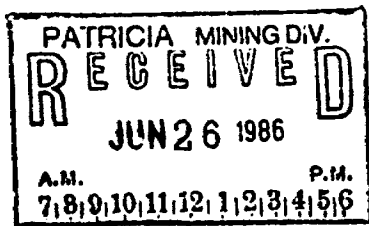

MISTANGO. CONSOLIDATED RES. LTD.

SKETCH OF LOCATION OF D.D.HOLE M-86-7

D.D.HOLE M-86-7

@ -45°, DUE NORTH, TO DEPTH OF 497.0

Claim PA 590687
B.Q. Core size
Core stored @ Mousseau
Camp. Sturgeon Lake

DIAMOND DRILL RECORD

MISTANGO CONS. RES. LTD.

GEOLOGY

HOLE NO. M-86-8 SHEET NO. 1

LATITUDE 17 + 00S DATUM _____ STARTED June 20, 1986
DEPARTURE 66 + 00 W BEARING Due North COMPLETED June 23, 1986
ELEVATION Lake + 5.0' DIP Collar -45° @ 200' @ 400' ULTIMATE DEPTH 486.0'

DEPTH FEET	FORMATION
0-6.0	Casing
6.0-46.0	Granite, pinkish, med. to coarse grained, equigranular texture, 15% greenish mafics in groundmass.
46.0-52.6	Andesitic dyke - dark greenish, fine grained, sharp chilled contacts at 40° to C/A.
52.6-97.8	Gabbro - dark greenish, med. grained, equigranular to diabasic texture.
97.8-101.3	Porphyritic granite - 20% white feldspar phenocrysts, fine grained groundmass.
101.3-149.0	Gabbro, dk. greenish, med. grained, equigranular to diabasic texture.
149.0-153.4	Andesitic dyke - lt. greenish, fine grained with chilled contact at 50° to C/A.

Drilled by Morisette D. Drilling

DUPLICATE COPY
POOR QUALITY ORIGINAL
TO FOLLOW

CLAIM # 590687

BQ CORE SIZE

CORE STORED @ MOUNTAIN
CAMP. STURLEON LAKE.

DIAMOND DRILL RECORD

MISTANGO CONS. RES. LTD. GEOLOGY

HOLE NO. M-86-8 SHEET NO. 1

LATITUDE 17° 00' S

DATUM

STARTED JUNE 20, 1986

DEPARTURE 66° 00' W

BEARING DUE NORTH

COMPLETED JUNE 23, 1986

ELEVATION LAKE + 5' 0"

DIP COLLAR - 45° 200' @ 100'

ULTIMATE DEPTH 486' 0"

DEPTH FEET	FORMATION	FORMATION
0 - 6.0	Casing	
6.0 - 46.0	Granite, pinkish, med. to coarse grained, equigranular texture, 15% greenish mafic in groundmass	
46.0 - 52.6	Andesitic dyke - dark greenish, fine grained, sharp chilled contacts at 48° To C/a.	
52.6 - 97.8	Gabbro - dark greenish, med. grained, equigranular to diabasic texture.	
97.8 - 101.3	Porphyritic granite - 20% white feldspar phenocrysts, fine grained groundmass.	
101.3 - 149.0	Gabbro, dk. greenish, med. grained, equigranular to diabasic texture.	
149.0 - 153.4	Andesitic dyke - dk. greenish, fine grained with chilled contact at 56° To C/a.	

DRILLED BY

Maurice D. Drilling

SIGNED

 CHESTER J. KURBATOW, M.Sc., P. Eng.
 CONSULTING GEOLOGIST

DIAMOND DRILL RECORD

MISTANGO CONS. RES. LTD.

GEOLOGY

HOLE NO. M-86-8 SHEET NO. 2

LATITUDE _____

DATUM _____

STARTED _____

DEPARTURE _____

BEARING _____

COMPLETED _____

ELEVATION _____

DIP _____

ULTIMATE DEPTH _____

DEPTH FEET	FORMATION
153.4-226.0	Gabbro - dk. greenish - med. grained.
226.0-254.0	Gabbro-peridotite, a dark to blackish green, fine to med. grained texture, no recognizable feldspars.
254.0-260.0	Andesitic dyke - lt greenish, fine grained, partly epitotized.
260.0-284.5	Gabbro-peridotite, dk. blackish green, fine grained, some minor dissem. chalco and pyrrhotite.
284.5-285.0	Andesitic dyke, lt. greenish, fine grained, chilled contacts at 60° to C/A.
285.0-289.0	Basalt, dark greenish, fine grained, massive
289.0-294.7	Feldspar prophyry dyke, greyish, 15% feldspar phenocrysts, greyish groundmass.

Drilled by: Morisette D. Drilling

DUPLICATE COPY
POOR QUALITY ORIGINAL
TO FOLLOW

DIAMOND DRILL RECORD
MISTANGO CONS. RES. LTD. GEOLOGY

HOLE NO. *M286-8* SHEET NO. *2*

LATITUDE _____ DATUM _____ STARTED _____
 DEPARTURE _____ BEARING _____ COMPLETED _____
 ELEVATION _____ DIP _____ ULTIMATE DEPTH _____

DEPTH FEET	FORMATION	FORMATION
153.4 - 226.0	Gabbro - dk. greenish - med. grained.	
226.0 - 254.0	Gabbro - peridotite, a dark to blackish green, fine to med. grained texture, no recognizable feldspar.	
254.0 - 260.0	Andesitic dyke - lt. greenish, fine grained, partly epitotized.	
260.0 - 284.5	Gabbro - Peridotite, dk. blackish green, fine grained, some minor dissem. Chalk and pyroxenite	
284.5 - 285.0	Andesitic dyke, lt. greenish, fine grained, chilled contacts lat 60° to 90°	
285.0 - 289.0	Basalt, dark greenish, fine grained, massive.	
289.0 - 294.7	Feldspar porphyry dyke, greyish, 15% feldspar phenocrysts, greyish groundmass.	

DRILLED BY Mrs. D. Drilling

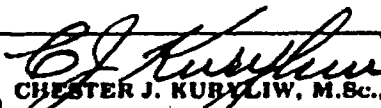
 SIGNED CHESTER J. KURYLIW, M.Sc., P. Eng.
 CONSULTING GEOLOGIST

DIAMOND DRILL RECORD MISTANGO CONS. RES. LTD.

GEOLOGY

HOLE NO. M-86-8 SHEET NO. 3

LATITUDE _____ DATUM _____ STARTED _____
 DEPARTURE _____ BEARING _____ COMPLETED _____
 ELEVATION _____ DIP _____ ULTIMATE DEPTH _____

DEPTH FEET	FORMATION
294.7-301.3	Basalt with 10% irreg. qtz. carb. in fractures
301.3-351.0	Basalt pillow lava, dk. greenish with some epitotized pillow rims, some parts were blockly to drilling.
351.0-374.0	Basalt - strongly fractured shear zone with 10-15% qtz. carbonate in an irregular fishnet pattern. The qtz. carbonate carries some pyrite and traces of chalcopyrite. Some narrow ceinlets of dk. blue-grey qtz occur. One veinlet at 367.5 ft carried two specks of <u>V.G.</u> Another veinlet at 393.0 ft carried two specks that may be fine <u>V.G.</u> This structure appears to be the eastern extension the Rainbow Island gold zone.
374.0-406.2	Basalt, a weakly fractured portion of the shear zone. It carries 5% qtz. carb. in irreg. fractures.

Drilled by: Morisette D. Drilling

**DUPLICATE COPY
POOR QUALITY ORIGINAL
TO FOLLOW**

DIAMOND DRILL RECORD

MISTANGO CONS. RES. LTD. GEOLOGY

HOLE NO. *M-86-8* SHEET NO. *3*

LATITUDE _____ DATUM _____ STARTED _____
 DEPARTURE _____ BEARING _____ COMPLETED _____
 ELEVATION _____ DIP _____ ULTIMATE DEPTH _____

DEPTH FEET	FORMATION
294.7-301.3	Basalt with 10% irreg. qtz. carb. in fractures
301.3-351.0	Basalt pillow lava, dk. greenish with some epitaxial pillow ridges, some parts were blocky to drilling.
351.0-374.0	Basalt - strongly fractured shear zone with 10% - 15% qtz. carbonate in an irregular fishnet pattern. The qtz. carbonate carries some pyrite and traces of chalcopirite. Some narrow veinlets of dk. blue-grey qtz. occur. One veinlet at 367.5 ft. carried two specks of V.G. Another veinlet at 393.0 ft. carried two specks that may be fine V.G. This structure appears to be the eastern extension of the Rainbow Island gold zone.
374.0-406.2	Basalt, a weakly fractured portion of the shear zone. It carries 5% qtz. carb. in irreg. fractures

DRILLED BY *Mousette D. Drilling*

SIGNED *[Signature]*
GUYSTER J. RORER, M.Sc., P. Eng.
 CONSULTING GEOLOGIST

DIAMOND DRILL RECORD

MISTANGO CONS. RES. LTD.

GEOLOGY

HOLE NO. M-86-8 SHEET NO. 4

LATITUDE _____ DATUM _____ STARTED _____
 DEPARTURE _____ BEARING _____ COMPLETED _____
 ELEVATION _____ DIP _____ ULTIMATE DEPTH _____

DEPTH FEET	FORMATION	FORMATION
406.2-415.4	Andesitic dyke - greenish, fine grained with contacts at 50° to C/A.	
415.4-448.5	Basalt, dk. greenish, fine grained, minor fracturing and rare qtz. carb.	
448.5-448.9	A granitic tongue at 70° to C/A.	
448.90455.0	Basalt lava, dk. greenish, fine grained.	
455.0-455.8	Granitic tongue pinkish, coarse grained.	
455.8-471.4	Basalt lava, dk. greenish, fine grained, a few hairline fractures.	
471.4-483.0	Feldspar prophyry dyke, 20% coarse white feldspar phenocrysts in dk. greyish groundmass.	
483.0-486.0	Basalt, dk. greenish, fine grained.	
	486.0' END OF HOLE	

Drilled by: Morisette D. Drilling

DUPLICATE COPY
 POOR QUALITY ORIGINAL
 TO FOLLOW

DIAMOND DRILL RECORD

MISTANGO CONS. RES. LTD. GEOLOGY

HOLE NO. *M-86-8* SHEET NO. *4*

LATITUDE _____

DATUM _____

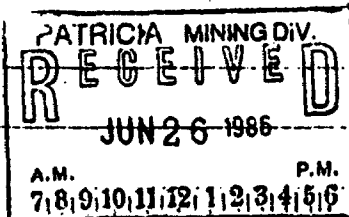

STARTED _____

DEPARTURE _____

BEARING _____

COMPLETED _____

ELEVATION _____

DIP _____

ULTIMATE DEPTH _____

DEPTH FEET	FORMATION	FORMATION
406.2 - 415.4	Andesitic dykes - greenish, fine grained with contacts at 50° to C/a.	
415.4 - 448.5	Basalt, dk. greenish, fine grained, minor fracturing and rare fte. carb.	
448.5 - 448.9	A granitic tongue at 70° to C/a	
448.9 - 455.0	Basalt lava, dk. greenish, fine grained.	
455.0 - 455.8	Granitic tongue pinkish, coarse grained.	
455.8 - 471.4	Basalt lava, dk. greenish, fine grained, a few hairline fractures.	
471.4 - 483.0	Feldspar porphyry dyke, 20% coarse white feldspar phenocrysts in dk. greyish groundmass	
483.0 - 486.0	Basalt, dk. greenish, fine grained.	
	486.0' End of Hole	

DRILLED BY *Moisette P. Drilling*

 SIGNED **CHESTER J. KURYLOW, M.Sc., P.Eng.**
 CONSULTING GEOLOGIST

DIAMOND DRILL RECORD

MISTANGO CONS. RES. LTD.

SAMPLING

HOLE NO. M-86-8 SHEET NO. 1

LATITUDE _____ DATUM _____ STARTED _____
 DEPARTURE _____ BEARING _____ COMPLETED _____
 ELEVATION _____ DIP _____ ULTIMATE DEPTH _____

DEPTH FEET	FORMATION	Sample No.	From	To	Width	OZS Au
254.4-255.3	Basalt lava contact zone, qtz. veinlets 1" wide, contacts at 55° to C/A, 1% Po. trace chalco	1485			0.9	
256.3-257.3	A 2" calcite vein at 55° to C/A, traces of chalco and pyrite	1486			1.0	
298.0-301.3	Basalt, 10% irreg. qtz. carb. minor Py.	1487			3.3	
342.0-343.3	Basalt pillow lava, 5% qtz. carb. 1% Po. 1/2% Py.	1488			1.3	
348.9-349.2	Basalt pillow lava, 5% qtz. carb. 1% Po.	1489			0.6	
355.0-357.5	Sheared basalt, 5% qtz. carb 2% Py. Trace chalco	1490			2.5	

Drilled by: Morisette D. Drilling

DUPLICATE COPY
POOR QUALITY ORIGINAL
TO FOLLOW

DIAMOND DRILL RECORD MISTANGO CONS. RES. LTD.

SAMPLING

HOLE NO. M-86-8 SHEET NO. 1

LATITUDE _____ DATUM _____ STARTED _____
 DEPARTURE _____ BEARING _____ COMPLETED _____
 ELEVATION _____ DIP _____ ULTIMATE DEPTH _____

DEPTH FEET	FORMATION	SAMPLE NO	FROM	TO	WIDTH	OZS. Au
254.4-255.3	Basalt lava contact zone, gtz. microlite at 55° to c/a, 1% Po. trace chalc.	1485			0.9	
256.3-257.3	A 2" calcite vein at 55° to c/a, Traces of chalc and pyrite.	1486			1.0	
298.0-301.3	Basalt, 10% irreg. gtz. carb. minor py.	1487			2.3	
342.0-343.3	Basalt pillow lava, 5% gtz. carb. 1% Po. 1/2% Py.	1488			1.3	
348.9-349.2	Basalt pillow lava, 5% gtz. carb, 1% Po.	1489			0.6	
355.0-357.5	Sheared basalt, 5% gtz. carb 2% Py. Trace chalc	1490			2.5	

DRILLED BY Moisette D. Drilling

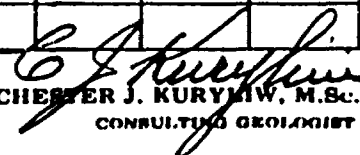
 SIGNED **CHESTER J. KURYLOW, M.Sc., P. Eng.**
 CONSULTING GEOLOGIST

DIAMOND DRILL RECORD

MISTANGO CONS. RES. LTD.

SAMPLING

HOLE NO. M-86-8 SHEET NO. 2

LATITUDE _____ DATUM _____ STARTED _____
 DEPARTURE _____ BEARING _____ COMPLETED _____
 ELEVATION _____ DIP _____ ULTIMATE DEPTH _____

DEPTH FEET	FORMATION	Sample No.	From	To	Width	Ozs Au
357.5-359.5	Basalt pillow lava, sheared 7% qtz. carb. 1% Py. Trace chalco	1491			2.0	
359.5-360.4	Basalt sheared with a 1" dk grey qtz. vein at 60° to C/A. 5% Py with specks of chalco	1492			0.9	
360.4-363.4	Basalt pillow lava. 7% qtz. carb. 1% Py (core stretched by drillers as marked in boxes)	1493			3.0	
360.4-362.6	Basalt pillow lava, 10% qtz. carb. 1% Py. Trace chalco	1494			2.2	
362.6-365.7	Basalt pillow lava, sheared 5% qtz. carb. minor py.	1495			3.1	

Drilled by: Morisette D. Drilling

DUPLICATE COPY
POOR QUALITY ORIGINAL
TO FOLLOW

DIAMOND DRILL RECORD MISTANGO CONS. RES. LTD.

SAMPLING

HOLE NO. 11-86-8 SHEET NO. 2

LATITUDE _____ DATUM _____ STARTED _____
 DEPARTURE _____ BEARING _____ COMPLETED _____
 ELEVATION _____ DIP _____ ULTIMATE DEPTH _____

DEPTH FEET	FORMATION	SAMPLE NO.	FROM	TO	WIDTH	OZS. Au
357.5-359.5	Basalt pillow lava, sheared 7% gtz. carb. 1% py. Trace chalc.	1491			2.0	
359.5-360.4	Basalt sheared with a 1" dk. grey gtz. vein at 60° to c/a. 5% py. with specks of chalc.	1492			0.9	
360.4-363.4	Basalt pillow lava, 7% gtz. carb. 1% py. (core stretched by drillers as marked in log)	1493			3.0	
360.4-362.6	Basalt pillow lava, 10% gtz. carb. 1% py. Trace chalc.	1494			2.2	
362.6-365.7	Basalt pillow lava, sheared 5% gtz. carb. minor py.	1495			3.1	

DRILLED BY *Morissette S. Drilling*

 SIGNED **CHESTER J. KURYLEW, M.Sc., P.Eng.**
 CONSULTING GEOLOGIST

DIAMOND DRILL RECORD

MISTANGO CONS. RES. LTD.

SAMPLING

HOLE NO. M-86-8 SHEET NO. 3

LATITUDE _____ DATUM _____ STARTED _____
 DEPARTURE _____ BEARING _____ COMPLETED _____
 ELEVATION _____ DIP _____ ULTIMATE DEPTH _____

DEPTH FEET	FORMATION	Sample No.	From	To	Width	OZS Au
365.7-367.4	Basalt pillow lava, 5% qtz. carb in irreg. fractures, 2% grey qtz. stringers 2% Py.	1496			1.7	
367.4-368.0	Sheared basalt pillow lava 5% qtz. carb in irreg. fractures. A 3" dk. grey qtz. vein carries 5% Py. specks of chalco, and two specks of V.G., one speck is quite coarse and about a 1/2mm diam. contacts of this vein are at 65° to C/A	1497			0.6	
368.0-369.3	Basalt pillow lava, 5% qtz. carb. in irreg. fractures, minor dk. qtz in qtz. carb minor py. and chalco.	1498			1.3	

Drilled by: Morisette D. Drilling

DUPLICATE COPY
 POOR QUALITY ORIGINAL
 TO FOLLOW

DIAMOND DRILL RECORD MISTANGO CONS. RES. LTD.

SAMPLING

HOLE NO. *M-86-8* SHEET NO. *3*

LATITUDE _____ DATUM _____ STARTED _____
 DEPARTURE _____ BEARING _____ COMPLETED _____
 ELEVATION _____ DIP _____ ULTIMATE DEPTH _____

DEPTH FEET	FORMATION	SAMPLE NO.	FROM	TO	WIDTH	OZS Au
365.7-367.4	Basalt pillow lava, 5% gtz. Carbon irreg. fractures, 2% grey gtz. stringers, 2% py.	1496			1.7	
367.4-368.0	Shredded basalt pillow lava 5% gtz- carb in irreg. fractures a 3" dk. grey gtz. vein carries 5% py. splcks of chalc., and two specks of V.G., one speck is quite coarse and about a 1/2 mm. diam. contacts of this vein are at 65° to Fla.	1497			0.6	
368.0-369.3	Basalt pillow lava, 5% gtz. Carbon irreg. fractures, minor dk. gtz- in gtz. carb. minor py. and chalc.	1498			1.3	

DRILLED BY

Maurice H. Drilling

SIGNED

C. J. Kurylow
 CHESTER J. KURYLOW, M.Sc., P.Eng.
 CONSULTING GEOLOGIST

DIAMOND DRILL RECORD MISTANGO CONS. RES. LTD.

HOLE NO. M-86-8 SHEET NO. 4

LATITUDE _____ DATUM _____ STARTED _____
 DEPARTURE _____ BEARING _____ COMPLETED _____
 ELEVATION _____ DIP _____ ULTIMATE DEPTH _____

DEPTH FEET	FORMATION	Sample No.	From	To	Width	Ozs Au
369.3-371.8	Basalt pillow lava, 5% irreg. qtz. carb. minor Py.	1499			2.5	
371.8-372.8	Basalt pillow lava 15% qtz. carb. in irreg. fractures, minor dk. grey qtz. minor Py. and chalco.	1500			1.0	
372.8-377.0	Basalt pillow lava, 8% qtz. carb. minor Py.	1501			4.2	
377.0-380.2	Basalt pillow lava, 5% qtz. carb. minor Py.	1502			3.2	
392.7-394.2	Basalt pillow lava, 5% qtz. carb. 1% Py	1503			1.5	
394.2-394.8	Basalt pillow lava, 5% qtz. carb. with a 2" dk. grey qtz. vein that carries 3% Py. specks of chalco and two lone specks that may be <u>V.G.</u>	1504			0.6	

Drilling by: Morisette D. Drilling

**DUPLICATE COPY
POOR QUALITY ORIGINAL
TO FOLLOW**

DIAMOND DRILL RECORD MISTANGO CONS. RES. LTD.

SAMPLING

HOLE NO. M-86-8 SHEET NO. 4

LATITUDE _____ DATUM _____ STARTED _____
 DEPARTURE _____ BEARING _____ COMPLETED _____
 ELEVATION _____ DIP _____ ULTIMATE DEPTH _____

DEPTH FEET	FORMATION	SAMPLE NO	FROM	TO	WIDTH	OZS Au
369.3-371.8	Basalt pillow lava, 5% irreg. gtz. carb. minor py.	1499			2.5	
371.8-372.8	Basalt pillow lava 15% gtz. carb. in irreg. fractures, minor dk. grey gtz. minor py. and chalc.	1500			1.0	
372.8-377.0	Basalt pillow lava, 8% gtz. carb. minor py.	1501			4.2	
377.0-380.2	Basalt pillow lava, 5% gtz. carb, minor py.	1502			3.2	
392.7-394.2	Basalt pillow lava, 5% gtz. carb. 1% py.	1503			1.5	
394.2-394.8	Basalt pillow lava, 5% gtz. carb. with a 2" dk. grey gtz. vein that carries 3% py. specks of chalc. and two fine specks that may be v.g.	1504			0.6	

DRILLED BY Monsieur D. Drilling

SIGNED

Christopher J. Norton
 CHRISTOPHER J. NORTON, M.Sc., P. Eng.
 CONSULTING GEOLOGIST

DIAMOND DRILL RECORD

MISTANGO CONS. RES. LTD.

SAMPLING

HOLE NO. M-86-8 SHEET NO. 5

LATITUDE _____ DATUM _____ STARTED _____
 DEPARTURE _____ BEARING _____ COMPLETED _____
 ELEVATION _____ DIP _____ ULTIMATE DEPTH _____

DEPTH FEET	FORMATION	Sample No.	From	To	Width	Ozs Au
394.8-396.0	Basalt pillow lava, 8% qtz. carb. 2% Py.	1505			1.2	
396.0-399.4	Basalt pillow lava, 5% qtz. minor Py	1506			3.4	
447.5-448.4	Basalt, a 2½" carbonate vein at 45° to C/A, 1% chalco, 1% Py and Po.	1507			0.9	

Drilled by: Morisette D. Drilling

DUPLICATE COPY
 POOR QUALITY ORIGINAL
 TO FOLLOW

DIAMOND DRILL RECORD MISTANGO CONS. RES. LTD.

SAMPLING

HOLE NO *A-86-8* SHEET NO. *5*

LATITUDE _____ DATUM _____ STARTED _____
 DEPARTURE _____ BEARING _____ COMPLETED _____
 ELEVATION _____ DIP _____ ULTIMATE DEPTH _____

DEPTH FEET	FORMATION	SAMPLE NO	FROM	TO	WIDTH	GZS. An
394.8-396.0	Basalt pillow lava, 8% gtz. Cark. 2% py.	1505			1.2	
396.0-399.4	Basalt pillow lava, 5% gtz. minor py.	1506			3.4	
447.5-448.4	Basalt, a 2 1/2" carbonate vein at 45° to c/a, 1% chalco, 1% py. and po.	1507			0.9	

ONTARIO GEOLOGICAL SURVEY
 ASSESSMENT PILES
 RESEARCH OFFICE
 AUG 18 1986
 RECEIVED

PATRICIA MINING DIV.
RECEIVED
 JUN 26 1986
 A.M. P.M.
 7 8 9 10 11 12 1 2 3 4 5 6

DRILLED BY *Maurette D. Drilling*

SIGNED *C. J. Kurat*
 CHESTER J. KURAT, M.Sc., P. Eng.
 CONSULTING GEOLOGIST

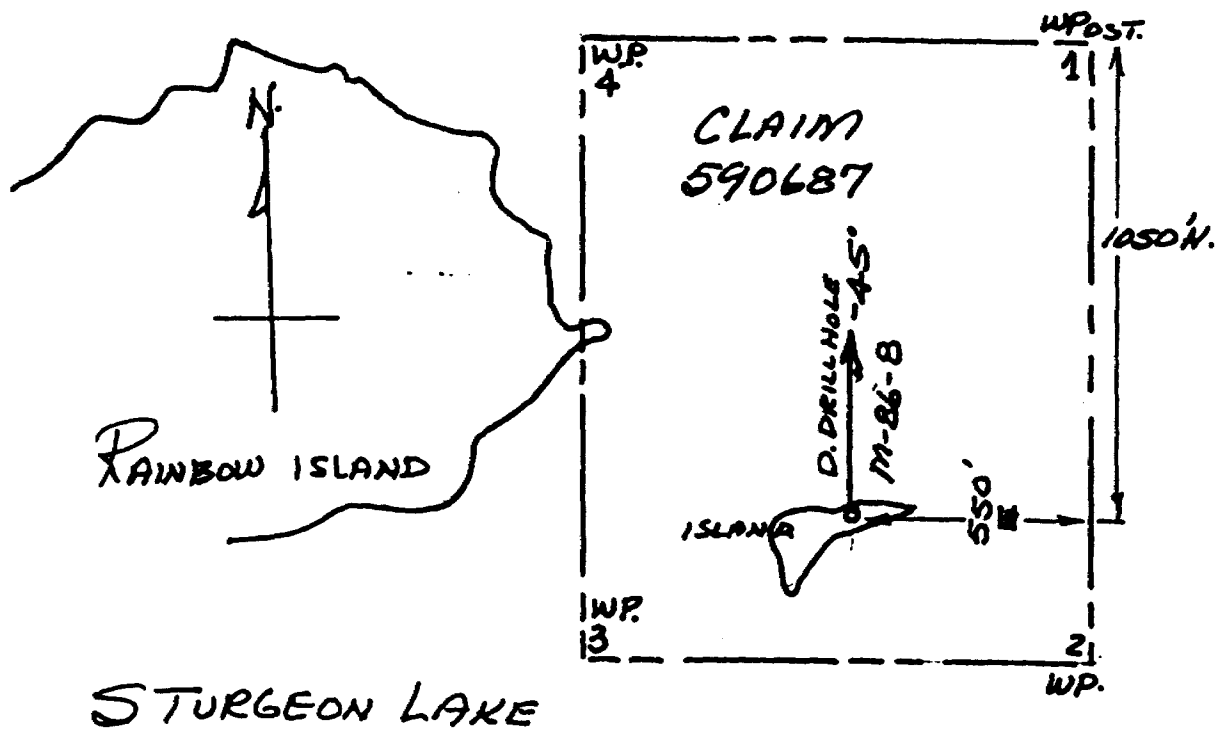

MISTANGO CONSOLIDATED RES. LTD.

SKETCH OF LOCATION OF DD HOLE M-86-8

D. DRILL HOLE M-86-8

@ -45°, TO DUE NORTH, TO DEPTH OF 486'.0

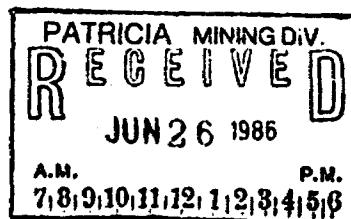

PATRICIA MINING DIV.
RECEIVED
JUN 26 1985
A.M. P.M.
7 8 9 10 11 12 1 2 3 4 5 6

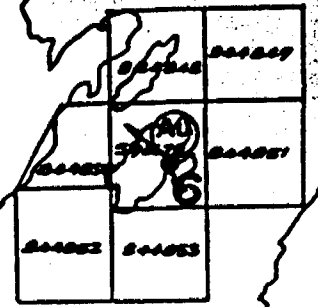

STURGEON LAKE

STEEP ROCK

Northwest Arm

PLAN OF 1986 D. DRILLING

MISTANGO CONS. RES.

CLAIM GROUP

STURGEON LAKE, ONT.

STEEP ROCK

KERR ADD.

(AU)

(AU)

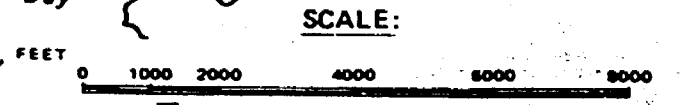
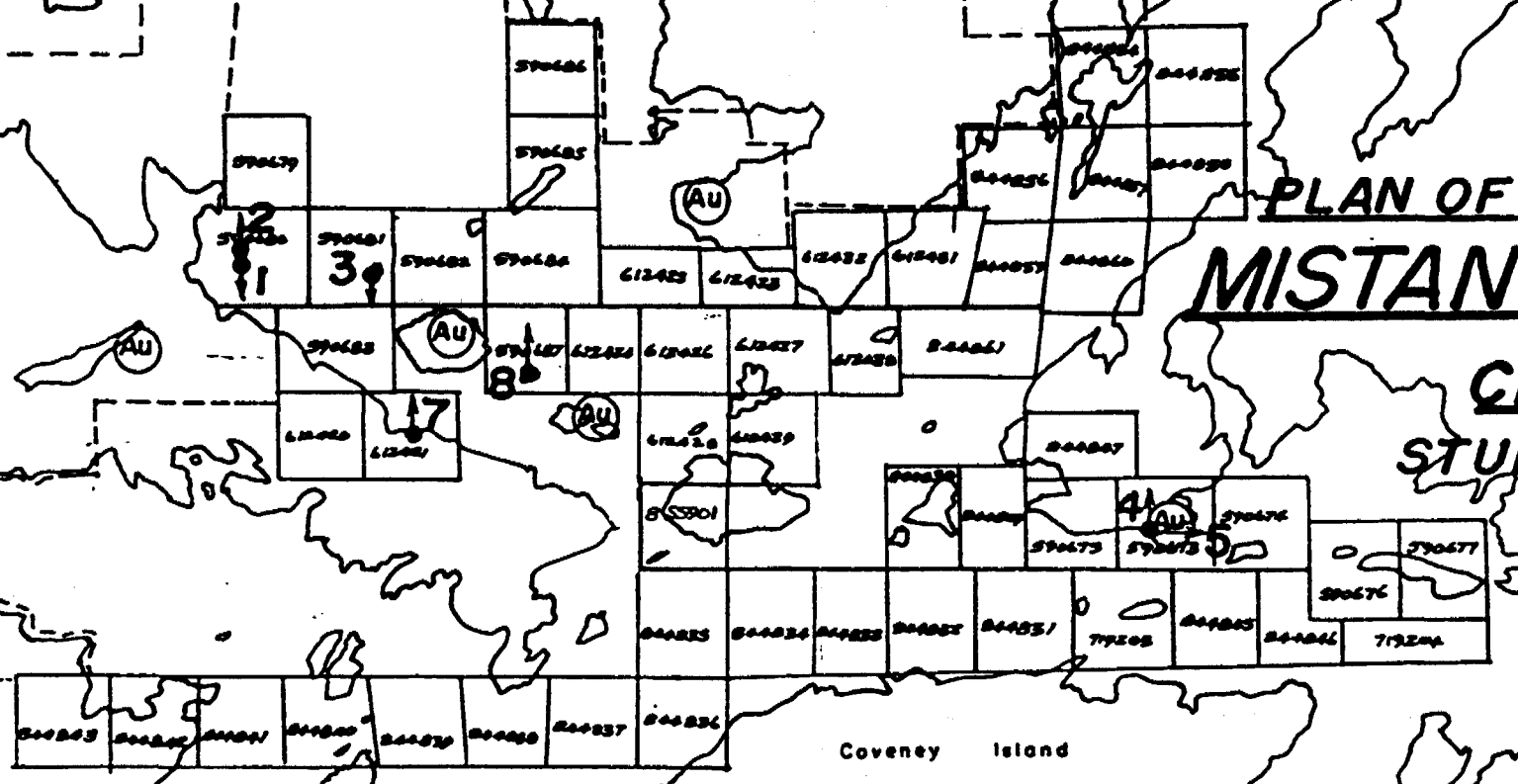

Squad Lake
3140

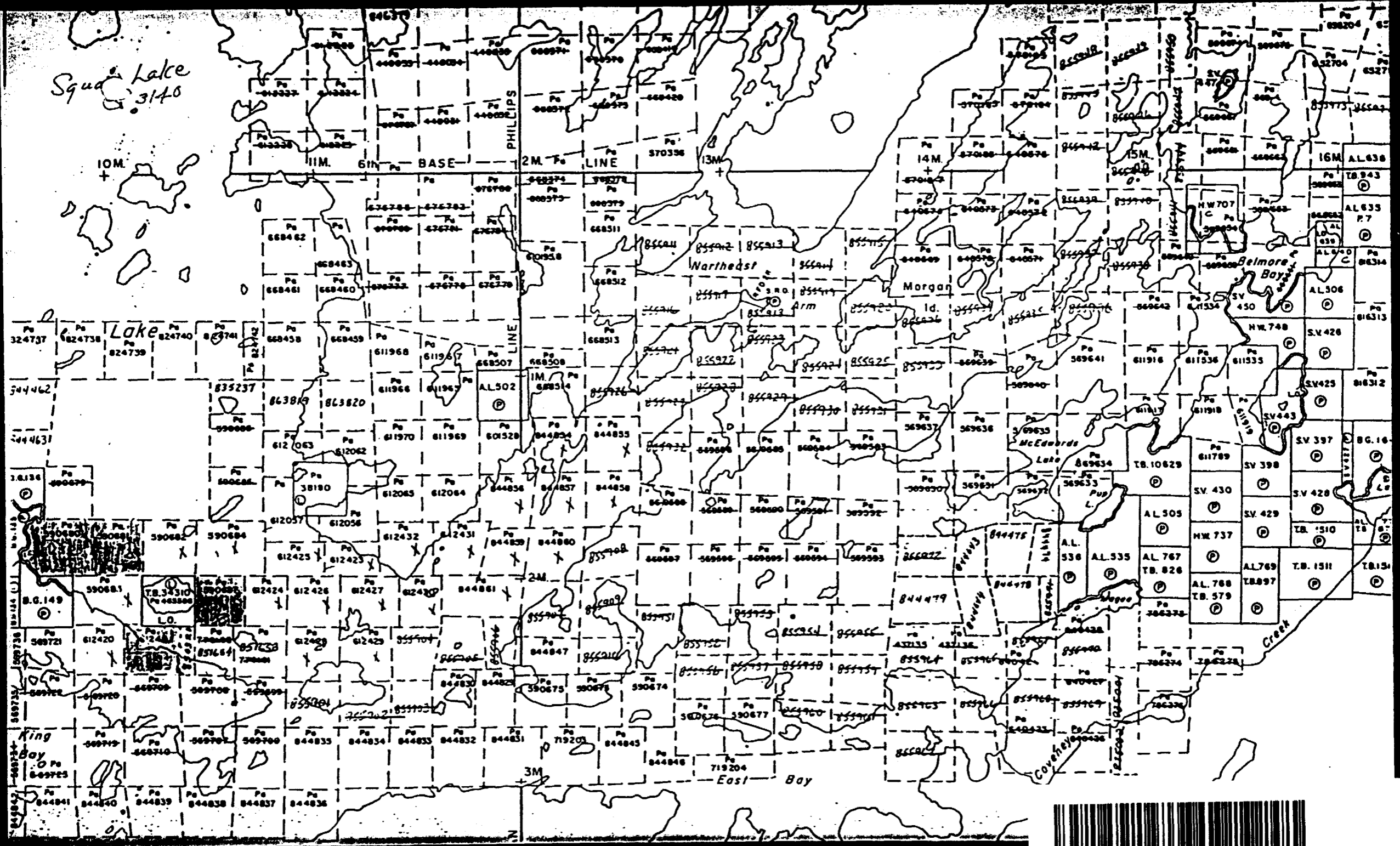

52J02E9260 36 SQUAW LAKE

Fourbay Lake Area -
M. 2879

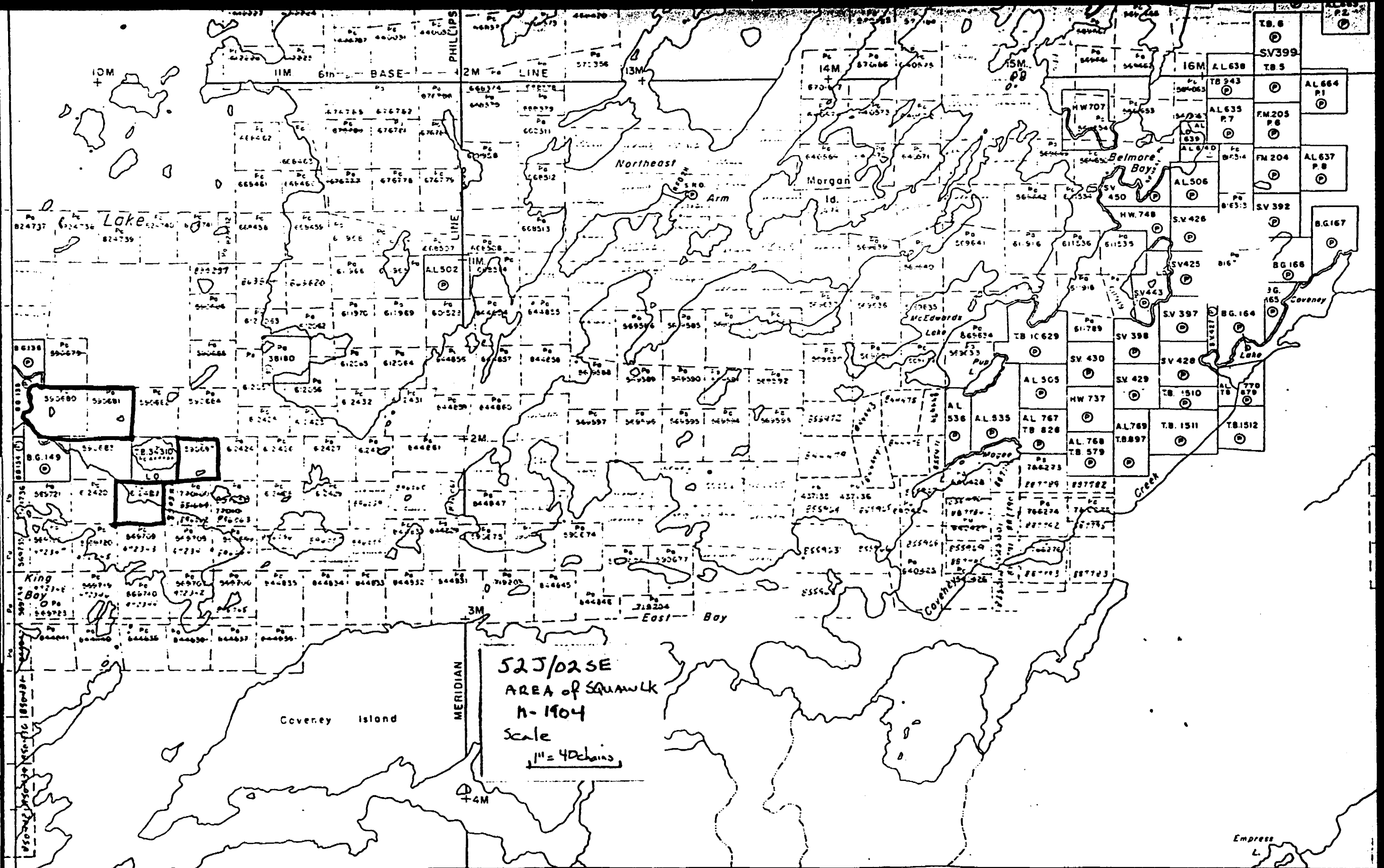

50°00'

90°45' 44' 43' 42' 41' 40' 39' 38' 37' 36'

Quest Lake Area - G-2556



Ministry of Natural Resources
Report of Work

86-124

Instructions - Supply required data on a separate form for each type of work to be recorded (see table below).
- For Geo-technical work use form no. 1362 "Report of Work (Geological, Geophysical, Geochemical and Expenditures)".

Ontario Assess. Lib. Squaw Lake G3140 Mining Act

Name and Postal Address of Recorded Holder: **MISTANGO CONSOLIDATED RESOURCES LTD.**
 137 HURON HTS. DR. NEWMARKET, ONT., L3Y 4Z6
 Prospector's Licence No.: **T-1551**

Summary of Work Performance and Distribution of Credits

Total Work Days Cr. claimed	Mining Claim			Mining Claim			Mining Claim		
	Prefix	Number	Work Days Cr.	Prefix	Number	Work Days Cr.	Prefix	Number	Work Days Cr.
1977	PA.	590680	100	Pa	612423	100	Pa	612431	100
		590681	100		612424	100		612432	100
		590682	100		612425	100		844855	20
		590683	100		612426	100		844856	20
		590684	100		612427	100		844857	20
		590687	100		612428	100		844858	20
		612420	100		612429	100		844859	20
		612421	100		612430	100		844860	20
All the work was performed on Mining Claim No. (Pa 590680, 590681, 612421, 590687)								844861	37

Required Information eg: type of equipment, Names, Addresses, etc. (See Table Below) **844854 20**

MORISSETTE DIAMOND DRILLING Co LTD. HAWLEY BURY, ONT.
DRILLED MAY-JUNE 1986, BQ CORE SIZE, TOTAL 1977.0

DRILL HOLE	CLAIM No	1986 DATES	DEPTH
M-86-1	Pa 590680	MAY 12 - MAY 20	350.0
M-86-2	590680	MAY 20 - MAY 22	297.6
M-86-3	590681	MAY 22 - MAY 24	347.0
M-86-7	612421	JUNE 16 - JUNE 19	497.0
M-86-8	590687	JUNE 20 - JUNE 23	486.0
AUG 18 1986 TOTAL DRILLING			1977.0

ON A CONTIGUOUS GROUP OF CLAIMS AS YR
 (AMENDED AUG 11 1986) Pa. 590673

Recorded Holder of Right (Signature): *Chester J. Kuryliw*
 Date of Report: **JUNE 23, 1986**

Certification Verifying Report of Work

I hereby certify that I have a personal and intimate knowledge of the facts set forth in the Report of Work annexed hereto, having performed the work or witnessed same during and/or after its completion and the annexed report is true.

Name and Postal Address of Person Certifying: **CHESTER J. KURYLIW, MSc. P. ENG. 46 INGALL DR. DRYDEN, ONT. P8N 3B7**
 Date Certified: **JUNE 23 1986**
 Certified by (Signature): *Chester J. Kuryliw*

Table of Information/Attachments Required by the Mining Recorder

Type of Work	Specific information per type	Other information (Common to 2 or more types)	Attachments
Manual Work	Nil	Names and addresses of men who performed manual work/operated equipment, together with dates and hours of employment.	Work Sketch: these are required to show the location and extent of work in relation to the nearest claim post.
Shaft Sinking, Drifting or other Lateral Work	Nil		
Compressed air, other power driven or mechanical equip.	Type of equipment	Names and addresses of owner or operator together with dates when drilling/stripping done.	Work Sketch (as above) in duplicate
Power Stripping	Type of equipment and amount expended. Note: Proof of actual cost must be submitted within 30 days of recording.		
Diamond or other core drilling	Signed core log showing: footage, diameter of core, number and angles of holes.	Nil	Nil
Land Survey	Name and address of Ontario land surveyor.		

MISTANGO CONS RES. DIAMOND DRILLING
STURGEON LAKE, DIST. OF PATRICIA, ONT.
MAY-JUNE, 1986.

DRILL HOLE No.	P.A. CLAIM NO	COORDINATES		DIP		BEARING	DEPTH FEET.
		LAT.	DEP.	DEPTH	DIP		
M-86 1 MAY 16 - MAY 20	590680	0+20' N	111+20' W	@ COLLAR @ 300'	-40° -40°	DUE SOUTH	350.0
M-86 2 MAY 20 - MAY 23	590680	2+80' N	111+00' W	@ COLLAR @ 290'	-40° -38½°	DUE NORTH	297.0
M-86 3 MAY 23 - MAY 26	590681	1+40' S	92+00' W	@ COLLAR @ 290.0	-40° -36°	DUE SOUTH	347.0
M-86 4 MAY 28 MAY 26	590673	2+00' N	17+50' E	@ COLLAR @ 200'	-70° -68°	DUE NORTH	203.0
M-86 5 MAY 26 - MAY 28	590673	2+00' N	17+53' E	@ COLLAR @ 200'	-50° -46°	DUE EAST	297.0
M-86 6 JUNE 12 - JUNE 15	590678	500' E of No 1 POST. 400' W "	400' W of No 1. Post	@ COLLAR @ 200' @ 500'	-50° -44° -36°	S-45°-E	516.0
M-86 7 JUNE 16 - JUNE 19	612421	24+50' S	86+00' W	@ COLLAR @ 300' @ 490'	-45° -44° -42°	DUE NORTH.	497.0
M-86 8 JUNE 20 - JUNE 23	590687	17+00' S	66+00' W	@ COLLAR @ 250' @ 486.0	-45° -45° -45½°	DUE NORTH	486.0

PATRICIA MINING DIV.
RECEIVED
 JUN 26 1986
 A.M. P.M.
 7 8 9 10 11 12 1 2 3 4 5 6

FOOTAGE TOTAL 2993.0