

523/02SE-0058-A1

LOAD: 16mm

51KT

Squaw Lake M-1904



Ministry of Natural Resources

Report of Work

#84-34



52J02SE9265 52J02SE58 SQUAW LAKE

Res. Geologist

The Mining Act

Name and Postal Address of Recorded Holder: **Moran Resources Corporation**
 Executive office: P.O. Box 458, St Andrews East, P.Q. J0V 1X0
 Head office: 600-800 West Pender Street, Vancouver, B.C. V6C 1K4

Prospector's Licence No.: **T-1175**

Total Work Days Cr. claimed	Mining Claim			Mining Claim			Mining Claim		
	Prefix	Number	Work Days Cr.	Prefix	Number	Work Days Cr.	Prefix	Number	Work Days Cr.
586.3	Pa	611534	40	Pa	612047	40			
for Performance of the following work. (Check one only) <input type="checkbox"/> Manual Work <input type="checkbox"/> Shaft Sinking Drifting or other Lateral Work. <input type="checkbox"/> Compressed Air, other Power driven or mechanical equip. <input checked="" type="checkbox"/> Power Stripping <input type="checkbox"/> Diamond or other Core drilling <input type="checkbox"/> Land Survey		611535	40		612048	40			
		611536	40		729913	20			
		611916	40		remainin.	credits	166.3 days		
		611917	40						
		611918	40						
		611919	40						
	611789	40							

All the work was performed on Mining Claim(s): Pa 569634 and Pa 612047

Required Information eg: type of equipment, Names, Addresses, etc. (See Table Below)

Power stripping from July 26, 1983 to August 10, 1983 with Thomas SF 2250 backhee, model no. U-81, 2 ft. bucket. Work performed by Kenora Diamond Drilling, P.O.Box 661, Kenora, Ont. P9N 3X6; operator O. Lotkuluk, assistant A. Iverson.

Work supervised by Lorontex Exploration Ltd., Dryden, Ont. as agent for Moran Resources Corporation.

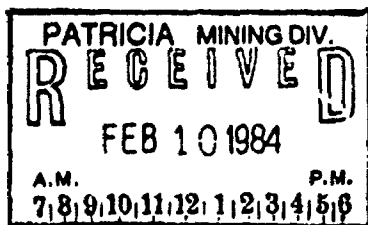

Date of Report: **Feb. 9, 1984**
 Recorded Name of Agent (Signature): *[Signature]*

Certification Verifying Report of Work

I hereby certify that I have a personal and intimate knowledge of the facts set forth in the Report of Work annexed hereto, having performed the work or witnessed same during and/or after its completion and the annexed report is true.

Name and Postal Address of Person Certifying: **R. van Enk, R.R. 1, Site 11, Box 7, Dryden, Ont. P6N 2E4**

Date Certified: **Feb. 9, 1984**
 Certified by (Signature): *[Signature]*

Table of Information/Attachments Required by the Mining Recorder

Type of Work	Specific information per type	Other information (Common to 2 or more types)	Attachments
Manual Work	Nil	Names and addresses of men who performed manual work/operated equipment, together with dates and hours of employment.	Work Sketch: these are required to show the location and extent of work in relation to the nearest claim post.
Shaft Sinking, Drifting or other Lateral Work			
Compressed air, other power driven or mechanical equip.	Type of equipment	Names and addresses of owner or operator together with dates when drilling/stripping done.	Work Sketch (as above) in duplicate
Power Stripping	Type of equipment and amount expended. Note: Proof of actual cost must be submitted within 30 days of recording.		
Diamond or other core drilling	Signed core log showing: footage, diameter of core, number and angles of holes.	Nil	Nil
Land Survey	Name and address of Ontario land surveyor.		

768 (81/3)

Ministry of Natural Resources
RECEIVED
 FEB 15 1984
 RESIDENT GEOLOGIST
 SIOUX LOOKOUT

52 1/2 SE
 Squaw Lake

36E

39F

40F

42E

44E

SKETCH MAP OF STRIPPED AREA
ON CLAIM 612047'

STURGEON LAKE

1" = 140'

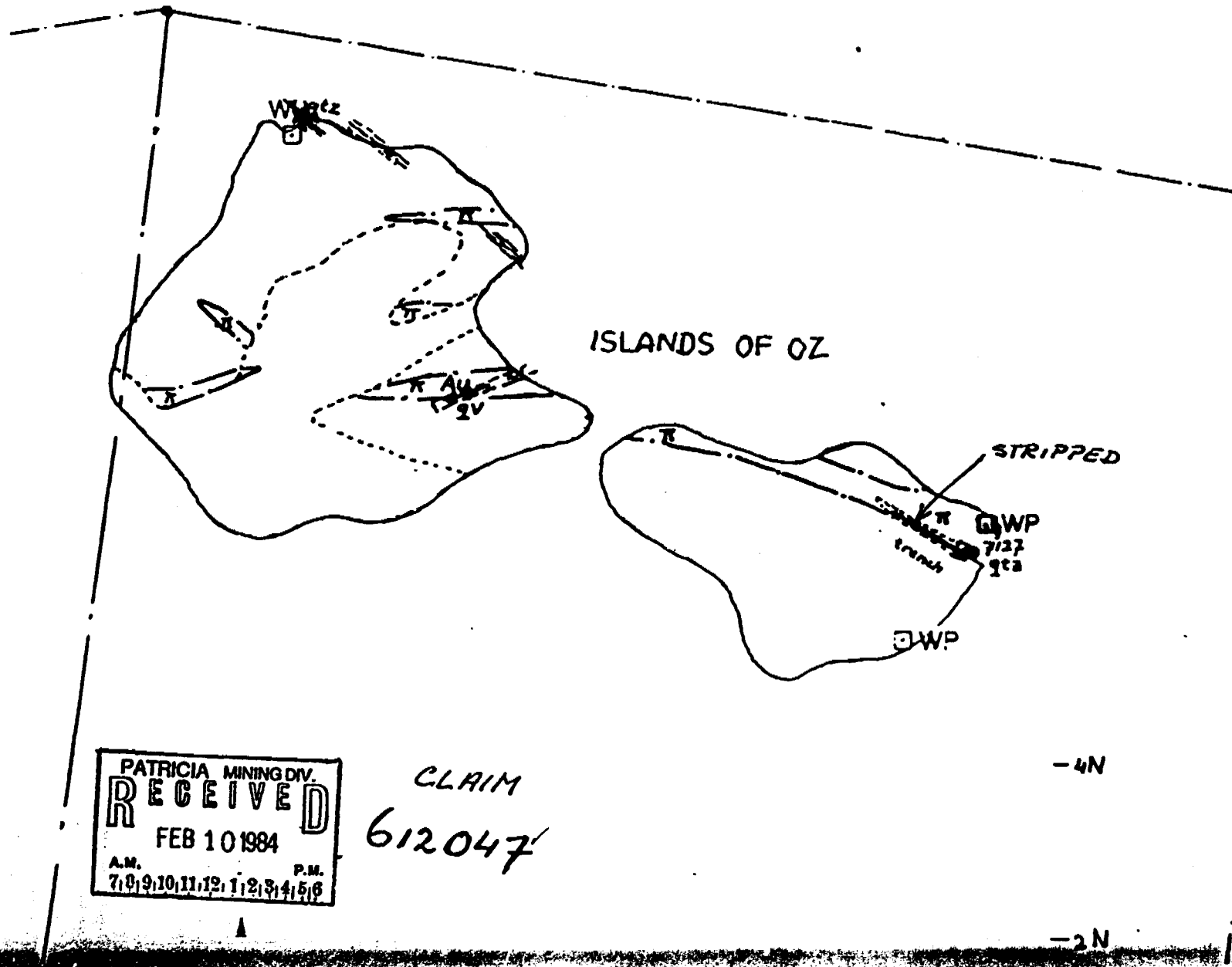

PATRICIA MINING DIV.
RECEIVED
 FEB 10 1984
 A.M. P.M.
 7 8 9 10 11 12 1 2 3 4 5 6

CLAIM
 612047'

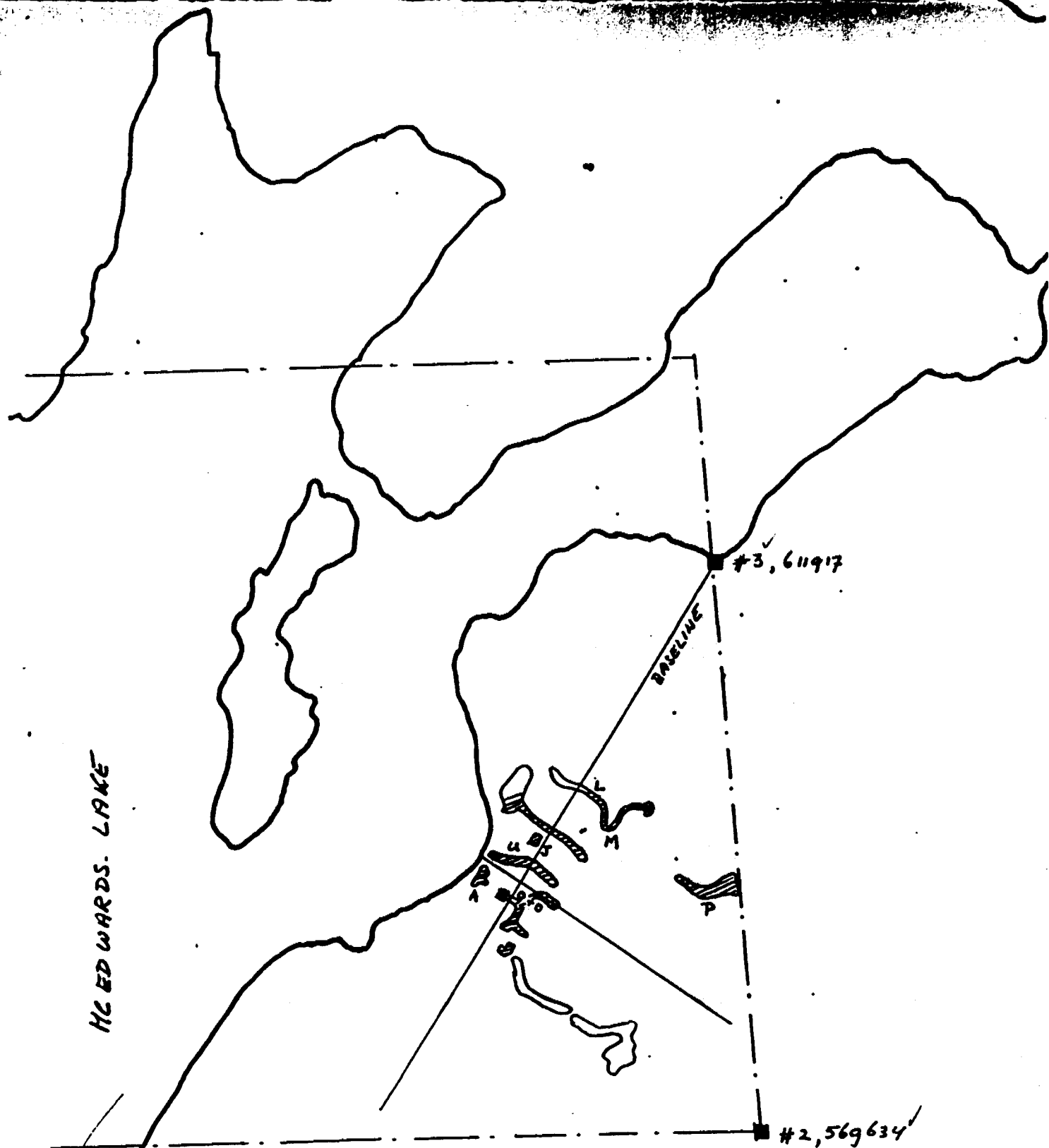

SKETCH MAP OF STRIPPED AREAS
ON CLAIM 569634 (NE EDWARDS LAKE)

1" = 200'

////// STRIPPED

PATRICIA MINING DIV.
RECEIVED
 FEB 10 1984
 A.M. P.M.
 7 8 9 10 11 12 1 2 3 4 5 6

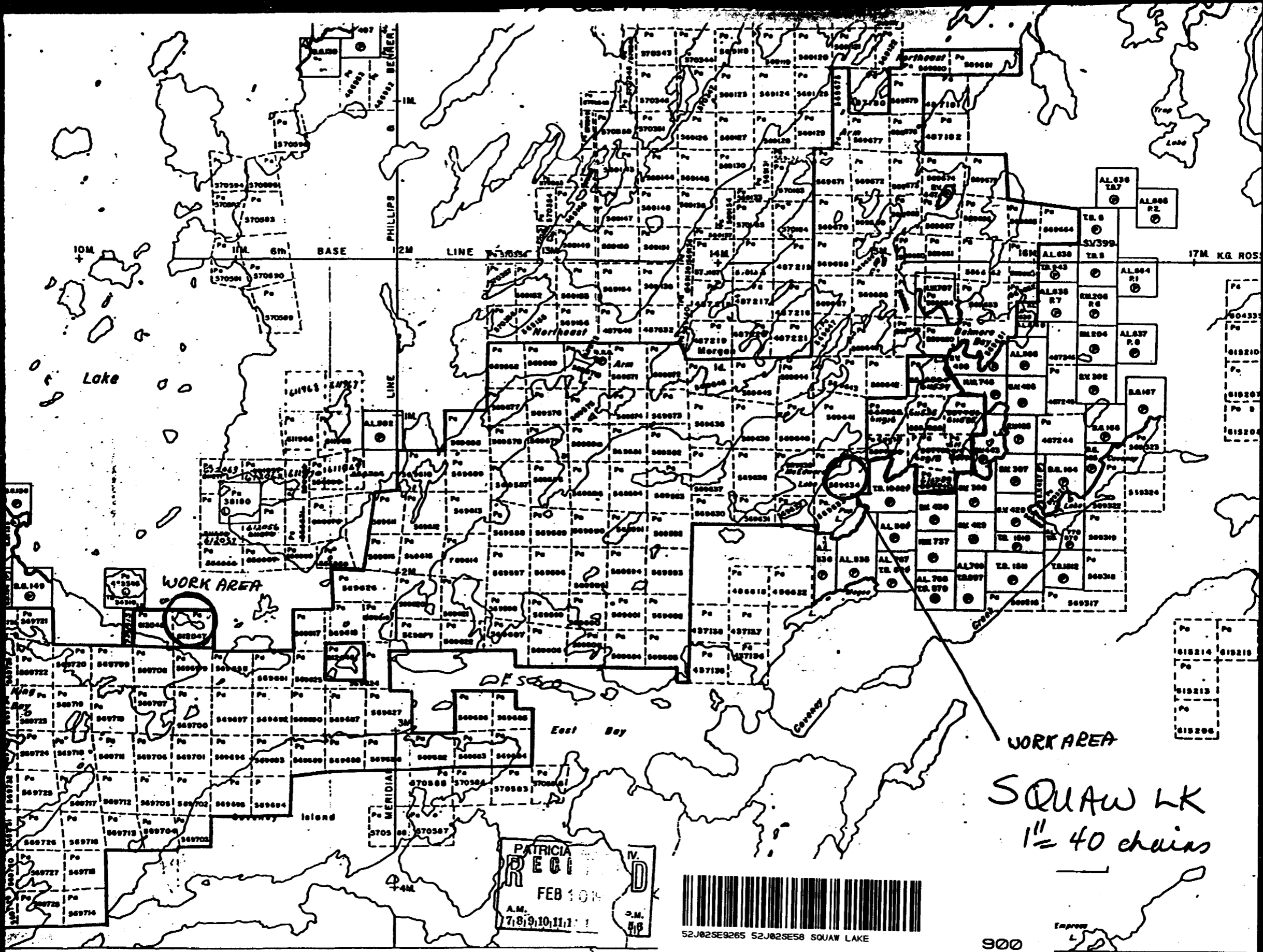

WORK AREA

WORK AREA

SQUAW LK
1" = 40 chains

PATRICIA
REC'D
FEB 10 1904
A.M.
7,8,9,10,11,12
IV.
S.M.
48

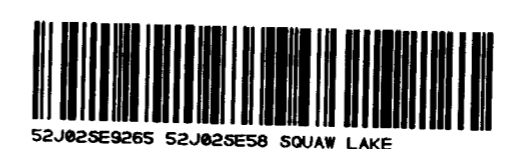

900

SQUAW LAKE M.1904

Quest Lake Area - M.2875

44' 43' 42' 41' 40' 39' 38' 37' 36' 35'