



52J02SW0034 52J02SW0025B1 FOURBAY LAKE

010

DIAMOND DRILLING

AREA: FOURBAY LAKE

Report No:

WORK PERFORMED FOR: FALCONBRIDGE LIMITED

RECORDED HOLDER: SAME AS ABOVE [x]

; OTHER [ ]

<u>CLAIM NO.</u>	<u>HOLE NO.</u>	<u>FOOTAGE</u>	<u>DATE</u>	<u>NOTE</u>
PA 487247	OK B-1	56'	Feb/86	
"	OK B-2	61'	Feb/86	
"	OK B-3	53'	Feb/86	
PA 475233	OK B-4	47'	Feb/86	
PA 487247	OK B-5	86'	Feb/86	
"	OK B-6	105'	Feb/86	
"	OK B-7	91'	Feb/86	
PA 475233	OK B-8	82'	Feb/86	
PA 487247	OK B-9	93'	Feb/86	
"	OK B-10	100'	Feb/86	
PA 475233	OK B-11	96'	Feb/86	
"	OK B-12	108'	Feb/86	
PA 570266	OK B-24	98'	Feb/86	
PA 569540	OK B-25	87'	Feb/86	
PA 475233	OK B-26	83'	Feb/86	
PA 487247	OK B-27	40'	Feb/86	
PA 487247	OK B-28	27'	Feb/86	
PA 475233	OK B-30	47'	Feb/86	
"	OK B-31	45'	Feb/86	
"	OK B-32	47'	Feb/86	
PA 487247	OK B-45	87'	Feb/86	
"	OK B-46	103'	Feb/86	
PA 475233	OK B-47	96'	Feb/86	
"	OK B-49	106'	Feb/86	
"	OK B-50	104'	Feb/86	
PA 487247	OK B-52	80'	Feb/86	
"	OK B-53	96'	Feb/86	

TOTAL

27 DH

2124 FT

NOTES:

OVERBURDEN DRILLING

Location: 7+00E/3+00S Logged by: D.F. Bosowec Hole No.: OKB-1

Started: February 13, 1986 Finished: February 13, 1986 Sheet No.: 1

Property: King Bay (PN 520)

Description: Grain size and texture of matrix (clay, sandy, silty) sorting. Colour. Structure (bedded, compact). Pebble size range, angularity. Pebble lithology with estimated percentages. HCL reaction.

FROM (feet)	TO		DESCRIPTION
0.0	10.0	10.0	Water Depth
10	16.7	6.7	Brownish grey, pebbly silty sandy till with minor cobbles, strongly consolidated, the clasts are angular to subrounded, polyolithic with qtz-feldspar porphyry, mafic volcanic and pegmatitic granite clasts, poorly sorted and worked. 60% recovery
16.7	31.3	15.1	Medium grey, pebbly sandy till with minor cobbles, loose material, angular to rounded, polyolithic with qtz-feldspar porphyry, mafic volcanic, pegmatitic granite and limestone clasts, moderately sorted and worked. HCL reaction. 65% recovery
31.8	37.0	5.2	Medium grey, pebbly silty till, minor cobble, moderately consolidated, angular to subangular, polyolithic with qtz-feldspar porphyry and mafic volcanic clasts, poorly sorted and worked. 50% recovery
37.0	39.1	2.1	Medium grey, pebbly sandy till, loose material angular to rounded, moderately sorted and worked, polyolithic with qtz-feldspar porphyry, mafic volcanic pegmatitic granite and limestone clasts. HCL reaction. 100% recovery

OVERBURDEN DRILLING

Location: 7+00E/3+00S Logged by: D.F. Bosowec Hole No.: OKB-1  
 Started: February 13, 1986 Finished: February 13, 1986 Sheet No.: 2  
 Property: King Bay (PN 520)

Description: Grain size and texture of matrix (clay, sandy, silty) sorting.  
 Colour. Structure (bedded, compact). Pebble size range, angularity.  
 Pebble lithology with estimated percentages. HCL reaction.

FROM	TO (feet)		DESCRIPTION
39.1	51.0	11.9	Medium to dark grey, cobbly pebbly sandy silty basal till, strongly consolidated, poorly worked and sorted, angular to subangular; minor subrounded, the lithology is generally polyolithic with qtz-feldspar porphyry, mafic volcanic pegmatitic granite and limestone, however qtz-feldspar porphyry clasts became predominant towards the bottom of the unit (45%). HCL reaction.  50.2-51.0 marked by dry coring of bedrock  Close to 100% recovery
51.0	56.0	5.0	<u>QTZ FELDSPAR PORPHYRY</u>  Unaltered and large feldspar phenocrysts.
	56.0		<u>END OF HOLE</u>  Contractor: Midwest Drilling, Winnipeg, Manitoba  Core is being stored on the property.

*[Handwritten Signature]*  
26/9/86

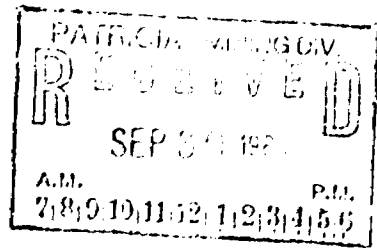

OVERBURDEN DRILLING

Location: 3+00S 6+00E Logged by: R.B. Band/Rick Hole No.: OKB2

Kristansen

Started: February 13, 1986 Finished: February 13, 1986 Sheet No.: 1

Property: King Bay (PN 520)

Description: Grain size and texture of matrix (clay, sandy, silty) sorting.  
Colour. Structure (bedded, compact). Pebble size range, angularity.  
Pebble lithology with estimated percentages. HCL reaction.

FROM (feet)	TO	DESCRIPTION
0.0	17.0	Water
17.0	18.2	Till. Grey-Brown; silt-sand grit matrix.  Angular pebbles and occasional small cobbles. Variable clasts, mainly mafic volcanics, but includes porphyry and granite.  Well consolidated.  HCL strong.
18.2	27.0	Grey, silty sandy-gritty till; pebbles are subangular occasional small cobbles. Varied lithology. Dominant mafic volcanic; granite. Poor sorting moderate-poor consolidation. Limestone fragments in grit component.  Strong reaction HCL.
27.0	31.5	Well sorted sand unit.  Size gradation from fine sand at top to coarse sand to grit at base.  Basal unit is a 0.5 ft. trace pebble bed with sub-rounded pebbles of FQP, granite and mafic volcanics.  Sand is grey, and unconsolidated. Grit-size limestone fragments. Strong HCL reaction.
32.0	54.5	<u>SILTY TILL</u>  Medium grey, poor-moderate, consolidation: Matrix-predominantly silty, with minor grit to small pebble phase and occasional (10%) sub-angular to subrounded

OVERBURDEN DRILLING

Location: 3+00S 6+00E Logged by: R.B. Band/Rick Hole No.: OKB2  
Kristansen  
 Started: February 13, 1986 Finished: February 13, 1986 Sheet No: 2  
 Property: King Bay (PN 520)

Description: Grain size and texture of matrix (clay, sandy, silty) sorting.  
 Colour. Structure (bedded, compact). Pebble size range, angularity.  
 Pebble lithology with estimated percentages. HCL reaction.

FROM	TO (feet)	DESCRIPTION
		<p>pebbles to cobbles. These have varied lithology including black ground mass. FQP, mafic volcanics and red coarse granodiorite/pegmatite.</p> <p>Strong HCL reaction; grit size limestone fragments.</p> <p>From 37.0' becomes slightly more consolidated and has more frequent sub-rounded cobbles.</p> <p>At 50.5-51.3: cored through a 0.8 ft. cobble of feldspar quartz porphyry. This is subrounded by white, dry rock flow produced by dry coring.</p> <p>From 51.5 becomes moderately well consolidated pebbles angular to subangular and dominantly FQP.</p> <p>[Silty to fine sand band at 48.0-49.0']</p>
54.5	61.0	<p><u>BEDROCK</u></p> <p>Contact marked by 1.0 ft. of dry rock flour caused by dry coring.</p> <p>54.5-57.5 Feldspar quartz porphyry</p> <p>57.5-61.0 Dark green-black fine-grained mafic dyke.</p> <p>Core broken: poor recovery</p>
	61.0	<p><u>END OF HOLE</u></p> <p>Contractor: Midwest Drilling, Winnipeg, Manitoba</p> <p>Core is being stored on the property.</p> <p style="text-align: right;"><i>R.B. Band</i> 26/9/86</p>

PATRICIA M. ...  
 SEP 5 1986  
 10, 11, 12, 13, 14, 15

OVERBURDEN DRILLING

Location: 3+00S; 5+00E Logged by: R.B. Band Hole No.: OKB3

Started: February 12, 1986 Finished: February 12, 1986 Sheet No.: 1

Property: King Bay (PN 520)

Description: Grain size and texture of matrix (clay, sandy, silty) sorting.  
 Colour. Structure (bedded, compact). Pebble size range, angularity.  
 Pebble lithology with estimated percentages. HCL reaction.

FROM (feet)	TO		DESCRIPTION
0.0	41.0	41.0	Water
41.0	44.5	3.5	<u>LACUSTRINE CLAY</u> Medium grey clay-silt, no grit size fragments. Soft and gel-like. No HCL reaction.
44.0	47.0	3.0	<u>TILL</u> Silt-sand-grit matrix with subangular to angular pebbles and minor cobbles. Grey; Poorly sorted, "normally" consolidated. Range of clast compositions, mafic volcanics roughly equal to FQP but QFP forms larger pebbles and cobbles. Pebble size increases with depth. FQP clast appears to increase with depth indicating high content of local material. HCL positive: Minor grit size creamy limestone fragments.
47.0	47.5	0.5	<u>SHATTERED BEDROCK/TILL CEMENTED</u> 75% angular fragments to 3.0" of FQP 25% light grey compact silt-grit till with angular QFP forming grit size material.
47.5	53.0		<u>FELDSPAR QUARTZ PORPHYRY</u> 40-50% white euhedral feldspar, 3 x 5mm. 10% black glossy quartz 40% dark grey glossy matrix No visible alteration.

PATRICIA M. MURPHY  
 10 11 12 1 2 3 4 5 6 7 8 9 10 11 12  
 SEP 3 1986  
 P.M.  
 10 11 12 1 2 3 4 5 6 7 8 9 10 11 12

OVERBURDEN DRILLING

Location: 3+00S; 5+00E Logged by: R.B. Band Hole No.: OKB3

Started: February 12, 1986 Finished: February 12, 1986 Sheet No.: 2

Property: King Bay

Description: Grain size and texture of matrix (clay, sandy, silty) sorting.  
 Colour. Structure (bedded, compact). Pebble size range, angularity.  
 Pebble lithology with estimated percentages. HCl reaction.

FROM (feet)	TO	DESCRIPTION
	53.0	<p>Bedrock surface masked by breccia of FOP clasts cemented with compact till.</p> <p><u>END OF HOLE</u></p> <p>Contractor: Midwest Drilling, Winnipeg, Manitoba</p> <p>Core is being stored on the property.</p> <p style="text-align: right;"><i>R.B. Band</i> 20/4/86</p>

OVERBURDEN DRILLING

Location: 3+00S; 4+00E Logged by: D.F. Bosowec Hole No.: OKB-4

Started: February 12, 1986 Finished: February 13, 1986 Sheet No.: 1

Property: King Bay (PN 520)

Description: Grain size and texture of matrix (clay, sandy, silty) sorting.  
 Colour. Structure (bedded, compact). Pebble size range, angularity.  
 Pebble lithology with estimated percentages. HCL reaction.

FROM (feet)	TO		DESCRIPTION
0.0	31.0	31.0	Water Depth
31.0	42.0	11.0	Medium grey, grain size varies from clay to cobble with grain size increasing from small pebbles to cobbles down hole, poorly sorted and worked, the majority of the clasts are angular to subangular, however near the top of the hole there are subrounded sands and pebbles. Clast lithology varies from polyolithic near the top of the sequence (granite, greenstone, etc.) to monolithic near the base of the sequence coarse grained qtz-feldspar porphyry? (90%)  Approximately 60% recovery.  Basal Till.
42.0	42.5	0.5	Gravel, generally coarsed grained QFP (95%), however there are also pebbles of k-feldspar rich granite and greenstone, subangular to angular. All fines and sands are absent indicating poor recovery.
42.5	47.0	4.5	<u>COARSE GRAINED QUARTZ FELDSPAR PORPHYRY</u>  Greyish black, coarse grained  Unaltered porphyry with (50%) euhedral feldspar crystals up to 1cm in size. Qtz present up to 10%.  Some of the feldspars are weakly altered green (saussurization). Trace py. Close to 100% recovery.
	47.0		<u>END OF HOLE</u>



OVERBURDEN DRILLING

Location: 3+00S; 4+00E Logged by: D.F. Bosowec Hole No.: OKB-4

Started: February 12, 1986 Finished: February 13, 1986 Sheet No.: 2

Property: King Bay

Description: Grain size and texture of matrix (clay, sandy, silty) sorting.  
 Colour. Structure (bedded, compact). Pebble size range, angularity.  
 Pebble lithology with estimated percentages. HCL reaction.

FROM (feet)	TO	DESCRIPTION
		Contractor: Midwest Drilling, Winnipeg, Manitoba Core is being stored on the property.

*RB-1*  
*26/9/86*

PATRICIA MINING DIV.  
**RECEIVED**  
 SEP 3 1986  
 A.M. P.M.  
 7 8 9 10 11 12 1 2 3 4 5 6

OVERBURDEN DRILLING

Location: 8+00E/4+00S Logged by: D.F. Bosowec Hole No.: OKB-5

Started: February 13, 1986 Finished: February 13, 1986 Sheet No.: 1

Property: King Bay (PN 520)

Description: Grain size and texture of matrix (clay, sandy, silty) sorting.  
Colour. Structure (bedded, compact). Pebble size range, angularity.  
Pebble lithology with estimated percentages. HCL reaction.

FROM (feet)	TO		DESCRIPTION
0.0	52.0	52.0	Water depth.
52.0	59.3	7.3	Dark brownish grey clay, plastic, brownish color probably attributed to organic matter.  Recent Fresh Water clay/Lacustrine clay
59.3	63.0	3.7	Medium grey pebbly sandy clay, poorly to moderately sorted and worked, clasts are angular to rounded, polyolithic.  Lacustrine clay/Clayey Till
63.0	70.0	7.0	Medium grey, gravelly pebbly sandy silty till, consolidated and plastic, poorly worked and sorted, angular to subrounded clasts, polyolithic with Qtz-feldspar porphyry, pegmatitic granite and granitoids. HCL reaction.  70% recovery.
70.0	80.0	10.0	Dark grey, cobbly to silty till, consolidated poorly worked and sorted, angular to subrounded, polyolithic with qtz-feldspar porphyry, mafic-intermediate volcanics, granitoid and limestone clasts. The section is dominated by blackish clasts (qtz-feldspar porphyry and intermediate volcanics?)  HCL reaction.  80% recovery.
80.0	86.0	6.0	<u>QTZ-FELDSPAR PORPHYRY</u>
	86.0		<u>END OF HOLE</u>

PATRICIA MINING DIV.  
**RECEIVED**  
SEP 30 1986  
A.M. P.M.  
9 10 11 12 1 2 3 4 5 6

Contractor: Midwest Drilling, Winnipeg, Manitoba

Core is being stored on the property.

*R.B. Bosowec*  
26/9/86

OVERBURDEN DRILLING

Location: 7+00E/4+00S Logged by: D.F. Bosowec Hole No.: OKB-6

Started: February 13, 1986 Finished: February 14, 1986 Sheet No.: 1

Property: King Bay (PN 520)

Description: Grain size and texture of matrix (clay, sandy, silty) sorting.  
 Colour. Structure (bedded, compact). Pebble size range, angularity.  
 Pebble lithology with estimated percentages. HCL reaction.

FROM (feet)	TO		DESCRIPTION
0.0	57.0	57.0	Water Depth
57.0	62.0	5.0	Dark brownish grey clay, plastic, brownish color probably attributed to organic matter.  Fresh Water clay/lacustrine clay
62.0	63.8	1.8	Medium grey, pebbly sandy clay, plastic, poorly worked and sorted, angular to rounded clasts, polyolithic, HCL reaction.  Clayey Till
63.8	68.3	4.5	Medium grey, cobbly to pebbly coarse grained sand, the pebble and cobble size clasts are concentrated in the top 4" of the section, moderately worked and sorted, angular to rounded grams, polyolithic.  HCL reaction.  Worked Till  40% recovery
68.3	78.0	9.7	Medium grey, gravelly, to silty till, poorly worked and sorted, consolidated, angular to rounded, polyolithic with qtz-feldspar porphyry, granitoid, limestone and mafic volcanic clasts.  Mild HCL reaction.  70% recovery

PATRICIA MIMINGDON  
**RECEIVED**  
 SEP 30 1986  
 A.M. P.M.  
 7 8 9 10 11 12 1 2 3 4 5 6

OVERBURDEN DRILLING

Location: 7+00E/4+00S Logged by: D.F. Bosowec Hole No.: OKB-6  
 Started: February 13, 1986 Finished: February 14, 1986 Sheet No.: 2  
 Property: King Bay (PN 520)

Description: Grain size and texture of matrix (clay, sandy, silty) sorting.  
 Colour. Structure (bedded, compact). Pebble size range, angularity.  
 Pebble lithology with estimated percentages. HCL reaction.

FROM (feet) TO			DESCRIPTION
78.0	92.0	14.0	<p><u>SILTY TILL</u></p> <p>Dominantly silty with minor fine sand and grit component, 5% subrounded pebbles, mainly dark grey-black fine-grained mafic. Plus occasional granitoid pebbles and cobbles. Moderately consolidated. Medium grey color, strong HCL reaction. Minor limestone fragments in grit component.</p> <p>80.0-80.5 Pebble to small cobble-rich section, more compact than main section.</p>
92.0	96.0	4.0	<p><u>BOULDER TO COBBLE TILL</u></p> <p>Poor core recovery (25%) with fines washed out. Boulder/cobbles are angular to rounded, (probably broken by drilling) 50% mafic volcanics, 50% granitoid. No FQP. Poor recovery may be due to partial blocking of bit on boulder?</p>
96.0	100.0	4.0	<p><u>SILTY-GRITTY-PEBBLE TILL, COMPACT</u></p> <p>Slightly darker grey colors, more consolidated. Pebble-small cobbles more abundant (10-15%) subangular to angular. Basal 2 ft. is definitely more compact.</p> <p>Dominant clast type is altered porphyry with 5% pyrite mainly on joints. Relic feldspar and quartz phenocrysts in fine-grained dark-medium grey groundmass. Feldspars are corroded and saussuritised. Altered porphyry clasts</p>

OVERBURDEN DRILLING

Location: 7+00E/4+00S      Logged by: D.F. Bosowec      Hole No.: OKB-6  
 Started: February 13, 1986      Finished: February 14, 1986      Sheet No.: 3  
 Property: King Bay (PN 520)

Description: Grain size and texture of matrix (clay, sandy, silty) sorting.  
 Colour. Structure (bedded, compact). Pebble size range, angularity.  
 Pebble lithology with estimated percentages. HCl reaction.

FROM	TO (feet)		DESCRIPTION
100.0	105.0	5.0	<p>increase in basal 2 ft., are mostly sharply angular; size range 1" to 3 ins.</p> <p>Other clasts are mafic volcanic and granitoid. No fresh FQP.</p> <p>Strong HCl reaction. Limestone fragments in grit component. Panned concentrate has high pyrite content.</p>
			<p><u>BEDROCK: FELDSPAR QUARTZ PORPHYRY</u></p> <p>Broken core (jointing?) 30-40% feldspar as euhedral 2 x 5 to 3 x .10mm phenocrysts, minor saussuritisation: 10% quartz as 2-3mm rounded quartz eyes in dark grey fine grained matrix.</p> <p>Minor (1%) fine pyrite on joints.</p> <p>This is fresh, composed to altered clasts in overlying till.</p>
	105.0		<p><u>END OF HOLE</u></p> <p>Contractor: Midwest Drilling, Winnipeg, Manitoba</p> <p>Core is being stored on the property.</p> <p style="text-align: right;"><i>RFB</i> 26/9/86</p>

OVERBURDEN DRILLING

Location: 4+00S/6+00E Logged by: R.B. Band Hole No.: OKB-7  
 Started: February 13, 1986 Finished: February 14, 1986 Sheet No.: 1  
 Property: King Bay (PN 520)

Description: Grain size and texture of matrix (clay, sandy, silty) sorting.  
 Colour. Structure (bedded, compact). Pebble size range, angularity.  
 Pebble lithology with estimated percentages. HCL reaction.

FROM (feet)	TO		DESCRIPTION
0.0	62.0		Water
62.0	70.0	8.0	<u>LACUSTRINE CLAY/SILT</u> Brown-grey plastic to gel-like clay silt. No fragments coarser than silt. Colour changes to medium grey at 67.0 ft.
70.0	77.0	7.0	<u>SILTY SANDY, GRITTY TILL</u> Silt dominant, minor sand, minor grit 5% pebbles-cobbles, generally sub-rounded multiple lithologies, granitoid, mafic volcanics. Moderately to poorly consolidated. Medium grey. Strong HCL reaction. Rounded limestone fragments in grit component.
77.0	82.0	5.0	<u>SILTY-GRITTY TILL</u> Slight increase in grit component otherwise same.
82.0	87.0	5.0	<u>SILTY-GRIT-COBBLE TILL</u> Grey, moderately consolidated; poorly sorted, bimodal grain size - 35% cobbles of feldspar-quartz porphyry; subangular-look like joint bounded blocks. No other lithologies in pebble-cobbles. Matrix is silty with minor grit component. Rarely FQP clasts have fine pyrite on joints. HCL reaction positive.
87.0	91.0	4.0	<u>BEDROCK</u> Feldspar-quartz porphyry.

PATRICIA MUNG DIV.  
**RECEIVED**  
 SEP 30 1986  
 A.M. P.M.  
 7 8 9 10 11 12 1 2 3 4 5 6

OVERBURDEN DRILLING

Location: 4+00S/6+00E Logged by: R.B. Band Hole No.: OKB-7

Started: Febraury 13, 1986 Finished: February 14, 1986 Sheet No.: 2

Property: King Bay (PN 508)

Description: Grain size and texture of matrix (clay, sandy, silty) sorting.  
 Colour. Structure (bedded, compact). Pebble size range, angularity.  
 Pebble lithology with estimated percentages. HCL reaction.

FROM (feet)	TO	DESCRIPTION
	91.0	<p><u>END OF HOLE</u></p> <p>Contractor: Midwest Drilling, Winnipeg, Manitoba</p> <p>Core is being stored on the property.</p> <p><i>R.B.B.</i> 26/7/16</p>

OVERBURDEN DRILLING

Location: 4+00S/5+00E Logged by: R.B. Sand Hole No.: OKB-8  
 Started: February 14, 1986 Finished: February 14, 1986 Sheet No.: 1  
 Property: King Bay (PN 520)

Description: Grain size and texture of matrix (clay, sandy, silty) sorting.  
 Colour. Structure (bedded, compact). Pebble size range, angularity.  
 Pebble lithology with estimated percentages. HCL reaction.

FROM (feet)	TO		DESCRIPTION
0.0	50.0		Water
50.0	57.0	7.0	<u>LACUSTRINE CLAY</u> Clay-silt, nothing coarser. Medium grey plastic to gel-like. Upper 2 ft. is brownish.
57.0	62.5	5.5	<u>SILTY-GRITTY TILL</u> Grey, moderately well consolidated silty-gritty matrix with 5% pebbles and cobbles. These vary from subrounded to sub-angular and include granitoid (mainly sub-rounded) mafic volcanics (subangular) and F.Q.P. (1-2" and sub-angular). One subrounded chert pebble. Strong HCL reaction.
62.5	67.0	4.5	<u>SILTY TILL</u> Grey well consolidated, silty matrix minor grit component. Pebbles subrounded: mafic volcanics and granitoid. Strong HCL reaction.
67.0	73.0	6.0	<u>SILTY-BOULDERY TILL</u> Grey, well consolidated matrix slightly more gritty. Boulders of mafic volcanic and granite. Strong HCL reaction.
73.0	76.0	3.0	<u>SILTY BOULDERY TILL</u> As above with two FQP boulders separated by 1 ft. silty till.
76.0	82.0	6.0	<u>BEDROCK</u> Feldspar-Quartz-Porphyry:

PATRICIA MINING DIV.  
**RECEIVED**  
 SEP 30 1986  
 A.M. P.M.  
 7 8 9 10 11 12 1 2 3 4 5 6



OVERBURDEN DRILLING

Location: 4+00S/5+00E Logged by: R.B. Band Hole No.: Or.S-8

Started: February 14, 1986 Finished: February 14, 1986 Sheet No.: 2

Property: King Bay (PN 520)

Description: Grain size and texture of matrix (clay, sandy, silty) sorting.  
 Colour. Structure (bedded, compact). Pebble size range, angularity.  
 Pebble lithology with estimated percentages. HCL reaction.

FROM (feet)	TO	DESCRIPTION
	82.0	<p>30-40% feldspars, phenocrysts, 10% bluish quartz phenocrysts, matrix is fine-medium grained, dark grey. Feldspars to 4 x 10mm, qtz. to 3mm.</p> <p>Feldspars are white, no evident alteration.</p> <p><u>END OF HOLE</u></p> <p>Contractor: Midwest Drilling, Winnipeg, Manitoba</p> <p>Core is being stored on the property.</p> <p style="text-align: right;"><i>R.B.B.-S</i> 26/9/86</p>

OVERBURDEN DRILLING

Location: 5+00S/7+00E Logged by: RB/DFB Hole No.: OrB-9

Started: February 14, 1986 Finished: February 14, 1986 Sheet No.: 1

Property: King Bay (PM 520)

Description: Grain size and texture of matrix (clay, sandy, silty) sorting. Colour. Structure (bedded, compact). Pebble size range, angularity. Pebble lithology with estimated percentages. HCL reaction.

FROM (feet)	TO		DESCRIPTION
0.0	67.0	67.0	Water
67.0	72.0	5.0	Lacustrine Clay Brown-grey, clay-silt, plastic to gel-like.
72.0	74.5	2.5	Medium grey, sandy-silt, gel-like, poorly sorted and moderately worked. Reworked till
74.5	86.5	12.0	Medium grey cobbly to silty till, loose to consolidated with the loose material consisting of pebbles to cobbles. This loose material is probably the result of poor recover of the fines and sands. Poorly sorted and worked, angular to subangular clasts, poly lithic with qtz-feldspar porphyry, mafic volcanic and granitoid clasts. [Till core was lost from core tube as it was pulled. It was redrilled and sampled, so that sample is mixed up and fines lost].
			Basal Till 80% recovery
86.5	93.0	6.5	<u>QTZ FELDSPAR PORPHYRY</u> Extremely broken up core resembling gravel and cobble size. The porphyry has been moderately altered with saussuritization and k-feldspar replacement (hematization?) of feldspars. Also found are microfractures less than 2mm in width which are siliceous.

PATRICIA MINING DIV.  
 RECEIVED  
 SEP 2 1986  
 A.S.  
 10 11 12 13 14

OVERBURDEN DRILLING.

Location: 5+00S/7+00E Logged by: RB/DFB Hole No.: OKB-9

Started: February 14, 1986 Finished: February 14, 1986 Sheet No.: 2

Property: King Bay (PN 520)

Description: Grain size and texture of matrix (clay, sandy, silty) sorting.  
 Colour. Structure (bedded, compact). Pebble size range, angularity  
 Pebble lithology with estimated percentages. HCL reaction.

FROM (feet)	TO	DESCRIPTION
	93.0	<p><u>END OF HOLE</u></p> <p>Contractor: Midwest Drilling, Winnipeg, Manitoba</p> <p>Core is being stored on the property.</p> <p style="text-align: right;"><i>RB</i> 26/4/86</p>

OVERBURDEN DRILLING

Location: 5+00S/6+00E Logged by: D.F. Bosowec Hole No.: OKB-10

Started: February 14, 1986 Finished: February 14, 1986 Sheet No.: 1

Property: King Bay (PN 520)

Description: Grain size and texture of matrix (clay, sandy, silty) sorting.  
 Colour. Structure (bedded, compact). Pebble size range, angularity.  
 Pebble lithology with estimated percentages. HCL reaction.

FROM (feet)	TO		DESCRIPTION
0.0	80.0	80.0	Water depth (Possible poor recovery of day)
80.0	86.0	6.0	Brownish grey clay, plastic to gel-like, organic rich? Fresh water clay/Lacustrine clay.
86.0	90.2	4.2	Medium grey, the unit grades from a sandy clay to silty coarse grain sand down hole, angular to subrounded grains, polyolithic composition.  Reworked Till  Close to 100% recovery.
90.2	93.2	3.0	Medium grey cobbly to silty till, moderately consolidated, poorly sorted and worked, angular to subrounded, polyolithic with qtz-feldspar porphyry, mafic volcanic, granitoid and limestone. HCL reaction.  92.2-93.2 gravelly, coarse grain sand, poorly recovery of the fines.  95% recovery Basal Till
93.2	94.0	0.8	Rock flour and fragments of qtz-feldspar porphyry. Result of dry coring.
94.0	100.0	6.0	<u>QTZ-FELDSPAR PORPHYRY</u>  Extremely broken core. Weak saussuritization and k-feldspar (hematite?) replacement of feldspars.  Close to 100% recovery.
	100.0		<u>END OF HOLE</u> Contractor: Midwest Drilling, Winnipeg, Manitoba Core is being stored on the property.

RECEIVED  
 SEP 30 1986  
 A.T.  
 10 11 11 11 2 3 4 5 6

DR

*RB*  
 26/9/86

OVERBURDEN DRILLING

Location: 5+00S/5+00E Logged by: D.F. Bosowec Hole No.: OKB-11

Started: February 15, 1986 Finished: February 15, 1986 Sheet No.: 1

Property: King Bay (PN 520)

Description: Grain size and texture of matrix (clay, sandy, silty) sorting.  
Colour. Structure (bedded, compact). Pebble size range, angularity.  
Pebble lithology with estimated percentages. HCL reaction.

FROM (feet) TO			DESCRIPTION
0.0	75.0	75.0	Water depth
75.0	83.5	8.5	Dark brown to brownish grey clay, plastic to gel-like, clay becomes greyish down hole, possibly due to decreasing organic content.  Fresh water clay/Lacustrine clay.
83.5	86.6	3.1	Medium grey clay, gel-like, small percentage of sand size fragments (less than 5%).  Lacustrine clay.
86.6	91.0	4.4	Medium grey, gravelly to silty till, the unit grades from a silty-sandy till to gravelly pebbly coarse grain sandy till down hole, poorly sorted and worked, angular to sub-angular, generally monolithic with qtz-feldspar clasts however minor granitoid and mafic volcanic clasts.  Mild HCL reaction.  Close to 100% recovery.  Basal Till
91.0	96.0	5.0	<u>QTZ-FELDSPAR PORPHYRY</u>  Extremely broken core. Moderate saussuritization and k-feldspar replacement of feldspars.  95% recovery
	96.0		<u>END OF HOLE</u>

PATRICIA KINGSON  
RECEIVED  
SEP 3 1986  
AM 10:11:22 PM 10/11/86

Contractor: Midwest Drilling, Winnipeg, Manitoba.  
Core is being stored on the property.

*DFB*  
26/9/86

OVERBURDEN DRILLING

Location: 4+00E/5+00S Logged by: D.F. Bosowec Hole No.: OKB-12

Started: February 15, 1986 Finished: February 15, 1986 Sheet No.: 1

Property: King Bay (PN 520)

Description: Grain size and texture of matrix (clay, sandy, silty) sorting.  
 Colour. Structure (bedded, compact). Pebble size range, angularity.  
 Pebble lithology with estimated percentages. HCL reaction.

FROM (feet)	TO		DESCRIPTION
0.0	77.0	77.0	Water depth
77.0	91.2	14.2	Dark brown to brownish grey clay, plastic to gel-like; clay becomes greyish down hole-decreasing organic content. Fresh water clay/Lacustrine clay.
91.2	98.2	7.0	Medium grey clay, gel-like. Lacustrine clay
98.2	103.0	4.8	Medium grey cobbly to silty till, moderately consolidated, poorly sorted and worked, angular to subrounded, polyolithic with qtz-feldspar porphyry, mafic volcanic + granitoid. Moderate HCL reaction. Basal Till 100% recovery
103.0	108.0	5.0	<u>QTZ-FELDSPAR PORPHYRY</u> Broken core (rubbly), a majority of the feldspar phenocrysts have been altered (stained) a tan brown color. Minor microfractures. 80% recovery, one foot of core not recovered, lost down hole.
	108.0		<u>END OF HOLE</u>

Contractor: Midwest Drilling, Winnipeg, Manitoba.

Core is being stored on the property.

*RBB*  
 26/9/86

RECEIVED  
 SEP 30 1986  
 10 11 12 13 15

OVERBURDEN DRILLING

Location: 0+00/7+00S Logged by: D.F. Bosowec Hole No.: OKB-24

Started: February 16, 1986 Finished: February 17, 1986 Sheet No.: 1

Property: King Bay (PN 520)

Description: Grain size and texture of matrix (clay, sandy, silty) sorting.  
 Colour. Structure (bedded, compact). Pebble size range, angularity.  
 Pebble lithology with estimated percentages. HCl reaction.

FROM (feet)	TO		DESCRIPTION
0.0	83.0	83.0	Water depth
83.0	88.0	5.0	Dark brown clay, plastic to gel-like, organic rich. Fresh water clay/ Lacustrine clay.
88.0	92.0	4.0	Medium grey silty to sandy clay, gel-like, sand content increases down hole (less than 5%). Moderately worked and sorted. Lacustrine Clay
92.0	98.0	6.0	Medium grey sandy to gravelly till, the unit grades from silty sand to pebbly gravel down hole, moderately worked and sorted, angular to subround clasts, polyolithic with qtz-feldspar and intermediate intrusive clasts(?) becoming dominant near the bottom of the unit. Reworked Basal Till 85% Recovery
98.0			<u>BEDROCK</u> No recovery of bedrock, angular fragments at the till. Bedrock surface suggest that the bedrock is either qtz-feldspar porphyry or fine grained intermediate intrusive.
	98.0		<u>END OF HOLE</u> Contractor: Midwest Drilling, Winnipeg, Manitoba Core is being stored on the property.

PATRICIA M. GEA  
 DELETED  
 SEP 30 1986  
 A.M. P.M.  
 10:10 11:23 15:5

*R.B.B.*  
 26/9/86

OVERBURDEN DRILLING

Location: 1+00W/7+00S Logged by: D.F. Bosowec Hole No.: OKB-25

Started: February 17, 1986 Finished: February 17, 1986 Sheet No.: 1

Property: King Bay (PN 520)

Description: Grain size and texture of matrix (clay, sandy, silty) sorting.  
 Colour. Structure (bedded, compact). Pebble size range, angularity.  
 Pebble lithology with estimated percentages. HCL reaction.

FROM (feet) TO			DESCRIPTION
0.0	77.0	77.0	Water depth
77.0	82.0	5.0	Dark brown to brownish grey clay, plastic to gel like, organic rich.  Fresh water clay/Lacustrine clay.  Pillowed mafic volcanics
82.0	87.0	5.0	<u>INTERMEDIATE INTRUSIVE</u>  Greyish green, massive, very fine grained.  Moderate saussuritization.  Minor qtz-carbonate veining. Less than 1% py.  Minor epidote bands which could be pillow margins.  Close to 100% recovery.
	87.0		<u>END OF HOLE</u>  Contractor: Midwest Drilling, Winnipeg, Manitoba  Core is being stored on the property.

*OKB-25*  
*26/9/86*

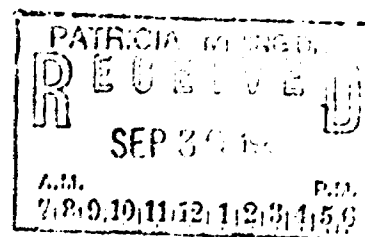



OVERBURDEN DRILLING

Location: 4+00S/4+00E Logged by: R.B. Band Hole No.: OKB-26

Started: February 16, 1986 Finished: February 16, 1986 Sheet No.: 1

Property: King Bay (PN 520)

Description: Grain size and texture of matrix (clay, sandy, silty) sorting.  
 Colour. Structure (bedded, compact). Pebble size range, angularity.  
 Pebble lithology with estimated percentages. HCL reaction.

FROM (feet)	TO		DESCRIPTION
0.0	62.0	62.0	Water
62.0	88.5	6.5	Lacustrine clay Green-brown gel-like clay.
68.5	75.0	6.5	<u>SILT-SAND</u> Medium grey, graded well-sorted sediment. Grading from silt at 68.5 to moderately-well sorted. Silty-sand at base of section unconsolidated. Strong HCL reaction.
75.0	78.0	3.0	Silty-gritty till Unconsolidated, poorly sorted, brownish grey silt-sand-grit, with pebbles subrounded to sub-angular of varying lithologies. One angular blue-grey quartz fragment 1" x 3/4" with chloritic wall-rock Basal layer of rounded 3" cobbles of granite, mafic volcanics.
78.0	79.0	1.0	<u>SILTY-BOULDERY TILL</u> Medium grey moderately consolidated silt-grit-boulder till. Strong HCL reaction. Clasts seem to be mostly angular to subangular, and mafic.
79.0	83.0	4.0	<u>BEDROCK</u> Dark green black, fine-medium grained massive. Massive mafic flow or minor intrusion.

OVERBURDEN DRILLING

Location: 4+00S/4+00E Logged by: R.B. Band Hole No.: OKB-26

Started: February 16, 1986 Finished: February 16, 1986 Sheet No.: 2

Property: King Bay

Description: Grain size and texture of matrix (clay, sandy, silty) sorting.  
 Colour. Structure (bedded, compact). Pebble size range, angularity  
 Pebble lithology with estimated percentages. HCl reaction.

FROM (feet)	TO	DESCRIPTION
	83.0	<p><u>END OF HOLE</u></p> <p>Contractor: Midwest Drilling, Winnipeg, Manitoba</p> <p>Core is being stored on the property.</p> <p><i>R.B. Band</i> 26/9/86</p>

PATRICIA, MANITOBA  
**RECEIVED**  
 SEP 24 1986  
 A.M. P.M.  
 3819 10.11.12.112.3.115.6

OVERBURDEN DRILLING

Location: 2+00S/8+00E Logged by: R.B. Band Hole No.: OKB-27

Started: February 17, 1986 Finished: February 17, 1986 Sheet No.: 1

Property: King Bay (PN 520)

Description: Grain size and texture of matrix (clay, sandy, silty) sorting.  
 Colour. Structure (bedded, compact). Pebble size range, angularity.  
 Pebble lithology with estimated percentages. HCL reaction.

FROM TO (feet)			DESCRIPTION
0.0	7.0	7.0	Water
7.0	9.0	2.0	<u>BROWN LACUSTRINE CLAY</u> Organic-rich, brown gel-like clay.
9.0	20.0	11.0	<u>SILTY PEBBLY TILL</u> Grey, silt-rich pebbly till: plastic in places. Pebbles are multiple lithologies and are generally sub-angular, but include sharply angular FQP. Strong HCL-reaction.
20.0	28.0	8.0	<u>SILTY SANDY TILL</u> Grey, poorly consolidated, moderately sorted. Silty-sand with 10% subangular-subrounded pebbles. Strong HCL reaction.
28.0	33.0	5.0	<u>SILTY-SANDY-PEBBLY TILL</u> Slightly brownish grey, poorly consolidated. 40% pebbles to grit; 60% silty-sandy matrix. Moderate HCL reaction. Occasional sharply angular FQP pebbles. Most pebbles are subangular -subrounded.
33.0	40.0	7.0	<u>BEDROCK</u> Fresh feldspar-quartz porphyry; 30% feldspar, 15% pale blue quartz, medium grained greenish matrix. Cut by dark green black medium grained (1mm) 20% feldspar mafic dyke. Sharp contact preserved.

PATRICIA LANGRISH  
**RECEIVED**  
 SEP 30 1986  
 A.M. P.M.  
 7:00 10:00 11:00 12:00 1:00 2:00 3:00 4:00 5:00 6:00

DR

OVERBURDEN DRILLING

Location: 2+00S/8+00E Logged by: R.B. Band Hole No.: OKB-27

Started: February 17, 1986 Finished: February 17, 1986 Sheet No.: 2

Property: King Bay

Description: Grain size and texture of matrix (clay, sandy, silty) sorting.  
 Colour. Structure (bedded, compact). Pebble size range, angularity.  
 Pebble lithology with estimated percentages. HCL reaction.

FROM	TO (feet)	DESCRIPTION
	40.0	<p><u>END OF HOLE</u></p> <p>Contractor: Midwest Drilling, Winnipeg, Manitoba</p> <p>Core is being stored on the property.</p> <p><i>R.B.B.</i> 26/9/86</p>

OVERBURDEN DRILLING

Location: 7+00E/2+00S Logged by: D.F. Bosowec Hole No.: OKB-28

Started: February 17, 1986 Finished: February 17, 1986 Sheet No.: 1

Property: King Bay (PN 520)

Description: Grain size and texture of matrix (clay, sandy, silty) sorting.  
 Colour. Structure (bedded, compact). Pebble size range, angularity.  
 Pebble lithology with estimated percentages. HCl reaction.

FROM (feet)	TO		DESCRIPTION
0.0	5.0	5.0	Water depth
5.0	8.4	3.4	Brown, gravelly pebbly sand, moderately worked and sorted, angular to subrounded, organic rich, polyolithic.  Reworked Till.
8.4	13.9	5.5	Medium grey, cobbly to pebbly medium coarse grained sand, moderately worked and sorted, angular to subrounded clasts, polyolithic.  Reworked Till
13.9	23.0	9.1	Medium grey, cobbly to silty till, poorly sorted and worked, moderately consolidated, angular to subrounded, polyolithic with the majority of the clasts consisting of qtz-feldspar porphyry and intermediate/mafic volcanics with minor granitoid and limestone. Also present are altered qtz-porphyry clasts (less than 1%).  22.0-23.0 cobbly gravel, the result of poor recovery of fines and sands.  Basal Till  90% Recovery
23.0	27.0	4.0	<u>QTZ-FELDSPAR PORPHYRY</u>  -generally unaltered with minor Potash (K+) replacement of feldspars.
	27.0		<u>END OF HOLE</u>

*R.B. Bosowec*  
26/9/86

Contractor: Midwest Drilling, Winnipeg, Manitoba  
 Core is being stored on the property.

SEP 3 1986  
 AM 10:11  
 PM 12:31

DR

OVERBURDEN DRILLING

Location: 3+00E/3+00S Logged by: D.F. Boswec Hole No.: OKB-30

Started: February 17, 1986 Finished: February 17, 1986 Sheet No.: 1

Property: King Bay (PN 520)

Description: Grain size and texture of matrix (clay, sandy, silty) sorting.  
 Colour. Structure (bedded, compact). Pebble size range, angularity.  
 Pebble lithology with estimated percentages. HCL reaction.

FROM (feet)	TO		DESCRIPTION
0.0	22.0	22.0	Water depth
22.0	25.6	3.6	Medium grey, the unit grades from a silty fine grained sand to cobbly pebbly coarse grained sand down hole, moderately well sorted and worked, angular to subround fragments, polyolithic.  Reworked Till
25.6	43.0	17.4	Dark to medium grey, cobbly to sandy, silt rich till, compact and well consolidated, fissile, poorly worked and sorted, angular to subround clasts, polyolithic with qtz-feldspar porphyry, intermediate-mafic volcanic, granitoid, limestone, k-feldspar and qtz-clasts.  Basal/Subglacial Till  Close to 100% recovery
43.0	47.0	4.0	<u>QTZ-FELDSPAR PORPHYRY</u>  Relatively unaltered with weak Potash replacement in feldspars.
	47.0		<u>END OF HOLE</u>  Contractor: Midwest Drilling, Winnipeg, Manitoba  Core is being stored on the property.

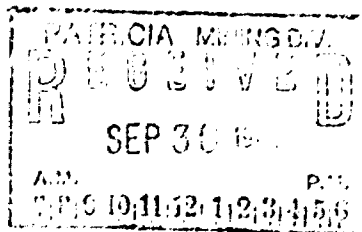

*P.B.S.*  
26/4/86

OVERBURDEN DRILLING

Location: 2+00E/3+00S Logged by: D.F. Bosowec Hole No.: OKB-31

Started: February 18, 1986 Finished: February 18, 1986 Sheet No.: 1

Property: King Bay (PN 520)

Description: Grain size and texture of matrix (clay, sandy, silty) sorting.  
 Colour. Structure (bedded, compact). Pebble size range, angularity.  
 Pebble lithology with estimated percentages. HCL reaction.

FROM (feet) TO			DESCRIPTION
0.0	18.0	18.0	Water depth
18.0	20.7	2.7	Brownish grey clay, gel-like, organic rich. Fresh Water clay/Lacustrine clay
20.7	27.0	6.3	Tannish to medium grey, cobbly to pebbly coarse grained sand, slightly worked and sorted, angular to rounded clasts, polyolithic. Reworked Till
27.0	40.0	13.0	Dark to medium grey, cobbly to sandy, silt rich till, compacted and consolidated, fissile, poorly sorted and worked, angular to subround, polyolithic with qtz-feldspar porphyry, intermediate/mafic volcanic, granitoid, limestone, feldspar and qtz clasts. Basal/subglacial Till Close to 100% recovery
40.0	45.0	5.0	<u>QTZ-FELDSPAR PORPHYRY</u> Relatively unaltered with weak saussuritization of feldspars.
	45.0		<u>END OF HOLE</u> Contractor: Midwest Drilling, Winnipeg, Manitoba Core is being stored on the property.

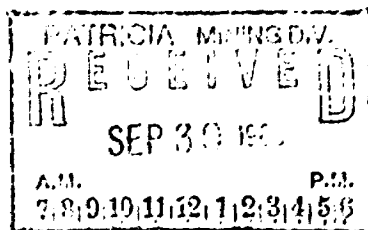

*P.B.B.S.*  
26/9/86

OVERBURDEN DRILLING

Location: 3+00S/1+00E Logged by: R.B. Band Hole No.: OKB-32

Started: February 17, 1986 Finished: February 17, 1986 Sheet No.: 1

Property: King Bay (PN 520)

Description: Grain size and texture of matrix (clay, sandy, silty) sorting.  
 Colour. Structure (bedded, compact). Pebble size range, angularity.  
 Pebble lithology with estimated percentages. HCL reaction.

FROM (feet)	TO		DESCRIPTION
0.0	18.0	18.0	Water
18.0	42.0	24.0	<p><u>SILTY PEBBLY TILL</u></p> <p>Medium grey, silty matrix, 15% pebbles, generally sub-angular to sub-rounded.</p> <p>Generally compact (good tight molds of matrix around pebbles). Strong HCL reaction.</p> <p>Water logged from 18.0 to 25.0</p> <p>From 25.0-42.0 compact and moderately well consolidated.</p> <p>31.0-37.0 Bouldery till layers: boulders sub-rounded and mainly granitoid.</p> <p>37.0-42.0 Low pebble content.</p>
42.0	47.0	5.0	<p><u>BEDROCK</u></p> <p>Fresh feldspar quartz porphyry.</p> <p>30-40% white feldspar - 10-15% pale blue quartz, both to 3 x 10mm.</p> <p>Matrix is fine-grained dark green-black, interstitial to phenocrysts.</p> <p>Large xenolith or dyke of darker grey porphyry with 15% feldspar laths 5% quartz.</p>
	47.0		<p><u>END OF HOLE</u></p> <p>Contractor: Midwest Drilling, Winnipeg, Manitoba</p> <p>Core is being stored on the property.</p>

RECEIVED  
 SEP 10 1986  
 10,11 12 13 14 15 16 17 18 19 20 21 22 23 24 25 26 27 28 29 30 31

*R.B. Band*  
 26/9/86



OVERBURDEN DRILLING

Location: 6+50E/5+00S      Logged by: D.F. Bosowec      Hole No.: OKB-45  
 Started: February 19, 1986      Finished: February 20, 1986      Sheet No.: 1  
 Property: King Bay (PN 520)

Description: Grain size and texture of matrix (clay, sandy, silty) sorting.  
 Colour. Structure (bedded, compact). Pebble size range, angularity.  
 Pebble lithology with estimated percentages. HCL reaction.

FROM (feet)	TO		DESCRIPTION
0.0	76.0	76.0	Water depth
76.0	82.0	6.0	Brownish to medium grey clay, plastic to gel-like; organic rich.  Fresh water clay/Lacustrine clay
82.0	83.0	1.0	Medium grey, cobbly to silty till, loose material, poorly sorted and worked, angular to subrounded, polyolithic with qtz-feldspar porphyry, granitoid and mafic-intermediate metavolcanic clasts. There is also a few pebble size clasts of altered qtz-feldspar porphyr.
83.0	87.0	4.0	Basal Till <u>QTZ-FELDSPAR PORPHYRY</u> Minor saussuritization. Trace py.
	87.0		<u>END OF HOLE</u> Contractor: Midwest Drilling, Winnipeg, Manitoba Core is being stored on the property.

*P.B.S.*  
26/9/86

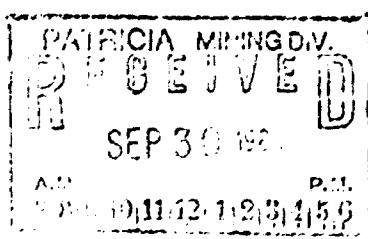

OVERBURDEN DRILLING

Location: 5+50E/5+00S Logged by: D.F. Bosowec Hole No.: OKB-46

Started: February 20, 1986 Finished: February 20, 1986 Sheet No.: 1

Property: King Bay (PN 520)

Description: Grain size and texture of matrix (clay, sandy, silty) sorting.  
 Colour. Structure (bedded, compact). Pebble size range, angularity.  
 Pebble lithology with estimated percentages. HCl reaction.

FROM (feet)	TO		DESCRIPTION
0.0	85.0	85.0	Water depth
85.0	98.0	13.0	Medium grey, cobbly to pebbly, sand rich silt till, consolidated, slightly worked and sorted, angular to sub-rounded, polyolithic with qtz-feldspar porphyry, intermediate, mafic metavolcanics, granitoid, limestone and pyroclastic clasts.  Partially Worked Till  100% recovery
98.0	103.0	5.0	<u>QTZ-FELDSPAR PORPHYRY</u>  Moderate saussuritization and Potash replacement of feldspars. Trace py.
	103.0		<u>END OF HOLE</u>  Contractor: Midwest Drilling, Winnipeg, Manitoba  Core is being stored on the property.

*227-1*  
*26/9/86*

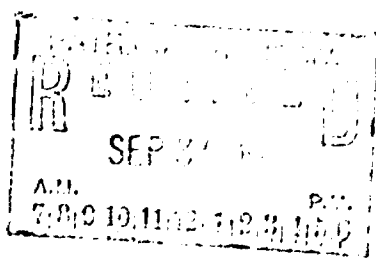

OVERBURDEN DRILLING

Location: 4+50E/5+00S Logged by: D.F. Bosowec Hole No.: OKB-47

Started: February 20, 1986 Finished: February 20, 1986 Sheet No.: 1

Property: King Bay (PN 520)

Description: Grain size and texture of matrix (clay, sandy, silty) sorting.  
 Colour. Structure (bedded, compact). Pebble size range, angularity.  
 Pebble lithology with estimated percentages. HCL reaction.

FROM (feet)	TO		DESCRIPTION
0.0	87.0	87.0	Water depth
87.0	89.1	2.1	Brownish grey clay, gel-like, organic rich. Fresh Water clay/Lacustrine clay
89.1	93.0	3.9	Medium grey, cobbly to silty till, poorly sorted and worked, angular to subrounded, poly lithic with a predominant amount of intermediate-mafic volcanic clasts. 60% Recovery Basal Till/Dry cored bedrock
93.0	96.0	3.0	Bedrock Bedrock core was dropped from tube and re-drilled, so that it is now a mix of subangular pebbles and cobbles. 95% are medium-dark grey, medium grained, moderately magnetic mafic intrusion. 5% are feldspar-quartz-porphyry. Feldspars weakly saussuritized (pale green)/subrounded cobble has 10% feldspar, 5% deep blue quartz eyes in grey matrix.
	96.0		<u>END OF HOLE</u> Contractor: Midwest Drilling, Winnipeg. Manitoba Core is being stored on the property.

PATROL OF CANADA  
 DEPT. OF ENERGY  
 SEP 30 1986  
 A.M. 12:00 P.M. 1:30

*RBB*  
 26/9/86

OVERBURDEN DRILLING

Location: 5+00S/3+00E Logged by: R.B. Band Hole No.: OKB-49

Started: February 20, 1986 Finished: February 20, 1986 Sheet No.: 1

Property: King Bay (PN 520)

Description: Grain size and texture of matrix (clay, sandy, silty) sorting.  
 Colour. Structure (bedded, compact). Pebble size range, angularity.  
 Pebble lithology with estimated percentages. HCL reaction.

FROM (feet)	TO		DESCRIPTION
0.0	77.0	77.0	Water
77.0	90.5	13.5	Lacustrine clay. Brown-green gel-like, organic rich clay.
90.5	99.0	8.5	Silty-sandy pebbly till Grey, silty-fine sand matrix (60-70% silt) poorly compacted, poor-moderate consolidation. Pebbles sub-angular to subrounded. Strong HCL reaction. 92.0-93.0 coarse sand predominantly-reworked till Pebble types: are subangular, include mafic dyke; FQP, with blue qtz-eyes and slight greening of feldspars; granite, mafic volcanics.
99.0	106.0		Bedrock Fresh feldspar-quartz porphyry 40% white feldspars, to 3 x 5mm 15% clear grey glassy quartz phenocrysts Matrix is green grey-looks like chloritised biotite predominantly. Possibly a dyke of grey matrix, blue grey quartz phenocrysts porphyry. Only minor component, possibly a sharp bounded dyke.
	106.0		<u>END OF HOLE</u> Contractor: Midwest Drilling, Winnipeg, Manitoba Core is being stored on the property.

MANITOBA  
 SEP 11 1986  
 A 111 2128

*R.B. Band*

OVERBURDEN DRILLING

Location: 5+00S/2+00E Logged by: R.B. Band Hole No.: OKB-50  
 Started: February 20, 1986 Finished: February 20, 1986 Sheet No.: 1  
 Property: King Bay (PN 520)

Description: Grain size and texture of matrix (clay, sandy, silty) sorting.  
 Colour. Structure (bedded, compact). Pebble size range, angularity.  
 Pebble lithology with estimated percentages. HCL reaction.

FROM (feet)	TO	DESCRIPTION
0.0	75.0	Water
75.0	78.0	Brown-green organic rich gel-like lacustrine clay.
78.0	79.0	Silty-sandy pebbly till
79.0	83.0	<p>Pebble-rich layer, clasts predominantly sub-angular</p> <p>Silty-fine sand</p> <p>Well sorted silty-fine sand occasional coarser grains; but no grit on pebbles.</p> <p>Water logged; no original structure preserved.</p> <p>Moderate HCL reaction.</p>
83.0	99.0	<p><u>BOULDERY SILTY-TILL</u></p> <p>Grey, moderately compacted silty till with 30% cobbles. Pebble clasts leave good moulds. Locally preserved moderately consolidated sections. Moderate HCL reaction.</p> <p>In the basal 4 feet boulders are exclusively feldspar quartz porphyry. Most are fresh; one is weakly altered, with green tinged feldspars blue quartz, matrix is grey-siliceous looking and has fine pyrite film on joints.</p> <p>Large boulders, initially thought to be bedrock.</p>
99.0	104.0	<p>Bedrock</p> <p>Two types:</p> <p>a) sheared feldspar quartz porphyry: chloritic shear planes, green feldspar; matrix grey, looks silicified 1% py on shear planes, trace cpy.</p>

PAIRO...  
 O B...  
 SEP...  
 A.M.  
 1986 10 12 12:12

OVERBURDEN DRILLING

Location: 5+00S/2+00E Logged by: R.B. Band Hole No.: OKB-50

Started: February 20, 1986 Finished: February 20, 1986 Sheet No.: 2

Property: King Bay (PN 520)

Description: Grain size and texture of matrix (clay, sandy, silty) sorting.  
 Colour. Structure (bedded, compact). Pebble size range, angularity.  
 Pebble lithology with estimated percentages. HCL reaction.

FROM (feet)	TO	DESCRIPTION
	104.0	b) Fresh FQP with white feldspars.  <u>END OF HOLE</u>  Contractor: Midwest Drilling, Winnipeg, Manitoba  Core is being stored on the property.  <i>R.B.B.</i> <i>26/2/86</i>

OVERBURDEN DRILLING

Location: 6+50E/4+00S Logged by: D.F. Bosowec Hole No.: OKB-52

Started: February 20, 1986 Finished: February 20, 1986 Sheet No.: 1

Property: King Bay (PN 520)

Description: Grain size and texture of matrix (clay, sandy, silty) sorting.  
 Colour. Structure (bedded, compact). Pebble size range, angularity.  
 Pebble lithology with estimated percentages. HCL reaction.

FROM (feet)	TO		DESCRIPTION
0.0	58.0	58.0	Water depth
58.0	62.5	4.5	Dark brown clay, gel-like, organic rich. Fresh Water clay/Lacustrine clay
62.5	75.0	12.5	Medium grey, cobbly to silty till, with silt content increasing down hole, poorly to slightly sorted and worked, compact and consolidated, angular to subrounded, polyolithic with qtz-feldspar porphyry, intermediate mafic volcanic, granitoid, limestone and chert clasts. Close to 100% recovery Partially worked Basal Till
75.0	80.0	5.0	<u>QTZ-FELDSPAR PORPHYRY</u> Unaltered feldspars. Trace pyrite.
	80.0		<u>END OF HOLE</u> Contractor: Midwest Drilling, Winnipeg, Manitoba Core is being stored on the property.

*RBB-l*  
*26/9/86*

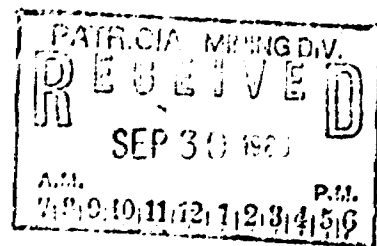

OVERBURDEN DRILLING

Location: 7+50E/4+00S Logged by: D.F. Bosowec Hole No.: OKB-53  
 Started: February 20, 1986 Finished: February 20, 1986 Sheet No.: 1  
 Property: King Bay (PN 520)

Description: Grain size and texture of matrix (clay, sandy, silty) sorting.  
 Colour. Structure (bedded, compact). Pebble size range, angularity.  
 Pebble lithology with estimated percentages. HCl reaction.

FROM (feet)	TO		DESCRIPTION
0.0	59.0	59.0	Water depth
59.0	63.5	4.5	Brown to medium grey clay, gel-like, organic rich. Fresh Water Clay/Lacustrine clay
63.5	82.0	18.5	Medium grey, bouldery to silty sand with sand content increasing down hole, consolidated and compact, slightly sorted and worked, angular to subrounded, polyolithic. Reworked Till
82.0	92.0	10.0	Medium to darkish grey, cobbly to sandy silt rich till, compact and consolidated, poorly worked and sorted; angular to subangular. Polyolithic with qtz-feldspar porphyry, granitoid and intermediate-mafic volcanic clasts. Basal Till
92.0	96.0	4.0	<u>QTZ-FELDSPAR PORPHYRY</u> Moderate saussuritization and Potash replacement of feldspars. Trace pyrite. Some of the feldspars also show tannish-brown staining on their crystal surfaces.
	96.0		<u>END OF HOLE</u>

Contractor: Midwest Drilling, Winnipeg, Manitoba  
 Core is being stored on the property.

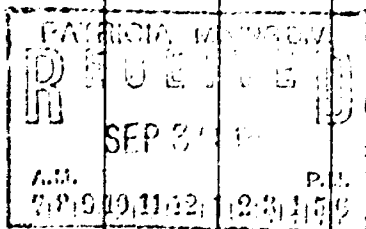

*RBB*  
 26/9/86

OR



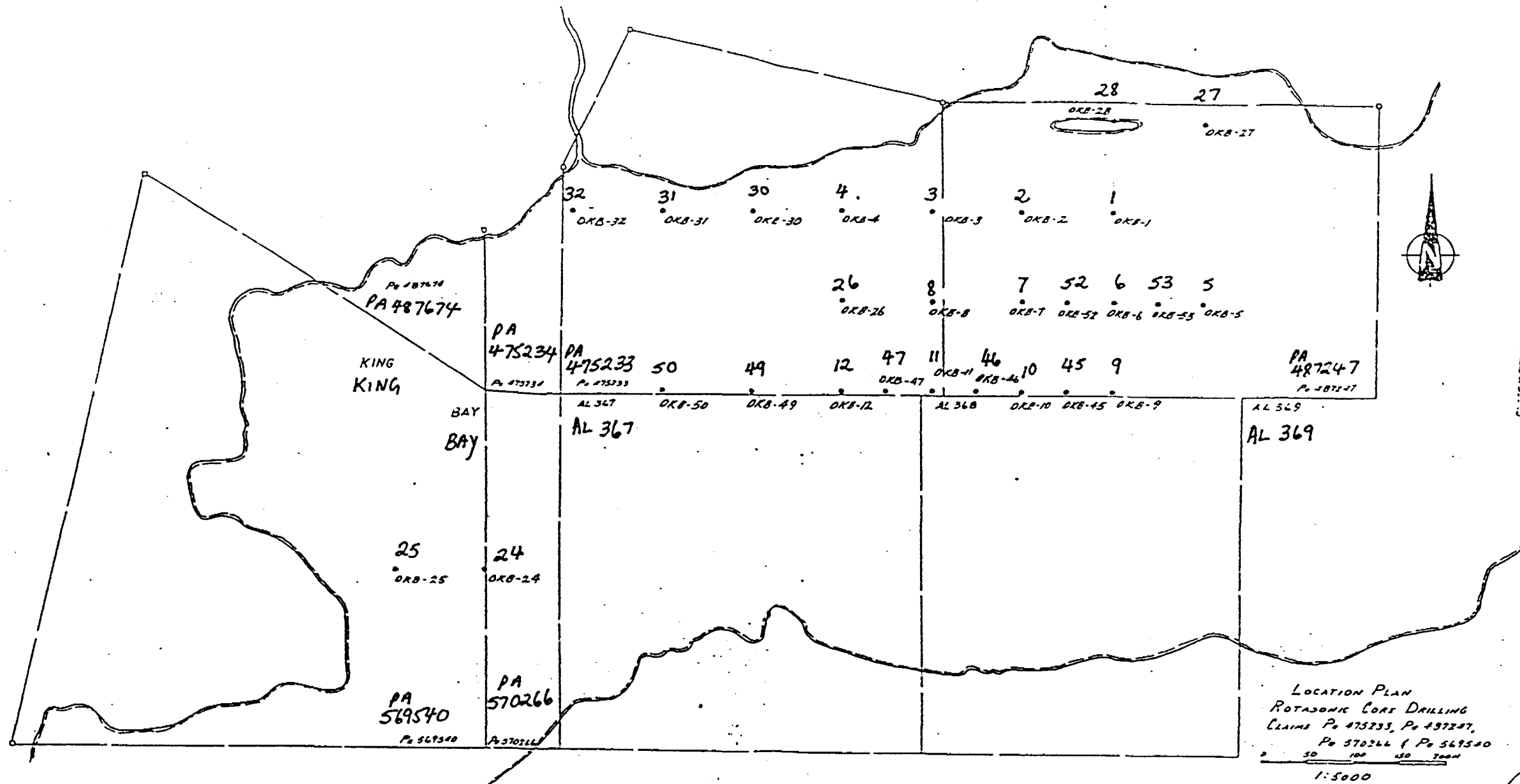

PATRICIA MINING DIV.  
**RECEIVED**  
 SEP 30 1986  
 P.M.  
 10:10, 11:22, 11:31, 11:51

LOCATION PLAN  
 ROTASONIC CORE DRILLING  
 CLAIMS PA 475233, PA 497287,  
 PA 570266 & PA 569540  
 1:5000

LOCATION PLAN  
 ROTASONIC CORE DRILLING  
 CLAIMS PA 475233, PA 487247  
 PA 570366 & PA 569540  
 1:5000  
 200M

*RBB*  
 26/9/86

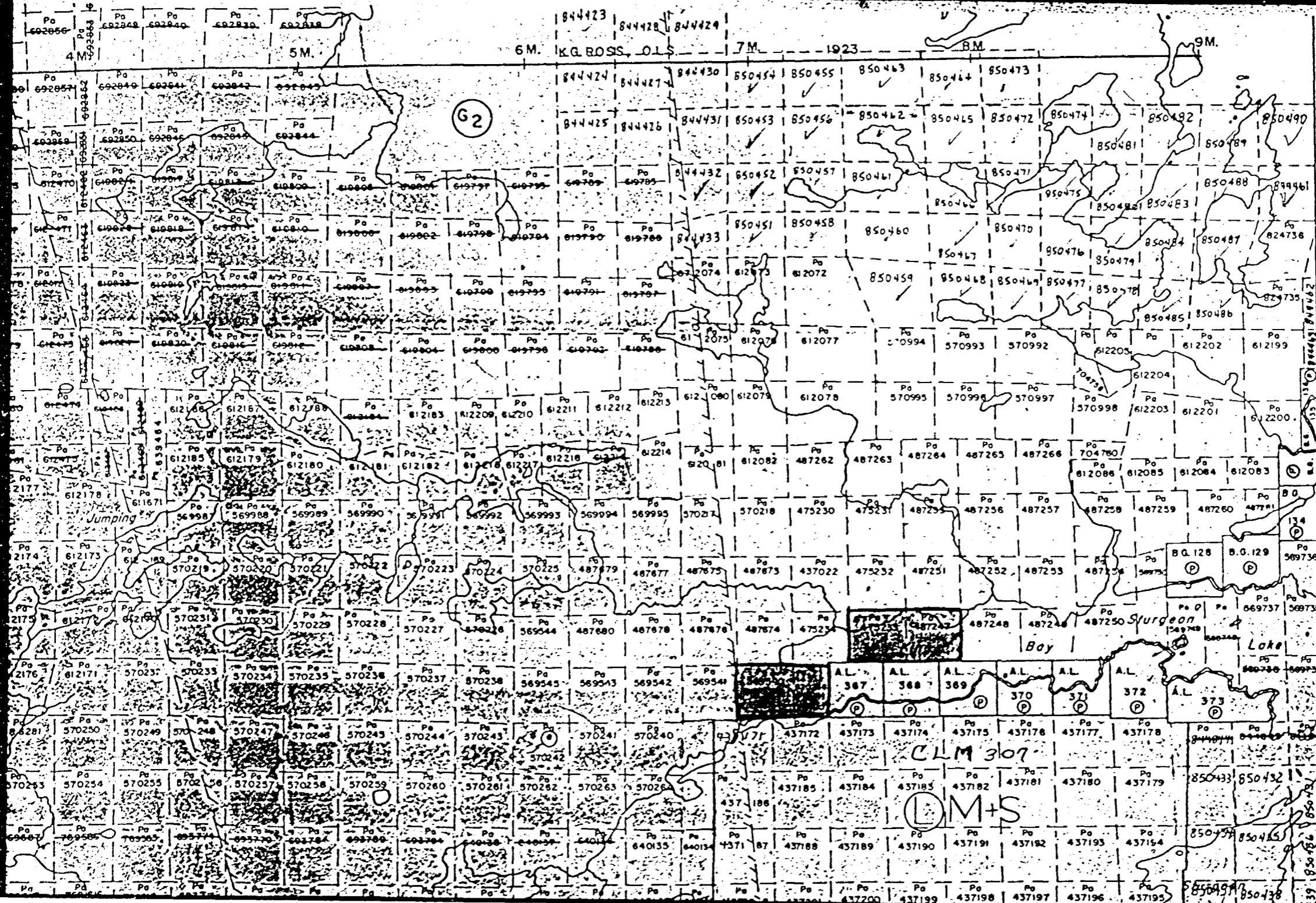

Four Bay  
Lake  
G-2543



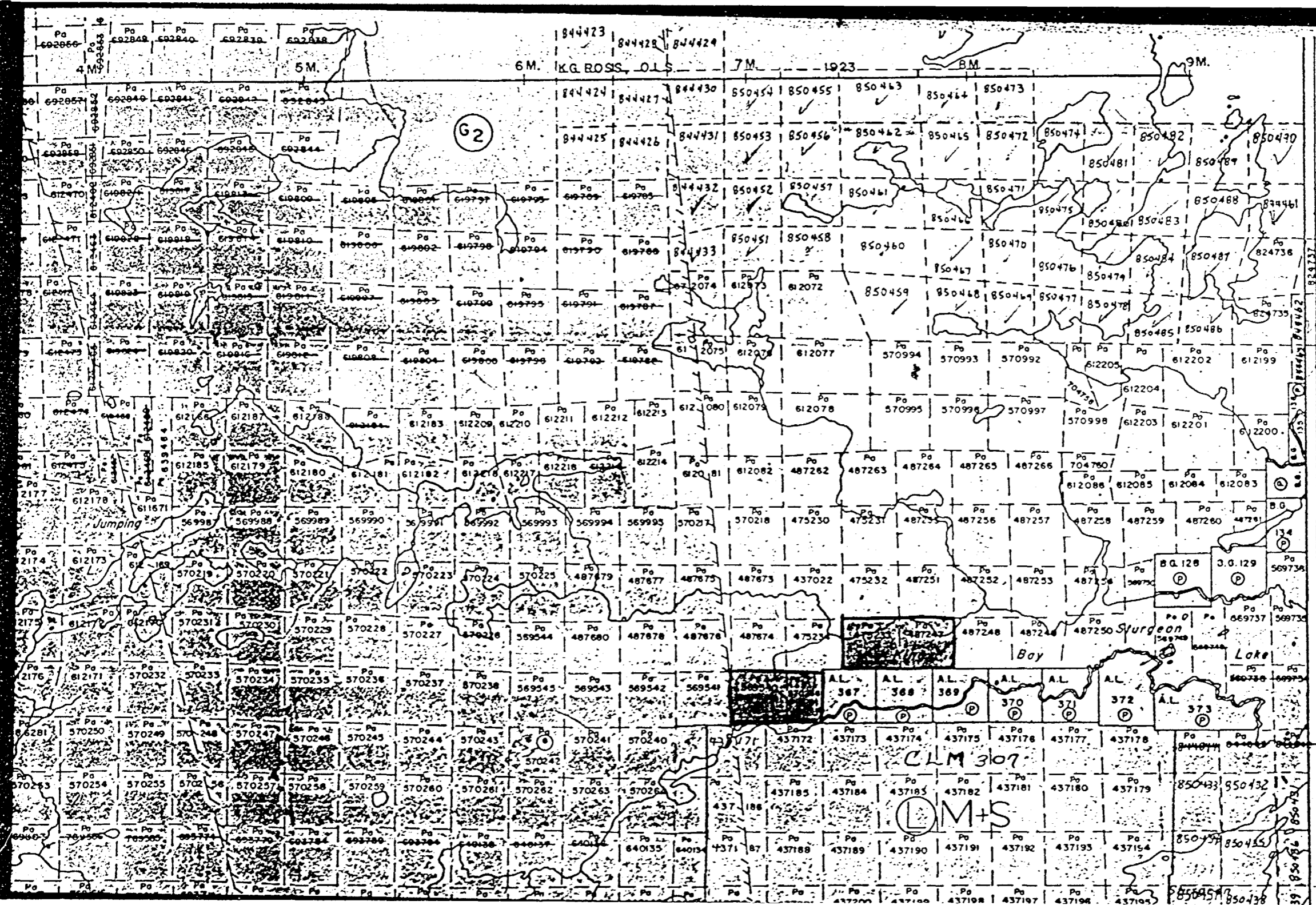

SQUAW LAKE AREA G-3

FOUR BAY LAKE  
G-2543

03'  
02'  
01'

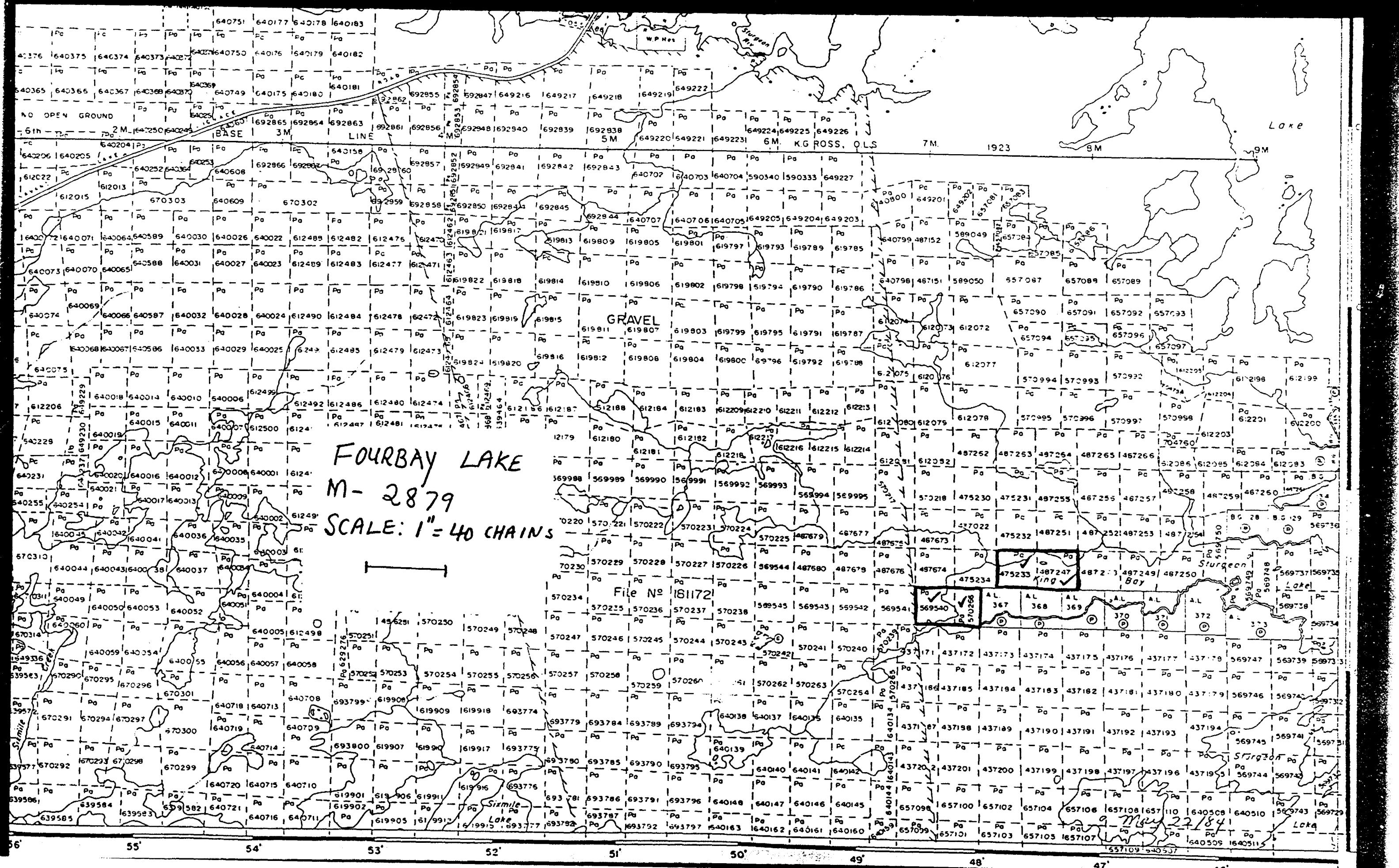

FOURBAY LAKE  
M-2879  
SCALE: 1" = 40 CHAINS

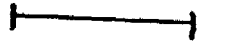

File No 181172

475234 475233 487247 King Bay

9 May 22 184



Ministry of  
Natural  
Resources

*Geo.*  
Report  
of Work

#86-147

Instructions - Supply required data on a separate form for each type of work to be recorded (see table below).  
- For Geo-technical work use form no. 1362 "Report of Work (Geological, Geophysical, Geochemical and Expenditures)".

52 J 102 SW (18) (Mining Act)

Name and Postal Address of Recorded Holder: **Falconbridge Limited**  
 40th Floor, Commerce Court West, Toronto, Ontario M5L 1B4  
 Prospector's Licence No. **63140**  
**A 21647 SQUAW LAKE**  
**TOURBAY LAKE C-2543**

Summary of Work Performance and Distribution of Credits

Total Work Days Cr. claimed	Mining Claim		Work Days Cr.	Mining Claim		Work Days Cr.	Mining Claim		Work Days Cr.
	Prefix	Number		Prefix	Number		Prefix	Number	
670.75 925	See attached list								
For Performance of the following work. (Check one only) <ul style="list-style-type: none"> <li><input type="checkbox"/> Manual Work</li> <li><input type="checkbox"/> Shaft Sinking Drifting or other Lateral Work.</li> <li><input type="checkbox"/> Compressed Air, other Power driven or mechanical equip.</li> <li><input type="checkbox"/> Power Stripping</li> <li><input checked="" type="checkbox"/> Diamond or other Core drilling</li> <li><input type="checkbox"/> Land Survey</li> </ul>									

All the work was performed on Mining Claim(s): Pa 475233, Pa 487247, Pa 570266, Pa 569540

Required Information eg: type of equipment, Names, Addresses, etc. (See Table Below)

Rotasonic core drilling by Midwest Drilling, 180 Cree Crescent, Winnipeg, Manitoba R3J 3W1

Drill program was carried out from February 12 to February 21, 1986.

Core diameter 3 1/2 inch.

All holes were drilled vertically.

21 holes less than or equal to 100 ft, total length 1596 feet equivalent to 399 work days (all holes greater than 25 ft).

5 holes greater than 100 ft, total length 526' giving 526 work days

Total work credit claimed 925.

*TOTAL 925*  
*USING 86-147 885*  
*Bal - 40 days*

*21 - 34 - 2124*

*Pa 475230*

RECEIVED  
SEP 30 1986  
A.M. 7:8:9:10:11:12:1:2:3:4:5:6 P.M.

Date of Report: September 26/86  
Recorded Holder or Agent (Signature): *R.B. Band*

Certification Verifying Report of Work

I hereby certify that I have a personal and intimate knowledge of the facts set forth in the Report of Work annexed hereto, having performed the work or witnessed same during and/or after its completion and the annexed report is true.

Name and Postal Address of Person Certifying: **R.B. Band 100-3074 Portage Avenue, Winnipeg, Manitoba R3K 0Y2**

Date Certified: September 26/86  
Certified by (Signature): *R.B. Band*

Table of Information/Attachments Required by the Mining Recorder

Type of Work	Specific information per type	Other information (Common to 2 or more types)	Attachments
Manual Work	Nil	Names and addresses of men who performed manual work/operated equipment, together with dates and hours of employment.	Work Sketch: these are required to show the location and extent of work in relation to the nearest claim post.
Shaft Sinking, Drifting or other Lateral Work			
Compressed air, other power driven or mechanical equip.	Type of equipment	Names and addresses of owner or operator together with dates when drilling/stripping done.	
Power Stripping	Type of equipment and amount expended. Note: Proof of actual cost must be submitted within 30 days of recording.		
Diamond or other core drilling	Signed core log showing; footage, diameter of core, number and angles of holes.	Nil	Nil
Land Survey	Name and address of Ontario land surveyor.		

#86-147

Instructions - Supply required data on a separate form for each type of work to be recorded (see table below).  
 - For Geo-technical work use form no. 1362 "Report of Work (Geological, Geophysical, Geochemical and Expenditures)".

Mining Act

Name and Postal Address of Recorded Holder: **Falconbridge Limited**  
 40th Floor, Commerce Court West, Toronto, Ontario M5L 1B4  
 Prospector's Licence No. **63140**  
**A 21647 Squaw Lake**  
**TOURBAY LAKE C-2543**

Summary of Work Performance and Distribution of Credits

Total Work Days Cr. claimed	Mining Claim		Work Days Cr.	Mining Claim		Work Days Cr.	Mining Claim		Work Days Cr.
	Prefix	Number		Prefix	Number		Prefix	Number	
<b>670.75 925</b>									
for Performance of the following work. (Check one only)	See attached list								
<input type="checkbox"/> Manual Work									
<input type="checkbox"/> Shaft Sinking Drifting or other Lateral Work.									
<input type="checkbox"/> Compressed Air, other Power driven or mechanical equip.									
<input type="checkbox"/> Power Stripping									
<input checked="" type="checkbox"/> Diamond or other Core drilling									
<input type="checkbox"/> Land Survey									

All the work was performed on Mining Claim(s): **Pa 475233, Pa 487247, Pa 570266, Pa 569540**

Required Information eg: type of equipment, Names, Addresses, etc. (See Table Below)

Rotasonic core drilling by Midwest Drilling, 180 Cree Crescent, Winnipeg, Manitoba R3J 3W1  
 Drill program was carried out from February 12 to February 21, 1986.  
 Core diameter 3 1/2 inch.  
 All holes were drilled vertically.  
 21 holes less than or equal to 100 ft, total length 1596 feet equivalent to 399 work days (all holes greater than 25 ft).  
 5 holes greater than 100 ft, total length 526' giving 526 work days  
 Total work credit claimed 925.

*Handwritten notes:*  
 TOTAL 925  
 Using 86-147 925  
 Balance 45 days

*Stamp:* PATRICIA MINING DIV. RECEIVED SEP 30 1986

*Signature:* R.B. Band

*Date of Report:* September 26/86

Certification Verifying Report of Work

I hereby certify that I have a personal and intimate knowledge of the facts set forth in the Report of Work annexed hereto, having performed the work or witnessed same during and/or after its completion and the annexed report is true.

Name and Postal Address of Person Certifying: **R.B. Band 100-3074 Portage Avenue, Winnipeg, Manitoba R3K 0Y2**

Date Certified: **September 26/86**

Certified by (Signature): *R.B. Band*

Table of Information/Attachments Required by the Mining Recorder

Type of Work	Specific information per type	Other information (Common to 2 or more types)	Attachments
Manual Work	Nil	Names and addresses of men who performed manual work /operated equipment, together with dates and hours of employment.	Work Sketch: these are required to show the location and extent of work in relation to the nearest claim post.
Shaft Sinking, Drifting or other Lateral Work			
Compressed air, other power driven or mechanical equip.	Type of equipment	Names and addresses of owner or operator together with dates when drilling/stripping done.	
Power Stripping	Type of equipment and amount expended. Note: Proof of actual cost must be submitted within 30 days of recording.		
Diamond or other core drilling	Signed core log showing: footage, diameter of core, number and angles of holes.	Nil	Work Sketch (as above) in duplicate
Land Survey	Name and address of Ontario land surveyor.		Nil

LIST OF CLAIMS AND WORK DAYS CREDIT

Claim Number	No. of Days	Claim Number	No. of Days
Pa. 844432	5	Pa. 850468	20
Pa. 844433	20	Pa. 850469	20
Pa. 844461	20	Pa. 850470	20
Pa. 844462	20	Pa. 850471	20
Pa. 844463	20	Pa. 850472	20
Pa. 844464	20	Pa. 850473	20
Pa. 844465	20	Pa. 850474	20
Pa. 850451	20	Pa. 850475	20
Pa. 850452	20	Pa. 850476	20
Pa. 850453	20	Pa. 850477	20
Pa. 850454	20	Pa. 850478	20
Pa. 850455	20	Pa. 850479	20
Pa. 850456	20	Pa. 850480	20
Pa. 850457	20	Pa. 850481	20
Pa. 850458	20	Pa. 850482	20
Pa. 850459	20	Pa. 850483	20
Pa. 850460	20	Pa. 850484	20
Pa. 850461	20	Pa. 850485	20
Pa. 850462	20	Pa. 850486	20
Pa. 850463	20	Pa. 850487	20
Pa. 850464	20	Pa. 850488	20
Pa. 850465	20	Pa. 850489	20
Pa. 850466	20	Pa. 850490	20
Pa. 850467	20		

