

52J025W0108 52J025W0020 FOURBAY LAKE

010

### Diamond Drilling

Area of Fourbay Lake

Report NQ 16

Work performed by: Harry Cravit (Giant Sturgeon Mg. Corp.)

| Claim NQ     | Hole NQ     | Footage       | Date   | Note    |
|--------------|-------------|---------------|--------|---------|
| Pa. 250064   | G.S.-1      | 500'          | Dec/70 | (1) (2) |
| <i>TOTAL</i> | <u>1 DH</u> | <u>500 FT</u> |        |         |

#### Notes:

- (1) 85/71 Work filed twice by mistake
- (2) 400/71 " " " " " " autopositive enclosed

# DIAMOND DRILL RECORD

PROPERTY GIANT STURGEON MINING CORP. LTD.

LOCATION Fourbay Lake Area, Ont.  
(Sturgeon Lake)

Latitude 300 feet south and 50 feet  
east No. 4 post claim

Departure PA-250064

Elevation

Started: Dec. 9, 1970

Completed: Dec. 20, 1970

Dip tests:

HOLE No. G.S.-1

Bearing: 360 degrees

Dip: -45°

Length: 500.0 feet

Logged by: J.D. McCannell

| Footage               | Description   | Sample | Footage | Width | Assays |
|-----------------------|---|--------|---------|-------|--------|
| 0.0- 3.0<br>3.0-211.4 | CASING<br>LAVA - rhyolite, fine grained dark coloured, very hard and massive with some short sections of greyish coloured dacite. Minor amounts of pyrite, pyrrhotite and chalcopyrite throughout and occasional thin seam of massive sulphides. Scattered quartz seams and stringers. 106.2-108.0 considerable pyrrhotite and pyrite with minor chalcopyrite<br>175.5-199.4 sheared at about 60° to core, some development of sericite, rock fairly well bleached and altered with considerable pyrrhotite, pyrite and minor chalco. |        |         |       |        |
| 211.4-217.2           | LAVA - dacite, greyish coloured, fine grained medium hard with minor disseminated sulphides largely pyrrhotite  |        |         |       |        |
| 217.2-223.3           | PORPHYRY - rhyolite porphyry, coarse to medium grained very hard and siliceous with disseminated coarse pyrite and pyrrhotite with minor chalcopyrite. Considerable hematite discolouration.  |        |         |       |        |
| 223.3-227.5           | LAVA - dacite fine grained minor sulphides  |        |         |       |        |
| 227.5-229.3           | PORPHYRY - rhyolite medium grained some sulphides with hematite alteration  |        |         |       |        |
| 229.3-260.5           | LAVA - dacite greyish coloured and fine grained<br>233.5-236.3 much silicification and epidote<br>238.2-239.7 " " " "<br>241.2-246.0 " " " " some sulphides   |        |         |       |        |
| 260.5-466.5           | LAVA - rhyolite, medium grained to fine grained dark coloured very hard and massive with minor scattered disseminations of pyrrhotite, pyrite and chalcopyrite throughout. Scattered quartz vesicles up to one inch in diameter.  |        |         |       |        |

PATRICIA  
MINING CO.

RECEIVED

NOV - 3 1971

AM 7:28 10/11/19 12:34:58 PM

# DIAMOND DRILL RECORD

PROPERTY Giant Sturgeon Mining Corp. Ltd

HOLE No. G.S.-1

LOCATION

Started:

Bearing:

Latitude

Completed:

Dip:

Departure

Dip tests:

Length: 500.0 feet

Elevation

Logged by:

| Footage     | Description   | Sample | Footage | Width | Assays |
|-------------|---|--------|---------|-------|--------|
|             | 359.4-360.8 almost massive pyrrhotite with some pyrite and chalcopyrite.  |        |         |       |        |
| 466.5-500.0 | PORPHYRY - medium to coarse grained intrusive granite porphyry, greenish white coloured very hard and massive with some scattered coarse pyrite. Rock shows chilled contact with digestion of volcanic rock at 466.5 contact. |        |         |       |        |
|             | Note: last six feet of core lost in hole.   |        |         |       |        |

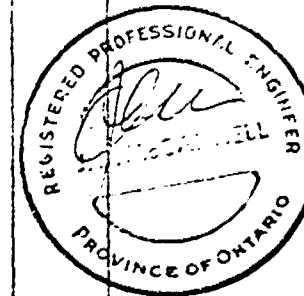
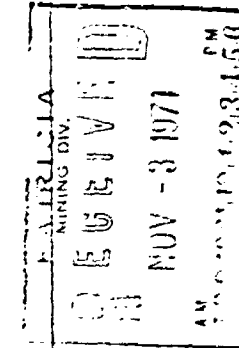

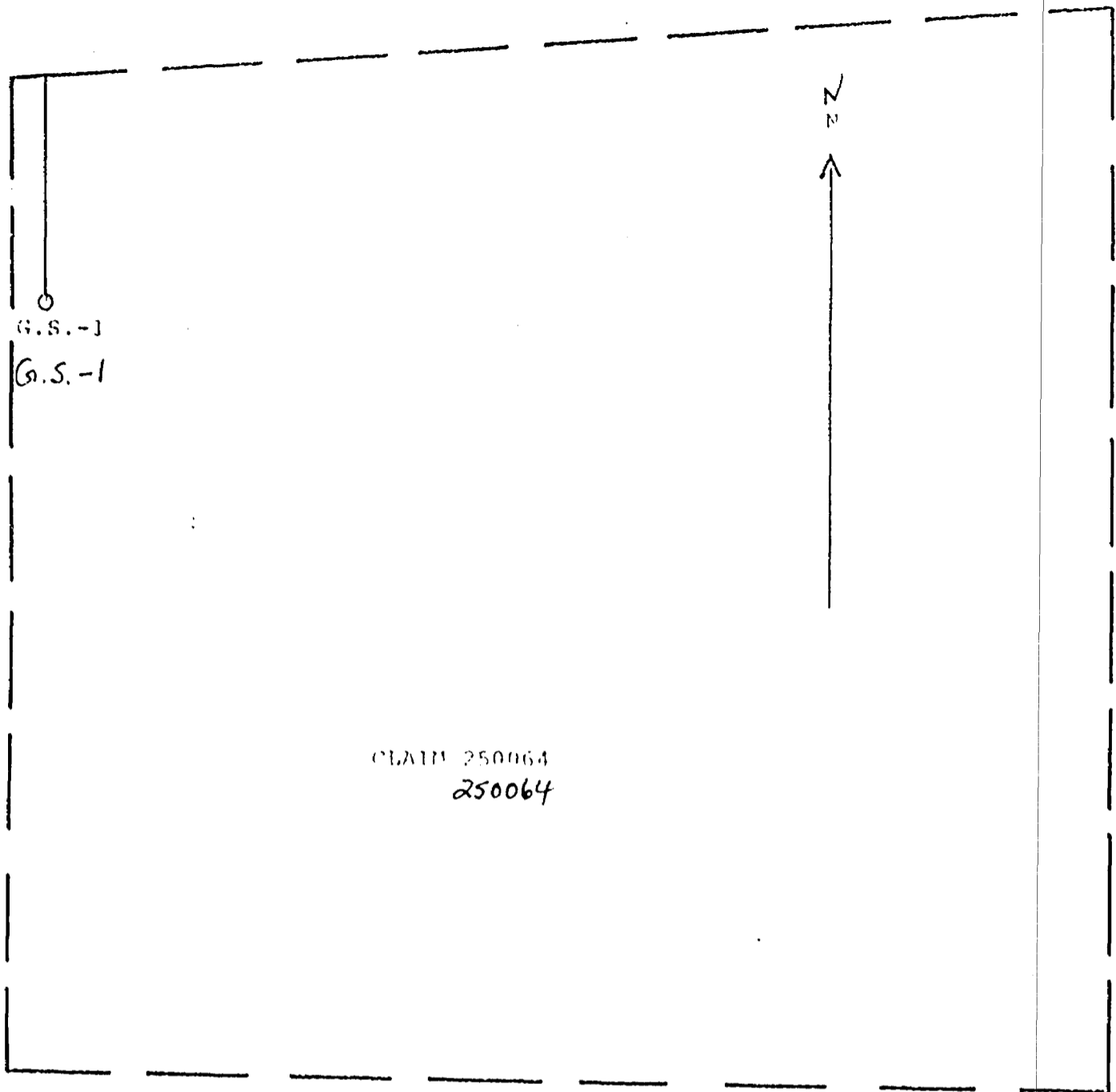

DIAMOND DRILL HOLE LOCATIONS

GIANT STURGEON MINING CORPORATION LIMITED

FOURBAY LAKE AREA

PATRICIA MINING DIVISION

ONTARIO



DIAMOND DRILL HOLE LOCATIONS

GIANT STURGEON MINING CORPORATION LIMITED

FOURBAY LAKE AREA

PATRICIA MINING DIVISION

ONTARIO

AXT core 1 1/4" diam

G.S. - 1

# DIAMOND DRILL RECORD

PROPERTY GIANT STURGEON MINING CORP. LTD.

LOCATION Fourbay Lake Area, Ontario

Claim PA-250064

Latitude 300 feet south No. 4 post  
50 feet east No. 4 Post

Departure

Elevation

Started: December <sup>9</sup>20, 1970

Completed: January <sup>20</sup>26, 1970

Dip tests:

HOLE No. CT

Bearing: 360°

Dip: -45°

Length: 500 feet

Logged by: J. McCannell

| Footage       | Description   | Sample | Footage | Width | Assays |
|---------------|---|--------|---------|-------|--------|
| 0.0 - 5.0     |   |        |         |       |        |
| 5.0 - 468.0   | LAVA - andesite, fine grained massive dark green coloured with occasional narrow quartz stringer. Very minor pirite throughout.<br>217.0-225.0 fine grained rhyolite dike<br>227.5-230.0 fine grained rhyolite dike<br>359.6-361.0 sheared with massive pyrrhotite and some chalcopyrite. |        |         |       |        |
| 468.0 - 500.0 | PORPHYRY - massive quartz porphyry, very siliceous with considerable scattered phenocrysts.   |        |         |       |        |
|               | 500.0 end of hole   |        |         |       |        |

*Preliminary log*  
*J. McCannell*

*J. McCannell*

AXT Core 1 1/4" diam

# DIAMOND DRILL RECORD

PROPERTY GIANT STURGEON MINING CORP. LTD.

HOLE No. G-1

LOCATION Fourbay Lake Area, Ontario Started: December 20, 1970

Bearing: 360°

Claim PA-250064

Latitude 300 feet south No. 4 post Completed: January 16, 1970  
50 feet east No. 4 Post

Dip: -45°

Departure

Length: 500 feet

Elevation

Dip tests:

Logged by: J. McCannell

| Footage       | Description   | Sample | Footage | Width | Assays |
|---------------|---|--------|---------|-------|--------|
| 0.0 - 5.0     |   |        |         |       |        |
| 5.0 - 468.0   | LAVA - andesite, fine grained massive dark green coloured with occasional narrow quartz stringer. Very minor pirite throughout.<br>217.0-225.0 fine grained rhyolite dike<br>227.5-230.0 fine grained rhyolite dike<br>359.6-361.0 sheared with massive pyrrhotite and some chalcopyrite. |        |         |       |        |
| 468.0 - 500.0 | PORPHYRY - massive quartz porphyry, very siliceous with considerable scattered phenocrysts.   |        |         |       |        |
|               | 500.0 end of hole   |        |         |       |        |

PATRICKIA  
 MINING DIV.  
 M. G. B. J. V.  
 APR 14 1971  
 11:00 AM '71

*J. McCannell*

75/11

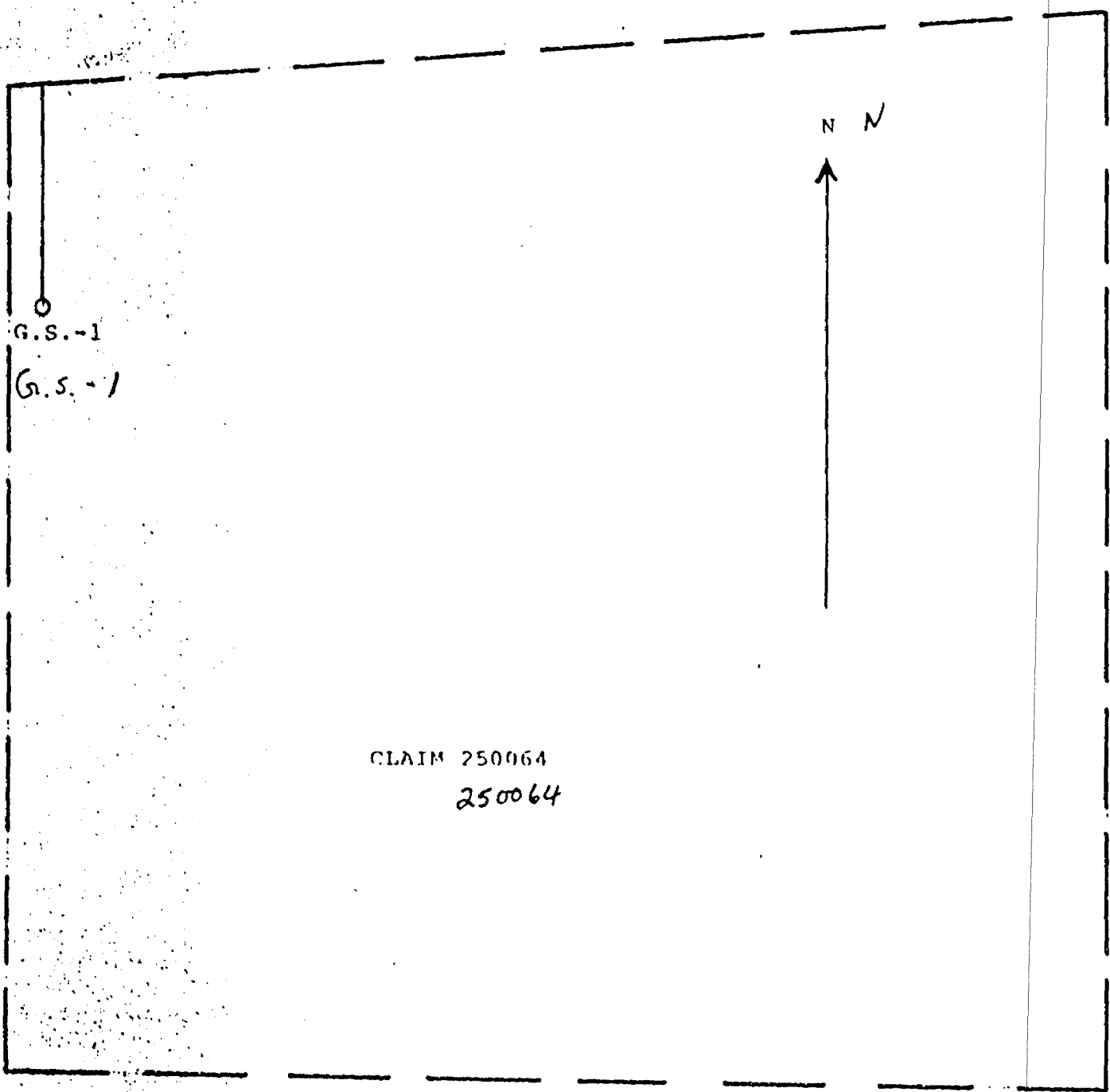

DIAMOND DRILL HOLE LOCATIONS

GIANT STURGEON MINING CORPORATION LIMITED

FOURBAY LAKE AREA

PATRICIA MINING DIVISION

ONTARIO



DIAMOND DRILL HOLE LOCATIONS  
GIANT STURGEON MINING CORPORATION LIMITED

FOURBAY LAKE AREA

PATRICIA MINING DIVISION

ONTARIO

Part of Geophysical  
Survey plan

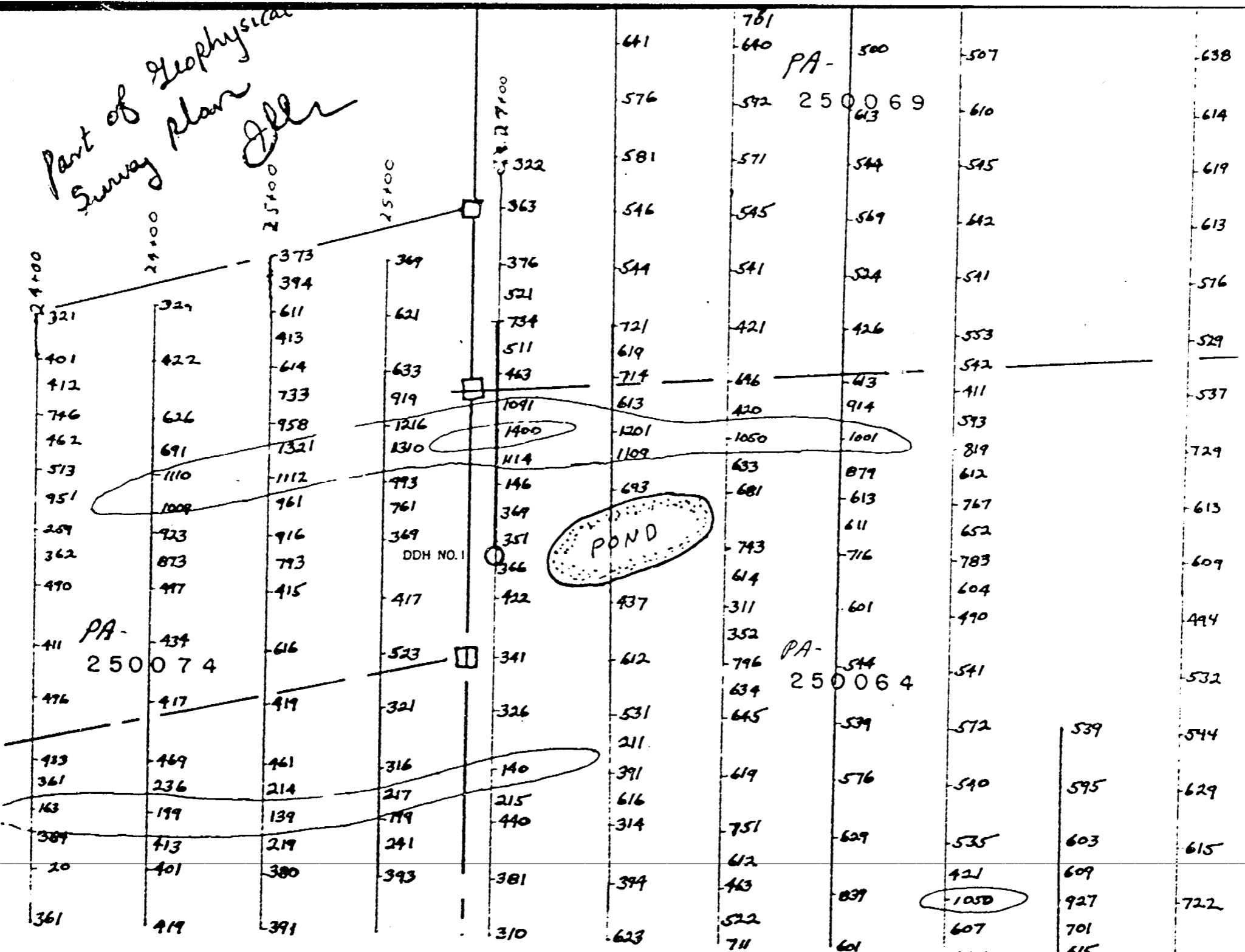



KENORA  
E THUNDER BAY

Fourbay Lake

M-2879

A NIVEN, OLS IM .897

FOURBAY LAKE  
M-2879  
SCALE: 1"=40 CHAINS

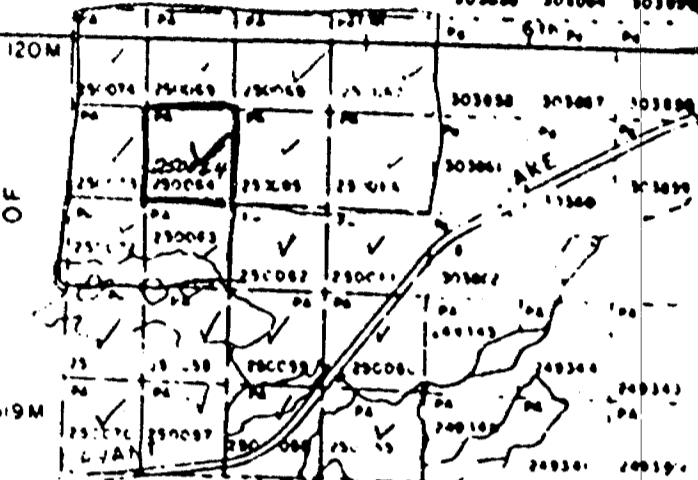

DISTRICT  
OF

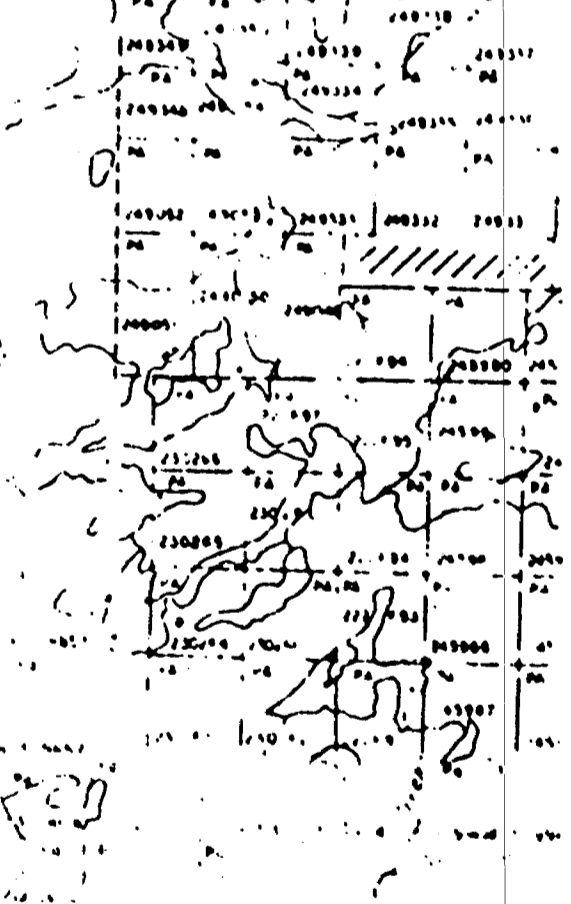
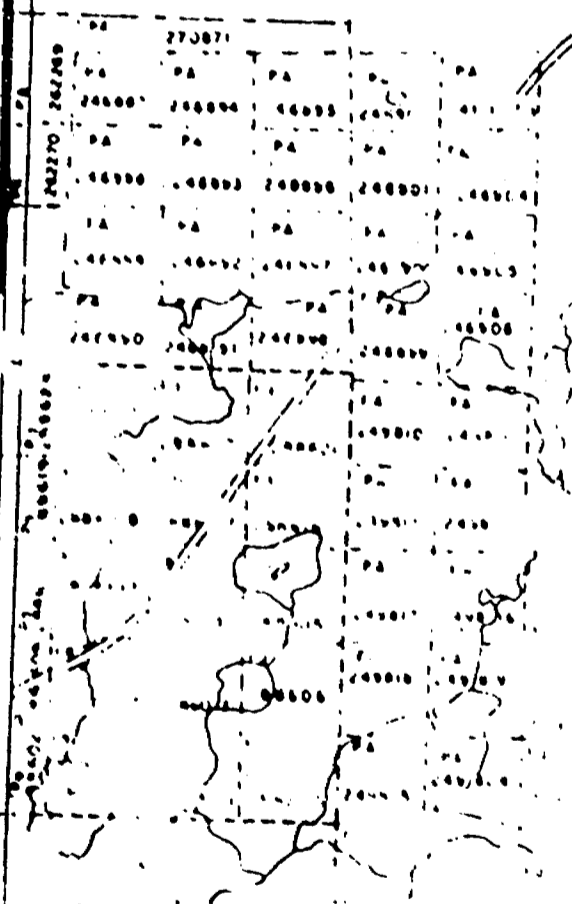





52J02SW0106 52J02SW0020 FOURBAY LAKE

900

FOUR BAY LAKE M-2879

52 J/02SW (13)



ONTARIO

A separate form is required for each type of work to be recorded.

# 400

THE MINING ACT REPORT OF WORK

To the Recorder of Patricia Mining Division

I, Harry Cravit A-36026

name of Recorded Holder Miner's Licence c/o Giant Sturgeon Mining Corp. Ltd. Suite 302, 350 Bay Street, Toronto, Ont

Post Office Address 500

do hereby report the performance of 500 days of diamond drilling type of work

not before reported to be applied on the following contiguous claims

| Claim No. | Days | Claim No. | Days | Claim No. | Days |
|-----------|------|-----------|------|-----------|------|
| 250063    | 50   | 250069    | 50   |           |      |
| 250064    | 50   | 250072    | 50   |           |      |
| 250065    | 50   | 250073    | 50   |           |      |
| 250066    | 50   | 250074    | 50   |           |      |
| 250067    | 50   |           |      |           |      |
| 250068    | 50   |           |      |           |      |

All the work was performed on Mining Claim (s) 250064 (In the case of geological and/or geophysical survey (s) where more than 18 claims are involved attach a schedule)

READ CAREFULLY: THE FOLLOWING INFORMATION IS REQUIRED BY THE MINING RECORDER.

For Manual Work, Stripping or Opening up of Mines, Sinking Shafts or Other Actual Mining Operations - Names and addresses of the men who performed the work and the dates and hours of their employment.

For Diamond and other Core Drilling - Footage, No. and angle of hole and diameter of core. Name and address of owner or operator of drill. Dates when drilling was done. Signed core log and sketch in duplicate.

For Compressed Air or Other Power Driven or Mechanical Equipment

Type of drill or equipment. Names and addresses of men engaged in operating equipment and the dates and hours of their employment.

For Power Stripping - Type of equipment. Name and address of owner or operator. Amount expended. Dates on which work was done. Proof of actual cost must be submitted within 30 days of recording.

With each of the above types of work sketches are required to show the location and extent of the work in relation to the nearest claim post. In the case of diamond or other core drilling the sketch must be submitted in duplicate.

For Geological and Geophysical Survey - The names and addresses of men employed as well as dates. Type of instrument used in the case of geophysical survey. Reports and maps in duplicate must be filed with the Minister within 60 days of recording.

For Land Survey - the name and address of Ontario Land surveyor.

The Required Information is as Follows: (Attach a list if this space is insufficient)

The diamond drilling was carried out during the period Dec. 9 to Dec. 20, 1970 by V.J. Diamond Drilling Company, Wahigoon, Ontario The hole was drilled to a depth of 500 feet at an angle of -45° with AXT equipment which recovered a 1 1/4 inch diameter core.

Date Nov. 1, 1971

Signature of Recorded Holder or Agent

The Mining Act Certificate Verifying Report of Work

I, James D. McCannell Suite 202, 350 Bay Street, Toronto, Ontario (Post Office Address)

hereby certify:

- That I have a personal and intimate knowledge of the facts set forth in the report, having performed the work or witnessed some during and/or after its completion.
- That the annexed report is true.

Dated Nov. 1 19 71

Signature

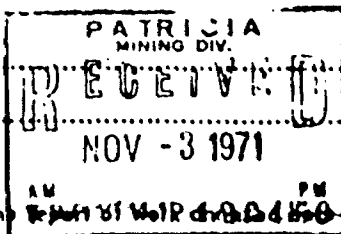

250055

THE PENALTY FOR MAKING A FALSE STATEMENT IN THIS REPORT AND/OR CERTIFICATE IS \$500. OR SIX MONTHS IMPRISONMENT OR BOTH

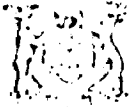

ONTARIO

Ministry  
of Natural  
Resources

Memorandum

To Mr. W. A. Buchan  
Mining Recorder  
Sionx Lookout, Ont.

June 1, 1973

965-6139

From M. Howell  
Research Clerk  
Geological Branch  
Ministry of Natural Resources

Re

I have attached two Report Work forms #85/71 and #400/71 together with the appropriate drill logs. It would seem that the two holes (G.S.-1 and G-1) are the same.

There is a difference in dates, G.S.-1 was drilled Dec. 9 - 20, 1971, G-1 was drilled Dec. 20, 1970 to Jan. 16, 1971. The description of the logs vary some what.

Your assistance in this matter will be greatly appreciated.

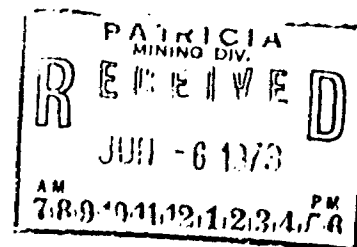

A

Lands Administration Branch  
P.O. Box 669  
Sioux Lookout, Ontario POV 2T0  
June 15, 1973

Mr. James D. McCannell  
Suite 202 - 350 Bay Street  
TORONTO, Ontario

Dear Sir:

Attached herewith two (2) work reports submitted by you on April 14, 1971 and November 3, 1971 together with drill logs and location sketches. It appears that the two holes GS-1 and G1 are one and the same. The location sketches are identical the drill log varies somewhat but the dates differ by a couple of weeks.

Please advise at your earliest convenience if the holes are duplicated or substantiate your reports for the two holes.

Yours truly,

for

J.R. Oatway  
Regional Director

W.A. Buchan:dc  
Mining Recorder  
attach.

c. c. Mr. Harry Cravit  
c/o Giant Sturgeon Mining Corp. Ltd.  
Suite 203 - 350 Bay Street  
Toronto, Ontario

c. c. Mr. M. Howell  
Research Clerk  
Geological Branch  
Ministry of Natural Resources  
Queen's Park  
Toronto, Ontario

JAMES D. MCCANNELL  
CONSULTING GEOLOGIST

TELEPHONE 363-8995  
380 BAY STREET  
TORONTO, ONTARIO, CANADA

June 18, 1973

Mr. J.R. Oatway  
Regional Director  
Lands Administration Branch  
P.O. Box 669  
Sioux Lookout, Ontario

Dear Sir:

In reply to your letter of June 15th, 1973, there appears to have been a duplication of filing diamond drilling for assessment work credits on claims 250063 to 69 inclusive and 250072 to 74 inclusive, all located at Fourbay Lake.

The drill log filed on April 12, 1971, was only a preliminary log made for my own information while the hole was drilling. The hole was later logged in detail and the final log filed for assessment work on November 1st, 1971. At this date I can only assume that the first log was submitted because there was concern that assessment work was required immediately and when I filed the work in November 1971, I had forgotten about the submission of April 12, 1971. The hole was numbered G.S.-1 and the dates of drilling, December 9 to 20, 1970.

Yours very truly,

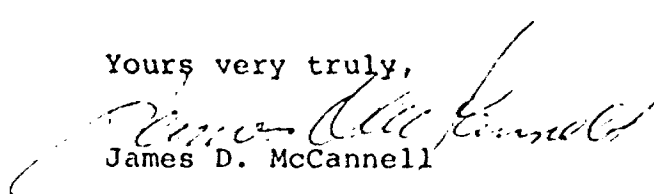
  
James D. McCannell

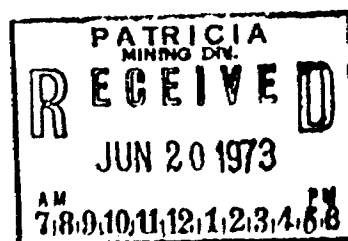

Lands Administration Branch  
P.O. Box 609  
Sioux Lookout, Ontario  
POB 210  
June 20, 1973

Mr. James D. McCannell,  
Consulting Geologist,  
350 Bay Street,  
TORONTO, Ontario.

Dear Sir:

Re: Report of Work - Diamond drilling  
Pa.250063-69 incl., 250072-74 incl.

Please be advised that the assessment work credits for diamond drilling, filed on April 14, 1971 will be deleted from the records of the above listed mining claims as this report has been duplicated.

As mining claim Pa.250072 will be in jeopardy, I will allow you fifteen days to apply for an extension of time.

Yours truly,

for J. R. Catway  
Regional Director

W. A. Buchan  
Mining Recorder

/mj

cc: Mr. Harry Cravit  
c/o Giant Sturgeon Mining Corp. Ltd.,  
203 - 350 Bay Street,  
Toronto, Ontario.

Mr. M. Howell  
Research Clerk, Geological Branch  
Ministry of Natural Resources  
Queen's Park  
Toronto, Ont.



DEPARTMENT OF MINES AND NORTHERN AFFAIRS

IN THE MATTER OF THE MINING ACT

BEFORE THE MINING RECORDER

IN THE MATTER OF: Mining Claims Pa. 250063-69 incl.,  
Pa. 250072-73-74, situate in the  
Fourbay Lake Area, Patricia Mining  
Division.

AND IN THE MATTER OF: Working Conditions, Section 85 of  
The Mining Act.

The above group of claims were recorded on  
November 24th, 1969, and subsequently transferred to Harry  
Cravit, licence #A-36026 on the 3rd of December, 1969.

A geophysical survey was performed and recorded  
on November 13th, 1970, granting 40 days credits per claim.  
This work placed the claims in good standing to and including  
the 24th of November, 1971, subject to approval of the  
geophysical survey. (Section 86, subsection 10) Survey was  
approved excepting Pa. 250072. Credits were cancelled for  
insufficient coverage on April 21, 1971.

Diamond drill credits were recorded on April 14th,  
1971, totalling 500 days credits. Distribution covered the  
shortage of credits on Pa. 250072. A further report of  
diamond drilling was filed on November 3rd, 1971, for additional  
credits totalling 500 days.

WHEREAS - the Research Library of Division of Mines  
questioned the reports due to similarities in  
logs and locations of holes,

AND WHEREAS the consulting geologist J.D. McCannell, has  
confirmed the apparent duplication of reports.

AND WHEREAS the recorded holder H. Cravit having been advised  
of the error, also the reduction of credits which  
would jeopardize the standing of mining claim  
Pa. 250072, the Mining Recorder allowed fifteen  
days after June 20th, 1973, to apply for an  
extension of time. No application for extension  
has been submitted to date.

I HEREBY ORDER - the correct filing of diamond drill credits  
dated November 3rd, 1971, be allowed.

.... 2

250055



IN THE MATTER OF THE MINING ACT

BEFORE THE MINING RECORDER

Pa. 250063 et al

..... 2

I FURTHER ORDER THAT - the preliminary work report filed April 14, 1971, be cancelled from the records. The claim Pa. 250072, being delinquent in work credits as required by Section 85, is hereby cancelled. Relief from forfeiture and extension of time may be obtained through the Mining Commissioner as provided under Section 95 (1-b) of the Mining Act.

Dated at SIOUX LOOKOUT, this 17th day of JULY, 1973.



W.A. Buchan  
Mining Recorder  
Patricia Mining Division

WAB:dc

250055

SEE ACCOMPANYING  
MAP(S) IDENTIFIED AS

52J/02 SW - 0020 # 1

LOCATED IN THE MAP  
CHANNEL IN THE  
FOLLOWING SEQUENCE

(X)

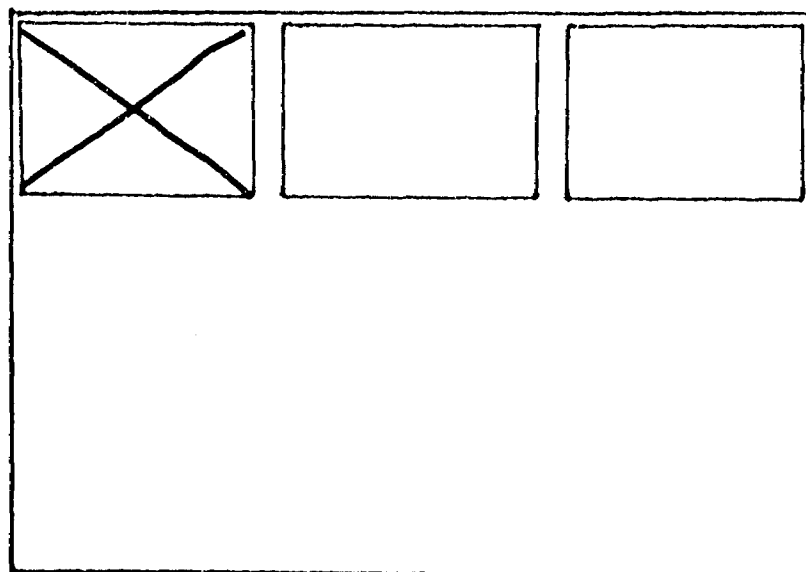

PROPERTY OF  
**GIANT STURGEON MINING CORP. LIMITED**

FOURBAY LAKE AREA

STURGEON LAKE

DISTRICT OF THUNDER BAY

ONTARIO

SCALE 1 INCH = 200 FEET

PATRICIA  
 RECEIVED  
 APR 14 1971  
 10:34 AM

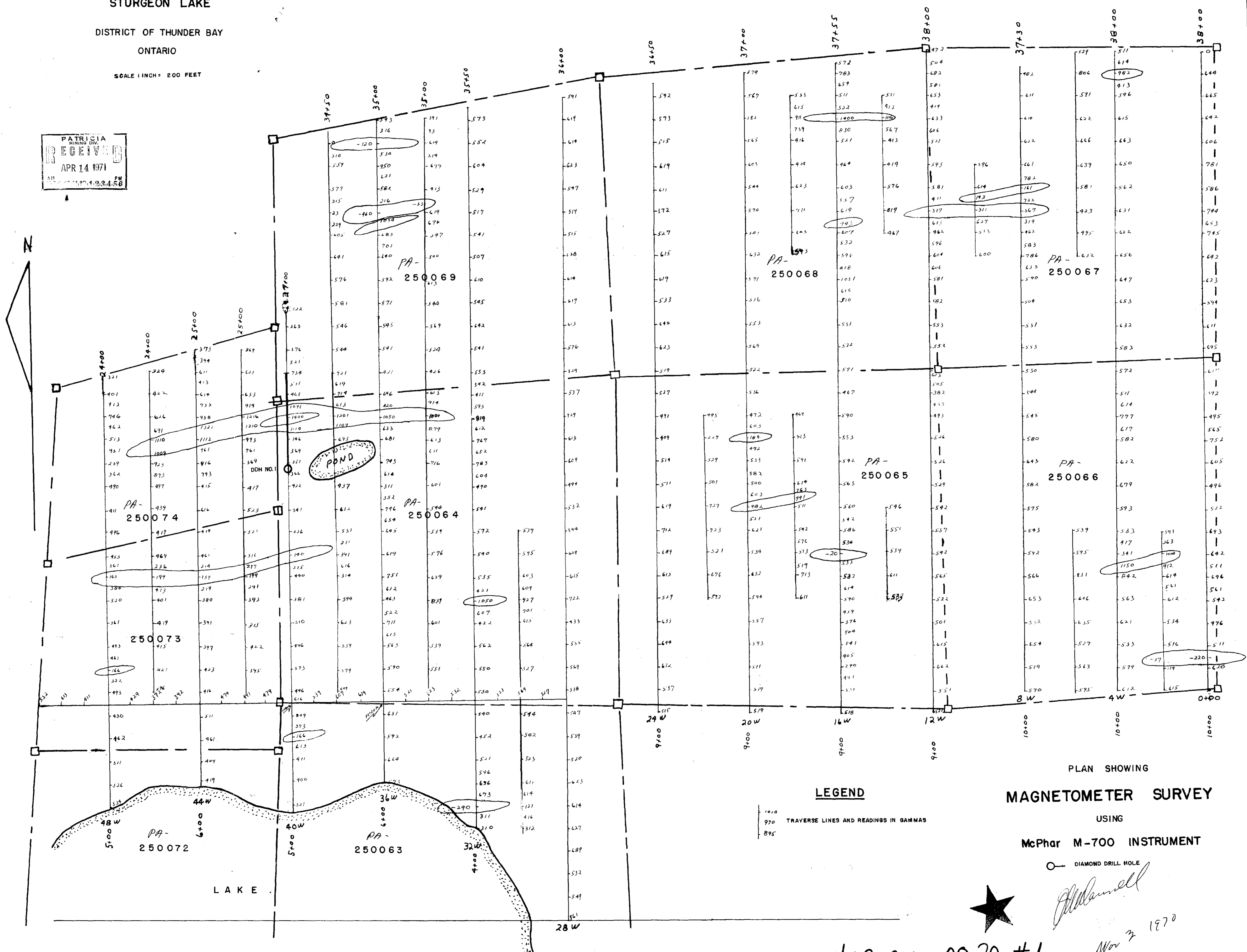

**LEGEND**

1000  
 990 TRAVERSE LINES AND READINGS IN GAMMAS  
 895

PLAN SHOWING  
**MAGNETOMETER SURVEY**

USING  
**McPhar M-700 INSTRUMENT**

DIAMOND DRILL HOLE



*McPhar*

52J/02 SW - 0020 #1

Nov 7 1970

