



52J025W863S 63.4332 FOURBAY LAKE

010

63.4332

This Report consists a  
GEOLOGICAL MAP



52J02SW8635 63.4332 FOURBAY LAKE

300

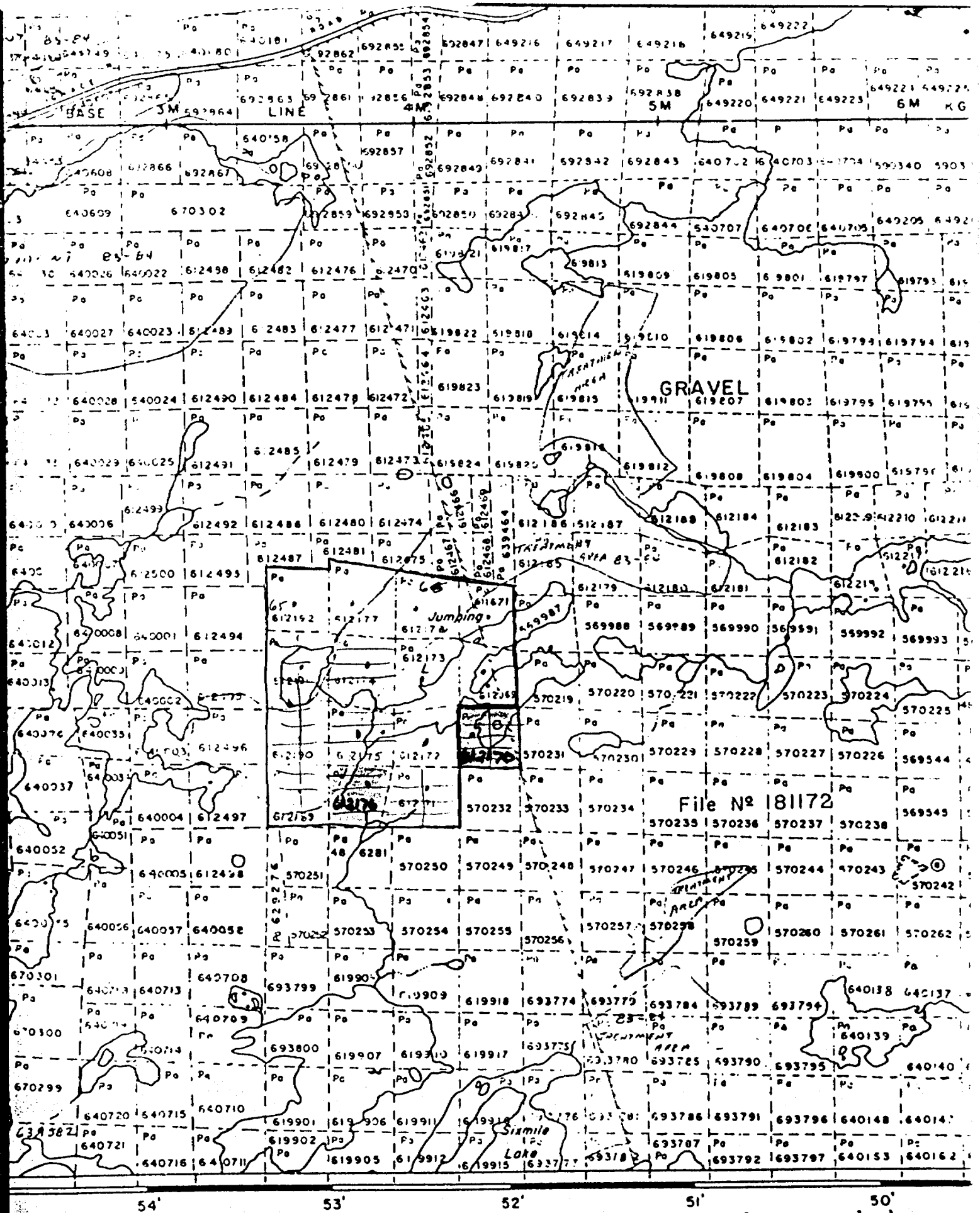

Sixmile Lake Area - M.2877

Fourbay Lake  
M-2879

63.4332



Report of Work

Fourbay Lake M-2879  
#84-4

Instructions - Supply required data on a separate form for each type of work to be recorded (see table below).  
- For Geo-technical work use form no. 1362 "Report of Work (Geological, Geophysical, Geochemical and Expenditures)".

Manual

Assess. Lib.

The Mining Act

Name and Postal Address of Recorded Holder Loydex Resources Inc. 24 Kenton Court, Whitby, Ontario L1N 5X7	Prospector's Licence No. T1293
---	-----------------------------------

Summary of Work Performance and Distribution of Credits

Total Work Days Cr. claimed 17.3 51.9	Mining Claim			Mining Claim			Mining Claim		
	Prefix	Number	Work Days Cr.	Prefix	Number	Work Days Cr.	Prefix	Number	Work Days Cr.
For Performance of the following work. (Check one only) <input checked="" type="checkbox"/> Manual Work <input type="checkbox"/> Shaft Sinking Drifting or other Lateral Work. <input type="checkbox"/> Compressed Air, other Power driven or mechanical equip. <input type="checkbox"/> Power Stripping <input type="checkbox"/> Diamond or other Core drilling <input type="checkbox"/> Land Survey	PA	612189	3.46 1.2	PA	612173	3.46 1.2			
		612190	3.46 1.2		612174	3.46 1.2			
		612191	3.46 1.2		612175	3.46 1.2			
		612192	3.46 1.2		612176	3.46 1.2			
		612169	3.46 1.2		612177	3.46 1.2			
		612170	3.46 1.2		612178	3.46 1.2			
		612171	3.46 1.2		611671	3.46 1.2			
		612172	3.46 1.2						

All the work was performed on Mining Claim(s): PA-612170 and PA-612176

Required Information eg: type of equipment, Names, Addresses, etc. (See Table Below)

C. Buck - General Delivery, Temagami, Ontario  
 C. Debow - 43A Centre Street, Belleville, Ontario  
 P. Hartwick - 34 Chipper Crescent, Scarborough, Ontario

Total - 13 Man-Days x 8 hrs. = 104 hours ÷ 6 = 17.3 Credit Days  
 17.3 x 3 = 51.9

Work Sketch provided in covering report.

*Recorded*  
*Patricia* →

PATRICIA MINING DIV.  
**RECEIVED**  
 JAN 19 1984  
 A.M. P.M.  
 7 8 9 10 11 12 1 2 3 4 5 6

Pa. 611671

Date of Report Nov. 24, 1983	Recorded Holder or Agent (Signature) <i>R. E. Routledge</i>
---------------------------------	--

Certification Verifying Report of Work

I hereby certify that I have a personal and intimate knowledge of the facts set forth in the Report of Work annexed hereto, having performed the work or witnessed same during and/or after its completion and the annexed report is true.

Name and Postal Address of Person Certifying R. E. Routledge, Suite 2302, 401 Bay Street, Toronto, Ontario M5H 2Y4	Date Certified Jan. 9, 1984	Certified by (Signature) <i>R. E. Routledge</i>
--	--------------------------------	--

Table of Information/Attachments Required by the Mining Recorder

Type of Work	Specific Information per type	Other information (Common to 2 or more types)	Attachments
Manual Work	Nil	Names and addresses of men who performed manual work/operated equipment, together with dates and hours of employment.	Work Sketch: these are required to show the location and extent of work in relation to the nearest claim post.
Shaft Sinking, Drifting or other Lateral Work			
Compressed air, other power driven or mechanical equip.	Type of equipment	Names and addresses of owner or operator together with dates when drilling/stripping done.	Work Sketch (as above) in duplicate
Power Stripping	Type of equipment and amount expended. Note: Proof of actual cost must be submitted within 30 days of recording.		
Diamond or other core drilling	Signed core log showing: footage, diameter of core, number and angles of holes.	Nil	Nil
Land Survey	Name and address of Ontario land surveyor.		



Report of Work

Fourbay Lake M-2879  
# 84-5

Instructions - Supply required data on a separate form for each type of work to be recorded (see table below).  
- For Geo-technical work use form no. 1362 "Report of Work (Geological, Geophysical, Geochemical and Expenditures)".

Mechanical

The Mining Act

Name and Postal Address of Recorded Holder Loydex Resources Inc.	Prospector's Licence No. T 1293
24 Kenton Court, Whitby, Ontario L1N 5X7	

Total Work Days Cr. claimed 45.3 90.6	Mining Claim			Mining Claim			Mining Claim		
	Prefix	Number	Work Days Cr.	Prefix	Number	Work Days Cr.	Prefix	Number	Work Days Cr.
for Performance of the following work. (Check one only) <input type="checkbox"/> Manual Work <input type="checkbox"/> Shaft Sinking Drifting or other Lateral Work. <input checked="" type="checkbox"/> Compressed Air, other Power driven or mechanical equip. <input type="checkbox"/> Power Stripping <input type="checkbox"/> Diamond or other Core drilling <input type="checkbox"/> Land Survey	PA	612189	3 6	PA	612173	3 6			
		612190	3 6		612174	3 6			
		612191	3 6		612175	3 6			
		612192	3 6		612176	3 6			
		612169	3 6		612177	3 6			
		612170	3 6		612178	3 6			
		612171	3 6		611671	3 6			
		612172	3 6						

All the work was performed on Mining Claim(s): PA-612170 and PA-612176

Required Information eg: type of equipment, Names, Addresses, etc. (See Table Below)

C. Debow - 43A Centre Street, Belleville, Ontario  
 D. Richardson - 12 Flaremore Crescent, Willowdale, Ontario

Total - 17 Man-Days x 8 hrs. = 136 hrs. ÷ 3 = 45.3 Credit Days  
 July 15th - August 25th, 1983  
 $\frac{136}{3} = 45.3$   
 $\frac{45.3 \times 2}{2} = 90.6$

Equipment - Atlas Copco Super Cobra and 3' Drill Steel.  
 - Prospector Picks.  
 - Shovels and Axes.

Work Sketch - See Report and Maps.

*Recorded*  
*Patricia*

PATRICIA MINING DIV.  
**RECEIVED**  
 JAN 19 1984  
 A.M. P.M.  
 7|8|9|10|11|12|1|2|3|4|5|6

*P. 611671*

Date of Report Nov. 24, 1984	Recorded Holder or Agent (Signature) <i>R.E. Routledge</i>
---------------------------------	---

Certification Verifying Report of Work

I hereby certify that I have a personal and intimate knowledge of the facts set forth in the Report of Work annexed hereto, having performed the work or witnessed same during and/or after its completion and the annexed report is true.

Name and Postal Address of Person Certifying R.E. Routledge, Suite 2302, 401 Bay Street,		
Toronto, Ontario M5H 2Y4	Date Certified Jan. 9, 1984	Certified by (Signature) <i>R.E. Routledge</i>

Table of Information/Attachments Required by the Mining Recorder

Type of Work	Specific information per type	Other information (Common to 2 or more types)	Attachments
Manual Work	Nil	Names and addresses of men who performed manual work/operated equipment, together with dates and hours of employment.	Work Sketch: these are required to show the location and extent of work in relation to the nearest claim post.
Shaft Sinking, Drifting or other Lateral Work			
Compressed air, other power driven or mechanical equip.	Type of equipment	Names and addresses of owner or operator together with dates when drilling/stripping done.	Work Sketch (as above) in duplicate
Power Stripping	Type of equipment and amount expended. Note: Proof of actual cost must be submitted within 30 days of recording.		
Diamond or other core drilling	Signed core log showing: footage, diameter of core, number and angles of holes.		
Land Survey	Name and address of Ontario land surveyor.	Nil	Nil

SEE ACCOMPANYING  
MAP(S) IDENTIFIED AS

52J/02SW-0071-A#1

LOCATED IN THE MAP  
CHANNEL IN THE  
FOLLOWING SEQUENCE

(X)

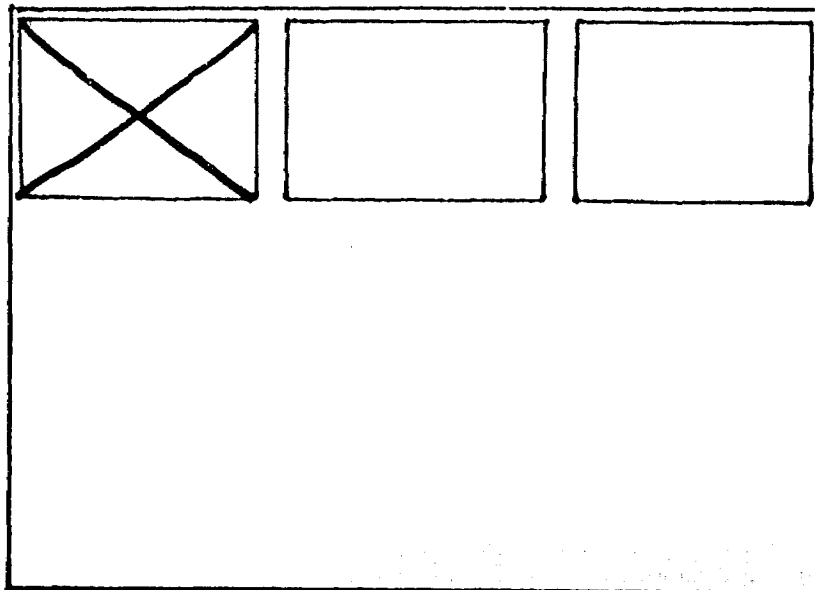

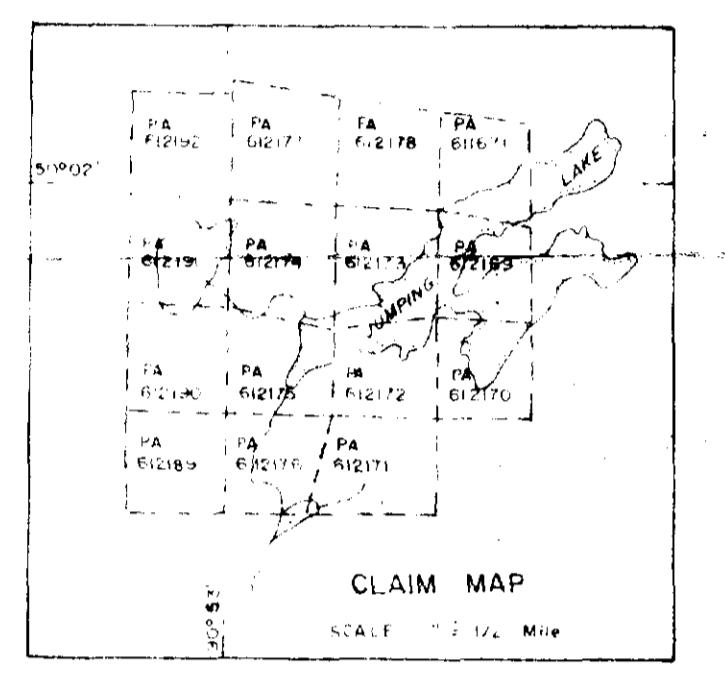
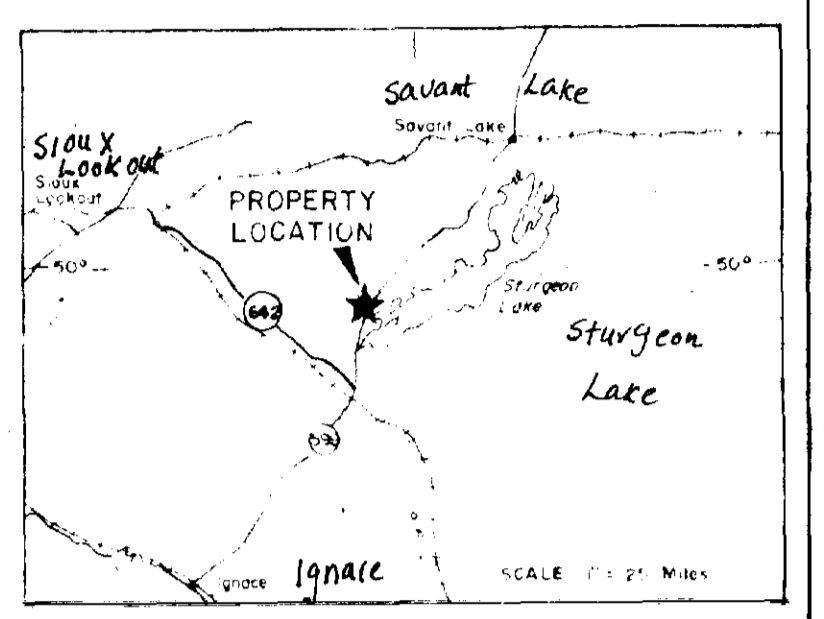
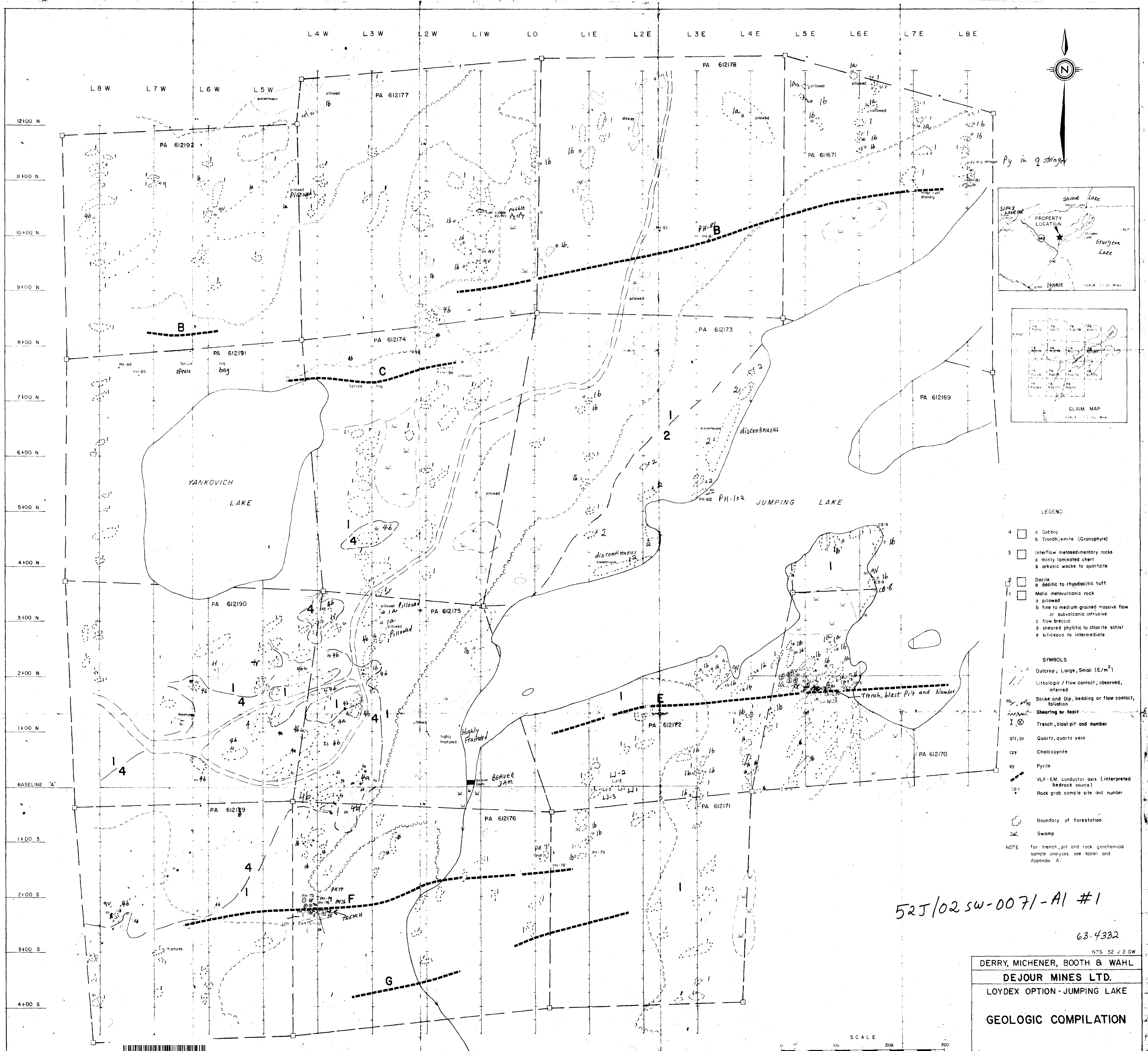

- LEGEND**
- 4  a Gabbro
  - b Trondhjemite (Granophyre)
  - 3  Interflow metasedimentary rocks
    - a thinly laminated chert
    - b arkosic wacke to quartzite
  - 2  Dacite
    - a dacitic to rhyodacitic tuff
  - 1  Mafic metavolcanic rock
    - a pillowed
    - b fine to medium grained massive flow or subvolcanic intrusive
    - c flow breccia
    - d sheared phyllitic to chlorite schist
    - e siliceous to intermediate
- SYMBOLS**
- Outcrop: Large, Small (E/m<sup>2</sup>)
  - Lithologic / flow contact, observed, inferred
  - Strike and Dip, bedding or flow contact, foliation
  - Shearing or fault
  - Trench, blast pit and number
  - qtz, qv Quartz, quartz vein
  - cpy Chalcopyrite
  - py Pyrite
  - VLF-EM conductor axis (interpreted bedrock source)
  - Rock grab sample site and number
  - Boundary of forestation
  - Swamp
- NOTE:** for trench, pit and rock geochemical sample analyses see table and Appendix A.

52J/02 SW-0071-A1 #1

63-4332

NTS 52 J 2 SW

DERRY, MICHENER, BOOTH & WAHL  
 DEJOUR MINES LTD.  
 LOYDEX OPTION - JUMPING LAKE  
 GEOLOGIC COMPILATION

