



52J04NE0011 52J04NE0022A1 SHARRON LAKE

010

# E. M. Survey

Line cutting  
 Workers address Mr. Walter Thompson Mr. Martin Thompson  
38 King St. Lion's Lookout ont POV20

Base

Line cutting	20 Oct	2 Men	12 <sup>hr</sup> ea	24 hrs
Picket line cutting	21 "	" "	" "	24 hrs
Picket line cutting	22 "	" "	" "	24 hrs

Worker Mr. Walter Thompson

E. M. Survey starts	24 Oct	1 man	12 hrs
"	25 Oct	1 man	12 hrs
"	26 Oct	1 man	12 hrs
"	27 Oct	1 man	12 hrs
"	28 Oct	1 man	12 hrs
"	29 Oct	1 man	12 hrs

72

9 days

Stripper, Blasting

Plugging

DEC 28 1983

MINING LAKE

PATRICIA MINING DIV.  
**RECEIVED**  
 DEC 15 1983  
 A.M. P.M.  
 7|8|9|10|11|12|1|2|3|4|5|6



52J04NE0011 52J04NE0022A1 SHARRON LAKE

900



Ministry of Natural Resources  
Ontario F.M.

Report of Work  
(Geophysical, Geological,  
Geochemical and Expenditures)

#83-141

Instructions: - Please type or print.  
- If number of mining claims (if any) exceeds space on this form, attach a list.  
Note: - Only days credits calculated in the "Expenditures" section may be entered in the "Expend. Days Cr." columns.  
- Do not use shaded areas below.

Mining Lands

The Mining Act

Type of Survey(s) <b>Electromagnetic</b>		Township or Area <b>Sharron Lake M-2605</b>	
Claim Holder(s) <b>Mr David F Petruka</b>		Prospector's Licence No. <b>E 25944</b>	
Address <b>208 Huron Crescent, Thunder Bay Ont P7A 3K4</b>			
Survey Company <b>Mr Walter Thompson and Sons</b>	Date of Survey (from & to) <b>20 Day 10 Mo. 83 Yr. 21 Day 10 Mo. 83 Yr.</b>		Total Miles of line Cut <b>2 miles 108 ft</b>
Name and Address of Author (of Geo-Technical report) <b>David F. Petruka, 208 Huron Cresc, Thunder Bay, Ont. P7A 3K4</b>			

Credits Requested per Each Claim in Columns at right

Mining Claims Traversed (List in numerical sequence)

Special Provisions	Geophysical		Days per Claim
	- Electromagnetic, 40		
For first survey: Enter 40 days. (This includes line cutting)	- Magnetometer		
	- Radiometric		
	- Other		
	Geological		
For each additional survey: using the same grid: Enter 20 days (for each)	Geochemical		
	Geophysical		
	- Electromagnetic		
	- Magnetometer		
Man Days Complete reverse side and enter total(s) here	- Radiometric		
	- Other		
	Geological		
	Geochemical		
Airborne Credits Note: Special provisions credits do not apply to Airborne Surveys.	Electromagnetic		
	Magnetometer		
	Radiometric		
	Geophysical		

Mining Claims Traversed			Mining Claims Traversed		
Prefix	Number	Expend. Days Cr.	Prefix	Number	Expend. Days Cr.
Pa.	437105				
	437107				
	437108				

RECEIVED  
DEC 28 1983  
MINING LANDS - S.T.C.

PATRICIA MINING DIV.  
RECEIVED  
DEC 15 1983  
A.M. 7,8,9,10,11,12,1,2,3,4,5,6 P.M.

Expenditures (excludes power stripping)

Type of Work Performed <b>Electromagnetic Survey</b>
Performed on Claim(s) <b>PA 437105 and PA 437108</b>
Calculation of Expenditure Days Credits Total Expenditures <b>\$3000.00</b> ÷ <b>15</b> = <b></b> Total Days Credits

Instructions  
Total Days Credits may be apportioned at the claim holder's choice. Enter number of days credits per claim selected in columns at right.

Date <b>15 Dec 83</b>	Recorded Holder or Agent (Signature) <b>W Thompson</b>
--------------------------	---

Total number of mining claims covered by this report of work. <b>3</b>	
For Office Use Only	
Total Days Cr. Recorded <b>120</b>	Date Recorded <b>Dec. 15, 1983</b>
Date Approved as Recorded	Mining Recorder <b>Sharron</b>
	Branch Director

Certification Verifying Report of Work

I hereby certify that I have a personal and intimate knowledge of the facts set forth in the Report of Work annexed hereto, having performed the work or witnessed same during and/or after its completion and the annexed report is true.

Name and Postal Address of Person Certifying <b>Mr Walter Thompson 38 Kinross St. Thunder Bay, Ont. P7A 3K4</b>	Date Certified	Certified by (Signature) <b>W Thompson</b>
--	----------------	---



Ministry of  
Natural  
Resources

Geotechnical  
Report  
Approval

File  
26214

Mining Lands Comments

- need report.  
- E.M. plan needs profiles.

To: Geophysics Mr. Barlow

Comments

- VLF data not plotted  
- no report  
- key maps needed scales, signatures etc.

Approved  Wish to see again with corrections Date Signature

To: Geology - Expenditures

Comments

Approved  Wish to see again with corrections Date Signature

To: Geochemistry

Comments

LD

Approved  Wish to see again with corrections Date Signature

To: Mining Lands Section, Room 6462, Whitney Block. (Tel: 5-1380)

1984 01 05

Your File: 141

Our File: 2.6214

Mr. Albert Hanson  
Mining Recorder  
Ministry of Natural Resources  
P.O. Box 669  
Sioux Lookout, Ontario  
POV 2T0

Dear Sir:

We have received reports and maps for a Geophysical (Electromagnetic) survey submitted under Special Provisions (credit for Performance and Coverage) on Mining Claims PA 437105 et al in the Area of Sharron Lake.

This material will be examined and assessed and a statement of assessment work credits will be issued.

We do not have a copy of the report of work which is normally filed with you prior to the submission of this technical data. Please forward a copy as soon as possible.

Yours very truly,

J.R. Morton  
Acting Director  
Land Management Branch

Whitney Block, Room 6643  
Queen's Park  
Toronto, Ontario  
M7A 1W3  
Phone: (416) 965-1380

A. Barr:uc

cc: Mr. David F. Petrunka  
208 Huron Crescent  
Thunder Bay, Ontario  
P7A 3K4

May 25, 1984

Our File: 2.6214

Mr. Donald F. Petrunka  
208 Huron Crescent  
Thunder Bay, Ontario  
P7A 3K4

Dear Sir:

RE: Geophysical (Electromagnetic) Survey on Mining  
Claims PA 437105-07-08 in the Sharron Lake Area

---

The report and map which you submitted for the above-described survey are not acceptable in their present form. Enclosed is a copy of the "Requirements for Submitting Geophysical, Geological and Geochemical Survey Reports". The requirements for submitting electromagnetic reports and maps are detailed on pages 1 to 6. Please note particularly that the VLF data is to be profiled. Returned herein are the plans for correction.

If you require further information or clarification when preparing this material, please contact Mr. Ray Pichette, at (416)965-6918.

Yours sincerely,

S.E. Yundt  
Director  
Land Management Branch

Whitney Block, Room 6643  
Queen's Park  
Toronto, Ontario  
M7A 1W3  
Phone: (416)965-6918

S. Hurst:mc

Encl.

July 24, 1984

Your File: 83-141  
Our File : 2.6214

REGISTERED

Donald F. Petrunka  
208 Huron Crescent  
Thunder Bay, Ontario  
P7A 3K4

Dear Sir:

RE: Geophysical (Electromagnetic) Survey submitted  
on Mining Claims PA 437105 et al in the Area  
of Sharron Lake.

---

Enclosed is a copy of our letter dated May 25, 1984 requesting  
additional information for the above mentioned survey.

Unless you can provide the required data by August 3, 1984,  
the mining recorder will be directed to cancel the work  
credits recorded on December 15, 1983.

For further information, please contact Mr. Ray Pichette at  
(416)965-4888.

Yours sincerely,

S.E. Yundt  
Director  
Land Management Branch

Whitney Block, Room 6643  
Queen's Park  
Toronto, Ontario  
M7A 1W3  
Phone:(416)965-6918

S. Hurst:sc

Encl:

cc: Mining Recorder  
Thunder Bay, Ontario

cc: Walter M. Thompson  
38 King Street  
Sioux Lookout, Ontario  
POV 2T0

2.6214

1984 08 27

83-141  
7561.1V2  
2.6214

Albert Hanson  
Mining Recorder  
Ministry of Natural Resources  
P.O. Box 309  
Sioux Lookout, Ontario  
POV 2T0

Dear Sir:

David F. Petrunka recorded 40 days Electromagnetic assessment work credits on each of Mining Claims PA 437105-07-08 inclusive on December 15, 1983.

Additional information has been requested from the claim holder and not submitted.

You are hereby authorized to delete the work credits recorded on December 15, 1983 from each of the claim record sheets. Please inform the recorded holder accordingly.

Yours sincerely,

S.E. Yundt  
Director  
Land Management Branch

Whitney Block, Room 6643  
Queen's Park  
Toronto, Ontario  
M7A 1W3  
Phone: (416)965-4888

S. Hurst:mc

cc: David F. Petrunka  
208 Huron Crescent  
Thunder Bay, Ontario  
P7A 3K4

cc: Walter H. Thompson  
38 King Street  
Sioux Lookout, Ontario  
POV 2T0

Encl.

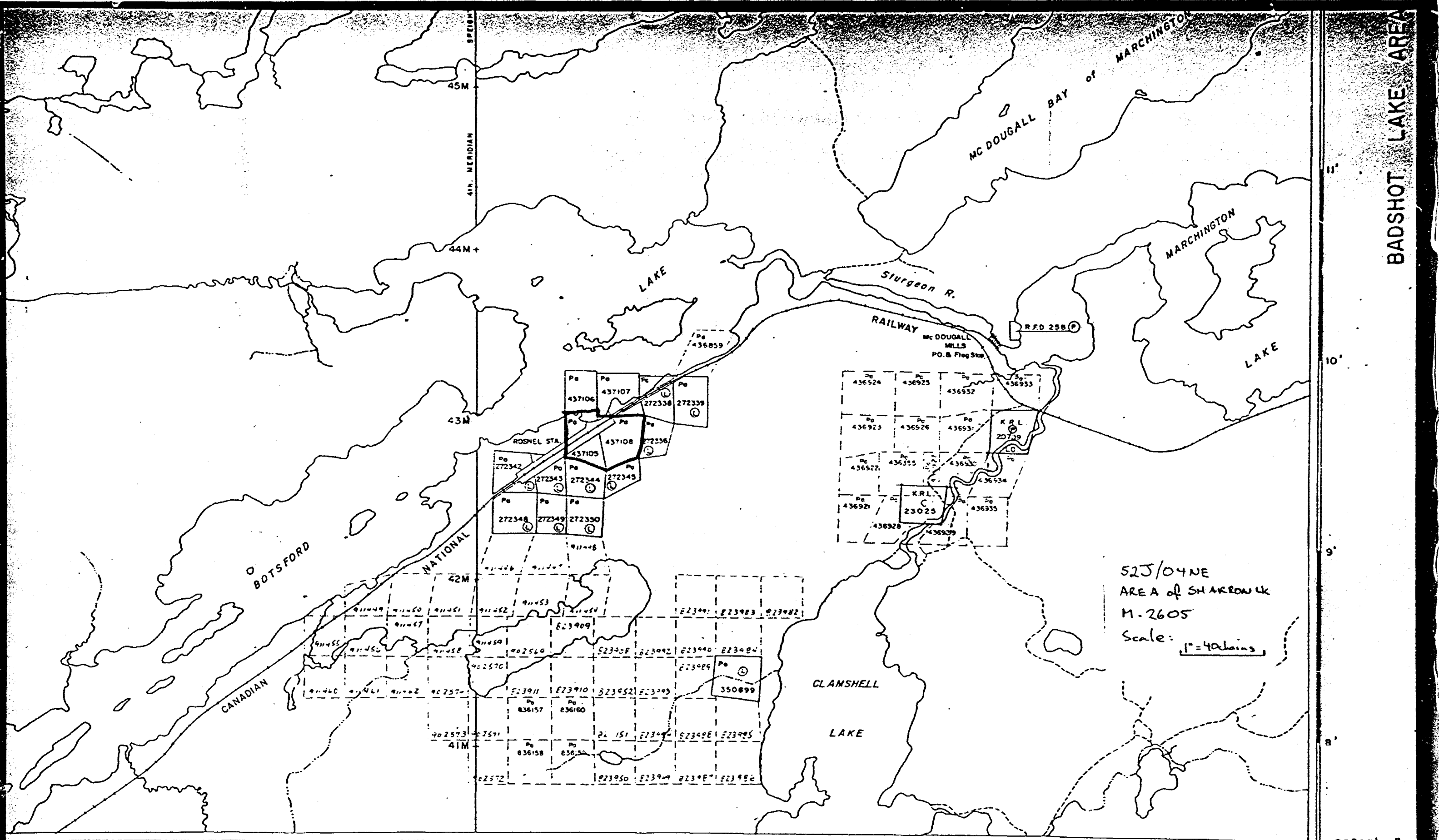

525/04NE  
 AREA of SHARROW LK  
 M-2605  
 Scale: 1" = 40 chains

40' 39' 38' 37' 36' 35' 34' 33' 32' 31' 50°07'30"

ZARN LAKE AREA G-2277

BADSHOT LAKE AREA