



52J04NE0031 52J04NE0010A1 SHARRON LAKE

010

### Diamond Drilling

Area of Sharron Lake

Report No 10

Work performed by: Bankfield Consolidated Mines Ltd.

Claim No	Hole No	Footage	Date	Note
Pa. 32306	1	113'	July/63	
	2	100.4'	July/63	
	3	100'	July/63	
Pa. 32312	4	101'	July/63	
	5	103'	July/63	
	6	126'	July/63	
	7	121'	July/63	
	8	137'	Aug/63	
	9	113'	Aug/63	

---

TOTAL: 9 DH

1014 FT

Notes:

PROPERTY:

Bankfield Consolidated Mines Limited - Sharron Lake

HOLE NO.

1.

LATITUDE:

BEARING:

S10°W

DIP:

47°

STARTED:

July 15/63

COMPLETED:

July 17/63

page 1

DEPARTURE:

V.D.

H.D.

DRILLED BY:

DEPTH:

113'

ELEVATION:

LOCATION:

80' east of line 58C 1+62N

LOGGED BY:

S.T.

FOOTAGE		SAMPLE FOOTAGES	SAMPLE No.	WIDTH Ft.	ASSAY		DATA	
					Au/Oz	\$		
00	Collar							
11.5	Casing - sand & boulders							
17.0	Acid fragmental - carbonate - bleached sheared places partly ox., sericite in slips; fine cubes white pyrite; blebs of darker pyrite to 1/4" maybe marcasite		7801	5.5	Nil			
19.5	As above - includes 1/2" stringers quartz - milky some fine pyrite along edges		7802	2.5	Nil			
20.0	Lost core							
23.0	As above, better shearing fine fracturing; less disseminated pyrite but still 1/4" blebs of dark		7803	3.0	Nil			
28.0	As above - fine grained - intense shearing - still blebs dark pyrite favouring basic fragments		7804	5.0	Nil			
34.8	As above		7805	6.8	Nil			
36.5	quartz vein - some includes sericitic fragments, fine light pyrite in blebs & disseminated - also in slip planes		7806	1.7	0.01	0.35		
37.5	Lost core							
40.0	Basic fragmental - dark green, weakly sheared, finer fragments, sparse disseminated coarse pyrite throughout with occasional seams of heavier pyrite transgressing shear planes - quartz stringers to 1" barren		7807	2.5	0.01	0.35		
42.5	As above, less quartz more pyrite		7808	2.5	0.005	0.17		
46.0	As above, still pyrite fine dark & c.g. brassy		7809	3.5	0.01	0.35		

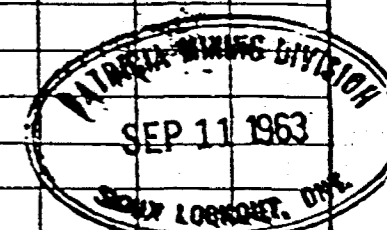

PROPERTY: Bankfield Consolidated Mines Limited - Sharrow Lake							HOLE NO. 1	
LATITUDE:	BEARING: S10°W	DIP: 47°	STARTED: July 15/63	COMPLETED: July 17/63	DEPTH: page 2		LOGGED BY: 113 S.F.	
DEPARTURE:	V.D.	H.D.	DRILLED BY:					
ELEVATION:	LOCATION: 80' east of line 58C 1-62N							
FOOTAGE		SAMPLE FOOTAGES	SAMPLE No.	WIDTH Ft.	ASSAY DATA			
					Au/Oz			
47.6	As above, 2 quartz stringers - X" & 1" pyrite in dark rock		7810	1.6	0.02	0.70		
48.0	Quartz vein		7811	0.5	Nil	-		
49.0	As above - (as 40 - 47.6)		7812	1.0	0.01	0.35		
50.0	Lost core							
52.2	As above, 20 - 30% pyrite - coarse white - well distributed quartz sections 7 - 10% total - quartz, barren		7813	2.2	0.04	1.40		
52.6	quartz vein		7814	0.4	Nil	-		
55.0	As above, less pyrite, more quartz includes + stringers		7815	2.4	0.005	0.17		
57.5	As above, less quartz (includes 2" barren stringer) pyrite c.g.		7816	2.5	0.01	0.35		
58.5	As above, more stringers 10-15% pyrite		7817	1.0	0.01	0.35		
60.0	As above, 2-3% pyrite - less shearing - semi massive		7818	1.5	Nil	-		
64.0	As above, prominent fragments - well pyritized & with fine quartz injections, some quartz stringers along slip planes, weak shearing		7819	4.0	0.005	0.17		
67.5	As above, less fragments, less shearing, less pyrite		7820	3.5	Nil	-		
73.6	As above, little more shearing very sparse pyrite no quartz		7821	6.1	Nil	-		
79.0	As above, more stringers - increase in quartz in slips and fine stringers - better pyrite		7823	1.0	Nil	-		
80.0	As above, less quartz - less pyrite							
84.0	As above, more quartz alteration, 5-10% injected quartz; good pyrite perhaps marcasite best material		7824	4.0	Nil	-		

PROPERTY: Bankfield Consolidated Mines Limited - Sharron Lake				HOLE NO. 1
LATITUDE:	BEARING: S10°W	DIP: 47°	STARTED: July 15/63	COMPLETED: July 17/63
DEPARTURE:	V.D.	H.D.	DRILLED BY:	DEPTH: 113'
ELEVATION:	LOCATION: 80' east of line 58C 1+62N			LOGGED BY: S.T.

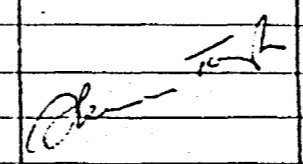
FOOTAGE	DESCRIPTION	SAMPLE FOOTAGES	SAMPLE No.	WIDTH Ft.	ASSAY DATA	
					Au/Oz	\$
89.0	As above, less quartz less pyrite slightly more shearing		7825	5.0	Nil	
92.0	Rhyolite, semi-bleached, some suggestion of fine fragments, well sheared, sericitic, very sparse pyrite		7826	3.0	Nil	
95.0	Greenstone - andesitic, coarse grained, still sheared flecks feldspar; very sparse pyrite mostly in slips					
105.0	As above, still sheared, barren except for occasional silicious spot with marcasite					
113.0	As above, little alteration & more stringers 112-113					
E N D O F H O L E						
						

page 3  
113'  
S.T.

PROPERTY: Bankfield Consolidated Mines Limited - Snarron Lake

HOLE NO. 2.

LATITUDE: BEARING: S10°d DP: 45° STARTED: July 17/63 COMPLETED: July 18/63

page 1

DEPARTURE: V.D. H.D. DRILLED BY:

DEPTH 100.4'

ELEVATION: LOCATION: 33' east 10' south of No. 1

LOGGED BY: S.T.

FOOTAGE	DESCRIPTION	SAMPLE FOOTAGES	SAMPLE No.	WIDTH Ft.	ASSAY		DATA							
					Au/Oz	\$								
00	Collar													
8.0	Casing sand													
9.0	Rhyolite - very fine grained, sheared, bluish grey													
12.0	Vein material - quartz & rusty rock with pyrite in breccia forms - very bleached, good fracturing, sericite & fair to good fine pyrite		7827	3.0	0.05	1.75								
14.5	Acid fragmental, sericitic, partly bleached some sections of quartzose material with fair pyrite good quartz		7828	2.5	0.005	.17								
16.0	As above, sheared													
17.0	As above, well sheared, some ox.		7829	1.0	N11	-								
18.5	As above													
20.6	Basic fragmental - quartz stringers fair pyrite		7830	2.1	N11	-								
22.0	As above 40% quartz good pyrite occasional sparse chalcopyrite		7831	1.4	0.03	1.05								
22.6	quartz unknown while metallic crystals (stibnite?)		7832	0.6	0.06	2.10								
24.6	As above, 25-30% quartz - good pyrite in basic material		7833	2.0	0.03	1.05								
28.0	Basic fragments as above, occasional ox. seams 15-20% quartz, good coarse pyrite in basic		7834	3.4	0.02	0.70								
30.0	As above, less quartz, less pyrite		7835	2.0	0.005	0.17								
33.6	As above, fair to good pyrite		7836	3.6	0.03	1.05								
36.1	As above, 20-30% quartz, good pyrite		7837	2.5	N11	-								
33.0	As above		7838	2.9	0.03	1.05								
42.0	As above less quartz and pyrite		7839	3.0	N11	-								
44.0	As above		7840	2.0	0.005	0.17								

*[Handwritten signature]*

PROPERTY: Bankfield Consolidated Mines Limited - Sharron Lake				HOLE NO. 2
LATITUDE:	BEARING: 510°W	DP: 45°	STARTED: July 17/63	COMPLETED: July 18/63
DEPARTURE:	V.D.	H.D.	DRILLED BY:	DEPTH: 100.4'
ELEVATION:	LOCATION: 33' east 10' south of No. 1			LOGGED BY: S.T.

FOOTAGE	SAMPLE FOOTAGES	SAMPLE No.	WIDTH Ft.	ASSAY		DATA	
				Au/Oz	g		
50.5	Rhyolite, still suggests fragments banded, occasional pyrite						
55.5	As above, still suggests banding, very sparse pyrite in slips						
56.5	As above with 20% quartz, good c.g. pyrite	7841	1.0	Nil	-		
100.4	Greenstone, weak shearing occasional 1/2" to 1" barren quartz stringer or breccia zone with dark pyrite (2 79.2 & 81.0)						
E N D O F H O L E							
<i>Alan Tough</i>							

PROPERTY: <b>Sharron Lake</b>		<b>Barkfield consolidated Mines Limited</b>			HOLE NO. <b>3</b>
LATITUDE:	BEARING: <b>S10°W</b>	DIP: <b>45°</b>	STARTED: <b>July 20/63</b>	COMPLETED: <b>July 23/63</b>	page 1
DEPARTURE:	V.D.	H.D.	DRILLED BY:		DEPTH: <b>100'</b>
ELEVATION:	LOCATION: <b>88' east and 13' north of hole No. 1</b>				LOGGED BY: <b>S.T.</b>

FOOTAGE		SAMPLE FOOTAGES	SAMPLE No.	WIDTH Ft.	ASSAY		DATA	
					Au/Oz	%		
00	Collar							
10.0	Casing - sand							
11.0	Acid fragmental, carbonated, sheared, much less bleaching than in hole No. 2. Brown-buff color, erratic quartz stringers and veinlets one-eighth to one and one-half in ches.							
12.5	As above, 10% quartz stringers. Few spots pyrite along edges of quartz		7842	1.5	Nil	-		
16.5	As 11.0 to 12.5							
17.5	As above. Four stringers quartz sparse pyrite		7843	1.0	0.005	0.17		
19.0	As above, barren quartz stringers		7844	1.5	Nil	-		
20.0	As above, 80% pyrite and/or marcasite		7845	1.0	0.03	1.05		
24.0	As above, less carbonate - contorted quartz stringers .1 to 1"							
26.0	Basic fragmental, uncarbonated, unbleached, dark medium grained still contorted quartz veinlets, well sheared sparse pyrite		7846	2.0	0.005	0.17		
30.0	As above, still shearing less quartz very sparse pyrite		7847	4.0	Nil	-		
32.0	As above, less quartz and pyrite							
34.0	Kynolite, not as fine grained as in 2. some suggestion of banding coarser sparse pyrite		7848	2.0	Nil	-		
36.0	As above, fine grained banded							
37.0	As above, fair pyrite in silicious sections		7849	1.0	Nil	-		
40.0	As above, very sparse pyrite							
45.0	As above							

*Plum Tough*

PROPERTY: Bankfield Consolidated Mines Limited - Sharron Lake						HOLE NO. 3
LATITUDE:	BEARING: S10°W	DIP: 45°	STARTED: July 20/63	COMPLETED: July 23/63	page 2	
DEPARTURE:	V.D.	H.D.	DRILLED BY:			DEPTH: 100'
ELEVATION:	LOCATION: 88' east and 13' north of hole No. 1				LOGGED BY: S.T.	

FOOTAGE	DESCRIPTION	SAMPLE FOOTAGES	SAMPLE No.	WIDTH Ft.	ASSAY		DATA		
					Au/Oz	\$			
47.0	As above, more injected quartz and better pyrite, short sections of 20% pyrite		7850	2.0	Nil	-			
50.0	As above, less quartz, good fine pyrite in short sections		7851	3.0	Nil	-			
58.0	As above, fine grained, and sheared								
100/0	Greenstone, contact indefinite flecks feldspar as in 1 and 2 still sheared soft - barren except for occasional 1/2" section silicified material with pyrite								
E N D O F H O L E									



*Alvin Taylor*



PROPERTY: Bankfield Consolidated Mines Limited - Sharron Lake						HOLE NO. 4		
LATITUDE:	BEARING: N20°W	DIP: 45°	STARTED: July 23/63	COMPLETED: July 25/63	page 1			
DEPARTURE:	V.D.	H.D.	DRILLED BY:		DEPTH: 101'			
ELEVATION:	LOCATION: 61' north - 94' east of No. 3 of 32312				LOGGED BY: S.T.			
FOOTAGE		SAMPLE FOOTAGES	SAMPLE No.	WIDTH Ft.	ASSAY		DATA	
					Au/Oz	g		
00	Collar							
5.0	Casing							
7.5	Tuff, silicious, grey-brown, carbonated, fine fragmentation contorted quartz veinlets fine whitish pyrite		7853	2.5	Nil	3		
9.3	As above, less quartz stringers							
10.5	Tuff, 30% quartz fine pyrite		7854	1.2	Nil	3		
12.0	Tuff, little quartz							
14.0	Tuff, as above, 20% quartz, in form of contorted stringers mostly barren except along edges		7855	2.0	Nil	3		
16.0	Tuff, as above, some stringers							
16.5	Lost core							
20.0	Tuff, as above, more quartz stringers							
24.0	Tuff, as above, numerous quartz stringers, fine pyrite		7856	4.0	Nil	3		
30.5	Tuff, more noticeable fragments							
33.0	Tuff, brecciated, faulted, some quartz and pyrite		7857	2.5	Nil	-		
34.0	quartz vein, 85% quartz mostly barren		7858	1.0	0.28	9.80		
35.2	Tuff, little quartz some fine pyrite							
38.0	Greenstone, sheared, dark green, chloritic, fine quartz stringers and inclusions							
38.5	Greenstone-quartz complex, contorted quartz veinlets, very good pyrite favoring greenstone		7859	0.5	0.005	0.17		
40.0	quartz, 85% inclusions of greenstone as irregular blebs and shards. quartz has sparse galena chalcopyrite (No. 1 vein)		7860	1.5	0.01	0.35		

*Alma Tough*



PROPERTY: Bankfield Consolidated Mines Limited - Sharron Lake							HOLE NO. 5	
LATITUDE:	BEARING: N18°E	DIP: 45°	STARTED: July 26/63	COMPLETED: July 29/63			page 1	
DEPARTURE:	V.D.	H.D.	DRILLED BY:		DEPTH: 103'		LOGGED BY: S.P.	
ELEVATION:	LOCATION: 66' north - 80' east No. 3 hole 32312							
FOOTAGE		SAMPLE FOOTAGES	SAMPLE No.	WIDTH Ft.	ASSAY		DATA	
					Au/Oz	g		
00	Collar							
5.5	Casing							
8.0	Tuff, silicious, with quartz stringers, fine pyrite, carbonate and sheared		7864	2.5	Nil			
18.5	Tuff, gray-buff, carbonate							
21.0	Greenstone, some intercalated bands tuff							
32.4	Tuff, 1 to 2" bands greenstone							
40.0	Greenstone still sheared							
53.0	Tuff, with thin intercalated bands greenstone alteration toward 53							
55.0	quartz vein material, with 10% altered, yellow to grey-brown rock inclusions. Some chloritic rock inclusions. Very fine galena and sparse chalcopyrite and some pyrite		7865	2.0	0.24	8.40		
55.6	Greenstone, chloritic							
57.0	Tuff							
59.0	Tuff, irregular contorted quartz veinlets, some rusting, white pyrite		7866	2.0	Nil			
72.0	Tuff, less greenstone bands							
78.5	Greenstone few quartz veinlets							
96.5	Tuff, still few quartz veinlets							
99.0	Tuff, as above, larger (to 1/2" fragments) some fine pyrite		7867	2.5	Nil			
103.0	Tuff as above							
END OF HOLE								

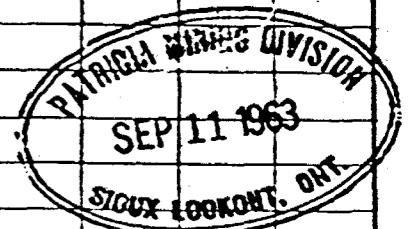

PROPERTY:

Bankfield Consolidated Mines Limited - Sharron Lake

HOLE NO.

6

LATITUDE:

BEARING:

N20°E

DIP:

45°

STARTED:

July 29/63

COMPLETED:

July 31/63

page 1

DEPARTURE:

V.D.

H.D.

DRILLED BY:

DEPTH:

126'

ELEVATION:

LOCATION:

34' north - 69' east of No. 3 32312

LOGGED BY:

S.T.

FOOTAGE		SAMPLE FOOTAGES	SAMPLE No.	WIDTH Ft.	ASSAY		DATA							
					Au/Oz	\$								
00	Collar													
13.0	Casing													
14.3	Tuff													
18.0	Greenstone, sheared													
20.0	Lost core													
32.5	Greenstone as above, oxidized 20-21' few stringers quartz													
33.5	Greenstone, 15-20% quartz in stringers formation, fair pyrite		7871	1.0	Nil	-								
37.3	Greenstone still quartz stringers mostly 1/8"													
39.3	Tuff, better quartz stringers, fair pyrite		7872	2.0	Nil	-								
48.5	Tuff, coarser grained, brecciated, fine white pyrite													
51.3	Tuff fragment, more quartz heavy pyrite in dense bunches		7873	2.8	Nil	-								
52.9	Tuff as above but with reddish fragments (hematization?)		7874	1.6	0.005	0.17								
58.8	Tuff, reddish as above to 54' then normal													
59.6	Tuff-quartz complex, sparse chalcopyrite, fair pyrite		7875	0.8	Nil	0								
68.0	Tuff, normal, still sheared, scattered pyrite throughout													
69.0	Tuff, quartz stringers, good pyrite, possible galena, possible hematite		7876	1.0	Nil	-								
72.5	Tuff, normal													
77.0	Greenstone													
78.5	Tuff, transverse fractures with hematite stain, 1-1/2 quartz stringers with chalcopyrite and hematite		7877	1.5	0.005	0.17								

*Alan Tombs*



PROPERTY: <b>Bankfield Consolidated Mines Limited - Sharron Lake</b>				HOLE NO. <b>7</b>
LATITUDE:	BEARING: <b>N19°E</b>	DIP: <b>45°</b>	STARTED: <b>July 31/63</b>	COMPLETED: <b>Aug. 2/63</b>
DEPARTURE:	V.D.	H.D.	DRILLED BY:	
ELEVATION:	LOCATION: <b>28' north - 87' east of No. 3 32312</b>			DEPTH: <b>121'</b>
				LOGGED BY: <b>S.F.</b>

FOOTAGE	DESCRIPTION	SAMPLE FOOTAGES	SAMPLE No.	WIDTH Ft.	ASSAY		DATA	
					AU/OZ	\$		
00	Collar							
12.0	Casing							
23.0	Greenstone, normal, few quartz, stringers							
24.0	Tuff? altered grey banded rock with coarse cube pyrite							
24.2	Tuff							
26.0	Tuff, 15% quartz in contorted stringers		7879	1.8	Nil	-		
37.5	Tuff, few continued quartz stringers							
38.5	Tuff, 15 to 20% quartz, fine pyrite along edges							
51.5	Tuff, as above but less quartz							
55.0	Tuff, fine quartz stringers and inclusions and folded veinlets, good coarse, whitish pyrite		7880	3.5	Nil	-		
69.6	Tuff, as above, occasional stringers							
70.5	Tuff, several quartz stringers, good pyrite, occasional chalcopyrite		7881	1.0	Nil	-		
86.0	Tuff, finer grained, still few stringers							
88.5	Tuff, reddish (hematized) fragments and stain, brecciated quartz good pyrite and some hematite, oxidized seen on footwall		7882	2.5	Nil	-		
90.5	Tuff, as above, more quartz		7883	2.0	Nil	-		
99.0	Tuff, normal, still quartz stringers to 3/8"							
101.0	Tuff, much more quartz, good pyrite, some chalcopyrite		7884	2.0	Nil	-		
104.0	Tuff as above, less quartz, still white pyrite		7885	3.0	Nil	-		
105.0	Tuff, yellow alteration, some sericite, pyrite		7886	1.0	Nil	-		
106.0	Tuff - quartz Vein Material, includes 2" quartz with pyrite & chalcopyrite		7887	1.0	Nil	-		

*Alvin Togh*

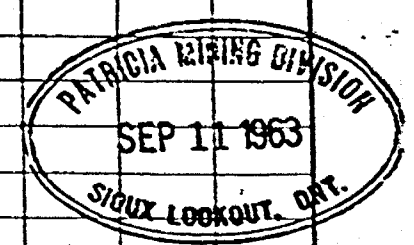

PROPERTY: Sankfield Consolidated Mines Limited - Sharrow Lake							HOLE NO. 7	
LATITUDE:	BEARING: N19°E	DIP: 45°	STARTED: July 31/63	COMPLETED: Aug. 2/63	DEPTH: 121'		PAGE 2	
DEPARTURE:	V.D.	H.D.	DRILLED BY:		LOGGED BY: J.R.			
ELEVATION:	LOCATION: 26' north 87' east of No. 3 32312						3.7.	
FOOTAGE		SAMPLE FOOTAGES	SAMPLE No.	WIDTH Ft.	ASSAY	DATA		
111.0	Greenstone, numerous quartz stringers, mostly barren				Au/02 3			
118.0	Tuff, normal							
119.0	Tuff - quartz complex, fair pyrite		7888	1.0	Si1 -			
121.0	Tuff, normal							
E N D O F H O L E								
<i>John T. O.</i>								

PROPERTY:

Bankfield Consolidated Mines Limited - Sharron Lake

HOLE NO.

8

LATITUDE:	BEARING: N19°E	DIP: 45°	STARTED: Aug. 2/63	COMPLETED: Aug. 4/63	DEPTH: page 1
DEPARTURE:	V.D.	H.D.	DRILLED BY:		137.0'
ELEVATION:	LOCATION: 46' north - 32' east of No. 3 32312				LOGGED BY: S.T.

FOOTAGE	DESCRIPTION	SAMPLE FOOTAGES	SAMPLE No.	WIDTH Ft.	ASSAY		DATA	
					Ag/Oz	\$		
00	Collar							
10.0	Casing							
11.5	lost core							
28.5	Tuff, medium to coarse grained, fair pyrite in quartz stringers and inclusions, very sparse chalcopyrite							
39.3	Tuff, fine grained, felsic, fine pyrite. No stringers but silicious							
70.0	Tuff, coarse grained, fragments to 1/2", few quartz stringers, occasional good pyrite in short sections							
74.0	Greenstone, no quartz stringers							
78.0	Tuff, coarse grained, few quartz stringers							
82.0	Tuff, numerous quartz stringers, very contorted, good pyrite in seams transgressing stringers and shearing		7889	4.0	Nil	-		
93.5	Tuff, as above, less quartz, still fair pyrite							
95.0	Tuff, sands light green altered rock, good quartz, good pyrite		7890	1.5	0.005	0.17		
98.0	Tuff, as above, less quartz, still fair pyrite		7891	3.0	Nil	-		
105.0	Tuff, as above, less quartz, less pyrite, still contorted stringers & small bunches good pyrite, more green alteration at 103							
106.0	Tuff, good quartz, good pyrite, sparse chalcopyrite		7892	1.0	0.005	0.17		
116.3	Greenstone, couple of thin bands tuff							
118.0	Tuff, concentration of pyrite at contact with green stone @ 116.0							

*Sharron Lake*

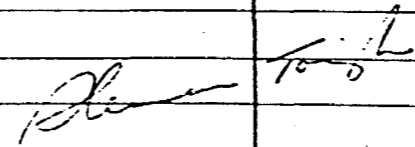

PROPERTY: Bankfield Consolidated Mines Limited - Sharron Lake				HOLE NO. 8
LATITUDE:	BEARING: N10°E	DIP: 45°	STARTED: Aug. 2/63	COMPLETED: Aug. 4/63
DEPARTURE:	V.D.	H.D.	DRILLED BY:	DEPTH: page 2
ELEVATION:	LOCATION: 46' north - 32' east of No. 3 32312			LOGGED BY: S.T.

FOOTAGE	DESCRIPTION	SAMPLE FOOTAGES	SAMPLE No.	WIDTH Ft.	ASSAY		DATA	
					in/oz	%		
119.0	Tuff, quartz stringers, fair pyrite, occasional chalcopyrite		7893	1.0	Nil	-		
130.4	Tuff, normal, occasional quartz stringers							
133.6	Dike, grey, fine grained, very silicious (vein material) fair pyrite		7894	3.2	Nil	-		
135.0	Tuff, normal, quartz stringers, fair pyrite		7895	1.4	0.005	0.17		
137.0	Tuff, as above, finer grained							
E N D O F H O L E								
								

PROPERTY: Bankfield Consolidated Mines Limited - Sharron Lake

LATITUDE: \_\_\_\_\_ BEARING: 519°W DIP: 45° STARTED: Aug. 5/63 COMPLETED: Aug. 6/63

DEPTH: page 1

DEPARTURE: \_\_\_\_\_ V.D. \_\_\_\_\_ H.D. \_\_\_\_\_ DRILLED BY: \_\_\_\_\_

LOGGED BY: S.T.

ELEVATION: \_\_\_\_\_ LOCATION: 145' north - 80' east No. 3 32312

FOOTAGE	DESCRIPTION	SAMPLE FOOTAGES	SAMPLE No.	WIDTH Ft.	ASSAY DATA	
					Au/Cz	g
00	Collar					
5.0	Casing					
22.6	Tuff, fine to medium grained					
31.5	Tuff, medium to coarse grained, few quartz stringers					
48.3	Tuff, coarse grained, very few quartz stringers					
50.5	Dike, granitized, fair pyrite in coarse cubes		7897	2.2	Nil	
60.2	Tuff, fragments to 1 1/2"					
62.6	Greenstone, fine grained altered, suggestion banding no stringers					
76.2	Tuff, normal, some large fragments					
79.0	Tuff, fair to good pyrite (marcasite)		7898	2.8	0.005	0.17
80.0	Tuff, quartz stringers, fair pyrite					
81.0	Greenstone, some contorted stringers					
91.0	Tuff, little pyrite					
92.0	Tuff with 1 1/2" quartz, fine pyrite and one spot chalcopyrite		7899	1.0	0.005	0.17
97.0	Tuff, normal					
101.5	Greenstone					
113.0	Tuff, normal, quartz stringers and some fair pyrite in rock					

END OF HOLE

*Henry Toth*

NO. 1 ZONE

SCALE 1" = 20'

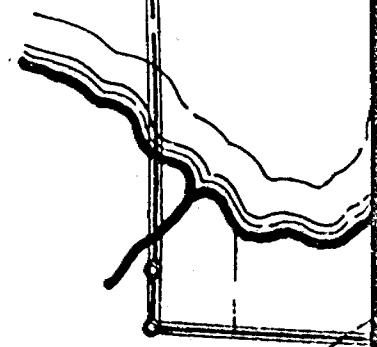
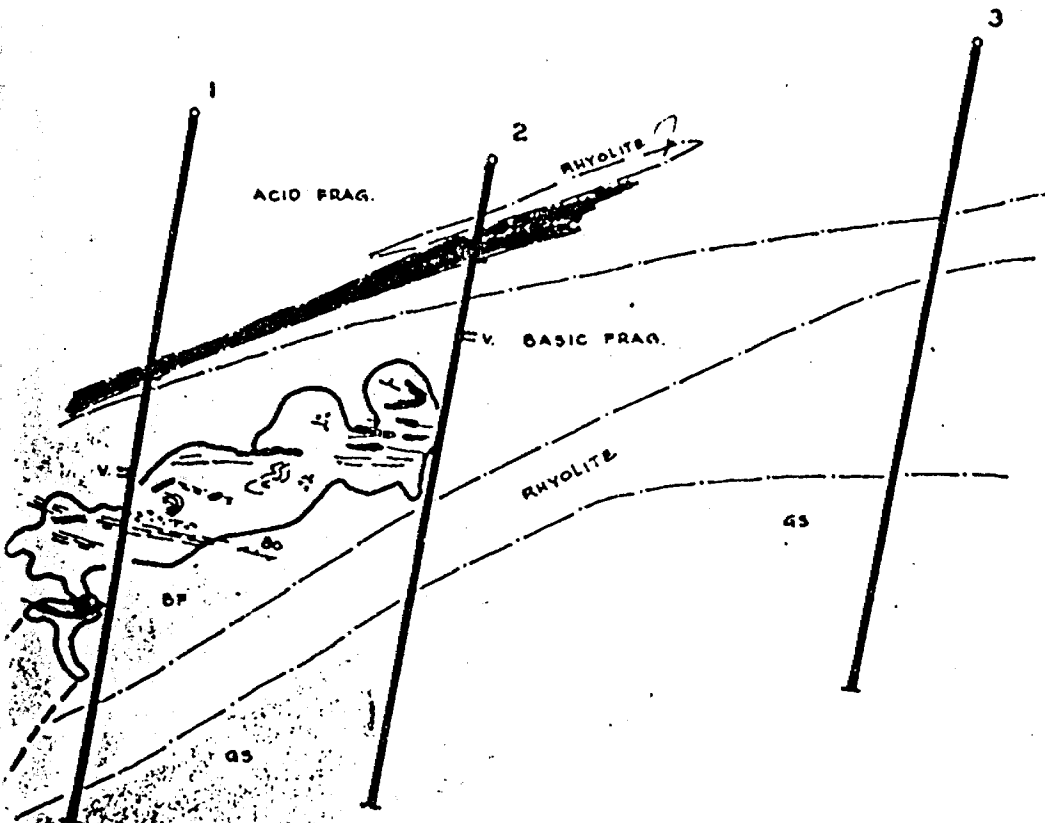

STORM

PROJECTED TO SURFACE AT 80° N.

NO. 2 SHOWING

SCALE 1" = 20'

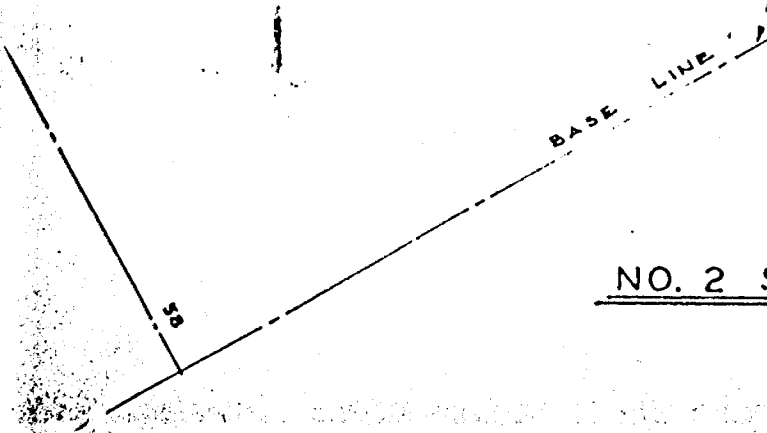

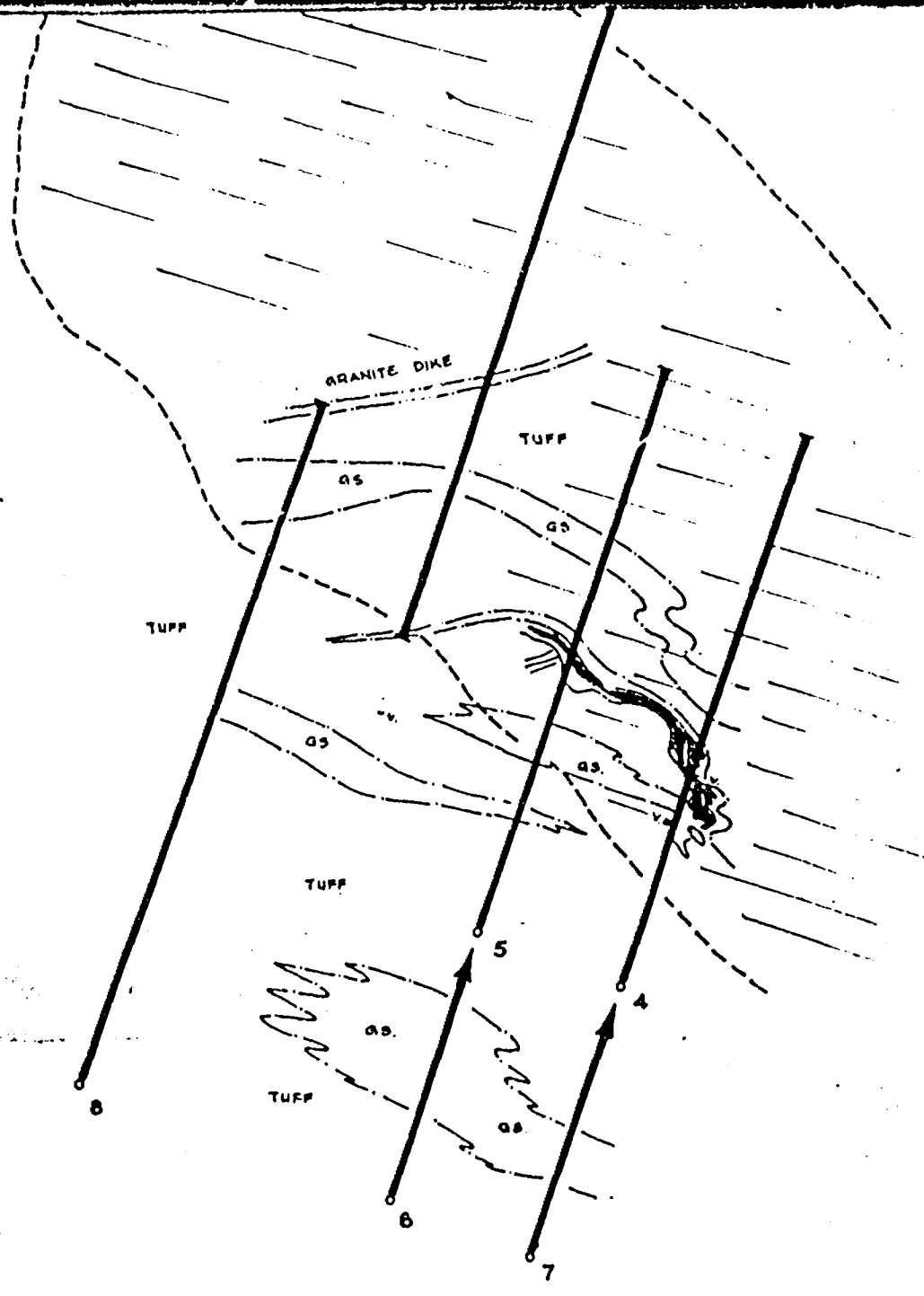

32312

NO. 1 ZONE

SCALE 1" = 20'

