

DIAMOND DRILLING



52J04SE0025 52J04SE0011B1 ZARN LAKE

010

AREA: ZARN LAKE

REPORT No.: 13

WORK PERFORMED BY: ROBERT ROSENBLAT

<u>CLAIM No.</u>	<u>HOLE No.</u>	<u>FOOTAGE</u>	<u>DATE</u>	<u>NOTE</u>
PA 436255-6-7	79-1	150.0	Nov./79	(1)
	79-2	150.0	Nov./79	(1)
	79-3	150.0	Nov./79	(1)
	79-4	150.0	Nov./79	(1)
	79-5	120.0	Nov./79	(1)
	79-6	120.0	Nov./79	(1)
	79-7	120.0	Nov./79	(1)
	79-8	150.0	Nov./79	(1)
	79-9	150.0	Nov./79	(1)

TOTAL: 9 DH 1260 FT

NOTES: (1) #32-80

results obtained in the drill hole vein intercepts:

DRILL HOLE NUMBER	FROM FT.	TO FT.	LENGTH FEET	Au.oz/ton	Ag.oz/ton	REMARKS
79 - 1	13.5	15.0	1.50	0.086	0.38	No.2 Vein
79 - 2	15.5	18.0	2.50	0.048	0.35	No.2 Vein
	115.0	116.0	1.00	0.003	0.01	No.1 Vein
79 - 3	38.0	41.0	3.00	0.037	0.16	No.2 Vein
	95.0	99.0	4.00	0.098	0.34	No.1 Vein
79 - 4	112.5	114.7	2.20	0.142	0.63	No.1 Vein
79 - 5	44.0	45.3	1.30	0.030	0.21	No.2 Vein
	61.0	63.0	2.00	0.260	0.82	No.1 Vein

No. 3 VEIN

79 - 6	-	-	-	-	-	Fault displaced vein.
79 - 7	75.0	78.0	3.00	0.042	0.76	with 10% galena.

CENTRAL VEIN

79 - 8	96.0	99.0	3.00	0.046	0.14	-50°, 150 feet.
79 - 9	92.0	97.0	5.00	0.046	0.04	-50°, 150 feet.

An above normal quartz stringer density and pervasive pyrite dissemination characterized all the drill holes suggesting the possibility of a 'porphyry style' gold deposit. Consequently, rock geochemical analysis for gold and silver were done on 10 foot core sample split (other than vein intercepts) for holes 79-1, 79-5, 79-7 and 79-9. The results indicate mostly rock background values in gold and silver, thus, negating the possibility of such gold deposit.

CONCLUSIONS AND RECOMMENDATIONS:

The writer met with, reviewed and discussed the drilling program with Mr. Ross Kidd in Toronto on November 30, 1979. Both parties concur that unless assay results from this drilling program is satisfactory no further drilling or additional work is warranted. The preceding assay tabulation indicates that no economic grade over minimum mining width was encountered in this program. Therefore, no further work is recommended for the property at this time.

Respectfully submitted,

S. S. Tan
S. S. Tan, P.Eng.

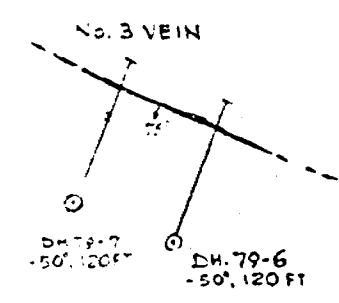
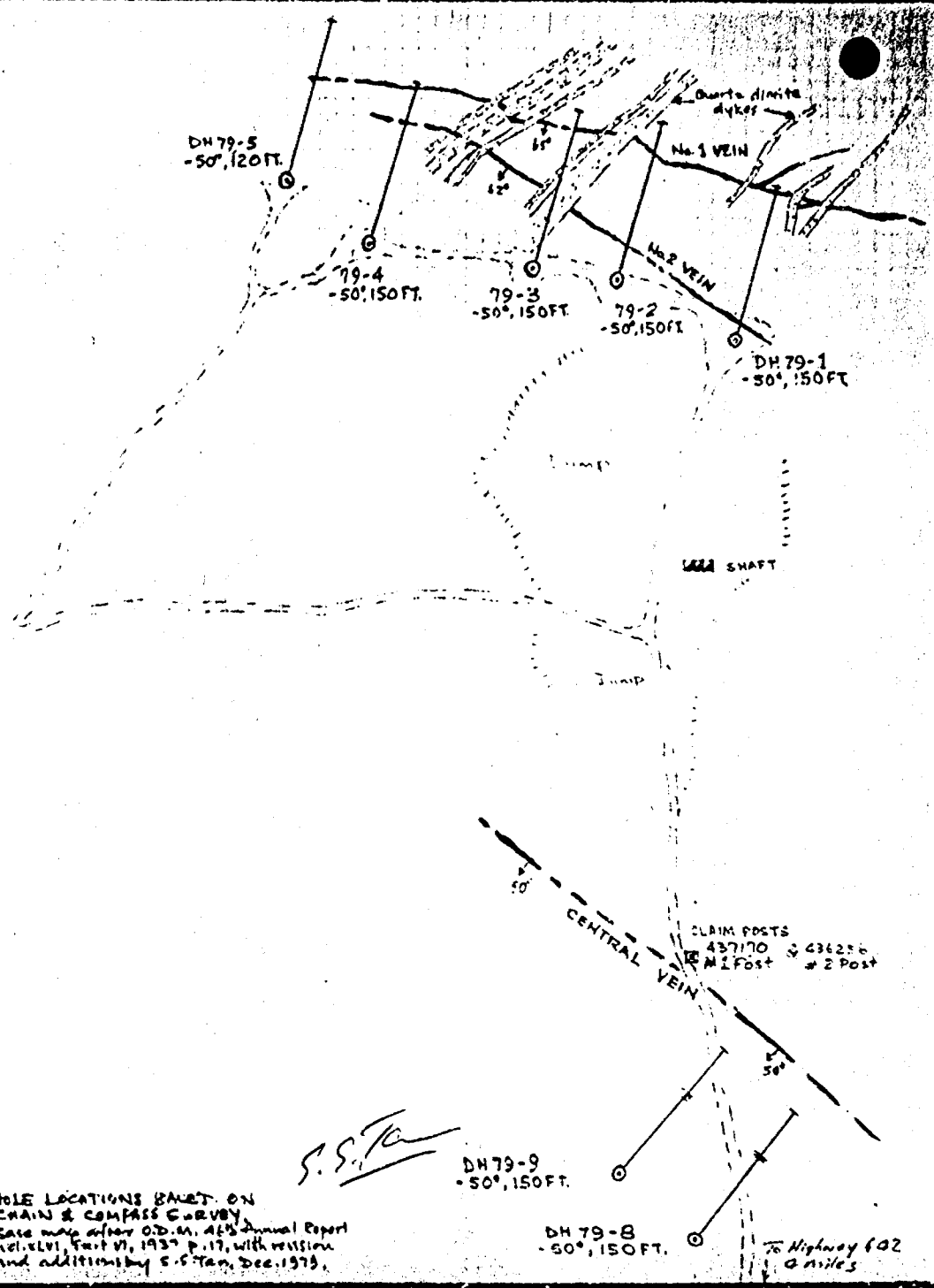
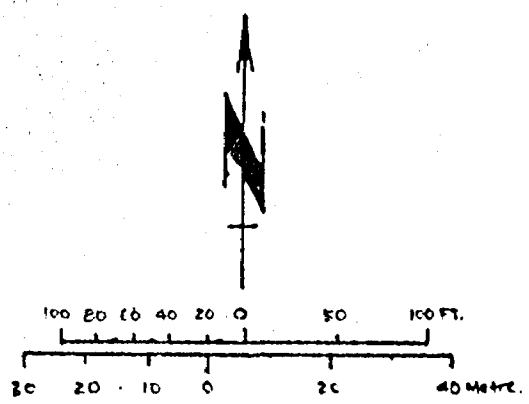

S.S. Tan

CRIANA DEVELOPMENTS LTD.
 DRILL HOLE LOCATIONS
 ALCONA MINE PROPERTY
 SPLIT LAKE AREA, SIOUX LOOKOUT, ONT.
 Drawn by: S.S. TAN, P.ENG.
 Date: Dec. 20, 1979.

- NOTE:-
1. HOLE LOCATIONS BASED ON CHAIN & COMPASS SURVEY.
 2. Base map after O.D.M. A.C.S. Annual Report 1914/15, Part VI, 1937 p. 17, with revisions and additions by S.S. Tan, Dec. 1979.



52J04SE0025 52J04SE0011B1 ZARN LAKE

020

ORIANA DEVELOPMENTS LTD.

PROGRESS REPORT -- DIAMOND DRILLING PROGRAM

ALCONA MINE PROPERTY, SPLIT LAKE AREA
PATRICIA MINING DIVISION, ONTARIO

BY:

SIAM S. TAN, P.Eng.(Geological)

December 22, 1979.

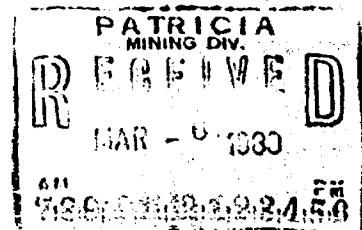

DRILL HOLE RECORD

HOLE NUMBER

79-1

COMPANY ORIANA DEVEL. LTD. CO-ORDINATES SEE MAP FOR LOCATION

TESTS _____

DATE DRILLED from Nov. 11/79

PROPERTY ALCONA-SPLIT LAKE TOTAL LENGTH 150 feet

to Nov. 11/79

LOCATION SIOUX LOOKOUT, ONT EL. of COLLAR --

BRG. 016° Az CORRECTED _____

LOGGED BY S.S. TAN, P.ENG.

~~NO~~ NO 1 + 2 veins CORE SIZE AQ

DIP -50° CORRECTED _____

DATE 11/13/79

FOOTAGE		RECOV %	DESCRIPTION	SAMPLE NUMBER	Length		ANALYSIS						
from	to				FROM	TO	FEET	Au	Ag				
0	5	FEET	Casing										
5	13.5		Andesite- dark green to black, massive, moderate qtz. healed hair-line fractures. 5% f.g. disseminated pyrite.										
13.5	15		Quartz Vein (no. 2 veins), ca. @80° massive qtz with grey bands 10% py dissemination and streaks, lesser ga-sp-cpy stringers	278	13.5	5	1.5		0.008		0.38		
				279	14.5	13.5	2		4.003		0.01		
15	34		Altered Andesite; green chloritized, silicified. Abundant reticular(?) qtz. stringers to 1/2" wide. Minor py dissemination.	280	15	17	2		4.002		0.02		
				281	95	100	5		0.02		0.18		
			15-17; qtz rich patch @30'; 2" grey qtz ca. 80° with minor ga-cpy-py	282	100	105	5		4.003		0.06		
				283	105	110	5		0.02		0.07		
34	70		Porphyritic Andesite; feldspar porphyry to 1/2" diameter. Minor py dissemination. Dark green to black.	284	126	131	5		4.003		0.01		
			63-67'; abundant omnidirectional(?) qtz stringers	285	Clip + 1" above 2'				0.03		0.15		
70	71.5		Quartz, milky massive qtz. no sulphide ca. 85°										
71.5	80.5		Andesite; massive dr. green to black, 5% dissem. pyrite. Moderate chloritization & silicification										
			73.5-74.5; about 30% qtz stringers.										
				ROCK	Geochem				Au		Ag		
80.5	84		Porphyritic Andesite; - as 34-70	101	5	11.5	6.5		4.10		0.1		
84	89.3		Quartz Diorite; f.g. black contacts @cc50° up to 10% f.g. pyrite dissem.	102	11.5	30	13		100		0.1		
				103	30	40	10		40		0.1		
89.3	110		Quartz Diorite; as in 84-89.3 bnt up to 15% py	104	40	50	10		4.10		0.1		
			@96.5; 3" qtz veinlet, @ 103.5'; 1" qtz patches	105	50	60	10		4.10		0.1		
			@108'; 2" qtz-py-cpy.	106	60	70	10		4.10		0.1		
110	120		Porphyritic Andesite; as in 34-70, bnt with up to 10% f.g. dissem. py	107	70	80	10		70		0.1		
120	122		Sheared Andestie Porphyry with qtz veinlets ca @40° @121.8-122; white qtz. us sulphides @120.5-121.5; 20% py- qtz rich zone	108	80	90	10		4.10		0.1		
				109	90	95	5		4.10		0.1		
				110	110	120	10		4.10		0.1		
				111	120	126	6		740		2.2		
				112	131	140	9		4.10		0.2		
				113	140	150	10		4.10		0.1		

DUPLICATE COPY
POOR QUALITY ORIGINAL
TO FOLLOW

DRILL HOLE RECORD

HOLE NUMBER **79-1**

COMPANY OBAMA DEVELOPMENTS LTD
 PROPERTY ALCONA - SPLIT LAKE
 LOCATION SIOUX LOOKOUT, DNT.
 HOLE NO. 18 2-UGENS

CO-ORDINATES See Map for Location.
 TOTAL LENGTH 150 FEET
 EL. of COLLAR ---
 CORE SIZE AQ

TESTS ---
 BRG. 016°A CORRECTED ---
 DIP -50° CORRECTED ---

DATE DRILLED from Nov. 11, 79
 to Nov. 11, 79.
 LOGGED BY S.S. TAYLOR, P. 5024
 DATE 11/13/79.

FOOTAGE		RECOV. %	DESCRIPTION	SAMPLE NUMBER	ANALYSIS				
from	to				FEET	Am	Ag		
0	5	FEET	CASING.						
5	13.5		ANDESITE: Dark green to black, massive, moderate qtz. healed hairline fractures. 5% f.g. disseminated pyrite.						
13.5	15		QUARTZ VEIN (No. 2UGEN), c.a. @ 80°. Massive qtz with grey bands 10% py. dissemination and streaks, lesser ga-sp-epy stringers.	278	13.5	15	1.5'	0.086	0.78
				279	11.5	13.5	2	<.003	0.01
				280	15	17	2	<.003	0.02
15	34		ALTERED ANDESITE: Green chloritized, silicified. Abundant reticulate qtz. stringers to 1/2" wide. Minor py dissemination. 15-17: qtz. rich patch @ 30'; 2" grey qb. ca. 80° with minor ga-epy-py.	281	95	100	5	0.02	0.18
				282	100	105	5	<.003	0.06
				283	105	110	5	0.028	0.07
				284	126	131	5	<.003	0.04
34	70		PORPHYRIC ANDESITE: Feldspar porphyry to 1/2" diameter. minor py dissemination. Dark green to black. 63-67': abundant unidirectional qtz. stringers.	285	clip - 1" every 2'			0.03	0.15
70	71.5		QUARTZ, Milky massive qb. no sulphide, c.a. 85°						
71.5	80.5		ANDESITE: Massive dk. green to black, 5% dissem. pyrite. Moderate chloritization & silicification. 73.5-74.5: about 30% qb. stringers.						
80.5	84		PORPHYRIC ANDESITE: - as 34-70.						
84	89.3		QUARTZ DIORITE: f.g. black, contacts @ ca. 50° up to 10% f.g. pyrite dissem.	101	5	11.5	6.5	410	0.1
				102	11.5	30	13	100	0.1
				103	20	40	10	110	0.1
				104	40	50	10	410	0.1
89.3	95		PORPHYRIC ANDESITE: - as in 34-70'.	105	50	60	10	410	0.1
95	110		QUARTZ DIORITE: as in 84-89.3, but up to 15% py. @ 96.5: 3" qb. veinlet, @ 103.5: 1" qb. patch @ 108: 2" qb-py-epy.	106	60	70	10	410	0.1
				107	70	80	10	70	0.1
				108	80	90	10	410	0.1
110	120		PORPHYRIC ANDESITE: - as in 34-70, but with up to 10% f.g. dissem. py.	109	90	95	5	410	0.1
				110	110	120	10	410	0.1
120	122		SHEARED ANDESITE PORPHYRY with qb. veinlets. c.a. @ 40°. @ 121.8-122: white qb. no sulphide, @ 120.5-121.5: 20% py-qb-rich zone.	111	120	126	6	740	2.2
				112	131	140	9	410	0.2
				113	140	150	10	410	0.1

DRILL HOLE RECORD

HOLE NUMBER

79-1

COMPANY ORIANA
 PROPERTY ALGONA
 LOCATION SIOUX LOOKOUT
 JOB NO ONTARIO

CO-ORDINATES _____
 TOTAL LENGTH _____
 EL. at COLLAR _____
 CORE SIZE _____

TESTS _____
 BRG. _____ CORRECTED _____
 DIP _____ CORRECTED _____

DATE DRILLED from _____ to _____
 LOGGED BY S. TAN P. ENG.
 DATE _____

FOOTAGE		RECOV. %	DESCRIPTION	SAMPLE NUMBER	Length	ANALYSIS								
from	to													
122	126		PORPHYRITIC BASALT: black massive porphyry to 1/2" diameter. 5% pyrite dissemination.											
126	131.5		Shear Zone: sheared basalt ca. 50° up to 10% py dissemin. Qtz stringers to 1/2" every 2 feet parallel to shearing.											
131.5	150		PORPHYRITIC BASALT: as in 122-126 @146-149; qtz stringer rich @149' 2" qtz stringers and pyrite											
			END OF HOLE @ 150 FEET											

**DUPLICATE COPY
 POOR QUALITY ORIGINAL
 TO FOLLOW**

DRILL HOLE RECORD

HOLE NUMBER

79-1

COMPANY ORIANA
 PROPERTY ALCONA
 LOCATION Sioux Lookout
 JOB NO. ONTARIO

CO-ORDINATES _____
 TOTAL LENGTH _____
 EL. of COLLAR _____
 CORE SIZE _____

TESTS _____
 BRG. _____ CORRECTED _____
 DIP _____ CORRECTED _____

DATE DRILLED from _____ to _____
 LOGGED BY S. TAN, P. G. J.
 DATE _____

7901

FOOTAGE		RECOV. %	DESCRIPTION	SAMPLE NUMBER	Length	ANALYSIS								
from	to													
122	126		PORPHYRITIC BASALT: Black massive porphyry to 1/4" diameter. 5% pyrite dissemination											
126	131.5		SHEAR ZONE: Sheared basalt ca. 50° up to 10% py. dissem. Qtz. stringers to 1/4" every 2 feet parallel to shearing											
131.5	150		PORPHYRITIC BASALT: as in 122-126. @ 146-149: Qtz. stringer rich. @ 149', 2" Qtz. stringer and pyrite.											
			END OF HOLE @ 150 FEET ✓											

151

DRILL HOLE RECORD

HOLE NUMBER 79-2

COMPANY ORIANA DEV.
 PROPERTY ALCONA, SILIT. LK.
 LOCATION Sioux Lookout Ont.
 JOB NO 1 2 veins

CO-ORDINATES SEE MAP FOR LOCATION TESTS --
 TOTAL LENGTH 150 FEET
 EL. at COLLAR --
 CORE SIZE AQ

DATE DRILLED from NOV.12/79
 to NOV.13/79
 LOGGED BY S.Tan P.Eng.
 DATE Nov.15/79

FOOTAGE From	to	RECOV. %	DESCRIPTION	SAMPLE NUMBER	From to	ANALYSIS	
						feet	Au Ag
0	7		casing				
7	14		Andesite: porphyritic, phenocr(??) to 1/8" moderate omidirectional qtz stringers, 5% py dissem.	286	14	155	1.5
14	15.5		Shear Zone: ca.@80° about 40% quartz, chlorite minor py dissem	287	15.5	18	2.5
				288	18	22	4
15.5	18.0		QUARTZ VEIN (no. 2 vein) contacts at c.a. 85° grey quartz with 10% py and unodevate.(?) galena-sphalerite-pyrite narrow chlorite bands.	289	30	31.5	1.5
				290	31.5	34	2.5
				291	34	37	3.0
				292	37	116	1
18	30		Andesite (altered) greenwith abundant qtz stringers and patches. chloritized, silicified, minor pyrite dissemination @25.7-26.5; qtz vein ca. 45° and 20% py				
30	31.5		Quartz vein; milky quartz, 2 specks m.g. ga-py				
31.5	35.5		Shear zone: sheared andesite, silicified chloritized with up to 5% qtz stringers, 5% py dissem. 34-34.5: qtz veinlets ca. 80° mod. py, cpy.				
35.5	37		Andesite; massive, dk, green to black up to 20% qtz stringers e py. 64.5-65; shearing e ca. 50° 66-66.5; qtz veinlet @ 45° ca. with py				
68	87		Quartz Diorite: dk grey to black massive, f.g. with 5% f.g. to m.g. dissem. pyrite, minor qtz stringers . Contacts at ca. 85° 77-82 and 85-86; sheared andesite xenoliths.				
87	98.5		Andesite; as in 37-68				
98.5	108		Porphyritic Basalt; black, massive phenocrysts to 1"				
108	109.5		Quartz Ankerite: sugary textured, pinkish no sulphide, ca. 25°				

**DUPLICATE COPY
 POOR QUALITY ORIGINAL
 TO FOLLOW**

DRILL HOLE RECORD

HOLE NUMBER

79-2

COMPANY OPIMIA DEVELOPMENTS

CO-ORDINATES See Map for Location.

TESTS _____

DATE DRILLED

from Nov. 12/79

PROPERTY ALCONA SILTUK.

TOTAL LENGTH 150 FEET.

to Nov. 13/79

LOCATION Grey Lookout, Ont.

EL. of COLLAR _____

BRG 016°A CORRECTED _____

LOGGED BY

S.S. TAN, P. ENG.

NO. 1 22 VEINS

CORE SIZE

AQ

DIP -50° CORRECTED _____

DATE

Nov. 15, 1979.

FOOTAGE from	to	RECOV. %	DESCRIPTION	SAMPLE NUMBER	From Length	To	ANALYSIS		
							Fe ₂ O ₃	Fe	Ag
0	7		CASING.						
7	14		ANDESITE: porphyritic, phenocrysts to 1/8", moderate unidirectional quartz stringers, 5% py. dissem.	286	14	15.5	1.5	.003	0.06
14	15.5		SHEAR ZONE: c.a. @ 80°, about 40% quartz, chlorite, minor py. dissem.	287	15.5	18	2.5	0.048	0.35
				288	18	22	4	.005	0.01
15.5	18.0		QUARTZ VEIN (No. 2 VEIN), contacts at c.a. 85°. Grey quartz with 10% py and moderate galena-sphalerite-pyrite, narrow chlorite bands	289	30	31.5	1.5	0.003	0.03
				290	31.5	34	2.5	.003	0.02
				291	34	37	3.0	.003	0.06
				292	11.5	116	1	.003	0.01
18	30		ANDESITE (ALTERED), green, with abundant qt. stringers and patches chloritized, silicified, minor pyrite dissemination. a 25.7-26.5. Qt. vein c.a. 45°, and 20% py.						
30	31.5		QUARTZ G.W.: Milky quartz 2 specks m.g. 90-94						
31.5	35.5		SHEAR ZONE: sheared andesite, silicified chloritized with up to 50% qt. stringers, 5% py. dissem. 34-34.5. Qt. veinlet c.a. 80°, med. py. ep.						
35.5	37		MILKY MASSIVE QUARTZ: - m.c.a. 70° contacts, minor py.						
37	68		ANDESITE: massive, dk. green to black up to 20% qt. stringers & py. 64.5-65: shearing @ c.a. 50° 66-66.5: qt. veinlet @ 45° c.a. with py.						
68	87		QUARTZ-DIORITE: dk grey to black, massive, f.g. with 5% f.g. to m.g. dissem pyrite, minor qt. stringers. Contacts at c.a. 85°. 77-82 and 85-86, sheared andesite xenoliths.						
87	98.5		ANDESITE: - as in 37-68						
98.5	108		PORPHYRITIC BASALT: 5' thick, massive, phenocryst to 1/4"						
108	109.5		QUARTZ-ANDERITE: Sugary textured, pinkish no sulfide, c.a. 25°.						

S.S. Tan

DRILL HOLE RECORD

HOLE NUMBER 79-2

COMPANY ORIANA
 PROPERTY ALCONA
 LOCATION _____
 JOB NO _____

CO-ORDINATES _____
 TOTAL LENGTH 150 feet
 EL at COLLAR _____
 CORE SIZE _____

TESTS _____
 BRG. _____ CORRECTED _____
 DIP _____ CORRECTED _____

DATE DRILLED from _____ to _____
 LOGGED BY S. Tan
 DATE _____

FOOTAGE		RECOV %	DESCRIPTION	SAMPLE NUMBER	Length	ANALYSIS								
from	to													
109.5	111		Shear zone: about 40% qtz vein at , chloritized											
111	115		Porphyritic Basalt: as in 98.5-108											
115	116		Quartz Vein (no. vein) contacts ca. 85° massive quartz with one py-cpy-ga-sp stringer and py cube at centre											
116	150		PORPHYRITIC BASALT: As in 98.5-108 132-132.5 qtz veinlet, stained with 10% c.g. pyrite 137.5-138; ditto-											
			END OF HOLE 150 FEET											

**DUPLICATE COPY
 POOR QUALITY ORIGINAL
 TO FOLLOW**

DRILL HOLE RECORD

HOLE NUMBER

79-2

79-2

COMPANY ORIANA

CO-ORDINATES _____

TESTS _____

PROPERTY ALCONA

TOTAL LENGTH 150 Feet

DATE DRILLED from _____ to _____

LOCATION _____

EL. of COLLAR _____

ARG. _____ CORRECTED _____

LOGGED BY S. T. M. S. G. S.

JOB NO. _____

CORE SIZE _____

WIP _____ CORRECTED _____

DATE _____

FOOTAGE		RECOV. %	DESCRIPTION	SAMPLE NUMBER	Length	ANALYSIS				
from	to									
109.5	111		SHEAR ZONE - about 40% silicates, chloritized.							
111	115		PORPHYRITIC BASALT - as in 98.5-108							
115	116		QUARTZ VEIN (No. 1 VEIN). contacts e.a. 95°. massive quartz with one py-cpy-qa-sp stringer and py cubs at centre.							
116	150		PORPHYRITIC BASALT: - as in 98.5-108 132-132.5: - Qtz. veinlet, iron stained with 10% c.s. pyrid. 137.5-138 - ditto -							
			END OF HOLE 150 FT. ✓							

ST

DRILL HOLE RECORD

HOLE NUMBER 79-3

COMPANY ORIANA DEV.
 PROPERTY ALCONA-SPLIT LAKE
 LOCATION Sioux Lookout, Ont
 HRR NO 1 + 2 VEINS

CO-ORDINATES SEE MAP FOR LOCATION TESTS _____
 TOTAL LENGTH --
 EL. of COLLAR _____
 CORE SIZE AO

DATE DRILLED from Nov. 14/79
 to Nov. 15/79
 LOGGED BY S.S. TAN
 DATE NOV. 17/79

BRG. 0.16° Az CORRECTED _____
 DIP -50 CORRECTED _____

FOOTAGE		RECOV %	DESCRIPTION	SAMPLE NUMBER	Length			ANALYSIS	
from	to								
0	4		Casing						
4	24.8		Quartz Diorite: medium grained massive, ca. 35° @ 24.8'	293	35	38	3	.003	0.08
24.8	38		Andesite: dark green to black chloritized moderately 30-38; 30% qtz stringers with 5% pyrite.	294	38	41	3	.031	0.16
				295	108	113	5	.003	0.14
38	41		Vein Zone (no. 2 vein) qtz rich zone, 60% qtz, 5-10% py shearing at 75° cc. 39.5-39.7 grey qtz patches with minor cpy-py-ga 40.5-41; qtz veinlets with 10% py-cpy minor galena, 39.7-40.5; 70% bluish grey qtz with 20% py.	296	95	99	4	.018	0.31
				297	41	44	3	0.02	0.08
41	44		Andesite; sheared at 50° ca. with parallel qtz stringers						
44	80.5		Quartz diorite; medium grained, dark grey contacts at cc. 20° 63-64 silicified, 5-10% py quartz stringers.						
80.5	95		Andesite; as in 24.8-38 @ 83' 2" qtz c.a. 75° 82-83; sheared with qtz stringers 70° c.a.						
95	99		Vein Zone: qtz rich zone, 20% py qtz patches and stringers. 96.5-97 (no 1 vein) qtz veinlets ca. 85° with py-cpy-ga stringers 47-98.5 less silicified. 98-99; qtz rich 2" qtz veinlet with ga						
99	132		PORPHYRITIC BASALT: phenocryst to 1/2"; black massive @ 103; 1" qtz ca. 90° barren of sulphide. 108-113 f.g. qtz rich zone stringer and qtz patches up to 10% py dissem. 122.5-124 Shear zone with qtz veinlets, 10% py 1" qtz veinlet @ 123, 124 @ 90° ca.						
132	134		Quartz Diorite = as in 44 - 80 at 133'; 6" qtz						
134	150		Basalt; aphyritic, massive 5% cpy py dissem.						
			WNS OD HOLE 150 FEET						

**DUPLICATE COPY
 POOR QUALITY ORIGINAL
 TO FOLLOW**

DRILL HOLE RECORD

HOLE NUMBER **79-3**

DATE DRILLED from **10.14.79**
to **10.15.79**
LOGGED BY **S.S. TAN, P. ENG**
DATE **Nov 17, 1979**

COMPANY **ORIANA DEVELOPMENTS**
PROPERTY **ALCONA - SPLIT LAKE**
LOCATION **SIDNEY LOOKOUT, ONT**
NO. OF VEINS **1 & 2 VEINS**

CO-ORDINATES **See Map for location**
TOTAL LENGTH **150 FEET**
EL. of COLLAR **---**
CORE SIZE **AQ**

TESTS **---**
BRG. **0.16%** CORRECTED **---**
DIP **-50** CORRECTED **---**

FOOTAGE		RECOV. %	DESCRIPTION	SAMPLE NUMBER	FROM	TO	FT.	ANALYSIS	
from	to							Ca	Ag
0	4		CASING						
4	24.8		QUARTZ DIORITE: medium grained, massive, ca 35' @ 24.8'	293	35	38	3	0.003	0.08
24.8	38		ANDESITE: dark green to black chloritized moderately 30-38: 30% qb. stringers with 5% pyrite	294	38	41	3	0.032	0.16
38	41		VEIN ZONE (No 2 Vein) Qtz rich zone, 60% qb, 5-10% py shearing at 75°c. 35.5-39.7. Grey qb patches with minor cpy-py-qa. 40.5-41: qb veinlet with 10% py. cpy minor calc. 39.7-40.5: 70% bluish grey qb with 20% py	295	108	113	5	2013	0.14
				296	95	99	4	0.099	0.34
				297	41	44	3	0.02	0.08
41	44		ANDESITE: - sheared at 50°c a with parallel qtz stringers						
44	50.5		QUARTZ DIORITE: medium grained, dark grey contact at ca 20° 13-64: silicified 5-10% py. quartz stringers						
50.5	95		ANDESITE - as in 24.8-38. @ 82': 2' @ ca 75' 82-83: sheared with qb stringers 70°c A.						
95	99		VEIN ZONE: - Qtz rich zone 20% py qb patches (No 1 Vein) and stringers 35.5-37.5 qb veinlet ca 80° with py-qa stringers 37.5-38.5 less silicified 38-39: Qtz rich 2" veinlet with qa						
99	132		DIABASIC BASALT: intergrist 1/2"; black massive @ 103: 1" qb ca 50° barren of sulphide 108-113: f q qb rich zone stringers and qb patches up to 10% py dissem. 122.5-124: shear zone with qb veinlets, 10% py 1" qb veinlet @ 123, 124. @ 50°c a						
132	134		QUARTZ DIORITE: - as in 44-80 at 133': 6" qb						
134	150		BASALT: diabasic, massive, 5% cpy dissem.						
			END OF HOLE - 150 FEET						

S.S. Tan

DRILL HOLE RECORD

HOLE NUMBER

79-4

COMPANY ORIANA DEV.
 PROPERTY ALCONA -Split Lake
 LOCATION Sioux Lookout Ont.
 XXXX NO 1 + 2 VEINS

CO-ORDINATES SEE MAP LOCATION
 TOTAL LENGTH 150 feet
 EL. at COLLAR _____
 CORE SIZE AQ

TESTS --
 BRG 0.16° Az CORRECTED
 DIP 50° CORRECTED

DATE DRILLED from Nov. 16/79
to Nov. 17/79
 LOGGED BY S.S. TAN
 DATE Nov. 19/79

FOOTAGE		RECOV. %	DESCRIPTION	SAMPLE NUMBER	Length	ANALYSIS				
From	To									
0	27		casing- no core							
27	31.8		Andesite: dark green to black, chloritized fractures quartz healed. Abundant emidirectional qtz-ankerite stringers minor py dissemination.	7941	109	125	3.5	0.06	0.04	
31.8	60		Quartz Diorite: massive medium grained, contacts at ca. 50° @ 318' and 15° @ 60'. 42.5-45.5 chloritized andesite tenolith, @ 43'; 2" rose qtz no sulphides.	7942	112.5	114.7	2.2	0.14	0.12	
				7943	114.7	117.3	30	1.003	0.04	
60	64		Andesite: contacts ca. 15°, as in 27-31.8'							
64	87		Quartz Diorite: as in 31.8 Go, contacts ca 35° @ 87'							
87	112.5		Andesite fractured with qtz healed fractures @ 40° cc dark green, chloritized 5% py dissem. some cubes @ 89.8-91; f.g. qtz diorite dykelet ca. 25° @ 93.5; 1" white clear qtz. ca. 90° c.g.py cubes on walls 109.6-111; 10° py dissem and patches.							
112.5	114.7		Quartz vein (no 1 vein) contacts at 75° cc. milky qtz with hematitic fractures locally py=ga=cpy streaks and dissemination. @ 113.5; 1/2" heavy ga-py stringer and patches @ 113.5-114.7; 5% galena streaks and dissemination							
114.7	150		Basalt; massive black with about 10% qtz. stringers and patches minor py dissemination porphyritic from 146-150 feet. 135.5-136.5; qtz diorite dykelet cc. 10° 135.5 and 70° @ 136.5 @ 137; 1" milky qtz veinlet ca. 70° no sulphide @ 144; -ditto-							
			END OF HOLE 150 FEET							

**DUPLICATE COPY
 POOR QUALITY ORIGINAL
 TO FOLLOW**

DRILL HOLE RECORD

HOLE NUMBER

79-4

79-4

COMPANY ORIANA DEVELOPMENTS
 PROPERTY ALCONA - SPLIT LK.
 LOCATION SIBBY LOOKOUT, ONT.
 JOB NO. 12-2-VE-N3

CO-ORDINATES see location map.
 TOTAL LENGTH 150 FEET
 EL. of COLLAR ---
 CORE SIZE AQ

TESTS ---
 BRO. 0169 CORRECTED ---
 DIP -50° CORRECTED ---

DATE DRILLED from Nov. 16, 79
to Nov. 17, 79
 LOGGED BY S.S. TAN, P.G. 9
 DATE Nov. 19, 79

FOOTAGE from	to	RECOV. %	DESCRIPTION	SAMPLE NUMBER	ANALYSIS				
					From	To	Feet		
0	27		CASING - no core						
27	31.8		ANDESITE: dark green to black, chloritined, fracturing quartz healed. Abundant unidirectional qtz. submic stringers. minor py dissemination	7941	109	112.5	3.5	0.04	0.04
31.8	60		QUARTZ DIORITE: massive, medium grained, contacts at cass @ 31.8' and 15° @ 60'. qtz + ss chloritined andesite textural. cass: 2" recessed w/ sulf. in situ.	7942	112.5	117	2.2	0.142	0.63
				7943	114.7	117.7	3.0	0.003	0.06
60	64		ANDESITE: contacts ca 15° as in 27-31.8'						
64	87		QUARTZ DIORITE: - as in 31.8-60, contacts ca 35° @ 87'						
87	125		ANDESITE: fractured with qtz healed fractures; matrix dark green chloritined. Sp. py dissemin. some cubes 25.8-51.1: 2 a. of diorite intert ca 25° 29.3-37: 1" thick clear qtz. ca 90° ca 25° cubes above 16. 51.1-111: 15° py dissemin. and matrix						
125	150		DIORITE (1511 (100% 1/2)) contacts at 75° ca. matrix with some py dissemin. matrix coarse grained matrix and dissemination 31.8-125: heavy 20-30% disseminated matrix 125-150: 5% matrix disseminated dissemination						
150			DIORITE: massive, black with some 15% py dissemin. sand py dissemin. matrix py dissemination 125-150: 15% py dissemin. 125-150: 15% py dissemin. ca 10° py dissemin. 20° py dissemin. 125-150: 15% py dissemin. ca 10° py dissemin. 20° py dissemin. 125-150: 15% py dissemin. ca 10° py dissemin. 20° py dissemin.						
			END OF HOLE 150 FEET						

S.S. Tan

DRILL HOLE RECORD

HOLE NUMBER 79-5

COMPANY ORIANA DEV.
 PROPERTY ALCONA -Split Lk.
 LOCATION Sioux Lookout Ont.

CO-ORDINATES SEE MAP LOCATION
 TOTAL LENGTH 120 feet
 EL. at COLLAR --
 CORE SIZE AQ

TESTS --
 BRG. 016°Az CORRECTED ---
 DIP -50 CORRECTED ---

DATE DRILLED from Nov.18/79
to Nov.18/79
 LOGGED BY S.TAN
 DATE Nov.21/79

XXXXXXXXXX NO 1 + 2 veins

FOOTAGE		RECOV %	DESCRIPTION	SAMPLE NUMBER	Length	ANALYSIS			
from	to								
0	15		Casing - no core						
15	44		Andesite; dark green to black with chloritized and silicified sections Abundant qtz. reticulate stringers, mostly at 30° ca. lesser ankerite. Minor py dissem	298	41.5	44	2.5	10.003	0.01
			@19'; 2" qtz ankerite patch, @34'; 2" qtz patch 41-41.5; qtz ankerite patches/	299	44	45.3	1.3	0.03	0.2
				300	45.3	47.3	2.0	10.003	0.01
44	45.3		Quartz Vein: (no 2 vein) grey qtz. contacts 85° ca. 10% py stringers with moderate galena lesser cpy-sp	301	58	61	3.0	10.003	0.02
				302	61	63	2.0	0.26	0.82
45.3	60		Andesite; as in 15-44 with qtz stockwork. @ 52'; 1 1/2" qtz veinlet cc.85°, 56-58; 10% cg, py cubes @57'; 1" qtz with py-cpy-ga ca. 30°						
			59-60; sheared at 85° ca., coarse grained py @59.3; 1" white qtz. ca. 45°						
				Rock (Green)					Au 119
60	60.5		Quartz Veinlet; contacts c.a 85° white qtz hematite stained along fractures, minor cg py	501	15	20	5	410	0.1
				502	20	30	10	410	0.1
				503	30	41.5	11.5	410	0.1
60.5	61		Sheared andesite: silicified 40% qtz and ankerite.	504	47.3	58	10.7	10	0.1
61	63		Quartz Vein (No.1 vein) contacts at ca. 87° white massive qtz. @ 62.2; 2" band heavy galena py-cpy. @ 62.5-63 fractues with galena	505	63	70	7	410	0.1
				506	70	80	10	410	0.1
				507	80	90	10	410	0.1
63	115		Basalt; massive black abundant qtz. stringers minor f.g. py dissemination.	508	90	100	10	70	0.1
			@81'; 2" patch qtz-ankerite @84'; 1" white qtz veinlet ca. 90° @ 98'; 1" clear quartz ca. 90° 108-115 sheared greenish, schistose talcose.	509	100	110	10	20	0.1
				510	110	120	10	110	0.1
115	120		Porphyritic Basalt; phenocryst to 1/2", massive black about 5% py dissemination @117; 2" qtz ankerite veinlet ca. 90°						
			END OF HOLE 120 feet						

**DUPLICATE COPY
 POOR QUALITY ORIGINAL
 TO FOLLOW**

DRILL HOLE RECORD

HOLE NUMBER 79-6

COMPANY ORIANA DEV.
 PROPERTY ALCONA - SPLIT LK.
 LOCATION SIOUX LOOKOUT ONT
 JOB NO _____

CO-ORDINATES SEE MAP LOCATION
 TOTAL LENGTH 120 FEET
 EL. at COLLAR _____
 CORE SIZE AQ

TESTS _____
 BRG. 020°Az CORRECTED _____
 DIP -50 CORRECTED _____

DATE DRILLED from Nov. 19/79
 to Nov. 20/79
 LOGGED BY S.S.TAN
 DATE Nov. 24/79

FOOTAGE		RECOV. %	DESCRIPTION	SAMPLE NUMBER	Length	ANALYSIS			
from	to								
0	8		Casing						
8	12		Quartz Diorite; medium grained, massive with minor py dissemination. Qtz. healed hairline fractures every 2-3 feet. @ 27-27.5; qtz patch silicified. 41-42; silicified, pinkish secondary K-feldspar alteration.	7961	72	78	6	40.05	0.06
42	62.5		Andesite: dark green to black chloritized qtz stockwork to 30% OF CORE, MINOR PY @56. qtz patches, minor py	7962	78	84	6	40.05	0.02
62.5	84		Fault Breccia; contacts ca. 30° silicified angular massive and black breccia fragments to 1" qtz cement and stringers 5% f.g. dissem. pyrite. 72-78; 20% qtz stringers more py to 10% 81.5-84; bleached up to 10% f.g.py dissem.						
84	120		Quartz Diorite; massive black f.g. to m.g. contact @ 84' = 40° ca. 84-85.5; bleached chilled margin 107.5-108; dark green andesite xenolith 112-115; -ditto-						
			END OF HOLE 120 FEET	DUPLICATE COPY POOR QUALITY ORIGINAL TO FOLLOW					

DRILL HOLE RECORD

HOLE NUMBER

79-6

79-6

COMPANY ORIANA DEVELOPMENTS

CO-ORDINATES See Map Location (No. 3 UTM), TESTS _____

PROPERTY ALCANA - SPLIT LAKE

TOTAL LENGTH 120 feet

DATE DRILLED

from Nov. 19, 79

LOCATION Slony Lookout - QNT.

EL. of COLLAR _____

BRO. 020° Az. CORRECTED _____

LOGGED BY

S. TAN, P. GUY

JOB NO. _____

CORE SIZE AQ

DIP -50° CORRECTED _____

DATE

Nov. 24, 79.

FOOTAGE		RECOV. %	DESCRIPTION	SAMPLE NUMBER	ANALYSIS					
From	to				FROM	TO	FT.	As % Fe	As % Si	
0	8		CASING							
8	42		QUARTZ DIORITE: medium grained, massive with minor py dissemination. Qtz. healed hairline fractures every 2-3 feet. @ 27-27.5: Qtz. patch, silicified. 41-42: silicified, pinkish secondary K-feldspar alteration	7961	72	78	6	4.003	0.06	
42	62.5		ANDESITE:- dark green to black, chloritized, qtz stockwork to 30% of core. minor py @ 56. Qtz patches, minor py	7962	78	84	6	4.003	0.02	
62.5	84		FAULT BRECCIA: contacts ca 30°. silicified, angular mauve and black breccia fragments to 1", qtz cement and stringers. 5% f.g. dissem. pyrite. 72-78: 20% qtz stringers more py to 10%. 81-85: bleached up to 15% f.g. dissem.							
84	120		QUARTZ DIORITE: massive black f.g. to m.g. contact @ 84 = 40° c.a. 84-85.5: bleached f.g. chilled margin 107.5-108: dark green andesite xenolith 112-115: - ditto -							
			END OF HOLE 120 FT.							

S.S.P.

DRILL HOLE RECORD

HOLE NUMBER

79-7

COMPANY ORIANA DEV.
 PROPERTY ALCONA -SPLIT LK.
 LOCATION SIOUX LOOKOUT ONT.
 JOB NO _____

CO-ORDINATES SEE MAP LOCATION
 TOTAL LENGTH 120
 EL. at COLLAR _____
 CORE SIZE AQ

TESTS _____
 BRG. 020° CORRECTED _____
 DIP -50° CORRECTED _____

DATE DRILLED from NOV. 20/79
 to NOV. 21/79
 LOGGED BY S.S.TAN
 DATE NOV. 26/79

FOOTAGE from	to	RECOV %	DESCRIPTION	SAMPLE NUMBER	Length			ANALYSIS			
0	11		Casing								
11	55		Andesite; porphyritic, epidotized and chlorotized phenocryst to 1/2". Dark olive green, minor f.g. dissem. pyrite. Narrow chilled black silicified bands adjacent to qtz veinlets. @17.8'; 1" grey qtz ca. 45° @ 22-22.5; qtz. ca. 10° epidote minor py galena, 22.5-23.5; silicified black chilled 28.7; 1/2" qtz stringer ca. 90° epidote minor py	7971 7972	74 75	75 78	1.0 3.0	2.00 0.10	0.02 0.70		
55	57		Quartz Hornblende zone; ca. 80° contacts about 50% qtz stringers @90° ca. 10% f.g. dissem. py 3 white qtz veinlets 1/2" @ 55.5-56	Rock 701	56 11	57 20	10 9	1.00 1.10	0.10 0.1		
57	75		Andesite; as in 11-15 but more qtz-hornblende hairline stringers every 6" to 1' at core @70.5; 2" grey qtz py-cpy lesser galena ca. 60° epidote. 74-75; Quartz rich silicified up to 40% qtz stringers	702 703 704 705 706	20 30 40 50 55	30 40 50 55 57	10 10 10 5 2	1.10 1.10 1.10 1.10 1.00	0.1 0.1 0.1 0.1 0.1		
75	78		Quartz Vein (No 3 vein) contacts ca. 90° About 10% dissem. galena up to 15% py lesser cpy galena in a.g. cubes, stringers and patches Mostly qtz p on 75.5-76.8	707 708 709 710	57 67 78 82	67 74 82 90	10 7 4 8	1.10 1.10 1.10 1.10	0.1 0.1 0.1 0.1		
78	79		Andesite; porphyritic as in 57-75;	711	90	100	10	1.10	0.1		
79	82		Silicified andesite; dk green to black up to 40% of core in qtz stringers mostly at 90° ca. 10% py dissem. @79.6-80; rose qtz no sulphides ca. 40°	712 713	100 110	110 120	10 10	1.10 5.0	0.1 0.1		
82	117.8		PORPHYRITIC ANDESITE: as in 57-75; with local f.g. silicified and schistose bands @83.5-84 and 91.2-91.6 qtz stringer zone with 5% py qtz stringer every 2' of core								
117.8	120		CHLORITE SCHIST: contacts ca. 75° dark green soft.								
			END OF HOLE 120 FEET								

**DUPLICATE COPY
 POOR QUALITY ORIGINAL
 TO FOLLOW**

DRILL HOLE RECORD

HOLE NUMBER **79-7**

COMPANY ORIANA DEVELOPMENTS
 PROPERTY ALCONA - SPLIT LK.
 LOCATION SLONY LOOKOUT, ONT.
 JOB NO.

CO-ORDINATES See Map Location @ 2 (61N)
 TOTAL LENGTH 120
 EL. of COLLAR
 CORE SIZE AQ

TESTS
 BRO. 020A CORRECTED
 DIP -50° CORRECTED

DATE DRILLED from Nov. 26, 79
to Nov. 21, 79
 LOGGED BY S.S. TAN
 DATE Nov. 26, 79

FOOTAGE from	to	RECOV. %	DESCRIPTION	SAMPLE NUMBER	ANALYSIS				
					FUM	%	FT.	As ppm	Pb ppm
0	11		CASINGS.						
11	55		ANDESITE: porphyritic, epidotized and chloritized phenocryst to 1/4". Dark olive green, minor f.s. disse. pyrite. Narrow chilled black silicified bands adjacent to gte. veinlets. @ 17.8: 1" grey gte. c.a. 95° @ 22-22.5: gte. c.a. 10° epidote minor py. galena. 22.5-23.5: silicified, black chilled margin. 10% py disse. 26.5-27: gte. veinlet ca. 10° 28.7: 1/4" gte. stringer c.a. 90°. epidote minor py.	7971	74	75	1.0	11003	0.02
				7972	75	78	3.0	6042	0.76
55	57		QUARTZ-HORNBLende ZONE: c.a. 80° contacts, about 50% gte. stringer @ 90° c.a., 10% f.s. disse. py. 3 white gte. veinlets to @ 55.5-56.	Rock	Geochem.			As ppm	Pb ppm
				701	11	20	1	210	0.1
				702	20	30	10	210	0.1
57	75		ANDESITE: as in 11-15. but more gte. hornblende hail-like stringer every 6" to 1' of core @ 72.5: 2" grey gte. py-sph lesser galena c.a. 60°, epidote 74-75: Quartz rich, silicified, up to 40% gte. stringers	703	30	40	10	210	0.1
				704	40	50	10	210	0.1
				705	50	55	5	210	0.1
				706	55	57	2	160	0.1
				707	67	67	10	210	0.1
75	78		QUARTZ VEIN (No. 3 (61N)) contacts ca. 90°. about 10% disse. galena. up to 15% py. lesser sph. galena in a.g. cubes, stringers and patches. Mostly gte. from 75.5-76.8.	708	67	74	2	210	0.1
				709	78	82	4	210	0.1
				710	82	90	8	210	0.1
				711	90	100	10	210	0.1
78	79		ANDESITE: porphyritic as in 11-15.	712	100	110	10	210	0.1
79	82		SILICIFIED ANDESITE: dk. green to black. up to 40% of core is gte. stringers mostly at 90° c.a., 10% py disse. @ 79.6-80: 1/4" gte. no sulphide c.a. 40°	713	110	120	10	50	0.1
82	117.8		PORPHYRITIC ANDESITE: as in 57-75. with local f.s. silicified and schistose bands. @ 83.5-84 and 91.2-91.8 gte. stringer zone with 5% py. gte. stringer every 2' of core.						
117.8	120		EPIDOTITE SCHIST: contacts c.a. 75°, dark green soft.						

S.S. Tan

END OF HOLE 120 FEET

DRILL HOLE RECORD

HOLE NUMBER

79-8

COMPANY ORIANA DEV.
 PROPERTY ALCONA-SPLIT LK
 LOCATION SILOUX LOOKOUT ONT
 JOB NO _____

CO-ORDINATES SEE MAP LOCATION
 TOTAL LENGTH 150 FEET
 EL. at COLLAR _____
 CORE SIZE AQ

TESTS J
 BRG. 040°Az CORRECTED _____
 DIP -50 CORRECTED _____

DATE DRILLED from 22/11/79
 to 23/11/79
 LOGGED BY S.S.TAN
 DATE 26/11/79

FOOTAGE from	to	RECOV. %	DESCRIPTION	SAMPLE NUMBER	Length		ANALYSIS							
0	10		Casing											
10	58		Quartz Diorite: grey f.g. to m.g. massive with local greenish chloritized section. Qtz healed hairline fractures every 6-8" Minor py dissemination @15.5'; 1" qtz ca. 40° no sulphide, @17.5'; 1/2" qtz ca. 45° @ 25'; 1" qtz-biot patch no sulphide hairline fractures @ 35° to 90° every 1' @46'; 2" qtz biot. ca. 50° no sulphide 52-53.5; sheared qtz-ch ca. 75°											
58	59		Quartz Vein; and shearing at 70° ca. contacts. qtz-biot equal mixture. 58.4-58.6; grey qtz veinlet with py and lesser cpy. 1" heavy galena at 58.6'	7981	58	59	1.0	0.02	0.2					
				7982	96	99	3.0	0.04	0.14					
59	71.5		Quartz Diorite: medium grained, dark green chloritized and silicified qtz healed fractures every 6"- 1' mostly at 45° and 60° ca.											
71.5	80.6		Andesite: 10% py dissem. and stringers. Fracture, every 4"- 6" with c.g. py patches and qtz.											
80.6	96		Quartz Diorite: as in 59-71.5 qtz py healed fractures every 4-6" mostly at 70° cc.											
96	99		Quartz Vein (central vein): sheared contacts grounded core sheared mainly qtz. chlor(?) and ankerite with biotite specks up to 15% dissem. py 96-97 mostly grey qtz. with galena stringers at 60° ca.											
99	105		Andesite: contacts cc. 85° chloritized silicified qtz stringers											
105	121.3		andesite: porphyry; altered dk green to black minor py											
121.3	150		Andesite: contacts ca. 82° chloritized and silicified abundant qtz biot. stringers locally up to 10% py dissem.											
			END OF HOLE 150 FEET											

**DUPLICATE COPY
 POOR QUALITY ORIGINAL
 TO FOLLOW**

DRILL HOLE RECORD

HOLE NUMBER

79-8

COMPANY ORIANA DEVELOPMENTS

CO-ORDINATES See Map location (CENTRAL VEIN)

TESTS

DATE DRILLED

from 22/11/79

PROPERTY ALCONA-SPLIT LAKE

TOTAL LENGTH 150 FEET

to 23/11/79

LOCATION SIMX LOOKOUT, ONT.

EL. of COLLAR

BRG. 040° CORRECTED

LOGGED BY

26/11/79

JOB NO.

CORE SIZE

AQ

DIP -50° CORRECTED

DATE

5.1.79

FOOTAGE		RECOV. %	DESCRIPTION	SAMPLE NUMBER	ANALYSIS				
from	to				FROM	TO	FEET	Am 0.274	AQ 0.244
0	10		CASING						
10	58		QUARTZ DIORITE: grey, f.g. to m.g. massive with local greenish chloritized section. Qt. healed hairline fractures every 6"-8" Minor py dissemination. @ 15.5': 1" qtz, c.a. 40°, no sulphide, @ 17.5': 1/4" qtz ca. 45°, @ 25': 1" qtz-biot. patch, no sulphide. 40-58: Altered, chloritized, greenish, qt. healed hairline fractures @ 35° & 90° every 1'. @ 46': 2" qtz-biot. c.a. 50°, no sulphide. 52-53.5: sheared qtz-ch. c.a. 75°.						
58	59		QUARTZ VEIN: and shearing at 70° c.a. contacts. Qtz-biot equal mixture. 58.4-58.6: Grey qtz veinlet with py and lesser cpy. 1" heavy galena at 58.6'.	7981	58	59	1.0	0.02	0.2
				7982	96	99	3.0	0.046	0.14
59	71.5		QUARTZ DIORITE: medium grained, dark green chloritized and silicified. Qt. healed fractures every 6"-1" mostly at 45° and 60° c.a.						
71.5	80.5		ANDESITE: 10% py dissem. and stringers. Fractures every 4"-6" with c.g. py patches and qtz						
80.5	96		QUARTZ DIORITE as in 59-71.5, qtz-py healed fractures every 4"-6" mostly at 70° c.a.						
96	99		QUARTZ VEIN (CENTRAL VEIN): sheared, contacts grounded core, sheared mainly qtz chlorite andankerite with biotite specks. up to 15% dissem. py. 96-97 mostly grey qtz with galena stringers at 60° c.a.						
99	105		ANDESITE: contacts, c.a. 85°, chloritized silicified, qt. stringers.						
105	121.3		ANDESITE PORPHYRY: altered, dk green. to black, minor py						
121.3	150		ANDESITE: contacts, ca. 82°, chloritized and silicified abundant qtz-biot. stringers. locally up to 10% py dissem.						

END OF HOLE 150'

Page 1 of 1

**DUPLICATE COPY
POOR QUALITY ORIGINAL
TO FOLLOW**

DRILL HOLE RECORD

HOLE NUMBER 79-9

COMPANY ORIANA DEV.
PROPERTY ALCONA-SPLIT LK
LOCATION STOLIX LOOKOUT ONT
JOB NO _____

CO-ORDINATES SEE MAP LOCATION
TOTAL LENGTH 150 FEET
EL. of COLLAR _____
CORE SIZE A Q

TESTS _____
BRG. 040°Az CORRECTED _____
DIP -50 CORRECTED _____

DATE DRILLED from 23/11/79
to 24/11/79
LOGGED BY S. Tan
DATE 27/11/79

FOOTAGE from	to	RECOV %	DESCRIPTION	SAMPLE NUMBER	Length		ANALYSIS							
0	11.5		Casing											
11.5	27		QUARTZ DIORITE: massive, f.g. dk grey, chloritized 10% py dissem. Fractures every 4-6" mostly 50° ca. 15-225; medium grained bluish green more in base chloritization 5% py dissem. 22.5-27; finer grained	7991	90	82	2			1.003	0.01			
27	51		TALC-CHLORITE-QUARTZ SCHIST: contact ca. 10% soft talcose minor py. (0.46.96) (1.012.45) (19.3-97)	7992	92	94	2			0.005	0.00			
51	60		Quartz Diorite: black, f.g. massive minor py @51.5; 2" qtz ch veinlet ca. 15° with 20% py	7993	94	95	1			0.024	0.01			
				7994	95	97	2			1.149	0.04			
				7995	97	100	3			0.105	0.03			
60	92		Andesite: contacts ca. 20° greenish black abundant qtz stringers stockwork f.g. to c.g pyrite dissemination to 10%, 1" qtz veinlet with pyrite @ 60, 64, 79 and 83' cc 50°-90°, 90-92 sheared	7996	100	105	5			0.003	0.01			
				Peak	90	100	10							
92	97		Quartz Vein Zone: 92.. 92.5; brown qtz in shear at ca 82° with py 92.5-94; grey qtz 10% py galena dissemination	901	11.5	20	8.5			1.10	0.1			
			94-95; sheared black andesite with 50% qtz stringers and patches 20% py 95-97; mostly qtz vein 95-96.5;	902	20	30	10			1.10	0.1			
			white qtz 95-95.6; py patches lesser pyrrhotite and chalcopyrite - galena. 95.6-96.4; milky qtz	903	30	40	10			1.10	0.1			
			96.4-97; 80% grey qtz and biot 20% py	904	40	50	10			1.10	0.1			
				905	50	60	10			1.10	0.1			
				906	60	70	10			1.10	0.1			
97	105		Shear Zone: sheared andesite with qtz. stockwork shearing at 65° ca. 10% py 101.2-101.6; white qtz	907	70	80	10			1.10	0.1			
				908	80	90	10			1.10	0.1			
105	145		Andesite: contacts ca. 65° 105-113 dark green chloritized porphyry 5-10% py dissem. 113-117 massive ??? 10% py dissem and qtz veinlets 117-123; more	909	105	110	5			1.10	0.1			
				910	110	120	10			30	0.1			
				911	120	130	10			40	0.1			
			massive grey to dk green to 130' qtz stringers & py ca. 80° with qtz stringers.	912	130	140	10			10	0.1			
				913	140	150	10			30	0.2			
145	150		Quartz-mica schist; contact and schistosit- at 80° ca. minor py interbanded biot-chlorite and qtz.											
			END OF HOLE 150 FEET											

DRILL HOLE RECORD

HOLE NUMBER 79-9

79-9

COMPANY CELANA DEVELOPMENTS
 PROPERTY ALCONA - SPLIT LK.
 LOCATION Stony Lookout, Ont.
 JOB NO. _____

CO-ORDINATES See map location (CENTRAL VERM) TESTS _____
 TOTAL LENGTH 150 FEET
 EL. of COLLAR _____
 CORE SIZE AQ

DATE DRILLED from 2/11/79
 to 24/1/79
 LOGGED BY S. TAN
 DATE 27/1/79

FOOTAGE from	to	RECOV. %	DESCRIPTION	SAMPLE NUMBER	ANALYSIS					
					from	To	FT.	As AN	As OAT	
0	11.5		CASING.							
11.5	27		QUARTZ DIORITE: massive, f.g., dk. grey, chloritized. 10% py dissem. Fractures every 4"-6" mostly 50° c.a. 15-22.5: medium grained bluish green more intense chloritization. 5% py dissem. 22.5-27: finer grained	7991	90	92	2	0.003	0.01	
27	51		TALC-CHLORITE-QUARTZ SCHIST: contact c.a. 10', soft talcose minor py	7992	92	94	2	0.062	0.06	
51	60		QUARTZ DIORITE: black, f.g., massive, minor py. @ 51.5: 2" qtz-ch. veinlet c.a. 15° with 20% py	7993	94	95	1	0.024	0.01	
60	92		INDESITE: contacts c.a. 20'. greenish black abundant qtz. stringers-stockwork, f.g. to c.g. pyrite dissemination in 10% 1" qtz. veinlet with pyrite @ 60' 60' 79' and 83' c.a. 50° & 90° 90-92: sheared	7994	95	97	2	0.092	0.07	
92	92		QUARTZ VEIN ZONE: 92-92.5: Brown qtz in shear at c.a. 82° with mg. 92.5-94: Gray qtz. 10% py. galena dissemination 94-95: sheared black andesite with 50% qtz. stringers and patches 20% py. 95-97: mostly qtz. vein. 95-96.5: white qtz. 95-95.6: py patches lesser pyrrhotite and chalcopyrite-galena. 95.6-96.9: milky qtz 96.9-97: 80% grey qtz. and biot. 20% py	7995	97	100	3	0.005	0.02	
97	97		SHEAR ZONE: sheared andesite with qtz. stockwork shearing at 65° c.a. 10% py. 101.2-101.6: white qtz.	7996	100	105	5	0.003	0.01	
97	97		INDESITE: contacts c.a. 15'. 100-112 dark green, chloritized porphyritic. 5-70% py dissem. 113-117 massive epidinite 10% py dissem. and qtz. veinlets. 117-123: more massive grey to dk. green @ 130' qtz. stringer & py c.a. 80° 130-145: porphyritic, silicified sections, lesser py. 70 with qtz. stringers	901	115	20	85	10	0.1	
145	150		QUARTZ-BIOT SCHIST: contact and schistosity at 80° c.a. minor py. Interbedded biot-chlorite and qtz.	902	20	30	10	10	0.1	
				903	30	40	10	10	0.1	
				904	40	50	10	10	0.1	
				905	50	60	10	10	0.1	
				906	60	70	10	10	0.1	
				907	70	80	10	10	0.1	
				908	80	90	10	10	0.1	
				909	105	110	5	10	0.1	
				910	110	120	10	30	0.1	
				911	120	130	10	10	0.1	
				912	130	140	10	10	0.1	
				913	140	150	10	80	0.2	

0.046 Au
0.042 Ag
5.0'
(92-97')

S. Tan

END OF HOLE - 150 FT.

SIAM S. TAN, P.Eng.
CONSULTING & MANAGEMENT ENGINEER

310 - 1965 WEST EIGHTH AVENUE, VANCOUVER, CANADA. V6J 1W2. Phone (604) 736-0848

December 22, 1979.

President and Directors,
Oriana Developments Ltd.,
417-402 West Pender Street,
Vancouver, B.C.



52J04SE0025 52J04SE0011B1 ZARN LAKE

900

Dear Sirs:

During the period November 4th. to 30th. 1979, the writer supervised the diamond drilling program at your Alcona Mine property in the Split Lake area, sited about 21 Km. east-southeast of Sioux Lookout, Ontario. This program was recommended in the August 2, 1979 report by Ross Kidd, P.Eng.

Nine AQ sized holes totaling 1,260 feet were drilled to test the four known gold bearing quartz veins within the property. The results are discouraging since the drill hole vein intercepts did not encounter any economic grade gold values across mining width. Therefore, no further work is recommended for this property at this time.

DIAMOND DRILL HOLE DISTRIBUTION:

According to a 1936 assay plan by E.P.Sawyer, P.Eng., surface trench sampling returned an average of 0.39 oz.Au/ton across 1.46 feet in 350 feet length for the No.1 Vein and 0.31 oz.Au/ton across 1.65 feet in 235 feet length for the No.2 Vein. A total of 720 feet, in five short holes, were drilled at 50 feet to 100 feet spacing to test the No.1 and No.2 Vein. Holes 79-1 and 79-2 were spotted in the field by Mr. Ross Kidd, P.Eng., while holes 79-3, 79-4 and 79-5 were spotted by the writer in compliance with Mr. Kidd's drill site location plan. Both veins were intersected by Holes 79-2, 79-3 and 79-5. The failure of hole 79-1 to cut the No.1 Vein and hole 79-4 the No.2 Vein is attributed to post vein quartz diorite dykes disrupting vein continuity.

Holes 79-6 and 79-7, spaced 60 feet apart, were drilled to test the No.3 Vein. Drill hole 79-7 encountered a fault zone at the projected vein location while hole 79-8 did intersect the vein. Holes 79-8 and 79-9, at 60 feet apart, were drilled to test the Central Vein.

All holes were drilled at -50° . Holes 79-5, 79-6 and 79-7 were each 120 feet in length and the other holes were each 150 feet in length.

The drill hole location map, drill logs and assay certificates are appended to this report.

DRILL HOLE SAMPLE ASSAY RESULTS:

The vein intercepts are approximately true widths since all holes cut the veins at 5° to 8° from normal. The ensuing tabulation displays the assay



CHEMEX LABS LTD.

212 BROOKSBANK AVE
 NORTH VANCOUVER, B.C.
 CANADA V7J 2C1
 TELEPHONE 625-2200 971 0221
 AREA CODE 604
 TELEX 043 52597

• ANALYTICAL CHEMISTS • GEOCHEMISTS • REGISTERED ASSAYERS

CERTIFICATE OF ASSAY

TO: Oriana Developments
 417 - 402 W. Pender
 Vancouver, B.C.

CERTIFICATE NO. 67088
 INVOICE NO. 34222
 RECEIVED Nov. 29/79
 ANALYSED Dec. 6/79

ATTN:

SAMPLE NO. :	oz/ton Silver	oz/ton Gold	
286	0.06	0.003	
287	0.35	0.048	DH-2: #2 Vein: 15-5-18 = 2.5'
288	0.01	0.005	
289	0.02	< 0.003	
290	0.02	0.003	
291	0.06	0.003	
292	0.01	0.003	DH-2: #1 Vein: 115-116 = 1'
293	0.08	< 0.003	
294	0.16	0.037	DH79-3: #2 Vein: 38-41 = 3'
295	0.14	< 0.003	
296	0.34	0.098	79-3: #1 Vein: 95-99 = 4'
297	0.08	0.020	
298	0.01	< 0.003	
299	0.21	0.030	#2 Vein: 44-45.3 = 1.3
300	0.01	< 0.003	
301	0.02	< 0.003	
302	0.82	0.260	#1 Vein: 61-63 = 2'
7941	0.04	0.016	
7942	0.63	0.142	#1 Vein: 112.5-114 = 2.2'
7943	0.06	< 0.003	
7961	0.06	< 0.003	
7962	0.02	0.003	DH79-6
7971	0.02	< 0.003	
7972	0.76	0.042	#3 Vein: 75-78 = 3'

S.S. To

B. Stewart



MEMBER
 CANADIAN TESTING
 ASSOCIATION

REGISTERED ASSAYER, PROVINCE OF BRITISH COLUMBIA



CHEMEX LABS LTD.

217 BROOKSHANK AVE
 NORTH VANCOUVER, B.C.
 CANADA V7J 2C1
 TELEPHONE: (604) 261-6541
 AREA CODE 604
 TELEFAX 043 52501

• ANALYTICAL CHEMISTS • GEOCHEMISTS • REGISTERED ASSAYERS

CERTIFICATE OF ANALYSIS

TO: Oriana Dev. Ltd.
 417 - 402 W. Pender St.
 Vancouver, B.C.
 V6B 1T6

"ROCKS"

CERTIFICATE NO. 51750

INVOICE NO. 34139

RECEIVED Nov. 19/79

ANALYSED Dec. 3/79

ATTN:

SAMPLE NO. :	PPM	PPB
	Ag	Au
501	0.1	< 10
502	0.1	< 10
503	0.1	< 10
504	0.1	10
505	0.1	< 10
506	0.1	< 10
507	0.1	< 10
508	0.1	70
509	0.1	20
510	0.1	< 10
701	0.1	< 10
702	0.1	< 10
703	0.1	< 10
704	0.1	< 10
705	0.1	< 10
706	0.1	160

55/10



MEMBER
 CANADIAN TESTING
 ASSOCIATION

CERTIFIED BY:

D. F. [Signature]



CHEMEX LABS LTD.

210 BROOKSBANK AVE
 NORTH VANCOUVER B.C.
 CANADA V7J 2C1
 TELEPHONE 984-0221
 AREA CODE 604
 TELEX 043-52597

ANALYTICAL CHEMISTS GEOCHEMISTS REGISTERED ASSAYERS

CERTIFICATE OF ANALYSIS

TO: Oriana Dev. Ltd.
 217 - 402 W. Pender St.
 Vancouver, B.C.
 V6B 1T6

CERTIFICATE NO. 51815

INVOICE NO. 34352

RECEIVED Dec. 4/79

ANALYSED Dec. 18/79

ATTN:

SAMPLE NO.	PPM Ag	FPM Au
101	0.1	< 10
102	0.1	100
103	0.1	< 10
104	0.1	< 10
105	0.1	< 10
106	0.1	< 10
107	0.1	70
108	0.1	< 10
109	0.1	< 10
110	0.1	< 10
111	2.2	740
112	0.2	< 10
113	0.1	< 10
707	0.1	< 10
708	0.1	< 10
709	0.1	< 10
710	0.1	< 10
711	0.1	< 10
712	0.1	< 10
713	0.1	50
901	0.1	< 10
902	0.1	< 10
903	0.1	< 10
904	0.1	< 10
905	0.1	< 10
906	0.1	< 10
907	0.1	< 10
908	0.1	< 10
909	0.1	< 10
910	0.1	30
911	0.1	< 10
912	0.1	10
913	0.2	80

Also on Assay

PATRICIA
 MINING DIV.
 R E S I S T I V E D
 MAR - 6 1980
 AM 7:38 PM 7:38 PM 7:38 PM 7:38 PM

Handwritten signature

Handwritten signature

Geology

Zarr Lake
M-2222



ONTARIO

THE MINING ACT REPORT OF WORK

A separate form is required for each type of work to be recorded.

80-32

To the Recorder of Patricia Mining Division
name of Recorded Holder
Miner's Licence

Post Office Address

do hereby report the performance of 540 days of diamond drilling type of work

not before reported to be applied on the following contiguous claims

Claim No.	Days	Claim No.	Days	Claim No.	Days
436255	40	437166	40		
436256	40	437167	40		
436257	40	437168	40		
437163	40	437169	40		
437164	40	437170	40		
437165	40				

All the work was performed on Mining Claim (s) 436255, 436256 and 437170-436257 (In the case of geological and/or geophysical survey (s) where more than 18 claims are involved attach a schedule)

READ CAREFULLY: THE FOLLOWING INFORMATION IS REQUIRED BY THE MINING RECORDER.

- For Manual Work, Stripping or Opening up of Mines, Sinking Shafts or Other Actual Mining Operations - Names and addresses of the men who performed the work and the dates and hours of their employment.
- For Diamond and other Core Drilling - Footage, No. and angle of holes and diameter of core. Name and address of owner or operator of drill. Dates when drilling was done. Signed core log and sketch in duplicate.
- For Compressed Air or Other Power Driven or Mechanical Equipment Type of drill or equipment. Names and addresses of men engaged in operating equipment and the dates and hours of their employment.
- For Power Stripping - Type of equipment. Name and address of owner or operator. Amount expended. Dates on which work was done. Proof of actual cost must be submitted within 30 days of recording.
- With each of the above types of work sketches are required to show the location and extent of the work in relation to the nearest claim post. In the case of diamond or other core drilling the sketch must be submitted in duplicate.
- For Geophysical, Geological, Geochemical Surveys and Expenditure Credits - the name of author of report. Covering dates of survey (linecutting & office). Type of instrument used. Total amount of expenditure. Technical reports, maps, expenditure breakdown, receipts must be filed in duplicate with the Minister within 60 days of recording.
- For Land Survey - the name and address of Ontario Land surveyor.

The Required Information is as Follows: (Attach a list if this space is insufficient)

DIAMOND DRILLING: by AMALGAMATED DRILLING (Art Dungen), R.R.# 5, Thunder Bay, Ont. P7C 5M9
Date: Nov. 1, 1979 to Nov. 24, 1979.

Hole 79-1 = 150 feet ✓ 79-6 = 120 feet ✓
 79-2 = 150 feet ✓ 79-7 = 120 feet ✓
 79-3 = 150 feet ✓ 79-8 = 150 feet ✓
 79-4 = 150 feet ✓ 79-9 = 150 feet ✓
 79-5 = 120 feet ✓

AQ = 1-1/16 inch. core diameter
 All holes at -50° inclination.
 Total: 1,260 feet in 9 holes.

Performed 1110 days
Recorded 540 days
Balance 570 days

Date Feb 25/80 Signature of Recorded Holder or Agent

The Mining Act Certificate Verifying Report of Work

S. S. Tan
310 - 1965 West 8th. Ave., Vancouver, B.C. V6J 1W2
(Post Office Address)

PATRICIA MINING DIV. RECEIVED JUN - 3 1980

- hereby certify:
- That I have a personal and intimate knowledge of the facts set forth in the report to, having performed the work or witnessed same during or after its completion.
 - That the annexed report is true.

Dated December 22 19 79

RECEIVED MAR - 6 1980

Signature

Pa. 436251

THE PENALTY FOR MAKING A FALSE STATEMENT IN THIS REPORT AND/OR CERTIFICATE IS \$500. OR SIX MONTHS IMPRISONMENT OR BOTH

ZARN LK.

M. 2222

Zarn Lake

M-2222

32-80

(ROBT ROSENBERG)

SCALE: 1" = 4000'

502787	502791
502792	502790
502793	502794

PA	11496	(P)
PA	11494	(P)
PA	11495	(P)
PA	11500	(P)
PA	15177	(P)

