



52J04SE0553 31 DRAYTON

010

DIAMOND DRILLING

TOWNSHIP: DRAYTON TWP.

REPORT NO: 31

WORK PERFORMED FOR: Norlode Resources Inc.

RECORDED HOLDER: Same as Above [xx]
: Other []

<u>Claim No.</u>	<u>Hole No.</u>	<u>Footage</u>	<u>Date</u>	<u>Note</u>
816871	88-1	171'	Sept/88	(1)(2)
	88-2	280'	Sept/88	(1)(2)
	88-3	153'	Sept/88	(1)(2)
	88-4	148'	Sept/88	(1)(2)
	88-5	134'	Sept/88	(1)(2)
816870	88-6	161'	Sept/88	(1)(2)
816871	88-7	247'	Oct/88	(1)(2)

Notes: (1) #W8803.237, filed in Feb/89

(2) comparable to envp submission OM 88 3 (11)
date filed June/91

Diamond drill log
NORLODE RESOURCES INC.

PROPERTY : Northeast Bay
LOCATION : Island FP 61, Minnitaki L.,
Drayton Twsp., District of
Kenora, Ontario.
NTS: 52 J/4, Sioux Lookout,
346428
CLAIM NO. : Pa 816871
LATITUDE : 3+92' S 950' N & 65'E of
DEPARTURE : 23+84'W #3 P of 816871
DRILLED BY : Ferguson Mining Services
HOLE NO. : 88-1
DIP : 40°
BEARING : N 20° W
LENGTH : 171 ft.
STARTED : Sept 6, 1988
COMPLETED : Sept 7, 1988
LOGGED BY : H. Dowhaluk
MACHINE: : G-15 Winky
CORE SIZE : IAX, 1-3/8"

- 0 - 9.0 : OVERBURDEN. Casing.
- 9.0 - 20.0 : FELDSPAR PORPHYRY. Med gray. White plagioclase phenocrysts (25%) in a dark, f-grd groundmass of altered material containing hornblende, chlorite and feldspar. Phenos up to 5 mm, subhedral, tend to rectangular forms. Occasional qtz veinlets up to 1/2".
- 20.0 - 22.1 : GREENSTONE, POPRPHYRY. Altered zone. Some porphyry texture present in most of section, but a 1-inch seam runs more or less parallel to core which contains a 1/2" qtz veinlet associated with large lenses of cpy-py. A white egg-shaped patch of of qtz diorite over 2" long may be a clast.
- 22.1 - 29.5 : GREENSTONE. Dk green, massive, f-grd. Contains some porphyry in spots.
- 29.5 - 36.0 : FELDSPAR PORPHYRY. Contains some breccia fragments.
- 36.0 - 104.0 : GREENSTONE. Dk gray-green, f-grd, massive, andesitic. Fragments of porphyry, some rounded, in the greenstone. Considerable carbonate present as impregnation of greenstone, also lines (qtz-carb).
56.5-57.1: 4" mass of qtz blebs, lenses. Minor py, @35°.
65.1-65.6: Irregular streak of cpy @40°.
81.5-82.3: Qtz diorite.
Scattered nests of cpy to about 66 ft.
Black tourmaline crystals up to 1/2" long at contact with next. Tourmaline also occurs in the cpy nests.
- 104.0 - 128.5: DIORITE. Med to dk gray. Crse-med grd. Equigranular texture. Hornblende and plag. Grades into next.
- 128.5 - 171.0: GREENSTONE. As before. 5-10% qtz-carb lines, streaks @35°. Abundant carbonate content from 140 - 160

END OF HOLE - 171 ft.

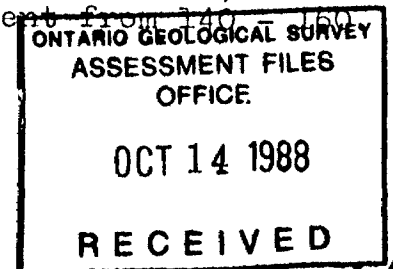
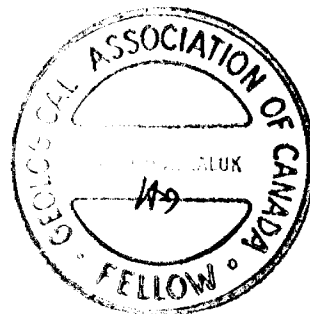

Ang Dowhaluk
Oct. 11, 1988

Diamond drill log

NORLODE RESOURCES INC

PROPERTY	: Northeast Bay	HOLE NO.	: 38-2
LOCATION	: Island FP 61, Minnitaki L., Drayton Twsp., District of Kenora, Ontario.	DIP	: 60°
	NTS: 52 J/4, Sioux Lookout, 846428	BEARING	: N 20° W
CLAIM NO.	: Pa 816871	LENGTH	: 280 ft.
LATITUDE	: 3+94 S 947' N & 67' E of	STARTED	: Sept. 8/88
DEPARTURE	: 23+83 W #3 P of 816371	COMPLETED	: Sept. 14/88
DRILLED BY:	Ferguson Mining Services	LOGGED BY	: H. Dowhaluk
		MACHINE	: G-15 Winky
		CORE SIZE	: IAX, 1-3/8"

- 0 - 10.1 : OVERBURDEN. Casing.
- 10.1 - 43.4 : GREENSTONE. Dk bluish-greenish gray, massive, f-grd to dense. Carbonatized.
10.5 - 14.3: (3.8 ft) Cpy, py in small streaks, or small aggregates generally w qtz-carbonate in small fractures. Frequent fine tourmaline. Feldspar porphyry patches less than a foot.
- 43.4 - 47.0 : FELDSPAR PORPHYRY. White phenocrysts of feldspar in greenstone matrix. Grades into next.
- 47.0 - 87.0 : GREENSTONE. Porphyritic greenstone (10% phenos) from 49.6 to 53. Faint foliation @ 30°. 76.8: 1" mass of po & cpy. Cpy streaks @ 35.0. Grades into next.
- 87.0 - 90.7 : FELDSPAR PORPHYRY. Very coarse-grd. Rectangular, subhedral white plag crystals up to 1/2" long in greenstone groundmass. Grades into next.
- 90.7 - 132.0 : GREENSTONE. Between 114 and 119 ft., 5% qtz-carb streaks and lenses @ 30° to 15°. Very gradational into next w small sections of felds porph for the last 3 feet.
- 132.0 - 138.3: FELDSPAR PORPHYRY. Distinct, or more often, indistinct sections of porphyry w small sections of greenstone up 4 or 5 inches.
- 138.3 - 139.8: GREENSTONE.
- 139.8 - 147.5: FELDSPAR PORPHYRY.
- 147.5 - 148.9: GREENSTONE. Some porphyry.
- 148.9 - 150.8: FELDSPAR PORPHYRY. Contact w next @ 30°.
- 150.8 - 154.0: GREENSTONE.
- 154.0 - 156.7: FELDSPAR PORPHYRY.
- 156.7 - 176.0: GREENSTONE. Contains small sections and patches of feldspar porphyry, waxing and waning.
- 176.0 - 186.8: FELDSPAR PORPHYRY. Greenstone matrix w white feldspar phenos. Grading into next.
- 186.8 - 188.5: GREENSTONE. At 186.8, 2 flat plates of native copper? about 2 mm in size. Soft, sectile. Coppery colour, but very golden yellow in some lights when first observed, gradually becoming more coppery.

continued

W. J. Dowhaluk
Dec. 11, 1988

NORLODE RESOURCES INC.

DDH: 88-2

- 188.5 - 207.0: PORPHYRITIC GREENSTONE. Greenstone w scattered large phenos of feldspar up to 1" long. Contact wiyh above at 35°.
- 207.0 - 238.0: DIORITE. Med gray, med-grd, massive, compact, sugary texture.
- 238.0 - 280.0: FELDSPAR PORPHYRY. Amount of phenocrysts variable.
276.5-278.3: over 50% phenos.
@245, 2" qtz; @276, 2" qtz diorite dikelet.

END OF HOLE - 280 ft

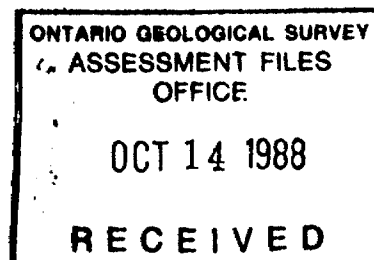

Mary Dunlop
Oct. 11, 1988

diamond drill log

NORLODE RESOURCES INC.

PROPERTY : Northeast Bay
 LOCATION : Island FP 61, Minnitaki L.,
 Drayton Twsp., District of
 Kenora, Ontario.
 NTS: 52 J/4, Sioux Lookout,
 846428
 CLAIM NO. : Pa 816371
 LATITUDE : 3+92 S 950' N & 62'E of
 DEPARTURE : 23+87 W #3 P of 816371
 DRILLED BY: Ferguson Mining Services

HOLE NO. : 88-3
 DIP : 40°
 BEARING : Due West
 LENGTH : 153 ft.
 STARTED : Sept. 14/88
 COMPLETED : Sept. 16/88
 LOGGED BY : H. Dowhaluk
 MACHINE : G-15 Winky
 CORE : IAX, 1-3/8"

- 0 - 9.0 : OVERBURDEN. Casing.
 9.0 - 10.5 : GREENSTONE. Greenish gray. Massive.
 10.5 - 13.7 : FELDSPAR PORPHYRY. Greenstone matrix w small (2-3 mm)
 white feldspar phenocrysts. Few qtz veinlets
 up to 1/2".
 13.7 - 45.5 : GREENSTONE. Greenish-bluish gray. Some flow breccia.
 Occasional qtz stringers 1/8 - 1/2" mostly at 45°. Grades into next. Up to 3% fine sulphides in places,
 i.e., 17 - 18 ft.
 45.5 - 65.0 : FELDSPAR PORPHYRY. Small phenocrysts up to 50.5,
 then larger, more prominent phenos.
 65.0 - 76.0 : GREENSTONE. Poorly defined patches of feldspar
 porphyry. Scattered zones of heavy sulphides up
 to 20% cpy, py, po. Best section from 75.4 to 75.8
 w 50% cpy, py. Fine, black tourmaline needles
 associated w cpy nests.
 76.0 - 79.0 : FELDSPAR PORPHYRY.
 79.0 - 82.0 : GREENSTONE.
 82.0 - 89.2 : FELDSPAR PORPHYRY.
 89.2 - 95.6 : GREENSTONE. 1" lens of cpy-py at 90.0 ft. 1/2" bleb of
 cpy-py at 95.6.
 95.6 - 97.6 : FELDSPAR PORPHYRY. Graphite on slip at 95.6.
 97.6 - 112.7 : GREENSTONE. Abundant inclusions of feldspar porphyry;
 some appear to be clasts. Streaks and zones of
 sulphides (cpy, py) and tourmaline needles at
 97.7, 100.0, 101.1, 101.7 - 102.3, 103.6, 104.1,
 104.8, 106.5, 108.3-109.7, 112.2, 112.7.
 112.7 - 115.0: FELDSPAR PORPHYRY.
 115.0 - 119.0: GREENSTONE. With scattered patches of feldspar porph.
 Sulphides at 118.9.
 119.0 - 121.8: FELDSPAR PORPHYRY. Small but abundant wh feldspar
 phenocrysts.
 121.8 - 126.0: GREENSTONE.
 126.0 - 132.0: FELDSPAR PORPHYRY.

ONTARIO GEOLOGICAL SURVEY
 ASSESSMENT FILES
 OFFICE

OCT 14 1988

RECEIVED

(continued)

H. Dowhaluk
 Oct. 11, 1988

- 132.0 - 135.0 : GREENSTONE. Dk green-gray. Massive. Contact with
above at 35°.
- 135.0 - 147.0 : DIORITE. Green-gray. Med-grd. Equiangular, massive.
- 147.0 - 150.7 : GREENSTONE. Massive.
- 150.7 - 153.0 : FELDSPAR PORPHYRY.

END OF HOLE - 153 ft.



John D. ...
Oct. 11, 1988

Diamond drill log

NORLODE RESOURCES INC

PROPERTY : Northeast Bay
LOCATION : Island FP 61, Minnitaki L.,
Drayton Twsp., District of
Kenora, Ontario.
NTS: 52 J/4, 'Sioux Lookout'
346428
CLAIM NO. : Pa 816871
LATITUDE : 4+00 S 942'N & 58'E of
DEPARTURE : 3+38 W #3 P of 316871
DRILLED By: Ferguson Mining Services

HOLE NO. : 88-4
DIP : 45°
BEARING : S 50° E
LENGTH : 148 ft.
STARTED : Sept. 18/88
COMPLETED : Sept. 21/88
LOGGED BY : H. Dowhaluk
MACHINE : G-15 Winkie
CORE SIZE : IAX, 1-3/8"

0 - 9.0 : OVERBURDEN. Casing.
9.0 - 17.7 : GREENSTONE. Dk gray-green. F-grd, massive. Grades
into next. Contains a 3" syenite dikelet, pink.
17.7 - 22.5 : FELDSPAR PORPHYRY. Abundant 1/4" white plag phenos
in greenstone groundmass. Grades into next.
22.5 - 40.0 : GREENSTONE. As above, massive. Some felsitic vein-
lets @ 30° @ 23.5, 24.0-24.6. Some scattered qtz
lenses @ 35 to 45°.
40.0 - 78.0 : DIORITE. Med-gray, f-grd, equigranular.
48.7-49.5, 50.8-55.0: Pink felsite dikelet in
part of, and parallel, to core.
78.0 - 80.0 : GREENSTONE. Massive. Some qtz blebs, lenses. 1-2% py.
80.0 - 97.5 : DIORITE. Med green-gray. Variable texture from
med-grd to crse-grd, slightly porphyritic in
places. Few 1/2" syenite dikelets up to 1".
97.5 - 116.3 : DIORITE. Med-lt gray, med-crse-grd, uniformly grained.
116.3 - 119.3: FELDSPAR PORPHYRY. 15% phenos, indistinct, in green-
stone groundmass.
119.3 - 121.0: GREENSTONE. Massive.
121.0 - 148.0: DIORITE. Lt-coloured, over 60% plag, rest mostly
hornblende. Crse-grd, uniformly-grd.

END OF HOLE - 148 ft

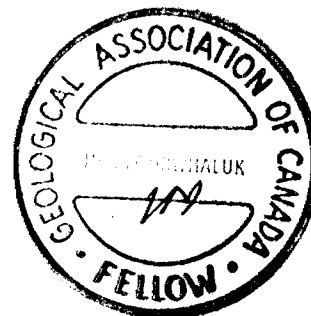
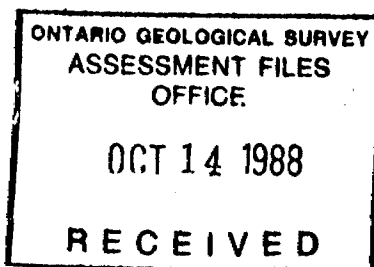

H. Dowhaluk
Oct. 11, 1988

Diamond drill log

NORLODE RESOURCES INC

PROPERTY	: Northeast Bay	Hole No.	: 88-5
LOCATION	: Island FP 61, Minnitaki L., Drayton Twsp., District of Kenora, Ontario.	DIP	: 45°
	NTS: 52 J/4, 'Sioux Lookout'. 846428	BEARING	: S 50°E.
CLAIM	: Pa 816871	LENGTH	: 134 ft.
LATITUDE	: 4+46 S 896' N and 39' W of	STARTED	: Sept. 23/88
DEPARTURE	: 24+88 W #3 P of 816871	COMPLETED	: Sept. 25/88
DRILLED BY	: Ferguson Mining Services	LOGGED BY	: H. Dowhaluk
		MACHINE	: G-15 Winkie
		CORE SIZE	: IAX, 1-3/8"

0 - 5.0 : OVERBURDEN. Casing.

5.0 - 23.0 : GREENSTONE. Med greenish gray, massive. Contact w next @ 60°.

23.0 - 36.8 : FELDSPAR PORPHYRY. Greenish gray w small (1-2 mm) white feldspar phenocrysts, (30%).

36.8 - 40.8 : GREENSTONE. Few patches of felds porph. Three 1/2" qtz-carb lenses towards end @ 45°.

40.8 - 53.8 : FELDSPAR PORPHYRY. Abundant phenos up to 4 mm.

53.8 - 54.6 : QUARTZ VEIN. Wh, glassy qtz @ 65°.

54.6 - 67.5 : DIORITE. Med gray, med-grd.
59.4-59.6: Wh qtz (3").
63.5 - 63.9: Qtz @ 45°
3/4" qtz @ 65.5; 1 1/2" qtz @ 66.0 @ 45°.

67.5 - 78.2 : GREENSTONE. Dk green-gray. Massive. Occasional qtz-carb veining, 1/2".

78.2 - 93.0 : DIORITE. Med-grd. Med to dk gray (darker towards ends Grades imperceptably into next.

93.0 - 95.8 : GREENSTONE. Dk green-gray, f-grd to dense, massive. Schistose towards next.

95.8 - 97.6 : FELDSPAR PORPHYRY.

97.6 - 98.5 : GREENSTONE. Gradational boundaries.

98.5 - 99.7 : FELDSPAR PORPHYRY.

99.7 - 134.0 : GREENSTONE. Greenish gray, massive, f-grd to dense.

END OF HOLE - 134 ft.

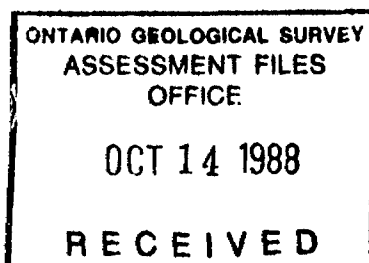

H. Dowhaluk
Oct. 11, 1988

Diamond drill log

NORLODE RESOURCES INC

PROPERTY	: Northeast Bay	HOLE NO.	: 88-6
LOCATION	: Island FP 61, Minnitaki L., Drayton Twsp., District of Kenora, Ontario.	DIP	: 45°
	NTS: 52 J/4, 'Sioux Lookout' 846428	BEARING	: N 50° W
CLAIM	: Pa 816870	LENGTH	: 161 ft.
LATITUDE	: 4+50 S 896' N & 39' W of	STARTED	: Sept. 26/88
DEPARTURE	: 24+84 W #2 P of 816870	COMPLETED	: Sept. 28/88
DRILLED BY:	Ferguson Mining Services	LOGGED BY	: H. Dowhaluk
		MACHINE	: G-15 Winkie
		CORE SIZE	: IAX, 1-3/8"

0 - 4.5 : OVERBURDEN. Casing.

4.5 - 9.0 : GREENSTONE. Med green-gray. F-grd.

9.0 - 17.5 : SAND SEAM. Casing.

17.5 - 39.3 : GREENSTONE. As above.

39.3 - 49.3 : FELDSPAR PORPHYRY. 25% white feldspar phenocrysts
in greenstone matrix.

49.3 - 51.0 : GREENSTONE.

51.0 - 52.3 : FELDSPAR PORPHYRY.

52.3 - 61.0 : DIORITE. Med gray, med-grd, anhedral texture.
Grades into next imperceptibly.

61.0 - 71.7 : GREENSTONE. As above. Some cleavage at 45°.

71.7 - 113.2 : FELDSPAR PORPHYRY. Contains abundant qtz as elongated
or rounded blebs, very short lenses. Qtz is
often smoky (black). Minor py. Much of it contains
greenstone (volcanic) in small sections suggest-
ing that lava flowed between clasts of porphyry.

113.2 - 119.2 : GREENSTONE. Reverse of above, mostly greenstone.
w a few porphyry clasts, sections.

119.2 - 122.0 : FELDSPAR PORPHYRY.

122.0 - 124.7 : DIORITE. Whitish, lt-coloured, very crse-grd.
Wh plag and hornblende.

124.7 - 127.7 : GREENSTONE. Some porphyry clasts up to 3". Grading
into next.

127.7 - 131.0 : FELDSPAR PORPHYRY. Grades into next.

131.0 - 139.0 : GREENSTONE. Some porphyry clasts and small sections.

139.0 - 142.3 : FELDSPAR PORPHYRY.

142.3 - 151.5 : GREENSTONE. Some porphyry clasts. Grades into next.
Some cleavage at 30°.

151.5 - 161.0 : FELDSPAR PORPHYRY. Some small greenstone sections.

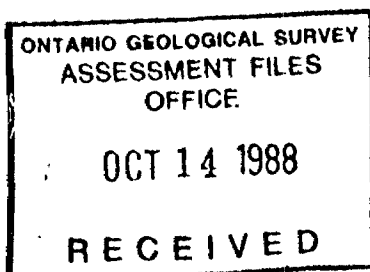

END OF HOLE - 161 ft.



Diamond drill log

NORLODE RESOURCES INC

PROPERTY	: Northeast Bay	HOLE NO.	: 88-7
LOCATION	: Island FP 61, Minnitaki L., Drayton Twsp., District of Kenora, Ontario.	DIP	: 45°
	NTS: 52 J/4, 'Sioux Lookout'	BEARING	: N 50° W
	846428	LENGTH	: 247 ft.
CLAIM NO.	: Pa 846428	STARTED	: Sept. 30/88
LATITUDE	: 3+92 S 950' N & 180' E of	COMPLETED	: Oct. 6/88
DEPARTURE	: 22+70 W #3 P of 846428	LOGGED BY	: H. Dowhaluk
DRILLED BY:	Ferguson Mining Services	MACHINE	: G-15 Winkie
		CORE SIZE	: IAX, 1-3/8"

- 0 - 3.0 : OVERBURDEN. Casing.
- 3.0 - 19.0 : QUARTZ DIORITE. Crse-grd. White plag (60%) w hornblende & chlorite (30%), up to 10% qtz. Persists as clasts beyond 19.0 ft. in the greenstone below.
- 19.0 - 44.0 : GREENSTONE. Breccia fragments of above gradually decreasing in abundance, some clasts are porphyritic.
37.2 - 39.0: Feldspar porphyry.
35.8 - 36.6: 1-2% py
Contact w next @ 30'.
- 44.0 - 46.3 : FELDSPAR PORPHYRY.
- 46.3 - 49.6 : GREENSTONE. Dk blue-green-gray. Massive, dense to f-grd.
- 49.6 - 85.0 : FELDSPAR PORPHYRY. 25% wh felds phenos of several sizes up to 3 mm.
- 85.0 - 88.0 : GREENSTONE. Abundant large clasts up to 5" in diameter (irregular shaped breccia in first two feet, then more sparsely some smaller pieces.
95.2 - 96.9: (1.7') Several nests of cpy. No qtz or apparent fractures.
90.3: Cpy, minor.
- 88.0 - 112.3 : FELDSPAR PORPHYRY. Some of this material continues into next as vague patches. Grades into next.
- 112.3 - 130.0: GREENSTONE.
112.8 - 116.7: Frequent cpy.
127.5: Minor cpy.
129.0-130.0: Heavy cpy.
- 130.0 - 144.0: GREENSTONE. Dk green-gray. Contains a few scattered white feldspar phenocrysts, small & indistinct. Also black grains of hornblende (2 mm). Some acicular black hornblende in spots. Contact w next quite sharp at 45°.
- 144.0 - 146.8: FELDSPAR PORPHYRY. Large, conspicuous wh feldspar phenocrysts. Grades into next.

ONTARIO GEOLOGICAL SURVEY
ASSESSMENT FILES
OFFICE

OCT 14 1988

RECEIVED

Continued

Harry Dowhaluk
OCT 11, 1988

Norlode Resources Inc.

DDH: 88-7

- 146.8 - 158.8: GREENSTONE. As above w a few inconspicuous phenocrysts of white feldspar, also clasts of feldspar porphyry. Small black grains of hornblende?. Massive and dense flow after 149.5. Indistinct contact w next at about 45°.
- 158.8 - 179.0: FELDSPAR PORPHYRY. Grades into next.
- 179.0 - 230.0: GREENSTONE. Small amounts of porphyritic material (sparse & indistinct).
- 183.7 - 184.9: Contains a few specks of silvery material (molybdenite?). Some bundles of black tourmaline needles.
- 230.0 - 247.0: FELDSPAR PORPHYRY. Somewhat lightly speckled w white feldspar phenocrysts.

END OF HOLE - 247 ft.

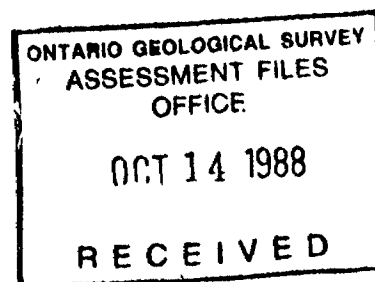

Harry Dowhaluk
Oct. 11, 1988

816870

816871

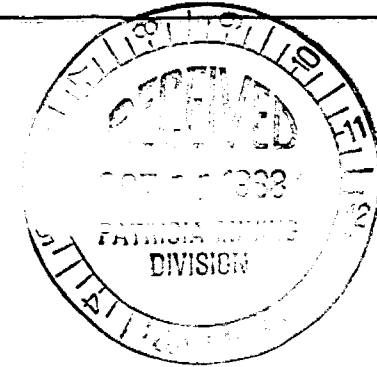

ONTARIO GEOLOGICAL SURVEY
ASSESSMENT FILES
OFFICE
OCT 14 1988
RECEIVED

LAKE

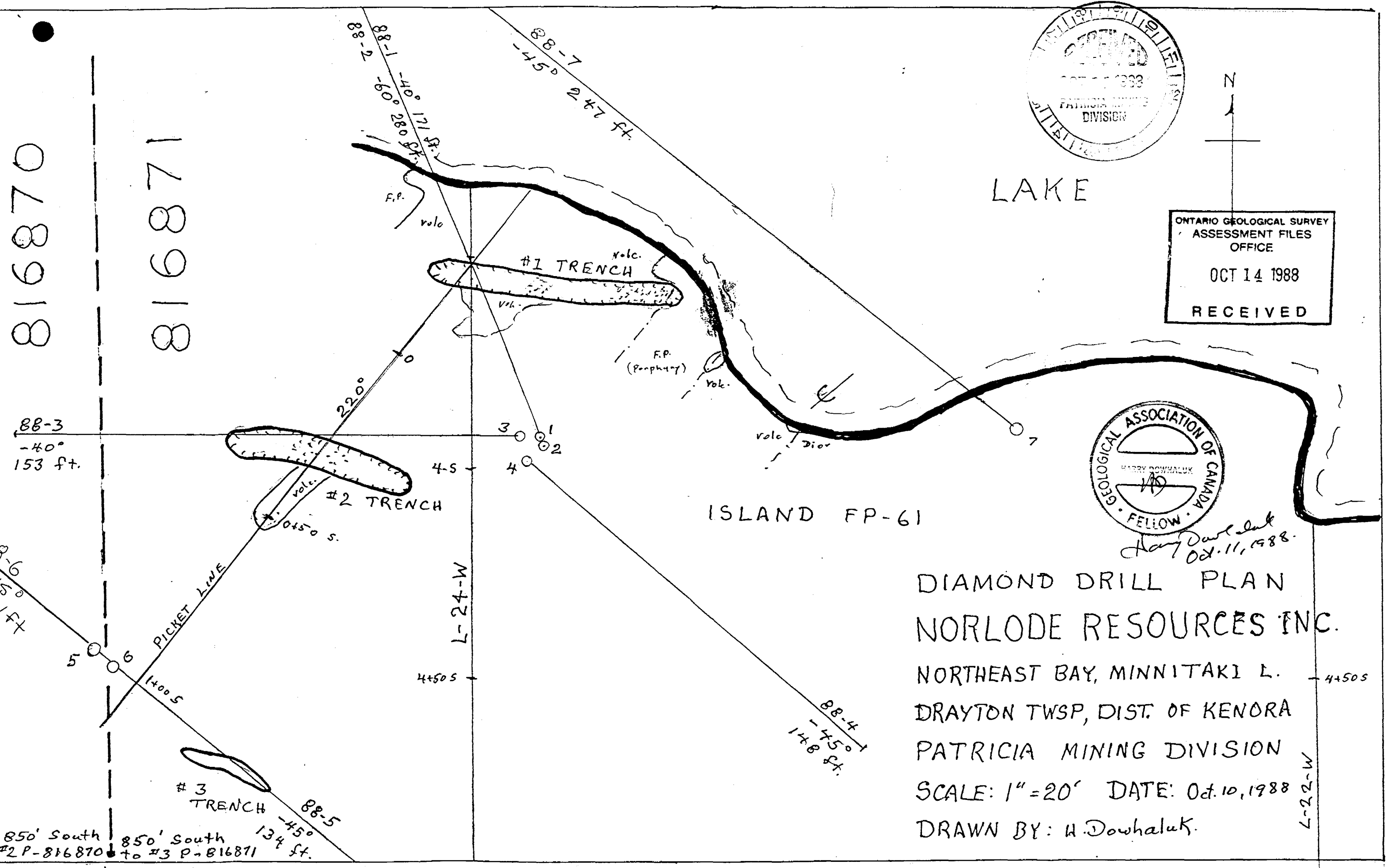

Harry Dowhaluk
Oct. 11, 1988

ISLAND FP-61

DIAMOND DRILL PLAN
NORLODE RESOURCES INC.

NORTHEAST BAY, MINNITAKI L. 4+505

DRAYTON TWSP, DIST. OF KENORA

PATRICIA MINING DIVISION

SCALE: 1"=20' DATE: Oct. 10, 1988

DRAWN BY: H. Dowhaluk.

L-22-W

850' South to #2 P-816870
850' South to #3 P-816871



Ontario Assess Lib

Mining Act



52J04SE0553 31 DRAYTON

900

Name and Postal Address of Recorded Holder
NOLODE RESOURCES INC
BOX 2038, 20 EGLINGTON AVE. W., TORONTO, ONT. M4R 1K8

Summary of Work Performance and Distribution of Credits
DRAYTON TWP. G-3379

Total Work Days Cr. claimed 1,294	Mining Claim			Mining Claim			Mining Claim		
	Prefix	Number	Work Days Cr.	Prefix	Number	Work Days Cr.	Prefix	Number	Work Days Cr.
for Performance of the following work. (Check one only)	Pa	816870	219						
		816871	215						
		816872	215						
		816873	215						
		816874	215						
		816875	215						

- Manual Work
- Shaft Sinking Drifting or other Lateral Work.
- Compressed Air, other Power driven or mechanical equip.
- Power Stripping
- Diamond or other Core drilling
- Land Survey

Patricia
RECORDED

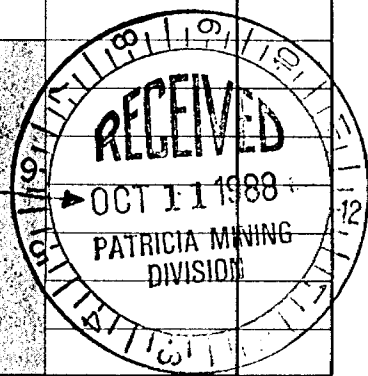

All the work was performed on Mining Claim(s): **816870, 816871**

Required Information eg: type of equipment, Names, Addresses, etc. (See Table Below)

Diamond Drill Holes

88-1	-40°	171 ft.	Drilled by Ferguson Mining Services Matachewan, Ont. POKIMO
88-2	-60°	280	
88-3	-40°	153	
88-4	-45°	148	
88-5	-45°	134	
88-6	-45°	161	
88-7	-45°	247	

Drilling in period:
Sept. 6 - Oct. 6, 1988

CORE SIZE: IAX, 1 3/8"

MACHINE: G-15 Winkie

Total 1,294

ONTARIO GEOLOGICAL SURVEY
 ASSESSMENT FILES OFFICE

OCT 14 1988

Date of Report: **Oct. 10, 1988**
 Recorded Holder or Agent (Signature): *Harry Dowhaluk*

Certification Verifying Report of Work **RECEIVED**

I hereby certify that I have a personal and intimate knowledge of the facts set forth in the Report of Work annexed hereto, having performed the work or witnessed same during and/or after its completion and the annexed report is true.

Name and Postal Address of Person Certifying
HARRY DOWHALUK, Box 118, TAMWORTH, ONT. K0K3G0

Date Certified: **Oct. 10, 1988**
 Certified by (Signature): *Harry Dowhaluk*

Table of Information/Attachments Required by the Mining Recorder

Type of Work	Specific information per type	Other information (Common to 2 or more types)	Attachments
Manual Work	Nil	Names and addresses of men who performed manual work/operated equipment, together with dates and hours of employment.	Work Sketch: these are required to show the location and extent of work in relation to the nearest claim post.
Shaft Sinking, Drifting or other Lateral Work			
Compressed air, other power driven or mechanical equip.	Type of equipment	Names and addresses of owner or operator together with dates when drilling/stripping done.	
Power Stripping	Type of equipment and amount expended. Note: Proof of actual cost must be submitted within 30 days of recording.		
Diamond or other core drilling	Signed core log showing; footage, diameter of core, number and angles of holes.	Nil	Work Sketch (as above) in duplicate
Land Survey	Name and address of Ontario land surveyer.		Nil

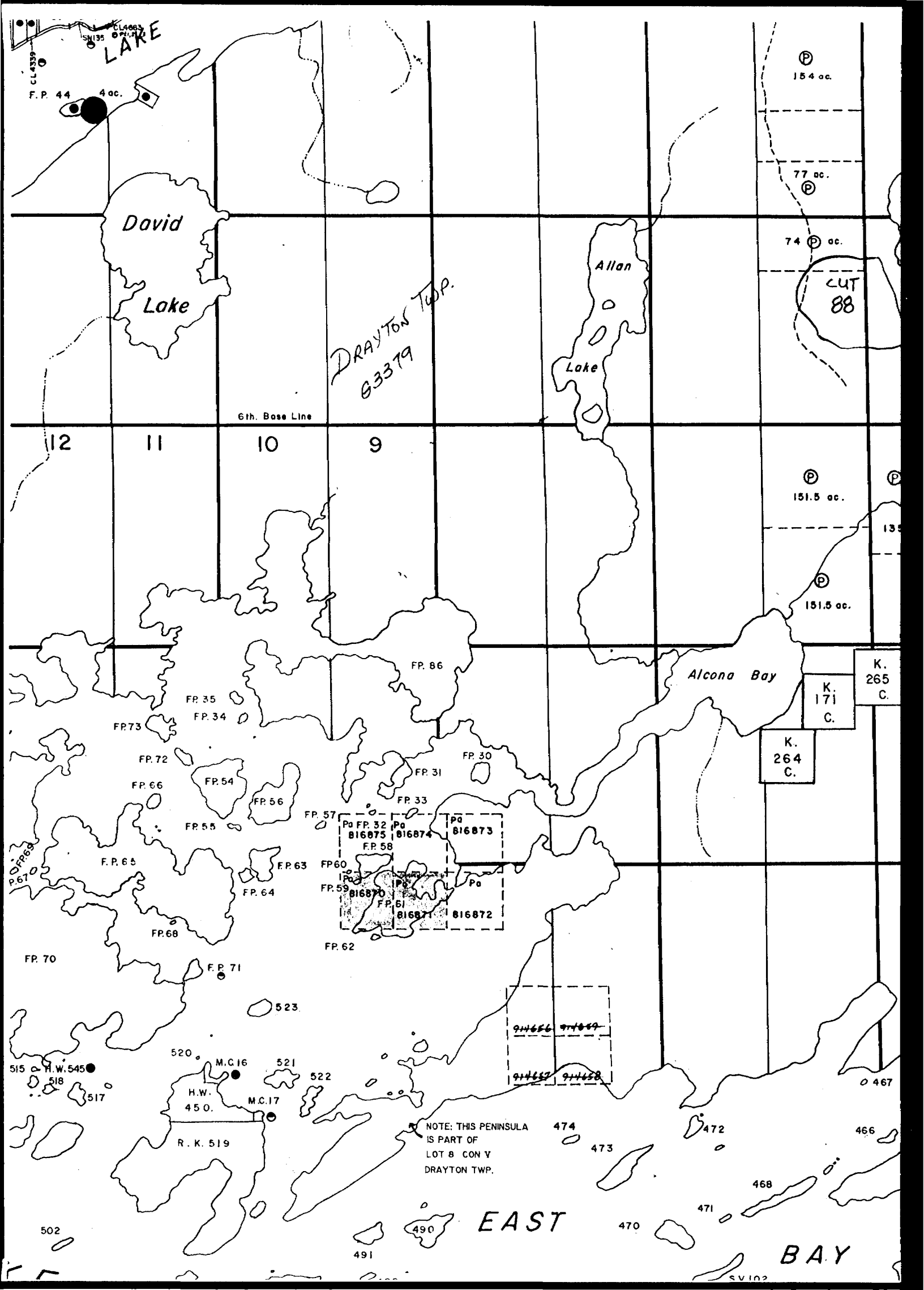

CL 4339
SN 135
F.P. 44 4 ac.

LAKE

David
Lake

DRAYTON TWP.
83379

6th. Base Line

12

11

10

9

77 ac.

74 ac.

CUT
88

151.5 ac.

151.5 ac.

Alcona Bay

K.
171
C.

K.
265
C.

K.
264
C.

FP. 86
FP. 35
FP. 34
FP. 73
FP. 72
FP. 66
FP. 54
FP. 56
FP. 55
FP. 57
FP. 32
FP. 31
FP. 30
FP. 33
FP. 58
FP. 65
FP. 63
FP. 60
FP. 59
FP. 61
FP. 62
FP. 64
FP. 68
FP. 70
FP. 71

Pa FP. 32
816875
816874
816873
FP. 58
816870
816871
816872

914656 914657
914658 914659

515 H.W. 545
518
517
520 M.C. 16
H.W. 450
M.C. 17
R. K. 519

NOTE: THIS PENINSULA
IS PART OF
LOT 8 CON V
DRAYTON TWP.

474
473
472
466
468
471
470
467
490
491
EAST
BAY

SV 102



Ministry of
Northern Development
and Mines

Ontario

Ministère du
Développement du Nord
et des Mines

P.O. Box 3000
Sioux Lookout, Ontario
POV 2T0

File: W8803-237

October 12, 1988

Norlode Resources Inc.
P.O. Box 2038
20 Eglinton Avenue West
Toronto, Ontario
M4R 1K8

Dear Sir:

SUBJECT: Work Report W8803-237; Diamond Drilling
Patricia Mining Division

Enclosed please find a copy of the above report of work for your records. With the above submission you have exceeded the minimum requirement of 200 days work and total assessment work credits is recorded as follows:

Pa. 816870 - 306.4 days
Pa. 816871-75 inclusive - 302.4 days

As discussed, once credits are placed on record, we will not redistribute at some future date.

If you have any questions on the above, do not hesitate to contact this office.

Yours very truly,

Doris H. Cosco,
Acting Mining Recorder
Mines and Minerals Division
Patricia Mining Division
Telephone 807:737-2034

smk
encl.
cc: Harry Dowhaluk