

DIAMOND DRILLIN'



52J04SW0020 52J04SW0011C1 DRAYTON

010

TOWNSHIP: Drayton

REPORT No.: 28

WORK PERFORMED BY: Denison Mines

<u>CLAIM No.</u>	<u>HOLE No.</u>	<u>FOOTAGE</u>	<u>DATE</u>	<u>NOTE</u>
PA 486834	F 81-1	303.0	1981	(1)
PA 560175	F 81-2	303.0	1981	(1)

TOTAL: 2 DH 606 FT

NOTES: (1) #129-81

DIAMOND DRILL RECORD

NAME OF PROPERTY / Fonz
 HOLE NO. F 81-1 LENGTH 303'
 LOCATION ISLAND FP 83 Pa 560175 (380' north of post #2)
 LATITUDE _____ DEPARTURE 486834
 ELEVATION _____ AZIMUTH 280° DIP 45°
 STARTED _____ FINISHED _____

FOOTAGE	DIP	AZIMUTH	FOOTAGE	DIP	AZIMUTH
100	44				
200	43				
300	40				

HOLE NO. F 81-1 SHEET NO. 1 of 3

REMARKS _____

LOGGED BY J. C. Patterson
G. Patterson

FOOTAGE		DESCRIPTION	SAMPLE			ASSAYS					
FROM	TO		NO.	% SULPHIDES	FOOTAGE			%	%	OZ/TON	OZ/TON
					FROM	TO	TOTAL				
0.0	3.0	Casing									
3.0	8.0	Coarse feldspar porphyry. Massive, 25% feldspar, laths up to 4mm in size. Fine grained matrix, grey in colour 7.0-7.5 very blocky ground									
8.0	22.0	Mafic volcanic. Massive, light green, fine grained, uniform 10.5-12.0 blocky ground 12.5-13.5 blocky ground 14.5-16.0 blocky ground 21.0-22.0 blocky ground									
22.0	28.5	Coarse feldspar porphyry. Massive, 40% feldspar, blocky xl up to 4mm in size, fine grained matrix, grey in colour 22.0-23.0 blocky ground									
28.5	38.0	Fine feldspar porphyry. Massive, 30% feldspar up to 2mm in size, fine grained matrix, grey in colour 37.0-38.0 blocky ground									
38.0	79.5	Coarse feldspar porphyry as 22.0-28.5 45.5-47.0 fine feldspar porphyry as 28.5-38.0 70.0-70.5 blocky ground									
79.5	103.0	Fine feldspar porphyry as 28.5-38.0 85.0-85.5 blocky ground	535		98	103	5'			0.003	

PATRICIA MINING DIV.
RECEIVED
 DEC - 8 1981
 A.M. 7, 8, 9, 10, 11, 12, 1, 2, 3, 4, 5, 6 P.M.

LANGRIDGES - TORONTO - 366-1168

DIAMOND DRILL RECORD

NAME OF PROPERTY Fonz
 HOLE NO. F 81-1 SHEET NO. 2 of 3

FOOTAGE		DESCRIPTION	SAMPLE			ASSAYS					
FROM	TO		NO.	% SULPHIDES	FOOTAGE			%	%	OZ TON	OZ TON
				FROM	TO	TOTAL					
103.0	108.0	Quartz vein, blocky, 15% lost core. 15% angular fragments of altered volcanics up to 2mm, 5% pyrite, 1% sphalerite, tr. asp. 80% white quartz	536	6 %	103.0	114.0	11			0.043	
					* 50 %	lost core					
108.0	120.0	Altered feldspar porphyry. 25% altered plagioclase, epidote, up to 3mm in size, randomly oriented. 75% light grey matrix, massive, fine grained	543	Trace	114	119	5			0.004	
120.0	172.0	Feldspar porphyry as 3-8, lower contact at 80° c.a. 133.0-138.0 agglomerate, fragments of coarse feldspar porphyry up to 4cm in matrix of fine feldspar porphyry 152.0-152.8 fine feldspar porphyry									
172.0	181.0	Coarse feldspar porphyry as 3-8. 40% feldspar xls, up to 4mm in size									
181.0	205.0	Feldspar porphyry as 28.5-38.0									
205.0	224.0	Coarse feldspar porphyry as 3-8. Xls of feldspar up to 1cm in size									
224.0	232.5	Feldspar porphyry as 28.5-38.0. Lower contact at 40° to c.a. 231.5 1cm wide chlorite band at 40° to c.a.									
232.5	240.0	Altered mafic volcanic. Fine grained, massive, chlorite-rich, bands of epidote, narrow quartz veins with some pyrite 238.5-239.0 vuggy quartz vein with 3% pyrite	537	Trace	232.5	238.5	5			0.010	
			538	3 %	238.5	238.0	0.5			0.004	
			539	Trace	239.0	240.0	1.0			0.046	
			533		240.0	245.0	5.0			Trace	
240.0	273.0	Mafic volcanic as 8-22 258.0-258.2 narrow 1cm quartz vein, minor sulfides	540		268.0	273.0	5.0			0.002	

DIAMOND DRILL RECORD

NAME OF PROPERTY FONZ

HOLE NO. F 81-1 SHEET NO. 3 of 3

FOOTAGE		DESCRIPTION	SAMPLE				ASSAYS				
FROM	TO		NO.	% SULPH IDES	FOOTAGE			%	%	OZ/TON	OZ. TON
					FROM	TO	TOTAL				
273.0	277.0	Quartz vein breccia. Contact 15% to c.a. 30% angular fragments of mafic volcanic in a white sugary quartz matrix. 5% pyrite as bands and lens	541		273.0	277.0	5			0.003	
277.0	284.5	Mafic volcanic as 8-22	542		277.0	282.0	5			0.002	
284.5	303.0	Fine grained feldspar porphyry									
	303.0	End of hole									

PATRICIA MINING DIV.
RECEIVED
 DEC - 8 1981
 A.M. P.M.
 1:8:9:10:11:12: 1 2:3:4:5:6

LANGRIDGES - TORONTO - 366-1168

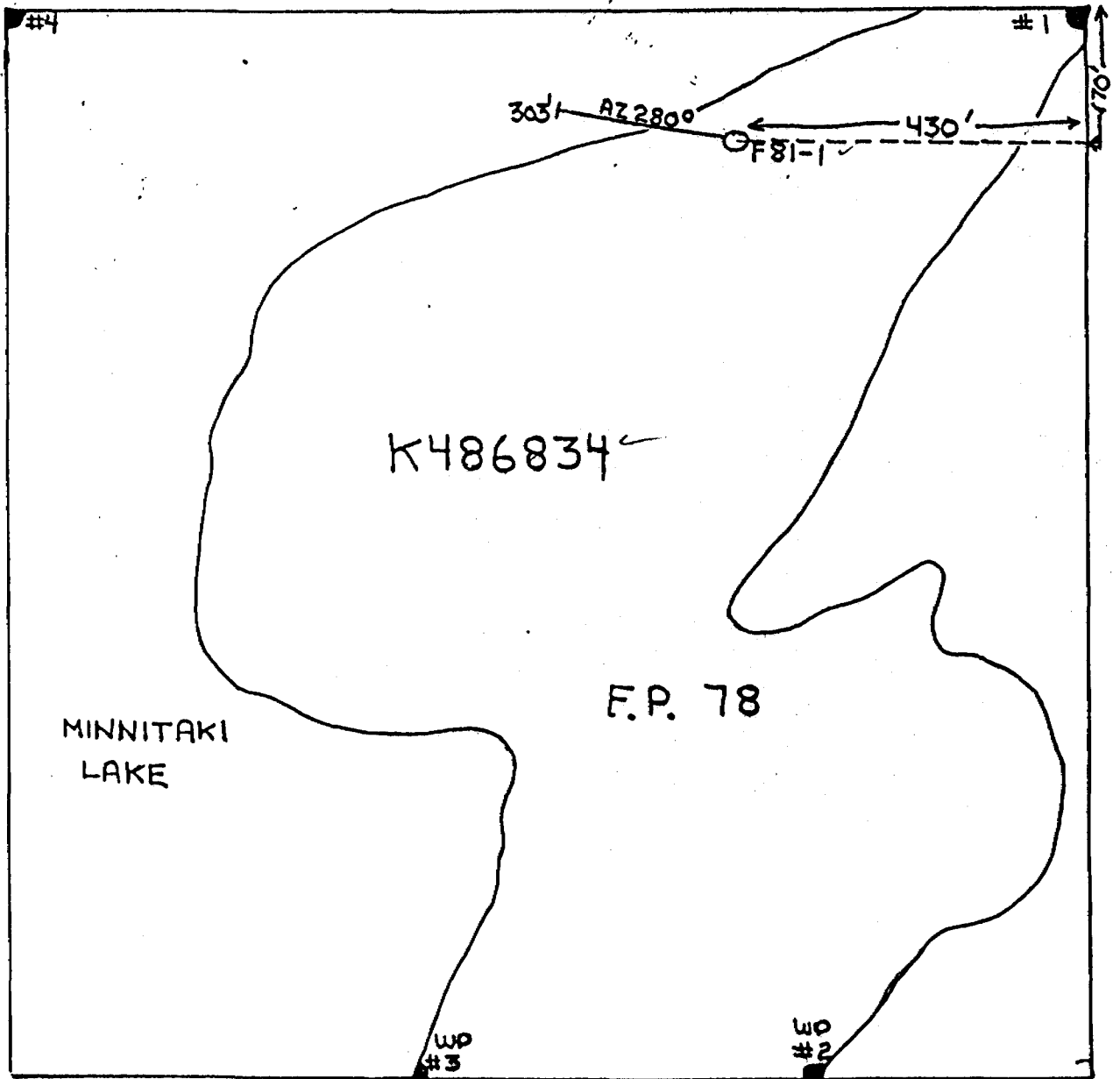

LOCATION MAP FOR DDH F81-1

PATRICIA MINING DIV.
R E C E I V E D
 DEC - 8 1981
 P.M.
 7:819101112, 1123456

DIAMOND DRILL RECORD

NAME OF PROPERTY / Fonz
 HOLE NO. F 81-2 LENGTH 303'
 LOCATION Pa560175
 LATITUDE _____ DEPARTURE _____
 ELEVATION _____ AZIMUTH 310° DIP 45°
 STARTED _____ FINISHED _____

FOOTAGE	DIP	AZIMUTH	FOOTAGE	DIP	AZIMUTH
100	45				
200	43				
300	42				

HOLE NO. F 81-2 SHEET NO. 1 of 4

REMARKS _____

LOGGED BY G. Patterson
D. C. Patterson

FOOTAGE		DESCRIPTION	SAMPLE			ASSAYS						
FROM	TO		NO.	% SULPHIDES	FOOTAGE			%	%	OZ/TON	OZ/TON	
					FROM	TO	TOTAL					
0	13.0	Casing - majority of core lost. Core is granite (overburden)										
13.0	165.0	Agglomerate, white feldspar porphyry in intermediate volcanic (greyish-green). Clasts - generally elongated parallel to the core axis (2.5 : 1), average size ~3" with range of ½"-18". Foliation present but erratic, varying with fragment size. Minor quartz stringers throughout, primarily at ~40° to core axis with average width of ~1/16". Principal variables are size and concentration of porphyroblasts (fragments).										
	13.0-32.0	agglomerate and feldspar porphyry. Fragments : angular and occupy ~30% of core surface area, size range from 1/16" to (½" x ½")										
	13.75	quartz vein at 40° to core axis. ½" thick, with pyrite throughout. Fragments in surrounding rock tend to align along the direction of the quartz vein.										
	26.5-28.0	quartz stringers (~1/16" thick at 10° to core axis)										
	32.0-34.0	agglomerate and feldspar porphyry. Fragments : angular and occupy ~10% of sun face area in clasts and surrounding rock. Size range : (1/32"² x 1/8"²)										
	32.5	pyrite in clast										
	34.0-35.0	agglomerate and feldspar porphyry. Clasts noticeably larger (up to 18" long). Fragments : angular and occupy ~30% of surface area, size range : (1/16"² x ½"²)										
	42.25	core fractured at 45°; carbonate rich, malachite and carbonate (ankerite) present										

PATRICIA MINING DIV.
RECEIVED
 DEC - 8 1981
 A.M. 7:8:9:10:11:12: P.M. 1:2:3:4:5:6

LANGRIP - TORONTO - 366-1188

DIAMOND DRILL RECORD

NAME OF PROPERTY FONZ

HOLE NO. F 81-2 SHEET NO. 2 of 4

FOOTAGE		DESCRIPTION	SAMPLE			ASSAYS						
FROM	TO		NO.	% SULPH IDES	FOOTAGE			%	%	OZ/TON	OZ/TON	
					FROM	TO	TOTAL					
		53.0-81.1										
		81.1-97.0										
		97.0-100.3										
		100.3-119.0										
		119.0-159.0										
		132.5-133.0										
		159.0-168.0										
165.0	201.1	Mineralized zone. Several quartz veins generally at 30° to core axis and very pyrriferous (pyrite, (marcasite?): 6% avg. and up to 80% content of quartz veins). Low grade metamorphism - epidote, (quartz vein breccia), chlorite present. Upper contact at 30°. Surrounding rock: massive amygdaloidal altered mafic volcanic (greyish-green) with quartz veins. Sections of quartz breccia. Amygdules of pyrrhotite, sphalerite and pyrite. Leached out carbonate	710		168	172	4			0.008		
			711		172	177	5			0.010		
			712		177	181	4			0.002		
			713		181	186	5			0.007		
			714		186	191	5			0.003		
			715		191	194.5	3.5			Nil		
			716		194.5	196.5	2.0			Nil		
			717		196.5	201	4.5			0.007		
		171.5-177.0										
		194.3-196.0										

PATRICIA MINING DIV.
RECEIVED
 DEC - 8 1981
 A.M. 7:8:9:10:11:12:1:2:3:4:5:6 P.M.

LANGRIGES - TORONTO - 368-1168

DIAMOND DRILL RECORD

NAME OF PROPERTY Fonz

HOLE NO. F 81-2

SHEET NO. 3 of 4

FOOTAGE		DESCRIPTION	SAMPLE			ASSAYS				
FROM	TO		NO.	% SULPHIDES	FOOTAGE		%	%	OZ/TON	OZ/TON
					FROM	TO				
		206.7								
		minor quartz stringers (1/4" thick at ~10° to c.a.). Core split - abundant chalcopryrite in rims of quartz vein								
201.1	203.3	Agglomerate with feldspar porphyry. Amygdaloidal - amygdules filled with sulphides (1) pyrrhotite, (2) pyrite, marcasite. Fragments : white, subangular, irregular positioning, covering ~20% of surface area, size range : 1/32"² to 1/8"². Surrounding rock : intermediate green, massive altered volcanic. Minor quartz stringers throughout at ~60° to c.a.	718		201	203.3	1.7			Nil
203.3	205.5	Mineralized zone : massive altered volcanic. Amygdaloidal - amygdules of sulphides (pyrite, pyrrhotite) and leached out carbonates. Upper and lower contacts at ~30°. 203.3-205.0 quartz vein bisects the core. Small crystals of pyrite around the rim of the vein (accounting for ~4% of total section). Fuchsite throughout quartz	719		203.3	205.5	2.2			Nil
205.5	234.0	Agglomerate with feldspar porphyry. Fragments : in clasts; angular, with size range (1/16"² to 1/2"²); surrounding rock - subangular with size range (1/32"² to 1/8"²) 230.0 quartz vein - non-mineralized; 1" thick at ~10° to core axis	720		205	209	4.0			Nil
234.0	238.0	Massive altered volcanic 234.5 large quartz vein (4" wide at ~10° to core axis). Pyrite throughout vein, but primarily in rim of vein. Fuchsite throughout quartz 237.0 several small quartz stringers. Concentration of pyrite : ~80% in veins. Stringers cross core at irregular angles								
238.0	245.0	Blocky ground - possible fault zone. Carbonate has leached out.								

DIAMOND DRILL RECORD

NAME OF PROPERTY Fonz

HOLE NO. F 81-2 SHEET NO. 4 of 4

FOOTAGE		DESCRIPTION	SAMPLE			ASSAYS					
FROM	TO		NO.	% SULPH DES	FOOTAGE			%	%	OZ/TON	OZ/TON
					FROM	TO	TOTAL				
245.0	303.0	Agglomerate - feldspar porphvry. Fragments : angular and well defined in clasts. Sub angular in surrounding rock. Size variation as before. Amygdaloidal - amygdules of sulphides (1) pyrrhotite,(2) pyrite.									
	303.0 ✓	End of hole									

PATRICIA MINING DIV.
RECEIVED
 DEC - 8 1981
 A.M. P.M.
 7 8 9 10 11 12 1 2 3 4 5 6

A

PATRICIA MINING DIV.
RECEIVED
DEC - 8 1981
A.M. 7:19 P.M. 4:56
7/8/9/10/11/12/1/2/3/4/5/6

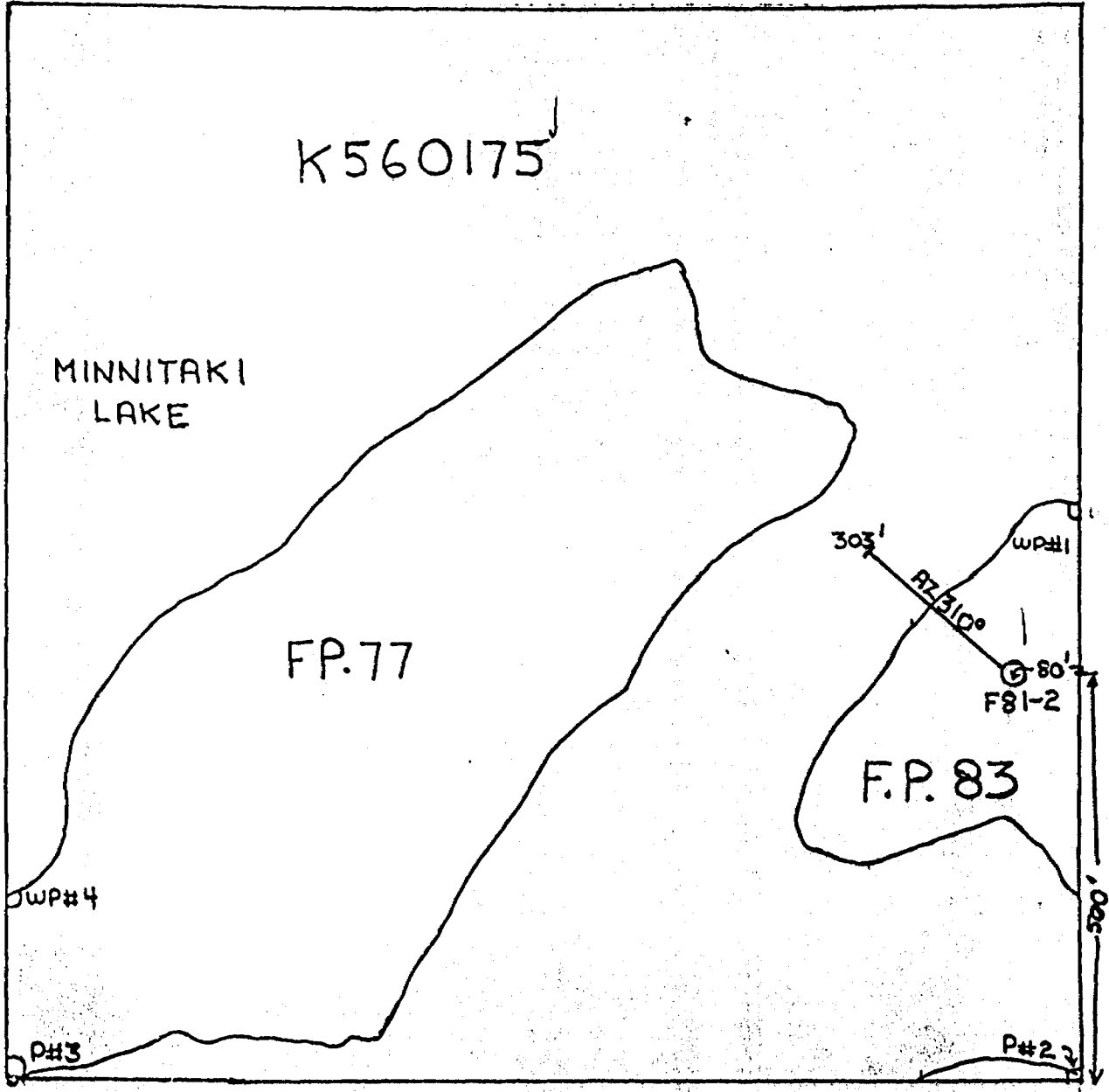

LOCATION MAP FOR DDH F81-2

Geology

Drayton Township M-2233

(22) 523/45w



Ministry of Natural Resources

Ontario



52J04SW0020 52J04SW0011C1 DRAYTON

THE MINING ACT REPORT OF WORK

900

Separate form is required for each report of work to be recorded.

81-129

To the Recorder of PATRICIA Mining Division
DENISON MINES LTD name of Recorded Holder
P.O. BOX 40, 18th FLOOR, ROYAL BANK PLAZA TORONTO, ONTARIO Post Office Address

A23621 Prospector's Licence

do hereby report the performance of 6.06 days of DIAMOND DRILLING type of work
not before reported to be applied on the following contiguous claims

Table with 6 columns: Claim No., Days, Claim No., Days, Claim No., Days. Contains entries for PA486834, PA487558, PA486835, PA487559, PA560175, PA487557.

All the work was performed on Mining Claim (s) 486834, 560175
(In the case of geological and/or geophysical survey (s) where more than 18 claims are involved attach a schedule)

READ CAREFULLY: THE FOLLOWING INFORMATION IS REQUIRED BY THE MINING RECORDER.

- For Manual Work, Stripping or Opening up of Mines, Sinking Shafts or Other Actual Mining Operations - Names and addresses of the men who performed the work and the dates and hours of their employment.
For Diamond and other Core Drilling - Footage, No. and angle of holes and diameter of core. Name and address of owner or operator of drill. Dates when drilling was done. Signed core log and sketch in duplicate.
For Compressed Air or Other Power Driven or Mechanical Equipment
Type of drill or equipment. Names and addresses of men engaged in operating equipment and the dates and hours of their employment.
For Power Stripping - Type of equipment. Name and address of owner or operator. Amount expended. Dates on which work was done. Proof of actual cost must be submitted within 30 days of recording.
With each of the above types of work sketches are required to show the location and extent of the work in relation to the nearest claim post. In the case of diamond or other core drilling the sketch must be submitted in duplicate.
For Geophysical, Geological, Geochemical Surveys and Expenditure Credits - the name of author of report. Covering dates of survey (linecutting & office). Type of instrument used. Total amount of expenditure. Technical reports, maps, expenditure breakdown, receipts must be filed in duplicate with the Minister within 60 days of recording.
For Land Survey - the name and address of Ontario Land surveyor.

The Required Information is as Follows: (Attach a list if this space is insufficient)

- 1) 303'; F81-1; 45°; BQ; KENORA DIAMOND DRILLERS EAST MELICK RD, KENORA, ONTARIO, AUG 17 - AUG 21, 1981
2) 303'; F81-2; 45°; BQ; KENORA DIAMOND DRILLERS EAST MELICK RD, KENORA, ONTARIO, AUG 25 - AUG 27, 1981
DUPLICATE LOGS + LOCATION MAPS ARE ATTACHED

Date DEC 2, 1981 Signature of Recorded Holder or Agent A.C. Patterson

The Mining Act Certificate Verifying Report of Work

G.C. PATTERSON
128 REGENT ST. THUNDERBAY, ONTARIO
(Post Office Address)

hereby certify:

- 1. That I have a personal and intimate knowledge of the facts set forth in the report of work annexed hereto, having performed the work or witnessed same during and/or after its completion.
2. That the annexed report is true

Dated DEC 2 19 81

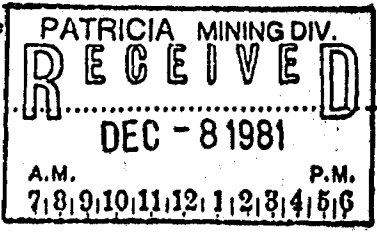

Signature of G.C. Patterson

Pa. 486833

THE PENALTY FOR MAKING A FALSE STATEMENT IN THIS REPORT AND/OR CERTIFICATE IS \$500. OR SIX MONTHS IMPRISONMENT OR BOTH

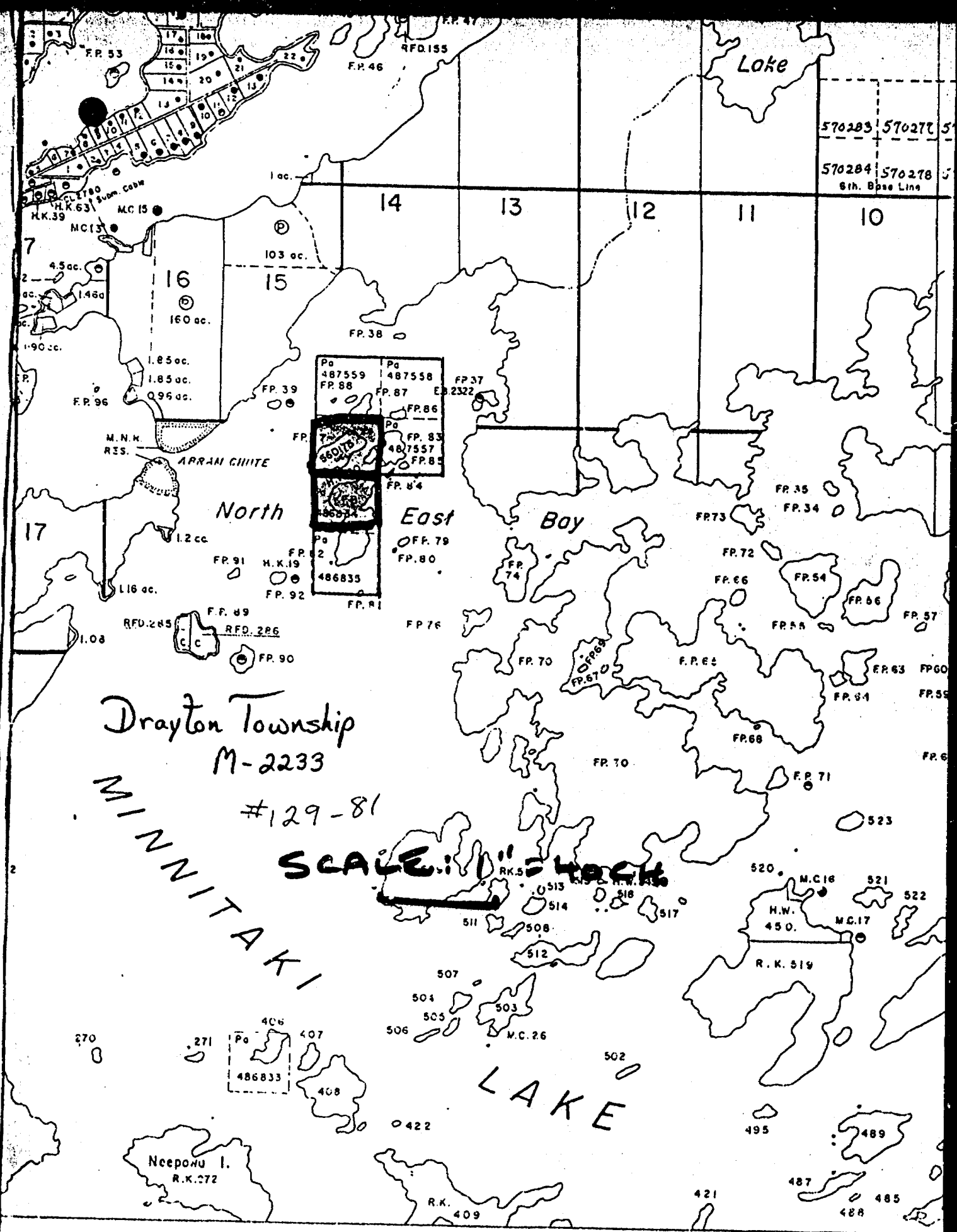

Drayton Township
M-2233

#129-81

SCALE: 1" = 40'

MINNITAKI

Parnes Lake Area (M.2150)