

DIAMOND DRILLING



52J07NE8919 10 POISSON

010

TOWNSHIP: Poisson

REPORT No.: 10

WORK PERFORMED BY: Raymond G. Ramsay

<u>CLAIM No.</u>	<u>HOLE No.</u>	<u>FOOTAGE</u>	<u>DATE</u>	<u>NOTE</u>
PA 437129	84-1	217	Feb/84	(1)
	84-2	207	Feb/84	(1)
	84-3	207	Feb/84	(1)
	84-4	507	Feb/84	(1)
PA 437128	84-5	497	Mar/84	(1)
486010		207	Mar/84	(1)
PA 437129		257	Mar/84	(1)
TOTAL	7 DH	2099 FT		

NOTES: (1) #47-84

# DIAMOND DRILL RECORD

Hole No. 84-1

Hole No. 84-1	Sheet 1	Length 217.0 ft	Commenced Feb. 23, 1984	Dip: Collar - 45°
Property Savant Property		Bearing N 38° W (N Shoal BL)	Completed Feb. 24, 1984	
Township Poisson Twp., Ont.		Dip -45°	Drilling Co. Kenora Diamond Drilling	Etch Test
Location 0+00, 0+60'S, Shoal		Objective	Core Size BQ	Depth
Base Line			Casing Left in Hole -	Rdg.
				True

Location Sketch North

Claim No. \_\_\_\_\_

Scale: 1" = 1000'

Claim Pa 437129

Remarks Shoal Prospect area, Savant Lake.

Footage		DESCRIPTION	Sample No.	From	To	Length ft.						
From	To											
0.0	17.0	Casing										
17.0	28.5	Graywacke, gray-green in color, var. carbonate, containing minor chlor. magnetite iron formation bands. Schistosity @ 65°-70° to core axis (ca). Rusty fracture at 21.0'.										
28.5	75.8	Magnetite iron formation with chlor. sections. Minor gray-green graywacke bands up to 4 ft. in width. Rock is crenulated throughout with bedding var. in attitude.	8724	62.0	65.0	3.0						
		52.0- 67.0 - Graywacke section, carb. and moderately oxidized (reddish). Section contains narrow white to pink qtz-carb. veinlets and fine, low dissem. pyrite. Veined areas max. at 62.0-65.0, 66.0-67.0, 74.6-	8725	66.0	67.0	1.0						
		75.8. Rusty iron formation band from 65.0-66.0. Note trace of Aspy at 66.8.	8726	74.6	75.8	1.2						
75.8	85.5	Graywacke, gray-green in color, var. carb. Minor magnetite iron formation bands. Schistosity at about 60°-65° to ca. Scattered white qtz-carb veinlets of same orientation. Veining and fracturing most strongly developed at 75.8-76.8 and 77.6-79.2.	8727	77.5	79.2	1.7						
85.5	133.8	Graywacke, reddish to brown in color (moderately to strongly oxidized), var. carb. Unit contains minor bands of mag. iron formation/chloritic material, and widely spaced fracturing with carbonate, brown in color. Schistosity at about 70° to ca.	8728	93.4	94.6	1.2						
		93.4-120.0 Rock is strongly oxidized and red in color, and contains scattered fine pyrite and narrow pink to reddish qtz-carb veinlets. At 97.0-	8729	94.6	96.9	2.3						
		100.6 rock is highly siliceous (cherty), red in color, and mineralized with fine pyrite (1-2%). Reddish qtz-carb. veining is well	8730	96.9	100.7	3.6						
		developed between 110.0-111.0 and 113.8-116.0, with some cubic pyrite present in veins and vein walls.	8731	109.5	110.9	1.4						
		120.0-133.8 Rock becomes moderately to poorly oxidized (pink to reddish) with scattered reddish qtz-carb veinlets and fine, low dissem. pyrite mainly in vein wall rocks.	8732	113.8	116.0	2.2						
			8733	126.0	127.0	1.0						

PATRICIA MINING DIV.  
**RECEIVED**  
 MAR 20 1984  
 A.M. P.M.  
 7819 1011121131314131

*Handwritten signature/initials*

# DIAMOND DRILL RECORD

Hole No. 84-1

Hole No. <u>84-1</u> Sheet: <u>2</u>	Length _____	Commenced _____	Dip: Collar _____	Location Sketch <span style="float: right;">North ↑ Claim No. _____ Scale: 1" = 1000'</span>
Property <u>Savant Property</u>	Bearing _____	Completed _____	Etch Test _____	
Township <u>Poisson Twp., Ont.</u>	Dip _____	Drilling Co. _____	Depth _____	
Location _____	Objective _____	Core Size _____	Rdg. _____	
_____	_____	Casing Left in Hole _____	True _____	
_____	_____	_____	_____	
Remarks _____				

Footage		DESCRIPTION	Sample No.	From	To	Length														
From	To																			
133.2	192.0	Magnetite iron formation with chloritic sections, and minor gray-green graywacke beds. Well developed iron formation. Bedding shows some crenulation, but is mainly regular at 75° to 80° to core axis.																		
		135.0- 138.4 Graywacke section, gray-green in color with some coarse pyrite.	8734	137.8	138.3	0.5														
		178.4- 178.6 Narrow white qtz-carb veinlets.																		
		180.5- 182.0 Some white to pink qtz-carb veining with minor assoc. pyrite.	8735	180.5	182.0	1.5														
182.0	199.0	Graywacke, gray-green in color, with low carbonate content. Schistosity at 75° to 80° to ca. Contains scattered white to slightly pink qtz-carb veinlets.																		
		185.2- 192.0 Crenulated iron formation section with scattered white qtz-carb veinlets 1 to 2 inches in width.																		
199.0	217.0	Magnetite iron formation with narrow graywacke and siliceous bands. Bedding at about 80° to ca.																		
217.0		End of hole.																		

PATRICIA MINING DIV.  
**RECEIVED**  
 MAR 20 1984  
 A.M. \_\_\_\_\_ P.M. \_\_\_\_\_  
 7 8 9 10 11 12 1 2 3 4 5 6

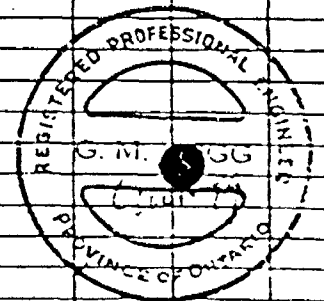

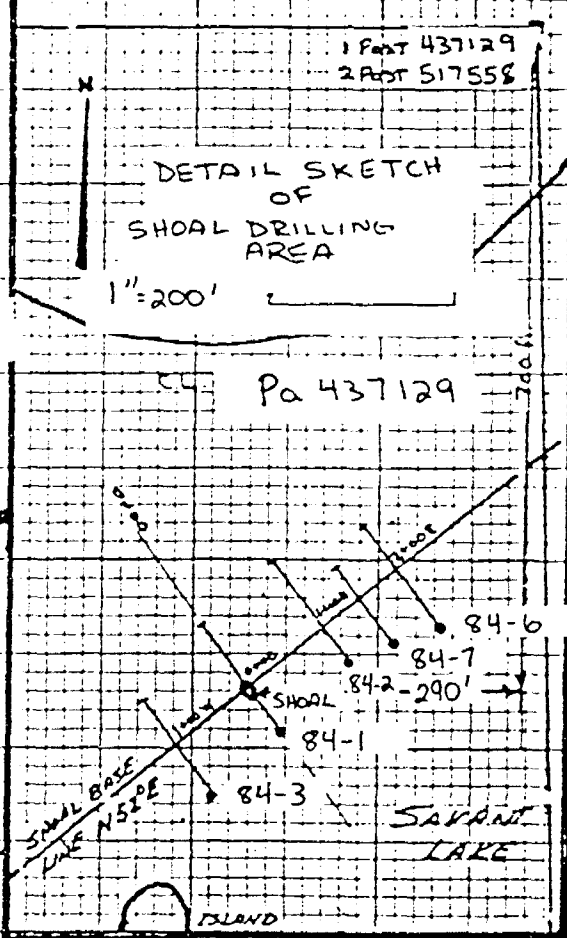
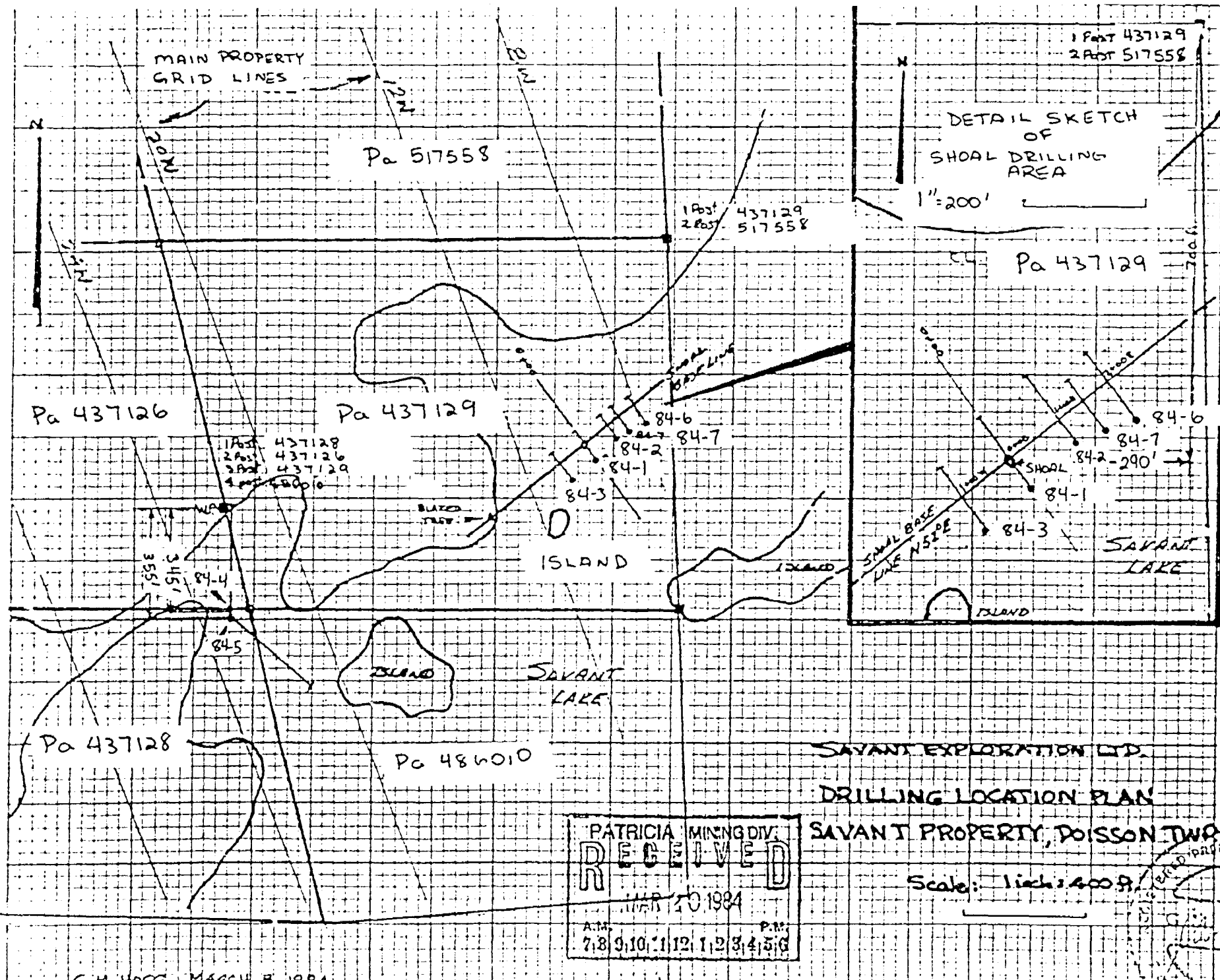

SAVANT EXPLORATION LTD.  
 DRILLING LOCATION PLAN  
 SAVANT PROPERTY, DOISSON TWP.

Scale: 1 inch = 200 ft.

PATRICIA MINING DIV.  
**RECEIVED**  
 MAR 20 1984  
 A.M. 7:8 9:10:11:12:1 2:3:4:5:6 P.M.

REGISTERED PROFESSIONAL ENGINEER  
 G. HOGG  
 ENGINEERING OF ONTARIO

G. H. HOGG, MARCH 8, 1984

335-5071

# DIAMOND DRILL RECORD

Hole No. 84-2

Hole No. 84-2	Sheet 1	Length 207.0 ft	Commenced Feb. 24, 1984	Dip: Collar - 45°	Location Sketch North Claim No. _____  Scale: 1" = 100'
Property Savant Property	Bearing N 38° W (N Shoal B.L.)	Completed Feb. 25, 1984	Etch Test nil	Depth	
Township Poisson Two., Ontario	Dip - 45°	Drilling Co. Kenora Diamond Drilling	Rdg.	True	
Location 1+00 E, 0+50 S, Shoal	Objective	Core Size BQ			
Base Line		Casing Left in Hole -			
Remarks _____					Claim No. Pa 437129

Footage		DESCRIPTION	Sample No.	From	To	Length												
From	To																	
0.0	17.0	Casing																
17.0	56.0	Graywacke, gray in color, low carbonate, and weakly altered (oxidized?). Minor bands of magnetite iron formation & chloritic material. Schistosity at about 70° to core axis (ca)																
	27.0- 43.8	Graywacke is moderately to strongly oxidized, reddish in color. It contains scattered reddish qtz-carb veinlets 1" to 2" max. width. Veining is irregular in attitude, but generally conforms to schistosity at 70° to ca. Minor pyrite (1-2%) is fine grained, and occurs in chloritic seams and clots in veinlets and wall rocks. There are a few crenulated iron formation bands present. Main zones of veining are at 28.6-30.0, 31.0-32.5, and 37.2-43.8. Note hairline fracture with trace of bornite and secondary copper stain at 41.0 ft.	8715	26.8	30.0	3.2												
			8716	31.0	32.5	1.5												
			8717	37.2	40.3	3.1												
			8718	40.3	42.0	1.7												
			8719	42.7	43.8	1.1												
			8720	48.5	49.6	1.1												
	43.8- 56.0	Graywacke becomes gray-green in color, low carbonate content. Scattered veinlets of white qtz-carb. veinlets up to 1" in width. Strongest development 48.5-49.6.																
56.0	83.0	Magnetite iron formation, chloritic zones. Minor bands of green-gray graywacke. The iron formation is highly crenulated, and bedding irregular.	8721	87.0	90.0	3.0												
			8722	84.9	87.0	2.2												
83.0	96.5	Graywacke, reddish to brown in color, strongly altered (oxidized?). Minor iron formation bands present. Scattered reddish qtz-carb. veinlets and fractures occur throughout, reaching max. development at 87.5-90.0. Fine to coarse pyrite extends through zone, mostly in vein wall rocks. Pyrite reaches max. of about 2-3% at 87.5-90.0. Traces of unidentified silver mineral also noted.	8723	90.0	92.5	2.5												
	94.0- 96.5	Graywacke becomes grayish in color, weakly to moderately oxidized. Schistosity is at about 70° to ca, but some crenulation is present in minor iron formation bands.																
96.5	207.0	Magnetite iron formation and chloritic zones. Minor graywacke beds (gray-green). Bedding and schistosity relatively regular at 70°-80° to ca. Rock contains																

**PATRICIA MINING DIV.**  
**RECEIVED**  
**MAR 20 1984**  
 A.M. P.M.  
 7 8 9 10 11 12 1 2 3 4 5 6

DIAMOND DRILL RECORD

Hole No. 84-2

Hole No. 84-2	Sheet 2	Length _____	Commenced _____	Dip: Collar _____	Location Sketch North Claim No. _____ Scale: 1" = 1000'
Property Savant Property		Bearing _____	Completed _____	Etch Test _____	
Township Poisson Twp, Ontario		Dip _____	Drilling Co. _____	Depth _____	
Location _____		Objective _____	Core Size _____	Rdg. _____	
_____			Casing Left in Hole _____	True _____	
Remarks _____					

Footage		DESCRIPTION	Sample No.	From	To	Length													
From	To																		
96.5	207.0	Continued.																	
		scattered white qtz-carb veinlets, with strongest development at 102.0-103.0, 118.0-120.0 and 128.0-128.3. Veined areas contain very low, fine dissem pyrite. After 128.3 vein development is sparse. At 128.3 bedding has become regular at about 70° to ca.																	
		141.8- 144.0 Graywacke, gray-green in color. Narrow sections follow.																	
		162.8- 163.3 Graywacke, reddish, with narrow qtz. veinlets and traces of pyrite.																	
		186.8- 187.0 Graywacke, reddish as above.																	
		193.8- 194.3 Graywacke, gray, siliceous, minor dissem. pyrite.																	
207.0		End of Hole.																	

PATRICIA MINING DIV.  
**RECEIVED**  
 MAR 20 1984  
 A.M. \_\_\_\_\_ P.M. \_\_\_\_\_  
 7 8 9 10 11 12 1 2 3 4 5 6

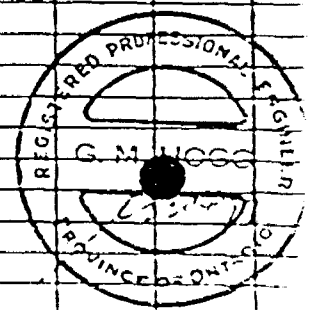

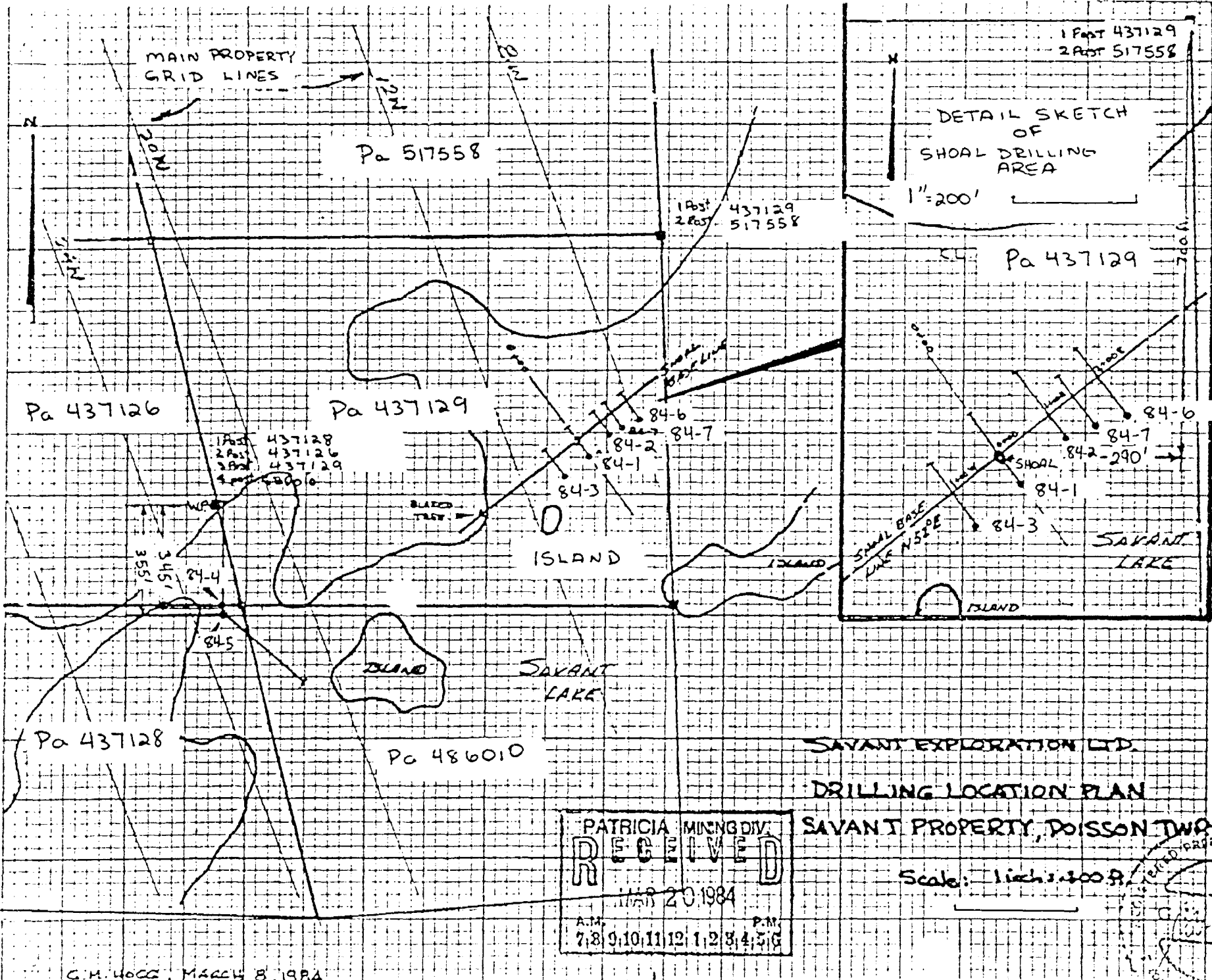

MAIN PROPERTY  
GRID LINES

Pa 517558

1Apt 437129  
2Apt 517558

DETAIL SKETCH  
OF  
SHOAL DRILLING  
AREA

1"=200'

1 Part 437129  
2 Part 517558

Pa 437129

Pa 437126

Pa 437129

1Apt 437128  
2Apt 437126  
3Apt 437129  
4Apt 486010

84-6  
84-7  
84-2  
84-1

ISLAND

SAVANT  
LAKE

345'  
355'

84-4  
84-5

ISLAND

SAVANT  
LAKE

Pa 437128

Pa 486010

SAVANT EXPLORATION LTD.

DRILLING LOCATION PLAN

SAVANT PROPERTY, POISSON TWO

Scale: 1 inch = 200 ft.

PATRICIA MINING DIV.  
**RECEIVED**  
MAR 20 1984  
A.M. 7, 8, 9, 10, 11, 12 P.M. 1, 2, 3, 4, 5, 6

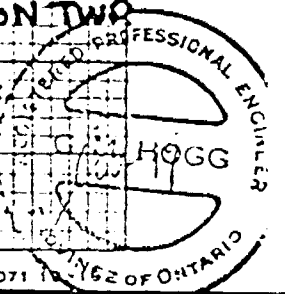

G.H. HOGG, MARCH 8, 1984

335-5071

# DIAMOND DRILL RECORD

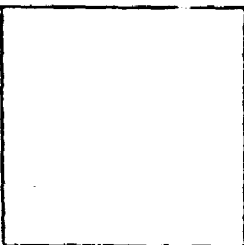
Hole No. 84-3	Sheet 1	Length 207.0 ft ✓	Commenced February 26, 1984	Dip: Collar -45°	Location Sketch North  Claim No. _____ Scale: 1" = 1000' Claim Pt. 437129	
Property Savant Property	Bearing N 38° W (N on Shoal B.L.)	Completed February 27, 1984	Etch Test	Depth 200.0		Rdg. -43 1/2°
Township Poisson Twp., Ontario	Dip -45°	Drilling Co. Kenora Diamond Drilling				
Location 1+00W, 0+70S, Shoal Base Line.	Objective	Core Size BQ				
		Casing Left in Hole -				
Remarks _____						

Footage		DESCRIPTION	Sample No.	From	To	Length								
From	To													
0.0	32.0	Casing												
32.0	43.0	Magnetite Iron Formation with chloritic sections. Minor gray-green graywacke bands. Schistosity and bedding at 75° to 80° to core axis (ca).												
		33.0- 34.0 Narrow qtz.-carb. veinlets (white). Minor dissem. pyrite in wall rocks of veinlets. Veining is in graywacke section.	8736	33.0	34.0	1.0								
43.0	112.0	Magnetite iron formation, chloritic sections, and gray-green graywacke in approx. equal proportions. Schistosity and bedding at about 75° to ca. Graywacke is rather coarse grained. White qtz.-carb. veinlets scattered through section.												
112.0	158.0	Graywacke, gray green in color, with minor iron formation bands. Schistosity at 75° to ca. White qtz.-carb. veinlets as above.												
		127.3- 127.9 White qtz.-carb. veinlet in crenulated iron formation area. Minor dissem. pyrite.	8737	127.3	127.9	0.6								
158.0	192.4	Graywacke, carbonated and reddish in color (moderately oxidized). 2 inch pink qtz.-carb. veinlets at 161.3 and 163.0.												
		166.8- 167.0 Fracture zone in narrow, brownish iron formation band (oxidized). Minor pink qtz.-carb. veinlets.												
		170.3- 171.3 Pink qtz.-carb. veinlets with some chloritic fragments incl. Minor pyrite dissem. in wall rocks.	8738	170.2	171.3	1.1								
		171.3- 172.7 Reddish strongly oxidized graywacke with scattered, narrow, pink qtz.-carb. veinlets up to 1/2 inch in width.	8739	171.3	172.5	1.2								
		172.7- 174.5 Zone of pink qtz.-carb. veining in strongly oxidized graywacke. Rock is siliceous (cherty) with about 1% dissem. pyrite in vein wall rock.	8742	172.5	174.4	1.9								
		177.5- 180.8 Strongly altered reddish graywacke with narrow irregular pink qtz.-carb. veinlets in section. Minor dissem. pyrite.	8740	177.5	178.9	1.4								
			8741	178.9	179.8	0.9								
		185.8- 187.0 Chert zone in graywacke section. Reddish, moderately oxidized. Low dissem., fine pyrite through section.	8743	185.9	187.0	1.1								

PATRICIA MINING DIV.  
**RECEIVED**  
 MAR 20 1984  
 A.M. A.M.  
 718191011 12112181418





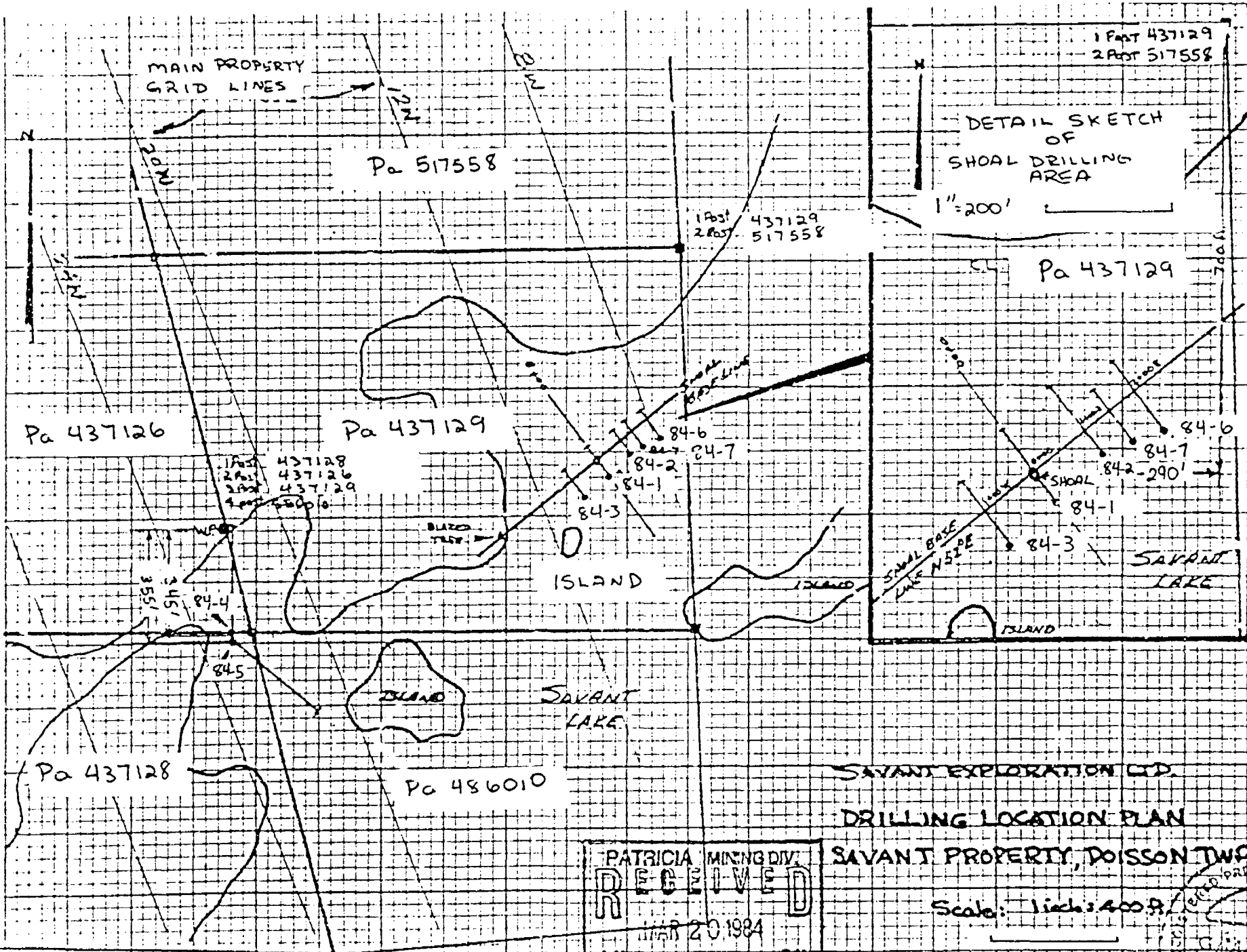

SAVANT EXPLORATION LTD.  
 DRILLING LOCATION PLAN

SAVANT PROPERTY, DOISSON TWO

Scale: 1 inch = 400 ft.

PATRICIA MING DIV.  
**RECEIVED**  
 MAR 20 1984  
 A.M. 7, 8, 9, 10, 11, 12, 1, 2, 3, 4, 5, 6 P.M.

REGISTERED PROFESSIONAL ENGINEER  
 G. HOGG  
 ONTARIO

C.H. HOGG MARCH 8, 1984

# DIAMOND DRILL RECORD

Hole No. 84-4

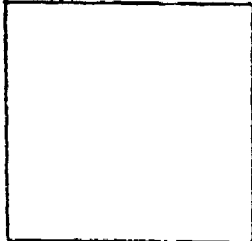
Hole No. 84-4	Sheet 1	Length 19.0 ft ✓	Commenced February 27, 1984	Dip: Collar -45°	Location Sketch North  Claim No. _____ Scale: 1" = 1000' Claims Pa 437126, 437129
Property Savant Property		Bearing Az. 0° (due North)	Completed February 29, 1984	Etch Test	
Township Poisson Twp., Ontario		Dip - 45°	Drilling Co. Kenora Diamond Drilling	Depth 490.0	
Location 23+00W, 25+00S on Main Grid of Property.		Objective	Core Size BQ	Rdg. -52°	
			Casing Left in Hole -	True	
Remarks _____					

Footage		DESCRIPTION	Sample No.	From	To	Length													
From	To																		
0.0	8.5	Casing.																	
8.5	139.3	Graywacke, gray-green in color, with minor magnetite iron formation and chloritic sections. Rock contains widely scattered white qtz.-carb. veinlets up to 1/2 in. in width. Schistosity at 60°-65° to core axis (ca). At collar graywacke is reddish in color, extending to 9.0 ft. depth. Minor pyrite and pink qtz.-carb. veinlet (1/2 in.) is present. A similar narrow section extends from 18.8 to 19.0 ft.																	
		92.0- 92.5 White qtz.-carb. veinlet																	
		101.8- 101.9 Pink qtz.-carb. veinlet.																	
		103.5- 105.0 Zone of white to pink qtz.-carb. veinlets. Low dissem. pyrite in wall rocks. Veining subparallel to schistosity at about 65° to ca	8745	103.5	105.0	1.5													
		Note narrow pink qtz.-carb. veinlets at 115.3 and 120.1.																	
		At approximately 125.0 magnetite iron formation with chlorite becomes more prominent.																	
139.3	141.0	Fractured and sheared zone (possible fault). Some talcose material.																	
141.0	157.6	Graywacke, gray-green in color, and somewhat cherty. Schistosity at 60° to ca.																	
		148.5- 148.8 Fractured zone, subparallel to core axis.	8746	148.7	151.0	2.3													
		148.8- 150.5 Zone of pink qtz.-carb. veinlets with low disseminated pyrite in vein wall rocks.	8747	152.2	156.0	3.8													
		From 150.5 rock contains widely spaced veinlets, minor pyrite, and some narrow magnetite iron formation bands. Rock is slightly reddish in color (low oxidation ?)																	
157.6	158.4	Fractured zone.																	
158.4	191.2	Magnetite iron formation with very minor chloritic and graywacke material. Schistosity and bedding at approx. 55° to 60° to ca. Local crenulations in IF.																	
		178.7 - 184.5 Weakly carbonated section (reddish) with minor pink qtz.-carb. veinlets.																	

PATRICIA MINING DIV.  
**RECEIVED**  
 MAR 20 1984  
 A.M. P.M.  
 7 8 9 10 11 12 1 2 3 4 5 6

*6/1/84*

# DIAMOND DRILL RECORD

Hole No. 84-4

Hole No. 84-4	Sheet 2	Length _____	Commenced _____	Dip: Collar _____
Property Savant Property		Bearing _____	Completed _____	Etch Test _____
Township Poisson Twp., Ontario		Dip _____	Drilling Co. _____	Depth _____
Location _____		Objective _____	Core Size _____	Rdg. _____
			Casing Left in Hole _____	True _____
Remarks _____				

Location Sketch

North  
↑  
Claim No. \_\_\_\_\_  
Scale: 1" = 1000'

Claims Pa 437126, 437129

Footage		DESCRIPTION	Sample No.	From	To	Length						
From	To											
191.2	240.0	Graywacke, gray-green in color. Magnetite iron formation bands are narrow and widely scattered. There are some cherty sections, but rock is mainly granular in nature. Schistosity at 65°-70° to ca.										
240.0	298.0	Magnetite iron formation with chloritic zones, and gray-green graywacke interbedded in approximately equal proportions. Schistosity and banding at about 60°-65° to ca. Banding is generally regular, but some local crenulated zones are present. There are occasional white qtz.-carb. veinlets up to 1 inch in width.										
298.0	372.5	Graywacke, gray-green in color, with minor iron formation sections. Schistosity at about 60° to ca. Scattered white qtz.-carb. veinlets up to 1 inch in width, with traces of pyrite in wall rocks. 338.5- 340.8 Iron formation band, crenulated. 348.0- 351.0 Some narrow crenulated iron formation bands, as above. 358.6- 358.9 Zone of narrow white qtz.-carb. veinlets wi. trace of pyrite 368.0- 370.0 Iron formation band, crenulated, as above.										
372.5	444.0	Graywacke, grayish in color and medium to coarse grained. Very little iron formation in section. Occasional narrow white qtz.-carb. veinlets. Schistosity at approx. 70° to ca. 385.0- 386.0 Cherty section with minor dissem. pyrite. 386.9- 387.0 Cherty zone, as above. At about 389.0 carbonate flecks appear, of sporadic distribution.										
444.0	482.2	Graywacke, pink to reddish in color (low to moderate oxidation). Section contains a few narrow cherty and magnetite iron formation zones. Schistosity is at 60°-70° to ca. There are some scattered pink qtz.-carb. veinlets, but veining is not strongly developed. There is a light dissemination of fine pyrite through the section, stronger in veined areas. 456.5- 457.2 Fracture zone with low pyrite, in at about 30° to ca.	8748	452.5	453.6	1.1						
			8749	459.0	460.8	1.8						
			8750	466.0	466.9	0.9						
			8751	480.0	482.2	2.2						



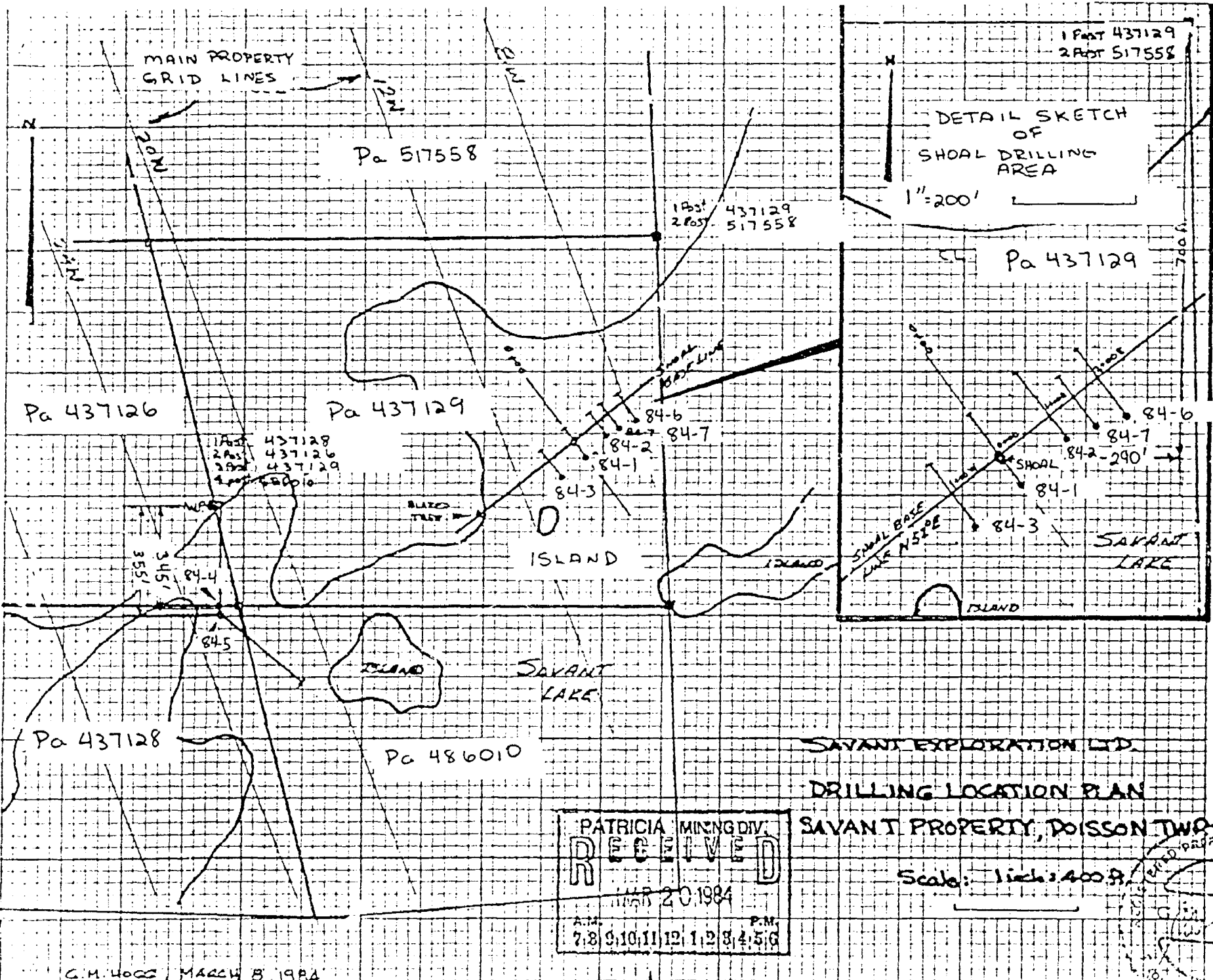

SAVANT EXPLORATION LTD.  
 DRILLING LOCATION PLAN

SAVANT PROPERTY, POISSON TWP

Scale: 1 inch = 400 ft.

PATRICIA MINING DIV.  
**RECEIVED**  
 MAR 20 1984  
 7:8 9:10:11 12:1 2:3 4:5:6 P.M.

PROFESSIONAL ENGINEER  
 G. HOGG  
 REG. NO. 12345  
 335-5071 REG. OF ONTARIO

G. H. HOGG MARCH 8, 1984

335-5071 REG. OF ONTARIO

DIAMOND DRILL RECORD

Hole No. 84-5

Hole No. 84-5 Sheet 1	Length 497.0 ft.	Commenced March 1, 1984	Dip: Collar -45°	Location Sketch North ↑ Claim No. _____ Scale: 1" = 1000'
Property Savant Property	Bearing S 50° E	Completed March 4, 1984	Etch Test Depth Rdg. True	
Township Poisson Twp., Ontario	Dip -45°	Drilling Co. Kenora Diamond Drilling	490.0' -43°	
Location 23+00 W, 25+10 S on Main Property Grid.	Objective	Core Size 30	Casing Left in Hole -	

Remarks \_\_\_\_\_

Claims Pa 43128, 486010

Footage		DESCRIPTION	Sample No.	From	To	Length					
From	To										
0.0	6.0	Casing.									
6.0	49.0	Graywacke, gray-green in color. Minor magnetite iron formation and chloritic bands. Schistosity at 25° to core axis (ca). Rock is rusty to 8.5 ft. depth, possibly from surface leaching. Very minor pink qtz.-carb. veining with traces of pyrite in this area. Note also some widely spaced chloritic seams with associated pyrite.									
49.0	119.0	Magnetite iron formation and chloritic zones with gray-green graywacke bands in about equal proportions. Schistosity and bedding at about 20°-25° to ca. A few narrow chloritic seams with associated quartz and pyrite.									
		66.5- 68.2 Core blocky and fractured.									
		77.0- 77.5 " "									
		87.5- 88.5 " "									
		99.4- 101.3 Veined section, pink quartz in veinlets subparallel to schistosity. Minor pyrite disseminated in vein wall rock.	8752	99.4	101.3	1.9					
		117.3- 118.0 Veined area as above.									
119.0	336.0	Magnetite iron formation with chloritic sections. Minor graywacke beds. Banding and schistosity at 25°-30° to ca.									
		137.3- 137.9 Pink qtz.-carb. veining at 20° to ca. Minor dissem. Pyrite in vein wall rocks.									
		139.3- 139.4 Veining, as above.									
		140.2- 141.0 " "									
		143.7- 144.7 " "	8753	143.7	147.2	3.5					
		145.7- 147.2 " "									
		154.0- 154.5 " "									
		At approximately 172.0 banding and schistosity steepens to 30° to ca., reverting to 20°-25° to ca. by 200.0.									
		241.1- 241.6 White qtz.-carb. veining in granulated iron formation band. Minor pyrite, possible trace of Asbv. and green mineral (epidote?) in									

PAT. CIA. MINING DIV.  
**RECEIVED**  
 MAR 20 1984  
 A.M. 7:00 P.M. 11:56

# DIAMOND DRILL RECORD

Hole No. 84-5

Hole No. <u>84-5</u> Sheet <u>2</u>	Length _____	Commenced _____	Dip: Collar _____	Location Sketch <span style="float:right">North</span> Claim No. _____ Scale: 1" = 1000'
Property <u>Savant Property</u>	Bearing _____	Completed _____	Etch Test _____	
Township <u>Poisson Twp., Ontario</u>	Dip _____	Drilling Co. _____	Depth _____	
Location _____	Objective _____	Core Size _____	Rdg. _____	
_____	_____	Casing Left in Hole _____	True _____	
Remarks _____				Claims Pa 43-128, 486010



Footage		DESCRIPTION	Sample No.	From	To	Length						
From	To											
119.0	336.0	Continued.										
		wall rocks of veins.										
		266.6- 268.2 White qtz.-carb. veining, with slight pink coloration. Veining up to 4 inches in width. Minor associated pyrite and possible trace of Aspy in wall rocks.	8754	266.7	268.2	1.5						
		319.5- 320.0 White qtz.-carb. veining as above.										
		323.6- 325.5 Schistose section. Possible sedimentation structure.										
		331.8- 332.0 White qtz.-carb. veining, as above.										
		337.8- 340.0 " "										
336.0	355.8	Gravwacke, gray-green in color. Rock is rather coarse grained with very low iron formation content. Schistosity is at approximately 30° to ca.										
355.8	415.7	Magnetite iron formation with chloritic zones and gray-green gravwacke in about equal proportions. Bedding and schistosity at about 30° to ca., and regular. 365.0- 366.0 Crenulated area. At 400.0 iron formation becomes dominant, and gravwacke is present in minor proportion. Banding remains at 30° to ca.										
415.7	424.8	Chert. Siliceous, dark gray rock, containing very low, fine disseminations of pyrite.	8755	415.7	417.0	1.3						
		417.0- 418.3 Magnetite iron formation band. At 418.3 the chert becomes lighter gray, and slightly reddish. It contains low, disseminations of fine pyrite.	8756	418.3	424.4	6.1						
		423.3- 424.8 Fractured and broken core. Possible fault zone.										
424.8	438.0	Magnetite iron formation, chloritic sections, and gray green gravwacke in about equal proportions. Banding and schistosity at about 30° to ca. It is mainly regular, but there are a few crenulated areas within iron formation.										
438.0	468.5	Magnetite iron formation with chloritic sections dominant. Minor gravwacke.										

6-47'

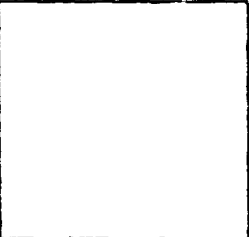

DIAMOND DRILL RECORD

Hole No. 84-5

Hole No. <u>84-5</u> Sheet <u>3</u>	Length _____	Commenced _____	Dip: Collar _____	Location Sketch  North  Claim No. _____ Scale: 1" = 1000' Claims Pa 43'129, 486010
Property <u>Savant Property</u>	Bearing _____	Completed _____	Etch Test _____	
Township <u>Poisson Twp., Ontario</u>	Dip _____	Drilling Co. _____	Depth _____	
Location _____	Objective _____	Core Size _____	Rdg. _____	
_____	_____	Casing Left in Hole _____	True _____	
_____	_____	_____	_____	
Remarks _____				

Footage		DESCRIPTION	Sample No.	From	To	Length													
From	To																		
438.0	468.5	Continued.																	
		Banding at approximately 30° to ca.																	
		451.7- 453.7 White qtz.-carb. veining with minor assoc. pyrite in wall rocks.	8758	451.7	453.7	2.0													
		Host rock is schistose and crenulated iron formation.																	
		457.0- 457.4 Veined as above. Rock less schistose.																	
		460.0- 461.5 Veined as above.																	
468.5	497.0	Magnetite iron formation with chloritic zones, and gray-green graywacke in about equal proportions. Banding at about 30° to ca.																	
		484.0- 486.0 Veined area. White qtz.-carb. material with some reddish coloration. Very low pyrite in wall rock.	8757	484.1	486.0	1.9													
		496.0- 497.0 Veined area, as above.																	
497.0		End of Hole																	

PATRICIA MINING DIV.  
**RECEIVED**  
 MAR 20 1984  
 A.M. P.M.  
 7 8 9 10 11 12 1 2 3 4 5 6

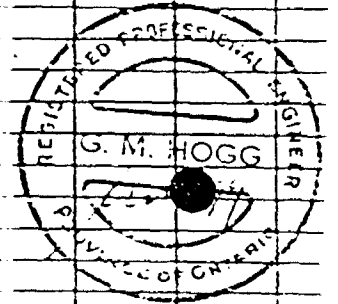

16

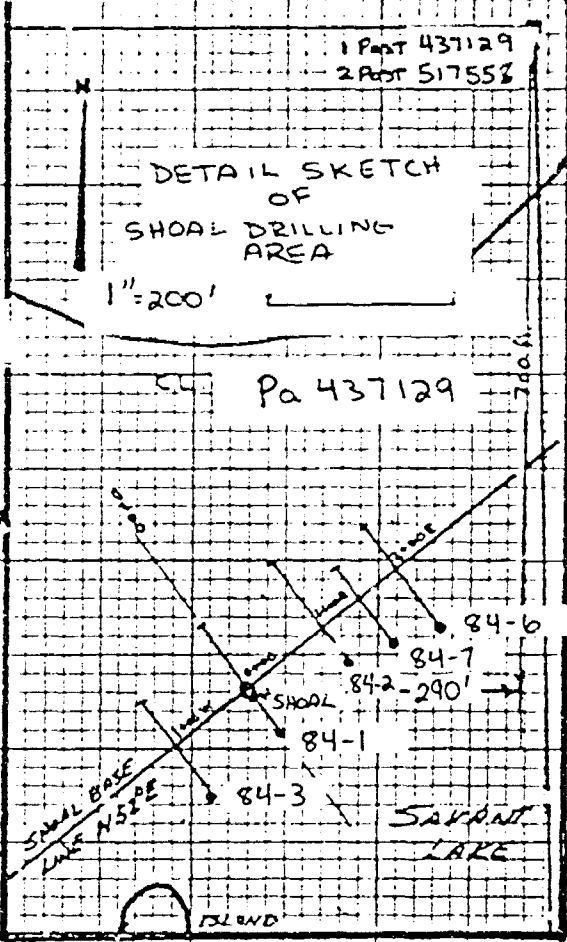
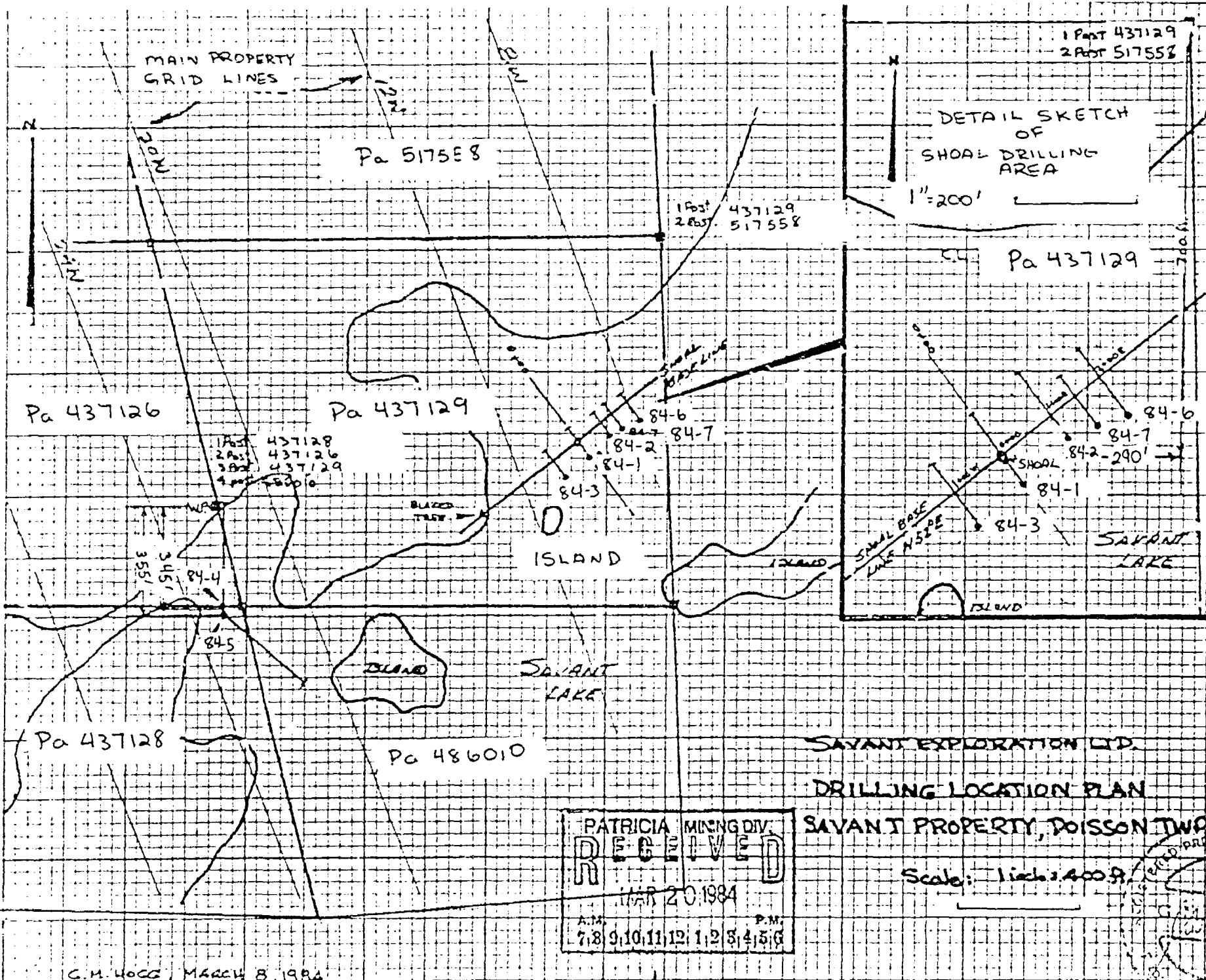

PATRICIA MINING DIV.  
**RECEIVED**  
 MAR 20 1984  
 A.M. P.M.  
 7 8 9 10 11 12 1 2 3 4 5 6

SAVANT EXPLORATION LTD.  
 DRILLING LOCATION PLAN  
 SAVANT PROPERTY, DOISSON TWP

Scale: 1 inch = 400 ft.

PROFESSIONAL ENGINEER  
 G.M. HOGG  
 335-5071  
 REG. OF ONTARIO

C.M. HOGG MARCH 8, 1984

# DIAMOND DRILL RECORD

Hole No. 84-6

Hole No. <u>84-6</u> Sheet <u>1</u>	Length <u>207.0 ft.</u>	Commenced <u>March 4, 1984</u>	Dip: Collar <u>-45°</u>
Property <u>Savant Property</u>	Bearing <u>N 38° W (N on Shoal Grid)</u>	Completed <u>March 5, 1984</u>	Etch Test
Township <u>Poission Twp., Ontario</u>	Dip <u>-45°</u>	Drilling Co. <u>Kenora Diamond Drilling</u>	Depth
Location <u>2+00E, 0+80S, Shoal</u>	Objective _____	Core Size <u>BQ</u>	Rdg. <u>-50°</u>
<u>Base Line</u>		Casing Left in Hole <u>-</u>	True <u>-53°</u>

Location Sketch

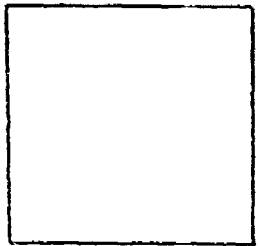

North ↑

Claim No. \_\_\_\_\_

Scale: 1" = 1000'

Claim Id 437129

Remarks \_\_\_\_\_

Footage		DESCRIPTION	Sample No.	From	To	Length					
From	To										
0.0	48.0	Casing.									
18.0	60.5	Graywacke, reddish (moderate oxidation), and magnetite iron formation bands in about equal proportions. Schistosity and bedding at approx. 70° to core axis.	8759	52.0	53.5	1.5					
		49.0- 51.4 Reddish-brown graywacke, minor IF, scattered pink qtz.-carb. veinlets and traces of dissem. pyrite.									
		52.0-53.5 Reddish-brown graywacke, as above.									
		From 53.0 iron formation bands show local crenulation, and schistosity is at approximately 45° to ca.									
60.5	83.9	Graywacke, gray-green in color, minor iron formation development in section. Schistosity at 45° to 60° to ca. Rock contains variable white carbonate flecks, and very minor pink qtz.-carb. veinlets.									
		74.0- 74.5 Reddish graywacke section with minor pink qtz.-carb. veining and low dissem. pyrite.	8760	74.0	74.5	0.5					
		82.5- 82.7 White qtz.-carb. veinlet, some slight pink coloration.									
83.9	99.7	Graywacke, reddish (low oxidation) with carbonate flecks and minor iron formation bands. Scattered pink qtz.-carb. veinlets. Schistosity at 45° to ca.	8761	89.3	92.4	3.1					
		At 91.3 rock becomes brownish (moderate oxidation), with very low iron formation content. Some fine dissem. pyrite.	8762	94.3	96.6	2.3					
		By 95.2 rock has become red-brown (mod. to strong oxidation) with widespread traces of fine pyrite mineralization. Schistosity at 45° to ca.	8763	96.6	99.6	3.0					
		96.6- 96.7 Rusty fracture at 80° to ca.									
		At 96.7 rock becomes cherty, and is red-brown in color (moderately oxidized). It contains minor pink qtz.-carb. stringers and some dissem. pyrite.									
99.7	156.3	Magnetite iron formation, chloritic sections, minor graywacke zones 1 to 3 ft. in width. Schistosity and banding at about 50° to ca at 100.0 ft. Graywacke is gray-green in color.									
		109.5- 111.4 Fractured and veined section in gray-green graywacke band. White qtz.-carb. veining is very narrow (hairline) for most part, and	8764	109.9	111.4	1.5					

PATRICIA MINING DIV.  
**RECEIVED**  
 MAR 20 1984  
 A.M. P.M.  
 7:30 9:10 11:12 1:23 4:56

# DIAMOND DRILL RECORD

Hole No. <u>84-6</u> Sheet <u>2</u>	Length _____	Commenced _____	Dip: Collar _____	Location Sketch <span style="float: right;">North ↑ Claim No. _____ Scale: 1" = 10.0'</span>
Property <u>Savant Property</u>	Bearing _____	Completed _____	Etch Test _____	
Township <u>Poisson Twp., Ontario</u>	Dip _____	Drilling Co. _____	Depth _____	
Location _____	Objective _____	Core Size _____	Rdg. _____	
_____	_____	Casing Left in Hole _____	True _____	
_____	_____	_____	_____	
Remarks _____				

Footage		DESCRIPTION	Sample No.	From	To	Length					
From	To										
99.7	156.3	Continued									
		contains low disseminated pyrite in veining and wall rock.									
		At 116.0 iron formation becomes crenulated and contains quartz-filled fractures. From 117.0 to 120.0 iron formation bedding is sub-parallel to ca.									
		121.0- 123.0 Veined graywacke, as above. Veining 1 to 2 inches in width.	8765	121.6	128.0	6.4					
		126.0- 128.0 Veined graywacke, as above.	8766	135.3	137.0	1.7					
		134.0- 137.0 Veined graywacke, as above.	8767	148.9	150.0	1.2					
		At 137.0 banding has become more regular, at approximately 70° to ca.									
		148.7- 150.1 Veined graywacke, as above. Note steep fracture at 150.0 ft.									
		152.0- 152.2 Veined graywacke, as above.									
		155.7- 156.3 Veined graywacke, as above.									
156.3	194.8	Graywacke, minor bands of iron formation with assoc. chloritic material. Schistosity at about 70° to ca. Rock is reddish in color from 156.7 to 163.3, with most highly oxidized section from 161.0 to 163.0.	8768	161.0	163.0	2.0					
		165.0- 166.2 Fractured and schistose iron formation band containing weak disseminated pyrite. Fault (?) or shear.	8769	165.0	166.2	1.2					
		168.0- 170.4 White to pink qtz.-carb. veinlets in gray-green graywacke. Low dissem. pyrite.	8770	168.0	170.4	2.4					
		173.5- 174.2 Crenulated iron formation, some white qtz.-carb. veinlets.									
		176.6- 177.4 Crenulated iron formation, veined, as above.									
		From 179.3 graywacke is gray-green in color, and shows schistosity at 60°-65° to ca. Minor white qtz.-carb. veinlets persist to 182.2.									
194.8	207.0	Magnetite iron formation with chloritic zones and minor graywacke sections. Banding at 70° to ca.									
		198.2- 198.4 White qtz.-carb. veinlet.									
207.0		End of hole.									

PATRICIA MINING DIV.  
**RECEIVED**  
FEB 20 1994  
A.M. 7:18 P.M. 4:55

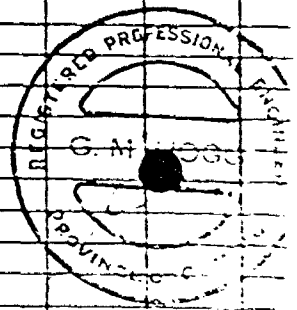

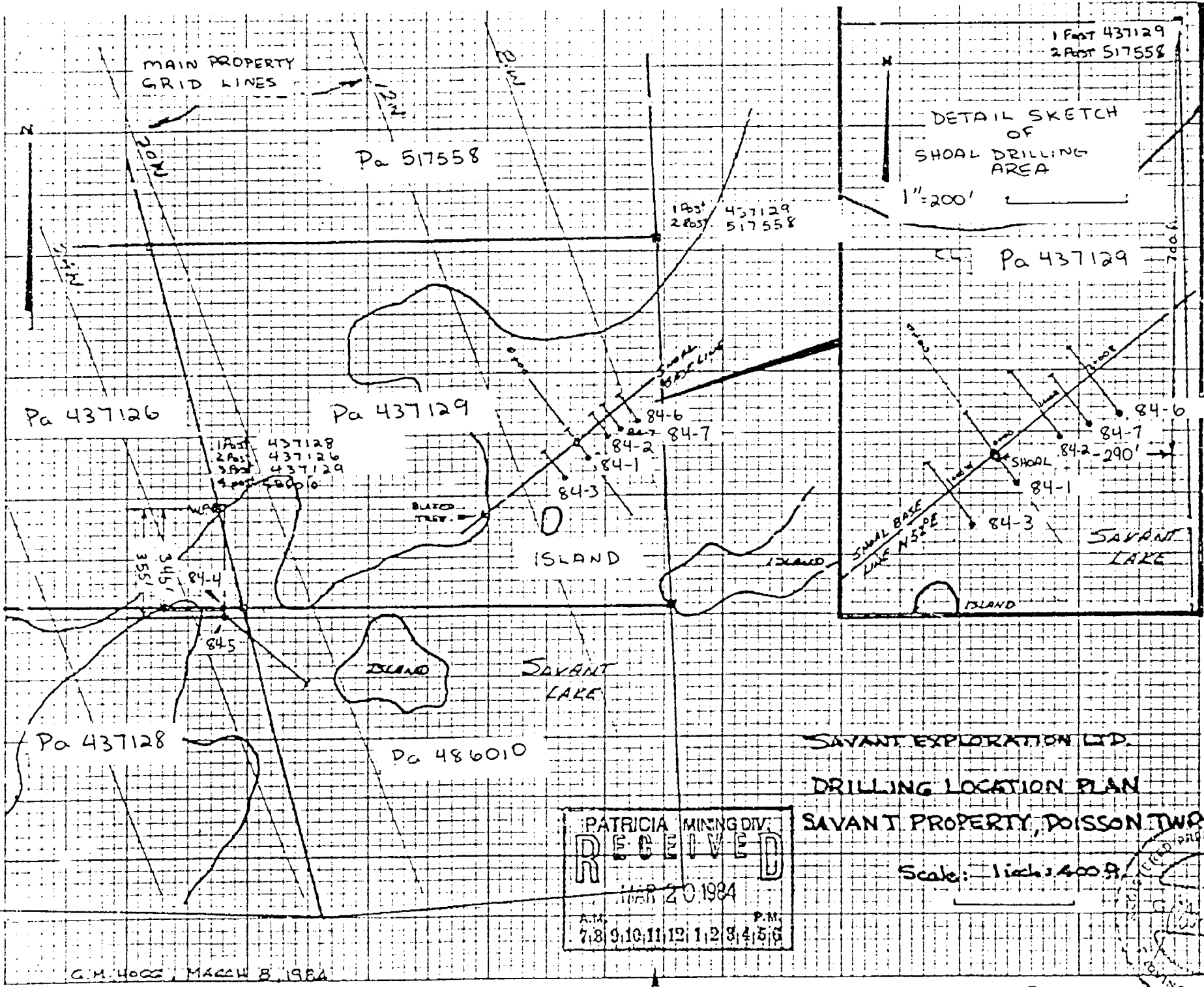

Pa 437126

Pa 437129

Pa 437129

Pa 517558

Pa 437128

Pa 486010

SAVANT EXPLORATION LTD.

DRILLING LOCATION PLAN

SAVANT PROPERTY, POISSON TWO

PATRICIA MINING DIV.  
**RECEIVED**  
 MAR 20 1984  
 A.M. 7:8 9:10:11:12:1:2:3:4:5:6 P.M.

Scale: 1 inch = 400 ft.

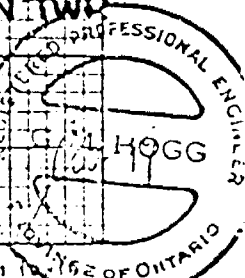

G. M. HOGG, MARCH 8, 1984

335-5071 1984 OF ONTARIO

# DIAMOND DRILL RECORD

Hole No. 84-7

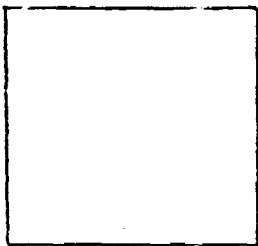
Hole No. 84-7	Sheet 1	Length 257.0 ft.	Commenced March 6, 1984	Dip: Collar -55°	Location Sketch North  Claim No. _____ Scale: 1" = 1000' Claim P. 437129
Property Savant Property	Bearing N 38° W (N on Shoal B.L.)	Completed March 7, 1984	Etch Test	Depth	
Township Poisson Twp., Ontario	Dip -55°	Drilling Co. Kenora Diamond Drilling	Rdg.	True	
Location 1+50 E, 0+60 S, Shoal Base Line.	Objective	Core Size BQ		250.0' -55°	
Remarks					

Footage		DESCRIPTION	Sample No.	From	To	Length						
From	To											
0.0	32.0	Casing.										
32.0	89.5	Magnetite iron formation with chloritic sections. A few gray-green graywacke interbeds. Banding and schistosity at 45°-50° to core axis (ca), with some local crenulation in the iron formation. Narrow white qtz.-carb. veinlets at 56.4, 57.2, 73.7, 80.0, and 84.6. At 87.0 the iron formation is crenulated and rusty brown in color.										
89.5	100.5	Graywacke, reddish in color (low alteration), and cherty in some sections. Minor magnetite iron formation bands. Schistosity at 60° to 70° to ca. Rock contains scattered narrow pink qtz.-carb. veinlets with assoc. fine, dissem pyrite.										
		97.2- 99.6 Strongly veined area, moderate oxidation.	8772	92.5	97.2	4.7						
100.5	122.3	Magnetite iron formation with chloritic sections. Minor graywacke beds. Banding and schistosity at 70° to ca. with local crenulated sections (eg. 116.0-122.3)	8773	97.2	99.6	2.4						
		Minor white qtz.-carb. veinlets present with traces of dissem. pyrite.	8774	115.5	116.4	0.9						
			8775	122.3	125.3	3.0						
122.3	139.5	Graywacke, gray-green in color, with a few narrow mag. iron formation bands. Schistosity at 60°-70° to ca.										
		122.3- 124.3 White qtz.-carb. veinlets.										
139.5	217.0	Graywacke, gray-green in color, and magnetite iron formation interbedded in about equal proportions. Banding and schistosity at approx. 70° to ca. in upper section. Sparse white qtz.-carb. veinlets present with low assoc. dissem. pyrite. Pyrite is also associated with narrow seams parallel to schistosity.										
		140.6- 141.7 White qtz.-carb. veinlets with low assoc. pyrite	8776	140.6	141.7	1.1						
		164.3- 164.8 Gray-green graywacke band with veining. Vuggy in part. wi. dissem Py	8777	164.3	164.9	0.6						
		172.0- 174.6 Cherty graywacke band. min or veining.										
		Qtz.-carb. veinlets about 1 inch wide at 176.0, 176.5 and 181.8.										
		182.8- 184.1 Crenulated iron formation band with some 1/2 inch white qtz.-carb. veinlets and assoc. pyrite (also crenulated) lying subparallel to the ca.	8778	182.8	184.2	1.4						
			8779	185.1	187.8	2.7						
		185.1- 186.4 Cherty graywacke band wi dissem. pyrite. Followed by a 2 inch qtz.-carb. veinlet.										

PATRIAL MINING DIV

RECEIVED

MAR 20 1984

A.M. 7:10 P.M. 11:21

# DIAMOND DRILL RECORD

Hole No. 84-7

Hole No. <u>84-7</u> Sheet <u>2</u>	Length _____	Commenced _____	Dip: Collar _____	Location Sketch <span style="float: right;">North ↑ Claim No. _____ Scale: 1" = 1000'</span>
Property <u>Savant Property</u>	Bearing _____	Completed _____	Etch Test _____	
Township <u>Poisson Twp., Ont.</u>	Dip _____	Drilling Co. _____	Depth _____	
Location _____	Objective _____	Core Size _____	Rdg. _____	
_____	_____	Casing Left in Hole _____	True _____	
_____	_____	_____	_____	
Remarks _____				

Footage		DESCRIPTION	Sample No.	From	To	Length								
From	To													
		186.4- 189.0 Crenulated iron formation with narrow white qtz -carb. veining and assoc. dissem. pyrite lying subparallel to ca.												
		Note 1 inch white qtz -carb. veinlets at 191.8, 195.9, 200.1, and 212.1.												
		From 197.0 banding an schistosity reverts to 70° to ca., regular.												
217.0	237.0	Magnetite iron formation with chloritic sections and minor graywacke interbeds. Banding at 70° to ca.												
		217.4- 217.7 White qtz -carb. veinlet.												
		At 220.0 iron formation becomes crenulated and fractured. It contains crenulated gray quartz stringers with variable assoc. pyrite in qtz. and wall rock.	8780	219.8	224.6	4.8								
		234.3- 234.7 White qtz -carb. veinlet.	87P1	232.2	234.7	2.5								
237.0	257.0	Graywacke, gray-green in color with indistinct banding. Minor iron formation bands. Schistosity at 70° to ca.												
257.0		End of Hole.												

PATRICIA MINING CO. LTD.  
**RECEIVED**  
 MAR 20 1984  
 A.M. \_\_\_\_\_ P.M. \_\_\_\_\_  
 7 8 9 10 11 12 1 2 3 4 5 6

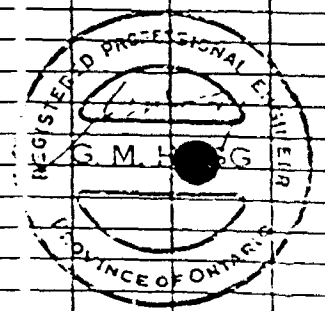



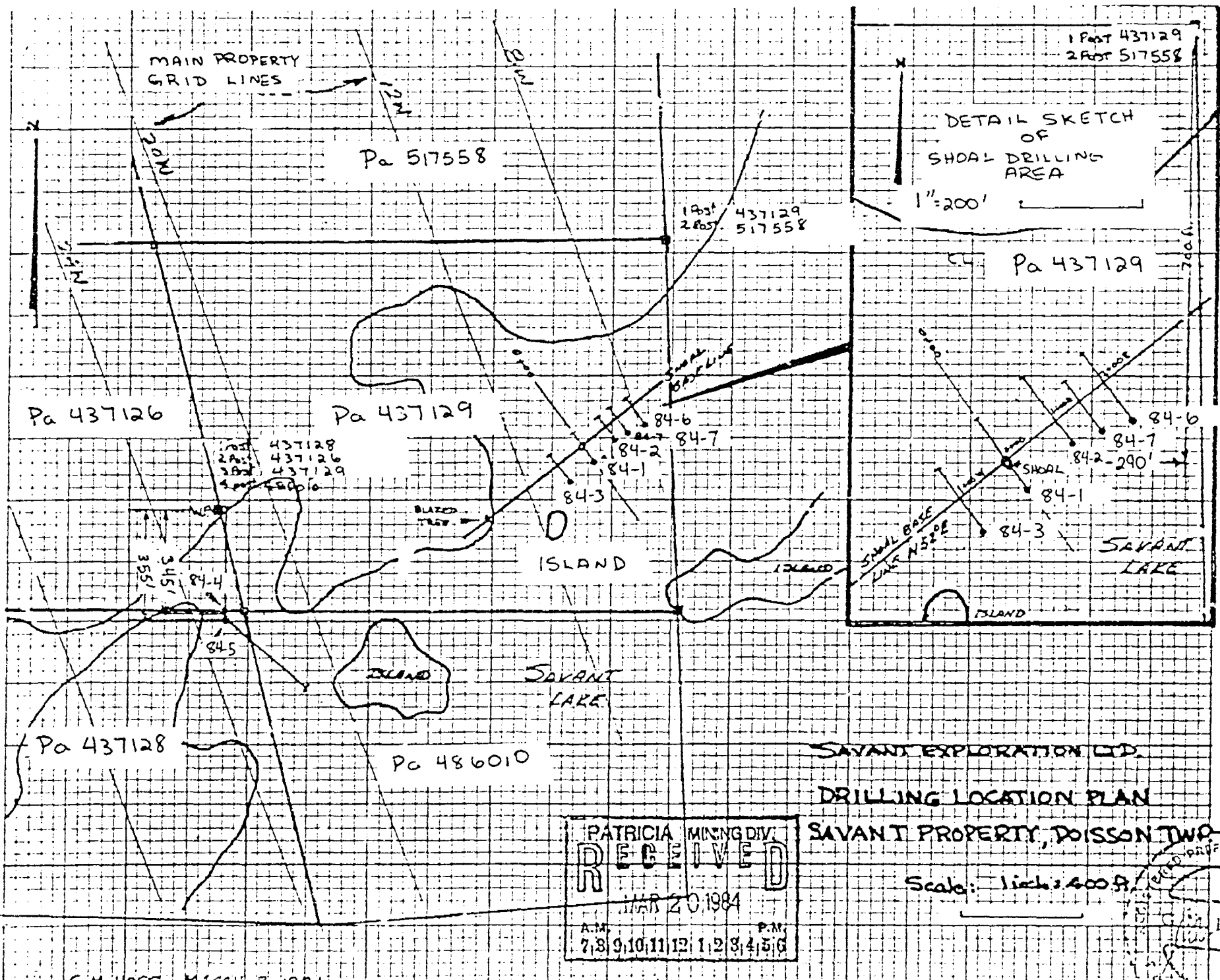

Pa 437126

Pa 437129

Pa 437128

Pa 486010

Pa 517558

Pa 437129

PATRICIA MINING DIV.  
**RECEIVED**  
 MAR 20 1984  
 A.M. 7:8 9:10:11:12: 1:2:3:4:5:6 P.M.

SAVANT EXPLORATION LTD.  
 DRILLING LOCATION PLAN  
 SAVANT PROPERTY, DOISSON TWP.

Scale: 1 inch = 400 ft.

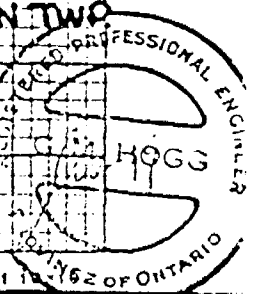

G.M. HOGG, MARCH 8, 1984

33-5071





52J07NE8919 10 POISSON

900

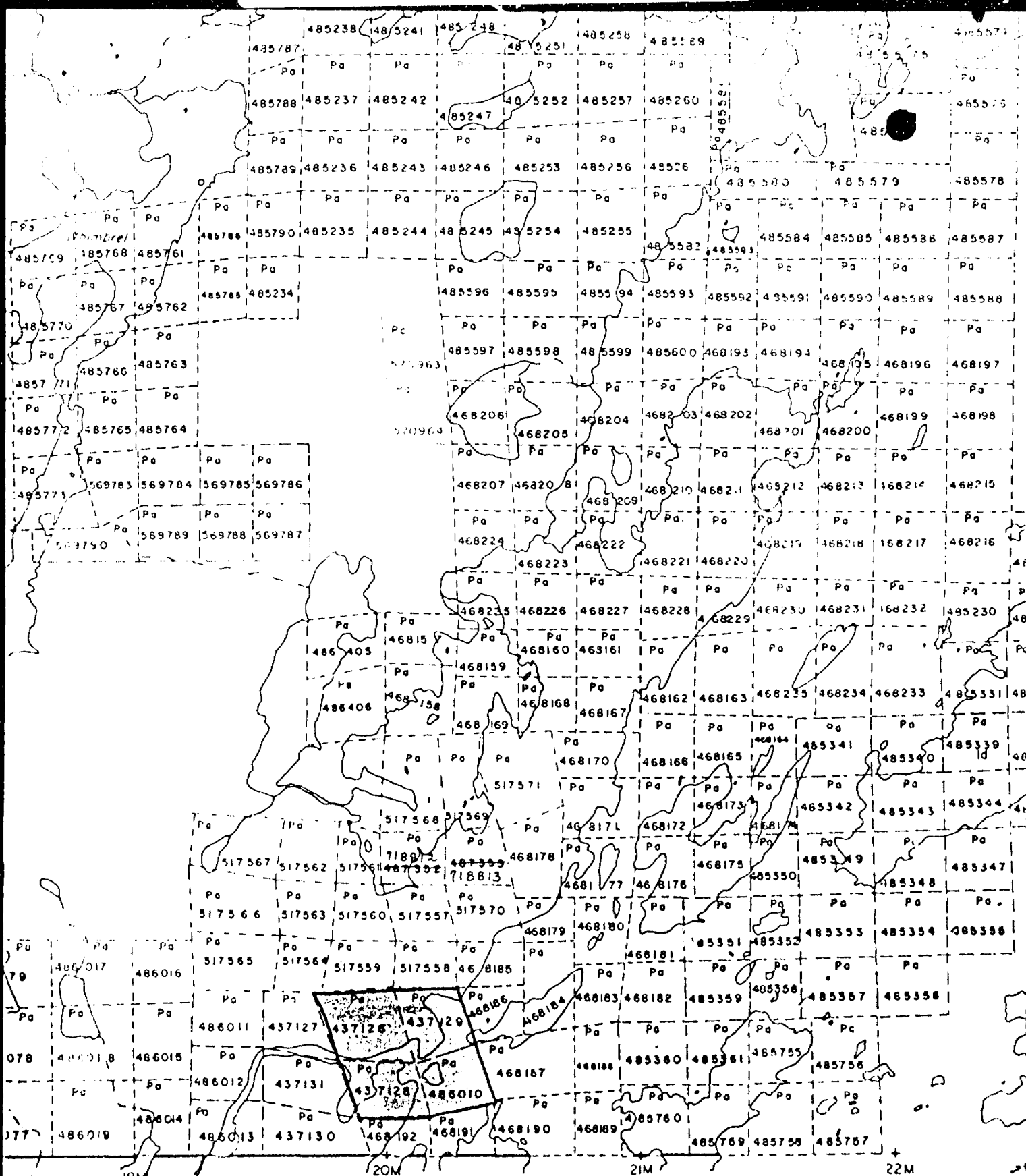

Poisson Township M-1865

1" = 40 CHAINS JUTTEN TWP. M-1767



Ministry of Natural Resources

Report of Work

Poisson Twp M-1865

Instructions - Supply required data on a separate form for each type of work to be recorded (see table below) - For Geo-technical work use form no. 1362 "Report of Work (Geological, Geophysical, Geochemical, and Expenditures)".

Assess. Lib.

#84-47

The Mining Act

Name and Postal Address of Recorded Holder Raymond G. Ramsay 10 Cook St., Barrie, Ontario L4M 4E9 (Opt. to Savant Exploration Ltd. Lic. T-1491)	Prospector's Licence No. A38000
---	------------------------------------

Summary of Work Performance and Distribution of Credits

Total Work Days Cr. claimed 2099	Mining Claim			Mining Claim			Mining Claim			
	Prefix	Number	Work Days Cr.	Prefix	Number	Work Days Cr.	Prefix	Number	Work Days Cr.	
for Performance of the following work. (Check one only)	Pa	486010	135	Pa	437130	100	Pa	517563	60	
	<input type="checkbox"/> Manual Work	486011	105		437131	110		517564	60	
	<input type="checkbox"/> Shaft Sinking Drifting or other Lateral Work.	486012	110		517557	60		517565	70	
	<input type="checkbox"/> Compressed Air, other Power driven or mechanical equip.	486013	115		517558	60		517566	70	
	<input type="checkbox"/> Power Stripping	437126	110		517559	60		517567	70	
	<input checked="" type="checkbox"/> Diamond or other Core drilling	437127	100		517560	60		517568	70	
	<input type="checkbox"/> Land Survey	437128	115		517561	70		517569	60	
		437129	115		517562	60		517570	70	
	All the work was performed on Mining Claim(s) Pa. 437129, 437126, 437128, 486010								517571	84

Required Information eg: type of equipment, Names, Addresses, etc. (See Table Below)

Seven diamond drill holes (BQ core size) were drilled from the ice of Savant Lake on claims Pa.437129, 437126, 437128 and 486010 during the period February 23, 1984 to March 7, 1984, incl. The holes were a minimum depth of 207.0 feet, with casing depths from 6.0 ft. to 48.0 feet. A total of 2099.0 feet of drilling was completed.

The drilling was done by Kenora Diamond Drilling Limited, P.O. Box 661, Kenora, Ontario P9N 3X6, under contract to Savant Exploration Ltd., 69 Willingdon Blvd., Toronto, Ontario M8X 2H5.

The program was supervised and the core logged by G.M. Hogg, P.Eng. of G.M. Hogg & Associates Ltd., 28 Thompson Avenue, Toronto, Ontario M8Z 3T3.

The 25 mining claims comprising the property are contiguous, and the above distribution of work credit is requested.

BQ wireline drilling equipment was used, yeilding core approximately 1 7/16 inches in diameter.

*Recorded Pa. 437126*

ONTARIO GEOLOGICAL SURVEY  
ASSESSMENT FILE  
RESEARCH OFFICE

Date of Report  
March 15, 1984

Recorded Holder or Agent (Signature)  
*[Signature]*

Certification Verifying Report of Work

I hereby certify that I have a personal and intimate knowledge of the facts set forth in the Report of Work annexed hereto, having performed the work or witnessed same during and/or after its completion and the annexed report is true.

Name and Postal Address of Person Certifying  
G.M. Hogg, P.Eng., G.M. Hogg & Associates Ltd.  
28 Thompson Ave., Toronto, Ont. M8Z 3T3

Date Certified  
March 15, 1984

Certified by (Signature)  
*[Signature]*

Table of Information/Attachments Required by the Mining Recorder

Type of Work	Specific Information (Common to 1 or more types)	Other Information (Common to 2 or more types)	Attachments	
Manual Work	PATRICIA MINING DIV. <b>RECEIVED</b> MAR 20 1984 A.M. 7, 8, 9, 10, 11, 12, 1, 2, 3, 4, 5, 6 P.M. 1, 2, 3, 4, 5, 6	Name and addresses of men who performed manual work / operated equipment, together with dates and hours of employment.	Work Sketch: these are required to show the location and extent of work in relation to the nearest claim post.	
Shaft Sinking, Drifting or other Lateral Work				
Compressed air, other power driven or mechanical equip.				Type of equipment
Power Stripping				Type of equipment and amount expended. Note: Proof of actual cost must be submitted within 30 days of recording.
Diamond or other core drilling			Signed core log showing: footage, diameter of core, number and angles of holes.	Names and addresses of owner or operator together with dates when drilling/stripping done.
Land Survey	Name and address of Ontario land surveyor.	NII	NII 27	