

F.W.M.
Mining Lands

2.5039



52J07NE9134 2.5039 POISSON

010

RECEIVED

AUG - 3 1982

MINING LANDS SECTI.

REPORT
ON
BLASTING & ASSAYING
BY
ABITIBI-PRICE INC.
MINERAL RESOURCES DIVISION
POISSON TOWNSHIP, ONTARIO

D. A. McCombe
July 23, 1982

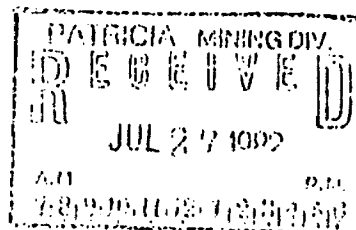

ASSESSMENT WORK CREDITS
POISSON TOWNSHIP, ONTARIO
CLAIMS # PA 487352 & 487353

Plugger/Mechanical Equipment

K. Bernier & M. Bernier
P. O. Box 1481
Sioux Lookout, Ontario

June 1982

8 - 12 Hr. Days
@ 1 Day/3 Hr/Man
= 32 Man Days

Assaying

Bell White Laboratories
P. O. Box 187
Haileybury, Ontario
POJ 1K0

June 1982

\$160 ÷ 15 = 10 Days ✓

Total 42 Days

PA 487352 - 21 Days

PA 487353 - 21 Days

D. A. McCombe
D. A. McCombe
Geologist

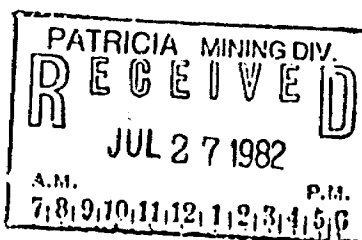

K BERNIER
 SIOUX LOCKOUT, ONT

M		Date	19	
ABITIBI-PRVCE		JUN 30	82	
SOLD BY	C.O.D.	CHARGE	ON ACCT.	ACCT. FWD.
1				
2		8 DAYS PLUGGER		
3		WORK @ 900/DAY		800 CR.
4				
5		K. BERNIER + H. BERNIER		
6				
7		JUNE 11-14 +		
8				
9		CLAIMS 487352		
10		487353		
11				
12				
13				
14				
15				

43



BELL-WHITE ANALYTICAL LABORATORIES LTD.

P.O. BOX 187 HAILEYBURY, ONTARIO TEL: (705) 672-3107
POJ 1KO

6/16 R 6/21
JUN 18 1982

Abitibi-Price Inc.,
Mineral Resources Division,
P. O. Box 21,
Toronto-Dominion Centre,
Toronto, Ontario.
M5K 1B3

INVOICE No 11932

ORDER NO. 0829

DATE June 16, 1982

CERTIFICATE NO.	DATE	DESCRIPTION	AMOUNT
14457	June 16/82	16 Au, 16 sample preparations Bernier Project, Savant Lake, Ont	\$ 160.00

CHEQUE 17397
17397
JUNE 28/82
\$ 160.00
STILL
Dues
JULY 2/82
July 2/82

PATRICIA MINING DIV.
RECEIVED
JUL 27 1982
A.M. 7:8 9 10 11 12 1 2 3 4 5 6 P.M.

A.F.E. # 469B (04)
ORDER NO. 0829 R. R. DATE
Nelson
Nelson
ACCOUNT
57-469-804 160.00



BELL-WHITE ANALYTICAL LABORATORIES LTD.

P.O. BOX 187.

HAILEYBURY, ONTARIO

TEL: 672-3107

Certificate of Analysis

NO. 14457

DATE: June 16, 1982

SAMPLE(S) OF: Rock(16)

RECEIVED: June 1982

SAMPLE(S) FROM: Mr. K. Bernier, Abitibi-Price Inc.

<u>Sample No.</u>	<u>Oz. Gold</u>	<u>Sample No.</u>	<u>Oz. Gold</u>
001-1	0.012	003-4	0.005
001-2	Trace	004-2	Trace
001-3	0.120 *	005-1	0.005
001-4	0.014	005-2	0.020
002-2	Trace	005-3	Trace
002-3	Trace	005-4	Trace
002-4	0.006	005-5	0.056
003-2	0.005		

* Checked.

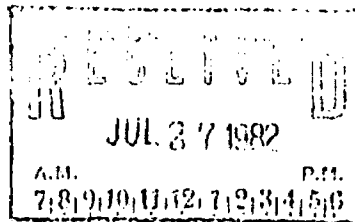

BELL-WHITE ANALYTICAL LABORATORIES LTD.

[Handwritten signature]

ACCORDANCE WITH LONG-ESTABLISHED NORTH AMERICAN CUSTOM, UNLESS IT IS SPECIFICALLY STATED OTHERWISE GOLD AND SILVER VALUES REPORTED ON THESE SHEETS HAVE NOT BEEN ADJUSTED TO COMPENSATE FOR LOSSES AND GAINS INHERENT IN THE FIRE ASSAY PROCESS.

McCUBBIN TWP. M-1804

McGILLIS TWP. M-1806

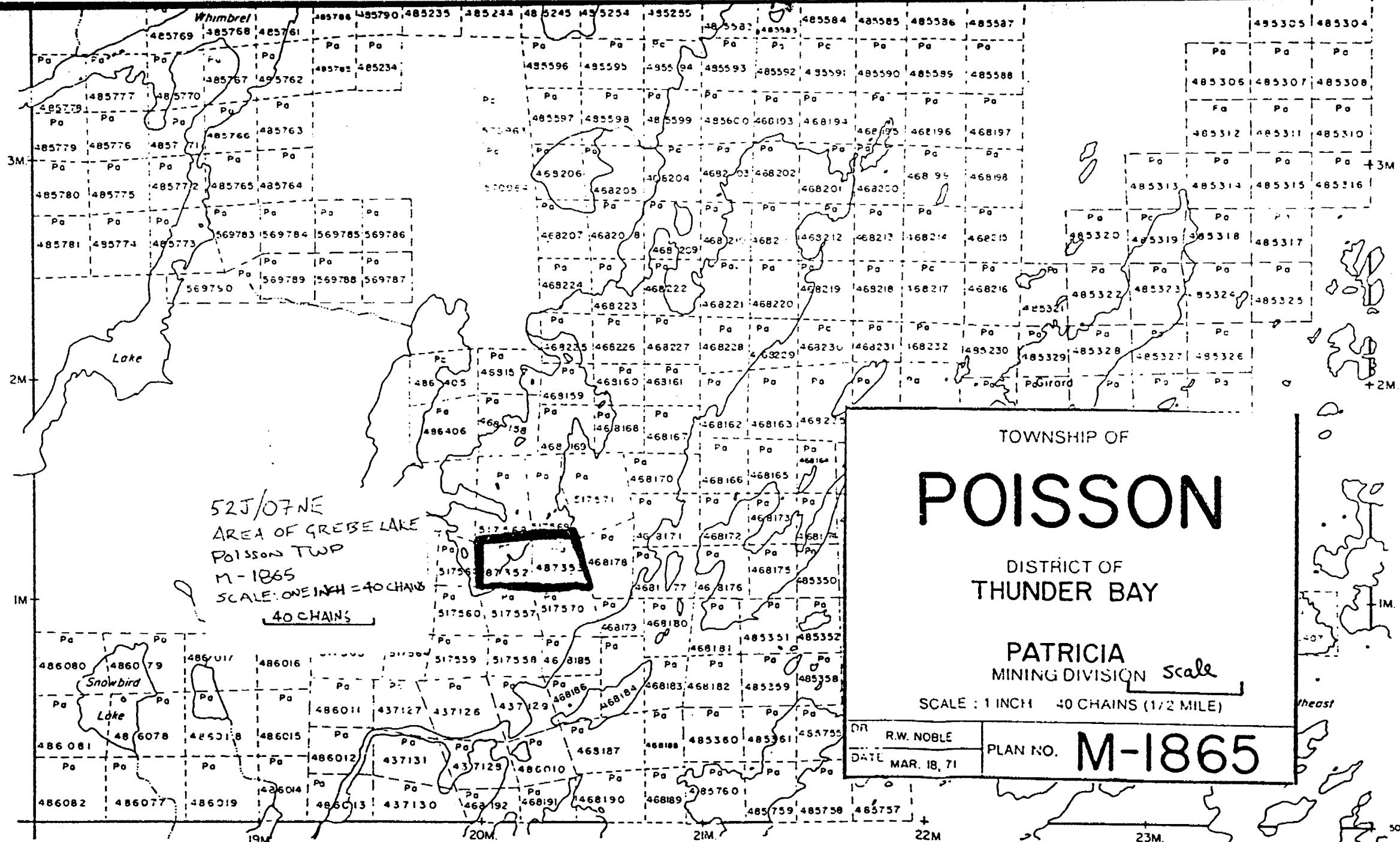

52J/07NE
 AREA OF GREBE LAKE
 POISSON TWP
 M-1865
 SCALE: ONE INCH = 40 CHAINS
 40 CHAINS

TOWNSHIP OF

POISSON

DISTRICT OF
 THUNDER BAY

PATRICIA
 MINING DIVISION

SCALE: 1 INCH = 40 CHAINS (1/2 MILE)

OR	R.W. NOBLE	PLAN NO. M-1865
DATE	MAR. 18, 71	

5207NE134 2.503 POISSON

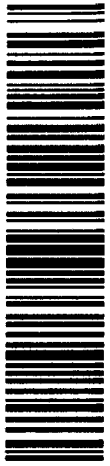

900

50° 24' 40"
 APPROX.
 24M
 90° 23' 15"

JUTTEN TWP. M-1767

F.W.M.



Ministry of Natural Resources

Report of Work

Poisson Township M-1865

Instructions

82-78

Supply required data on a separate form for each type of work to be recorded (see table below). For Geo technical work use form no. 1362 "Report of Work (Geological, Geophysical, Geochemical and Expenditures)".

Ontario

Mining Lands

The Mining Act

Name and Postal Address of Recorded Holder: Abitibi-Price Inc., Mineral Resources Division
 P. O. Box 21, Toronto Dominion Centre, Toronto, Ontario M5K 1B3

Prospector's Licence No.: T840

Summary of Work Performance and Distribution of Credits

Total Work Days Cr. claimed	Mining Claim			Mining Claim			Mining Claim		
	Prefix	Number	Work Days Cr.	Prefix	Number	Work Days Cr.	Prefix	Number	Work Days Cr.
42	PA	487352	21						
		487353	21						

for Performance of the following work. (Check one only)

Manual Work

Shaft Sinking Drifting or other Lateral Work.

Compressed Air, other Power driven or mechanical equip.

Power Stripping

Diamond or other Core drilling

Land Survey

RECEIVED
 OCT 21 1982
 MINING LANDS SECTION

All the work was performed on Mining Claim(s): 487352 & 487353

Required Information eg: type of equipment, Names, Addresses, etc. (See Table Below)

Blasting (Plugger Work) & Trenching

Mr. K. Bernier, Sioux Lookout, Ontario
 Mr. M. Bernier, Sioux Lookout, Ontario

June 1982 - Total - 8 - 12 Hr. Days
 32 Days Credit.

Assaying

Bell White Laboratories Ltd.
 P. O. Box 187
 Haileybury, Ontario
 P0J 1K0

June 1982 \$160 ÷ 15 = 10 Days Credit ✓

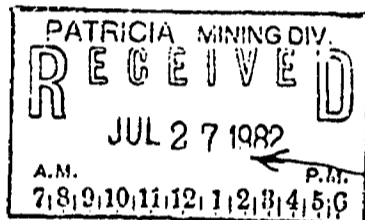

Recorded
Deborah A. McCombe
Acting Mining Recorder

Pa. 487352

Date of Report: July 22, 1982
 Recorded Holder or Agent (Signature): *Deborah A. McCombe*

Certification Verifying Report of Work

I hereby certify that I have a personal and intimate knowledge of the facts set forth in the Report of Work annexed hereto, having performed the work or witnessed same during and/or after its completion and the annexed report is true.

Name and Postal Address of Person Certifying

Deborah A. McCombe, Abitibi-Price Inc., Mineral Resources Division, P. O. Box 21

Toronto Dominion Centre, Toronto, Ont. M5K 1B3

Date Certified: July 22, 1982
 Certified by (Signature): *Deborah A. McCombe*

Table of Information/Attachments Required by the Mining Recorder

Type of Work	Specific information per type	Other information (Common to 2 or more types)	Attachments
Manual Work	Nil	Names and addresses of men who performed manual work/operated equipment, together with dates and hours of employment.	Work Sketch: these are required to show the location and extent of work in relation to the nearest claim post.
Shaft Sinking, Drifting or other Lateral Work			
Compressed air, other power driven or mechanical equip.	Type of equipment	Names and addresses of owner or operator together with dates when drilling/stripping done.	
Power Stripping	Type of equipment and amount expended. Note: Proof of actual cost must be submitted within 30 days of recording.		
Diamond or other core drilling	Signed core log showing; footage, diameter of core, number and angles of holes.		Work Sketch (as above) in duplicate
Land Survey	Name and address of Ontario land surveyor.	Nil	Nil



Ministry of
Natural
Resources

Geotechnical
Report
Approval

File
2.5037

Mining Lands Comments

To: Geophysics

Comments

<input type="checkbox"/> Approved	<input type="checkbox"/> Wish to see again with corrections	Date	Signature
-----------------------------------	---	------	-----------

To: Geology - Expenditures *M/R Knotra*

Comments

<input checked="" type="checkbox"/> Approved	<input type="checkbox"/> Wish to see again with corrections	Date <i>Jan 26/83</i>	Signature <i>C Knotra</i>
--	---	-----------------------	---------------------------

To: Geochemistry

Comments

LD

<input type="checkbox"/> Approved	<input type="checkbox"/> Wish to see again with corrections	Date	Signature
-----------------------------------	---	------	-----------



Ministry of
Natural
Resources

ntario

Your file:

1983 06 23

Our file: 2.5039

MINISTRY OF NATURAL RESOURCES
RECEIVED

JUN 27 1983

RESIDENT GEOLOGIST, RED LAKE

Mr. Albert Hanson
Mining Recorder
Ministry of Natural Resources
P.O. Box 669
Sioux Lookout, Ontario
POV 2T0

Dear Sir:

RE: Assaying submitted under Section 77(19) of the Mining
Act R.S.O. 1980, on Mining Claims PA 487352, PA 487353
in the Township of Poisson

The enclosed statement of assessment work credits for assaying
expenditures has been approved as of the above date.

Please inform the recorded holder of these mining claims and
so indicate on your records.

Yours very truly,

E.F. Anderson
Director
Land Management Branch

Whitney Block, Room 6450
Queen's Park
Toronto, Ontario
M7A 1W3
Phone: (416) 965-1380

Encl.

file
cc: Abitibi-Price Inc
Toronto, Ontario

cc: Resident Geologist
Sioux Lookout, Ontario

2.5039

1983 06 23

2.5039

Mr. Albert Hanson
Mining Recorder
Ministry of Natural Resources
P.O. Box 669
Sioux Lookout, Ontario
POV 2T0

Dear Sir:

RE: Assaying submitted under Section 77(19) of the Mining
Act R.S.O. 1980, on Mining Claims PA 487352, PA 487353
in the Township of Poisson

The enclosed statement of assessment work credits for assaying
expenditures has been approved as of the above date.

Please inform the recorded holder of these mining claims and
so indicate on your records.

Yours very truly,

E.F. Anderson
Director
Land Management Branch

Whitney Block, Room 6450
Queen's Park
Toronto, Ontario
M7A 1W3
Phone: (416) 965-1380

Encl.

cc: Abitibi-Price Inc
Toronto, Ontario

cc: Resident Geologist
Sioux Lookout, Ontario

1982 10 15

2.5039

Mining Recorder
Ministry of Natural Resources
P.O. Box 669
Sioux Lookout, Ontario
POV 2T0

Dear Sir:

We have received data for assaying submitted under Section 77/19 of the Mining Act R.S.O.1980 on Mining Claims PA 487352 et al in the Township of Poisson.

However, we have not received a duplicate report and maps. Please submit these to this office.

Upon receipt of the above material a statement of assessment work credits will be issued.

Yours very truly,

E.F. Anderson
Director/
Land Management Branch

Whitney Block, Room 6450
Queen's Park
Toronto, Ontario
M7A 1W3
Phone: 416/963-1300

J. Skura:sc

cc: Abitibi-Price Inc
Toronto, Ontario
Attention: D.A. McCombe

SEE ACCOMPANYING
MAP(S) IDENTIFIED AS

52J/07NE-0034-A # 1

LOCATED IN THE MAP
CHANNEL IN THE FOLLOWING
SEQUENCE (x)

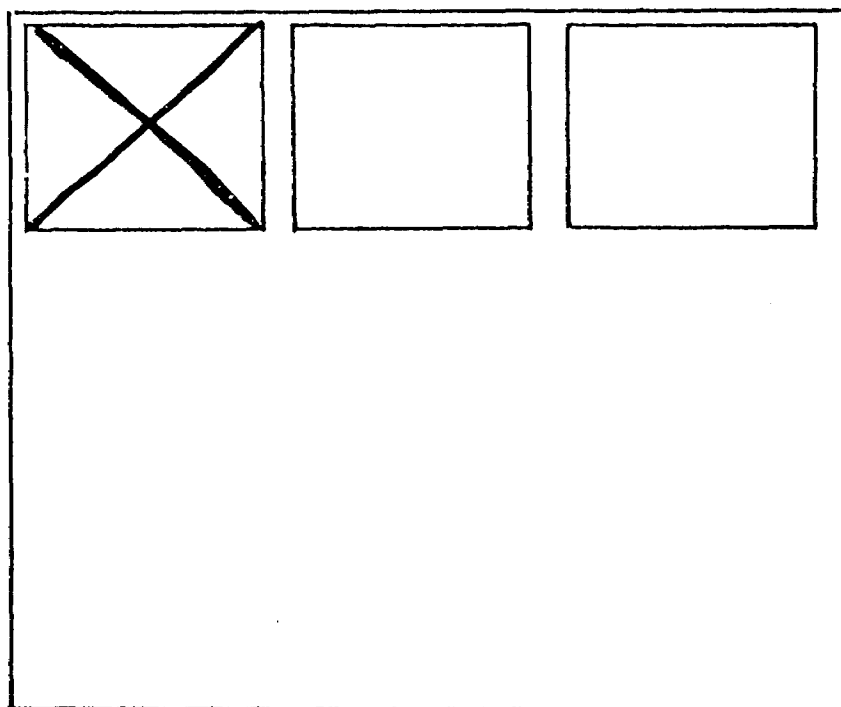

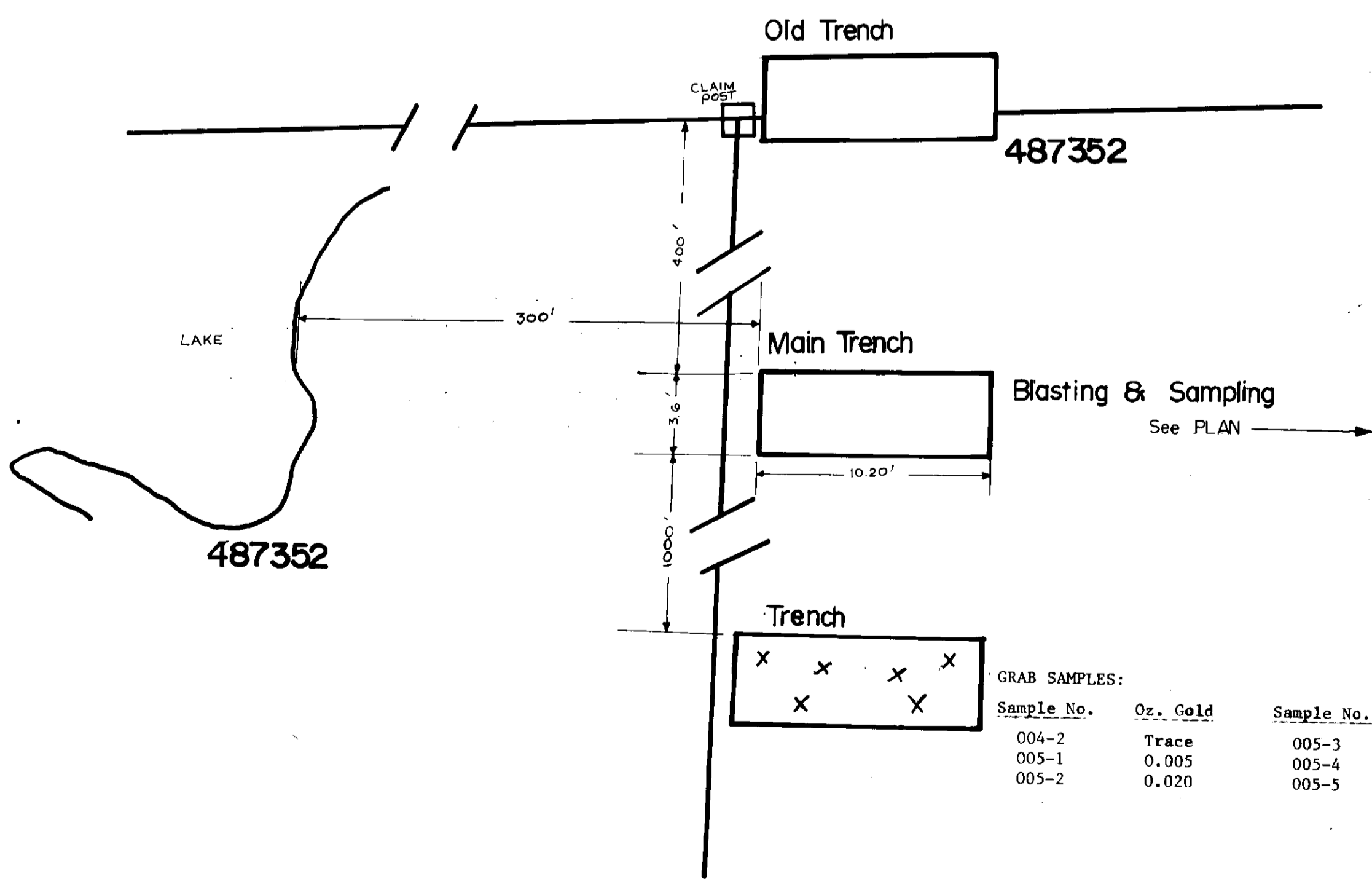
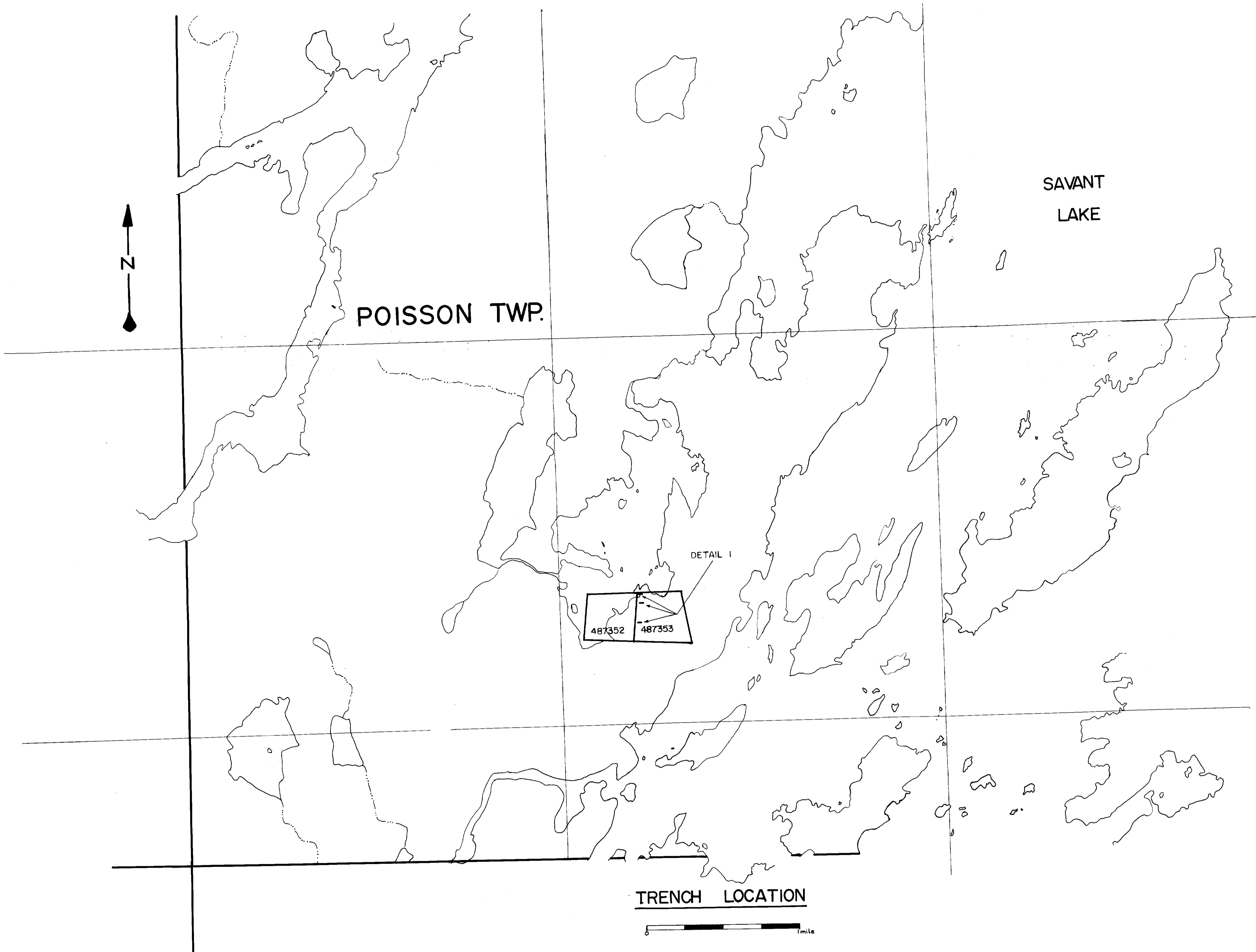

GRAB SAMPLES:

Sample No.	Oz. Gold	Sample No.	Oz. Gold
004-2	Trace	005-3	Trace
005-1	0.005	005-4	Trace
005-2	0.020	005-5	0.056

△ PYRITE
001-1 SAMPLE NO.

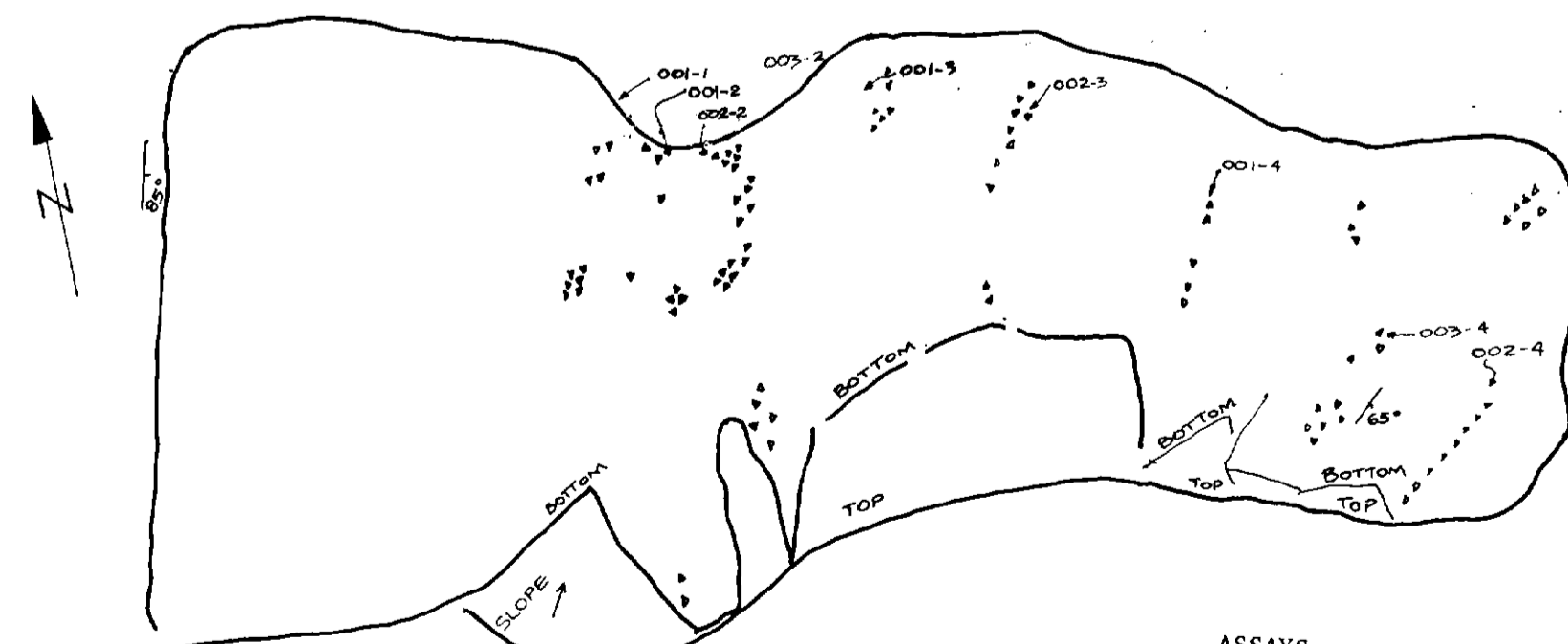

ASSAYS:

Sample No.	Oz. Gold
001-1	0.012
001-2	Trace
001-3	0.120
001-4	0.014
002-2	Trace

PATRICIA MINING DIV.
RECEIVED
JUL 27 1992
A.M. P.M.
7:8,9,10,11:12:1,2,3,4,5,6

Sample No.	Oz. Gold
002-3	Trace
002-4	0.006
003-2	0.005
003-4	0.005

DETAIL I

REVISED	TRENCHING & ASSAYS	
	Project: Poisson Twp.	Date: 7/23/92
	Surveyed By: K. B.	Drawn By: L.K.
	PROJ. No.:	DWG. No.:
	N.T.S.: 52 J B	Scale:
	ABITIBI-PRICE MINERAL RESOURCES DIVISION	

52J/07NE-0034-A1, #1

52 J/8NW
(34)

