

PATRICIA  
MINING DIV.  
R F I W F D  
JUN -4 1975  
AM 7:00 PM 1:00

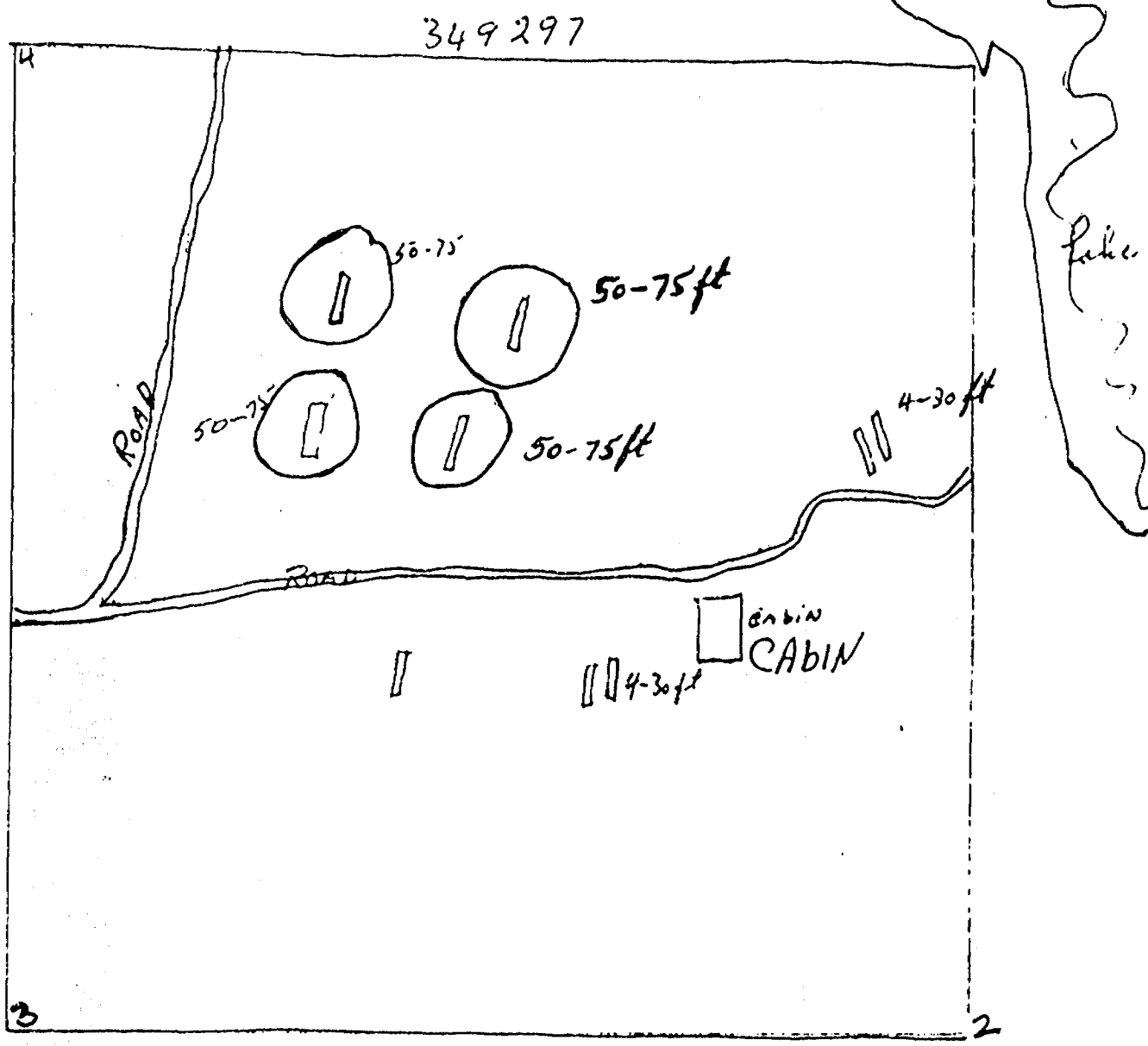

010



Work done pretty well middle of claim

Eric Hadley

— means Trench

○ Bull Dozer clearing & clean off rock

BULL DOZER clearing & clean off rock.





52J07SE0019 52J07SE68B1 EVANS LAKE

900



ONTARIO

EVANS LAKE 52 J/75E

M-1774

A separate form is required for each type of work to be recorded.

75-41

THE MINING ACT REPORT OF WORK

To the Recorder of Sourou Look Out Mining Division  
I, Eric W. Hadley E 23399  
name of Recorded Holder Miner's Licence

do hereby report the performance of 111 1/2 Post Office Address days of Shipping Rock  
type of work

not before reported to be applied on the following contiguous claims

Claim No.	Days	Claim No.	Days	Claim No.	Days
349297	60.4				

All the work was performed on Mining Claim (s) 349297  
(In the case of geological and/or geophysical survey (s) where more than 18 claims are involved attach a schedule)

READ CAREFULLY: THE FOLLOWING INFORMATION IS REQUIRED BY THE MINING RECORDER.

- For Manual Work, Stripping or Opening up of Mines, Sinking Shafts or Other Actual Mining Operations - Names and addresses of the men who performed the work and the dates and hours of their employment.
- For Diamond and other Core Drilling - Footage, No. and angle of holes and diameter of core. Name and address of owner or operator of drill. Dates when drilling was done. Signed core log and sketch in duplicate.
- For Compressed Air or Other Power Driven or Mechanical Equipment  
Type of drill or equipment. Names and addresses of men engaged in operating equipment and the dates and hours of their employment.
- For Power Stripping - Type of equipment. Name and address of owner or operator. Amount expended. Dates on which work was done. Proof of actual cost must be submitted within 30 days of recording.
- With each of the above types of work sketches are required to show the location and extent of the work in relation to the nearest claim post. In the case of diamond or other core drilling the sketch must be submitted in duplicate.
- For Geological and Geophysical Survey - The names and addresses of men employed as well as dates. Type of instrument used in the case of geophysical survey. Reports and maps in duplicate must be filed with the Minister within 60 days of recording.
- For Land Survey - the name and address of Ontario Land surveyor.

The Required Information is as Follows: (Attach a list if this space is insufficient)

Work done May 26-27-28  
By Claude Le Page

days performed 111 days  
 days recorded 60.4  
 days previously recorded 50.6  
 not allowed 11.0

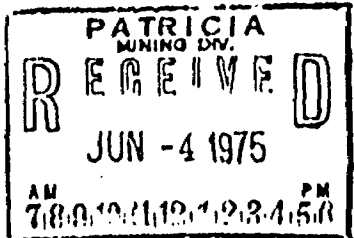

Date June 4<sup>th</sup> / 75 Signature of Recorded Holder or Agent Eric Hadley

The Mining Act Certificate Verifying Report of Work

I, ERIC HADLEY  
RR13 Thunder Bay  
(Post Office Address)

hereby certify:

- That I have a personal and intimate knowledge of the facts set forth in the report of work annexed here-to, having performed the work or witnessed same during and/or after its completion.
- That the annexed report is true.

Dated June 4<sup>th</sup> 19 75 Signature Eric Hadley  
Pa. 349297

THE PENALTY FOR MAKING A FALSE STATEMENT IN THIS REPORT AND/OR CERTIFICATE IS \$500. OR SIX MONTHS IMPRISONMENT OR BOTH

SAVANT FOREST PRODUCTS  
SAVANT LAKE, ONTARIO.

SHIP NUMBER	008881
DATE	MAY 31/75
CUSTOMER'S ORDER	
SALESMAN	
TERMS	
F.O.B.	

SOLD TO ERIC HADLEY  
THUNDER BAY, ONTARIO  
SHIPPED TO \_\_\_\_\_  
ADDRESS \_\_\_\_\_ VIA \_\_\_\_\_

INVOICE

WORK PERFORMED ON MINING CLAIM 4 MILES NORTH OF SAVANT LAKE				
FLOATING			60	00
D7E P/S TRACTOR STRIPPING 30 HOURS @ \$35.00 PER HOUR			1050	00
<i>Paul Wickham</i> TOTAL			1110	00

REDIFORM - 7M33