



52J07SE8806 19 JUTTEN

010

Diamond Drilling

Township OF JUTTEN

Report NO: 19

Work performed by: J. DONNER

Claim NO	Hole NO	Footage	Date	Note
Pa.309417	1	708'	Mar/72	(1)
	7	348'	Mar/72	(1)
Pa.202294	2	278'	Mar/72	(1)
	3	218'	Mar/72	(1)
Pa.202293	4	38'	Mar/72	(1)
Pa.202296	5	168'	Mar/72	(1)
	6	208'	Mar/72	(1)
<hr/>				
7 DH		<hr/> 1966.0'		

Notes:

- (...) date placed on file
- (1) 315/72 (June/72)

DIAMOND DRILL RECORD

Hole No: <u>1-PA. 307417</u>	Sheet No: <u>1</u>	Started: <u>March 13, 1972</u>	Completed: <u>March 18, 1972</u>
Location: <u>600N-275E (0-0-B.line)</u>	Latitude: _____	Departure: _____	Elevation: _____
Bearing: <u>West</u>	Dip: <u>52°</u>	Length: <u>708'</u>	
Purpose: <u>to test E.M. Conductor</u>			

FOOTAGE		LOGGED BY: <u>J. Donner</u>	CORE A.Q.							
From	To	Description	Sample No	Footage		Width	Cu	Zn	Ag	Cd
				From	To					
0	47	Casing								
47	708	Hard, fine grain greenstone (72' - 75' white bull quartz 32' a little native copper along slips 419' slight shearing 498' - 505' dark hard quartz feldspar porphyry) End of hole -								

PATRICIA
 MINING DIV.
 REPT. W/RE
 NOV - 3 1972
 119, 128, 417, 5
 PH

John Donner
 Nov 1st/72

208 -
 228 -
 238 -
 338 -
 168 -
 208 -
 348 -
 1966

DIAMOND DRILL HOLE No 1 - @ 52°
COLLAR LOCATION 600'N - 275'E (0-0 BASE LINE) -
SCALE 1" = 100'

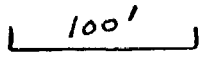

~~D.D.H. No 1~~

S U R F A C E

47' CASING
72' white bull quartz
82' ~~white native copper along clars~~

SECTION
Facing South-East

hard fine grain greenstone

41' slight shearing

505' ~~dark hard quartz - feldspar - porphyry~~

hard fine grain greenstone

708' END OF HOLE

BIRD RIVER MINES
SAVANT LAKE OPTION
Approx. 3000 Acres.
Jutten Township
ONTARIO

John Donner
Nov 1st/72

DIAMOND DRILL RECORD

Hole No <u>2 PA 202294</u>	Sheet No <u>1</u>	Started <u>March 19, 1972</u>	Completed <u>March 20, 1972</u>
Location <u>3005E-985S</u>	Latitude _____	Departure _____	Elevation _____
Geoging <u>South</u>	Dip <u>35°</u>	Length <u>278'</u>	
Purpose <u>to test E.M. conductor</u>			

FOOTAGE		LOGGED BY: J. Donner	CORE A.Q.								
From	To	Description	Sample No	Footage		Width	Cu P.P.M	Pb P.P.M	Zn P.P.M	Ag P.P.M	Cd
				From	To						
0	14'	Casing									
14'	175'	hard fine grain greenstone (a little sulphide at 25', slightly siliceous zones up to 18" to about 50') 92'-94' dark hard quartz feldspar porphyry 102'-107' " " " " " 137'-148' " " " " "									
175'	208'	88'-175' several minor shears fine grain altered diorite? some shearing/									
208'	247.5'	brown and dark red gossan (brown gossan - drill sludge recovered 17 oz brown, with some dark red gossan drill sludge recovered 26 oz brown gossan, drill sludge recovered 22 oz all dark red gossan, drill sludge recovered 4 oz drill sludge recovered 12 oz	569	208	218	10'-lost 4'	284	23	2000	1.6	
			570	218	228	10'-lost 7'	138	20	345	0.9	
			571	228	238	10'-lost 7'	160	28	280	0.9	
			572	238	248	10'-lost 4'	135	27	172	0.8	
			573	248	258	10'	138	14	175	1.0	
247.5		altered greenstone at 247.5' grading into hard, fine grain greenstone at 260' and to end of hole -									
	278'	end of hole.									

John Donner
Nov 1st/72

Diamond Island

L A K E

E.M. CONDUCTOR

10' CASING

hard fine grain greenstone

93' dark hard quartz feldspar porphyry
hard fine grain greenstone
107' dark hard quartz feldspar porphyry

SECTION
Facing - EAST

hard fine grain greenstone

148' dark hard quartz feldspar porphyry

hard fine grain greenstone

175'

DIAMOND DRILL HOLE No 2 - @ 35°

COLLAR LOCATION 3005'E - 985'S

SCALE 1" = 25'

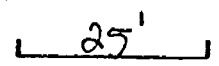

	CU	Pb	ZN	Ag		
	PPM	PPM	PPM	PPM		
					208	
284	23	2000	1.6		10'	brown gossan
138	20	345	0.9		10'	brown & dark red gossan
162	28	280	0.9		10'	brown gossan
125	27	172	0.3		10'	247.5' all dark red gossan
138	14	175	1.0		10'	

fine grain altered diorite?
some shalving

hard fine grain greenstone

278' end of hole

BIRD RIVER MINES

SAVANT LAKE OPTION

Approx. 3000 Acres.

Jutten Township

ONTARIO

John Bonner
Nov 1st / 72

DIAMOND DRILL RECORD

Hole No 3 - P.A. 20229A
 Location 3173E - 1375S
 Bearing South
 Purpose to test E.M. Conductor

Sheet No 1
 Latitude _____
 Dip 35°

Started March 21, 1972
 Departure _____
 Length 218

Completed March 23, 1972
 Elevation _____

FOOTAGE		LOGGED BY : J. Donner	CORE A.Q.							
From	To	Description	Sample No	Footage		Width	Cu	Zn	Ag	Cd
				From	To					
0	22'	Casing								
22'	59'	hard fine grain greenstone								
59'	63'	quartz feldspar porphyry								
63'	153.5'	hard fine grain greenstone with soft shears - (120'-128' shear lost 6.5 feet of core 148'-153.5' shear lost 2.5 feet of core)								
153.5'	158.5'	fine grain acid dyke, slightly altered and a little red stain								
158.5'		hard fine grain greenstone with soft shears - (158.5' to 165' shear lost 2.5 feet of core)								
	218'	End of hole.								

John Donner
Nov 1st/72

DIAMOND DRILL HOLE No 4 - @35°

COLLAR LOCATION 2100'E - 120'S

SCALE 1" = 5'

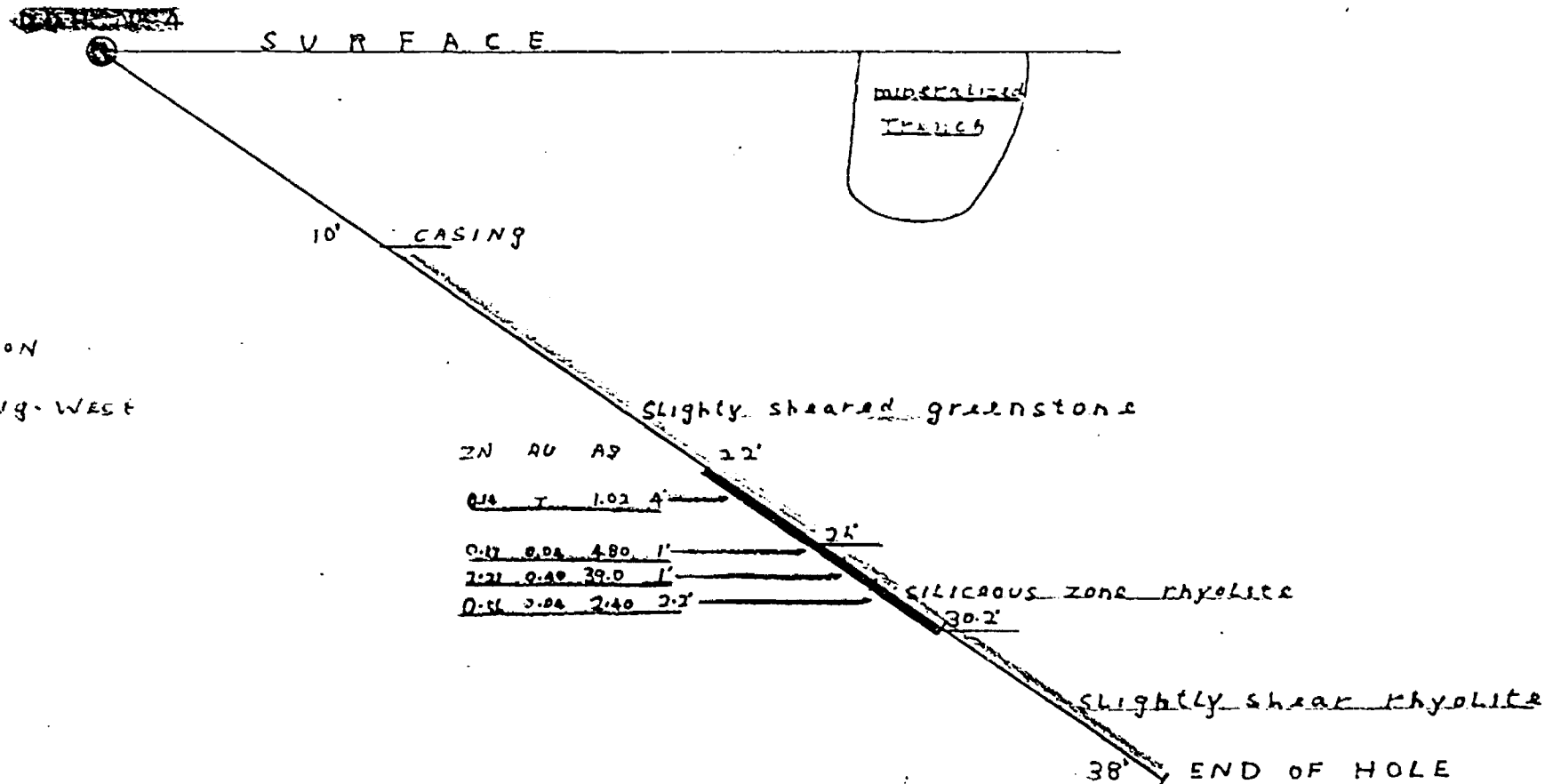
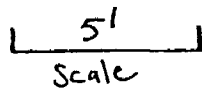

BIRD RIVER MINES

SAVANT LAKE OPTION

Approx. 3000 Acres.

Jutten Township

ONTARIO

John Pomeroy
Nov 1st/72

DIAMOND DRILL RECORD

Hole No <u>1 - PA 202293</u>	Sheet No <u>1</u>	Started <u>March 23, 1972</u>	Completed <u>March 23, 1972</u>
Location <u>2100'E - 220'S</u>	Latitude _____	Departure _____	Elevation _____
Bearing <u>North</u>	Dip <u>35°</u>	Length <u>38'</u>	
Purpose <u>Mineralized Trench</u>			

FOOTAGE		LOGGED BY: <u>J. Donner</u>	CORE A.Q.								
From	To	Description	Sample No	Footage		Width	Cu	Au	Zn	Ag	Cd
				From	To						
0	14	Casing									
14	26	Slightly sheared greenstone with narrow bands of rhyolite that are mineralized, and a little more pyrite and sphalerite 22' to 26'	312	22'	26'	4'		T	0.14	1.02	
26	30.2	Siliceous zone, rhyolite, some pyrite, sphalerite and galena	313	26'	27'	1'		0.04	0.17	4.80	
			314	27'	28'	1'		.40	2.21	39.0	
			315	28'	30.2'	2.2'		.04	.56	2.40	
30.2	38	Slightly sheared rhyolite									
		End of Hole									

John Donner
non-st
 72

DIAMOND DRILL HOL N^o 3-@ 35°

COLLAR LOCATION 3173E-1375S

SCALE 1" = 25'

Scale
25'

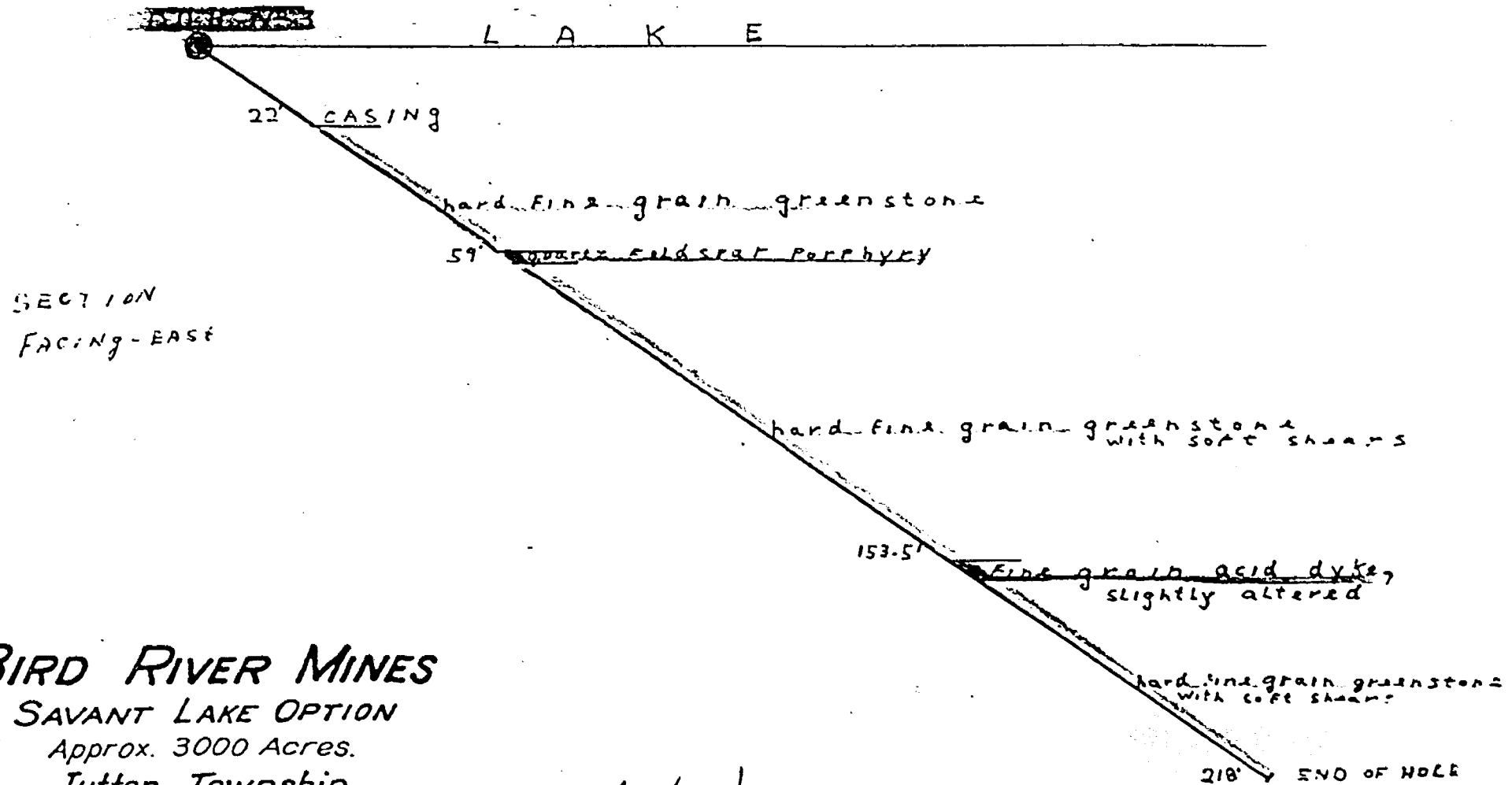

BIRD RIVER MINES

SAVANT LAKE OPTION

Approx. 3000 Acres.

Jutten Township

ONTARIO

John Bonser
now 1st/12

DIAMOND DRILL RECORD

Hole No <u>5 - P.A. 201296</u>	Sheet No <u>1</u>	Started <u>March 25, 1972</u>	Completed <u>March 26, 1972</u>
Location <u>5100'E - 630'S</u>	Latitude _____	Departure _____	Elevation _____
Bearing <u>North</u>	Dip <u>37°</u>	Length <u>168'</u>	
Purpose <u>To test P.M. conductor</u>			

FOOTAGE		LOGGED BY: J. Donner	CORE A.Q.							
From	To	Description	Sample No	Footage		Width	Cu	Zn	Ag	Co
				From	To					
0	19'	Casing								
19	91'	Hard fine grained greenstone								
91	109'	Hard fine grained greenstone with patches of rhyolite(?) (100.1' - 103.8' 50% pyrite, some massive with a little chalcopyrite)								
109	132'	Rhyolite(?)								
132		Hard fine grained greenstone								
	168'	End of hole								

*John Donner
Nov 1st/72*

DIAMOND DRILL RECORD

Hole No 6-102296
 Location 5100'E - 630'S
 Bearing North
 Purpose To test F.M. conductor

Sheet No 1
 Latitude _____
 Dip 52°

Started March 26, 1972
 Departure _____
 Length 208'

Completed March 27, 1972
 Elevation _____

FOOTAGE		LOGGED BY : J. Donner	CORE A.Q.							
From	To	Description	Sample No	Footage		Width	Cu	Zn	Ag	Cd
				From	To					
0	16'	Casing								
16	127.5'	Hard fine grained greenstone								
127.5	148.5'	Rhyolite?								
148.5	165.5'	Quartz feldspar porphyry								
165.5		Hard fine grained greenstone								
	208'	End of hole								

John Donner
 nov. 1st/72

DIAMOND ~~DRILL HOLE~~
 COLLAR LOCATIONS 5100E - 630S
 SCALE 1" = 25'

25'
 Scale

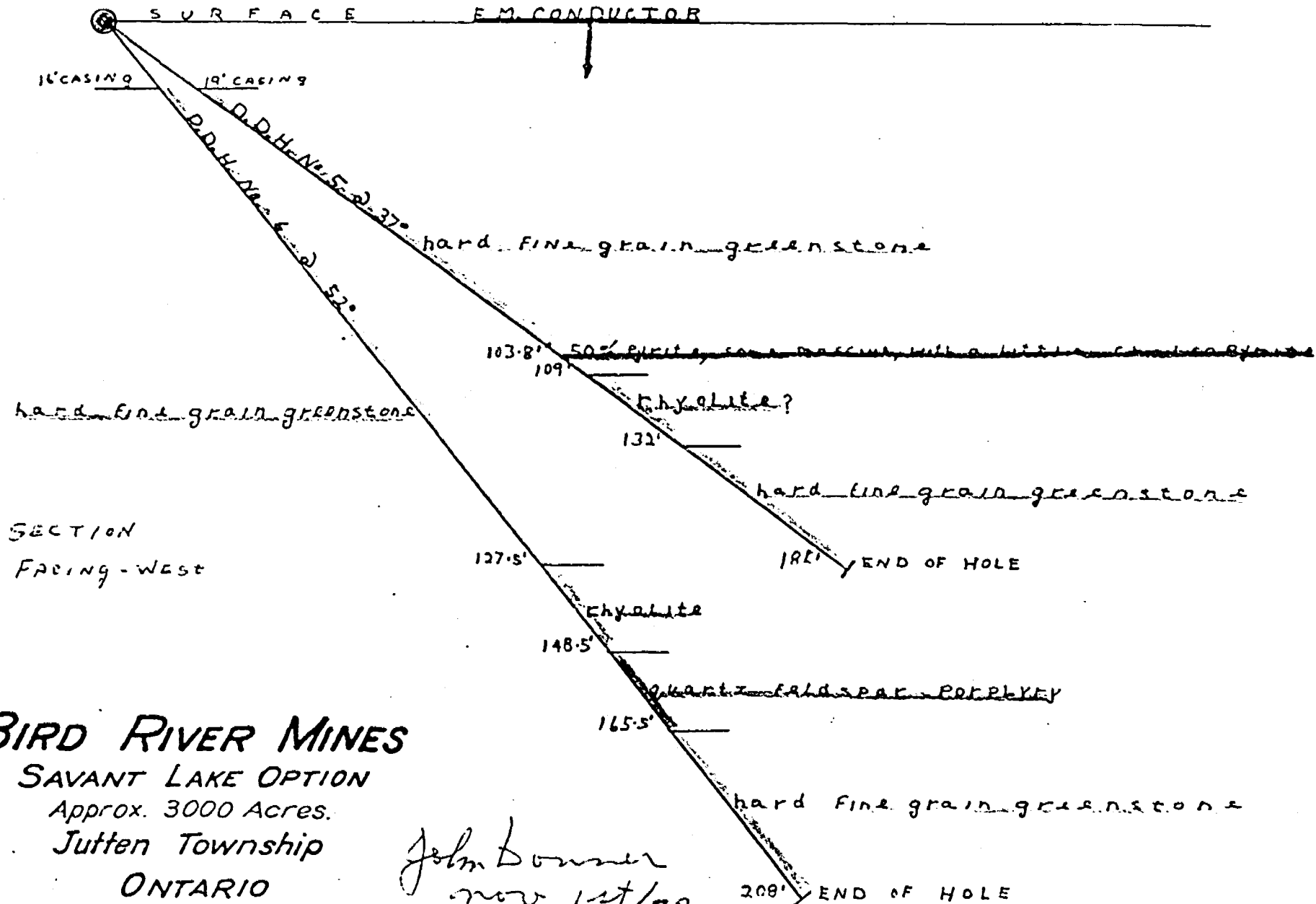

BIRD RIVER MINES
 SAVANT LAKE OPTION
 Approx. 3000 Acres.
 Jutten Township
 ONTARIO

John Bonner
 Nov. 1st/72

208' END OF HOLE

DIAMOND DRILL RECORD

PA 309417

Hole No <u>PA 2022-17</u>	Sheet No <u>1</u>	Started <u>March 29, 1972</u>	Completed <u>March 30, 1972</u>
Location <u>26°W-140°N (Q-Q-Base line)</u>	Latitude _____	Departure _____	Elevation _____
Beering <u>South</u>	Dip <u>43°</u>	Length <u>348'</u>	
Purpose <u>to test E.H. Conductor</u>			

FOOTAGE		LOGGED BY : J. Donner	CORE A.Q.								
From	To	Description	Sample No	Footage		Width	Cu P.P.M.	Pb P.P.M.	Zn P.P.M.	Ag P.P.M.	Cd
				From	To						
0	14'	Casing									
14'	114'	hard fine grain greenstone									
114'	118'	soft altered and sheared greenstone									
118'	143'	sheared altered soft fine grain grey greenstone, grading into brown gossan -	574	118'	143'	25' lost, 8.1'	126	14	164	15	
143'	166.5'	dark red gossan	575	143'	161.2'	18.2'	116	13	63	10	
166.5	180.2'	quartz diorite, contacts are sharp and altered -									
180.2	188'	lost core, few dark red gossan pebbles -									
188'		hard fine grain greenstone (sheared first few feet from contact)									
		patches of massive chlorite starting at 219' to 346' -									
		300' <i>little native copper</i>									
	348'	end of hole.									

*John Donner
Nov. 1st/72*

DIAMOND DRILL HOLE 1/2 7 @ 43°

COLLAR LOCATION 21'W - 140'N (0-0 BASE LINE)

SCALE 1" = 50'

Scale
50'

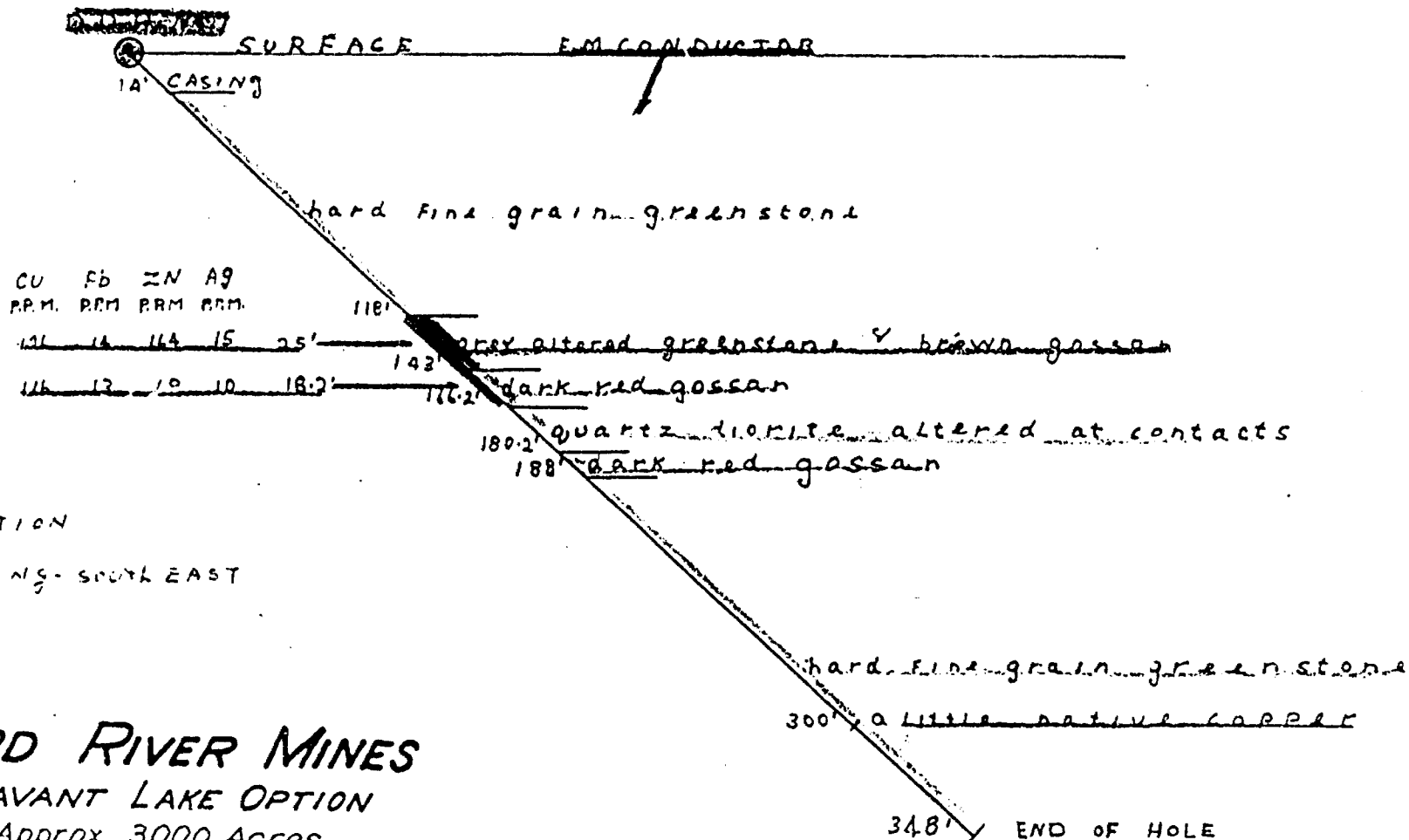

SECTION

FACING - SOUTH EAST

BIRD RIVER MINES

SAVANT LAKE OPTION

Approx. 3000 Acres.

Jutten Township

ONTARIO

John Lanner
Nov 1st/72

JUTTEN IWP M-1767



A separate form is required for each type of work to be recorded.

315 (a)

52 J/O7 SE (107) THE MINING ACT REPORT OF WORK

To the Recorder of Sioux Lookout Mining Division

I, John Donner name of Recorded Holder 98 Balmoral Street, Winnipeg, Manitoba R3C 1X4 Post Office Address

H-8596 Miner's Licence

do hereby report the performance of 600 1937 days of Diamond Drilling type of work not before reported to be applied on the following contiguous claims

Table with 6 columns: Claim No., Days, Claim No., Days, Claim No., Days. Lists various mining claims and their durations.

All the work was performed on Mining Claim (s) P.A. 202293, P.A. 202294, P.A. 202296, P.A. 309417. (In the case of geological and/or geophysical survey (s) where more than 18 claims are involved attach a schedule)

READ CAREFULLY: THE FOLLOWING INFORMATION IS REQUIRED BY THE MINING RECORDER.

- For Manual Work, Stripping or Opening up of Mines, Sinking Shafts or Other Actual Mining Operations - Names and addresses of the men who performed the work and the dates and hours of their employment. For Diamond and other Core Drilling - Footage, No. and angle of holes and diameter of core. Name and address of owner or operator of drill. Dates when drilling was done. Signed core log and sketch in duplicate. For Compressed Air or Other Power Driven or Mechanical Equipment Type of drill or equipment. Names and addresses of men engaged in operating equipment and the dates and hours of their employment. For Power Stripping - Type of equipment. Name and address of owner or operator. Amount expended. Dates on which work was done. Proof of actual cost must be submitted within 30 days of recording. With each of the above types of work sketches are required to show the location and extent of the work in relation to the nearest claim post. In the case of diamond or other core drilling the sketch must be submitted in duplicate. For Geophysical, Geological, Geochemical Surveys and Expenditure Credits - the name of author of report. Covering dates of survey (linecutting & office). Type of instrument used. Total amount of expenditure. Technical reports, maps, expenditure breakdown, receipts must be filed in duplicate with the Minister within 60 days of recording. For Land Survey - the name and address of Ontario Land surveyor.

The Required Information is as Follows: (Attach a list if this space is insufficient)

Diamond Drilling Contractor Griffith Bros. Drilling Ltd. Box 129, Lac du Bonnet, Manitoba, ROE 1A0

Drilling completed - 1937 Credits used - 600

Foreman George H. Graham

Balance for future use = 1,337

Type of Diamond Drill - BBS-1-Wireline

Work done from March 13, 1972 to and inclusive of March 30, 1972

Date November 1st, 1972

Signature of Recorded Holder or Agent

The Mining Act Certificate Verifying Report of Work

I, John Donner 98 Balmoral Street, Winnipeg, Manitoba, R3C 1X4 (Post Office Address)

hereby certify:

- 1. That I have a personal and intimate knowledge of the facts set forth in the report of work annexed hereto, having performed the work or witnessed same during and/or after its completion. 2. That the annexed report is true

Dated November 1st 1972

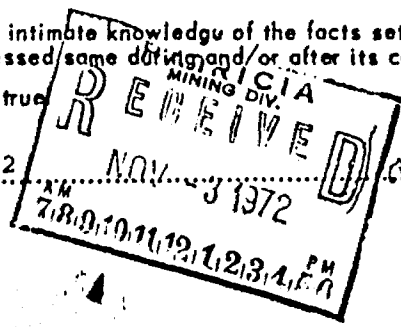

Signature

Pa. 202292

THE PENALTY FOR MAKING A FALSE STATEMENT IN THIS REPORT AND/OR CERTIFICATE IS \$500. OR SIX MONTHS IMPRISONMENT OR BOTH

JUTTEN TWP.



ONTARIO

M-1767

Sheet No. 2

A separate form is required for each type of work to be recorded.

315 (A)

THE MINING ACT REPORT OF WORK

To the Recorder of.....Sioux Lookout.....Mining Division

I, John Donner name of Recorded Holder H-8596 Miner's Licence

98 Balmoral Street, Winnipeg, Manitoba, R3C 1X4 Post Office Address

do hereby report the performance of 600 1937 days of Diamond Drilling type of work

not before reported to be applied on the following contiguous claims

Table with 6 columns: Claim No., Days, Claim No., Days, Claim No., Days. Rows include P.A. 309919, P.A. 309920, P.A. 330324.

All the work was performed on Mining Claim (s) P.A. 202293, P.A. 202294, P.A. 202296, P.A. 309417... (In the case of geological and/or geophysical survey (s) where more than 18 claims are involved attach a schedule)

READ CAREFULLY: THE FOLLOWING INFORMATION IS REQUIRED BY THE MINING RECORDER.

For Manual Work, Stripping or Opening up of Mines, Sinking Shafts or Other Actual Mining Operations - Names and addresses of the men who performed the work and the dates and hours of their employment.

For Diamond and other Core Drilling - Footage, No. and angle of holes and diameter of core. Name and address of owner or operator of drill. Dates when drilling was done. Signed core log and sketch in duplicate.

For Compressed Air or Other Power Driven or Mechanical Equipment Type of drill or equipment. Names and addresses of men engaged in operating equipment and the dates and hours of their employment.

For Power Stripping - Type of equipment. Name and address of owner or operator. Amount expended. Dates on which work was done. Proof of actual cost must be submitted within 30 days of recording.

With each of the above types of work sketches are required to show the location and extent of the work in relation to the nearest claim post. In the case of diamond or other core drilling the sketch must be submitted in duplicate.

For Geophysical, Geological, Geochemical Surveys and Expenditure Credits - the name of author of report. Covering dates of survey (linecutting & office). Type of instrument used. Total amount of expenditure. Technical reports, maps, expenditure breakdown, receipts must be filed in duplicate with the Minister within 60 days of recording.

For Land Survey - the name and address of Ontario Land surveyor.

The Required Information is as Follows: (Attach a list if this space is insufficient)

Diamond Drilling Contractor Griffith Bros. Drilling Ltd. Box 129, Lac du Bonnet, Manitoba, ROE 1A0

Foreman George H. Graham

Type of Diamond Drill - BBS-1-Wireline

Work done from March 13, 1972 to and inclusive of March 30, 1972

Date November 1st, 1972 Signature of Recorded Holder or Agent

The Mining Act Certificate Verifying Report of Work

I, John Donner

98 Balmoral Street, Winnipeg, Manitoba, R3C 1X4 (Post Office Address)

hereby certify:

- 1. That I have a personal and intimate knowledge of the facts set forth in the report of work annexed hereto, having performed the work or witnessed same during and/or after its completion.
2. That the annexed report is true.

Dated November 1st, 1972 Signature

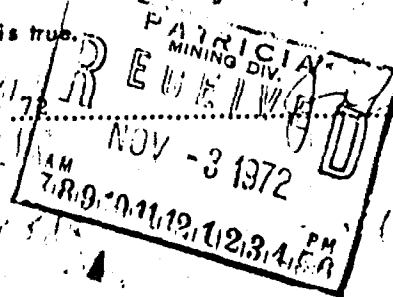

Pa. 202292

THE PENALTY FOR MAKING A FALSE STATEMENT IN THIS REPORT AND/OR CERTIFICATE IS \$500. OR SIX MONTHS IMPRISONMENT OR BOTH

202293
9

202294
278
218
496

202296
168
208
376

309417
708
348
1056

SEE ACCOMPANYING
MAP(S) IDENTIFIED AS

52 J / 07 SE - 0029-A1 # 1

LOCATED IN THE MAP
CHANNEL IN THE FOLLOWING
SEQUENCE (x)

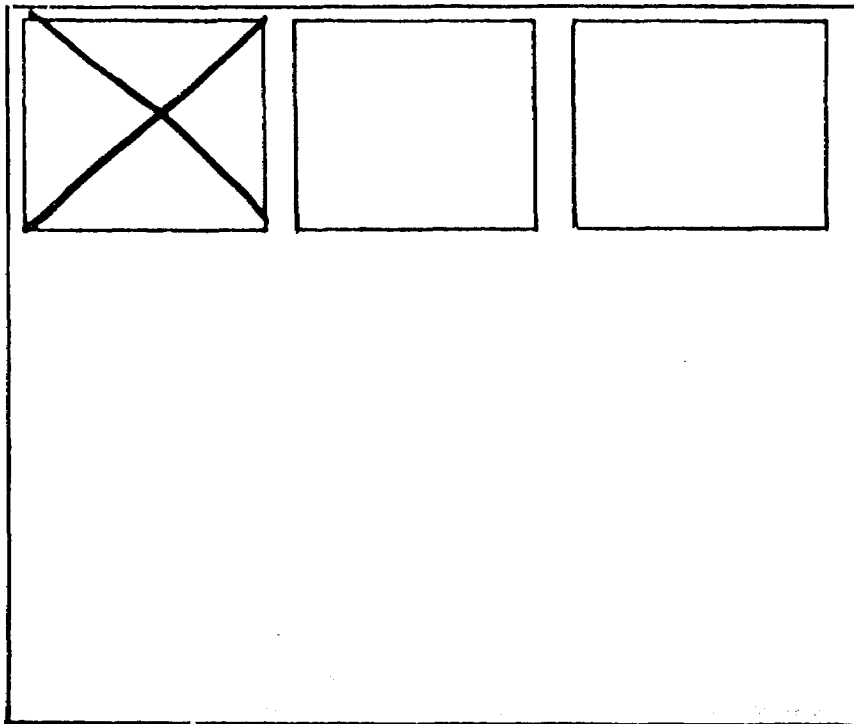

SAVANT LAKE
South Arm

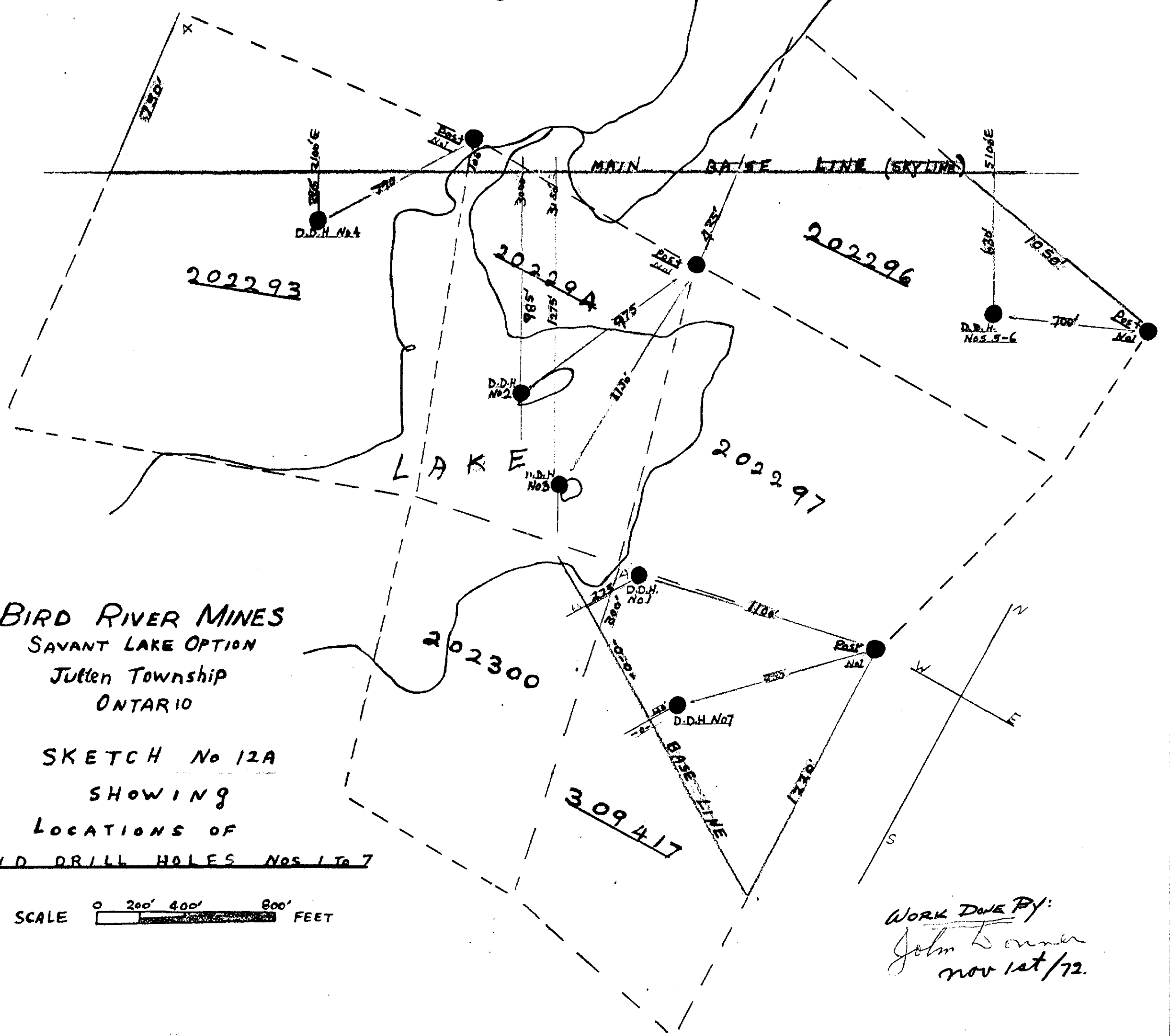

BIRD RIVER MINES
SAVANT LAKE OPTION
JUTTEN TOWNSHIP
ONTARIO

SKETCH No 12A
SHOWING
LOCATIONS OF
DIAMOND DRILL HOLES Nos 1 to 7

SKETCH SCALE 0 200' 400' 800' FEET

WORK DONE BY:
John Bonner
Nov 1st/72.

52J/07SE - 0029 - A1 #1



52J07SE8806 19 JUTTEN