

UNION MINIERE EXPLORATIONS AND MINING CORPORATION LIMITED
DRILL RECORD.

AREA SABIN II Hole No. GSI 1-84 Depth: 98 meters Drilled By: Bradley Bros.
 ANOMALY: Gols11 Bearing and Dip: 300°/44° Started: Dec. 1, 1984 Machine: Boyles 17A Described By:
 CLAIM: Pa 421553 Local Coord. X= LO+00 Y= 25E Z= Completed: Dec. 2, 1984 Diam Drill: BQ Brian Wing

Depth		%	Description & Lithology	Mineralization	Dip	No. of Sample.
From	To	Core				
0	8'		Casing			
8'	27		Intermediate to mafic tuff, becoming slightly more mafic at depth, feldspar phenocrysts @ 11.5 m 20 cm quartz vein @ 19 m rock becomes slightly foliated @ 20 m minor garnets in the core 21-22 m blocky core			
27	39		Garnets and staurolite present, rock is silicate iron formation 31 m increase in garnet percentage 34 10 cm chlorite band 35.5-36.5 garnets are coarser and up to 30% of core, staurolite alteration sulfides 38 m less garnets and they are fine grained 10 cm quartz veins @ 38 m and 39 m	S 10% (py)		
39	73		Massive, mafic to intermediate volcanic fine grained, contains chlorite and minor garnets 41 m quartz vein 42.5 m blocky core 43 m quartz alteration and 10 cm quartz vein 48 m chloritic alteration @ 52 m rock becomes slightly foliated 54-55 m garnet rich band with chlorite and quartz, may be thin silicate iron formation. 55 m & 57-58 blocky core Rock is intermediate to mafic with garnet horizons 61 m minor disseminated sulfides, the core is blocky and chopped up 62.5-64.5 metasediment with disseminated py and py fine grained groundmass	S < 7% py(po) S < 5%		

Depth		% of Core	Description & Lithology	Mineralization	Dip	No. of Samples
From	To					
73	75		2 m of altered dyke ?			
75	91		Intermediate tuff with an altered band from 79-82 @ 85 m rock becomes strongly foliated @ 45° to c.a. 88 m minor garnets <3% 89.5-89.6 quartz vein			
91	96		Very fine grained dacitic rock, greenish hue with staurolite alteration along contact, contact @ 45°, minor sulfides 91.8-92 quartz vein 93.5-93.8 " " 94 m less sulfides	py 3%		
96	98		96-96.2 blocky core intermediate volcanic 97-97.3m quartz vein with epidote and chlorite garnets at lower contact between quartz and intermediate volcanic minor sulfides in vein	py < 2%		
	98		END OF HOLE L0+00 0+25E 300°/44° collar 98 m 40° Left 8' casing in hole, hole makes water.	py = 2%		

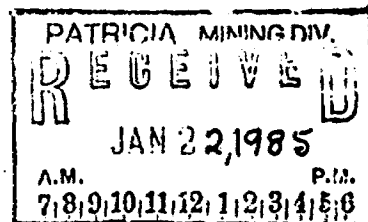

Alinger
 18/21/85

SRINIV II
 GOSIA 1984
 Hole GSL 1-84
 START DEC 1, 1984
 FINISH DEC 2, 1984

L 0700
 OF 25 E
 300°/44°

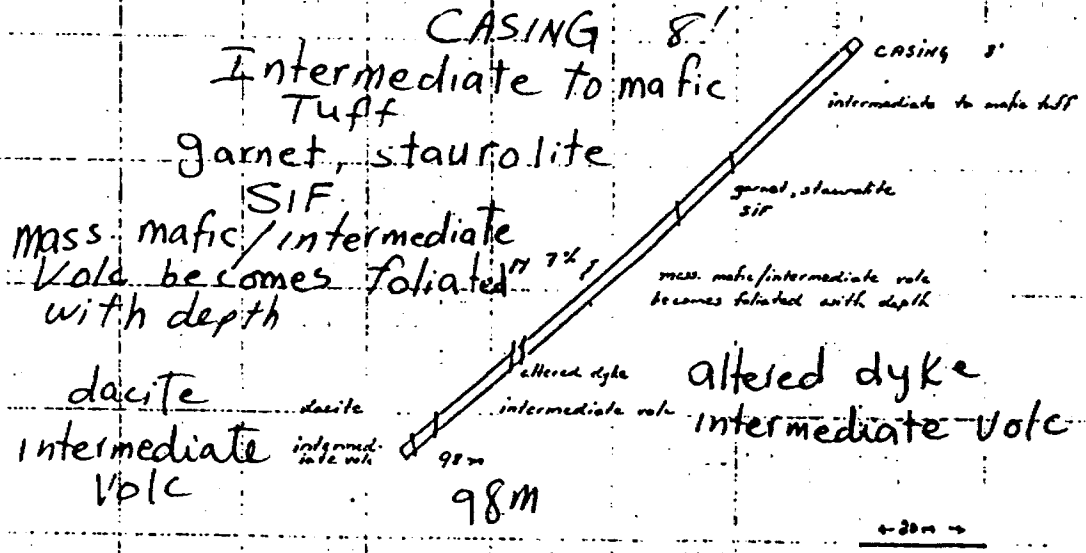

COLLAR 300/44 COLLAR 300/44
 98m 40°

LEFT 8' CASING AS HOLE MADE WATER
 LEFT 8' CASING AS HOLE MADE WATER

20m
 Scale

Alhager

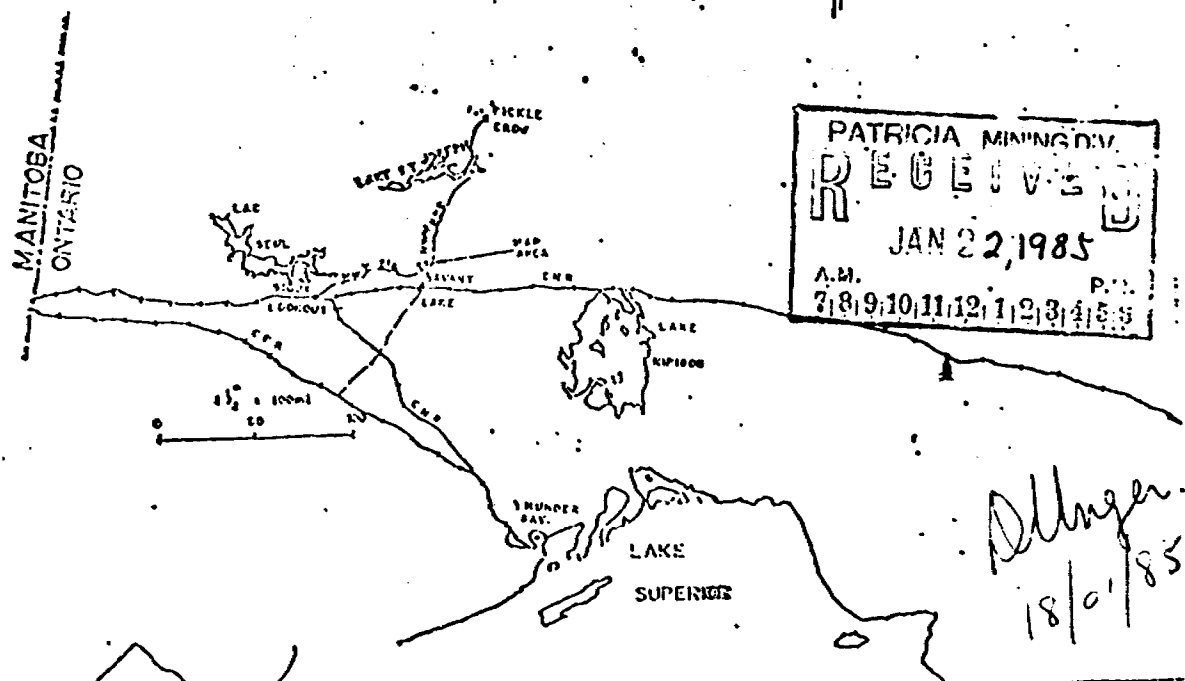
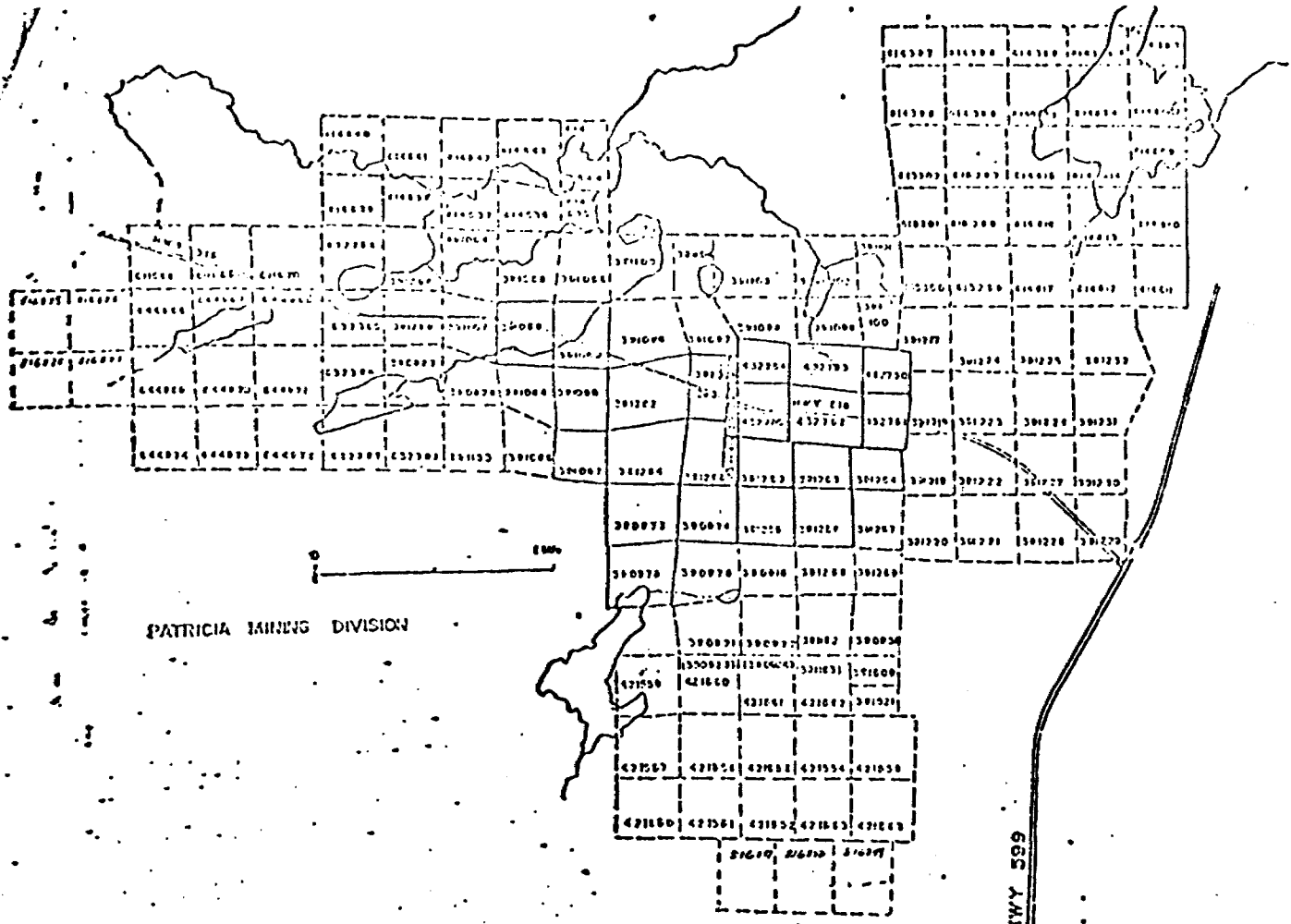

PATRICIA MINING DIV.
RECEIVED
 JAN 22, 1985
 A.M. P.M.
 7 | 8 | 9 | 10 | 11 | 12 | 1 | 2 | 3 | 4 | 5 | 6

D. Hager
 18/01/85



BRIAN HALL Geologist SEPT 1984

UMEX INC.
 SADRIN II CLAIMS
 LOCATION AND CLAIM PLAN

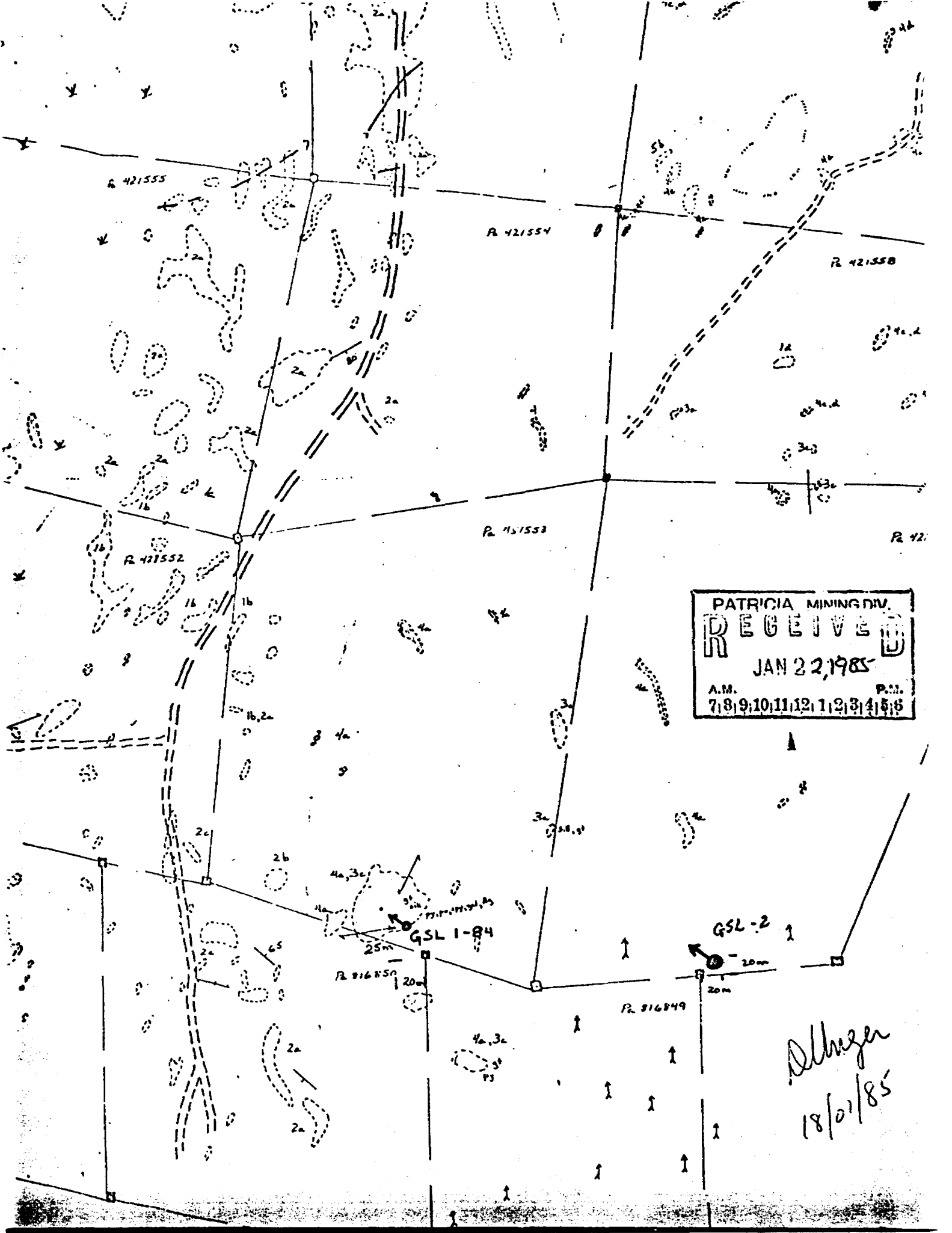

PATRICIA MINING DIV.
RECEIVED
 JAN 22, 1985
 A.M. P.M.
 7 8 9 10 11 12 1 2 3 4 5 6

Alizer
 18/01/85

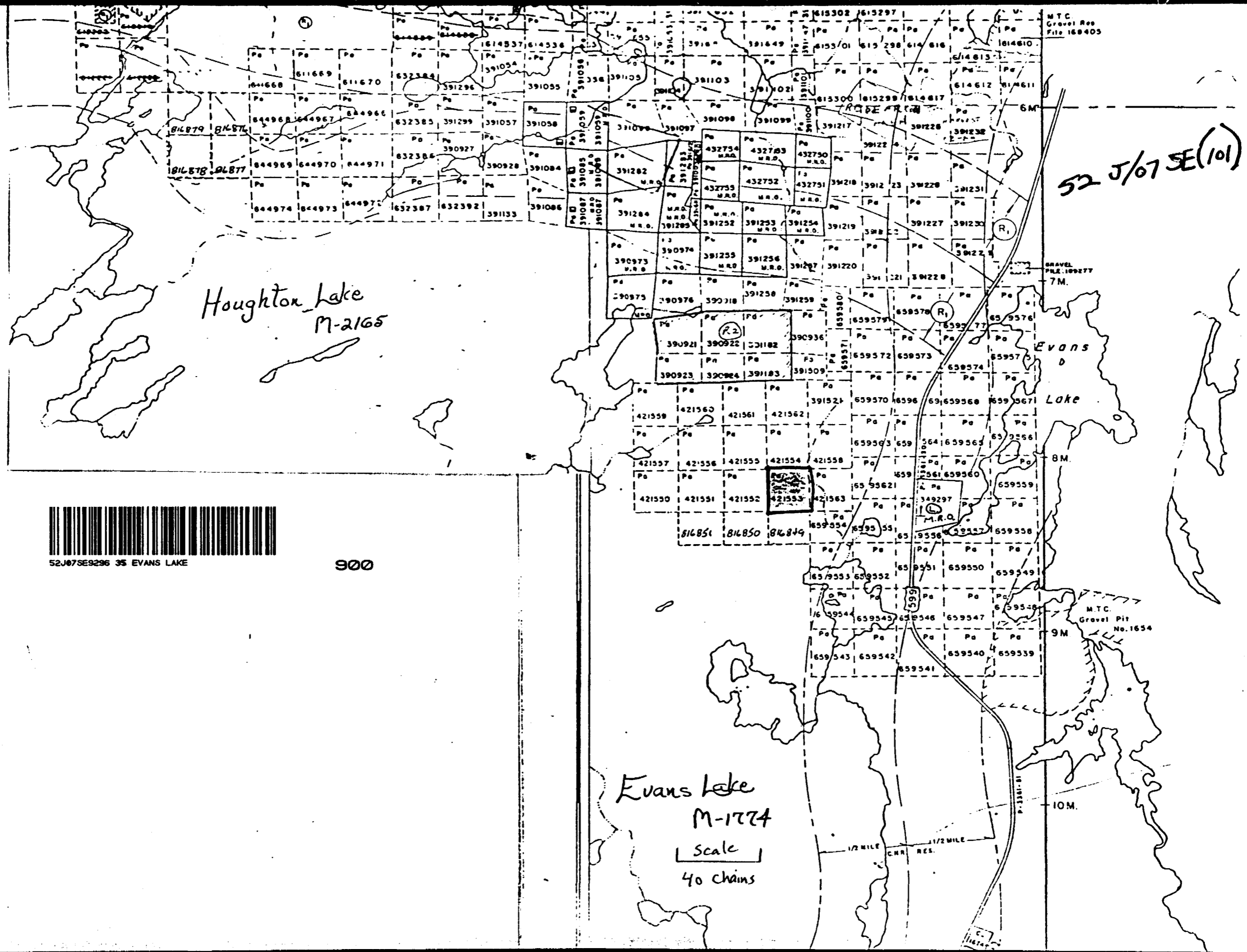

52 J/07 SE(101)

Houghton Lake
M-2165

Evans Lake
M-1774
Scale
40 chains

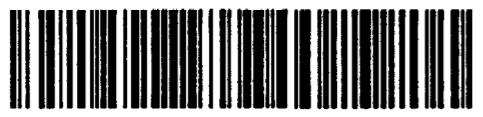

52J07SE9296 35 EVANS LAKE

900

M.T.C.
Gravel Pit
File 168405

GRAVEL
PIT 169277
7M.

M.T.C.
Gravel Pit
No. 1654

1/2 MILE CHR. RES.

10M.

8M.

Evans
Lake

615302 615297
615301 615298 614 616
614610
614613
614612 614611

615300 615299 614617
614618
614619

615301 615298 614 616
614610
614613
614612 614611

615300 615299 614617
614618
614619

615301 615298 614 616
614610
614613
614612 614611

615300 615299 614617
614618
614619

615301 615298 614 616
614610
614613
614612 614611

615300 615299 614617
614618
614619

615301 615298 614 616
614610
614613
614612 614611

615300 615299 614617
614618
614619

615301 615298 614 616
614610
614613
614612 614611

615300 615299 614617
614618
614619

615301 615298 614 616
614610
614613
614612 614611

615300 615299 614617
614618
614619

615301 615298 614 616
614610
614613
614612 614611

615300 615299 614617
614618
614619

615301 615298 614 616
614610
614613
614612 614611

615300 615299 614617
614618
614619

615301 615298 614 616
614610
614613
614612 614611

615300 615299 614617
614618
614619

615301 615298 614 616
614610
614613
614612 614611

615300 615299 614617
614618
614619

615301 615298 614 616
614610
614613
614612 614611

615300 615299 614617
614618
614619

615301 615298 614 616
614610
614613
614612 614611

615300 615299 614617
614618
614619

615301 615298 614 616
614610
614613
614612 614611

615300 615299 614617
614618
614619

615301 615298 614 616
614610
614613
614612 614611

EVANS Lake M-1774
 HOUGHTON Lake M-2165
 #85-24

The Mining Act

The Cost of Work (Capital, Operating, and Expenditures)

Name and Postal Address of Record Holder UMEX Inc 1935 Leslie Street, Don Mills, Ontario, M3B 2M3	Prospector's License No. T-133
---	-----------------------------------

Summary of Work Performance and Distribution of Credits

Total Work Days Cr. claimed 849.7272	Mining Claim		Work Days Cr.	Mining Claim		Work Days Cr.	Mining Claim		Work Days Cr.
	Prefix	Number		Prefix	Number		Prefix	Number	
for Performance of the following work. (Check one only)	Pa	614536	4						
<input type="checkbox"/> Manual Work									
<input type="checkbox"/> Shaft Sinking Drifting or other Lateral Work									
<input type="checkbox"/> Compressed Air, other Power driven or mechanical equip.									
<input type="checkbox"/> Power Stripping									
<input checked="" type="checkbox"/> Diamond or other Core drilling									
<input type="checkbox"/> Land Survey									

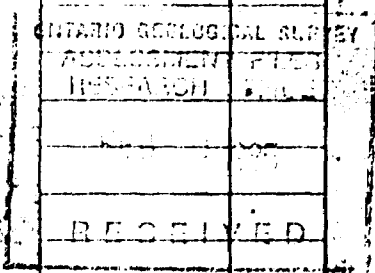

All the work was performed on Mining Claim(s): Pa 421553

Required Information eg: type of equipment, Names, Addresses, etc. (See Table Below)

DDH GSL 1-84 - Depth ^{321 feet} 98 meters - Bearing 300°, Dip 44° - Core size BQ drilled by Bradley Bros., December 1 and December 2, 1984.
 DDH GSL 2-84 - Depth ^{528 feet} 161 meters - Bearing 300°, Dip 45° - Core size BQ drilled by Bradley Bros., December 3 to December 5, 1984.

The remaining days to be held in abeyance for future submission. *Performed 849 days Using 4 days → 845 days*

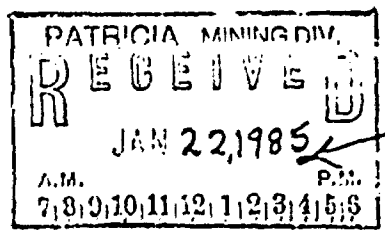

Recorded by [Signature]

Pa. 614535

Date of Report December 16, 1985	Recorded Holder or Agent (Signature) <i>[Signature]</i>
-------------------------------------	--

Certification Verifying Report of Work

I hereby certify that I have a personal and intimate knowledge of the facts set forth in the Report of Work annexed hereto, having performed the work or witnessed same during and/or after its completion and the annexed report is true.

Name and Postal Address of Person Certifying
Mr. F. Felder, c/o UMEX Inc, 1935 Leslie Street, Don Mills, Ont. M3B-2M3

Date Certified December 16, 1985	Certified by (Signature) <i>[Signature]</i>
-------------------------------------	--

Table of Information/Attachments Required by the Mining Recorder

Type of Work	Specific information per type	Other information (Common to 2 or more types)	Attachments
Manual Work	Nil	Names and addresses of men who performed manual work / operated equipment, together with dates and hours of employment.	Work Sketch: these are required to show the location and extent of work in relation to the nearest claim post.
Shaft Sinking, Drifting or other Lateral Work			
Compressed air, other power driven or mechanical equip.	Type of equipment	Names and addresses of owner or operator together with dates when drilling/stripping done.	Work Sketch (as above) in duplicate
Power Stripping	Type of equipment and amount expended. Note: Proof of actual cost must be submitted within 30 days of recording.		
Diamond or other core drilling	Signed core log showing; footage, diameter of core, number and angles of holes.	Nil	Nil
Land Survey	Name and address of Ontario land surveyer.		

AUTHOR'S QUALIFICATIONS

I, Frederick Felder of 7776 Nursery Street, Burnaby, B.C., V5E 2B4, certify the following:

I am a graduate of McGill University of B.Sc. Geology 1967 and M.Sc. Geology-Geochemistry the University of New Brunswick 1972.

I am a member of the Society of Exploration Geochemists, Canadian Institute of Mining and Metallurgy and Geological Association of Canada.

From 1967 to 1979, I have been employed in my field by Cominco + Exminesa in Eastern Canada, Spain and Mexico, Soquem in Quebec, and Union Minière S.A. in Mexico and Central and South America.

From 1979 to 1983, I have been the Regional Manager for Union Minière Explorations and Mining Corporation Limited for the Western District.

From 1983 to the present, I have acted as Exploration Manager for UMEX Inc.'s Canadian operations.

F. Felder

January 19, 1984.

