

Copy To Roland Moede

2.7331

Property Visit to the
Roland Moede Showing, Hackett Lake Area
July, 1984

by

Ralph Huggins, Resource Geologist

The Author accompanied Roland Moede (present holder) to his property which is located southeast of Hackett Lake.

Access:

Access was by fixed-wing plane from Sioux Lookout. The plane landed on Unnamed Lake which is one-half mile south of the showing.

Longitude: 90°28'

Latitude: 50°22'

NTS 52 J/8

RECEIVED

NOV 16 1984

History:

Noranda Mines did Magnetic and VLF surveys over ~~the~~ ^{MINING LANDS SECTION} property in the early 1970's (Resident Geologist's files 52 J/08 NW 0018-A1) (see Figure enclosed). They detected two weak conductors, one of which coincides with the present trench. These conductors are caused by mineralization in the form of sphalerite and calcopyrite. The EM was carried out using the Junior EM unit (JEM) which is manufactured by Crone Geophysics Limited. The frequency used was 1800 Hz and 480 Hz.



52J08NW9216 2.7331 JUTTEN

010

Geology:

The area of the major trenches (T-1 to T-4) is underlain by metavolcanics, mainly mafic pillow lavas and massive flows, which strike 060°. The mineralization occurs along shears and appears to be strongly controlled by them. Alteration into the host rock appears minor with a band of 10 cm. maximum. The veins appear to be dipping vertically and vary in width from 1 cm. to a maximum width of 50 cm. The other trenches (T-5 and T-6) occur within the Jutten Batholith in a biotite trondhjemite. It is also in a shear zone which runs north/south. Minor mineralization occurs as pyrite in narrow quartz veins (2 to 10 cm.). Samples were taken from all trenches (see Appendix for assay results).

Conclusion:

The most promising areas appear to be in the T-1 to T-4 trench areas. These trenches were done along strike, therefore, the width was not fully explored. The gold appears to be more centered in the heavily mineralized sections of sphalerite and calcopyrite. Extension of the trenches is recommended in a northeast direction. Further work on the area is warranted and we can recommend that geological and geophysical surveys, stripping and trenching be done, as well as a channel sample across the trenches. Diamond drilling is not recommended at

July, 1984
Prop. Visit to R. Moede property
page 3

this time, as it is expensive and should be done by a
major company.



Ralph Huggins

Resource Geologist

Savant Lake Ontario
October 2, 1984

TO WHOM IT MAY CONCERN

This is to certify that I, B.I.F Breaby of 137 Royal
Oreharo Blve., Thornhill Ontario, am a member of the
Professional Engineers of the Province of Ontario
in good standing and that I have logged the core presented
to me and submit:

1. Logs in duplicate of holes nos. 1&2 as being drilled
on the Roly Moede Property, Hawkett Lake area--more
particularly on claim No. 640979.
2. A plan in detail showing the location of holes
1&2 on claim #640779 in duplicate.
3. A plan of the "Roly Moede Group" of claims in duplicate.

The core is stored in a shed at the rear of the Savant
Lake Hotel, Savant Lake Ontario.

All of which is respectfully submitted.

B.I.F. Breaby
P. Eng

TO FOLLOW
FOR QUALITY ORIGINAL
DUPLICATE COPY

DUPLICATE COPY
FOR QUALITY ORIGINAL
TO FOLLOW

Savant Lake Ont
October 2 1984

To whom it may concern:

This is to certify that I, P.D. Breakey of 137 Royal Orchard Blvd, Thornhill Ont am a member of the Professional Engineers of the Province of Ontario in good standing. - and that I have logged the Coa presented to me and submit:

- 1 - Logs in duplicate of Holes NOS 1 + 2 as being drilled on the Roly Made Property, Hackett Lake Area - more particularly on claim NO. 640 779.
2. A plan in detail showing the location of Holes 1 + 2 on claim # 640 779 in duplicate.
3. A Plan of the "Roly Made" Group of claims in duplicate

The Coa is stored in a shed at the rear of the Savant Lake Hotel Savant Lake Ont

all of which is respectfully submitted.

P.D. Breakey P. Eng.

✓ SEAL

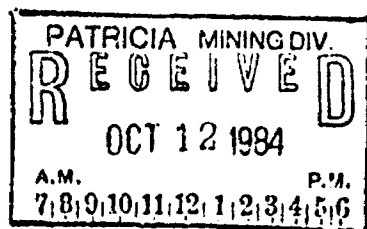

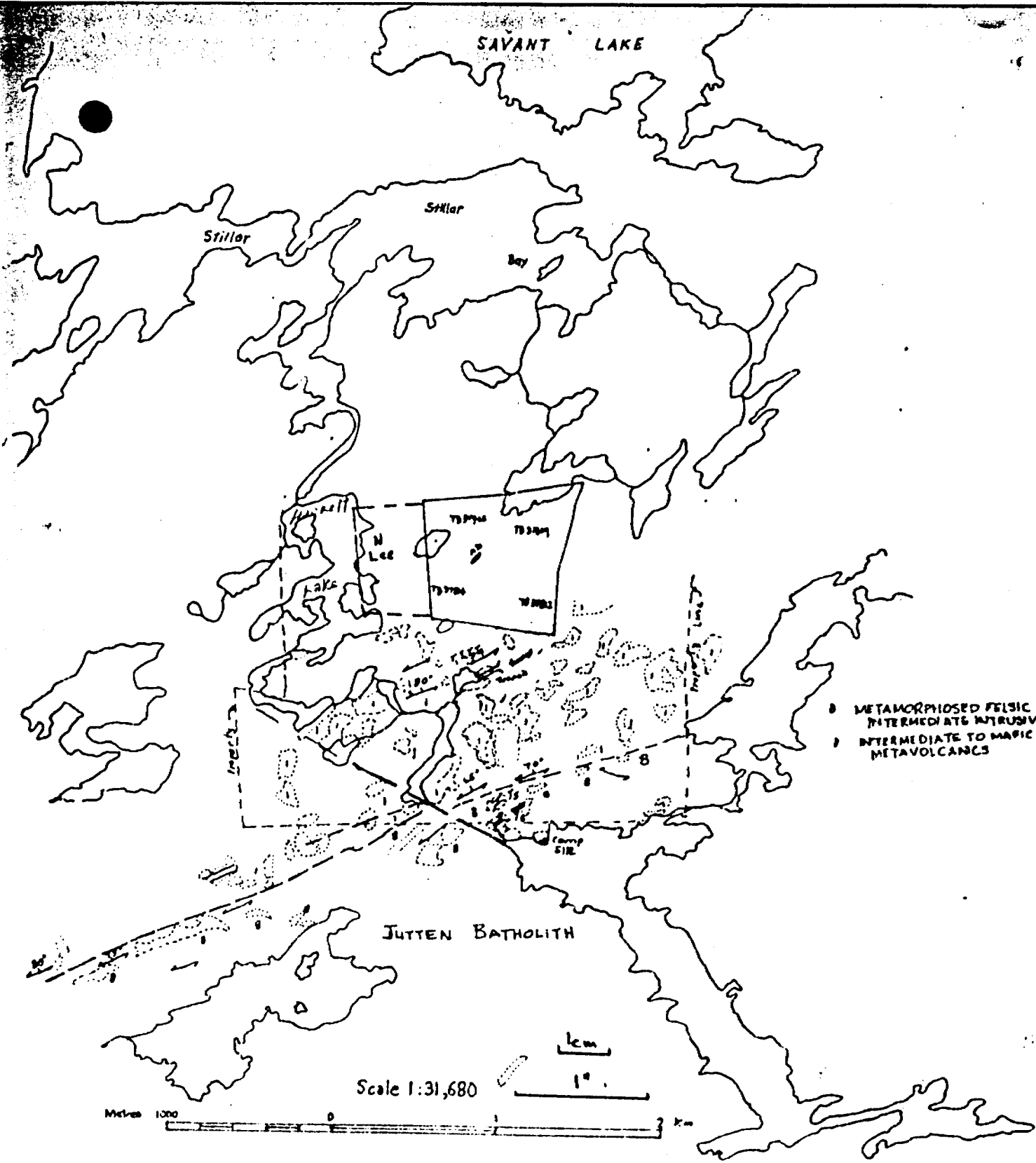

PLAN SHOWING LOCATION
OF DRILLING

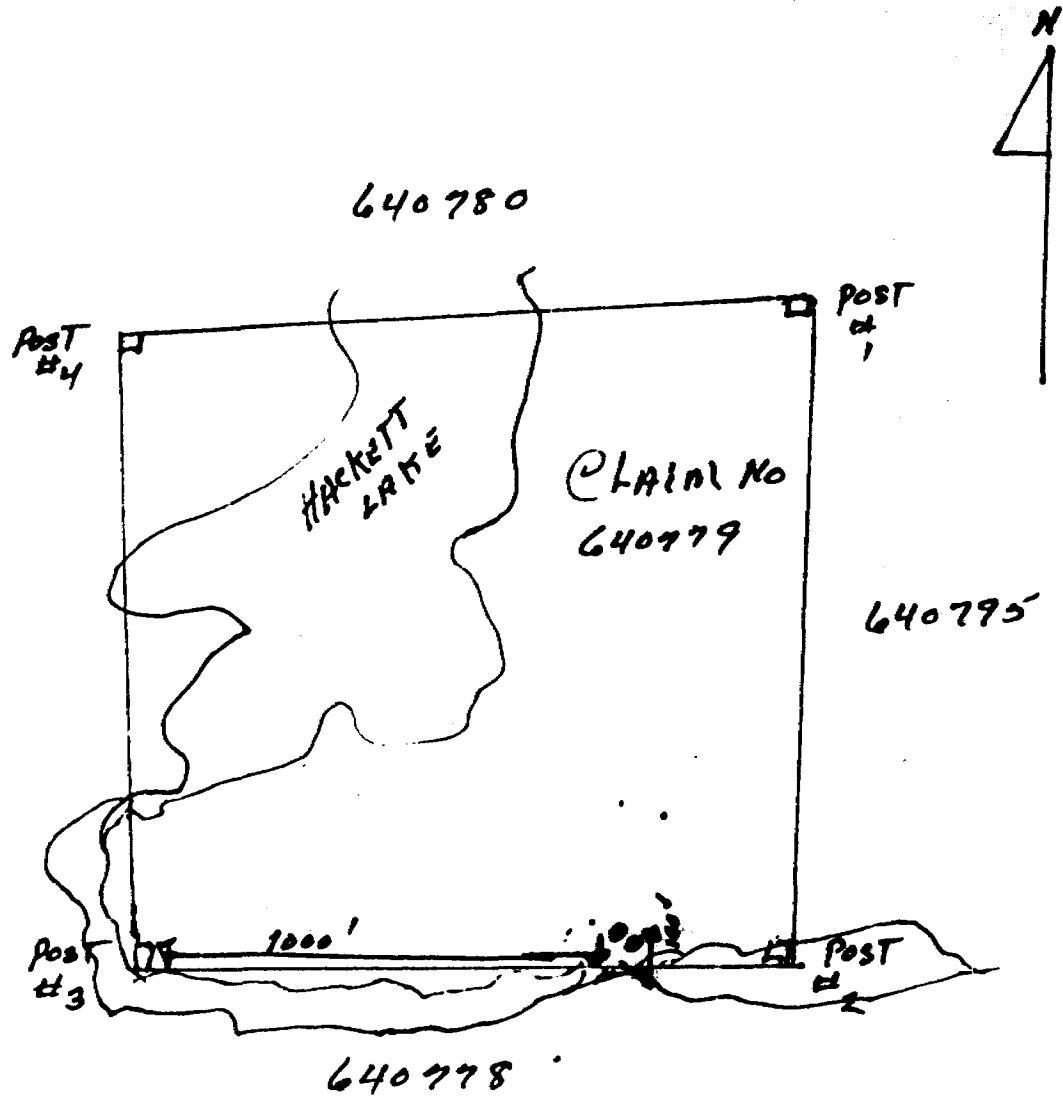

ROLAND MOEDE SHOWING.

PATRICIA MINING DIV.
RECEIVED
OCT 12 1984
A.M. P.M.
7 8 9 10 11 12 1 2 3 4 5 6



OTTEN Twp.

STILLER BAY

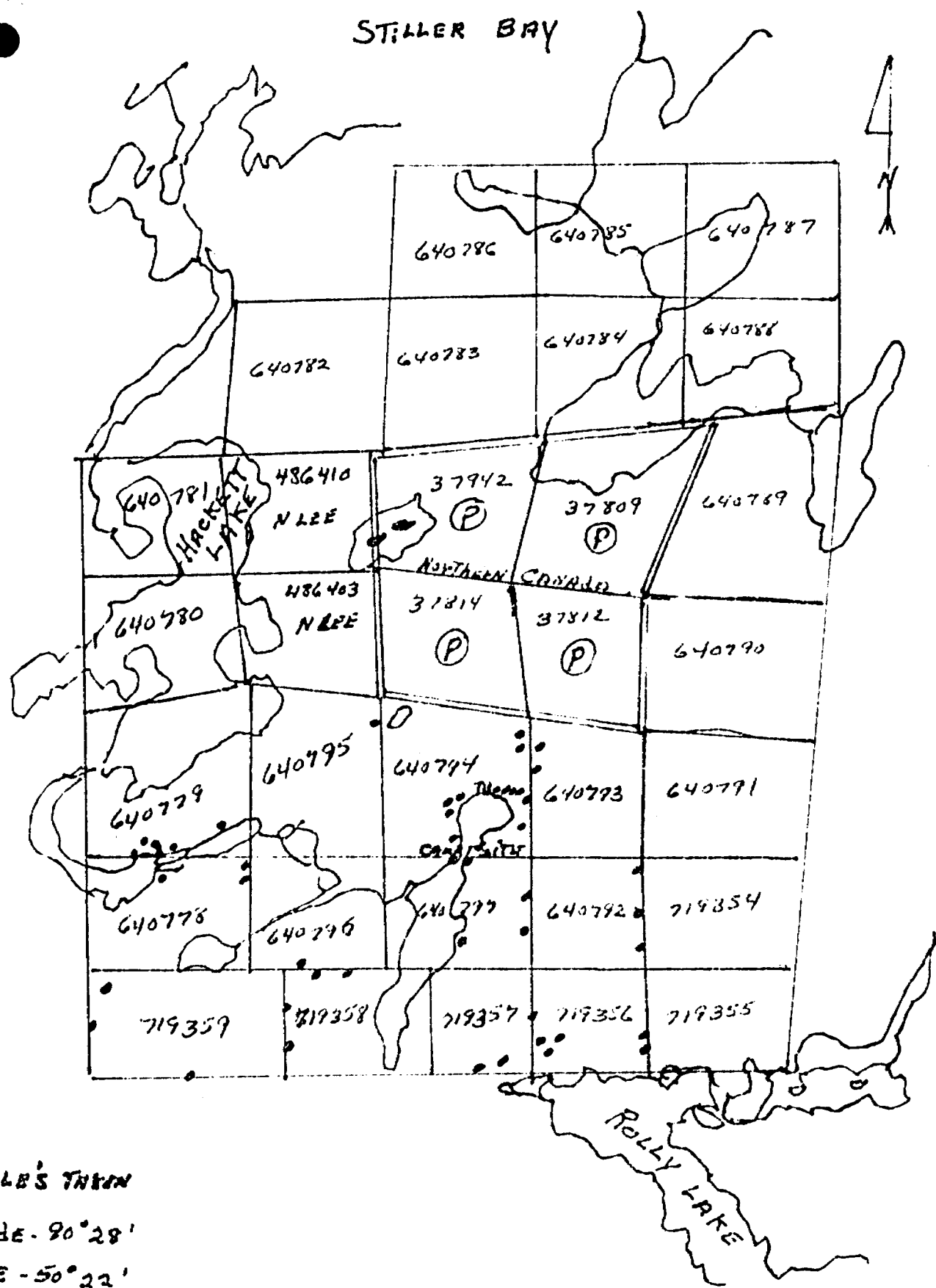

• SAMPLES TAKEN

LONGITUDE - 90° 28'

LATITUDE - 50° 22'

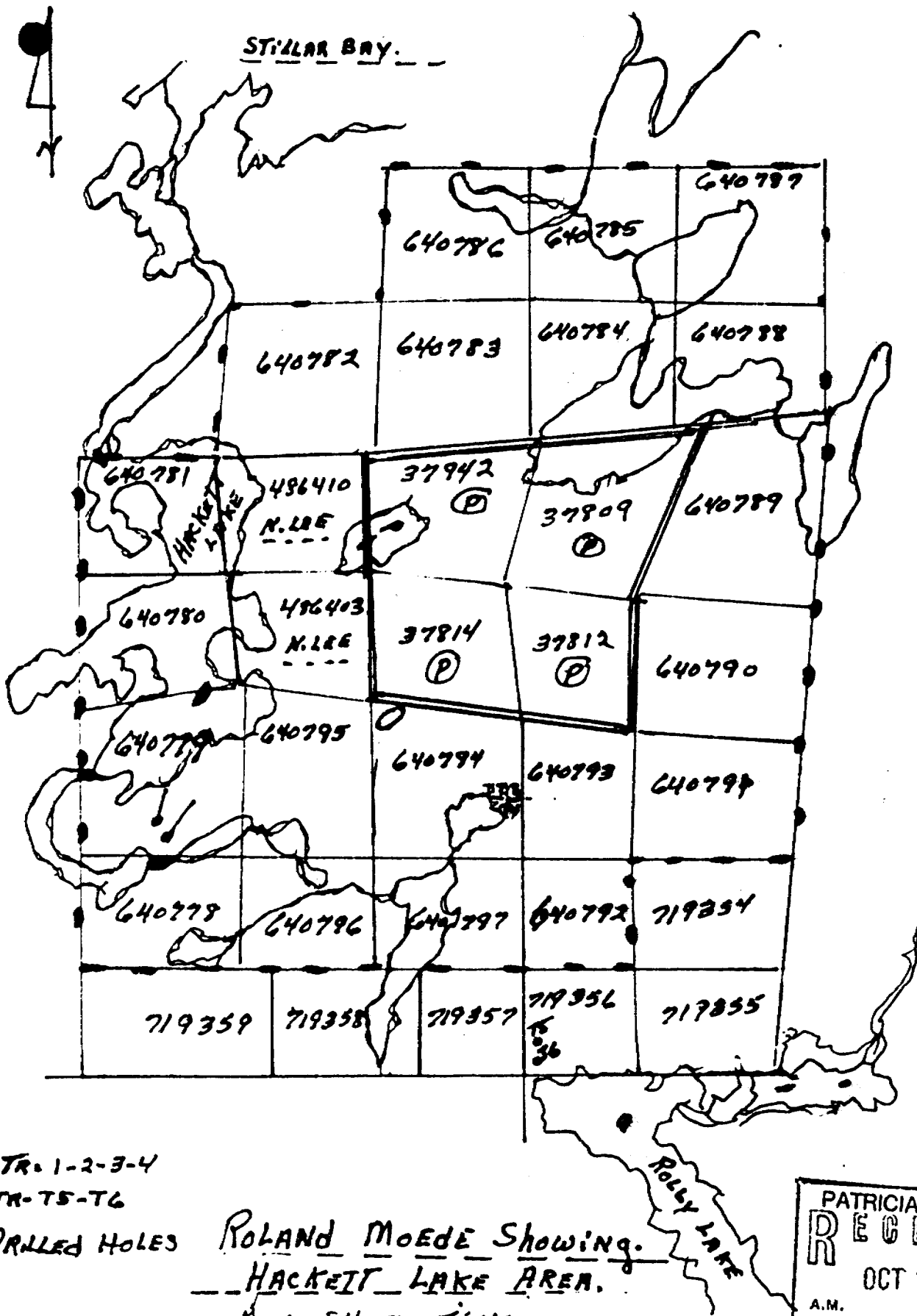

STILLAR BAY.

--- TR. 1-2-3-4

● TR. 5-6

↓ DRILLED HOLES ROLAND MOEDE Showing.
HACKETT LAKE AREA.
GOLD - SILVER - ZINC

PATRICIA MINING DIV.
RECEIVED
 OCT 12 1984
 A.M. P.M.
 7 8 9 10 11 12 1 2 3 4 5 6

PLAN.
SHOWING LOCATION
of
DIAMOND DRILL HOLE

PATRICIA MINNISON
REGISTERED
OCT 12 1964
A.M.
7:8 9:10:11:12:1:2:3:4:5:6

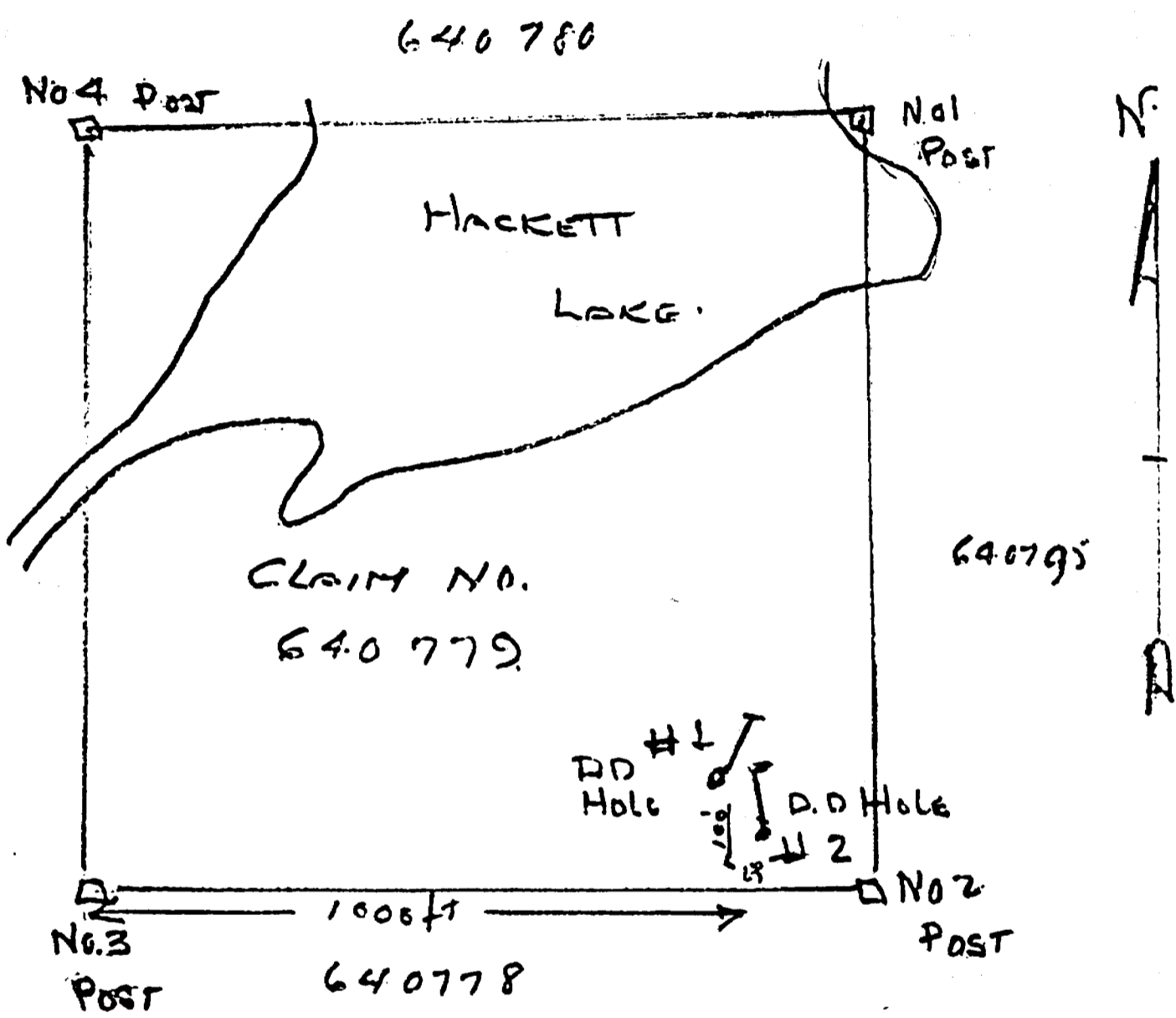

ROLAND MOEDE PROPERTY

B. J. Bentley

PLAN - SHOWING LOCATION
of
DIAMOND DRILL HOLES

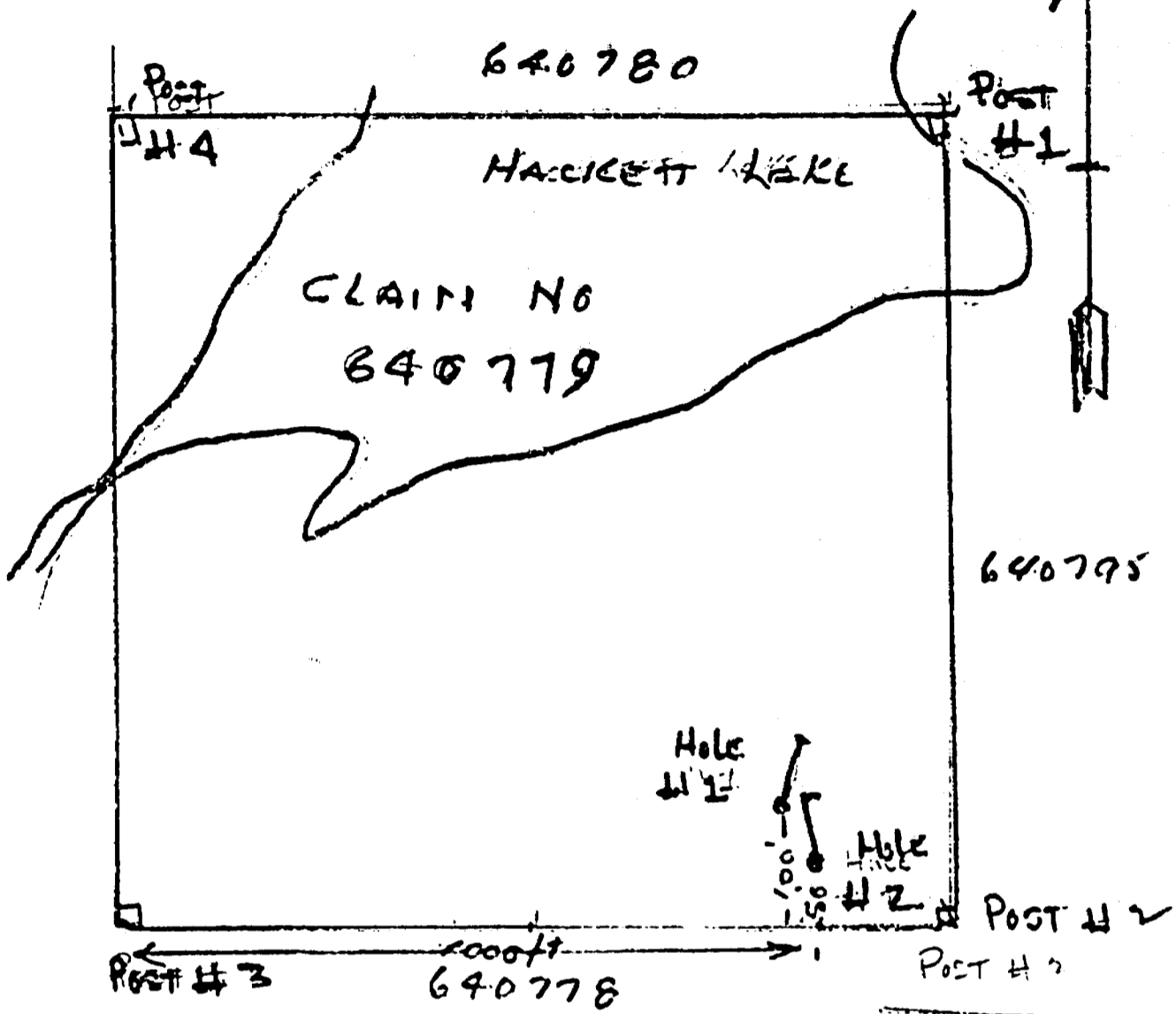

SCALE 1" = 225 feet

ROLAND HOEDE PROPERTY

Sawant Lake Ont.
Oct. 2. 1984

PATRICIA MANNING DIV.
RECEIVED
OCT 12 1984
A.M. 7 8 9 10 11 12 P.M. 1 2 3 4 5 6

BST Mackay.

Moede
PROSPECT

PA
230312

F
2303

PA
230110

PA
230311

F
230

16W

12

20W

21W

23W

VLF

Taken from
file 525/06NW 0018
Resident Geologist Acc. f.
S. G. ...



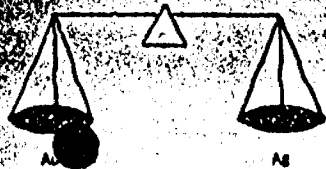

CUSTOM FIRE ASSAYING LTD.

Phone: Bus. 662-817.
Res. 662-336.

PAUL OKANSKI, Assayer
Box 253, Cochenour, Ontario POV 1LO

R. Moede

ASSAY CERTIFICATE

Date: May 7-84

Sample No.	Description	oz/ton Au	oz/ton Ag
C.359			
#A		Trace	Nil
B		"	1.08

Assayer: *Paul Okanski*

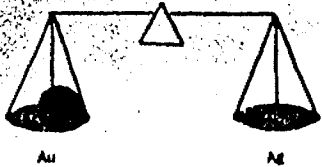

CUSTOM FIRE ASSAYING LTD.

Phone: Bus. 662-817
Res. 662-336

PAUL OKANSKI, Assayer
Box 253, Cochenour, Ontario POV 1L0

R. Lode

ASSAY CERTIFICATE

Date: May 16-74

Sample No.	Description	oz/ton Au	oz/ton Ag
#1	C-792	Trace	Nil
2		"	"
3		"	"

Assayer: *Paul Okanski*

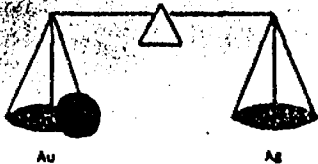

CUSTOM FIRE ASSAYING LTD.

Phone: Bus. 662-817
Res. 662-336

PAUL OKANSKI, Assayer
Box 253, Cochenour, Ontario POV 1LO

ASSAY CERTIFICATE

Date: May 18-84

Sample No.	Description	oz/ton Au	oz/ton Ag
#4	C.795	Trace	Nil

Assayer: *Paul Okanski*

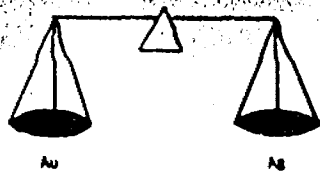

CUSTOM FIRE ASSAYING LTD.

Phone: Bus. 662-817
Res. 662-336

PAUL OKANSKI, Assayer
Box 253, Cochenour, Ontario POV 1L0

R. Moede

ASSAY CERTIFICATE

Date: June 28-84

Sample No.	C.	Description	oz/ton Au	oz/ton Ag
TR-2-1	794		.08	71.08
3-1			.09	2.27
2			.01	1.64
3-3			Trace	Nil
4			☿	"
357-1			.01	"
2			.01	"

Assayer: *Paul Okanski*

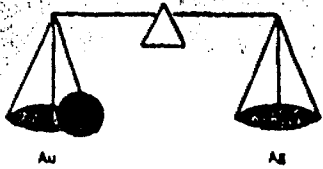

CUSTOM FIRE ASSAYING LTD.

Phone: Bus. 662-8171
Res. 662-3361

PAUL OKANSKI, Assayer
Box 253, Cochenour, Ontario POV 1LO

R. Mode

ASSAY CERTIFICATE

Date: Aug. 1-84

Sample No.	Description	oz/ton Au	oz/ton Ag
352		Trace	Nil
200-794	North of campsite South of campsite	"	"
3-V on 357		"	"
300 Ft. WSL		"	"
ESL		"	"
300-Tr-4	West of trench. 794	"	"
3S-100 WS		"	"
Campsite		"	"

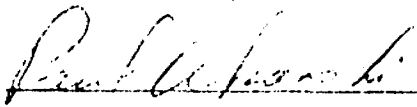
Assayer 

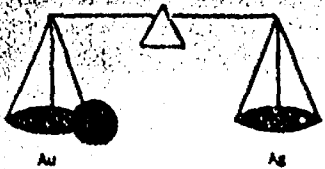

CUSTOM FIRE ASSAYING LTD.

Phone: Bus. 662-8171

Res. 662-3361

PAUL OKANSKI, Assayer
Box 253, Cochenour, Ontario POV 1L0

R. Moede

ASSAY CERTIFICATE

Date: Aug. 20-84

Sample No.	Description	oz/ton Au	oz/ton Ag
R-1-793		Trace	
2-793		"	

Assayer Paul Okanski

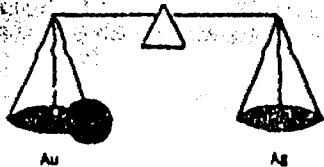

CUSTOM FIRE ASSAYING

Phone: Bus. 662-8171
Res. 662-3361

PAUL OKANSKI, Assayer
Box 253, Cochenour, Ontario POV 1L0

Roland Moede

ASSAY CERTIFICATE

Date: Sept. 23-83

Sample No.	Description	oz/ton Au	oz/ton Ag
793-3		Trace	/
4		"	
794-2		"	
4		"	
5		"	
7		X .03	
8		.04	

Assayer Paul Okanski

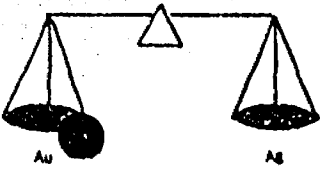

CUSTOM FIRE ASSAYING

Phone: Bus. 662-8171
Res. 662-3361

PAUL OKANSKI, Assayer
Box 253, Cochenour, Ontario POV 1LO

H. Moede

ASSAY CERTIFICATE

Date: Oct. 17-83

Sample No.	Description	oz/ton Au	oz/ton Ag
355-1		Trace	
356-1		.06	
2		Trace	
359		"	
778-1		"	
2		"	
779		"	

Assayer: *Paul Okanski*



BELL-WHITE ANALYTICAL LABORATORIES LTD.

P.O. BOX 187,

HAILEYBURY, ONTARIO

TEL: 672-3107

Certificate of Analysis

NO. 39497

DATE: September 6, 1984

SAMPLE(S) OF: Rock(3)

RECEIVED: September, 1984

SAMPLE(S) FROM: Mr. Roland Moede, Savant Lake, Ontario.

	<u>Sample No.</u>	<u>Oz. Gold</u>	<u>Oz. Silver</u>	<u>% Copper</u>
779	TR-1-83	0.002*	0.42**	0.32
	TR-1-663	Trace	0.02	
	TR-2-663	Trace	Trace	

* Estimated.

** Checked.

ACCORDANCE WITH LONG-ESTABLISHED NORTH AMERICAN CUSTOM UNLESS IT IS SPECIFICALLY STATED OTHERWISE GOLD AND SILVER VALUES REPORTED ON THESE SHEETS HAVE NOT BEEN ADJUSTED TO COMPENSATE FOR LOSSES AND GAINS INHERENT IN THE FIRE ASSAY PROCESS

BELL-WHITE ANALYTICAL LABORATORIES LTD

PER: 



BELL - WHITE ANALYTICAL LABORATORIES LTD.

P.O. BOX 187,

HAILEYBURY, ONTARIO

TEL: 672-3107

Certificate of Analysis

NO. 40917

DATE: September 27, 1984

SAMPLE(S) OF: Rock (5)

RECEIVED: September, 1984

SAMPLE(S) FROM: Mr. Roland Moede
General Delivery
Savant Lake, Ontario POV 250

<u>Sample No.</u>	<u>Gold/oz.</u>	<u>Silver/oz.</u>	<u>% Zinc</u>
538-3-5	Trace	0.03	
796-3-8	Trace	Trace	
358-3-10	Trace	Trace	
359-4	Trace	Trace	
357-T6	0.032		0.009

IN ACCORDANCE WITH LONG ESTABLISHED NORTH AMERICAN CUSTOM, UNLESS IT IS SPECIFICALLY STATED OTHERWISE GOLD AND SILVER VALUES REPORTED ON THESE SHEETS HAVE NOT BEEN ADJUSTED TO COMPENSATE FOR LOSSES AND GAINS INHERENT IN THE FIRE ASSAY PROCESS.

BELL-WHITE ANALYTICAL LABORATORIES LTD.

PER



BELL-WHITE ANALYTICAL LABORATORIES LTD.

P.O. BOX 187.

HAILEYBURY, ONTARIO

TEL: 672-3107

Certificate of Analysis

NO. B1140-84

DATE: October 10, 1984

SAMPLE(S) OF: Core (7)

RECEIVED: October, 1984

SAMPLE(S) FROM: Mr. Roland Moede
Savant Lake, Ontario

C-710	<u>Sample No.</u>	<u>Gold ppb</u>
	610	7
	611	2
	612	36
	613	4
	614	18
	615	15
	616	3

IN ACCORDANCE WITH LONG ESTABLISHED NORTH AMERICAN CUSTOM UNLESS IT IS SPECIFICALLY STATED OTHERWISE GOLD AND SILVER VALUES REPORTED ON THESE SHEETS HAVE NOT BEEN ADJUSTED TO COMPENSATE FOR LOSSES AND GAINS INHERENT IN THE FIRE ASSAY PROCESS

BELL-WHITE ANALYTICAL LABORATORIES LTD.

PER: 

Issued to:

R. Moede, General Delivery, Savant Lake, Ontario
POV 2S0

Fire Assay Determination

Sample Number	Gold Oz. Per Ton*	Silver Oz. Per Ton*
<u>794</u> TR-1	0.05	51.77
TR-4	0.01	4.27
TR-2-1	0.01	8.43
TR-5-1	0.14	

\$105.00

Fees Received

7 Coups. Card # 3458

[Signature]
R. Moede Chief Analyst

*Note: 1 Oz. Per Ton is equivalent to
34.3 Parts Per Million.

Except by special permission reproduction of these results must include any qualifying remarks made by this Ministry with reference to any sample.



Ministry of Ontario
Natural Geological
Resources Survey

77 Grenville Street
11th Floor
Toronto, Ontario
M5S 1B3
Telephone 965-1337

Geoscience
Laboratories
Report

Report No
C 23069

Date
Aug. 20, 1984

Issued to:

Roland Moede, General Delivery, Savant Lake, Ontario
POV 2S0

C-794

Sample #	Copper (Cu) ppm	Zinc (Zn) ppm	Nickel (Ni) ppm	Lead (Pb) ppm
TR-1	5400 <i>g</i>	6.958 <i>g</i>	-	320 <i>g</i>
TR-4	490 <i>g</i>	7.158 <i>g</i>	-	29 <i>g</i>
TR-2-1	-	1350 <i>g</i>	83 <i>g</i>	-
TR-5-1	38 <i>g</i>	240 <i>g</i>	52 <i>g</i>	-

g

Fees Received

11 Coups, Card #3458

Chris Fiedle
Chris Fiedle, Chief Analyst

Except by permission reproduction of these results must include any qualifying remarks made by this ministry with reference to any sample.

2091 (12 n)

Ordered for:
 R. Huggins, Res. Geol., Ministry of Natural Resources
 Box 309, Sioux Lookout, Ontario

Sample #	Gold (Au) ppb	Silver (Ag) ppm	Arsenic (As) ppm	Copper (Cu) ppm	Molybdenum (Mo) ppm
----------	------------------	--------------------	---------------------	--------------------	------------------------

Sample #	Gold (Au) ppb	Silver (Ag) ppm	Arsenic (As) ppm	Lead (Pb) ppm	Zinc (Zn) ppm	Molybdenum (Mo) ppm
RBH84-012	680	<2	15	<10	85	<3 T5
-013	24	<2	4.5	<10	82	<3 T6
-014	545	1260	1.5	140	7.65%	<3 T1
-015	430	44	81	<10	9.05%	<3 T3
-016	880	1340	25	540	5.92%	<3 T2
-017	500	67	17	36	8.00%	<3 T4
-018	1210	1170	1.5	140	11.7%	<3 T4

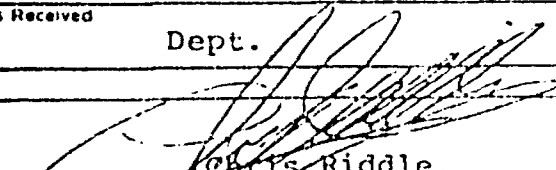
Specimens Received
 Dept. _____

 Chris Riddle, Chief Analyst

KENORA DIAMOND DRILLING LTD.

P.O. BOX 661 — KENORA, ONTARIO P9N 3X6 — PHONE 548-5569

792

KENORA, ONTARIO October 4 19 84

HOLAND MOEDE

SAVANT LAKE

ONTARIO



52J08NW9216 2.7331 JUTTEN

900

DIAMOND DRILLING AT SAVANT LAKE Sept/84					Debit		Credit		Balanc	
HOLE #	FROM	TO	FOOTAGE	UNIT PRICE						
1	0	102	102	\$20.00	\$	2040	00			
2	0	103	103	\$20.00		2060	00			4100 00

Paid in full
Paid Michael
K.D.D.

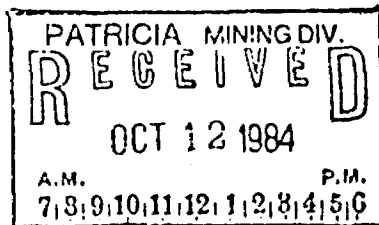



BELL - WHITE ANALYTICAL LABORATORIES LTD.

P.O. BOX 187 HAILEYBURY, ONTARIO TEL: (705) 672-3107
POJ 1KO

Mr. Roland Moede,
Savant Lake Hotel,
Savant Lake, Ontario.
POV 2S0

INVOICE No 17196

ORDER NO.

DATE September 6, 1984

CERTIFICATE NO.	DATE	DESCRIPTION	AMOUNT
39497	Sept. 6/84	3 Au @ \$8.50 each, 3 Ag @ 8.50 each, 1 Cu @ \$8.50 3 sample preparations @ \$2.50 each	\$ 25.50 25.50 8.50 7.50 <hr/> \$ 67.00

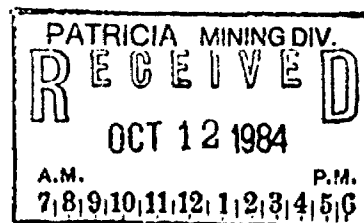



BELL - WHITE ANALYTICAL LABORATORIES LTD.

P.O. BOX 187 HAILEYBURY, ONTARIO TEL: (705) 672-3107
POJ 1KO

Mr. Roland Noede
Savant Hotel
General Delivery
SAVANT LAKE, Ontario
POV 2S0

INVOICE No 17362

ORDER NO.

DATE September 27, 1984

CERTIFICATE NO.	DATE	DESCRIPTION	AMOUNT
40917	Sept. 27/84	5 Au @ \$8.50 4 Ag @ \$8.50 1 Zn @ \$8.50	\$ 42.50 34.00 8.50 <hr/> \$ 85.00

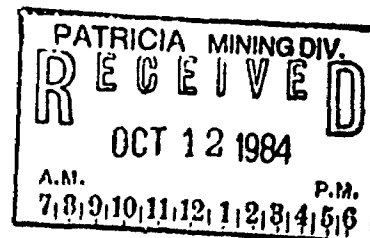



BELL - WHITE ANALYTICAL LABORATORIES LTD.

P.O. BOX 187 HAILEYBURY, ONTARIO TEL: (705) 672-3107
POJ 1K0

Mr. Roland Moede
Savant Lake Hotel
SAVANT LAKE, Ontario
POV 280

INVOICE No 17441

ORDER NO.

DATE October 10, 1984

CERTIFICATE NO.	DATE	DESCRIPTION	AMOUNT
B1140-84	Oct. 10/84	7 Au @ \$8.50 7 sample preparations @ \$2.50	\$ 59.50 17.50 <u> </u> <u>\$ 77.00</u>

BOX 253
COCHENOUR, ONTARIO POV 1L0

CUSTOM FIRE ASSAYING LTD.
BOX 253
COCHENOUR, ONTARIO POV 1L0

Date JUNE 28 1984
M. B. MOEDE

SOLD BY	C.O.D.	CHARGE	ON ACCT.	ACCT. NO.
7	SAMP	77.00		
8				
9				
10				
11				
12				
13				
14				
15				

2

Paid July 2/84

REDIFORM - 88523E

Date Aug 1 1984
M. B. MOEDE

SOLD BY	C.O.D.	CHARGE	ON ACCT.	ACCT. NO.
8	SAMP	58.00		
2				
3				
4				
5				
6				
7				
8				
9				
10				
11				
12				
13				
14				
15				

50

Paid Aug 21/84

REDIFORM - 88523E

PATRICK MANNING
RECEIVED
OCT 12 1984
In Account With
Doll A

Mr. R. Moede

Savant Lake, Ont.

STATEMENT / ETAT DE COMPTE Oct 17 1983

Box 253
Cochenour, Ont. POV 1L0

DATE	DESCRIPTION	INVOICE * PARTICULARS ETC. NUMERO DE FACTURE, PARTICULARS ETC.	DEBIT DEBIT	CREDI CREDI
	7 Samples Au. at \$8.00 ea.		56.00	

Paid 10/20

TERMS / CONDITIONS

BALANCE 56.00

BALANCE PAST DUE

BALANCE PASSE DUE

PHONE
807-274-5335

Rusty Myers Flying Service Ltd.

P.O. BOX 668 FORT FRANCES, ONTARIO

Fly to Your Favorite Hunting and Fishing Spots

FORT FRANCES, ONT.

NAME

ADDRESS

CITY

A/C MAKE

REGISTRATION

CREDIT CARD NO.

	GRADE	QUAN.	PRICE	AMOUNT
GASOLINE				
TAX				
OIL				
MAINTENANCE				
To Rolly Lake				73.50
out				73.50
TOTAL				147.00

2735

SIGNATURE

NUMBER PLATE

RECEIVED ABOVE IN GOOD ORDER

STATEMENT / ÉTAT DE COMPTE

Aug. 29, 83

M ~~XXX~~ Roland Moede,

Savant Lake, Ont.

In Account With
Dolt A

Custom Fire Assaying,

Box 253

Cochénour, Ont. POV-110

DATE	DESCRIPTION	INVOICE #, PARTICULARS ETC. NUMERO DE FACTURE, PARTICULARITÉS ETC.	DEBIT DÉBIT	CREDIT CRÉDIT
	7 Samples for Au.	@ \$8.00	56.00	
<p><i>[Handwritten Signature]</i> Aug 31 / 83</p>				

TERMS / CONDITIONS

BALANCE

56.00

BALANCE PAST DUE
BALANCE PASSÉ DÙE

PATRICIA MINING DIV.

2027 10

OCT 12 1984

3 9 10 11 12 1 2 3 4 5 6

CUSTOM FIRE ASSAYING LTD.
 BOX 253
 COCHENOUR, ONTARIO POV 110

CUSTOM FIRE ASSAYING LTD.
 BOX 253
 COCHENOUR, ONTARIO POV 110

Date MAY 7 1984
 M. R. MOEDE
SAVANT HOTEL

NO. BY	QTY.	CHARGE	ON ACCT.	ACCT. FWD.
32	SAMP. AA @ 11.00	22.00		
4	A 9 B			
14				
15				

3

Date MAY 18 1984
 M. R. MOEDE

NO. BY	QTY.	CHARGE	ON ACCT.	ACCT. FWD.
14	SAMP. AA @ 11.00	44.00		
2				
3				
4	#1 to 4			
5				
6				
7				
8				
9				
10				
11				
12				
13				
14				
15				

23

REDIFORM - 58523E

REDIFORM - 58523E

PATRICIA KIRKING DIV.
 RECEIVED
 OCT 12 1984
 P.M.
 710-9101-1191-4100

STATEMENT / ETAT DE COMPTE Sept 23 1983

M. R. Moede

Savant Lake, Ont.

In Account With Custom Fire Assaying.

Box 253

Cochenour, Ont POV - 110

DATE	DESCRIPTION INVOICE # PARTICULARS ETC. NUMERO DE FACTURE PARTICULAIRES ETC	DEBIT DEBIT	CREDIT CREDIT
7	Samples for Ass. @ \$8.00 ea.	56.00	

TERMS / CONDITIONS

BALANCE 56.00

BALANCE PAST DUE
 BALANCE PASSE DUE

CUSTOM FIRE ASSAYING LTD.
 BOX 253
 COCHENOUR, ONTARIO POY 1LO

Date JULY 10 1984
 M. R. MOEDE

SOLD BY	QTY	PRICE	ON HAND	ACC. NO.
1	1	66.00		
2				
3				
4				
5				
6				
7				
8				
9				
10				
11				
12				
13				
14				
15				

44

REDIFORM - 58813E

PATRICIA MINING DIV.
RECEIVED
 OCT 12 1984
 A.M. P.M.
 7 8 9 10 11 12 1 2 3 4 5 6

TRANSPORTATION RECEIPT

RUSTY MYERS FLYING SERVICE LTD.

Box 608
 Fort Frances, Ont
 P8A 3M9

Date Oct 3

NAME <u>Poland</u>						CASH <input checked="" type="checkbox"/>
ADDRESS <u>Saw + Lake</u> <small>st. no. name of street</small>						CHARGE <input type="checkbox"/>
City or Town			Prov. or State			
ROUTING AND POINTS OF CALL	MILES or HOURS	AIRCRAFT		Rate	Frt.	INFORMATION
		on	off			
1	XXXX		XXX			
2 To Dely Lake	50	C-141		1.45		72.50
3 From Dely Lake	50	C-141		1.45		72.50
4						
5						
6						
7						
8						
9						
EXTRA LANDINGS						
WAITING TIME						
EXTERNAL LOAD						
BOATS RENTED						
MOTORS RENTED						
CAMP RENTAL						
GAS SALES						
TOTAL					145.00	

paid by cheque
Shaw

I hereby acknowledge receipt of the transportation described herein.

PER al DISPATCHER

ISSUED AT Saw

INV. # 3459

INVOICE - FACTURE

500

GILBY C-I-L Inc.

Remit to
Payer à P.O. BOX 1800, STN A
ACRTH YORK, ONT.
M2N 2Z9

Shipped to
Destinataire CASH SALE
EGLAND MOEDE
SAVANT LAKE
2 ONTARIO

Invoice to
Facturer à CASH SALES
THUNDER BAY ONT.
P7A 4L6

Invoice Date Date facture			Page
D/J	M	Y/A	
18	6	24	1

Invoice no/NO facture		B.O./R.C.
o.s./p.s.c.	no. dtl. no.	
069	49440	

If query please quote this number.
Dans toute communication, indiquer ce numéro.

VIA - TRANSPORTEUR CUSTOMER CALLING	F.O.B. - P.A.B. SHIPPING POINT - COLLECT	CAA NO. - NP WAÇON 06559440
TERMS - CONDITIONS CCO	CLIENT NO. - NO DU CLIENT 133033VCO	PROV TAX NO. - NO TAXE PROV.
CURT. REF. - REF. CLIENT	DIV	TG/SA
53	006	60
64	006	459
SHIPPED FROM - POINT DE DEPART		B.P./0008
THUNDER BAY WHSE		069 069
SHIPPED DATE EXP.		DJ M Y/A
		18 6 84

DESCRIPTION	NO COLIS	QUANTITE	PRIX	PAR	T.V.F.	PORTANT
CCOE	NO ITEMS	QUANTITY	PRICE	PER	EST	AMOUNT

AMT REC'D 108.58						
FORCITE 40X 25X200						
18589	1 CS	25 KG	372.40	K	9%	P 93.10

5% FEDERAL SALES TAX ON	93.10	8.38
7% CNT. TAX ON	101.48	7.10

P - AMOUNT SUBJECT TO PROVINCIAL TAX

EQUIVALENT IMPERIAL WEIGHT IN POUNDS 55

TOTAL VALUE 108.58

PATRICIA MINING DIV.
RECEIVED
OCT 12 1984
A.M. P.M.
7 8 9 10 11 12 1 2 3 4 5 6

• - REGISTERED TRADEMARKS

INVOICE NUMBER 069 49440

PHONE
807-274-5335

Telephone 274-5335

STATEMENT

P.O. Box 668 Fort Frances, Ontario June 27, 1984

Rusty Myers Flying Service Ltd.

P.O. BOX 868 FORT FRANCES, ONTARIO

Fly to Your Favorite Hunting and Fishing Spots

FORT FRANCES, ONT. *June 27 1984*

NAME *Moede*

ADDRESS

CITY

A/C MAKE REGISTRATION

CREDIT CARD NO.

	GRADE	QUAN.	PRICE	AMOUNT
GASOLINE				
TAX				
OIL				
MAINTENANCE		HRS.		
<i>To Lady Lake</i>				<i>73.50</i>
<i>Chg</i>				
TAX				
TOTAL				<i>73.50</i>

RECEIVED ABOVE IN GOOD ORDER

SIGNATURE *[Signature]*

MOODE PLATPAT 2

2971

*PAID & RECEIVED
27 JUN 1984*

Mr. R. Moede
SavantLake, Ontario

Rusty Myers Flying Service Ltd.

Why Waste Time?

FLY to your Favourite Hunting and Fishing Spots

"We have operated in this district since 1941"

Invoice #2971

\$73.50

PATRICIA MINING DIV.
RECEIVED
 OCT 12 1984
 A.M. P.M.
 7 8 9 10 11 12 1 2 3 4 5 6

1% per month charged on overdue accounts.

PHONE
907-274-5325

Rusty Myers Flying Service Ltd.

P.O. BOX 668 FORT FRANCES, ONTARIO

Fly to Your Favorite Hunting and Fishing Spots

FORT FRANCES, ONT. *15* 19*84*

NAME *Russell*
ADDRESS _____

CITY _____

A/C MAKE _____ REGISTRATION _____

CREDIT CARD NO. _____

GRADE	QTY	PRICE	AMOUNT

GASOLINE

TAX

OIL

MAINTENANCE

TO RUSSELL

TO " "

Patricia Mining Div
189.50

RECEIVED ABOVE IN GOOD ORDER

SIGNATURE *Russell*

2028

TRANSPORTATION RECEIPT

RUSTY MYERS FLYING SERVICE LTD.

Box 668
Fort Frances, Ont
P9A 3M9

Date *Oct 7*

NAME *Roland* CASH
ADDRESS *Sawant Lake* CHARGE
st. no. name of street

ROUTING AND POINTS OF CALL	MILES or HOURS	AIRCRAFT		Rate	Frt.	INFORMATION
		on	off			
1	XXXX		XXX			
2 <i>To Poly Lakes</i>	50	<i>P-185</i>		<i>1.41</i>		<i>72.50</i>
3 <i>From Poly</i>	50	<i>P-185</i>		<i>1.41</i>		<i>72.50</i>
4						
5						
6						
7						
8						
9						
10						
EXTRA LANDINGS						
WAITING TIME						
EXTERNAL LOAD						
BOATS RENTED						
MOTORS RENTED						
CAMP RENTAL						
GAS SALES						
TOTAL				<i>145.00</i>		

*paid by
cheque
glenn*

PATRICIA MINING DIV.
RECEIVED
OCT 12 1984
A.M. P.M.
7 8 9 10 11 12 1 2 3 4 5 6

I hereby acknowledge receipt of the transportation described herein.

PER *al* DISPATCHER

ISSUED AT *Sawant*

INV. # **3470**

PHONE
807-274-5335

Rusty Myers Flying Service Ltd.
P.O. BOX 668 FORT FRANCES, ONTARIO
Fly to Your Favorite Hunting and Fishing Spots
FORT FRANCES, DNT., June 28 1984

NAME Rolly
ADDRESS Sawant Hotel

CITY _____
A/C MAKE _____ REGISTRATION _____

CREDIT CARD NO. _____

	GRADE	QUAN.	PRICE	AMOUNT
GASOLINE				
TAX				
OIL				
MAINTENANCE		HRS.		
June 22 IN+OUT Rath Lake C-160				147.00
out Sawant Hotel				115.00
TAX				
TOTAL				262.00

RECEIVED ABOVE IN GOOD ORDER
SIGNATURE Ol

2981

MOORE PLATTAR 2

TRANSPORTATION RECEIPT



Box 668
Fort Frances, Ont
P8A 3M9

Date Aug 22

NAME Roland Muede CASH
ADDRESS Sawant Lake Hotel CHARGE
st. no. name of street

ROUTING AND POINTS OF CALL	MILES or HOURS	AIRCRAFT		Rate	Frt.	INFORMATION
		on	off			
1	XXXX		XXX			
2 To Lake Sawant	50	BJ 18		110		145.00
3 out Lake Sawant	50	BEV		120		110.00
4						
5						
6						
7						
8						
9						

EXTRA LANDINGS _____
WAITING TIME _____
EXTERNAL LOAD _____
BOATS RENTED _____
MOTORS RENTED _____
CAMP RENTAL _____
GAS SALES 120.00
TOTAL 295.00

PATRICIA MINING DIV.
RECEIVED
OCT 12 1984
A.M. P.M.
7 8 9 10 11 12 1 2 3 4 5 6

Roland Muede
I hereby acknowledge receipt of transportation described herein.
PER Bill DISPATCHER

ISSUED AT Sawant
INV. # 2479

SAVANT HOTEL
 GENERAL DELIVERY PH. 1-807-584-2238
 SAVANT LAKE, ONTARIO NV 250

1194
 June 30 1984

PAY TO THE
 ORDER OF

Three Days
 Thirteen Hundred Dollars

\$ 1300.00
 00 DOLLARS
 100

RE: *Wash. Treaching on Chama*



CANADIAN IMPERIAL
 BANK OF COMMERCE
 IGNACE, ONT.

SAVANT HOTEL

Robert Mack

⑆01087⑆010⑆ 8100217⑆

⑆000030000⑆

PATRICIA MINING DIV.
RECEIVED
 OCT 12 1984
 A.M. P.M.
 7 8 9 10 11 12 1 2 3 4 5 6

TRANSPORTATION RECEIPT

RUSTY MYERS FLYING SERVICE LTD.

Box 868
 Fort Frances,
 P9A 3M9

Date *Sept*

NAME _____ CASH
print full name
 ADDRESS _____ CHARGE
st. no. name of street

ROUTING AND POINTS OF CALL	MILES or HOURS	AIRCRAFT		Rate	Frt.	INFORMATION
		on	off			
1	XXXX		XXX			
2 <i>2 in summer, 1984</i>	50	13		14		75.50
3						
4						
5						
6						
7						
8						
9						
EXTRA LANDINGS						
WAITING TIME						
EXTERNAL LOAD						
BOATS RENTED						
MOTORS RENTED <i>5 Motors @ 15.00</i> 75.00						
CAMP RENTAL <i>TAY</i> 5.25						
GAS SALES						
TOTAL				<i>153.75</i>		

I hereby acknowledge receipt of transportation described here

PER *[Signature]*
 DISPATCHER

ISSUED AT *[Signature]*

INV. # *NO 511*

SAVANT HOTEL
GENERAL DELIVERY
SAVANT LAKE, ONTARIO P0V 2S0

PAY TO THE ORDER OF *Donald Savant*

SUM OF *One Hundred Fifty Dollars* DOLLARS

RE *Pay preceding 8/17/84 Wilson Plains*

ROLAND MOEDE

CANADIAN IMPERIAL
BANK OF COMMERCE
IGNACE, ONT.

Roland Moede

PATRICIA MINING DIV.
RECEIVED
OCT 12 1984
A.M. P.M.
7 8 9 10 11 12 1 2 3 4 5 6

⑆01087⑈0101⑆ 81100217⑈

⑆006⑈0000⑆1164⑆⑈

TRANSPORTATION RECEIPT

ROSTY MYERS FLYING SERVICE LTD.

Box 668
Fort Frances, Ont
P9A 3M9

Date *SEPT-84*

NAME <i>Roly</i> <small>print full name</small>						CASH <input type="checkbox"/>
ADDRESS _____ <small>st. no. name of street</small>						CHARGE <input type="checkbox"/>
City or Town			Prov. or State			INFORMATION
ROUTING AND POINTS OF CALL	MILES or HOURS	AIRCRAFT on off		Rate	Frt.	
1	XXXX		XXX			
2 2, GEAR TO HACKETT	50	DAZ		230		
3 2, GEAR TO HACKETT	50	DAZ		230		
4						
5 100 ft.	5	100		147		
6						
7						
8						
9						
EXTRA LANDINGS						I hereby acknowledge receipt of the transportation described herein. PER <i>[Signature]</i> DISPATCHER
WAITING TIME						
EXTERNAL LOAD						
BOATS RENTED						
MOTORS RENTED						
CAMP RENTAL						ISSUED AT <i>[Signature]</i> INV. # <i>30350</i> NO. <i>515</i>
GAS SALES						
TOTAL					<i>30350</i>	

0865

Aug 17 1984

\$ 116.00

46
100

1195

July 1 1984

SAVANT HOTEL
GENERAL DELIVERY P.H. 1-807-584-2236
SAVANT LAKE, ONTARIO POV 250

\$ 1,13.⁰⁰/₁₀₀

PAY TO THE ORDER OF

Wesley Savant

SUM OF *One Thousand One Hundred Thirteen* DOLLARS

RE: *Washed on Mining Claims Trucking*

SAVANT HOTEL



CANADIAN IMPERIAL
BANK OF COMMERCE
IGNACE, ONT.

Roland Macke

⑆000110000⑆

⑆01087⑆0101⑆ 81⑆000217⑆

PATRICIA MINING DIV.
RECEIVED
OCT 12 1984
A.M. P.M.
7 8 9 10 11 12 1 2 3 4 5 6

TRANSPORTATION RECEIPT

RUSTY MYERS FLYING SERVICE LTD.

Box 668
Fort Frances, On
P9A 3M9

Date *7/1*

NAME <i>Savant</i> print full name						CASH <input type="checkbox"/>
ADDRESS _____ st. no. _____ name of street _____						CHARGE <input type="checkbox"/>
City or Town _____			Prov. or State _____			
ROUTING AND POINTS OF CALL	MILES or HOURS	AIRCRAFT		Rate	Frt.	INFORMATION
		on	off			
1	XXXX		XXX			
2 <i>to hotel</i>	50	<i>4</i>		<i>18</i>		7350
3 <i>to</i>	50					7350
4						
6						
6						
7						
8						
9						
EXTRA LANDINGS						
WAITING TIME						
EXTERNAL LOAD						
BOATS RENTED						
MOTORS RENTED						
CAMP RENTAL						
GAS SALES						
TOTAL				<i>147.50</i>		

I hereby acknowledge receipt of the transportation described herein.

PER *[Signature]*
DISPATCHER

ISSUED AT *[Signature]*

INV. # *NO 514*

TRANSPORTATION RECEIPT

RUSTY MYERS FLYING SERVICE LTD.

Box 668
Fort Frances, Ont.
P9A 3M9

Date Sept 27

NAME Rusty CASH
print full name
 ADDRESS 1007 Main St CHARGE
st. no. name of street

ROUTING AND POINTS OF CALL	MILES or HOURS	AIRCRAFT		Rate	Frt.	INFORMATION
		on	off			
1	XXXX		XXX			
2 <u>To Hebert</u>	<u>50</u>	<u>02:1</u>		<u>73.</u>		<u>115.00</u>
3 <u>From Hebert</u>	<u>50</u>	<u>01:1</u>				<u>73.00</u>
4						
5						<u>13.56</u>
6 <u>1007 Main St</u>	<u>50</u>	<u>1:0</u>				
7						
8						
9						
EXTRA LANDINGS						
WAITING TIME						
EXTERNAL LOAD <u>2000</u>				<u>50.00</u>		
BOATS RENTED						
MOTORS RENTED						
CAMP RENTAL						
GAS SALES						
TOTAL				<u>2800.00</u>		

I hereby acknowledge receipt of the transportation described herein.

PER [Signature]
DISPATCHER

ISSUED AT [Signature]
NOV 5 1984 NO. 5473

PATRICIA MINING DIV.
RECEIVED
OCT 12 1984
A.M. P.M.
7 8 9 10 11 12 1 2 3 4 5 6

PHONE
807-274-5335

P.O. Box 668 Fort Frances, Ontario September 1, 1984

Rusty Myers Flying Service Ltd.

P.O. BOX 668 FORT FRANCES, ONTARIO

Fly to Your Favorite Hunting and Fishing Spots

FORT FRANCES, ONT. 1984

Mr. Roland Moede

Savant Hotel

Savant Lake, Ontario

Rusty Myers Flying Service Ltd.

Why Waste Time?

FLY to your Favourite Hunting and Fishing Spots

"We have operated in this district since 1941"

NAME *Roland Moede*

ADDRESS *Savant Hotel*

CITY _____

A/C MAKE _____ REGISTRATION _____

CREDIT CARD NO. _____

	GRADE	QUAN.	PRICE	AMOUNT
GASOLINE				
TAX				
OIL				
MAINTENANCE		HRS.		
<i>7.25</i>	<i>12.5</i>	<i>50</i>	<i>625.00</i>	<i>312.50</i>
<i>Even Belly Lake</i>		<i>50</i>	<i>140</i>	<i>70.00</i>
			TAX	
			TOTAL	<i>147.00</i>

Invoice #2809

\$147.00

[Handwritten Signature]

RECEIVED ABOVE IN GOOD ORDER

SIGNATURE *al*

2809

MOORE PLATTBART 2

PATRICIA MINING DIV.
RECEIVED
 OCT 12 1984
 A.M. P.M.
 7|8|9|10|11|12|1|2|3|4|5|6

*Checked
to show
book*

Don J Savare

Greg Sage

PATRICIA MINING DIV.
RECEIVED
OCT 12 1984
A.M. P.M.
7 8 9 10 11 12 1 2 3 4 5 6

FOR DEPOSIT ONLY
TO THE CREDIT OF
SAVANT LAKE HOTEL

010-7557-010
255 252
19 JUL 84
IMPERIAL
COMMERCIAL
C.I.B.C.
010-7557-010

JY '84 04
C.I.B.C.
MONTREAL
REGIONAL
DATA CENTRE
In Bank of Montreal
2403 Sioux Lookout, Ont.
payee

JUL 08 1984
Bank of Montreal
2403
Sioux Lookout, Ont.
24037-001

24037-001
Bank of Montreal
AUG 21 1984
61 Front St.
Sioux Lookout, Ont.
24037-001

AG '84 22
C.I.B.C.
DATA CENTRE
WINNIPEG, MANITOBA

AG '84
MONTREAL
REGIONAL
DATA CENTRE

JY '84 16
C.I.B.C.
DATA CENTRE
WINNIPEG, MANITOBA

0607-001
24037-001
010-7557-010

SAVANT HOTEL
GENERAL DELIVERY PH. 1-807-584-2236
SAVANT LAKE, ONTARIO P0V 2S0

0819

✓ Oct 20 1983

PAY TO THE
ORDER OF

Custom Fine Processing

\$ 56.⁰⁰/₁₀₀

SUM OF

Fifty Six Dollars

⁰⁰/₁₀₀ DOLLARS

RE: _____



CANADIAN IMPERIAL
BANK OF COMMERCE
IGNACE, ONT.

SAVANT HOTEL

Roland Meade

⑆01087⑉010⑆ 81⑉00217⑉

⑈0000005600⑈

*for deposit to the a/c of
Custom Fine Processing*

1127 61600

30197-002 2
THE BANK OF NOVA SCOTIA
SALMONTOWN, ONTARIO
30 OCT '83
2 30197-002

SAVANT HOTEL
GENERAL DELIVERY PH. 584-2236
SAVANT LAKE, ONTARIO P0V 2S0

0890

August 21 1984

PAY TO ORDER OF

Customs Line Agency Ltd

\$ 53

SUM OF

Eighty Eight Dollars

DOLLARS

RE



ROLAND MOEDE

CANADIAN IMPERIAL
BANK OF COMMERCE
IGNACE, ONT.

Roland Moede

⑆01087⑉010⑆ 81⑉00217⑉

⑆0000008800⑆

SAVANT HOTEL
SAVANT LAKE, ONTARIO
01

30197-002
THE BANK OF NOVA SCOTIA
BALDWINVILLE BRANCH
30197-002

DEPOSIT TO THE CREDIT OF
CUSTOMER'S ACCOUNT
3043-21

Handwritten notes:
Moe
Moe
Moe

SAVANT HOTEL
GENERAL DELIVERY PH. 584-2230
SAVANT LAKE, ONTARIO P0V 2S0

Aug 25 1983

PAY TO ORDER OF Dave Norman \$ 240.00

SUM OF Two Hundred Ninety Dollars 00/100 DOLLARS

RE: Christmas



CANADIAN IMPERIAL
BANK OF COMMERCE
IGNACE, ONT.

ROLAND MOEDE

Roland Moede

⑆01087⑉010⑆ 81⑉00217⑈

⑈0000024000⑈

712

SAVANT HOTEL
GENERAL DELIVERY PH. 584-2230
SAVANT LAKE, ONTARIO P0V 2S0

Aug 24 1983

PAY TO THE ORDER OF Michael Cunningham \$ 235.35

SUM OF Two Hundred Thirty Five Dollars 35/100 DOLLARS

RE: Christmas



CANADIAN IMPERIAL
BANK OF COMMERCE
IGNACE, ONT.

ROLAND MOEDE

Roland Moede

⑆01087⑉010⑆ 81⑉00217⑈

⑈0000023535⑈



Roland Maede
Sawant Lake Hotel

M. Maede
Roland Maede
Sawant Lake



Paul Hanson

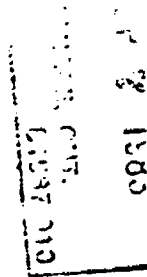
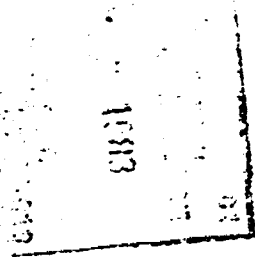

SAVANT HOTEL
GENERAL DELIVERY PH. 584-2238
SAVANT LAKE, ONTARIO POV 2S0

722

Aug 31 1983

PAY TO ORDER OF Custom Fire Assaying \$ 56.⁰⁰/₁₀₀
SUM OF Fifty Six Dollars 00 DOLLARS
100

RE: _____



ROLAND MOEDE

Roland Moede

⑆01087⑉010⑆ 81⑉00217⑉⑆ ⑆0000005600⑆

SAVANT HOTEL
GENERAL DELIVERY PH. 1-807-584-2238
SAVANT LAKE, ONTARIO POV 2S0

1196

July 2 1984

PAY TO THE ORDER OF Custom Fire Assaying Ltd \$ 77.⁰⁰/₁₀₀
SUM OF Seventy Seven Dollars 00 DOLLARS
100

RE: _____



SAVANT HOTEL

Roland Moede

⑆01087⑉010⑆ 81⑉00217⑉⑆ ⑆0000007700⑆

SAVANT HOTEL
GENERAL DELIVERY PH. 584-2238
SAVANT LAKE, ONTARIO POV 2S0

0975

Oct 15 1984

PAY TO THE ORDER OF Pell White Analytical Labs Ltd \$ 77.⁰⁰/₁₀₀
SUM OF Seventy Seven Dollars 00 DOLLARS
100

RE: Invoice 17441



ROLAND MOEDE

Roland Moede

⑆01087⑉010⑆ 81⑉00217⑉⑆ ⑆0000007700⑆

For the deposit to CU
credit of
Custom Fire Assaying

30197 200067

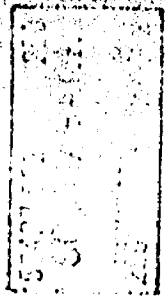

50-3-83

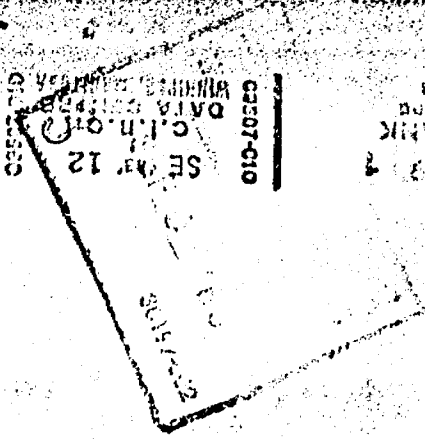

DEPOSIT TO THE CREDIT OF
Custom Fire Assaying
88443-21

30197-002
THE BANK OF NOVA SCOTIA
BALMESTON, ONTARIO
30197-002

RECORDED & INDEXED

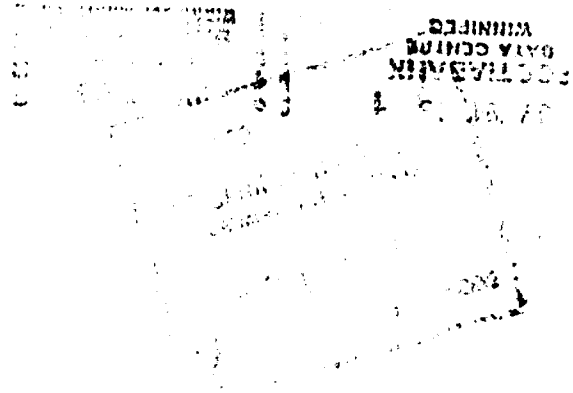

RECORDED & INDEXED

DEPOSIT TO THE CREDIT OF
BellWhite Analytical
Laboratories Ltd.

30002-002
THE BANK OF NOVA SCOTIA
BALMESTON, ONTARIO

03507-016
C.I.O.C.
DATA CENTRE
WINNIPEG, MANITOBA

01 25
30002-002

01 04 24 5
SCOTTABANK
DATA CENTRE
TORONTO

769

SAVANT HOTEL
GENERAL DELIVERY PH. 584-2236
SAVANT LAKE, ONTARIO POV 2S0

✓ Sept 28 1983

PAY TO THE ORDER OF Custom Fire Assaying \$ 56.⁰⁰/₁₀₀

SUM OF Fifty Six Dollars 00 DOLLARS 100

RE: _____



CANADIAN IMPERIAL
BANK OF COMMERCE
IGNACE, ONT.

ROLAND MOEDE

Roland Moede

⑆01087⑉010⑆ 81⑉00217⑉⑆

⑈0000005600⑈

SAVANT HOTEL
GENERAL DELIVERY PH. 1-807-534-2236
SAVANT LAKE, ONTARIO POV 2S0

1130

May 24 1984

PAY TO THE ORDER OF Custom Fire Assaying Ltd \$ 44.⁰⁰/₁₀₀

SUM OF Forty Four Dollars 00 DOLLARS 100

RE: _____



CANADIAN IMPERIAL
BANK OF COMMERCE
IGNACE, ONT.

SAVANT HOTEL

Roland Moede

⑆01087⑉010⑆ 81⑉00217⑉⑆

⑈0000004400⑈

SAVANT HOTEL
GENERAL DELIVERY PH. 1-807-584-2236
SAVANT LAKE, ONTARIO POV 2S0

1115

May 12 1984

PAY TO THE ORDER OF Custom Fire Assaying Ltd \$ 22.⁰⁰/₁₀₀

SUM OF Twenty Two Dollars 00 DOLLARS 100

RE: _____



CANADIAN IMPERIAL
BANK OF COMMERCE
IGNACE, ONT.

SAVANT HOTEL

Roland Moede

⑆01087⑉010⑆ 81⑉00217⑉⑆

⑈0000002200⑈

30197-002
 THE BANK OF NOVA SCOTIA
 BALMERTOWN, ONTARIO
 4 OCT '83
 30197-002

*For deposit to the acct
 Eastern Air Base*

SCOTIABANK
 DATA CENTRE
 BALMERTOWN, ONTARIO
 15 OCT 83

DEPOSIT TO THE CREDIT OF
 Custom Fire Arming
 88443-21

30197-002
 THE BANK OF NOVA SCOTIA
 BALMERTOWN, ONTARIO
 30197-002

30197-002
 THE BANK OF NOVA SCOTIA
 BALMERTOWN, ONTARIO
 1 JUN '84
 30197-002

SCOTIABANK
 DATA CENTRE
 BALMERTOWN, ONTARIO
 15 OCT 83

30197-002
 THE BANK OF NOVA SCOTIA
 BALMERTOWN, ONTARIO
 30197-002

DEPOSIT TO THE CREDIT OF
 Custom Fire Arming
 88443-21

SAVANT HOTEL
GENERAL DELIVERY PH. 584-2236
SAVANT LAKE, ONTARIO POV 250

0955

Oct 1 1984

PAY TO THE ORDER OF Bell White Analytical Lab Ltd \$ 85.00

SUM OF Eighty Five Dollars 00 DOLLARS
100

RE: Invoice = 17362



CANADIAN IMPERIAL
BANK OF COMMERCE
IGNACE, ONT.

ROLAND MOEDE

Roland Moede

⑆01087⑆010⑆ 81⑆00217⑆

⑆0000008500⑆

SAVANT HOTEL
GENERAL DELIVERY PH. 584-2236
SAVANT LAKE, ONTARIO POV 250

0820

July 12 1984

PAY TO THE ORDER OF Custom Fire Assaying Ltd \$ 66.00

SUM OF Sixty Six Dollars 00 DOLLARS
100

RE: Samples Rock. assaying



CANADIAN IMPERIAL
BANK OF COMMERCE
IGNACE, ONT.

ROLAND MOEDE

Roland Moede

⑆01087⑆010⑆ 81⑆00217⑆

⑆0000006600⑆

SAVANT HOTEL
GENERAL DELIVERY PH. 584-2236
SAVANT LAKE, ONTARIO POV 250

0931

Sept 17 1984

PAY TO THE ORDER OF Bell White Analytical Laboratories Ltd \$ 67.00

SUM OF Sixty Seven Dollars 00 DOLLARS
100

RE: Three assay samples



CANADIAN IMPERIAL
BANK OF COMMERCE
IGNACE, ONT.

ROLAND MOEDE

Roland Moede

⑆01087⑆010⑆ 81⑆00217⑆

⑆0000006700⑆

DEPOSIT TO THE CREDIT OF
Epi-Write Analytical
Laboratories Ltd.

80382-002
THE BANK OF NOVA SCOTIA
HALIFAX, ONTARIO
80382-002

SE '07 27
SCOTIABANK
DATA CENTRE
TORONTO

1 2 3 4 5 6 7 8 9 10 11 12 13 14 15 16 17 18 19 20 21 22 23 24 25 26 27 28 29 30 31 32 33 34 35 36 37 38 39 40 41 42 43 44 45 46 47 48 49 50 51 52 53 54 55 56 57 58 59 60 61 62 63 64 65 66 67 68 69 70 71 72 73 74 75 76 77 78 79 80 81 82 83 84 85 86 87 88 89 90 91 92 93 94 95 96 97 98 99 100

30197-002
THE BANK OF NOVA SCOTIA
BALMINTOWN, ONTARIO
88443-21
Custom Fire Assaying

DEPOSIT TO THE CREDIT OF

JY '07 16
WINNIPEG

JY '07 16
C.I.B.C.
DATA CENTRE
WINNIPEG, MANITOBA
09507-010

1 2 3 4 5 6 7 8 9 10 11 12 13 14 15 16 17 18 19 20 21 22 23 24 25 26 27 28 29 30 31 32 33 34 35 36 37 38 39 40 41 42 43 44 45 46 47 48 49 50 51 52 53 54 55 56 57 58 59 60 61 62 63 64 65 66 67 68 69 70 71 72 73 74 75 76 77 78 79 80 81 82 83 84 85 86 87 88 89 90 91 92 93 94 95 96 97 98 99 100

DEPOSIT TO THE CREDIT OF
Epi-Write Analytical
Laboratories Ltd.

80302-002
THE BANK OF NOVA SCOTIA
HALIFAX, ONTARIO
80302-002

01 '08 10
C.I.B.C.
DATA CENTRE
WINNIPEG, MANITOBA
09507-010

06 '08 10
C.I.B.C.
DATA CENTRE
WINNIPEG, MANITOBA
09502-01

DATA CENTRE

1 2 3 4 5 6 7 8 9 10 11 12 13 14 15 16 17 18 19 20 21 22 23 24 25 26 27 28 29 30 31 32 33 34 35 36 37 38 39 40 41 42 43 44 45 46 47 48 49 50 51 52 53 54 55 56 57 58 59 60 61 62 63 64 65 66 67 68 69 70 71 72 73 74 75 76 77 78 79 80 81 82 83 84 85 86 87 88 89 90 91 92 93 94 95 96 97 98 99 100

POISSON TWP. M-1865

3.

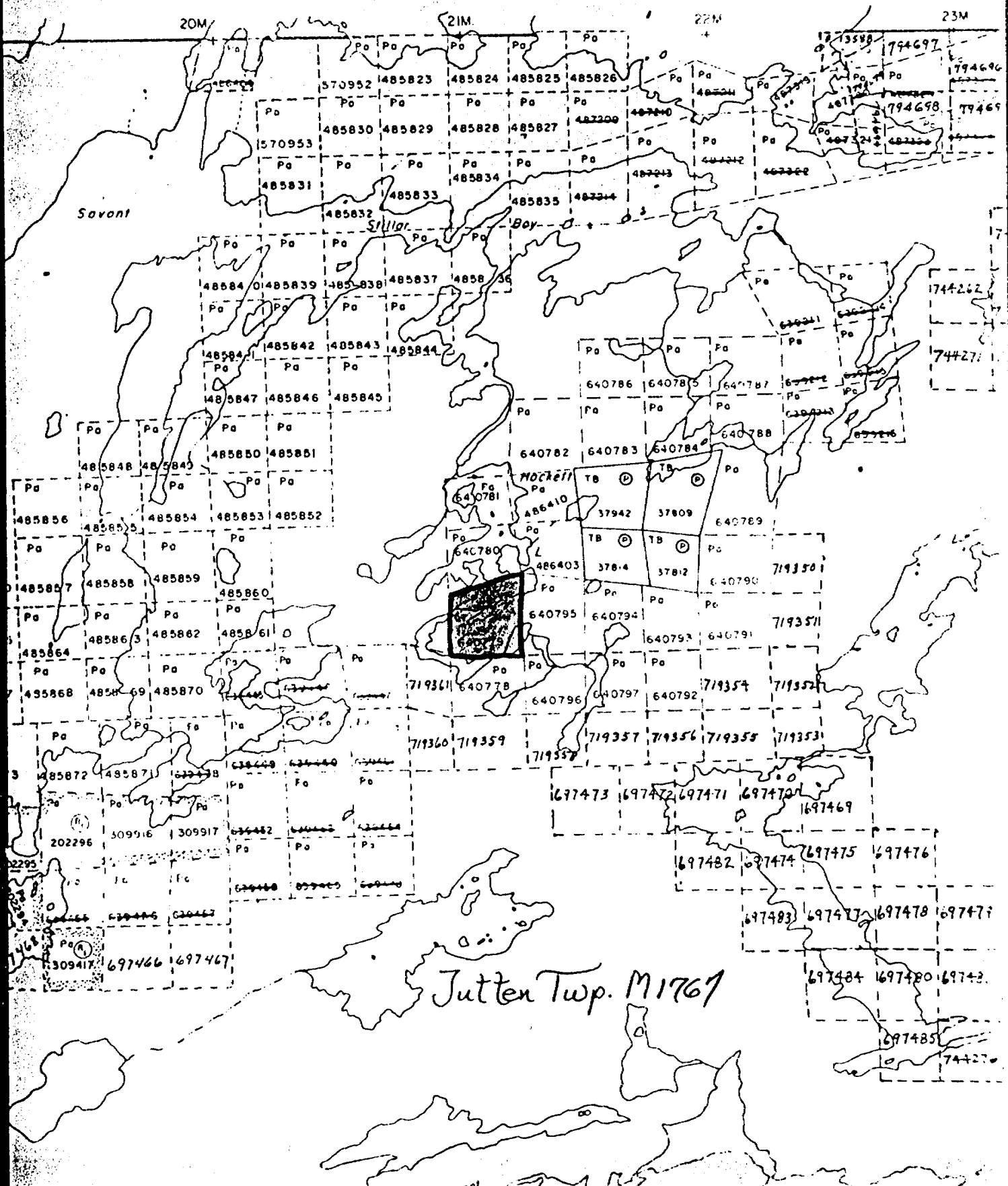

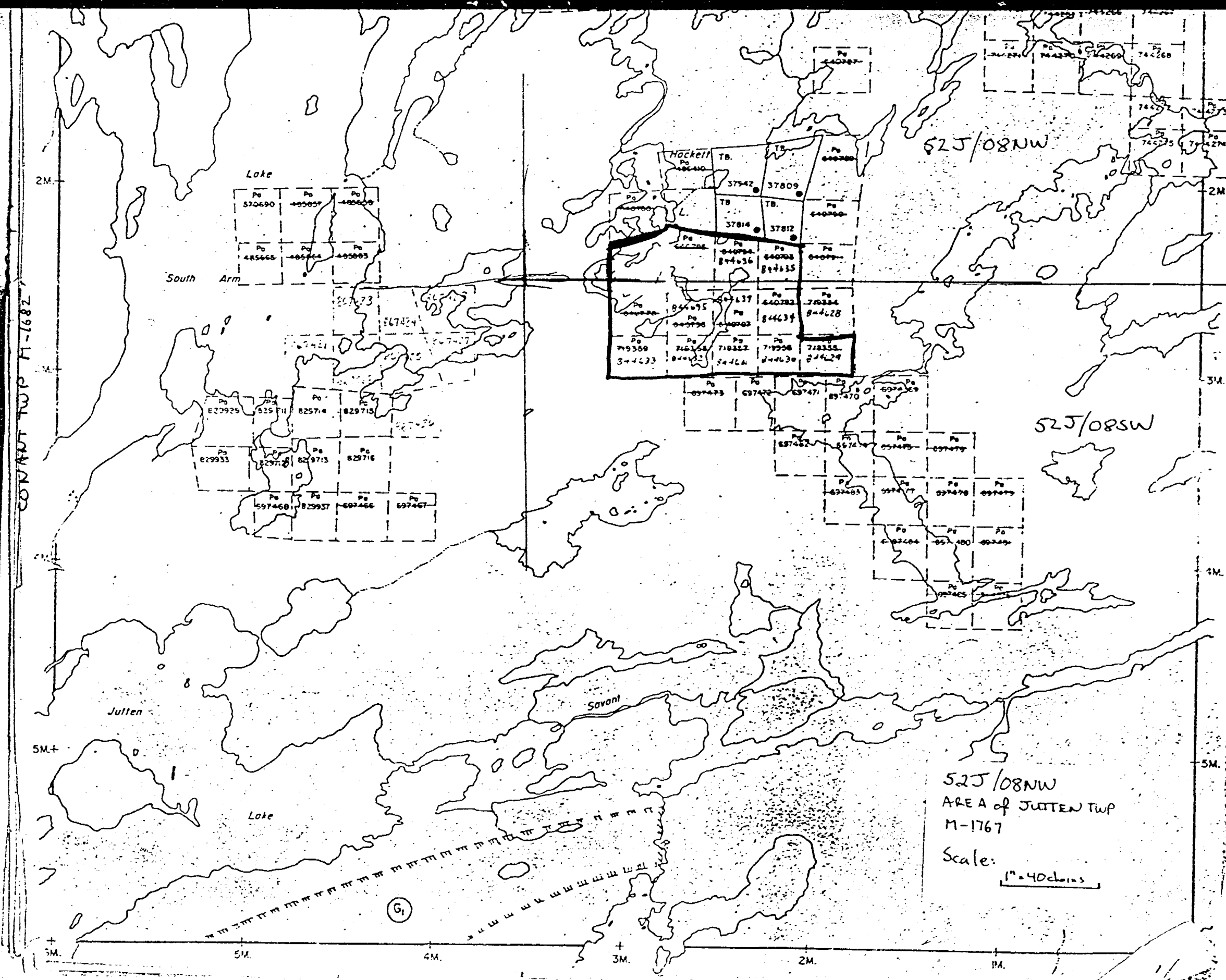

①

LEGEND

- PATENTED LAND
- PATENTED FOR SURFACE RIGHTS
- LEASE
- LICENSE OF OCCUPATION
- CROWN LAND SALES
- LOCATED LAND
- CANCELLED
- MINING RIGHTS ONLY
- SURFACE RIGHTS ONLY
- HIGHWAY & ROUTE NO.
- ROADS
- TRAILS
- RAILWAYS
- POWER LINES
- MARSH OR MUSKEG
- MINES

*used only with summer resort location

TOWNSHIP

JUTT

DISTRICT
THUNDER

PATRIC
MINING DIV

SCALE: 1 INCH = 40 CHAINS

DR. R. NOBLE
DATE MAY 12, 71.

PLAN NO. **M**

ONTARIO

52J/08NW
AREA of JUTTEN TWP
N-1767
Scale: 1" = 40 chains

CHEURIER TWP N-1673

Type of Surveyist: _____
 Claim Holder(s): 11 days
 Address: Reland Mining
 Survey Company: Sherwin-Lite Corp. 500 D.L. 230
 Date of Survey (from & to): _____
 Name and Address of Author (of Geo-Technical report): _____

Special Provisions	Geophysical	Days per Claim
For first survey: Enter 40 days. (This includes line cutting)	Electromagnetic	
	- Magnetometer	
	- Radiometric	
	- Other	
For each additional survey: using the same grid: Enter 20 days (for each)	Geological	
	Geochemical	
	Geophysical	
	Electromagnetic	
Man Days Complete reverse side and enter total(s) here	- Magnetometer	
	- Radiometric	
	- Other	
	Geological	
Airborne Credits Note: Special provisions credits do not apply to Airborne Surveys.	Geochemical	
	Electromagnetic	
	Magnetometer	

Mining Claims Traversed (List in numerical sequence)		
Prefix	Mining Claim Number	Expens Days Cr
Pa	640777	2
	640774	2
	640785	2
	640791	2
	640797	2
	640780	4
	640786	2
	640792	2
	640781	2
	640787	1
	640793	2
	640782	2
	640788	2
	640783	1
	640784	2
	640790	2
	640778	5
	640784	2
	640796	2

Expenditures (excludes power stripping)
 Type of Work Performed: Section 77-19
Assay Cost from Pat sample
 Performed on Claim(s): 640777, 640778, 640779, 640780, 640781, 640782, 640783, 640784, 640785, 640786, 640787, 640788, 640789, 640790, 640791, 640792, 640793, 640794, 640795, 640796, 640797, 640798, 640799, 640800
 Calculation of Expenditure Days Credits:
 Total Expenditures: \$ 677.00 ÷ 15 = 46 Total Days Credits

Instructions: Total Days Credits may be apportioned at the claim holder's choice. Enter number of days credits per claim selected in columns at right.
 Date: 10/12/84
 Request Holder or Agent (Signature): Michael J. ...

Pat: 640778
 For Office Use Only
 Recorded: 41
 Date Approved: Oct. 12, 1984
 Signature: [Signature]

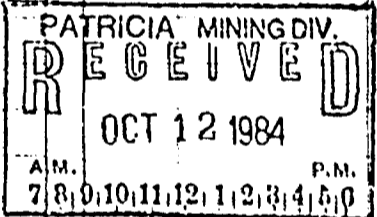

Certification Verifying Report of Work
 I hereby certify that I have a personal and intimate knowledge of the facts set forth in the Report of Work annexed thereto and its performance or witnessed same during and/or after its completion and the annexed report is true.
 Name and Postal Address of Person Certifying: [Signature]
 Date Certified: [Signature]

F.W.M. Mining Lands
 Division of Work
 Geological, Geological, and Expenditures

#84-142

Amended Mining Act 2.7331

Instruct
 Note
 Do not use shaded areas below

Type of Survey(s) Assays Location of Area Tu-ten Top M 1767
 Claim Holder(s) Richard Meridi Prospector's License No. 56299
 Address Savant LITE CNT: New Del. per 350
 Survey Company _____ Date of Survey (from & to) _____ Total Miles of Line Cut _____
 Day | Mo. | Yr. | Day | Mo. | Yr.

Credits Requested per Each Claim in Columns at right

Special Provisions	Geophysical	Days per Claim
For first survey: Enter 40 days. (This includes line cutting)	• Electromagnetic	
	• Magnetometer	
	• Radiometric	
	• Other	
For each additional survey: using the same grid: Enter 20 days (for each)	Geological	
	Geochemical	
Man Days Complete reverse side and enter total(s) here	Geophysical	Days per Claim
	• Electromagnetic	
	• Magnetometer	
	• Radiometric	
	• Other	
	Geological	
Airborne Credits Note: Special provisions credits do not apply to Airborne Surveys.	Electromagnetic	Days per Claim
	Magnetometer	
	Radiometric	

Mining Claims Traversed (List in numerical sequence)

Mining Claim Prefix	Mining Claim Number	Expend. Days Cr.
	640779	
	640784	2
	640785	2
	640791	2
	640792	2
	640780	4
	640786	2
	640792	2
	640781	2
	640787	1
	640793	2
	640782	2
	640788	2
	640783	4
	640787	2
	640790	2
	640778	5
	640784	2
	640790	2
	640796	2

PATRICIA MINING DIV.
RECEIVED
 OCT 12 1984
 A.M. 7 8 9 10 11 12 P.M. 1 2 3 4 5 6

Expenditures (excludes power stripping)
 Type of Work Performed Section 77-19
Assay Cost from Rock Samples
 Performed on Claim(s) 640779, 640792, 640794, 640793
640795, 640796, 640797
 Calculation of Expenditure Days Credits
 Total Expenditures \$674.00 + Total Days Credits 15 = 46
 Instructions
 Total Days Credits may be apportioned at the claim holder's choice. Enter number of days credits per claim selected in columns at right.

P. 640778

For Office Use Only
 Total Days Cr. Date Recorded 46 Oct. 12, 1984
 Date Approved as Recorded 85. 1. 18

Date 10/12/84 Request Holder or Agent (Signature) Richard Meridi

Certification Verifying Report of Work
 I hereby certify that I have a personal and intimate knowledge of the facts set forth in the Report of Work and that I have performed the work or witnessed same during and/or after its completion and the annexed report is true.
 Name and Postal Address of Person Certifying Richard Meridi, Savant LITE CNT, New Del.
 Date Certified 10/12/84 Signature _____

Your File: 84-142
Our File: 2.7331

October 26, 1984

Mining Recorder
Ministry of Natural Resources
P.O. Box 309
Stouffville, Ontario
POY 2T0

Dear Sir/Madam:

We received Data for Assaying on October 22, 1984 submitted under Section 77(19) of the Mining Act R.S.O. 1980 for Mining Claims Pa #40778 et al in the Township of Jutten.

This material will be examined and assessed and a statement of assessment work credits will be issued.

Yours sincerely,

S.E. Yundt
Director
Land Management Branch

Whitney Block, Room 6643
Queen's Park
Toronto, Ontario
M7A 1W3
Phone:(416)965-4888

D. Kinvig:lg

cc: Roland Moede
Savant Lake, Ontario
POY 2S0
General Delivery

November 5, 1984

File: 2.7331

Roland Moed:
c/o General Delivery
Savant Lake, Ontario
POY 2S0

Dear Sir:

RE: Data for Assaying filed under Section 77(19)
of the Mining Act RSO 1980 submitted on
Mining Claims PA 640778 et al in the Township
of Jutten

In order to complete your submission for assessment
credit, the following information is required:

1. A sample location plan indicating where the
samples were taken.
2. Certificates of analysis of the samples which
may be related to the sample location plan.
3. Signed receipts or cancelled cheques as verification
of the assaying expenses of \$694.00.

Please forward the above information, in duplicate,
to this office quoting file 2.7331.

For further information, please contact Doug Isherwood
at (416)965-4888.

Yours sincerely,

S.E. Yundt
Director
Land Management Branch

Whitney Block, Room 6643
Queen's Park
Toronto, Ontario
M7A 1W3
Phone: (416)965-4888

D. Isherwood:mc

cc: Mining Recorder
Sioux Lookout, Ontario

December 21, 1984

File: 2.7331

Rolande Moede
c/o General Delivery
Savant Lake, Ontario
POV 2S0

Dear Sir:

RE: Data for Assaying filed under Section 77(19)
of the Mining Act R.S.O. 1980 submitted on
Mining Claims PA 640773 et al in the Township
of Jutten

As requested in my letter of November 5, 1984 we still
require a sample location map which can be related to
the certificates of analysis or which displays the
sampling results.

Please forward the above information, in duplicate,
to this office quoting file 2.7331.

For further information, please contact Doug Isherwood
at (416)965-4888.

Yours sincerely,

S.E. Yundt
Director
Land Management Branch

Whitney Block, Room 6643
Queen's Park
Toronto, Ontario
M7A 1W3
Phone: (416)965-4888

D. Isherwood:mc

cc: Mining Recorder
Sioux Lookout, Ontario

FOR ADDITIONAL

INFORMATION

SEE MAPS:

52J/08NW-0036 # 1

