



52J10SE0005 52J10SE0011C1 SOLITUDE LAKE

010

Diamond Drilling

Area of SOLITUDE LAKE

Report N^o 16

Work performed by: Hanna Mining Company

Claim N ^o	Hole N ^o	Footage	Date	Note
PA 36612	66	434.0'	Aug/67	
PA 36609	67	298.0'	Aug/67	
PA 36610	68	334.0'	Aug/67	

TOTAL: 3DN 1066'

Notes:

PROPERTY Minors River Property - Hanna Lake Claims **HOLE No.** 6f
SHEET NUMBER Claim Pa-36612 - 450' East of #3 Post **STARTED** August 26, 1967
LATITUDE 110°N **DATUM** **COMPLETED** August 27, 1967
DEPARTURE 400'E **BEARING** N50°W **ULTIMATE DEPTH** 434'
ELEVATION **DIP** -45°W 380' - 39°30' **PROPOSED DEPTH**

DEPTH FEET	FORMATION	SAMPLE NO.	FROM	TO	WIDTH	ASSAY VALUES			
0- 17	Casing								
17- 26	Basic Tuff								
	With biotitic banding at 55° to core.								
26- 52	Lean Iron Formation								
	Brown iron silicate, sugary quartz								
	and magnetite interband at 65° to								
	core. Minor pyrrhotite and pyrite								
52- 78	Banded Iron Formation								
	As above, but magnetite bands are								
	more frequent.								
78- 87	Lean Iron Formation								
87-114	Interbanded Lean Iron formation and								
	amphibolitized basic volcanic.								

NORTHERN MINER FORM 303 REV. 64

DRILLED BY _____

LOGGED BY _____

William Hogg

PROPERTY Miniss River Property - Hanna Lake Claims

HOLE No. 66

SHEET NUMBER 2 of 4 SECTION FROM TO STARTED
 LATITUDE DATUM COMPLETED
 DEPARTURE BEARING ULTIMATE DEPTH
 ELEVATION DIP PROPOSED DEPTH

DEPTH FEET	FORMATION	SAMPLE NO.	FROM	TO	WIDTH	ASSAY VALUES			
114-135	Lean Iron Formation								
	Banded at 72° to core. Brown iron silicate bands predominate.								
135-177	Banded Iron Formation								
	Bands of magnetite, brown iron silicates and greenish amphibole. Minor pyrrhotite.								
177-182	Amphibolite								
	Basic dike or sill with fine margins.								
182-238	Lean Iron Formation								
	With bands of brown iron silicates and minor magnetite.								
238-291	Banded Iron Formation								
	Bands of magnetite, brown iron								

NORTHERN MINER FORM 509 REV. 54

DRILLED BY _____

SIGNED _____

Richard Bogg

PROPERTY Miniss River Property - Hanna Lake Claims

HOLE No. 66

SHEET NUMBER 3 of 4 SECTION FROM _____ TO _____

STARTED _____

LATITUDE _____ DATUM _____

COMPLETED _____

DEPARTURE _____ BEARING _____

ULTIMATE DEPTH _____

ELEVATION _____ DIP _____

PROPOSED DEPTH _____

DEPTH FEET	FORMATION	SAMPLE NO.	FROM	TO	WIDTH	ASSAY VALUES			
	silicate and sugary quartz at 70°-								
	80° to core.								
291-315	Lean Iron Formation								
	Only a few narrow magnetite bands.								
	Includes 2 narrow dikes of amphibol-								
	ite, up to 1½ feet thick.								
315-330	Pegmatite								
	Coarse granitic rock, with several								
	inclusions of amphibolite.								
330-392	Amphibolitized Basic Volcanic								
	Generally massive, with faint band-								
	ing - possibly a tuff.								
392-404	Interbedded Lean Iron Formation								
	And basic tuff in bands up to 5' thick.								

NORTHERN MINER FORM 500 REV. 7-54

DRAWN BY _____

DATE _____

Orlando Hogg

PROPERTY Hills River Property - Hanna Lake Claims

HOLE No. 66

SHEET NUMBER 4 of 4

SECTION FROM _____ TO _____

STARTED _____

LATITUDE _____

DATUM _____

COMPLETED _____

DEPARTURE _____

BEARING _____

ULTIMATE DEPTH _____

ELEVATION _____

DIP _____

PROPOSED DEPTH _____

DEPTH FEET	FORMATION	SAMPLE NO.	FROM	TO	WIDTH	ASSAY VALUES			
404-434	Amphibolite								
	Probably a dike or sill, with finer textures toward contact.								
434	END OF HOLE								

NORTHERN MINER FORM 505 REV./54

DRILLED BY Heath & Sherwood

SIGNED _____

Nelson Hogg
Nelson Hogg

PROPERTY Miniss River Property - Hanna Lake Claims
 Claim Pa-36609 - 400' S65°E of #4 Post

HOLE No. 67

SHEET NUMBER

SECTION FROM

TO

STARTED

August 28, 1967

LATITUDE

DATUM

COMPLETED

August 30, 1967

DEPARTURE

480'E

BEARING

N50°W

ULTIMATE DEPTH

298'

ELEVATION

DIP

-45°W 298' - 41°

PROPOSED DEPTH

DEPTH FEET	FORMATION	SAMPLE NO.	FROM	TO	WIDTH	ASSAY VALUES			
0- 12	Casing								
12- 75	Lean Iron Formation								
	Bands of sugary quartz, brown iron silicates and minor magnetite cut the core at 60-80°.								
75- 81	Amphibolitized basic Dike								
81-120	Lean Iron Formation as from 12 - 75								
120-224	Banded Iron Formation								
	Magnetite content increased from 120 to 148 feet, and banding is more prominent at 70° to core.								
224-298	Amphibolite -								
	Medium to coarse-grained with plagioclase laths.								

298

NORTHERN MINER FORM 905 REV. 64

END OF HOLE

DRILLED BY

Heath & Sherwood

DRILLED

Nelson Hogg

Nelson Hogg
 Nelson Hogg

PROPERTY Minniss River Property - Harma Lake Claims
 Claim Pa-36610 - 200' N35°W of #3 Post

HOLE No. 68

SHEET NUMBER

1 of 2

SECTION FROM

TO

STARTED

August 30, 1967

LATITUDE

L 14.3

DATUM

COMPLETED

September 1, 1967

DEPARTURE

170'W

BEARING

N50°W

ULTIMATE DEPTH

334'

ELEVATION

DIP

-45°W

318' - 340

PROPOSED DEPTH

DEPTH FEET	FORMATION	SAMPLE NO.	FROM	TO	WIDTH	ASSAY VALUES			
0- 8	Casing								
8- 25	Amphibolite								
	Probably a basic dike, somewhat sheared at the contact.								
25-123	Banded Iron Formation								
	Magnetite in bands up to 2" thick with brown iron silicate and sugary quartz. Banding cuts core at 65-73°.								
123-144	Amphibolite -								
	Probably a sill as dike, with fine-grained margins.								
144-159	Banded Iron Formation								
	Magnetite bands in equal amount with								

NORTHERN MINER FORM 505 REV. 64

DRAWN BY

SIGNED

Chelsea Hogg

SHEET NUMBER

SECTION FROM

TO

STATUS

LATITUDE

DATUM

COMPLETED

DEPARTURE

READING

ULTIMATE DEPTH

ELEVATION

REF

PROPOSED DEPTH

DEPTH FEET	FORMATION	SAMPLE NO.	FROM	TO	WIDTH	ASSAY VALUES			
	brown silicates and sugary quartz at 70° to core.								
159-258	Lean Iron Formation								
	silicate bands pre-dominant, with lesser amounts of sugary quartz, magnetite and pyrrhotite. Banding is at 75-85° to core.								
258-271	Banded Iron Formation								
	In which magnetite constitutes 25%.								
271-334	Amphibolite								
	Probably a basic dike, or sill, with laths of feldspar irregularly distributed.								
334	END OF HOLE								

NORTHERN MINING PATENT AND SERVICE

DRAWN BY Heath & Sherwood

Nelson Hogg
Nelson Hogg

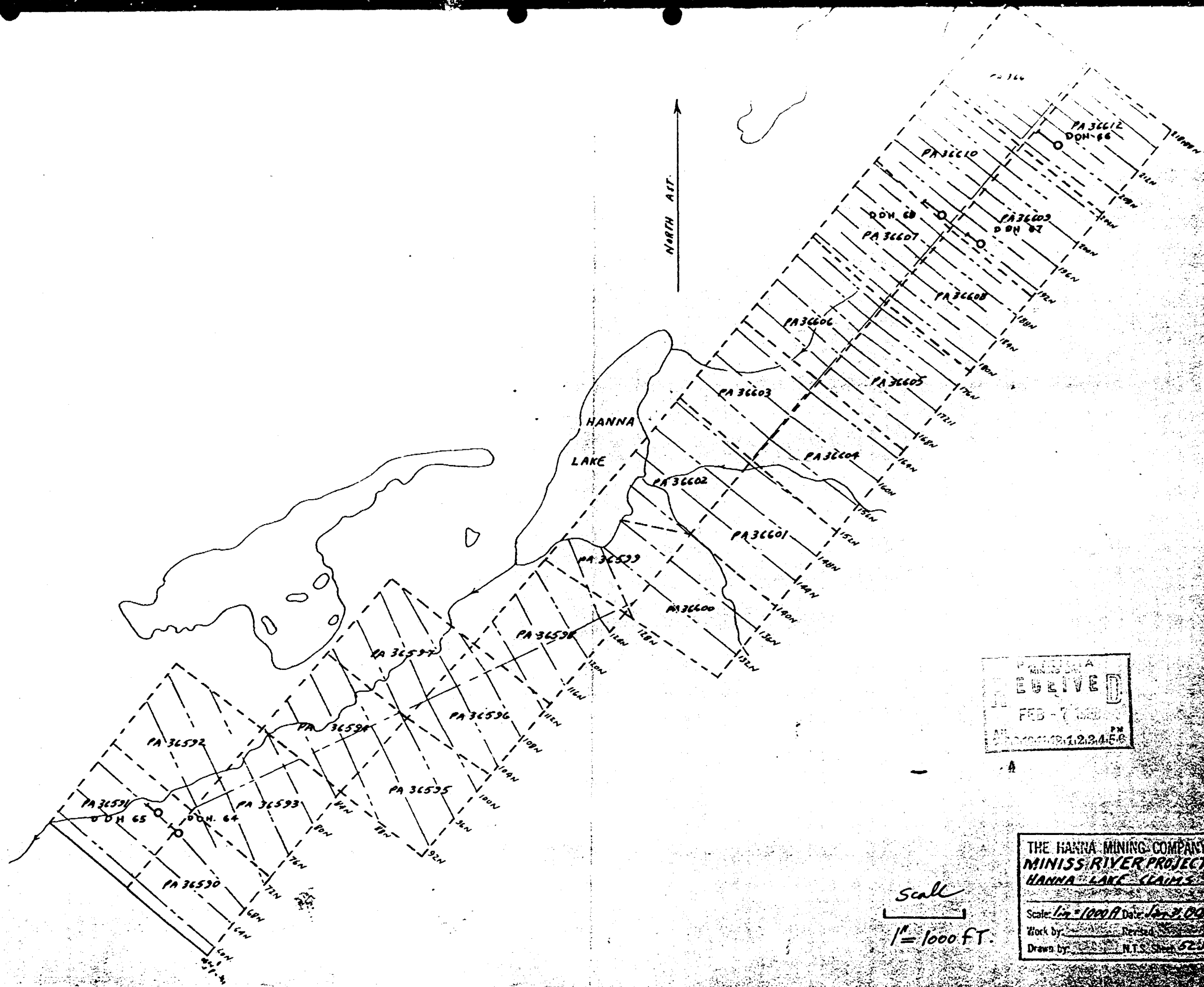

RECEIVED
 FEB - 1965
 122456

Scale
 1" = 1000 FT.

THE HANNA MINING COMPANY
MINISS RIVER PROJECT
HANNA LAKE CLAIMS
 Scale: 1" = 1000 FT. Date: Jan 21, 1965
 Work by: _____ Revised: _____
 Drawn by: _____ N.T.S. Sheet 52A