



52K01SE0582 52K01SE0011A1 DRAYTON

010

Diamond Drilling

Township of DRAYTON

Report NO: 12

Work performed by: MacDonald Group

Claim NO	Hole NO	Footage	Date	Note
PA 13116	A	234.6'	Mar/52	
PA 13119	B	293.2'	Mar/52	
	BA	352.0'	Mar/52	

TOTAL: 3 PH 880 FT

Notes:

PROPERTY Macdonald Group

HOLE NUMBER DDH-A
 SHEET NUMBER 1 of 1
 SECTION FROM TO

DIAMOND DRILL RECORD

LOCATION: LAT..... B. L. 4 - 4.404
 DEF Sec. 55.902
 ELEVATION OF COLLAR
 DATUM
 DIRECTION AT START: BEARING Ang.e 14° SE with Sec. Line 56.1
 DIP 58°

STARTED Mar. 6, 1952
 COMPLETED Mar. 12, 1952
 ULTIMATE DEPTH 234.6'
 PROPOSED DEPTH

DEPTH FEET	FORMATION	SAMPLE NO	WIDTH OF SAMPLE	GOLD g	SLUDGE GOLD g
0.0	Collar (lake ice)				
98.0	Casing (Lake depth - 26.0')				
99.9	Greenstone schist				
114.8	Greenstone schist heavily intruded by Felsite with associated semi-massive pyrite-pyrrhotite and minor carbonaceous occurrence. Ground(missing) cores:- 0.7' at 102.9' and 0.8' at 106.0'.				
234.8	Greenstone and greenstone schist. Ground(missing) cores: 1.5' at 174.1' and 1.1' at 225.6'. Bottom of hole				

**DUPLICATE COPY
 POOR QUALITY ORIGINAL
 TO FOLLOW**

PROPERTY Macdonald Group

HOLE NUMBER DDH-B

SHEET NUMBER 1 of 1

SECTION FROM TO

DIAMOND DRILL RECORD

LOCATION: LAT..... B. L. 4 - 5.165
 DFP. Sec. 45.589
 ELEVATION OF COLLAR
 DATUM
 DIRECTION AT START: BEARING Angle 12 $\frac{1}{2}$ $^{\circ}$ SE with Sec. Line 46.2
 DIP 55 $^{\circ}$

STARTED Mar. 13, 1952
 COMPLETED Mar. 27, 1952
 ULTIMATE DEPTH 293.2'
 PROPOSED DEPTH

DEPTH FEET	FORMATION	SAMPLE NO	WIDTH OF SAMPLE	GOLD g	SLUDGE GOLD g
0.0	Collar(Lake ice).				
257.0	Casing (lake depth - 38.0')				
200.5"	Soft white decomposed tuffs (negligible core recovery core washed out of core barrel by circulated drilling water.)				
293.2	Decomposed white tuffs, minor disseminated pyrite. Hole abandoned - on account of impossibility of re-turning core barrel to bottom of hole due to extreme enlargement of hole by action of circulated drilling water in upper sone of decomposed tuffs.				

**DUPLICATE COPY
 POOR QUALITY ORIGINAL
 TO FOLLOW**

PROPERTY

Macdonald Group

HOLE NUMBER DDH-BA

SHEET NUMBER 1 of 1

SECTION FROM .. TO ..

DIAMOND DRILL RECORD

LOCATION: LAT..... B. L, 4 - 5.410
 OFF Sec. 45.641

ELEVATION OF COLLAR

DATUM

DIRECTION AT START: BEARING Angle 124° SE with Sec. Line 46.2
 DIP 53°

STARTED Mar, 28, 1952

COMPLETED Apr. 11, 1952

ULTIMATE DEPTH 352.0'

PROPOSED DEPTH

DEPTH FEET	FORMATION	SAMPLE NO	WIDTH OF SAMPLE	GOLD \$	SLUDGE GOLD \$
0.0	Collar (Lake ice)				
237.0	Casing (Lake depth 40.0')				
255.0	Added casing (self driven through non-coring decomposed tuffs)				
287.2	Decomposed tuffs (non-coring in upper section)				
299.0	Tuffs, some carbonaceous material, weakly disseminated pyrite.				
306.0	Silicified tuffs, very weakly disseminated pyrite				
323.1	Weakly chloritized and strongly carbonaceous tuffs, moderate pyrrhotite-pyrite				
327.1	Fine grained semi-massive pyrite-pyrrhotite in carbonaceous tuffs.				
352.0	Porphyritic greenstone.				
	Bottom of hole.				

DUPLICATE COPY
POOR QUALITY ORIGINAL
TO FOLLOW

DRAYTON
TOWNSHIP.

NORTH HALF OF
LOT 33
CONCESSION
1.

NORTH HALF OF
LOT 32.
CONCESSION
1.

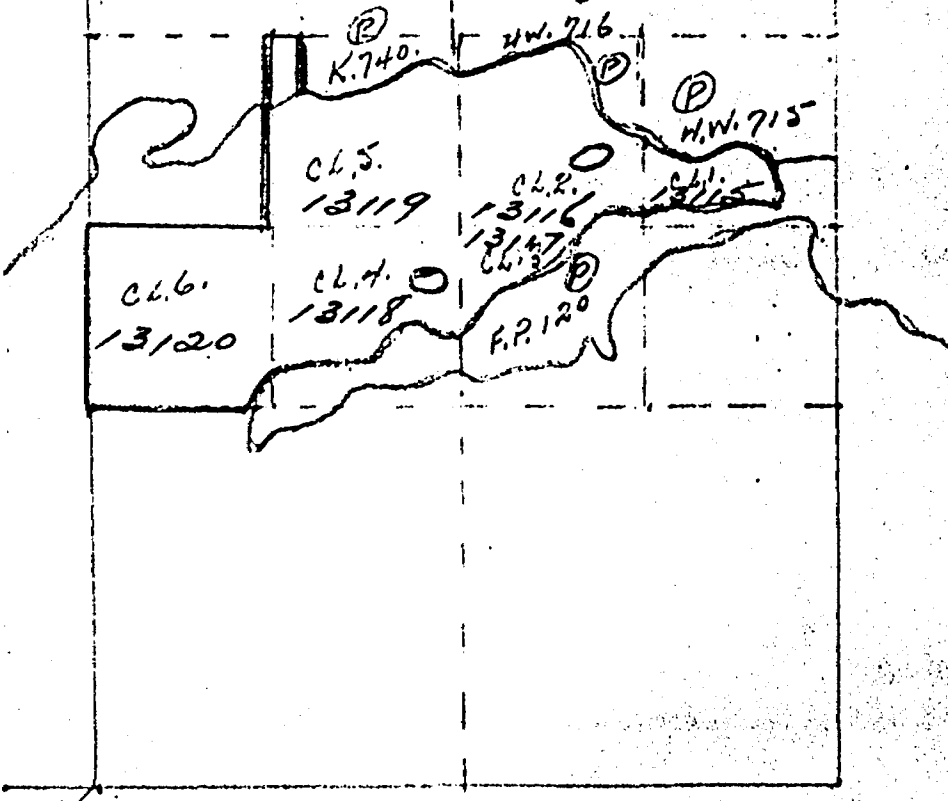

Report # 11
DRAYTON TWP. 2233

SCALE: 1" = 40 CH

