

Diamond Drilling

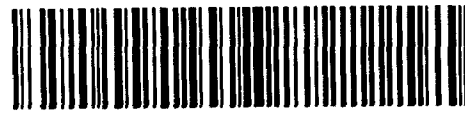

52K01SW0008 52K01SW0016B1 VERMILION

010

Township of LOMOND

Report NO 17

Work performed by: Selco Mining Corporation Limited

Claim NO	Hole NO	Footage	Date	Note
PA 436381	30-15-1	285.0	Mar/79	(1) (2)

TOTAL: 1 DH 285 FT

Notes:

- (1) #53-79
- (2) #21-80

DIAMOND DRILL RECORD

HOLE NO. 30-15-1

PROPERTY _____

GULLWING AREA

(Pa 436381)

SHEET NO 1 of 2

BEARING Grid South

LOCATION 8+00E
0+25S

DIP COLLAR -50°

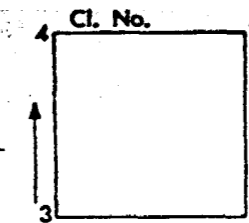

ELEVATION

TOTAL DEPTH 285'

CORE SIZE AQ

STARTED March 27, 1979 COMPLETED March 29, 1979

FROM	TO	DESCRIPTION	SAMPLE NO.	FROM	TO	CORE LENGTH	CORE RECOVERED	ASSAYS				REMARKS
								Au oz/t	Ag oz/t	Cu %	Zn %	
0	50.0	CASING (48' water, 2' Overburden)										
50.0	233.0	ANDESITE TUFF Fine grained, slate grey to pale brown with color varying from uniform to mottled appearance. - relict clastic texture with occasional black cherty knot or wispy feature. These probably are relict silicic clasts that have survived the pervasive carbonate alteration and bleaching of the unit. - bedding at 65° to core axis - trace of fine grained disseminated pyrite and chalcopryrite - numerous thin, irregular carbonate veinlets - quartz veining at 66.7-67.4; 77.1-77.6'										
233.0	245.0	GRAPHITIC ARGILLITE Fine grained, black, very highly graphitic with 20% pyrite, bedded with the argillite. Minor nodular pyrite. 233.0-240.0: 5' core recovered 240.0-245.0: 3.3' core recovered	0570 0571	233.0 240.0	240.0 245.0	7.0 5.0	5.0 3.3	Nil .002	.03 .02	.07 .07	0.28 0.75	
245.0	252.0	ANDESITE LAPILLI TUFF Fine grained, slate grey lenticular lapilli closely packed in an olive green matrix. - numerous 1-10 mm. thick grey glassy quartz veinlets at 70-80° to core axis.										
252.0	257.8	GRAPHITIC ARGILLITE Fine grained, black, highly graphitic, well bedded sediments with 50% fine grained pyrite, 252-256'. 256-257.8: grey tuff or wacke with minor argillite +5% pyrite, trace chalcopryrite.	0572	252.0	256.0	4.0	4.0	0.002	0.09	0.10	0.54	

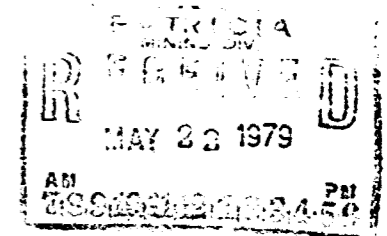

DRILLED BY Amalgamated Drilling

SIGNED A.P. Pryslak

DIAMOND DRILL RECORD

HOLE NO. 30-15-1

PROPERTY _____

GULLWING AREA

SHEET NO 2 of 2

BEARING _____

LOCATION 8 00E
0 25S

DIP COLLAR _____

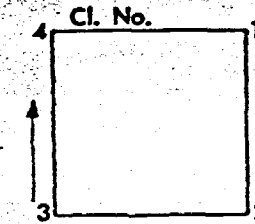

ELEVATION _____

TOTAL DEPTH _____

CORE SIZE _____

STARTED _____

COMPLETED _____

FROM	TO	DESCRIPTION	SAMPLE NO.	FROM	TO	CORE LENGTH	CORE RECOVERED	ASSAYS				REMARKS
257.8	285.0	<p>ANDESITE TUFF</p> <p>Fine grained, pale grey-green to slate grey, weakly mottled due to color variation. Occasional black silicic clast, otherwise the unit is pervasively bleached and carbonatized with 1-2% very fine disseminated pyrite.</p> <p>279-285.0: very highly fractured core with rust</p> <p>284: 1" massive pyrite plus goethite.</p>										

PATRICIA
MINING DIV.
R E C E I V E D
MAY 22 1973
AM 7:38:10 PM 7:38:45

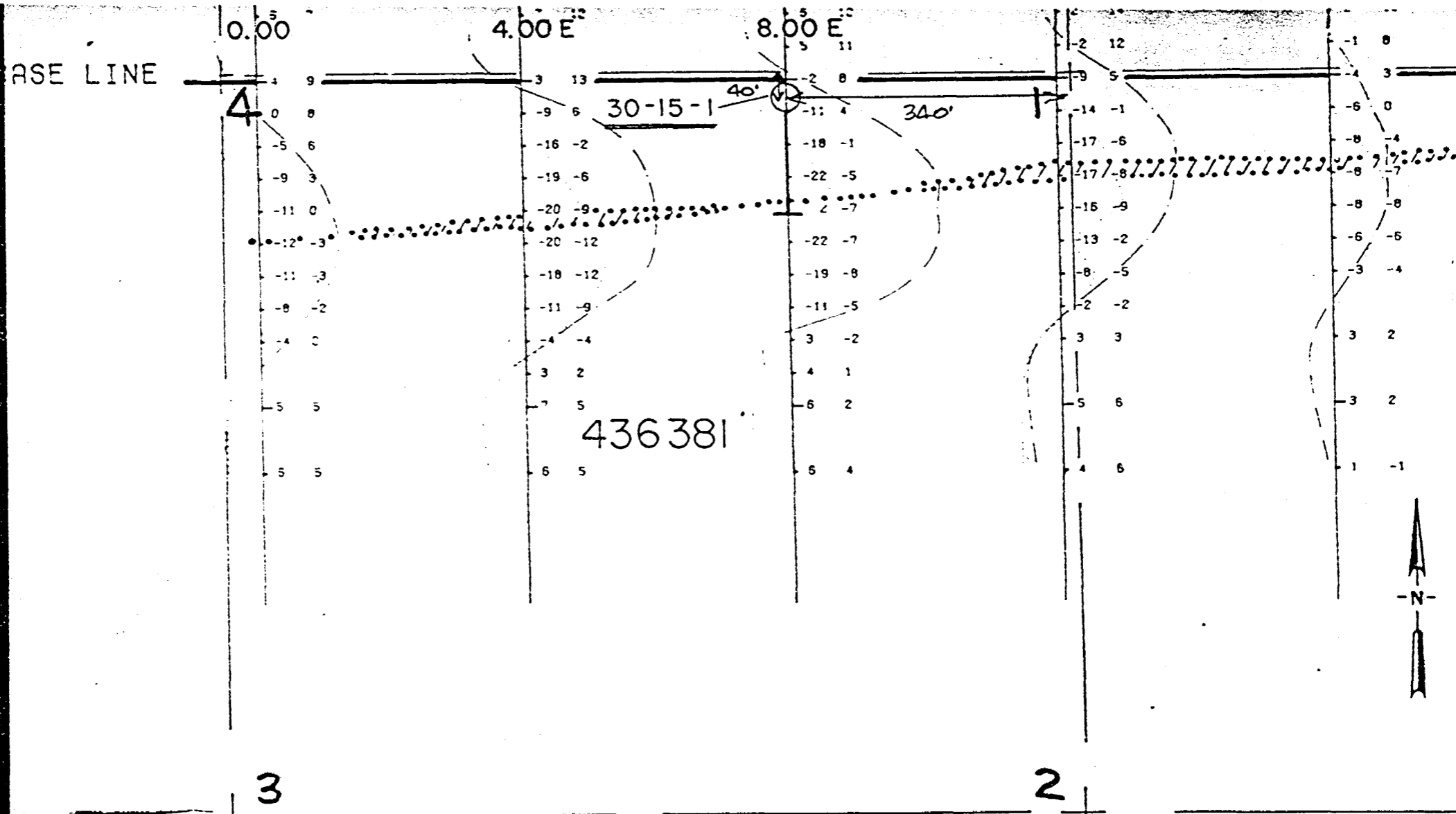

R
 PATRICIA
 MINING DIV.
 MAY 23 1979
 D

SELCO MINING CORPORATION LIMITED
 CLAIM LOCATION SKETCH - GULLWING AREA
 D.D.H. 30-15-1, CL. 436381
 CLAIM MAP M.2251, ONTARIO
 Scale 1" = 200' May, 1979

0.00

4.00E

8.00E

12.00E

16.00E

0 1
-1 2
2 3
2 3
4 3
6 7
4 9
4 0
-5 6
-9 3
-11 0
-12 -3
-11 -3
-8 -2
-4 0
-5 5
6 5

-1 -3
-2 -8
-2 -12
0 -7
4 2
7 12
-9 6
-18 -2
-19 -8
-20 -9
-20 -12
-10 -12
-11 -9
-4 -4
3 2
-7 5
6 5

-1 2
-3 -9
-3 -17
0 -7
4 1
6 10
5 11
-11 4
-18 -1
-22 -5
-22 -7
-19 -8
-11 -5
-3 -2
4 1
-6 2
6 4

-2 -5
-2 -12
-1 -10
2 0
5 10
2 14
-2 12
-14 -1
-17 -8
-18 -9
-13 -2
-8 -5
-2 -2
3 3
-5 6
4 6

-1 8
-2 -3
-2 -9
0 -5
4 5
2 10
-1 8
-4 0
-8 -4
-8 -8
-6 -8
-5 -4
3 2

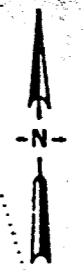

436380

436379

30-15-1

VERMILION BAY

436381

SELCO MINING CORPORATION LIMITED

GULLWING AREA

D.D.H. 30-15-1

CLAIM 436381

CLAIM MAP M.2251, ONTARIO

Scale 1"=200'

February, 1980

6-10-78



52K01SW0008 52K01SW0016B1 VERMILION

900

Lomond Township
M-2251

Resources

30-15

A separate form is required for each type of work to be recorded.

79-53

THE MINING ACT REPORT OF WORK

To the Recorder of Sioux Lookout Mining Division

I, Salco Mining Corporation Limited T-190

name of Recorded Holder Prospector's Licence

55 University Avenue, Suite 1700, Toronto, Ontario M5J 2H7

Post Office Address

do hereby report the performance of 40 days of Diamond Drilling type of work

not before reported to be applied on the following contiguous claims

Claim No.	Days	Claim No.	Days	Claim No.	Days
Pa. 436377	..20.
Pa. 436384	..20.
.....
.....
.....
.....

All the work was performed on Mining Claim (s) Pa 436381
(In the case of geological and/or geophysical survey (s) where more than 18 claims are involved attach a schedule)

READ CAREFULLY: THE FOLLOWING INFORMATION IS REQUIRED BY THE MINING RECORDER.

For Manual Work, Stripping or Opening up of Mines, Sinking Shafts or Other Actual Mining Operations - Names and addresses of the men who performed the work and the dates and hours of their employment.
For Diamond and other Core Drilling - Footage, No. and angle of holes and diameter of core. Name and address of owner or operator of drill. Dates when drilling was done. Signed core log and sketch in duplicate.
For Compressed Air or Other Power Driven or Mechanical Equipment
 Type of drill or equipment. Names and addresses of men engaged in operating equipment and the dates and hours of their employment.
For Power Stripping - Type of equipment. Name and address of owner or operator. Amount expended. Dates on which work was done. Proof of actual cost must be submitted within 30 days of recording.
 With each of the above types of work sketches are required to show the location and extent of the work in relation to the nearest claim post. In the case of diamond or other core drilling the sketch must be submitted in duplicate.
For Geophysical, Geological, Geochemical Surveys and Expenditure Credits - the name of author of report. Covering dates of survey (linecutting & office). Type of instrument used. Total amount of expenditure. Technical reports, maps, expenditure breakdown, receipts must be filed in duplicate with the Minister within 60 days of recording.
For Land Survey - the name and address of Ontario Land surveyor.

The Required Information is as Follows: (Attach a list if this space is insufficient)

D.D.H.	TOTAL	USING	BEARING	DIP	CORE	DATES
30-15-1	285'	40'	Grid 'S'	-50°	AQ	Mar. 27-Mar. 29, 1979

Balance 245 days for future use

Date May 17, 79 Signature of Recorded Holder or Agent J.E. Rackley

The Mining Act Certificate Verifying Report of Work

I, J.E. Rackley

55 University Avenue, Suite 1700, Toronto, Ontario M5J 2H7

(Post Office Address)

hereby certify:

1. That I have a personal and intimate knowledge of the facts set forth in the report of work annexed hereto, having performed the work or witnessed same during and/or after its completion.
2. That the annexed report is true.

Dated May 17, 1979 Signature J.E. Rackley

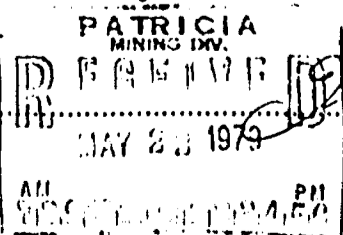

Pa. 436377

THE PENALTY FOR MAKING A FALSE STATEMENT IN THIS REPORT AND/OR CERTIFICATE IS \$500. OR SIX MONTHS IMPRISONMENT OR BOTH

30-15

Lomond Township
M-2251



A separate form is required for each type of work to be recorded.

80-21

30-15

THE MINING ACT REPORT OF WORK

To the Recorder of Sioux Lookout Mining Division

I, Selco Mining Corporation Limited T-190
name of Recorded Holder Prospector's Licence
55 University Avenue, Suite 1700, Toronto, Ontario M5J 2H7
Post Office Address

do hereby report the performance of 146 days of Diamond Drilling
type of work

not before reported to be applied on the following contiguous claims

Claim No.	Days	Claim No.	Days	Claim No.	Days
Pa 436377	40	Pa 436383	11		
Pa 436378	11	Pa 436384	40		
Pa 436379	11				
Pa 436380	11				
Pa 436381	11				
Pa 436382	11				

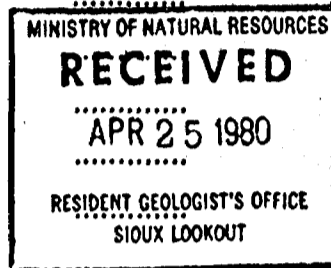

Pa 436381

All the work was performed on Mining Claim (s) Pa 436381
(In the case of geological and/or geophysical survey (s) where more than 18 claims are involved attach a schedule)

READ CAREFULLY: THE FOLLOWING INFORMATION IS REQUIRED BY THE MINING RECORDER.

- For Manual Work, Stripping or Opening up of Mines, Sinking Shafts or Other Actual Mining Operations - Names and addresses of the men who performed the work and the dates and hours of their employment.
- For Diamond and other Core Drilling - Footage, No. and angle of holes and diameter of core. Name and address of owner or operator of drill. Dates when drilling was done. Signed core log and sketch in duplicate.
- For Compressed Air or Other Power Driven or Mechanical Equipment
- Type of drill or equipment. Names and addresses of men engaged in operating equipment and the dates and hours of their employment.
- For Power Stripping - Type of equipment. Name and address of owner or operator. Amount expended. Dates on which work was done. Proof of actual cost must be submitted within 30 days of recording.
- With each of the above types of work sketches are required to show the location and extent of the work in relation to the nearest claim post. In the case of diamond or other core drilling the sketch must be submitted in duplicate.
- For Geophysical, Geological, Geochemical Surveys and Expenditure Credits - the name of author of report. Covering dates of survey (linecutting & office). Type of instrument used. Total amount of expenditure. Technical reports, maps, expenditure breakdown, receipts must be filed in duplicate with the Minister within 60 days of recording.
- For Land Survey - the name and address of Ontario Land surveyor.

The Required Information is as Follows: (Attach a list if this space is insufficient)

D.D.H.	TOTAL	REMAINING	USING	BEARING	DIP	CORE	DATES
30-15-1	285'	245'	146'	Grid S	-50°	AQ	27.03.79-29.03.79

CONTRACTOR: Amalgamated Drilling
R.R. #5,
Thunder Bay, Ontario

Balance for future use 99 days

Date March 26 80

J. E. Kraker
Signature of Recorded Holder or Agent

The Mining Act
Certificate Verifying Report of Work

I, A.P. Pryslak
P.O. Box 100, Cochenour, Ontario P0V 1L0
(Post Office Address)

hereby certify:

- That I have a personal and intimate knowledge of the facts set forth in the report of work annexed hereto, having performed the work or witnessed same during and/or after its completion.
- That the annexed report is true.

Dated March 20 19 80

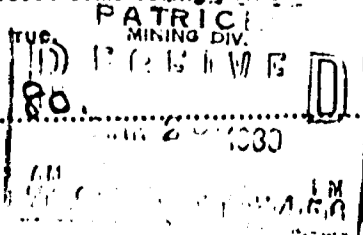

A.P. Pryslak
Signature

Pa. 436377

THE PENALTY FOR MAKING A FALSE STATEMENT IN THIS REPORT AND/OR CERTIFICATE IS \$500. OR SIX MONTHS IMPRISONMENT OR BOTH.

Yeat.
(25) 1979.
52 K/1 SW.

30-15



Ontario

THE MINING ACT REPORT OF WORK

LONDON IWI:
M-2251

A separate form is required for each type of work to be recorded.

80-25

To the Recorder of SIOUX LOOKOUT Mining Division
I, Selco Mining Corporation Limited T-190
name of Recorded Holder Prospector's Licence
55 University Avenue, Suite 1700, Toronto, Ontario M5J 2H7
Post Office Address

do hereby report the performance of 60 days of .. Diamond Drilling
not before reported to be applied on the following contiguous claims
type of work

Claim No.	Days	Claim No.	Days	Claim No.	Days
Pa 436378	10
Pa 436379	10
Pa 436380	10
Pa 436381	10
Pa 436382	10
Pa 436383	10

All the work was performed on Mining Claim (s) Pa 436381
(In the case of geological and/or geophysical survey (s) where more than 18 claims are involved attach a schedule)

READ CAREFULLY: THE FOLLOWING INFORMATION IS REQUIRED BY THE MINING RECORDER.

For Manual Work, Stripping or Opening up of Mines, Sinking Shafts or Other Actual Mining Operations - Names and addresses of the men who performed the work and the dates and hours of their employment.
For Diamond and other Core Drilling - Footage, No. and angle of holes and diameter of core. Name and address of owner or operator of drill. Dates when drilling was done. Signed core log and sketch in duplicate.
For Compressed Air or Other Power Driven or Mechanical Equipment
Type of drill or equipment. Names and addresses of men engaged in operating equipment and the dates and hours of their employment.
For Power Stripping - Type of equipment. Name and address of owner or operator. Amount expended. Dates on which work was done. Proof of actual cost must be submitted within 30 days of recording.
With each of the above types of work sketches are required to show the location and extent of the work in relation to the nearest claim post. In the case of diamond or other core drilling the sketch must be submitted in duplicate.
For Geophysical, Geological, Geochemical Surveys and Expenditure Credits - the name of author of report. Covering dates of survey (linecutting & office). Type of instrument used. Total amount of expenditure. Technical reports, maps, expenditure breakdown, receipts must be filed in duplicate with the Minister within 60 days of recording.
For Land Survey - the name and address of Ontario Land surveyor.

The Required Information is as Follows: (Attach a list if this space is insufficient)

D.D.H.	TOTAL	REMAINING	USING	BEARING	DIP	CORE	DATES
30-15-1	285'	99'	60'	Grid S	-50°	AQ	27.03.79-29.03.79

CONTRACTOR: Amalgamated Drilling
R.R. #5,
THUNDER BAY, Ontario

Reserve 99 days
Using 60
Balance 39 days

Date April 29. 80.
Signature of Recorded Holder or Agent

The Mining Act
Certificate Verifying Report of Work

I, A.P. Pryslak
..... P.O. Box 100, Cochenour, Ontario, POV 110
(Post Office Address)

hereby certify:
1. That I have a personal and intimate knowledge of the facts set forth in the report of work annexed hereto, having performed the work or witnessed same during and to its completion.
2. That the annexed report is true.

Dated April 25 19 80
Signature

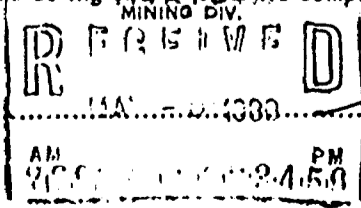

Pa 436377

THE PENALTY FOR MAKING A FALSE STATEMENT IN THIS REPORT AND/OR CERTIFICATE IS \$500. OR SIX MONTHS IMPRISONMENT OR BOTH

WHIPPER LAKE AREA M-2574

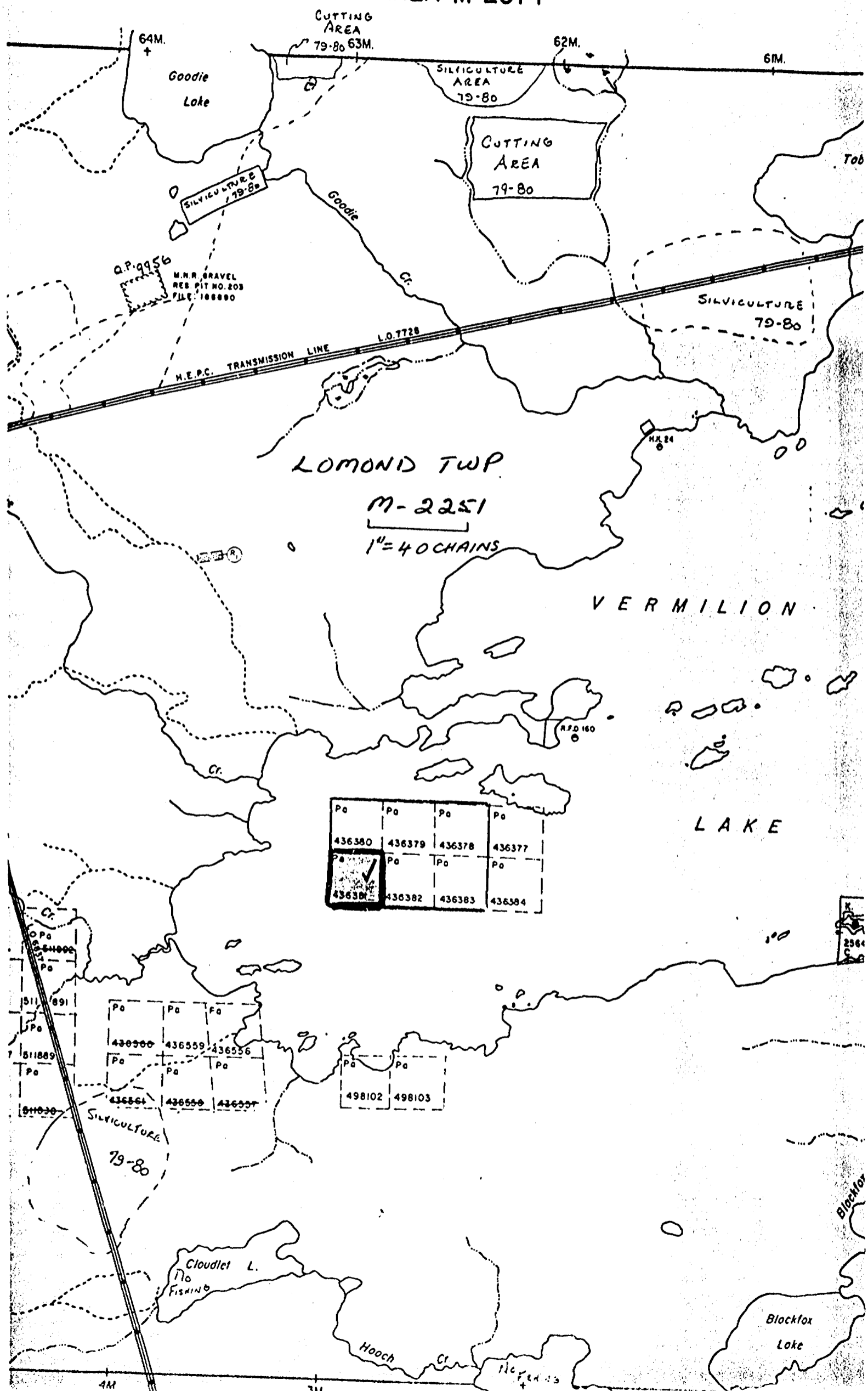

L O M O N D T W P
 M - 2 2 5 1
 1" = 4 0 C H A I N S

V E R M I L I O N
 L A K E

Pa	Pa	Pa	Pa
436380	436379	436378	436377
436381	436382	436383	436384

Pa	Pa	Pa
511889	436559	436556
511890	436558	436557

Pa	Pa
498102	498103

SILVICULTURE
 79-80

Cloudlet L.
 No Fishing

Blackfox
 Lake