

010

DIAMOND DRILLING

TOWNSHIP: LOMOND TWP.

REPORT NO: 22

WORK PERFORMED FOR: Donald E. Smith

RECORDED HOLDER: Same as Above [xx]
: Other []

<u>Claim No.</u>	<u>Hole No.</u>	<u>Footage</u>	<u>Date</u>	<u>Note</u>
Pa 1008296	13	307'	Feb/89	(1)

(1) W8903.061, date filed May/89



Complete this form and
related sketch in duplicate.

Fill in on
every page

Hole No. **13** Page No. **1**

5762N 12406W (1989 METRIC GRID)

Drilling Company LONGYEAR		Collar Elevation LAKE	Bearing of hole from true North	Total Footage 301'	Dip of Hole at Collar 90	Address/Location where core stored CAMP ON SOUTH SHORE OF VERMILION LAKE	Map Reference No.	Claim No. Pa 1008296
Date Hole Started FEB 18/89	Date Completed FEB 19/89	Date Logged FEB 19/89	Logged by W. RAINBATH		FL		Location (Twp., Lot, Con. or Lat. and Long.) LOMOND TWP.	Property Name
Exploration Co., Owner or Optionee ACADIA MINERAL VENTURES LTD.		Date Submitted MAR 14/89	Submitted by (Signature) <i>W. Rainbath</i>		FL			
					FL			

Footage		Rock Type	Description Colour, grain size, texture, minerals, alteration, etc.	Planar Feature Angle *	Core Specimen Footage †	Your Sample No.	Sample Footage		Sample Length	Rpb Ass	Assays †	
From	To						From	To				
0	52	CASING	Water - 25' core - 27'			6543	83	87	4'	NIL		
						6564	154	156	2'	NIL		
52	131	QUARTZ PORPHYRY	Pink, medium grained, sheared @ 40°/CA, Sincate alteration, quartz eyes up to 1/2". 83-87 - Fault zone, rusty, brecciated, contorted, crumbly, some quartz veining with pyrite Gouge @ 86			6565	161	165	4'	NIL		
						6566	171	176	5'	NIL		
						6567	182	184	2'	NIL		
						6568	197	199	2'	NIL		
						6569	211	212	1'	NIL		
131	213	AGGLOMERATE & TUFF BEDS	Pink alteration, bedding @ 45°/CA 154-155 - High pyrite 155 - 1/2" quartz vein fills fault (?) 197-199 - Contorted fractured, quartz-tourmaline-pyrite. 161-165 - Quartz-tourmaline-pyrite. 171-176 " 182-184 " 211-212 "			6570	231	232	1'	NIL		
						6571	242.5	244.5	2'	NIL		
						6572	260.5	261.5	1'	NIL		
213	301	AGGLOMERATE & TUFF BEDS	Relatively unaltered, colour of beds varies - white, pink, red, green, light and dark grey. @ 40°/CA 230-232 - Fault zone, quartz-tourmaline-pyrite 231.5 - Gouge. 242.5-244.5 - Quartz-tourmaline-pyrite 260.5-261.5 - "									



Ontario
Ass LIB.

Mining Ac

Name and Postal Address of Recorded Holder
DONALD E. SMITH
149 GRAND RIVER BLVD. SCARBOROUGH, ONT. M1B 1G1
 Inspector's License No. **B 20899 Lomond**
Vermilion

Summary of Work Performance and Distribution of Credits **VERMILION TWP. G-2887 & LOMOND TWP. G-2876**

Total Work Days Cr. claimed 2782	Mining Claim			Mining Claim			Mining Claim		
	Prefix	Number	Work Days Cr.	Prefix	Number	Work Days Cr.	Prefix	Number	Work Days Cr.
For Performance of the following work. (Check one only) <input type="checkbox"/> Manual Work <input type="checkbox"/> Shaft Sinking Drifting or other Lateral Work. <input type="checkbox"/> Compressed Air, other Power driven or mechanical equip. <input type="checkbox"/> Power Stripping <input checked="" type="checkbox"/> Diamond or other Core drilling <input type="checkbox"/> Land Survey	Pa	720390	22	Pa	1003136	140	Pa	1003144	20
		720391	60		1003137	20		1003145	20
		720394	60		1003138	40		1003146	20
		720405	60		1003139	20		1003147	20
		720407	60		1003140	20		1003148	20
		720409	60		1003141	20		1003149	20
		1003134	120		1003142	20		1003150	20
		1003135	140		1003143	20		1003151	20

All the work was performed on Mining Claim(s): **Pa 720390, 720392, 720393, 720404, 1003133, 1003136**

Required Information eg: type of equipment, Names, Addresses, etc. (See Table Below)

LOUGHEAR CANADA INC.
 P.O. Box 330
 NORTH BAY, ONT
 P1B 8H6
 6 HOLES - 2782' B9

DATE OF DRILLING:
FEB 6/89 - FEB 23/89

R. Majors
 RECORDED

ONTARIO GEOLOGICAL SURVEY
 ASSESSMENT FILES
 OFFICE
 MAR 28 1989
 RECEIVED

RECEIVED
 MAR 17 1989
 PATRICIA MINING
 DIVISION

Date of Report: **MAR 14/89**
 Recorded Holder or Agent (Signature): **W. Lawrence**

Certification Verifying Report of Work

I hereby certify that I have a personal and intimate knowledge of the facts set forth in the Report of Work annexed hereto, having performed the work or witnessed same during and/or after its completion and the annexed report is true.

Name and Postal Address of Person Certifying
W. LAWRENCE 1405-52 MARBELLE AVE.
TORONTO, ONT M9A 4X9

Date Certified: **MAR 14/89**
 Certified by (Signature): **W. Lawrence**

Table of Information/Attachments Required by the Mining Recorder

Type of Work	Specific information per type	Other Information (Common to 2 or more types)	Attachments
Manual Work	Nil	Names and addresses of men who performed manual work/operated equipment, together with dates and hours of employment.	Work Sketch: these are required to show the location and extent of work in relation to the nearest claim post.
Shaft Sinking, Drifting or other Lateral Work			
Compressed air, other power driven or mechanical equip.	Type of equipment	Names and addresses of owner or operator together with dates when drilling/stripping	
Power Stripping	Type of equipment and amount expended. Note: Proof of actual cost must be submitted within 30 days of recording.		

1003152	20
1003153	20
1003154	20
1003155	20
1003156	20
1003157	20
1003158	20
1003159	20
1003160	20
1008257	40
1008258	40
1008259	40
1008261	40
1008262	40
1008263	40
1008264	40
1008291	80
1008292	80
1008293	80
1008294	80
1008295	80
1008296	80
1008297	80
1008298	80
1008299	80
1008300	80
1008301	80
1008302	80
1008303	40
1008304	40
1008305	40
1008306	40
1008307	40
1008308	40
1008309	20
1008310	20



MARIA/BO - *[Signature]*

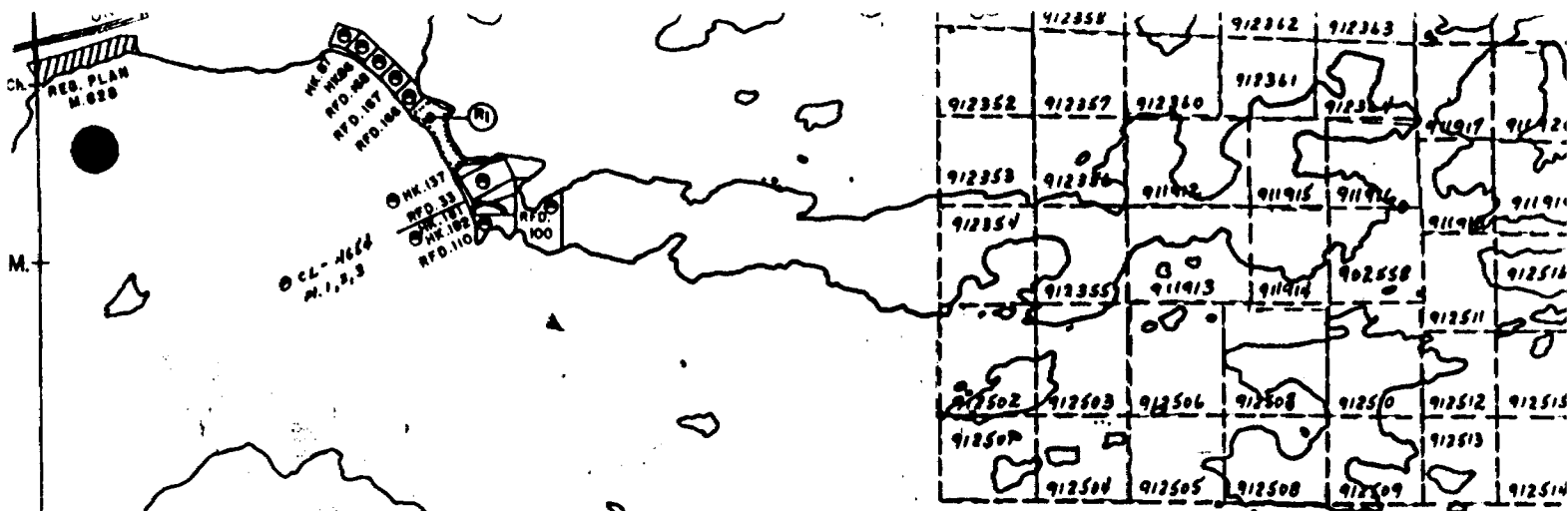

Sheridan Sup.
G 2887

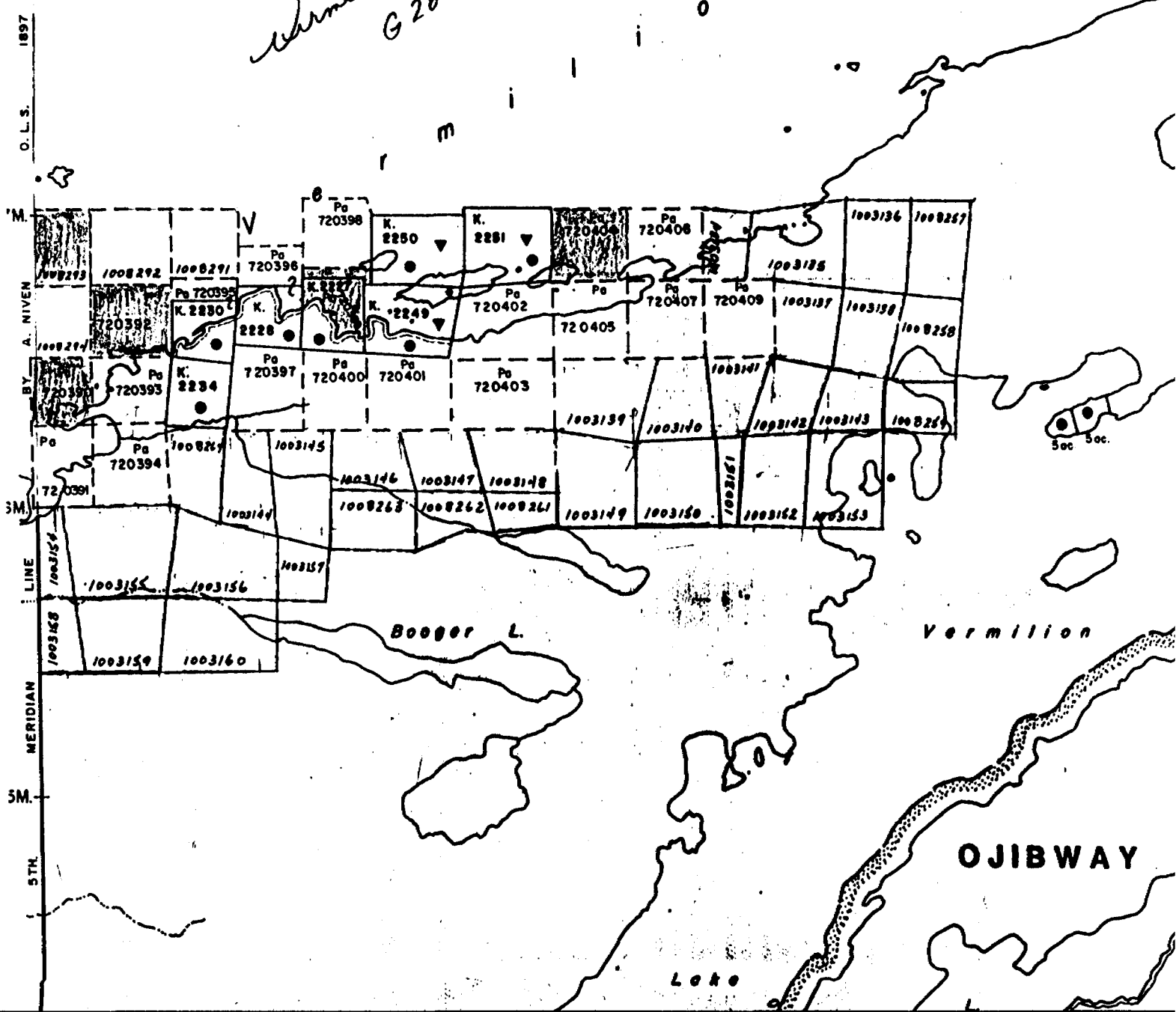

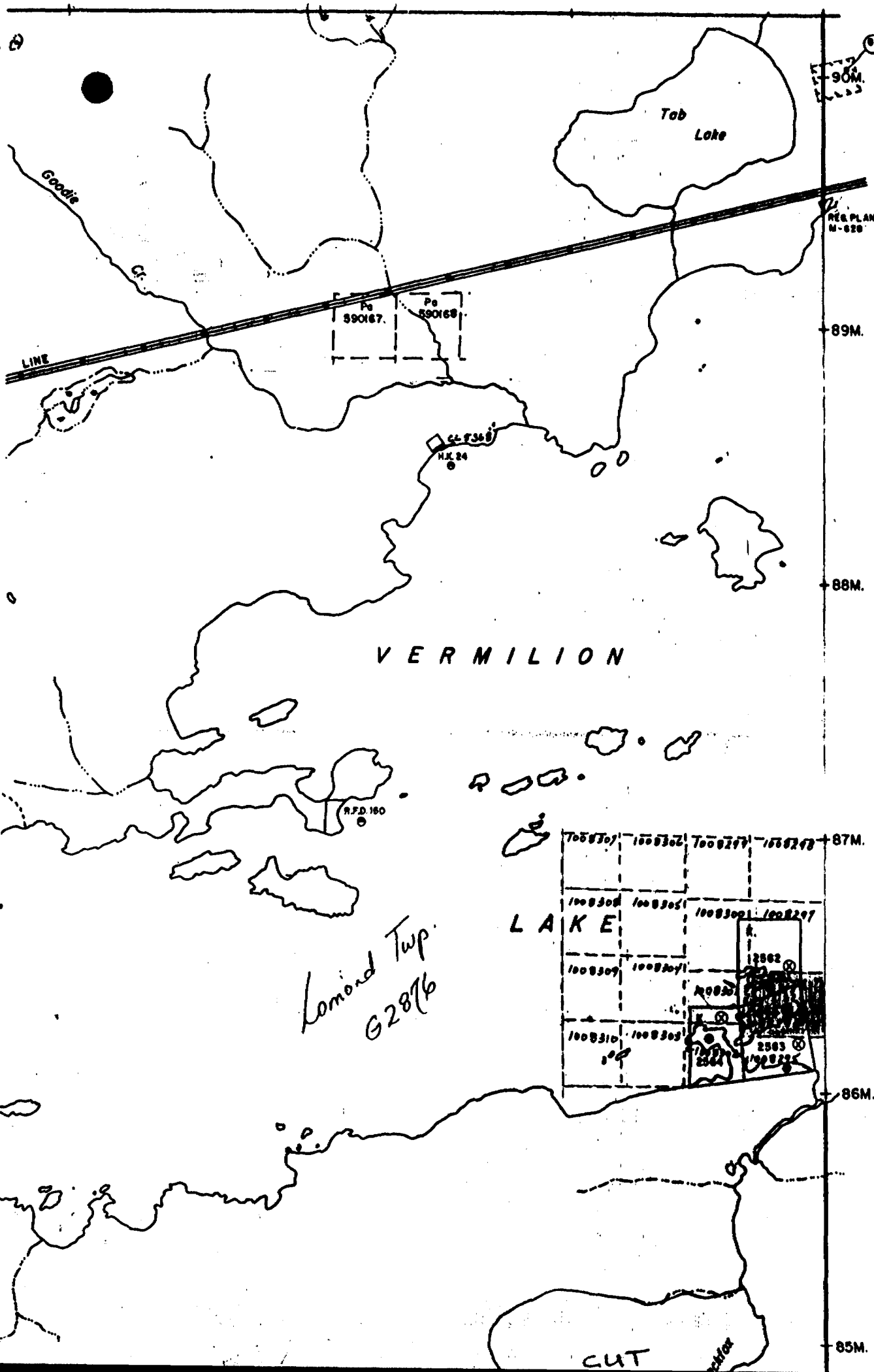

VERMILION TWP. 6-2887

*Lomond Twp.
G2876*

REG. PLAN
M-620

89M.

88M.

87M.

86M.

85M.

VERMILION

LAKE

1008307	1008306	1008305	1008304
1008308	1008307	1008306	1008305
1008309	1008308	1008307	1008306
1008310	1008309	1008308	1008307

Pa
590167

Pa
590168

St. F368
H.K. 24

R.F.D. 100

Tab
Lake

Goodie
Cr.

LINE

CUT

90M.