



52K01SW9004 21 LOMOND

010

DIAMOND DRILLING

TOWNSHIP: Lomond

REPORT No.: 21

WORK PERFORMED BY: Nahanni Mines Ltd.

<u>CLAIM No.</u>	<u>HOLE No.</u>	<u>FOOTAGE</u>	<u>DATE</u>	<u>NOTE</u>
PA 590167	G-83-1	353	Nov/83	(1)
<hr/>				
TOTAL:	1DH	353 FT		

NOTES: (1) #88-84

Contractor: Kenora Diamond Drilling  
Kenora, Ontario

# NAHANNI MINES LTD.

DEPTH		DIP		INCLINATION TESTS	
DEPTH	DIP	DEPTH	DIP	DEPTH	DIP
COLLAR	-60°				
353'	-60°				

**HOLE NO:** G-83-1

**LOCATION:** L300W    **GRID:** 100N    Goodie Creek Group  
**LENGTH:** 353.0'    **HORIZ:**    **VERT:**    **AZIMUTH:** Grid    **CORE SIZE:** BQ  
**RECOVERY:** 100%    **LOGGED BY:** K. Guy, B.A.Sc.    **DATE:** November, 1983

**PROJECT:** Lookout  
**STARTED:** Nov. 6, 1983  
**FINISHED:** Nov. 8, 1983  
**Claim:** Pa-590167-    - Lomond Twp.

FROM	TO	LITHOLOGY AND ALTERATION	MINERALIZATION-STRUCTURES	ANALYTICAL RESULTS														
				SAMPLE	FROM	TO	LENGTH (feet)	Cu (ppm)	Zn (ppm)	Ag (ppm)	Gold oz/ton							
0	81.0	CASING - OVERBURDEN - clay, sand																
81.0	86.4	OXIDE IRON FORMATION - CONDUCTOR - well bedded at 60° to C.A. - magnetite, chert, tuff beds - magnetite has tr. py, conductive - beds are very thin to 1/2" thick and distinctly laminated - slightly carbonatized		2722	83.0	86.4	3.4											Nil
86.4	90.0	MAFIC TUFF - fine grained - green colour - chlorite, sericite - talcose, carbonatized																
90.0	130.0	MAFIC TUFF BRECCIA - composed mainly of fragments of varying size up to 2" - fragments are plagioclase, chlorite, quartz - fragments are sericitic, highly carbonatized - density of fragments decrease down hole - fragments less altered down hole - more plagioclase chlorite rich - tr py, so, cpy usually associated with fragments																
130.0	159.5	MAFIC TUFF - as Tuff Breccia above but no fragments - greenish colour, chloritic - fine to medium grained - massive texture - carbonatized																

FATRICIA MINING CO.  
10 E GLEVE RD  
JUN 2 1984  
A.T.    P.M.  
7:8,9,10,11,12,1,2,3,4,5,6

# NAHANNI MINES LTD.

PROJECT: Lookout

HOLE NO.: G-83-1

PAGE 2 of 3

FROM	TO	LITHOLOGY AND ALTERATION	MINERALIZATION-STRUCTURES	SAMPLE	FROM	TO	LENGTH (feet)	ANALYTICAL RESULTS				
								Cu (ppm)	Zn (ppm)	Ag (ppm)	Gold oz/ton	
159.5	168.0	OXIDE IRON FORMATION - CONDUCTOR - banded iron formation - chert, magnetite - magnetite bands are conductive - occasional po bands and stringers with tr cpy - bedded at 65-70° to C.A. - carbonatized		2723	159.5	164.0	4.5					Nil
168.0	175.0	CHERT, CHERTY TUFF and SULPHIDES - CONDUCTOR - very well bedded units at 65-70° to C.A. - sulphides are mainly po - beds are up to 1" thick - sulphides are as laminations and as stringers - very fine grained units		2724	169.5	173.3	3.8					Nil
175.0	183.3	CHERT and FELSIC TUFF - very well bedded at 70° to C.A. - as above but no sulphides										
183.3	191.0	CHERT, CHERTY TUFF and SULPHIDES - CONDUCTOR - as before		2725	186.5	188.5	2.0					0.03
191.0	195.8	GRAPHITIC ARGILLITE and PYRRHOTITE - CONDUCTOR - very fine grained, black colour - massive texture - po laminated and as stringers - carbonatized										
195.8	205.5	CHERT, FELSIC TUFF and PYRRHOTITE - CONDUCTOR - well bedded units at 70° to C.A. - very fine grained - beds are up to 1" thick - po it in laminated beds - occasional argillaceous sections with po as stringers		2726	196.5	200.0	3.5					0.02
				2727	203.0	205.5	2.5					TR

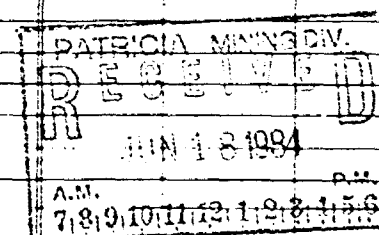

# NAHANNI MINES LTD.

PROJECT: Lookout

HOLE NO.: G-83-1

PAGE 3 of 3

FROM	TO	LITHOLOGY AND ALTERATION	MINERALIZATION-STRUCTURES	ANALYTICAL RESULTS							
				SAMPLE	FROM	TO	LENGTH (feet)	Cu (ppm)	Zn (ppm)	Ag (ppm)	Gold oz/ton
205.5	243.0	CARBONATIZED MAFIC TUFF - grey colour - fine to medium grained - very highly carbonatized - carbonate disseminated throughout and as carbonate stringers - sericitic, talcose - tr py		2728	215.0	217.8	3.8				TR
243.0	245.5	ARGILLITE - GRAPHITE, py - CONDUCTOR - very fine grained, black colour, massive - py as fine laminations - carbonatized - tr cpy		2729	243.0	246.0	3.0				TR
245.5	353.0	MAFIC FLOW - fine to medium grained - grey-green colour - massive texture - highly carbonatized to 300" with decreasing carbonate content down hole - occasional quartz-carbonate veins with tr py, po, cpy		2730	262.5	265.0	2.5				Nil
				2731	318.5	321.5	3.0				Nil
	353.0	END OF HOLE									

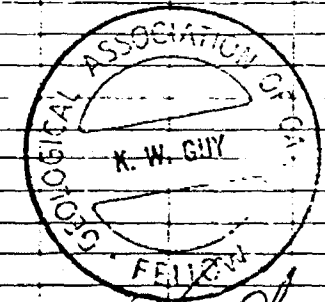

*Handwritten signature*

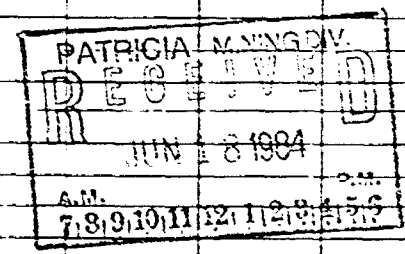

(H.E.P.C)

Electric Transmission Line

Claim Posts

Pa- 590167

Pa- 590,168



(-60°) G-83-1

L-353'

- Base Line -

L-4W

L-3W

L-2W

Pa- 590170

Pa- 590169

- DRILL HOLE LOCATION -

NAHANNI MINES LTD.  
LOMOND TWP. - PATRICIA M.D.

SCALE - 1:2500

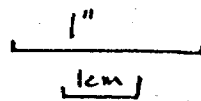

- Nov. 1983 -



900

LAKE AREA M-2574

Lomond Township  
M-2251

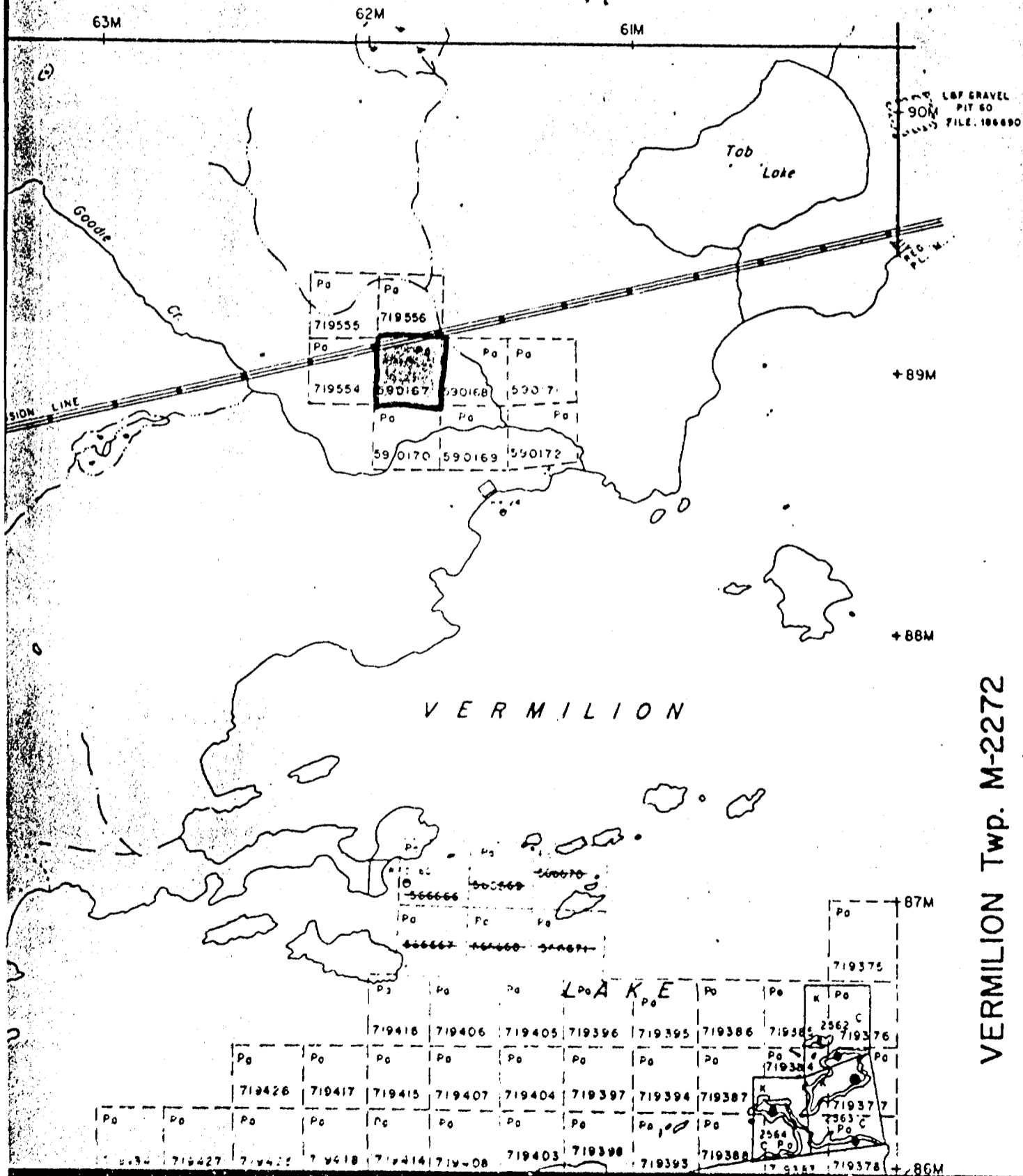

VERMILION TWP. M-2272

# WHIPPER LAKE AREA M-2574

McILRAITH Twp. M-1852

VERMILION Twp. M-2272

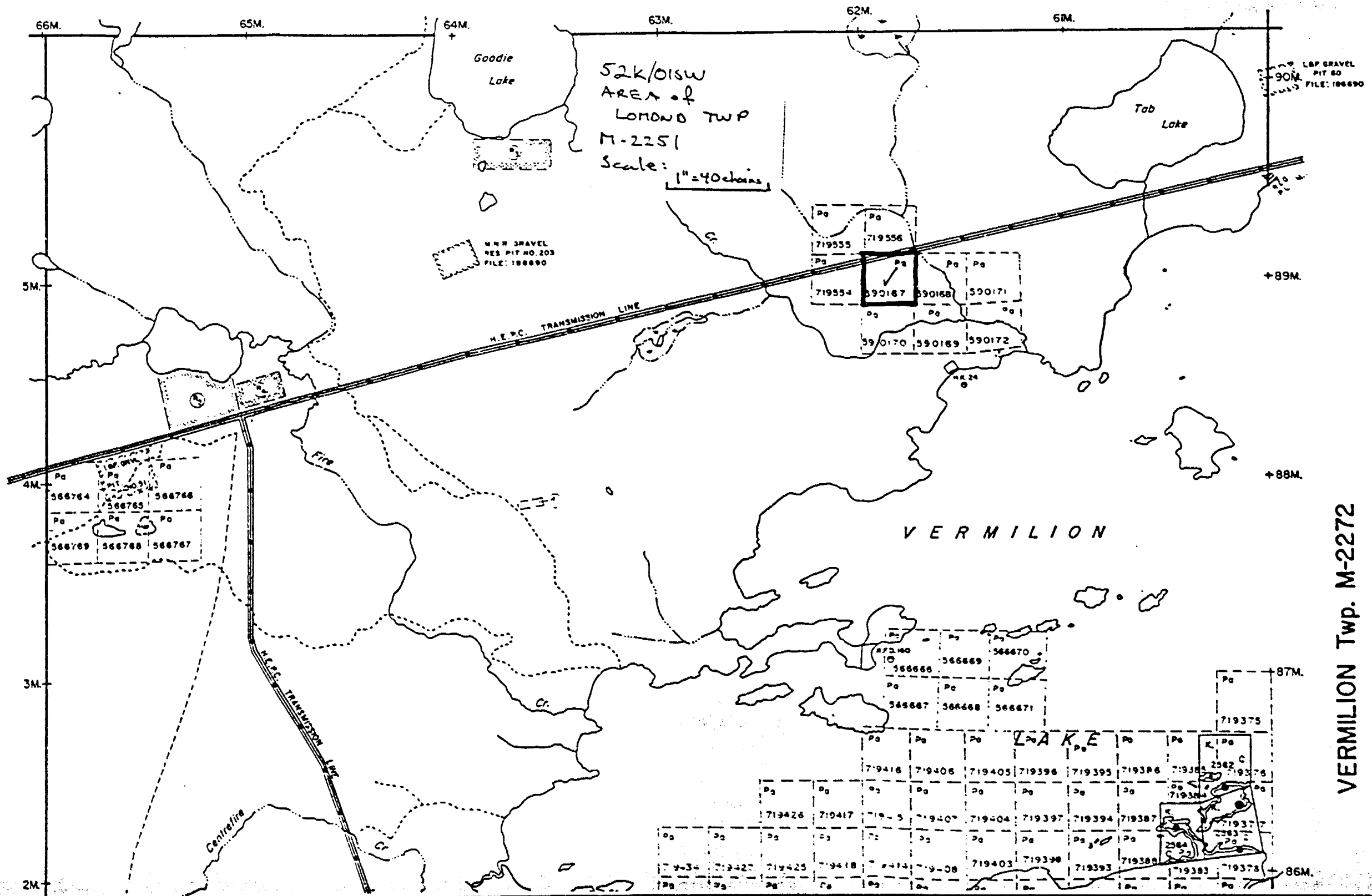

400' su  
lakes a

S.R. - SURFACE  
Order No  
w. C2/79  
w. 3/80  
w. 57/82  
w. 55/82

PATENT  
PATENT  
LEASE  
LICENS  
CROWN  
LOCATE  
CANCE  
MINING  
SURFACE  
HIGHWA  
ROADS  
TRAILS  
RAILWA  
POWER  
MADCU



Ministry of Natural Resources

Report of Work

Comond Township M-2251

Instructions

Supply required data on a separate form for each type of work to be recorded (see table below). For Geo-technical work use form no. 1362 "Report of Work (Geological, Geophysical, Geochemical and Expenditures)".

#84-88

Assess. Lib.

The Mining Act

Name and Postal Address of Recorded Holder <b>Nahanni Mines Limited</b> 330 Bay Street, Suite 1107, Toronto, Ontario M5H 2S8	Prospector's Licence No. <b>T-951</b>
--	--

Summary of Work Performance and Distribution of Credits

Total Work Days Cr. claimed <b>353</b>	Mining Claim			Mining Claim			Mining Claim		
	Prefix	Number	Work Days Cr.	Prefix	Number	Work Days Cr.	Prefix	Number	Work Days Cr.
for Performance of the following work. (Check one only)	See Schedule "A" attached for distribution of credits on all 9 contiguous claims.								
<input type="checkbox"/> Manual Work									
<input type="checkbox"/> Shaft Sinking, Drifting or other Lateral Work.									
<input type="checkbox"/> Compressed Air, other Power driven or mechanical equip.									
<input type="checkbox"/> Power Stripping									
<input checked="" type="checkbox"/> Diamond or other Core drilling									
<input type="checkbox"/> Land Survey									

All the work was performed on Mining Claim(s): **Pa-590167**

Required Information eg: type of equipment, Names, Addresses, etc. (See Table Below)

One drill hole (G-83-1) drilled on claim Pa-590167 using BQ Wireline equipment (1.5 inch diameter core) was completed at a depth of 353 feet in the period November 6, 1983 to November 8, 1983/

Contractor: Kenora Diamond Drilling  
Kenora, Ontario

ONTARIO GEOLOGICAL SURVEY  
ASSESSMENT FILES  
RESEARCH OFFICE  
SEP 17 1984  
RECEIVED

PATRICIA MINING DIV.  
RECEIVED  
JUN 18 1984  
A.M. 7 8 9 10 11 12 1 2 3 4 5 6 P.M.

*Recorded*  
*J. A. Harquail*

*Pa. 590167*

Date of Report <b>June 15, 1984</b>	Recorded by Agent (Signature) <i>J. A. Harquail</i>
--	--

Certification Verifying Report of Work  
I hereby certify that I have a personal and intimate knowledge of the facts set forth in the Report of Work annexed hereto, having performed the work or witnessed same during and/or after its completion and the annexed report is true.

Name and Postal Address of Person Certifying <b>J. A. Harquail, P.Eng., Consulting Engineer, 330 Bay St., Suite 1107, Toronto, Ontario</b>	Date Certified <b>June 15, 1984</b>	Certified by (Signature) <i>J. A. Harquail</i>
---	--	---

Table of Information/Attachments Required by the Mining Recorder

Type of Work	Specific Information per type	Other Information (Common to 2 or more types)	Attachments
Manual Work	Nil	Names and addresses of men who performed manual work/operated equipment, together with dates and hours of employment.	Work Sketch: these are required to show the location and extent of work in relation to the nearest claims post.
Shaft Sinking, Drifting or other Lateral Work			
Compressed air, other power driven or mechanical equip.	Type of equipment	Names and addresses of owner or operator together with dates when drilling/stripping done.	
Power Stripping	Type of equipment and amount expended. Note: Proof of actual cost must be submitted within 30 days of recording.		
Diamond or other core drilling	Signed core log showing; footage, diameter of core, number and angles of holes.	Nil	Work Sketch (as above) in duplicate
Land Survey	Name and address of Ontario land surveyor.		Nil



SCHEDULE "A"

NAHANNI MINES LIMITED (Lic. No. T-951)

Lomond Township  
Patricia Mining Division

Total of 9 Contiguous Claims all recorded as to 100% Interest  
in the name of Nahanni Mines Limited

<u>Claim No.</u>	<u>Date Recorded</u>	<u>Current Lapse Date</u>	<u>Total Days Recorded</u>	<u>Days Requested</u>	<u>New Lapse Date</u>	<u>Total Days</u>
Pa-590167	Jun 4/82	Jun 4/85	80	120	Jun 4/88	200
590168	" "	" "	60	140	" "	200
590169	" "	" "	75	-	Jun 4/85	75
590170	Jun 7/82	Jun 7/85	80	20	Jun 7/86	100
590171	" "	" "	80	73	Jun 7/87	153
590172	" "	" "	80	-	Jun 7/85	80
719554	Oct <del>29</del> /83	Oct <del>29</del> /84	-	-	Oct <del>29</del> /84	-
719555	" <del>31</del> "	" <del>31</del> "	-	-	" <del>31</del> "	-
719556	" "	" "	-	-	" "	-

