

Stan A Wilkins

contract staking & line cutting

Box 816
Stouxt Lookout, Ont.

Phone 737-2417
Area Code 807

S.A. Wilkins S.A. WILKINS

March 18	- 1971	10 hrs (12 hrs)	2 days	2 DAYS
" 19	"	"	2 days	"
" 20	"	"	2 days	"
" 22	"	"	2 days	"
" 23	"	"	2 days	"
" 29	"	"	2 days	"
" 30	"	"	2 days	"
April 5	"	"	2 days	"
" 6	"	"	2 days	"
" 7	"	"	2 days	"
" 8	"	"	2 days	"
			<hr/>	<hr/>
			22 days	22 DAYS.



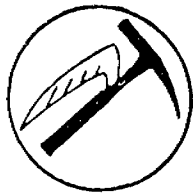

Stan A Wilkins

contract staking & line cutting

Box 816
Sloux Lookout, Ont.

Phone 737-2417
Area Code 807

Marcelle Lacasse
M. LACASSE

MARCH	18 - 1972	-	12 hrs (12 hrs)	-	2 days	2 DAYS
"	18 - 1972	-	"	-	2 days	"
"	19 - "	-	"	-	2 days	"
"	22 - "	-	"	-	2 days	"
"	23 - "	-	"	-	2 days	"
"	29 - "	-	"	-	2 days	"
"	30 - "	-	"	-	2 days	"
April	5 - "	-	"	-	2 days	"
"	6 - "	-	"	-	2 days	"
"	7 - "	-	"	-	2 days	"
"	8 - "	-	"	-	2 days	"

20 days

20 DAYS.





Stan A Wilkins

contract staking & line cutting

Box 816
Stoux Lookout, Ont.

Phone 737-2417
Area Code 807

Darnet Ezuidata -
Gr. Czandata

March 20-1972	-	12 hrs	12 hrs.	-	2 days	2 DAYS
" 21 "	-	"			2 days	"
" 27 "	-	"			2 days	"
" 28 "	-	"			2 days	"
April 4 "	-	"			2 days	"
" 5 "	-	"			2 days	"
<hr/>						
12 days						12 DAYS.

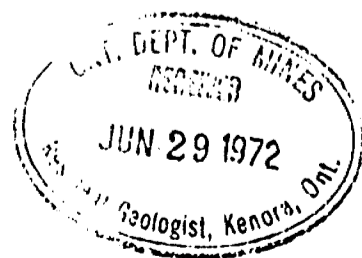

GROUP SKETCH OF CLAIMS LISTED ON PAGE 1

SCALE: 1 inch = 1320 feet (20 chains)

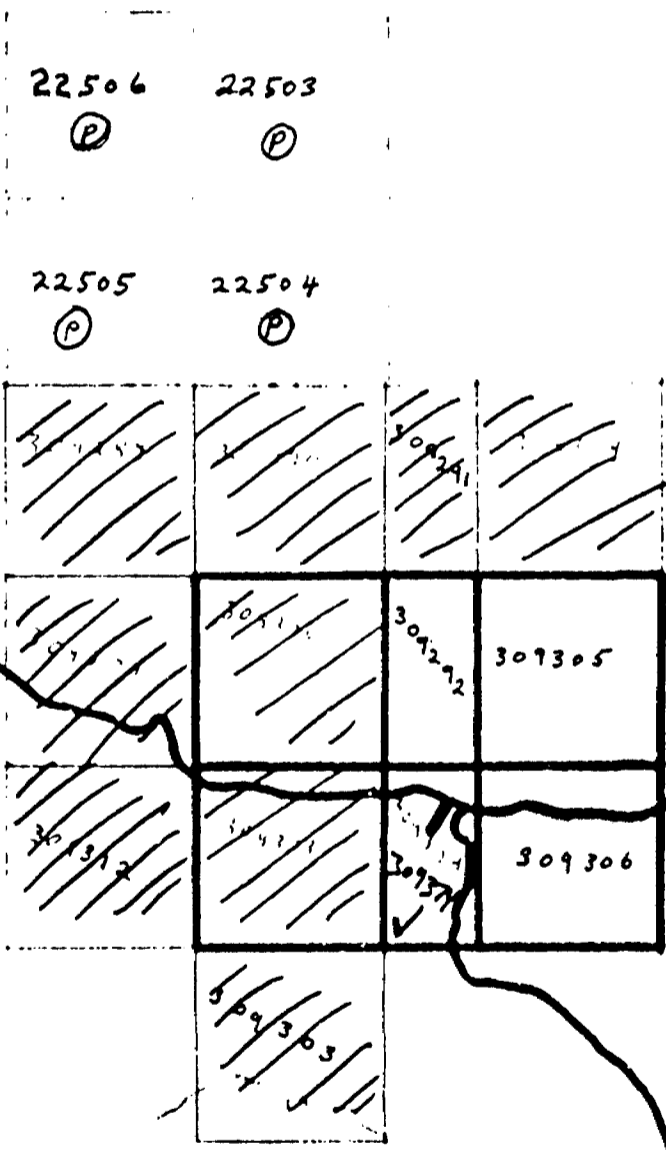
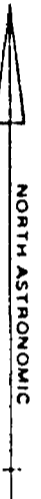

TAB LAKE



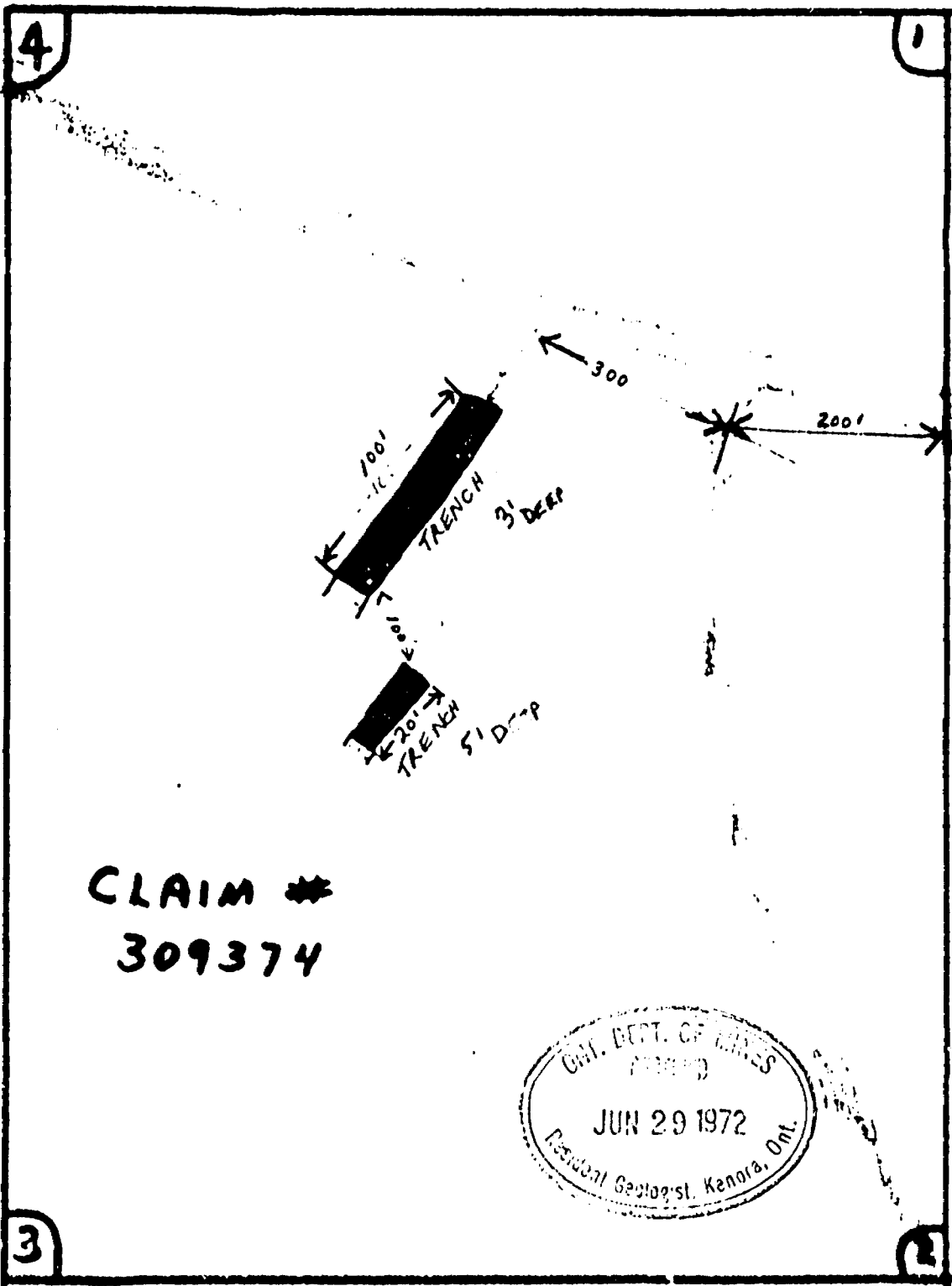

CLAIM #
309374

ONT. DEPT. OF MINES
JUN 29 1972
Resident Geologist, Kenora, Ont.



52K01SW9142 52K01SW0030C1 WHIPPER LAKE

WHIPPER LAKE

M. 2574

020



#98

A separate form is required for each type of work to be recorded

THE MINING ACT REPORT OF WORK

To the Recorder of PATRICIA Mining Division

I, STANLEY A. WILKINS name of Recorded Holder 5-2815 Miner's Licence

Box 322 SMOKE LOOKOUT ONT Post Office Address MECH. EQUIPMENT type of work

do hereby report the performance of 36 days of work not before reported to be applied on the following contiguous claims

Table with 6 columns: Claim No., Days, Claim No., Days, Claim No., Days. Contains entries for claims 309292, 309305, 309306, and 309374.

All the work was performed on Mining Claim (s) 309374 (In the case of geological and/or geophysical survey (s) where more than 18 claims are involved attach a schedule)

READ CAREFULLY: THE FOLLOWING INFORMATION IS REQUIRED BY THE MINING RECORDER:

- For Manual Work, Stripping or Opening up of Mines, Sinking Shafts or Other Actual Mining Operations - Names and addresses of the men who performed the work and the dates and hours of their employment.
For Diamond and other Core Drilling - Footage, No. and angle of holes and diameter of core. Name and address of owner or operator of drill. Dates when drilling was done. Signed core log and sketch in duplicate.
For Compressed Air or Other Power Driven or Mechanical Equipment Type of drill or equipment. Names and addresses of men engaged in operating equipment and the dates and hours of their employment.
For Power Stripping - Type of equipment. Name and address of owner or operator. Amount expended. Dates on which work was done. Proof of actual cost must be submitted within 30 days of recording.
With each of the above types of work sketches are required to show the location and extent of the work in relation to the nearest claim post. In the case of diamond or other core drilling the sketch must be submitted in duplicate.
For Geophysical, Geological, Geochemical Surveys and Expenditure Credits - the name of author of report. Covering dates of survey (linecutting & office). Type of instrument used. Total amount of expenditure. Technical reports, maps, expenditure breakdown, receipts must be filed in duplicate with the Minister within 60 days of recording.
For Land Survey - the name and address of Ontario Land surveyor.

The Required Information is as Follows: (Attach a list if this space is insufficient)

- EQUIPMENT - ATLAS COBO - COBRA - W.M. THOMPSON OWNER
OPERATOR - W.M. THOMPSON - 20 days
- S.A. WILKINS - 16 days

Date JUN 17/72 Signature of Stanley A. Wilkins

The Mining Act Certificate Verifying Report of Work

I, STANLEY A. WILKINS Box 322 - SMOKE LOOKOUT ONT (Post Office Address)

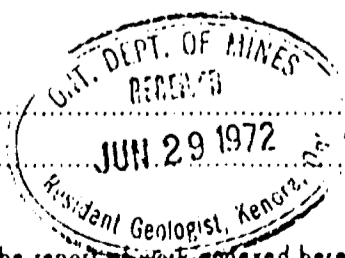

- hereby certify: 1. That I have a personal and intimate knowledge of the facts set forth in the report of work annexed hereto, having performed the work or witnessed same during and/or after its completion 2. That the annexed report is true.

Dated JUN 25/72 PATRICIA MINING DIV Signature Stanley A. Wilkins No. 309289

THE PENALTY FOR MAKING A FALSE STATEMENT IN THIS REPORT AND/OR CERTIFICATE IS \$500. OR SIX MONTHS IMPRISONMENT OR BOTH



Stan A Wilkins

contract staking & line cutting

Box 816
Sioux Lookout, Ont.

1194
Phone 737-~~2227~~
Area Code 807

Equipment - Atlas Copes - Babra.
ATLAS COPE? - COBRA

Operator - W.M. Thompson - Sioux Lookout.
OPERATOR W.M. THOMPSON - SIOUX LOOKOUT.

March	20	-1971	-	12 hrs	-	4 days
"	21	"	"	"	-	4 days
"	27	"	"	"	-	4 days
"	28	"	"	"	-	4 days
April	4	"	"	"		4 days
						<hr/>
						20 days



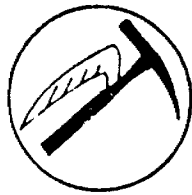

Star A Wilkins

contract staking & line cutting

Box 816
Sloux Lookout, Ont.

1194
Phone 737-~~8~~
Area Code 807

Equipment - Atlas Copac - Cobra.
ATLAS COPCO - COBEA

Operator - Star A Wilkins - Sloux Lookout.
S. A. WILKIN - S.L.

April 3 - 1971	12 hrs	4 days
" 5 - "	"	4 days
" 6 "	"	4 days
" 7 "	"	4 days
		<hr/>
		16 days



GROUP SKETCH OF CLAIMS LISTED ON PAGE 1

SCALE 1 inch = 1320 feet
(20 chains)



22506 (P) 22507 (P)

22505 (P) 22504 (P)

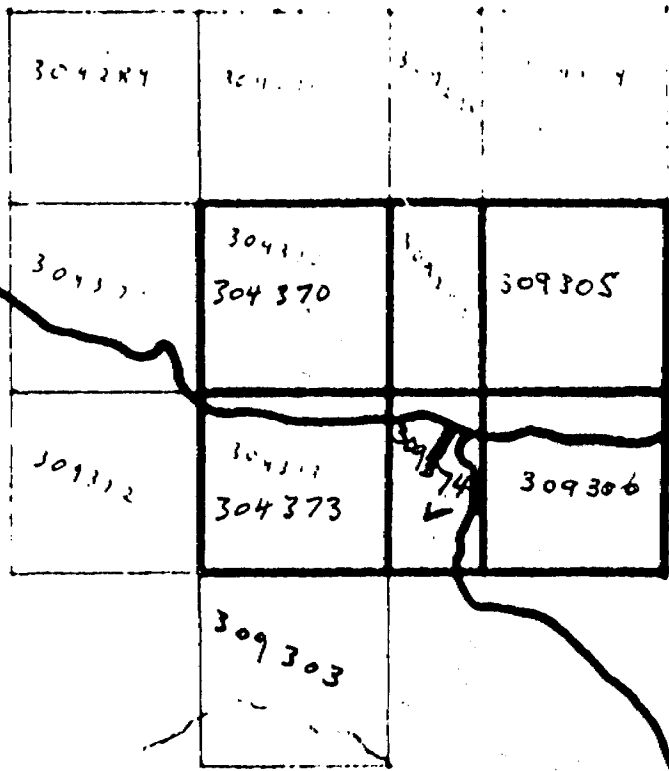

TAILS LAKE



11400 11400

MANUAL LABOUR - 120'
MANUAL LABOUR - 120'

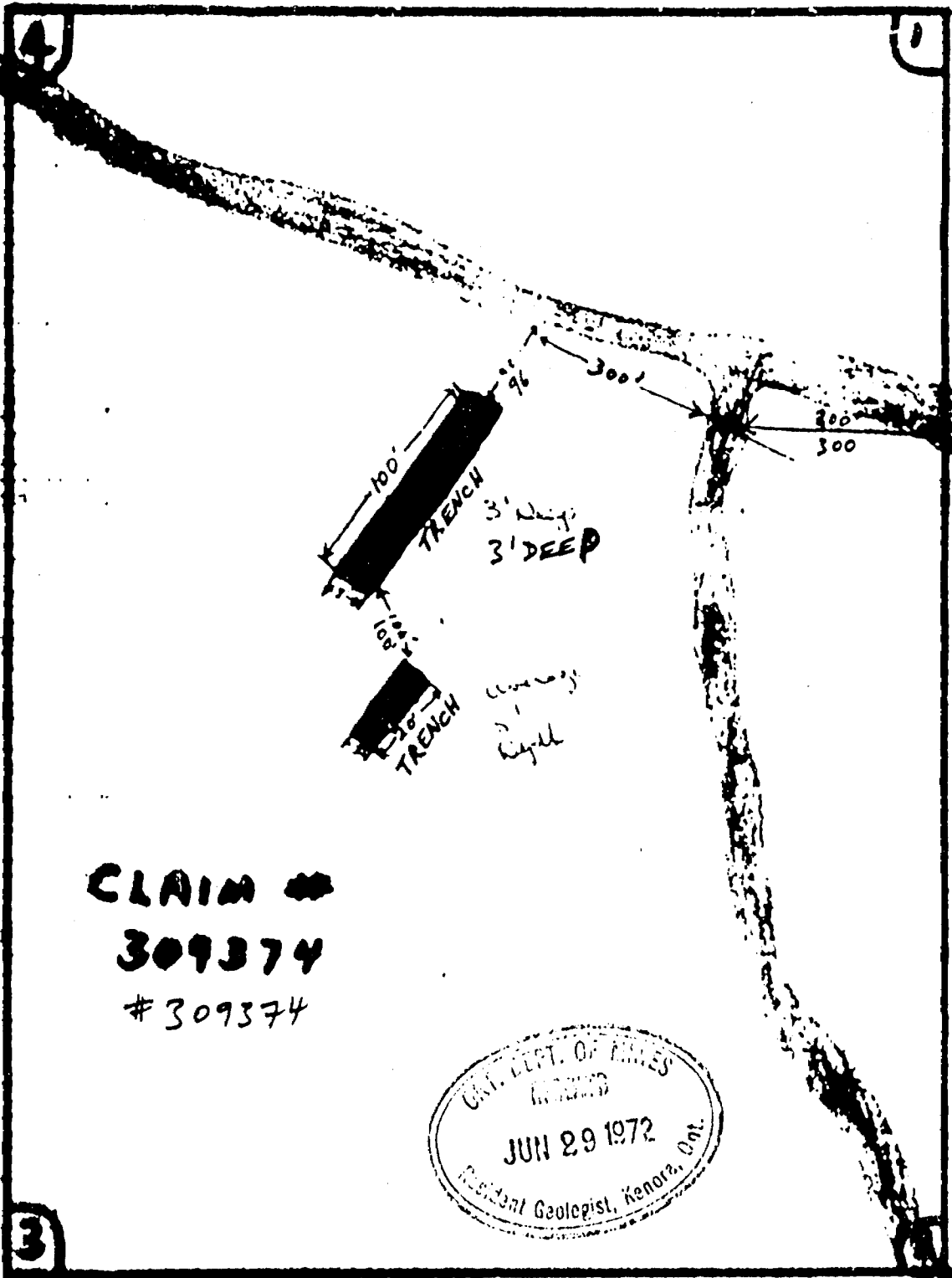

CLAIM #
309374
#309374

ONT. DEPT. OF MINES
JUN 29 1972
Resident Geologist, Kenora, Ont.

PATRIC
MILLS DIV
3
1972