



COLD SPRING

Quarriers and fabricators of building stone and memorialization products.

COLD SPRING GRANITE COMPANY, 202 South Third Avenue, Cold Spring, MN 56320 USA
800-328-5040 320-685-3621 Fax 320-685-8490

2.18101

The purpose of this assessment work was to open up another area or ledge to quarry from. Having two or more opened ledges is a common practice with drive in style quarries, it allows for more flexibility to perform different quarrying functions at the same time. The assessment work was performed on claim # 1149700 (formerly claim # 1160896).

The work that was performed was stripping two areas of overburden. The two areas are located approximately 400 feet south of the existing working quarry on either side of the access road. The first area is located on the west side of the quarry access road and is approximately 15 feet wide by 50 feet long by 14 feet deep, reference sketch #1. The overburden was piled on the west side of the excavation. Some exposed ledge was visible at this location. The stone appeared to have the same color and crystal pattern as the initial quarry area. The second area is located on the east side of the quarry road and is approximately 50 feet wide by 50 feet long by 3 feet deep, reference sketch #1. The overburden was piled on the north end of the excavation. The stone from this site also appeared to have the same color and crystal pattern as the initial site.

A total of six days or 58.18 hours was spent removing the overburden from both sites. The project started on November 26 and was completed on December 2, 1997. The only piece of equipment used for this work was a John Deere 544B loader with a 2 yard bucket. There was no further cleaning of the stripped ledge, this will be completed the spring of 1998. No test holes were drilled or samples taken from either site. Quarrying in these locations should commence the spring of 1998.

The other assessment work completed was the restaking of the above mentioned claim. Approximately five hours, @ \$90.00/hr, was spent on restaking and application preparation for claim # 1149700. The work was started and completed on the 15th of November, 1997.

Brian D. Sjaheim
Environmental Engineer
Cold Spring Granite Company

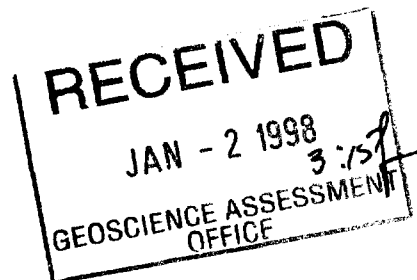

52K04SW2001 2.18101 KILGOUR LAKE

010

Cold Spring Granite Company is certified to the ISO 9001 standard for quality management.



CC-006-96

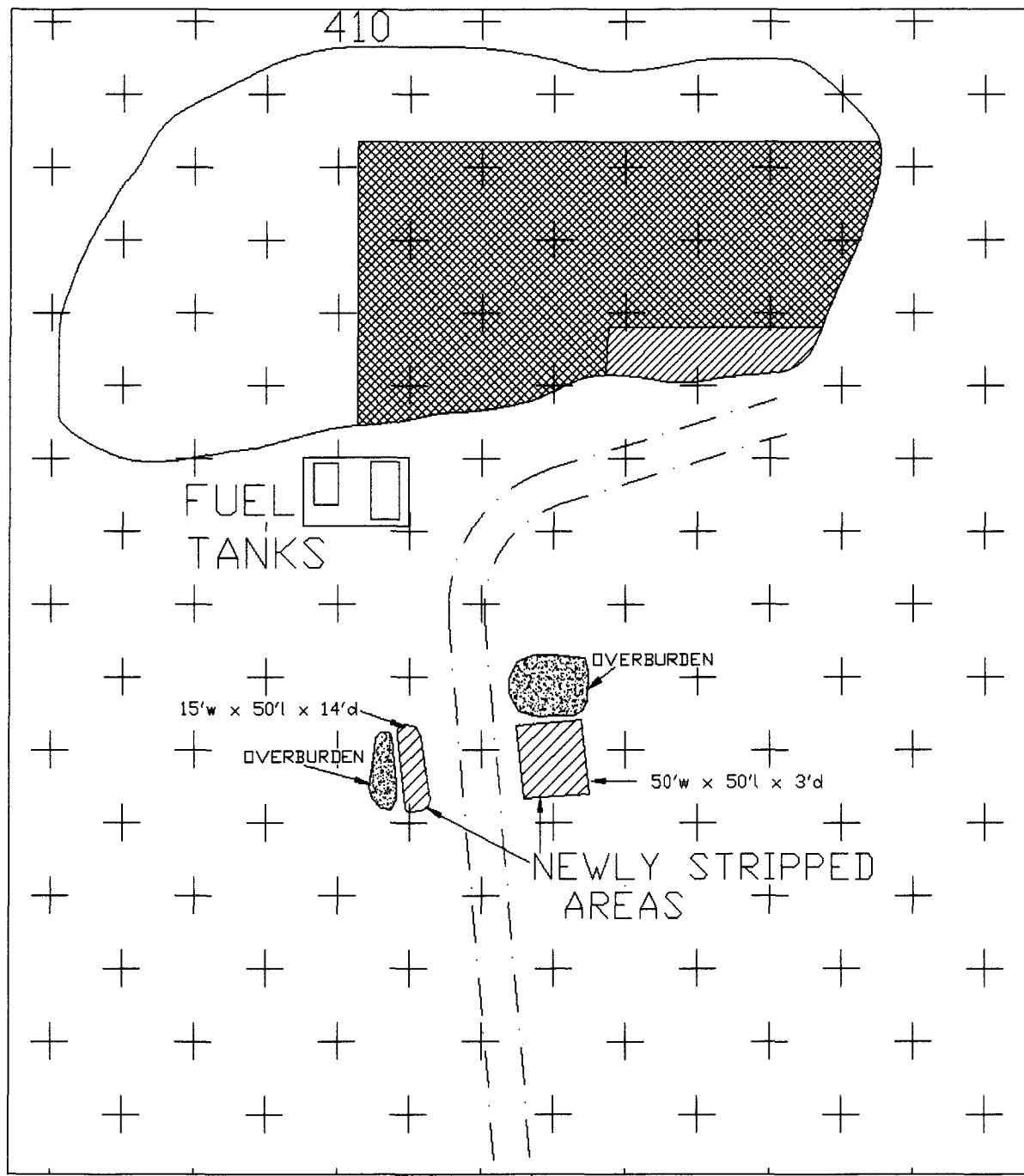

☐ EXPLOSIVE
☐ MAGAZINES

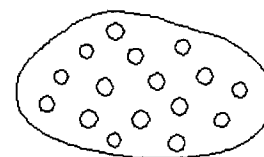

2.18101

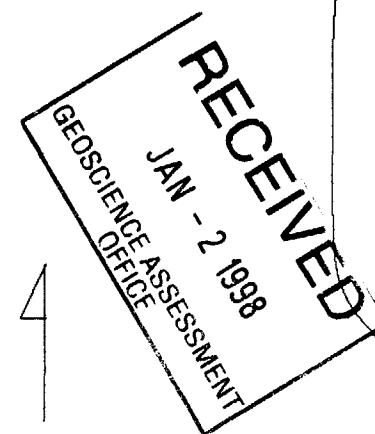

NORTH

SKETCH #1

400

01013101

RECEIVED
JAN - 2 1998
GEOLOGICAL ASSESSMENT
OFFICE

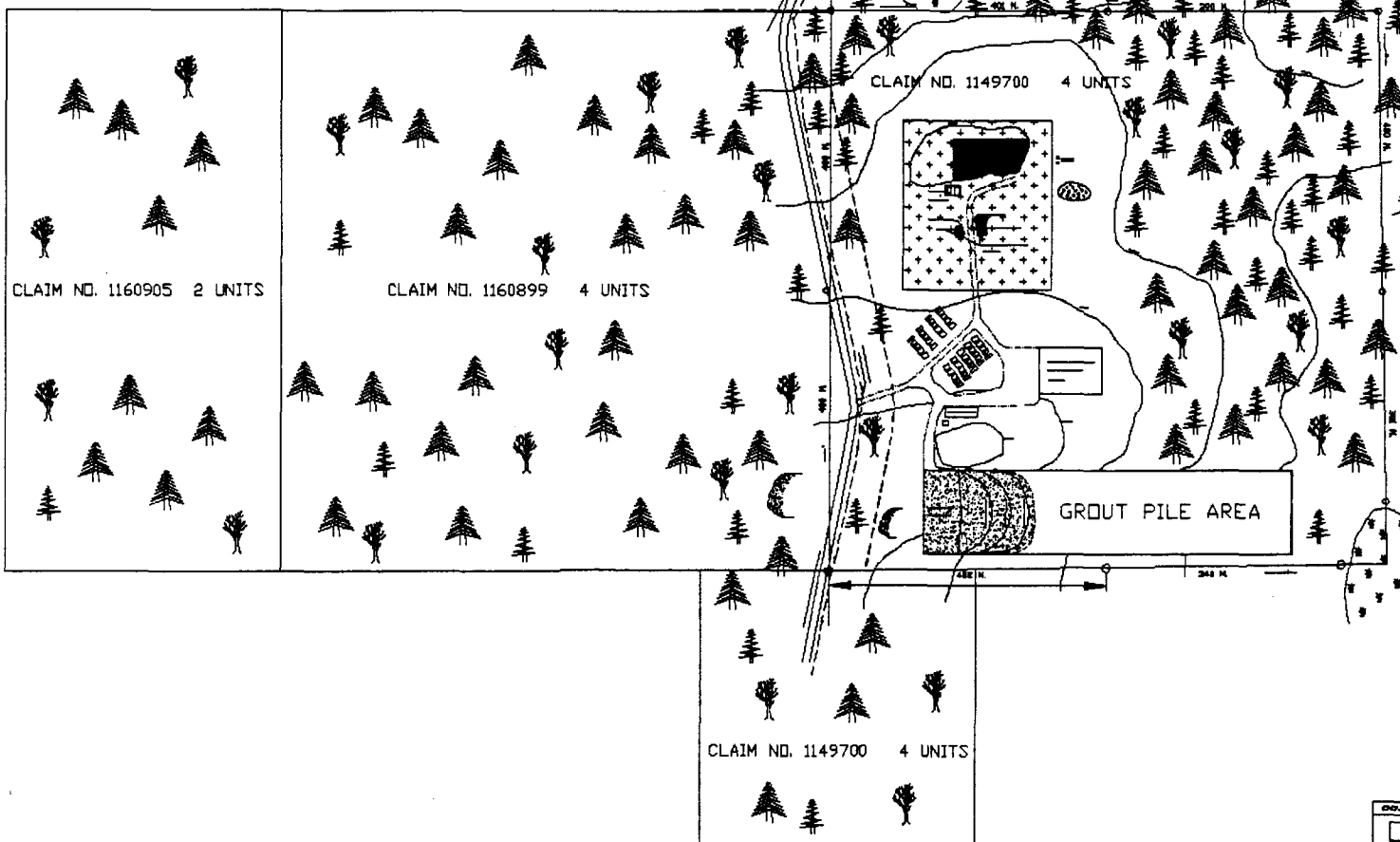

KILGOUR LAKE AREA
DISTRICT OF KENORA
ONTARIO

LEGEND

- GRAVEL ROAD
- GRAVEL ACCESS ROAD
- GRAVEL WORK SITE
- BLOCK STORAGE AREA
- GROUT CASTED PILE AREA
- EXISTING GRAVEL PIT
- TOPOGRAPHY LINES
- CLAIM BOUNDARY LINES
- EXCAVATION SETBACK FROM ROAD
- MARSH
- BLACK SPRUCE
- JACK PINE
- MARSH, SWAMP OVERLAID
- CLAIM CORNER MARKERS
- STRIPPED OVERLAID
- ENLARGED HYDRO PIPELINE



Deadfish Lake
G-2612

50° 07' 30"

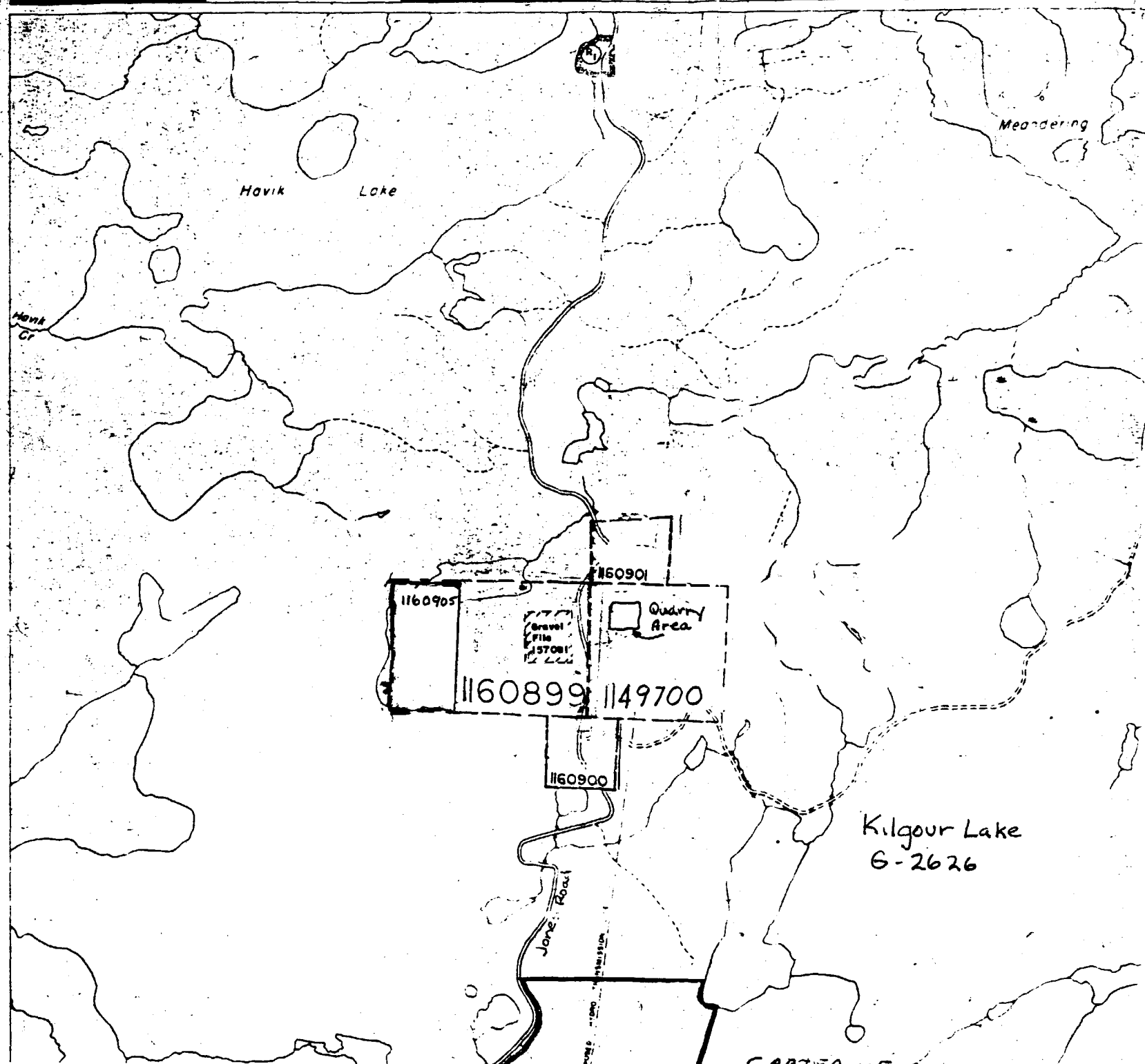

Wonderland Lake
- G-2658

CARTED MAP



COLD SPRING

Quarriers and fabricators of building stone and memorialization products.

COLD SPRING GRANITE COMPANY, 202 South Third Avenue, Cold Spring, MN 56320 USA
800-328-5040 320-685-3621 Fax 320-685-8490

April 17, 1998

Mr. Steve Beneteau
MND
Geoscience Assessment Office
933 Ramsey Lake Road
6th Floor
Sudbury, Ontario
P3E 6B5

Re: Revisions to Claim Assessment

Dear Steve,

I would like to add to the technical support data I submitted to you this past December. Specifically, Sections 10(2)(a)(I) and 10(2)(b)(iii). Enclosed are lab results of granite samples taken from the Kenora location as well as an updated drawing.

The stone uncovered from the recent stripping is the same color and crystal structure as the granite we have been quarrying on the active ledge. The average absorption is at 0.16%, the average compressive strength is 20,400 psi and the average flexural strength is 1,200 psi. If you have any further questions, please call me at 320-685-4838.

Sincerely,

Brian D. Sjaheim
Environmental Engineer
Cold Spring Granite Canada LTD.
Cold Spring Granite Company

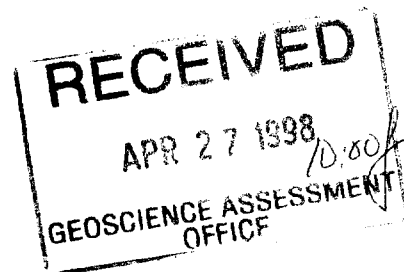

ENBDSCLMREV.41798



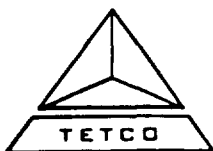

TRINITY ENGINEERING TESTING CORPORATION
AUSTIN, TEXAS

TETCO PN 3786

TO: Cold Spring Granite Company
Attn: Mr. Chuck Muehlbauer
202 South 3rd Avenue
Cold Spring, Minnesota 56320

PROJECT: Dimension Stone Testing
P.O. #01287113-N
CSGCo #97-9221

DATE: 4-1-97
REPORT NO.: T-4112

Page 1 of 17

REPORT OF: Flexural Strength of Dimension Stone

LAB NUMBER: 4074, 4067

MATERIAL DESCRIPTION: "Royal Auburn" Gray/Pink Granite (14-1/2" x 4" x 1-1/4"
thermal face, saw finish on other surfaces)

MATERIAL SOURCE: Cold Spring Granite (Kenora, Ontario, Canada)

SAMPLED BY: Cold Spring Granite

TEST METHOD: ASTM C880-96

TEST PERFORMED BY: B. Rice

RESULTS: Wet Condition - (Load applied parallel to rift direction with
thermal face in tension)

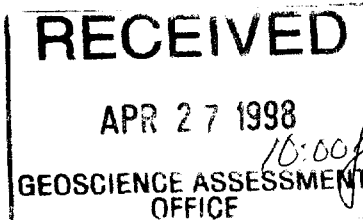

<u>Specimen Mark</u>	<u>Total Load,</u> <u>lbs.</u>	<u>Distance</u> <u>Between</u> <u>Supports,</u> <u>in.</u>	<u>Width,</u> <u>in.</u>	<u>Depth,</u> <u>in.</u>	<u>Flexural Strength,</u> <u>Lbs/in²</u>	<u>MPa</u>
<u>Wet Condition</u>						
9221-A-6-6-T-5	610	12.5	4.01	1.21	970	6.72
9221-A-6-7-T-5	575	12.5	4.00	1.18	970	6.67
9221-A-6-8-T-5	570	12.5	4.01	1.19	940	6.49
9221-A-6-9-T-5	605	12.5	4.02	1.20	980	6.76
9221-A-6-10-T-5	595	12.5	4.02	1.20	960	6.64
Average of Sample					970	6.66
Standard Deviation					15	0.10

The results shown on this report are for the exclusive use of the client for whom they were obtained and apply only to the samples tested and/or inspected. They are not intended to be indicative of the qualities of apparently identical products. The use of our name must receive our prior written approval.

**TRINITY ENGINEERING TESTING CORPORATION****AUSTIN, TEXAS**

TETCO PN 3786

TO: Cold Spring Granite Company
Attn: Mr. Chuck Muehlbauer
202 South 3rd Avenue
Cold Spring, Minnesota 56320

PROJECT: Dimension Stone Testing
P.O. #01287113-N
CSGCo Job #97-9221

DATE: 4-1-97
REPORT NO.: T-4112

Page 2 of 17

REPORT OF: Flexural Strength of Dimension Stone

LAB NUMBER: 4067, 4074

MATERIAL DESCRIPTION: "Royal Auburn" Gray/Pink Granite (14-1/2" x 4" x 1-1/4" thermal face, saw finish on other surfaces)

MATERIAL SOURCE: Cold Spring Granite (Kenora, Ontario, Canada)

SAMPLED BY: Cold Spring Granite

TEST METHOD: ASTM C880-96

TEST PERFORMED BY: B. Rice

RESULTS: Wet Condition - (Load applied perpendicular to rift direction with thermal face in tension)

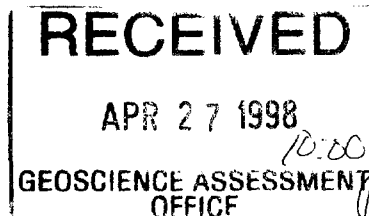

<u>Specimen Mark</u>	<u>Total Load,</u> <u>lbs.</u>	<u>Distance</u> <u>Between</u> <u>Supports,</u> <u>in.</u>	<u>Width,</u> <u>in.</u>	<u>Depth,</u> <u>in.</u>	<u>Flexural Strength,</u> <u>Lbs/in²</u>	<u>MPa</u>
<u>Wet Condition</u>						
9221-A-7-6-T-6	690	12.5	4.03	1.31	940	6.45
9221-A-7-7-T-6	680	12.5	4.02	1.21	1080	7.47
9221-A-7-8-T-6	490	12.5	4.02	1.30	680	4.66
9221-A-7-9-T-6	550	12.5	4.04	1.29	990	6.82
9221-A-7-10-T-6	590	12.5	4.03	1.30	1060	7.28

Average of Sample 950 6.54
Standard Deviation 163 1.12

The results shown on this report are for the exclusive use of the client for whom they were obtained and apply only to the samples tested and/or inspected. They are not intended to be indicative of the qualities of apparently identical products. The use of our name must receive our prior written approval.



Ministry of
Northern Development
and Mines

Declaration of Assessment Work Performed on Mining Land

Mining Act, Subsections 85(2) and 86(3), R.S.O. 1990

Transaction Number (office use)
W. 98/11-00001
Assessment File Research Imaging



52K04SW2001 2.18101 KILGOUR LAKE 900

Sections 85(2) and 86(3) of the Mining Act. Under section 8 of the
the assessment work and correspond with the mining land holder.
Ser. Ministry of Northern Development and Mines, 4th Floor

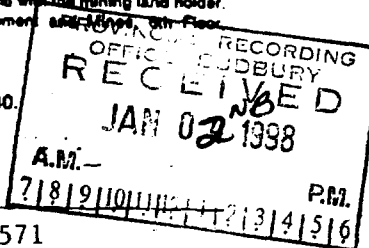

Instructions: Please type or print in ink. Ordering a claim, use form 0240.

1. Recorded holder(s) (Attach a list if necessary)

Name COLD SPRING GRANITE COMPANY	Client Number 119571
Address 202 South 3rd Avenue	Telephone Number 320-685-3621
Cold Spring, MN 56320	Fax Number 320-685-4721
Name	Client Number
Address	Telephone Number
	Fax Number

2. Type of work performed: Check (✓) and report on only ONE of the following groups for this declaration.

- ☐ Geotechnical: prospecting, surveys, assays and work under section 18 (regs) ☒ Physical: drilling, stripping, trenching and associated assays ☐ Rehabilitation

Work Type Stripping overburden Restaking claim	Office Use Commodity Total \$ Value of Work Claimed \$350 NTS Reference Mining Division Kenora Resident Geologist District Kenora
Dates Work Performed From 26 Day 11 Month 97 Year To 2 Day 12 Month 97 Year	
Global Positioning System Date (if available)	Township/Area Kilgour Lake Area M or G-Plan Number G-2626

Please remember to: - obtain a work permit from the Ministry of Natural Resources as required
- provide proper notice to surface rights holders before starting work;
- complete and attach a Statement of Costs, form 0212;
- provide a map showing contiguous mining lands that are linked for assigning work;
- include two copies of your technical report.

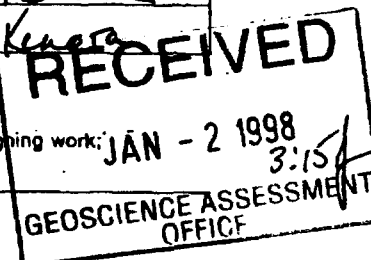

3. Person or companies who prepared the technical report (Attach a list if necessary)

Name Brian D. Sjaasheim	Telephone Number 320-685-4838
Address 202 South 3rd Avenue	Fax Number 320-685-4721
Name Cold Spring, MN 56320	Telephone Number
Address	Fax Number
Name	Telephone Number
Address	Fax Number

4. Certification by Recorded Holder or Agent

I, Brian D. Sjaasheim (Print Name), do hereby certify that I have personal knowledge of the facts set forth in this Declaration of Assessment Work having caused the work to be performed or witnessed the same during or after its completion and, to the best of my knowledge, the annexed report is true.

Signature of Recorded Holder or Agent <i>Brian D. Sjaasheim</i>	Date 12/31/97
Agent's Address As Above	Telephone Number Fax Number

Dated April 02/98

5. Work to be recorded and distributed. Work can only be assigned to claims that are contiguous (adjoining) to the mining land where work was performed, at the time work was performed. A map showing the contiguous link must accompany this form.

W 9810. 00001

Mining Claim Number. Or if work was done on other eligible mining land, show in this column the location number indicated on the claim map.	Number of Claim Units. For other mining land, list hectares.	Value of work performed on this claim or other mining land.	Value of work applied to this claim.	Value of work assigned to other mining claims.	Bank. Value of work to be distributed at a future date.
eg TB 7827	16 ha	\$26,825	N/A	\$24,000	\$2,825
eg 1234567	12	0	\$24,000	0	0
eg 1234568	2	\$8,892	\$4,000	0	\$4,892
1 1149700	4	\$3650.00	0	\$3200.00	\$450.00
2 1160899	4	0	\$1600.00	0	0
3 1160900	1	0	\$400.00	0	0
4 1160901	1	0	\$400.00	0	0
5 1160905	2	0	\$800.00	0	0
6					
7					
8					
9					
10					
11					
12					
13					
14					
15					
Column Totals		\$3650.00	\$3200.00	\$3200.00	\$450.00

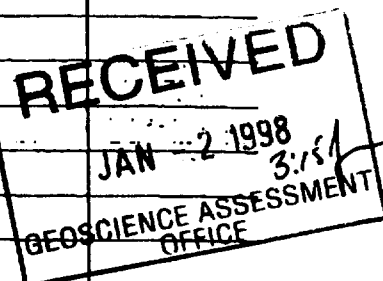

I, Brian D. Sjaasheim, do hereby certify that the above work credits are eligible under subsection 7 (1) of the Assessment Work Regulation 6/96 for assignment to contiguous claims or for application to the claim where the work was done.

Signature of Recorded Holder or Agent Authorized in Writing

Brian D. Sjaasheim

Date

12/31/97

6. Instructions for cutting back credits that are not approved.

Some of the credits claimed in this declaration may be cut back. Please check (✓) in the boxes below to show how you wish to prioritize the deletion of credits:

- ☒ 1. Credits are to be cut back from the Bank first, followed by option 2 or 3 or 4 as indicated.
- ☐ 2. Credits are to be cut back starting with the claims listed last, working backwards; or
- ☐ 3. Credits are to be cut back equally over all claims listed in this declaration; or
- ☐ 4. Credits are to be cut back as prioritized on the attached appendix or as follows (describe):

Note: If you have not indicated how your credits are to be deleted, credits will be cut back from the Bank first, followed by option number 2 if necessary.

For Office Use Only

Received Stamp

Deemed Approved Date	Date Notification Sent
Date Approved	Total Value of Credit Approved
Approved for Recording by Mining Recorder (Signature)	

8241 (02/98)

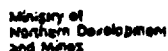

Transaction Number/ Office used

11. 9810.0000

Amended copy

Personal information collected on this form is obtained under the authority of subsection (2.1) of the Access to Information Act, R.S.C. (1985), c. A-61. Under section 9 of the Mining Act, the information is a public record. This information will be used to review the assessment work and correspondence with the mining land holder. Questions about this collection should be directed to the Chief Mining Recorder, Ministry of Northern Development and Mines, 6th Floor, 330 Ramsey Lake Road, Sudbury, Ontario, P3E 5B5.

RECEIVED
JAN - 2 1998
5:15
GEOSCIENCE ASSESSMENT
OFFICE

Post-It® Fax Note	7671	Date	1-5-98	# of pages	1
To	Jim Mc Alexy	From	Brian Swanson		
Co./Dept.	MND	Co.	CSG		
Phone #		Phone #	320-685-4838		
Fax #	705-670-5881	Fax #	4721		

1. Work filed within two years of performance is claimed at 100% of the above Total Value of Assessment Work.
2. If work is filed after two years and up to five years after performance, it can only be claimed at 50% of the Total Value of Assessment Work. If this situation applies to your claims, use the calculation below:

TOTAL VALUE OF ASSESSMENT WORK **x 0.60 =** **Total \$ value of worked claimed**

- Work older than 5 years is not eligible for credit.
- A recorded holder may be required to verify expenditures claimed in this statement of costs within 45 days of a request for verification and/or correction/clarification. If verification and/or correction/clarification is not made, the Minister may reject all or part of the assessment work submitted.

I, Brian Sjaasheim, do hereby certify, that the amounts shown are as accurate as may
(Please print full name)
reasonably be determined and the costs were incurred while conducting assessment work on the lands indicated on
the accompanying Declaration of Work form as Brian Sjaasheim I am authorized
(Please enter agent, or claim company position with signing authority)
to make this certification.

Signature <i>Brian D. Dolan</i>	Date 1-5-78
------------------------------------	----------------

785 670 5742

PAGE 15

** TOTAL PAGE.02 **
 ** TOTAL PAGE.01 **

May 4, 1998

Brian D. Sjaaheim
COLD SPRING GRANITE (CANADA) LTD.
202 SOUTH 3RD AVENUE
COLD SPRING, MINNESOTA,
563-20

Geoscience Assessment Office
933 Ramsey Lake Road
6th Floor
Sudbury, Ontario
P3E 6B5

Telephone: (888) 415-9846
Fax: (705) 670-5881

Dear Sir or Madam:

Submission Number: 2.18101

Status

Subject: Transaction Number(s): W9810.00001 Approval After Notice

We have reviewed your Assessment Work submission with the above noted Transaction Number(s). The attached summary page(s) indicate the results of the review. **WE RECOMMEND YOU READ THIS SUMMARY FOR THE DETAILS PERTAINING TO YOUR ASSESSMENT WORK.**

If the status for a transaction is a 45 Day Notice, the summary will outline the reasons for the notice, and any steps you can take to remedy deficiencies. The 90-day deemed approval provision, subsection 6(7) of the Assessment Work Regulation, will no longer be in effect for assessment work which has received a 45 Day Notice.

Please note any revisions must be submitted in DUPLICATE to the Geoscience Assessment Office, by the response date on the summary.

If you have any questions regarding this correspondence, please contact Steve Beneteau by e-mail at benetest@epo.gov.on.ca or by telephone at (705) 670-5855.

Yours sincerely,



ORIGINAL SIGNED BY
Blair Kite
Supervisor, Geoscience Assessment Office
Mining Lands Section

Work Report Assessment Results

Submission Number: 2.18101

Date Correspondence Sent: May 04, 1998

Assessor: Steve Beneteau

Transaction Number	First Claim Number	Township(s) / Area(s)	Status	Approval Date
W9810.00001	1149700	KILGOUR LAKE	Approval After Notice	May 01, 1998

Section:

10 Physical PSTRIIP

All deficiencies associated with this submission have been corrected. Accordingly, assessment credit has been approved as outlined on the attached Distribution of Assessment Credit form.

Correspondence to:

Resident Geologist
Kenora, ON

Assessment Files Library
Sudbury, ON

Recorded Holder(s) and/or Agent(s):

Brian D. Sjaaheim
COLD SPRING GRANITE (CANADA) LTD.
COLD SPRING, MINNESOTA,

Distribution of Assessment Work Credit

The following credit distribution reflects the value of assessment work performed on the mining land(s).

Date: May 04, 1998

Submission Number: 2.18101

Transaction Number: W9810.00001

<u>Claim Number</u>	<u>Value Of Work Performed</u>
1149700	3,424.00
Total: \$	3,424.00

WONDERLAND LAKE - G-2658

DEADFISH LAKE AREA - G-2612

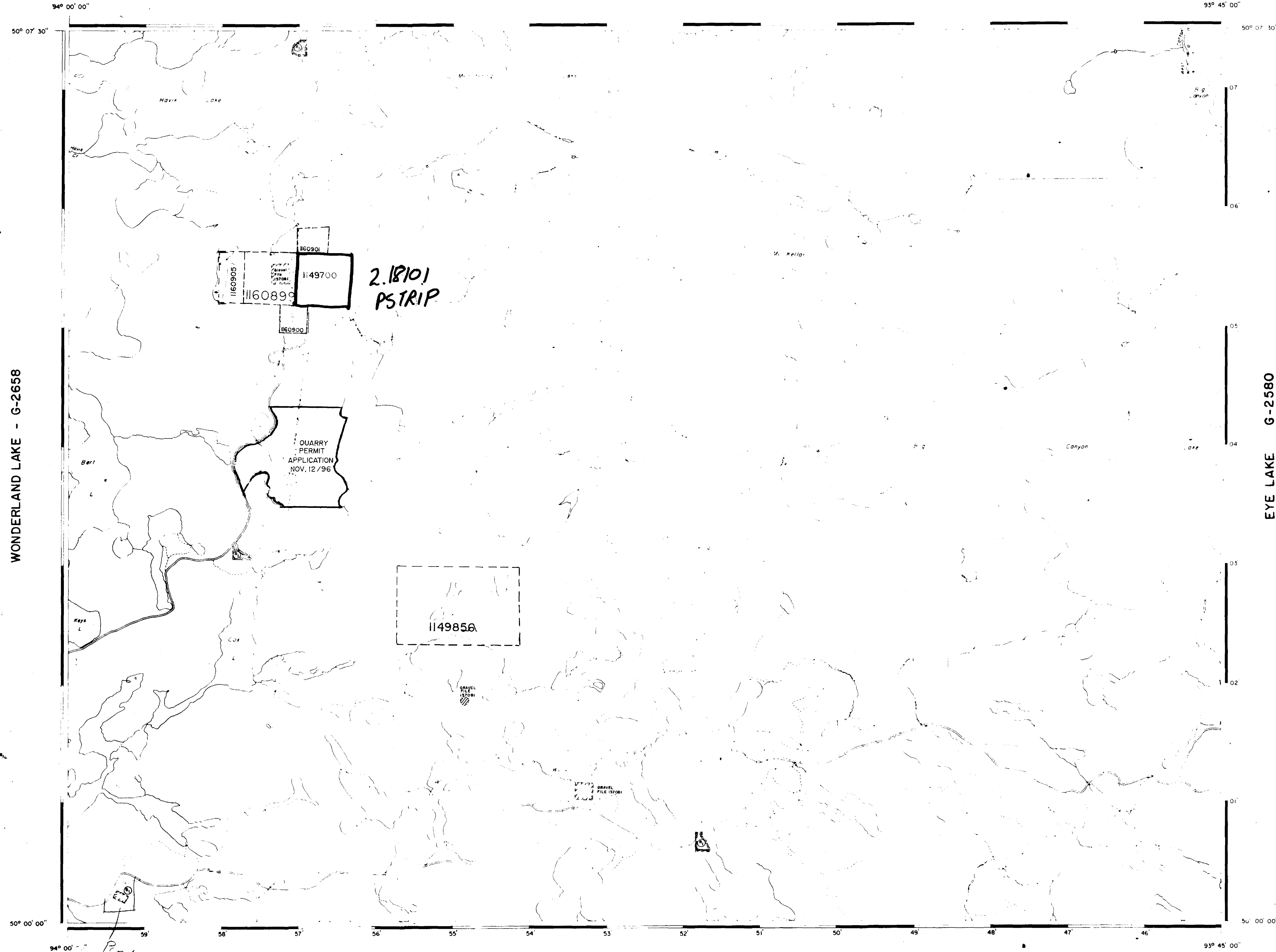

DANIELS LAKE G-2610

LEGEND

HIGHWAY AND ROUTE NO.	
OTHER ROADS	
TRAILS	
SURVEYED LINES	
TOWNSHIP BASE LINES ETC.	
LOTS, MINING CLAIMS, PARCELS ETC.	
UNSURVEYED LINES	
LOT LINES	
PARCEL BOUNDARY	
MINING CLAIMS ETC.	
RAILWAY AND RIGHT-OF-WAY	
UTILITY LINES	
NON-PERENNIAL STREAM	
FLOODING OR FLOODING RIGHTS	
SUBDIVISION OR COMPOSITE PLAN	
RESERVATIONS	
ORIGINAL SHORELINE	
MARSH OR MUSKIEG	
MINES	
TRAVERSE MONUMENT	

DISPOSITION OF CROWN LANDS

TYPE OF DOCUMENT	
PATENT SURFACE & MINING RIGHTS	
SURFACE RIGHTS ONLY	
MINING RIGHTS ONLY	
LEASE SURFACE & MINING RIGHTS	
SURFACE RIGHTS ONLY	
MINING RIGHTS ONLY	
LICENCE OF OCCUPATION	
ORDER IN CANCELLATION	
RESERVATION	
CANCELLED	
SAND & GRAVEL	

NOTE: MINING RIGHTS IN LARGE SCALE MAPS ARE INDICATED BY A STAR (*) AND ARE NOT TO BE USED FOR MINING PURPOSES. MINING RIGHTS IN SMALL SCALE MAPS ARE INDICATED BY A DOT (.) AND ARE NOT TO BE USED FOR MINING PURPOSES.

REFERENCES

AREAS WITHDRAWN FROM DISPOSITION

M.R.D. MINING RIGHTS ONLY

S.R.D. SURFACE RIGHTS ONLY

M.R.S. MINING RIGHTS & SURFACE RIGHTS

Description	Date	Disposition	File No.
W.H.B.	11/86	STMR	188555
0-11/86	11/86	STMR	759424

SAND AND GRAVEL

M.R. GRAVEL RESERVE (D.S.) AN 13 1986

M.R. GRAVEL RESERVE (D.S.) FILE 8008

THE INFORMATION THAT APPEARS ON THIS MAP HAS BEEN COMPILED FROM VARIOUS SOURCES, AND ACCURACY IS NOT GUARANTEED. THOSE WISHING TO STAKE MINING CLAIMS SHOULD CONSULT WITH THE MINING RECORDER, MINISTRY OF NORTHERN DEVELOPMENT AND MINES, FOR ADDITIONAL INFORMATION ON THE STATUS OF THE LANDS SHOWN HEREON.

EFFECT DATE

SCALE: 1:50,000

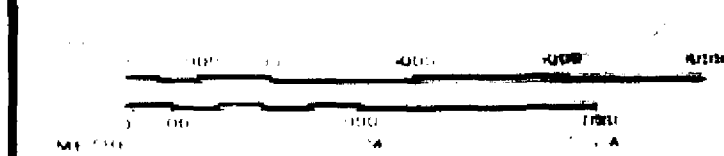

AREA

KILGOUR LAKE

M.N.R. ADMINISTRATIVE DISTRICT	DATE OF ISSUE
KENORA	MAR 25 1998
MINING DIVISION	PROVINCIAL RECORDING
KENORA	LAND TITLES DIVISION
KENORA	SUDBURY

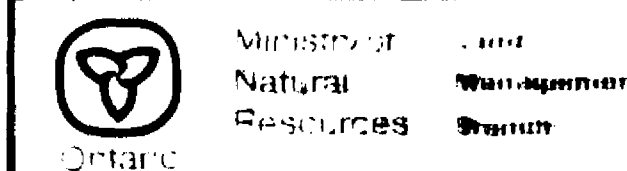

DATE: FEBRUARY, 1984

M-1964

G-2626



