



52K13NW0042 11 BAIRD

010

Diamond Drilling

Township of Baird

Report No: 11

Work performed by: Madsen Red Lake Gold Mines

Claim No	Hole No	Footage	Date	Note
KRL 36016	R-1	152.9 m	-	
	R-3		Sept/57	
KRL 36018	R-4	96.9 m combined	Sept/60	
	R-5		Sept/60	

249.8 m

1169.7

Notes:

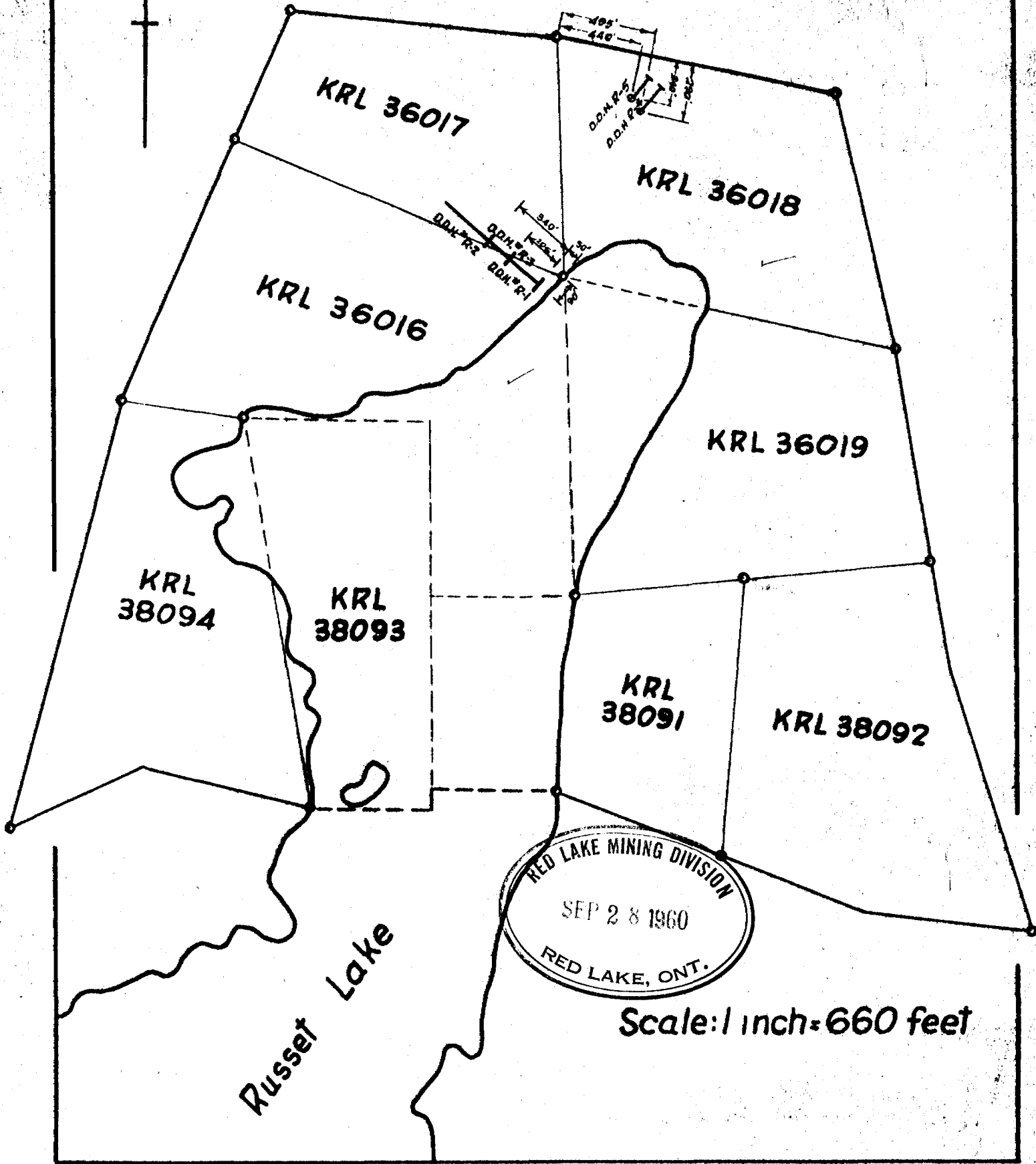

KRL 36017

KRL 36018

KRL 36016

KRL 36019

KRL 38094

KRL 38093

KRL 38091

KRL 38092

Russet Lake

RED LAKE MINING DIVISION
SEP 28 1960
RED LAKE, ONT.

Scale: 1 inch = 660 feet

11-2-16

DIAMOND DRILL HOLE R-1

- 0.0 - 11.6 Casing
- 11.6 - 14.4 Andesite, altered from 13.3 to 14.4
- 14.4 ~~4~~³-29.7 Hornblende diorite
- 29.7 - 42.4 Andesite, slightly altered
- 42.4 - 65.3 Tuff, siliceous from 53.7 to 54.8 and from 62.9 to 64.3
- 65.3 - 84.2 Highly altered diorite
- 84.2 ~~4~~³ 85.6 Highly altered andesite
- 85.6 - 88.0 Granodiorite
- 88.0 - 100.0 Altered andesite
- 100.0 - 200.0 Andesite

(Hole to be continued)

DIAMOND DRILL HOLE "R-1"

11-2-14

N.B.

0.0 - 200.0	Previously reported for assessment work.
200.0 - 212.4	Andesite
212.4 - 214.5	Diorite
214.5 - 229.6	Andesite
229.6 - 231.8	Diorite
231.8 - 285.3	Andesite; tuffaceous from 253.0 to 258.0
285.3 - 288.9	Granodiorite
288.9 - 289.2	Andesite
289.2 - 290.3	Granodiorite
290.3 - 356.9	Andesite; quartz from 327.8 to 332.3, from 335.5 to 336.9, from 341.9 to 343.7 and from 347.0 to 352.0.
356.9 - 363.0	Tuff
363.0 - 402.5	Andesite; quartz from 383.1 to 383.9 and from 386.3 to 387.5
402.5 - 408.6	Hornblende diorite
408.6 - 413.2	Andesite
413.2 - 437.6	Hornblende diorite
437.6 - 440.0	Altered and silicified tuff with an occasional speck of pyrrhotite
440.0 - 501.7	Andesite, partly recrystallized and dioritic; diorite from 474.0 to 477.5 and from 482.7 to 484.2; possibly tuff from 477.5 to 482.7 and from 494.6 to 501.7

END OF HOLE

STRIKE	N 12°28'E (N 47°32'W astronomic)
DIP	-45°00'
DEPARTURE	20815.7
LATITUDE	13159.6
ELEVATION	4870.0

DIAMOND DRILL HOLE # R-3

11-2-46

LOCATION: KRL 36016 (North end of Russet Lake)
STRIKE: N 47°30' W STARTED: Sept. 19, 1957
DIP: -60° FINISHED: Sept. 21, 1957
DEPTH: 350.0'

0.0 - 5.0	Casing.
5.0 - 10.0	Medium to fine grained diorite.
10.0 - 14.2	Granodiorite dyke.
14.2 - 28.9	Medium to fine grained diorite with occasional carbonate stringers from 27.0 to 28.8
28.9 - 34.3	Granodiorite dyke.
34.3 - 51.8	Medium to fine grained diorite with much quartz from 48.7 to 51.0
51.8 - 60.8	Andesite.
60.8 - 104.0	Medium to fine grained diorite.
104.0 - 119.7	Andesite with much quartz from 104.3 to 105.2
119.7 - 121.7	Fine grained felspar porphyry.
121.7 - 125.0	Andesite.
125.0 - 125.4	Highly carbonated andesite.
125.4 - 137.3	Medium to fine grained diorite.
137.3 - 175.0	Granodiorite with possibly a tuff inclusion from 165.7 to 166.2
175.0 - 219.8	Medium to fine grained diorite, carbonated from 182.9 to 183.2, from 192.6 to 193.7, from 196.5 to 197.7
219.8 - 221.2	Andesite.
221.2 - 230.5	Diorite dyke rock.



20.5 - 239.2 Andesite.
239.2 - 240.0 Brecciated and carbonated andesite.
240.0 - 258.8 Andesite with much quartz and occasional pyrite from 241.7 to 242.7, from 243.5 to 244.0, from 244.9 to 245.3, from 247.0 to 248.5, from 249.0 to 250.0.
258.8 - 273.3 Tuff with quartz carbonate from 261.8 to 263.3, from 266.1 to 267.8, from 268.6 to 269.5, from 272.9 to 273.3.
273.3 - 276.9 Recrystallised andesite.
276.9 - 281.2 Medium to fine grained diorite.
281.2 - 282.2 Andesite.
282.2 - 283.2 Medium to fine grained diorite.
283.2 - 290.4 Andesite with quartz-carbonate from 285.5 to 286.8.
290.4 - 294.0 Massive felspar porphyry.
294.0 - 295.6 Andesite.
295.6 - 296.0 Quartz.
296.0 - 327.0 Andesite, brecciated and fault altered from 304.3 to 305.6, slight carbonate stringers from 321.6 to 324.0.
327.0 - 350.0 Tuff with quartz carbonate from 327.0 to 328.4, from 333.7 to 336.4, from 340.5 to 341.5, from 348.0 to 348.8 and light pyrrhotite from 330.0 to 331.4.



MADSEN RED LAKE GOLD MINES LIMITED

11-2-60

DIAMOND DRILL HOLE # R-4

LOCATION: KRL 36018 (North end of Russet Lake)

STRIKE: N 40° E STARTED: 15 Sept. 1960.

DIP: Flat FINISHED: 17 Sept. 1960.

DEPTH: 173.0'

0.0' - 9.0' Andesite, carbonate filled fractures

9.0 - 27.5 Brownish, slightly banded tuffaceous andesite with carbonate veins from 14.8 to 15.3; from 24.2 to 25.7.

27.5 - 32.6 Mainly calcite.

32.6 - 46.2 Brown banded tuff with carbonate veins from 37.0 to 38.9; from 40.1 to 42.3; from 44.7 to 45.3 and slight pyrite from 37.0 to 37.4;

46.2 - 58.1 Brownish, slightly banded tuffaceous andesite with carbonate filled fractures from 50.0 to 55.0.

58.1 - 65.0 Fresh andesite

65.0 - 76.6 Brownish, slightly banded tuffaceous andesite with carbonate filled fractures from 65.0 to 66.5; from 69.1 to 73.4; and mainly calcite from 66.5 to 69.1; from 73.4 to 76.6.

76.6 - 78.0 Lost core

78.0 -116.4 Fresh andesite

116.4 -118.3 Feldspar porphyry

118.3 -119.0 Fresh andesite

119.0 -124.0 Feldspar porphyry

124.0 -133.5 Fresh andesite

133.5 -142.3 Feldspar porphyry

142.3 -143.1 Fresh andesite

143.1 -156.5 Feldspar porphyry

156.5 -173.0 Fresh andesite.



MADSEN RED LAKE GOLD MINES LIMITED

DIAMOND DRILL HOLE # R-5

LOCATION: KRI. 36018 (North End of Russet Lake)
STRIKE: N 40° E STARTED: 19 Sept. 1960.
DIP: Flat FINISHED: 20 Sept. 1960.
DEPTH: 145'

0 - 17.8 Andesite
17.8 - 20.5 Feldspar porphyry
20.5 - 32.0 Andesite
32.0 - 48.1 Brownish, slightly banded tuffaceous andesite
48.1 - 52.6 Brown banded tuff with quartz-carbonate from 50.2 to 50.7.
52.6 - 61.7 Brownish, slightly banded tuffaceous andesite with vein
quartz from 60.5 to 61.5.
61.7 - 103.1 Andesite
103.1 - 112.0 Brown banded tuff with quartz filled fractures.
112.0 - 114.0 Quartz-carbonate
114.0 - 120.0 Brown banded tuff with quartz filled fractures and slight
fine pyrite.
120.0 - 128.2 Brownish, slightly banded tuffaceous andesite.
128.2 - 131.0 Brown banded tuff.
131.0 - 134.8 Quartz-carbonate
134.8 - 145.0 Andesite

