



MECHANICAL ROCK DRILLING & BLASTING
SUMMARY OF WORK & LOCATION OF PITS

Area 5+00 E Sketch 1

Pit 1

Location: K-1023504 & K-1023505
3 M. West of #1 Post of K-1023505
Dimension: 7.2 M. x 1. M. x .5 M.

Area 6+00 E Sketch 2

Pit 1

Location: K-1023507
95 M. East; 18 M. North of #3 Post of
K-1023507
Dimension: 3.5 M. x .8 M. x .5 M.

Pit 2

Location: K-1023507
120 M. East; 20 M. North of #3 Post of
K-1023507
Dimension: 2 M. x 1 M. x .5 M.

Area 7+00 E. Sketch 3

Pit 1

Location: K-1023506
25 M. South; 201 M. West of #1 Post of
K-1023506
Dimension: 6 M. x 2 M. x 1 M.

Pit 2

Location: K-1023506
37 M. South; 203 M. West of #1 Post of
K-1023506
Dimension: 3 M. x 1.8 M. x .5 M.

Pit 3

Location: K-1023506
26 M. South; 199 M. West of #1 Post of
K-1023506
Dimension: 1.2 M. x 1.2 M. x .5

Pit 4

Location: K-1023506
40 M. South; 199 M. West of #1 Post of
K-1023506
Dimension: 1.2 M. x 1.2 M. x .5 M.

Area 7+00 E Sketch 4

Pit 5

Location: K-1023507
35 M. North; 200 M. West of #2 Post of
K-1023507
Dimension: 3 M. x 1.5 M. x .5 M.

Area 7+25 E Sketch 5

Pit 1

Location: K-1023506
15 M. South; 175 M. West of #1 Post of
K-1023506
Dimension: 2 M. x 1 M. x 1 M.

Pit 2

Location: K-1023506
15 M. South; 170 M. West of #1 Post of
K-1023506
Dimension: 1 M. x 1 M. x .5 M.

Area 8+00 E Sketch 6

Pit 1 (North)

Location: K-1023506
37 M. South; 101 M. West of #1 Post of
K-1023506
Dimension: 5.5 M. x 2 M. x .5 M.

Pit 2 (South)

Location: K-1023506
45 M. South; 102 M. West of #1 Post of 1023506
Dimension: 5 M. x 3 M. .5 M.

Area 8+50 E Sketch 7

Pit 1

Location: K-1023506
43 M. South; 42 M. West of #1 Post of
K-1023506
Dimension: 1.5 M. x 1.5 M. x .5 M.

Pit 2

Location: K-1023506
45 M. South; 33 M. West of #1 Post of
K-1023506
Dimension: 2 M. x 1.5 M. x .5 M.

Pit 3

Location: K1023506
23 M. South; 44 M. West of #1 Post of
K-1023506
Dimension: 2 M. x 1.5 M. x 1 M.

Area 9+35 E Sketch 8

Pit 1

Location: K-1023511

33 M. East; 70 M. South of #4 Post of
K-1023511

Dimension: 2 M. x 1 M. x .5 M.

Pit 1A

Location: K-1023511

35 M. East; 70 M. South of #4 Post of
K-1023511

Dimension: 5.5 M. x 1 M. x .5 M.

Pit 2

Location: K-1023511

34 M. East; 68 M. South of #4 Post of
K-1023511

Dimension: 1 M. x 1.2 M. x .5 M.

Pit 3

Location: K-1023511

34 M. East; 72 M. South of #4 Post of
K-1023511

Dimension: 4 M. x 1.2 M. x .5 M.

Pit 4

Location: K-1023511

30 M. East; 75 M. South of #4 Post of
K-1023511

Dimension: 2 M. x 1.5 M. x .5 M.

UMFREVILLE LAKE G-2653

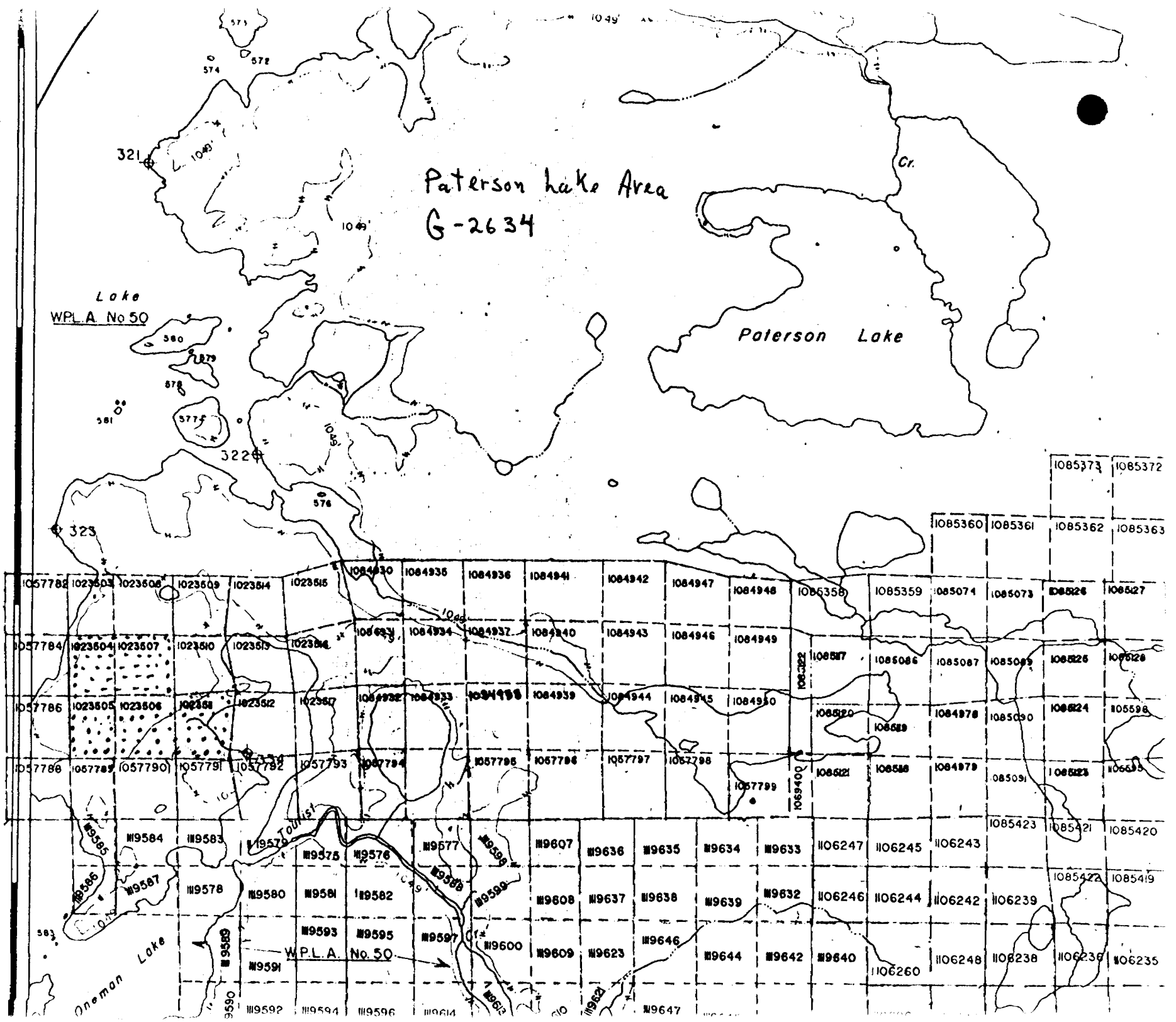

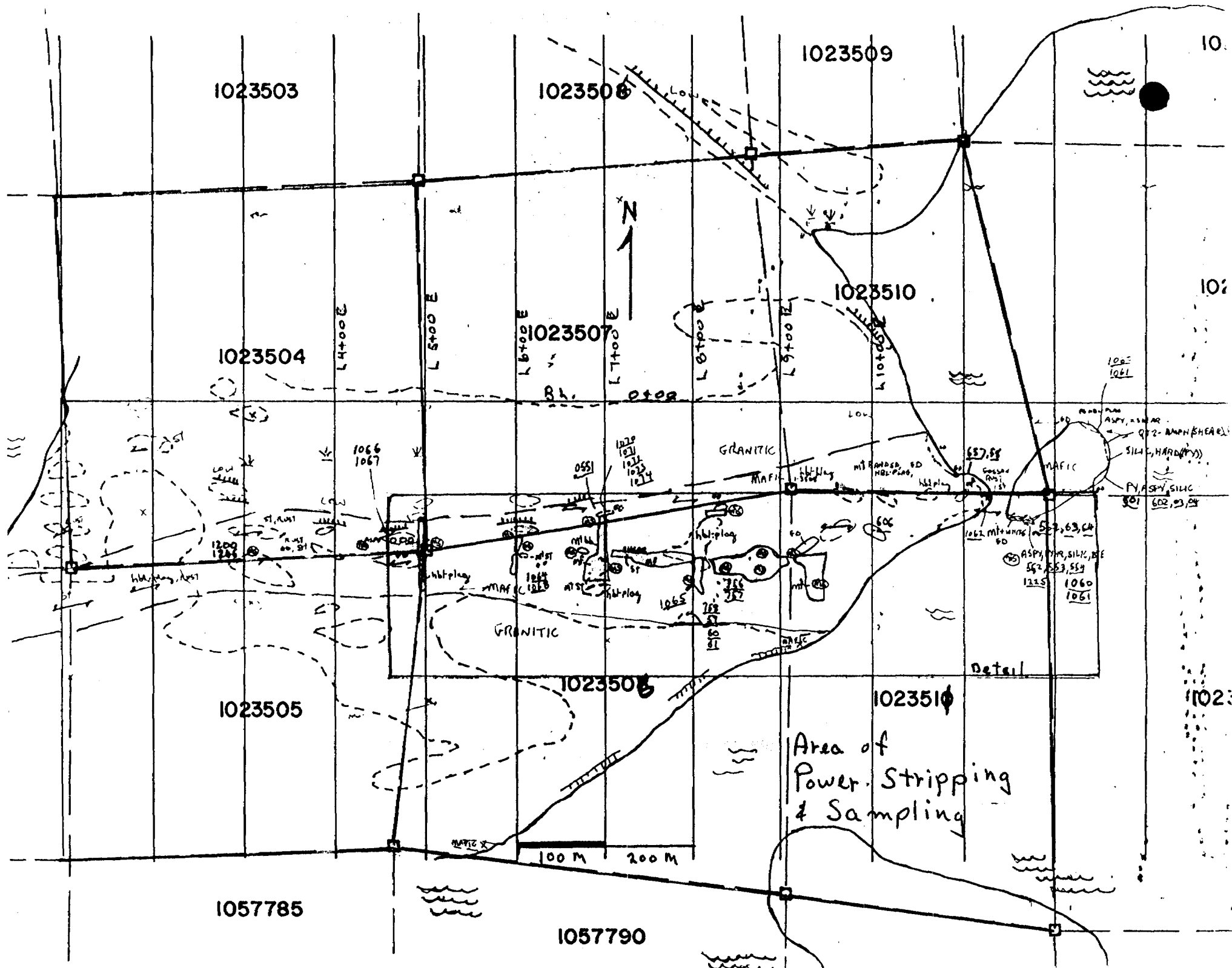

CHIP SAMPLES

SAMPLE	AU(ppb)	AS(ppm)
1120	1200	59000
1121	232	3700
1122	756	41000
1311	8	47
1312	12	10
1313	36	430
1314	48	6000
1315	28	1200
1316	786	55000
1317	734	62000
1318	10	58
1645	16	690
1307	184	6700
1308	10	96
1309	12	68
1310	10	142

K 1023507

claim line

K 1023506



Area 5+00 E
Sketch 1

K 1023504

Line 5+00 E

1311

1312

1313

1314

PIT-1

1316

1315

3 m

#1-K1023505
3 m East

1317

1122 GRAB

1307
1308
1309
1310

OC - K 1023505

OC

10 m.

1122 GRAB

SAMPLES

pb)	AS(ppm)
0	66000
2	9400
0	58000
0	3200

1042 GRABS
1043 "
1044 "
1045 "

#3-Post K1023507
18 M. South
25 M. West

PIT-1

Line 6+00 E

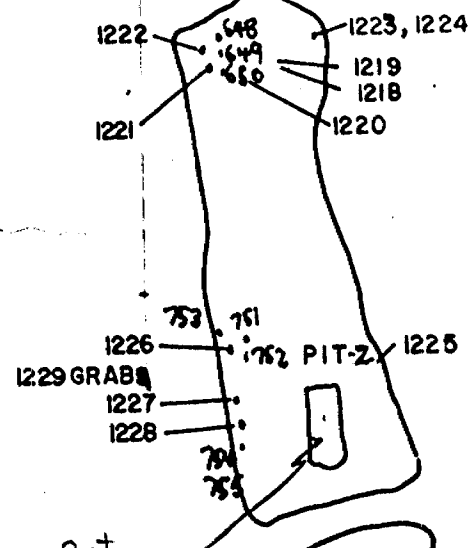

#3 Post
K1023507
20 M. South
120 M. West

SAMPLES

U(ppb)	AS(ppm)
596	116000
922	12700
282	13400
322	8800
616	141000
652	68000

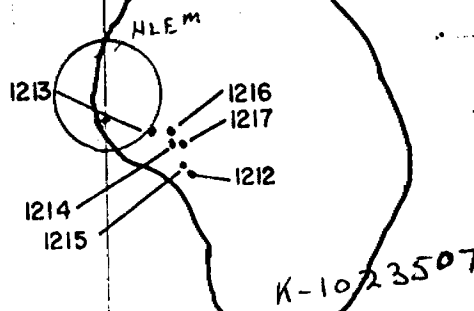

Chain line

K-1023506

10 M.

N

CHANNEL SAMPLES

SAMPLE	LENGTH	AU(ppb)	AS(ppm)
1645	104	16	690
1646	61	12	590
1647	61	8	63
1648	61	6	49
1649	76	2	125
1650	15	6	48
1651	85	2	32
1652	67	2	45
1653	15	28	1080

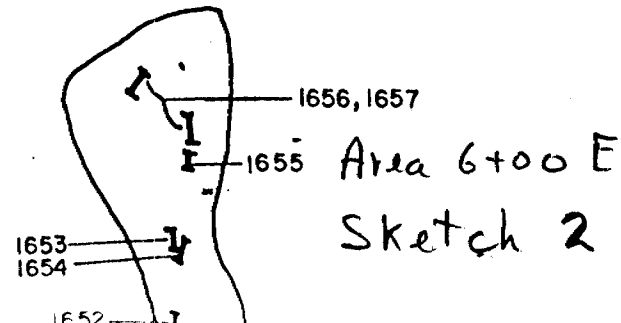

Area 6+00 E
Sketch 2

K-1023501

Chain Line

K 1023506

Area 7+00 E
Sketch 3

ES

(ppb) AS(ppm)

08	59000
672	1420
64	23000
62	81000
84	58000
92	51000
364	122000
74	161000
92	50000
54	4800

10 M.

624.

#1 Post - K 1023506

25 M. North
201 M. East.#1 Post K 1023506
26 M. North
199 M. East.

CHIP SAMPLES

SAMPLE AU(ppb) AS(ppm)

609	9400	2000
609*	9480	
610	378	7900
611	286	132
612	12	720
613	36	200
614	6	260
615	512	4400
616	14	53
618	16	32
619	10	190
620	12	113
621	15000	3700
621*	18620	
622	192	1460
763	8	43
770	10	170
771	24	720
859	860	5200
860	5620	1190
1074	280	6800
1082	82	38
1088	2376	1920
1265	1600	150
1266	15240	

CHANNEL SAMPLES

SAMPLE LENGTH AU(ppb) AS(ppm)

762	163	4	59
764	61	4	115
765	61	8	23
766	55	4	59
767	76	4	200
768	52	4	116
772	76	8	45
773	61	4	173

N

#2 Post.
K 1023507
35' m. South
200 m. East.

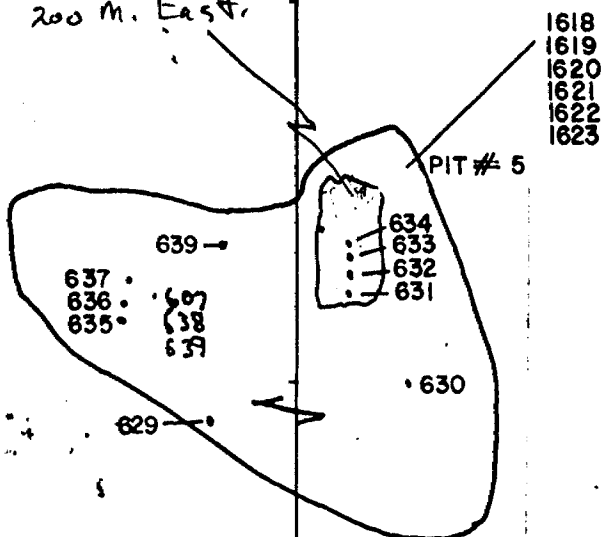

CHIP SAMPLES

SAMPLE	AU(ppb)	AS(ppm)
1068	6	21
629	4	32
630	76	139
631	102	2100
632	1700	177000
633	3740	85000
633*	4240	
634	62	5900
635	120	3500
636	1560	94000
637	128	3300
1618	72	2900
1619	324	3100
1620	380	5500
1621	1044	170000
1622	524	45000
1623	2248	240000

SAMPLE	AU(ppb)	AS(ppm)
624	8	68
625	4	64
626	12	61
627	8	53

• 626
• 627

N
↑

10 m.

K 1023507

Claim line

K 1023506

Area HOUE
Sketch 4

• 625

6	21
4	32
76	139
102	2100
1700	177000
3740	85000
4240	
62	5900
120	3500
1560	94000
128	3300
72	2900
324	3100
380	5500
1044	170000
524	45000
2248	240000

S(ppm)

68
64
61
53

10 M.

K-1023507

K-1023506

Claim line

N
↑

L7+25
PIT#1
1704

1705
PIT#2

#1 Post K 1023506
15 m. South
170 m. East.
|||||

#1 Post K 1023506
15 m. North
175 m. East

Area 7+25E
Sketch 5

S(ppm) K 1023506

726	112	7100
1112	404	4100
1113	24	3100
1149	6	280
1150	22	630

Area 8+50E
Sketch 7

10 M.



#1 Post K1023506
23 m. North
44 m. East

K 1023506

PIT # 3

1127
1128
1129
1130
1105
1104
1103
1102
CHIPS { 1101
1191
1192
1193
1194
1195
1196
1197
1198
1199

1639
1638

1188
1187
1186
1185

1123
1126
1125

7x IM

1156
1155
1154
1153

1152

CHIPS FROM
THIS LENGTH

1100

813
812
811
790
789
788
787
810
809
808
807

1168
1167
1166

697

1098
1099
1097
1095
1094
1093
1092
786
785
784
819
818
806
805
804
803
824
823
822
821
833
832
831
1089

1288
1287
829
830
801
802
828
827
826
825
1280
1281

1151 PIT # 1
1282
1283
1286
1169
1167
1173
1172
1171

1165
1164
1163
1162
1161
1160

PIT # 2

CHANNEL SAMPLES

SAMPLE LENGTH AU(ppb) AS(ppm)

787	70		
788	40		
789	60		
790	40		
801	40	274	5200
802	10	352	82000
803	30	44	150
804	50	140	520

SAMPLE LENGTH AU(ppb)

1176	100	40
1177	100	58
1178	100	56
1179	100	56
1180	100	22
1181	100	80

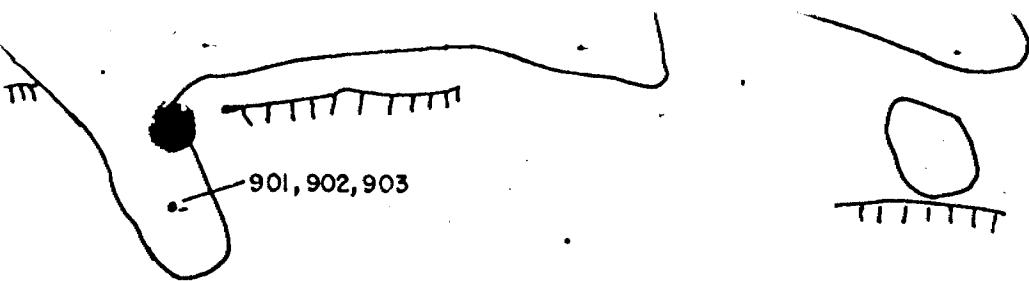

Distances from #4 Post K1023511

Pit 1	- 33m West; 70 m North
Pit 1A	- 35m West; 70 m North
Pit 2	34m West; 68 m North
Pit 3	34 m West; 72 m North
Pit 4	30 m West; 75 m North

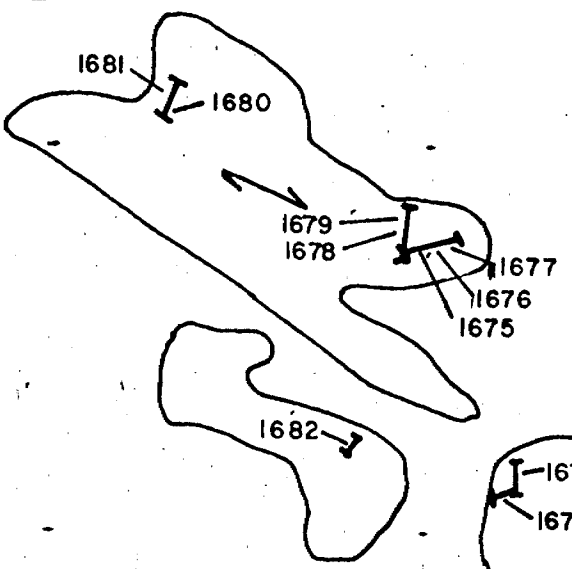

K 1023511

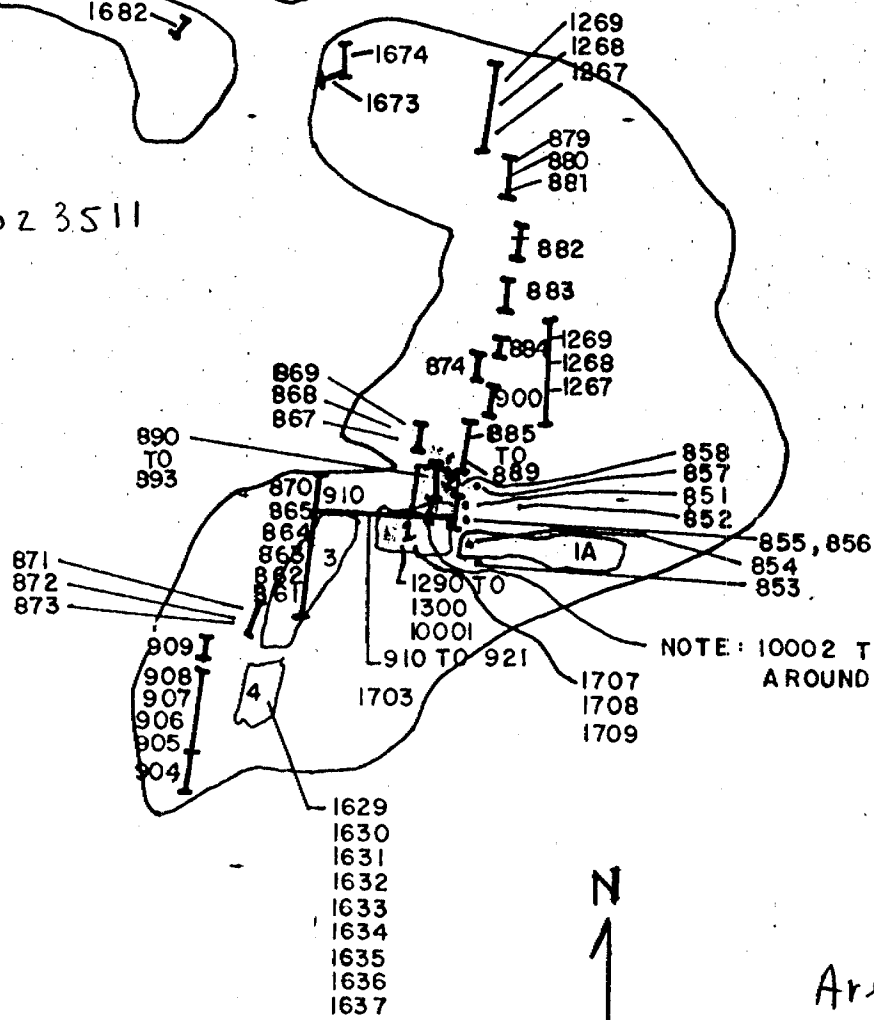

NOTE: 10002 TO 10009 LOCATED AROUND PIT 2

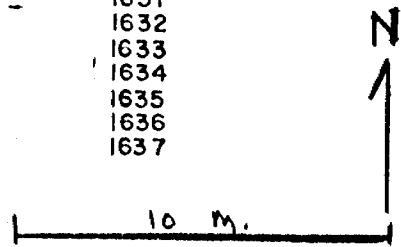

Area 9+35 E
Sketch B

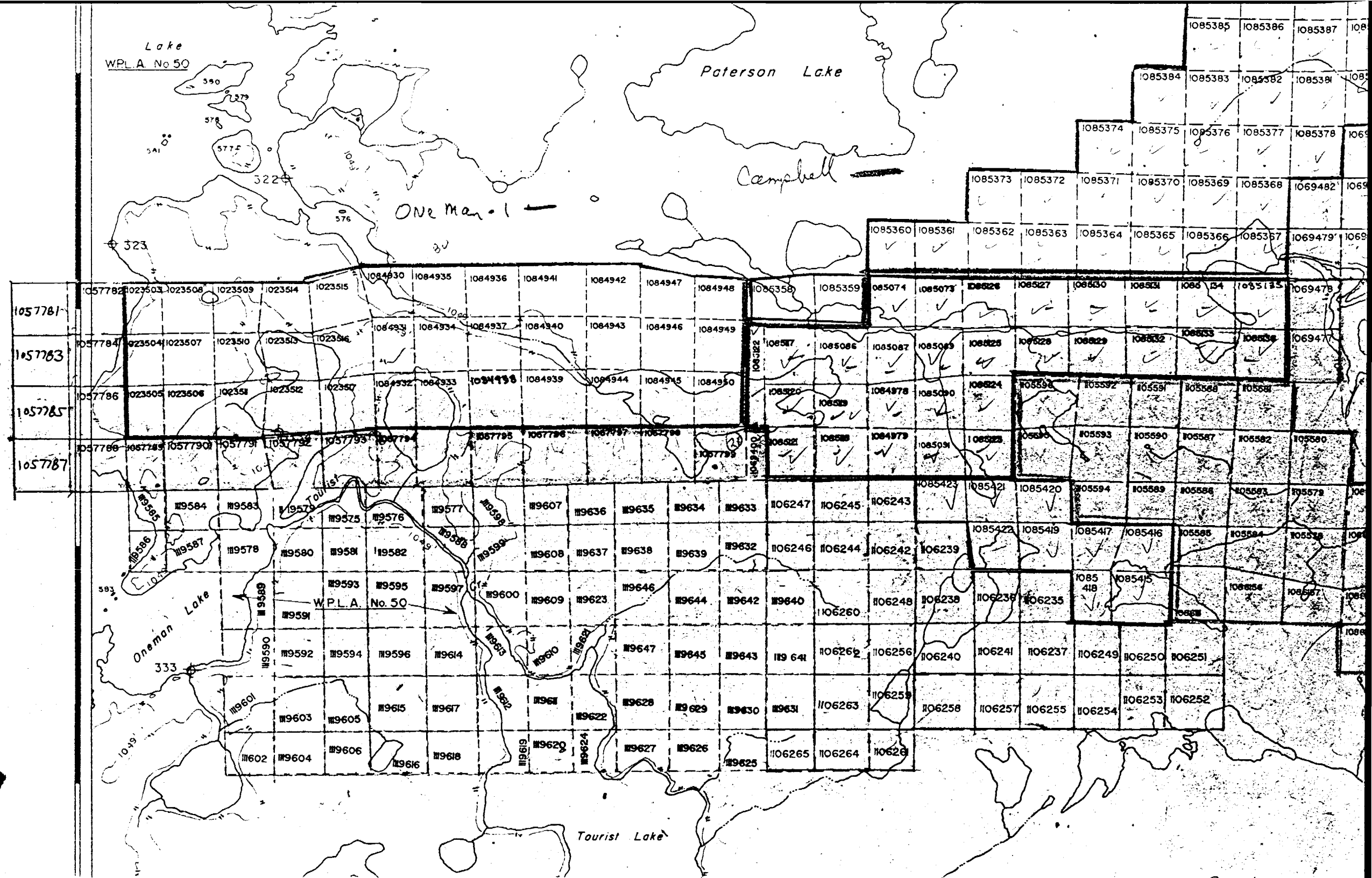



Ministry of
Natural
Resources

Report
of Work

*Assessment
file*

DOCUMENT NO
W9001-218

The Minir.



52L07SE0006 63.5333 PATTERSON PATTERSON LAKE

900

Name and Postal Address of Recorded Holder

Champion Bear Resources Ltd.

Prospector's Licence No.

T 5146

3805 - 7A Street S.W.; Calgary, Alberta; T2T 2Y8

Patterson Lk.

Summary of Work Performance and Distribution of Credits

Total Work Days Cr. claimed 73 1/3	Mining Claim		Work Days Cr.	Mining Claim		Work Days Cr.	Mining Claim		Work Days Cr.
	Prefix	Number		Prefix	Number		Prefix	Number	
for Performance of the following work. (Check one only)	K	1023507	21						
		1023510	40						
		1023511	12 1						
<input type="checkbox"/> Manual Work <input type="checkbox"/> Shaft Sinking Drifting or other Lateral Work. <input checked="" type="checkbox"/> Compressed Air, other Power driven or mechanical equip. <input type="checkbox"/> Power Stripping <input type="checkbox"/> Diamond or other Core drilling <input type="checkbox"/> Land Survey									

All the work was performed on Mining Claim(s): K-1023504, 1023505, 1023506, 1023507, 1023511.

Required Information eg: type of equipment, Names, Addresses, etc. (See Table Below)

See attached schedules and info.

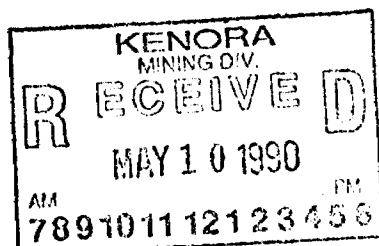
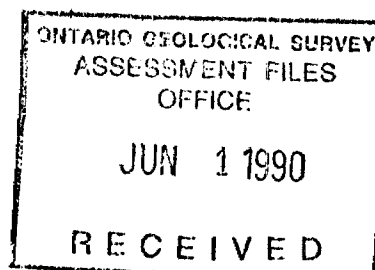

Date of Report <i>May 8, 1990</i>	Recorded Holder or Agent (Signature) <i>[Signature]</i>
--------------------------------------	--

Certification Verifying Report of Work

I hereby certify that I have a personal and intimate knowledge of the facts set forth in the Report of Work annexed hereto, having performed the work or witnessed same during and/or after its completion and the annexed report is true.

Name and Postal Address of Person Certifying

L. C. Chastko; 791 Elmhurst Rd.; Winnipeg, Manitoba; R3R 0V3

Date Certified <i>May 8, 1990</i>	Certified by (Signature) <i>[Signature]</i>
--------------------------------------	--

Table of Information/Attachments Required by the Mining Recorder

Type of Work	Specific information per type	Other information (Common to 2 or more types)	Attachments
Manual Work	Nil	Names and addresses of men who performed manual work/operated equipment, together with dates and hours of employment.	Work Sketch: these are required to show the location and extent of work in relation to the nearest claim post.
Shaft Sinking, Drifting or other Lateral Work			
Compressed air, other power driven or mechanical equip.	Type of equipment	Names and addresses of owner or operator together with dates when drilling/stripping done.	Work Sketch (as
Power Stripping	Type of equipment and amount expended. Note: Proof of actual cost must be submitted within 30 days of recording.		
Diamond or other core	Signed core log showing footage, diameter of		

MECHANICAL ROCK DRILLING

EQUIPMENT: Pionjar 120 Rock Drill

OPERATOR: I.E.S. Ltd.
Winnipeg, Manitoba

DATE: August 6th - 25th, 1989

Personnel: Justin Legarde
Aug. 6 - 8 3 days x 10 hrs/da.
Aug. 22 - 25 4 days x 10 hrs/da.

Kevin Marr
Aug. 6 - 10 5 days x 10 hrs/da.
Aug. 22 - 25 10 days x 10 hrs/da.

TOTAL 22 days 220 hrs.

DAYS CREDIT: $22 \text{ days} \times 10 \text{ hrs/day} = 220 \text{ hrs} / 3 = 73 \frac{1}{3} \text{ days}$

