



52L07SE0017 13 PATTERSON

010

Diamond Drilling

Area of PATERSON LAKE

Report NO 13

Work performed by: Consolidated Summit Mines Limited

Claim NO	Hole NO	Footage	Date	Note
K 415856	76-1	136.0'	Aug/76	(1)
	76-2	102.0'	Aug/76	(1)
	76-3	113.0'	Aug/76	(1)
	76-4	111.0'	Aug/76	(1)
	76-5	202.0'	Aug/76	(1)
	76-6	301.0'	Aug/76	(1)

710

100
6/76

Notes:

(1) #53-76

434855	434848	434847	434846	445927	445930
434849	434850	434851	434852	445928	445931
				445929	445932

#53-76

M-2531 Paterson Lake

K	K	K	K	K
415859	415860	415861	415862	415863
K	K	K	K	K
415858	415857	415856	415855	415854
K	K	K	K	K
415848	415849	415850	415851	415852
			415853	

Tourist Lake

42' 41' 40' 39' 38' 37' 36' 35'

KENORA DIAMOND DRILLING LTD.

P.O. BOX 661

— KENORA, ONTARIO —

PHONE 468-9123

185

KENORA, Ont. August 31 1976

M CONSOLIDATED SUMMIT MINES LIMITED

SUITE 432, 12 RICHMOND STREET EAST, TORONTO M5C 1N1.

					Debit	Credit	Balance
Diamond drilling at Tourist Lake Aug. 5-27, 1976.							
	<u>From</u>	<u>To</u>	<u>Footage</u>				
Hole 75-1	0	136	136	@ 10.85	1475.60		
Hole 75-2	0	102	102	@ 11.85	1106.70		
Hole 75-3	0	113	113	@ 10.85	1226.05		
Hole 75-4	0	111	111	@ 10.85	1204.35		
Hole 75-5	0	202	202	@ 10.85	2191.70		
Hole 75-6	0	301	301	@ 10.85	3265.35		10470.25
		Mobilisation charges			1600.00		12070.25

PROPERTY CONSOLIDATED SUMMIT MINES LTD. PAGE 1 (OF 1)
TOURIST LAKE KENORA AREA ONTARIO

LOCATION SEE DRILL PLAN K-415856 BEARING 333° TRUE HOLE NO. 76-1

LOGGED BY O.F. CARTER ELEVATION _____ DIP -45° FINAL DEPTH 136.0 FEET

STARTED AUGUST 14, 1976 TESTS (CORRECTED) _____

FINISHED AUGUST 16, 1976 NONE

CASING PULLED

CORE SIZE AXT (1 1/4")

FROM	TO	DESCRIPTION
0.0	2.0	<u>CASING</u>
2.0	24.0	<u>DIORITE</u> VERY COARSE TEXTURE. MASSIVE. GREY-WHITE. MUCH BIOTITE. SOME QUARTZ. UP TO 150 CPS RADIOACTIVITY.
24.0	29.0	<u>PEGMATITIC</u> COARSE. SLIGHTLY REDDISH. AVERAGE RADIOACTIVITY 150 CPS. ONE 3" BAND AT 27' WITH CONSIDERABLE BIOTITE IS 300 CPS.
29.0	30.0	<u>DIORITE</u> AS ABOVE.
30.0	34.0	<u>BIOTITE SCHIST</u> FINE, DARK. NO RADIOACTIVITY.
34.0	70.0	<u>DIORITE</u> AS ABOVE.
70.0	75.0	<u>BIOTITE SCHIST</u> 45° CONTACTS.
75.0	93.0	<u>MIXED DIORITIC BANDS IN FINE BIOTITE SCHIST</u> SHARP CONTACTS AT 45° TO CORE.
93.0	136.0	<u>DIORITE</u> AS ABOVE.
		112' - 18" BIOTITE SCHIST, NO RADIOACTIVITY
		121' - 10" " " " "
		130' - 20" " " " "
	136.0	<u>END OF HOLE</u>

O.F. Carter

HOLE NO. 76-1

PROPERTY CONSOLIDATED SUMMIT MINES LTD.
TOURIST LAKE KENORA AREA ONTARIO PAGE 1 (OF 1)

LOCATION 50' FROM 76-1, SEE DRILL PLAN BEARING 333° TRUE HOLE NO. 76-2

LOGGED BY O.F. CARTER ELEVATION _____ DIP -45° FINAL DEPTH 102.0 FT.

STARTED AUGUST 16, 1976 TESTS (CORRECTED) _____

FINISHED AUGUST 17, 1976 NONE

CASING PULLED

CORE SIZE AXT (1 1/4")

FROM	TO	DESCRIPTION
0.0	2.0	<u>CASING</u>
2.0	26.0	<u>DIORITE</u> AS IN HOLE 76-1, BUT WITH NARROW INCLUDED INDEFINITE PEGMATITIC SECTIONS. UP TO 150 CPS. BACKGROUND 100 CPS. 25' - 3" SECTION UP TO 400 CPS, HEAVY BIOTITE.
26.0	28.0	<u>BIOTITE SCHIST</u> DARK, FINE, 45° CONTACTS.
28.0	43.0	<u>DIORITE</u> AS ABOVE. 31' - 12" BIOTITE SCHIST.
43.0	50.0	<u>BIOTITE SCHIST</u> A LITTLE PYRRHOTITE. SLIGHTLY MAGNETIC.
50.0	87.0	<u>DIORITE</u> AS ABOVE.
87.0	102.0	<u>BIOTITE SCHIST</u> 45° CONTACTS.
	102.0	<u>END OF HOLE</u>

O.F. Carter

HOLE NO. 76-2

PROPERTY CONSOLIDATED SUMMIT MINES LTD. PAGE 1 (OF 1)
TOURIST LAKE KENORA AREA ONTARIO

LOCATION 50' FROM 76-2. SEE DRILL PLAN. BEARING 333⁰ TRUE HOLE NO. 76-3

LOGGED BY O.F. CARTER ELEVATION _____ DIP -45⁰ FINAL DEPTH 113.0 FT.

STARTED AUGUST 17, 1976 TESTS (CORRECTED) _____

FINISHED AUGUST 19, 1976 NONE

CASING PULLED

CORE SIZE AXT (1 1/4")

FROM	TO	DESCRIPTION
0.0	5.0	<u>CASING</u>
5.0	91.0	<u>DIORITE</u> AS IN HOLES 76-1 AND 76-2. GREY-WHITE, BIOTITIC. FEW INCLUDED NARROW BANDS BIOTITE SCHIST. SLIGHTLY RADIOACTIVE THROUGHOUT, UP TO 150-200 CPS. 42' - 8" - 200 + CPS, 46' - 14" - 200 + CPS 80' - 6" - 400 + CPS
91.0	113.0	<u>BIOTITE SCHIST</u>
	113.0	<u>END OF HOLE</u>

O.F. Carter

HOLE NO. **76-3**

PROPERTY CONSOLIDATED SUMMIT MINES LTD. PAGE 1 (OF 1)
TOURIST LAKE KENORA AREA ONTARIO

LOCATION 50' FROM 76-3. SEE DRILL PLAN. BEARING 333° TRUE HOLE NO. 76-4

LOGGED BY O.F. CARTER ELEVATION _____ DIP -45° FINAL DEPTH 111.0 FT.

STARTED AUGUST 19, 1976 TESTS (CORRECTED)

FINISHED AUGUST 20, 1976

CASING PULLED NONE

CORE SIZE AXT (1 1/4")

FROM	TO	DESCRIPTION
0.0	5.0	<u>CASING</u>
5.0	42.0	<u>DIORITE</u> AS IN PREVIOUS HOLES. RADIOACTIVITY UP TO 200 CPS IN SHORT SECTIONS.
42.0	47.0	<u>BIOTITE SCHIST</u>
47.0	52.0	<u>DIORITE</u> NARROW INCLUSIONS BIOTITE SCHIST.
52.0	68.0	GRADES TO PEGMATITIC ROCK, PINKISH, CONTAINS LESS BIOTITE THAN DIORITE. COARSE. UP TO 200 CPS.
68.0	72.0	BAND WITH MUCH COARSE BIOTITE AND OTHER FERROMAGS. SOME GARNET. 400 CPS.
72.0	75.0	<u>PEGMATITE</u> UP TO 200 CPS.
75.0	111.0	<u>DIORITE</u> SLIGHTLY RADIOACTIVE. UP TO 150 CPS IN NARROW BANDS.
	111.0	<u>END OF HOLE</u>

O.F. Carter

HOLE NO. 76-4

PROPERTY CONSOLIDATED SUMMIT MINES LTD. PAGE 1 (OF 1)
TOURIST LAKE KENORA AREA ONTARIO

LOCATION 50' FROM 76-4, SEE DRILL PLAN, BEARING 333° TRUE HOLE NO. 76-5

LOGGED BY ROSS KIDD ELEVATION _____ DIP -45° FINAL DEPTH 202.0 FT.

STARTED AUGUST 20, 1976 TESTS (CORRECTED) _____

FINISHED AUGUST 24, 1976

CASING PULLED NONE

CORE SIZE AXT (1 1/4")

FROM	TO	DESCRIPTION
0.0	8.0	<u>CASING</u>
8.0	42.5	<u>DIORITE</u> COARSE GRAINED. 70% PLAGIOCLASE FELDSPAR, 20% QUARTZ, 10% BIOTITE. WHITE. TOTAL GAMMA COUNT AVERAGES 3000 CPM (T ₁ SCALE ON MCPHAR TV-1 THRESHOLD SCINTILLOMETER)
42.5	43.2	<u>BIOTITE SCHIST</u> FINE TO MEDIUM GRAINED. GREY. BROKEN UP. T ₁ = 2000 CPM.
43.2	53.6	<u>DIORITE</u> MILDLY PEGMATIZED LOCALLY. AVERAGES 3500 CPM T ₁ . ONE SPOT AT 65.5' IS 4X B/G.
53.6	60.0	<u>BIOTITE SCHIST</u> DARK GREY. FOLIATED AT 70° TO CORE. FINE GRAINED. T ₁ B/G ABOUT 2000 CPM.
60.0	179.5	<u>DIORITE</u> T ₁ B/G ABOUT 3000 CPM. ONE 2" SPOT AT 124.3' IS TWICE B/G. 84.0 - 86.0: 3X B/G. 134.7': 3X B/G. 135.7': 3X B/G. 140.6': 3X B/G.
179.5	202.0	<u>DIORITE</u> LIGHT GREY. MOTTLED WITH FINE BIOTITE. T ₁ B/G AVERAGES 2000 CPM.
	202.0	<u>END OF HOLE</u>

Ross Kidd

HOLE NO. 76-5

PROPERTY CONSOLIDATED SUMMIT MINES LTD. PAGE 1 (OF 1)
TOURIST LAKE KENORA AREA ONTARIO

LOCATION 33' FROM HOLE 76-4. SEE PLAN BEARING 153° TRUE HOLE NO. 76-6

LOGGED BY ROSS KIDD ELEVATION _____ DIP -45° FINAL DEPTH 301.0 FT.

STARTED AUGUST 24, 1976 TESTS (CORRECTED) _____

FINISHED AUGUST 27, 1976

CASING PULLED NONE

CORE SIZE AXT (1 1/4")

FROM	TO	DESCRIPTION
0.0	22.0	<u>CASING</u>
22.0	301.0	<u>DIORITE</u> IVORY COLOURED, WITH FINE DARK BIOTITE MOTTLING. ABOUT 70% PLAGIOCLASE FELDSPAR, 20% QUARTZ, AND 10% BIOTITE. MEDIUM TO COARSE GRAINED. T, TOTAL GAMMA COUNT AVERAGES ABOUT 3500 CPM TO 100', THEN 3000 CPM TO 150', THEN 2500 CPM TO 200', THEN 2000 CPM TO 301'. 63.3 - 74.4: FELDSPATHIC SECTION. MUCH LESS QUARTZ. MORE RADIO-ACTIVE; ABOUT 2X B/G. 99.0 - 100.5: FELDSPATHIC SECTION. 1 1/2 XB/G.
	301.0	<u>END OF HOLE</u>

Ross Kidd

HOLE NO. 76-6

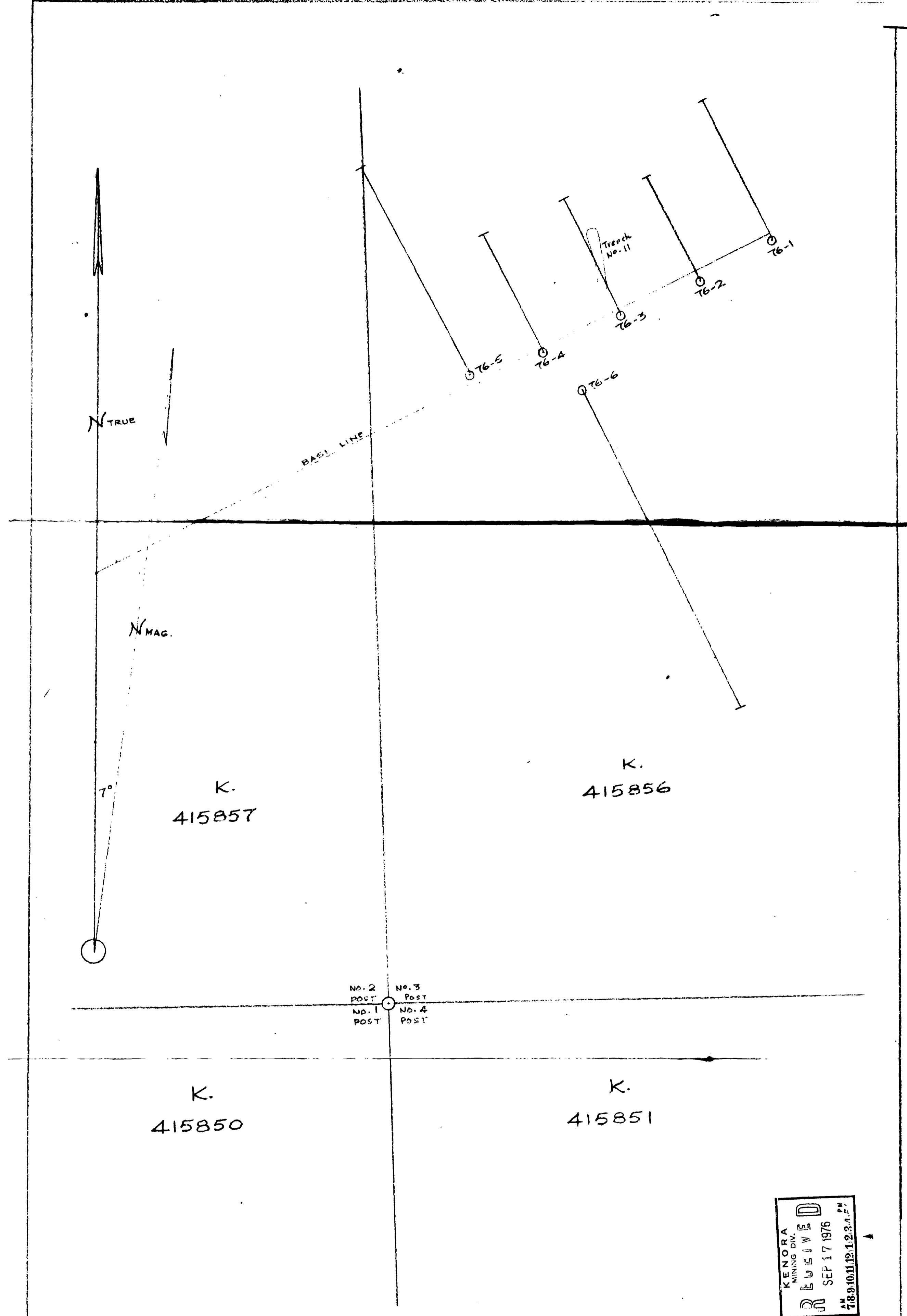

LOCATION OF DRILL HOLES 76-1 to 76-6
 CONSOLIDATED SUMMIT MINES LIMITED
 TOURIST LAKE KENORA AREA ONTARIO

SCALE: 1 IN. = 40 FT.

